

NOTE: ALL STAKING & GUYS SHALL BE REMOVED APPROXIMATELY 9 MONTHS AFTER PLANTING OR AS DIRECTED BY LANDSCAPE ARCHITECT

NOTES:

- CONTAINER GROWN SHRUBS - LOOSEN ROOTS AT EDGE OF ROOTBALL
- BALL IN BURLAP SHRUBS - CUT & REMOVE BURLAP FROM TOP 1/3 OF ROOTBALL
- WHERE SHRUBS & GROUNDCOVER ARE PLANTED IN BEDS, EXCAVATE ENTIRE BED & FILL W/ PLANTING BACKFILL MIXTURE
- DEPTH OF PLANTING PIT SHALL NOT BE LESS THAN 1-1/2 TIMES THE DEPTH OF THE ROOTBALL

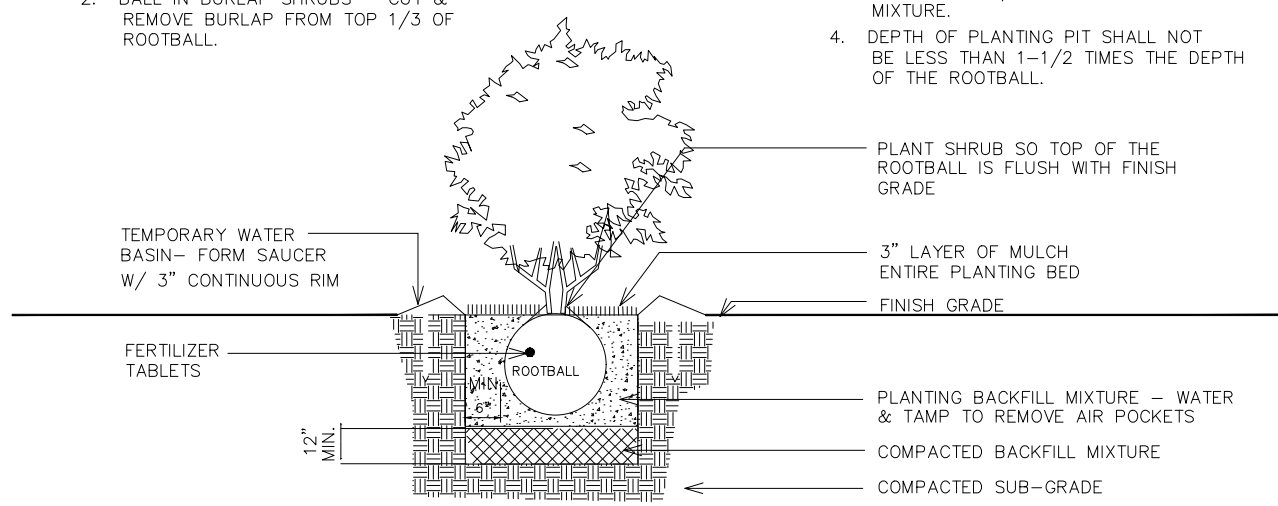

SHRUB PLANTING DETAIL

NOTES:

- SET TREE PLUMB & TREE TO GRADE
- PLANT TREES SO THAT THE TOP OF ROOTBALL IS FLUSH WITH FINISH GRADE
- ALL STAKING & GUYS SHALL BE REMOVED APPROXIMATELY 9 MONTHS AFTER PLANTING OR AS DIRECTED BY LANDSCAPE ARCHITECT

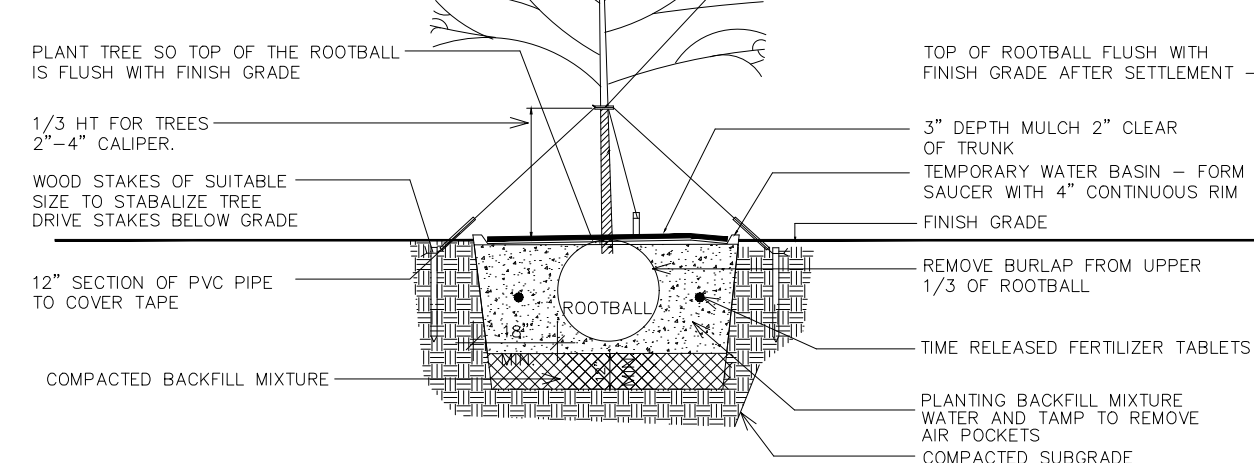

TREE STAKING DETAIL

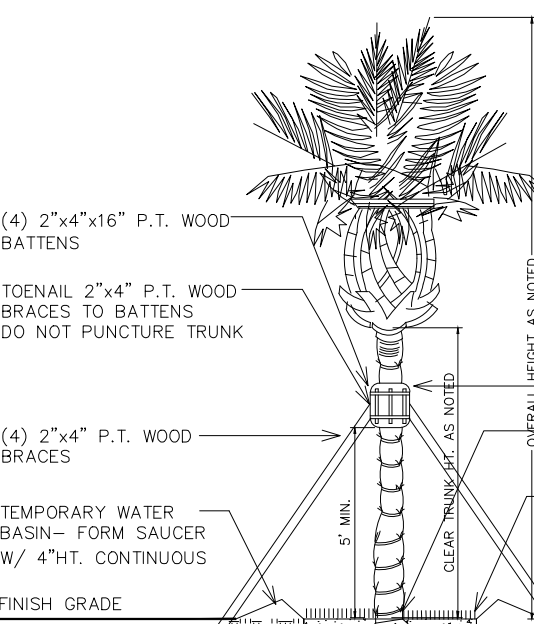

PALM PLANTING DETAIL

NOTE: NO WELLINGTON TAPE OR OTHER NON-BIODEGRADABLE MATERIALS SHALL COME INTO CONTACT WITH THE TREE.

Plant List for Proposed Plant Material

Sym	Qty	Botanical/ Common Name	Size	Native
TR	2	Thrinax radiata/ Thatch Palm	12' OA HT	yes
AF	2	Acacia farnesiana/ Sweet Acacia	5' Ht, std	yes
MF	2	Myrcianthes fragrans/ Simpson's Stopper	10' Ht x 4' Spr, 2' Cal	yes
CI	12	Chrysobalanus icaco/ Coccolup	24" x 24", 24" O.C.	yes
PM	45	Podocarpus macrophyllus/ Podocarpus	24" x 24", 24" O.C.	no
BE	24	Begonia odorata/ Alba/ White Angel	16" x 16", 24" O.C.	no
NE	18	Neoregelia Bossa Nova/ Bossa Nova	16" x 16"	no
IV	16	Ilex vomitoria/ Stokes Dwarf/ Ilex	9" x 12", 18" O.C.	yes
NF	13	Nephrolepis exaltata/ Boston Fern	20" x 20", 24" O.C.	yes
BA	15	Bambusa textilis gracilis/ Slender Weavers Bamboo	6' Ht, 5 stem min	no
PB	16	Philodendron Burle Marx/ Burle Marx	16" x 16", 24" O.C.	no
Mulch		Shredded Eucalyptus, Melaleuca or recycled mulch		

Landscape Legend

Zoning District: RPS-2 Lot Area: 2656.65 sf Acres: .06 AC		REQUIRED/ ALLOWED	PROVIDED
OPEN SPACE			
A. Square feet of required Open Space as indicated on site plan: Lot Area = 2656.65 s.f. x .65% = 1726.8 sf		1726.8 sf	2075 sf
B. Square feet of parking lot open space required as indicated on site plan: Number of parking spaces 0 x 10 s.f. parking space =		0	0
C. Total square feet of landscaped open space required: A+B=		1726.8 sf	2075 sf
LAWN AREA CALCULATION			
A. Square feet of landscaped open space required			
B. Maximum lawn area (sod) permitted= 20% x 1726.8 s.f.		345 sf	0
TREES			
A. Number of trees required per lot or net lot acre, less existing number of trees meeting minimum requirements= 22 trees x .06 net lot acres - number of existing trees=		2	3
B. % Natives required: Number of trees provided x 30% =		1	2
C. % Low maintenance / drought and salt tolerant required: Number of trees provided x 50% =		1	2
D. Street Trees (maximum average spacing of 20' o.c.) 47.4 LF along street divided by 20' =		3	2
E. Street tree species allowed directly beneath power lines: (maximum average spacing of 20' o.c.): 47.4 linear feet along street divided by 20' =		3	2
SHRUBS			
A. Number of shrubs required: Sum of lot and street trees x 12 =		60	161
B. % Native shrubs required: Number of shrubs x 50% =		30	41
LARGE SHRUBS OR SMALL TREES			
A. Number of large shrubs or small trees required: Number of required shrubs x 10% =		6	17
B. % Native large shrubs or small trees required: Number of large shrubs or small trees provided x 50% =		3	3

General Notes:

- All plant material shall be Florida No. 1 or better as given in the current Florida Grades and Standards for Nursery Plants, 2015, Florida Department of Agriculture and Consumer Services.
- All plant materials shall be subject to inspection and approval by the Landscape Architect at place of growth and upon delivery for conformity to specification.
- All plants shall be true to species and variety and shall conform to measurements specified. All substitutions shall be submitted to the City and Landscape Architect for final approval.
- All plants shall be exceptionally heavy, symmetrical, tight knit and so trained in appearance as to be superior to form, branching and symmetry.
- Contractor shall notify Sunshine 811 (call 811) for locations of existing utility lines 48 hours prior to beginning work. Contractor shall verify location of all utility lines and easements prior to commencing any work. Excavation in the vicinity of underground utilities shall be undertaken with care and by hand, if necessary. The Contractor bears full responsibility for this work and disruption or damage to utilities shall be repaired immediately at no expense to Owner.
- Grade B+, shredded sterilized Eucalyptus mulch shall be used in all mass planting beds and for individual tree pits. All trees shall have a mulch ring with a depth of 3" and a diameter of 3'-4" around their base. All mulch shall be kept 4" from base of all plant material. Mulch beds shall be a minimum of 12" wider than plants measured from outside edge of foliage.
- Sod shall be St Augustine and free of weeds, insects, fungus and disease, laid with alternating and abutting joints.
- All trees and shrubs shall be backfilled with a suitable planting soil consisting of 50 percent sand and 50 percent approved compost. All plant materials shall be planted with a minimum of 6 to 18 inches of planting soil around the root ball. Refer to planting details. Planting soil to be backfilled into plant pits by washing in. Planting beds shall be free from road, pea, egg or colored rock, building materials, debris, weeds, noxious pests and disease.
- All sodded areas to have a minimum of 2" of planting soil as described in note #8.
- All trees shall be warranted by the Contractor and will be healthy and in flourishing condition of active growth one year from date of final acceptance.
- All shrubs, groundcovers, vines and sod shall be fully warranted for 90 days under same condition as above.
- All synthetic burlap, synthetic string or cords or wire baskets shall be removed before any trees are planted. All synthetic tape shall be removed from trunks, branches, etc before inspection. The top 1/3 of any natural burlap shall be removed or tucked into the planting hole before trees are backfilled. Planting soil to be backfilled into pits by washing in.
- All trees, palms and other plants shall be planted with the top of their rootballs no deeper than the final grade surrounding the planting area.
- In areas where paved surfaces about sod or mulch, the final level of both surfaces should be even.
- All planting shall be installed with fertilizer at time of planting.
- All planting shall be installed in a sound, workmanlike manner and according to good planting procedures. Installation shall include watering, weeding, fertilizing, mulching, selective pruning and removal of refuse and debris on a regular basis so as to present a neat and well kept appearance at all times.
- All landscape and sod areas shall have an automatic irrigation system installed. Coverage should be 100% with 50% minimum overlap using rust free water to all landscape and sod areas. Spray upon public sidewalks, streets and adjacent properties should be minimized. Sodded areas and shrub/ groundcover beds should be on separate irrigation zones when feasible for a more efficient system. Irrigation system shall be installed with a rainswitch device.
- All landscape and irrigation shall be installed in compliance with all local codes.
- The plan shall take precedence over the plant list, should there be any discrepancy between the two.

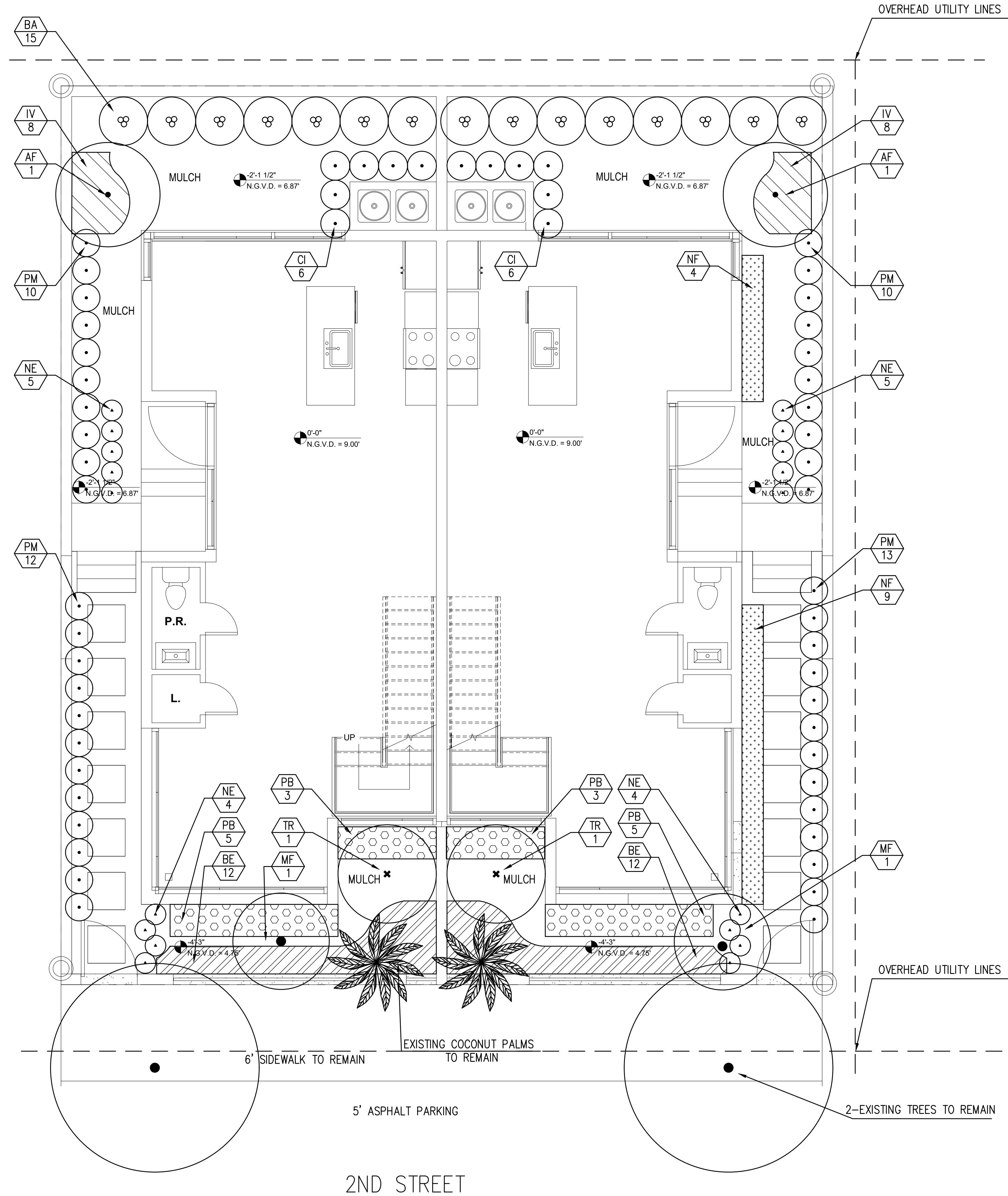

NOTE: A tree removal permit is required prior to the removal of any trees on site.

1 LANDSCAPE PLAN
1/4" = 1'-0"



REVISIONS