

LANDSCAPE NOTES

- ALL PLANT MATERIAL SHALL BE FLORIDA GRADE NO. 1 OR BETTER.
- CONTRACTOR SHALL BECOME FAMILIAR WITH THE LOCATION OF, AVOID, AND PROTECT ALL UTILITY LINES, BURIED CABLES, AND OTHER UTILITIES.
- TREE, PALM, ACCENT AND BED LINES ARE TO BE LOCATED IN THE FIELD AND APPROVED BY THE LANDSCAPE ARCHITECT PRIOR TO INSTALLATION.
ANY CHANGES TO R.O.W. (RIGHT OF WAY) MATERIAL IN REGARDS TO PLACEMENT OF SPECIES SHALL REQUIRE THE APPROVAL AND CONSULTATION OF THE CITY URBAN FORESTER AND OR CITY STAFF.
- ALL PLANTING SOIL SHALL BE 50:50 TOPSOIL:SAND MIX, FREE OF CLAY, STONES, ROCKS, OR OTHER FOREIGN MATTER. THIS SPECIFICATION INCLUDES ALL BACKFILL FOR BERMS AND OTHER LANDSCAPE AREAS.
CARE SHALL BE TAKEN TO AVOID PLACEMENT OF CONSTRUCTION FILL, GRAVEL, AND OR DEBRIS OVER THE ROOTBALLS OF INSTALLED OR EXISTING TREES AND OR PALMS ON SITE.
SODDED-LAWN AREAS
2" DEPTH PLANTING SOIL SPREAD IN PLACE- THROUGHOUT.
GROUND COVER PLANTING BEDS
6" DEPTH PLANTING SOIL SPREAD IN PLACE- THROUGHOUT.
SHRUB AND HEDGE PLANTING AREAS
12" DEPTH PLANTING SOIL SPREAD IN PLACE- THROUGHOUT.
TREES, PALMS, SPECIMEN PLANT MATERIAL LOCATIONS
REMOVE ALL LIMEROCK PRESENT TO A DEPTH OF AT LEAST 30" BEFORE PLACING NEW PLANTING SOIL.
APPLY NEW CLEAN PLANTING SOIL IN PLANTING AREA AS REQUIRED
LANDSCAPE ISLANDS AND BUILDING FOUNDATIONS
EXCAVATE AND REMOVE ALL LIMEROCK, ROCKS, DEBRIS, ETC. TO A DEPTH OF 12" AND BACKFILL W/ 50:50 TOPSOIL:SAND MIX. BUILDING FOUNDATIONS SHALL BE THE SAME DEPTH TO A WIDTH OF 36" FROM THE BUILDING BASE.
5. THE SITE CONTRACTOR SHALL BE RESPONSIBLE TO BRING ALL GRADES TO WITHIN 2" OF FINAL GRADES. THIS SHALL INCLUDE A 2" APPLICATION OF 50:50 TOPSOIL:SAND MIX FOR ALL LANDSCAPE AND AREAS TO BE SODDED.
6. THE LANDSCAPE CONTRACTOR SHALL CALCULATE AND SUBMIT AN ITEMIZED PRICE FOR THE 2" APPLICATION OF 50:50 MIX FOR ALL SOD AREAS AS A REFERENCE IN THE CASE THAT THERE WOULD BE A DISCREPANCY BETWEEN SITE AND LANDSCAPE CONTRACTORS AND NOTIFY THE SITE CONTRACTOR OR PROJECT SUPERINTENDENT AS TO THIS DISCREPANCY. IT WILL THEN BE DETERMINED WHICH PARTY WILL PROVIDE THIS 2" TOPSOIL:SAND APPLICATION AND SUBSEQUENT PAYMENT OTHER PLANTING SOIL MIXES TO BE ADDED, I.E. FOR TREES, PALMS, SPECIMEN PLANTS, SHRUBS AND GROUNDCOVERS SHALL BE THE RESPONSIBILITY OF THE LANDSCAPE CONTRACTOR AND BE INCLUSIVE WITH THE LANDSCAPE BID.
7. CONTRACTOR SHALL COORDINATE WITH THE IRRIGATION CONTRACTOR AND LEAVE PROVISIONS FOR ALL SLEEVING AND PIPE ROUTING. ALL UNDERGROUND UTILITIES TO BE LOCATED BY DIALING 811 AS REQUIRED BY LAW.
8. ALL PLANTING BEDS SHALL BE MULCHED TO A DEPTH OF 2" WITH A SMALL GRAY GRANITE AGGREGATE FREE FROM WEEDS AND PESTS. NO 'CYPRESS MULCH' OR 'RED DYED MULCH' TO BE ACCEPTED. KEEP MULCH 3" AWAY FROM TREE OR PALM TRUNKS AS PER INDUSTRY RECOMMENDATIONS.
9. SOD SHALL BE 'EMPIRE TURF' ZOYSIA GRASS IN ALL LAWN AREAS AS SHOWN ON THE PLANS. SOD SHALL BE STRONGLY ROOTED, FREE FROM WEED, FUNGUS, INSECTS AND DISEASE. CONTRACTOR SHALL SOD ALL AREAS AS INDICATED ON THE PLANS OR AS DIRECTED. PAYMENT SHALL BE DETERMINED BY THE TOTAL MEASURED SODDED AREAS X THE UNIT PRICE SUBMITTED AND FIELD VERIFIED. SOD SHALL CARRY A 5-MONTH WARRANTY.

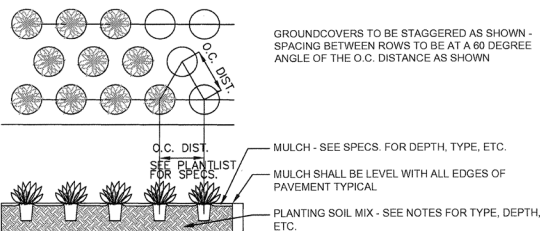

GROUND COVER PLANTING DETAIL

N.T.S.

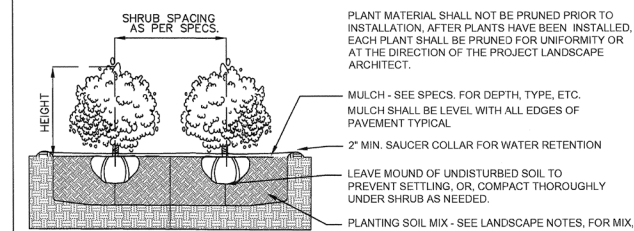

SHRUB PLANTING DETAIL

N.T.S.

IRRIGATION NOTES

- IRRIGATION CONTRACTOR SHALL PROVIDE, FURNISH, AND INSTALL A FULLY AUTOMATIC IRRIGATION SYSTEM WHICH WILL COMPLY WITH ALL LOCAL CODE, STATE CODE, & WATER MANAGEMENT DISTRICT (SWFMD) REQUIREMENTS.
- THE IRRIGATION CONTRACTOR SHALL SCHEDULE AN ON-SITE PRE-CONSTRUCTION CONFERENCE WITH THE OWNER AND THE OWNER'S AUTHORIZED REPRESENTATIVE PRIOR TO COMMENCEMENT OF INSTALLATION OF THE IRRIGATION SYSTEM.
- CONTRACTOR SHALL INSTALL POP-UP TYPE HEADS. SPRAY TYPE SHALL BE ROTOR, IMPACT, SPRAY, OR BUBBLER AND SHALL BE INSTALLED SO AS NOT TO CAUSE ANY OVERSPRAY ONTO ANY PAVED SURFACES, I.E. ROADS, SIDEWALKS, ETC. ALL FIXTURES SHALL BE "TORO", "RAINBIRD" OR AN APPROVED EQUAL. ALL WORK SHALL BE DONE IN A PROFESSIONAL MANNER AS PER MANUFACTURER'S SPECIFICATIONS.
- ALL MAIN SUPPLY LINE SHALL BE PVC SCHEDULE 40 PIPE. ALL PVC FITTINGS SHALL BE SCHEDULE 40. THE MAINLINE IS SHOWN SCHEMATICALLY. LOCATE MAIN LINES IN LANDSCAPE AREAS WHERE POSSIBLE AND SLEEVE UNDER PAVEMENT WHERE NECESSARY. MAINLINES SHALL BE IN THE SAME TRENCH WITH THE LATERAL LINES WHERE POSSIBLE.
- CONTRACTOR SHALL FAMILIARIZE HIMSELF WITH THE LOCATION OF AND AVOID & PROTECT ALL UTILITY LINES, DUCTS, BURIED CABLES AND OTHER UTILITIES IN THE AREA. CONTRACTOR WILL BE RESPONSIBLE FOR THE REPAIR, LIABILITY, AND COSTS INCURRED IN THE DAMAGE OR DESTRUCTION OF SAID UTILITIES. CALL SUNSHINE STATE ONE CALLS 811, 48 HOURS PRIOR TO COMMENCEMENT OF ANY WORK FOR PROPER UTILITY LOCATION AND CLEARANCES.
- THE CONTRACTOR SHALL SECURE ALL WORK WITH THE PROJECT MANAGER, LANDSCAPE CONTRACTOR AND ALL OTHER CONTRACTORS TO INSURE PROPER INSTALLATION, SCHEDULING AND PROCEDURE.
- THE CONTRACTOR SHALL COORDINATE WITH THE PROJECT MANAGER TO PROVIDE ELECTRICAL SUPPLY TO THE CONTROLLER, PUMP, ETC. AS NEEDED.
- THE CONTRACTOR SHALL BE RESPONSIBLE TO SECURE ALL PERMITS AS MAY BE DEEMED NECESSARY TO PERFORM THE WORK. ENTIRE SYSTEM SHALL BE INSTALLED IN COMPLIANCE WITH ALL LOCAL AND STATE CODES.
- ALL SLEEVES UNDER PAVEMENT SHALL BE BURIED PER FLORIDA BUILDING CODE, APPENDIX "F". ALL LATERAL SLEEVES UNDER SIDEWALKS SHALL BE BURIED BELOW WALKWAYS AND SHALL BE SCHEDULE 40 PVC. ALL SLEEVING SHALL BE SCHEDULE 40 PVC PIPE AND SHALL BE 2 TIMES THE MAIN OR LATERAL PIPE SIZE.
- THE CONTRACTOR SHALL CONNECT THE MASTER VALVE (WHEN APPLICABLE) AND ALL ELECTRIC VALVES TO THE CONTROLLER AND PROVIDE PROPER SYNCHRONIZATION.
- ALL LOW VOLTAGE ELECTRIC VALVES SHALL BE #14 DIRECT BURIAL. ALL WIRES UNDER ROADS TO BE PLACED IN A SEPARATE 1" SLEEVE. CONTRACTOR SHALL PROVIDE A MINIMUM OF TWO EXTRA WIRES FOR EMERGENCY POST INSTALLATION WIRING.
- ALL LINE LOCATIONS ARE APPROXIMATE. THE CONTRACTOR SHALL ADJUST TRENCHING AND LOCATION OF SPRAY HEADS IN THE FIELD FOR EXISTING CONDITIONS, WALKS, UTILITIES, STRUCTURES, AND PLANTINGS TO PROVIDE AND INSURE 100% COVERAGE AND 100% OVERLAP.
- CONTRACTOR SHALL PROVIDE A ONE-YEAR GUARANTEE ON ALL PARTS AND A 90 DAY GUARANTEE ON LABOR FROM THE DATE OF FINAL ACCEPTANCE.
- THE IRRIGATION CONTRACTOR SHALL RECORD ALL CHANGES MADE TO THE IRRIGATION SYSTEM DURING INSTALLATION, AND PROVIDE AN AS-BUILT DRAWING TO THE OWNER'S REPRESENTATIVE UPON COMPLETION AND ACCEPTANCE OF THE WORK.
- THE IRRIGATION CONTRACTOR SHALL INSTRUCT THE OWNER OR THE OWNER'S REPRESENTATIVE IN THE COMPLETE OPERATION AND MAINTENANCE OF THE SYSTEM. THE CONTRACTOR SHALL FURNISH TWO COPIES OF AN IRRIGATION SYSTEM MANAGEMENT MANUAL PREPARED BY THE MANUFACTURER AND THE SYSTEM INSTALLER.

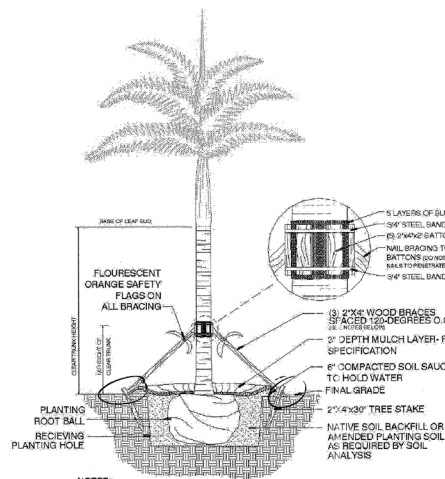

M.B. PALM PLANTING DETAIL

N.T.S.

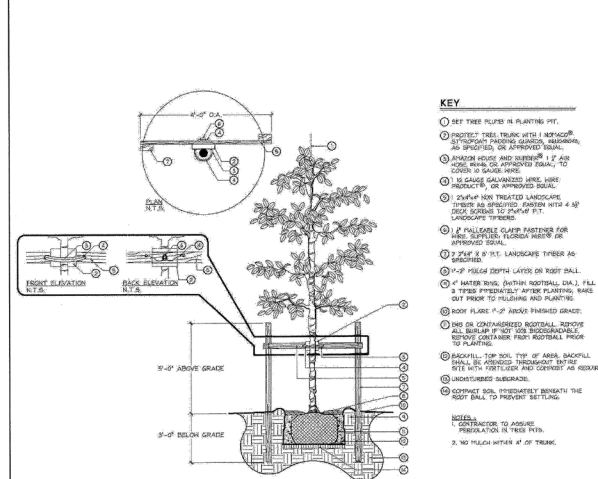

M.B. MEDIUM TREE PLANTING DETAIL

N.T.S.

C.M.B. PUBLIC WORKS / GREENSPACE MANAGEMENT COMMENTS

- SHOULD ANY EXISTING TREES OR PALMS BE DAMAGED THEY SHALL BE EVALUATED BY THE CITY URBAN FORESTER TO DETERMINE CORRECTIVE ACTIONS THAT MAY INCLUDE REMOVAL, CORRECTIVE PRUNING AND OR REPLACEMENT. ANY CORRECTIVE ACTIONS REQUIRED SHALL BE PERFORMED IN ACCORDANCE WITH MIAMI BEACH CODE, THE MOST CURRENT ANSI A-300 PRUNING STANDARDS AND OR AN ISSUED CITY OF MIAMI BEACH TREE WORK PERMIT. ANY CORRECTIVE PRUNING REQUIRED SHALL BE PERFORMED BY AN ISA CERTIFIED ARBORIST AND THE CITY URBAN FORESTER SHALL BE CONSULTED.
- CARE SHALL BE TAKEN TO AVOID UTILITY OR CONSTRUCTION TRENCHING THROUGH EXISTING TREE OR PALM DRIPLINES OF TREES SLATED TO REMAIN IN PLACE OR BE RELOCATED. IF CONSTRUCTION REQUIRES THE CUTTING OF ANY ROOTS WITH A DIAMETER OF 2" OR GREATER, ROOTS SHALL BE CLEANLY CUT WITH A SHARP TOOL, AS DIRECTED BY AN ISA CERTIFIED ARBORIST, AND IN ACCORDANCE WITH THE ANSI A-300 STANDARDS. CUT ROOTS SHOULD BE IMMEDIATELY COVERED WITH SOIL TO PREVENT DRYING. ROOTS SHOULD NOT BE TORN OR BROKEN BY HEAVY EQUIPMENT, AND NO SHREDDED, RAGGED OR BROKEN ROOT ENDS SHOULD BE LEFT. THE CITY URBAN FORESTER SHALL BE NOTIFIED IN WRITING AND OR CONSULTED PRIOR TO ANY ROOT PRUNING TAKING PLACE.
- SHOULD ANY CORRECTIVE STRUCTURAL PRUNING BE NECESSARY FOR TREES PROPOSED TO REMAIN ONSITE, DUE TO CLEARANCE, SAFETY OR FOR CONSTRUCTION RELATED REASONS THE PRUNING SHALL BE PERFORMED BY AN ISA OR ASCA CERTIFIED ARBORIST IN ACCORDANCE WITH THE LATEST VERSION OF THE ANSI A-300 PRUNING STANDARDS AND GOOD HORTICULTURAL PRACTICES. THE CITY URBAN FORESTER SHALL BE PROVIDED WITH A WRITTEN COPY OF THE PROPOSED PRUNING PLAN INCLUDING THE REASONS WHY PRUNING IS NECESSARY, PRIOR TO THE PRUNING ACTIVITIES TAKING PLACE.
- ANY ROOT PRUNING, IF REQUIRED DURING THE PROJECT, SHALL BE CONDUCTED UNDER THE SUPERVISION OF AN ISA CERTIFIED ARBORIST OR ASCA CONSULTING ARBORIST. ANY ROOT PRUNING, IF REQUIRED, WILL BE LIMITED TO WHAT IS ABSOLUTELY NECESSARY FOR CONSTRUCTION. ADDITIONALLY, AND ROOT PRUNING WORK WILL BE DOCUMENTED WITH COLOR PICTURES AND PROVIDED TO MR. MARK WILLIAMS AT C.M.B. PUBLIC WORKS / GREENSPACE MANAGEMENT + MR. RICARDO GUZMAN AT C.M.B. PLANNING + ZONING DEPARTMENTS ON A REGULAR BASIS.

City of Miami Beach
Planning Department

Landscape Review
APPROVED AS NOTED

Eq. 11/24/15

REFER TO
REVISED
CMB DETAILS

CHRISTOPHER CAWLEY CC
LANDSCAPE ARCHITECTURE LLC LA
Florida Landscape Architecture Business LC 26000460
780 NE 69th Street | Suite 1106 | Miami, FL 33138
T 305.979.1585 | www.christophercawley.com

LANDSCAPE NOTES + DETAILS

REVISIONS / SUBMISSIONS

1	
2	
3	
4	
5	
6	
7	
8	
9	
10	
11	
12	
13	
14	
15	

1561

ALL DRAWINGS AND WRITTEN MATERIAL APPEARING HEREIN CONSTITUTE THE ORIGINAL AND UNPUBLISHED WORK OF KOBKARP AIA, AND MAY NOT BE DUPLICATED, USED, OR DISCLOSED WITHOUT THE EXPRESS WRITTEN CONSENT OF KOBKARP ARCHITECTURE & INTERIOR DESIGN LLC AIA (c) 2015.

STAR ISLAND RESIDENCE

6 STAR ISLAND DRIVE
MIAMI BEACH, FL 33139

CHRISTOPHER CAWLEY, AIA
Florida Landscape Architect

10.07.2015

Lic. # AR0012578

ARCHITECTURE
INTERIOR DESIGN
PLANNING

AIA ASID NCARB

2915 Biscayne Boulevard
Suite 200
Miami, Florida 33137
O 305.273.1818
F 305.273.3766

WWW.KOBKARP.COM

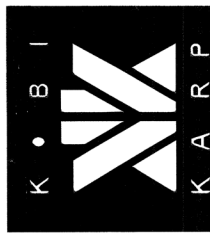

DRAWN BY:
CHECKED BY:
DATE: 10/07/2015

L-4

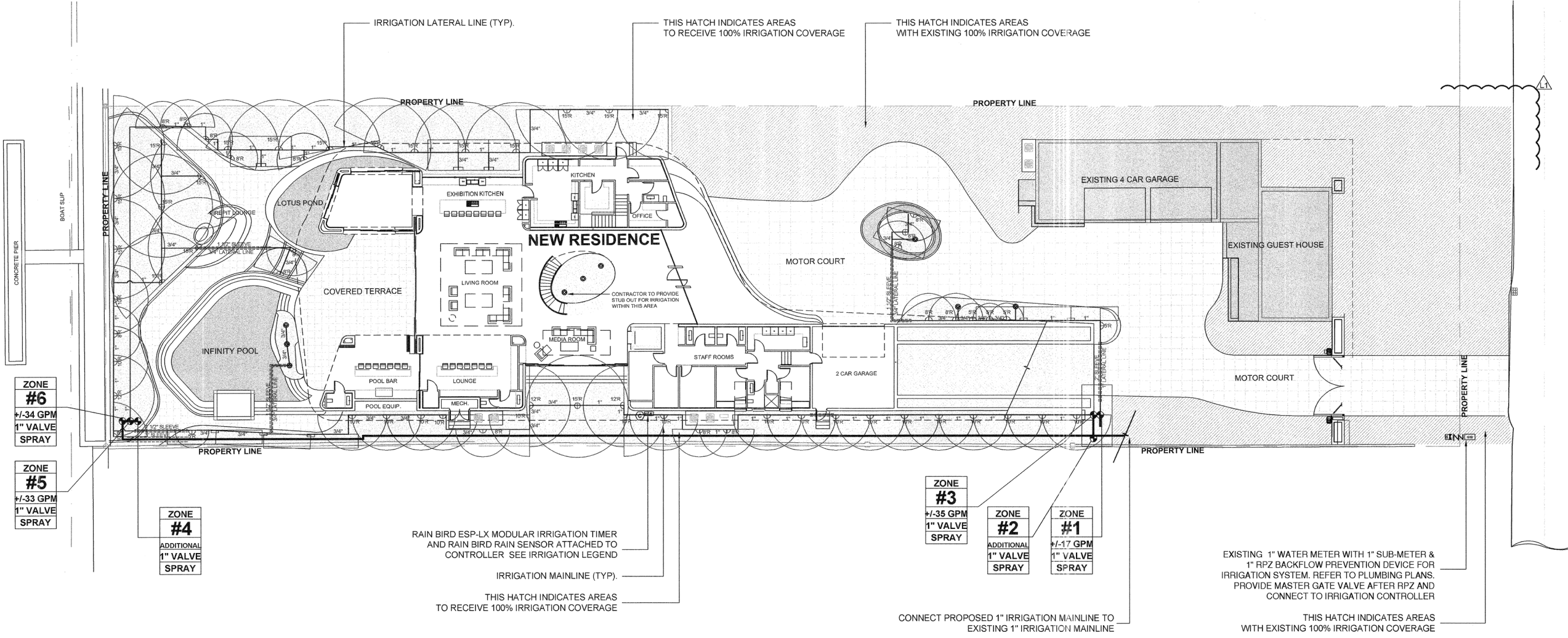

IRRIGATION INSTALLATION NOTES

PROVIDE ADDITIONAL ZONES TO ACCOMMODATE FUTURE LANDSCAPE EXPANSION

LOCATION OF IRRIGATION LINES IS SHOWN SCHEMATICALLY, FIELD ADJUST AS NECESSARY TO AVOID TRENCHING THROUGH EXISTING TREE OR PALM DRIPLINES

- P+Z COMMENTS DATED 11.13.15**
1. Coordinated with Architect to provide a revised Existing Tree Disposition + Protection Plan that also includes the location of temporary construction parking layout. (See Sheet L-1)
 2. Coordinated with Civil Engineer to address retention + protection of existing trees on Grading / Drainage Plans. (See Civil Engineer's Plans)
 3. Land surveyor has verified the location of Mahogany Tree #12. Autocourt and drive areas have been adjusted to be a min. of 10' distance from face of tree trunk. (See Sheet L-2)
 - 4.5. Prior to demolition permit approval, a copy of the CMB Tree Removal Permit will be provided and temporary fences shall be approved on site by MB P+Z / Mr. Ricardo Guzman.
 6. There is very limited planting currently located in the ROW area, and the majority of ROW area is currently open lawn. Please note that there is an extensive tropical garden located on private property adjacent to the ROW line. Based on the beauty of the existing tropical landscape, the Land. Arch. requests to keep the existing conditions as is, and have the (4) canopy street tree requirement waived.
 7. Modified Landscape Plans to include A/C equipment and provided 6' Podocarpus where screening is necessary. (See Sheets L-1, L-1a, L-2 and L-5)

IRRIGATION LEGEND

- WM 1" IRRIGATION METER REFER TO CIVIL ENGINEER'S PLANS
- Z PVZ (BACKFLOW PREVEN. DEVICE) REFER TO CIVIL ENGINEER'S PLANS
- SV 1" MASTER VALVE FOR TOTAL SYSTEM SHUT OFF. CONNECT TO CONTROLLER
- C RAINBIRD ESP-LX MODULAR SERIES CONTROLLER W/ RAINBIRD RAIN SENSOR
- RS RAINBIRD RSD SERIES RAIN SENSOR ATTACHED TO CONTROLLER
- JB 1" ELECTRIC VALVES-RAINBIRD PEB SERIES OR APPROVED EQUAL, IN 10" ROUND VALVE BOX
- JB JUNCTION BOX W/ WATER PROOF CONNECTORS REFER TO ELECTRICAL ENGINEER'S PLANS
- 1" PVC Main Supply Line - Sch 40
- PVC LATERAL LINE (Sch. 160)
- PIPE IN SLEEVE (See Sizing Chart)
- PIPE CONNECTION
- PIPE CROSSING

- ZONE #1**
25 GPM
1" VALVE
SPRAY
- ZONE DESIGNATION & INFORMATION
- GALLONS PER MINUTE
- VALVE SIZE
- IRRIGATION TYPE
- RAINBIRD 1800 PRS - U SERIES NOZZE 10", 12", 15" POP-UP / QUARTER, HALF, FULL RADIUS DIAMETERS AS NOTED
- RAINBIRD 1800 SERIES STRIP-TYPE 15EST (END STRIP), 15 CST (CENTER STRIP) 1.5 GPM
- RAINBIRD -5 SERIES, MPR STREAM BUBBLER NOZZLES, 5" RADIUS, 1.5 GPM

PIPE INSTALLATION + SLEEVE NOTES

FLORIDA BUILDING CODE - APPENDIX F PIPE INSTALLATION - DEPTH OF COVER	
VEHICLE TRAFFIC AREAS	
PIPE SIZE (INCHES)	DEPTH OF COVER (INCHES)
1 1/2" TO 2 1/2"	18" TO 24"
3" TO 5"	24" TO 30"
6" OR GREATER	30 TO 36"
NON-TRAFFIC AND NON-CULTIVATED AREAS	
PIPE SIZE (INCHES)	DEPTH OF COVER (INCHES)
1 1/2" TO 1 1/4"	6" TO 12"
1 1/2" TO 2"	12" TO 18"
2 1/2" TO 3"	18" TO 24"
4" OR LARGER	24" TO 36"

FLORIDA BUILDING CODE - APPENDIX F SLEEVE SIZES - PART V A-6	
WATER PIPE SIZE	SLEEVE SIZE
3/4"	1 1/2"
1"	2"
1 1/4"	2 1/2"
1 1/2"	3"
2"	4"
3"	6"
4"	8"
SLEEVES TO EXTEND A MIN. 3" BEYOND ALL PAVED AREAS, BACKFILL AND COMPACTION PER APPENDIX F	

IRRIGATION PLAN NOTES

ALL MAIN LINES, LATERAL LINES AND IRRIGATION SPRINKLER COMPONENT LOCATIONS ARE SHOWN SCHEMATICALLY AND SHALL BE ADJUSTED BASED ON FIELD CONDITIONS. ALL LANDSCAPES AREAS TO RECEIVE 100% COVERAGE WITH A MINIMUM 50% OVERLAP BY A FULLY AUTOMATIC IRRIGATION SYSTEM WITH RAIN SENSOR. AFTER SITE INVESTIGATION THE LANDSCAPE CONTRACTOR IS TO PROVIDE A 'SHOP DRAWING' DETAILING THE PROPOSED IRRIGATION SYSTEM DESIGN TO THE LANDSCAPE ARCHITECT AND GENERAL CONTRACTOR.

A ROUGH INSPECTION IS REQUIRED BY THE CITY OF MIAMI BEACH PRIOR TO TRENCH BACKFILLING AND A FINAL INSPECTION SHALL BE REQUIRED PRIOR TO COMPLETION OF IRRIGATION WORK.

SOUTH FLORIDA WATER MANAGEMENT DISTRICT (SFWMD) WATER RESTRICTIONS, PHASE II ARE IN EFFECT. NEW LANDSCAPE INSTALLATION SHALL BE EXEMPT PER SFWMD FOR A PERIOD OF SIXTY DAYS AFTER INSTALLATION WITH CONTRACTOR and/or OWNER TO ASSUME RESPONSIBILITY AFTER 60 DAY PERIOD.

USE EXTREME CAUTION IN ALL AREAS TO AVOID ROOTS OF EXISTING TREES, PALMS + VEGETATION. HAND EXCAVATE AS NECESSARY AND ADJUST ALL MAIN AND LATERAL IRRIGATION LINES BASED ON FIELD CONDITIONAL. TRENCHING THRU ROOT ZONES SHALL BE AVOIDED AND ALL IRRIGATION LINES ARE TO RUN OUTSIDE OF THE ROOT ZONES OF ALL EXISTING VEGETATION

City of Miami Beach
Planning Department
Landscape Review
APPROVED
En 11/24/15

GROUND FLOOR IRRIGATION PLAN



CHRISTOPHER CAWLEY | CC
LANDSCAPE ARCHITECTURE LLC | LA

Florida Landscape Architecture Business LC 26000460
780 NE 69th Street | Suite 1106 | Miami, FL 33138
T 305.979.1585 | www.christophercawley.com

REVISIONS / SUBMISSIONS	
P+Z COMMENTS	11.13.15

1561

ALL DRAWINGS AND WRITTEN MATERIAL APPEARING HEREIN, CONSTITUTE THE ORIGINAL AND UNPUBLISHED WORK OF KOB KARP AND MAY NOT BE DUPLICATED, USED, OR DISCLOSED WITHOUT THE EXPRESS WRITTEN CONSENT OF KOB KARP ARCHITECTURE & INTERIOR DESIGN, INC. AIA 19 2013.

STAR ISLAND RESIDENCE
6 STAR ISLAND DRIVE
MIAMI BEACH, FL 33139

REGISTERED PROFESSIONAL ARCHITECT
FLORIDA LICENSE # 15615

Ch. Cawley
11.17.15

Lic. # AR0012578

ARCHITECTURE
INTERIOR DESIGN
PLANNING

AIA ASID NCARB
2015 Biscayne Boulevard
Suite 200
Miami, Florida 33137
P 305.572.3785
F 305.572.3786
WWW.KOBKARP.COM

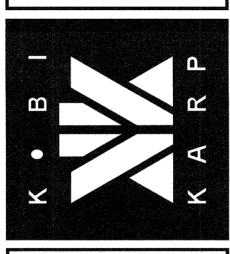

DRAWN BY:
CHECKED BY:
DATE: 10/07/2015

L-5

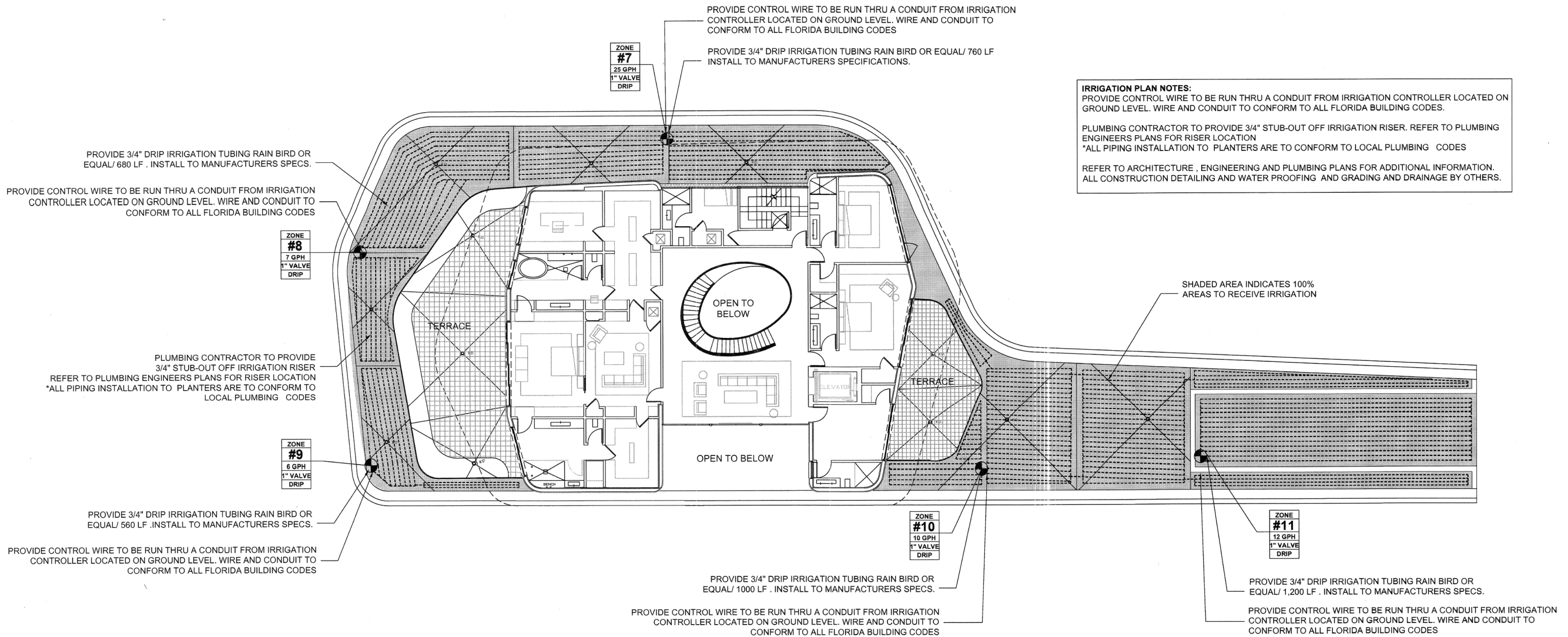

IRRIGATION LEGEND

--- 3/4" IRRIGATION DRIP TUBING



1" ELECTRIC VALVES-RAINBIRD PEB SERIES OR APPROVED EQUAL, IN 10" ROUND VALVE BOX

ZONE	ZONE DESIGNATION & INFORMATION
#1	
8 GPM	GALLONS PER MINUTE
1" VALVE	VALVE SIZE
DRIP	IRRIGATION TYPE

PIPE INSTALLATION + SLEEVE NOTES

FLORIDA BUILDING CODE - APPENDIX F PIPE INSTALLATION - DEPTH OF COVER

VEHICLE TRAFFIC AREAS	
PIPE SIZE (INCHES)	DEPTH OF COVER (INCHES)
1/2" TO 2 1/2"	18" TO 24"
3" TO 5"	24" TO 30"
6" OR GREATER	30 TO 36"
NON-TRAFFIC AND NON-CULTIVATED AREAS	
PIPE SIZE (INCHES)	DEPTH OF COVER (INCHES)
1/2" TO 1 1/4"	6" TO 12"
1 1/2" TO 2"	12" TO 18"
2 1/2" TO 3"	18" TO 24"
4" OR LARGER	24" TO 36"

FLORIDA BUILDING CODE - APPENDIX F SLEEVE SIZES - PART V A-6

WATER PIPE SIZE	SLEEVE SIZE
3/4"	1 1/2"
1"	2"
1 1/4"	2 1/2"
1 1/2"	3"
2"	4"
3"	6"
4"	8"
SLEEVES TO EXTEND A MIN. 3' BEYOND ALL PAVED AREAS, BACKFILL AND COMPACTION PER APPENDIX F	

IRRIGATION PLAN NOTES

ALL MAIN LINES, LATERAL LINES and IRRIGATION SPRINKLER COMPONENT LOCATIONS ARE SHOWN SCHEMATICALLY AND SHALL BE ADJUSTED BASED ON FIELD CONDITIONS. ALL LANDSCAPES AREAS TO RECEIVE 100% COVERAGE WITH A MINIMUM 50% OVERLAP BY A FULLY AUTOMATIC IRRIGATION SYSTEM with RAIN SENSOR. AFTER SITE INVESTIGATION THE LANDSCAPE CONTRACTOR IS TO PROVIDE A 'SHOP DRAWING' DETAILING THE PROPOSED IRRIGATION SYSTEM DESIGN TO THE LANDSCAPE ARCHITECT AND GENERAL CONTRACTOR.

A ROUGH INSPECTION IS REQUIRED BY THE CITY OF MIAMI BEACH PRIOR TO TRENCH BACKFILLING AND A FINAL INSPECTION SHALL BE REQUIRED PRIOR TO COMPLETION OF IRRIGATION WORK.

SOUTH FLORIDA WATER MANAGEMENT DISTRICT (SFWMD) WATER RESTRICTIONS, PHASE II ARE IN EFFECT. NEW LANDSCAPE INSTALLATION SHALL BE EXEMPT PER SFWMD FOR A PERIOD OF SIXTY DAYS AFTER INSTALLATION with CONTRACTOR and/or OWNER TO ASSUME RESPONSIBILITY AFTER 60 DAY PERIOD.

USE EXTREME CAUTION IN ALL AREAS TO AVOID ROOTS OF EXISTING TREES, PALMS + VEGETATION. HAND EXCAVATE AS NECESSARY AND ADJUST ALL MAIN AND LATERAL IRRIGATION LINES BASED ON FIELD CONDITIONAL. TRENCHING THRU ROOT ZONES SHALL BE AVOIDED AND ALL IRRIGATION LINES ARE TO RUN OUTSIDE OF THE ROOT ZONES OF ALL EXISTING VEGETATION

REFER TO ARCHITECTURAL, ENGINEERING AND PLUMBING PLANS FOR ADDITIONAL INFORMATION. ALL CONSTRUCTION DETAILING, WATERPROOFING AND GRADING TO BE BY OTHERS.



SECOND FLOOR IRRIGATION PLAN

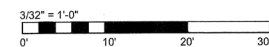

CHRISTOPHER CAWLEY | CC
LANDSCAPE ARCHITECTURE LLC | LA
Florida Landscape Architecture Business LC 26000460
780 NE 69th Street | Suite 1106 | Miami, FL 33138
T 305.979.1585 | www.christophercawley.com

REVISIONS / SUBMISSIONS

1561

ALL DRAWINGS AND WRITTEN MATERIAL APPEARING HEREIN, INCLUDING THE ORIGINAL AND UNLESS OTHERWISE SPECIFIED, ARE THE PROPERTY OF KOB KARP AIA, AND MAY NOT BE DUPLICATED, USED, OR DISCLOSED WITHOUT THE EXPRESS WRITTEN CONSENT OF KOB KARP ARCHITECTURE & INTERIOR DESIGN, INC. AIA, 10/2015.

STAR ISLAND RESIDENCE
6 STAR ISLAND DRIVE
MIAMI BEACH, FL 33139

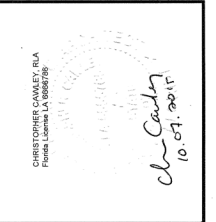

Lic. # AR0012578

**ARCHITECTURE
INTERIOR DESIGN
PLANNING**
AIA ASID NCARB
2915 Biscayne Boulevard
Suite 200
Miami, Florida 33137
P 305.979.1585
F 305.979.3768
WWW.KOBKARP.COM

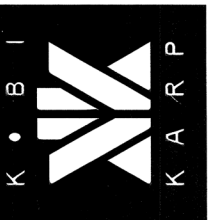

DRAWN BY:
CHECKED BY:
DATE: 10/07/2015

L-6