

LENOX LANE

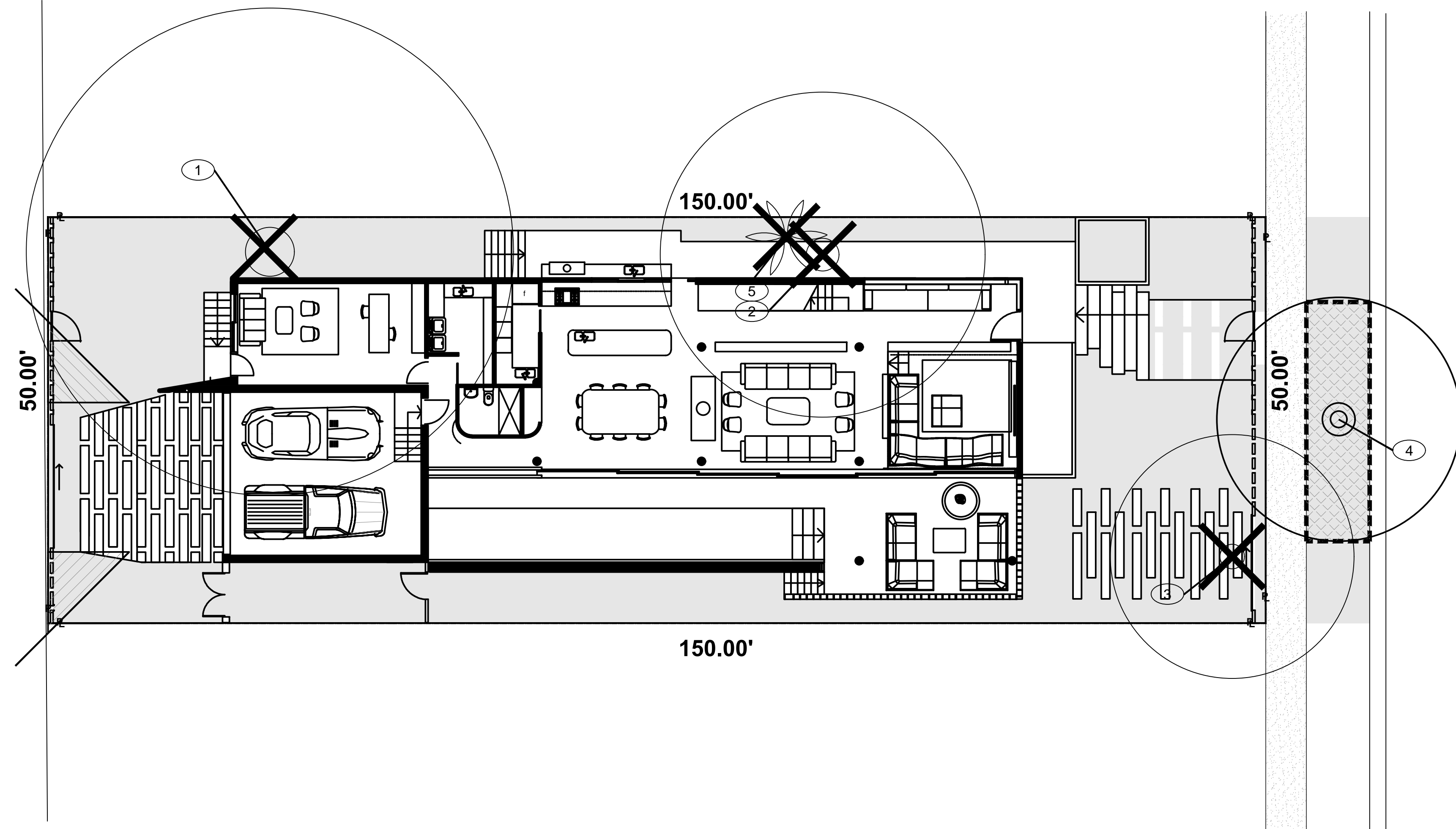

LENOX AVE.

CITY OF MIAMI BEACH TREE DISPOSITION-LANDSCAPE NOTES
SHALL TAKE PRECEDENCE OVER ANY OTHER LANDSCAPE NOTES OR DISCREPANCIES

- 1 "Tree protection fences shall be constructed prior to any construction activity including grubbing for all trees/palms to remain or be relocated. Fences should be of sturdy construction, preferably 4x4 posts with wire mesh. Orange plastic mesh fences are ineffective because they are easily removed, dropped, knocked down, ignored, etc. Fences must be maintained intact until the project is completed. They should not be removed or dropped for any reason without authorization from the city's urban forester. No activity or disturbance should occur within the fenced areas, including vehicle use, storage of materials, dumping of liquids or materials, grade changes, grubbing, and mechanical trenching for irrigation, electrical lighting, etc."
- 2 All proposed irrigation in City property shall follow CMB irrigation specifications.
- 3 "Do not place fill, rocks, grading sand nor any other construction material over the roots or in the root zone."
- 4 "Any proposed tree root or structural pruning shall be performed by an ISA Certified Arborist in accordance with ANSI A-300 (part 1) pruning standards. Tree pruning should be limited to the bare minimum required to achieve clearance for construction activities and the City Urban Forester shall be consulted prior to the start of any tree or root pruning onsite."
- 5 "Mulch shall be kept a minimum of 6" away from all trunks of trees and palms. Fill/topsoil shall not be placed on top of the root ball."
- 6 "The City Urban Forester and or Greenspace Management Staff shall be notified prior to installation of trees or palms in the ROW to inspect the planting holes and conduct a grades and standards inspection."
- 7 "Contractor is responsible for the maintenance and/or repair of all staking and guying of trees and palms during warranty period and removal & disposal of staking within 1-year of installation. Exceptions to this require the written approval of the City Urban Forester."
- 8 The Landscape Contractor shall guarantee all new and or relocated trees and palms for a period of 1-year from the date of initial acceptance and approval.
- 9 All guying and staking shall be removed from all trees and palms within twelve months after planting. Exceptions require written authorization from the City Urban Forester.
- 10 Tree protection barriers may not be taken down, modified and or removed without written authorization from the City Urban Forester.
- 11 Mulch shall not be applied within 6" of any tree or palm trunks that are installed or incorporated into the project.
- 12 A final on-site inspection shall be required by the Urban Forestry Division staff prior to any official acceptance of ROW plant material, in order to verify proper planting depth, spacing and quality of the material. Failure to conduct the inspection could result in rejection of the plant material.

TREE MITIGATION-REPLACEMENT PLANTLIST

SYMBIATIVE	NAME	BOTANICAL NAME	SPECIFICATION
* SEE TREE DISPOSITION PLAN FOR EXISTING TREE INVENTORY AND STATUS			
* REMOVAL OF 103" D.B.H. OF EXISTING TREES			
MITIGATION REQUIREMENT: 36 TREES @ 12' HT., 2" DBH OR 18 TREES @ 16' HT., 4" DBH			
PROVIDED MITIGATION:			
* BS	YES	1 GUMBO LIMBO	Bursera simaruba 16' x 1" spr, 4' cal, 6' ct.
CG12	YES	3 SMALL LEAF CLUSIA	Clusia guttifera 12' OA, X 6'-8', full
CD	YES	3 PIGEON PLUM	Coccoloba diversifolia 12' x 6' spr, 2 1/2' cal.
* ED		4 JAPANESE BLUEBERRY	Elaeagnus japonica 8' TD, 12' HT, X 6', 2' CAL
* QVC	YES	2 LIVE OAK 'Cathedral'	Quercus virginiana 'Cathedral' 16' x 1" spr, 4' cal, 6' ct.
PROVIDED MITIGATION: 10 TREES @ 12' HT., 2" DBH AND 3 TREES @ 16' HT., 4" DBH			
MITIGATION DEFICIT: \$20,000 (20 TREES @ \$1,000 PER TREE)			
REMOVAL OF 1 EXISTING REGULATED PALMS:			
MITIGATION DEFICIT: \$1,000 (1 TREE @ \$1,000 PER TREE)			
MITIGATION DEFICIT TO BE A PAYMENT TO THE CITY OF MIAMI BEACH TREE TRUST FUND.			

PRIVATE RESIDENCE

1728 LENOX AVE.
MIAMI BEACH, FL. 33319

No.	Date	Revision
1.	09/06/24	Site Plan modifications per Project Architect.

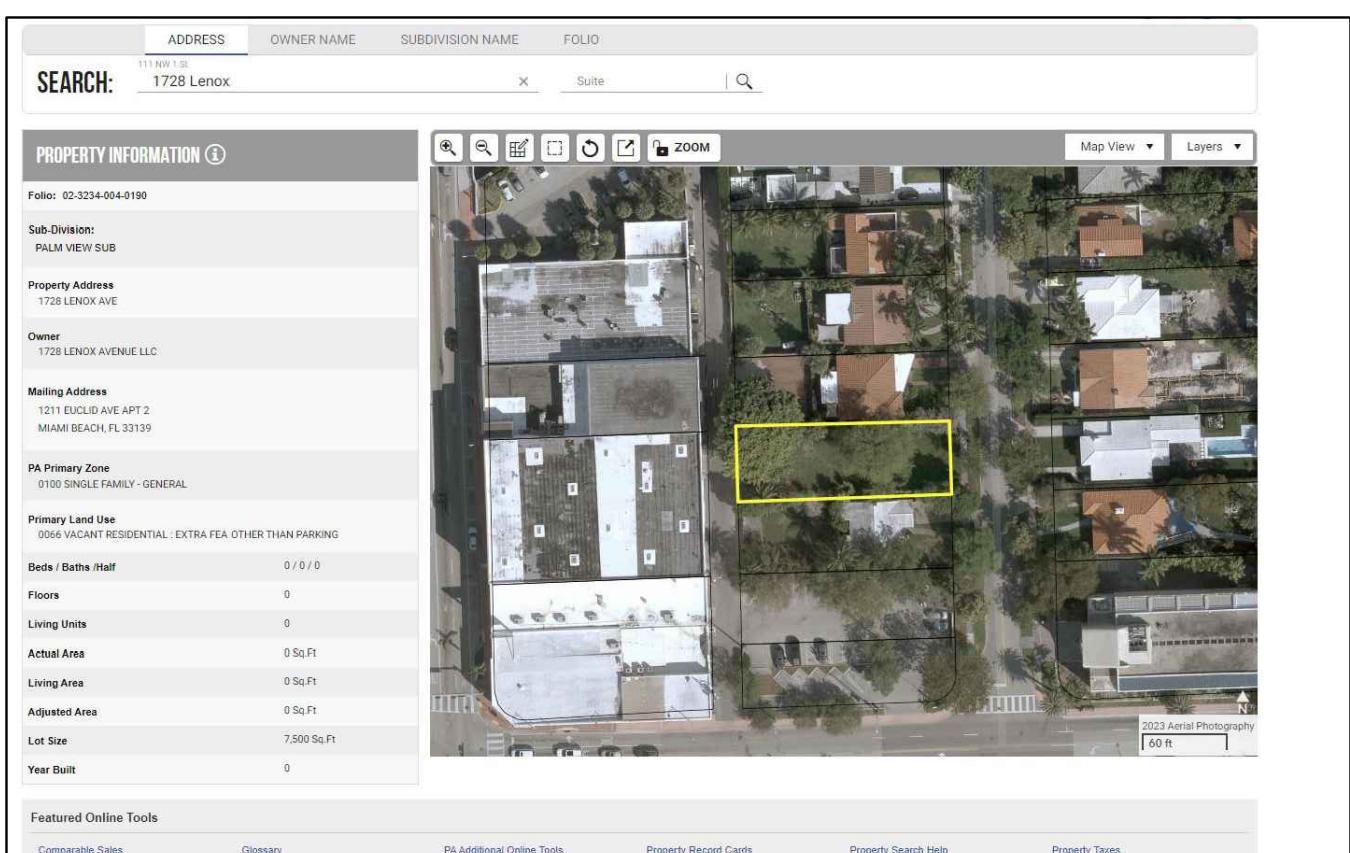

Appendix B: Tree Protection Detail

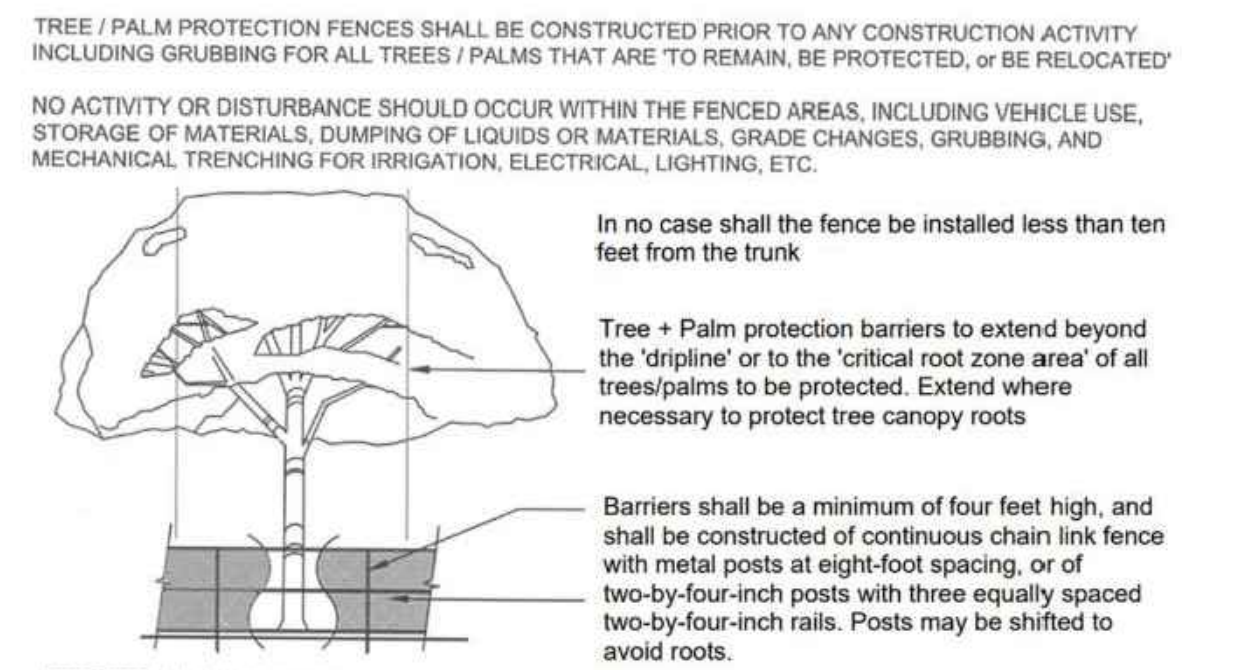

C.M.B. TREE / PALM PROTEC. DETAIL

TREE DISPOSITION SUMMARY TOTAL				
1728 LENOX AVE, MIAMI BEACH, FL. 33319				
	REMAIN	REMOVE	RELOCATE	TOTAL
TREES	2	2	0	4
PALMS	0	1	0	1

23-33-PRIVATE RESIDENCE-1728 LENOX AVE., MIAMI BEACH, FL. 33139													
TREE NUM	SYM	COMMON NAME	BOTANICAL NAME	HEIGHT	SPREAD	CLEAR TRUNK (ft)	DBH inches	CONDITION	CONDITION %	STATUS	DBH LOSS	PALM LOSS	REMARKS
1	PIC	BANYAN FIG	Ficus benghalensis	41	58	45	54"	FAR	54%	REMOVE	45		PROHIBITED SPECIES
2	PIT	MANILA TAMARIND	Pithecellobium dulce	43	34	32	46"	FAR	46%	REMOVE	32		
3	FB	BENJAMIN FIG	Ficus benjamina	32	20	26	40"	POOR	40%	REMOVE	26		
4	LL	WILD TAMARIND	Lysitoma latissiliquum	29	26	14	62"	GOOD	62%	REMAIN			EXISTING STREET TREE
5	VM	MONTGOMERY PALM	Veitchia arifolia	20	7	16	5"	FAR	52%	REMOVE		1	
TOTALS											103	1	

FIELD INVENTORY CONDUCTED BY JFS DESIGN INC. ON OCTOBER 31, 2023



A WRITTEN TREE REMOVAL PERMIT IS REQUIRED FROM THE CITY OF MIAMI BEACH PRIOR TO REMOVAL OF ANY REGULATED TREES OR PALMS FROM THE SITE.
SEE SHEET TD-2 FOR ISA CERTIFIED ARBORIST REPORT.

SEE LANDSCAPE PLANS FOR LANDSCAPE DESIGN, LANDSCAPE LEGEND, DETAILS, NOTES, SPECIFICATIONS, ETC.
SEE IRRIGATION PLANS FOR IRRIGATION DESIGN, LAYOUT, DETAILS, NOTES, ETC.

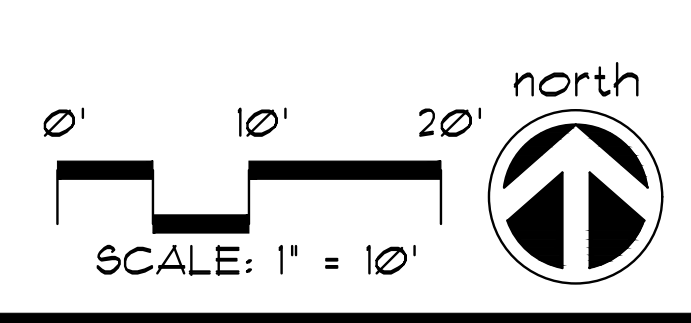

TREE DISPOSITION PLAN

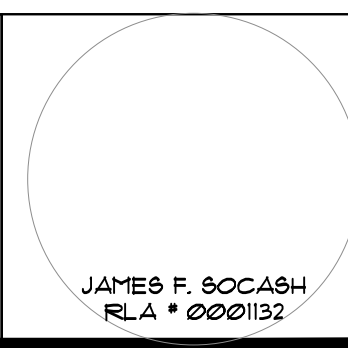

Drawing: **TD-1**

November 7, 2023

Page 1 of 4

JFS Design Inc.
1833 NW 140th Terr.
Pembroke Pines, FL 33028

To Whomever This May Concern,

I visited the above-mentioned property on Tuesday, November 7, 2023, to evaluate +/- 5 trees, take photographs, perform relocation evaluations, and note any defects.

Overview

Please see attached tree table with data collected in the field including species, height, width, diameter at breast height (dbh), clear trunk (CT), condition, condition percentage, relocation evaluations, and pertinent notes.

Note all trees were evaluated from the ground only, no aerial inspections, soil excavations or penetrations were performed. The performed reviews were 360-degree visual assessments only. Health condition ratings are in accordance with the CTLA 10th Edition Guide for Plant Appraisal.

A total of 4 trees and 1 palm were evaluated. Please find additional details, and photographs below.

Treemendous Consulting Group, LLC
"Every Tree is Unique"
18459 Pines Blvd. Suite #503
Pembroke Pines, FL 33029
C. 954-354-3210
istreeman@gmail.com

Trees One & Two

Page 2 of 4



Banyan (*Ficus benghalensis*) Tree # One, and Manila Tamarind (*Pithecellobium dulce*) Tree # Two, facing north. Note poor structure, canopy dieback, visual evidence of decay, deadwood for Tree # One, and Poor structure, trunk lean, heading cuts, deadwood for Tree # Two.

Treemendous Consulting Group, LLC
"Every Tree is Unique"
18459 Pines Blvd. Suite #503
Pembroke Pines, FL 33029
C. 954-354-3210
istreeman@gmail.com

Trees Three, Four, & Five

Page 3 of 4



Weeping Fig (*Ficus benjamina*) Tree # Three, Wild Tamarind (*Lysiloma latifolium*) Tree # Four, and Montgomery Palm (*Veitchia arecina*) Tree # Five, facing south, west, and north. Note poor structure, visual evidence of decay, vines, trunk lean for Tree # Three, poor structure, confined root space, heading cuts, insufficient root ball for relocation for Tree # Four, and nutrient deficiency for Tree # Five.

Treemendous Consulting Group, LLC
"Every Tree is Unique"
18459 Pines Blvd. Suite #503
Pembroke Pines, FL 33029
C. 954-354-3210
istreeman@gmail.com

End Report

Page 4 of 4

Mark C. Williams

Mark C. Williams

ASCARCA #580

Registered Consulting Arborist*
ASCA Tree Plant Appraisal Qualified
ISA Certified Arborist Municipal Specialist FL 5221-AM
ISA Tree Risk Assessment Qualified
LIAF Certified Landscape Inspector #2007-0083

Treemendous Consulting Group, LLC
"Every Tree is Unique"
18459 Pines Blvd. Suite #503
Pembroke Pines, FL 33029
C. 954-354-3210
istreeman@gmail.com

PRIVATE RESIDENCE

**1728 LENOX AVE.
MIAMI BEACH, FL. 33319**

No.	Date	Revision
1.	09/06/24	Site Plan modifications per Project Architect.

designed: JIMMYTICO
 drawn: WENDY M.
 checked: T.Y. MORAN
 approved: J. F. SOCAASH
 project #: 23-33
 scale: AS SHOWN
 date: Nov. 7, 2023
 folio: 02-3234-004-0190

Drawing:
TD-2

TREE #	COMMON NAME	BOTANICAL NAME	HEIGHT (ft)	WIDTH (ft)	CLEAR TRUNK (ft)	DBH (in)	CONDITION	CONDITION %	TREE DISPOSITION	RELOCATION CANDIDATE (Y/N)	OBSERVATIONS
1	Banyan	<i>Ficus benghalensis</i>	40.7	58		45	Fair	54%	N	N	Poor structure, canopy dieback, visual evidence of decay, deadwood
2	Manila Tamarind	<i>Pithecellobium dulce</i>	42.6	34		32	Fair	48%	N	N	Poor structure, trunk lean, heading cuts, deadwood
3	Weeping Fig	<i>Ficus benjamina</i>	31.9	20		28	Poor	40%	N	N	Poor structure, visual evidence of decay, vines, trunk lean
4	Wild Tamarind	<i>Lysiloma latifolium</i>	28.6	28		14	Good	62%	N	N	Poor structure, confined root space, heading cuts, insufficient root ball for relocation
5	Montgomery Palm	<i>Veitchia arecina</i>	20.3	7	18.3	5	Fair	52%	N	N	Nutrient deficiency

*I certify that all statements are true, complete and correct to the best of my knowledge and belief and that they are made in good faith.

Mark C. Williams FL-5221-AM, ISA Certified Arborist Municipal Specialist (Treemendous Consulting Group, LLC)

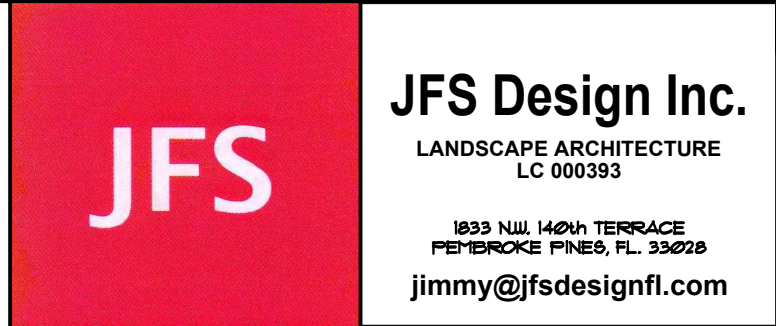

A WRITTEN TREE REMOVAL PERMIT IS REQUIRED FROM THE CITY OF MIAMI BEACH PRIOR TO REMOVAL OF ANY REGULATED TREES OR PALMS FROM THE SITE.

SEE SHEET TD-2 FOR ISA CERTIFIED ARBORIST REPORT.

SEE LANDSCAPE PLANS FOR LANDSCAPE DESIGN, LANDSCAPE LEGEND, DETAILS, NOTES, SPECIFICATIONS, ETC.

SEE IRRIGATION PLANS FOR IRRIGATION DESIGN, LAYOUT, DETAILS, NOTES, ETC.

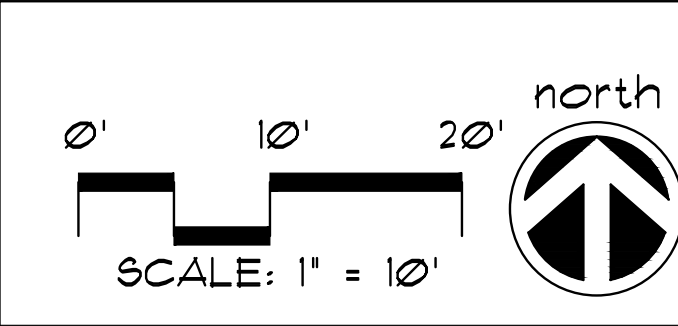

ISA CERTIFIED ARBORIST REPORT

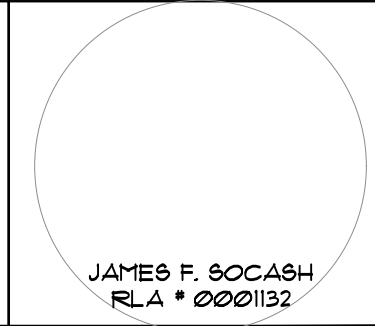



CD - PIGEON PLUM



VM - MONTGOMERY PALM



C17 - COCOPLUM



IXM - IXORA MAUI



CG12 - SMALL LEAF CLUSIA



STR - BIRD OF PARADISE



CAB - CABADA PALM



BL3 - BLUEBERRY FLAX LILY



CAT - CAT PALM



BS - GUMBO LIMBO



ED - JAPANESE BLUEBERRY



CR - CLUSIA TREE



IMP - IMPERIALIS "MALBEC"



PEG - GREEN FOUNTAIN GRASS

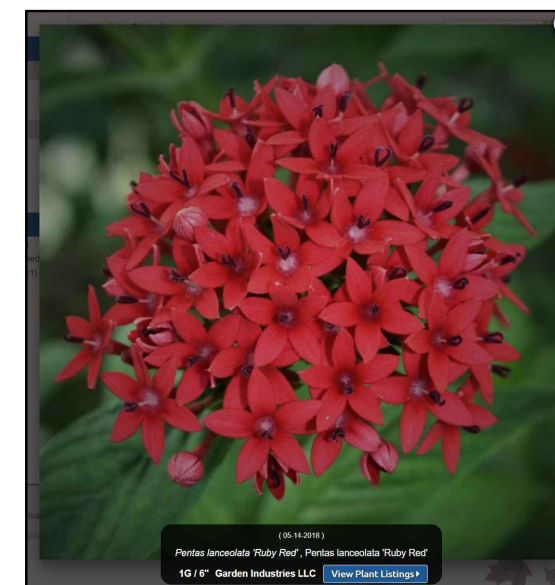

PEN - PENTAS



PEN - EGYPTIAN STAR CLUSTER



PHI - PHILODENDRON

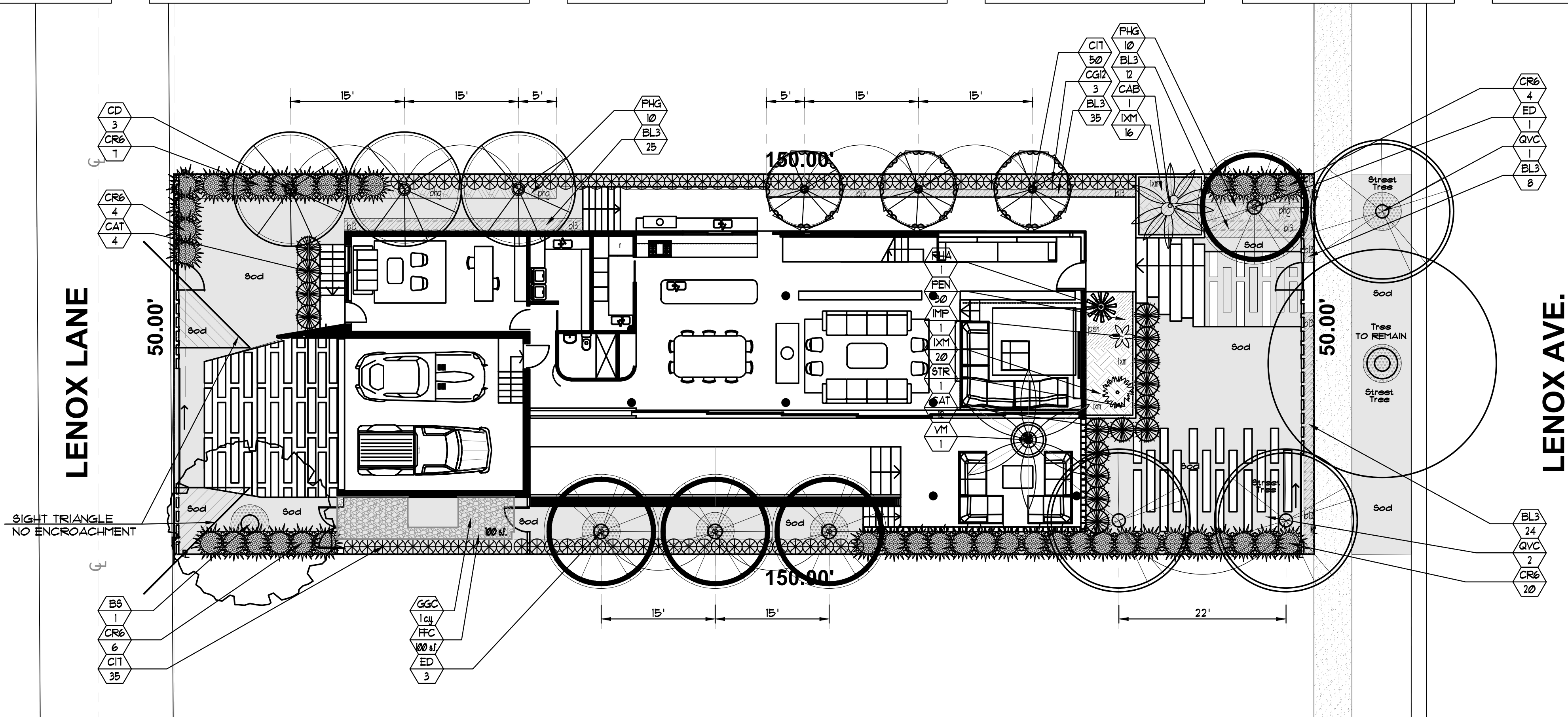

QV - LIVE OAK



RHA - LADY PALM

PRIVATE RESIDENCE

1728 LENOX AVE.
MIAMI BEACH, FL. 33319

No.	Date	Revision
1.	05/10/24	Site Plan modifications per Project Architect.

designed:	JIMMYTICO
drawn:	WENDY M.
checked:	T.Y. MORAN
approved:	J. F. SOCAASH
project #:	23-33
scale:	AS SHOWN
date:	Nov. 7, 2023
folio:	02-3234-004-0190

Drawing:

ILL-1



A WRITTEN TREE REMOVAL PERMIT IS REQUIRED FROM THE CITY OF MIAMI BEACH PRIOR TO REMOVAL OF ANY REGULATED TREES OR PALMS FROM THE SITE.

SEE SHEET TD-2 FOR ISA CERTIFIED ARBORIST REPORT.

SEE LANDSCAPE PLANS FOR LANDSCAPE DESIGN, LANDSCAPE LEGEND, DETAILS, NOTES, SPECIFICATIONS, ETC.

SEE IRRIGATION PLANS FOR IRRIGATION DESIGN, LAYOUT, DETAILS, NOTES, ETC.

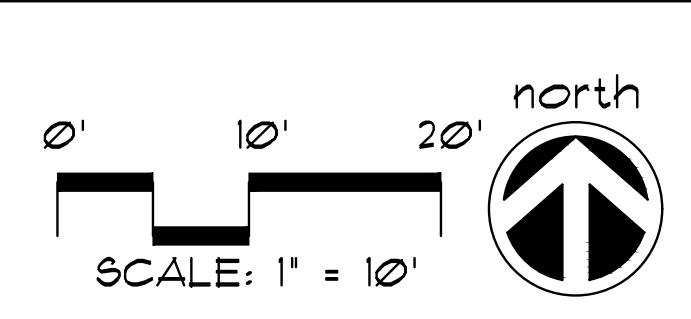

ILLUSTRATIVE LANDSCAPE PLAN

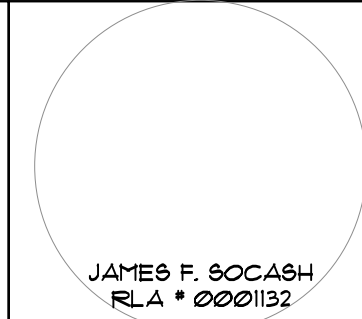



PEG - GREEN FOUNTAIN GRASS



CH A - EUROPEAN FAN PALM



DIY - YELLOW AFRICAN IRIS



FUR - FALSE AGAVE



JAT - JATROPHA

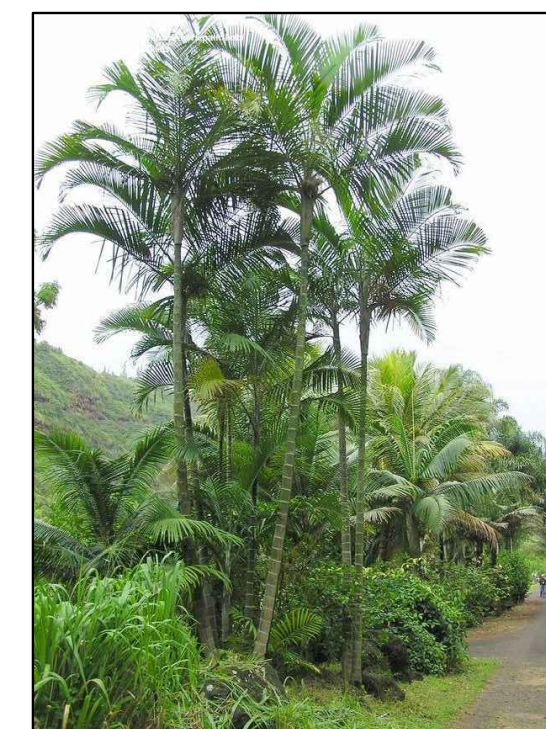

CAB - CABADA PALM



IXM - IXORA MAUI

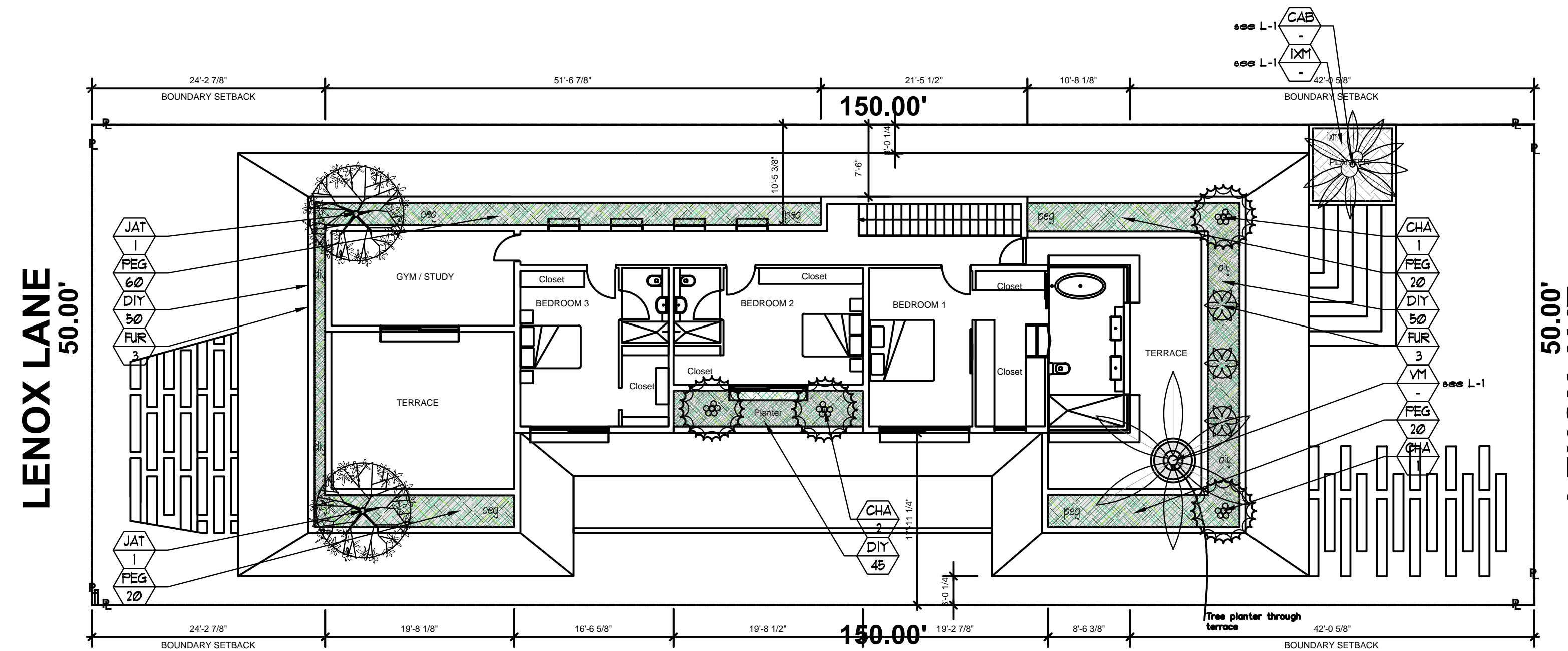

LENOX LANE
50.00'

LENOX AVENUE
50.00'

LENOX AVENUE

PRIVATE RESIDENCE

1728 LENOX AVE.
MIAMI BEACH, FL. 33319

No.	Date	Revision
1.	09/06/24	Site Plan modifications per Project Architect.

designed:	JIMMYICO
drawn:	WENDY M.
checked:	T.Y. MORAN
approved:	J. F. SOCAASH
project #:	23-33
scale:	AS SHOWN
date:	Nov. 7, 2023
folio:	02-3234-004-0190

Drawing:

ILL-2

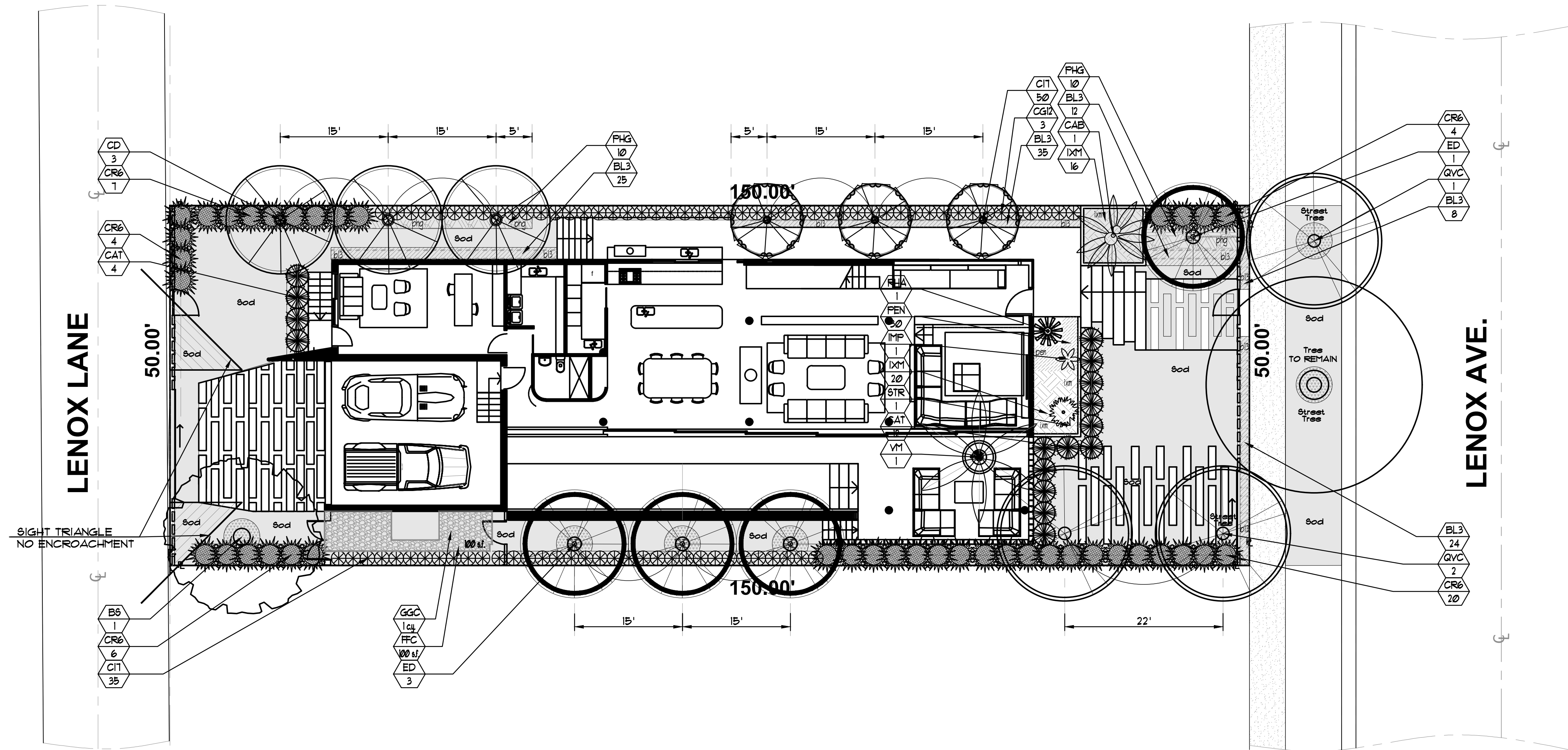

CITY OF MIAMI BEACH
LANDSCAPE LEGEND

INFORMATION REQUIRED TO BE PERMANENTLY AFFIXED TO PLANS

Zoning District	RS-R	Lot Area	7,500 s.f.	Acres	0.172
OPEN SPACE					
A. Square feet of required Open Space as indicated on site plan: Lot Area = 7,500 s.f. x 50% = 3,750 s.f.				REQUIRED/ ALLOWED	PROVIDED
B. Square feet of parking lot open space required as indicated on site Number of parking spaces N/A x 10 s.f. parking space =				N/A	N/A
C. Total square feet of landscaped open space required: A+B=				3,750 s.f.	2,555 s.f.
LAWN AREA CALCULATION					
A. Square feet of landscaped open space required				3,750 s.f.	2,555 s.f.
B. Maximum lawn area (sod) permitted = 50% x 3,750 s.f.				1,875 s.f.	1,102 s.f.
TREES					
A. Number of trees required per lot or net lot acre, less existing number of trees meeting minimum requirements =				5	11
B. % Natives required: Number of trees provided x 30% =				2	7
C. % Low maintenance / drought and salt tolerant required: Number of trees provided x 50% =				3	11
D. Street Trees (maximum average spacing of 20' o.c.) 50 ft linear feet along street divided by 20' =				3	3
E. Street tree species allowed directly beneath power lines: (maximum average spacing of 20' o.c.): _ (DRIVEWAY)-ft linear feet along street divided by 20' =				0	N/A
SHRUBS					
A. Number of shrubs required: Sum of lot and street trees required x 12=				132	157
B. % Native shrubs required: Number of shrubs provided x 50% =				66	85
LARGE SHRUBS OR SMALL TREES					
A. Number of large shrubs or small trees required: Number of required shrubs x 10% =				14	35
B. % Native large shrubs or small trees required: Number of large shrubs or small trees provided x 50% =				66	157

PLANTLIST

SYM.	NATIVE	#	NAME	BOTANICAL NAME	SPECIFICATION
* SINGLE ASTERISK = PROVIDE PHOTOS FOR OWNER APPROVAL PRIOR TO PURCHASE					
** DOUBLE ASTERISK = AT TIME OF PLANTING					
** STREET TREE REQUIREMENT					
	1	EXISTING			SEE TREE INVENTORY
* QVC	YES	2	LIVE OAK 'Cathedral'	<i>Quercus virginiana 'Cathedral'</i>	16' x 1" spr, 4" cal, 6' c.t.
	3	STREET TREES			
**PROPOSED LOT TREES					
* BS	YES	1	GUMBO LIMBO	<i>Bursera simaruba</i>	16' x 1" spr, 4" cal, 6' c.t.
CG12	YES	3	SMALL LEAF CLUSIA	<i>Clusia guttifera</i>	12' O.A. x 6'-8', full
CD	YES	3	PIGEON PLUM	<i>Coccoloba diversifolia</i>	12' x 6'spr, 2 1/2' cal.
* ED	4	JAPANESE BLUEBERRY	<i>Elaeagnus decipiens</i>	STD, 12' HT, X 6', 2' CAL	
	11	LOT TREES			
** PALMS					
* CAB	1	CABADA PALMS	<i>Dypsis cabada</i>	FG, 12'-14' o.a., full head	
* VM	1	MONTGOMERY PALMS	<i>Veitchia montgomeryana</i>	SGL, TK, FG, 18' C.T., full hd.	
** SHRUBS					
CAT	16	CAT PALMS	<i>Chamaedorea cataractarum</i>	1 gal, 30' x 24', 36' o.c.	
CIT	YES	25	COCOPLUM	<i>Cryobalanus icaco</i>	1 GAL, 30' x 24' full, 24' o.c.
IXM	36	IXORA 'MAUI'	<i>Ixora spp. 'Maui'</i>	3 gal, 18' x 18', 18' o.c., full	
PHG	20	PHILO 'GIGANTEUM'	<i>Philodendron giganteum</i>	1 gal, 24' x 24', 24' o.c., full	
** PROPOSED LARGE SHRUBS					
* CR6	YES	35	PITCH APPLE CLUSIA	<i>Clusia rosea</i>	6' ht, 36' o.c., FTB.

PLANTLIST

SYM.	NATIVE	#	NAME	BOTANICAL NAME	SPECIFICATION
** ACCENT PLANTS AND GROUNDCOVERS					
IMP		1	IMPERIALIS BROMELIAD	<i>Alcantarea imperialis</i>	1 gal, full, BULLIS
BL3		99	BLUEBERRY FLAX LILY	<i>Dianella tasmanica</i>	3 gal, 12' x 18', 18' o.c., full
PEN		30	EGYPTIAN STAR CLUSTER	<i>Pentas lanceolata</i>	1 gal, 10' x 10', 14' o.c., full
RHA		1	LADY PALMS	<i>Rhaps excelsa</i>	5' o.a., FTG, sun acclimated
BTB		1	BIRD OF PARADISE	<i>Strelitzia reginae</i>	15 gal, 36' o.a. ht.
LANDSCAPE MATERIALS					
GGC		1 c.y.	GRAY GRANITE CHIPS	1/2" dia., 2" depth on filter fabric, CRUSHED GRANITE, GRAY	
FFC		100 s.f.	FILTER FABRIC	Black porous, erosion control matting or sim.	
SOD					
lot	SOD	1,102 s.f.	'PALMETTO' ST. AUGUSTINE	<i>Stenotaphrum secundatum</i>	SOLID SOD, price per s.f.
swale	SOD	334 s.f.	'PALMETTO' ST. AUGUSTINE	<i>Stenotaphrum secundatum</i>	SOLID SOD, price per s.f.
TOPSOIL:					
			TOPSOIL: SAND MIX	50:50 TOPSOIL: SAND MIX, SPREAD IN PLACE	
		60 c.y.	TREES, PALMS, SHRUBS AND GROUNDCOVERS		
		9 c.y.	AREA TO BE SODDED WITH A 2" DEPTH OF TOPSOIL SPREAD IN PLACE		
MULCHING:					
		13 c.y.	DRK BRN RECYCLED MULCH	3" DEPTH, SPREAD IN PLACE, ATLAS FEAT AND SOIL	
PROVIDE SAMPLE FOR APPROVAL PRIOR TO INSTALLATION					
--- TOPSOIL, SOD AND MULCH QUANTITIES SHOWN ARE APPROXIMATE, CONTRACTOR TO PROVIDE A UNIT PRICE PER UNIT AND WILL BE PAID ON THAT UNIT PRICE BASIS UPON FINAL INSPECTION AND APPROVAL.					
INSTALLATION WATERING:					
CONTRACTOR SHALL THOROUGHLY WATER IN ALL PLANTINGS WHEN PLANTED, AND SHALL CONTINUE WATERING UNTIL FINAL INSPECTION AND APPROVAL BY THE LOCAL GOVERNING AGENCY AND THE OWNER.					
REPLACEMENT PLANTING NOTE: ANY PLANT MATERIAL THAT IS DEAD, DYING OR LESS THAN FLORIDA GRADE #1 WILL BE REPLACED BY THE OWNER WITH THE SAME OR SIMILAR SPECIES AND SIZED WITHIN 60 DAYS OF PROBLEM IDENTIFICATION.					

STREET TREE TABULATIONS

REQUIRED STREET TREES ARE SUBJECT TO THE REVIEW AND APPROVAL OF THE CIP OFFICE AND PW GREENSPACE DIVISION PRIOR TO INSTALLATION.	REQUIRED	PROVIDED
LENOX AVE. 50' L.F. @ 1 TREE / 20' L.F. = 3	3	3 1 EXIST., + 1 QVC + 1 ED

PRIVATE RESIDENCE

1728 LENOX AVE.
MIAMI BEACH, FL. 33319

No.	Date	Revision
1.	05/10/24	Site Plan modifications per Project Architect.

designed: JIMMYTICO
drawn: WENDY M.
checked: T.Y. MORAN
approved: J. F. SOCCASH
project #: 23-33
scale: AS SHOWN
date: Nov. 7, 2023
folio: 02-3234-004-0190

Drawing:
L-1

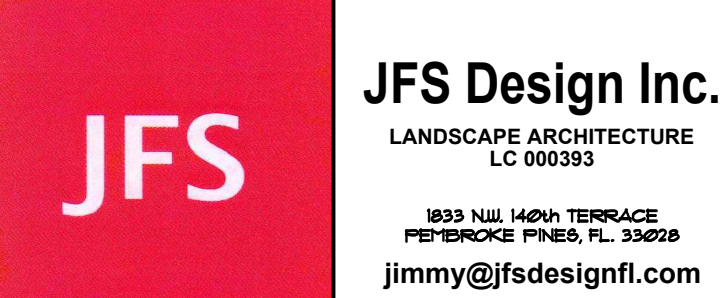

A WRITTEN TREE REMOVAL PERMIT IS REQUIRED FROM THE CITY OF MIAMI BEACH PRIOR TO REMOVAL OF ANY REGULATED TREES OR PALMS FROM THE SITE.
SEE SHEET TD-2 FOR ISA CERTIFIED ARBORIST REPORT.

SEE LANDSCAPE PLANS FOR LANDSCAPE DESIGN, LANDSCAPE LEGEND, DETAILS, NOTES, SPECIFICATIONS, ETC.
SEE IRRIGATION PLANS FOR IRRIGATION DESIGN, LAYOUT, DETAILS, NOTES, ETC.

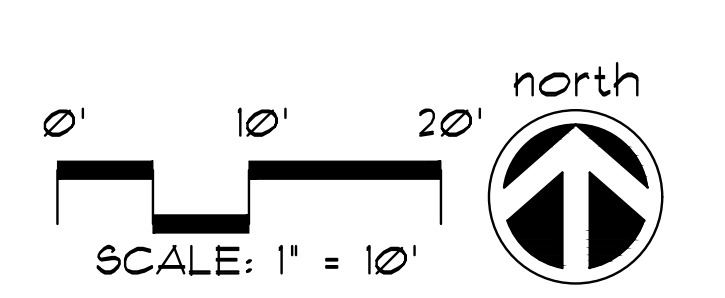

SITE LANDSCAPE PLAN

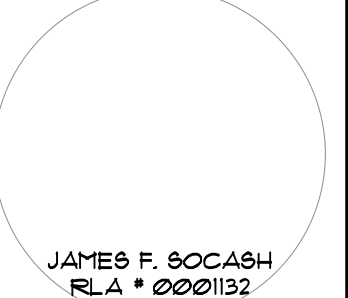

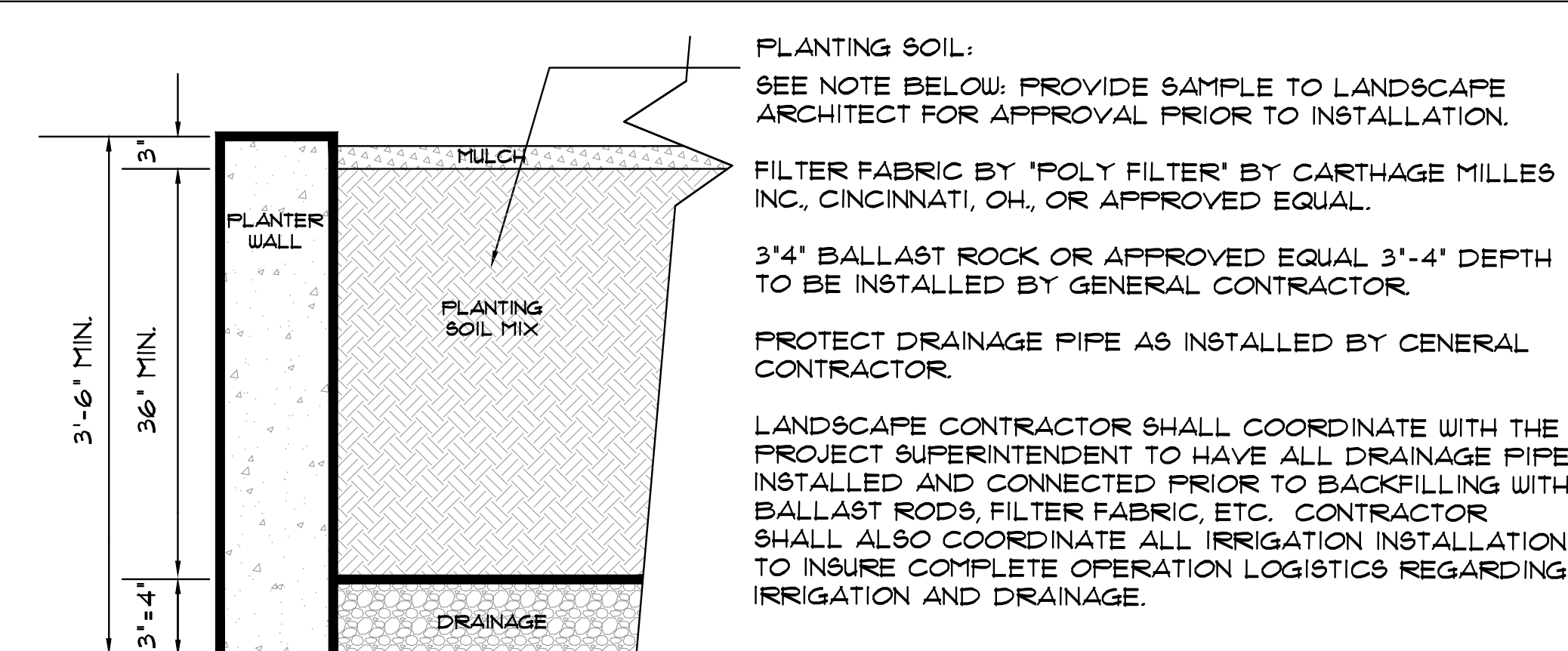
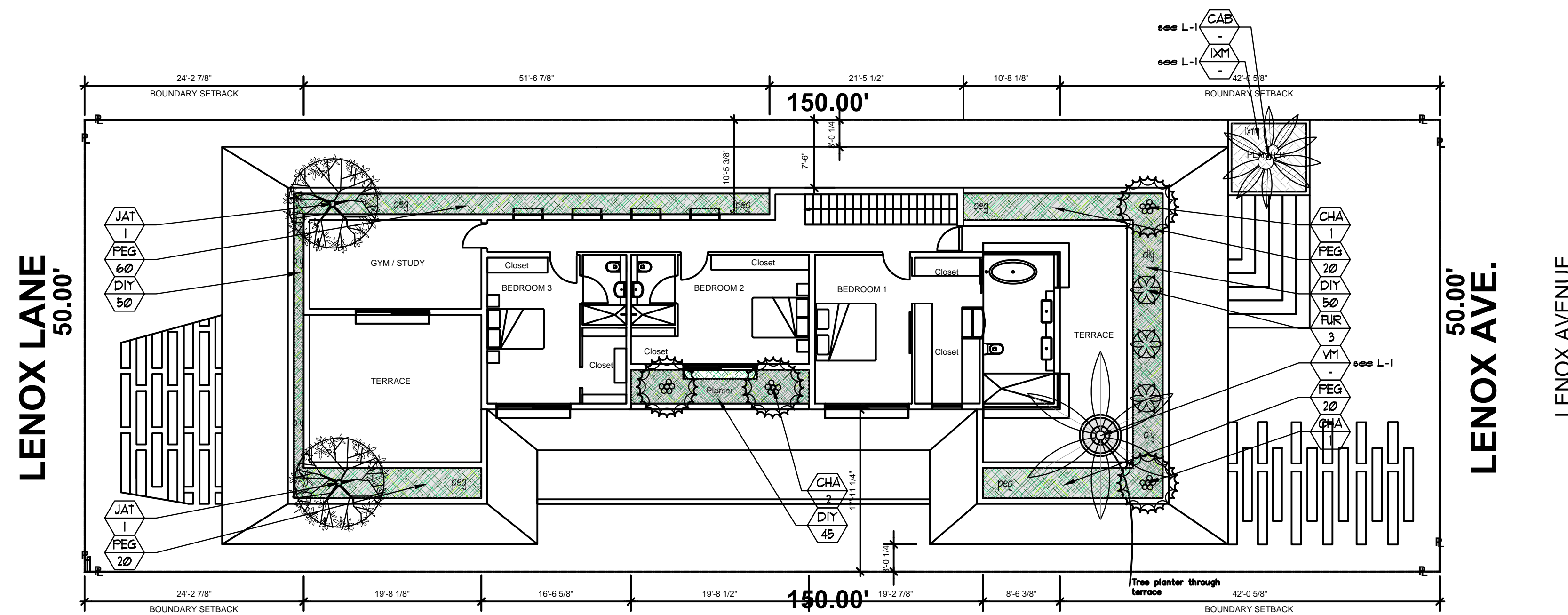

TYPICAL LANDSCAPE PLANTER
N.T.S.

PLANTING SOIL:
SEE NOTE BELOW: PROVIDE SAMPLE TO LANDSCAPE ARCHITECT FOR APPROVAL PRIOR TO INSTALLATION.

FILTER FABRIC BY 'POLY FILTER' BY CARTHAGE MILLES INC., CINCINNATI, OH, OR APPROVED EQUAL.

3'-4" BALLAST ROCK OR APPROVED EQUAL 3'-4" DEPTH TO BE INSTALLED BY GENERAL CONTRACTOR.

PROTECT DRAINAGE PIPE AS INSTALLED BY GENERAL CONTRACTOR.

LANDSCAPE CONTRACTOR SHALL COORDINATE WITH THE PROJECT SUPERINTENDENT TO HAVE ALL DRAINAGE PIPE INSTALLED AND CONNECTED PRIOR TO BACKFILLING WITH BALLAST ROCKS, FILTER FABRIC, ETC. CONTRACTOR SHALL ALSO COORDINATE ALL IRRIGATION INSTALLATION TO INSURE COMPLETE OPERATION LOGISTICS REGARDING IRRIGATION AND DRAINAGE.

THE LANDSCAPE CONTRACTOR SHALL PROVIDE THE PLANTERS WITH AN APPROVED SOIL MIX.

CONTRACTOR SHALL SUBMIT TO THE LANDSCAPE ARCHITECT A SOIL SAMPLE AND A SOIL MATERIAL RATIO CHART FOR APPROVAL PRIOR TO INSTALLATION OF THE SOIL. SOIL MIX SHALL BE A SPECIAL MIX TO PROVIDE POROSITY FOR DRAINAGE, AND CONTAIN AMENDMENTS (PERLITE OR SIMILAR) TO REDUCE SOIL DENSITY AND WEIGHT. SOIL MIX SHALL BE AS PER ATLAS PEAT AND SOIL OR TOM WATERS INC. SOIL MIX OR AN APPROVED EQUAL TO CONTAIN EQUAL OR FORMULATED RATIOS OF THE FOLLOWING:

1. SILICA
2. SOIL
3. COMPOST
4. PERLITE
5. SHAVINGS

THE CONTRACTOR SHALL BE RESPONSIBLE TO FILL THE PLANTING MIX TO A DEPTH WHICH WILL BE 4" FROM THE TOP OF THE PLANTING WALL. SOIL & BALLAST ROCK QUANTITIES ARE APPROX. & WILL BE THE RESPONSIBILITY OF THE CONTRACTOR FOR FINAL GRADE AS PER THIS NOTE.

WALL IMPERMEABILIZATION, DRAINS AND EYE HOOKS SHALL BE PREPARED & INSTALLED BY THE GENERAL CONTRACTOR.

THE LANDSCAPE AND IRRIGATION CONTRACTORS SHALL COORDINATE ALL WORK WITH THE PROJECT MANAGER AND ALL PERTINENT SUBCONTRACTORS TO INSURE A PROFESSIONAL EXPEDITIOUS PROCESS.

ALL PLANTING BEDS SHALL BE MULCHED WITH AN APPROVED RECYCLED MULCH, OR AN APPROVED EQUAL. SEE 'LANDSCAPE NOTES'.

THE CONTRACTOR SHALL SUBMIT PHOTOS FOR ALL SPECIMEN PLANT MATERIAL (ALL PALMS AND TREES) TO THE L.A. FOR APPROVAL PRIOR TO PLANTING.

PLANTLIST			
SYM.	NATIVE *	NAME	BOTANICAL NAME SPECIFICATION
* SINGLE ASTERISK = PROVIDE PHOTOS FOR OWNER APPROVAL PRIOR TO PURCHASE			
** DOUBLE ASTERISK = AT TIME OF PLANTING			
** ACCENTS AND GROUNDCOVERS			
* CHA	4	EUROPEAN FAN PALM	Chamerops humilis 15 gal, 4' o.a., full
DIY	145	YELLOW AFRICAN IRIS	Dietes bicolor 3 gal, 12" x 18", 18' o.a., full
FUR	3	GIANT FALSE AGAVE	Furcraea foetida 15 gal, 4' x 4', full specimen
* JAT	2	RED JATROPHA	Jatropha spp. 25 gal, 5' o.a., MULTI TRUNK
PEG	165	GREEN FOUNTAIN GRASS	Pennisetum setaceum 3 gal, 18" x 18", 24" o.a., full
TOPSOIL:			
TOPSOIL SAND MIX			
43 c.y. '2100 MIX' FOR PLANTING-PER ATLAS PEAT AND SOIL FOR PLANTER BOXES			
*Based on 581 s.f. x 2' depth= 1162 c.f./ 27= 43 c.y.			
MULCHING:			
5 c.y. DRK BRN RECYCLED MULCH 3' DEPTH, SPREAD IN PLACE, ATLAS PEAT AND SOIL			
PROVIDE SAMPLE FOR APPROVAL PRIOR TO INSTALLATION			
--- TOPSOIL, SOD AND MULCH QUANTITIES SHOWN ARE APPROXIMATE, CONTRACTOR TO PROVIDE A UNIT PRICE PER UNIT AND WILL BE PAID ON THAT UNIT PRICE BASIS UPON FINAL INSPECTION AND APPROVAL.			
INSTALLATION WATERING:			
CONTRACTOR SHALL THOROUGHLY WATER-IN ALL PLANTINGS WHEN PLANTED, AND SHALL CONTINUE WATERING UNTIL FINAL INSPECTION AND APPROVAL BY THE LOCAL GOVERNING AGENCY AND THE OWNER.			
REPLACEMENT PLANTING NOTE: ANY PLANT MATERIAL THAT IS DEAD, DYING OR LESS THAN FLORIDA GRADE #1 WILL BE REPLACED BY THE OWNER WITH THE SAME OR SIMILAR SPECIES AND SIZED WITHIN 60 DAYS OF PROBLEM IDENTIFICATION.			

PRIVATE RESIDENCE
1728 LENOX AVE.
MIAMI BEACH, FL. 33319

No.	Date	Revision
1.	05/10/24	Site Plan modifications per Project Architect.

designed: JIMMYTICO
drawn: WENDY M.
checked: T.Y. MORAN
approved: J. F. SOGASH
project #: 23-33
scale: AS SHOWN
date: Nov. 7, 2023
folio: 02-3234-004-0190

Drawing:
L-2



A WRITTEN TREE REMOVAL PERMIT IS REQUIRED FROM THE CITY OF MIAMI BEACH PRIOR TO REMOVAL OF ANY REGULATED TREES OR PALMS FROM THE SITE.
SEE SHEET TD-2 FOR ISA CERTIFIED ARBORIST REPORT.

SEE LANDSCAPE PLANS FOR LANDSCAPE DESIGN, LANDSCAPE LEGEND, DETAILS, NOTES, SPECIFICATIONS, ETC.
SEE IRRIGATION PLANS FOR IRRIGATION DESIGN, LAYOUT, DETAILS, NOTES, ETC.

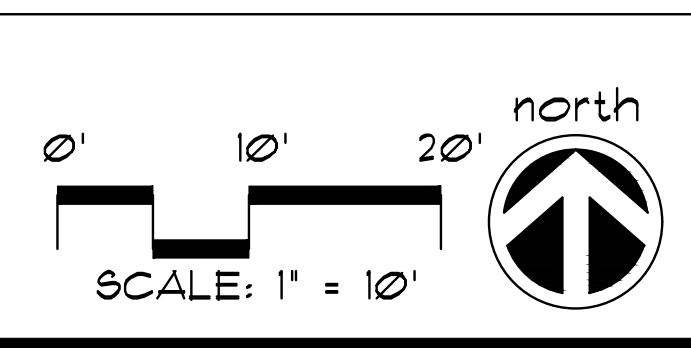

FIRST FLOOR LANDSCAPE PLAN

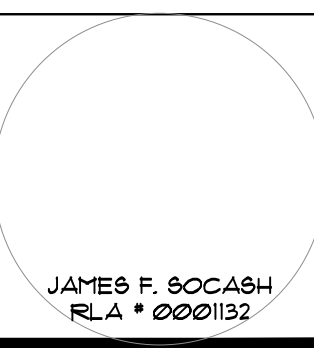

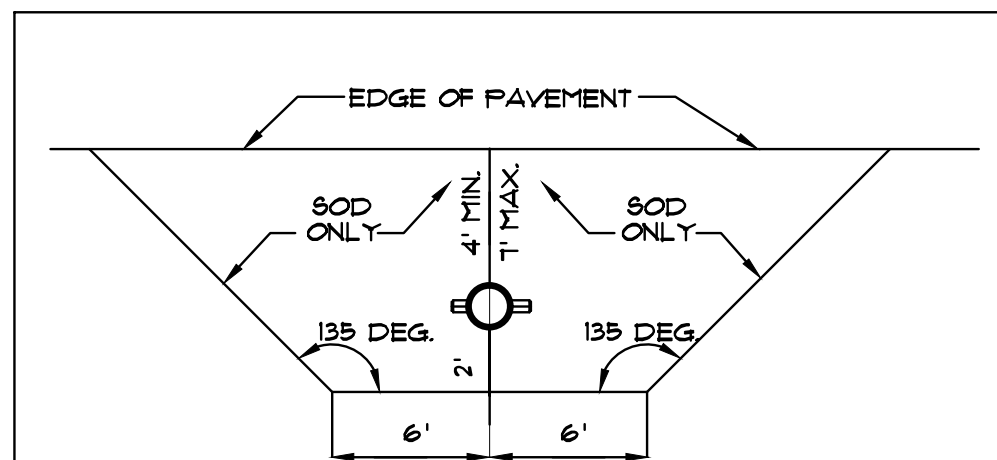

REQUIREMENTS APPLY TO FIRE HYDRANTS, SIAMSE CONNECTIONS AND ANY OTHER FIRE EQUIPMENT FOR UTILIZING FIRE HOSE, ON PUBLIC OR PRIVATE PROPERTY.

BY THE AUTHORITY OF THE SOUTH FLORIDA FIRE PREVENTION CODE SECTION 5212

THIS DIAGRAM SHALL APPEAR ON ALL LANDSCAPE PLANS PRIOR TO APPROVAL.

THE CLEAR ZONE SHALL BE FREE OF LANDSCAPE (EXCEPT SOD), MAILBOXES, PARKING, LAMP-POSTS AND ALL OTHER OBJECTS.

EXCEPTIONS: OTHER FIRE FIGHTING EQUIPMENT OR TRAFFIC POSTS TO PREVENT FIRE FIGHTING EQUIPMENT.

FIRE HYDRANT CLEAR ZONE

N.T.S.

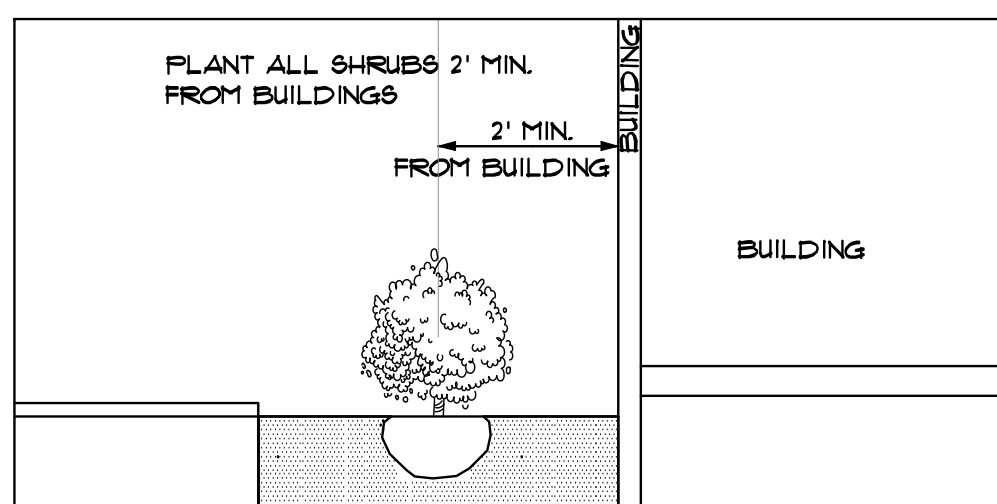

SHRUB PLANTINGS BUILDING DETAIL

N.T.S.

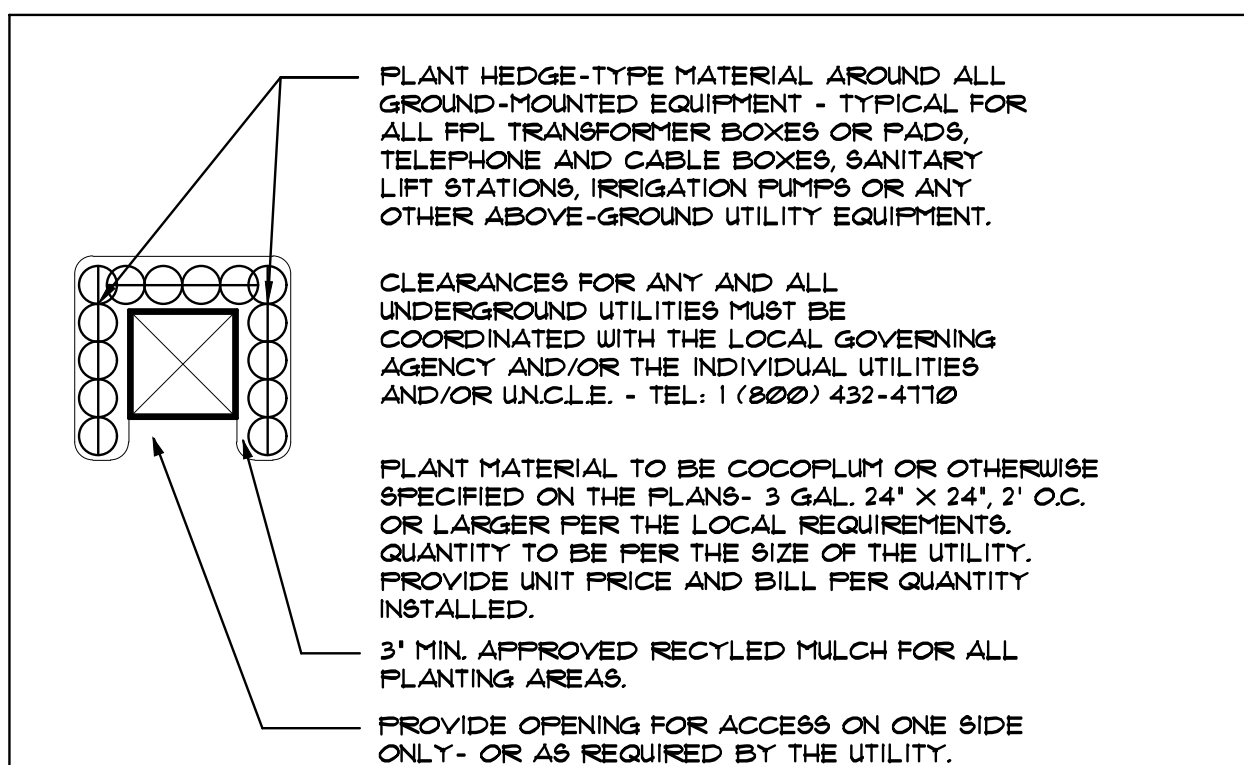

TYPICAL PLANTINGS FOR GROUND-MOUNTED EQUIPMENT

N.T.S.

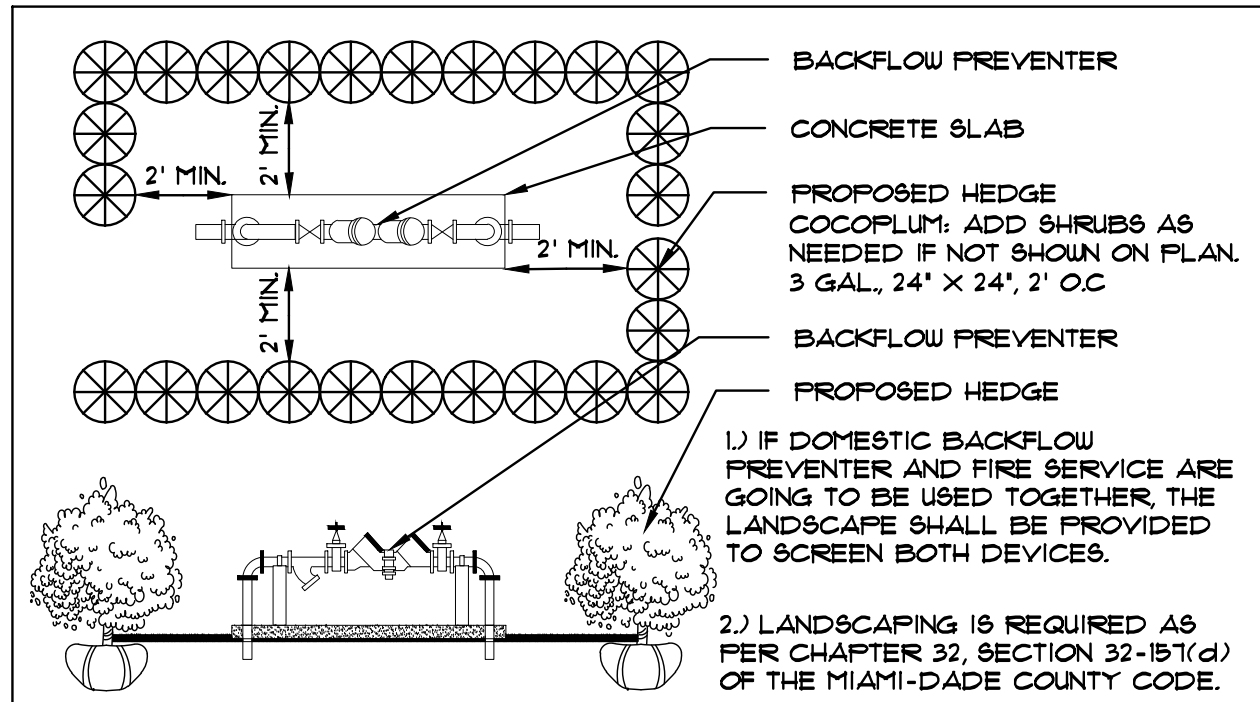

TYPICAL PLANTING SCREEN FOR ABOVE-GROUND UTILITIES

N.T.S.

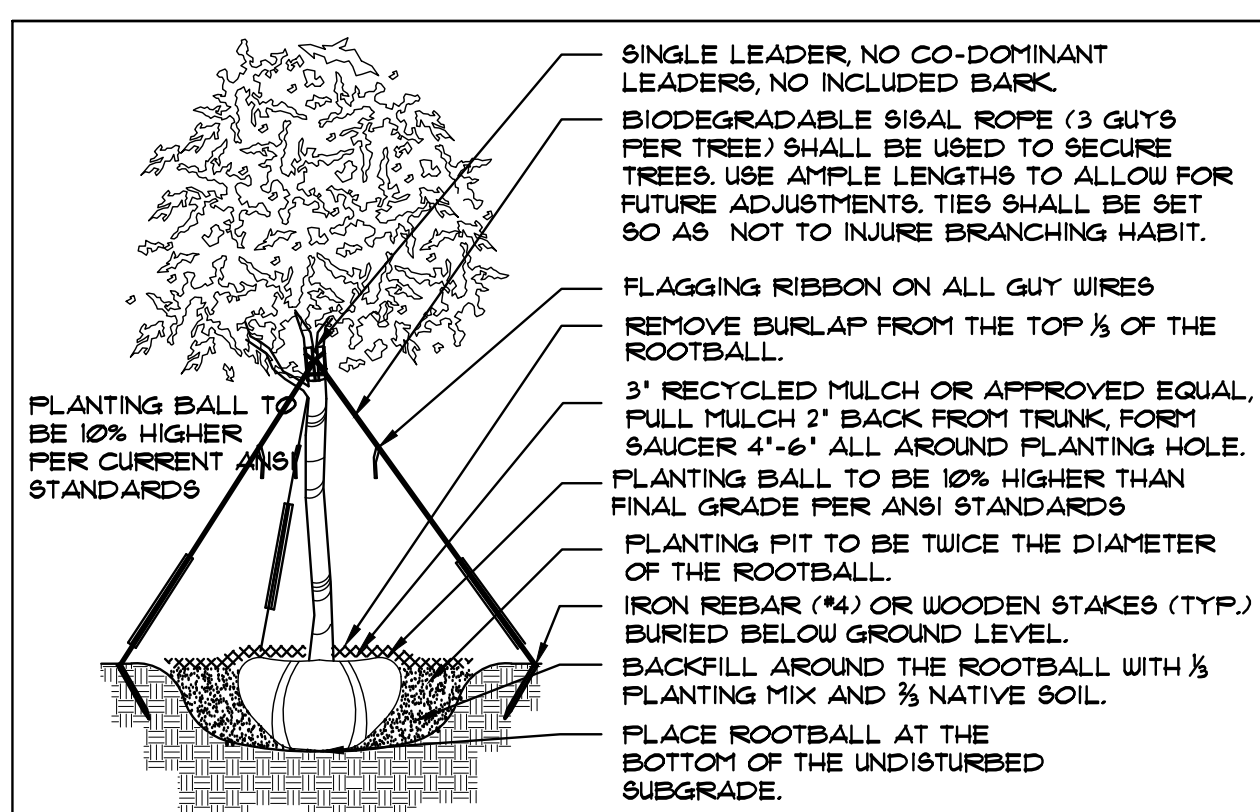

TREE PLANTING DETAIL

N.T.S.

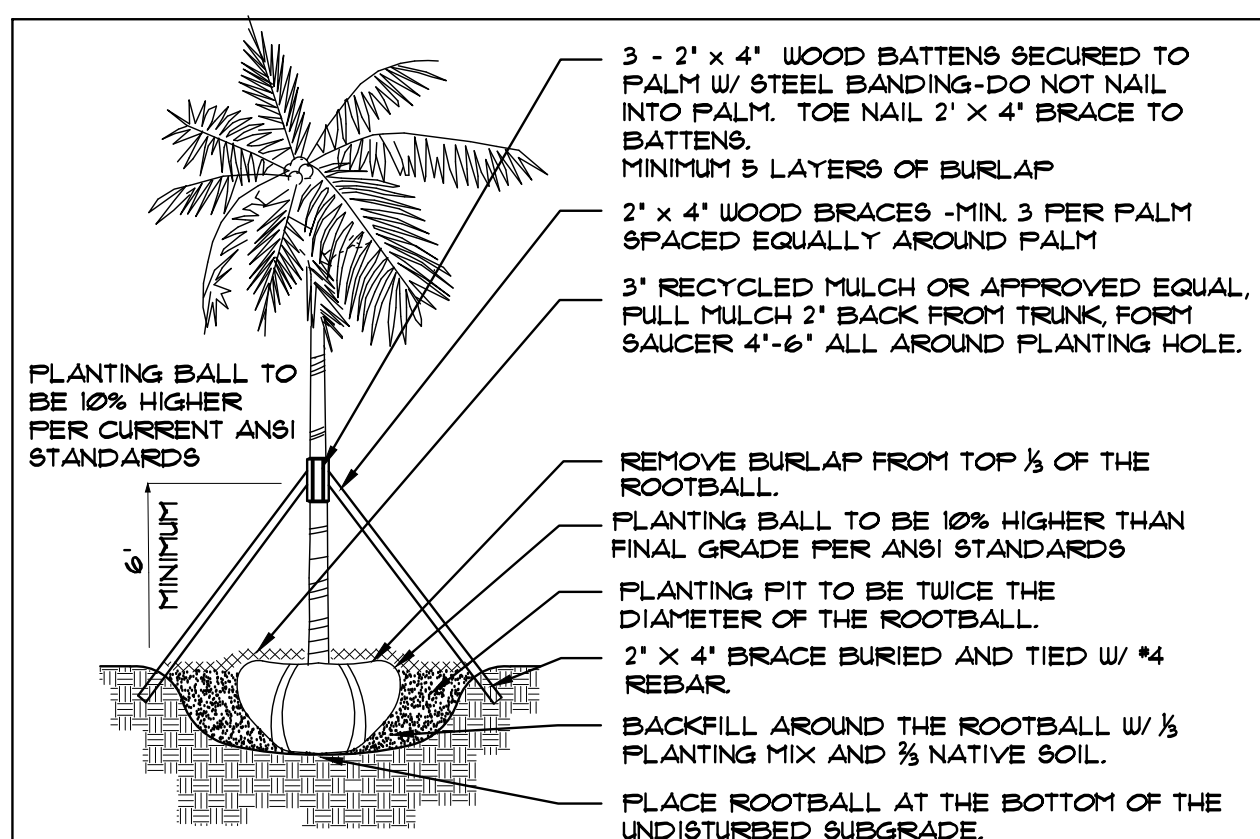

PALM PLANTING DETAIL

N.T.S.

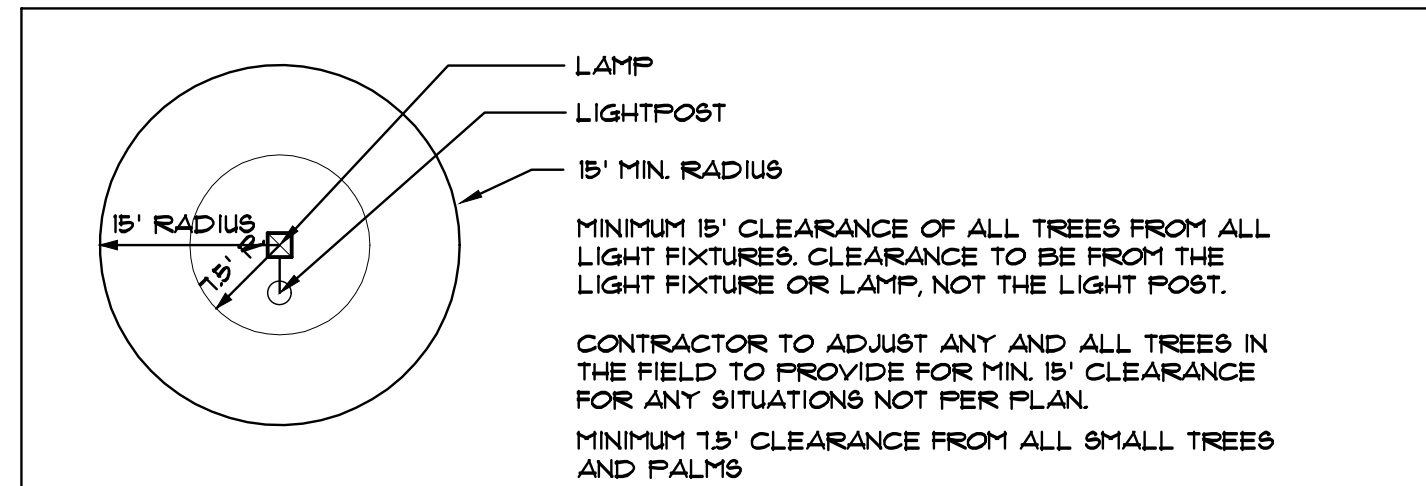

MINIMUM TREE CLEARANCE FROM LIGHT FIXTURES

N.T.S.

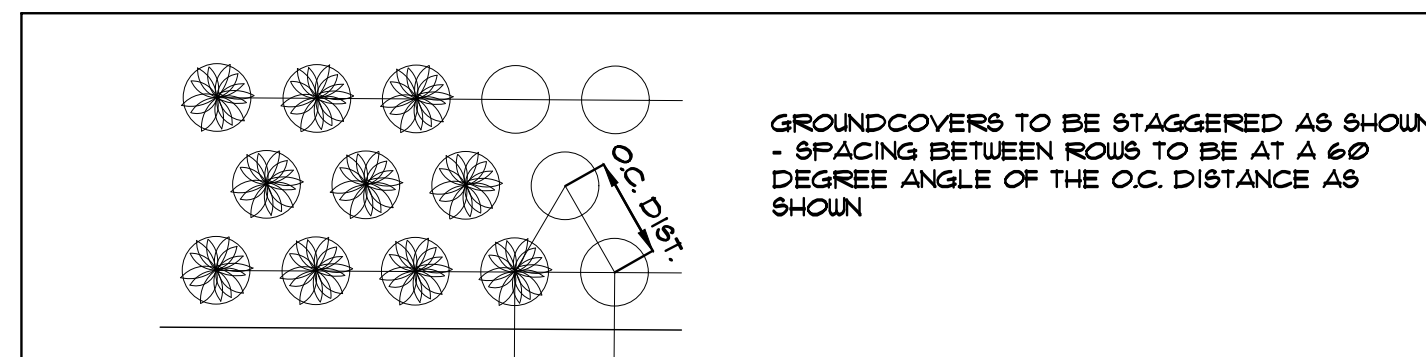

GROUNDCOVER DETAIL

N.T.S.

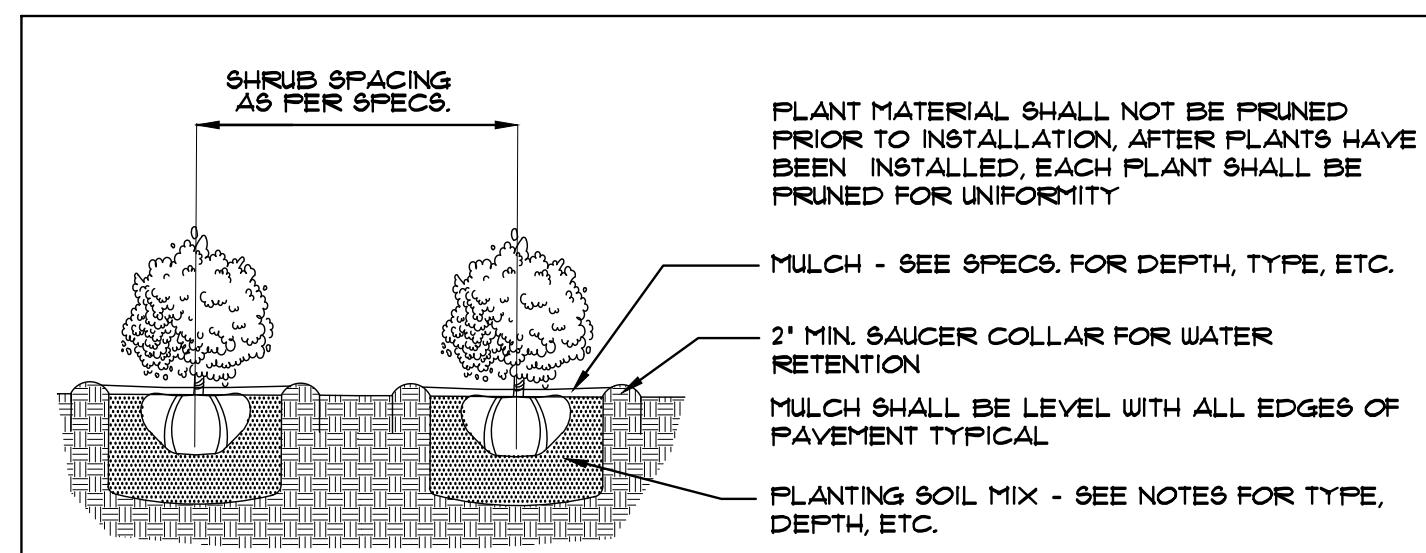

SHRUB PLANTING DETAIL

N.T.S.

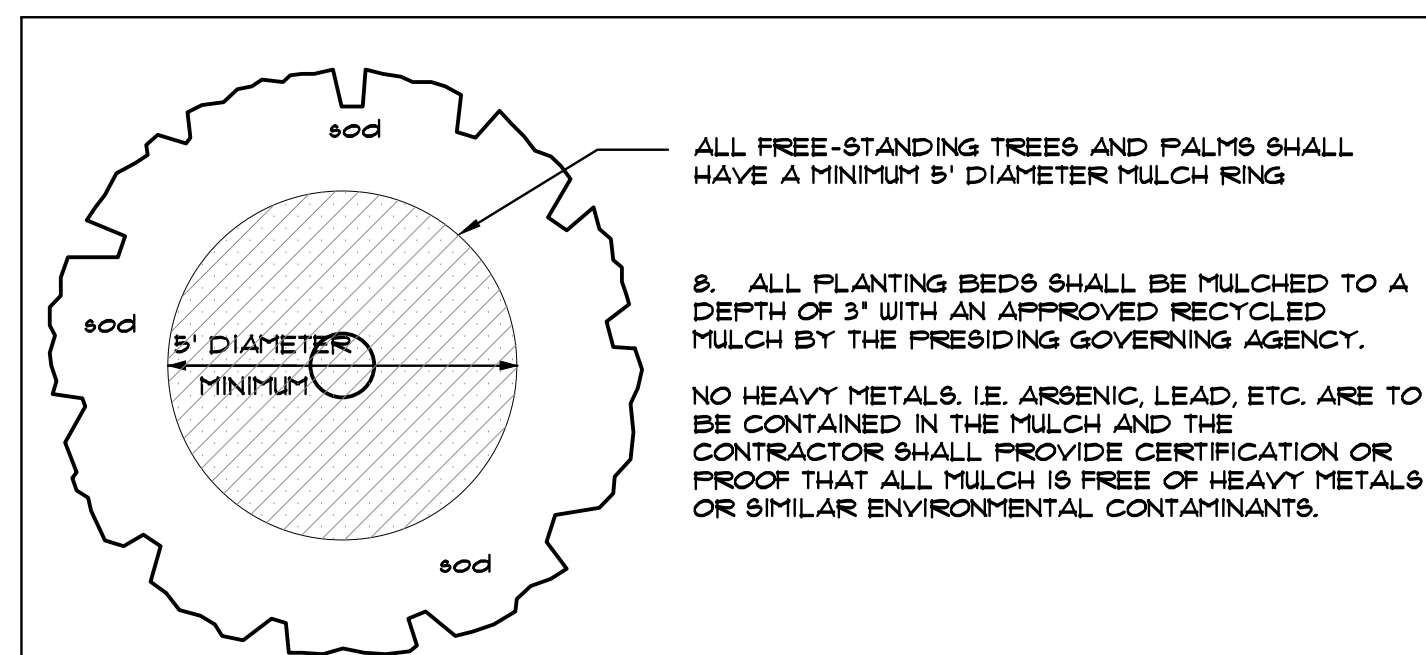

TYPICAL MULCH RING FOR FREE-STANDING TREES AND PALMS

N.T.S.

LANDSCAPE NOTES

- ALL PLANT MATERIAL SHALL BE FLORIDA NO. 1 GRADE OR BETTER.
- CONTRACTOR SHALL FAMILIARIZE HIMSELF WITH THE LOCATION OF AND AVOID AND PROTECT UTILITY LINES, BURIED CABLES, AND OTHER UTILITIES.
- TREE, PALM, ACCENT AND BED LINES ARE TO BE LOCATED IN THE FIELD AND APPROVED BY THE LANDSCAPE ARCHITECT PRIOR TO INSTALLATION.
- ALL PLANTING SOIL SHALL BE 50:50 TOPSOIL:SAND MIX, FREE OF CLAY, STONES, ROCKS, OR OTHER FOREIGN MATTER. THIS SPECIFICATION INCLUDES ALL BACKFILL FOR BERMS AND OTHER LANDSCAPE AREAS.
 - SODDED-LAWN AREAS: 2\"/>
- THE SITE CONTRACTOR SHALL BE RESPONSIBLE TO BRING ALL GRADES TO WITHIN 2\"/>
- THE LANDSCAPE CONTRACTOR SHALL CALCULATE AND SUBMIT AN ITEMIZED PRICE FOR THE 2\"/>
- CONTRACTOR SHALL COORDINATE WITH THE IRRIGATION CONTRACTOR AND LEAVE PROVISIONS FOR ALL, INCLUDING UNDERGROUND UTILITY LINE LOCATIONS DIAL 811 "NO CUTS" AS REQUIRED BY LAW.
- ALL PLANTING BEDS SHALL BE MULCHED TO A DEPTH OF 3\"/>
- SOD SHALL BE ARGENTINE "BAHIA" OR ST. AUGUSTINE "FLORATAM" AS SHOWN ON THE PLANS, STRONGLY ROOTED, FREE FROM WEED, FUNGUS, INSECTS AND DISEASE. CONTRACTOR SHALL SOD ALL AREAS AS INDICATED ON THE PLAN OR AS DIRECTED. PAYMENT SHALL BE DETERMINED BY THE TOTAL MEASURED SODDED AREAS X THE UNIT PRICE SUBMITTED AND FIELD VERIFIED.
- SOD SHALL BE INSTALLED IN ACCORDANCE WITH THE SPECIFICATIONS AS DEFINED BY FDOT. SOD SHALL CARRY A 5-MONTH WARRANTY.
- ALL TREES, PALMS, SHRUBS AND GROUNDCOVERS SHALL CARRY A ONE-YEAR WARRANTY FROM THE DATE OF FINAL ACCEPTANCE.
- ALL TREES AND PALMS SHALL BE STAKED PER ACCEPTED STANDARDS BY THE FLORIDA NURSERYMEN & GROUERS LANDSCAPE ASSOCIATION (FNLGA). THERE SHALL BE ONE FINAL INSPECTION FOR APPROVAL BY THE PRESIDING GOVERNING AGENCY. CONTRACTOR SHALL INSURE THAT THE PLANS, DETAILS, SPECIFICATIONS AND MATERIALS HAVE BEEN ADHERED TO AND THAT THE LANDSCAPE AND IRRIGATION INSTALLATION IS COMPLIANT TO ALL ITEMS AS DIRECTED ON THE PLANS PRIOR TO SCHEDULING OF THE FINAL INSPECTION.
- THE PLANT LIST IS INTENDED ONLY AS AN AID TO BIDDING. ANY DISCREPANCIES FOUND BETWEEN THE QUANTITIES ON THE PLAN AND PLANT LIST, THE QUANTITIES ON THE PLAN SHALL BE HELD VALID.
- IRRIGATION SHALL PROVIDE FOR A 100% COVERAGE WITH A 100% OVERLAP. AUTOMATIC SYSTEM W/ RAIN MOISTURE SENSOR ATTACHED TO CONTROLLERS. ALL FLORIDA BUILDING CODE APPENDIX "F" IRRIGATION REQUIREMENTS SHALL BE STRICTLY ADHERED TO FOR INSTALLATION AND PREVAILING WATER MANAGEMENT DISTRICT RESTRICTIONS AND REGULATIONS SHALL BE IN COMPLIANCE FOR POST-INSTALLATION WATERING SCHEDULES.
- EXISTING IRRIGATION SYSTEM (IF APPLICABLE) SHALL BE RETROFITTED TO COMPLY WITH THOSE SPECIFICATIONS AS OUTLINED ABOVE.
- CONTRACTOR SHALL PROVIDE A WATER TRUCK DURING PLANTING TO INSURE PROPER WATERING-IN DURING INSTALLATION AND WILL BE RESPONSIBLE FOR CONTINUAL WATERING UNTIL FINAL ACCEPTANCE BY THE OWNER.
- ALL EXISTING TREES, PALMS AND PLANT MATERIAL TO REMAIN SHALL BE PROTECTED DURING CONSTRUCTION. CONTRACTOR SHALL INSTALL PROTECTIVE BARRIERS SUCH AS "TENAX" PROTECTIVE FENCING OR AS SHOWN ON THE DETAILS TO BE INSTALLED AT THE BEGINNING OF THE PROJECT. BARRIERS SHALL BE LOCATED TO INCLUDE THE DRIFLINE OF THE TREES, PALMS AND PLANT MATERIAL WHERE POSSIBLE. THE CONTRACTOR SHALL TAKE EXTRA CAUTION TO PREVENT ANY DAMAGE TO THE TRUNK, BRANCHES, ROOTS, ROOT ZONE AREAS AND ADJACENT GRADES.
- EXISTING TREES AND PALMS TO REMAIN SHALL BE TRIMMED PER ANSI-300 STANDARDS. SUPERVISION OF THE TRIMMING SHALL BE PERFORMED BY AN ISA-CERTIFIED ARBORIST.
- ALL EXISTING TREES AND PALMS SHALL BE "LIFTED AND THINNED" TO PROVIDE FOR AN 8\"/>
- REMOVAL OF ANY TREES OR PALMS WILL REQUIRE A WRITTEN "TREE REMOVAL PERMIT" FROM THE LOCAL GOVERNING AGENCY PRIOR TO REMOVAL.
- ALL PLANTINGS IN NON-IRRIGATED AREAS, I.E. RIGHTS OF WAYS, SVALES, ETC. SHALL BE WATERED-IN THOROUGHLY AND CONTINUED TO BE WATERED THROUGHOUT UNTIL CO. ACCEPTANCE. COORDINATE WITH OWNER AND PROJECT MANAGER TO PROVIDE POST CO. WATERING TO INSURE PLANT ESTABLISHMENT FOR A MINIMUM OF ONE YEAR AFTER CERTIFICATE OF OCCUPANCY ACCEPTANCE.
- THE LANDSCAPE CONTRACTOR SHALL SCHEDULE A PRE-CONSTRUCTION CONFERENCE WITH THE LOCAL GOVERNING AGENCY, GENERAL CONTRACTOR, LANDSCAPE ARCHITECT, AND IRRIGATION CONTRACTOR PRIOR TO COMMENCEMENT OF WORK.

PRIVATE RESIDENCE

1728 LENOX AVE.
MIAMI BEACH, FL. 33319

No.	Date	Revision
1.	05/10/24	Site Plan modifications per Project Architect.

designed:	JIMMYTICO
drawn:	WENDY M.
checked:	T.Y. MORAN
approved:	J. F. SOCCASH
project #:	23-33
scale:	AS SHOWN
date:	Nov. 7, 2023
folio:	02-2324-004-0190

Drawing:
L-3



A WRITTEN TREE REMOVAL PERMIT IS REQUIRED FROM THE CITY OF MIAMI BEACH PRIOR TO REMOVAL OF ANY REGULATED TREES OR PALMS FROM THE SITE.

SEE SHEET TD-2 FOR ISA CERTIFIED ARBORIST REPORT.

SEE LANDSCAPE PLANS FOR LANDSCAPE DESIGN, LANDSCAPE LEGEND, DETAILS, NOTES, SPECIFICATIONS, ETC.

SEE IRRIGATION PLANS FOR IRRIGATION DESIGN, LAYOUT, DETAILS, NOTES, ETC.

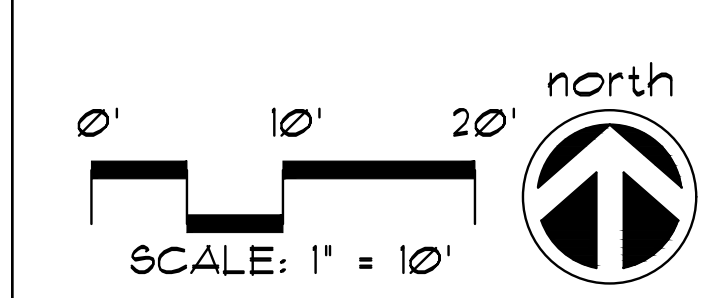

LANDSCAPE NOTES, DETAILS, SPECIFICATIONS, ETC.

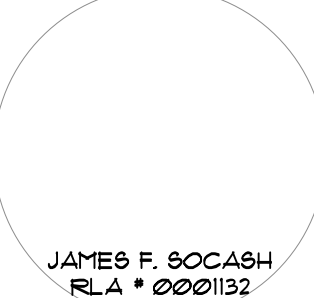

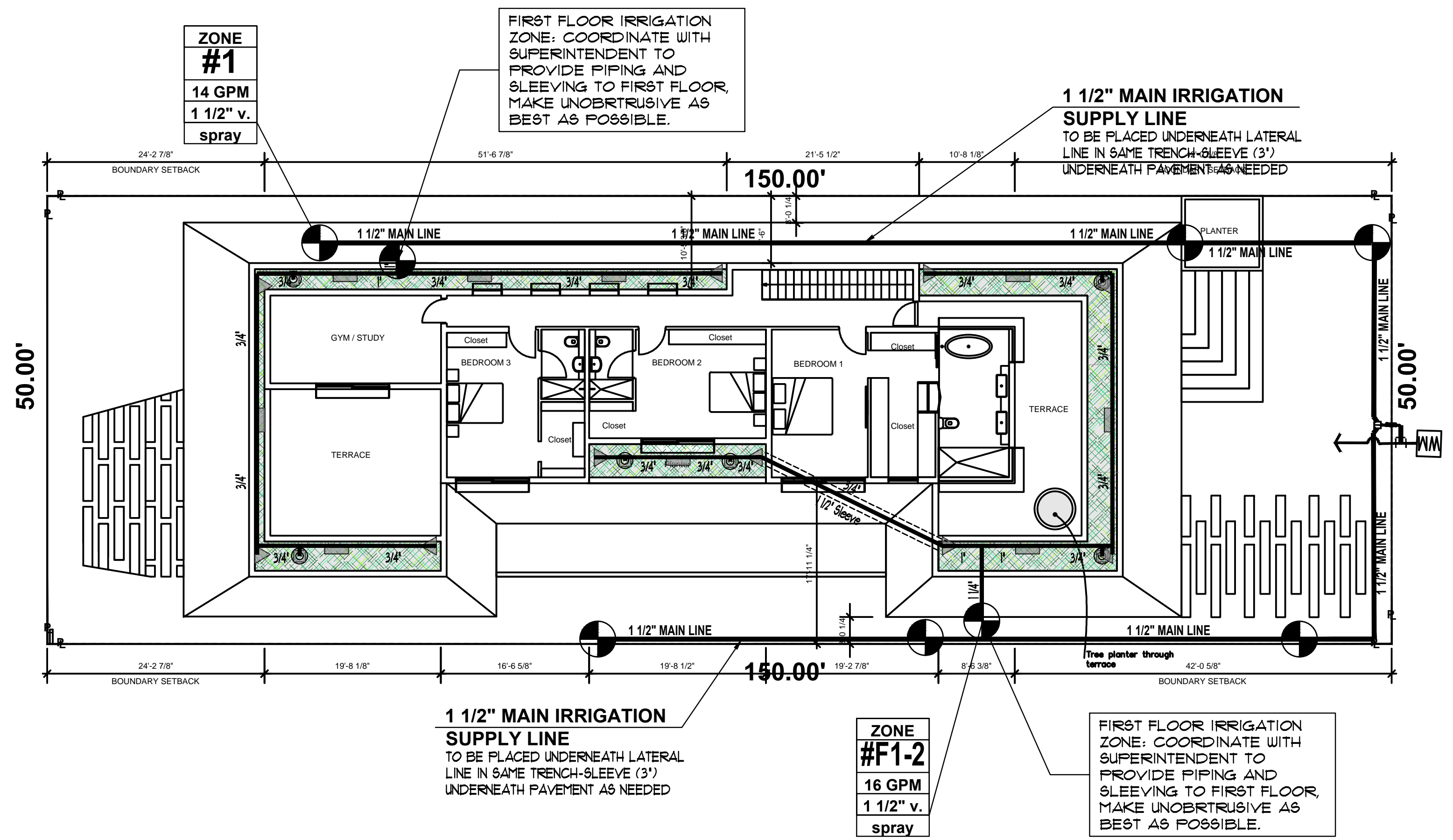

LENOX AVENUE

PRIVATE RESIDENCE

1728 LENOX AVE.
MIAMI BEACH, FL. 33319

No.	Date	Revision
1.	05/06/24	Site Plan modifications per Project Architect.

designed:	JIMMYTICO
drawn:	WENDY M.
checked:	T.Y. MORAN
approved:	J. F. SOGASH
project #:	23-33
scale:	AS SHOWN
date:	Nov. 7, 2023
Folio:	02-3234-004-0190

Drawing:
IRR-2



A WRITTEN TREE REMOVAL PERMIT IS REQUIRED FROM THE CITY OF MIAMI BEACH PRIOR TO REMOVAL OF ANY REGULATED TREES OR PALMS FROM THE SITE.
SEE SHEET TD-2 FOR ISA CERTIFIED ARBORIST REPORT.

SEE LANDSCAPE PLANS FOR LANDSCAPE DESIGN, LANDSCAPE LEGEND, DETAILS, NOTES, & SPECIFICATIONS, ETC.
SEE IRRIGATION PLANS FOR IRRIGATION DESIGN, LAYOUT, DETAILS, NOTES, ETC.

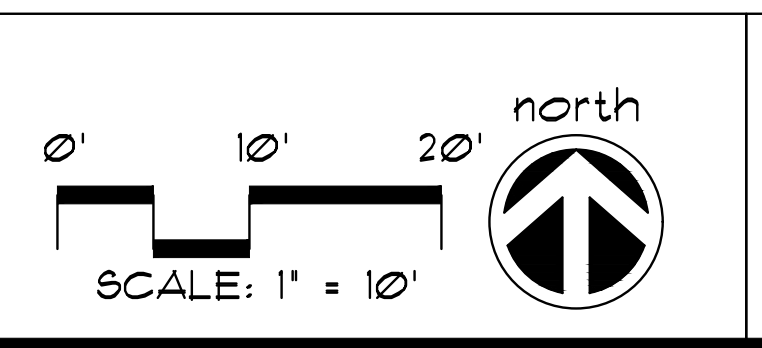

FIRST FLOOR IRRIGATION PLAN

