

Landscape Plan
SCALE 3/32" = 1'-0"

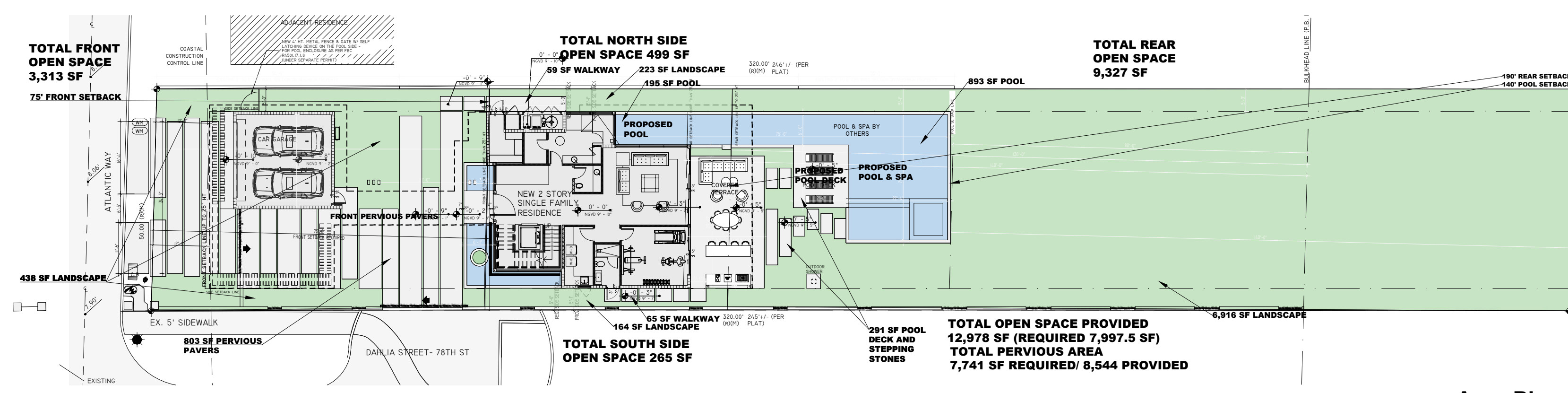

Area Plan

- LANDSCAPE NOTES**
- ALL PLANT MATERIAL SHALL BE GRADED FLORIDA #1 OR BETTER, AS DEFINED IN THE GRADES AND STANDARDS FOR NURSERY PLANTS, PART I AND II BY THE STATE OF FLORIDA, DEPARTMENT OF AGRICULTURE.
 - ALL PLANTS NOT LISTED IN GRADES AND STANDARDS FOR NURSERY PLANTS, PUBLISHED BY THE FLORIDA DEPARTMENT OF AGRICULTURE AND CONSUMER AFFAIRS SHALL CONFORM TO A FLORIDA NO. 1 AS TO (1) HEALTH AND VITALITY, (2) CONDITION OF FOLIAGE, (3) ROOT SYSTEM, (4) FREEDOM FROM PEST OR MECHANICAL DAMAGE, (5) HEAVILY BRANCHED AND DENSELY FOLIATED ACCORDING TO THE ACCEPTED NORMAL SHAPE OF THE SPECIES.
 - ALL LANDSCAPE MATERIAL SHALL COMPLY WITH COUNTY, CITY OR LOCAL ORDINANCES.
 - SYMBOLS REPRESENT PLANTS AT MATURE STAGE, NEVER AT TIME OF INSTALLATION.
 - ALL TREES, SHRUBS AND GROUNDCOVERS SHALL RECEIVE 3" DEPTH OF SHREDDED MELALEUCA MULCH.
 - TERRA-SORB MOISTURE RETENTION GRANULES SHALL BE ADDED TO ALL TREE/PALM PITS AT THE RATE RECOMMENDED BY MANUFACTURER.
 - ALL PLANTING BEDS TO BE WEED AND GRASS FREE.
 - THERE SHALL BE A 24" WIDE STRIP OF MULCH BETWEEN STEM OF SHRUBS/GROUNDCOVERS AND SOD.
 - ALL TREES AND PALMS TO BE STAKED IN A GOOD WORK-MAN-LIKE MANNER, NO NAIL STAKING IS PERMITTED.
 - PLANTING SOIL SHALL CONSIST OF AN EVENLY BLENDED MIX OF 50% MUCK, 25% SAND, 15% SPHAGNUM PEAT MOSS & 10% SHEEP MANURE. TWO POUNDS OF FERTILIZER SHALL BE ADDED TO EACH CUBIC YARD OF PLANTING SOIL & THOROUGHLY MIXED. PLANTING SOIL SHALL HAVE A PH OF BETWEEN 6.0 & 7.0 AFTER MIXING & ADDITION OF FERTILIZER.
 - TOP SOIL SHALL CONSIST OF 80% SAND & 20% MUCK AND THOROUGHLY MIXED WITH A COMMERCIAL SHREDDER. MIX SHALL BE FREE OF ROCKS, LIMBS, ROOTS & OTHER MATTER.
 - AN UNDERGROUND AUTOMATIC IRRIGATION SYSTEM SHALL BE PROVIDED FOR ALL LANDSCAPE AREAS. THIS IS DESIGNED FOR "HEAD TO HEAD" COVERAGE.
 - LANDSCAPE CONTRACTOR SHALL REVIEW ALL DRAWINGS AND PREPARE HIS OWN TAKE-OFF AND PLANT LIST PRIOR TO BID COST, AND COMPARE TO LANDSCAPE ARCHITECT'S PLANT LIST.
 - LANDSCAPE CONTRACTOR IS RESPONSIBLE FOR ATTAINING ACCURATE COUNTS OF PLANT MATERIALS SPECIFIED, IN THE EVENT OF DISCREPANCIES, LANDSCAPE CONTRACTOR SHALL BRING TO THE ATTENTION OF THE LANDSCAPE ARCHITECT. PLAN SHALL TAKE PRECEDENCE OVER PLANT LIST - NO EXCEPTIONS!
 - LANDSCAPE CONTRACTOR SHALL LOCATE AND VERIFY ALL UNDERGROUND UTILITIES PRIOR TO DIGGING.
 - NO CHANGES SHALL BE MADE WITHOUT PRIOR CONSENT OF THE LANDSCAPE ARCHITECT AND OWNER.

GENERAL NOTES

NURSERY SUPPORT POLES SHALL BE REMOVED AT THE NURSERY, PRIOR TO DELIVERY, AND THAT TREES DELIVERED WITH THE NURSERY POLES WILL NOT BE ACCEPTED, AND THEREFORE REJECTED, WITH THE EXCEPTION OF THE FOLLOWING TREE SPECIES: CLUSIA ROSEA AND SILVER BUTTWOOD TREES

17. LANDSCAPE ARCHITECT SHALL NOT BE RESPONSIBLE FOR ANY DAMAGE CAUSED BY FALLING TREES OR TREE LIMBS DUE TO ROOT PRUNING AND STRESS CAUSED BY INSUFFICIENT LATERAL ROOTS AND/OR ANY OTHER DAMAGE TO TREES RELATED TO CONSTRUCTION. BEFORE ROOT PRUNING OR GRADING, LANDSCAPE ARCHITECT ADVISES THAT AN ARBORIST AND/OR A STRUCTURAL ENGINEER VERIFY THAT THE PROPOSED LATERAL ROOTS IN THE TREE ROOT PROTECTION ZONE ARE SUFFICIENT FOR TREES NOT TO FALL.

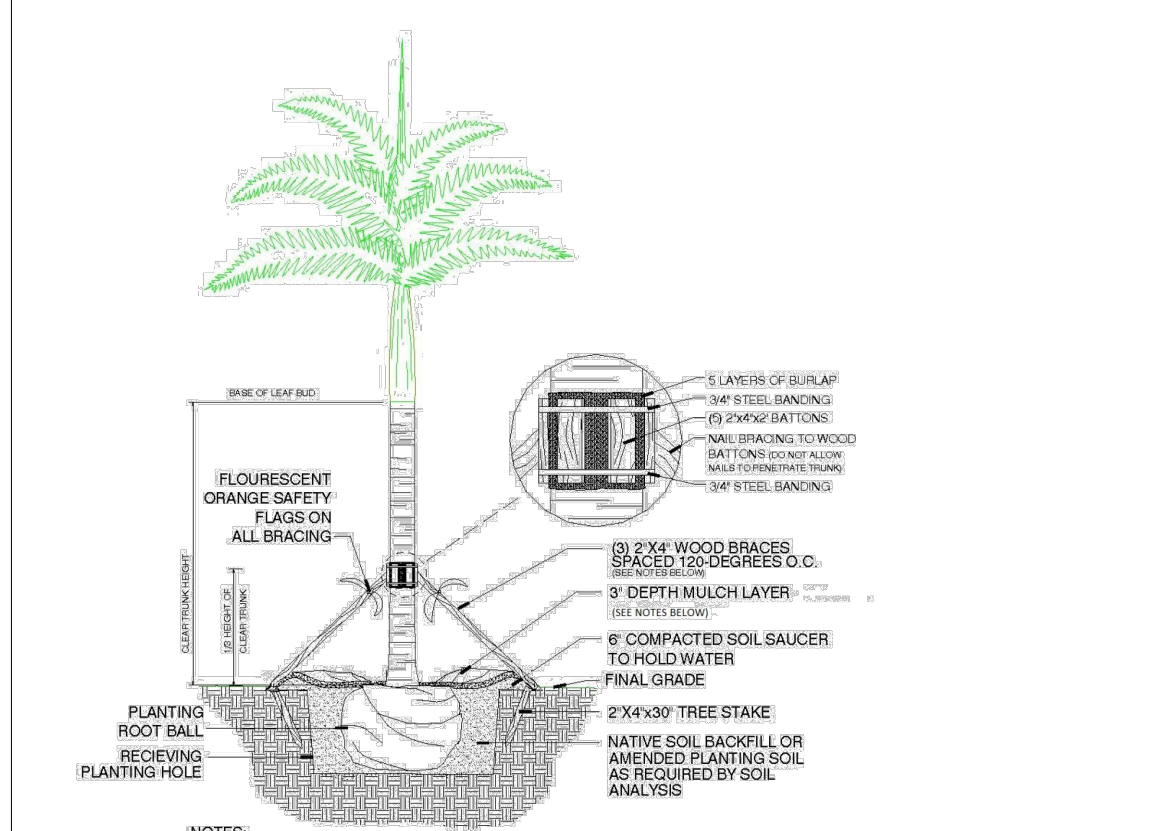

City of Miami Beach
Typical Palm Planting Detail
N.T.S.

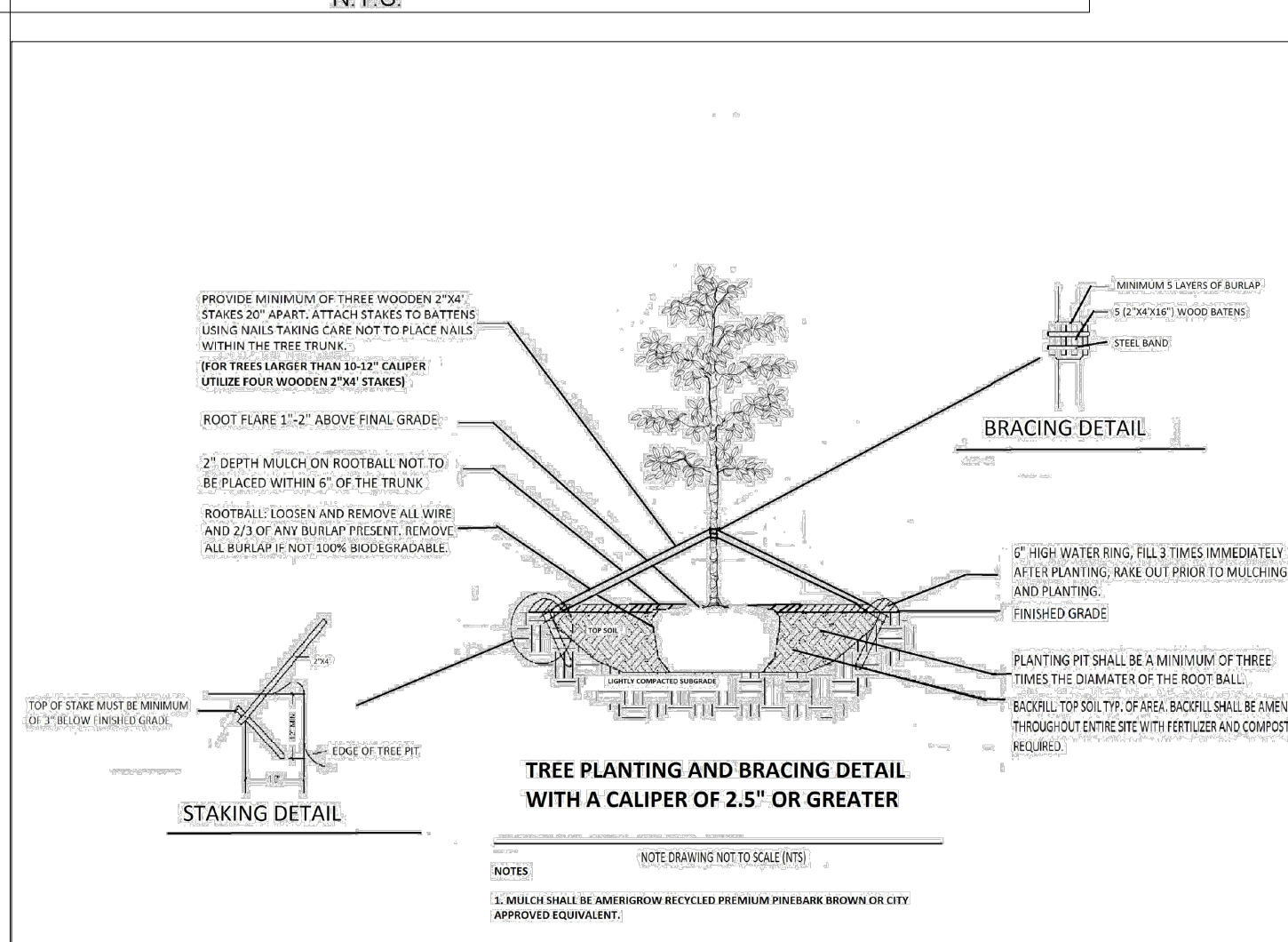

TREE PLANTING AND BRACING DETAIL WITH A CALIPER OF 2.5" OR GREATER

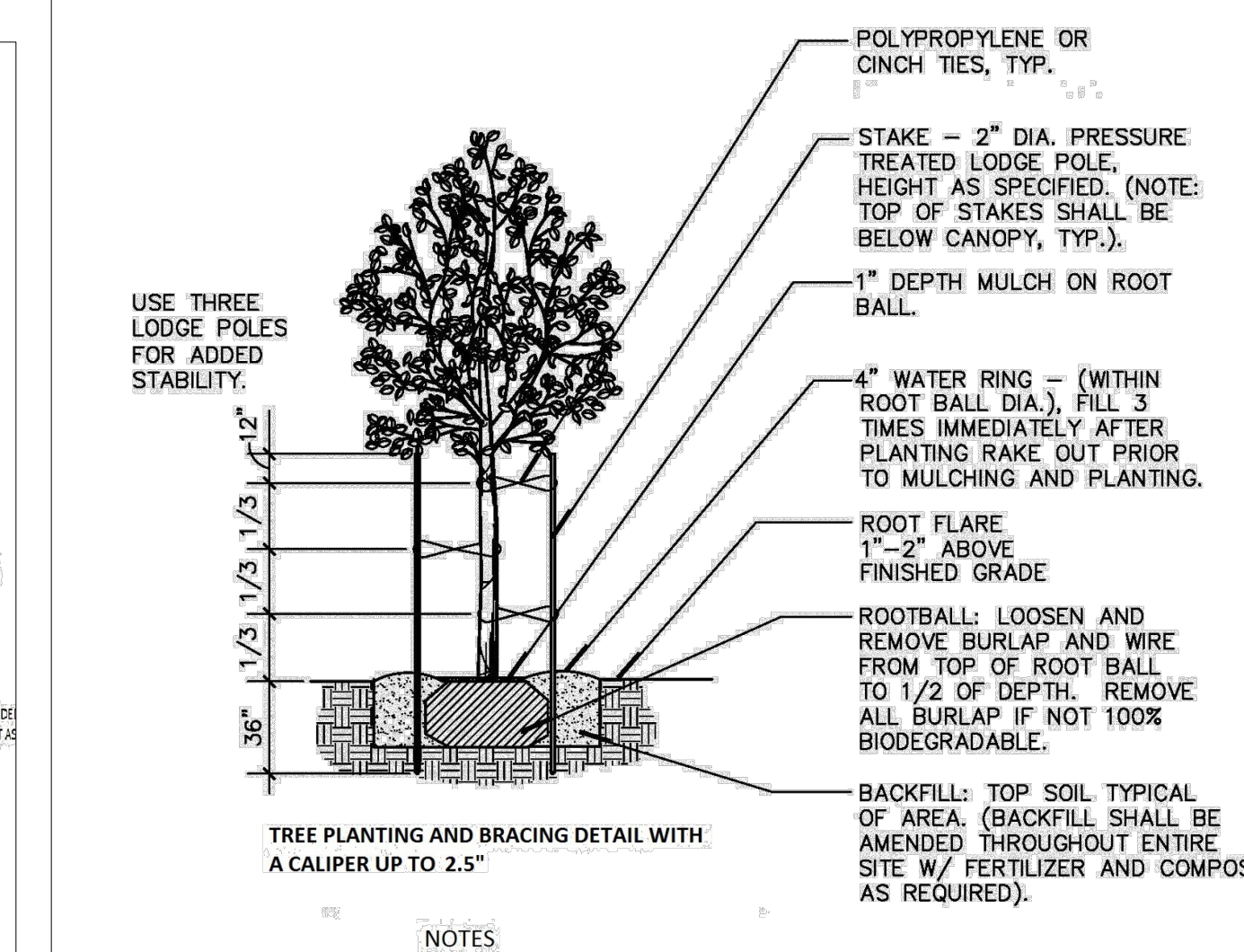

TREE PLANTING AND BRACING DETAIL WITH A CALIPER UP TO 2.5"

- NOTES**
- MULCH SHALL BE AMERIGROW RECYCLED PREMIUM PINEBARK, BROWN OR CITY APPROVED EQUIVALENT.
 - DO NOT APPLY MULCH WITHIN 6" OF THE TREE TRUNK

CODE REQUIREMENTS		
ZONING DISTRICT: RS-3	LOT AREA = 15,995 SF	
OPEN SPACE	REQUIRED	PROVIDED
A SQ. FT. OF REQUIRED OPEN SPACE AS INDICATED ON SITE PLAN LOT AREA = 15,995 SF X 50% (CHP 128 TABLE A) = 7,997.5 SF	7,997.5 SF	12,978 SF
B SQUARE FT. OF PARKING LOT OPEN SPACE REQUIRED AS INDICATED ON SITE PLAN NUMBER OF PARKING SPACES X 10 S.F. PARKING SPACE = ?	NA	NA
C TOTAL SQ. FT. OF LANDSCAPED OPEN SPACE REQUIRED: A+B	7,997.5 SF	12,978 SF
LAWN AREA CALCULATION		
A SQ. FT. OF LANDSCAPED OPEN SPACE REQUIRED	7,997.5 SF	12,978 SF
B MAXIMUM LAWN AREA (SOD) PERMITTED = 50% X 12,978 SF	6,489 SF	3,829 SF
TREES		
A NUMBER OF TREES REQUIRED PER LOT OR NET LOT ACRE: UP TO 6,000 SQ. FT. PROVIDE ONE ADDITIONAL TREE FOR EACH ADDITIONAL 1,000 SQUARE FEET. 15,995 SQ. FT. 10 ADDITIONAL TREES REQUIRED. RS-3 PER LOT (FRONT YARD) = 2, PER LOT (BACK YARD) 3. TOTAL TREES 5 MINIMUM REQUIREMENT = 10 (ADDITIONAL REQUIRED) = 16 TREES	16	19
B % NATIVES REQUIRED: NUMBER OF TREES PROVIDED (16) X 30% = 4.8 = 5	5	19
C % LOW MAINTENANCE / DROUGHT AND SALT TOLERANT REQUIRED: NUMBER OF TREES PROVIDED X 50% = 8	8	19
D STREET TREES (MAXIMUM AVERAGE SPACING 20' OC) / 50 LINEAR FEET ALONG STREET DIVIDED BY 20' = 2.5 ROUNDED TO 3	3	3
E STREET TREE SPECIES ALLOWED DIRECTLY BELOW POWER LINES: MAXIMUM AVERAGE SPACING OF 20' OC: N/A	N/A	N/A
SHRUBS		
A NUMBER OF SHRUBS REQUIRED: SUM OF LOT AND STREET TREES = 16 REQUIRED + 3 STREET TREES = 19 X 12 = 228	228	1,340
B % NATIVE SHRUBS REQUIRED: NUMBER OF SHRUBS PROVIDED X 50% =	114	1,042
LARGE SHRUBS OR SMALL TREES		
A NUMBER OF LARGE SHRUBS OR SMALL TREES REQUIRED: NUMBER OF REQUIRED SHRUBS 228 X 10% = 23	23	28
B % NATIVE LARGE SHRUBS OR SMALL TREES REQUIRED: NUMBER OF LARGE SHRUBS OR SMALL TREES PROVIDED X 50% = 11.5 = 12	12	26

PLANT SCHEDULE			
KEY	QUANTITY	PROPOSED MATERIAL	NATIVE WATER DESCRIPTION
SHRUBS			
DM	28	CARISSA MACROCARPA DWARF CARISSA	NO LOW 12" HT. X 12" SPR. FULL 12" OC.
TF	406	THYRSACUM FLORIDANUM DWARF FANPAGET CHEE GRASS	YES LOW 48" HT. X 24" SPR. FULL AS SHOWN
BE	258	BEGONIA	NO LOW 48" HT. X 24" SPR. FULL 24" OC.
PL	15	PHLOEDENDRON GIGANTEUM GIANT PHLOEDENDRON	NO LOW 24" HT. X 24" SPR. FULL AS SHOWN
MC	144	MALAMBENGERIA CAPILLARIS MARYLY GRASS	YES LOW 48" HT. X 48" SPR. FULL SHADE GRASS
MD	15	MONSTERA DELICIOSA SWISS CHEESE PLANT	NO LOW 24" HT. X 24" SPR. FULL AS SHOWN
CS	53	PHLOEDENDRON CONGO GREEN CONGO GREEN	NO LOW 24" HT. X 24" SPR. FULL AS SHOWN
BO	234	BONINA PANICULARIA SEEDS	YES LOW 18" HT. X 12" SPR. FULL 18" OC.
LI	80	LIRIOPE MUSCARI GREEN GIANT BLUE GIANT LIRIOPE	NO LOW 12" HT. X 12" SPR. FULL 12" OC.
RH	4	RHAPIS EXCELSA LADY PALM	NO MID 48" HT. X 24" SPR. 15 GAL. FULL 5 P.P. MIN.
PT	2	BEAUCAERNA RECURVATA PONTAL	NO LOW 9" HT. X 2" SPR. FULL HEAVY HEAD 15 GAL.
FM	166	FORSYTHIA MICROCARPA GREEN BILLOW FOGS	NO LOW 18" HT. X 18" SPR. 3 GALLONS 18" G.C. FULL
LAWN	3,829	BOVISA TERNATA (CONTRACTOR TO CHECK QUANTITIES FOR SITE)	NO MID SOLID BLENDED PINE
TREES AND PALMS			
TRM	19	PROPOSED MATERIAL	NATIVE WATER DESCRIPTION
SB	5	SONOCHARPUS ERECTUS GREEN BUTTWOOD	YES LOW 16" HT. X 8" SPR. X 4" C.T. X 2.5" CAL. FG. 88. FF. SINGLE MAIN LEADER
SB	5	SONOCHARPUS ERECTUS SERICEUS SILVER BUTTWOOD	YES LOW 16" HT. X 8" SPR. X 4" C.T. X 2.5" CAL. FG. 88. FF. SINGLE MAIN LEADER
SA	7	MALAMBENGERIA CAPILLARIS MARYLY GRASS	YES LOW 16" HT. X 8" SPR. X 4" C.T. X 2.5" CAL. FG. 88. FF. SINGLE MAIN LEADER
SA	7	DOCCOCCOBA UAUPEIRA BUA GRASS	YES LOW 16" HT. X 8" SPR. X 4" C.T. X 2.5" CAL. FG. 88. FF. SINGLE MAIN LEADER
SA	7	CLUSIA ROSEA	YES LOW 15" HT. X 8" SPR. X 4" C.T. X 2.5" CAL. FG. 88. FF. SINGLE MAIN LEADER
SA	7	PANDANUS UTILIS SPOON PINE	NO LOW 9" - 12" O.A. HT. 7' G. FULL HEAVY HEAD/ MULTIPLE TRUNKS
STREET TREES			
PP3	3	DOCCOCCOBA DIMORPHICA PANDAN PINE (STREET TREE 30' OC.)	YES LOW 16" HT. X 8" SPR. 2.5" CAL. FG. 88. FF. SINGLE MAIN LEADER
SMALL TREES/LARGE SHRUBS			
SD	21	CAPPARIS CHNOPLAOPHORA	YES LOW 10" HT. X 6" SPR. 1.5" CAL. FG. 88. FF. SINGLE MAIN LEADER
SD	5	ELIENNA ANGLARIS WHITE STOPPER	YES LOW 10" HT. X 6" SPR. 1.5" CAL. FG. 88. FF. SINGLE MAIN LEADER

TOPO GRAPHIC
 TOPO GRAPHIC LLC
 LAW 666853
 941-564-5016
 Miami Beach, FL / Punta Gorda, FL
 info@topographic.com

All ideas, designs, and indicated or represented by this drawing are owned by and are the exclusive property of ecopacheco llc, and were created, evolved and developed for the use in and in conjunction with the project herein referenced. No such ideas, designs, and plans shall be used or disclosed to any person, firm or corporation for any purpose whatsoever without the written permission of ecopacheco llc.

ecopacheco llc
 design consultants + project management
 www.ecopacheco.com
 (305) 915-8600
 juan@ecopacheco.com

7801 ATLANTIC WAY RESIDENCE
Landscape Plan
 7801 ATLANTIC WAY
 MIAMI BEACH, FL 33141

Project:

REVISIONS:

Scale:

Lic. # LA666853
 Manuel C. Alonso; A.S.L.A.

Drawing: LANDSCAPE PLAN

Date: 03.12.2023

Scale: 1/8" = 1' - 0"

Drawn by: JRP/MCA

Sheet No.:

L-1



TOPO GRAPHIC

TOPO GRAPHIC LLC
LA# 666653
941-564-0918
Miami Beach, FL / Punta Gorda, FL
info@topo-graphic.com

All ideas, designs, and indicated or represented by this drawing are owned by and are the exclusive property of TOPO GRAPHIC LLC and were created, evolved and developed for the use in and in conjunction with the project therein referenced. No such ideas, designs, and plans shall be used or disclosed to any person, firm or corporation for any purpose whatsoever without the written permission of TOPO GRAPHIC LLC.

ecopacheco llc
design consultants + project management
www.ecopacheco.com
(305) 915 6626
juan@ecopacheco.com

**7801 ATLANTIC WAY RESIDENCE
TREE DISPOSITION PLAN**

7801 ATLANTIC WAY
MIAMI BEACH, FL 33141

Project:

Tree Disposition Plan

SCALE 1/8" = 1'-0"

REVISIONS:

Seal:

Lic. # LA666653
Manuel C. Alonso, A.S.L.A.

Drawing :LANDSCAPE PLAN
Date: 03.10.2023
Scale: 1/8" = 1' - 0"
Drawn by: JRP/MCA
Sheet No.:
TD-1

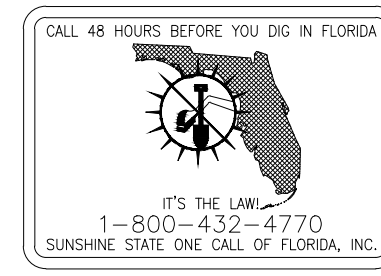
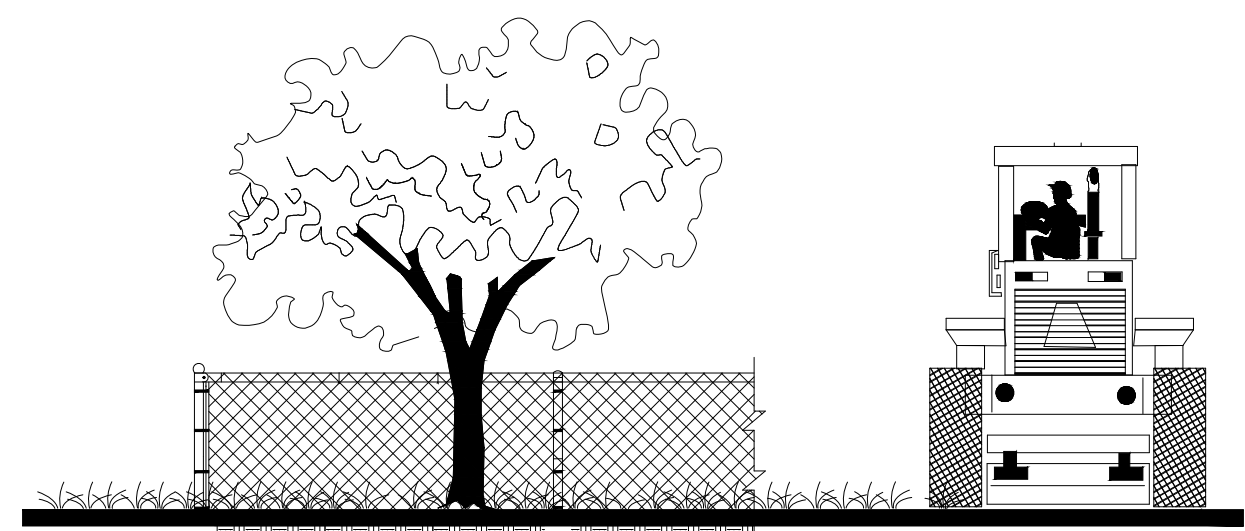

Chainlink Fencing
Barricade Shall Be Placed So As To Encompass
The Critical Protection Zone (CPZ)

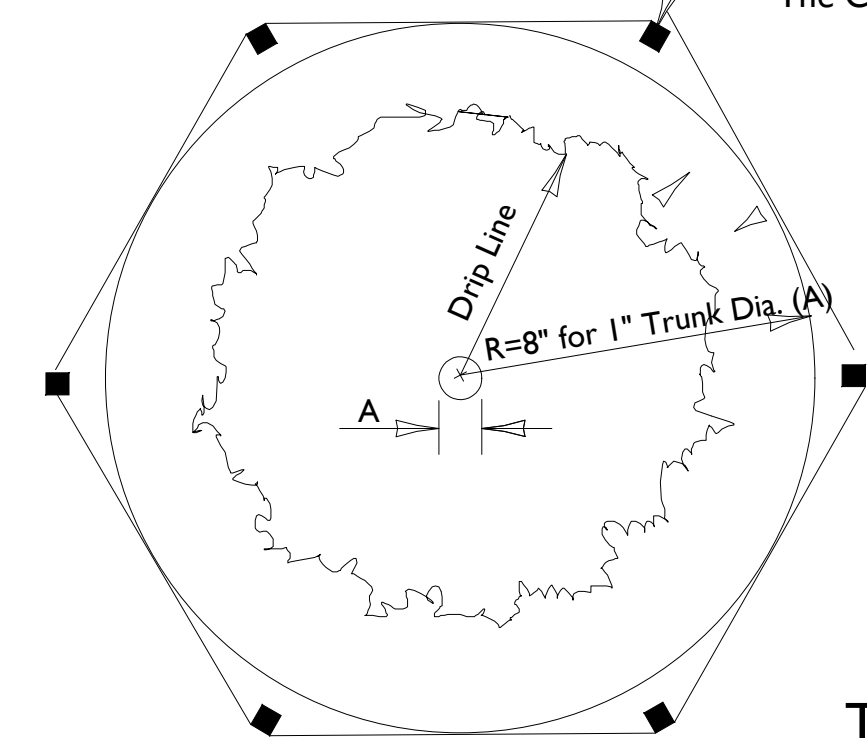

A=Inches Diameter 4.5' Above Grade Of Protected Tree
B=Tree Protection Zone (TPZ) That area Surrounding A Tree Within A Circle Described By A Radius Of 8" for 1" of Trunk Diameter Diameter measured At 4.5' Above Grade

TREE PROTECTION DETAIL
* THIS DETAIL APPLIES TO ALL TREES THAT WILL REMAIN OR BE RELOCATED

Jeff Szymanski, Certified Arborist FL-1052AM							
7801 Atlantic Way, Miami Beach							
EXISTING TREE TABLE							
Scientific name	Common name	DBH	H/CT	Canopy	Action	Mitigation	
1	Phoenix medjool	Medjool palm	17"	28'	28'	Relocate (in way of new driveway/garage)	N/A
2	Cocos nucifera	Coconut palm	9"	26'	26'	Relocate	N/A
3	Cocos nucifera	Coconut palm	10"	30'	28'	Relocate	N/A
4	Cocos nucifera	Coconut palm	9"	25'	28'	Relocate	N/A
5	Adonidia merrillii	Christmas palm	6"	15'	10'	Relocate	N/A
6	Adonidia merrillii	Christmas palm	6"	15'	10'	Relocate	N/A
7	Adonidia merrillii	Christmas palm	7"	15'	10'	Relocate	N/A
8	Ptychosperma elegans x 2 tks	Solitaire palm	6"	28'	12'	Relocate	N/A
9	Cocos nucifera	Coconut palm	8"	28'	18'	Relocate	N/A
10	Veitchia montgomeryana x 2 tks	Montgomery palm	7"	7'	12'	Relocate	N/A
11	Veitchia montgomeryana	Montgomery palm	2"	8'	10'	Relocate	N/A
12	Cocos nucifera	Coconut palm	10"	26'	20'	Relocate	N/A
13	Veitchia montgomeryana	Montgomery palm	4"	7'	10'	Relocate	N/A
14	Cocos nucifera	Coconut palm	8"	28'	26'	Relocate	N/A
15	Veitchia montgomeryana	Montgomery palm	4"	6'	10'	Relocate	N/A
16	Cocos nucifera	Coconut palm	9"	22'	26'	Relocate	N/A
17	Coccoloba uvifera	Seagrape	7"	30'	18'	Relocate	N/A
17a	Coccoloba uvifera	Seagrape	17"	30'	25'	Relocate	N/A
17b	Coccoloba uvifera	Seagrape	22"	30'	30'	Relocate	N/A
17c	Coccoloba uvifera	Seagrape	42"	30'	30'	Relocate	N/A
18	Coccoloba uvifera	Seagrape	31"	18'	28'	Relocate	N/A
19	Coccoloba uvifera	Seagrape	26"	20'	35'	Relocate	N/A
20	Coccoloba uvifera	Seagrape	15"	16'	35'	Relocate	N/A
21	Coccoloba uvifera	Seagrape	9"	18'	35'	Relocate	N/A
22	Coccoloba uvifera	Seagrape	17"	18'	35'	Relocate	N/A
23	Coccoloba uvifera	Seagrape	3"	14'	14'	Relocate	N/A
24	Coccoloba uvifera	Seagrape	18"	16'	25'	Relocate	N/A
37	Cocos nucifera	Coconut palm	9"	20'	30'	Relocate (in way of new construction)	N/A
28	Ptychosperma elegans	Solitaire palm	4"	20'	8'	Relocate (in way of new construction)	N/A
32	Thrinax radiata x 4 tks	Florida thatch palm	14"	30'	20'	Relocate (in way of new construction)	N/A
33	Thrinax radiata x 2 tks	Florida thatch palm	7"	30'	8'	Relocate (in way of new construction)	N/A
34	Adonidia merrillii	Christmas palm	6"	24'	8'	Relocate (in way of new construction)	N/A
35	Dypsis lutescens	Arecia palm	44"	22'	10'	Relocate (in way of new construction)	N/A
36	Thrinax radiata x 2 tks	Florida thatch palm	7"	30'	14'	Relocate (in way of new construction)	N/A
37	Streptocarpus	White bird of paradise	5"	20'	8'	Remove	N/A
38	Thrinax radiata x 3 tks	Florida thatch palm	12"	30'	18'	Relocate (in way of new construction)	N/A
39	Cocos nucifera	Coconut palm	10"	22'	18'	Relocate	N/A
40	Cocos nucifera	Coconut palm	7"	13'	18'	Relocate	N/A
41	Cocos nucifera	Coconut palm	9"	22'	18'	Relocate	N/A
42	Cocos nucifera	Coconut palm	8"	20'	18'	Relocate	N/A
43	Cocos nucifera	Coconut palm	8"	13'	18'	Relocate	N/A
Total Canopy Removal							

DBH is rounded-off to the nearest inch
H/CT denotes approximate overall height of trees and approximate clear trunk of palm
The clear trunk measurement for palms with multiple trunks is of the tallest trunk