

# 100 BLOCK ENTRY CONCEPT

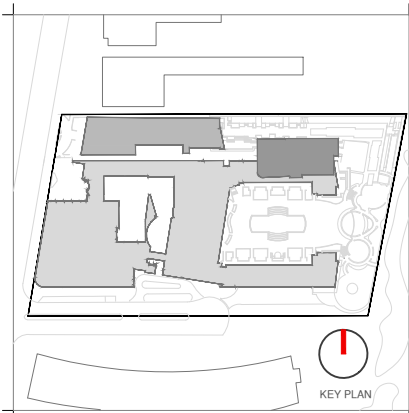

Rev.	Date	Rev.	Date

ALL DRAWINGS AND WRITTEN MATERIAL APPEARING HEREIN CONSTITUTE THE ORIGINAL AND UNPUBLISHED WORK OF Kobi Karp AIA, AND MAY NOT BE DUPLICATED, USED, OR DISCLOSED WITHOUT THE EXPRESS WRITTEN CONSENT OF Kobi Karp Architecture, & Interior Design, Inc. AIA 01/2020

**HPB- Final Submission**

**LINCOLN ROAD**  
100 Block  
Miami Beach, FL 33139

**Owner:**  
Name  
Address  
Address  
Tel:  
Email

**Consultant:**  
Name  
Address  
Address  
Tel:  
Email

**Consultant:** LANDSCAPE ARCHITECT  
Name: Naturalical  
Address: 6915 Red Road, Suite 224  
Address: Coral Gables, FL 33143  
Tel: 786.717.6564  
Email:

**Consultant:** CIVIL ENGINEER  
Name: KIMLEY HORN  
Address: 3201 Peters Road  
Address: Suite 2200  
Tel: Plantation, FL, 33324  
Email: 954.535.5144

**Consultant:**  
Name: Desimore Consulting Engineering  
Address: 800 Brickell Avenue, 6th Floor  
Address: Miami, FL 33131  
Tel: 305.441.0755  
Email:

**Architect:**  
Kobi Karp Architecture and Interior Design, Inc.  
571 NW 26TH ST  
Miami, Florida 33137 USA  
Tel: +1(305) 573 1818  
Fax: +1(305) 573 3766

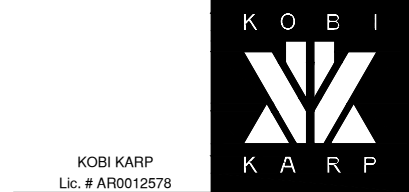

**WALK ENTRY CONCEPT**  
LINCOLN ROAD - 100 BLOCK

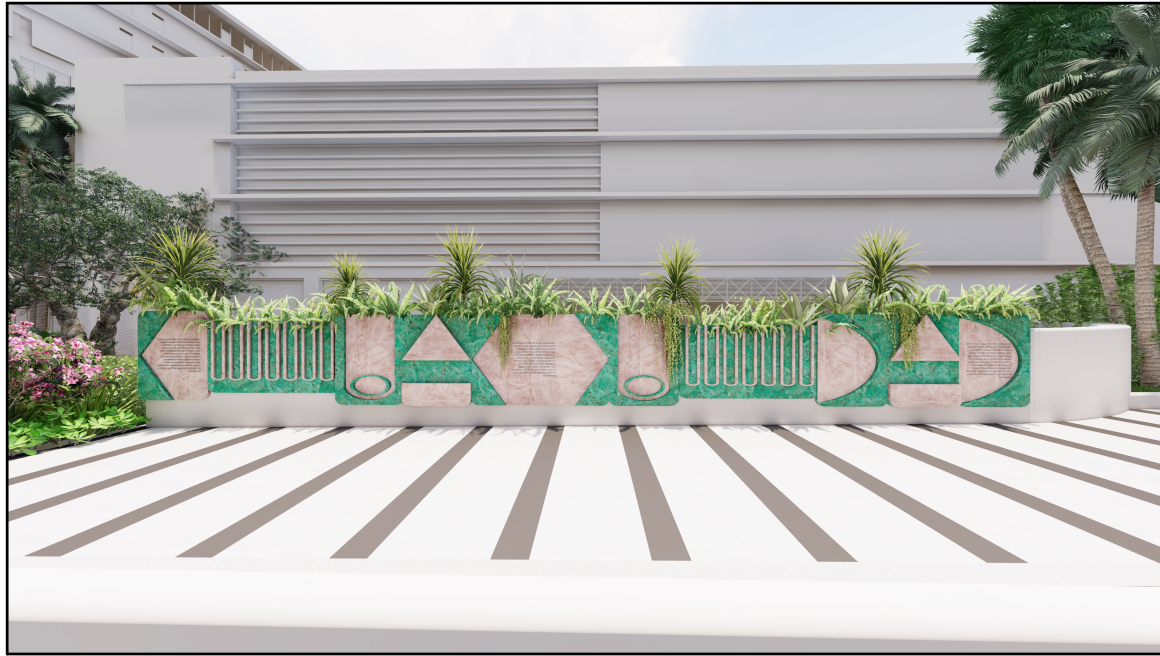

Date	11-13-2023	Sheet No.	A1.03
Scale	AS SHOWN		
Project	2018		



# 100 BLOCK ARTWALK CONCEPT

The Artwalk is an envelope in which local and national artists can compete in exchange for name recognition to create the iconic block-long experience of an outdoor museum of art from Collins Avenue to the Beach Gateway.

There will be specialized 3D paintings giving the perception of subterranean panoramas in the sidewalk. Above ground sculpture and other artistic depictions will line the sidewalk.

The Artwalk serves the dual purpose of re-linking Lincoln Road with its artistic heritage and encouraging pedestrians to avoid heavily trafficked areas on the block.

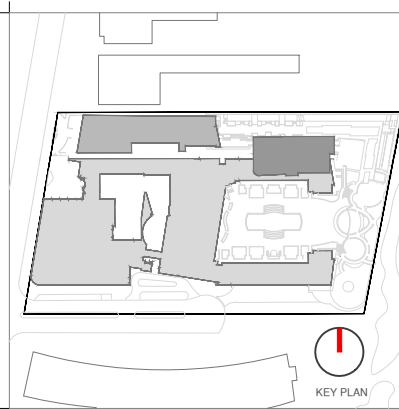

Rev.	Date	Rev.	Date

## HPB- Final Submission

LINCOLN ROAD  
100 Block  
Miami Beach, FL 33139

**Owner:**  
Name  
Address  
Address  
Tel:  
Email

**Consultant:**  
Name  
Address  
Address  
Tel:  
Email

**Consultant:** LANDSCAPE ARCHITECT  
Name: Naturalical  
Address: 6915 Red Road, Suite 224  
Address: Coral Gables, FL 33143  
Tel: 786.717.6564  
Email:

**Consultant:** CIVIL ENGINEER  
Name: KIMLEY HORN  
Address: 8201 Peters Road  
Address: Suite 2200  
Tel: Plantation, FL, 33324  
Email: 954.535.5144

**Consultant:**  
Name: Desimore Consulting Engineering  
Address: 800 Brickell Avenue, 6th Floor  
Address: Miami, FL 33131  
Tel: 305.441.0755  
Email:

**Architect:**  
Kobi Karp Architecture and Interior Design, Inc.  
571 NW 28TH ST  
Miami, Florida 33137 USA  
Tel: +1(305) 573 1818  
Fax: +1(305) 573 3766



## ARTWALK CONCEPT LINCOLN ROAD - 100 BLOCK

Date	11-13-2023	Sheet No.	A1.04
Scale	AS SHOWN		
Project	2018		

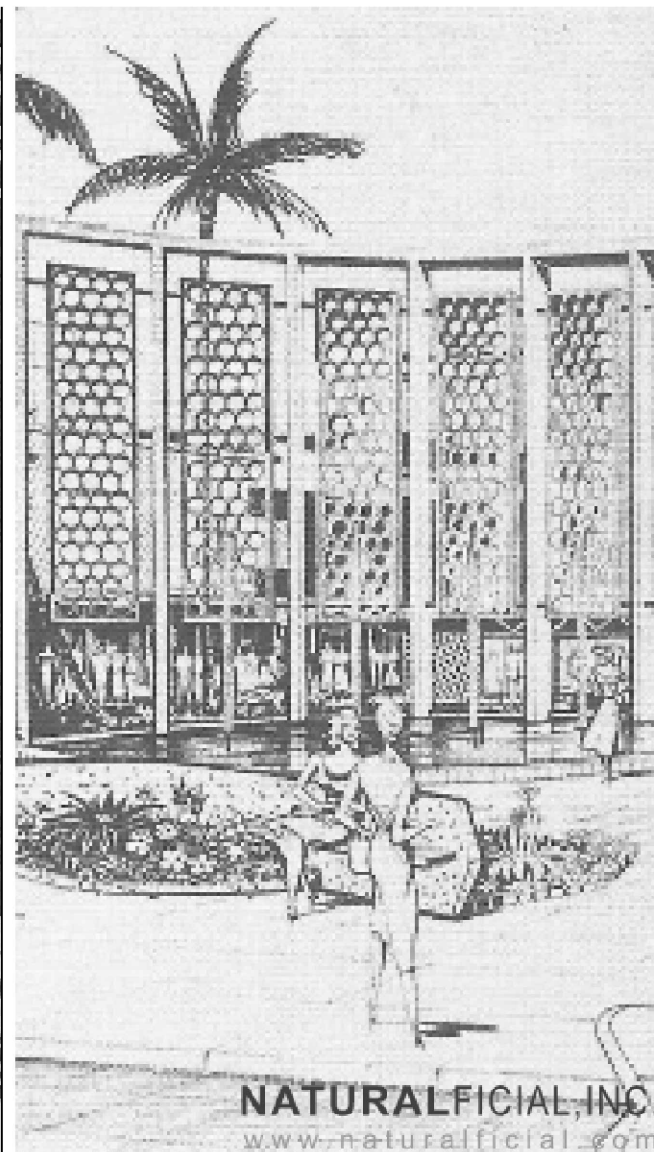
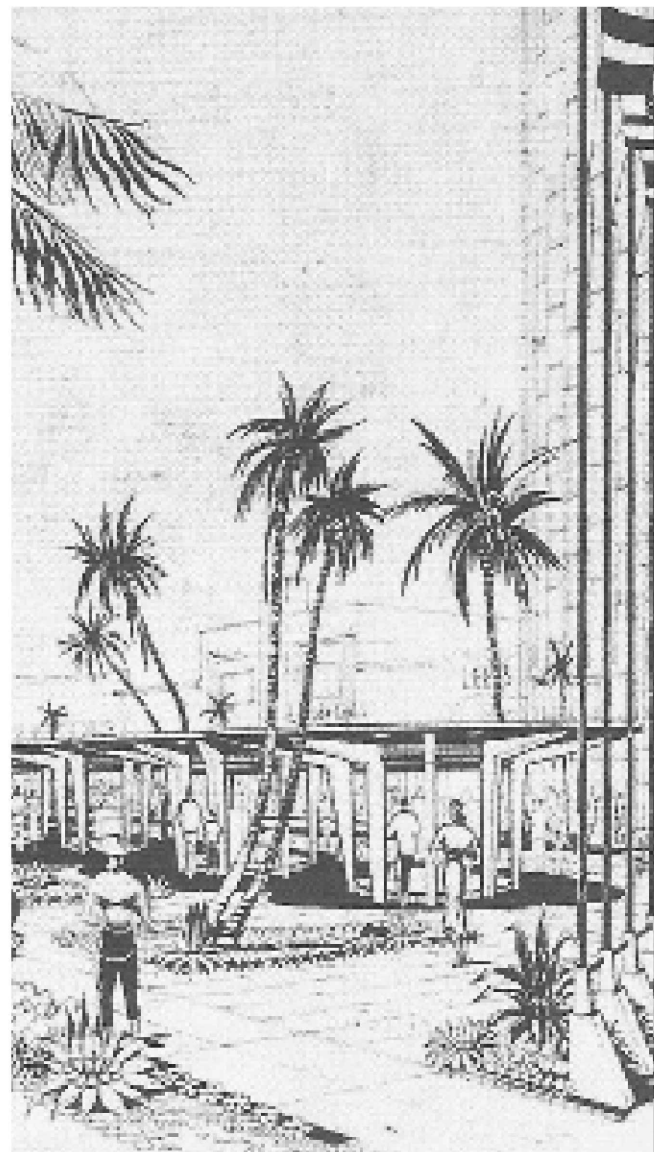
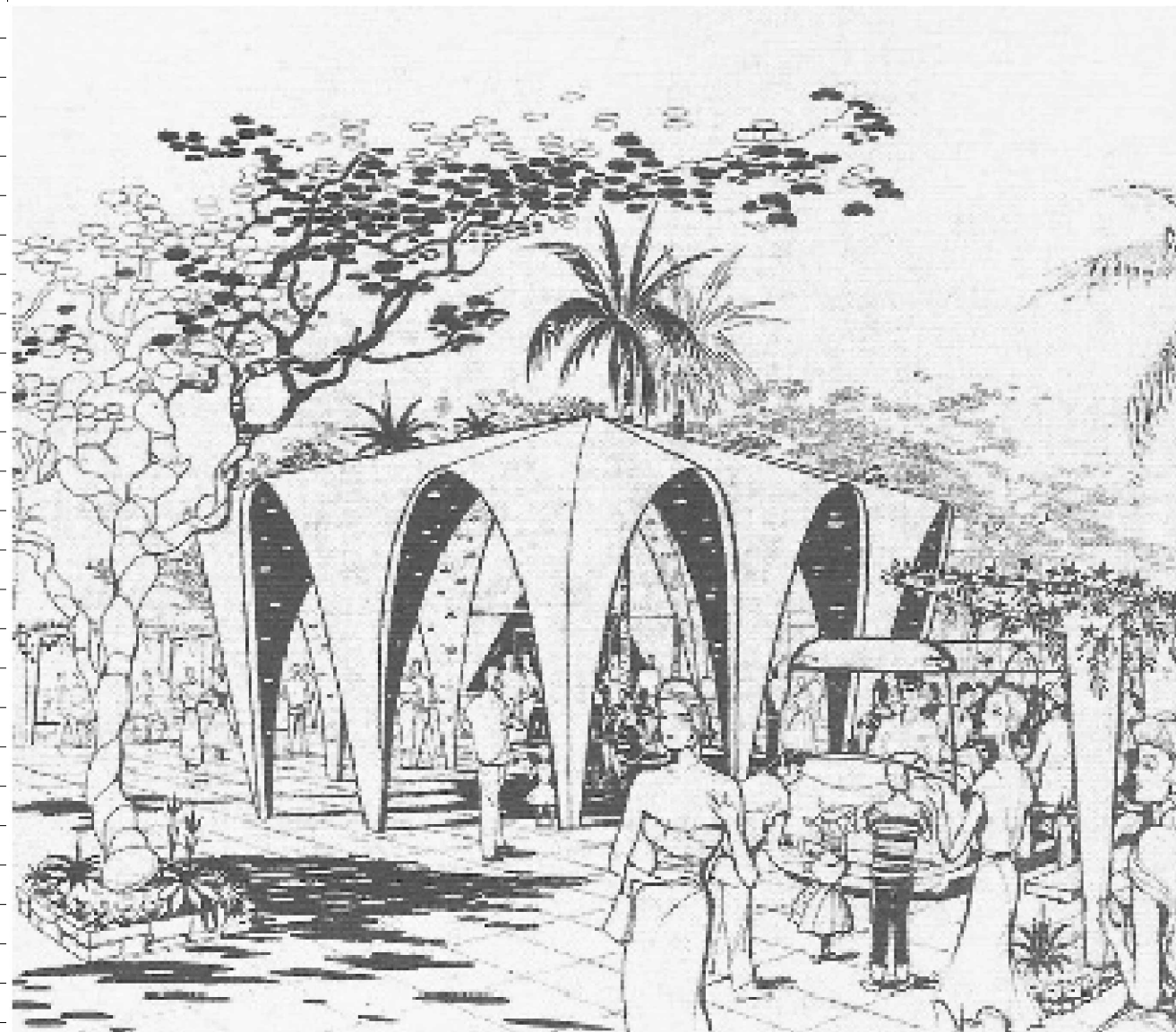
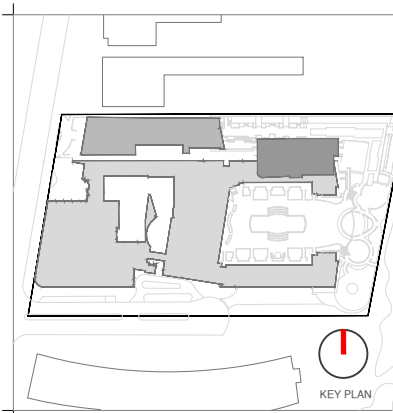

POST CARDS ILLUSTRATING MORRIS LAPIDUS' ORIGINAL VISION FOR LINCOLN ROAD

Rev.	Date	Rev.	Date

ALL DRAWINGS AND WRITTEN MATERIAL APPEARING HEREIN CONSTITUTE THE ORIGINAL AND UNPUBLISHED WORK OF KOB KARP AIA, AND MAY NOT BE DUPLICATED, USED, OR DISCLOSED WITHOUT THE EXPRESS WRITTEN CONSENT OF KOB KARP ARCHITECTURE & INTERIOR DESIGN, INC. AIA 01-2020

**HPB- Final Submission**

**LINCOLN ROAD**  
100 Block  
Miami Beach, FL 33139

**Owner:**  
Name  
Address  
Address  
Tel:  
Email

**Consultant:**  
Name  
Address  
Address  
Tel:  
Email

**Consultant:** LANDSCAPE ARCHITECT  
Name: Naturalficial  
Address: 6915 Red Road, Suite 224  
Address: Coral Gables, FL 33143  
Tel: 786.717.6564  
Email:

**Consultant:** CIVIL ENGINEER  
Name: KIMLEY HORN  
Address: 8201 Peters Road  
Address: Suite 2200  
Tel: Plantation, FL, 33324  
Email: 954.535.5144

**Consultant:**  
Name: Desimore Consulting Engineering  
Address: 800 Brickell Avenue, 6th Floor  
Address: Miami, FL 33131  
Tel: 305.441.0755  
Email:

**Architect:**  
Name: Kobi Karp Architecture and Interior Design, Inc.  
Address: 571 NW 26TH ST  
Address: Miami, Florida 33137 USA  
Tel: +1(305) 573 1818  
Fax: +1(305) 573 3766

K O B I  
  
K A R P

K O B I K A R P  
Lic. # AR0012578

**HISTORIC CONTEXT IMAGES**  
LINCOLN ROAD - 100 BLOCK

Date	11-13-2023	Sheet No.	A2.00
Scale	N/A		
Project	2018		



Rev.	Date	Rev.	Date

ALL DRAWINGS AND WRITTEN MATERIAL APPEARING HEREIN CONSTITUTE THE ORIGINAL AND UNPUBLISHED WORK OF KOBİ KARP AIA, AND MAY NOT BE DUPLICATED, USED, OR DISCLOSED WITHOUT THE EXPRESS WRITTEN CONSENT OF KOBİ KARP ARCHITECTURE, & INTERIOR DESIGN, INC. AIA 01-2009

**HPB- Final Submission**

**LINCOLN ROAD**  
100 Block  
Miami Beach, FL 33139

**Owner:**  
Name  
Address  
Address  
Tel:  
Email

**Consultant:**  
Name  
Address  
Address  
Tel:  
Email

**Consultant:** LANDSCAPE ARCHITECT  
Name: Naturalfigial  
Address: 6915 Red Road, Suite 224  
Address: Coral Gables, FL 33143  
Tel: 786.717.6564  
Email:

**Consultant:** CIVIL ENGINEER  
Name: KIMLEY HORN  
Address: 8201 Peters Road  
Address: Suite 2200  
Tel: Plantation, FL, 33324  
Email: 954.535.5144

**Consultant:**  
Name: Desimore Consulting Engineering  
Address: 800 Brickell Avenue, 6th Floor  
Address: Miami, FL 33131  
Tel: 305.441.0755  
Email:

**Architect:**  
Kobi Karp Architecture and Interior Design, Inc.  
571 NW 26TH ST  
Miami, Florida 33137 USA  
Tel: +1(305) 573 1818  
Fax: +1(305) 573 3766



LINCOLN ROAD MALL MORRIS LAPIDUS' BUILT DESIGN + FOLLIES

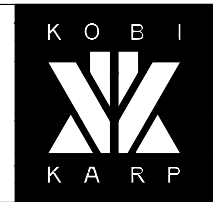

KOBİ KARP  
Lic. # AR0012578

**HISTORIC CONTEXT IMAGES**

LINCOLN ROAD - 100 BLOCK

Date	11-13-2023	Sheet No.	A2.01
Scale	N/A		
Project	2018		



NATURALFICIAL, INC.  
[www.naturalficial.com](http://www.naturalficial.com)

RITZ LOBBY WALL

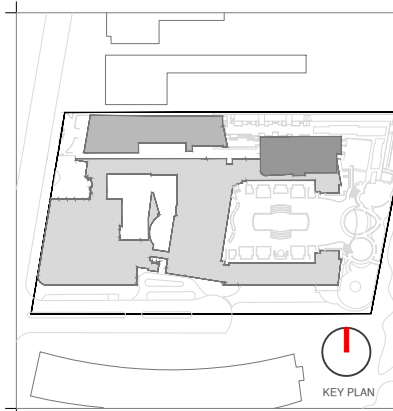

Rev.	Date	Rev.	Date

ALL DRAWINGS AND WRITTEN MATERIAL APPEARING HEREIN CONSTITUTE THE ORIGINAL AND UNPUBLISHED WORK OF KOBİ KARP AIA, AND MAY NOT BE DUPLICATED, USED, OR DISCLOSED WITHOUT THE EXPRESS WRITTEN CONSENT OF KOBİ KARP ARCHITECTURE & INTERIOR DESIGN, INC. AIA 10-2009.

**HPB- Final Submission**

**LINCOLN ROAD**  
 100 Block  
 Miami Beach, FL 33139

**Owner:**  
 Name  
 Address  
 Address  
 Tel:  
 Email

**Consultant:**  
 Name  
 Address  
 Address  
 Tel:  
 Email

**Consultant:** LANDSCAPE ARCHITECT  
 Name  
 Address  
 Address  
 Tel:  
 Email

**Consultant:** CIVIL ENGINEER  
 Name  
 Address  
 Address  
 Tel:  
 Email

**Consultant:**  
 Name  
 Address  
 Address  
 Tel:  
 Email

**Architect:**  
 Kobi Karp Architecture and Interior Design, Inc.  
 571 NW 26TH ST  
 Miami, Florida 33137 USA  
 Tel: +1(305) 573 1818  
 Fax: +1(305) 573 3766

K O B I  
  
 K A R P  
 KOBİ KARP  
 Lic. # AR0012578

**HISTORIC CONTEXT IMAGES**  
 LINCOLN ROAD - 100 BLOCK

Date	11-13-2023	Sheet No.	A2.02
Scale	N/A		
Project	2018		



Rev.	Date	Rev.	Date

ALL DRAWINGS AND WRITTEN MATERIAL APPEARING HEREIN CONSTITUTE THE ORIGINAL AND UNPUBLISHED WORK OF KOBİ KARP AIA, AND MAY NOT BE DUPLICATED, USED, OR DISCLOSED WITHOUT THE EXPRESS WRITTEN CONSENT OF KOBİ KARP ARCHITECTURE & INTERIOR DESIGN, INC. AIA 01-2020

**HPB- Final Submission**

**LINCOLN ROAD**  
100 Block  
Miami Beach, FL 33139

**Owner:**  
Name  
Address  
Address  
Tel:  
Email

**Consultant:**  
Name  
Address  
Address  
Tel:  
Email

**Consultant:** LANDSCAPE ARCHITECT  
Name  
Naturalifical  
Address  
6915 Red Road, Suite 224  
Coral Gables, FL 33143  
Tel:  
786.717.8564  
Email

**Consultant:** CIVIL ENGINEER  
Name  
KIMLEY HORN  
Address  
3201 Peters Road  
Address  
Suite 2200  
Tel:  
Plantation, FL, 33324  
Email  
954.535.5144

**Consultant:**  
Name  
Desimore Consulting Engineering  
Address  
800 Brickell Avenue, 6th Floor  
Tel:  
Miami, FL 33131  
305.441.0755  
Email

**Architect:**  
Name  
Kobi Karp Architecture and Interior Design, Inc.  
Address  
571 NW 28TH ST  
Miami, Florida 33137 USA  
Tel:  
+1(305) 573 1818  
Fax:  
+1(305) 573 3786

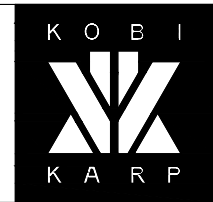

KOBİ KARP  
Lic. # AR0012578

**HISTORIC CONTEXT IMAGES**

LINCOLN ROAD - 100 BLOCK

Date	11-13-2023	Sheet No.	A2.03
Scale	N/A		
Project	2018		



MODERNIST ARCHITECTURE FROM BRAZIL



NATURALFIGIAL, INC.



Rev.	Date	Rev.	Date

ALL DRAWINGS AND WRITTEN MATERIAL APPEARING HEREIN CONSTITUTE THE ORIGINAL AND UNPUBLISHED WORK OF KOBİ KARP AIA, AND MAY NOT BE DUPLICATED, USED, OR DISCLOSED WITHOUT THE EXPRESS WRITTEN CONSENT OF KOBİ KARP ARCHITECTURE, & INTERIOR DESIGN, INC. AIA 10-2020.

**HPB- Final Submission**

**LINCOLN ROAD**  
 100 Block  
 Miami Beach, FL 33139

**Owner:**  
 Name  
 Address  
 Address  
 Tel:  
 Email

**Consultant:**  
 Name  
 Address  
 Address  
 Tel:  
 Email

**Consultant:** LANDSCAPE ARCHITECT  
 Name  
 Address  
 Address  
 Tel:  
 Email

**Consultant:** CIVIL ENGINEER  
 Name  
 Address  
 Address  
 Tel:  
 Email

**Consultant:**  
 Name  
 Address  
 Address  
 Tel:  
 Email

**Architect:**  
 Kobi Karp Architecture and Interior Design, Inc.  
 571 NW 26TH ST  
 Miami, Florida 33137 USA  
 Tel: +1(305) 573 1818  
 Fax: +1(305) 573 3766

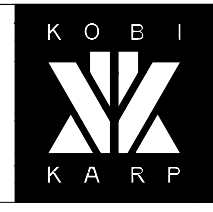

KOBİ KARP  
 Lic. # AR0012578

**HISTORIC CONTEXT IMAGES**

LINCOLN ROAD - 100 BLOCK

Date	11-13-2023	Sheet No.	A2.04
Scale	N/A		
Project	2018		



ARCH STRUCTURES + PLANTERS

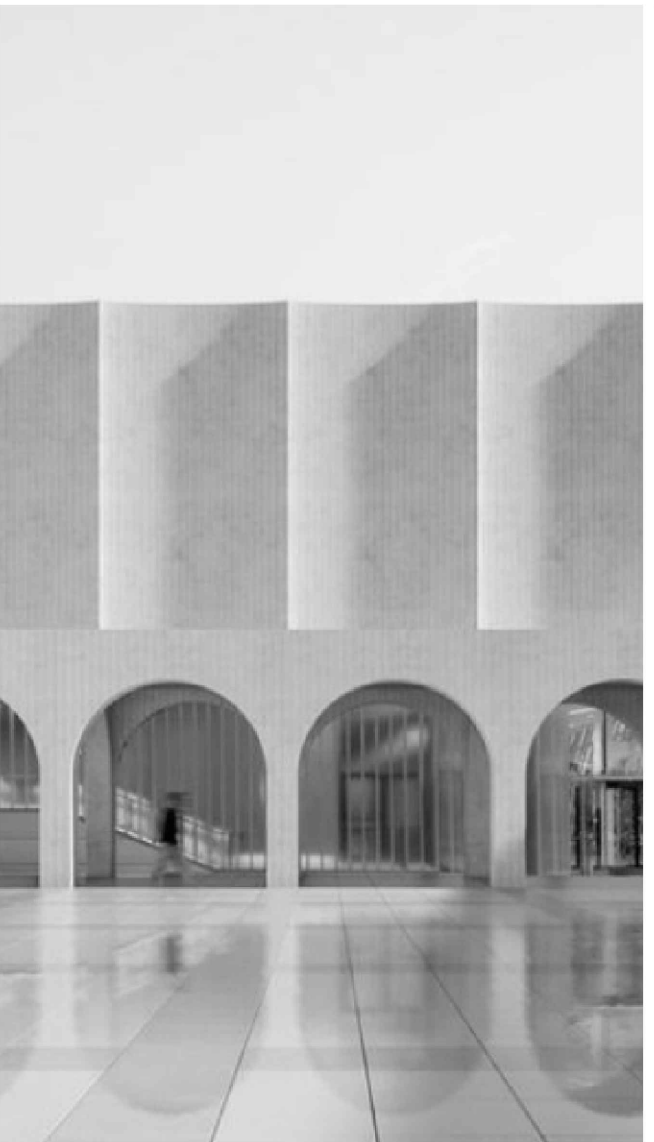

www.naturalficial.com

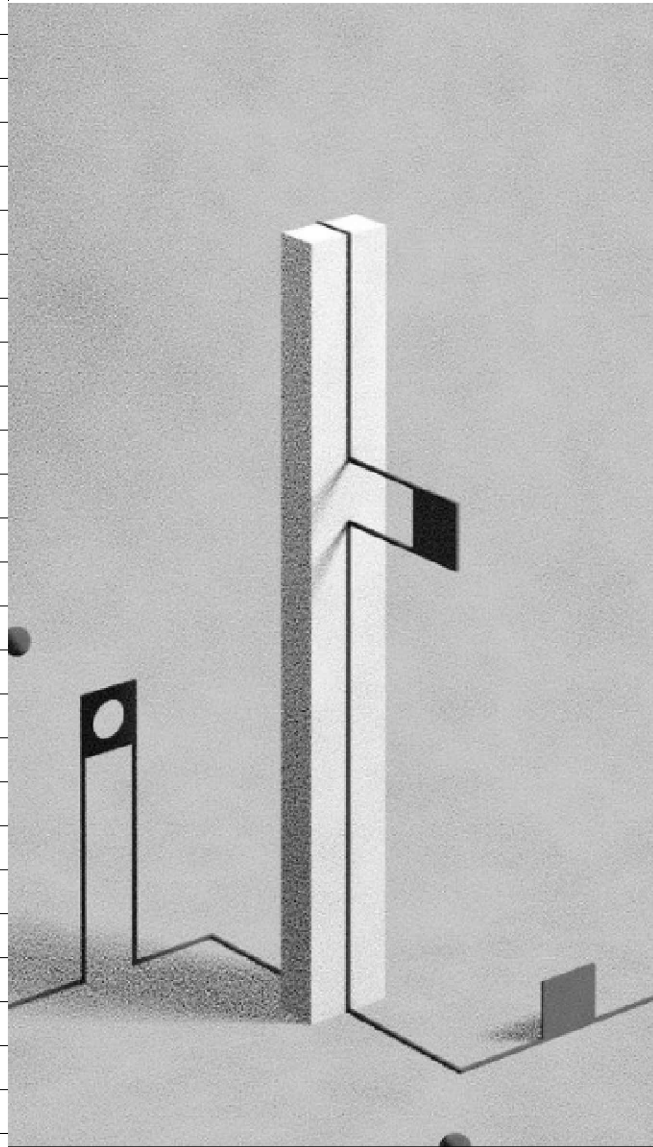

ART FOLLIES + LIGHTING



Rev.	Date	Rev.	Date

ALL DRAWINGS AND WRITTEN MATERIAL APPEARING HEREIN CONSTITUTE THE ORIGINAL AND UNPUBLISHED WORK OF KOBİ KARP AIA, AND MAY NOT BE DUPLICATED, USED, OR DISCLOSED WITHOUT THE EXPRESS WRITTEN CONSENT OF KOBİ KARP ARCHITECTURE & INTERIOR DESIGN, INC. AIA 01-2020

**HPB- Final Submission**

**LINCOLN ROAD**  
100 Block  
Miami Beach, FL 33139

**Owner:**  
Name  
Address  
Address  
Tel:  
Email

**Consultant:**  
Name  
Address  
Address  
Tel:  
Email

**Consultant:** LANDSCAPE ARCHITECT  
Name: Naturalficial  
Address: 6915 Red Road, Suite 224  
Address: Coral Gables, FL 33143  
Tel: 786.717.8564  
Email:

**Consultant:** CIVIL ENGINEER  
Name: KIMLEY HORN  
Address: 8201 Peters Road  
Address: Suite 2200  
Tel: Plantation, FL, 33324  
Email: 954.535.5144

**Consultant:**  
Name: Desimore Consulting Engineering  
Address: 800 Brickell Avenue, 6th Floor  
Address: Miami, FL 33131  
Tel: 305.441.0755  
Email:

**Architect:**  
Kobi Karp Architecture and Interior Design, Inc.  
571 NW 28TH ST  
Miami, Florida 33137 USA  
Tel: +1(305) 573 1818  
Fax: +1(305) 573 3766



KOBİ KARP  
Lic. # AR0012578

**HISTORIC CONTEXT IMAGES**

LINCOLN ROAD - 100 BLOCK

Date	11-13-2023	Sheet No.	A2.05
Scale	N/A		
Project	2018		





ART FOLLIES + LIGHTING

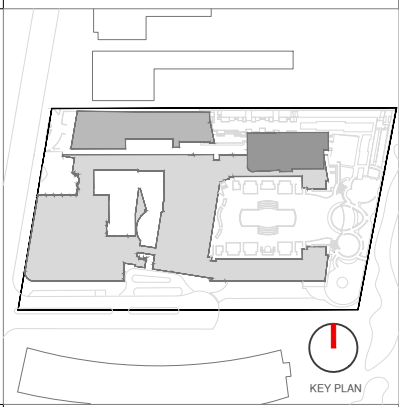

Rev.	Date	Rev.	Date

ALL DRAWINGS AND WRITTEN MATERIAL APPEARING HEREIN CONSTITUTE THE ORIGINAL AND UNPUBLISHED WORK OF KOBİ KARP AIA, AND MAY NOT BE DUPLICATED, USED, OR DISCLOSED WITHOUT THE EXPRESS WRITTEN CONSENT OF KOBİ KARP ARCHITECTURE, & INTERIOR DESIGN, INC. AIA 01-2020

**HPB- Final Submission**

**LINCOLN ROAD**  
 100 Block  
 Miami Beach, FL 33139

**Owner:**  
 Name  
 Address  
 Address  
 Tel:  
 Email

**Consultant:**  
 Name  
 Address  
 Address  
 Tel:  
 Email

**Consultant:** LANDSCAPE ARCHITECT  
 Name: Naturalicial  
 Address: 6915 Red Road, Suite 224  
 Address: Coral Gables, FL 33143  
 Tel: 786.717.6564  
 Email:

**Consultant:** CIVIL ENGINEER  
 Name: KIMLEY HORN  
 Address: 8201 Peters Road  
 Address: Suite 2200  
 Tel: Plantation, FL, 33324  
 Email: 954.535.5144

**Consultant:**  
 Name: Desimore Consulting Engineering  
 Address: 800 Brickell Avenue, 6th Floor  
 Address: Miami, FL 33131  
 Tel: 305.441.0755  
 Email:

**Architect:**  
 Kobi Karp Architecture and Interior Design, Inc.  
 571 NW 28TH ST  
 Miami, Florida 33137 USA  
 Tel: +1(305) 573 1818  
 Fax: +1(305) 573 3766

KOBİ KARP  
 Lic. # AR0012578

**HISTORIC CONTEXT IMAGES**  
 LINCOLN ROAD - 100 BLOCK

Date	11-13-2023	Sheet No.	A2.06
Scale	N/A		
Project	2018		



GATEWAY



Rev.	Date	Rev.	Date

ALL DRAWINGS AND WRITTEN MATERIAL APPEARING HEREIN CONSTITUTE THE ORIGINAL AND UNPUBLISHED WORK OF KOBİ KARP AIA, AND MAY NOT BE DUPLICATED, USED, OR DISCLOSED WITHOUT THE EXPRESS WRITTEN CONSENT OF KOBİ KARP ARCHITECTURE & INTERIOR DESIGN, INC. AIA 01-2020

**HPB- Final Submission**

**LINCOLN ROAD**  
 100 Block  
 Miami Beach, FL 33139

**Owner:**  
 Name  
 Address  
 Address  
 Tel:  
 Email

**Consultant:**  
 Name  
 Address  
 Address  
 Tel:  
 Email

**Consultant:** LANDSCAPE ARCHITECT  
 Name  
 Address  
 Address  
 Tel:  
 Email

**Consultant:** CIVIL ENGINEER  
 Name  
 Address  
 Address  
 Tel:  
 Email

**Consultant:**  
 Name  
 Address  
 Address  
 Tel:  
 Email

**Architect:**  
 Kobi Karp Architecture and Interior Design, Inc.  
 571 NW 26TH ST  
 Miami, Florida 33137 USA  
 Tel: +1(305) 573 1818  
 Fax: +1(305) 573 3766

KOBİ KARP  
 Lic. # AR0012578

**HISTORIC CONTEXT IMAGES**

LINCOLN ROAD - 100 BLOCK

Date	11-13-2023	Sheet No.	A2.07
Scale	N/A		
Project	2018		



Rev.	Date	Rev.	Date

ALL DRAWINGS AND WRITTEN MATERIAL APPEARING HEREIN CONSTITUTE THE ORIGINAL AND UNPUBLISHED WORK OF KOBİ KARP AIA, AND MAY NOT BE DUPLICATED, USED, OR DISCLOSED WITHOUT THE EXPRESS WRITTEN CONSENT OF KOBİ KARP ARCHITECTURE & INTERIOR DESIGN, INC. AIA 01-2019.

**HPB- Final Submission**

**LINCOLN ROAD**  
100 Block  
Miami Beach, FL 33139

**Owner:**  
Name  
Address  
Address  
Tel:  
Email

**Consultant:**  
Name  
Address  
Address  
Tel:  
Email

**Consultant:** LANDSCAPE ARCHITECT  
Name: Naturalific  
Address: 6915 Red Road, Suite 224  
Address: Coral Gables, FL 33143  
Tel: 786.717.8564  
Email:

**Consultant:** CIVIL ENGINEER  
Name: KIMLEY HORN  
Address: 8201 Peters Road  
Address: Suite 2200  
Tel: Plantation, FL, 33324  
Email: 954.535.5144

**Consultant:**  
Name: Desimore Consulting Engineering  
Address: 800 Brickell Avenue, 6th Floor  
Address: Miami, FL 33131  
Tel: 305.441.0755  
Email:

**Architect:**  
Kobi Karp Architecture and Interior Design, Inc.  
571 NW 26TH ST  
Miami, Florida 33137 USA  
Tel: +1(305) 573 1818  
Fax: +1(305) 573 3786



NATURALIFIC  
www.naturalific.com  
FOLLEY WALL



KOBİ KARP  
Lic. # AR0012578

**HISTORIC CONTEXT IMAGES**

LINCOLN ROAD - 100 BLOCK

Date	11-13-2023	Sheet No.	A2.08
Scale	N/A		
Project	2018		

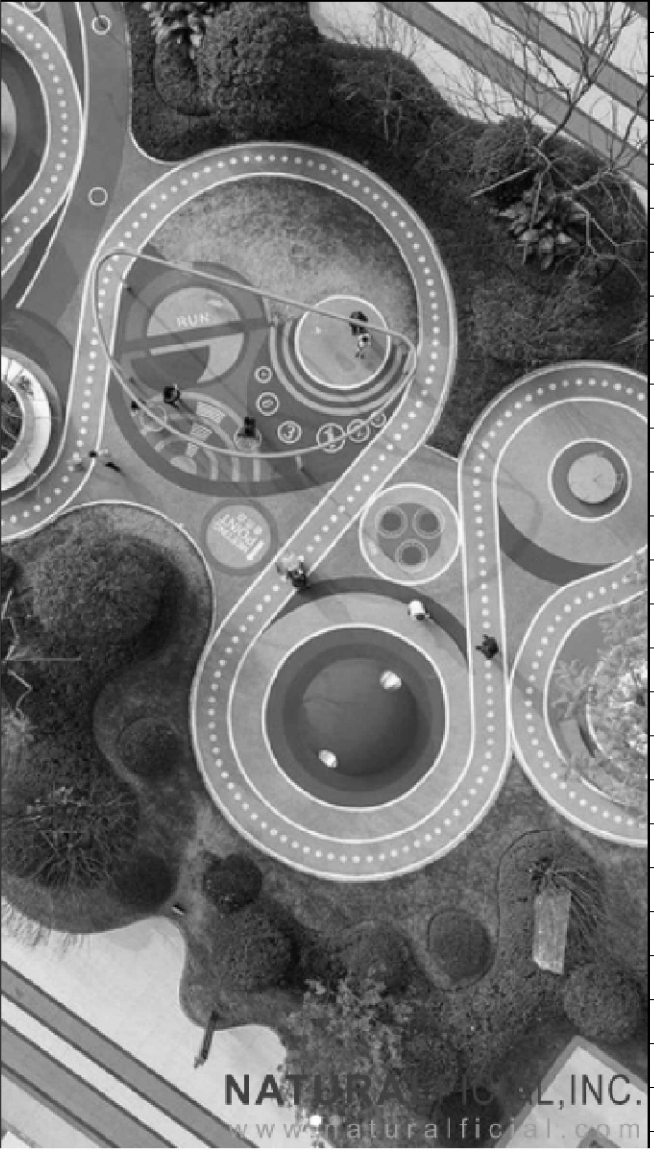

BEACH PARK

Rev.	Date	Rev.	Date

ALL DRAWINGS AND WRITTEN MATERIAL APPEARING HEREIN CONSTITUTE THE ORIGINAL AND UNPUBLISHED WORK OF KOBI KARP AIA, AND MAY NOT BE DUPLICATED, USED, OR DISCLOSED WITHOUT THE EXPRESS WRITTEN CONSENT OF KOBI KARP ARCHITECTURE & INTERIOR DESIGN, INC. AIA 01-2009

**HPB- Final Submission**

**LINCOLN ROAD**  
100 Block  
Miami Beach, FL 33139

**Owner:**  
Name  
Address  
Address  
Tel:  
Email

**Consultant:**  
Name  
Address  
Address  
Tel:  
Email

**Consultant:** LANDSCAPE ARCHITECT  
Name: Naturalformal  
Address: 6915 Red Road, Suite 224  
Address: Coral Gables, FL 33143  
Tel: 786.717.8564  
Email:

**Consultant:** CIVIL ENGINEER  
Name: KIMLEY HORN  
Address: 8201 Peters Road  
Address: Suite 2200  
Tel: Plantation, FL, 33324  
Email: 954.535.5144

**Consultant:**  
Name: Desimore Consulting Engineering  
Address: 800 Brickell Avenue, 6th Floor  
Address: Miami, FL 33131  
Tel: 305.441.0755  
Email:

**Architect:**  
Kobi Karp Architecture and Interior Design, Inc.  
571 NW 26TH ST  
Miami, Florida 33137 USA  
Tel: +1(305) 573 1818  
Fax: +1(305) 573 3766

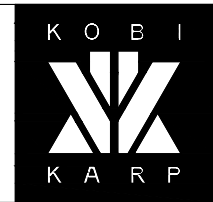

KOBI KARP  
Lic. # AR0012578

**HISTORIC CONTEXT IMAGES**

LINCOLN ROAD - 100 BLOCK

Date	11-13-2023	Sheet No.	A2.09
Scale	N/A		
Project	2018		