

CITY OF MIAMI BEACH LANDSCAPE NOTES
 SHALL TAKE PRECEDENCE OVER ANY OTHER LANDSCAPE NOTES OR DISCREPANCIES

- "Tree protection fences shall be constructed prior to any construction activity including grubbing for all trees/palms to remain or to be relocated. Fences should be of sturdy construction, preferably 4x4 posts with wire mesh. Orange plastic mesh fences are ineffective because they are easily removed, dropped, knocked down, ignored, etc. Fences must be maintained intact until the project is completed. They should not be removed or dropped for any reason without authorization from the city's urban forester. No activity or disturbance should occur within the fenced areas, including vehicle use, storage of materials, dumping of liquids or materials, grade changes, grubbing, and mechanical trenching for irrigation, electrical lighting, etc."
- All proposed irrigation in City property shall follow CMB irrigation specifications.
- "Do not place fill, rocks, grading sand nor any other construction material over the roots or in the root zone."
- "Any proposed tree root or structural pruning shall be performed by an ISA Certified Arborist in accordance with ANSI A-300 (part 1) pruning standards. Tree pruning should be limited to the bare minimum required to achieve clearance for construction activities and the City Urban Forester shall be consulted prior to the start of any tree or root pruning onsite."
- "Mulch shall be kept a minimum of 6' away from all trunks of trees and palms. Filtopsoil shall not be placed on top of the root ball."
- "The City Urban Forester and/or Greenspace Management Staff shall be notified prior to installation of trees or palms in the ROW to inspect the planting holes and conduct a grades and standards inspection."
- "Contractor is responsible for the maintenance and/or repair of all staking and guying of trees and palms during warranty period and removal & disposal of staking within 1 year of installation. Exceptions to this require the written approval of the City Urban Forester."

4344 ALTON ROAD, MIAMI BEACH, FL. 33140
LANDSCAPE LEGEND (THIS INFORMATION IS REQUIRED TO BE PERMANENTLY AFFIXED TO THE PLAN)

ZONING DISTRICT: RS-3 NET LOT AREA: 0.14 ACRES 6,491 SQUARE FEET

OPEN SPACE	REQUIRED	PROVIDED
A. Square feet of open space required by Chapter 33, as indicated on site plan: Net lot area x .32% = 2113 square feet	2273	3721
B. Square feet of parking lot open space required by Chapter 18A, on site plan: The number of parking spaces x 10 square feet per parking space =	0	0
C. Total square feet of open space required by Chapter 33: A + B =	2273	3721
LAWN AREA CALCULATION		
A. Total square feet of landscaped open space required by chapter 33 =	2273	3721
B. Maximum lawn area (St. Augustine sod) permitted: .25% x 3,721 square feet	1302	1302
TREES		
A. The number of trees required per net lot acre Less the existing number of trees that meet minimum requirements trees x net lot acreage =	3 -	1 -
B. 30% Palms trees allowed (two palms = one tree) Palms provided =	1	-
C. Percentage of natives trees required = the number of trees provided x 30% =	1	6
D. Street Trees (max. average spacing of 35' o.c.) linear feet along street /35 = Palms as street trees (max. average spacing 25' o.c.) linear feet along street /25 =	2 2	2 2
E. Street Trees located directly beneath power lines (Max. average spacing of 25' o.c.) linear feet along street /25 =	-	-
F. Total number of trees provided =	5	9
SHRUBS:		
A. The total number of trees required x 10 = number of shrubs required	50	179
B. The number of shrubs required x 30% = number of native shrubs required	15	25 (68%)
IRRIGATION PLAN Required by Chapter 33. Autoirrigation YES or hose bib _____		

PLANTLIST

SYM.	NATIVE	NAME	BOTANICAL NAME	SPECIFICATION
PROPOSED TREES				
BA	YES	1 YELLOW VERAWOOD	Bulnesia arborea	12' x 6' apr., 2 1/2" cal.
IC	YES	5 DAHOON HOLLY	Ilex cassine	12' x 5' apr., 2" cal.
QV6	YES	3 LIVE OAKS	Quercus virginiana	16' x 7' apr., 4" cal., 6' c.t.
PALMS				
VM2	5	MONTGOMERY PALMS	Veitchia montgomeryana	DBL. TK, FG, 14' o.s., full hd.
VM3	1	MONTGOMERY PALMS	Veitchia montgomeryana	TPL. TK, FG, 14' o.s., full hd.
RAV	1	TRAVELER'S PALM	Ravenea madagascarensis	FG, 12' o.s., full head
SHRUBS				
CC1	YES	25 JAMAICA CAPER	Capparis cynophallophora	1 gal., 30" x 24", 24" o.c. full
CIT	YES	100 COCOPLUM	Chycobalanus icaco	1 GAL., 30" x 24" full, 24" o.c.
CRT	30	PITCH APPLE	Clusia rosea	1 GAL., 36" Ht., 30" Ø.C., FTB.
CPC	24	CROTON 'PIECRUST'	Codiaeum variegatum	3 gal., 18" x 18", 18" o.c., full
ACCENT PLANTS AND GROUNDCOVERS				
IMP	1	IMPERIALIS BROMELIAD	Alcantarea imperialis	1 gal., full, BULL15
CAT	8	CAT PALMS	Chamadorea cataractarum	1 gal., 30" x 24", 30" o.c.
EL	YES	25 GOLDEN CREEPER	Emodea littoralis	1 gal., 12" x 8", full, 12" o.c.
FG3	75	'GREEN ISLAND' FIGS	Ficus 'Green Island'	3 gal., 18" x 18", 18" o.c., full
FUR	1	GIANT FALSE AGAVE	Furcraea foetida	15 gal., 4" x 4", full specimen
NEP	YES	100 BOSTON FERN	Nephrolepis exaltata	1 gal., 12" x 12" full, 15" o.c.
FTF	YES	107 FISHTAIL FERN	Nephrolepis falcata 'Furcans'	3 gal., 18" x 18" full, 24" o.c.
BUR	12	PHILODENDRON 'ROJO CONGO'	Philodendron spp.	3 gal., 18" x 18" 18" o.c., full
LANDSCAPE MATERIALS				
SS	10	STEPPING STONES	18" x 18", SIMULATED KEYSTONE,	on 2" sand leveling course, level to grade
SOD				
PAS	2,000 s.f.	SEASHORE PASPALUM	Paspalum spp. 'SeaDwarf'	SOLID SOD, price per s.f.
TOPSOIL:				
	TOPSOIL: SAND MIX	50:50 TOPSOIL: SAND MIX, SPREAD IN PLACE		
	10 C.Y.	TREES, PALMS, SHRUBS AND GROUNDCOVERS		
	13 C.Y.	AREA TO BE SODDED WITH A 2" DEPTH OF TOPSOIL SPREAD IN PLACE		
MULCHING:				
	20 C.Y. +/-	'FINE BARK' MULCH	3" DEPTH, SPREAD IN PLACE, ATLAS PEAT AND SOIL	PROVIDE SAMPLE FOR APPROVAL PRIOR TO INSTALLATION
	---	TOPSOIL, SOD AND MULCH QUANTITIES SHOWN ARE APPROXIMATE, CONTRACTOR		TO PROVIDE A UNIT PRICE PER UNIT AND WILL BE PAID ON THAT UNIT PRICE BASIS UPON FINAL INSPECTION AND APPROVAL.

STREET TREE TABULATIONS

	REQUIRED	PROVIDED
ALTON ROAD 60' L.F. @ 1 TREE / 35' L.F. = 2	2	2 2 QV
TOTAL	2	2

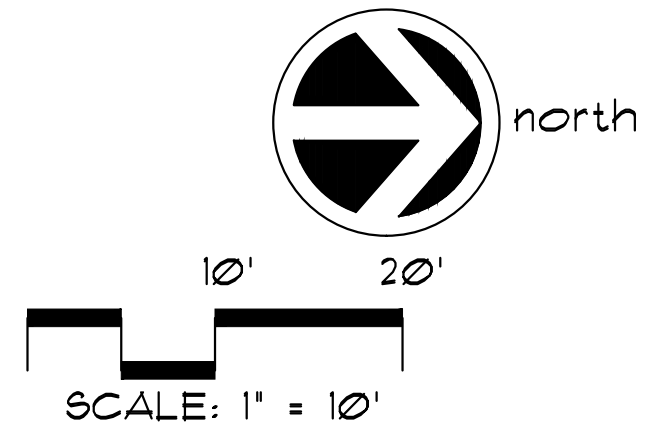

A WRITTEN TREE REMOVAL PERMIT FROM THE CITY OF MIAMI BEACH IS REQUIRED PRIOR TO REMOVAL OF ANY TREE OR PALM FROM THE SITE.
 SEE L-2 FOR LANDSCAPE DETAILS, NOTES, SPECIFICATIONS, ETC.

DATE: 2.12.16
 DESIGNED BY: JAV
 DRAWN BY: JAG
 REVIEWED BY: MDF
 PROJECT NO.: 16-0005

REVISIONS

NO.	DESCRIPTION

JOSE A. VIDAL AR94535
 MANUEL D. FERNANDEZ
 AR95501

JAMES F. BOSCH
 RLA # 0001132

SEAL

LANDSCAPE PLAN

L-1

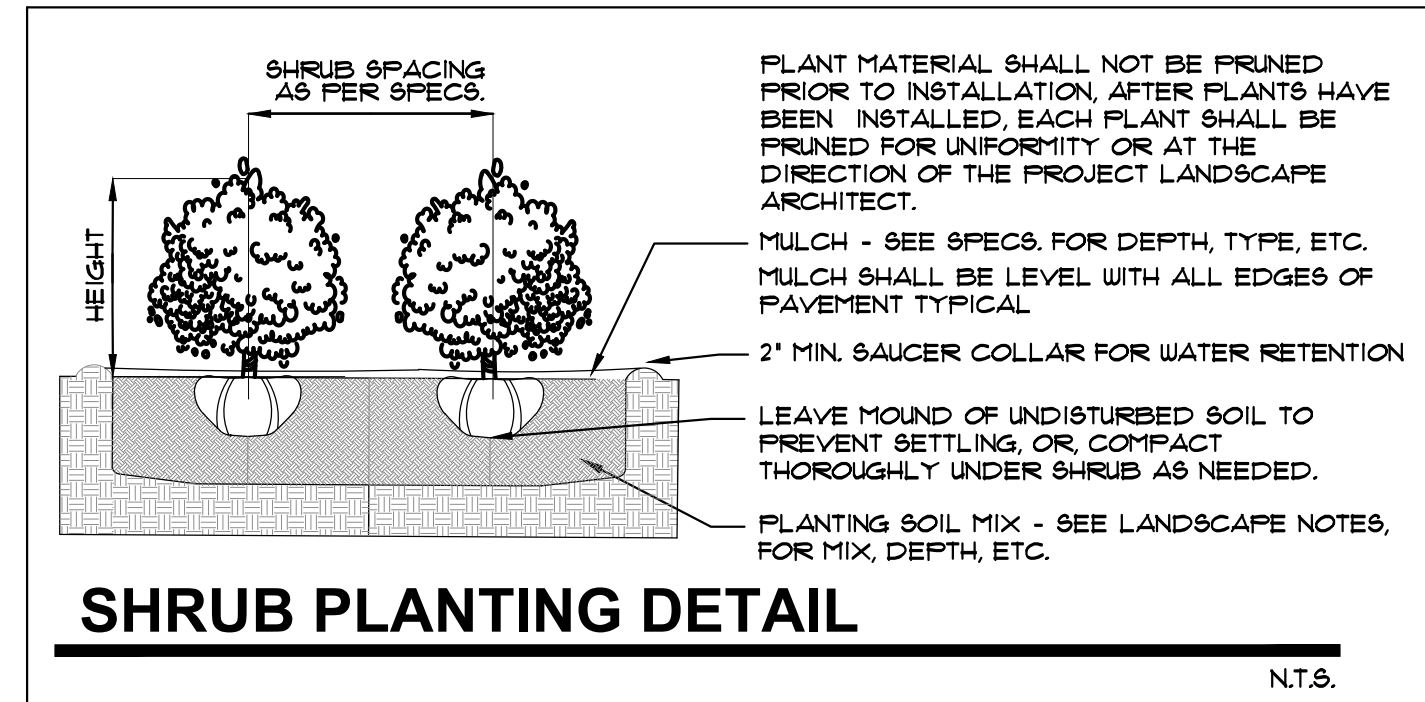
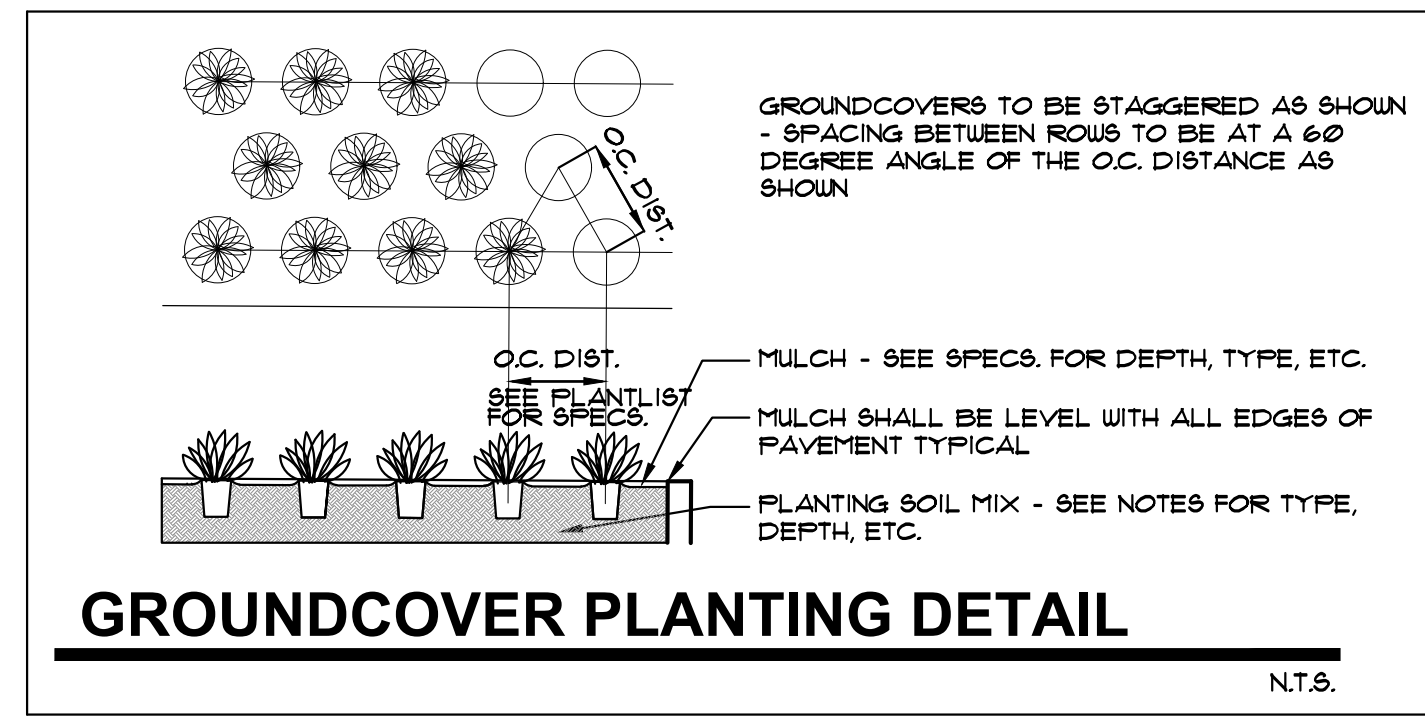
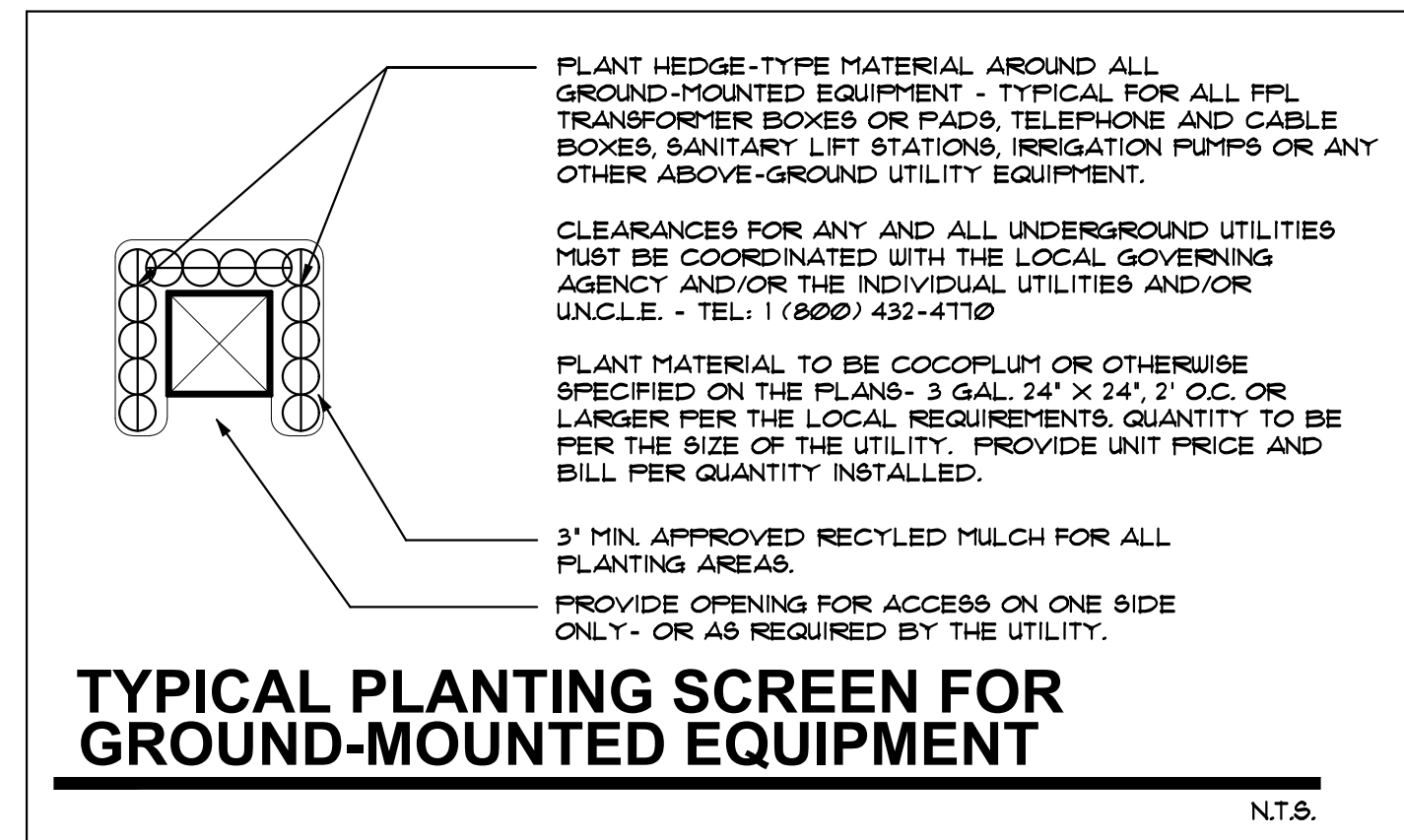
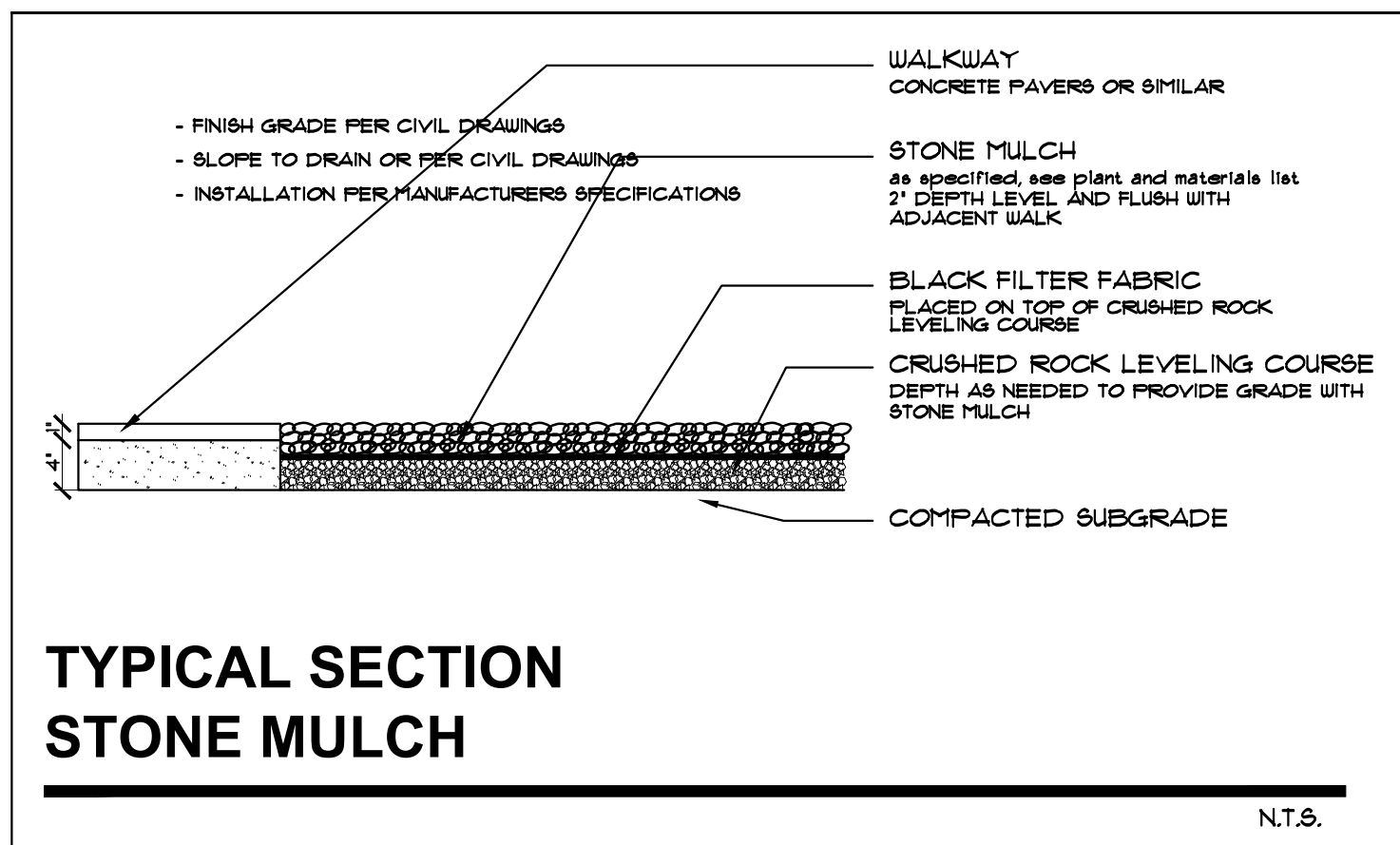
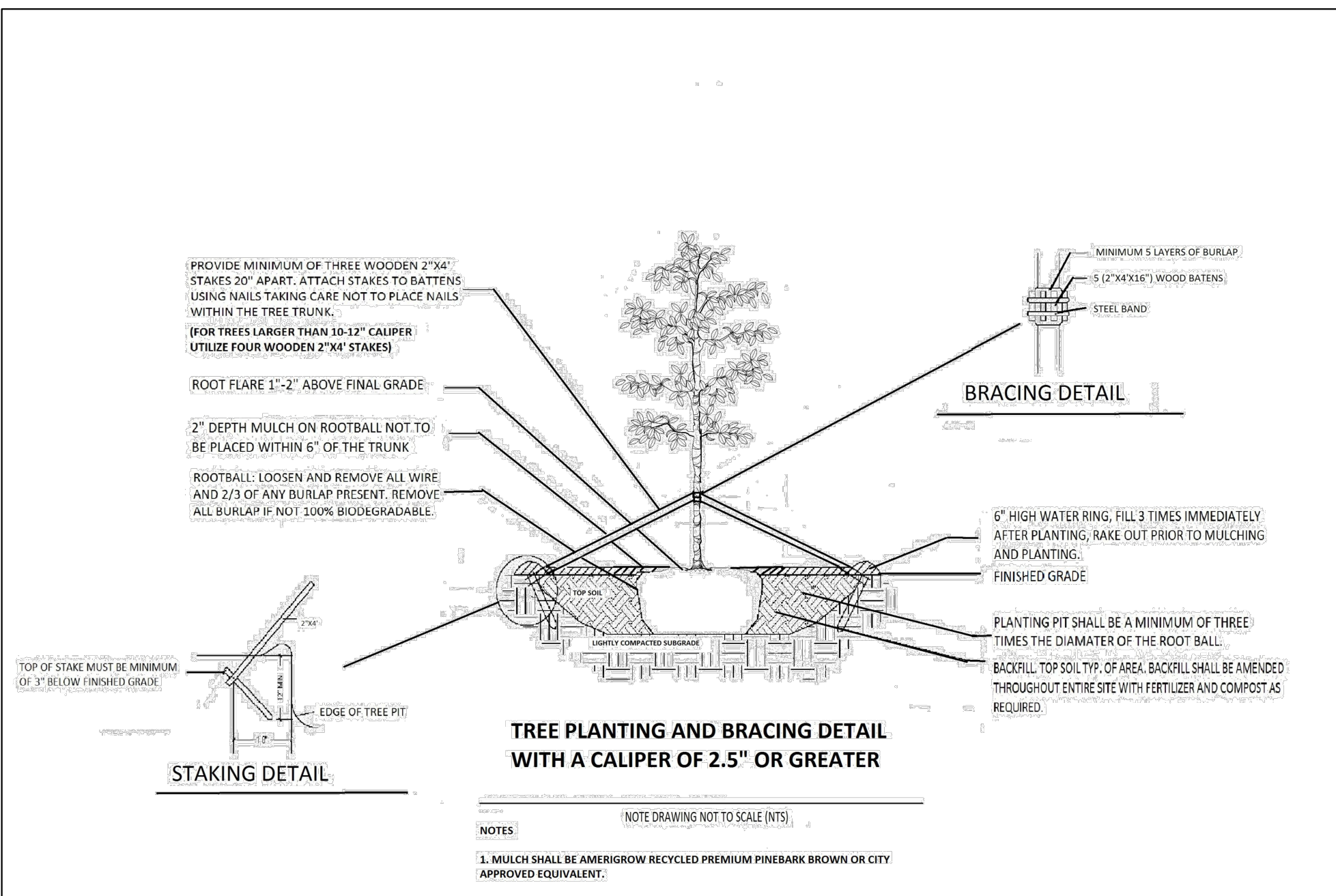
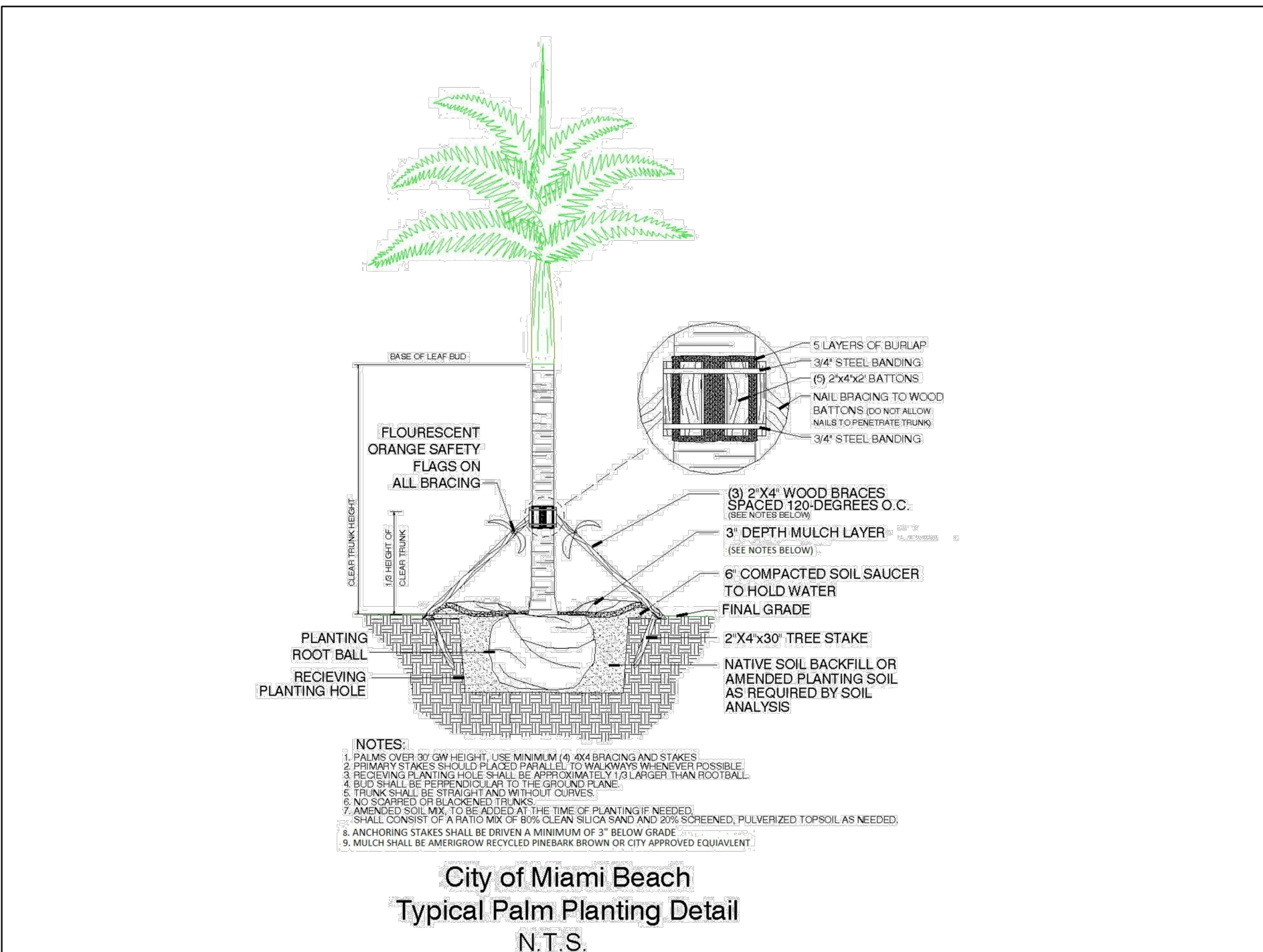
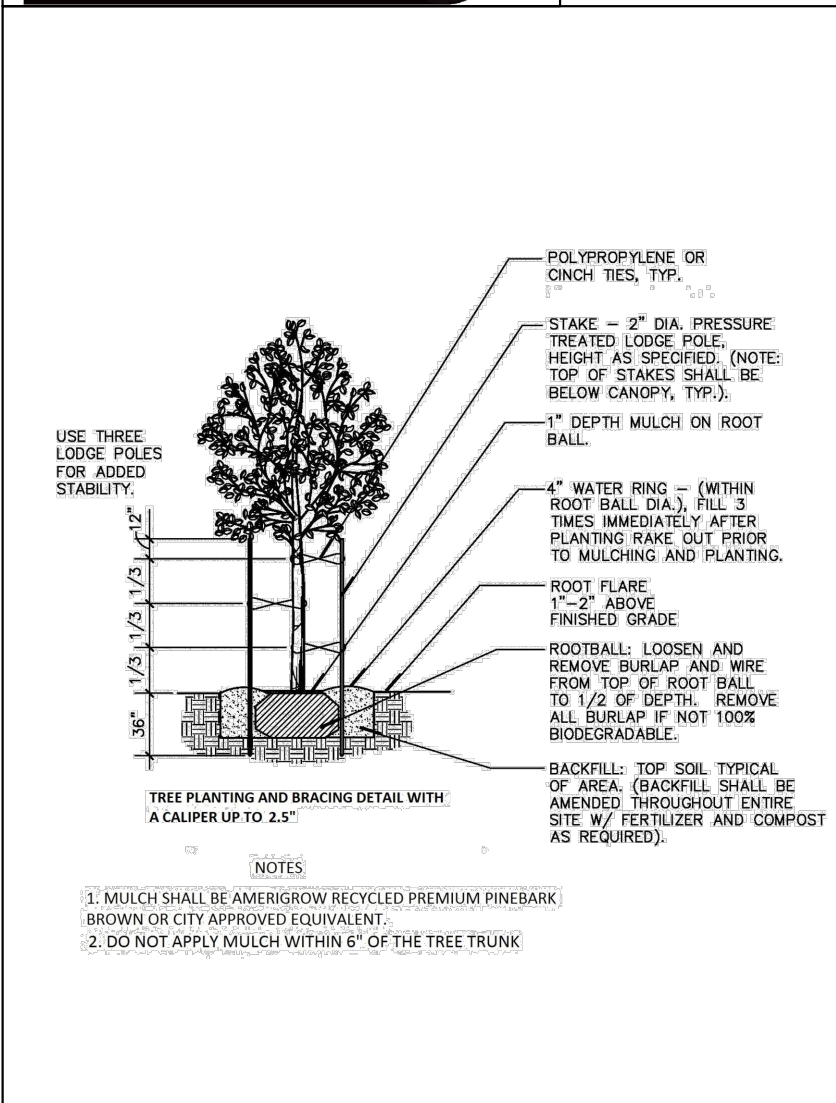

- ALL PLANT MATERIAL SHALL BE FLORIDA NO. 1 GRADE OR BETTER.
 - CONTRACTOR SHALL FAMILIARIZE HIMSELF WITH THE LOCATION OF AND AVOID AND PROTECT UTILITY LINES, BURIED CABLES, AND OTHER UTILITIES.
 - TREE, PALM, ACCENT AND BED LINES ARE TO BE LOCATED IN THE FIELD AND APPROVED BY THE LANDSCAPE ARCHITECT PRIOR TO INSTALLATION.
 - ALL PLANTING SOIL SHALL BE 50:50 TOPSOIL:SAND MIX, FREE OF CLAY, STONES, ROCKS, OR OTHER FOREIGN MATTER. THIS SPECIFICATION INCLUDES ALL BACKFILL FOR BERMS AND OTHER LANDSCAPE AREAS.
- SODDED-LAWN AREAS**
- 2" DEPTH PLANTING SOIL SPREAD IN PLACE - THROUGHOUT.
 - 6" DEPTH PLANTING SOIL SPREAD IN PLACE - THROUGHOUT.
 - SHRUB AND HEDGE PLANTING AREAS:
 - 12" DEPTH PLANTING SOIL SPREAD IN PLACE - THROUGHOUT.
 - TREES, PALMS, SPECIMEN PLANT MATERIAL:
 - 24" DEPTH PLANTING SOIL SPREAD IN PLACE OR TO THE DEPTH OF THE ROOTBALL OR CONTAINER WHICHEVER IS GREATEST.
- LANDSCAPE ISLANDS AND BUILDING FOUNDATIONS:**
- EXCAVATE AND REMOVE ALL LIMESTONE, ROCKS, DEBRIS, ETC. TO A DEPTH OF 12" AND BACKFILL WITH 50:50 TOPSOIL:SAND MIX.
 - BUILDING FOUNDATIONS SHALL BE THE SAME DEPTH TO A WIDTH OF 36" FROM THE BUILDING BASE.
- THE SITE CONTRACTOR SHALL BE RESPONSIBLE TO BRING ALL GRADES TO WITHIN 2" OF FINAL GRADES. THIS SHALL INCLUDE A 2" APPLICATION OF 50:50 TOPSOIL:SAND MIX FOR ALL LANDSCAPE AND AREAS TO BE SODDED.
 - THE LANDSCAPE CONTRACTOR SHALL CALCULATE AND SUBMIT AN ITEMIZED PRICE FOR THE 2" APPLICATION OF 50:50 MIX FOR ALL SOD AREAS AS A REFERENCE IN THE CASE THAT THERE WOULD BE A DISCREPANCY BETWEEN SITE AND LANDSCAPE CONTRACTORS AND NOTIFY THE SITE CONTRACTOR OR PROJECT SUPERINTENDENT AS TO THIS DISCREPANCY. IT WILL THEN BE DETERMINED WHICH PARTY WILL PROVIDE THIS 2" TOPSOIL:SAND APPLICATION AND SUBSEQUENT PAYMENT.
 - OTHER PLANTING SOIL MIXES TO BE ADDED, I.E. FOR TREES, PALMS, SPECIMEN PLANTS, SHRUBS AND GROUNDCOVERS SHALL BE THE RESPONSIBILITY OF THE LANDSCAPE CONTRACTOR AND BE INCLUSIVE WITH THE LANDSCAPE BID.
 - CONTRACTOR SHALL COORDINATE WITH THE IRRIGATION CONTRACTOR AND LEAVE PROVISIONS FOR ALL INCLUDING UNDERGROUND UTILITY LINE LOCATIONS DIAL 811 "NO CUTS" AS REQUIRED BY LAW.
 - ALL PLANTING BEDS SHALL BE MULCHED TO A DEPTH OF 3" WITH AN APPROVED RECYCLED MULCH BY THE PRESIDING GOVERNING AGENCY. NO DISEASE, CONTRACTOR SHALL SOO ALL AREAS AS INDICATED ON THE PLAN OR AS DIRECTED. PAYMENT SHALL BE DETERMINED BY THE TOTAL MEASURED SODDED AREAS X THE UNIT PRICE SUBMITTED AND FIELD VERIFIED.
 - SOD SHALL BE ARGENTINE "BAHIA" OR ST. AUGUSTINE "FLORATAM" AS SHOWN ON THE PLANS, STRONGLY ROOTED, FREE FROM WEED, FUNGUS, INSECTS AND DISEASE. CONTRACTOR SHALL SOO ALL AREAS AS INDICATED ON THE PLAN OR AS DIRECTED. PAYMENT SHALL BE DETERMINED BY THE TOTAL MEASURED SODDED AREAS X THE UNIT PRICE SUBMITTED AND FIELD VERIFIED.
 - SOD SHALL BE INSTALLED IN ACCORDANCE WITH THE SPECIFICATIONS AS DEFINED BY FDOT. SOD SHALL CARRY A 9-MONTH WARRANTY.
 - ALL TREES, PALMS, SHRUBS AND GROUNDCOVERS SHALL CARRY A ONE-YEAR WARRANTY FROM THE DATE OF FINAL ACCEPTANCE.
 - ALL TREES AND PALMS SHALL BE STAKED PER ACCEPTED STANDARDS BY THE FLORIDA NURSERYMEN & GROWERS LANDSCAPE ASSOCIATION (FNGLA). THERE SHALL BE ONE FINAL INSPECTION FOR APPROVAL, BY THE PRESIDING GOVERNING AGENCY. CONTRACTOR SHALL INSURE THAT THE PLANS, DETAILS, SPECIFICATIONS AND NOTES HAVE BEEN ADHERED TO AND THAT THE LANDSCAPE AND IRRIGATION INSTALLATION IS COMPLIANT TO ALL ITEMS AS DIRECTED ON THE PLANS PRIOR TO SCHEDULING OF THE FINAL INSPECTION. ALL BRACINGS AND STRAPPING MATERIAL SHALL BE INSTALLED FROM ALL TREES AND PALMS WITHIN 1 YEAR OF INSTALLATION. EXCEPTIONS REQUIRE WRITTEN AUTHORIZATION FOR THE CITY URBAN FORESTER.
 - THE PLANT LIST IS INTENDED ONLY AS AN AID TO BIDDING. ANY DISCREPANCIES FOUND BETWEEN THE QUANTITIES ON THE PLAN AND PLANT LIST, THE QUANTITIES ON THE PLAN SHALL BE HELD VALID.
 - IRRIGATION SHALL PROVIDE FOR A 100% COVERAGE WITH A 100% OVERLAP. AUTOMATIC SYSTEM WITH RAIN MOISTURE SENSOR ATTACHED TO CONTROLLER. ALL FLORIDA BUILDING CODE APPENDIX "F" IRRIGATION REQUIREMENTS SHALL BE STRICTLY ADHERED TO FOR INSTALLATION AND PREVAILING WATER MANAGEMENT DISTRICT RESTRICTIONS AND REGULATIONS SHALL BE IN COMPLIANCE FOR POST-INSTALLATION WATERING SCHEDULES.
 - EXISTING IRRIGATION SYSTEM (IF APPLICABLE) SHALL BE RETROFITTED TO COMPLY WITH THOSE SPECIFICATIONS AS OUTLINED ABOVE.
 - CONTRACTOR SHALL PROVIDE A WATER TRUCK DURING PLANTING TO INSURE PROPER WATERING-IN DURING INSTALLATION AND WILL BE RESPONSIBLE FOR CONTINUAL WATERING UNTIL FINAL ACCEPTANCE BY THE OWNER.
 - ALL EXISTING TREES, PALMS AND PLANT MATERIAL TO REMAIN SHALL BE PROTECTED DURING CONSTRUCTION. CONTRACTOR SHALL INSTALL PROTECTIVE BARRIERS SUCH AS "TENAX" PROTECTIVE FENCING OR AS SHOWN ON THE DETAILS TO BE INSTALLED AT THE BEGINNING OF THE PROJECT. TREE PROTECTIVE BARRIERS THAT NOT BE RELOCATED OR REMOVED WITHOUT THE WRITTEN PERMISSION OF THE LANDSCAPE ARCHITECT AND CITY URBAN FORESTER. BARRIERS SHALL BE LOCATED TO INCLUDE THE DRIPLINE OF THE TREES, PALMS AND PLANT MATERIAL WHERE POSSIBLE. THE CONTRACTOR SHALL TAKE EXTRA CAUTION TO PREVENT ANY DAMAGE TO THE TRUNK, BRANCHES, ROOTS, ROOT ZONE AREAS AND ADJACENT GRADES. SHOULD ANY TREES OR PALMS BE DAMAGED THEY SHALL BE EVALUATED BY THE CITY URBAN FORESTER TO DETERMINE CORRECTIVE ACTIONS THAT MAY INCLUDE REMOVAL, CORRECTIVE PRUNING AND OR REPLACEMENT. ANY CORRECTIVE ACTIONS REQUIRED SHALL BE PERFORMED IN ACCORDANCE WITH MIAMI DADE COUNTY CODE, ANSI A-300 PRUNING STANDARDS AND OR AN ISSUED ERM TREE OR ENVIRONMENTAL PERMIT. ANY CORRECTIVE PRUNING REQUIRED SHALL BE PERFORMED BY AN ISA CERTIFIED ARBORIST OR ASCA CONSULTING ARBORIST AND THE CITY URBAN FORESTER SHALL BE CONSULTED.
 - EXISTING TREES AND PALMS TO REMAIN SHALL BE TRIMMED PER ANSI-300 STANDARDS. SUPERVISION OF THE TRIMMING SHALL BE PERFORMED BY AN ISA-CERTIFIED ARBORIST. THE CITY URBAN FORESTER SHALL BE NOTIFIED AND CONSULTED PRIOR TO ANY CORRECTIVE STRUCTURAL PRUNING BEING PERFORMED ON-SITE.
 - ALL EXISTING TREES AND PALMS SHALL BE "LIFTED AND THINNED" TO PROVIDE FOR AN 8' MINIMUM CLEARANCE FOR SIDEWALKS AND PEDESTRIAN WALKWAYS AND A 14' MINIMUM CLEARANCE FOR ROADWAYS, DRIVEWAYS, AND ALL VEHICULAR USE AREAS. ALL PRUNING PERFORMED SHALL FOLLOW CURRENT ANSI A-300 STANDARDS AND GOOD HORTICULTURAL PRACTICES AS PERFORMED BY AN ISA CERTIFIED ARBORIST. NO PRUNING SHALL BE ALLOWED THAT DESTROYS A TREE OR PALM'S CHARACTER, AESTHETICS OR RESULTS IN MATERIAL BEING DOUNGRADED BELOW CITY OR COUNTY STANDARDS. THE CITY URBAN FORESTER SHALL BE NOTIFIED AND CONSULTED PRIOR TO ANY STRUCTURAL PRUNING BEING PERFORMED.
 - REMOVAL OF ANY TREES OR PALMS WILL REQUIRE A WRITTEN "TREE REMOVAL PERMIT" FROM THE LOCAL GOVERNING AGENCY PRIOR TO REMOVAL.
 - ALL PLANTINGS IN NON-IRRIGATED AREAS, I.E. RIGHTS OF WAY, SWALES, ETC. SHALL BE WATERED-IN THOROUGHLY AND CONTINUED TO BE WATERED THROUGHOUT UNTIL C.O. ACCEPTANCE. COORDINATE WITH OWNER AND PROJECT MANAGER TO PROVIDE POST C.O. WATERING TO INSURE PLANT ESTABLISHMENT FOR A MINIMUM OF ONE YEAR AFTER CERTIFICATE OF OCCUPANCY ACCEPTANCE.

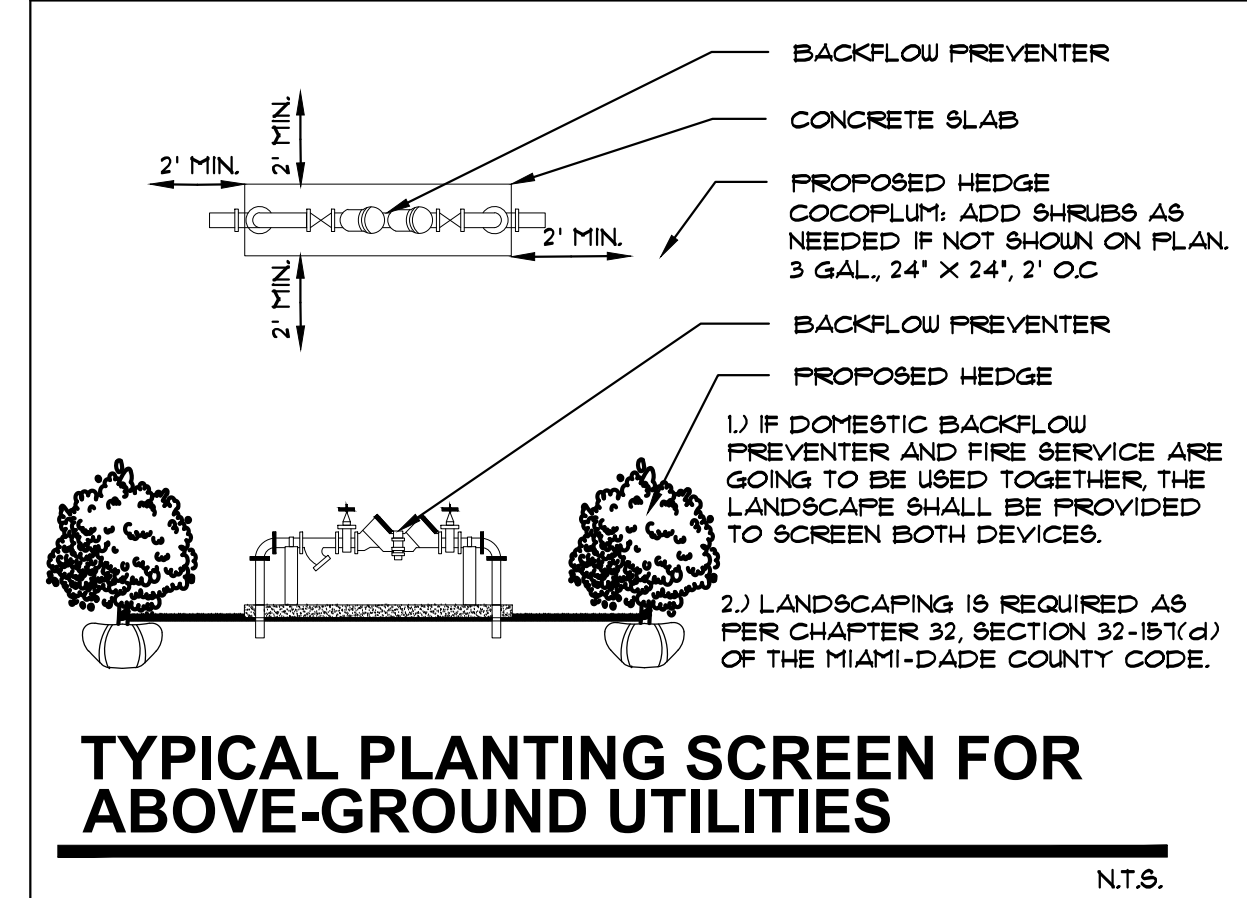
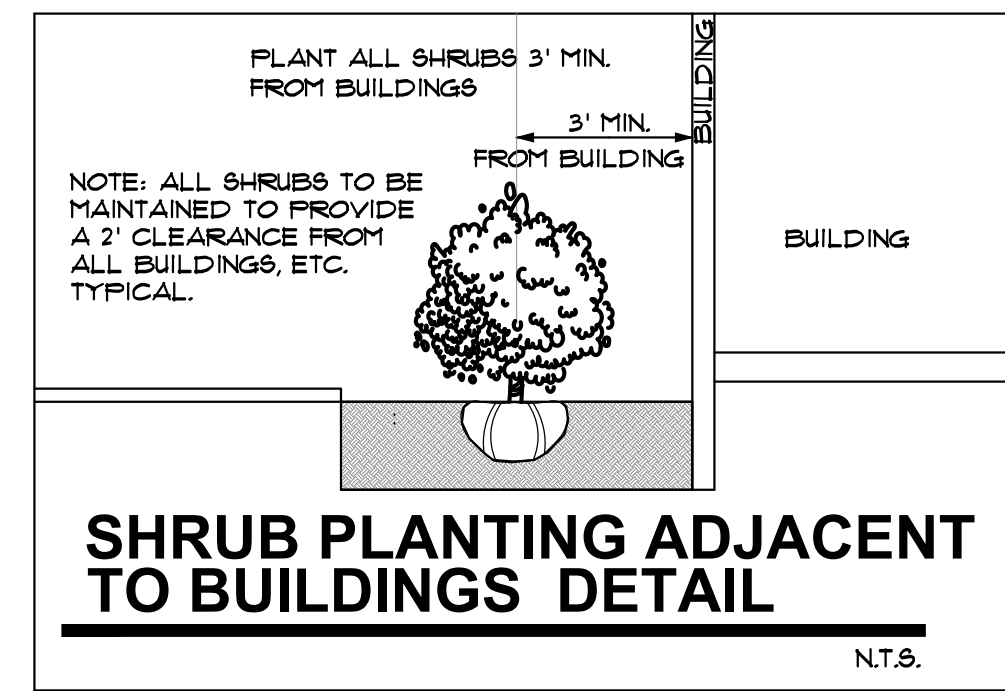
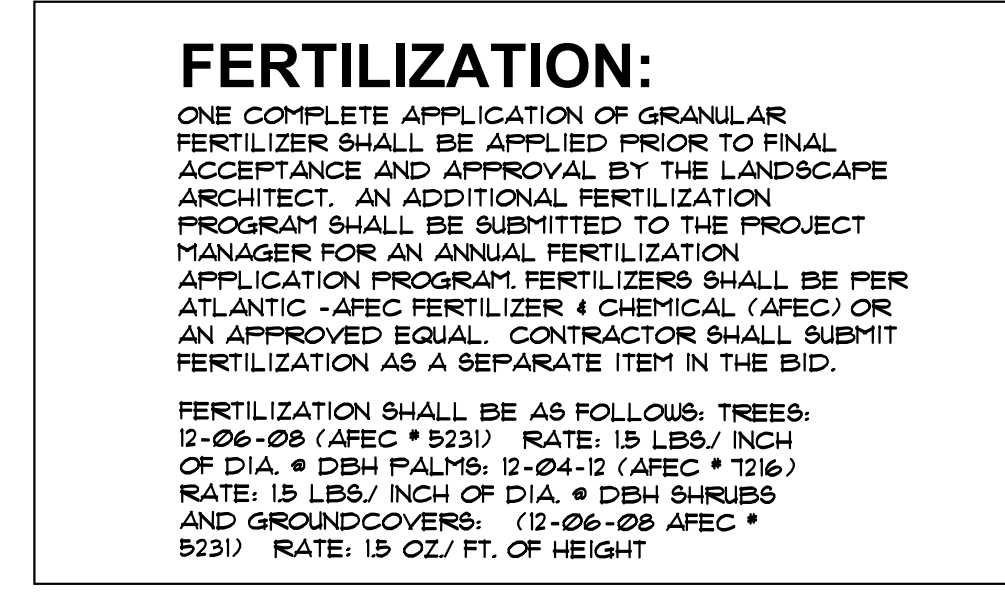

A WRITTEN TREE REMOVAL PERMIT FROM THE CITY OF MIAMI BEACH IS REQUIRED PRIOR TO REMOVAL OF ANY TREE OR PALMS FROM THE SITE.

SEE L-1 FOR LANDSCAPE PLAN.

SEE IRR-1 FOR IRRIGATION PLAN.

Copyright 2016 JFS Architectural Group, Inc.
All rights reserved. These drawings and specifications are instruments of service and shall remain the property of JFS Architectural Group, Inc. whether the product for which they were prepared is installed or not. They are not to be used on any project or other project or extension to the project except by agreement in writing and with appropriate compensation to JFS Architectural Group, Inc. Reproduction of specifications without the written consent of JFS Architectural Group, Inc. is prohibited.

4344
ALTON ROAD
MIAMI BEACH, FLORIDA 33140

DATE:	2.12.16
DESIGNED BY:	JAV
DRAWN BY:	JAG
REVIEWED BY:	MDF
PROJECT NO.:	16-0005

NO.	REVISIONS

JOSE A. VIDALLAR 4535
MANUEL D. FERNANDEZ
MAR 15 2016
JAMES F. BOSCH
RLA # 0001132

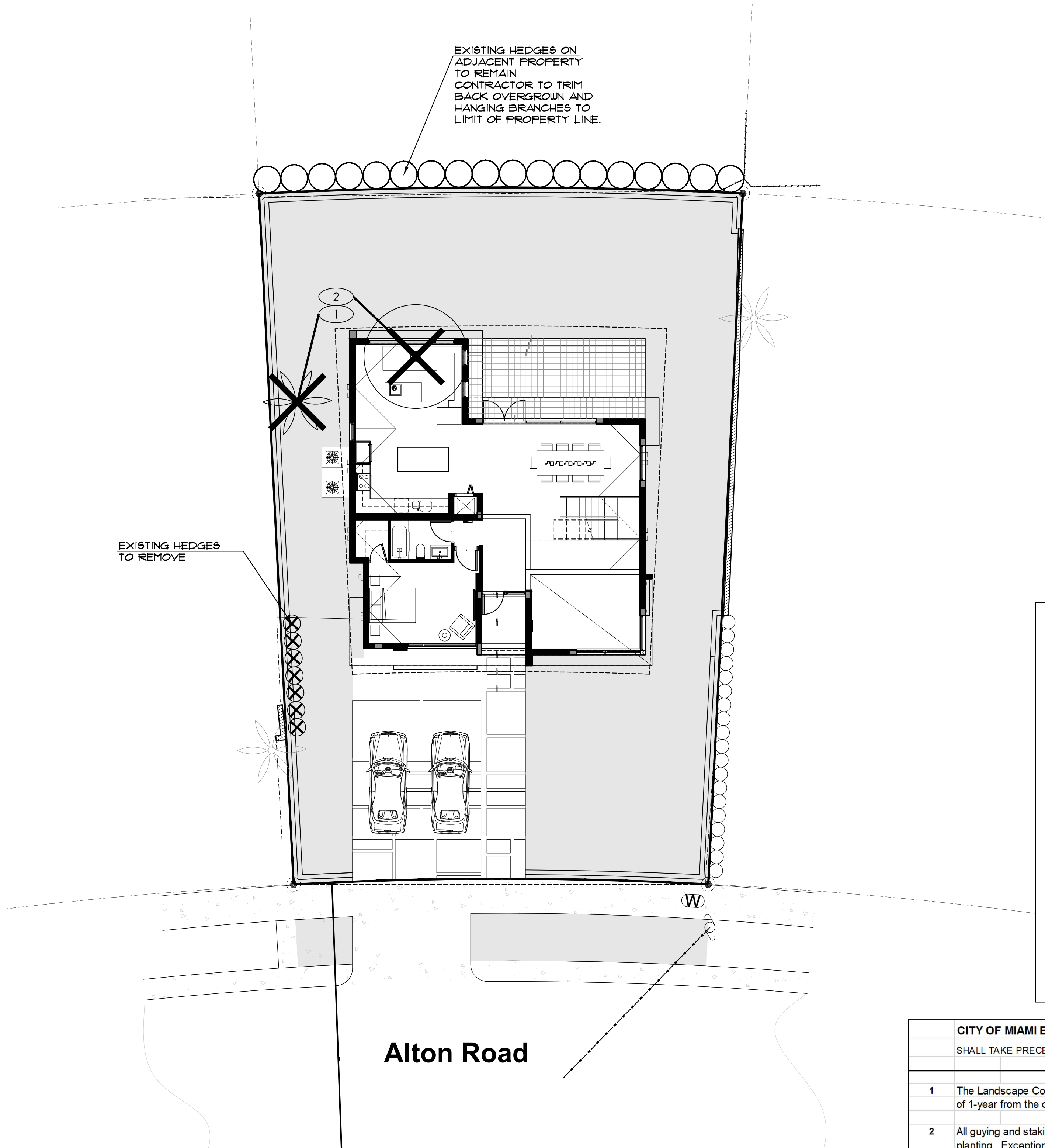

- NOTES:**
1. A WRITTEN TREE REMOVAL PERMIT IS REQUIRED FROM THE LOCAL GOVERNING AGENCY PRIOR TO REMOVAL OF ANY TREES OR PALMS FROM THE SITE.
 2. SEE LANDSCAPE PLANS FOR PROPOSED LANDSCAPE PLANTINGS, LANDSCAPE LEGEND, PLANTLIST, SPECIFICATIONS, DETAILS, ETC.
 3. THE CONTRACTOR SHALL REMOVE ALL TREES AND HEDGES AS PER PLANS AND AS APPROVED BY THE LOCAL GOVERNING AGENCIES (THE CITY OF MIAMI BEACH). TREE, PALM AND HEDGE MATERIAL SHALL INCLUDE ALL TRUNKS, STUMPS AND ROOTS. ALL EXCESS DEBRIS SHALL BE REMOVED FROM THE SITE AND DISPOSED OF AT AN APPROVED SITE. ALL HOLES AND DEPRESSIONS SHALL BE BACKFILLED WITH CLEAN, APPROVED BACKFILL.
 4. LOCATIONS SHOWN FOR THE EXISTING TREES AND PALMS ARE APPROXIMATE, EXACT LOCATIONS ARE TO BE FIELD VERIFIED BY A REGISTERED LAND SURVEYOR (RLS) PRIOR TO ANY PAVING OR ANY OTHER SUCH WORK WHICH WILL BE IMPACTED BY ANY TREES OR PALMS TO REMAIN.
 5. ALL INVASIVE EXOTIC VEGETATION AND ANY ANY OTHER PLANTS LISTED AS CATEGORY I, ON THE FLORIDA EXOTIC PEST PLANT COUNCIL'S LIST OF FLORIDA'S MOST INVASIVE SPECIES SHALL BE REMOVED FROM THE SITE AND MAINTENANCE SHALL GUARANTEE CONTROL OF RE-INVASION.

CITY OF MIAMI BEACH TREE DISPOSITION NOTES
SHALL TAKE PRECEDENCE OVER ANY OTHER NOTES OR DISCREPANCIES

- 1 The Landscape Contractor shall guarantee all new and or relocated trees and palms for a period of 1-year from the date of initial acceptance and approval.
- 2 All guying and staking shall be removed from all trees and palms within twelve months after planting. Exceptions require written authorization from the City Urban Forester.
- 3 Tree protection barriers may not be taken down, modified and or removed without written authorization from the City Urban Forester.
- 4 Mulch shall not be applied within 6" of any tree or palm trunks that are installed or incorporated into the project.
- 5 A final on-site inspection shall be required by the Urban Forestry Division staff prior to any official acceptance of ROW plant material, in order to verify proper planting depth, spacing and quality of the material. Failure to conduct the inspection could result in rejection of the plant material.

4344 ALTON ROAD, MIAMI BEACH, FL 33140
1/17/2016

No.	SYM	COMMON NAME	BOTANICAL NAME	HEIGHT FT.	SPREAD FT.	DBH Inches	CANOPY S.F.	STATUS	SPECIMEN TREE		
									CANOPY LOSS S.F.	2X CANOPY LOSS S.F.	COMMENTS
1	RAW	TRAVELER'S PALM	<i>Ravenea madagascarenensis</i>	25	25	multi	491	REMOVE	491		
2		DEAD TREE		12	15	6	177	REMOVE	314		
TOTALS							668		805	0	

CALCULATIONS ARE APPROXIMATE PER FIELD OBSERVATION AND INVENTORY FROM SITE VISIT ON JANUARY 16, 2016
PROHIBITED SPECIES ARE NOT CALCULATED FOR CANOPY MITIGATION PER MIAMI-DADE CO. TREE PRESERVATION ORDINANCE

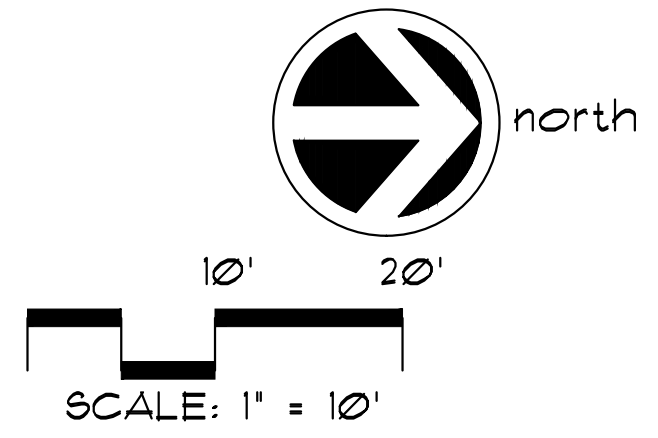

A WRITTEN TREE REMOVAL PERMIT IS REQUIRED FROM THE CITY OF MIAMI BEACH PRIOR TO REMOVAL OF ANY TREES FROM THIS SITE.
SEE LANDSCAPE PLANS FOR PROPOSED PLANTINGS, LANDSCAPE LEGEND, PLANTLIST, DETAILS, ETC.

4344 ALTON ROAD
MIAMI BEACH, FLORIDA 33140

DATE: 2.12.16
DESIGNED BY: JAV
DRAWN BY: JAG
REVIEWED BY: MDF
PROJECT NO. 16-0005

REVISIONS

JOSÉ A. VIDALLAR 4535
MANUEL D. FERNANDEZ
AR 95501

JAMES F. SOCCASH
R.L.A. # 000132

SEAL

TREE DISPOSITION PLAN