

§ 18A-11
Landscape maintenance.

- (A) An owner is responsible to ensure that landscaping required to be planted pursuant to this chapter, or the ordinances which were in effect prior to the effective date of this chapter, is:
- (1) Installed in compliance with the Landscape requirements;
 - (2) Maintained as to present a healthy, vigorous, and neat appearance free from refuse and debris; and
 - (3) Sufficiently fertilized and watered to maintain the plant material in a healthy condition.
- (B) If any tree or plant dies which is being used to satisfy current landscape code requirements, such tree or plant shall be replaced with the same landscape material or an approved substitute.
- (C) Trees shall be pruned in the following manner:
- (1) All cuts shall be clean, flush and at junctions, laterals or crotches. All cuts shall be made as close as possible to the trunk or parent limb, without cutting into the branch collar or leaving a protruding stub.
 - (2) Removal of dead wood, crossing branches, weak or insignificant branches, and sucker shall be accomplished simultaneously with any reduction in crown.
 - (3) Cutting of lateral branches that results in the removal of more than one-third (1) of all branches on one (1) side of a tree shall only be allowed if required for hazard reduction or clearance pruning.
 - (4) Lifting of branches or tree thinning shall be designed to distribute over half of the tree mass in the lower two-thirds (1) of the tree.
 - (5) No more than one-third (1) of a tree's living canopy shall be removed within a one (1) year period.
 - (6) Trees shall be pruned according to the current ANSI A300 Standards and the Landscape Manual.
 - (7) All newly install planting material will be maintained in a condition that meets or exceeds Florida Grade #01 and has (01) one year replacement guarantee

LANDSCAPE NOTES

01. Non Cypress variety mulch shall extend under all trees, shrubs and ground cover beds to the closest hard edge or sod border, in a minimum of 3" depth.
02. All plants shall meet the minimum standard of Florida No. 1, or better as specified in Grade and Standards for Nursery Plants as published by the Division of Plant Industry, Florida Department of Agriculture, latest edition.
03. All shrubs to be planted a minimum of 24" , and ground covers a minimum of 12" from the edge of walks, building walls, pond's edge, etc. ,Ivora Nora Grant and Raphiolepis Indica to be planted 30" form edge of walkways.
04. All trees and palms over 8" in height shall be braced to prevent lateral movement for a period of six months from the date of planting. Either wood braces as shown in the planting detail, or the wire and turnbuckle method shall be used. No nails, screws, metal straps or wires are to be used directly against the trees or palms trunks.
05. All palms except for species such as Cocco, Acoelorrhaphis, Rapahis, and other multitrunk palms, shall have straight trunks, free of scars, decay or any damage caused by digging, transport or planting handling of the same.
06. All work by the Landscape Contractor shall be performed in a professional and sound manner in accordance with established standards of landscape installation practices and workmanship.
07. Landscape Contractor is responsible for verifying plant quantities prior to bidding. Quantities shown in the plans may vary due to actual site scale, job conditions, etc... Landscape Architect assumes no responsibility for the actual plant count necessary for the successful completion of the work.
08. Landscape Contractor and his subcontractors shall be licensed and insured as required by the municipality, county, state or any other governmental agency requiring a license or insurance in order for the Landscape Contractor to perform his work.
09. All work shall conform to Miami-Dade County's landscape ordinance Chapter 18-A, ordinance # 98-13, and any other municipal landscape ordinance in effect at the projects location, includins streets-tres.
10. Landscape Contractor is required to procure and obtain any necessary permits applicable for the successful completion of this project, if applicable.
11. Landscape material shall not be allowed to grow in such a manner as to impede streetfront triangle of visibility to property owner or neighbors, so as to materially impede vision between a height of 5 feet and 8 feet.
12. Landscape Contractor shall call Sunshine State One Call Center of Florida at 1-800-432-4770 (Toll Free) 48 hours before digging.
13. Landscape Contractor is responsible for inspecting the site and physically observing all the site conditions prior to entering into Agreements or Contract with Owner. Landscape Contractor shall coordinate his work with the General Contractor of Construction Manager in such a manner as to allowed for a speedy and orderly completion of all work on the site.
14. Any excess soil, landscape materials and debris from the landscape Contractor's work shall be removed from the site immediately upon completion of his work.
15. Landscape Contractor shall coordinate the proposed planting in the Planting Plan with the work required in recolacing and removal of trees in sheet L-1 (Existing Trees).
16. One year guarantee on plan material

Sec. 30-242 - Artificial turf.

- (a)Definitions . The following words, terms and phrases when used in this section, shall have the meanings ascribed to them in this section:
- (1)Corner Lot: A Lot located at the intersection of two streets and abutting such streets on two adjacent sides.
- (2)Artificial Turf: An artificial product manufactured from synthetic materials that simulates the appearance of natural turf, grass, sod or lawn.
- (b)Installation.
- (1)Single Family and Two-Family Districts. Within the VR, VE, IR and PS Districts, Artificial Turf shall not be permitted to be installed within a Front Yard of any Lot, or within a Street Side Yard of a Corner Lot.
- (2)Other Districts. Within all other zoning districts with the exception of the PROS Public Recreation and Open Space Use District and the GU Government Use District, Artificial Turf shall not be permitted to be installed within a Front Yard, or within a Side Yard facing a Street.
- (c)Installation, Maintenance and Repair
- (1)No person shall install Artificial Turf without first obtaining a permit from the Village Planning, Building and Zoning Department.
- (2)All Artificial Turf shall, at a minimum, be installed according to the manufacturer's specifications.
- (3)All seams shall be nailed and glued, not sewn, and edges shall be trimmed to fit against all regular and irregular edges to resemble a natural look.
- (4)If Artificial Turf is planned to be installed immediately adjacent to a seawall, the Artificial Turf shall be pinned or staked behind the seawall. No Artificial Turf or installation mechanism shall be attached directly to or placed on a seawall or seawall cap.
- (5)Artificial Turf shall be visually level, with the grain pointing in a single direction.
- (6)An appropriate solid barrier device (e.g., concrete mow strip, border board) is required to separate Artificial Turf from soil and live vegetation.
- (7)Precautions for installation around existing trees, including a proper radius, shall be provided to ensure that tree roots are not damaged with the installation of the base material and that the overall health of the tree will not be compromised.
- (8)All Artificial Turf shall be maintained in a green fadeless condition and shall be maintained free of dirt, animal waste, mud, stains, weeds, debris, tears, holes, and impressions. Maintenance shall include, but not be limited to cleaning, brushing, debris removal, repairing of depressions and ruts to maintain a visually-level surface, elimination of any odors, flat or matted areas, weeds, and invasive roots, and all edges of the Artificial Turf shall not be loose and must be maintained with appropriate edging or stakes.
- (9)All Artificial Turf must be replaced if it fails into disappear with fading or holes or loose areas. Replacement and repairs shall be done with like materials from the same manufacturer and done so in a manner that results in a repair that blends in with the existing Artificial Turf, without any maiting.
- (10)All Artificial Turf shall be installed on a permeable backing in order to ensure proper drainage.(12)All Artificial Turf shall be of the highest quality available from a list of Village-approved manufacturers, and shall be a natural green color selected from a palette of colors approved by the Village.

LANDSCAPE LEGEND

TRANSECT ZONE: ____CPS--2____ LOT AREA : 5000 SF ACRES: ____0.114____

	REQUIRED/	ALLOWED	PROVIDED
TREES			
A. NUMBER OF TREES REQUIRED PER LOT ACRE, LESS EXISTING NUMBER OF TREE			
MEETING MINIMUM REQUIREMENTS =			
1. TREES : LOT ACRE / 22 = NUMBER OF EXISTING TREES =		__3__	__5__
B. % PALMS ALLOWED: NUMBER OF TREE PROVIDED X 40% =		__2__	__2__
C. % NATIVES REQUIRED: NUMBER OF TREE PROVIDED 40% =		__4__	__8__
D. % DROUGHT TOLERANT AND LOW MAINTENANCE			
NUMBER OF TREE PROVIDED X 20% =		__3__	__3__
E. STREET TREES (MAXIMUM AVERAGE SPACING OF 20' O.C.)			
LINEAR FEET ALONG STREET / 20 =		__NA__	__NA__
F. STREET TREES LOCATED DIRECTLY BENEATH POWER LINES : (MAXIMUM			
AVERAGE SPACING OF 20' O.C.) : LINEAR FEET ALONG STREET / 20 =			
SHRUBS			
A. NUMBER OF SHRUBS REQUIRED: NUMBER OF TREES REQUIRED X 12 =		__72__	__80__
B. % NATIVE SHRUBS REQUIRED : NUMBER OF SHRUBS PROVIDE X 40% =		__29__	__54__
LARGE SHRUBS OR SMALL TREE			
A. NUMBER OF SHRUBS REQUIRED X 10% =		__8__	__8__
B. % NATIVE REQUIRED : NUMBER OF SHRUBS PROVIDED X 50% =		__4__	__4__

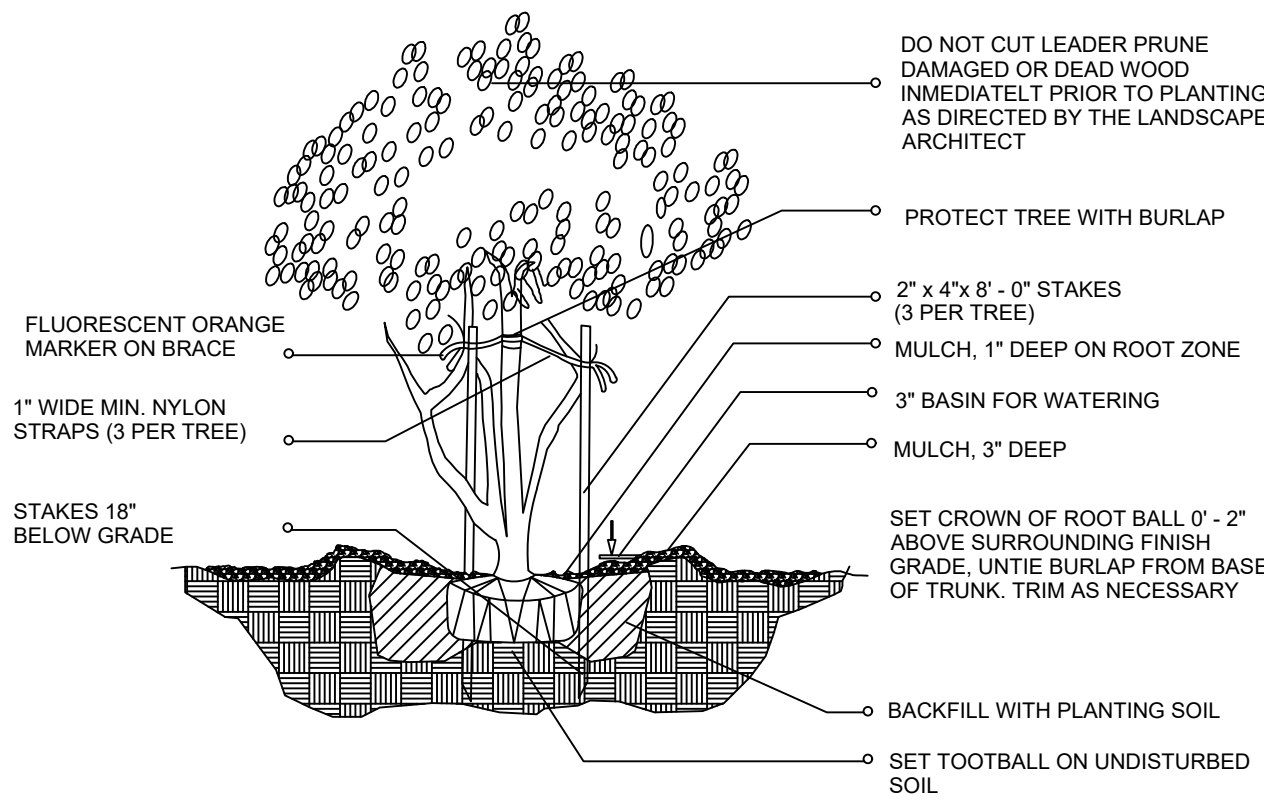

MULTI-TRUNK AND SMALL TREE (2' cal. and under) / PLANTING DETAIL

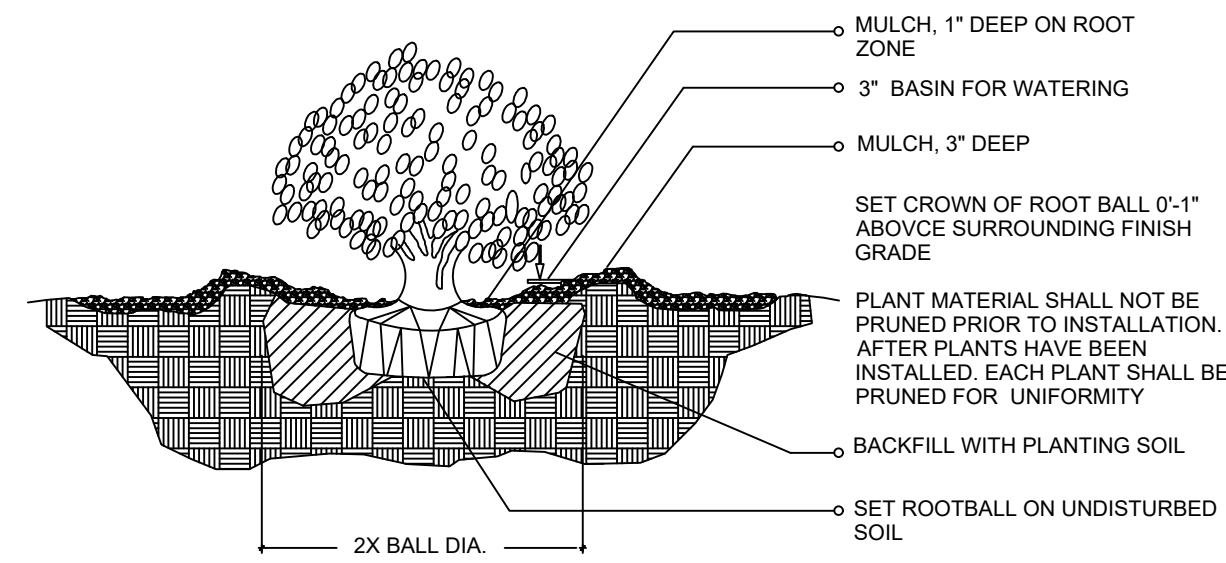

SHRUB / PLANTING DETAIL

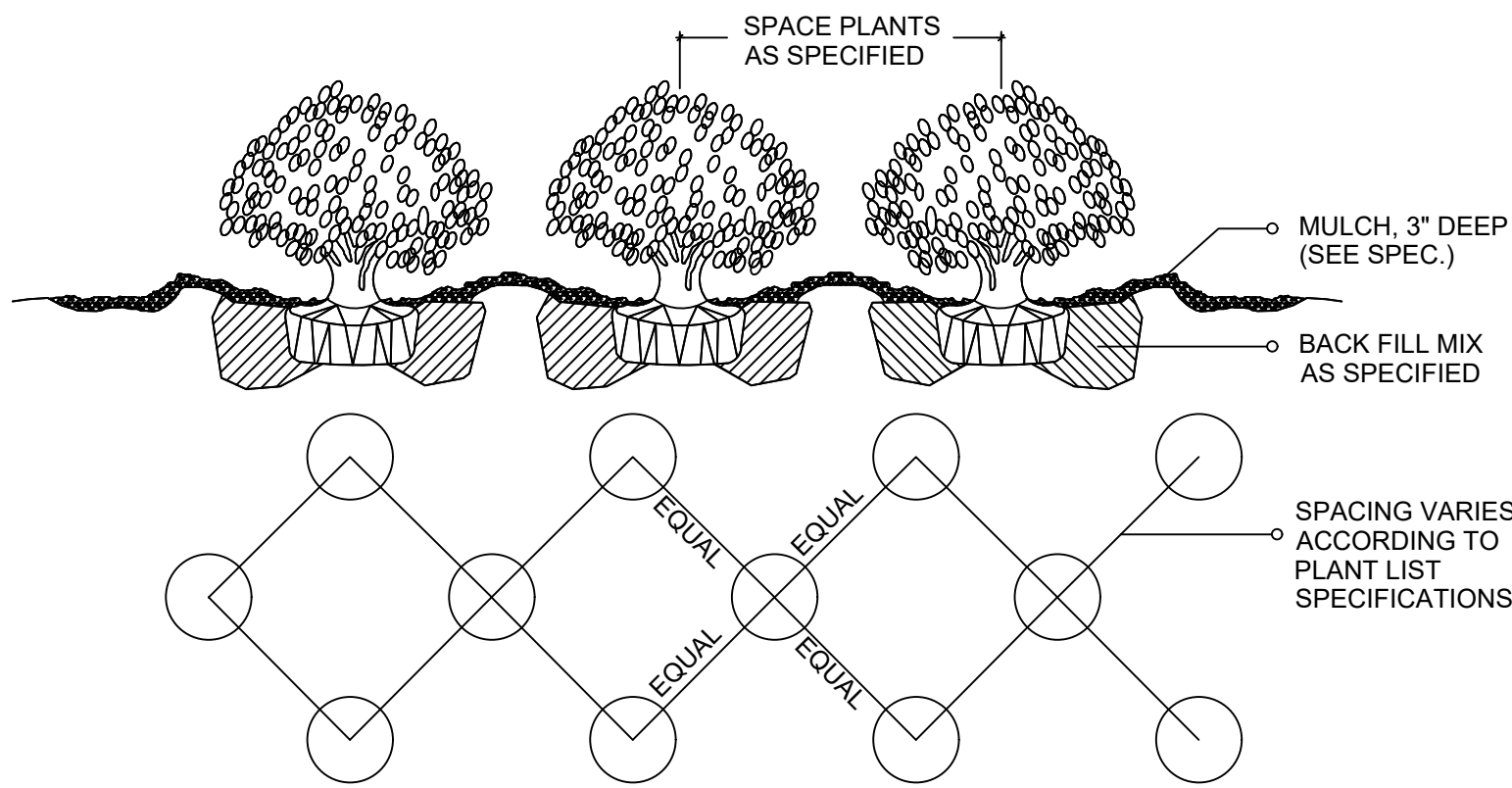
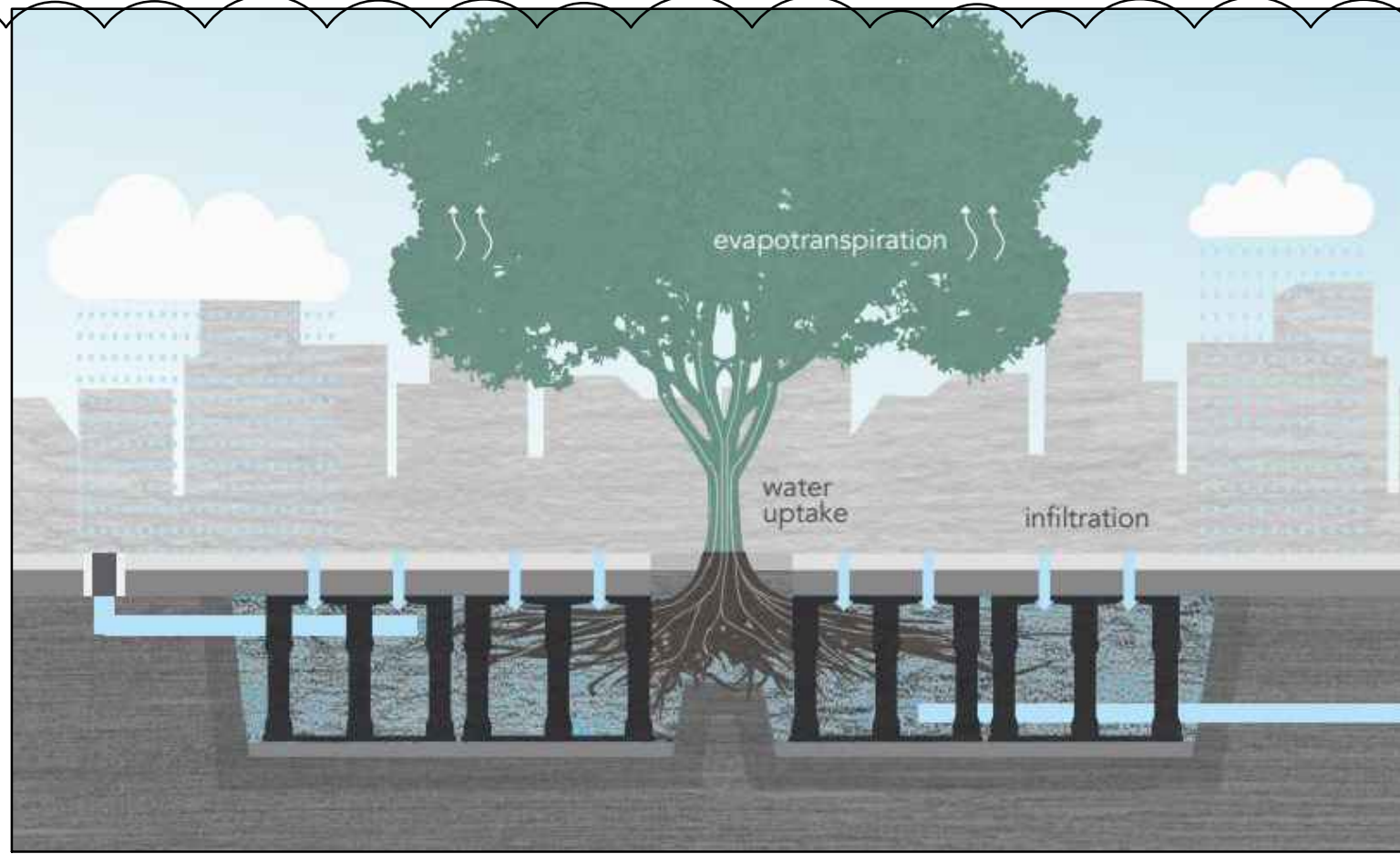
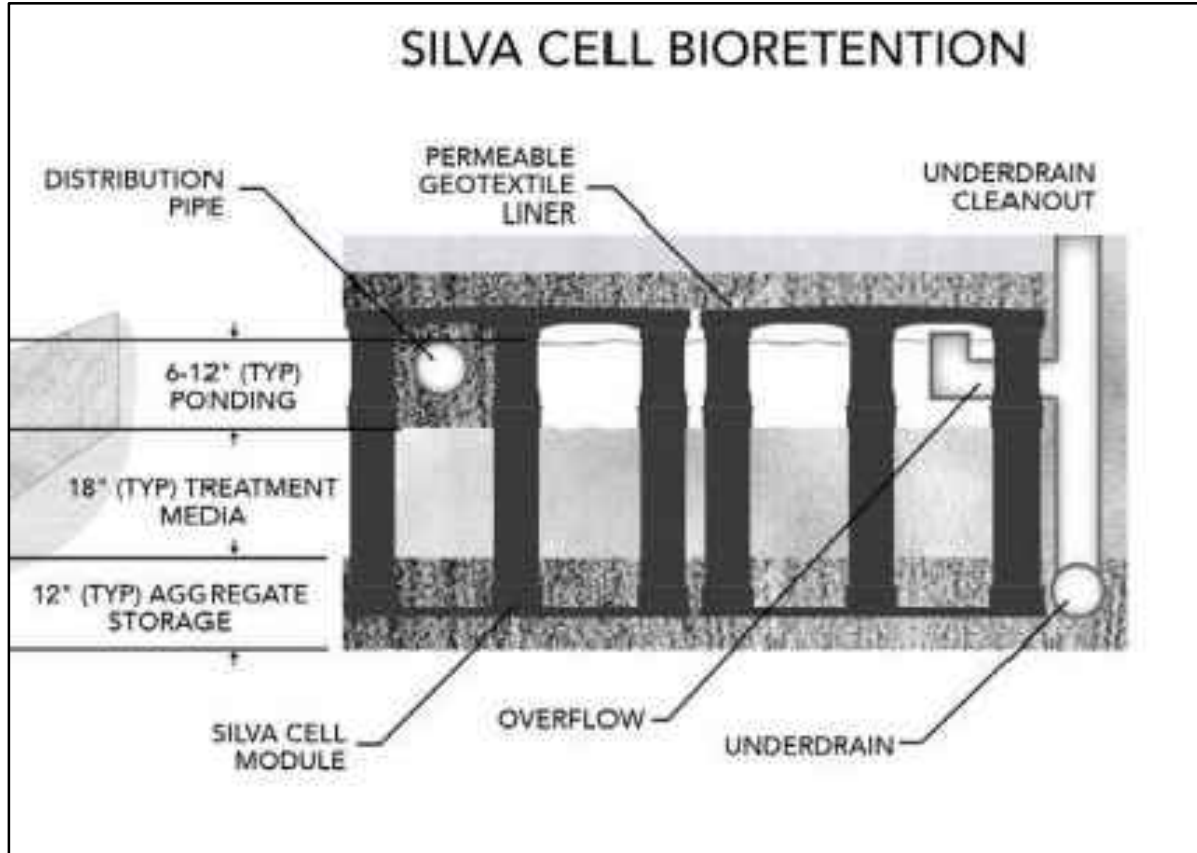

SHRUB / GROUNDCOVER
SPACING PLANTING DETAIL

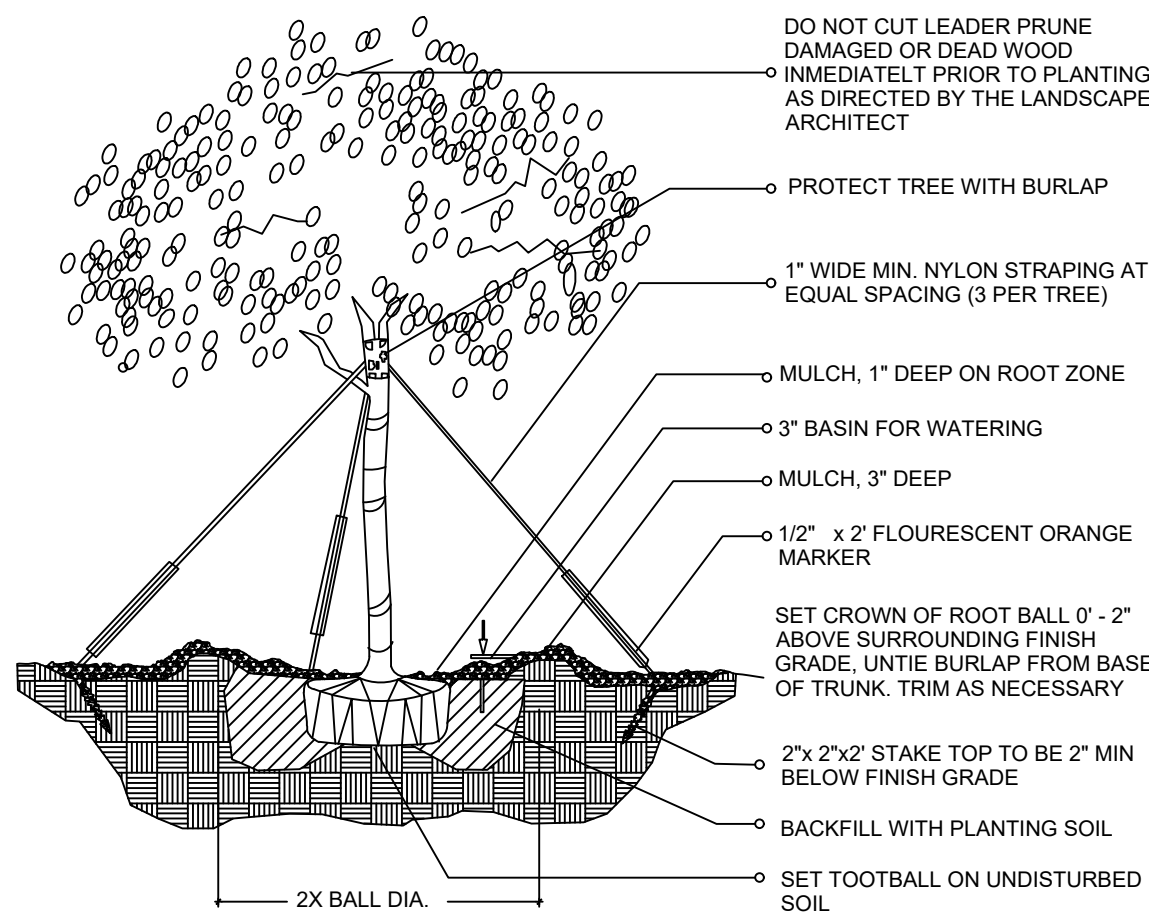

(2" cal. and over)
LARGE TREE / PLANTING DETAIL

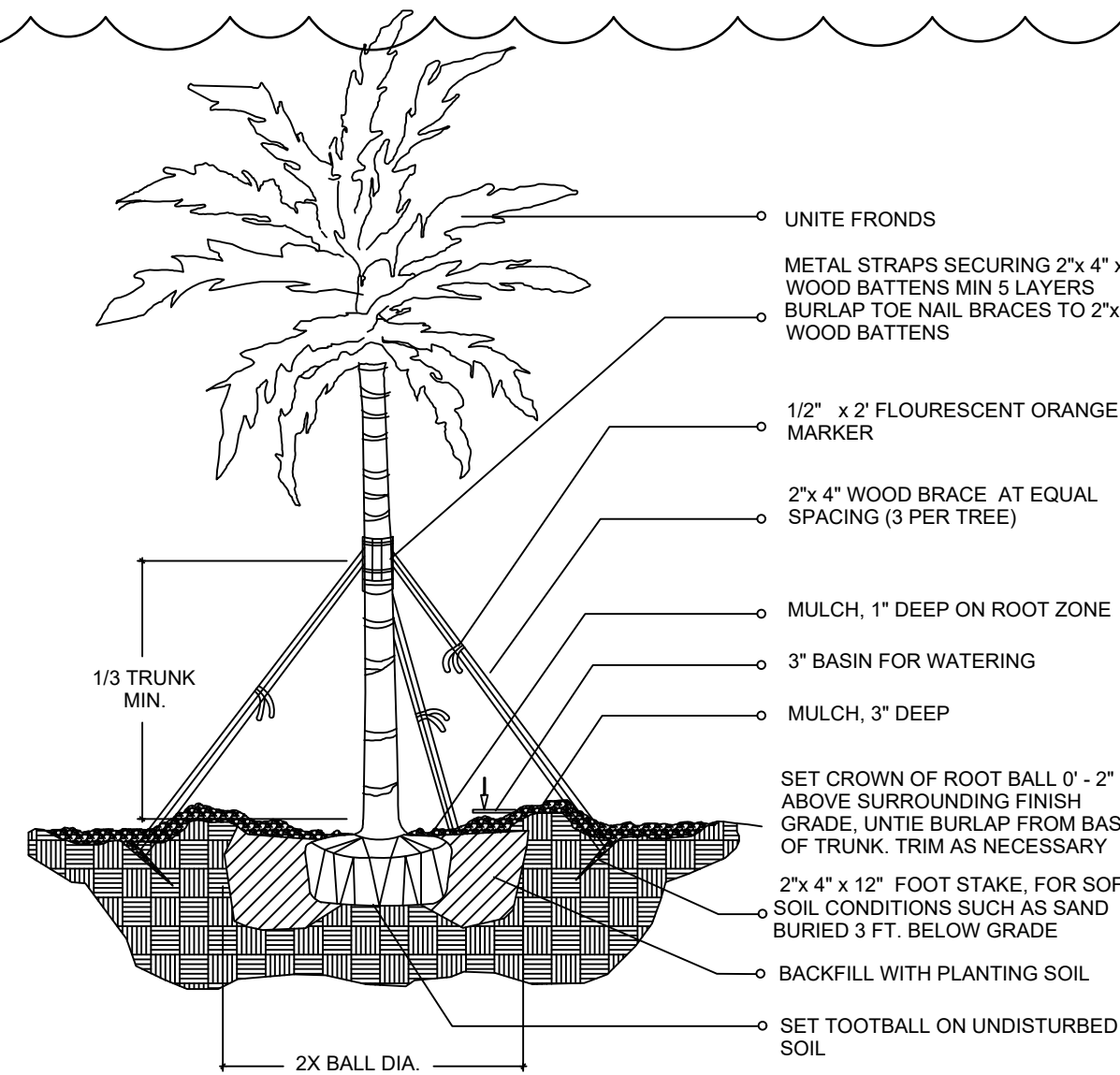

LARGE PALM / PLANTING DETAIL

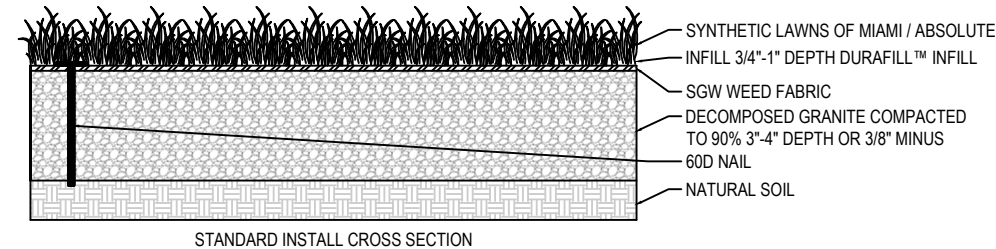

SPECIFICATIONS:
BRAND: LAWNS GUYS MIAMI
MODEL: SUNSET
RECOMMENDED USE: MODERATE TO HEAVY TRAFFIC
YARN COLORS: FELD GREEN / LIME GREEN WITH BROWN THATCH
YARN TYPE: MONOFILAMENT

YARN COMPOSITION: PE WITH THATCH
THATCH COLOR: BROWN
YARN DENIER: 9000 / 5000
FACE WEIGHT: 80 OZ/YD
TOTAL WEIGHT: 107 OZ/YD
PILE HEIGHT: 1 3/4"

GAUGE: 3/8"
ROLL WIDTH: 15'
ROLL LENGTH: 100'
ROLL WEIGHT: 1155 LB
RECOMMENDED INFILL: 1.5 - 2.5 LBS/SF
WEIGHT/SQ.FT: 0.77 LB

- NOTES:**
- Artificial turf shall consist of green lifelike individual blades of grass that emulate natural turf in look and color and shall have a minimum pile height of 1.5 inches and shall have a minimum tufted weight of 56.80 ounces per square yard.
 - Artificial turf installations shall have a minimum permeability of 30 inches per hour per square yard.
 - All artificial turf shall have a minimum eight year manufacturer's warranty that protects against color fading and a decrease in pile height.
 - Artificial turf shall be laid free.
 - Artificial turf shall be flame retardant.
 - Artificial turf shall be manufactured from polyethylene monofilament, Dual Yarn System.
 - All materials must include test documentation which declares that the artificial turf yarn and backing materials are disposable under normal conditions, at any US landfill station (Total Content Leach Protocol (TCLP) test).
 - The use of indoor or outdoor plastic or nylon carpeting as a replacement for artificial turf or natural turf shall be prohibited.
 - Artificial turf shall not be treated as a fill in material, but rather as a planned element of the landscape.

- Installation, maintenance and repair.
- All artificial turf shall, at a minimum, be installed by a licensed professional pursuant to the manufacturer's specifications.
 - All artificial turf installations shall be anchored to ensure that the turf will withstand the effects of wind.
 - All seams shall be joined in a tight and secure manner, nailed or glued, not sewn, and edges shall be trimmed to fit against all regular and irregular edges to resemble a natural look.
 - All artificial turf shall be installed over a subgrade prepared to provide positive drainage and an evenly graded mass of compacted, porous crushed rock aggregate material. Base comprising of sand only is not permitted.
 - Proper drainage shall be provided for all artificial turf installations to prevent excess runoff or pooling of water.
 - An infill medium consisting of clean silica sand or other approved mixture shall be brushed into the fibers to ensure that the fibers remain in an upright position and to provide ballast that will hold the turf in place and provide a cushioning effect. Artificial turf shall be visually level, with the grain pointing in a single direction.
 - An appropriate solid barrier device (e.g., concrete mow strip, border board, aluminum edging other barrier with a minimum 3/8" thickness) is required to separate artificial turf from soil and live vegetation prevent intrusion of living plant material into the artificial turf area.
 - Precautions for installation around existing trees shall be monitored and may be restricted to ensure tree roots are not damaged with the installation of the base material and that the overall health of the tree will not be compromised.
 - All artificial turf shall be maintained in a green fadeless condition and shall be maintained free of dirt, mud, stains, shall include, but not be limited to cleaning, brushing, debris removal, repairing of depressions and ruts to maintain a visually-level surface; elimination of any odors, flat or matted areas, weeds, and invasive roots; and all edges of the artificial turf shall not be loose and must be maintained with appropriate edging or stakes.
 - All artificial turf must be replaced if it falls into disappear with fading or holes or loose areas. Replacement and/or repairs shall be done with like materials from the same manufacturer and done so in a manner that results in a repair that blends in with the existing artificial turf.
 - Made, assembled and warranted in the United States



EXOTICSCAPE & ASSOCIATES LANDSCAPE ARCHITECTURE

181 Harbor Dr. Key Biscayne, Fl, 33149
(305)785-8256
LA Theresa Wymer LA6667363
Mercedes B.Porcari

NEW RESIDENTIAL BUILDING

829 4th St Miami Beach, FL 33139

SHEET TITLE

LANDSCAPE
DETAILS

SCALE

1 / 8" = 1" - 0

ISSUE DATE

01/04/2023

REVISION

02/06/2023

DESIGN

MERCEDES PORCARI

DRAWN

ROBERTO CR

SEAL

THERESA WYMER
LA6667363

SHEET NUMBER

LA.03



EXOTICSCAPE & ASSOCIATES
LANDSCAPE ARCHITECTURE

181 Harbor Dr. Key Biscayne, FL, 33149
(305)785-8256
LA Theresa Wymer LA6667363
Mercedes B.Porcari

NEW RESIDENTIAL BUILDING

829 4th St Miami Beach, FL 33139

SHEET TITLE

**LANDSCAPE
ELEVATIONS**

SCALE

1 / 8" = 1" - 0

ISSUE DATE

01/04/2023

REVISION

DESIGN

MERCEDES PORCARI

DRAWN

ROBERTO CR

SEAL

THERESA WYMER
LA6667363

SHEET NUMBER

LA.04