

ARCHITEKNICS
ARCHITECTS & PLANNERS

7450 Southwest 48th Street
Miami, Florida 33155
Phone (305) 661-5392
Fax (305) 661-5832
info@architeknics.com
License # AAC000546

www.architeknics.com

Project:
NEW RESTROOM / CONCESSION FACILITY
NORTH SHORE PARK
501 72nd STREET
MIAMI BEACH, FLORIDA

MIAMI BEACH

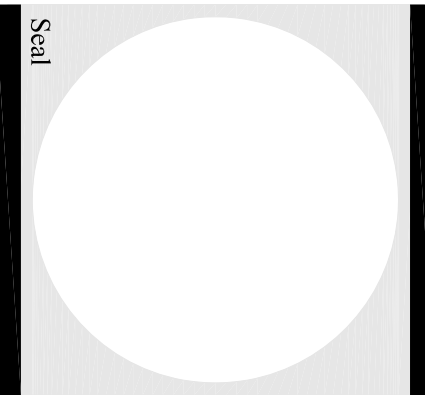

Edward C. Bromusky, RA,
License Number: AB000433

Drawing title:

FINAL
SUBMITTAL

SITE PLAN

Issue Date: 09/26/16
Revisions:

Job No.:	15114
Drawn By:	
Sheet No.:	

A-1.1

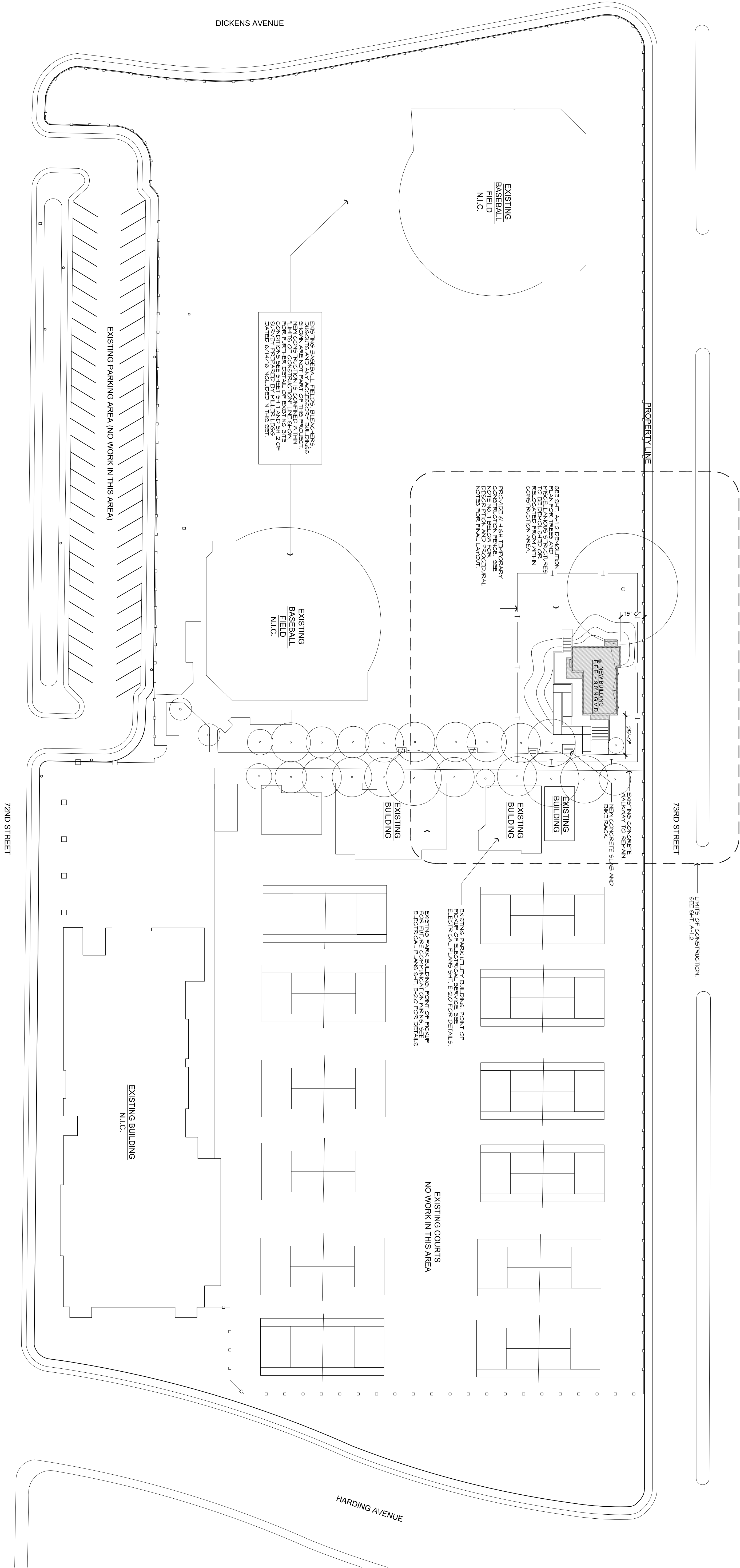

PROPERTY ADDRESS	LEGAL DESCRIPTION	SITE NOTES
NORTH SHORE PARK 501 72 STREET (7251 COLLING AVE) FOLIO NUMBER: 02-3202-000-0020	A PORTION OF LOT 8, WHICH WAS RESERVED FOR COAST GUARD PURPOSES BY THE PRESIDENT OF THE UNITED STATES BY PROCLAMATION NO. 1584 OF MARCH 11, 1921, CONTAINING 21 ACRES MORE OR LESS, AND WHICH COULD BE USED FOR ANY PURPOSES, EXCEPTED TO TOWNSHIP 33 SOUTH, RANGE 43 EAST, TALLAHASSEE MERIDIAN, FLORIDA, EXCEPTING THAT PORTION OF LOT 8 GRANTED TO THE CITY OF MIAMI BEACH, FLORIDA, BY THE UNITED STATES BY QUILCIAN DEED DATED JUNE 16, 1931, RECORDED IN BOOK 1821 OF DEEDS AT PAGE 46 OF THE LATER RECORDS OF DADE COUNTY, FLORIDA, BUT INCLUDING THE PORTION OF LOT 8 RESERVED FOR THE CITY OF MIAMI BEACH BY SUCH DEED.	1. CONTRACTOR TO PROVIDE TEMPORARY CONSTRUCTION FENCE 6'-0" HIGH WITH DUST AND VIBR BLOCKER SCREENING. LOCATION IS SHOWN APPROXIMATE FOR REFERENCE ON THIS SHEET. CONTRACTOR IS TO MEET ON SITE WITH MIAMI BEACH PARK REPRESENTATIVES PROJECT MANAGER AND ARCHITECT TO REVIEW AND APPROVE THE PROPOSED TEMPORARY FENCE LAYOUT AND DETERMINE FINAL TEMPORARY FENCE LAYOUT. 2. CONTRACTOR TO KEEP ALL AREAS OUTSIDE OF TEMPORARY FENCE FREE OF MATERIALS, EQUIPMENT AND FREE OF DEBRIS AT ALL TIMES. 3. CONTRACTOR TO REPLACE AND RESTORE AS NEEDED ALL SOD IN STAGING AREA AND ALL AREAS THAT ARE DAMAGED BY CONSTRUCTION WORK. 4. CONTRACTOR IS TO PROTECT ALL TREES AND LANDSCAPING AND LANDSCAPE TO REMAIN (SEE SITE PLAN) AND THROUGHOUT THE SITE NOT SLATED TO BE REMOVED OR RELOCATED BY MEANS OF TEMPORARY BARRIERS, ANY TREES AND/OR LANDSCAPE DAMAGED BY CONTRACTOR AND/OR SUBCONTRACTOR MUST BE REPLACED BY CONTRACTOR WITH SAME TYPE AND SIZE AT NO ADDITIONAL COST TO THE OWNER.
SITE LEGEND	EXISTING BUILDINGS NEW BUILDING TEMPORARY FENCE EXISTING TREES TO REMAIN EXISTING TREES TO BE REMOVED	1. CONTRACTOR SHALL PROVIDE ALL NECESSARY SAFEGUARDS INCLUDING SIGNAGE AT APPROACHES TO CONSTRUCTION AREA PROVIDING LIMITED ACCESS WHERE REQUIRED DURING WORKING HOURS SO THAT PUBLIC IS PROTECTED AND SAFEGUARDED AT ALL TIMES. 2. GENERAL CONTRACTOR SHALL VISIT THE SITE TO DETERMINE THE EXTENT OF WORK TO BE REMOVED, REPLACED OR ALTERED PRIOR TO SUBMITTING BIDS, AND SHALL NOTIFY THE ARCHITECT OF ANY DISCREPANCIES AND/OR OMISSIONS WHICH WOULD INTERFERE WITH THE SATISFACTORY COMPLETION OF THE WORK. 3. CONTRACTOR IS TO FILL, COVER OR BARRICADE AND CLEARLY MARK ALL OPEN TRENCHES NIGHTLY FOR THE PROTECTION AND SAFETY OF THE PUBLIC. 4. GENERAL CONTRACTOR IS TO FINISH AND BRACE A TEMPORARY JOB SIGN AS REQUIRED BY MIAMI BEACH CAPITAL IMPROVEMENTS PROGRAM OFFICE. CONTRACTOR IS TO COORDINATE WITH C.I.P. FOR ALL PERTINENT INFORMATION REQUIRED, SIGN SIZE AND STANDARDS. 5. CONTRACTOR TO VERIFY, IN WRITING, THE CONDITION OF ADJACENT IRRIGATION SYSTEM & HEADS, RE-ROUTE EXISTING IRRIGATION FOUND BENEATH NEW BUILDING AREA, MODIFY EXISTING IRRIGATION TO ACCOMMODATE FOOTINGS AND NEW BUILDING STRUCTURE/FOUNDATIONS AND VALUANTS. 6. CONTRACTOR TO VERIFY, IN WRITING, THE CONDITION OF ADJACENT IRRIGATION SYSTEM & HEADS, RE-ROUTE EXISTING IRRIGATION FOUND BENEATH NEW BUILDING AREA, MODIFY EXISTING IRRIGATION TO ACCOMMODATE FOOTINGS AND NEW BUILDING STRUCTURE/FOUNDATIONS AND VALUANTS.
STATEMENT OF COMPLIANCE	TO THE BEST OF MY KNOWLEDGE THESE DRAWINGS ARE IN COMPLETE COMPLIANCE WITH THE FLORIDA BUILDING CODE, 2014 (5TH EDITION)	13. CONTRACTOR TO DOCUMENT EXISTING CONDITIONS OF SITE/AREAS BEFORE CONSTRUCTION ALL EXISTING ADJACENT SIDEWALKS TO BE PROTECTED DURING CONSTRUCTION. 14. AT COMPLETION OF THE WORK, CONTRACTOR IS TO REMOVE ALL EQUIPMENT AND TEMPORARY FACILITIES / BARRIERS & FENCES AND REPLACE ALL SOD AND TOPSOIL IN STAGING AREA (GRADE SURFACE PRIOR TO INSTALLING SOD / TOPSOIL).

SITE PLAN - NEW OVERALL AND PROJECT LOCATION
SCALE: 1/32" = 1'-0"