



C.M.B. HPB LANDSCAPE FINAL SUBMITTAL 09.06.22
 NEW RESIDENCE | 803 2ND STREET | MIAMI BEACH, FLORIDA

CLIENT / PROPERTY INFORMATION

PROPERTY ADDRESS
 803 2ND STREET
 MIAMI BEACH, FL 33139

EXISTING VEGETATION SUMMARY

The existing vegetation located on the property is composed mostly of palms and two canopy trees in the R.O.W. Please note that the landscape architect is proposing to preserve + protect the large Calophyllum tree on Meridian Ave. In addition the landscape architect is proposing to preserve the bridal veil and two palms in the ROW and requesting to remove the remaining vegetation of small palms on site. Please note that the landscape architect intends to provide an improved landscape design that shall mitigate for the palm loss by introducing new native trees to the site and meet all landscape requirements set forth by C.M.B. Chapter 126.

SCOPE OF WORK

- New landscape design to complement new Residence

INDEX OF SHEETS

- L0.00 Landscape Cover + Sheet Index
- L1.00 Landscape Plan
- L2.00 Plant List, Landscape Code + Details
- L3.00 Existing Tree Survey + Disposition Plan
- L3.01 Existing Tree Chart + Mitigation Summary

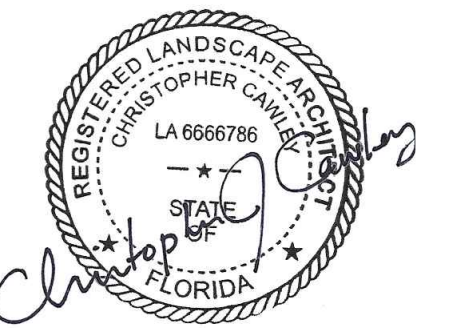

CHRISTOPHER CAWLEY, RLA
 Florida License LA 6666786

JENNIFER MCCONNEY FLORIDA LIC# AR93044
 ALL DRAWINGS AND WRITTEN MATERIAL APPEARING
 HEREIN CONSTITUTE THE ORIGINAL AND UNPUBLISHED
 WORK OF STUDIO MCG ARCHITECTURE, INC. AND MAY
 NOT BE DUPLICATED, USED OR DISCLOSED WITHOUT
 THE EXPRESS WRITTEN CONSENT OF STUDIO MCG
 ARCHITECTURE, INC. © 2022

SCALE:
 CHECK: JMcG
 DATE: 08/15/2022
 SHEET NUMBER

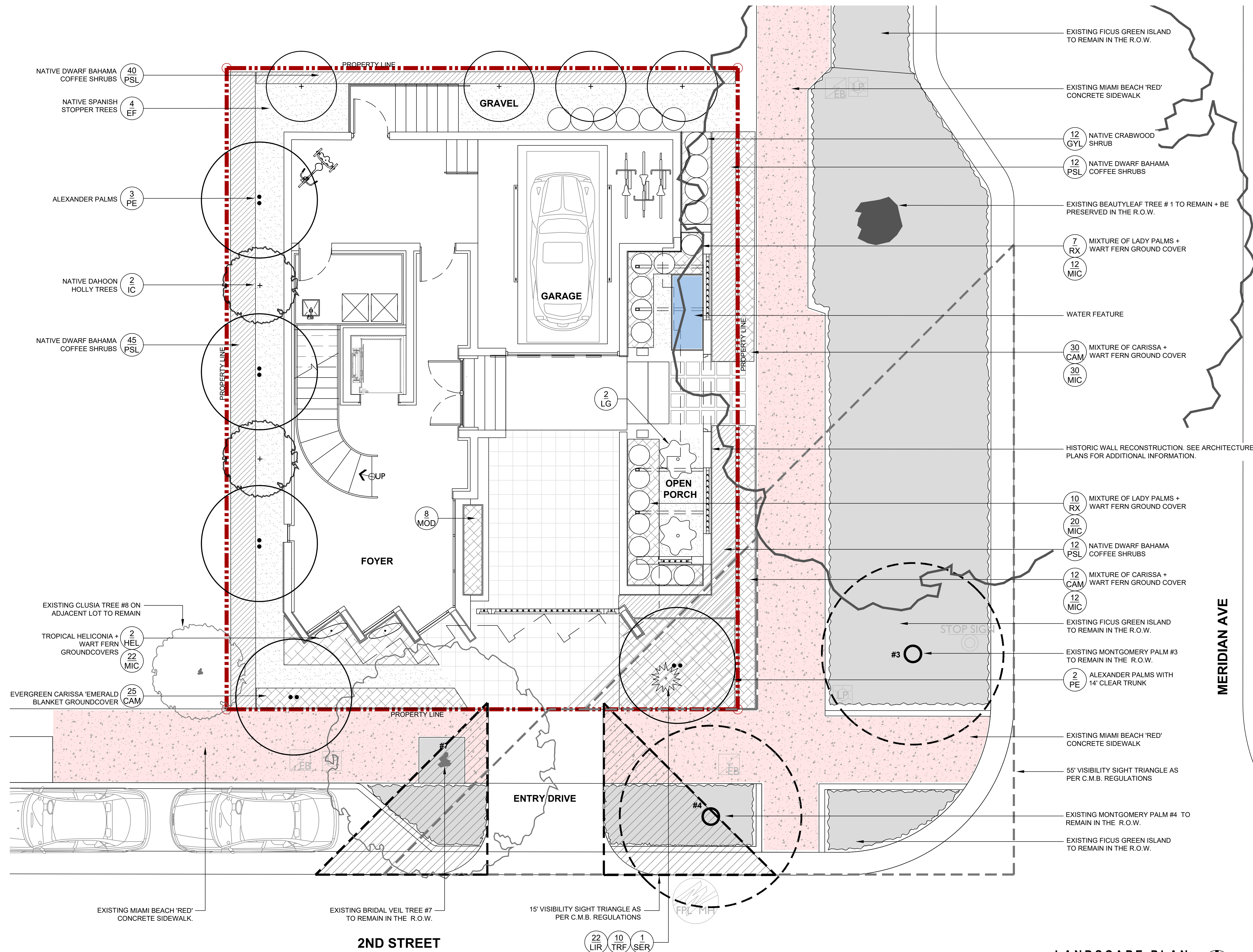

MERIDIAN AVE

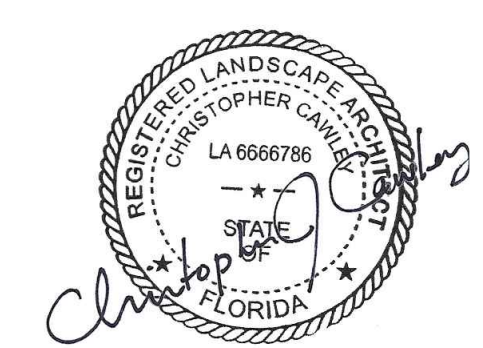

CHRISTOPHER CAWLEY, R.L.A.
Florida License LA 666786

JENNIFER MCCONNEY FLORIDA LIC# AR93044
ALL DRAWINGS AND WRITTEN MATERIAL APPEARING
HEREIN CONSTITUTE THE ORIGINAL AND UNPUBLISHED
WORK OF STUDIO MCG ARCHITECTURE, INC. AND MAY
NOT BE REPRODUCED, COPIED, OR DISCLOSED WITHOUT
THE EXPRESS WRITTEN CONSENT OF STUDIO MCG
ARCHITECTURE, INC. (03/2022)

SCALE:
CHECK: JMcG
DATE: 08/15/2022
SHEET NUMBER

LANDSCAPE PLAN
1/4" = 1'-0"
0' 4' 8' 12'

**CHRISTOPHER
CAWLEY
LANDSCAPE
ARCHITECTURE**
7500 NE 4th Court, Suite 102 Miami, Florida 33138
P 786.538.2961 M 305.979.1585
CHRISTOPHERCAWLEY.COM | LC 20000460

L1.00

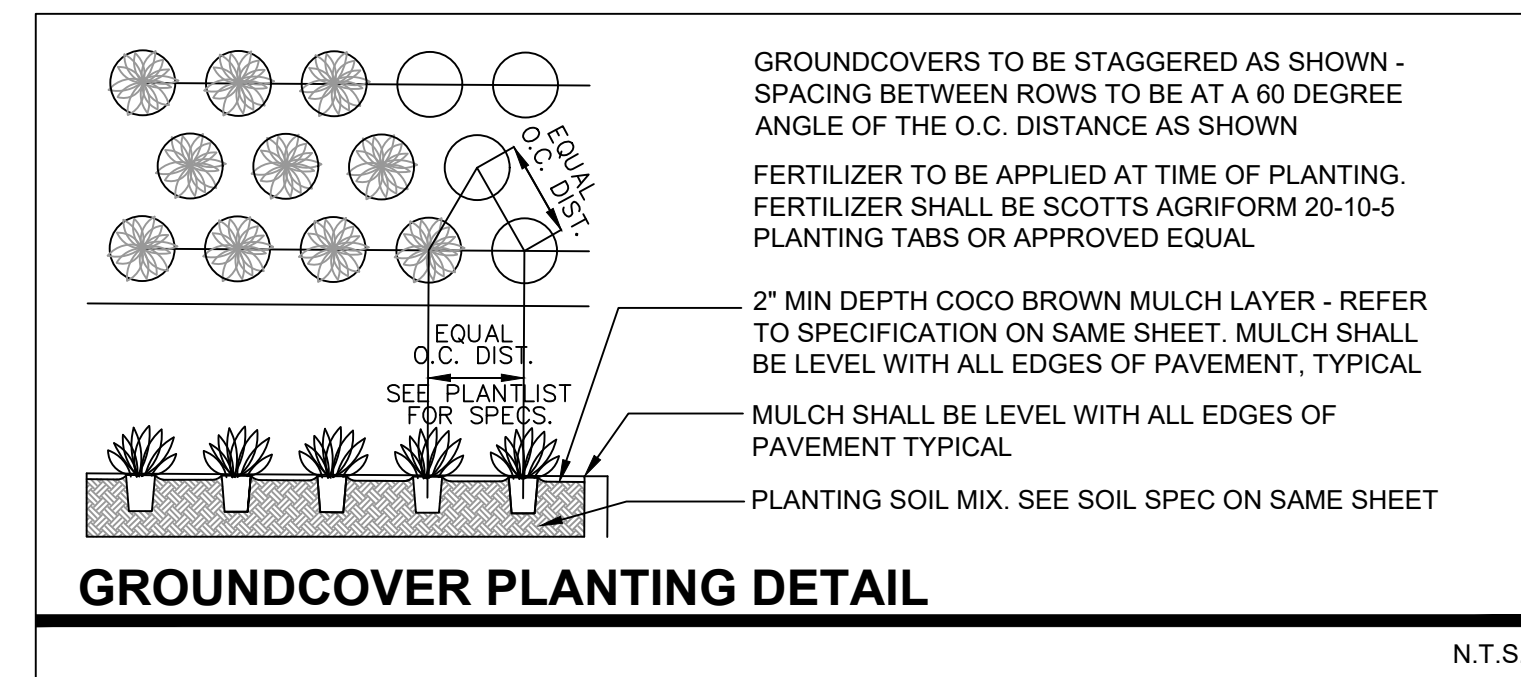
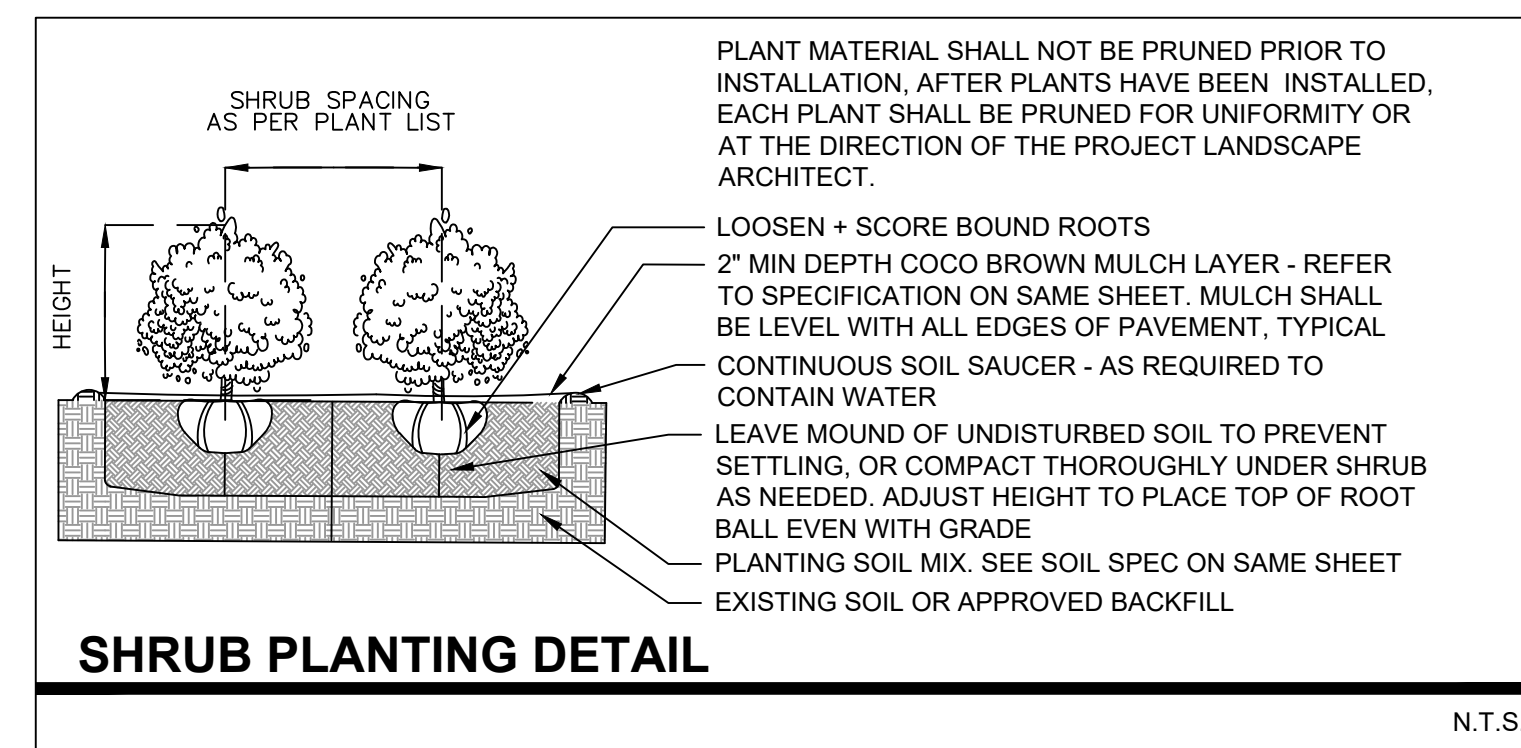
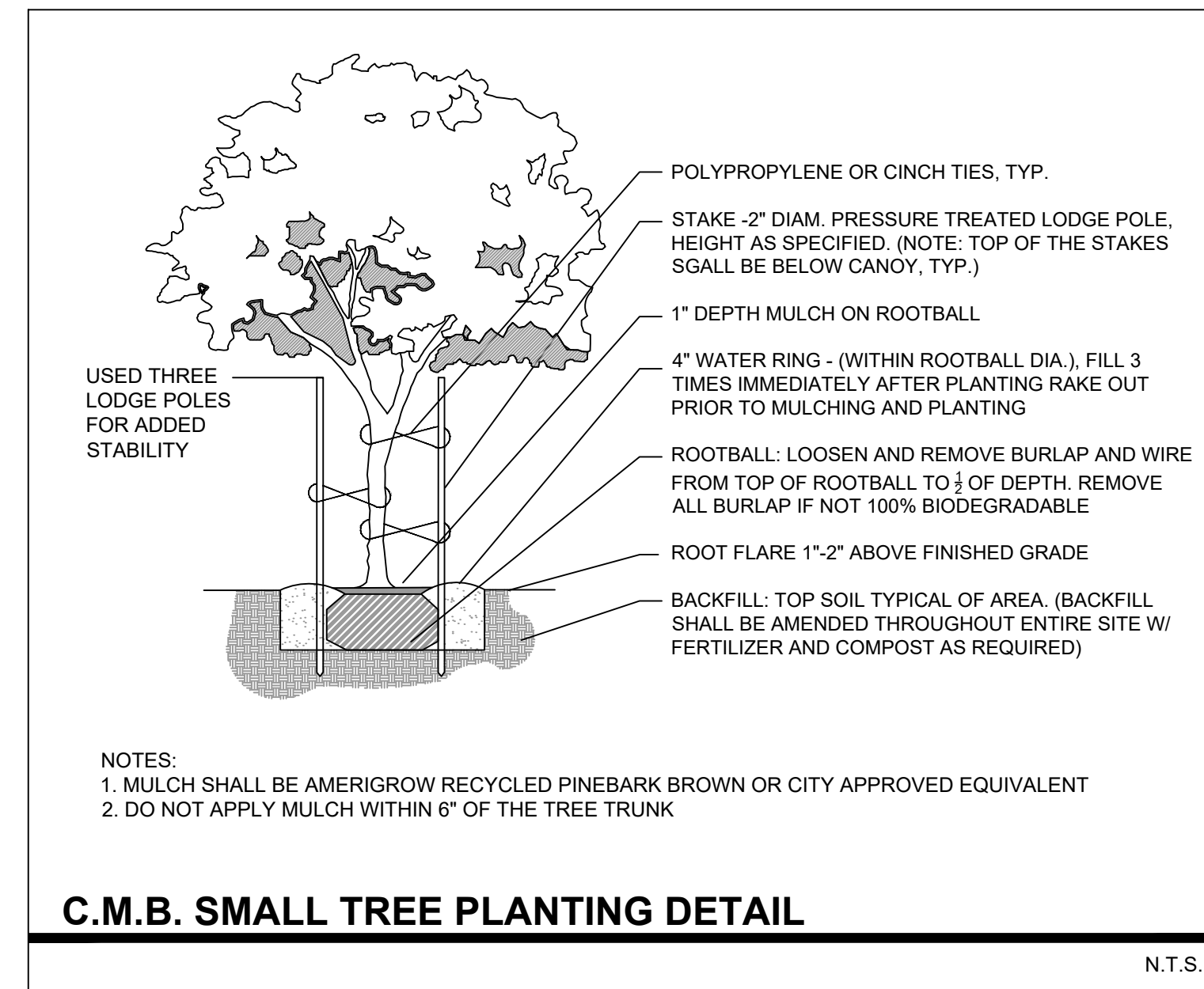
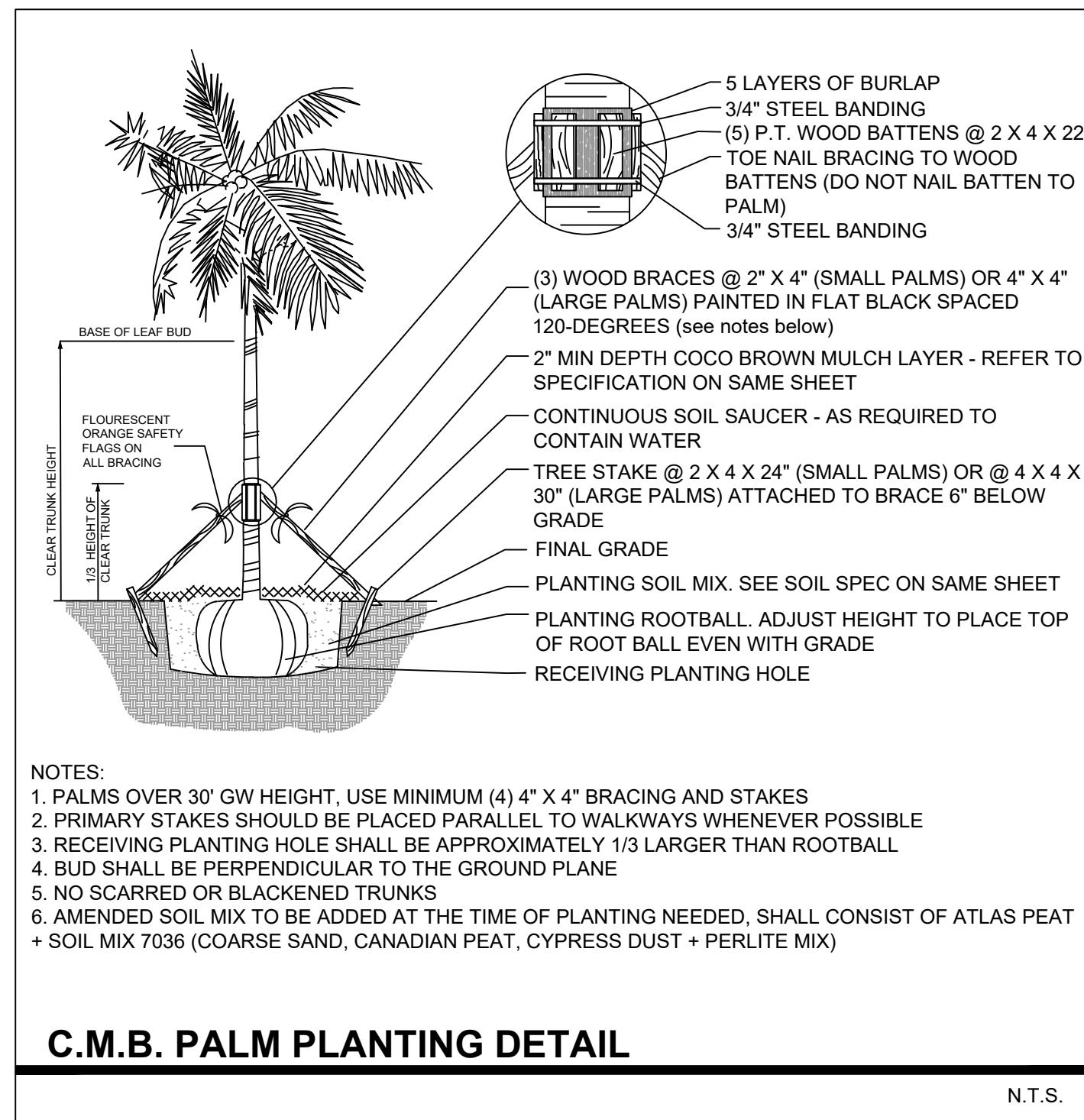
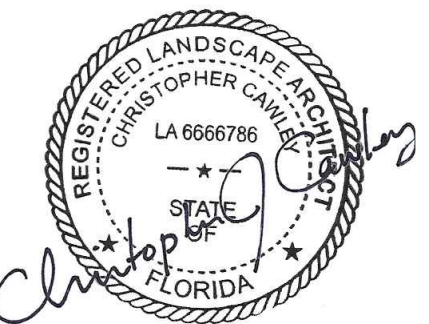

PLANT LIST - 803 2ND STREET					
KEY	QTY.	NATIVE	COMMON NAME	BOTANICAL NAME	HEIGHT, SPECIFICATION, & NOTES
TREES					
EF	4	YES	SPANISH STOPPER TREE	Eugenia foetida	12' ht min, 6' spread min, 2" dbh, standard trunk, equal to Treeworld Wholesale
IC	2	YES	DAHOON HOLLY	Ilex cassine	65 gallon, 13' height min, 5' spread min, 2" dbh, 4' clear trunk
PALMS					
PE	5	NO	ALEXANDER PALM	Ptychosperma elegans	10-14' gray wood, Florida Fancy, double trunk
LG	2	NO	LICUALA PALM	Licuala grandis	15 gallon, 5' height, full + shade grown
RX	17	NO	LADY PALM	Rhapis excelsa	7 gallon, 3' - 4' height, full + shade grown
SHRUBS					
CAC	ALT	YES	JAMAICAN CAPER	Capparis cynophallophora	7 gallon, full, 18" on center
GYL	12	YES	CRABWOOD	Gymnanthes lucida	15 gallon, 5' height, 2' spread, 30" on center
PSL	110	YES	DWARF BAHAMA COFFEE	Psychotria ligustrifolia	7 gallon, 2' height, 30" spread
GROUNDCOVERS					
CAM	50	NO	CARISSA 'EMERALD BLANKET'	Carissa macrocarpa	3 gallon, 12" on center, full
HEL	2	NO	HELICONIA 'LOBSTER CLAW'	Heliconia rostrata	15 gallon, 5' - 6' height, full
LIR	22	NO	LILYTURF	Liriope muscari	3 gallon, 12" on center, full
MIC	--	NO	WART FERN	Microsorium scolopendrium	3 gallon, 18" on center, full
MOD	8	NO	SWISS CHEESE PLANT	Monstera deliciosa	7 gallon, 3' - 4' height, full + shade grown
SER	1	YES	SILVER SAW PALMETTO	Serenoa repens 'Georgia Silver'	7 gallon, 3' height x 4' width, full
TRF	10	YES	DWARF FAKAHATCHEE	Tripsacum floridana	3 gallon, 18" on center, full
CONTRACTOR TO PROVIDE IMAGES OF ALL MAJOR PLANT MATERIAL TO LANDSCAPE ARCHITECT AND OWNER FOR APPROVAL BEFORE PURCHASE + INSTALLATION. LANDSCAPE CONTRACTOR TO MEET WITH LANDSCAPE ARCHITECT AND OWNER ON SITE TO REVIEW THE PROPOSED DESIGN PRIOR TO SUBMITTING A BID FOR THE PROJECT. THE LANDSCAPE CONTRACTOR IS TO PROVIDE AN ADDITIONAL ALLOWANCE OF \$15,000 DOLLARS FOR POTTED PLANTS + MISCELLANEOUS VEGETATION TO BE SELECTED DURING THE INSTALLATION OF THE PROJECT					

LANDSCAPE LEGEND		
MIAMI BEACH LANDSCAPE ORDINANCE CHAPTER 126 (RS1 - RS4 Single Family Home Residential)		
ZONING:	R-PS2	LOT SIZE: 2,499 SF ACRES: .06
MINIMUM STANDARDS	REQUIRED	PROVIDED
TREES		
22 TREES PER NET ACRE LOT	22 TREES X .06 ACRES = 1.32 TOTAL TREES REQUIRED	6 TOTAL TREES PROVIDED
MIN 30% OF REQUIRED TREES SHALL BE NATIVE SPECIES	30% x 2 = 0.6 TREES OF NATIVE SPECIES REQUIRED	6 TOTAL NATIVE TREES PROVIDED
MIN 50% OF REQUIRED TREES SHALL BE LOW MAINTENANCE AND DROUGHT TOLERANT SPECIES	50% x 2 = 1 TREES OF LOW MAINTENANCE + DROUGHT TOLERANT SPECIES REQUIRED	6 TOTAL LOW MAINTENANCE TREES PROVIDED
DIVERSITY OF 11 - 15 TOTAL TREES REQUIRED : 4 TREE SPECIES	2 TREE SPECIES REQUIRED	2 TREE SPECIES PROVIDED
STREET TREES		
AVERAGE STREET TREE SPACING 20' ON CENTER	2ND STREET 44 LINEAR FEET / 20 = 3 STREET TREES REQUIRED	3 STREET TREES PROVIDED
	MERIDIAN AVE 56 LINEAR FEET / 20 = 3 STREET TREES REQUIRED	3 STREET TREES PROVIDED
SHRUBS		
12 SHRUBS PER THE NUMBER OF REQUIRED LOT AND STREET TREES	12 x (TOTAL LOT + STREET TREES) = 96 TOTAL SHRUBS REQUIRED	122 TOTAL SHRUBS PROVIDED
MIN 50% OF REQUIRED SHRUBS SHALL BE NATIVE SPECIES	50% x 96 = 48 SHRUBS OF NATIVE SPECIES REQUIRED	122 TOTAL NATIVE SHRUBS PROVIDED
MIN 10% OF REQUIRED SHRUBS SHALL BE LARGE SHRUBS OR SMALL TREES	10% x 96 = 10 TOTAL LARGE SHRUBS REQUIRED	12 TOTAL LARGE SHRUBS PROVIDED
MIN 50% OF REQUIRED LARGE SHRUBS SHALL BE NATIVE SPECIES	50% x 10 = 5 LARGE SHRUBS OF NATIVE SPECIES	12 TOTAL NATIVE LARGE SHRUBS
LAWN		
LAWN SHALL BE MAXIMUM OF 50 % OF REQUIRED LANDSCAPE AREA	LAWN AREAS ARE LESS THAN 50% OF LANDSCAPE AREA	
IRRIGATION SYSTEM		
LANDSCAPE SHALL BE WATERED BY A PERMANENT IRRIGATION SYSTEM		100% IRRIGATION COVERAGE PROVIDED

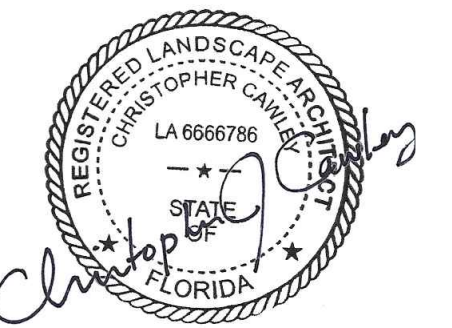

CHRISTOPHER CAWLEY, RLA
Florida License LA 6666786

JENNIFER MCCONNEY FLORIDA LIC# AR93044
ALL DRAWINGS AND WRITTEN MATERIAL APPEARING
HEREIN CONSTITUTE THE ORIGINAL AND UNPUBLISHED
WORK OF STUDIO MCG ARCHITECTURE, INC. AND MAY
NOT BE DUPLICATED, USED OR DISCLOSED WITHOUT
THE EXPRESS WRITTEN CONSENT OF STUDIO MCG
ARCHITECTURE, INC. (03/2022)

SCALE:
CHECK: JMcG
DATE: 08/15/2022
SHEET NUMBER

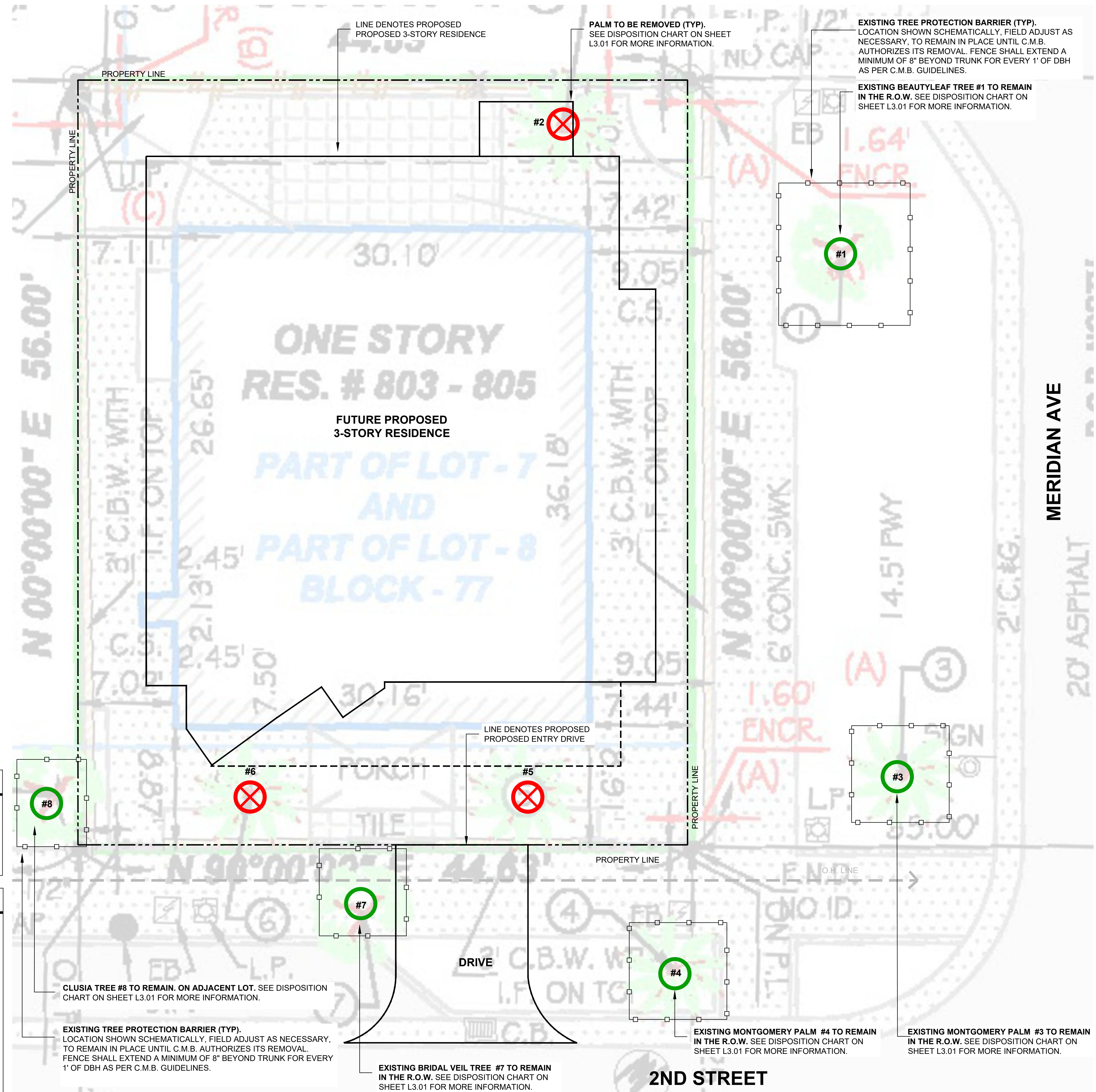

C.M.B. EXISTING TREE SURVEY LEGEND

	TREE or PALM TO BE REMOVED. SEE CHART L3.01.
	TREE or PALM TO REMAIN. PRESERVE + PROTECT
	TREE or PALM PROTECTION FENCE

C.M.B. CHAPTER 46, DIVISION 2 - TREE INVENTORY + DISPOSITION PLAN NOTES

1. THIS 'EXISTING TREE INVENTORY + DISPOSITION PLAN' HAS BEEN PREPARED IN ACCORDANCE WITH THE CITY OF MIAMI BEACH, CHAPTER 46 - ENVIRONMENT, DIVISION 2, TREE PRESERVATION and PROTECTION ORDINANCE.
2. EXISTING TREE, PALM, AND VEGETATION INFORMATION AS INDICATED HAS BEEN PREPARED AS AN OVERLAY ON THE SURVEY PREPARED BY JOHN IBARRA & ASSOCIATES, INC. DATED 03.23.21
3. THE INFORMATION AS PRESENTED HEREIN HAS BEEN FIELD VERIFIED BY THE LANDSCAPE ARCHITECT ON 04.16.22
4. MIAMI BEACH P+Z MUST APPROVE LANDSCAPE PLANS PRIOR TO REMOVING ANY TREES OR PALMS WITH A DBH BETWEEN 6" AND 12" INCHES. A WRITTEN TREE REMOVAL PERMIT IS REQUIRED FROM CITY OF MIAMI BEACH GREENSPACE MANAGEMENT / P.W FOR THE REMOVAL OF TREES / PALMS WITH A DBH GREATER THAN 12" INCHES OR IN THE R.O.W.
5. THE OWNER RESERVES THE RIGHT TO REMOVE ANY VEGETATION NOT LOCATED WITHIN THE CITY R.O.W. w/ a D.B.H. OF LESS THAN 6" WITHOUT OBTAINING A TREE REMOVAL PERMIT.
6. THERE ARE NO TREES or PALMS LOCATED ON THIS PROPERTY THAT WILL REQUIRE TEMPORARY IRRIGATION. ALL EXISTING TREES + PALMS ARE MATURE AND ARE CURRENTLY THRIVING WITHOUT SUPPLEMENTAL IRRIGATION WATER.

CLUSIA TREE #8 TO REMAIN. ON ADJACENT LOT. SEE DISPOSITION CHART ON SHEET L3.01 FOR MORE INFORMATION.

EXISTING TREE PROTECTION BARRIER (TYP). LOCATION SHOWN SCHEMATICALLY. FIELD ADJUST AS NECESSARY. TO REMAIN IN PLACE UNTIL C.M.B. AUTHORIZES ITS REMOVAL. FENCE SHALL EXTEND A MINIMUM OF 8" BEYOND TRUNK FOR EVERY 1' OF DBH AS PER C.M.B. GUIDELINES.

EXISTING BRIDAL VEIL TREE #7 TO REMAIN IN THE R.O.W. SEE DISPOSITION CHART ON SHEET L3.01 FOR MORE INFORMATION.

EXISTING MONTGOMERY PALM #4 TO REMAIN IN THE R.O.W. SEE DISPOSITION CHART ON SHEET L3.01 FOR MORE INFORMATION.

EXISTING MONTGOMERY PALM #3 TO REMAIN IN THE R.O.W. SEE DISPOSITION CHART ON SHEET L3.01 FOR MORE INFORMATION.

PALM TO BE REMOVED (TYP). SEE DISPOSITION CHART ON SHEET L3.01 FOR MORE INFORMATION.

EXISTING TREE PROTECTION BARRIER (TYP). LOCATION SHOWN SCHEMATICALLY. FIELD ADJUST AS NECESSARY. TO REMAIN IN PLACE UNTIL C.M.B. AUTHORIZES ITS REMOVAL. FENCE SHALL EXTEND A MINIMUM OF 8" BEYOND TRUNK FOR EVERY 1' OF DBH AS PER C.M.B. GUIDELINES.

EXISTING BEAUTYLEAF TREE #1 TO REMAIN IN THE R.O.W. SEE DISPOSITION CHART ON SHEET L3.01 FOR MORE INFORMATION.

EXISTING TREE SURVEY + DISPOSITION PLAN

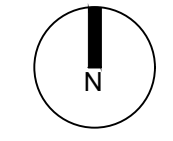

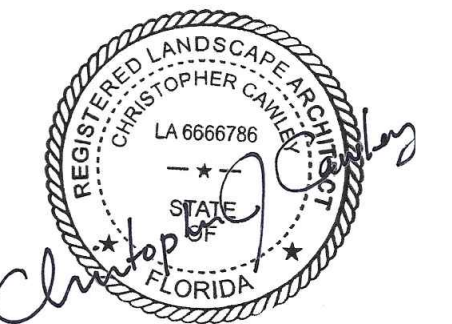

CHRISTOPHER CAWLEY, RLA
Florida License LA 6666786

JENNIFER MCCONNEY FLORIDA LIC# AR93044
ALL DRAWINGS AND WRITTEN MATERIAL APPEARING
HEREIN CONSTITUTE THE ORIGINAL AND UNPUBLISHED
WORK OF STUDIO MCG ARCHITECTURE, INC. AND MAY
NOT BE DUPLICATED, USED OR DISCLOSED WITHOUT
THE EXPRESS WRITTEN CONSENT OF STUDIO MCG
ARCHITECTURE, INC. 03/2022

SCALE:
CHECK: JMcG
DATE: 08/15/2022
SHEET NUMBER

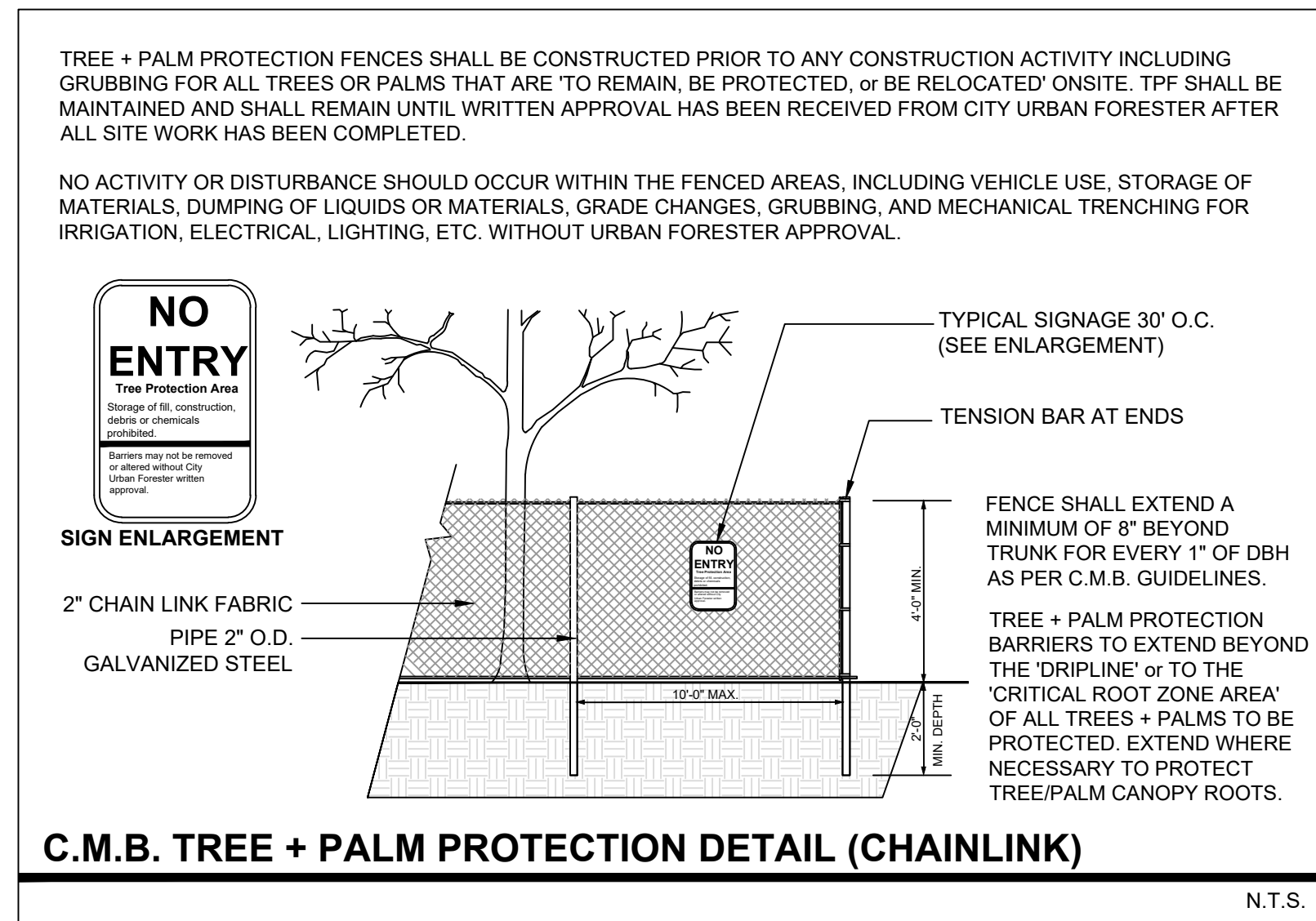

C.M.B. EXISTING TREE INVENTORY + DISPOSITION CHART - 803 2ND STREET

NUMBER	COMMON NAME	BOTANICAL NAME	SPECIMEN	D.B.H. (IN)	HEIGHT (FT)	SPREAD (FT)	CONDITION	DISPOSITION	MITIGATION	COMMENTS
#1	BEAUTYLEAF TREE	Calophyllum antillarum	YES	+/- 50"	+/- 45'	+/- 65'	FAIR	REMAIN	N/A	PRESERVE + PROTECT DURING CONSTRUCTION
#2	CHRISTMAS PALM	Veitchia merillii	NO	+/- 30"	+/- 25'	+/- 20'	FAIR	REMOVE	1 REP. TREE	IN CONFLICT WITH SITE DESIGN. MITIGATION PROVIDED
#3	MONTGOMERY PALM	Veitchia arecina	NO	+/- 8"	+/- 40'	+/- 20'	FAIR	REMAIN	N/A	PRESERVE + PROTECT DURING CONSTRUCTION
#4	MONTGOMERY PALM	Veitchia arecina	NO	+/- 7"	+/- 25'	+/- 15'	FAIR	REMAIN	N/A	PRESERVE + PROTECT DURING CONSTRUCTION
#5	COCONUT PALM	Cocos nucifera	NO	+/- 8"	+/- 40'	+/- 15'	FAIR	REMOVE	1 REP. TREE	IN CONFLICT WITH SITE DESIGN. MITIGATION PROVIDED
#6	COCONUT PALM	Cocos nucifera	NO	+/- 7"	+/- 40'	+/- 15'	FAIR	REMOVE	1 REP. TREE	IN CONFLICT WITH SITE DESIGN. MITIGATION PROVIDED
#7	BRIDAL VEIL	Caesalpinia granadillo	NO	+/- 15"	+/- 25'	+/- 30'	FAIR	REMAIN	N/A	PRESERVE + PROTECT DURING CONSTRUCTION
#8	PITCH APPLE	Clusia rosea	NO	+/- 7"	+/- 15'	+/- 8'	FAIR	REMAIN	N/A	NOT LOCATED ON SITE. PRESERVE + PROTECT

TOTAL PALM LOSS: REMOVAL OF (3) PALMS
PALM MITIGATION REQUIRED: (3) REPLACEMENT TREES @ 12'HT x 2" DBH X 6' SPREAD

CH 46 TREE PRESERVATION + PROTECTION / TREE + PALM MITIGATION SUMMARY

MIAMI BEACH LANDSCAPE ORDINANCE CHAPTER 46 ENVIRONMENT

PALMS		
REMOVED (TOTAL PALMS)	REPLACEMENT TREES REQUIRED	REPLACEMENT TREES PROVIDED
3	3 @ 12' HEIGHT + 2" DBH + 6' SPREAD OR 2 @ 16' HEIGHT + 4" DBH + 8' SPREAD	6 REPLACEMENT TREES PROVIDED @ 12' HEIGHT + 2" DBH + 6' SPREAD BREAKDOWN: (4) NATIVE SPANISH STOPPER TREES @ 12' HEIGHT + 2" DBH + 6' SPREAD = 4 REPLACEMENT TREES (2) NATIVE DAHOONY LILLY TREES @ 12' HEIGHT + 2" DBH + 6' SPREAD = 2 REPLACEMENT TREES

TREE DISPOSITION SUMMARY

	TOTAL	REMAIN	REMOVE	RELOCATE
TREES	3	3	0	0
PALMS	5	2	3	0

EXISTING TREE CHART + MITIGATION SUMMARY