

**TREES & PLANTING TO BE PRESERVED NOTES**

- EXISTING TREES TO BE PRESERVED SHALL BEAR SAME RELATIONSHIP TO FINISHED GRADE AS THEY BEAR TO PRE-CONSTRUCTION GRADE.
- EXISTING TREES TO BE PRESERVED SHALL BE PROTECTED WITH STURDY, WEATHERPROOF FENCING AT A MINIMUM FOUR (4) FEET HEIGHT INSTALLED PER DETAIL 1/ TD101. THIS FENCE SHALL BE MAINTAINED IN WORKING ORDER DURING ALL PHASES OF CONSTRUCTION. MAINTAIN TREE PROTECTION ZONES FREE OF WEEDS AND TRASH.
- NO WORK SHALL BE CONDUCTED WITHIN THE DRIPLINE, UNLESS REVIEWED AND APPROVED BY THE LANDSCAPE ARCHITECT. ALL WORK APPROVED WITHIN THE DRIPLINE SHALL BE COMPLETED BY HAND. PROTECT ROOT SYSTEMS FROM PONDING, ERODING, OR EXCESSIVE WETTING.
- THE PROJECT LIMIT OF CONSTRUCTION AND ALL EXISTING UNDERSTORY VEGETATION TO REMAIN IS TO BE CLEARLY DEFINED BY STURDY, WEATHERPROOF FENCING AT A MINIMUM OF FOUR (4) FEET HIGH.

**TREES & PLANTING TO BE RELOCATED NOTES**

- THE CONTRACTOR IS TO ROOT PRUNE ALL PLANT MATERIAL 90 DAYS MINIMUM IN ADVANCE OF MOVING PLANT MATERIAL.
- THE CONTRACTOR IS TO WARRANTY ALL RELOCATED PLANT MATERIAL.
- THE CONTRACTOR IS RESPONSIBLE FOR THE WATERING AND FERTILIZING OF ALL PLANT RELOCATED PLANT MATERIAL UNTIL PROJECT COMPLETION.
- ALL RELOCATED PLANT MATERIAL IS TO BE APPROPRIATELY BRACED.
- CONTRACTOR TO NOTIFY LANDSCAPE ARCHITECT TWO WEEKS IN ADVANCE OF ALL SCHEDULED WORK PERTAINING TO THE RELOCATION OF SITE TREES.

**TREES & PLANTING TO BE REMOVED NOTES**

- THE CONTRACTOR IS TO COMPLETELY REMOVE ALL PLANTER MATERIAL DESIGNATED FOR REMOVAL (I.E. ROOT BALL, DEBRIS, SAW DUST, ETC.).
- THE CONTRACTOR IS TO BACKFILL ALL EXCAVATED ROOT BALLS FLUSH TO THE ADJACENT ELEVATION LEVEL.
- CONTRACTOR TO NOTIFY LANDSCAPE ARCHITECT TWO WEEKS IN ADVANCE OF ALL SCHEDULED WORK PERTAINING TO THE RELOCATION OF SITE TREES.

**MITIGATION NOTES**

- PLANTS TO BE REMOVED PER CITY REQUEST ARE BELOW SIZES REQUIRING MITIGATION.

**CANOPY PRUNING NOTES**

- CROWN (CANOPY) THINNING AND LIFTING PRUNING PER ANSI A-300 STANDARDS. WORK TO BE PERFORMED BY CERTIFIED ARBORIST.

PRUNING CRITERIA (REFER TO DETAIL 2/TD101):

ZONE A - REMOVE SUCKERS AND WEAK STEMS ONLY.

ZONE B - REMOVE 25 - 75% OF SUB-CANOPY FOR UNDERSTANDING TREES OVER 12' HT. PERCENTAGE OF REMOVAL TO CORRESPOND WITH AREA: 25% INFILTRATED VIEW AREA 50 - 75% IN OPEN NEW AREA. FOR TREES BELOW 12' HT., REMOVE 25% OF CANOPY MAX.

ZONE C - REMOVE UP TO 20% OF CANOPY FOR BALANCE AS REQUIRED

**TREE PROTECTION NOTES**

- PROTECTION FENCE SHALL BE GALVANIZED CHAIN LINK STANDARD 2"x2" MESH. .
- PROVIDE HINGED GATE.
- ALTERNATE: 2X4 WOOD POSTS (6'-0" O.C. MAX) WITH THREE EVENLY SPACED WOODEN RAILS. MIN. HT 4'
- POSTS MAY BE SHIFTED TO AVOID ROOTS.
- NO STORAGE, DEBRIS, VEHICULAR TRAFFIC OR EQUIPMENT CLEANING IS ALLOWED WITHIN THE PROTECTED AREA.
- REFER TO MUNICIPAL REQUIREMENTS FOR ADDITIONAL INFORMATION.

TREE No.	TREE - LATIN NAME	TREE - COMMON NAME	DIAMETER at BREAST HEIGHT (in inches)	DBH MULTI TRUNK	HEIGHT OF CANOPY TREES (in feet)	CLEAR TRUNK HEIGHT OF PALM TREES (in feet)	CANOPY DIAMETER (in feet)	CANOPY (in Sq. Ft.)	DISPOSITION	CONDITION	REMOVAL-MUNICIPAL CRITERIA AND NOTES
1	<i>Phoenix sylvestris</i>	WILD DATE PALM	14		30		20	314	REMAIN		
2	<i>Veitchia montgomeryana</i>	MONTGOMERY PALM	4			12	14	154	REMAIN		
3	<i>Veitchia montgomeryana</i>	MONTGOMERY PALM	4			14	20	314	REMAIN		
4	<i>Coco nucifera</i>	COCONUT PALM	10			22	25	491	REMAIN		
5	<i>Coco nucifera</i>	COCONUT PALM	12			22	25	491	REMAIN		
6	<i>Coco nucifera</i>	COCONUT PALM	11			22	25	491	REMAIN		
7	<i>Coco nucifera</i>	COCONUT PALM	12			22	25	491	REMAIN		
8	<i>Coco nucifera</i>	COCONUT PALM	12			22	25	491	REMAIN		
9	<i>Coco nucifera</i>	COCONUT PALM	8			14	20	314	REMAIN		
10	<i>Coco nucifera</i>	COCONUT PALM	12			22	25	491	REMAIN		
11	<i>Coco nucifera</i>	COCONUT PALM	12			22	25	491	REMAIN		
12	<i>Coco nucifera</i>	COCONUT PALM	8			14	20	314	REMAIN		
13	<i>Veitchia montgomeryana</i>	MONTGOMERY PALM	3			10, 12, 10	10	79	REMAIN	POOR	
14	<i>Roystonea eleta</i>	ROYAL PALM	15			32	30	707	REMAIN		
15	<i>Roystonea eleta</i>	ROYAL PALM	15			32	30	707	REMAIN		
16	<i>Ptychosperma elegans</i>	SOLITAIRE PALM	6			24	14	154	REMAIN		
17	<i>Coco nucifera</i>	COCONUT PALM	10			16	22	380	REMAIN		
18	<i>Ravenala madagascariensis</i>	TRAVELER'S PALM	12			8	14 x2	28	REMAIN		
19	<i>Ravenala madagascariensis</i>	TRAVELER'S PALM	12			10, 12, 10	14x2	28	REMAIN		
20	<i>Conocarpus erectus</i>	GREEN BUTTONWOOD	8			22	20	314	REMAIN	POOR	
21	<i>Conocarpus erectus</i>	GREEN BUTTONWOOD	5		10		14	154	REMAIN	POOR	
22	<i>Coco nucifera</i>	COCONUT PALM	12			22	25	491	REMAIN		
23	<i>Roystonea eleta</i>	ROYAL PALM	12			25	25	491	REMAIN		
24	<i>Roystonea eleta</i>	ROYAL PALM	15			30	25	491	REMAIN		
25	<i>Veitchia montgomeryana</i>	MONTGOMERY PALM	3 @ 3	9		10, 14, 24	14	154	REMAIN		
26	<i>Ravenala madagascariensis</i>	TRAVELER'S PALM	5			5	3 x 2	6	REMAIN	POOR	
27	<i>Coco nucifera</i>	COCONUT PALM	10			22	25	491	REMAIN		
28	<i>Coco nucifera</i>	COCONUT PALM	12			22	25	491	REMAIN		
29	<i>Ptychosperma elegans</i>	SOLITAIRE PALM	4			14	12	113	REMAIN		
30	<i>Veitchia montgomeryana</i>	MONTGOMERY PALM	8			32	20	314	REMAIN		
31	<i>Roystonea eleta</i>	ROYAL PALM	15			24	25	491	REMAIN	FAIR	
32	<i>Roystonea eleta</i>	ROYAL PALM	15			28	25	491	REMAIN	FAIR	
33	<i>Veitchia montgomeryana</i>	MONTGOMERY PALM	4			10, 12, 13	14	154	REMAIN		
34	<i>Ptychosperma elegans</i>	SOLITAIRE PALM	8			22	20	314	REMAIN		
35	<i>Clusia guttifer</i>	SMALL LEAF CLUSIA	8		20		26	531	REMAIN		
36	<i>Veitchia montgomeryana</i>	MONTGOMERY PALM	3			16	14	154	REMAIN		
37	<i>Conocarpus erectus var. sericeus</i>	SILVER BUTTONWOOD	8		28		30	707	REMAIN		
38	<i>Veitchia montgomeryana</i>	MONTGOMERY PALM	3			7 thru 20	14	154	REMAIN		
39	<i>Ravenala madagascariensis</i>	TRAVELER'S PALM	8			5	12 x 2	24	REMAIN	FAIR	
40	<i>Roystonea eleta</i>	ROYAL PALM	18			25	25	491	REMAIN		
41	<i>Roystonea eleta</i>	ROYAL PALM	16			20	25	491	REMAIN		
42	<i>Veitchia montgomeryana</i>	MONTGOMERY PALM	6			24	22	380	REMAIN		
43	<i>Veitchia montgomeryana</i>	MONTGOMERY PALM	8			22	22	380	REMAIN		
44	<i>Conocarpus erectus var. sericeus</i>	SILVER BUTTONWOOD	2 @ 12	24	18		25	491	REMAIN		
45	<i>Conocarpus erectus var. sericeus</i>	SILVER BUTTONWOOD	2 @ 8	16	18		20	314	REMAIN		
46	<i>Conocarpus erectus var. sericeus</i>	SILVER BUTTONWOOD	2 @ 3	6	18		25	491	REMAIN		
47	<i>Conocarpus erectus var. sericeus</i>	SILVER BUTTONWOOD	3 @ 4	12	18		20	314	REMAIN		
48	<i>Conocarpus erectus var. sericeus</i>	SILVER BUTTONWOOD	2 @ 3	6	18		20	314	REMAIN		
49	<i>Conocarpus erectus var. sericeus</i>	SILVER BUTTONWOOD	4 @ 2	8	18		25	491	REMAIN		
50	<i>Coco nucifera</i>	COCONUT PALM	10			22	25	491	REMAIN		
51	<i>Coccoloba uvifera</i>	SEA GRAPE	2 @ 3	6	14		8	50	REMAIN		
52	<i>Coccoloba uvifera</i>	SEA GRAPE	2 @ 4	8	12		5	20	REMAIN		
53	<i>Coco nucifera</i>	COCONUT PALM	12			18	20	314	REMAIN		
54	<i>Coccoloba uvifera</i>	SEA GRAPE	2 @ 4	8	18		12	113	REMAIN		
55	<i>Coccoloba uvifera</i>	SEA GRAPE	2 @ 4	8	18		12	113	REMAIN		
56	<i>Coccoloba uvifera</i>	SEA GRAPE	2 @ 4	8	18		12	113	REMAIN		
57	<i>Conocarpus erectus var. sericeus</i>	SILVER BUTTONWOOD	12		18		20	314	REMAIN		
58	<i>Conocarpus erectus var. sericeus</i>	SILVER BUTTONWOOD	12		18		20	314	REMAIN		
59	<i>Coco nucifera</i>	COCONUT PALM	12		20		25	491	REMAIN		
60	<i>Eugenia foetida</i>	SPANISH STOPPER	2		12		10	79	REMAIN		
61	<i>Thrinax radiata</i>	GREEN THATCH PALM	8			6	10	79	REMAIN		
62	<i>Eugenia confusa</i>	REDBERRY STOPPER	2		18		10	79	REMAIN		
63	<i>Eugenia confusa</i>	REDBERRY STOPPER	4 @ 1	4	18		10	79	REMAIN		
64	<i>Eugenia confusa</i>	REDBERRY STOPPER	4 @ 1	4	18		10	79	REMAIN		
65	<i>Eugenia confusa</i>	REDBERRY STOPPER	4 @ 1	4	18		10	79	REMAIN		
66	<i>Eugenia confusa</i>	REDBERRY STOPPER	4 @ 1	4	18		10	79	REMAIN		
67	<i>Thrinax radiata</i>	GREEN THATCH PALM	4			12	8	50	REMAIN		
68	<i>Eugenia confusa</i>	REDBERRY STOPPER	4 @ 1	4	18		10	79	REMAIN		
69	<i>Eugenia confusa</i>	REDBERRY STOPPER	4 @ 1	4	18		10	79	REMAIN		
70	<i>Eugenia confusa</i>	REDBERRY STOPPER	4 @ 1	4	18		10	79	REMAIN		
71	<i>Coco nucifera</i>	COCONUT PALM	10			16	25	491	REMAIN		
72	<i>Eugenia confusa</i>	REDBERRY STOPPER	2 @ 2	4	12		8	50	REMAIN		
73	<i>Thrinax radiata</i>	GREEN THATCH PALM	8			5	6	28	REMAIN		
74	<i>Thrinax radiata</i>	GREEN THATCH PALM	4			22	10	79	REMAIN		
75	<i>Eugenia foetida</i>	SPANISH STOPPER	2 @ 2	4	14		6	28	REMAIN		
76	<i>Ravenala madagascariensis</i>	TRAVELER'S PALM	14			8	18 x 2	36	REMAIN		
77	<i>Coco nucifera</i>	COCONUT PALM	8			20	25	491	REMAIN		
78	<i>Thrinax radiata</i>	GREEN THATCH PALM	4			12	8	50	REMAIN		
79	<i>Thrinax radiata</i>	GREEN THATCH PALM	4			13	5	20	REMAIN		
80	<i>Eugenia foetida</i>	SPANISH STOPPER	2 @ 2	4	14		4	13	REMAIN		
81	<i>Conocarpus erectus var. sericeus</i>	SILVER BUTTONWOOD	4 @ 4	8	25		10	79	REMAIN		
82	<i>Eugenia foetida</i>	SPANISH STOPPER	2 @ 2	4	14		5	20	REMAIN		
83	<i>Thrinax radiata</i>	GREEN THATCH PALM	5			20	6	28	REMAIN		
84	<i>Eugenia foetida</i>	SPANISH STOPPER	3 @ 3	9	14		5	20	REMAIN		
85	<i>Eugenia foetida</i>	SPANISH STOPPER	2 @ 3	6	14		6	28	REMAIN		
86	<i>Clusia rosea</i>	AUTOGRAPH TREE	2		12		5	20	REMAIN		
87	<i>Clusia rosea</i>	AUTOGRAPH TREE	2		12		5	20	REMAIN		
88	<i>Coccothrinax argentata</i>	FLORIDA SILVER PALM	8			3	8	50	REMAIN		
89	<i>Clusia rosea</i>	AUTOGRAPH TREE	3		10		6	28	REMAIN		
90	<i>Coccothrinax argentata</i>	FLORIDA SILVER PALM	8			3	8	50	REMAIN		
91	<i>Clusia guttifer</i>	SMALL LEAF CLUSIA	3		10		6	28	REMAIN		
92	<i>Clusia rosea</i>	AUTOGRAPH TREE	2		10		5	20	REMAIN		
93	<i>Clusia guttifer</i>	SMALL LEAF CLUSIA	2		10		5	20	REMAIN		
94	<i>Clusia guttifer</i>	SMALL LEAF CLUSIA	2		10		5	20	REMAIN		
95	<i>Eugenia foetida</i>	SPANISH STOPPER	2		12		5	20	REMOVE		
96	<i>Conocarpus erectus var. sericeus</i>	SILVER BUTTONWOOD	2 @ 4	6	18		20	314	REMAIN		
97	<i>Conocarpus erectus var. sericeus</i>	SILVER BUTTONWOOD	2 @ 2	4	12		10	79	REMAIN		
98	<i>Eugenia foetida</i>	SPANISH STOPPER	2			12	4	13	REMOVE		

**LAND**

2610 NORTH MIAMI AVENUE  
MIAMI, FL 33127  
614.439.4895  
WWW.LAND.DESIGN

**SOHO BEACH HOUSE**

4385 COLLINS AVENUE | MIAMI BEACH, FL 33140

SEAL (MARSH C. KRIPLEN LIC. FL. LA6667007)  
**NOT FOR CONSTRUCTION**

**TREE DISPOSITION NOTES & SCHEDULE**

DATE ISSUE

07/07/16 HISTORIC PRESERVATION BOARD REVIEW

**TD100**



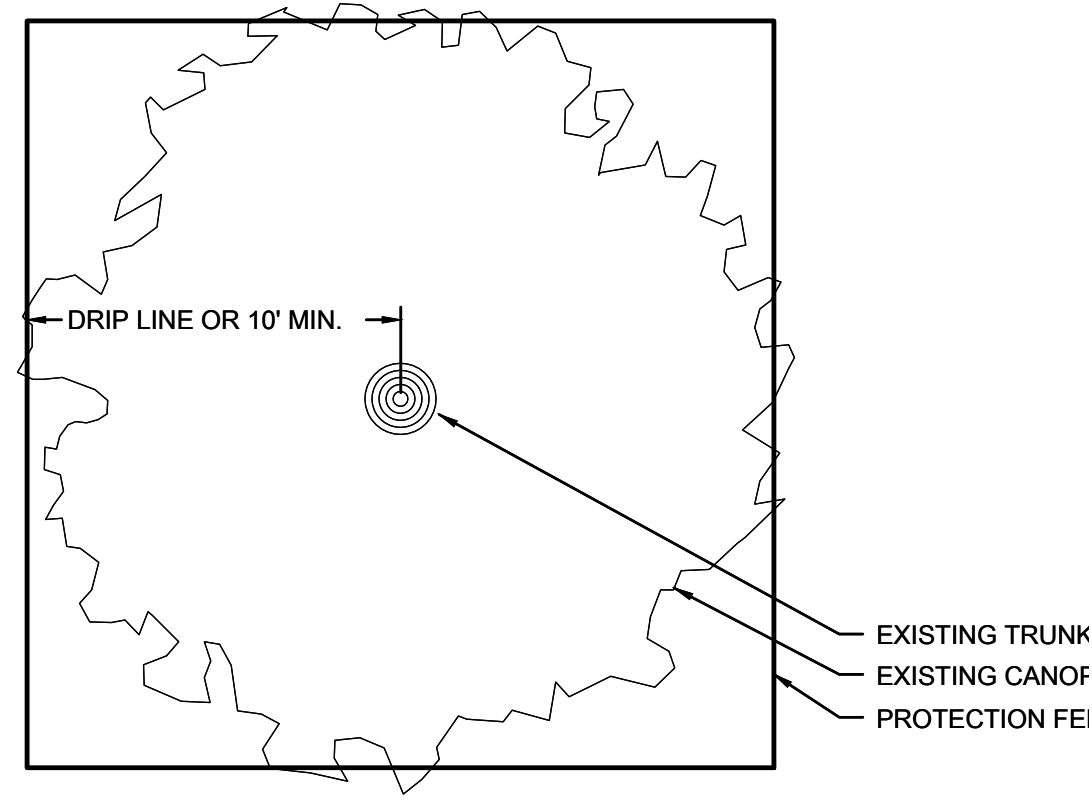

PLAN

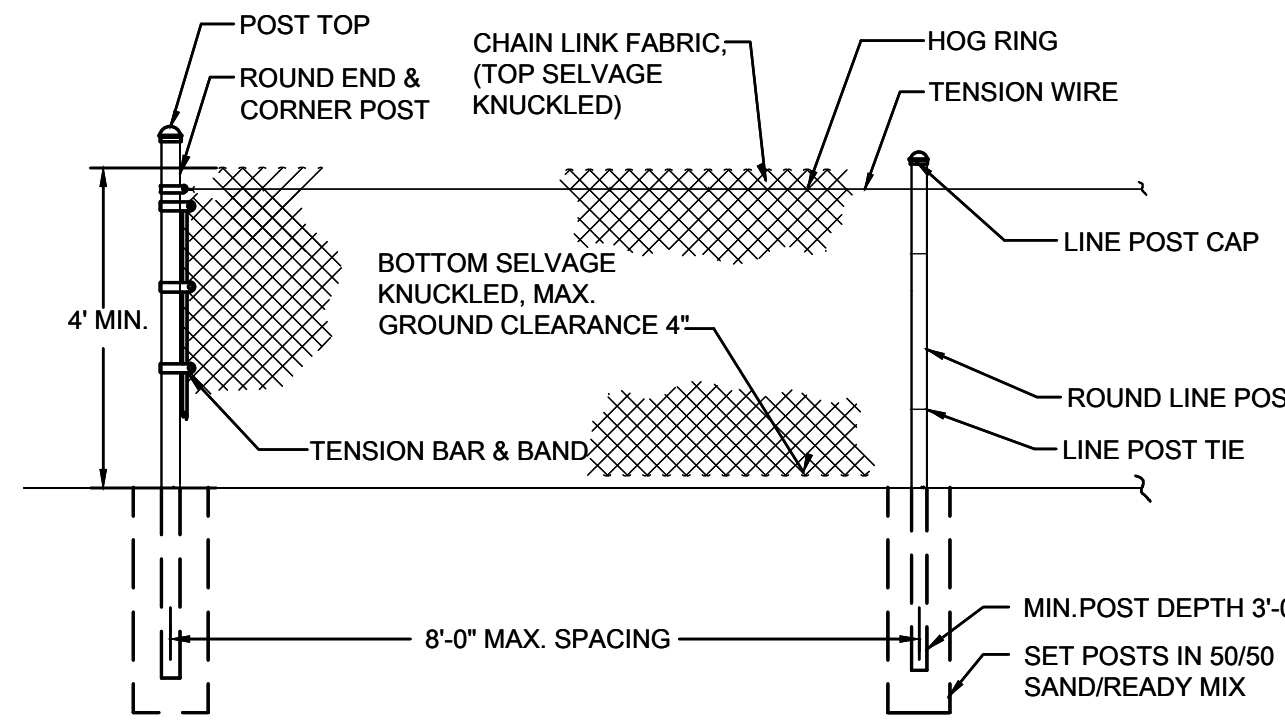

ELEVATION

1 TREE PROTECTION DETAIL

NTS

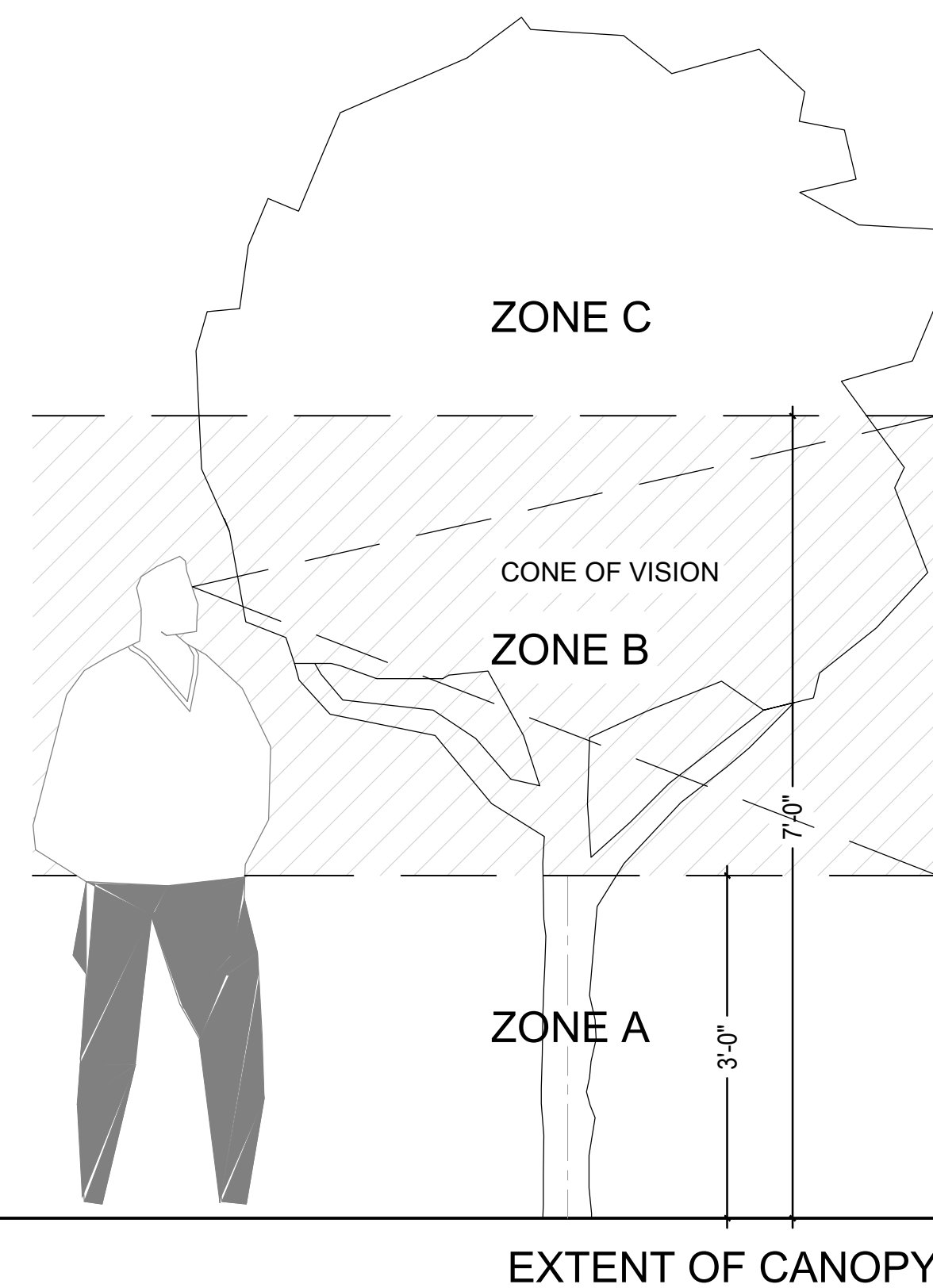

2 PRUNING DIAGRAM

NTS

TREE No.	TREE - LATIN NAME	TREE - COMMON NAME	DIAMETER at BREAST HEIGHT (in inches)	DBH MULTI TRUNK	HEIGHT OF CANOPY TREES (in feet)	CLEAR TRUNK HEIGHT OF PALM TREES (in feet)	CANOPY DIAMETER (in feet)	CANOPY (in Sq. Ft.)	DISPOSITION	CONDITION	REMOVAL-MUNICIPAL CRITERIA AND NOTES
99	<i>Coco nucifera</i>	COCONUT PALM	12			18	25	491	REMAIN		
100	<i>Conocarpus erectus</i>	GREEN BUTTONWOOD	8		20		18	254	REMAIN		
101	<i>Conocarpus erectus</i>	GREEN BUTTONWOOD	14		20		30	707	REMAIN		
102	<i>Conocarpus erectus</i>	GREEN BUTTONWOOD	10		20		20	314	REMAIN	FAIR	
103	<i>Conocarpus erectus</i>	GREEN BUTTONWOOD	8		20		20	314	REMOVE	FAIR	
104	<i>Coco nucifera</i>	COCONUT PALM	8			16	25	491	REMAIN		
105	<i>Conocarpus erectus var. sericeus</i>	SILVER BUTTONWOOD	4 @ 2	8	16		10	79	REMOVE		
106	<i>Bismarckia nobilis</i>	BISMARCK PALM	N/A			1	10	79	REMAIN		
107	<i>Coco nucifera</i>	COCONUT PALM	12		30		20	314	REMAIN		
108	<i>Coccoloba uvifera</i>	SEA GRAPE	2 @ 6	12	20		20	314	REMAIN		
109	<i>Capparis cynophallophora</i>	JAMAICAN CAPER	N/A		6		4	13	REMAIN		
110	<i>Coco nucifera</i>	COCONUT PALM	12			22	20	314	REMAIN		
111	<i>Coccoloba uvifera</i>	SEA GRAPE	2 @ 6	12	15		25	491	REMAIN		
112	<i>Thrinax radiata</i>	GREEN THATCH PALM	4			15	12	113	REMAIN		
113	<i>Coco nucifera</i>	COCONUT PALM	10			22	18	254	REMAIN		
114	<i>Coco nucifera</i>	COCONUT PALM	10			24	20	314	REMAIN		
115	<i>Coccoloba uvifera</i>	SEA GRAPE	2 @ 6	12	12		12	113	REMAIN		
116	<i>Thrinax radiata</i>	GREEN THATCH PALM	3			10	8	50	REMAIN		
117	<i>Coco nucifera</i>	COCONUT PALM	12			26	20	314	REMAIN		
118	<i>Coco nucifera</i>	COCONUT PALM	8			22	20	314	REMAIN		
119	<i>Coccoloba uvifera</i>	SEA GRAPE	3 @ 3	9	14		10	79	REMAIN		
120	<i>Coccoloba uvifera</i>	SEA GRAPE	4 @ 1	4	12		10	79	REMAIN		
121	<i>Coco nucifera</i>	COCONUT PALM	12			20	20	314	REMAIN		
122	<i>Thrinax radiata</i>	GREEN THATCH PALM	4			18,16,6	8x3	24	REMAIN		
123	<i>Coccoloba uvifera</i>	SEA GRAPE	4 @ 1	4	18		10	79	REMAIN		
124	<i>Coco nucifera</i>	COCONUT PALM	12			26	20	314	REMAIN		
125	<i>Thrinax radiata</i>	GREEN THATCH PALM	3			14	8	50	REMAIN		
126	<i>Coccoloba uvifera</i>	SEA GRAPE	4 @ 1	4	14		14	154	REMAIN		
127	<i>Coccoloba uvifera</i>	SEA GRAPE	4 @ 1	4	12		12	113	REMAIN		
128	<i>Coco nucifera</i>	COCONUT PALM	10			24	18	254	REMAIN		
129	<i>Leucothrinax morrisii</i>	SILVER THATCH PALM	3			8,10	5	20	REMAIN		
130	<i>Thrinax radiata</i>	GREEN THATCH PALM	3			20	8	50	REMAIN		
131	<i>Coccoloba uvifera</i>	SEA GRAPE	4 @ 1		16		12	113	REMAIN		
132	<i>Coco nucifera</i>	COCONUT PALM	12			24	20	314	REMAIN		
133	<i>Eugenia foetida</i>	SPANISH STOPPER	3 @ 1	3	12		6	28	REMAIN		
134	<i>Thrinax radiata</i>	GREEN THATCH PALM	4			10,18	8x2	16	REMAIN		
135	<i>Capparis cynophallophora</i>	JAMAICAN CAPER	4 @ 1	4	12		4	13	REMAIN		
136	<i>Coccoloba uvifera</i>	SEA GRAPE	3 @ 3	9	16		7	38	REMAIN		
137	<i>Coccoloba uvifera</i>	SEA GRAPE	6 @ 2	12	18		12	113	REMAIN		
138	<i>Coco nucifera</i>	COCONUT PALM	12			26	25	491	REMAIN		
139	<i>Thrinax radiata</i>	GREEN THATCH PALM	4			10	10	79	REMAIN		
140	<i>Capparis cynophallophora</i>	JAMAICAN CAPER	4 @ 1	4	8		4	13	REMAIN		
141	<i>Capparis cynophallophora</i>	JAMAICAN CAPER	5 @ 1	5	10		6	28	REMAIN		
142	<i>Capparis cynophallophora</i>	JAMAICAN CAPER	4 @ 1	4	14		10	79	REMAIN		
143	<i>Thrinax radiata</i>	GREEN THATCH PALM	3			14	8	50	REMAIN		
144	<i>Coccoloba uvifera</i>	SEA GRAPE	4 @ 3	12	18		8	50	REMAIN		
145	<i>Coccoloba uvifera</i>	SEA GRAPE	6		14		6	28	REMAIN		
146	<i>Capparis cynophallophora</i>	JAMAICAN CAPER	3 @ 1	3	14		10	79	REMAIN		
147	<i>Sabal palmetto</i>	CABBAGE PALM	14			18	20	314	REMAIN		
148	<i>Conocarpus erectus var. sericeus</i>	SILVER BUTTONWOOD	2 @ 3	6	16		18	254	REMAIN		
149	<i>Capparis cynophallophora</i>	JAMAICAN CAPER	4 @ 1	4	6		5	20	REMAIN		
150	<i>Capparis cynophallophora</i>	JAMAICAN CAPER	4 @ 1	4	8		6	28	REMAIN		
151	<i>Coco nucifera</i>	COCONUT PALM	8			20	22	380			
152	<i>Capparis cynophallophora</i>	JAMAICAN CAPER	4 @ 1	4	10		5	20	REMAIN		
153	<i>Conocarpus erectus var. sericeus</i>	SILVER BUTTONWOOD	2 @ 4	8	16		10	79	REMAIN		
154	<i>Sabal palmetto</i>	CABBAGE PALM	16			22	20	314	REMAIN		
155	<i>Clusia rosea</i>	AUTOGRAPH TREE	2 @ 3	6	5		4	13	REMAIN		DOES NOT MEET THE REQUIREMENTS TO QUALIFY AS A TREE. CMB. CHAPTER 46, DIV. 2
156	<i>Coco nucifera</i>	COCONUT PALM	12			20	20	314	REMAIN		
157	<i>Capparis cynophallophora</i>	JAMAICAN CAPER	4 @ 1	4	12		6	28	REMAIN		
158	<i>Capparis cynophallophora</i>	JAMAICAN CAPER	4 @ 1	4	12		6	28	REMAIN		
159	<i>Capparis cynophallophora</i>	JAMAICAN CAPER	4 @ 1	4	12		6	28	REMAIN		
160	<i>Conocarpus erectus var. sericeus</i>	SILVER BUTTONWOOD	2 @ 4	8	12		14	154	REMAIN		
161	<i>Copernicia macroglossa</i>	PETTICOAT PALM	N/A			2	10	79	REMAIN		
162	<i>Eugenia foetida</i>	SPANISH STOPPER	3 @ 1	3	14		6	28	REMAIN		
163	<i>Capparis cynophallophora</i>	JAMAICAN CAPER	4 @ 1	4	10		4	13	PRUNE		
164	<i>Eugenia foetida</i>	SPANISH STOPPER	2 @ 2	4	14		8	50	REMAIN		
165	<i>Clusia guttifera</i>	SMALL LEAF CLUSIA	2 @ 3	6	4		4	13	REMAIN		
166	<i>Eugenia foetida</i>	SPANISH STOPPER	3 @ 1	3	10			0	REMOVE	DEAD	
167	<i>Coco nucifera</i>	COCONUT PALM	8			30	25	491	REMAIN		
168	<i>Sabal palmetto</i>	CABBAGE PALM	16			15	20	314	REMAIN		
169	<i>Coco nucifera</i>	COCONUT PALM	10			25	25	491	REMAIN		
170	<i>Sabal palmetto</i>	CABBAGE PALM	14			18	20	314	REMAIN		
171	<i>Coco nucifera</i>	COCONUT PALM	10			25	25	491	REMAIN		
172	<i>Clusia guttifera</i>	SMALL LEAF CLUSIA	2 @ 3	6	4		3	7	REMOVE		
173	<i>Clusia guttifera</i>	SMALL LEAF CLUSIA	2 @ 3	6	4		3	7	REMOVE		DOES NOT MEET THE REQUIREMENTS TO QUALIFY AS A TREE. CMB. CHAPTER 46, DIV. 2
174	<i>Clusia guttifera</i>	SMALL LEAF CLUSIA	2 @ 3	6	4		3	7	REMOVE		
175	<i>Gymnanthes lucida</i>	CRABWOOD	3 @ 1	3	6		3	7	REMAIN		
176	<i>Clusia guttifera</i>	SMALL LEAF CLUSIA	2 @ 3	6	6		3	7	REMOVE		DOES NOT MEET THE REQUIREMENTS TO QUALIFY AS A TREE. CMB. CHAPTER 46, DIV. 2
177	<i>Coco nucifera</i>	COCONUT PALM	10			30	20	314	REMAIN		
178	<i>Coco nucifera</i>	COCONUT PALM	10			20	20	314	REMAIN		
179	<i>Coco nucifera</i>	COCONUT PALM	10			25	20	314	REMAIN		
180	<i>Coco nucifera</i>	COCONUT PALM	10			20	20	314	REMAIN		
181	<i>Coco nucifera</i>	COCONUT PALM	10			18	20	314	REMAIN		
182	<i>Thrinax radiata</i>	GREEN THATCH PALM	4			4,14,15	20	314	REMAIN		
183	<i>Coccoloba uvifera</i>	SEA GRAPE	3 @ 3	9	14		12	113	PRUNE		
184	<i>Caryota mitis</i>	FISHTAIL PALM	8 @ 2	16	10		5	20	REMOVE		
185	<i>Clusia guttifera</i>	SMALL LEAF CLUSIA	2 @ 3	6	4		3	7	REMOVE		
186	<i>Clusia guttifera</i>	SMALL LEAF CLUSIA	2 @ 3	6	4		3	7	REMOVE		DOES NOT MEET THE REQUIREMENTS TO QUALIFY AS A TREE. CMB. CHAPTER 46, DIV. 2
187	<i>Clusia guttifera</i>	SMALL LEAF CLUSIA	2 @ 3	6	4		4	13	REMOVE		
188	<i>Capparis cynophallophora</i>	JAMAICAN CAPER	4 @ 1	4	6		3	7	REMOVE		
189	<i>Gymnanthes lucida</i>	CRABWOOD	3 @ 1	3	6		4	13	REMOVE		
190	<i>Eugenia foetida</i>	SPANISH STOPPER	2		12		8	50	REMAIN		
191	<i>Capparis cynophallophora</i>	JAMAICAN CAPER	4 @ 1	4	6		3	7	REMAIN		
192	<i>Capparis cynophallophora</i>	JAMAICAN CAPER	4 @ 1	4	7		5	20	REMOVE		DOES NOT MEET THE REQUIREMENTS TO QUALIFY AS A TREE. CMB. CHAPTER 46, DIV. 2
193	<i>Coccoloba uvifera</i>	SEA GRAPE	2 @ 4	8	10		6	28	PRUNE		

# LAND

2610 NORTH MIAMI AVENUE  
MIAMI, FL 33127  
614.439.4895  
WWW.LAND.DESIGN

## SOHO BEACH HOUSE

4385 COLLINS AVENUE | MIAMI BEACH, FL 33140

SEAL  
(MARSH C. KRIPLEN LIC. FL. LA6667007)  
NOT FOR CONSTRUCTION

### TREE DISPOSITION SCHEDULE & DETAILS

DATE	ISSUE
07/07/16	HISTORIC PRESERVATION BOARD REVIEW

# TD101



TREE No.	TREE - LATIN NAME	TREE - COMMON NAME	DIAMETER at BREAST HEIGHT (in inches)	DBH MULTI TRUNK	HEIGHT OF CANOPY TREES (in feet)	CLEAR TRUNK HEIGHT OF PALM TREES (in feet)	CANOPY DIAMETER (in feet)	CANOPY (in Sq. Ft.)	DISPOSITION	CONDITION	REMOVAL-MUNICIPAL CRITERIA AND NOTES
194	<i>Gymnanthes lucida</i>	CRABWOOD	3 @ 1	3	8		6	28	REMAIN		
195	<i>Thrinax radiata</i>	GREEN THATCH PALM	4			2	7	38	REMAIN		
196	<i>Capparis cynophallophora</i>	JAMAICAN CAPER	4 @ 1	4	5		3	7	REMOVE		
197	<i>Bougainvillea 'Alabama Sunset'</i>	BOUGAINVILLEA	1 Multi		14		6	28	REMOVE		DOES NOT MEET THE REQUIREMENTS TO QUALIFY AS A TREE. CMB. CHAPTER 46, DIV. 2
198	<i>Clusia guttifer</i>	SMALL LEAF CLUSIA	2 @ 3	6	6		4	13	REMOVE		
199	<i>Sabal palmetto</i>	CABBAGE PALM	14			18	20	314	REMAIN		
200	<i>Clusia guttifer</i>	SMALL LEAF CLUSIA	2 @ 3	6	6		4	13	REMOVE		
201	<i>Clusia guttifer</i>	SMALL LEAF CLUSIA	2 @ 3	6	5		2	3	REMOVE		DOES NOT MEET THE REQUIREMENTS TO QUALIFY AS A TREE. CMB. CHAPTER 46, DIV. 2
202	<i>Clusia guttifer</i>	SMALL LEAF CLUSIA	2 @ 3	6	4		2	3	REMOVE		
203	<i>Clusia guttifer</i>	SMALL LEAF CLUSIA	2 @ 3	6	5		5	20	REMOVE		
204	<i>Sabal palmetto</i>	CABBAGE PALM	14			16	20	314	REMAIN		
205	<i>Clusia guttifer</i>	SMALL LEAF CLUSIA	2 @ 3	6	6		4	13	REMOVE		
206	<i>Clusia guttifer</i>	SMALL LEAF CLUSIA	2 @ 3	6	6		3	7	REMOVE		DOES NOT MEET THE REQUIREMENTS TO QUALIFY AS A TREE. CMB. CHAPTER 46, DIV. 2
207	<i>Clusia guttifer</i>	SMALL LEAF CLUSIA	2 @ 3	6	6		4	13	REMOVE		
208	<i>Coccoloba uvifera</i>	SEA GRAPE	2 @ 2	4	12		8	50	PRUNE		
209	<i>Coco nucifera</i>	COCONUT PALM	4		14		20	314	REMOVE		
210	<i>Coccoloba uvifera</i>	SEA GRAPE	3 @ 3	9	12		10	79	PRUNE		
211	<i>Eugenia foetida</i>	SPANISH STOPPER	2 @ 2	4	14		10	79	REMAIN		
212	<i>Eugenia foetida</i>	SPANISH STOPPER	3 @ 1	3	12		10	79	REMOVE		
213	<i>Coccoloba uvifera</i>	SEA GRAPE	3 @ 3	9	25		14	154	REMOVE		
214	<i>Clusia guttifer</i>	SMALL LEAF CLUSIA	2 @ 3	6	5		5	20	REMOVE		DOES NOT MEET THE REQUIREMENTS TO QUALIFY AS A TREE. CMB. CHAPTER 46, DIV. 2
215	<i>Gymnanthes lucida</i>	CRABWOOD	3 @ 1	3	6		4	13	REMOVE		
216	<i>Coccoloba uvifera</i>	SEA GRAPE	3 @ 4	12	25		18	254	PRUNE		
217	<i>Eugenia foetida</i>	SPANISH STOPPER	3 @ 1	3	12		10	79	REMAIN		
218	<i>Capparis cynophallophora</i>	JAMAICAN CAPER	4 @ 1	4	4		1	1	REMOVE		DOES NOT MEET THE REQUIREMENTS TO QUALIFY AS A TREE. CMB. CHAPTER 46, DIV. 2
219	<i>Capparis cynophallophora</i>	JAMAICAN CAPER	4 @ 1	4	7		3	7	REMOVE		
220	<i>Capparis cynophallophora</i>	JAMAICAN CAPER	4 @ 1	4	5		2	3	REMOVE		
221	<i>Coccoloba uvifera</i>	SEA GRAPE	2 @ 4	8	12		8	50	PRUNE		
222	<i>Gymnanthes lucida</i>	CRABWOOD	3 @ 1	3	8		4	13	REMAIN		
223	<i>Coco nucifera</i>	COCONUT PALM	8			18	20	314	REMOVE		
224	<i>Gymnanthes lucida</i>	CRABWOOD	3 @ 1	3	7		2	3	REMOVE		
225	<i>Coccoloba uvifera</i>	SEA GRAPE	3 @ 3	9	18		8	50	REMAIN		
226	<i>Capparis cynophallophora</i>	JAMAICAN CAPER	4 @ 1	4	6		5	20	REMOVE		DOES NOT MEET THE REQUIREMENTS TO QUALIFY AS A TREE. CMB. CHAPTER 46, DIV. 2
227	<i>Gymnanthes lucida</i>	CRABWOOD	3 @ 1	3	6		4	13	REMAIN		
228	<i>Coccoloba uvifera</i>	SEA GRAPE	6		20		16	201	PRUNE		
229	<i>Gymnanthes lucida</i>	CRABWOOD	3 @ 1	3	8		3	7	REMAIN		
230	<i>Coccoloba uvifera</i>	SEA GRAPE	4 @ 1	4	16		12	113	REMAIN		
231	<i>Clusia guttifer</i>	SMALL LEAF CLUSIA	2 @ 3	6	10		4	13	REMOVE		DOES NOT MEET THE REQUIREMENTS TO QUALIFY AS A TREE. CMB. CHAPTER 46, DIV. 2
232	<i>Capparis cynophallophora</i>	JAMAICAN CAPER	4 @ 1	4	8		4	13	REMAIN		
233	<i>Clusia guttifer</i>	SMALL LEAF CLUSIA	2 @ 3	6	6		3	7	REMOVE		DOES NOT MEET THE REQUIREMENTS TO QUALIFY AS A TREE. CMB. CHAPTER 46, DIV. 2
234	<i>Capparis cynophallophora</i>	JAMAICAN CAPER	4 @ 1	4	8		4	13	REMOVE		
235	<i>Clusia guttifer</i>	SMALL LEAF CLUSIA	2 @ 3	6	6		4	13	REMOVE		DOES NOT MEET THE REQUIREMENTS TO QUALIFY AS A TREE. CMB. CHAPTER 46, DIV. 2
236	<i>Sabal palmetto</i>	CABBAGE PALM	16			18	20	314	REMAIN		
237	<i>Gymnanthes lucida</i>	CRABWOOD	3 @ 1	3	6		3	7	REMOVE		
238	<i>Clusia guttifer</i>	SMALL LEAF CLUSIA	2 @ 3	6	6		3	7	REMOVE		DOES NOT MEET THE REQUIREMENTS TO QUALIFY AS A TREE. CMB. CHAPTER 46, DIV. 2
239	<i>Copernicia macroglossa</i>	PETTICOAT PALM	N/A			2	12	113	REMAIN		
240	<i>Sabal palmetto</i>	CABBAGE PALM	14			15	20	314	REMAIN		
241	<i>Clusia guttifer</i>	SMALL LEAF CLUSIA	2 @ 3	6	6		3	7	REMOVE		DOES NOT MEET THE REQUIREMENTS TO QUALIFY AS A TREE. CMB. CHAPTER 46, DIV. 2
242	<i>Thrinax radiata</i>	GREEN THATCH PALM	5			22	8	50	REMAIN		
243	<i>Gymnanthes lucida</i>	CRABWOOD	3 @ 1	3	10		5	20	REMAIN		
244	<i>Clusia guttifer</i>	SMALL LEAF CLUSIA	2 @ 3	6	7		4	13	REMOVE		DOES NOT MEET THE REQUIREMENTS TO QUALIFY AS A TREE. CMB. CHAPTER 46, DIV. 2
245	<i>Sabal palmetto</i>	CABBAGE PALM	16			16	20	314	REMAIN		
246	<i>Clusia guttifer</i>	SMALL LEAF CLUSIA	2 @ 3	6	8		4	13	REMOVE		DOES NOT MEET THE REQUIREMENTS TO QUALIFY AS A TREE. CMB. CHAPTER 46, DIV. 2
247	<i>Clusia guttifer</i>	SMALL LEAF CLUSIA	2 @ 3	6	8		4	13	REMOVE		
248	<i>Capparis cynophallophora</i>	JAMAICAN CAPER	4 @ 1	4	10		5	20	REMAIN		
249	<i>Sabal palmetto</i>	CABBAGE PALM	15			12	18	254	REMAIN		
250	<i>Clusia guttifer</i>	SMALL LEAF CLUSIA	2 @ 3	6	8		3	7	REMOVE		DOES NOT MEET THE REQUIREMENTS TO QUALIFY AS A TREE. CMB. CHAPTER 46, DIV. 2
251	<i>Sabal palmetto</i>	CABBAGE PALM	15			12	18	254	REMAIN		
252	<i>Clusia guttifer</i>	SMALL LEAF CLUSIA	2 @ 3	6	6		3	7	REMOVE		DOES NOT MEET THE REQUIREMENTS TO QUALIFY AS A TREE. CMB. CHAPTER 46, DIV. 2
<b>REMOVAL TOTAL:</b>											0

SEAL  
(MARSH C. KRIPLEN LIC. FL. LA6667007)  
NOT FOR CONSTRUCTION

TREE DISPOSITION SCHEDULE	
DATE	ISSUE
07/07/16	HISTORIC PRESERVATION BOARD REVIEW



COLLINS AVENUE

PROPERTY LINE - 100.00'

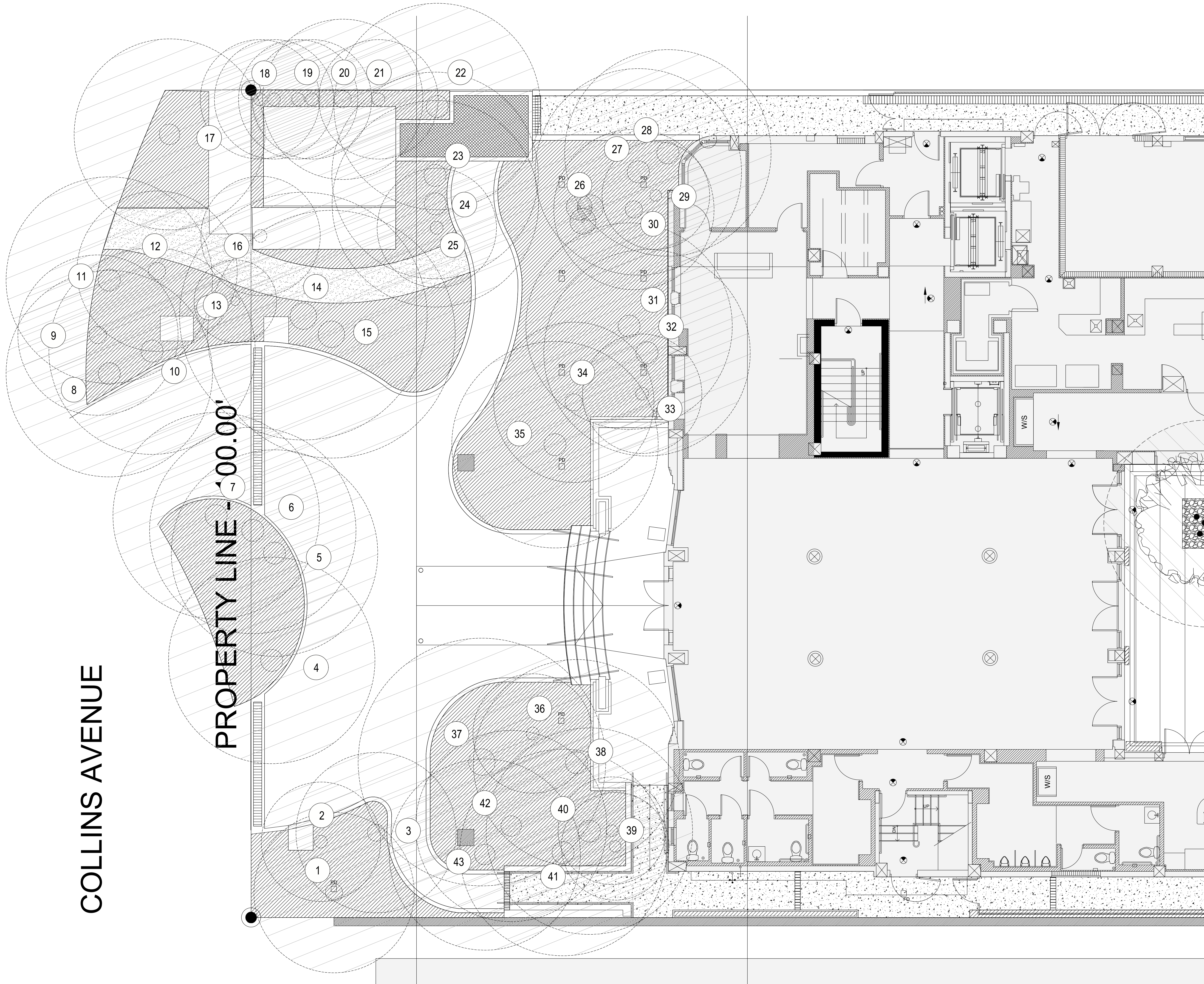

### TREE DISPOSITION LEGEND

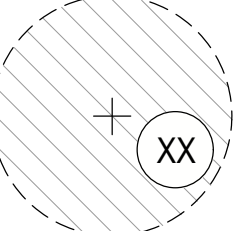
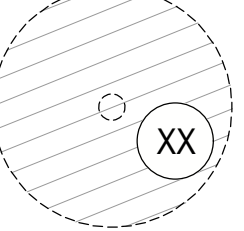
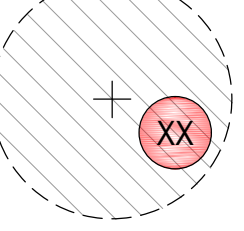
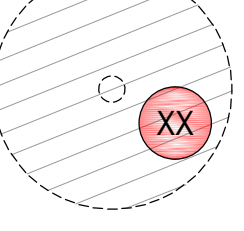
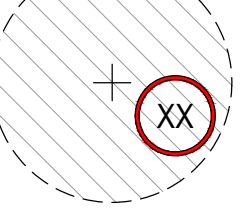
-  EXISTING TREE
-  EXISTING PALM
-  TREE TO BE REMOVED
-  PALM TO BE REMOVED
-  PLANTING TO BE PRUNED

SEAL  
(MARSH C. KRIPLEN LIC. FL. LA6667007)  
NOT FOR CONSTRUCTION

TREE DISPOSITION PLAN  
DATE ISSUE

07/07/16 HISTORIC  
PRESERVATION BOARD  
REVIEW

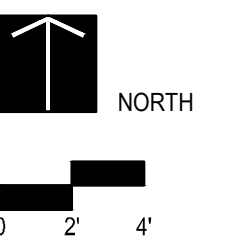

# TD103



## PROPERTY LINE - 364.74'

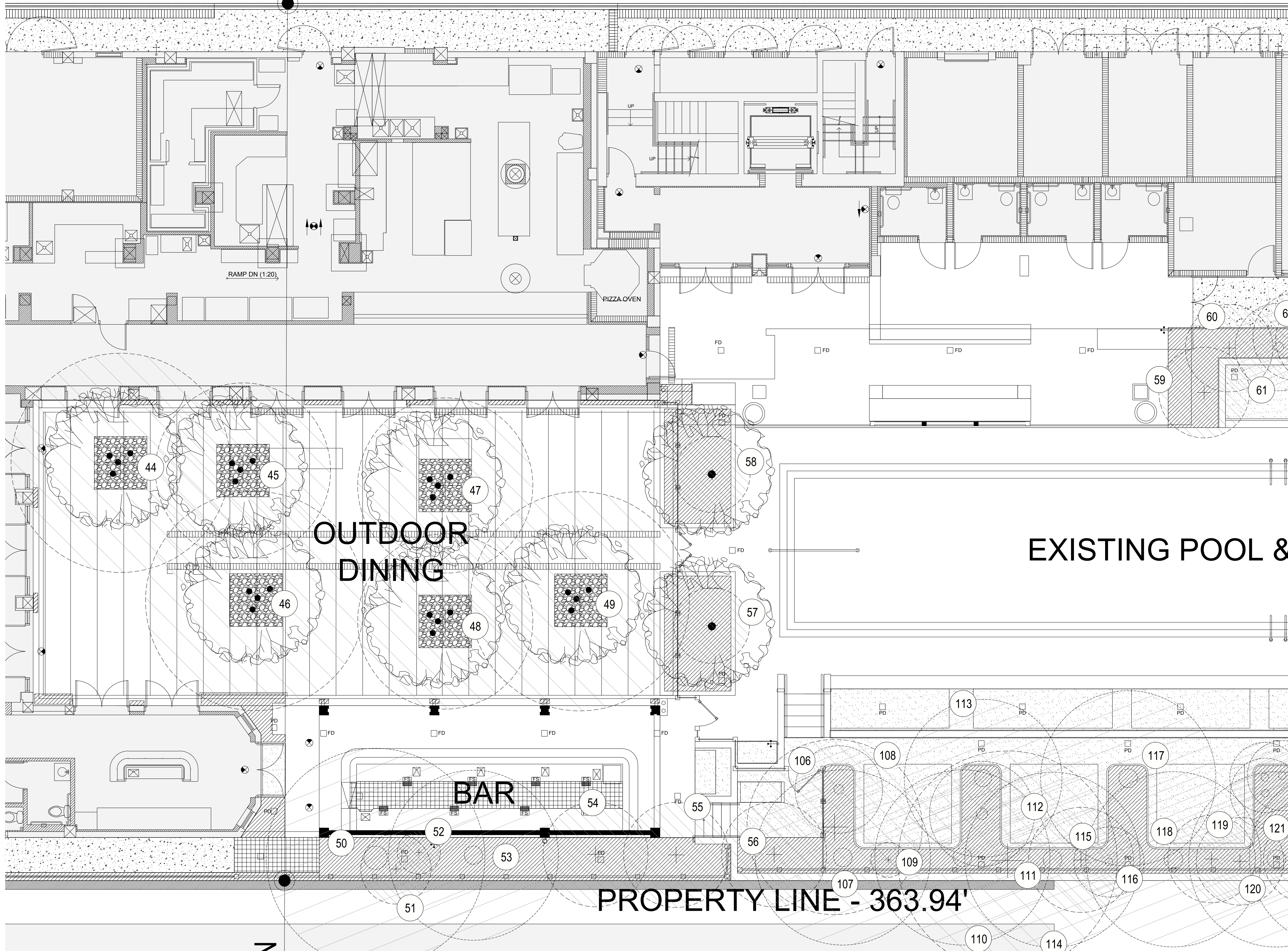

### TREE DISPOSITION LEGEND

- EXISTING TREE
- EXISTING PALM
- TREE TO BE REMOVED
- PALM TO BE REMOVED
- PLANTING TO BE PRUNED

SOHO BEACH HOUSE  
4385 COLLINS AVENUE | MIAMI BEACH, FL 33140

SEAL  
(MARSH C. KRIPLEN LIC. FL. LA6667007)  
NOT FOR CONSTRUCTION

TREE DISPOSITION PLAN	
DATE	ISSUE
07/07/16	HISTORIC PRESERVATION BOARD REVIEW

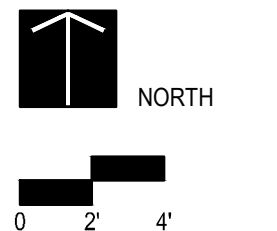

### KEY PLAN

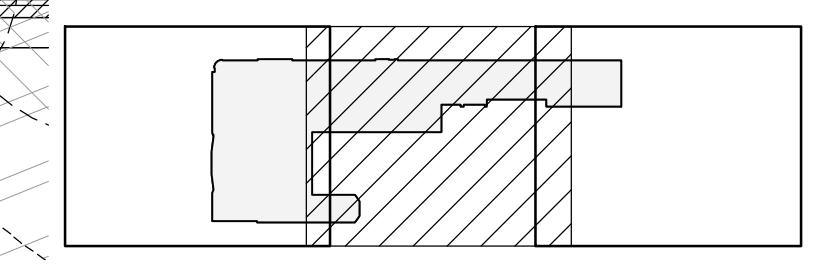

## TD104





ING POOL & DECK

STAL

### TREE DISPOSITION LEGEND

- EXISTING TREE
- EXISTING PALM
- TREE TO BE REMOVED
- PALM TO BE REMOVED
- PLANTING TO BE PRUNED

### KEY PLAN

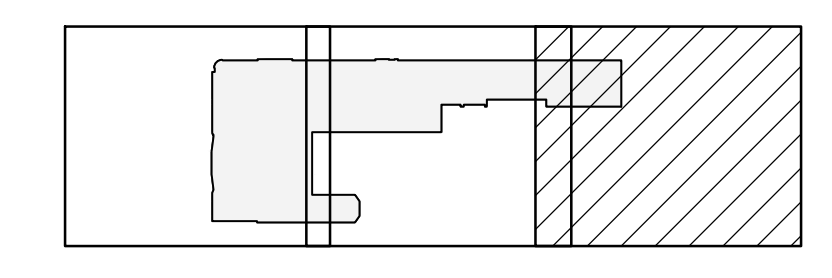

SOHO BEACH HOUSE  
4385 COLLINS AVENUE | MIAMI BEACH, FL 33140

SEAL  
(MARSH C. KRIPLEN LIC. FL LA6667007)  
NOT FOR CONSTRUCTION

TREE DISPOSITION PLAN & SCHEDULE  
DATE: 07/07/16  
ISSUE: HISTORIC PRESERVATION BOARD REVIEW

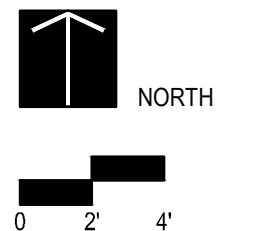

## TD105



## SOHO BEACH HOUSE



4385 COLLINS AVENUE | MIAMI BEACH, FL 33140

SEAL  
(MARSH C. KRIPLEN LIC. FL. LA6667007)  
NOT FOR CONSTRUCTION

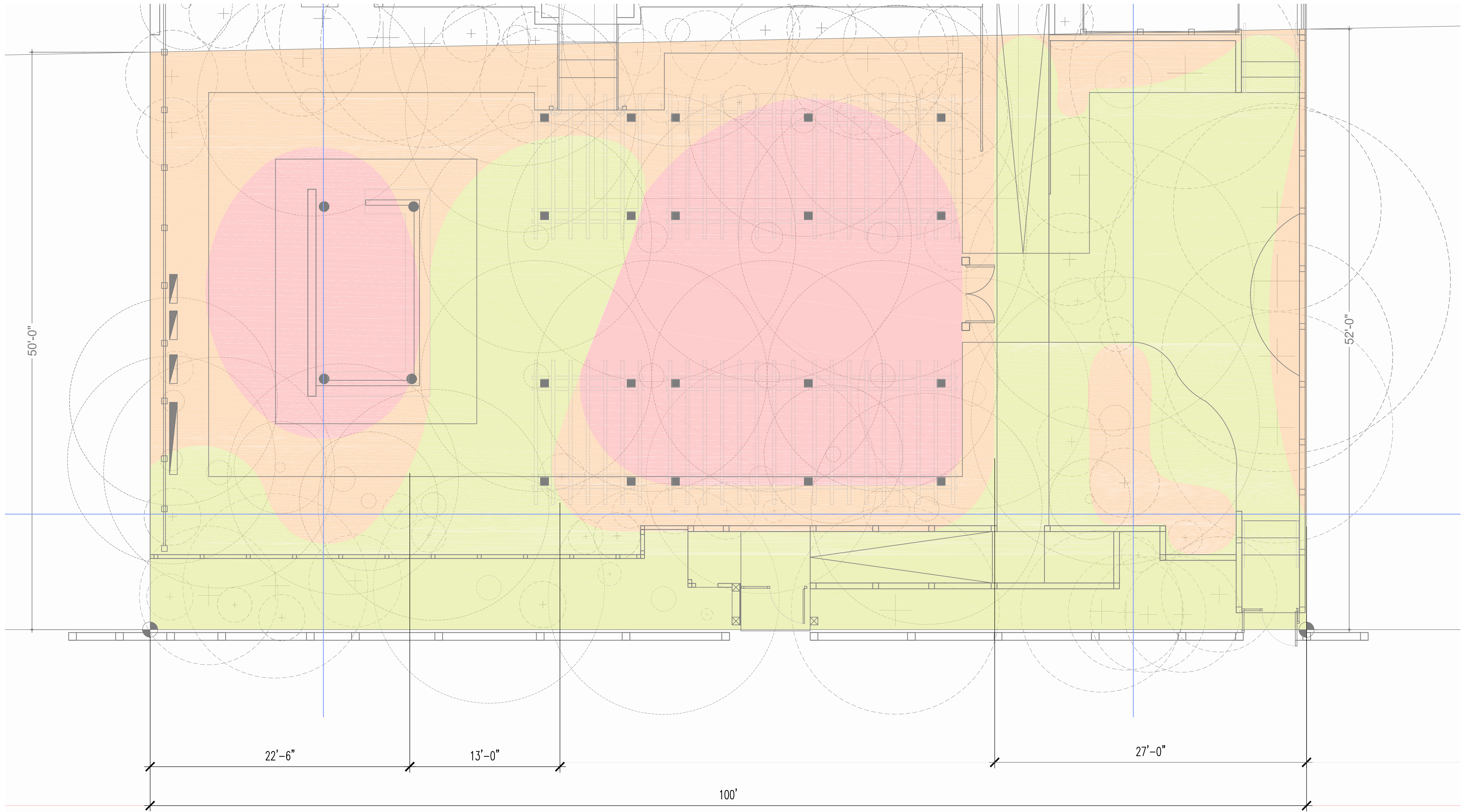
VIEW DIAGRAM	
DATE	ISSUE
07/07/16	HISTORIC PRESERVATION BOARD REVIEW

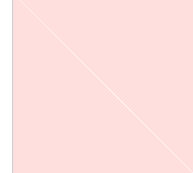

### LEGEND

-  UNOBSTRUCTED VIEWS
-  FILTERED VIEWS
-  SCREENED VIEWS

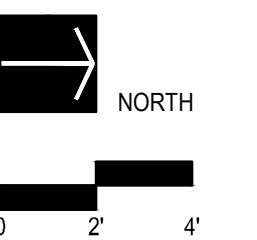

# L050



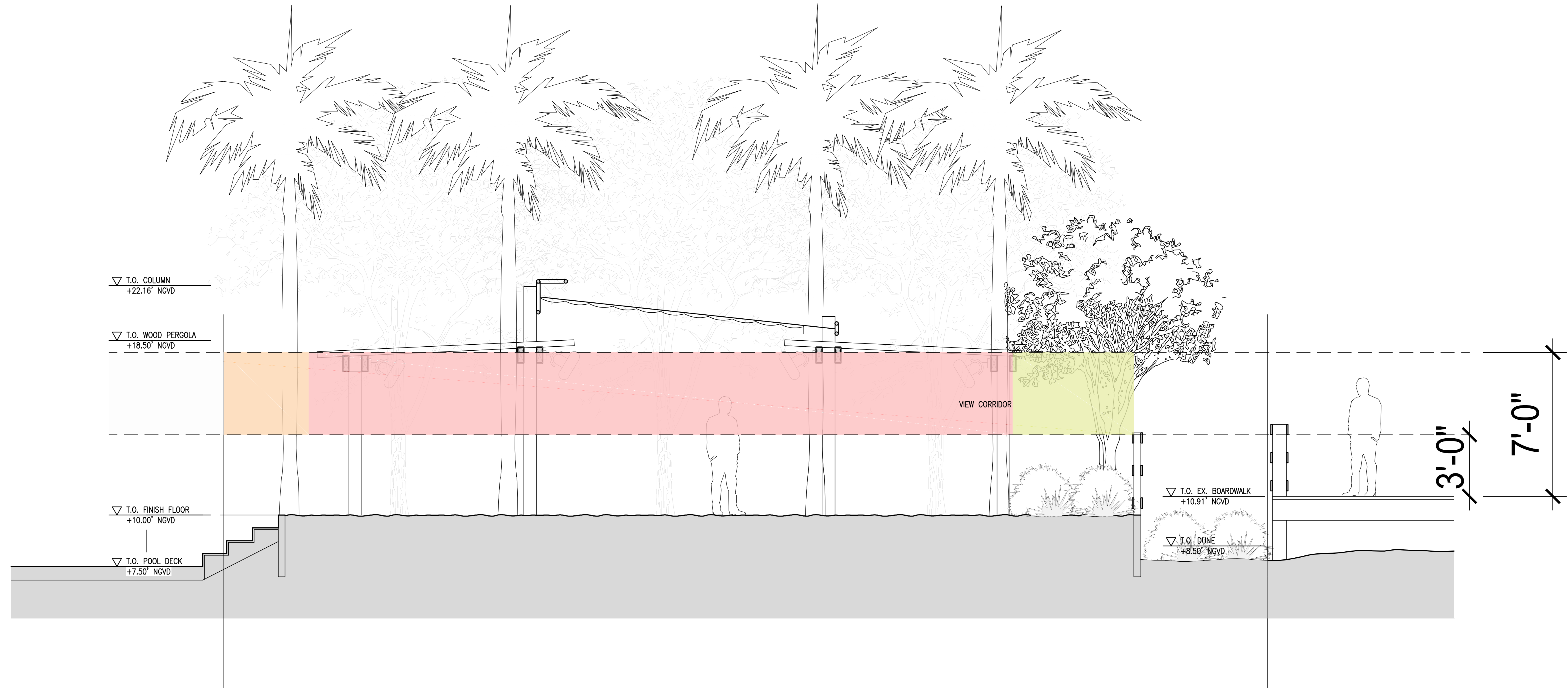

1 SECTION - VIEW NORTH AT TIKI

3/8" = 1'-0"

**LEGEND**

- UNOBSTRUCTED VIEWS
- FILTERED VIEWS
- SCREENED VIEWS

SEAL  
(MARSH C. KRIPLEN LIC. FL LA6667007)  
NOT FOR CONSTRUCTION

VIEW DIAGRAM ELEVATION	
DATE	ISSUE
07/07/16	HISTORIC PRESERVATION BOARD REVIEW

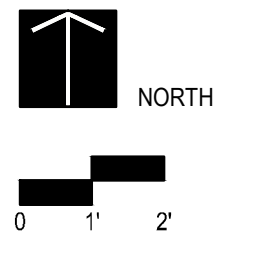

L051



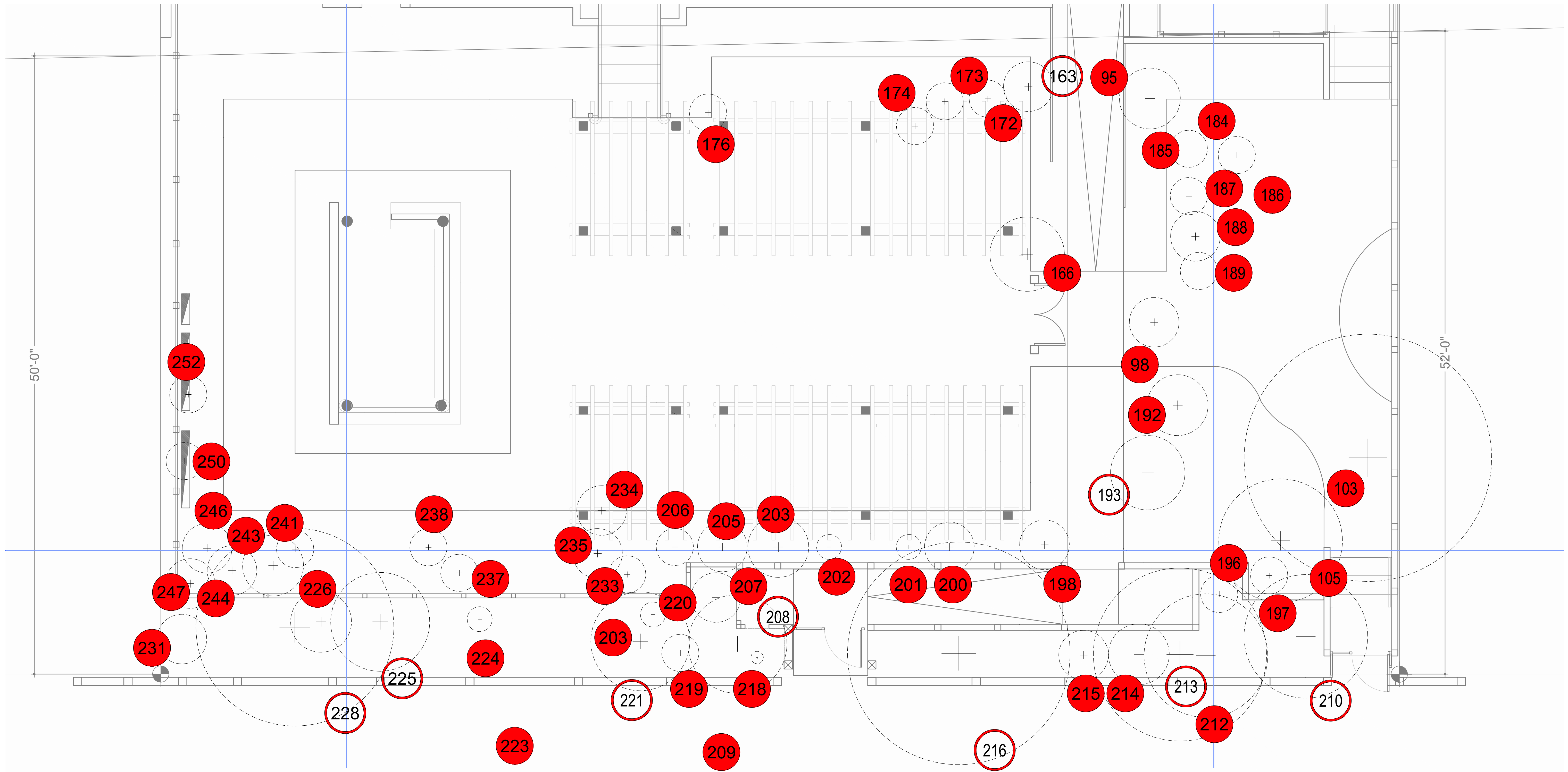

### NOTES:

1. REMOVE ALL BAMBOO AND WOOD FENCING FROM DUNE OVERLAY ZONE
2. REMOVE ALL ROOTS AND DEBRIS ASSOCIATED WITH TREE REMOVAL.
3. PROTECT EXISTING PLANT MATERIAL TO REMAIN.

### LEGEND

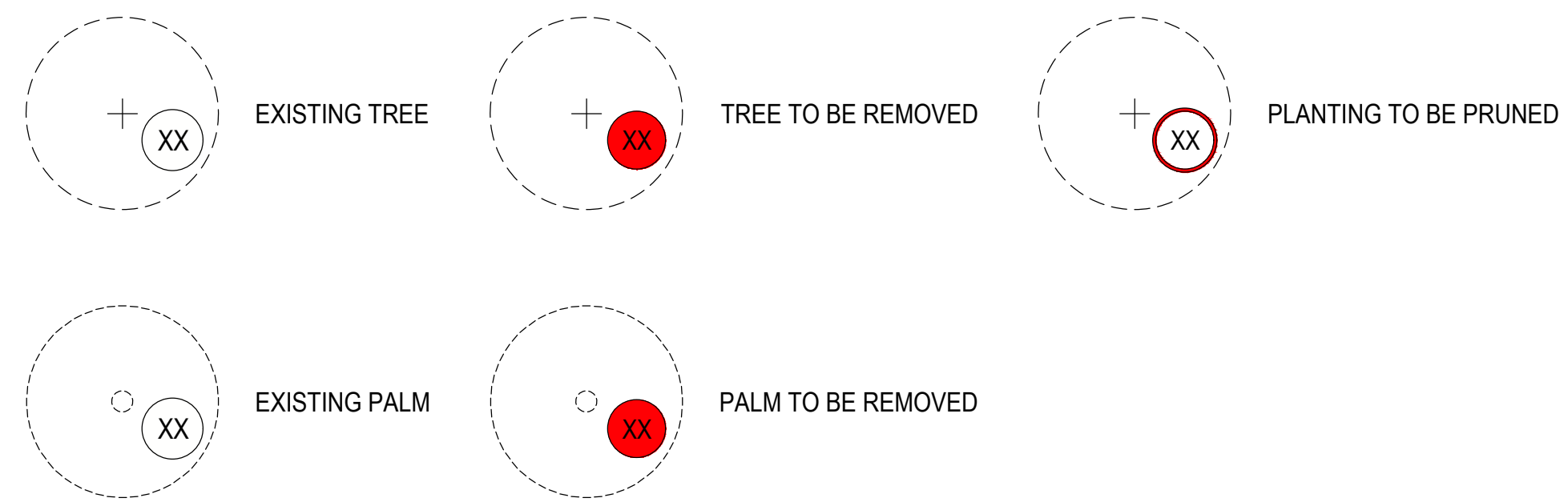

### TREE DISPOSITION SCHEDULE

TREE No.	TREE - LATIN NAME	TREE - COMMON NAME	DISPOSITION	TREE No.	TREE - LATIN NAME	TREE - COMMON NAME	DISPOSITION	TREE No.	TREE - LATIN NAME	TREE - COMMON NAME	DISPOSITION	TREE No.	TREE - LATIN NAME	TREE - COMMON NAME	DISPOSITION
95	<i>Eugenia foetida</i>	SPANISH STOPPER	REMOVE	192	<i>Capparis cynophallophora</i>	JAMAICAN CAPER	REMOVE	214	<i>Clusia guttifera</i>	SMALL LEAF CLUSIA	REMOVE	235	<i>Clusia guttifera</i>	SMALL LEAF CLUSIA	REMOVE
98	<i>Eugenia foetida</i>	SPANISH STOPPER	REMOVE	193	<i>Coccoloba uvifera</i>	SEA GRAPE	PRUNE	215	<i>Gymnanthes lucida</i>	CRABWOOD	REMOVE	237	<i>Gymnanthes lucida</i>	CRABWOOD	REMOVE
103	<i>Conocarpus erectus</i>	GREEN BUTTONWOOD	REMOVE	196	<i>Capparis cynophallophora</i>	JAMAICAN CAPER	REMOVE	216	<i>Coccoloba uvifera</i>	SEA GRAPE	PRUNE	238	<i>Clusia guttifera</i>	SMALL LEAF CLUSIA	REMOVE
105	<i>Conocarpus erectus var. sericeus</i>	SILVER BUTTONWOOD	REMOVE	197	<i>Bougainvillea 'Alabama Sunset'</i>	BOUGAINVILLEA	REMOVE	218	<i>Capparis cynophallophora</i>	JAMAICAN CAPER	REMOVE	241	<i>Clusia guttifera</i>	SMALL LEAF CLUSIA	REMOVE
163	<i>Capparis cynophallophora</i>	JAMAICAN CAPER	PRUNE	198	<i>Clusia guttifera</i>	SMALL LEAF CLUSIA	REMOVE	219	<i>Capparis cynophallophora</i>	JAMAICAN CAPER	REMOVE	243	<i>Clusia guttifera</i>	SMALL LEAF CLUSIA	REMOVE
166	<i>Eugenia foetida</i>	SPANISH STOPPER	REMOVE	200	<i>Clusia guttifera</i>	SMALL LEAF CLUSIA	REMOVE	220	<i>Capparis cynophallophora</i>	JAMAICAN CAPER	REMOVE	244	<i>Clusia guttifera</i>	SMALL LEAF CLUSIA	REMOVE
172	<i>Clusia guttifera</i>	SMALL LEAF CLUSIA	REMOVE	201	<i>Clusia guttifera</i>	SMALL LEAF CLUSIA	REMOVE	221	<i>Coccoloba uvifera</i>	SEA GRAPE	PRUNE	246	<i>Clusia guttifera</i>	SMALL LEAF CLUSIA	REMOVE
173	<i>Clusia guttifera</i>	SMALL LEAF CLUSIA	REMOVE	202	<i>Clusia guttifera</i>	SMALL LEAF CLUSIA	REMOVE	222	<i>Gymnanthes lucida</i>	CRABWOOD	REMOVE	247	<i>Clusia guttifera</i>	SMALL LEAF CLUSIA	REMOVE
174	<i>Clusia guttifera</i>	SMALL LEAF CLUSIA	REMOVE	203	<i>Clusia guttifera</i>	SMALL LEAF CLUSIA	REMOVE	223	<i>Coco nucifera</i>	COCONUT PALM	REMOVE	248	<i>Clusia guttifera</i>	SMALL LEAF CLUSIA	REMOVE
176	<i>Clusia guttifera</i>	SMALL LEAF CLUSIA	REMOVE	205	<i>Clusia guttifera</i>	SMALL LEAF CLUSIA	REMOVE	224	<i>Gymnanthes lucida</i>	CRABWOOD	REMOVE	249	<i>Clusia guttifera</i>	SMALL LEAF CLUSIA	REMOVE
183	<i>Coccoloba uvifera</i>	SEA GRAPE	PRUNE	206	<i>Clusia guttifera</i>	SMALL LEAF CLUSIA	REMOVE	225	<i>Capparis cynophallophora</i>	JAMAICAN CAPER	REMOVE	250	<i>Clusia guttifera</i>	SMALL LEAF CLUSIA	REMOVE
184	<i>Caryota mitis</i>	FISHTAIL PALM	REMOVE	207	<i>Clusia guttifera</i>	SMALL LEAF CLUSIA	REMOVE	226	<i>Coccoloba uvifera</i>	SEA GRAPE	PRUNE	251	<i>Clusia guttifera</i>	SMALL LEAF CLUSIA	REMOVE
185	<i>Clusia guttifera</i>	SMALL LEAF CLUSIA	REMOVE	208	<i>Coccoloba uvifera</i>	SEA GRAPE	PRUNE	227	<i>Coccoloba uvifera</i>	SEA GRAPE	PRUNE	252	<i>Clusia guttifera</i>	SMALL LEAF CLUSIA	REMOVE
186	<i>Clusia guttifera</i>	SMALL LEAF CLUSIA	REMOVE	209	<i>Coco nucifera</i>	COCONUT PALM	REMOVE	228	<i>Coccoloba uvifera</i>	SEA GRAPE	PRUNE				
187	<i>Clusia guttifera</i>	SMALL LEAF CLUSIA	REMOVE	210	<i>Coccoloba uvifera</i>	SEA GRAPE	PRUNE	229	<i>Clusia guttifera</i>	SMALL LEAF CLUSIA	REMOVE				
188	<i>Capparis cynophallophora</i>	JAMAICAN CAPER	REMOVE	212	<i>Eugenia foetida</i>	SPANISH STOPPER	REMOVE	230	<i>Clusia guttifera</i>	SMALL LEAF CLUSIA	REMOVE				
189	<i>Gymnanthes lucida</i>	CRABWOOD	REMOVE	213	<i>Coccoloba uvifera</i>	SEA GRAPE	PRUNE	231	<i>Clusia guttifera</i>	SMALL LEAF CLUSIA	REMOVE				
				214	<i>Capparis cynophallophora</i>	JAMAICAN CAPER	REMOVE	232	<i>Clusia guttifera</i>	SMALL LEAF CLUSIA	REMOVE				
				215	<i>Clusia guttifera</i>	SMALL LEAF CLUSIA	REMOVE	233	<i>Clusia guttifera</i>	SMALL LEAF CLUSIA	REMOVE				
				216	<i>Clusia guttifera</i>	SMALL LEAF CLUSIA	REMOVE	234	<i>Capparis cynophallophora</i>	JAMAICAN CAPER	REMOVE				
				217	<i>Clusia guttifera</i>	SMALL LEAF CLUSIA	REMOVE								
				218	<i>Clusia guttifera</i>	SMALL LEAF CLUSIA	REMOVE								
				219	<i>Clusia guttifera</i>	SMALL LEAF CLUSIA	REMOVE								
				220	<i>Clusia guttifera</i>	SMALL LEAF CLUSIA	REMOVE								
				221	<i>Clusia guttifera</i>	SMALL LEAF CLUSIA	REMOVE								
				222	<i>Clusia guttifera</i>	SMALL LEAF CLUSIA	REMOVE								
				223	<i>Clusia guttifera</i>	SMALL LEAF CLUSIA	REMOVE								
				224	<i>Clusia guttifera</i>	SMALL LEAF CLUSIA	REMOVE								
				225	<i>Clusia guttifera</i>	SMALL LEAF CLUSIA	REMOVE								
				226	<i>Clusia guttifera</i>	SMALL LEAF CLUSIA	REMOVE								
				227	<i>Clusia guttifera</i>	SMALL LEAF CLUSIA	REMOVE								
				228	<i>Clusia guttifera</i>	SMALL LEAF CLUSIA	REMOVE								
				229	<i>Clusia guttifera</i>	SMALL LEAF CLUSIA	REMOVE								
				230	<i>Clusia guttifera</i>	SMALL LEAF CLUSIA	REMOVE								
				231	<i>Clusia guttifera</i>	SMALL LEAF CLUSIA	REMOVE								
				232	<i>Clusia guttifera</i>	SMALL LEAF CLUSIA	REMOVE								
				233	<i>Clusia guttifera</i>	SMALL LEAF CLUSIA	REMOVE								
				234	<i>Capparis cynophallophora</i>	JAMAICAN CAPER	REMOVE								

SEAL  
(MARSH C. KRIPLEN LIC.FL LA6667007)  
NOT FOR CONSTRUCTION

REMOVAL PLAN  
DATE: ISSUE:  
07/07/16 HISTORIC PRESERVATION BOARD REVIEW

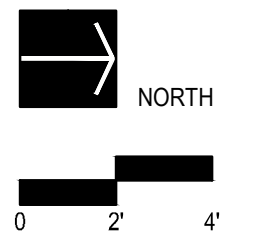

# L075



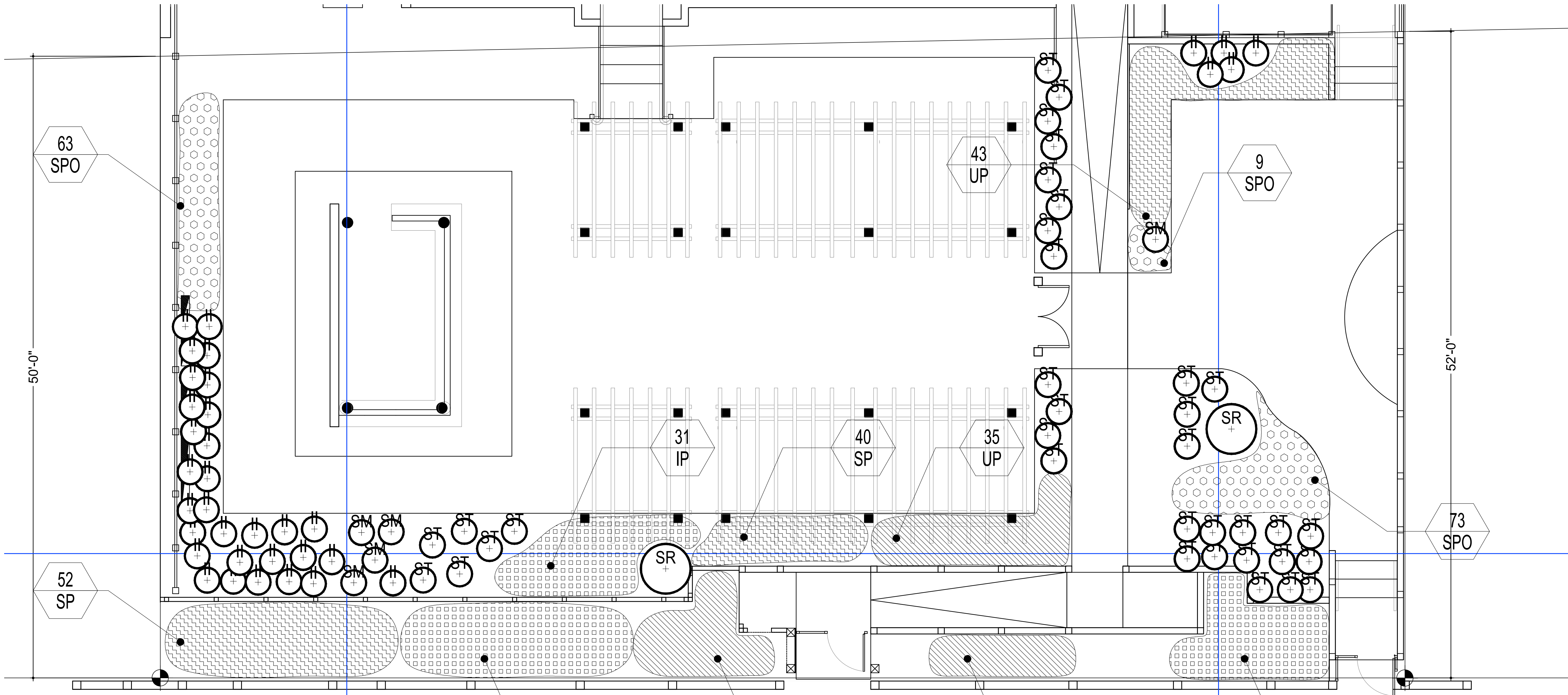

### PLANTING LEGEND

	UNIOLA PANICULATA		SOPHORA TOMENTOSA
	IPOMOEA PES-CAPRAE		SERENOA REPENS
	SPARTINA PATENS		IVA IMBRICATA WALT
	SESUVIUM PORTULACASTUM		SURIANA MARITIMA

### PLANTING SCHEDULE:

ABR.	QTY.	BOTANICAL NAME	COMMON NAME	SPECIFICATION	ORIGIN
<b>SHRUBS</b>					
SM	5	<i>SURIANA MARITIMA</i>	BAY CEDAR	15GAL	FLORIDA
SPO	159	<i>SESUVIUM PORTULACASTUM</i>	SALTMEADOW CORDGRASS	3GAL	FLORIDA
ST	35	<i>SOPHORA TOMENTOSA</i>	NECKLACE POD	7GAL	FLORIDA
SR	2	<i>SERENOA REPENS</i>	SAW PALMETTO	15GAL	FLORIDA
II	35	<i>IVA IMBRICATA WALT</i>	BEACH ELDER	15GAL	FLORIDA
<b>GRASSES</b>					
UP	126	<i>UNIOLA PANICULATA</i>	SEA OATS	3 GAL	FLORIDA
IP	120	<i>IPMOEA PES-CAPRAE</i>	RAILROAD VINE	1GAL	FLORIDA
SP	119	<i>SPARTINA PATENS</i>	SALTMEADOW CORDGRASS	3GAL	FLORIDA

SEAL  
(MARSH C. KRIPLEN LIC.FL LA6667007)  
NOT FOR CONSTRUCTION

### PLANTING PLAN

DATE: 07/07/16

ISSUE: HISTORIC PRESERVATION BOARD REVIEW

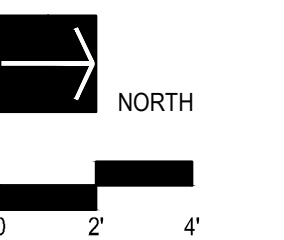

# L401