

MIAMIBEACH

OFFICE OF CAPITAL IMPROVEMENT PROJECTS NORTH BEACH ENTRANCE MARKERS HARDING AVENUE & 87th STREET



CITY OF MIAMI BEACH

MAYOR: DAN GELBER

COMMISSIONERS: RICKY ARRIOLA
ALEX J. FERNANDEZ
KRISTEN ROSEN GONZALEZ
STEVEN MEINER
DAVID RICHARDSON

CITY MANAGER: ALINA T. HUDAK
DEPUTY CITY MANAGER: ERIC CARPENTER
ASST. CITY MANAGER: LESTOR SOLA
CITY ATTORNEY: RAFAEL A. PAZ
CITY CLERK: RAFAEL E. GRANADO
CIP DIRECTOR: DAVID MARTINEZ P.E.

CONSULTANTS

PRIME CONSULTANT &
STRUCTURAL ENGINEERING: DOUGLAS WOOD ASSOCIATES, INC.
DESIGN ARCHITECT: SHULMAN + ASSOCIATES
ELECTRICAL ENGINEERING: EMTec CORPORATION
LANDSCAPE ARCHITECTURE: SAVINO MILLER DESIGN STUDIO
CIVIL ENGINEERING: FORTIN, LEAVY, SKILES, INC.
GEOTECHNICAL ENGINEERING: ARDAMAN & ASSOCIATES
SURVEYING: FORTIN, LEAVY, SKILES, INC.

HISTORIC PRESERVATION BOARD HPB22-0531 FINAL SUBMITTAL JULY 11, 2022

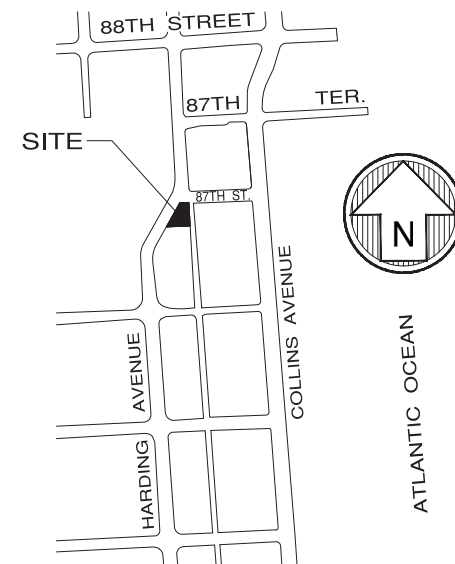

HARDING AVENUE & 87TH STREET LOCATION MAP

DRAWING INDEX

V-1.00	SURVEY
G-1.00	CONTEXT LOCATION PLAN
G-1.01	ZONING AND HISTORIC DISTRICT MAP
G-1.02	ZONING DATA
G-1.03	SITE PHOTOS
G-1.04	PRECEDENT IMAGES
G-1.05	PRECEDENT IMAGES
A-1.00	SITE PLAN AT GROUND LEVEL
A-1.01	SITE PLAN AT CANOPY LEVEL
A-1.02	SITE PLAN AT GROUND LEVEL ENLARGED
A-1.03	SITE PLAN AT CANOPY LEVEL ENLARGED
A-2.00	ELEVATION
A-3.00	SECTION
A-7.00	EXPLODED AXONOMETRIC
A-9.00	PERSPECTIVE (DAY)
A-9.01	PERSPECTIVE (DAY)
A-9.02	PERSPECTIVE (NIGHT)
L-1.00	LANDSCAPE PLAN
L-1.01	LANDSCAPE PLAN ENLARGED
L-1.02	TREE MITIGATION PLAN
L-1.03	LIGHTING PLAN

G-1.00 CONTEXT LOCATION PLAN

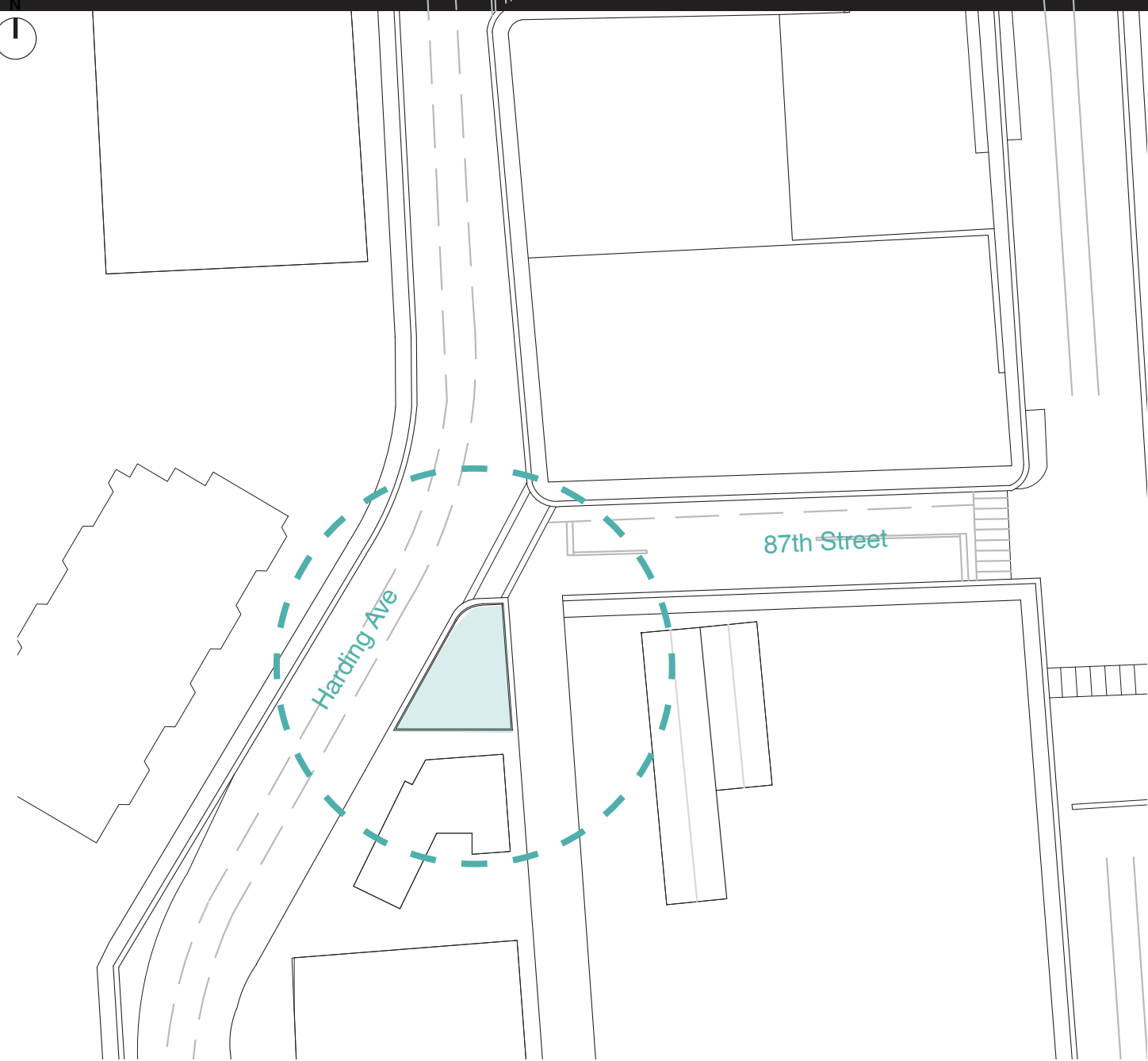

HARDING AVE. ENTRANCE

G-1.01 ZONING AND HISTORIC DISTRICT MAP

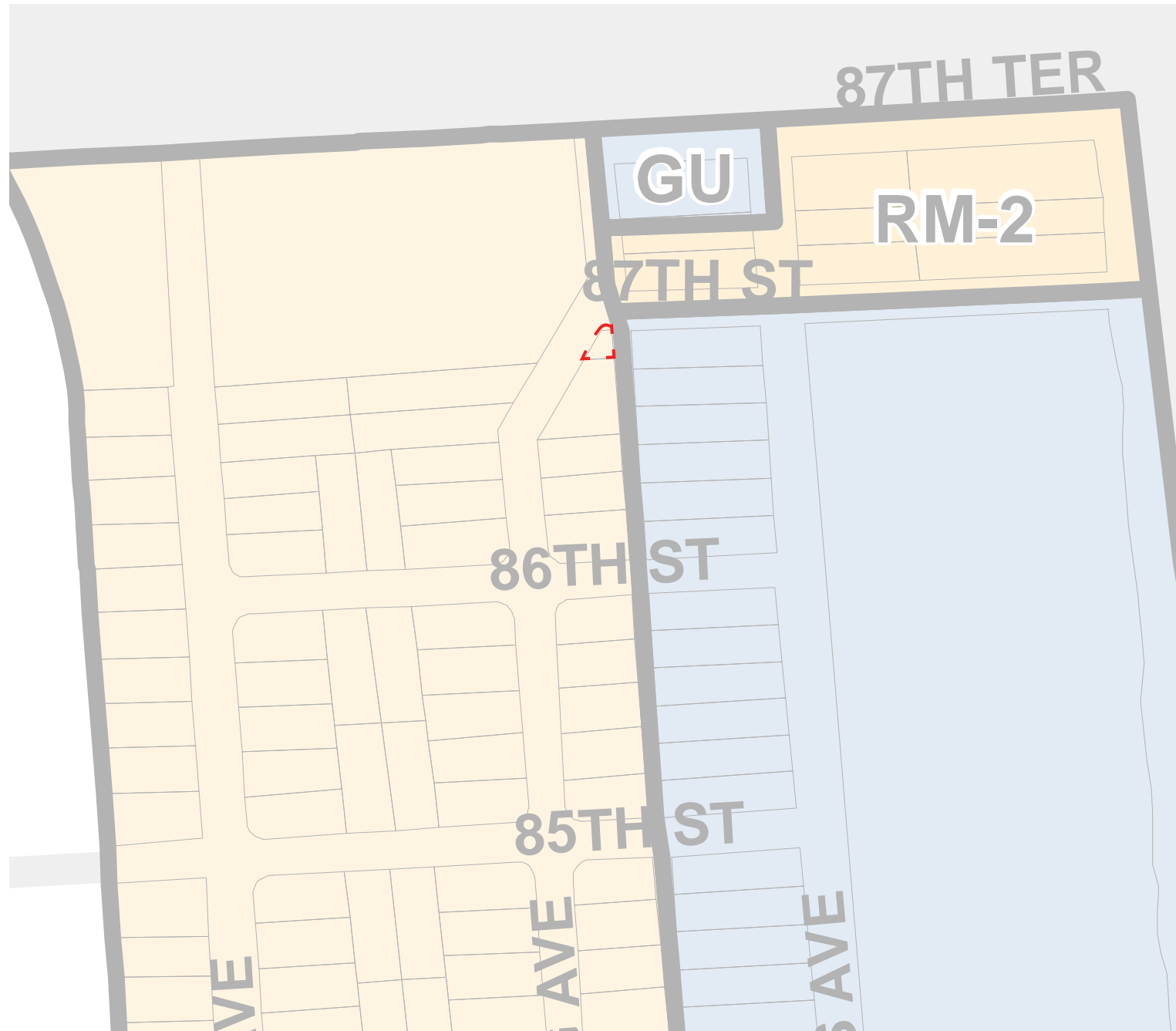



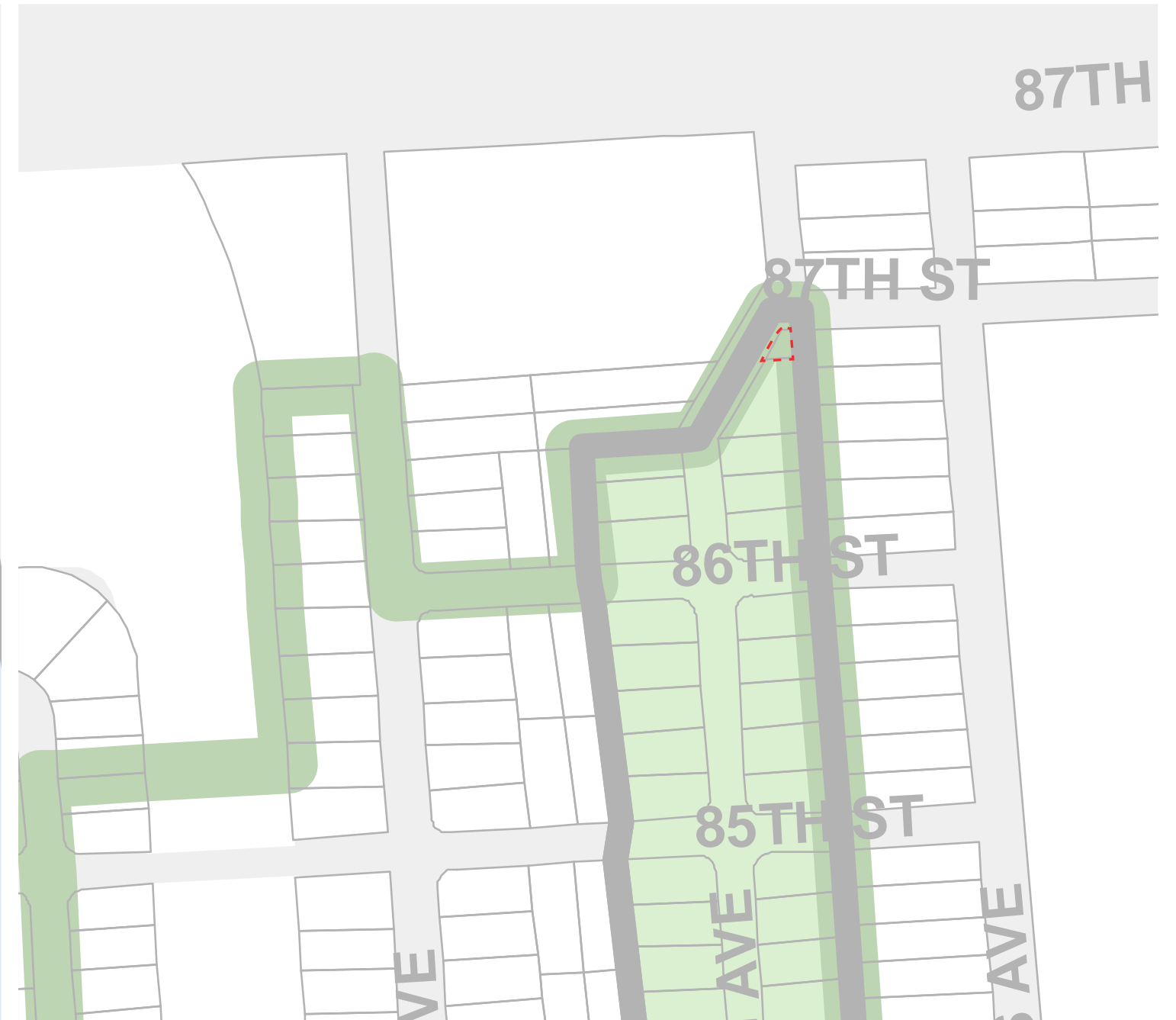

ZONING MAP

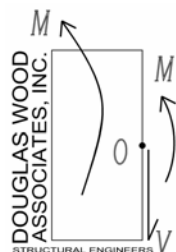

HISTORIC DISTRICT MAP



-  North Shore Historic District
-  North Shore Historic District
-  RM-1
-  Site

G-1.02 ZONING DATA

GENERAL	
ADDRESS	87th Street and Harding Avenue
FOLIO NUMBER	02-3202-000-0055
ZONING DISTRICT	RM-1
LOT AREA	1,204 SF
LOT WIDTH	25.265'
LOT DEPTH	46.78' (MEASURED DIAGONALLY AT LOT LINE)

SETBACK REQUIREMENTS	
	REQUIRED
BUILDING	
FRONT	20'-0" (WEST - HARDING AVE)
SIDE, FACING A STREET	7'-6" (NORTH - 87TH STREET)
SIDE, INTERIOR	7'-6" (SOUTH)
REAR	10% OF LOT DEPTH (EAST - ALLEY)

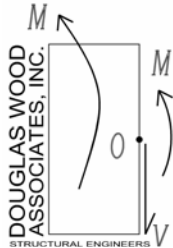

G-1.03 SITE PHOTOS

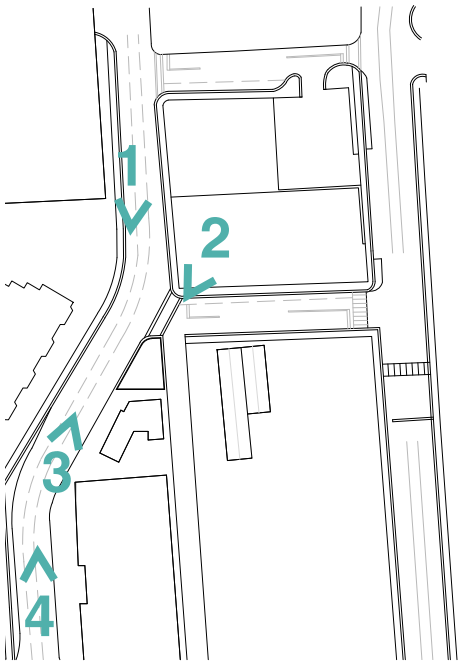

1



2



3



4

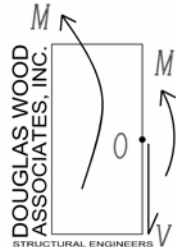

DOUGLAS WOOD ASSOCIATES, INC. STRUCTURAL ENGINEERS

Shulman + Associates **savinomiller**

G-1.04 PRECEDENT IMAGES



Lincoln Road Follies, Morris Lapidus

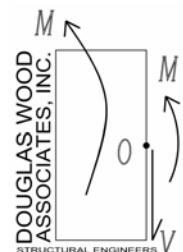

G-1.05 PRECEDENT IMAGES



Shelborne Hotel, Miami Beach



Howard Johnson Refreshment Center, Rufus Nims

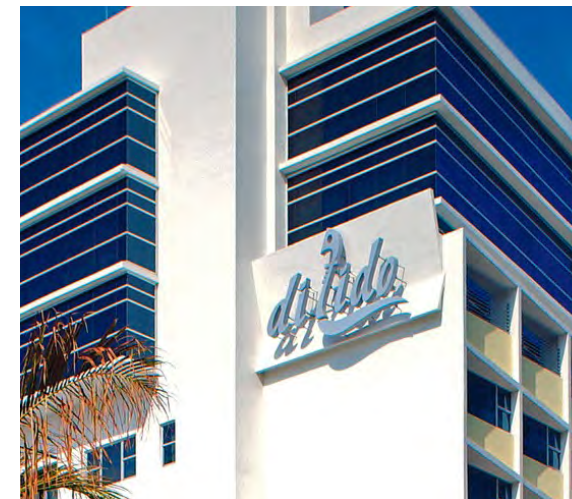

Di Lido Hotel, Miami Beach



North Beach Bandshell

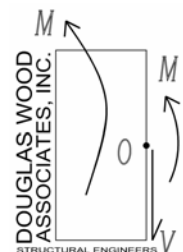

A-1.01 SITE PLAN AT CANOPY LEVEL

- Existing palm trees to remain
- Concrete canopy with stucco finish (white) slope for positive drainage
- 24" high concrete barrier/ retaining wall with stucco finish radiused top bellow
- New sable palm trees in canopy apertures

Existing crosswalk to remain

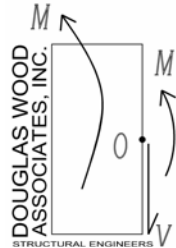
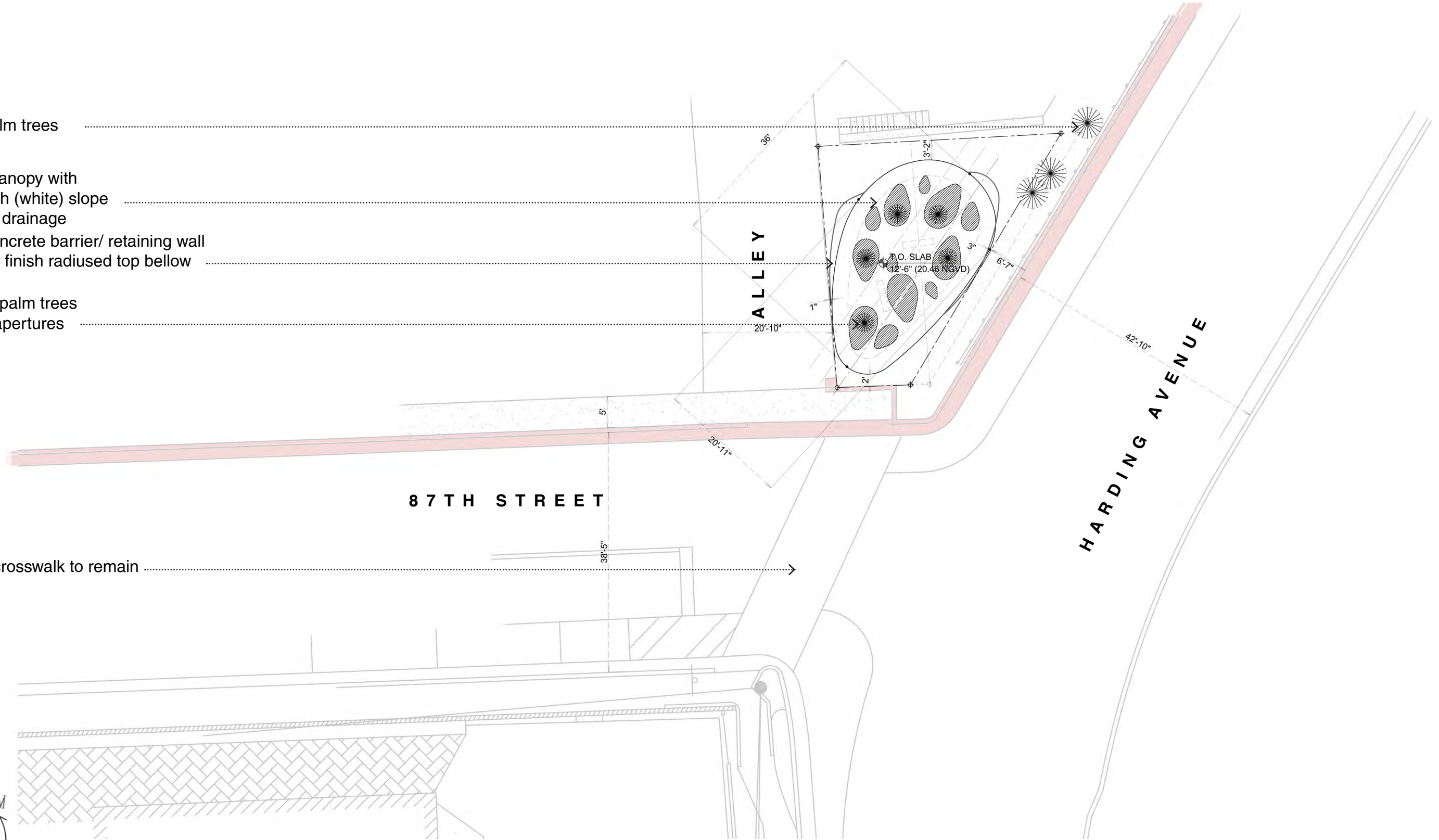

A-1.02 SITE PLAN AT GROUND LEVEL ENLARGED

Existing metal barrier to remain

Existing sign to remain

Existing aluminum light pole to remain

24" high concrete barrier/ retaining wall with stucco finish radiused top bellow

Concrete piers (painted variable colors)

Line of 6" curb and gutter

Existing crosswalk to remain

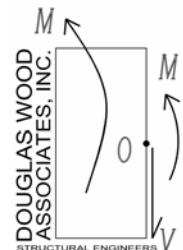

SCALE: 1/8" = 1'-0"

A-1.03 SITE PLAN AT CANOPY LEVEL ENLARGED

Existing palm trees to remain

Concrete canopy with stucco finish (white) slope for positive drainage

24" high concrete barrier/ retaining wall with stucco finish radiused top bellow

New sable palm trees in canopy apertures

Existing crosswalk to remain

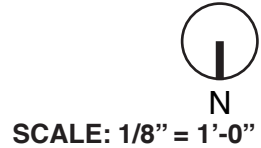
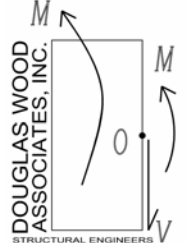
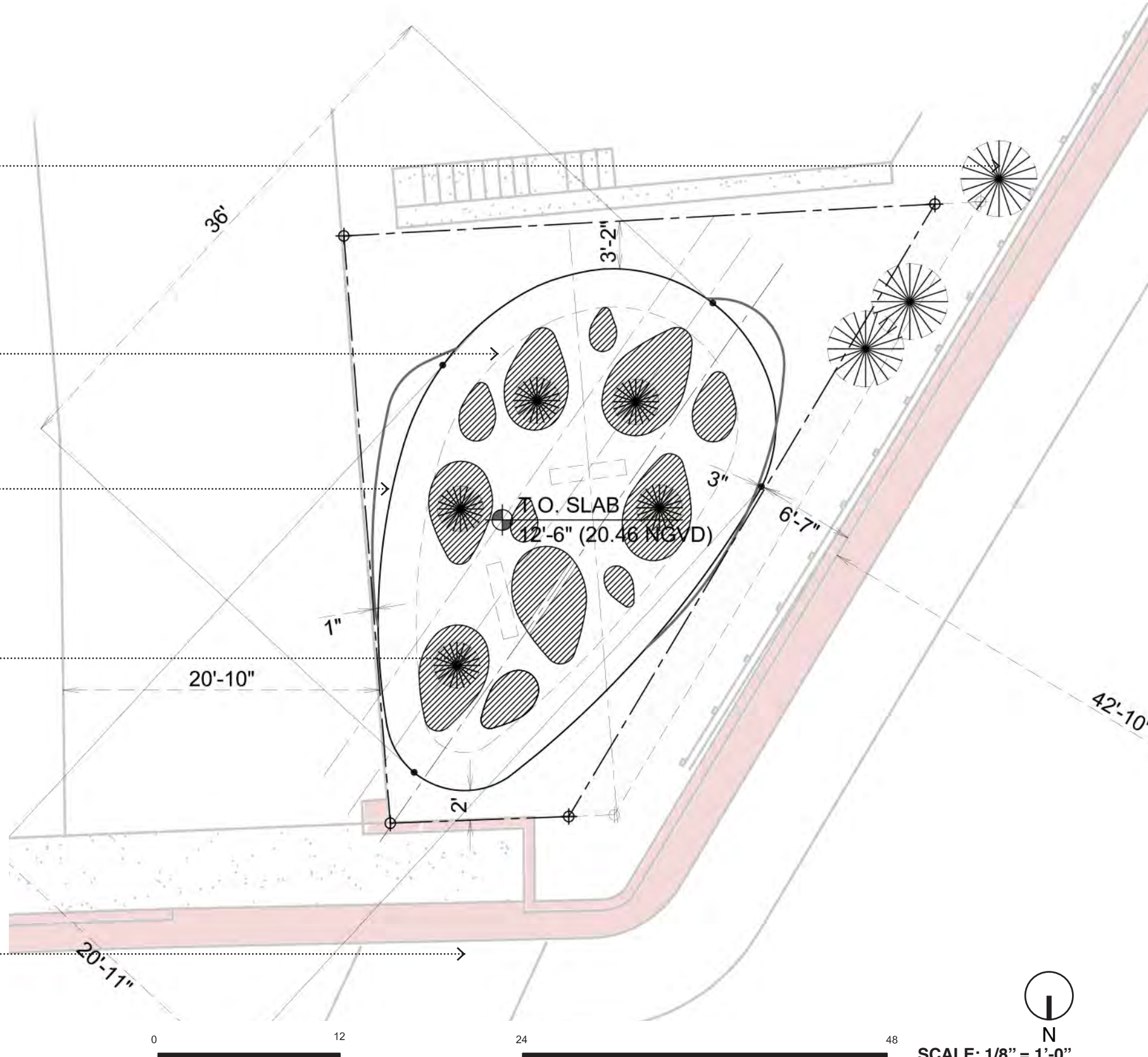

A-2.00 ELEVATION

Concrete canopy with stucco finish (white) slope for positive drainage

Illuminated powder coated perforated aluminum box letters with concealed dimmable LED lights

24" high concrete barrier/ retaining wall with stucco finish radiused top bellow

Lower planter

Line of 6" curb

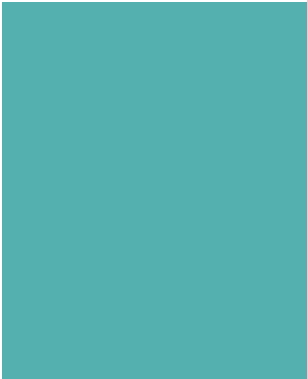
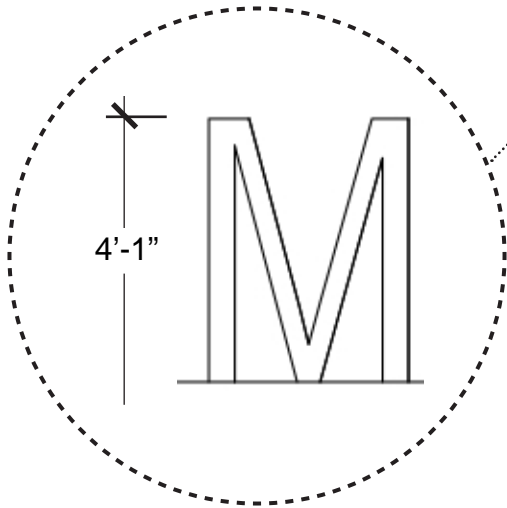
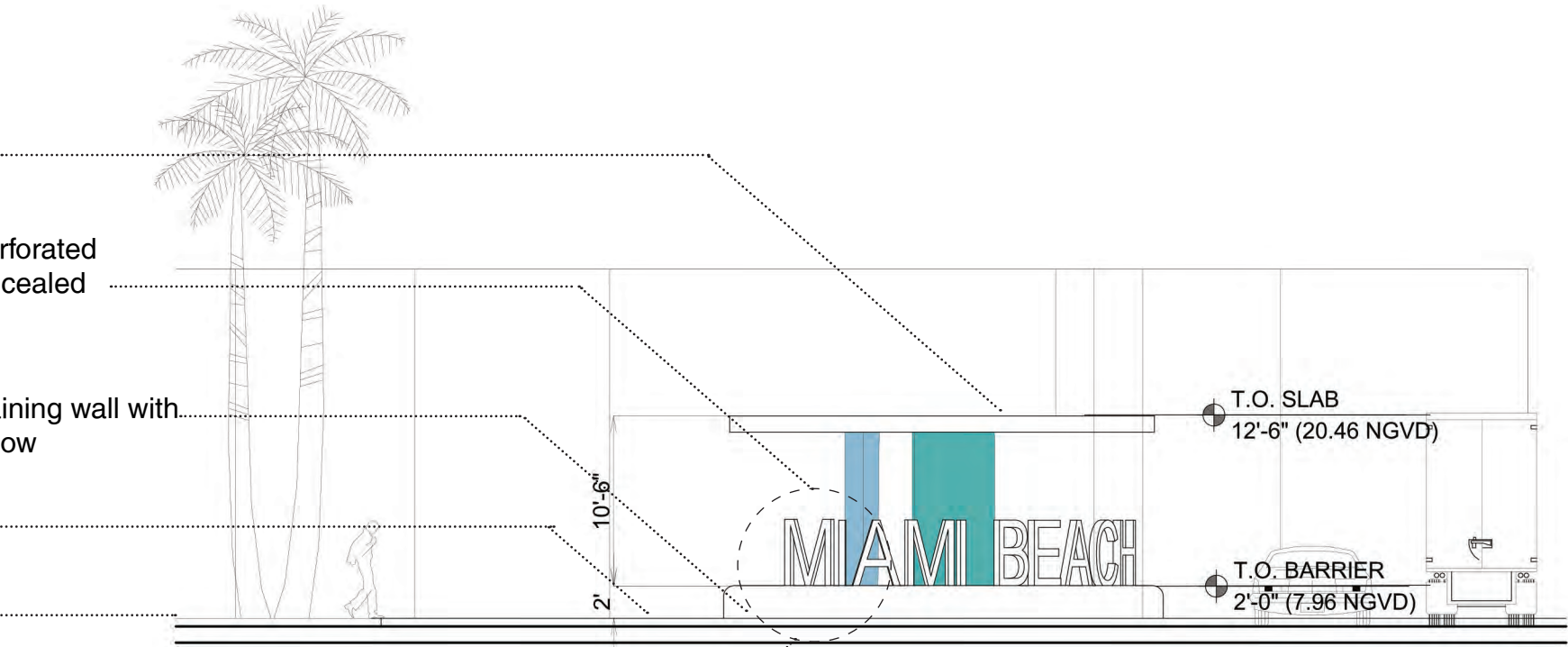

Pantone Blue Turquoise



Pantone Sky Blue

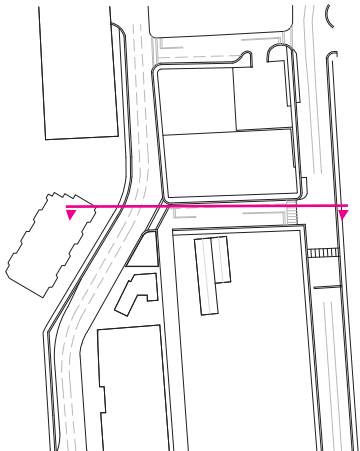

SCALE: 3/32" = 1'-0"

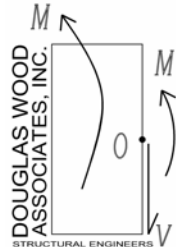

A-3.00 SECTION

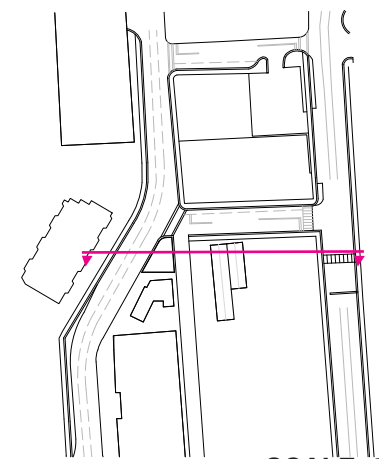
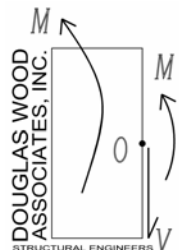
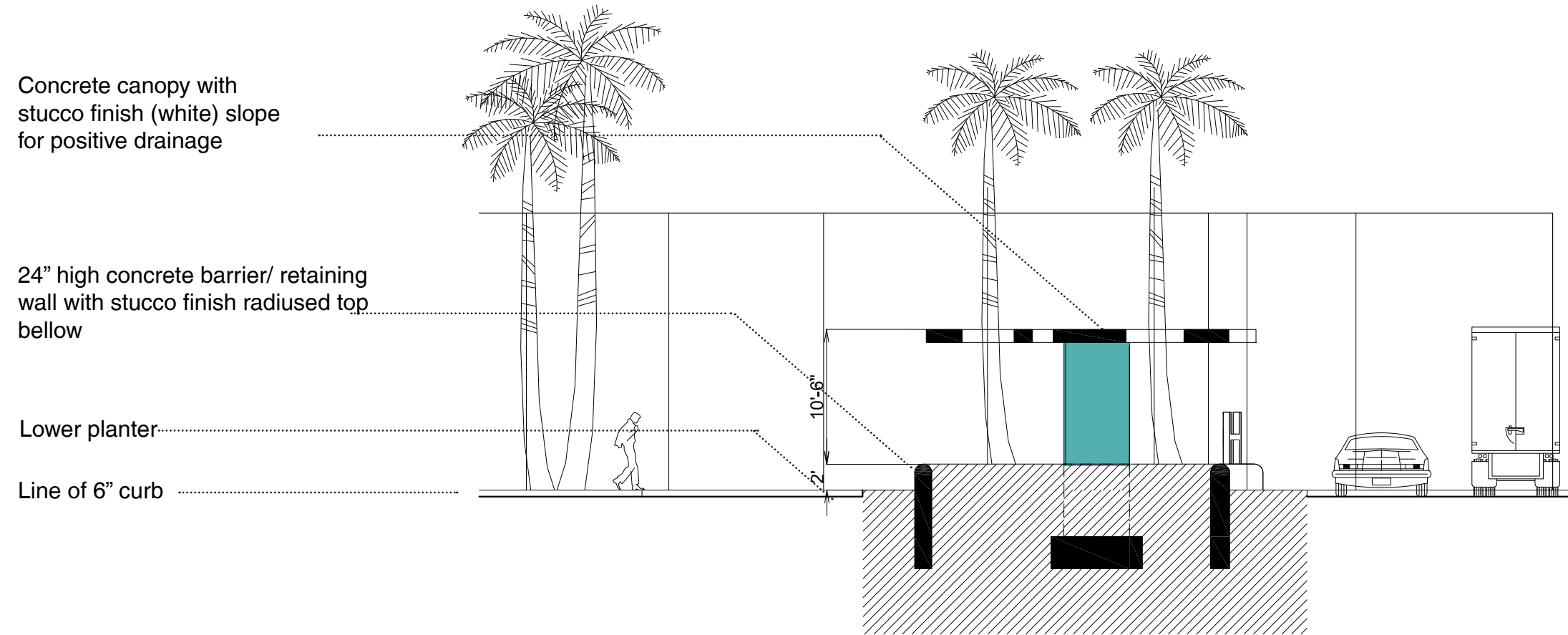

SCALE: 3/32" = 1'-0"

A-7.00 EXPLODED AXONOMETRIC

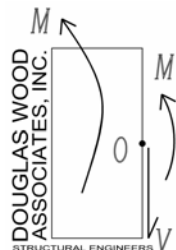

A-9.00 PERSPECTIVES



Site without City chevron road signs

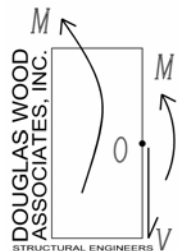

A-9.01 PERSPECTIVES



Site with City chevron road signs

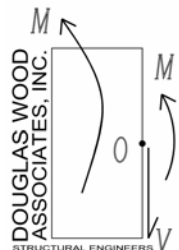

A-9.02 PERSPECTIVES

