

2022/07/07 P:\18 Gyms S:\PROJECTS\18000_Ocean Terrace\201703\DESIGN\LA\WORKING\CAD\Sheet\HPB_Sheet_18102_Pavilion Hardscape Plan.dwg



- KEY NOTES:**
- 1 CONCRETE STAIRS. REFER TO STRUCTURAL DRAWINGS.
 - 2 FURNITURE NIC.
 - 3 WOOD TRELLIS ABOVE.
 - 4 SERVICE ACCESS PATH TO BAR.
 - 5 CONCRETE ROOF UNDERBELLY OF CONCRETE TO BE IMPRINTED WITH EUCALYPTUS BOARDS. REFER TO REFLECTED CEILING PLAN.
 - 6 SERVICE GATE.
 - 7 BAR. FINAL BAR DESIGN IS NOT INCLUDED IN THIS PERMIT. BAR CONSULTANT SHALL COORDINATE SANITARY, WATER, DRAINS, DATA AND ELECTRICAL CONNECTIONS PRIOR TO CONSTRUCTION. FINAL POINT OF CONNECTION IS NOT INCLUDED IN THIS PERMIT.
 - 8 CONCRETE BENCH. REFER TO STRUCTURAL AND HARDSCAPE DRAWINGS FOR DETAILS.
 - 9 CONCRETE COLUMN. REFER TO STRUCTURAL DRAWINGS.
 - 10 CONCRETE PLANTER. REFER TO STRUCTURAL DRAWINGS.
 - 11 ROOF OPENING ABOVE.

jungles
 Landscape Architect FASLA
 2964 Aviation Avenue
 Coconut Grove, FL 33133
 Ph 305.658.6777 FAX 786.703.4382
 www.raymondjungles.com
 PROJECT NO.: 19000

HPB22-0517: Second First Submittal 06-21-22
OCEAN TERRACE
 OCEAN TERRACE, MIAMI BEACH, FL 33141

SUBMISSION:
 FIRST SUBMITTAL 04-18-22

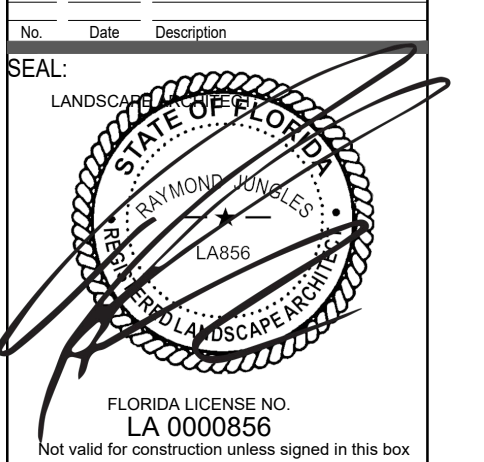

SHEET TITLE:
**PAVILION
 HARDSCAPE PLAN**

Scale: 1/8"=1'-0"
 Drawn By:
 Checked By:

SHEET NUMBER:
LH.102

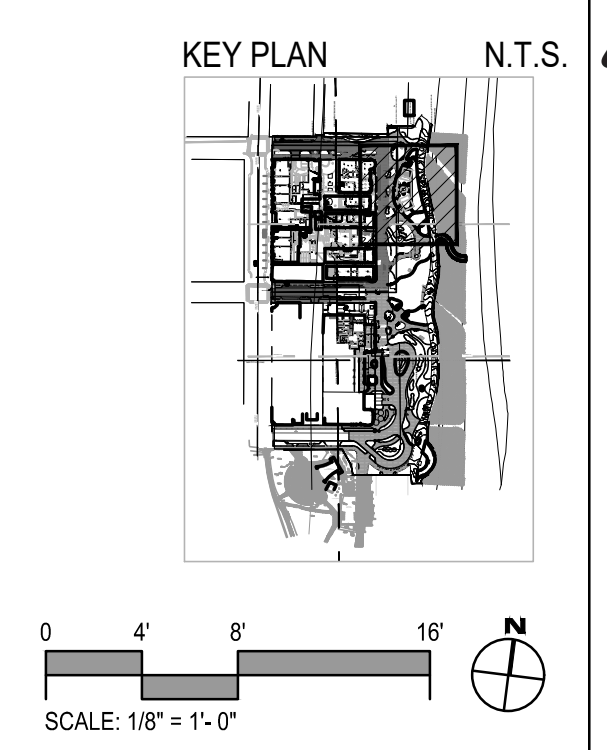

SCALE: 1/8" = 1'-0"

KEY NOTES:

- 1 CONCRETE ROOF SYSTEM. REFER TO STRUCTURAL AND LANDSCAPE DRAWINGS
- 2 ROOF DRAIN.
- 3 SINGLE PLY TPO ROOF SYSTEM OVER TONGUE AND GROOVE IPE WOOD. (TPO COLOR TO BE SELECTED BY LANDSCAPE ARCHITECT) REFER TO STRUCTURAL DRAWINGS.
- 4 CONCRETE BEAM STRUCTURE. REFER TO STRUCTURAL DRAWINGS
- 5 UNDERGROUND DRAIN PIPE. REFER TO CIVIL DRAWINGS.
- 6 OVERFLOW SCUPPER.
- 7 ROOF PLANTER. REFER TO STRUCTURAL AND LANDSCAPE DRAWINGS FOR DETAILS.
- 8 ROOF OPENING.

ROOF DRAIN DESIGN AREA CALCULATIONS:

2,409 SF/4 ROOF DRAINS = 602.3 SF PER ROOF DRAIN
 PER CPD MANUAL: (24"4)4.5 IN/HOUR RAINFALL RATE = 21.3 SF/GPM
 602.3 SF / 21.3 SF/GPM = 28.6 GPM PER ROOF DRAIN
 PER IPC, A 3" DIAMETER MINIMUM ROOF/OVERFLOW DRAIN CAN BE USED.



HPB22-0517: Second First Submittal 06-21-22
OCEAN TERRACE
 OCEAN TERRACE, MIAMI BEACH, FL 33141

SUBMISSION:
 FIRST SUBMITTAL 04-18-22

No.	Com.	Revised

SEAL:

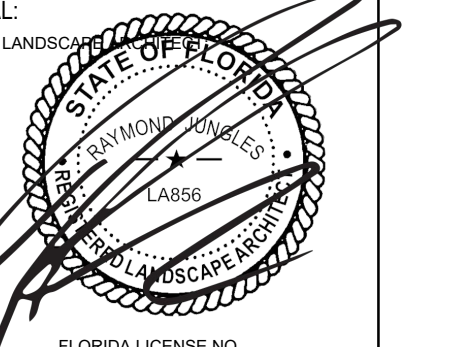

FLORIDA LICENSE NO.
 LA 0000856
 Not valid for construction unless signed in this box

SHEET TITLE:
**PAVILION
 ROOF PLAN**

Scale: 1/8"=1'-0"
 Drawn By: .
 Checked By: .

SHEET NUMBER:

LH.103

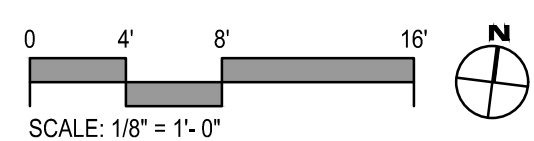
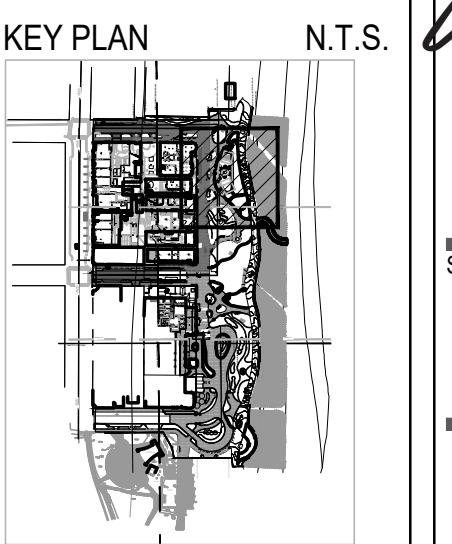

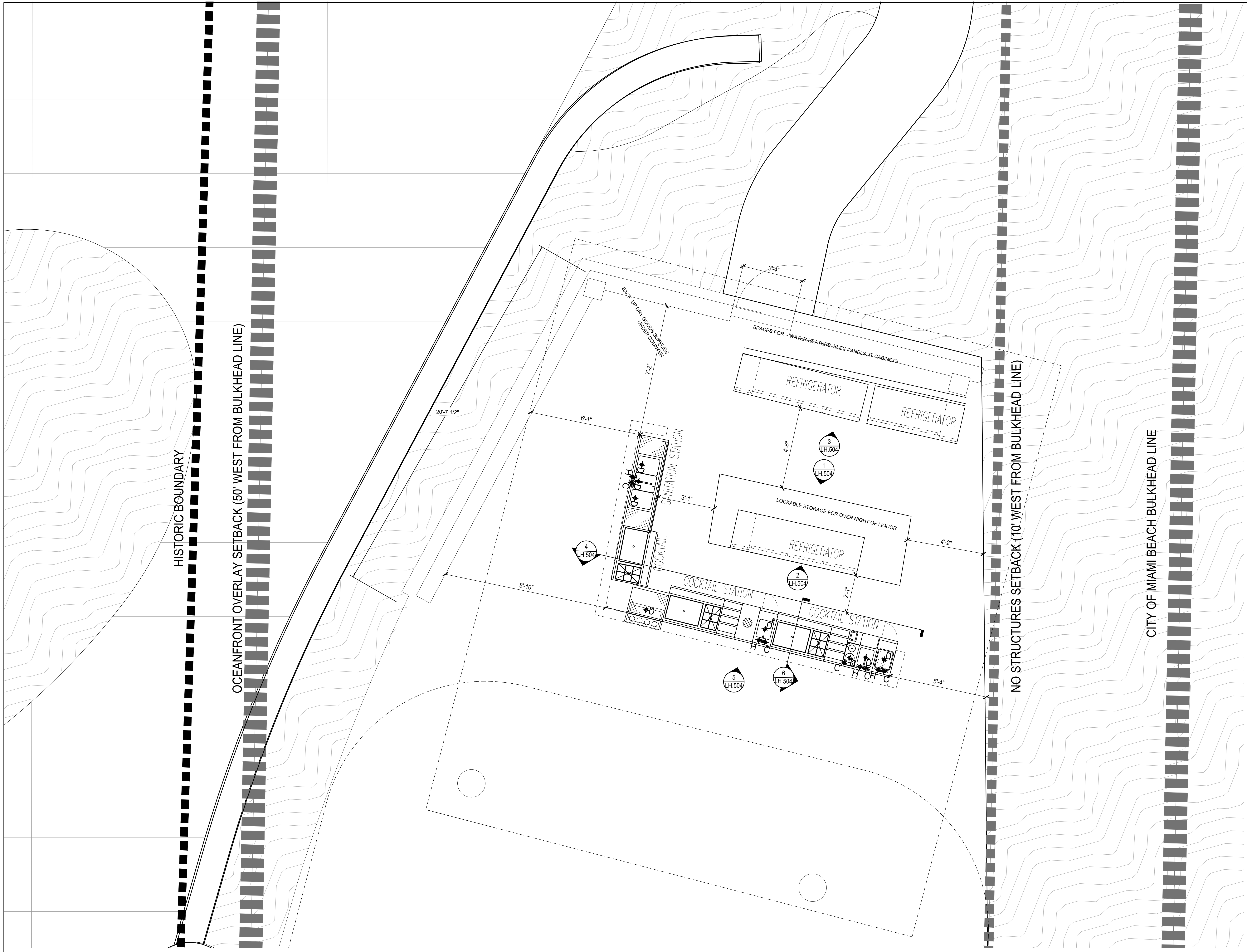

- KEY NOTES:**
- 1 CONCRETE STAIRS. REFER TO STRUCTURAL DRAWINGS.
 - 2 FURNITURE NIC.
 - 3 WOOD TRELLIS ABOVE.
 - 4 SERVICE ACCESS PATH TO BAR.
 - 5 CONCRETE ROOF UNDERBELLY OF CONCRETE TO BE IMPRINTED WITH EUCALYPTUS BOARDS. REFER TO REFLECTED CEILING PLAN.
 - 6 SERVICE GATE.
 - 7 BAR; FINAL BAR DESIGN IS NOT INCLUDED IN THIS PERMIT. BAR CONSULTANT SHALL COORDINATE SANITARY, WATER, DRAINS, DATA AND ELECTRICAL CONNECTIONS PRIOR TO CONSTRUCTION. FINAL POINT OF CONNECTION IS NOT INCLUDED IN THIS PERMIT.
 - 8 CONCRETE BENCH. REFER TO STRUCTURAL AND HARDSCAPE DRAWINGS FOR DETAILS.
 - 9 CONCRETE COLUMN. REFER TO STRUCTURAL DRAWINGS.
 - 10 CONCRETE PLANTER. REFER TO STRUCTURAL DRAWINGS.
 - 11 ROOF OPENING ABOVE.

jungles
 Landscape Architect FASLA
 2964 Aviation Avenue
 Coconut Grove, FL 33133
 PH 305.658.6777 FAX 786.703.4382
 www.raymondjungles.com
 PROJECT NO. 19000

HPB22-0517: Second First Submittal 06-21-22
OCEAN TERRACE
 OCEAN TERRACE, MIAMI BEACH, FL 33141

No.	Desc.	Revision

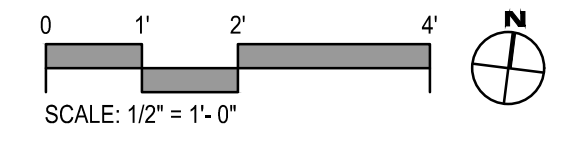
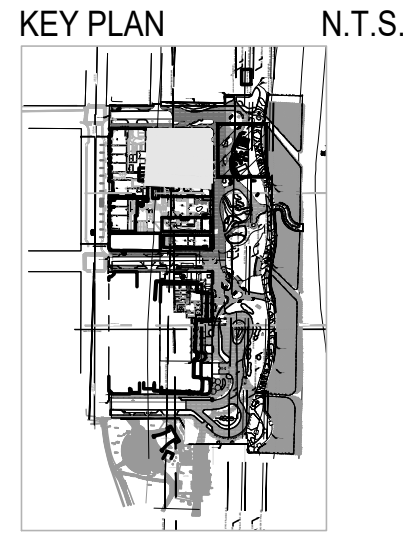
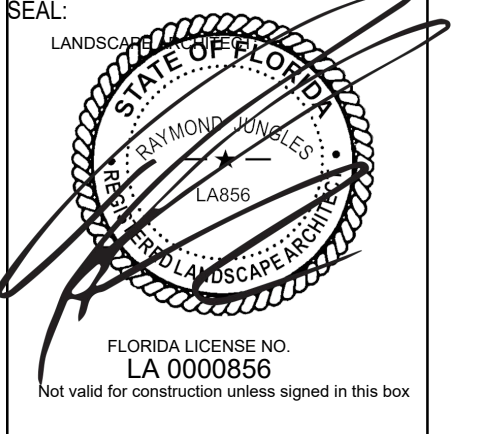

SHEET TITLE:
BAR ENLARGEMENT PLAN

Scale: 1/2"=1'-0"
 Drawn By:
 Checked By:

SHEET NUMBER:
LH.104

2022/07/06 PH: gyms S:\PROJECTS\19000_Ocean Terrace\2019\01 DESIGN\04 WORKING\CD\Sheet\HPB Sheet Set\19000_2_LH.104_Bar Enlargement Plan.dwg

BLOCK 9
ALTOS DEL MAR NO.1
PLAT BOOK 31, PAGE 40

BLOCK 8
ALTOS DEL MAR NO.1
PLAT BOOK 31, PAGE 40

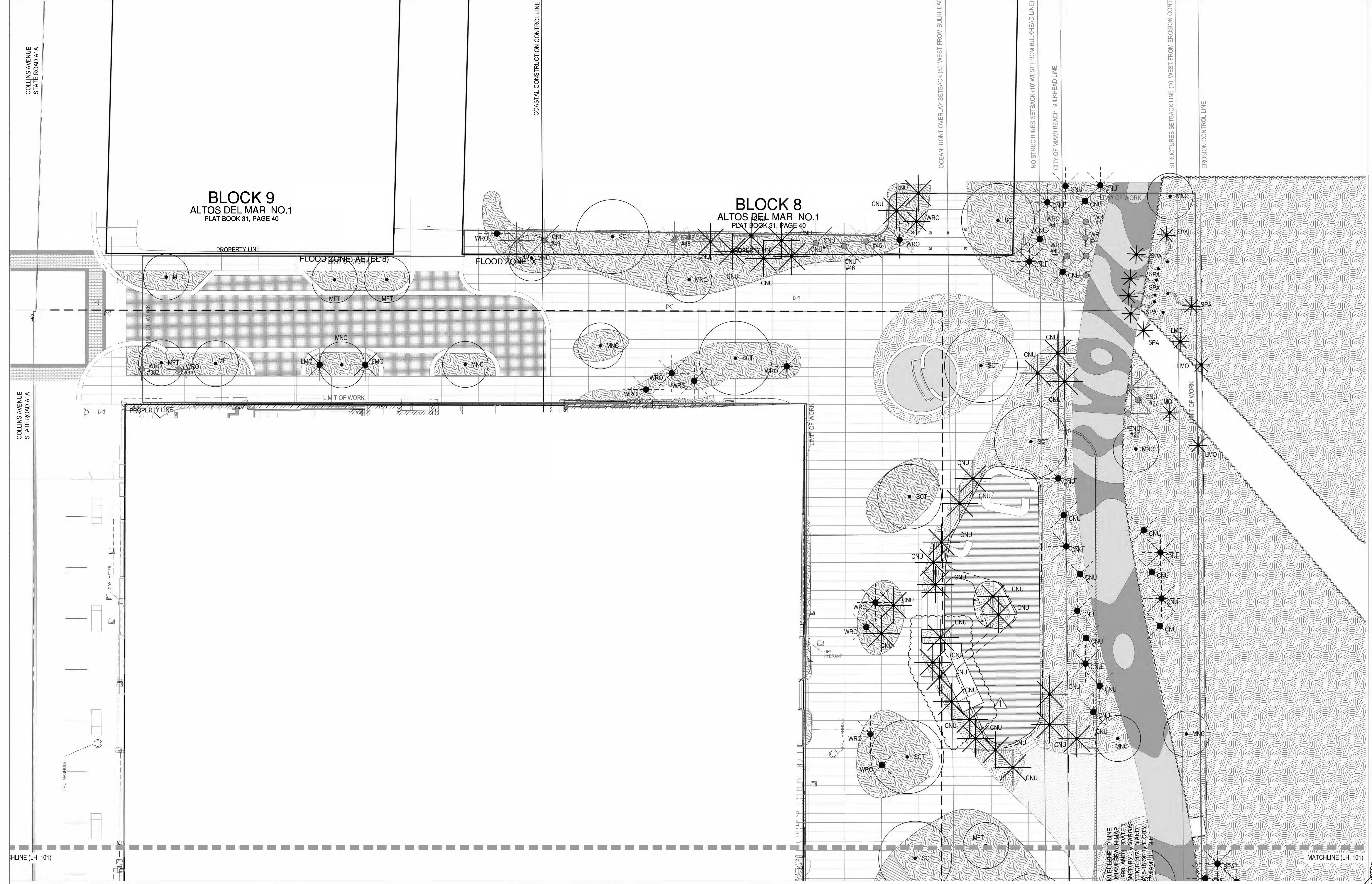

LINETYPE LEGEND		VEGETATION LEGEND	
PROPERTY LINE	—	EXISTING TO REMAIN	RELOCATED FROM ON-SITE
SETBACKS	---	TREE	TREE
LIMIT OF WORK	- - -	PALM	PALM
		PALM	PALM
		CHARACTER PALM	
		PLANTING AREA, TYP.	
		LAWN AREA, TYP.	
		EXISTING DUNE VEGETATION	

- GENERAL NOTES:**
- CONTRACTOR IS RESPONSIBLE FOR CALCULATING / VERIFYING ALL QUANTITIES.
 - GENERAL CONTRACTOR SHALL SUBMIT, OBTAIN AND KEEP RECORDS OF ALL PERMITTING REQUIRED BY LOCAL CODES.
 - ALL PLANT MATERIAL ARE TO BE APPROVED BY LANDSCAPE ARCHITECT PRIOR TO PROCUREMENT.
 - ALL PLANT MATERIALS AND ELEMENTS LOCATION / LAYOUT SHALL BE APPROVED BY LANDSCAPE ARCHITECT PRIOR TO INSTALLATION. LANDSCAPE ARCHITECT SHALL BE PROVIDED 3 WEEKS NOTIFICATION IN ADVANCE OF LAYOUT WORK, TO APPROVE ON-SITE FORM WORK, PRIOR TO FABRICATION.
 - REFER TO ARCHITECTURE DRAWINGS FOR PAVING PATTERNS.
 - REFER TO SHEET LP.300 FOR PLANTING SCHEDULE.
 - ALL UNDERGROUND UTILITIES SHALL BE VERIFIED IN FILED BY GENERAL CONTRACTOR PRIOR TO TREE AND PALM INSTALLATION.
 - ALL NEW UNDERGROUND UTILITIES SHALL BE COORDINATED WITH LANDSCAPE ARCHITECT PRIOR TO INSTALLATION.

PREVIOUSLY APPROVED

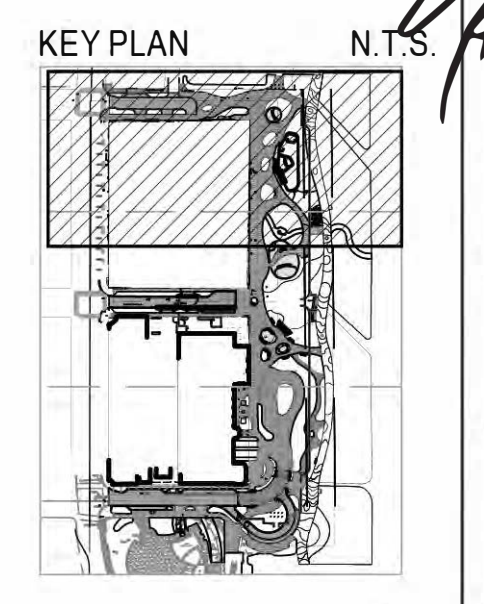

SCALE: 1/16" = 1'-0"

HPB22-0517: Second First Submittal 06-21-22
OCEAN TERRACE
OCEAN TERRACE, MIAMI BEACH, FL 33141

SUBMISSION:

No.	Date	Description

SEAL

FLORIDA LICENSE NO. LA 000856
Not valid for construction unless signed in this box.

SHEET TITLE: **CANOPY PLAN**

Scale: N.T.S.
Drawn By: _____
Checked By: _____
Date: 06/21/22
SHEET NUMBER: **LP.102**

20220520
Philip Byrnes
I:\M\F\21517_Diver\PROJECTS\19000_Ocean Terrace\2019\05\DESIGN\44 WORKING\CAD\Sheet\PS Sheet Set\19000_3_LH_102_Markets and Specifications.dwg

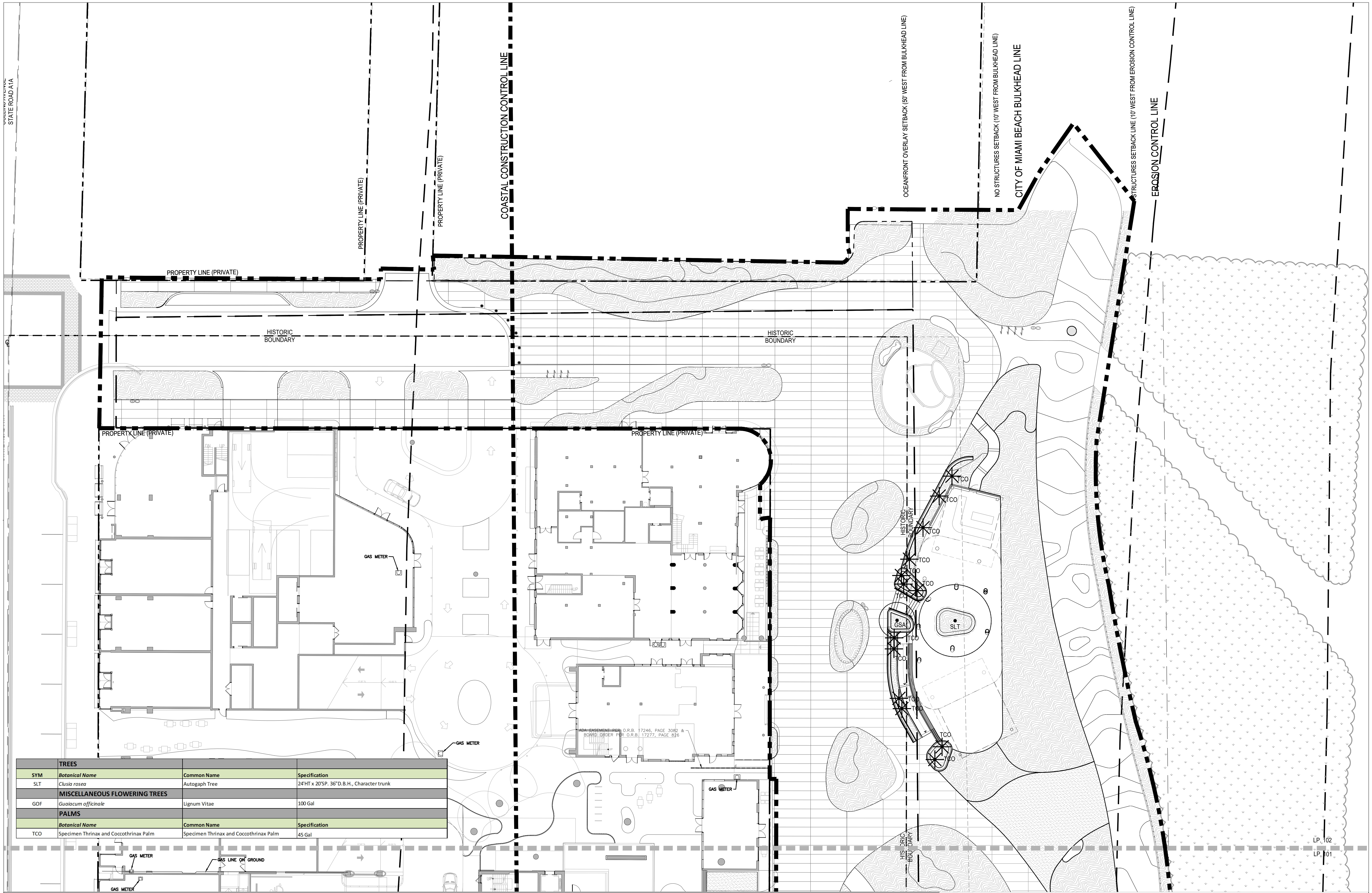

TREES			
SYM	Botanical Name	Common Name	Specification
SLT	<i>Clusia rosea</i>	Autograph Tree	24"HT x 20"SP, 36" O.B.H., Character trunk
MISCELLANEOUS FLOWERING TREES			
GOF	<i>Guaiacum officinale</i>	Lignum Vitae	100 Gal
PALMS			
TCO	Botanical Name	Common Name	Specification
	Specimen Thrinax and Coccolithrinax Palm	Specimen Thrinax and Coccolithrinax Palm	45 Gal

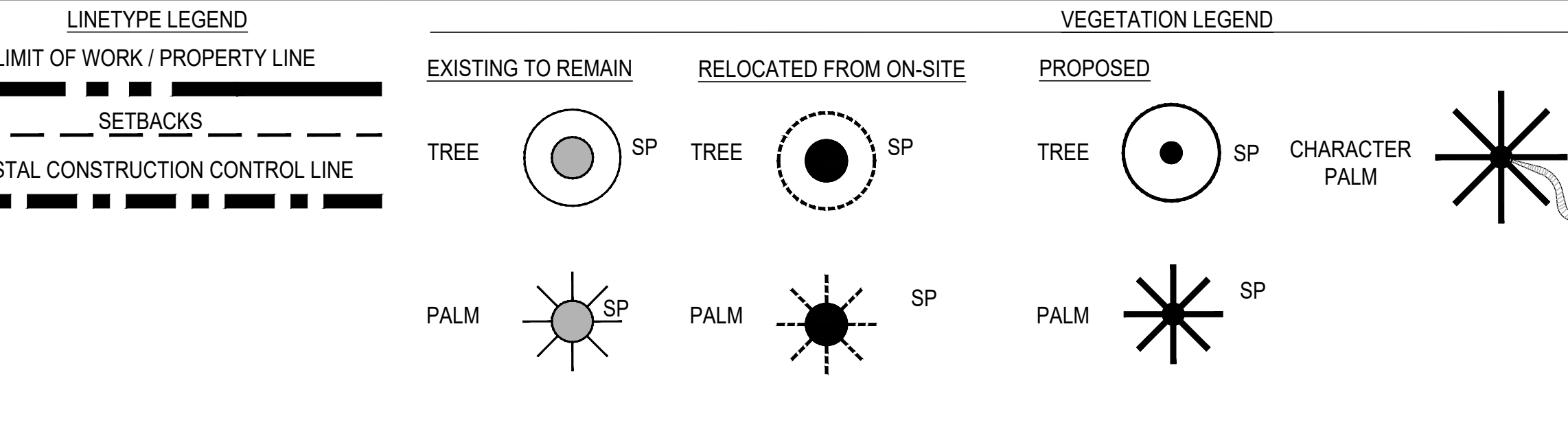

- GENERAL NOTES:**
- CONTRACTOR IS RESPONSIBLE FOR CALCULATING / VERIFYING ALL QUANTITIES.
 - GENERAL CONTRACTOR SHALL SUBMIT, OBTAIN AND KEEP RECORDS OF ALL PERMITTING REQUIRED BY LOCAL CODES.
 - ALL PLANT MATERIAL ARE TO BE APPROVED BY LANDSCAPE ARCHITECT PRIOR TO PROCUREMENT.
 - ALL PLANT MATERIALS AND ELEMENTS LOCATION / LAYOUT SHALL BE APPROVED BY LANDSCAPE ARCHITECT PRIOR TO INSTALLATION. LANDSCAPE ARCHITECT SHALL BE PROVIDED 3 WEEKS NOTIFICATION IN ADVANCE OF LAYOUT WORK, TO APPROVE ON-SITE FORM WORK, PRIOR TO FABRICATION.
 - REFER TO ARCHITECTURE DRAWINGS FOR PAVING PATTERNS.
 - REFER TO SHEET LP-300 FOR PLANTING SCHEDULE.
 - ALL UNDERGROUND UTILITIES SHALL BE VERIFIED IN FILED BY GENERAL CONTRACTOR PRIOR TO TREE AND PALM INSTALLATION.
 - ALL NEW UNDERGROUND UTILITIES SHALL BE COORDINATED WITH LANDSCAPE ARCHITECT PRIOR TO INSTALLATION.

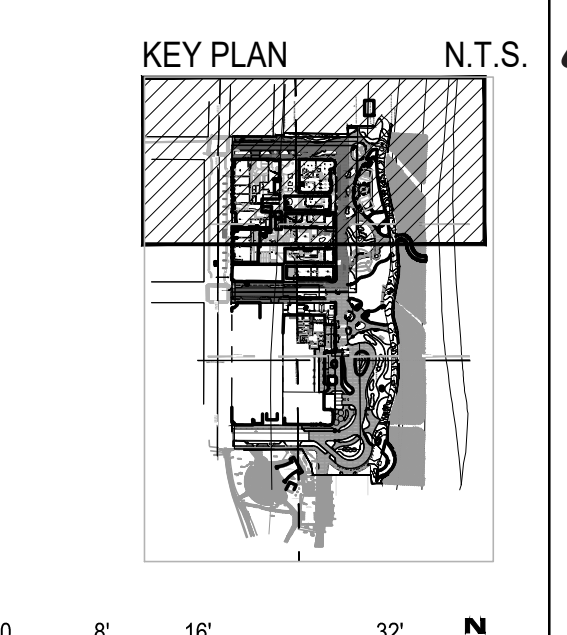

jungles
Landscape Architect FAS/LA
2964 Aviation Avenue
Coconut Grove, FL 33133
PH 305.858.6777 FAX 786.703.4382
www.raymondjungles.com
PROJECT NO. - 19000

HPB22-0517: Second First Submittal 06-21-22
OCEAN TERRACE
OCEAN TERRACE, MIAMI BEACH, FL 33141

NO.	DATE	DESCRIPTION
1	04-18-22	FIRST SUBMITTAL

FLORIDA LANDSCAPE ARCHITECTURE BOARD
LA 000856
Not valid for construction unless signed in this box.

SHEET TITLE:
CANOPY PLAN

Scale: 1/16" = 1'-0"
Drawn By:
Checked By:

SHEET NUMBER:
LP.102-A

2022/07/06 P:\19000 - Ocean Terrace\2019\20 DESIGN\LA WORKING\CAD\Sheet\LP.102_Canopy Plan.dwg

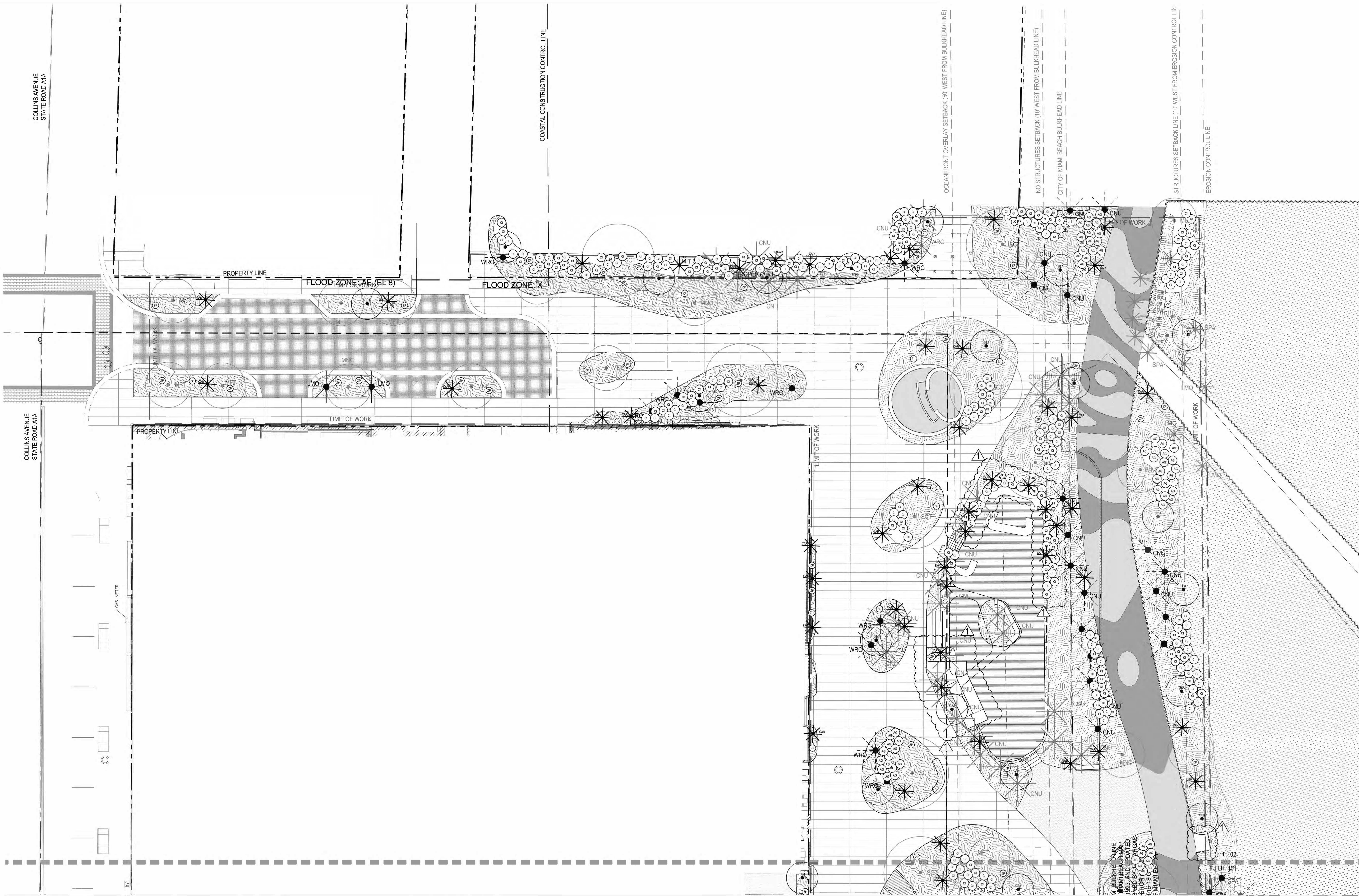

LINETYPE LEGEND

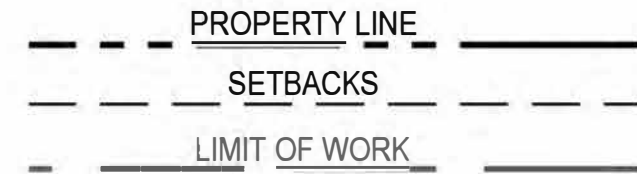

PROPOSED

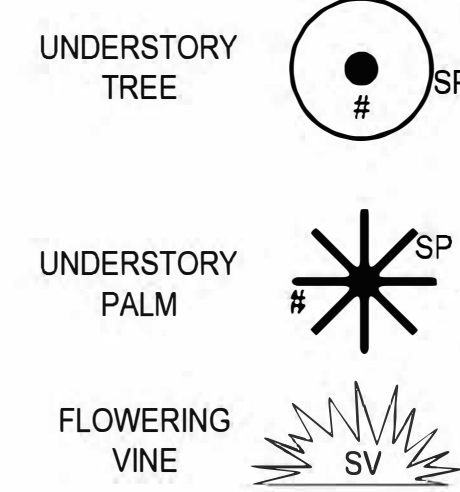

VEGETATION LEGEND

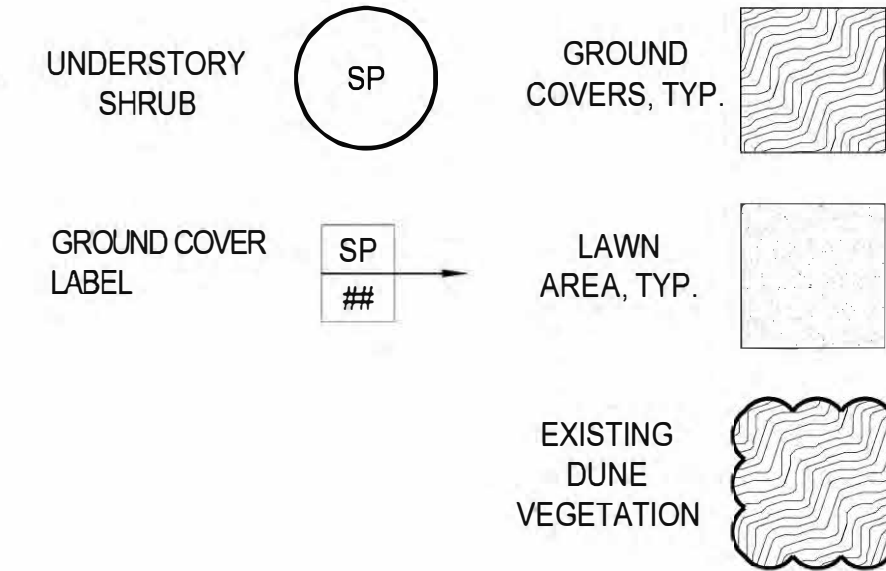

EXISTING TO REMAIN

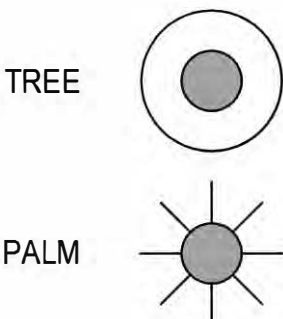

GENERAL NOTES:

1. CONTRACTOR IS RESPONSIBLE FOR CALCULATING / VERIFYING ALL QUANTITIES.
2. GENERAL CONTRACTOR SHALL SUBMIT, OBTAIN AND KEEP RECORDS OF ALL PERMITTING REQUIRED BY LOCAL CODES.
3. ALL PLANT MATERIAL ARE TO BE APPROVED BY LANDSCAPE ARCHITECT PRIOR TO PROCUREMENT.
4. ALL PLANT MATERIALS AND ELEMENTS LOCATION / LAYOUT SHALL BE APPROVED BY LANDSCAPE ARCHITECT PRIOR TO INSTALLATION. LANDSCAPE ARCHITECT SHALL BE PROVIDED 3 WEEKS NOTIFICATION IN ADVANCE OF LAYOUT WORK, TO APPROVE ON-SITE FORM WORK, PRIOR TO FABRICATION.
5. REFER TO SHEET LH 20 FOR PAVING LAYOUT.
6. REFER TO SHEET LP 30 FOR PLANTING SCHEDULE.
7. ALL UNDERGROUND UTILITIES SHALL BE VERIFIED IN FILED BY GENERAL CONTRACTOR PRIOR TO TREE AND PALM INSTALLATION.
8. ALL NEW UNDERGROUND UTILITIES SHALL BE COORDINATED WITH LANDSCAPE ARCHITECT PRIOR TO INSTALLATION.
9. ALL PLANTING AREAS SHALL RECEIVE 100% COVERAGE FROM AN AUTOMATIC IRRIGATION SYSTEM.

ALL UNDERSTORY PLANT MATERIAL SPECIFIED WITHIN THE VIEW CORRIDOR AREAS IN PUBLIC AND PRIVATE PROPERTY SHALL NOT NATURALLY EXCEED 36" IN HEIGHT AT MATURITY.



KEY PLAN N.T.S.

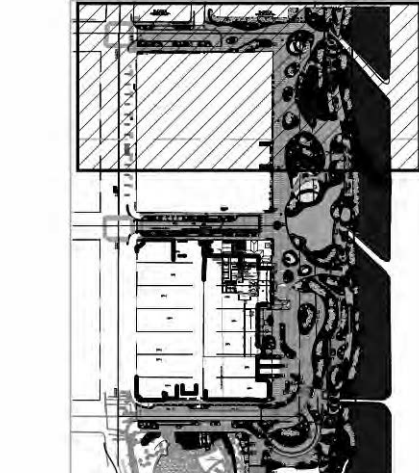

PREVIOUSLY APPROVED

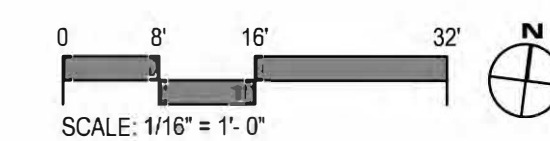

SUBMISSION:

No.	Date	Description

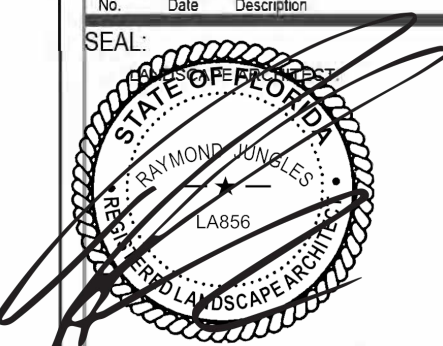

FLORIDA LICENSE NO. LA 000856
Not valid for construction unless signed in this box

SHEET TITLE: UNDERSTORY PLAN

Scale: N.T.S.
Drawn By: ...
Checked By: ...
Date: 06/21/22
SHEET NUMBER: **LP.202**

HPB22-0517: Second First Submittal 06-21-22
OCEAN TERRACE
OCEAN TERRACE, MIAMI BEACH, FL 33141

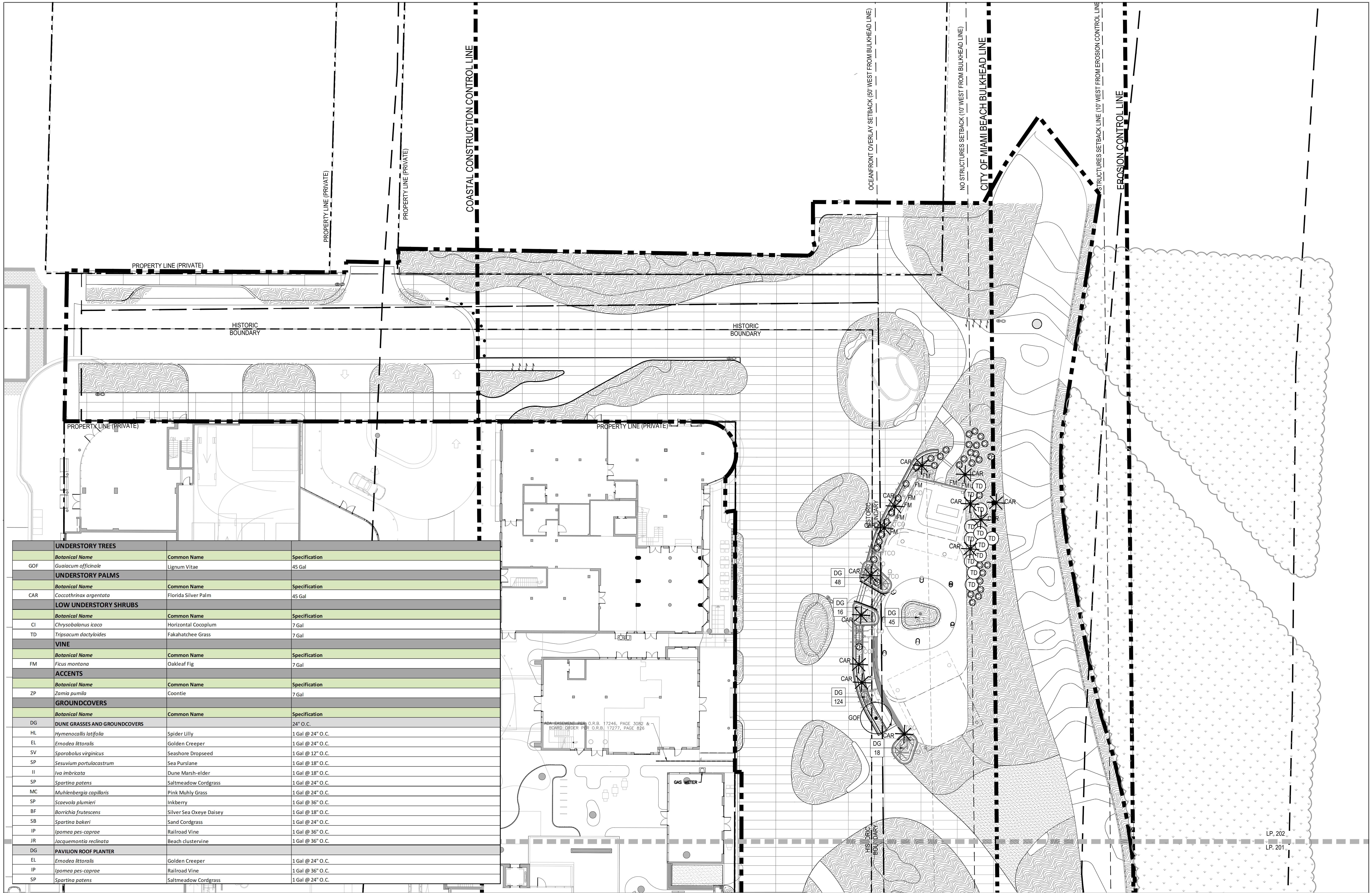

UNDERSTORY TREES			
Botanical Name	Common Name	Specification	
GOF	<i>Gualoum officinale</i>	Lignum Vitae	
UNDERSTORY PALMS			
Botanical Name	Common Name	Specification	
CAR	<i>Coccothrinax argentata</i>	Florida Silver Palm	
LOW UNDERSTORY SHRUBS			
Botanical Name	Common Name	Specification	
CI	<i>Chrysobalanus icaco</i>	Horizontal Cocoplum	
TD	<i>Tripsacum dactyloides</i>	Fakahatchee Grass	
VINE			
Botanical Name	Common Name	Specification	
FM	<i>Ficus montana</i>	Oakleaf Fig	
ACCENTS			
Botanical Name	Common Name	Specification	
ZP	<i>Zamia pumila</i>	Coontie	
GROUNDCOVERS			
Botanical Name	Common Name	Specification	
DUNE GRASSES AND GROUNDCOVERS			
DG	<i>Hymenocallis latifolia</i>	Spider Lilly	
HL	<i>Ernodea littoralis</i>	Golden Creeper	
EL	<i>Sporobolus virginicus</i>	Seashore Dropseed	
SV	<i>Sesuvium portulacastrum</i>	Sea Purslane	
SP	<i>Iva imbricata</i>	Dune Marsh-elder	
II	<i>Spartina patens</i>	Saltmeadow Cordgrass	
SP	<i>Muhlenbergia capillaris</i>	Pink Muhly Grass	
MC	<i>Scaevola plumieri</i>	Inkberry	
SP	<i>Barrichia frutescens</i>	Silver Sea Oxeye Daisy	
BF	<i>Spartina bakeri</i>	Sand Cordgrass	
SB	<i>Ipomea pes-caprae</i>	Railroad Vine	
IP	<i>Jacquemontia reclinata</i>	Beach clustervine	
JR	PAVILION ROOF PLANTER		
DG	<i>Ernodea littoralis</i>	Golden Creeper	
EL	<i>Ipomea pes-caprae</i>	Railroad Vine	
IP	<i>Spartina patens</i>	Saltmeadow Cordgrass	
SP			

LINETYPE LEGEND

- LIMIT OF WORK / PROPERTY LINE
- SETBACKS
- COASTAL CONSTRUCTION CONTROL LINE
- WATER

PROPOSED

- UNDERSTORY TREE
- UNDERSTORY PALM
- FLOWERING VINE

VEGETATION LEGEND

- UNDERSTORY SHRUB
- GROUND COVER LABEL
- GROUNDCOVERS, TYP.
- LAWN AREA, TYP.
- EXISTING DUNE VEGETATION

EXISTING TO REMAIN

- TREE
- PALM

- GENERAL NOTES:**
- CONTRACTOR IS RESPONSIBLE FOR CALCULATING / VERIFYING ALL QUANTITIES.
 - GENERAL CONTRACTOR SHALL SUBMIT, OBTAIN AND KEEP RECORDS OF ALL PERMITTING REQUIRED BY LOCAL CODES.
 - ALL PLANT MATERIAL ARE TO BE APPROVED BY LANDSCAPE ARCHITECT PRIOR TO PROCUREMENT.
 - ALL PLANT MATERIALS AND ELEMENTS LOCATION / LAYOUT SHALL BE APPROVED BY LANDSCAPE ARCHITECT PRIOR TO INSTALLATION. LANDSCAPE ARCHITECT SHALL BE PROVIDED 3 WEEKS NOTIFICATION IN ADVANCE OF LAYOUT WORK, TO APPROVE ON-SITE FORM WORK, PRIOR TO FABRICATION.
 - REFER TO SHEET LH.20 FOR PAVING LAYOUT.
 - REFER TO SHEET LP.30 FOR PLANTING SCHEDULE.
 - ALL UNDERGROUND UTILITIES SHALL BE VERIFIED IN FILED BY GENERAL CONTRACTOR PRIOR TO TREE AND PALM INSTALLATION.
 - ALL NEW UNDERGROUND UTILITIES SHALL BE COORDINATED WITH LANDSCAPE ARCHITECT PRIOR TO INSTALLATION.
 - ALL PLANTING AREAS SHALL RECEIVE 100% COVERAGE FROM AN AUTOMATIC IRRIGATION SYSTEM.

KEY PLAN N.T.S.

SCALE: 1/16" = 1'-0"

HPB22-0517: Second First Submittal 06-21-22
OCEAN TERRACE
OCEAN TERRACE, MIAMI BEACH, FL 33141

SUBMISSION:
FIRST SUBMITTAL 04-18-22

SEAL:
LANDSCAPE ARCHITECT
RAYMOND JUNGLES
FLORIDA LICENSE NO. LA 000856
Not valid for construction unless signed in this box.

SHEET TITLE:
UNDERSTORY PLAN

Scale: 1/16"=1'-0"
Drawn By:
Checked By:
Date: 06/14/2021

SHEET NUMBER:
LP.202-A

2/22/2018
 P:\19\19000_Coastal\Ocean Terrace\201903\DESIGN\LA\WORKING\CD\Sheets\LP\Sheet LP.202_Understory Plan.dwg
 SUPPROJECTS\19000_Coastal\Ocean Terrace\201903\DESIGN\LA\WORKING\CD\Sheets\LP\Sheet LP.202_Understory Plan.dwg
 P:\19\19000_Coastal\Ocean Terrace\201903\DESIGN\LA\WORKING\CD\Sheets\LP\Sheet LP.202_Understory Plan.dwg

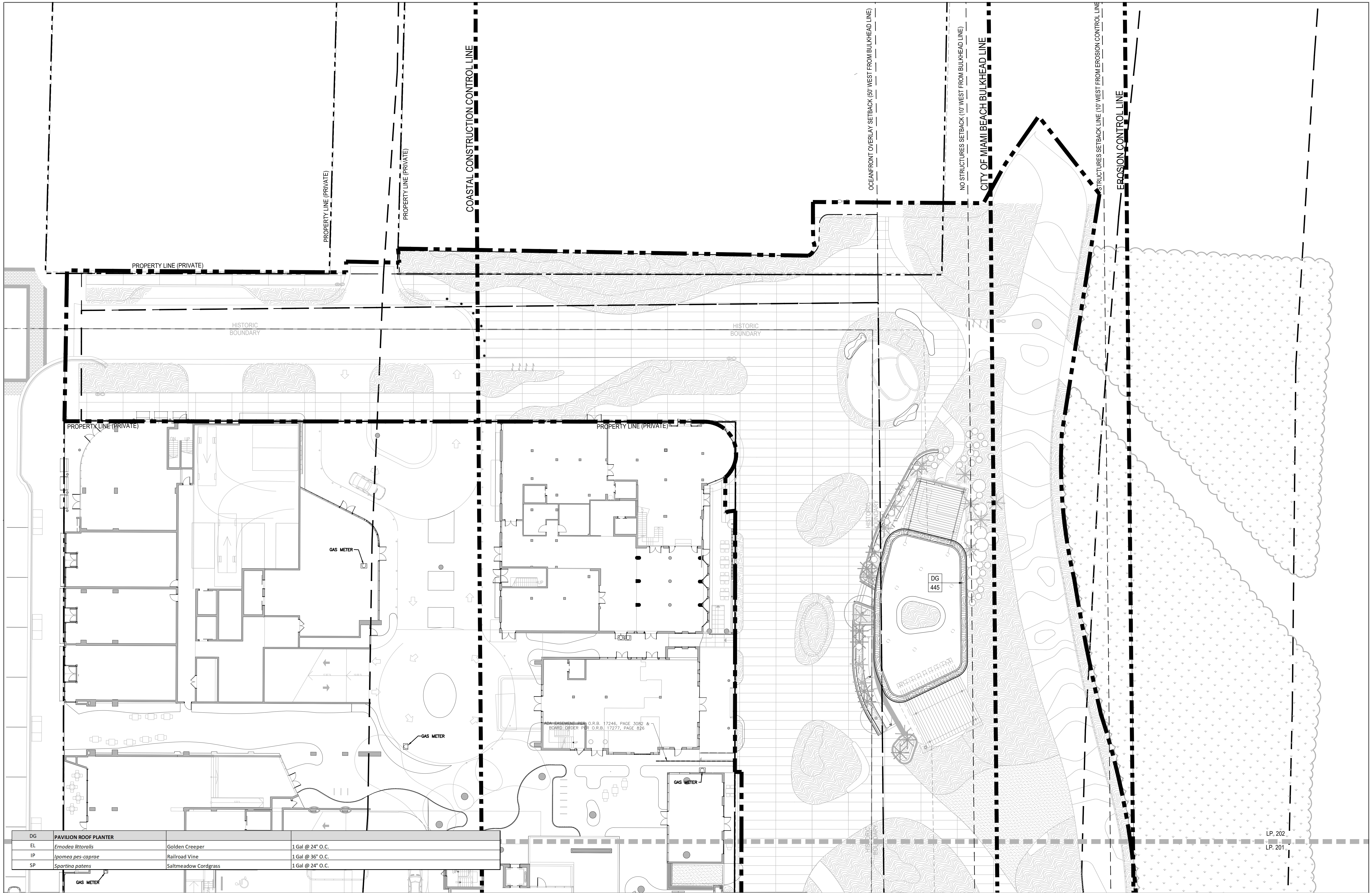

DG	PAVILION ROOF PLANTER		
EL	<i>Ernodea littoralis</i>	Golden Creeper	1 Gal @ 24" O.C.
IP	<i>Ipomea pes-caprae</i>	Railroad Vine	1 Gal @ 36" O.C.
SP	<i>Spartina patens</i>	Saltmeadow Cordgrass	1 Gal @ 24" O.C.

LINETYPE LEGEND

LIMIT OF WORK / PROPERTY LINE
SETBACKS

COASTAL CONSTRUCTION CONTROL LINE

WATER

PROPOSED

UNDERSTORY TREE

UNDERSTORY PALM

FLOWERING VINE

VEGETATION LEGEND

UNDERSTORY SHRUB

GROUND COVER LABEL

GROUND COVERS, TYP.

LAWN AREA, TYP.

EXISTING DUNE VEGETATION

EXISTING TO REMAIN

TREE

PALM

- GENERAL NOTES:**
- CONTRACTOR IS RESPONSIBLE FOR CALCULATING / VERIFYING ALL QUANTITIES.
 - GENERAL CONTRACTOR SHALL SUBMIT, OBTAIN AND KEEP RECORDS OF ALL PERMITTING REQUIRED BY LOCAL CODES.
 - ALL PLANT MATERIAL ARE TO BE APPROVED BY LANDSCAPE ARCHITECT PRIOR TO PROCUREMENT.
 - ALL PLANT MATERIALS AND ELEMENTS LOCATION / LAYOUT SHALL BE APPROVED BY LANDSCAPE ARCHITECT PRIOR TO INSTALLATION. LANDSCAPE ARCHITECT SHALL BE PROVIDED 3 WEEKS NOTIFICATION IN ADVANCE OF LAYOUT WORK, TO APPROVE ON-SITE FORM WORK, PRIOR TO FABRICATION.
 - REFER TO SHEET LH.20 FOR PAVING LAYOUT.
 - REFER TO SHEET LP.30 FOR PLANTING SCHEDULE.
 - ALL UNDERGROUND UTILITIES SHALL BE VERIFIED IN FILED BY GENERAL CONTRACTOR PRIOR TO TREE AND PALM INSTALLATION.
 - ALL NEW UNDERGROUND UTILITIES SHALL BE COORDINATED WITH LANDSCAPE ARCHITECT PRIOR TO INSTALLATION.
 - ALL PLANTING AREAS SHALL RECEIVE 100% COVERAGE FROM AN AUTOMATIC IRRIGATION SYSTEM.

KEY PLAN N.T.S.

SCALE: 1/16" = 1'-0"

HPB22-0517: Second First Submittal 06-21-22
OCEAN TERRACE
OCEAN TERRACE, MIAMI BEACH, FL 33141

SUBMISSION:
FIRST SUBMITTAL 04-18-22

SEAL:
LANDSCAPE ARCHITECT
RAYMOND JUNGLES
FLORIDA LICENSE NO. LA 0000856
Not valid for construction unless signed in this box

SHEET TITLE:
ROOF UNDERSTORY PLAN

Scale: 1/16"=1'-0"
Drawn By:
Checked By:
Date: 06/14/2021

SHEET NUMBER:
LP.203

2022/07/07 P:\19\19000_Coconut Terrace\201901\DESIGN\LA\WORKING\CD\Sheet\LP\Sheet LP.203_Understory Plan.dwg
 2022/07/07 P:\19\19000_Coconut Terrace\201901\DESIGN\LA\WORKING\CD\Sheet\LP\Sheet LP.203_Understory Plan.dwg