

# 1685 COLLINS HOTEL GARDEN

1685 COLLINS AVE., MIAMI BEACH, FL 33139

Historic Preservation Board Submittal - December 03, 2021

Prepared for:

Eldridge 17th Street Holdings, LLC  
350 Park Ave 14th Floor  
New York, NY 10022

Prepared by:

## jungles

Raymond Jungles, Inc.  
**Landscape Architect**

2964 Aviation Ave.  
Coconut Grove, FL 33133  
P: 305.858.6777  
www.raymondjungles.com  
Florida License No. LA 0000856

Sheet #	Drawing Index	HISTORIC PRESERVATION BOARD SUBMITTAL (12/03/2021)
LR.101	TREE DISPOSITION PLAN - WEST	•
LR.102	TREE DISPOSITION PLAN - CENTER	•
LR.103	TREE DISPOSITION PLAN - EAST	•
LR.200	TREE DISPOSITION SCHEDULE	•
LR.201	TREE DISPOSITION NOTES & DETAILS	•

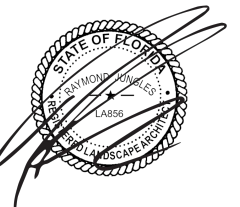

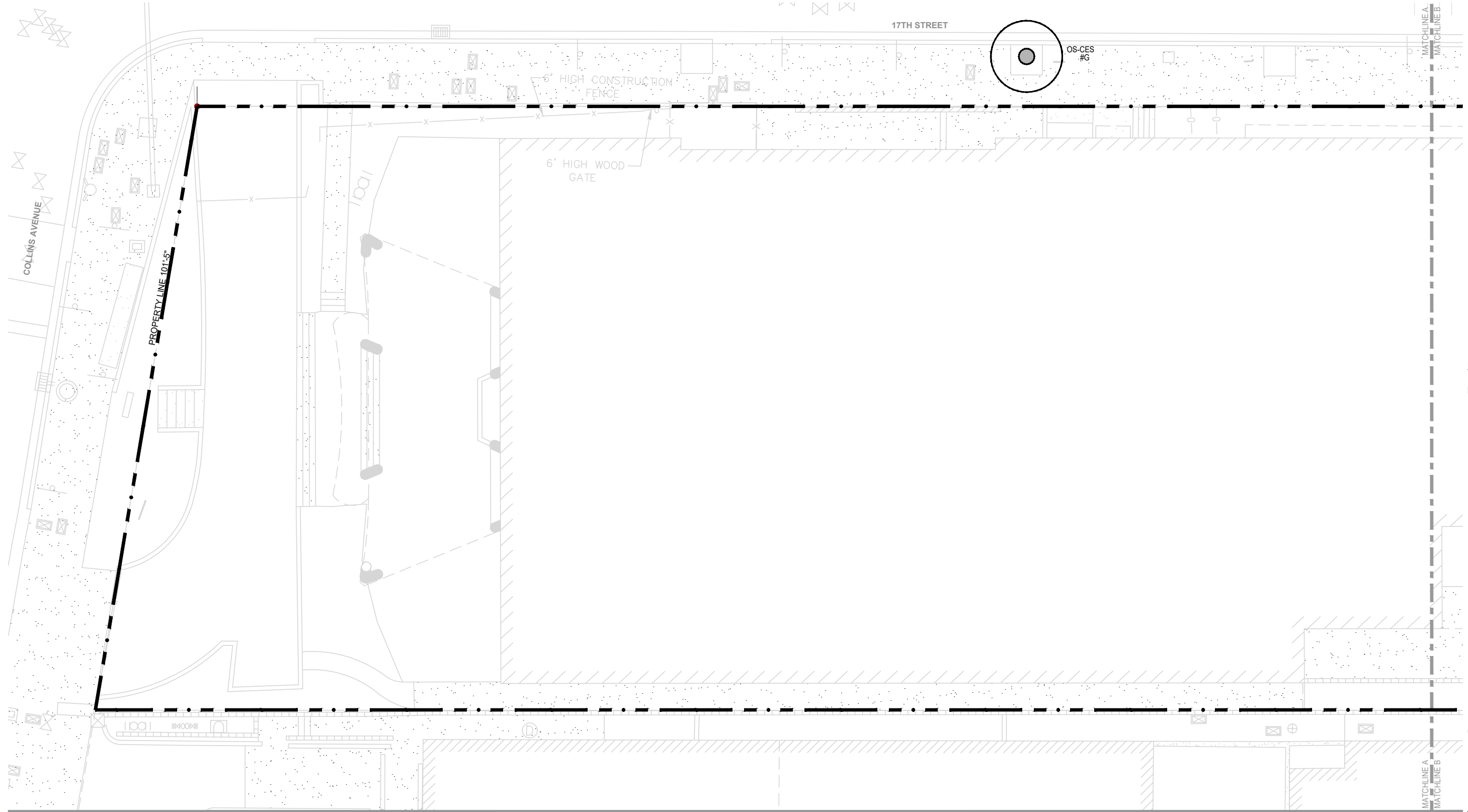

**TREE  
DISPOSITION  
PLAN - WEST**

LANDSCAPE ARCHITECT: RAYMOND JUNGLES

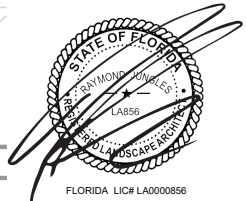

ALL DRAWINGS AND WRITTEN MATERIAL APPEARING HEREIN CONSTITUTE THE ORIGINAL AND UNPUBLISHED WORK OF STUDIO MCG ARCHITECTURE, INC. AND MAY NOT BE DUPLICATED, USED OR DISCLOSED WITHOUT THE EXPRESS WRITTEN CONSENT OF STUDIO MCG ARCHITECTURE, INC. (c) 2021

SCALE: 1/8" = 1'-0"  
CHECK: JS  
DATE: 12/03/2021  
SHEET NUMBER

**LEGEND**

	EXISTING TO REMAIN	EXISTING TO BE RELOCATED	EXISTING TO BE REMOVED	EXISTING OFF-SITE TO REMAIN
TREE				
PALM			N/A	

**GENERAL NOTES:**

- TREE SURVEY BASED ON ALL AVAILABLE INFORMATION. CONTRACTOR TO REPORT ALL DISCREPANCIES TO LANDSCAPE ARCHITECT FOR REVIEW PRIOR TO CONSTRUCTION. RAYMOND JUNGLES, INC. (RJI) MAY ASSIST WITH THE TAGGING OF ALL TREES IN THE FIELD.
- ALL TREES TO BE RELOCATED SHALL BE ROOT PRUNED A MINIMUM OF 60 DAYS PRIOR TO THEIR RELOCATION AND SHOULD BE SETUP ON A CONTROLLED IRRIGATION SYSTEM DURING THIS TIME. RJI WILL ALSO OVERSEE ANY RECOMMENDATIONS FOR FURTHER MODIFICATIONS TO ANY EXISTING MATERIAL.
- ALL PITS TO BE FILLED THE SAME DAY OF REMOVAL OF TREES. RESTORE SURFACE WITH SOD OR MULCH TO MATCH EXISTING CONDITIONS.
- CONTRACTOR SHALL VERIFY ALL EXISTING ABOVE AND UNDERGROUND UTILITIES 48 HOURS PRIOR TO ANY ON SITE EXCAVATION.
- REVIEW ADDITIONAL NOTES AND DETAILS ON SHEET LR.201 FOR RELOCATED MATERIAL.
- SEE LR.200 FOR TREE DISPOSITION SCHEDULE.
- REFER TO LANDSCAPE PLANS FOR FINAL LOCATION OF RELOCATED TREES.
- ALL WORK AND/OR IMPROVEMENTS WITHIN THE RIGHT-OF-WAY, INCLUDING LANDSCAPING AND IRRIGATION, REQUIRES A SEPARATE CITY OF MIAMI BEACH PUBLIC WORKS DEPARTMENT RIGHT-OF-WAY CONSTRUCTION PERMIT.

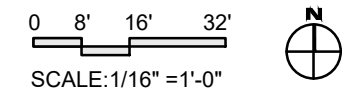

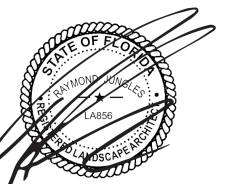

FLORIDA LIC# LA000856  
ALL DRAWINGS AND WRITTEN MATERIAL APPEARING HEREIN CONSTITUTE THE ORIGINAL AND UNPUBLISHED WORK OF STUDIO MCG ARCHITECTURE, INC. AND MAY NOT BE DUPLICATED, USED OR DISCLOSED WITHOUT THE EXPRESS WRITTEN CONSENT OF STUDIO MCG ARCHITECTURE, INC. (c) 2021  
SCALE: 1/8" = 1'-0"  
CHECK: JS  
DATE: 12/03/2021  
SHEET NUMBER

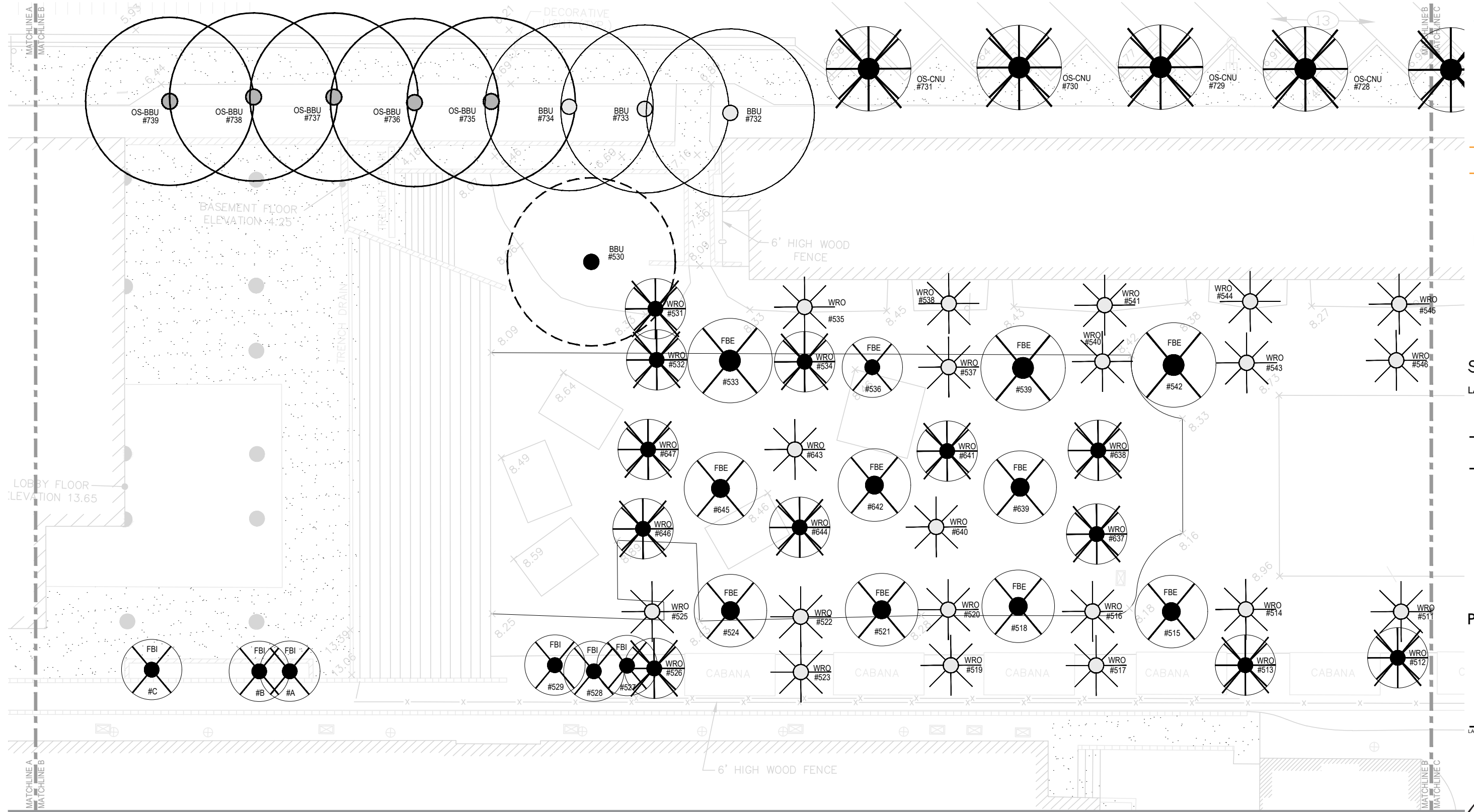

**LEGEND**

PROPERTY LINE				
	EXISTING TO REMAIN	EXISTING TO BE RELOCATED	EXISTING TO BE REMOVED	EXISTING OFF-SITE TO REMAIN
TREE				
PALM			N/A	

**GENERAL NOTES:**

1. TREE SURVEY BASED ON ALL AVAILABLE INFORMATION. CONTRACTOR TO REPORT ALL DISCREPANCIES TO LANDSCAPE ARCHITECT FOR REVIEW PRIOR TO CONSTRUCTION. RAYMOND JUNGLES, INC. (RJI) MAY ASSIST WITH THE TAGGING OF ALL TREES IN THE FIELD.
2. ALL TREES TO BE RELOCATED SHALL BE ROOT PRUNED A MINIMUM OF 60 DAYS PRIOR TO THEIR RELOCATION AND SHOULD BE SETUP ON A CONTROLLED IRRIGATION SYSTEM DURING THIS TIME. RJI WILL ALSO OVERSEE ANY RECOMMENDATIONS FOR FURTHER MODIFICATIONS TO ANY EXISTING MATERIAL.
3. ALL PITS TO BE FILLED THE SAME DAY OF REMOVAL OF TREES. RESTORE SURFACE WITH SOD OR MULCH TO MATCH EXISTING CONDITIONS.
4. CONTRACTOR SHALL VERIFY ALL EXISTING ABOVE AND UNDERGROUND UTILITIES 48 HOURS PRIOR TO ANY ON SITE EXCAVATION.
5. REVIEW ADDITIONAL NOTES AND DETAILS ON SHEET LR.201 FOR RELOCATED MATERIAL.
6. SEE LR.200 FOR TREE DISPOSITION SCHEDULE.
7. REFER TO LANDSCAPE PLANS FOR FINAL LOCATION OF RELOCATED TREES.
8. ALL WORK AND/OR IMPROVEMENTS WITHIN THE RIGHT-OF-WAY, INCLUDING LANDSCAPING AND IRRIGATION, REQUIRES A SEPARATE CITY OF MIAMI BEACH PUBLIC WORKS DEPARTMENT RIGHT-OF-WAY CONSTRUCTION PERMIT.



0 8' 16' 32'  
SCALE: 1/16" = 1'-0"



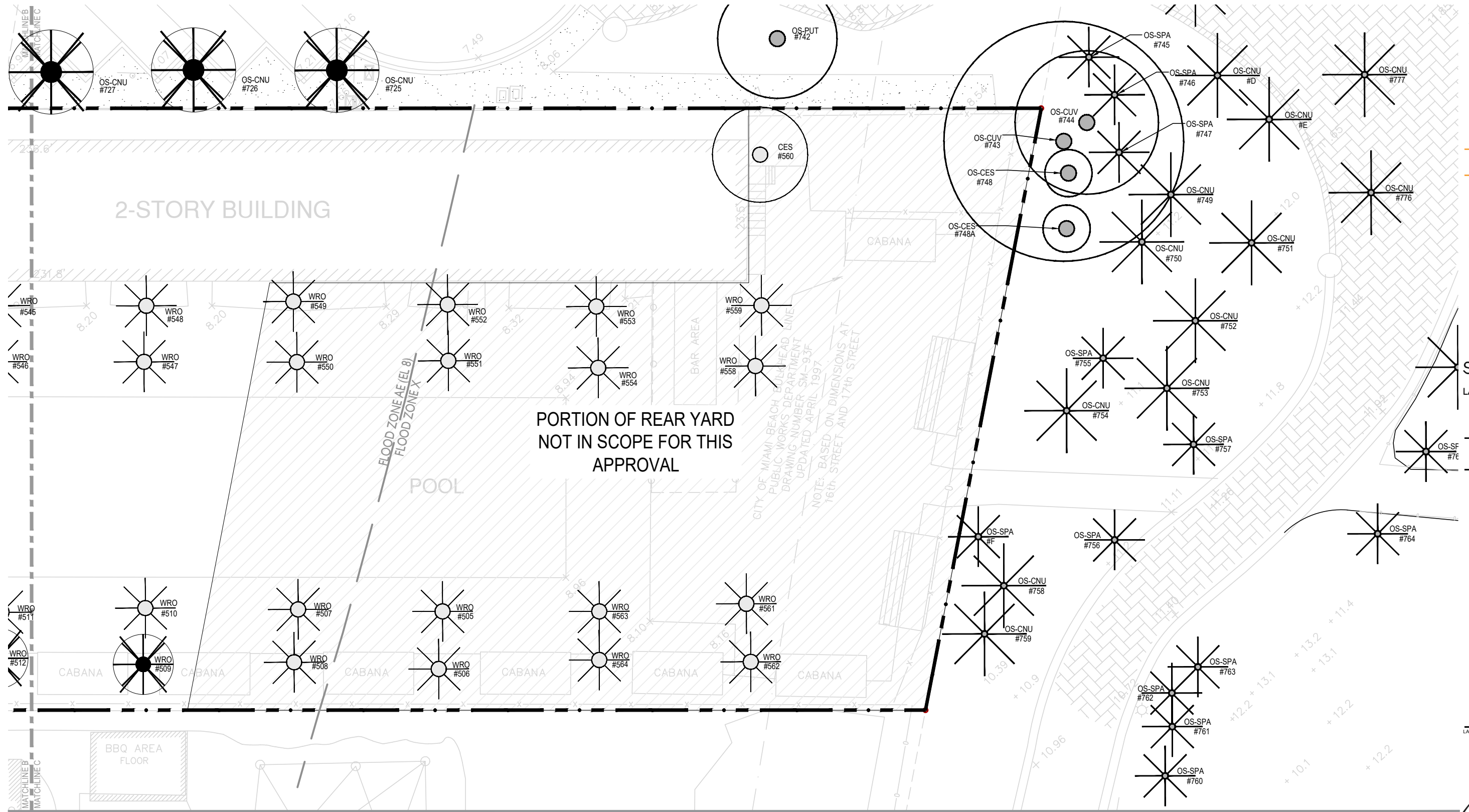
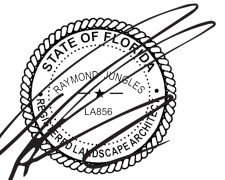

**LEGEND**

PROPERTY LINE	EXISTING TO REMAIN	EXISTING TO BE RELOCATED	EXISTING TO BE REMOVED	EXISTING OFF-SITE TO REMAIN
	TREE			
	PALM		N/A	

**GENERAL NOTES:**

- TREE SURVEY BASED ON ALL AVAILABLE INFORMATION. CONTRACTOR TO REPORT ALL DISCREPANCIES TO LANDSCAPE ARCHITECT FOR REVIEW PRIOR TO CONSTRUCTION. RAYMOND JUNGLES, INC. (RJI) MAY ASSIST WITH THE TAGGING OF ALL TREES IN THE FIELD.
- ALL TREES TO BE RELOCATED SHALL BE ROOT PRUNED A MINIMUM OF 60 DAYS PRIOR TO THEIR RELOCATION AND SHOULD BE SETUP ON A CONTROLLED IRRIGATION SYSTEM DURING THIS TIME. RJI WILL ALSO OVERSEE ANY RECOMMENDATIONS FOR FURTHER MODIFICATIONS TO ANY EXISTING MATERIAL.
- ALL PITS TO BE FILLED THE SAME DAY OF REMOVAL OF TREES. RESTORE SURFACE WITH SOD OR MULCH TO MATCH EXISTING CONDITIONS.
- CONTRACTOR SHALL VERIFY ALL EXISTING ABOVE AND UNDERGROUND UTILITIES 48 HOURS PRIOR TO ANY ON SITE EXCAVATION.
- REVIEW ADDITIONAL NOTES AND DETAILS ON SHEET LR.201 FOR RELOCATED MATERIAL.
- SEE LR.200 FOR TREE DISPOSITION SCHEDULE.
- REFER TO LANDSCAPE PLANS FOR FINAL LOCATION OF RELOCATED TREES.
- ALL WORK AND/OR IMPROVEMENTS WITHIN THE RIGHT-OF-WAY, INCLUDING LANDSCAPING AND IRRIGATION, REQUIRES A SEPARATE CITY OF MIAMI BEACH PUBLIC WORKS DEPARTMENT RIGHT-OF-WAY CONSTRUCTION PERMIT.

0 8' 16' 32'  
SCALE: 1/16" = 1'-0"



