

**Waiver 3: Attachment C – Code Excerpt: Section 142-155(a)(4)**

**Sec. 142-155. - Development regulations and area requirements.**

- a.) The development regulations in the RM-1 residential multifamily, low density district are as follows:
  - (4) In the Flamingo Park Local Historic District, the following shall apply:
    - I. If an alley exists, no front curb cut shall be permitted. If no alley exists, any curb-cut required shall not exceed 12 feet in width.

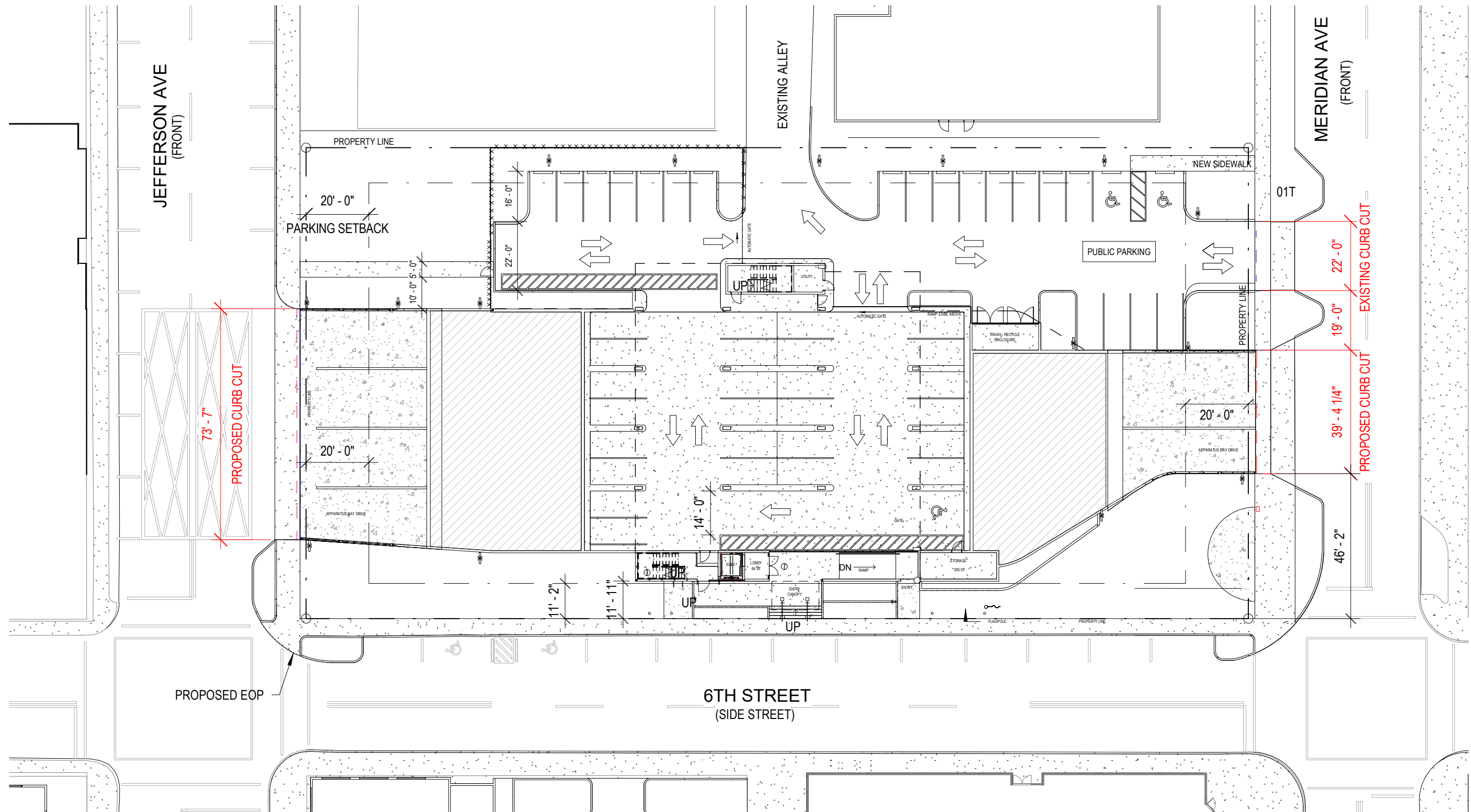

1 CURB CUT WAIVER 142-155(a)(4)i  
 1/32" = 1'-0"

