

TREES & PLANTING TO BE PRESERVED NOTES

1. EXISTING TREES TO BE PRESERVED SHALL BEAR SAME RELATIONSHIP TO FINISHED GRADE AS THEY BEAR TO PRE-CONSTRUCTION GRADE.
2. EXISTING TREES TO BE PRESERVED SHALL BE PROTECTED WITH STURDY, WEATHERPROOF FENCING AT A MINIMUM FOUR (4) FEET HEIGHT INSTALLED NO CLOSER TO THE TREE TRUNK THAN ITS DRIPLINE. THIS FENCE SHALL BE MAINTAINED IN WORKING ORDER DURING ALL PHASES OF CONSTRUCTION. MAINTAIN TREE PROTECTION ZONES FREE OF WEEDS AND TRASH.
3. NO WORK SHALL BE CONDUCTED WITHIN THE DRIPLINE, UNLESS REVIEWED AND APPROVED BY THE LANDSCAPE ARCHITECT. ALL WORK APPROVED WITHIN THE DRIPLINE SHALL BE COMPLETED BY HAND. PROTECT ROOT SYSTEMS FROM PONDING, ERODING, OR EXCESSIVE WETTING.
4. THE PROJECT LIMIT OF CONSTRUCTION AND ALL EXISTING VEGETATION TO REMAIN IS TO BE CLEARLY DEFINED BY STURDY, WEATHERPROOF FENCING AT A MINIMUM OF FOUR (4) FEET HIGH.

TREES & PLANTING TO BE RELOCATED NOTES

1. THE CONTRACTOR IS TO ROOT PRUNE ALL PLANT MATERIAL 90 DAYS MINIMUM IN ADVANCE OF MOVING PLANT MATERIAL.
2. THE CONTRACTOR IS TO WARRANTY ALL RELOCATED PLANT MATERIAL.
3. THE CONTRACTOR IS RESPONSIBLE FOR THE WATERING AND FERTILIZING OF ALL PLANT RELOCATED PLANT MATERIAL UNTIL PROJECT COMPLETION.
4. ALL RELOCATED PLANT MATERIAL IS TO BE APPROPRIATELY BRACED.
5. CONTRACTOR TO NOTIFY LANDSCAPE ARCHITECT TWO WEEKS IN ADVANCE OF ALL SCHEDULED WORK PERTAINING TO THE RELOCATION OF SITE TREES.

TREES & PLANTING TO BE REMOVED NOTES

1. THE CONTRACTOR IS TO COMPLETELY REMOVE ALL PLANTER MATERIAL DESIGNATED FOR REMOVAL (I.E. ROOT BALL, DEBRIS, SAW DUST, ETC.).
2. THE CONTRACTOR IS TO BACKFILL ALL EXCAVATED ROOT BALLS FLUSH TO THE ADJACENT ELEVATION LEVEL.
3. CONTRACTOR TO NOTIFY LANDSCAPE ARCHITECT TWO WEEKS IN ADVANCE OF ALL SCHEDULED WORK PERTAINING TO THE RELOCATION OF SITE TREES.

MITIGATION NOTES

1. THE PROPOSED PLAN SPECIFIES THE REMOVAL OF 6,018 SQUARE FEET OF CANOPY AREA. PER , CITY OF MIAMI BEACH CODE OF ORDINANCES, CHAPTER 46, DIVISION 2.

TREE PROTECTION NOTES

1. PROTECTION FENCE SHALL BE GALVANIZED CHAIN LINK STANDARD 2"X2" MESH.
2. PROVIDE HINGED GATE.
3. ALTERNATE: 2X4 WOOD POSTS (6'-0" O.C. MAX) WITH THREE EVENLY SPACED WOODEN RAILS. MIN. HT 4'
4. POSTS MAY BE SHIFTED TO AVOID ROOTS.
5. NO STORAGE, DEBRIS, VEHICULAR TRAFFIC OR EQUIPMENT CLEANING IS ALLOWED WITHIN THE PROTECTED AREA.
6. REFER TO MUNICIPAL REQUIREMENTS FOR ADDITIONAL INFORMATION.

DEFINITIONS

1. TREE: ANY SELF-SUPPORTING WOODY PLANT OR PALM WHICH USUALLY HAS A SINGLE MAIN AXIS OR TRUNK, WITH A MINIMUM TRUNK DIAMETER AT BREAST HEIGHT OF TWO INCHES AND A MINIMUM OVERALL HEIGHT OF 12 FEET. THIS DEFINITION EXCLUDES PLANTS WHICH ARE DEFINED AS SHRUBS, HEDGES, VINES, OR GROUND COVERS. PALMS SHALL HAVE A MINIMUM HEIGHT OF 14 FEET IN ORDER TO BE CLASSIFIED AS A TREE. - CITY OF MIAMI BEACH CODE OF ORDINANCES, CHAPTER 46, DIVISION 2

TREES DISPOSITION SCHEDULE

TREE No.	TREE - LATIN NAME	TREE - COMMON NAME	DIAMETER at BREAST HEIGHT (in Inches)	DBH MULTI TRUNK	HEIGHT OF CANOPY TREES (in feet)	CLEAR TRUNK HEIGHT OF PALM TREES (in feet)	CANOPY DIAMETER (in feet)	CANOPY (in Sq. Ft.)	DISPOSITION	CONDITION	REMOVAL- MUNICIPAL CRITERIA AND NOTES			
1	<i>Schinus terebinthifolius</i>	BRAZILIAN PEPPER TREE	14		25		20	314	REMOVE		CRITERIA	CANOPY SQ. FT.	R.OW CANOPY SQ. FT.	
2	<i>Veitchia montgomeryana</i>	MONTGOMERY PALM	4			16	12	113	REMOVE		INVASIVE	113		
3	<i>Sabal palmetto</i>	CABBAGE PALM	12			10	10	79	REMOVE		DOES NOT MEET THE REQUIREMENTS TO QUALIFY AS A TREE. CMB. CHAPTER 46, DIV. 2			
4	<i>Mangifera indica</i>	MANGO TREE	6		20		10	79	REMOVE	POOR		79		
5	<i>Mangifera indica</i>	MANGO TREE	14		25		30	707	REMOVE			707		
6	<i>Ficus benghalensis</i>	BANYAN TREE			3			0	REMOVE	POOR	DOES NOT MEET THE REQUIREMENTS TO QUALIFY AS A TREE. CMB. CHAPTER 46, DIV. 2			
7	<i>Ficus aurea</i>	STANGLER FIG	8		18		17	227	REMOVE	POOR	UNSAFE CONDITIONS	227		
8	<i>Sabal palmetto</i>	CABBAGE PALM	11			7	15	177	REMOVE	FAIR	DOES NOT MEET THE REQUIREMENTS TO QUALIFY AS A TREE. CMB. CHAPTER 46, DIV. 2			
9	<i>Sabal palmetto</i>	CABBAGE PALM	10			22	12	113	REMOVE	FAIR		113		
10	<i>Sabal palmetto</i>	CABBAGE PALM	10			20	12	113	REMOVE			113		
11	<i>Sabal palmetto</i>	CABBAGE PALM	10			18	12	113	REMOVE			113		
12	<i>Washingtonia robusta</i>	WASHINGTON PALM	10			8	12	113	REMOVE		INVASIVE			
13	<i>Wodyetia bifurcata</i>	FOXTAIL PALM	10			14	12	113	REMOVE			113		
14	<i>Wodyetia bifurcata</i>	FOXTAIL PALM	10			12	12	113	REMOVE			113		
15	<i>Roystonea regia</i>	ROYAL PALM	10			20	20	314	REMOVE	FAIR		314		
16	<i>Chamaerops humilis</i>	MEDITERRANEAN FAN PALM	6			8	7	38	REMOVE		DOES NOT MEET THE REQUIREMENTS TO QUALIFY AS A TREE. CMB. CHAPTER 46, DIV. 2	38		
17	<i>Sabal palmetto</i>	CABBAGE PALM	8			18	14	154	REMOVE	FAIR		154		
18	<i>Sabal palmetto</i>	CABBAGE PALM	8			20 , 28	14	28	REMOVE			28		
19	<i>Sabal palmetto</i>	CABBAGE PALM	8			18, 25	14	28	REMOVE			28		
20	<i>Sabal palmetto</i>	CABBAGE PALM	8			20	14	154	REMOVE			154		
21	<i>Veitchia montgomeryana</i>	MONTGOMERY PALM	8			25	16	201	REMOVE			201		
22	<i>Veitchia montgomeryana</i>	MONTGOMERY PALM	8			32	16	201	REMOVE			201		
23	<i>Veitchia montgomeryana</i>	MONTGOMERY PALM	2 @ 8			30, 25	28	616	REMOVE			616		
24	<i>Veitchia merrillii</i>	MANILA PALM	3 @ 4			12	12	113	REMOVE			113		
25	<i>Veitchia merrillii</i>	MANILA PALM	3 @ 4			14	12	113	REMOVE			113		
26	<i>Veitchia merrillii</i>	MANILA PALM	3 @ 5			15	15	6	REMOVE			6		
27	<i>Veitchia merrillii</i>	MANILA PALM	2 @ 4			13	12	113	REMOVE		DOES NOT MEET THE REQUIREMENTS TO QUALIFY AS A TREE. CMB. CHAPTER 46, DIV. 2			
28	<i>Veitchia merrillii</i>	MANILA PALM	3 @ 4			12	16	201	REMOVE					
29	<i>Veitchia merrillii</i>	MANILA PALM	6			8	12	113	REMOVE					
30	<i>Wodyetia bifurcata</i>	FOXTAIL PALM	8			10	10	79	REMOVE	POOR				
31	<i>Roystonea regia</i>	ROYAL PALM	14		22	30	707	REMOVE					707	
32	<i>Bursera simaruba</i>	GUMBO LIMBO	12		22	30	707	REMOVE				707		
33	<i>Bursera simaruba</i>	GUMBO LIMBO	12		22	30	707	REMOVE				707		
STREET TREES														
40	<i>Conocarpus erectus</i>	GREEN BUTTONWOOD	36		35		30	707	REMAIN	FAIR				
41	<i>Conocarpus erectus</i>	GREEN BUTTONWOOD	40		26		30	707	REMOVE	FAIR			707	
42	<i>Roystonea regia</i>	ROYAL PALM	14			30	20	314	REMOVE				314	
43	<i>Conocarpus erectus</i>	GREEN BUTTONWOOD	36		35		40	1257	REMAIN					
44	<i>Roystonea regia</i>	ROYAL PALM	14			30	20	314	REMOVE				314	
45	<i>Roystonea regia</i>	ROYAL PALM	14			24	18	24	REMOVE	FAIR			24	
46	<i>Roystonea regia</i>	ROYAL PALM	14			20	15	177	REMOVE	POOR			177	
47	<i>Roystonea regia</i>	ROYAL PALM	14			26	25	491	REMOVE				491	
48	<i>Roystonea regia</i>	ROYAL PALM	14			26	20	314	REMOVE				314	
49	<i>Roystonea regia</i>	ROYAL PALM	14			26	16	201	REMOVE				201	
50	<i>Roystonea regia</i>	ROYAL PALM	14			26	16	201	REMOVE				201	
51	<i>Roystonea regia</i>	ROYAL PALM	14			30	20	314	REMOVE				314	
52	<i>Roystonea regia</i>	ROYAL PALM	18			32	25	491	REMOVE				491	
53	<i>Roystonea regia</i>	ROYAL PALM	18			34	25	491	REMOVE				491	
54	<i>Roystonea regia</i>	ROYAL PALM	18			30	20	314	REMOVE	FAIR			314	
55	<i>Roystonea regia</i>	ROYAL PALM	18			24	20	314	REMOVE				314	
56	<i>Roystonea regia</i>	ROYAL PALM	19			24	20	314	REMAIN					
57	<i>Roystonea regia</i>	ROYAL PALM	14			22	20	314	REMOVE				314	
58	<i>Lysiloma bahamensis</i>	TAMARIND TREE	8		20		20	314	REMOVE				314	
59	<i>Roystonea regia</i>	ROYAL PALM	18			22	18	254	REMOVE				254	
60	<i>Lysiloma bahamensis</i>	TAMARIND TREE	7		25		20	314	REMOVE				314	
61	<i>Roystonea regia</i>	ROYAL PALM	12			18	14	154	REMOVE				154	
												TOTAL SQ. FEET FOR SITE REMOVAL:	5,778	
												TOTAL SQ. FEET FOR ROW REMOVALS:		6,018



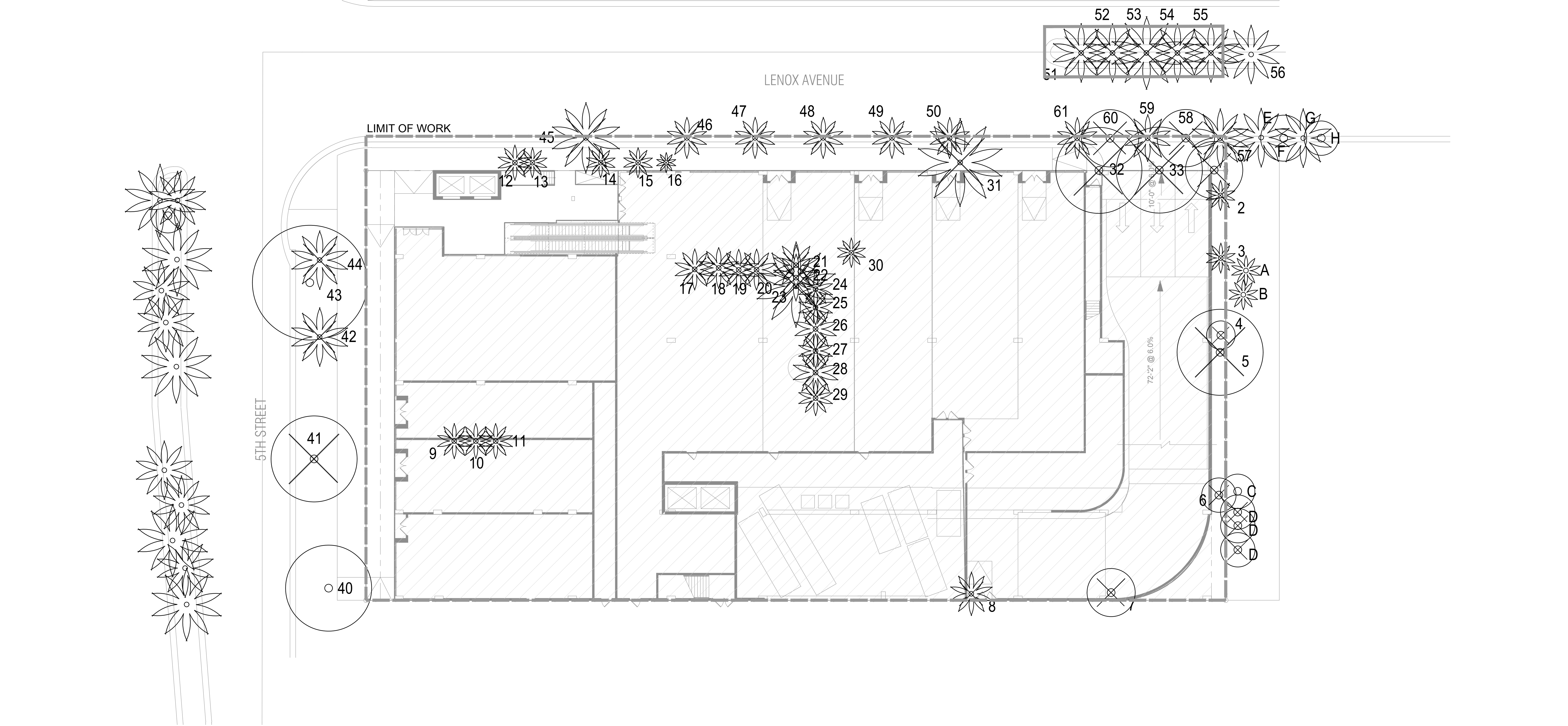

TREE PROTECTION DETAIL

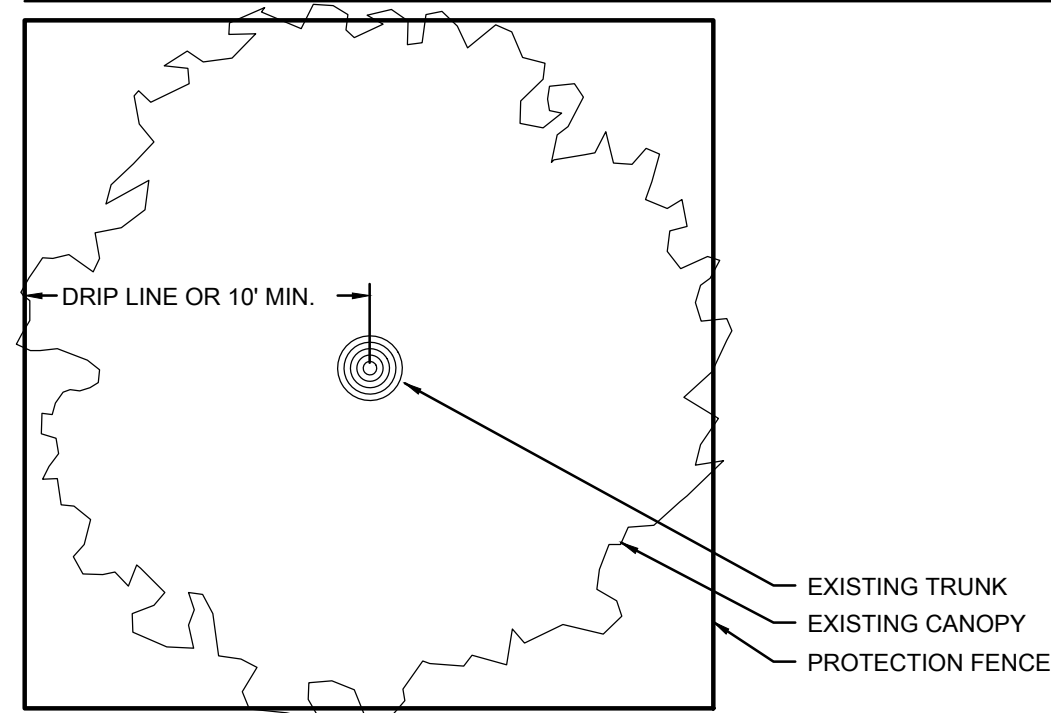

PLAN

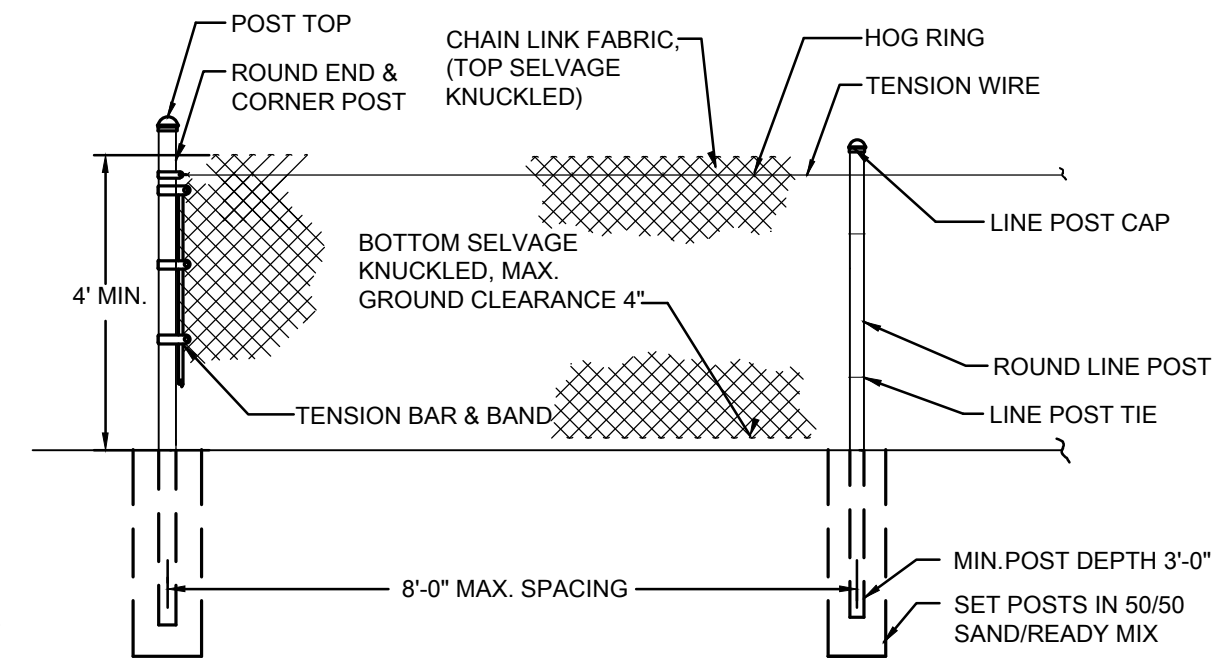

ELEVATION

TREE DISPOSITION LEGEND

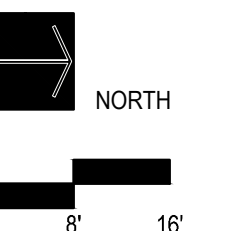
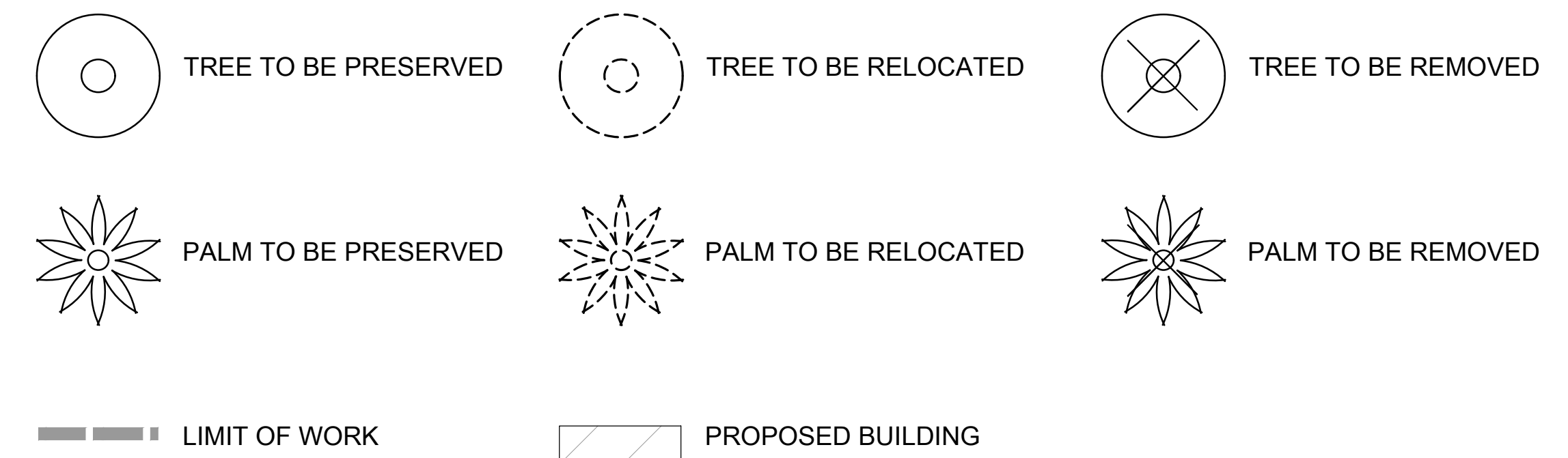



PLANTING NOTES

1.
- PLANT MATERIAL IS TO BE HEALTHY SPECIMENS FREE FROM DISEASE OR DAMAGE, AND IS TO BE MAINTAINED IN EXCELLENT CONDITION WHILE ON THE JOBSITE. LANDSCAPE ARCHITECT SHALL INSPECT PLANT MATERIAL UPON ARRIVAL TO JOBSITE AND WILL REJECT PLANT MATERIAL THAT DOES NOT MEET THE STANDARDS DESCRIBED WITHIN THE CONTRACT DOCUMENTS.
2.
- THE LANDSCAPE ARCHITECT WILL PERIODICALLY INSPECT PLANT MATERIAL STOCKPILED AND/OR PLANTED ON SITE DURING THE COURSE OF CONSTRUCTION. PLANT MATERIAL NOT MEETING THE STANDARDS CONTAINED WITHIN CONTRACT DOCUMENTS SHALL BE REPLACED AT NO COST TO THE OWNER.
3.
- PROVIDE MATCHING SIZES AND FORMS FOR EACH PLANT OF THE SAME SPECIES UNLESS OTHERWISE INDICATED.
4.
- CONTRACTOR TO VERIFY ALL QUANTITIES. IN CASE OF DISCREPANCIES, GRAPHICALLY SHOWN QUANTITIES SHALL TAKE PRECEDENCE.
5.
- ALL MATERIALS USED SHALL CONFORM TO THE GUIDELINES ESTABLISHED BY THE CURRENT AMERICAN STANDARDS FOR NURSERY STOCK, PUBLISHED BY THE AMERICAN ASSOCIATION OF NURSERYMEN.
6.
- ALL PLANT MATERIAL SHALL BE INSTALLED PLUMB AND PER THE SPECIFICATIONS CONTAINED WITHIN THE CONTRACT DOCUMENTS. ANY NECESSARY STAKING AND/OR OTHER SUPPORTS MATERIALS/METHODS SHALL BE SUBMITTED TO THE LANDSCAPE ARCHITECT FOR REVIEW AND APPROVAL PRIOR TO INSTALLATION.
7.
- THE CONTRACTOR SHALL PRUNE EXISTING AND/OR NEW TREES ONLY PER LANDSCAPE ARCHITECT DIRECTION.
8.
- THE CONTRACTOR SHALL STAKE THE LOCATIONS OF ALL TREES AND B&B SHRUBS FOR LANDSCAPE ARCHITECT REVIEW AND APPROVAL, PRIOR TO INSTALLATION.
9.
- ALL ROOT-WRAPPING MATERIALS THAT ARE NOT BIO-DEGRADABLE SHALL BE REMOVED FROM THE ROOT BALL. ROOT BALLS SHALL BE FREE OF WEEDS.
10.
- SPECIFIED PLANT MATERIAL SIZES SHALL BE CONSIDERED MINIMUM SIZES.
11.
- FINISH GRADE OF PLANTING BEDS SHALL BE ONE (1) INCH BELOW ADJACENT FLATWORK, UNLESS SPECIFIED OTHERWISE.
12.
- MULCH OR PLANTING BED DRESSING SHALL BE PLACED IN ALL PLANTING AREAS AS SPECIFIED. MULCH OR PLANTING BED DRESSING SHALL NOT BE PLACED WITHIN SIX (6) INCHES OF TREE TRUNKS. MULCHING SHOULD BE REPEATED ANNUALLY DURING THE AUTUMN TO A THREE (3) INCH DEPTH.
13.
- ALL PLANT MATERIAL SHOULD RECEIVE AN ORGANIC FERTILIZER IN LIMITED APPLICATION FOLLOWING INSTALLATION. TYPE AND APPLICATION RATE AND METHOD OF APPLICATION TO BE SPECIFIED BY THE CONTRACTOR AND APPROVED BY THE LANDSCAPE ARCHITECT.
14.
- EXCESS FERTILIZER SHALL BE DISPOSED OF PROPERLY OFF-SITE. IT SHALL NOT BE DISPOSED OF IN STORM DRAINS AND/OR DRYWELLS.
15.
- STOCKPILED PLANT MATERIAL TO BE PLACED IN THE SHADE AND PROPERLY HAND-WATERED UNTIL PLANTED.
16.
- MINI-NUGGET TYPE DECORATIVE BARK MULCH WILL BE USED TO RETURN NUTRIENTS TO THE SOIL, REDUCE MAINTENANCE AND MINIMIZE EVAPORATION FOR AREAS APPROXIMATE TO THE RESIDENCE. LARGER SHREDDED BARK MULCH WILL BE USED FOR STEEP AREAS SO SLOUGHING IS LESS LIKELY TO OCCUR.
17.
- PRESERVE & PROTECT ALL EXISTING VEGETATION INDICATED TO REMAIN AT ALL TIMES.
18.
- ALL VEGETATION PROPOSED FOR OUTSIDE THE BUILDING ENVELOPE TO BE NATIVE UNLESS OTHERWISE NOTED. PLANTING THAT OCCURS OUTSIDE THE BUILDING ENVELOPE IS FOR RESTORATION PURPOSES ONLY OR IS SPECIFIC TO UTILITIES RESTORATION.
19.
- SIX (6) INCH PLANT MIX SHALL BE PROVIDED FOR ALL LAWN, TURF, AND NATIVE PLANTING ZONES. 18 INCH PLANT MIX SHALL BE PROVIDED FOR ALL PERENNIAL PLANTING BEDS UNLESS OTHERWISE NOTED.

PLANTING SCHEDULE:

ABR.	QTY.	BOTANICAL NAME	COMMON NAME	SPECIFICATION
TREES				
CRO	8	Clusia rosea	PITCH APPLE	20'
CER	2	Conocarpus erectus	BUTTONWOOD	16' OA. COLLECTED
SHRUBS				
PN	46	Psychotria nervosa	WILD COFFEE	7 GAL.

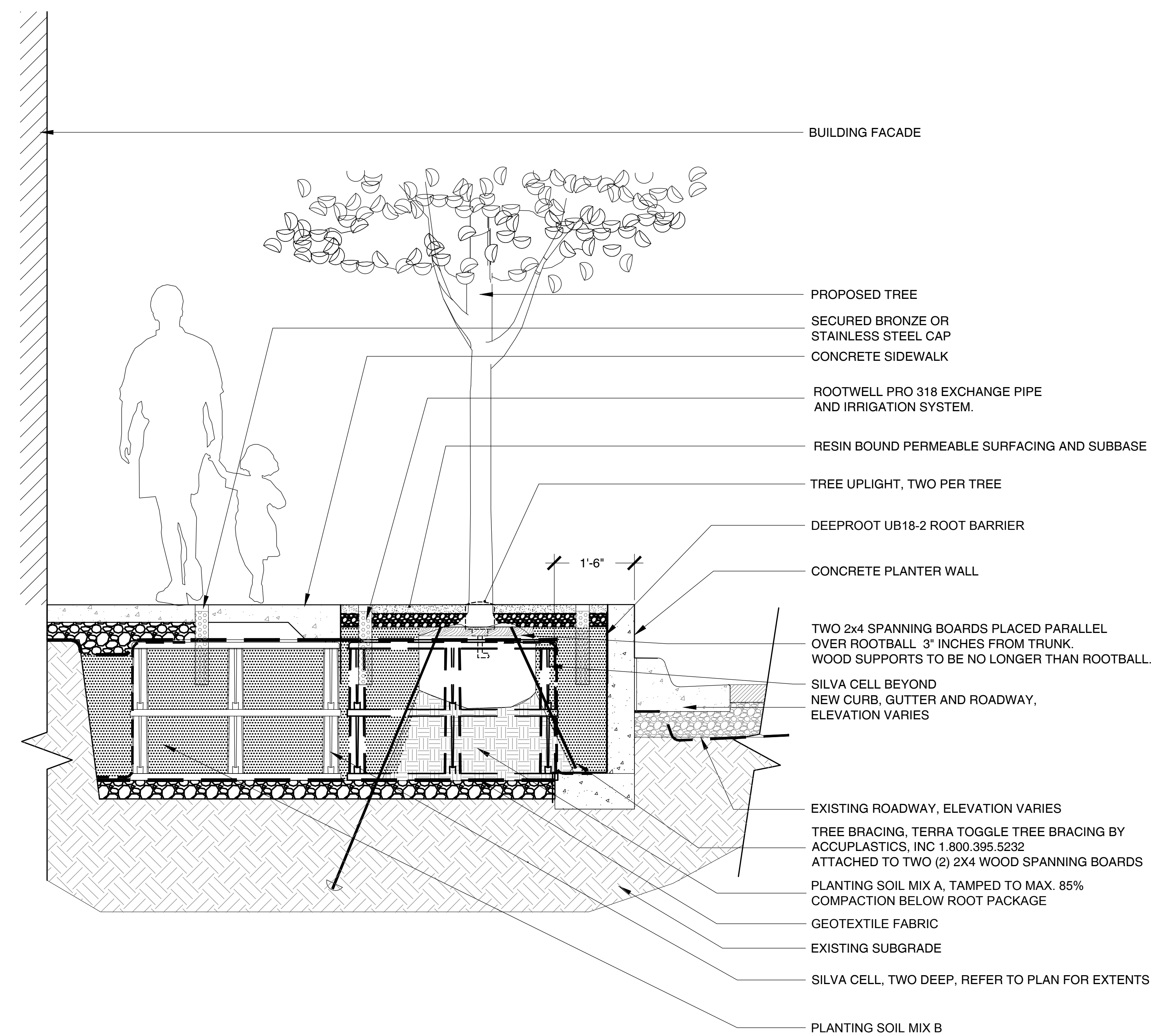



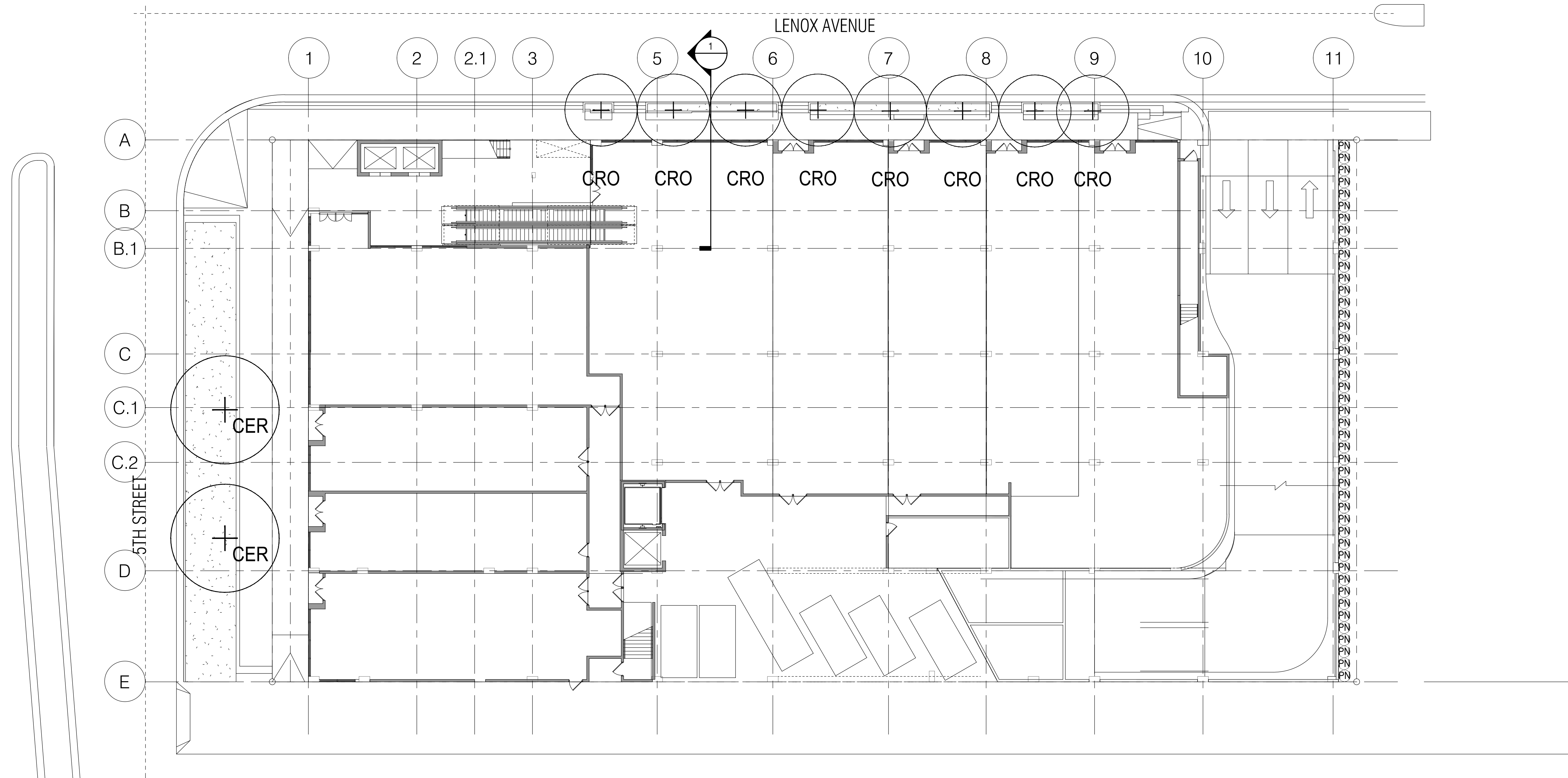

#### TREE DISPOSITION LEGEND

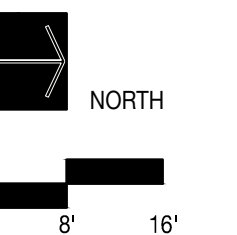
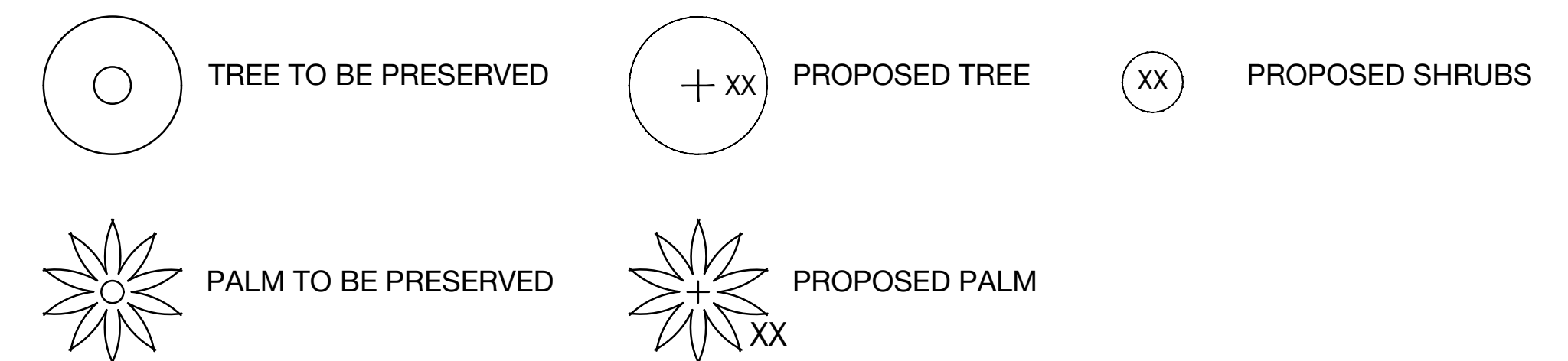

**BLVD at Lenox**

**Miami Beach, Florida**

*Planting Plan*

*1/16" = 1'-0"*

*08/10/2016*

*No copies, transmissions, reproductions, or electronic revisions of any portions of these drawings in whole or in part be made without the express written permission of Zyscovich Architects. All designs indicated in these drawings are property of Zyscovich Architects. All copyrights reserved © 2014.*



**LAND**

**ZYSCOVICH**  
ARCHITECTS

100 N Biscayne Blvd . 27th Fl  
Miami . FL 33132.2304  
t 305.372.5222 f 305.577.4521

e info@zyscovich.com  
w www.zyscovich.com



1. THE EXTERIOR LIGHTING PLAN ILLUSTRATES FIXTURE LOCATION AND TYPE SOLELY. ALL ELECTRICAL LOADS, WIRING, AND CALCULATIONS ARE BY OTHERS.
2. CONTRACTOR TO COORDINATE WITH CLIENT AND LANDSCAPE ARCHITECT CONTROL SYSTEM FOR EXTERIOR LIGHTING.
3. THE CONTRACTOR TO PROVIDE SLEEVES AND CONDUIT AS NEEDED FOR ALL EXTERIOR LIGHTING FIXTURES..
4. THE CONTRACTOR IS TO STAKE ALL EXTERIOR LIGHTING FIXTURES FOR LANDSCAPE ARCHITECT REVIEW.
5. COORDINATE LANDSCAPE LIGHTING WITH INTERIOR AND EXTERIOR ARCHITECTURAL LIGHTING. ENSURE COMPATIBILITY WITH ARCHITECTURAL LIGHTING SYSTEM CONTROLLERS.
6. ALL EXTERIOR FIXTURES TO BE INSTALLED TO PREVENT GLARE AND UNWANTED DIRECTED LIGHT. CONTRACTOR TO ENSURE ALL FIXTURES DO NOT DIRECT LIGHT ONTO ADJACENT PROPERTIES.
7. PROVIDE NEMA RATED EQUIPMENT AND ENCLOSURES FOR SYSTEM CONTROLLERS EXPOSED TO THE ELEMENTS. SUBMIT PROPOSED MOUNTING SYSTEM, ENCLOSURES AND LOCATIONS AS PART OF THE SUBMISSION PROCESS.
8. THE CONTRACTOR IS TO NOTIFY THE LANDSCAPE ARCHITECT TWO WEEKS IN ADVANCE OF SCHEDULED EXTERIOR LIGHT INSTALLATION. UPON COMPLETION OF THE EXTERIOR LIGHT INSTALLATION, CONTRACTOR TO PROVIDE NIGHTTIME WALK THROUGH WITH LANDSCAPE ARCHITECT FOR FINAL REVIEW.

# LUMINAIRE SPECIFICATION

Head Office: Tel: 503-645-0500  
7144 NW Progress Ct. Fax: 503-645-8100  
Hillsboro, Oregon 97124  
www.ligmanlightingusa.com

IP65: Suitable for Wet Locations  
IK07: Impact Resistant (Vandal Resistant)

## UVI-40326

### Vios 3 square recessed guide light LED

A range of round and square wall recessed luminaires, suitable for indoor or outdoor applications for use in residential, pedestrian areas, and shopping malls, as a decorative wall guide light.

Luminaires are class II for remote transformer installations.

Low copper content die-cast aluminum housing with high corrosion resistance. Stainless steel screws. Durable silicone rubber gasket and toughened glass diffuser. Single cable entry. Housing is treated with a chemical chromatinized protection before powder coating, ensuring high corrosion resistance. Integral driver - 120v only, for 277v remote driver should be used. Galvanized concrete recessing box included. This fixture is suitable for concrete pour applications.

#### Physical Data

Trim: 4.13"

Weight: 1.3 lbs

Lamp

☐ 4.4w - 252lm - White - LED ®

#### LED Color (Please Specify)

☐ W27 - 2700K

☐ W30 - 3000K

☐ W40 - 4000K

#### Voltage (Please Specify)

☐ 120V - Integral

☐ 277V - Remote Driver Only

☐ Other

#### Options (Please Specify)

Color (Please Specify)

☐ 01-Black - RAL 9011

☐ 03-White - RAL 9003

☐ 05-Matt Silver - RAL 9006

☐ 06-Bronze - RAL 6014

☐ 02- Dark Grey - RAL 7043

☐ 04 - Metallic Silver - RAL 9006

☐ 07- Custom - RAL

#### IP65 Remote Box (Optional for 277v)

☐ A80191 - 3" wide remote box

☐ A80291 - 4" wide remote box

Ordering Example : UVI - 40326 - 4.4w - W30 - 120v - Options

PROJECT:

TYPE:

QUANTITY:

NOTE:

DATE:

Rev: 11/13

Ligman Lighting USA reserves the right to change specifications without prior notice, please contact factory for latest information.

**LIGMAN**  
LIGHTING USA

# LUMINAIRE SPECIFICATION

Tel: 503-645-0050  
 7144 NW Progress Ct.  
 Hillsboro, Oregon 97124  
 Fax: 503-645-8100  
[www.ligmanlightingusa.com](http://www.ligmanlightingusa.com)

---

IP65 : Suitable for Wet Locations  
 IK07 : Impact Resistant (Vandal Resistant)

## ULE-40611

### Legend 3 recessed step light LED

A range of vandal resistant rectangular wall recessed luminaires. Suitable for indoor or outdoor applications in residential, shopping and pedestrian areas as decorative grid lighting. Available in a variety of lamp options that include energy saving compact fluorescent and LED light sources.

Main characteristic are low glare and the limited maintenance concept.

The legend is available with aluminum or stainless steel frames. Low copper content die-cast aluminum housing with a high corrosion resistance. Stainless steel screws. Durable silicone rubber gasket and impact resistant UV stabilized acrylic diffuser. Double cable entry. Housing is treated with a chemical chromatinized protection before powder coating, ensuring high corrosion resistance. Integral control gear. Anodized high purity aluminum reflector.

The SMD (LED's) are available in red, blue, amber, green and white 2700K, 3000K and 4000K. Consult factory for additional colors. This fixture is suitable for concrete pour applications.

(S) Stainless Steel

(A) Aluminum

Weight: (S) 4.1 lbs (A) 3.5 lbs

**Lamp**

- ☐ 10w - White - LED

**LED Color (Please Specify)**

- ☐ W27 - 2700K
- ☐ W30 - 3000K
- ☐ W40 - 4000K

**Voltage (Please Specify)**

- ☐ 120V
- ☐ 277V
- ☐ Other \_\_\_\_\_

**Options (Please Specify)**

Front Ring Style

- ☐ S - Stainless Steel
- ☐ A - Aluminum

Color (Please Specify for Aluminum Style Only)

<input type="checkbox"/> 01-Black - RAL 9011 <input type="checkbox"/> 03-White - RAL 9003 <input type="checkbox"/> 05-Matt Silver - RAL 9006 <input type="checkbox"/> 06-Bronze - RAL 6014	<input type="checkbox"/> 02- Dark Grey - RAL 7043 <input type="checkbox"/> 04- Metallic Silver - RAL 9006 <input type="checkbox"/> 07- Custom -RAL_____
-----------------------------------------------------------------------------------------------------------------------------------------------------------------------------------------------------	---------------------------------------------------------------------------------------------------------------------------------------------------------------

Wall Clamping

**Surface Mounting Box Enclosure**

- ☐ F - Frosted Lens
- ☐ C - Clear Lens
- ☐ Wall Clamping
- ☐ Surface Mounting Box Enclosure

**Ordering Example :** ULE - 40611 - White-10w - 120v - Options

Date: \_\_\_\_\_

**PROJECT:** \_\_\_\_\_

**TYPE:** \_\_\_\_\_

**QUANTITY:** \_\_\_\_\_

**NOTE:**

Ligman Lighting USA reserves the right to change specifications without prior notice, please contact factory for latest information.  
 Due to the continual improvements in LED technology data and components may change without notice.

Rev: 1/13

# SH-200

## Solar LED Ground Light

Water Proof / No Wiring

METEOR Solar LED Paver lights incorporate state-of-the-art technology, combining the best solar panels, power storage and optical design to create products that will function for years to come.

Quantity
Project
Note
Type

### General

Weight: 0.55 lbs  
 Rim Finish: Brushed/Polished stainless steel; Optional: SUS316 stainless steel / Brass  
 Lens: GE super light permeable PC  
 Housing: SUS304 stainless steel, cast aluminum  
 Power Storage: Ultracapacitor

### Operational

Operation Time: Minimum 12 hours (fully charged) 4-8 hours (overcast)  
 Full Charge Time: 6 hours (direct sunlight)  
 Switch: Light sensitive auto on/off

### Environmental

Compressive Strength: 2541 lbs/1153 kgs (minimum)  
 Operating Temperature: -4° F-140° F  
 Storage Temperature: -13° F-176° F

### Warranty

3 year limited warranty. See [www.meteor-lighting.com](http://www.meteor-lighting.com) for details.

## How To Specify

Ordering Example: SH200C-AMB-PS-HS

Model		LED Color		Rim Finish		Housing	
SH200C	Product	AMB	Amber	BS	Brushed Stainless Steel	HS	Housing and Anchor Plate Included
SH200B	Battery sample	BLU	Blue	PS	Polished Stainless Steel	NH	Without Housing and Anchor Plate
		GEN	Green	SS	SUS316 Stainless Steel		
		RED	Red	BR	Brass		
		WHT	White				
		WAM	Warm white				

*Color	LUX (Average)
White	25
Amber	25
Red	80
Blue	20
Green	80
Warm White	25

METEOR LIGHTING

P: 213.255.2060 F: 213.596.3704 [www.meteor-lighting.com](http://www.meteor-lighting.com)

2016 V1 | Page 1 of 1

\*METEOR LIGHTING reserves the right to make changes to this product at any time without prior notice and such modification shall be effective immediately.

e info@zyscovich.com  
w www.zyscovich.com



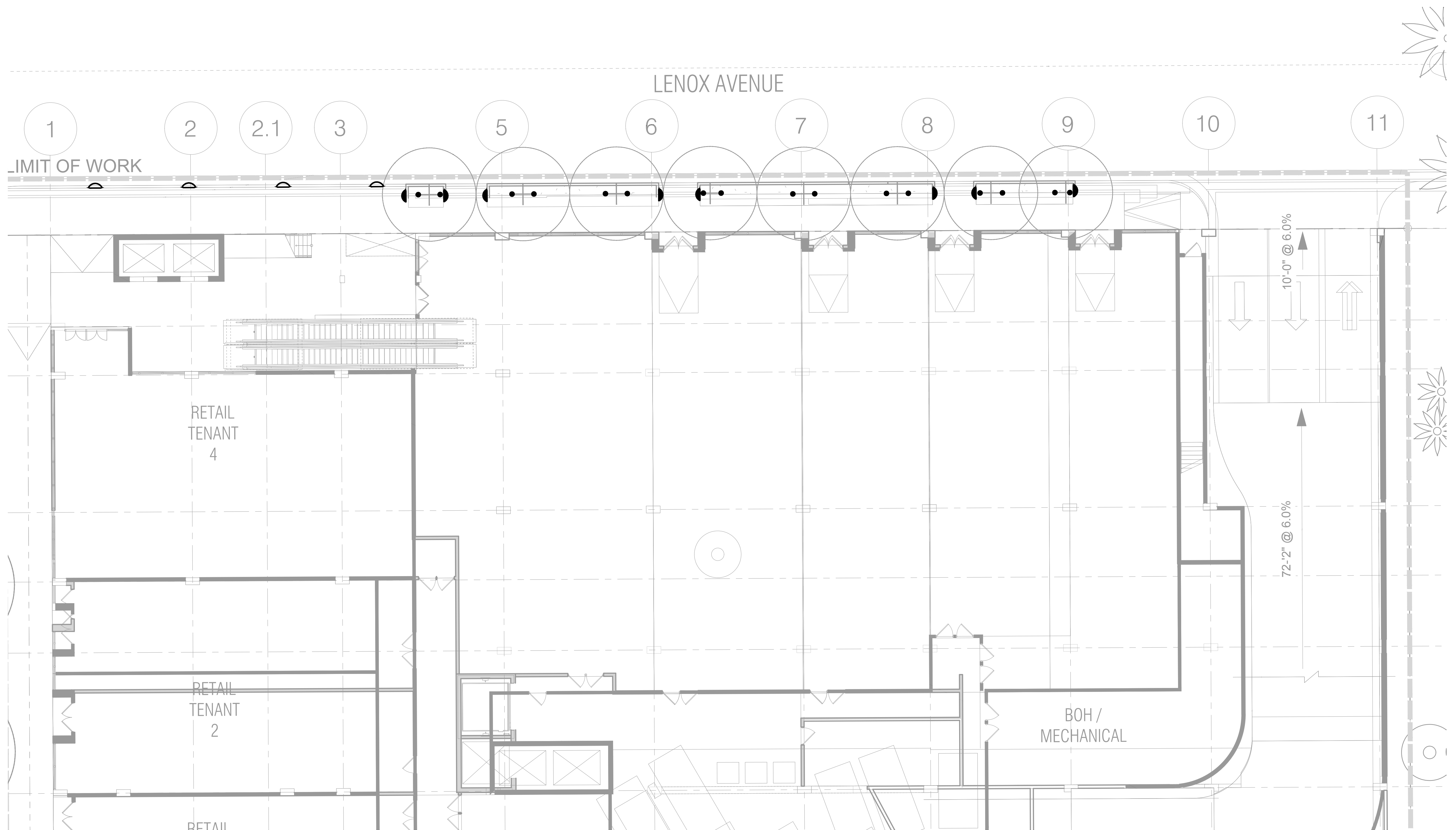

LEGEND:

-  STEP LIGHT
-  WALL LIGHT
-  TREE UP LIGHT

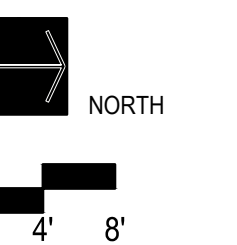

**BLVD at Lenox**

**Miami Beach, Florida**

*Lighting Plan*

3/32" = 1'-0"

08/10/2016

*No copies, transmissions, reproductions, or electronic revisions of any portions of these drawings in whole or in part be made without the express written permission of Zyscovich Architects. All designs indicated in these drawings are property of Zyscovich Architects. All copyrights reserved © 2014.*



**LAND**

**ZYSCOVICH**  
ARCHITECTS

100 N Biscayne Blvd. 27th Fl  
Miami, FL 33132.2304  
t 305.372.5222 f 305.577.4521

e info@zyscovich.com  
w www.zyscovich.com