



DRB FIRST SUBMITTAL
NEW RESIDENCE | 40 WEST SAN MARINO | MIAMI BEACH, FLORIDA

CLIENT / PROPERTY INFORMATION

Reynolds Residence

PROPERTY ADDRESS
40 WEST SAN MARINO
MIAMI BEACH, FL 33139

EXISTING VEGETATION SUMMARY

There is an existing Black Olive Tree in the southern corner of the ROW to remain, which acts as a screen for the existing utility pole. (2) Royal Palms and (1) Areca Palm are marked to be removed, as they are in conflict with the proposed architecture and finished elevations. Existing miscellaneous tropical vegetation not requiring a permit or approval will also be removed. CCLA is providing a preliminary Existing Tree Survey and will provide an updated Tree Disposition Chart once an updated Survey is received.

SCOPE OF WORK

- Removal of existing vegetation and landscape in conflict with proposed architecture
- New landscape design to complement architecture of new structure.

INDEX OF SHEETS

- L-0 Landscape Cover Page + Sheet Index
- L-1 Existing Tree Survey + Disposition Chart
- L-2 Landscape Plan
- L-3 Landscape Notes + Details

REYNOLDS RESIDENCE
40 W. SAN MARINO DR.
MIAMI BEACH, FL 33139

CHRISTOPHER CAWLEY | CC
LANDSCAPE ARCHITECTURE LLC | LA
Florida Landscape Architecture Business LC 26000460
780 NE 69th Street | Suite 1106 | Miami, FL 33138
T 305.979.1885 | www.christophercawley.com

MIAMI BEACH DESIGN REVIEW BOARD FIRST SUBMITTAL
CHOEFF LEVY FISCHMAN
ARCHITECTURE + DESIGN
8425 Biscayne Blvd. suite 201
Miami, Florida 33138
(t) 305.434.8398
(f) 305.892.5292
www.clarchitects.com

CHRISTOPHER CAWLEY, RLA
Florida License LA 6666786

comm no.
1639

date:
09/30/2016

revised:

sheet no.

L-0

C.M.B. PUBLIC WORKS / GREENSPACE MANAGEMENT CONDITIONS

1. SHOULD ANY EXISTING TREES OR PALMS BE DAMAGED THEY SHALL BE EVALUATED BY THE CITY URBAN FORESTER TO DETERMINE CORRECTIVE ACTIONS THAT MAY INCLUDE REMOVAL, CORRECTIVE PRUNING AND OR REPLACEMENT. ANY CORRECTIVE ACTIONS REQUIRED SHALL BE PERFORMED IN ACCORDANCE WITH MIAMI BEACH CODE, THE MOST CURRENT ANSI A-300 PRUNING STANDARDS AND OR AN ISSUED CITY OF MIAMI BEACH TREE WORK PERMIT. ANY CORRECTIVE PRUNING REQUIRED SHALL BE PERFORMED BY AN ISA CERTIFIED ARBORIST AND THE CITY URBAN FORESTER SHALL BE NOTIFIED IN WRITING AND OR CONSULTED PRIOR TO ANY ROOT PRUNING TAKING PLACE.

2. CARE SHALL BE TAKEN TO AVOID UTILITY OR CONSTRUCTION TRENCHING THROUGH EXISTING TREE OR PALM DRIPLINES OF TREES SLATED TO REMAIN IN PLACE OR BE RELOCATED. IF CONSTRUCTION REQUIRES THE CUTTING OF ANY ROOTS WITH A DIAMETER OF 2" OR GREATER, ROOTS SHALL BE CLEANLY CUT WITH A SHARP TOOL, AS DIRECTED BY AN ISA CERTIFIED ARBORIST, AND IN ACCORDANCE WITH THE ANSI A-300 STANDARDS. CUT ROOTS SHOULD BE IMMEDIATELY COVERED WITH SOIL TO PREVENT DRYING. ROOTS SHOULD NOT BE TORN OR BROKEN BY HEAVY EQUIPMENT, AND NO SHREDDED, RAGGED OR BROKEN ROOT ENDS SHOULD BE LEFT. THE CITY URBAN FORESTER SHALL BE NOTIFIED IN WRITING AND OR CONSULTED PRIOR TO ANY ROOT PRUNING TAKING PLACE.

3. SHOULD ANY CORRECTIVE STRUCTURAL PRUNING BE NECESSARY FOR TREES PROPOSED TO REMAIN ONSITE, DUE TO CLEARANCE, SAFETY OR FOR CONSTRUCTION RELATED REASONS THE PRUNING SHALL BE PERFORMED BY AN ISA OR ASCA CERTIFIED ARBORIST IN ACCORDANCE WITH THE LATEST VERSION OF THE ANSI A-300 PRUNING STANDARDS AND GOOD HORTICULTURAL PRACTICES. THE CITY URBAN FORESTER SHALL BE PROVIDED WITH A WRITTEN COPY OF THE PROPOSED PRUNING PLAN INCLUDING THE REASONS WHY PRUNING IS NECESSARY, PRIOR TO THE PRUNING ACTIVITIES TAKING PLACE.

4. **ANY ROOT PRUNING, IF REQUIRED DURING THE PROJECT, SHALL BE CONDUCTED UNDER THE SUPERVISION OF AN ISA CERTIFIED ARBORIST. ANY ROOT PRUNING, IF REQUIRED, WILL BE LIMITED TO WHAT IS ABSOLUTELY NECESSARY FOR CONSTRUCTION. ADDITIONALLY, AND ROOT PRUNING WORK WILL BE DOCUMENTED WITH COLOR PICTURES AND PROVIDED TO MR. MARK WILLIAMS AT C.M.B. PUBLIC WORKS / GREENSPACE MANAGEMENT + MR. RICARDO GUZMAN AT C.M.B. PLANNING + ZONING DEPARTMENTS ON A REGULAR BASIS.**

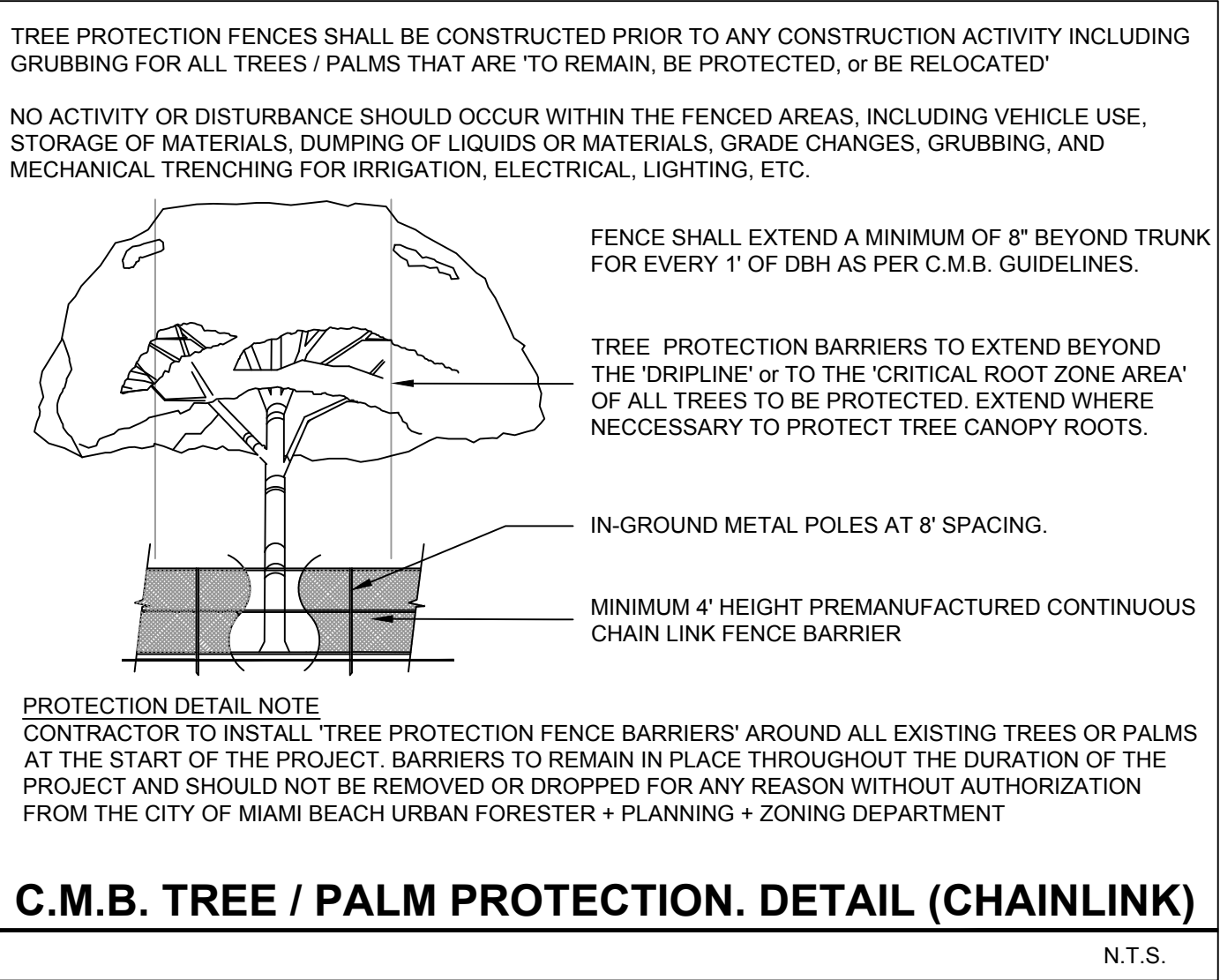

C.M.B. CANOPY MITIGATION NOTES

THE CANOPY MITIGATION OF 797 SF AS REQUIRED BY THE PERMIT HAS BEEN MET AND EXCEEDED. A TOTAL 4,100 SF OF CANOPY HAS BEEN PROVIDED.

CANOPY MITIGATION SUMMARY

- (2) NATIVE SIMPSON'S STOPPER TREES: 200 SF (MB category III @100 SF each)
- (8) NATIVE PIGEON PLUM TREES: 1,200 SF (MB category II @150 SF each)
- (19) JAPANESE BLUEBERRY TREES: 1,900 SF (MB category III @100 SF each)
- (6) BAYRUM TREES: 600 (MB category III @100 SF each)
- (4) PALMS: 200 SF (MB category IV @ 50 SF each)

| C.M.B. EXISTING TREE INVENTORY + DISPOSITION CHART - 40 WEST SAN MARINO | | | | | | | | | | | | |
|---|------------------|-------------------|----------|-------------|-------------|-------------|-----------|-------------|-------------|--------------------------------------|------------------------|--|
| NUMBER | COMMON NAME | BOTANICAL NAME | SPECIMEN | D.B.H. (IN) | HEIGHT (FT) | SPREAD (FT) | CONDITION | DISPOSITION | CANOPY AREA | CANOPY LOSS / MIT. REQ. (SF) | COMMENTS | PERMIT REQUIREMENTS P+Z - GPM / PW - N/A |
| #1 | BLACK OLIVE TREE | Bucida bucura | YES | +/- 30" | +/- 30' | +/- 20' | FAIR | REMAIN | 310 SF | 0 SF | GROWING INTO O.H LINES | N/A |
| #2 | ROYAL PALM | Roystonea elata | YES | +/- 24" | +/- 40' | +/- 20' | GOOD | REMOVE | 310 SF | 310 SF | MITIGATION PROVIDED | GREEN SPACE MANGMT / PW |
| #3 | ARECA PALM | Dypsis lutescense | NO | +/- 10" | +/- 20' | +/- 15' | POOR | REMOVE | 177 SF | 177 SF | MITIGATION PROVIDED | P+Z APPROVAL |
| #4 | ROYAL PALM | Roystonea elata | YES | +/- 24" | +/- 40' | +/- 20' | GOOD | REMOVE | 310 SF | 310 SF | MITIGATION PROVIDED | GREEN SPACE MANGMT / PW |
| TOTAL MITIGATION REQUIRED: 797 SF | | | | | | | | | | TOTAL MITIGATION PROVIDED : 4,100 SF | | |

C.M.B. EXISTING TREE SURVEY LEGEND



TREE or PALM TO BE REMOVED. SEE CHART L-1b.



TREE or PALM TO REMAIN. PRESERVE + PROTECT



TREE or PALM PROTECTION FENCE

| C.M.B. CHAPTER 46, DIVISION 2 - TREE INVENTORY + DISPOSITION PLAN NOTES | | | | | | | | | | | |
|--|--|--|--|--|--|--|--|--|--|--|--|
| 1. THIS 'EXISTING TREE INVENTORY + DISPOSITION PLAN' HAS BEEN PREPARED IN ACCORDANCE WITH THE CITY OF MIAMI BEACH, CHAPTER 46 - ENVIRONMENT, DIVISION 2, TREE PRESERVATION and PROTECTION ORDINANCE. | | | | | | | | | | | |
| 2. EXISTING TREE, PALM, AND VEGETATION INFORMATION AS INDICATED HAS BEEN PREPARED AS AN OVERLAY ON THE SURVEY PREPARED BY J. BONFILL + ASSOCIATES. DATED 04.16.12 | | | | | | | | | | | |
| 3. MIAMI BEACH P+Z MUST APPROVE LANDSCAPE PLANS PRIOR TO REMOVING ANY TREES OR PALMS WITH A DBH BETWEEN 8" AND 12" INCHES. A WRITTEN TREE REMOVAL PERMIT IS REQUIRED FROM CITY OF MIAMI BEACH GREENSPACE MANAGEMENT / P.W FOR THE REMOVAL OF TREES / PALMS WITH A DBH GREATER THAN 12" INCHES OR IN THE R.O.W. | | | | | | | | | | | |
| 4. THE OWNER RESERVES THE RIGHT TO REMOVE ANY VEGETATION NOT LOCATED WITHIN THE CITY R.O.W. w/ a D.B.H. OF LESS THAN 8" WITHOUT OBTAINING A TREE REMOVAL PERMIT. | | | | | | | | | | | |
| 5. THERE ARE NO TREES OR PALMS LOCATED ON THIS PROPERTY THAT WILL REQUIRE TEMPORARY IRRIGATION. ALL EXISTING TREES + PALMS ARE MATURE AND ARE CURRENTLY THRIVING WITHOUT SUPPLEMENTAL IRRIGATION WATER. | | | | | | | | | | | |
| 6. ROYAL PALMS #2 AND #4 ARE PROPOSED TO BE REMOVED BECAUSE THEY ARE IN CONFLICT WITH PROPOSED ARCHITECTURE AND FINISHED ELEVATION. LANDSCAPE ARCHITECT IS PROPOSING NEW SATAKENTIA PALMS WHICH ARE IN SCALE WITH THE PROPOSED ARCHITECTURE AND EXISTING STREETScape CONDITIONS. | | | | | | | | | | | |
| 7. EXISTING TREE DISPOSITION CHART SHALL BE UPDATED ONCE AN UPDATED SURVEY HAS BEEN PROVIDED. | | | | | | | | | | | |

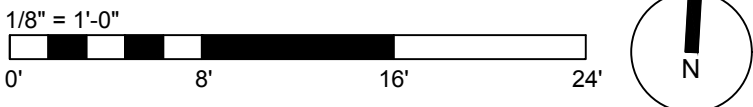

EXISTING TREE SURVEY + DISPOSITION PLAN

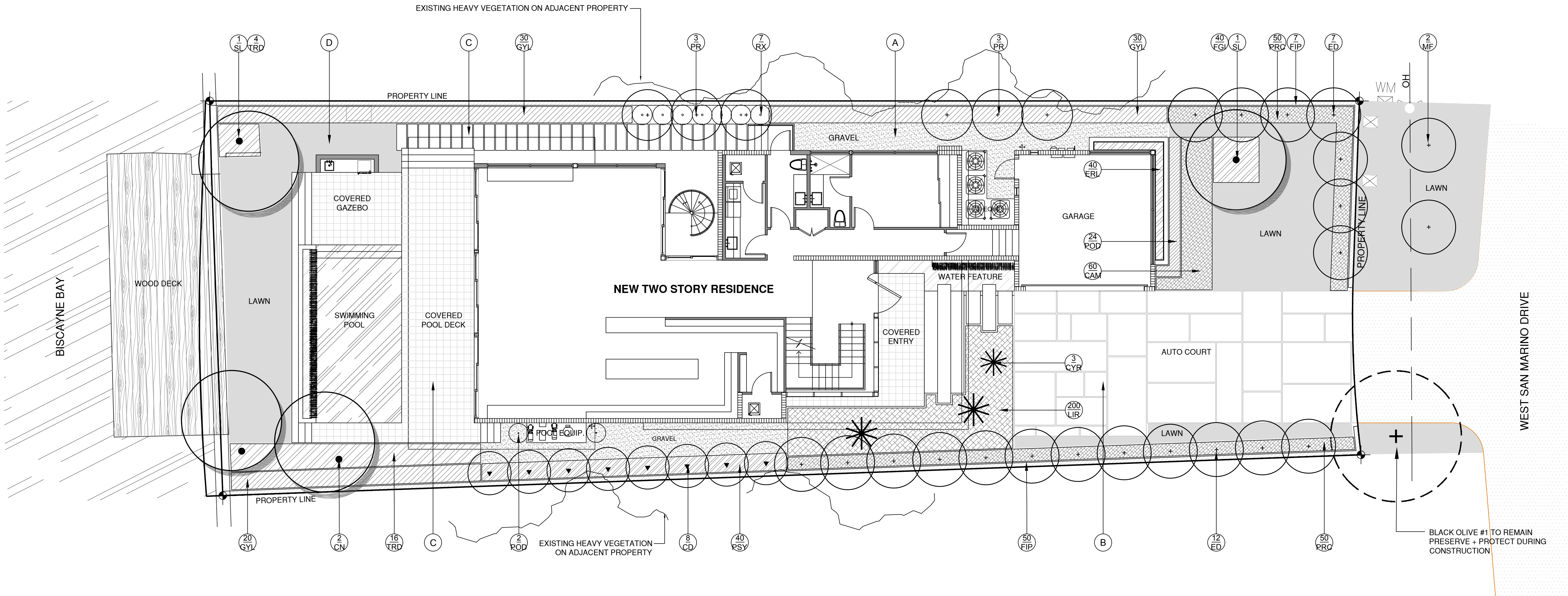

LANDSCAPE PLAN LEGEND

- A 3/8" DECOMPOSED GRANITE AGGREGATE OVER FILTER FABRIC
- B CAST IN PLACE CONCRETE PAVERS WITH LAWN JOINTS
- C STONE PAVERS TO BE SELECTED
- D 'EMPIRE TURF' ZOYSIA GRASS - OVER 2" TOPSOIL BED, SEE PLANTING SPECS

LANDSCAPE LEGEND

MIAMI - DADE COUNTY LANDSCAPE ORDINANCE CHAPTER 18-A (RESIDENTIAL VERSION)

TREES
3 TREES REQUIRED PER LOT / **35 TREES PROVIDED**
(8 PIGEON PLUM TREES + 19 JAPANESE BLUEBERRY TREES + 2 SIMPSON STOPPER + 6 BAY RUM TREES)

NATIVE TREES
30% OF REQUIRED TREES OR .30 X 3 = .9 NATIVE TREES REQUIRED / **8 NATIVE TREES PROVIDED**
(8 PIGEON PLUM TREES)

SHRUBS
10 SHRUBS REQUIRED FOR EACH REQUIRED TREE OR 10 X (3) = 30 REQUIRED / **81 SHRUBS PROVIDED**

NATIVE SHRUBS
30% OF TOTAL SHRUBS REQUIRED MUST BE NATIVE OR .30 X 30 = 9 / **36 NATIVE SHRUBS PROVIDED**
75 DWARF CRABWOOD SHRUBS PROVIDED

LAWN AREA
50% MAXIMUM OF LANDSCAPE AREA: NEW LAWN AREAS ARE LESS THAN 50% OF LANDSCAPE AREA

IRRIGATION SYSTEM
100% COVERAGE PROVIDED PURSUANT TO MIAMI DADE CODE

C.M.B. CANOPY MITIGATION NOTES

THE CANOPY MITIGATION OF 797 SF AS REQUIRED BY THE PERMIT HAS BEEN MET AND EXCEEDED.
A TOTAL 4,100 SF OF CANOPY HAS BEEN PROVIDED.

CANOPY MITIGATION SUMMARY

- (2) NATIVE SIMPSON'S STOPPER TREES: 200 SF (MB category III @100 SF each)
- (8) PIGEON PLUM TREES: 1,200 SF (MB category II @150 SF each)
- (19) JAPANESE BLUEBERRY TREES: 1,900 SF (MB category III @100 SF each)
- (6) BAYRUM TREES: 600 (MB category III @100 SF each)
- (4) PALMS: 200 SF (MB category IV @ 50 SF each)

PLANTLIST - 40 WEST SAN MARINO

| KEY | NATIVE | QTY. | COMMON NAME | BOTANICAL NAME | HEIGHT, SPECIFICATION, & NOTES |
|---|--------|------|---|----------------------------------|---|
| TREES | | | | | |
| CD | YES | 8 | PIGEON PLUM TREE | Coccoloba diversifolia | 65 gallon, 14' height, standard, equal to Treeworld Wholesale |
| ED | NO | 19 | JAPANESE BLUEBERRY TREE | Elaeocarpus decipiens, | 100 gallon, standard, specimen, equal to Treeworld Wholesale |
| MF | YES | 2 | SIMPSON STOPPER TREE | Myrcianthes fragrens | 100 gallon, 14' height, standard, specimen, equal to Treeworld Wholesale |
| PR | NO | 6 | BAY RUM TREE | Myrcianthes fragrens | 100 gallon, 14' height, standard, equal to Treeworld Wholesale |
| PALMS + BAMBOO | | | | | |
| CN | NO | 2 | 'GR. MALAYAN' COCONUT PALM | Cocos nucifera 'Green Malayan' | 14' graywood, Full heads, Florida Fancy, see landscape plans for grey wood |
| SL | NO | 2 | SATAKENTIA PALMS | Satakentia ilukuensis | 10' graywood, Full heads, Florida Fancy, see landscape plans for grey wood |
| RX | NO | 7 | LADY PALMS | Rhapis excelsa | 5' height, 5' spread, full |
| SHRUBS | | | | | |
| GYL | YES | 80 | CRABWOOD SHRUBS | Gymnanthes lucida | 6' overall height, full to base, matched, 30" o.c. or as required to create a full screen |
| POD | NO | 26 | PODOCARPUS | Podocarpus macrophyllus | 4' height, full to base, 12" o.c. or as required to create a full screen, (2) by pool eq. at 6' ht. |
| PSY | YES | 40 | DWARF BAHAMA COFFEE | Psychotria ligustrifolia | 7 gallon, full, space 18" on center |
| TROPICALS, GROUNDCOVERS, + ACCENTS | | | | | |
| CAM | NO | 60 | DWARF CARRISSA | Carrisa macro. 'Emerald Blanket' | 3 gallon, full 18" on center |
| CYR | NO | 3 | KING SAGO PALM | Cycas revoluta | 25 gallon, 4' h x 4' spread |
| FGI | NO | 40 | FICUS GREEN ISLAND | Ficus macrocarpa 'Green Island' | 3 gallon, full, space 12" on center |
| ERL | YES | 40 | GOLDEN BEACH CREEPER | Ermodea littoralis | 3 gallon, full, space 12" on center |
| LIR | NO | 536 | LILYTURF | Liriope muscari | 3 gallon, full 12" on center |
| PRC | NO | 100 | ROJO CONGO | Philodendron 'Rojo Congo' | 3 gallon, full 24" on center |
| TRD | YES | 20 | FAKAHATCHEE GRASS | Tripsacum dactyloides | 3 gallon, full 36" on center |
| SOD, AGGREGATE & MULCH | | | | | |
| DGA | | | 3/8" DECOMPOSED GRANITE AGGREGATE OR STONE TO BE SELECTED, INSTALLED OVER FILTER FABRIC AND WEED BARRIER MATERIAL / OLIMAR, 2" MIN. DEPTH | | |
| MLC | | | DARK BROWN 'FLORI MULCH' SHREDDED ORGANIC MULCH (NO CYPRESS), TO BE DETERMINED | | |
| SOD | | | 'EMPIRE TURF' ZOYSIA GRASS - OVER 2" TOPSOIL BED, SEE PLANTING SPECS | | |

LANDSCAPE PLAN



REYNOLDS RESIDENCE
40 W. SAN MARINO DR.
MIAMI BEACH, FL 33139

seal

CHRISTOPHER CAWLEY, RLA
Florida License LA 6666786

comm no.
1639

date:
09/30/2016

revised:

sheet no.

L-2

LANDSCAPE NOTES

1. ALL PLANT MATERIAL SHALL BE FLORIDA GRADE NO. 1 OR BETTER.
2. CONTRACTOR SHALL BECOME FAMILIAR WITH THE LOCATION OF, AVOID, AND PROTECT ALL UTILITY LINES, BURIED CABLES, AND OTHER UTILITIES.
3. TREE, PALM, ACCENT AND BED LINES ARE TO BE LOCATED IN THE FIELD AND APPROVED BY THE LANDSCAPE ARCHITECT PRIOR TO INSTALLATION.

ANY CHANGES TO R.O.W. (RIGHT OF WAY) MATERIAL IN REGARDS TO PLACEMENT OF SPECIES SHALL REQUIRE THE APPROVAL AND CONSULTATION OF THE CITY URBAN FORESTER AND OR CITY STAFF.

4. ALL PLANTING SOIL SHALL BE 50:50 TOPSOIL-SAND MIX, FREE OF CLAY, STONES, ROCKS, OR OTHER FOREIGN MATTER. THIS SPECIFICATION INCLUDES ALL BACKFILL FOR BERMS AND OTHER LANDSCAPE AREAS.

CARE SHALL BE TAKEN TO AVOID PLACEMENT OF CONSTRUCTION FILL, GRAVEL, AND OR DEBRIS OVER THE ROOTBALLS OF INSTALLED OR EXISTING TREES AND OR PALMS ON SITE.

SODDED-LAWN AREAS
2" DEPTH PLANTING SOIL SPREAD IN PLACE- THROUGHOUT.

GROUNDCOVER PLANTING BEDS:
6" DEPTH PLANTING SOIL SPREAD IN PLACE- THROUGHOUT.

SHRUB AND HEDGE PLANTING AREAS:
12" DEPTH PLANTING SOIL SPREAD IN PLACE- THROUGHOUT.

TREES, PALMS, SPECIMEN PLANT MATERIAL LOCATIONS:
REMOVE ALL LIMEROCK PRESENT TO A DEPTH OF AT LEAST 30" BEFORE PLACING NEW PLANTING SOIL. APPLY NEW CLEAN PLANTING SOIL IN PLANTING AREA AS REQUIRED

5. THE SITE CONTRACTOR SHALL BE RESPONSIBLE TO BRING ALL GRADES TO WITHIN 2" OF FINAL GRADES. THIS SHALL INCLUDE A 2" APPLICATION OF 50:50 TOPSOIL-SAND MIX FOR ALL LANDSCAPE AND AREAS TO BE SODDED.
6. THE LANDSCAPE CONTRACTOR SHALL CALCULATE AND SUBMIT AN ITEMIZED PRICE FOR THE 2" APPLICATION OF 50:50 MIX FOR ALL SOD AREAS AS A REFERENCE IN THE CASE THAT THERE WOULD BE A DISCREPANCY BETWEEN SITE AND LANDSCAPE CONTRACTORS AND NOTIFY THE SITE CONTRACTOR OR PROJECT SUPERINTENDENT AS TO THIS DISCREPANCY. IT WILL THEN BE DETERMINED WHICH PARTY WILL PROVIDE THIS 2" TOPSOIL-SAND MIX APPLICATION AND SUBSEQUENT PAYMENT OTHER PLANTING SOIL MIXES TO BE ADDED, I.E. FOR TREES, PALMS, SPECIMEN PLANTS, SHRUBS AND GROUNDCOVERS SHALL BE THE RESPONSIBILITY OF THE LANDSCAPE CONTRACTOR AND BE INCLUSIVE WITH THE LANDSCAPE BID.
7. ALL EXISTING TREE + PALM INFORMATION THAT HAS BEEN PROVIDED ON THIS PLAN FOLLOWS THE CITY OF MIAMI BEACH TREE PERMITTING GUIDELINES. ANY TREES or PALMS CONSIDERED INVASIVE or THAT FALL UNDER THE TREE PERMIT EXEMPTION / PROHIBITED SPECIES LIST 24-94 (4) MAY NOT BE SHOWN FOR CLARITY PURPOSES. ANY DISCREPANCIES IF NOTED UPON FURTHER FIELD INSPECTION SHALL BE BROUGHT TO THE IMMEDIATE ATTENTION OF THE LANDSCAPE ARCHITECT.
8. IRRIGATION SHALL PROVIDE FOR A 100% COVERAGE WITH 50% OVERLAP MINIMUM AND BE PROVIDED BY A FULLY AUTOMATIC IRRIGATION SYSTEM W/ RAIN MOISTURE SENSOR ATTACHED TO CONTROLLER. ALL FLORIDA BUILDING CODE APPENDIX "F" IRRIGATION REQUIREMENTS SHALL BE STRICTLY ADHERED TO FOR INSTALLATION AND PREVAILING WATER MANAGEMENT DISTRICT RESTRICTIONS AND REGULATIONS SHALL BE IN COMPLIANCE FOR POST-INSTALLATION WATERING SCHEDULES. CONTRACTOR SHALL COORDINATE WITH THE IRRIGATION CONTRACTOR AND LEAVE PROVISIONS FOR ALL SLEEVING AND PIPE ROUTING. ALL UNDERGROUND UTILITIES TO BE LOCATED BY DIALING 811 AS REQUIRED BY LAW.
9. ALL PLANTING BEDS SHALL BE MULCHED TO A DEPTH OF 2" WITH A SMALL GRAY GRANITE AGGREGATE or APPROVED ORGANIC MULCH FREE FROM WEEDS AND PESTS. NO 'CYPRESS MULCH' OR 'RED DYED MULCH' TO BE ACCEPTED. KEEP MULCH 6" AWAY FROM TREE OR PALM TRUNKS AS PER INDUSTRY RECOMMENDATIONS.

10. SOD SHALL BE 'EMPIRE TURF' ZOYSIA GRASS IN ALL LAWN AREAS AS SHOWN ON THE PLANS. SOD SHALL BE STRONGLY ROOTED, FREE FROM WEED, FUNGUS, INSECTS AND DISEASE. CONTRACTOR SHALL SOD ALL AREAS AS INDICATED ON THE PLANS OR AS DIRECTED. PAYMENT SHALL BE DETERMINED BY THE TOTAL MEASURED SODDED AREAS X THE UNIT PRICE SUBMITTED AND FIELD VERIFIED. SOD SHALL CARRY A 5-MONTH WARRANTY.

11. ALL TREES, PALMS, SHRUBS AND GROUNDCOVERS, AND SOD / LAWN SHALL CARRY A ONE-YEAR WARRANTY FROM THE DATE OF FINAL ACCEPTANCE.

12. ALL TREES AND PALMS SHALL BE STAKED PER ACCEPTED STANDARDS BY THE FLORIDA NURSERYMEN & GROWERS LANDSCAPE ASSOCIATION (FNGLA) AND ANSI A-300 (PART 6)-2012 TREE, SHRUB, AND OTHER WOODY PLANT MANAGEMENT STANDARD PRACTICES (PLANTING AND TRANSPLANTING). CONTRACTOR SHALL ENSURE THAT THE PLANS, DETAILS, SPECIFICATIONS AND NOTES HAVE BEEN ADHERED TO AND THAT THE LANDSCAPE AND IRRIGATION INSTALLATION IS COMPLIANT TO ALL ITEMS AS DIRECTED ON THE PLANS PRIOR TO SCHEDULING OF THE FINAL INSPECTION.

CONTRACTOR SHALL REMOVE ALL STAKES, POLES, WELLINGTON TAPE AND OR BRACING MATERIALS FROM ALL PALMS, TREES AND SHRUBS WITHIN 1 YEAR OF INSTALLATION.

13. THE PLANT LIST IS INTENDED ONLY AS AN AID TO BIDDING. ANY DISCREPANCIES FOUND BETWEEN THE QUANTITIES ON THE PLAN AND PLANT LIST, THE QUANTITIES ON THE PLAN SHALL BE HELD VALID.

14. IF NECESSARY, CONTRACTOR SHALL PROVIDE A WATER TRUCK DURING PLANTING TO ENSURE PROPER WATERING IN DURING INSTALLATION AND CONTRACTOR WILL BE RESPONSIBLE FOR CONTINUAL WATERING UNTIL FINAL ACCEPTANCE BY THE OWNER.

A MINIMUM OF 6 MONTHS OF SUPPLEMENTAL HAND OR AUTOMATIC IRRIGATION SYSTEM WATERING SHALL BE REQUIRED TO AID IN NEW TREE OR PALM ESTABLISHMENT.

15. FERTILIZATION: ONE COMPLETE APPLICATION OF GRANULAR FERTILIZER SHALL BE APPLIED PRIOR TO FINAL ACCEPTANCE AND APPROVAL BY THE LANDSCAPE ARCHITECT. FERTILIZER SHALL BE OSMACOTE OR APPROVAL EQUAL.

16. SHOULD ANY TREES OR PALMS BE DAMAGED THEY SHALL BE EVALUATED BY THE CITY URBAN FORESTER TO DETERMINE CORRECTIVE ACTIONS THAT MAY INCLUDE REMOVAL, CORRECTIVE PRUNING AND OR REPLACEMENT. ANY CORRECTIVE ACTION REQUIRED SHALL BE PERFORMED IN ACCORDANCE WITH A MIAMI DADE COUNTY CODE, ANSI-A 300 PRUNING STANDARDS AND OR AN ISSUED ERM TREE PERMIT OR ENVIRONMENTAL PERMIT. ANY CORRECTIVE PRUNING REQUIRED SHALL BE PERFORMED BY AN ISA CERTIFIED ARBORIST OR ASCA CONSULTING ARBORIST AND THE CITY URBAN FORESTER SHALL BE CONSULTED.

17. ALL TREES TO REMAIN ON SITE IN THE VICINITY OF CONSTRUCTION ACTIVITIES, SHALL BE PROTECTED THROUGH THE USE OF TREE PROTECTION BARRICADES INSTALLED AT THE TREE DRIP LINE. A TREE PROTECTION FENCE SHALL BE CONSTRUCTED PRIOR TO ANY CONSTRUCTION ACTIVITY INCLUDING GRUBBING AND SHALL REMAIN IN PLACE UNTIL ON SITE CONSTRUCTION HAS BEEN COMPLETED.

18. CITY OF URBAN FORESTER AND OR PLANNING DEPARTMENT STAFF TO APPROVE ROW TREES BEFORE THEY ARE PLANTED.

20. MULCH SHALL NOT BE APPLIED WITHIN 6" OF ANY TREE OR PALM TRUNK THAT IS INSTALLED OR INCORPORATED INTO THE PROJECT. FOR ROW TREES + PALMS, ALL MULCH SHALL BE AMERIGROW 'PREMIUM PINEBARK BROWN' SHREDDED MULCH OR A CITY APPROVED ALTERNATIVE.

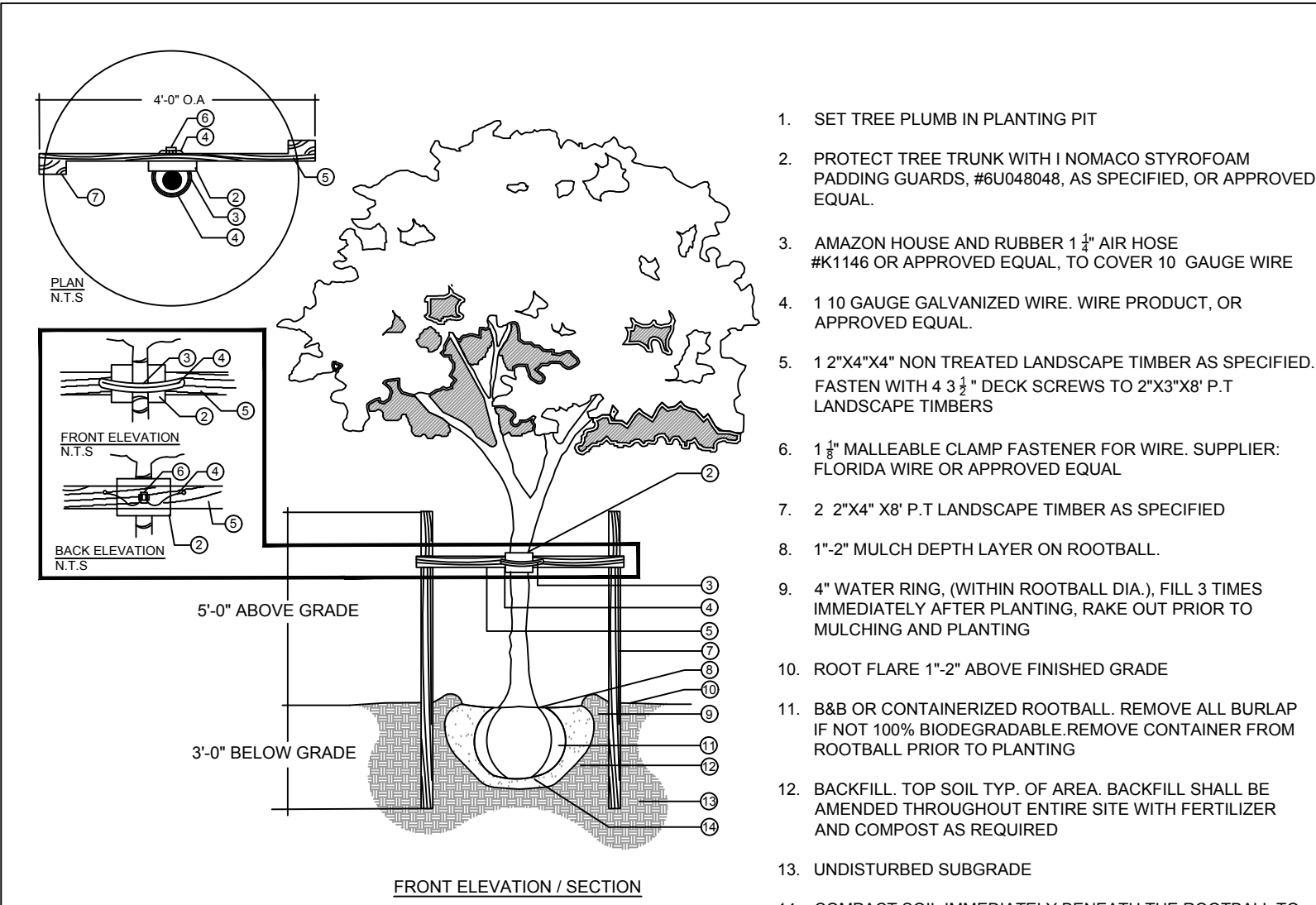

C.M.B. MEDIUM TREE PLANTING DETAIL

N.T.S.

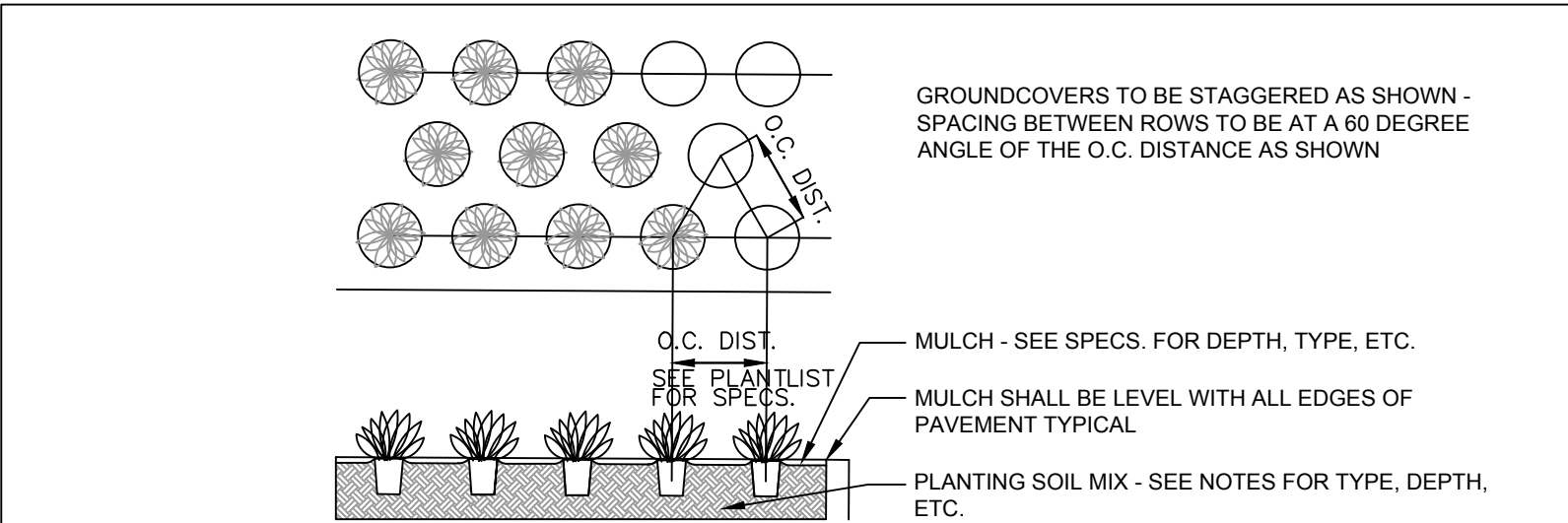

GROUNDCOVER PLANTING DETAIL

N.T.S.

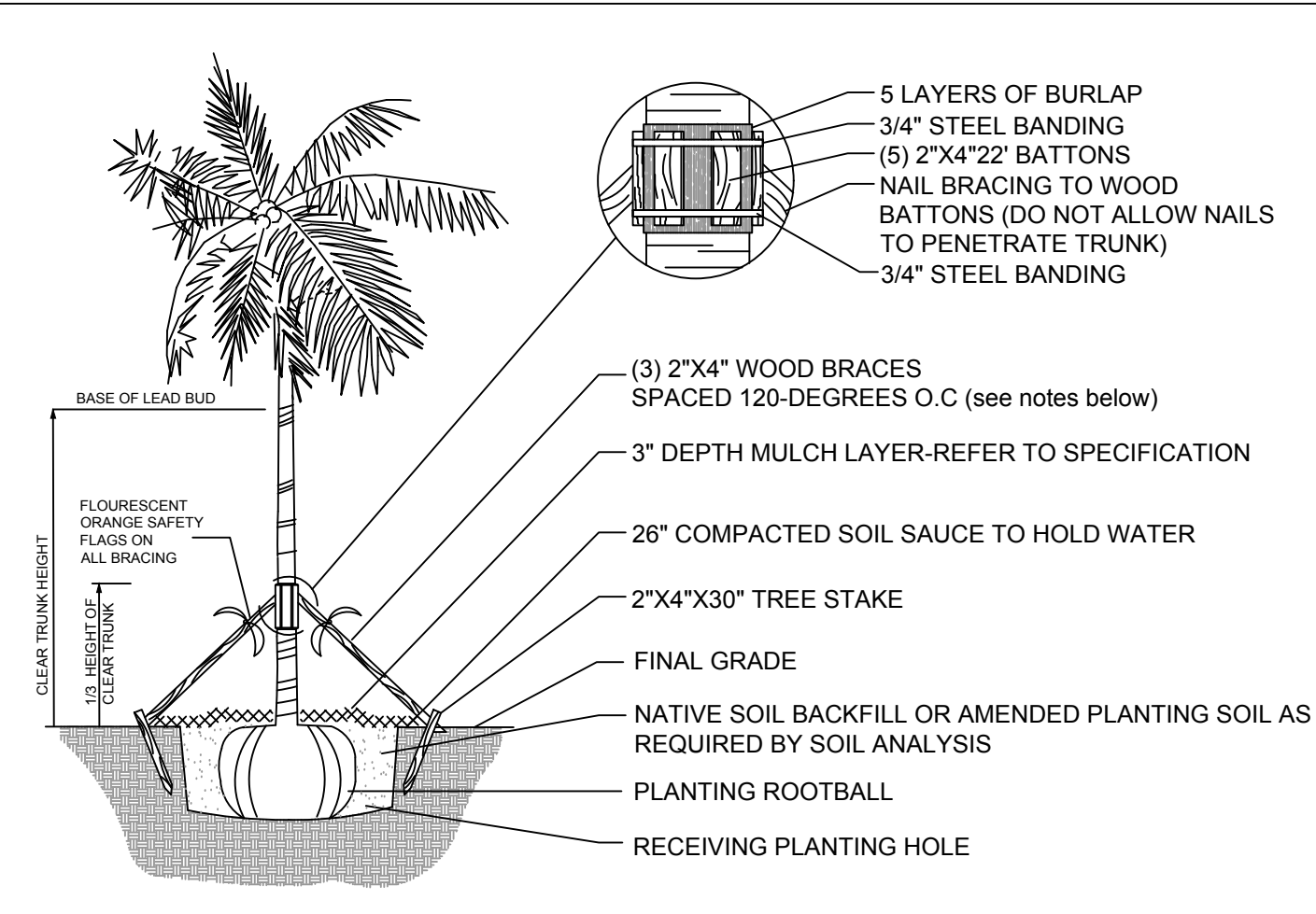

- NOTES:
1. PALMS OVER 30' GW HEIGHT, USE MINIMUM (4) 4X4 BRACING AND STAKES
 2. PRIMARY STAKES SHOULD PLACED PARALLEL TO WALKWAYS WHENEVER POSSIBLE
 3. RECEIVING PLANTING HOLE SHALL BE APPROXIMATELY 1/3 LARGER THAN ROOTBALL
 4. BUD SHALL BE PERPENDICULAR TO THE GROUND PLANE
 5. TRUNK SHALL BE STRAIGHT AND WITHOUT CURVES
 6. NO SCARRED OR BLACKENED TRUNKS
 7. AMENDED SOIL MIX TO BE ADDED AT THE TIME OF PLANTING NEEDED, SHALL CONSIST OF A RATIO MIX OF 80% CLEAN SILICA SAND AND 20% SCREENED PULVERIZED TOPSOIL AS NEEDED

C.M.B. PALM PLANTING DETAIL

N.T.S.

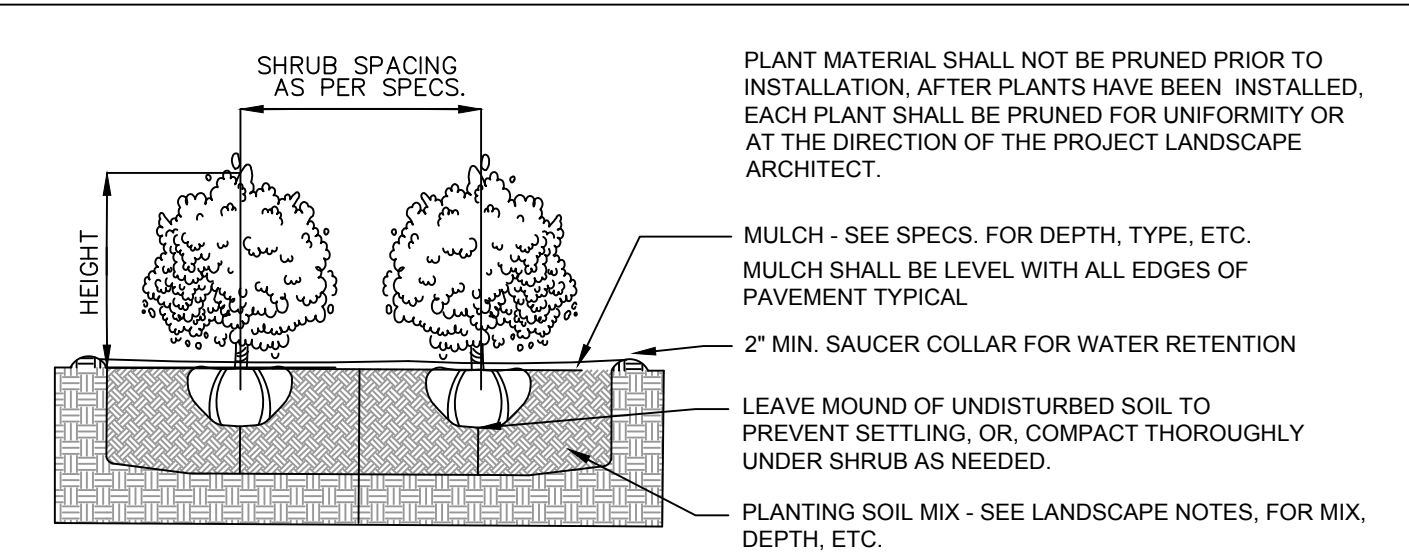

SHRUB PLANTING DETAIL

N.T.S.

IRRIGATION NOTES

1. IRRIGATION CONTRACTOR SHALL PROVIDE, FURNISH, AND INSTALL A FULLY AUTOMATIC IRRIGATION SYSTEM WHICH WILL COMPLY WITH ALL LOCAL CODE, STATE CODE, & WATER MANAGEMENT DISTRICT (SWFMD) REQUIREMENTS.
2. THE IRRIGATION CONTRACTOR SHALL SCHEDULE AN ON-SITE PRE-CONSTRUCTION CONFERENCE WITH THE OWNER AND THE OWNER'S AUTHORIZED REPRESENTATIVE PRIOR TO COMMENCEMENT OF INSTALLATION OF THE IRRIGATION SYSTEM.
3. CONTRACTOR SHALL INSTALL POP-UP TYPE HEADS. SPRAY TYPE SHALL BE ROTOR, IMPACT, SPRAY, OR BUBBLER AND SHALL BE INSTALLED SO AS NOT TO CAUSE ANY OVERSPRAY ONTO ANY PAVED SURFACES, I.E. ROADS, SIDEWALKS, ETC. ALL FIXTURES SHALL BE "TORO", "RAINBIRD" OR AN APPROVED EQUAL. ALL WORK SHALL BE DONE IN A PROFESSIONAL MANNER AS PER MANUFACTURER'S SPECIFICATIONS.
4. ALL MAIN SUPPLY LINE SHALL BE PVC SCHEDULE 40 PIPE. ALL PVC FITTINGS SHALL BE SCHEDULE 40. THE MAINLINE IS SHOWN SCHEMATICALLY. LOCATE MAIN LINES IN LANDSCAPE AREAS WHERE POSSIBLE AND SLEEVE UNDER PAVEMENT WHERE NECESSARY. MAINLINES SHALL BE IN THE SAME TRENCH WITH THE LATERAL LINES WHERE POSSIBLE.
5. CONTRACTOR SHALL FAMILIARIZE HIMSELF WITH THE LOCATION OF AND AVOID & PROTECT ALL UTILITY LINES, DUCTS, BURIED CABLES AND OTHER UTILITIES IN THE AREA. CONTRACTOR WILL BE RESPONSIBLE FOR THE REPAIR, LIABILITY, AND COSTS INCURRED IN THE DAMAGE OR DESTRUCTION OF SAID UTILITIES. CALL SUNSHINE STATE ONE CALLS 811, 48 HOURS PRIOR TO COMMENCEMENT OF ANY WORK FOR PROPER UTILITY LOCATION AND CLEARANCES.
6. THE CONTRACTOR SHALL SECURE ALL WORK WITH THE PROJECT MANAGER, LANDSCAPE CONTRACTOR AND ALL OTHER CONTRACTORS TO INSURE PROPER INSTALLATION, SCHEDULING, AND PROCEDURE.
7. THE CONTRACTOR SHALL COORDINATE WITH THE PROJECT MANAGER TO PROVIDE ELECTRICAL SUPPLY TO THE CONTROLLER, PUMP, ETC. AS NEEDED.
8. THE CONTRACTOR SHALL BE RESPONSIBLE TO SECURE ALL PERMITS AS MAY BE DEEMED NECESSARY TO PERFORM THE WORK. ENTIRE SYSTEM SHALL BE INSTALLED IN COMPLIANCE WITH ALL LOCAL AND STATE CODES.
9. ALL SLEEVES UNDER PAVEMENT SHALL BE BURIED PER FLORIDA BUILDING CODE, APPENDIX "F". ALL LATERAL SLEEVES UNDER SIDEWALKS SHALL BE BURIED BELOW WALKWAYS AND SHALL BE SCHEDULE 40 PVC. ALL SLEEVING SHALL BE SCHEDULE 40 PVC PIPE AND SHALL BE 2 TIMES THE MAIN OR LATERAL PIPE SIZE.
10. THE CONTRACTOR SHALL CONNECT THE MASTER VALVE (WHEN APPLICABLE) AND ALL ELECTRIC VALVES TO THE CONTROLLER AND PROVIDE PROPER SYNCHRONIZATION.
11. ALL LOW VOLTAGE ELECTRIC VALVES SHALL BE #14 DIRECT BURIAL. ALL WIRES UNDER ROADS TO BE PLACED IN A SEPARATE 1" SLEEVE. CONTRACTOR SHALL PROVIDE A MINIMUM OF TWO EXTRA WIRES FOR EMERGENCY POST INSTALLATION WIRING.
12. ALL LINE LOCATIONS ARE APPROXIMATE. THE CONTRACTOR SHALL ADJUST TRENCHING AND LOCATION OF SPRAY HEADS IN THE FIELD FOR EXISTING CONDITIONS, WALKS, UTILITIES, STRUCTURES, AND PLANTINGS TO PROVIDE AND INSURE 100% COVERAGE AND 100% OVERLAP.
13. CONTRACTOR SHALL PROVIDE A ONE-YEAR GUARANTEE ON ALL PARTS AND A 90 DAY GUARANTEE ON LABOR FROM THE DATE OF FINAL ACCEPTANCE.
14. THE IRRIGATION CONTRACTOR SHALL RECORD ALL CHANGES MADE TO THE IRRIGATION SYSTEM DURING INSTALLATION, AND PROVIDE AN AS-BUILT DRAWING TO THE OWNER'S REPRESENTATIVE UPON COMPLETION AND ACCEPTANCE OF THE WORK.
15. THE IRRIGATION CONTRACTOR SHALL INSTRUCT THE OWNER OR THE OWNER'S REPRESENTATIVE IN THE COMPLETE OPERATION AND MAINTENANCE OF THE SYSTEM. THE CONTRACTOR SHALL FURNISH TWO COPIES OF AN IRRIGATION SYSTEM MANAGEMENT MANUAL PREPARED BY THE MANUFACTURER AND THE SYSTEM INSTALLER.

