

ENLARGED 2ND LEVEL LANDSCAPE PLAN - MATCHLINE A  
 SCALED TO FIT 11"x17"

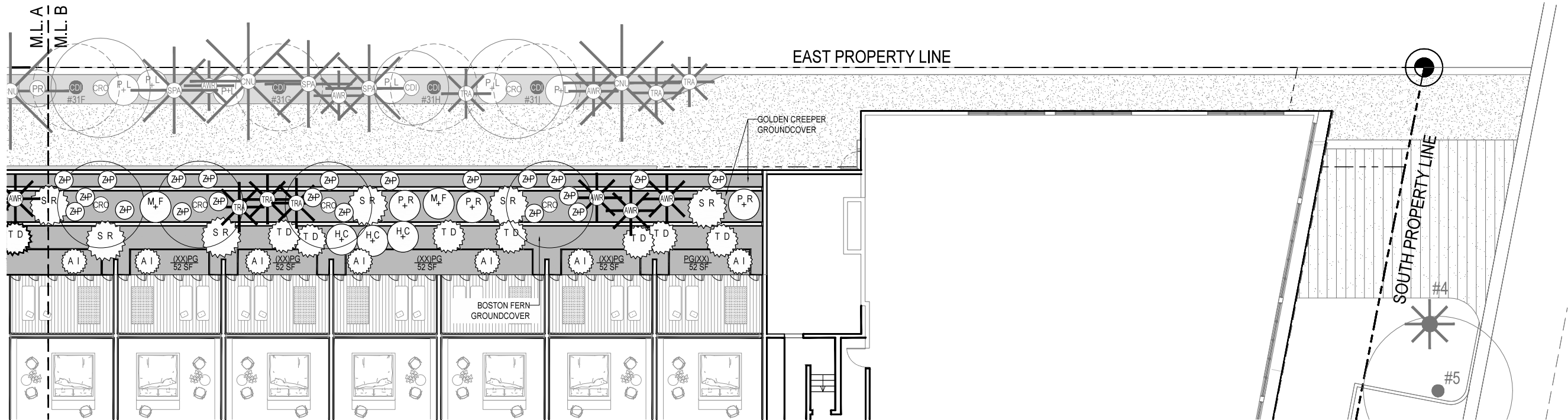

ENLARGED 2ND LEVEL LANDSCAPE PLAN - MATCHLINE B  
 SCALED TO FIT 11"x17"

**PLANT SYMBOLS**

EXISTING PALM TO REMAIN	NEW PALM	RELOCATED PALM	SHRUB/ACCENT PLANT
EXISTING TREE TO REMAIN	NEW TREE	RELOCATED TREE	NEW GROUND COVER & COUNT

**NOTE:**  
 SEE SHEET L-3.04 FOR PLANT LIST.

FOR MORE INFORMATION, CONTACT THE ARCHITECT OR LANDSCAPE ARCHITECT. THESE PLANS COMPLY WITH ALL APPLICABLE BUILDING AND ZONING CODES.

NATURALFACIAL, INC.  
 Landscape Architecture + Design  
 6915 Red Road, Suite 224  
 Coral Gables, FL 33143  
 O: 786.777.8864 / M: 305.321.2341  
 www.naturalfacial.com  
 FIRM REG. NO. LC26000548



RENE GONZALEZ architect  
 670 NE 50 TERRACE  
 MIAMI, FLORIDA 33137  
 305.795.6803  
 WWW.RENEGONZALEZARCHITECT.COM  
 AA # 0003351  
 AR # 001824

THE STANDARD HOTEL  
 40 ISLAND AVENUE  
 MIAMI BEACH, FL 33139  
 DRB FINAL SUBMITTAL

PETER ANSELMO  
 R.L.A. FL# 6667221  
 DATE: 2016.09.09  
 SCALE: SCALED TO FIT 11"x17"  
 REVISIONS:

ENLARGED 2ND LEVEL  
 LANDSCAPE  
 PLAN - MATCHLINE A & B

TO THE BEST OF OUR KNOWLEDGE,  
 THESE PLANS COMPLY WITH ALL  
 APPLICABLE BUILDING AND ZONING CODES

GENERAL

1. EXISTING TREES DESIGNATED TO REMAIN SHALL BE PROTECTED DURING ALL CONSTRUCTION PHASES. ANY TREES OR SHRUBS DESIGNATED TO REMAIN WHICH ARE SCARPED OR DESTROYED WILL BE REPLACED AT THE CONTRACTORS EXPENSE, WITH SIMILAR SPECIES, SIZE AND QUALITY.  
2. EXISTING TREES DESIGNATED TO BE STORED OFF-SITE, SHALL BE PROTECTED AND CARED FOR ACCORDINGLY TO INDUSTRY STANDARD. ANY TREES OR SHRUBS SCARPED OR DESTROYED WILL BE REPLACED AT THE CONTRACTORS EXPENSE, WITH SIMILAR SPECIES, SIZE AND QUALITY.  
3. LANDSCAPE CONTRACTOR SHALL BECOME FAMILIAR WITH ALL UNDERGROUND UTILITIES OR STRUCTURES PRIOR TO DIGGING. LANDSCAPE CONTRACTOR SHALL REPAIR ALL DAMAGE TO UNDERGROUND UTILITIES AND/OR CONSTRUCTION AT NO COST TO THE OWNER.  
4. ALL PLANT MATERIALS SHALL BE GUARANTEED FOR A PERIOD OF 12 MONTHS AFTER DATE OF SUBSTANTIAL COMPLETION.  
5. LANDSCAPE CONTRACTOR SHALL VERIFY ALL ESTIMATED QUANTITIES OF MATERIAL SHOWN ON THE DRAWINGS PRIOR TO SUBMITTING A BID. PLANTING PLAN TO TAKE PRECEDENCE OVER PLANT LIST.  
6. EXISTING PLANT MATERIAL NOT SHOWN ON THE PLAN AND IN CONFLICT WITH NEW PLANTING SHALL BE EVALUATED AT THE TIME OF NEW PLANTING INSTALLATION BY THE LANDSCAPE ARCHITECT.  
7. ALL BUILDING CONSTRUCTION MATERIAL AND FOREIGN MATERIAL SHALL BE REMOVED FROM PLANTING AREAS AND REPLACED WITH 80/20 WH/PLANT MIX, OR AS PER SPECIFICATIONS. ALL ISLANDS IN PARKING LOTS AND AROUND BUILDINGS SHALL BE EXCAVATED TO A DEPTH OF 3" MIN. AND REPLACED WITH 80/20 PLANT MIX, OR AS PER SPECIFICATIONS.  
8. ALL PLANT MATERIAL SYMBOLS SHOWN ON LANDSCAPE PLAN SHALL BE CONSIDERED DIAGRAMMATIC AND SHOULD BE ADJUSTED IN THE FIELD BY CONTRACTOR TO AVOID ALL UTILITIES AND ALL OTHER OBSTRUCTIONS AFTER CONSULTING THE LANDSCAPE ARCHITECT.  
9. ALL SIZES SHOWN FOR PLANT MATERIAL ON THE PLAN ARE TO BE CONSIDERED MINIMUM. ALL PLANT MATERIAL MUST MEET OR EXCEED THESE MINIMUM REQUIREMENTS FOR BOTH HEIGHT AND SPREAD. ANY OTHER REQUIREMENTS FOR SPECIFIC SHAPE OR EFFECT AS NOTED ON THE PLAN SHALL ALSO BE REQUIRED FOR ACCEPTANCE. ALL TREES TO HAVE SINGLE TRUNK, UNLESS OTHERWISE NOTED ON THE PLANS OR PLANT LIST.  
10. SITE PREPARATION SHALL INCLUDE THE ERADICATION AND REMOVAL OF ANY WEEDS, GRASS AS WELL AS CLEANUP OF ANY DEAD MATERIAL AND FINISH GRADING AS PER THE SPECS.  
11. THE LANDSCAPE CONTRACTOR SHALL AT ALL TIMES KEEP THE JOB SITE CLEAN AND FREE FROM ACCUMULATION OF WASTE MATERIAL, DEBRIS AND RUBBISH.  
12. THE LANDSCAPE CONTRACTOR SHALL EXERCISE CAUTION TO PROTECT ANY NEW HARDSCAPE CONSTRUCTION OR IRRIGATION. ANY DAMAGE SHALL BE REPLACED OR REPAIRED TO THE ORIGINAL STATE BY THE LANDSCAPE CONTRACTOR AT NO ADDITIONAL COST TO THE OWNER.  
13. ALL PLANT MATERIAL TO BE FLORIDA #1 OR BETTER, AS DEFINED BY THE FLORIDA DEPARTMENT OF AGRICULTURES "CODES AND STANDARDS FOR NURSERY PLANTS PART I AND II".  
14. MULCH ALL PLANTING AREAS WITH SHREDDED ORGANIC MULCH TO A MINIMUM DEPTH OF 2" WITH THE EXCEPTION OF BEACH PLANTING.  
15. ALL PLANTING AREAS WITHIN UNIT OF WORK SHALL BE 100% FULLY IRRIGATED. THE IRRIGATION CONTRACTOR AWARDED THE BID SHALL COMPLY WITH THE PROPOSED IRRIGATION DESIGN.  
16. ON-SITE LAYOUT OF PLANT MATERIAL MUST BE COORDINATED WITH THE LANDSCAPE ARCHITECT PRIOR TO INSTALLATION. L.A. TO BE GIVEN A MIN. OF (1) WEEK NOTICE TO REVIEW PRIOR TO IMPLEMENTATION.  
17. LANDSCAPE CONTRACTOR TO INCLUDE REMOVAL, CORRECTIVE PRUNING AND/OR REPLACEMENT. ANY CORRECTIVE ACTIONS REQUIRED SHALL BE PERFORMED IN ACCORDANCE WITH CITY OF MIAMI BEACH PRUNING STANDARDS AND/OR AN ISSUED ERM TREE OR ENVIRONMENTAL PERMIT.  
18. TREE PROTECTION BARRIERS MUST BE INSTALLED AT THE DRIP LINES OF ALL TREES AND PALMS PRIORS TO REMAIN OR BE RELOCATED PRIOR TO THE START OF CONSTRUCTION ACTIVITIES. BARRIERS AND SHALL REMAIN IN PLACE UNTIL CONSTRUCTION HAS COMPLETED.  
19. CARE SHALL NOT BE APPLIED WITHIN 6" OF ANY TREE OR PALM TRUNKS THAT ARE INSTALLED OR INCORPORATED INTO THE PROJECT. FOR ROW TREES/PALMS PLEASE UTILIZE AMERIGROW (PREMIUM FIREHAWK BROWN) SHREDDED MULCH OR A CITY APPROVED ALTERNATIVE.  
20. SHOULD ANY CORRECTIVE STRUCTURAL PRUNING BE NECESSARY FOR TREES PROPOSED TO REMAIN ON SITE, DUE TO CLEARANCE, SAFETY OR FOR CONSTRUCTION RELATED REASONS THE PRUNING SHALL BE PERFORMED BY AN ISA OR ASCA CERTIFIED ARBORIST IN ACCORDANCE WITH THE LATEST VERSION IN THE ANSI A300 PRUNING STANDARDS AND GOOD HORTICULTURAL PRACTICES. THE CITY URBAN FORESTER SHALL BE PROVIDED WITH A WRITTEN COPY OF THE PROPOSED PRUNING PLAN INCLUDING THE REASONS WHY PRUNING IS NECESSARY PRIOR TO THE PRUNING ACTIVITIES TAKING PLACE.  
21. CARE SHALL BE TAKEN TO AVOID UTILITY OR CONSTRUCTION TRENCHING THROUGH EXISTING TREE OR PALM DRIP LINES. IF TREES SLATED TO REMAIN IN PLACE OR BE RELOCATED, IF CONSTRUCTION REQUIRES THE CUTTING OF ANY ROOTS WITH A DIAMETER OF 2" OR GREATER, ROOTS SHALL BE CLEANLY CUT WITH A SHARP TOOL, AS DIRECTED BY AN ISA CERTIFIED ARBORIST AND IN ACCORDANCE WITH THE ANSI A300 STANDARDS. CUT ROOTS SHOULD BE IMMEDIATELY COVERED WITH SOIL TO PREVENT DRYING. ROOTS SHOULD NOT BE TORN OR BROKEN BY HEAVY EQUIPMENT. SHREDDED, RAGGED OR BROKEN ROOTS ENDS SHOULD BE NOTED IN WRITING AND AN ARBORIST SHOULD BE CONSULTED PRIOR TO ANY ROOT PRUNING TAKING PLACE.

HANDLING AND TRANSPORTATION

1. TREES/PALMS SHALL BE PROPERLY HANDLED DURING EXCAVATION, MOVING, STORAGE, RELOCATION, AND REPLANTING. DO NOT SCAR OR OTHERWISE DAMAGE TRUNKS AND BRANCHES, AND AVOID BREAKING LIMBS, BRANCHES AND FRONDS. DAMAGE TO TREE/PALM MAY BE CAUSE FOR ITS REJECTION AND MAY REQUIRE MITIGATION REPLACEMENT.  
2. CONTRACTOR SHALL BE RESPONSIBLE FOR THE MANUAL WATERING OF ALL RELOCATED TREES/PALMS DURING MAINTENANCE PERIOD, UNTIL FINAL ACCEPTANCE OF ALL WORK BY THE LANDSCAPE ARCHITECT AND/OR CLIENT.  
3. LANDSCAPE CONTRACTOR SHALL BE RESPONSIBLE FOR INSTALLING AND MAINTAINING TREE/PALM PROTECTION. INSTALL BARRICADE OF GALVANIZED WELDED WIRE FABRIC OR PLASTIC MESH TO ENCOMPASS THE DRIPLINE OF THE TREE/PALM. BARRICADE SHALL BE PLUMB, TAUT, AND STURDY BARRICADE TO BE LEFT UP AND MAINTAINED UNTIL DIRECTED TO REMOVE BY LANDSCAPE ARCHITECT.

TREE PROTECTION MATERIALS

1. BARRICADE SHALL BE CHAIN LINK FENCING WITH METAL POSTS, 48" IN HEIGHT  
2. POSTS: METAL OR AS PER CITY OF MIAMI BEACH SPECIFICATIONS  
3. ACCESS: PROVIDE HINGED, LATCHING GATE.  
4. METAL GATE: SHALL PERMIT FREE PASSAGE OF WATER, AIR AND SHALL ACCEPT CONSTRUCTION TRAFFIC WITHOUT EXCESSIVE DEFLECTION.

WARRANTY

1. LANDSCAPE CONTRACTOR SHALL PROVIDE A MINIMUM OF ONE (1) YEAR GUARANTEE FOR ALL TREES/PALMS AFTER FINAL ACCEPTANCE BY LANDSCAPE ARCHITECT AND/OR CLIENT.  
2. LANDSCAPE CONTRACTOR SHALL REMOVE COMPLETELY AND DISPOSE OF OFF-SITE, ANY TREE/PALM THAT FAILS TO THRIVE AS DETERMINED BY THE LANDSCAPE ARCHITECT.  
3. FOR ANY TREE/PALM REMOVED DUE TO ITS FAILURE TO THRIVE, LANDSCAPE CONTRACTOR SHALL BE RESPONSIBLE FOR REPLACING AND INSTALLING WITH A SPECIMEN OF EQUAL OR GREATER SPECIFICATION OF ORIGINAL REPLACEMENT MATERIAL. SHALL BE APPROVED BY LANDSCAPE ARCHITECT PRIOR TO PROCUREMENT PREPARATION OR INSTALLATION.

TREE / PALM RELOCATION NOTES

1. VERIFY AND INSURE ALL TREES/PALMS IDENTIFIED ON THE CONSTRUCTION DRAWINGS AND THOSE TAGGED IN THE FIELD CORRESPOND AS TO NUMBER AND DESCRIPTION. ANY DISCREPANCIES SHALL BE BROUGHT TO THE ATTENTION OF THE LANDSCAPE ARCHITECT IMMEDIATELY PRIOR TO PREPARATION.  
2. LANDSCAPE CONTRACTOR SHALL BE RESPONSIBLE FOR TREE/PALM PROTECTION OF ALL VERIFIED MATERIAL. INSTALL BARRICADE OF GALVANIZED WELDED WIRE FABRIC OR PLASTIC MESH TO ENCOMPASS THE DRIPLINE OF THE TREE/PALM.  
3. TREE ROOT BALL SHALL BE ROOT PRUNED 50% EQUALLY AROUND TREE 60 DAYS PRIOR TO TRANSPLANT. THE REMAINING 50% TO BE PRUNED 30 DAYS PRIOR TO TRANSPLANTING.  
4. PALMS TO BE RELOCATED MAY BE IMMEDIATELY RELOCATED AFTER DIGGING.  
5. ROOTS TO BE PRUNED WITH CLEAN, SHARP TOOLS. ROOTS ONE (1) INCH AND LARGER IN DIAMETER SHALL BE NEATLY AND CLEANLY CUT WITH A HAND SAW OR OTHER APPROVED CUTTING IMPLEMENT.  
6. LANDSCAPE CONTRACTOR TO APPLY MYCORRHIZA APPLICATION TO ROOTS DURING ROOT PRUNING AND DIGGING OPERATIONS. ALL PRUNING TO BE REVIEWED AND APPROVED BY LANDSCAPE ARCHITECT PRIOR TO PRUNING.  
7. DEAD WOOD, CROSSING BRANCHES AND GENERAL CANOPY PRUNING SHALL BE PERFORMED BY THE LANDSCAPE CONTRACTOR IMMEDIATELY AFTER COMPLETION OF ROOT PRUNING OF EACH SPECIMEN TO BE RELOCATED. ALL PRUNING TO BE REVIEWED AND APPROVED BY LANDSCAPE ARCHITECT PRIOR TO PRUNING.  
8. ROOT BALL SIZE TABLE:  
(NOTE: ROOT BALL SIZES SHALL EXCEED MINIMUM STANDARDS SET FORTH IN "GRADES AND STANDARDS FOR NURSERY PLANTS, PART II: PALMS AND TREES, FLORIDA DEPARTMENT OF AGRICULTURE")

TREE/PALM CALIPER	MINIMUM ROOT BALL DIAMETER
1" - 1 1/2"	16"
1 1/2" - 1 3/4"	20"
1 3/4" - 2"	24"
2" - 2 1/2"	28"
2 1/2" - 3 1/2"	32"
3 1/2" - 4"	36"
4" - 4 1/2"	40"
4 1/2" - 5"	44"
5" - 5 1/2"	48"

THE ROOT BALL OF LARGER CALIPER SIZES SHALL BE INCREASED PROPORTIONALLY AT THREE (3) INCHES OF ROOT BALL DIAMETER FOR EVERY INCREASE OF ONE (1) INCH IN CALIPER OR FRACTION THEREOF.  
9. MAINTAIN COMPACT ROOT BALLS. ROOT BALLS SHALL BE COMPLETELY ENCLOSED WITHIN A BURLAP COVERING OR STRETCH WRAP AS COMMONLY USED WITHIN THE HORTICULTURAL INDUSTRY IN TWO COMPLETE LAYERS.  
10. ALL TREES TO BE FLOODED FOR FIVE (5) DAYS PRIOR TO TRANSPLANT.  
11. ALL PITS TO BE FILLED THE SAME DAY AND WITH CLEAN FILL IN 18 INCH LIFT LAYERS. EACH THEN COMPACTED BEFORE A SUBSEQUENT 18" LIFT LAYER IS PLACED. REPEAT UNTIL BACKFILL IS FLUSH WITH SURROUNDING GRADE.  
12. CORRECT ALL PROBLEMS RELATED TO SETTLEMENT, EROSION, OR OTHER DISTRESS OF EXCAVATED/BACKFILLED PIT FROM WHICH TREE/PALM HAS BEEN REMOVED, INCLUDING THE COMPLETE AND THOROUGH REMOVAL OF ALL RESIDUAL ROOTS, STUMPS AND PORTIONS AND PARTS THEREOF.  
13. RESTORE THE SURFACE WITH MATERIAL TO MATCH ADJACENT AREAS. MATERIAL TO BE APPROVED BY LANDSCAPE ARCHITECT. CONTRACTOR TO PROVIDE A MINIMUM ONE YEAR WARRANTY ON SETTLING AND PLANT MATERIAL.  
14. LANDSCAPE CONTRACTOR IS RESPONSIBLE FOR ALL MATERIAL INCLUDING BUT NOT LIMITED TO BACKFILL MATERIAL, PROTECTION FENCING, FLAGGING, ROOT BALL BURLAP OR SHRINK WRAP.

INSTALLATION

1. VERIFY ALL UNDERGROUND CONSTRUCTIONS OR OBSTRUCTIONS (UTILITIES, SEPTIC SYSTEMS, ETC.) ARE IDENTIFIED, LOCATED AND CLEARLY MARKED AS APPROPRIATE PRIOR TO EXCAVATION OF PLANTING PITS FOR RELOCATED TREES AND PALMS. ANY UNKNOWN OBJECTS SHALL BE BROUGHT TO THE ATTENTION OF THE LANDSCAPE ARCHITECT IMMEDIATELY PRIOR TO INSTALLING AND BACKFILLING.  
2. LANDSCAPE CONTRACTOR TO FLAG ALL PROPOSED PLANT LOCATIONS FOR LANDSCAPE ARCHITECTS APPROVAL PRIOR TO INSTALLATION.  
3. PLANTING PITS SHALL BE A MINIMUM OF TWO (2) TIMES LARGER IN DIAMETER AND ONE AND A HALF (1-1/2) TIMES LARGER IN DEPTH THAN THE ROOT BALL. ROUGHEN SIDES AND BOTTOM OF PIT.  
4. AFTER EACH PLANTING PIT IS EXCAVATED, PLACE SUFFICIENT PLANTING MIX IN BOTTOM OF EXCAVATION, AND SEAT PLANT, INSURING TOP OF ROOT BALL IS FLUSH WITH IMMEDIATELY ADJACENT FINAL OR PROPOSED GRADE.  
5. LANDSCAPE CONTRACTOR TO INSURE ALL PLANT MATERIAL IS INSTALLED AT THE CORRECT ELEVATION. REFER TO GRADING PLAN.  
6. LANDSCAPE CONTRACTOR TO INSURE ALL ROOT FLARES ARE EXPOSED.  
7. CENTER EACH RELOCATED TREE/PALM IN ITS PLANTING PIT AND BACKFILL WITH SPECIFIED PLANTING MIX.  
8. PLACE PLANTING MIX IN 12 INCH LIFT LAYERS AROUND ROOT BALL AND COMPACT UNTIL ALL VOIDS ARE FILLED WITH COMPACTED PLANTING MIX.  
9. BUILD SOIL SAUCER OF MOUNDED EXCAVATED SOIL AROUND PERIMETER OF EACH PLANTING PIT TO FORM WATERING BASIN. MULCH TO A DEPTH OF 2".

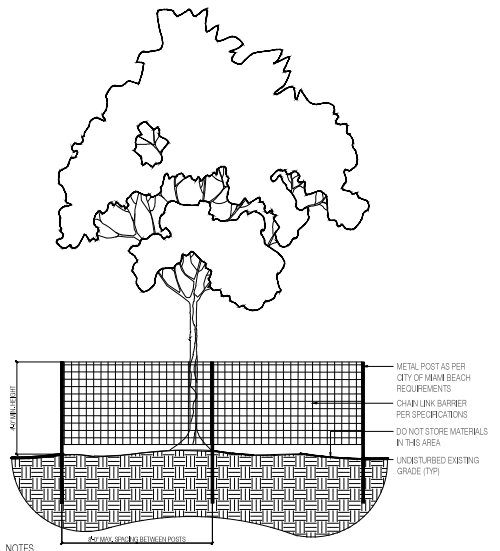

- 1.) THE TREE PROTECTION BARRICADE SHALL BE INSTALLED PER CITY OF MIAMI BEACH CODE CHAPTER 46, AND WILL BE AT LEAST FOUR (4) FEET HIGH. THE BARRIER SHALL BE CONSTRUCTED OF CONTINUOUS CHAIN LINK FENCE WITH METAL POSTS AT (8) FOOT SPACING, OR OF 2X4 POSTS WITH THREE EQUALLY SPACED 2X4 RAILS. POSTS MAY BE SHIFTED TO AVOID ROOTS.
- 2.) THE BARRIER SHALL BE PLACED AT THE DRIP LINE OF EACH TREE OR PRESERVATION AREA, AND IN NO CASE LESS THAN 10' FROM THE TRUNK OF ANY PROTECTED TREE. FOR ANY DISCREPANCIES RELATED TO PLACEMENT OF THE BARRIER, THE CITY'S URBAN FORESTER SHOULD BE CONTACTED FOR APPROVAL.
- 3.) HAND WORK ONLY WITHIN TREE BARRICADES.
- 4.) TREE BARRICADE APPROVAL: OBTAIN CITY APPROVAL OF TREE BARRICADES BEFORE BEGINNING CLEARING OPERATIONS OR ANY SITE DEVELOPMENT.

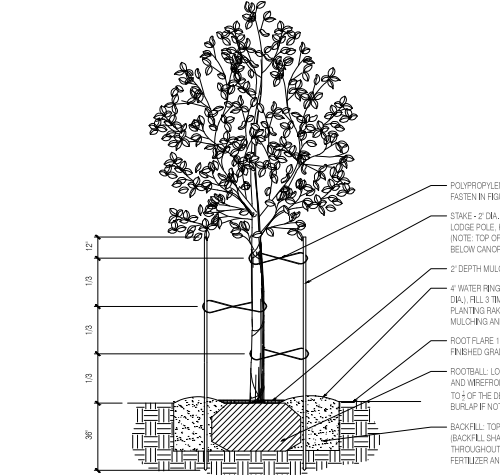

- 1.) PRUNING: REMOVE ANY BROKEN BRANCHES.  
2.) NO MULCH WITHIN 4\"/>

4 SMALL TREE PLANTING AND STAKING DETAIL (UP TO AND INCLUDING 2.5\"/>

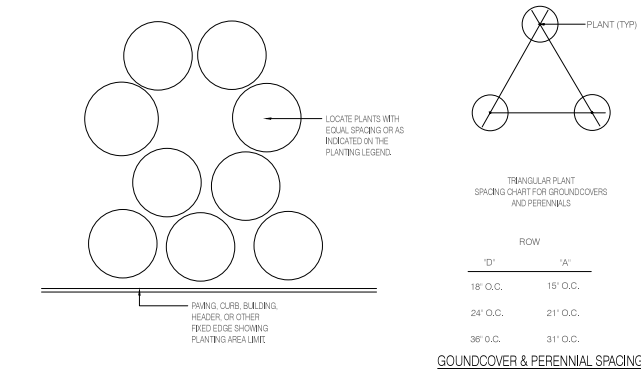

8 PLANT SPACING DETAIL SCALE: 1/8\"/>

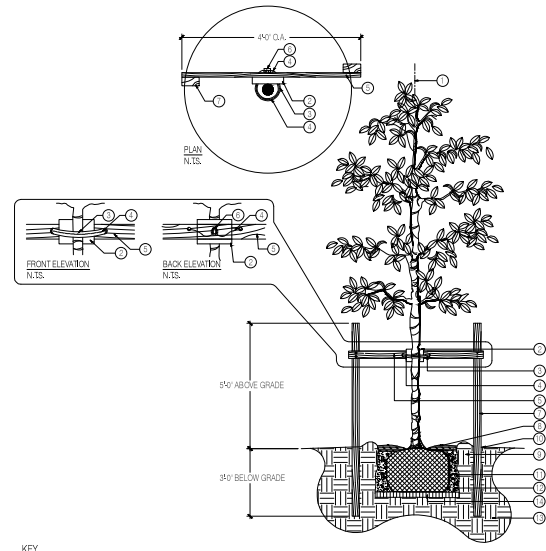

- 1.) SET TREE PLUMB IN PLANTING PIT.  
2.) PROTECT TREE TRUNK WITH 1\"/>

2 MEDIUM TREE PLANTING AND STAKING DETAIL SCALE: 1/8\"/>

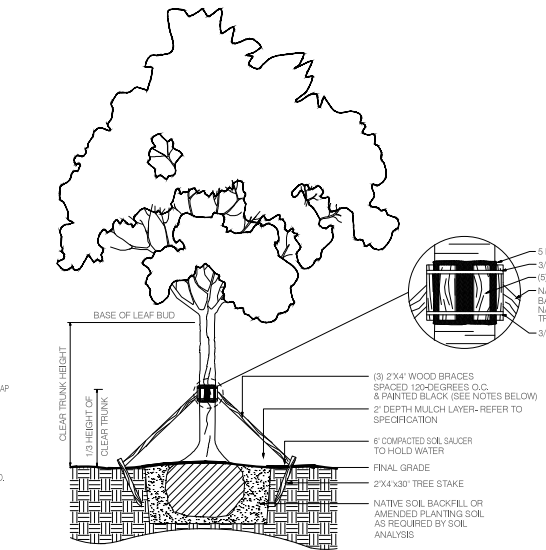

5 LARGE TREE PLANTING AND STAKING DETAIL SCALE: 1/8\"/>

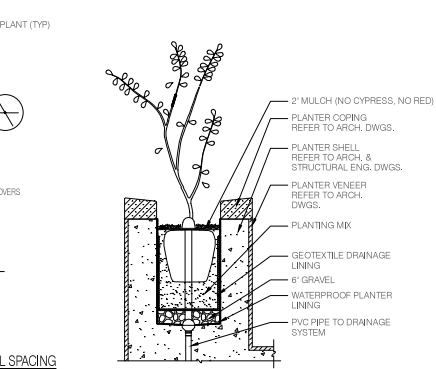

9 PLANTER PLANTING DETAIL SCALE: 1/8\"/>

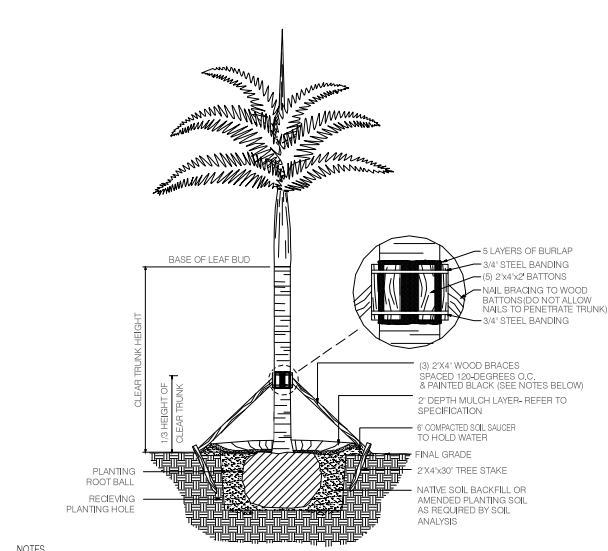

- 1.) PALMS OVER 30\"/>

3 PALM PLANTING AND STAKING DETAIL SCALE: 1/8\"/>

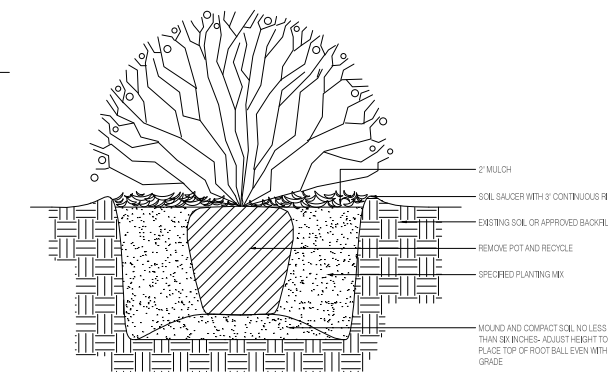

6 SHRUB PLANTING DETAIL SCALE: 1/8\"/>

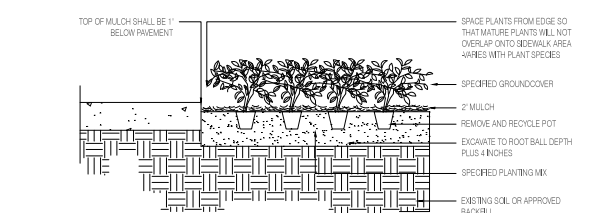

- NOTE  
1.) SEE PLANTING PLAN FOR SPACING.

7 GROUND COVER PLANTING DETAIL SCALE: 1/8\"/>

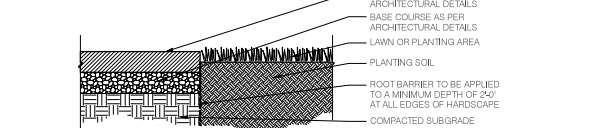

10 ROOT BARRIER DETAIL SCALE: 1/8\"/>

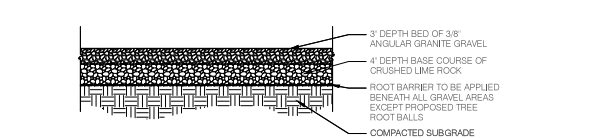

11 GRAVEL BED DETAIL SCALE: 1/8\"/>

TO THE BEST OF OUR KNOWLEDGE, THESE PLANS COMPLY WITH ALL APPLICABLE BUILDING AND ZONING CODES

STATE OF FLORIDA  
COUNTY OF MIAMI  
NATURALFICIAL, INC.  
LANDSCAPE ARCHITECTURE + DESIGN  
6915 RED ROAD, SUITE 224  
CORAL GABLES, FL 33143  
O: 786.777.6864 / M: 305.321.2341  
WWW.NATURALFICIAL.COM  
FIRM REG. NO. LC28000548

NATURALFICIAL, INC.  
Landscape Architecture + Design  
6915 Red Road, Suite 224  
Coral Gables, FL 33143  
O: 786.777.6864 / M: 305.321.2341  
www.naturalficial.com  
www.naturalficial.com FIRM REG. NO. LC28000548



RENE GONZALEZ architect  
670 NE 50 TERRACE  
40 ISLAND AVENUE  
MIAMI BEACH, FL 33139  
P: 305.789.6863  
WWW.RENEGONZALEZARCHITECT.COM  
AA # 0003351  
AR # 0076824

THE STANDARD HOTEL  
40 ISLAND AVENUE  
MIAMI BEACH, FL 33139  
DRB FINAL SUBMITTAL

PETER ANSELMO  
R.L.A. FL# 6667221  
DATE: 2016.09.09  
SCALE: N.T.S.  
REVISIONS:

## GENERAL PLANTING DETAILS

# L-3.06

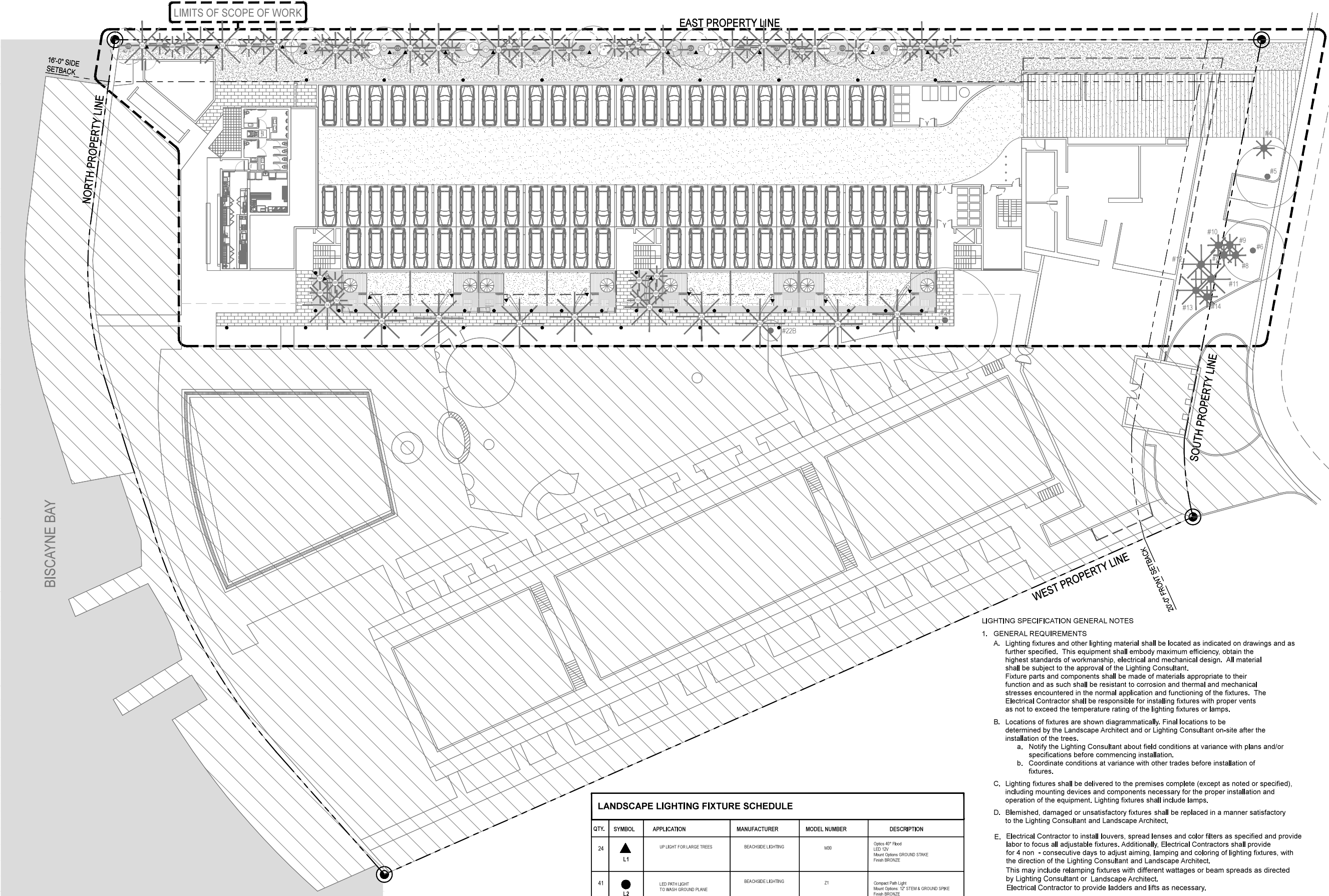

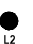
LANDSCAPE LIGHTING FIXTURE SCHEDULE					
QTY.	SYMBOL	APPLICATION	MANUFACTURER	MODEL NUMBER	DESCRIPTION
24	 L1	UP LIGHT FOR LARGE TREES	BEACHSIDE LIGHTING	M30	Optics 40" Flood LED 12V Mount Options: GROUND STAKE Finish BRONZE
41	 L2	LED PATH LIGHT TO WASH GROUND PLANE	BEACHSIDE LIGHTING	Z1	Compact Path Light Mount Options: 12" STEM & GROUND SPIKE Finish BRONZE

LIGHTING SPECIFICATION GENERAL NOTES

- GENERAL REQUIREMENTS
  - Lighting fixtures and other lighting material shall be located as indicated on drawings and as further specified. This equipment shall embody maximum efficiency, obtain the highest standards of workmanship, electrical and mechanical design. All material shall be subject to the approval of the Lighting Consultant. Fixture parts and components shall be made of materials appropriate to their function and as such shall be resistant to corrosion and thermal and mechanical stresses encountered in the normal application and functioning of the fixtures. The Electrical Contractor shall be responsible for installing fixtures with proper vents as not to exceed the temperature rating of the lighting fixtures or lamps.
  - Locations of fixtures are shown diagrammatically. Final locations to be determined by the Landscape Architect and or Lighting Consultant on-site after the installation of the trees.
    - Notify the Lighting Consultant about field conditions at variance with plans and/or specifications before commencing installation.
    - Coordinate conditions at variance with other trades before installation of fixtures.
  - Lighting fixtures shall be delivered to the premises complete (except as noted or specified), including mounting devices and components necessary for the proper installation and operation of the equipment. Lighting fixtures shall include lamps.
  - Blemished, damaged or unsatisfactory fixtures shall be replaced in a manner satisfactory to the Lighting Consultant and Landscape Architect.
  - Electrical Contractor to install louvers, spread lenses and color filters as specified and provide labor to focus all adjustable fixtures. Additionally, Electrical Contractors shall provide for 4 non - consecutive days to adjust aiming, lamping and coloring of lighting fixtures, with the direction of the Lighting Consultant and Landscape Architect. This may include relamping fixtures with different wattages or beam spreads as directed by Lighting Consultant or Landscape Architect. Electrical Contractor to provide ladders and lifts as necessary.

- WARRANTY
  - All lighting fixtures shall be covered by a minimum two year warranty covering workmanship and material. If the fixtures are supplied by the installing contractor the guarantee shall include the labor to replace defective fixtures.

TO THE BEST OF OUR KNOWLEDGE,  
THESE PLANS COMPLY WITH ALL  
APPLICABLE BUILDING AND ZONING CODES

THESE PLANS ARE THE PROPERTY OF NATURALAFICIAL, INC. AND ARE NOT TO BE REPRODUCED OR COPIED IN ANY MANNER WITHOUT THE WRITTEN PERMISSION OF NATURALAFICIAL, INC. ANY REUSE OR MODIFICATION OF THESE PLANS WITHOUT THE WRITTEN PERMISSION OF NATURALAFICIAL, INC. IS STRICTLY PROHIBITED. NATURALAFICIAL, INC. IS NOT RESPONSIBLE FOR ANY ERRORS OR OMISSIONS IN THESE PLANS. THE USER ASSUMES ALL LIABILITY FOR THE USE OF THESE PLANS. NATURALAFICIAL, INC. IS NOT A PROFESSIONAL ENGINEER OR ARCHITECT. THESE PLANS ARE NOT TO BE USED FOR ANY OTHER PURPOSES WITHOUT THE WRITTEN PERMISSION OF NATURALAFICIAL, INC.

NATURALAFICIAL, INC.  
Landscape Architecture + Design  
6915 Red Road, Suite 224  
Coral Gables, FL 33143  
O: 786.777.6664 / M: 305.321.2341  
www.naturalaficial.com  
www.naturalaficial.com FIRM REG. NO. LC26000548



RENE GONZALEZ architect  
670 NE 50 TERRACE  
MIAMI, FLORIDA 33137  
954.795.6803  
WWW.RENEGONZALEZARCHITECT.COM  
AA # 00033551  
AR # 0016824

THE STANDARD HOTEL  
40 ISLAND AVENUE  
MIAMI BEACH, FL 33139  
DRB FINAL SUBMITTAL

PETER ANSELMO  
R.L.A. FL# 6667221

DATE: 2016.09.09  
SCALE: SCALED TO FIT 11"X17"  
REVISIONS:

OVERALL GROUND  
LANDSCAPE LIGHTING  
PLAN & NOTES



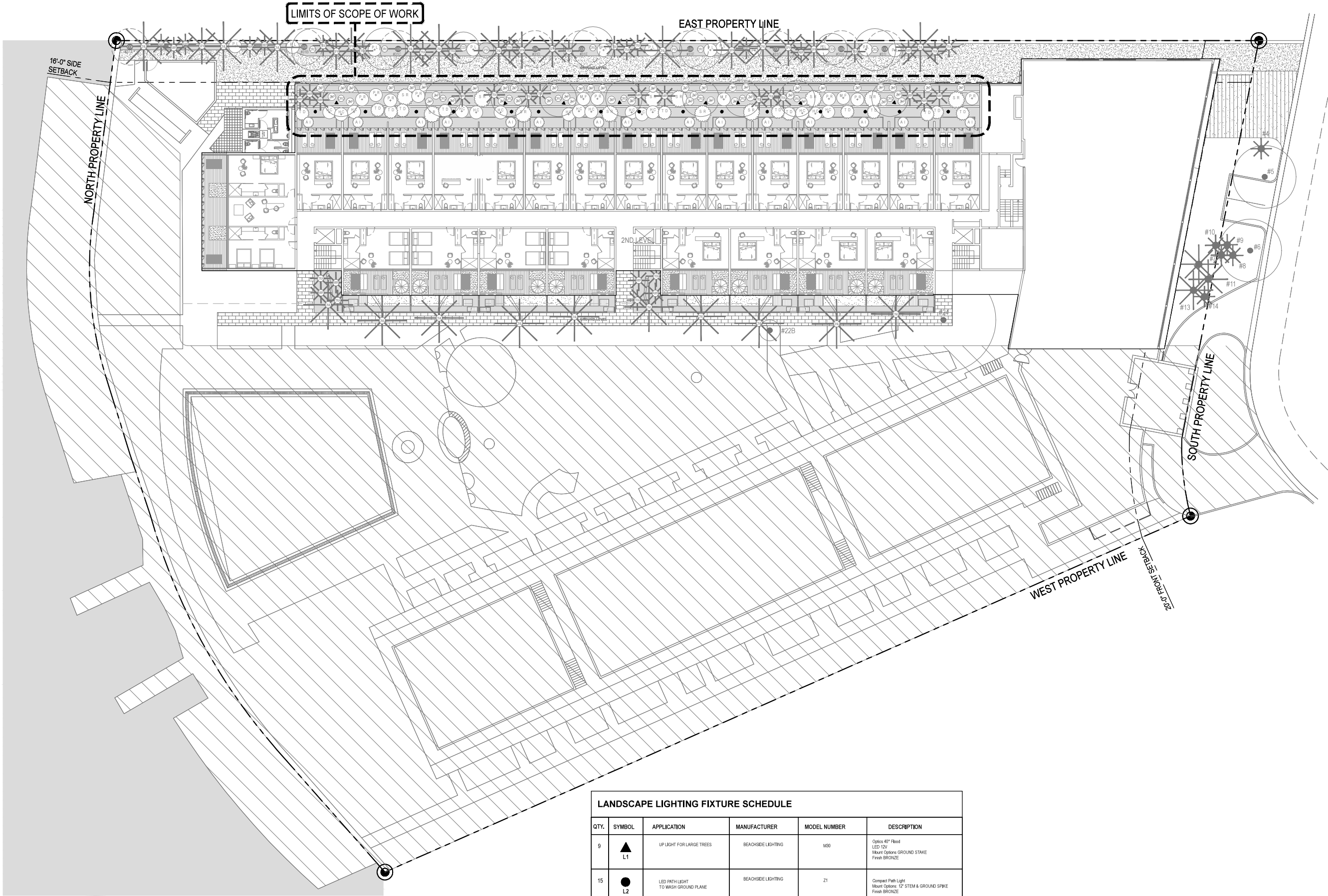

OVERALL 2ND LEVEL LANDSCAPE LIGHTING PLAN  
SCALED TO FIT 11"x17"

LANDSCAPE LIGHTING FIXTURE SCHEDULE					
QTY.	SYMBOL	APPLICATION	MANUFACTURER	MODEL NUMBER	DESCRIPTION
9		UP LIGHT FOR LARGE TREES	BEACHSIDE LIGHTING	M30	Optics: 40" Flood LED: 12V Mount Options: GROUND STAKE Finish: BRONZE
15		LED PATH LIGHT TO WASH GROUND PLANE	BEACHSIDE LIGHTING	Z1	Compact Path Light Mount Options: 12" STEM & GROUND SPIKE Finish: BRONZE

TO THE BEST OF OUR KNOWLEDGE,  
THESE PLANS COMPLY WITH ALL  
APPLICABLE BUILDING AND ZONING CODES



L-4.01

THE STANDARD HOTEL  
40 ISLAND AVENUE  
MIAMI BEACH, FL 33139

DRB FINAL SUBMITTAL

THE STANDARD HOTEL  
40 ISLAND AVENUE  
MIAMI BEACH, FL 33139

DRB FINAL SUBMITTAL

PETER ANSELMO  
R.L.A. FL# 6667221  
DATE: 2016.09.09  
SCALE: SCALED TO FIT 11"x17"  
REVISIONS:

OVERALL 2ND LEVEL  
LANDSCAPE LIGHTING  
PLAN

L-4.01

NATURAL FIRM, INC.  
Landscape Architecture + Design  
6915 Red Road, Suite 224  
Coral Gables, FL 33143  
O: 786.777.6664 / M: 305.321.2341  
www.naturalfirm.com  
FIRM REG. NO. LC26000548



RENE GONZALEZ architect  
670 NE 50 TERRACE  
SUITE 200  
MIAMI, FLORIDA 33137  
WWW.RENEGONZALEZARCHITECT.COM  
AA # 0003351  
AR # 0016824



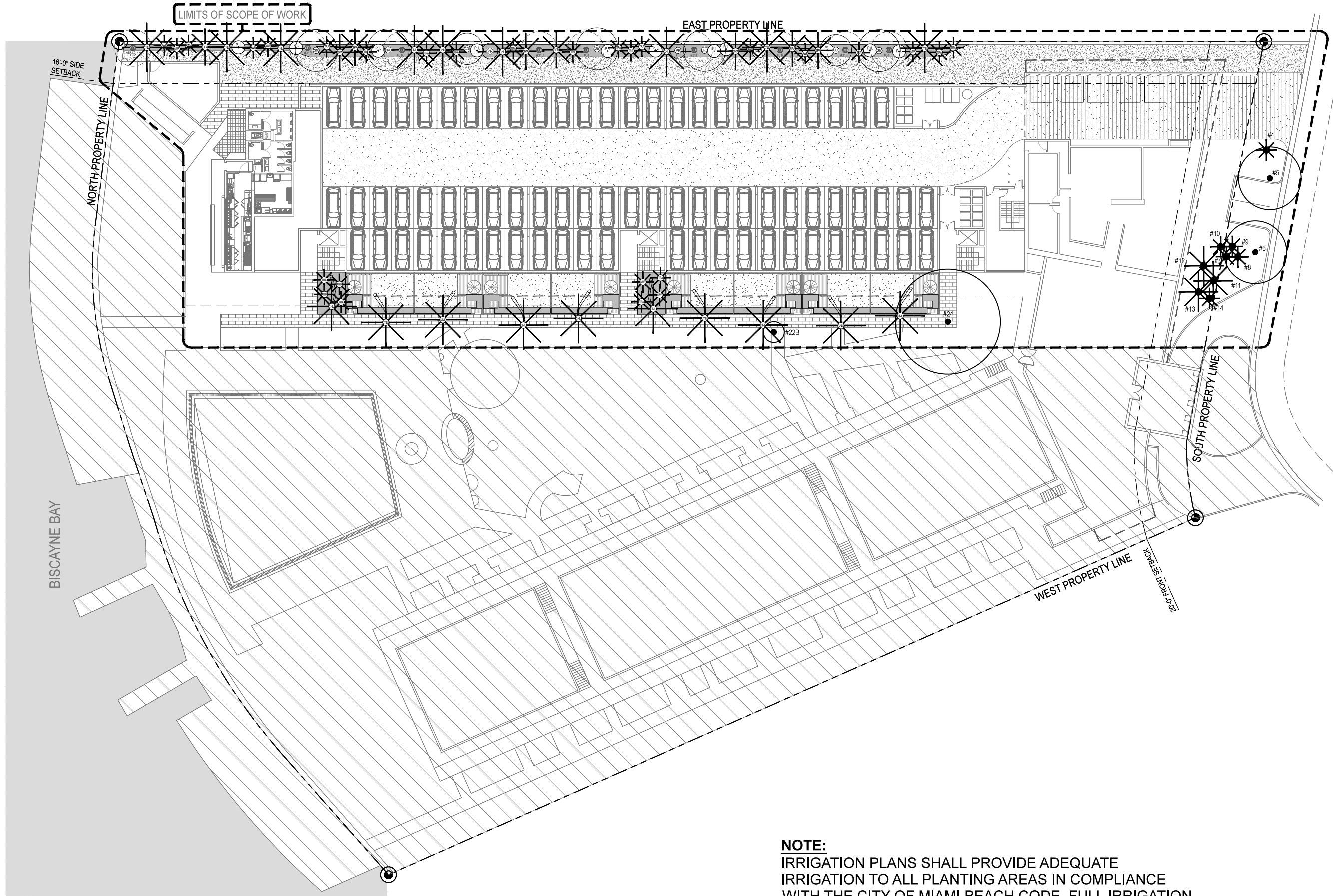

OVERALL GROUND IRRIGATION PLAN  
 SCALED TO FIT 11"x17"

**NOTE:**  
 IRRIGATION PLANS SHALL PROVIDE ADEQUATE  
 IRRIGATION TO ALL PLANTING AREAS IN COMPLIANCE  
 WITH THE CITY OF MIAMI BEACH CODE. FULL IRRIGATION  
 PLANS TO BE DEVELOPED FOLLOWING PLANNING BOARD  
 AND HPB APPROVALS.

TO THE BEST OF OUR KNOWLEDGE,  
 THESE PLANS COMPLY WITH ALL  
 APPLICABLE BUILDING AND ZONING CODES

**L-5.00**  
 NORTH

PETER ANSELMO  
 R.L.A. FL# 6667221  
 DATE: 2016.09.09  
 SCALE: SCALED TO FIT 11"x17"  
 REVISIONS:

OVERALL GROUND  
 IRRIGATION PLAN

THE STANDARD HOTEL  
 40 ISLAND AVENUE  
 MIAMI BEACH, FL 33139  
 DRB FINAL SUBMITTAL

RENE GONZALEZ architect  
 670 NE 50 TERRACE  
 MIAMI, FLORIDA 33137  
 305.789.6863  
 WWW.RENEGONZALEZARCHITECT.COM  
 AA # 0003351  
 AR # 0016824



NATURALFICIAL, INC.  
 Landscape Architecture + Design  
 6915 Red Road, Suite 224  
 Coral Gables, FL 33143  
 O: 786.777.6664 / M: 305.321.2341  
 www.naturalficial.com  
 www.naturalficial.com - FIRM REG. NO. LC26000548

THIS DOCUMENT IS THE PROPERTY OF NATURALFICIAL, INC. AND IS NOT TO BE REPRODUCED OR TRANSMITTED IN ANY FORM OR BY ANY MEANS, ELECTRONIC OR MECHANICAL, INCLUDING PHOTOCOPYING, RECORDING, OR BY ANY INFORMATION STORAGE AND RETRIEVAL SYSTEM, WITHOUT THE WRITTEN PERMISSION OF NATURALFICIAL, INC. THE USER OF THIS DOCUMENT AGREES TO HOLD NATURALFICIAL, INC. HARMLESS FROM AND AGAINST ALL CLAIMS, DAMAGES, LOSSES AND EXPENSES, INCLUDING REASONABLE ATTORNEY'S FEES, THAT MAY BE ASSERTED AGAINST NATURALFICIAL, INC. BY ANY THIRD PARTY AS A RESULT OF THE USER'S USE OF THIS DOCUMENT. THE USER OF THIS DOCUMENT AGREES TO HOLD NATURALFICIAL, INC. HARMLESS FROM AND AGAINST ALL CLAIMS, DAMAGES, LOSSES AND EXPENSES, INCLUDING REASONABLE ATTORNEY'S FEES, THAT MAY BE ASSERTED AGAINST NATURALFICIAL, INC. BY ANY THIRD PARTY AS A RESULT OF THE USER'S USE OF THIS DOCUMENT.



TO THE BEST OF OUR KNOWLEDGE,  
THESE PLANS COMPLY WITH ALL  
APPLICABLE BUILDING AND ZONING CODES

## OVERALL 2ND LEVEL IRRIGATION PLAN

THE STANDARD HOTEL  
40 ISLAND AVENUE  
MIAMI BEACH, FL 33139

DRB FINAL SUBMITTAL

**RENE GONZALEZ** architect  
670 NE 50 TERRACE MIAMI, FLORIDA 33136  
T: 305.762.5895 F: 305.762.5893  
WWW.RENEGONZALEZARCHITECT.COM  
AA # 0003351  
AR # 0018924

**NATURALFICIAL, INC.**  
Landscape Architecture + Design  
6915 Red Road, Suite 224  
Coral Gables, FL 33143  
O: 786.717.6564 / M: 305.321.2341  
[www.naturalficial.com](http://www.naturalficial.com)  
FIRM REG. NO. LC26000548



L-5.01