

- C.M.B. CHAPTER 46, DIVISION 2 - TREE INVENTORY + DISPOSITION PLAN NOTES**
- THIS 'EXISTING TREE INVENTORY + DISPOSITION PLAN' HAS BEEN PREPARED IN ACCORDANCE WITH THE CITY OF MIAMI BEACH, CHAPTER 46 - ENVIRONMENT, DIVISION 2, TREE PRESERVATION and PROTECTION ORDINANCE.
  - EXISTING TREE, PALM, AND VEGETATION INFORMATION AS INDICATED HAS BEEN PREPARED AS AN OVERLAY ON THE SURVEY PREPARED BY AMERICAN SERVICES OF MIAMI, CORP. DATED 06.15.16
  - THE INFORMATION AS PRESENTED HEREIN HAS BEEN FIELD VERIFIED BY THE LANDSCAPE ARCHITECT ON 07.27.16
  - MIAMI BEACH P+Z MUST APPROVE LANDSCAPE PLANS PRIOR TO REMOVING ANY TREES OR PALMS WITH A DBH BETWEEN 8" AND 12" INCHES. A WRITTEN TREE REMOVAL PERMIT IS REQUIRED FROM CITY OF MIAMI BEACH GREENSPACE MANAGEMENT / P.W FOR THE REMOVAL OF TREES / PALMS WITH A DBH GREATER THAN 12" INCHES OR IN THE R.O.W.
  - THE OWNER RESERVES THE RIGHT TO REMOVE ANY VEGETATION NOT LOCATED WITHIN THE CITY R.O.W. w/ a D.B.H. OF LESS THAN 8" WITHOUT OBTAINING A TREE REMOVAL PERMIT.
  - THERE ARE NO TREES or PALMS LOCATED ON THIS PROPERTY THAT WILL REQUIRE TEMPORARY IRRIGATION. ALL EXISTING TREES + PALMS ARE MATURE AND ARE CURRENTLY THRIVING WITHOUT SUPPLEMENTAL IRRIGATION WATER.

- C.M.B. EXISTING TREE SURVEY LEGEND**
- TREE or PALM TO BE REMOVED
  - TREE or PALM TO REMAIN. PRESERVE + PROTECT
  - TREE or PALM TO BE RELOCATED
  - RELOCATED TREE or PALM
  - TREE or PALM PROTECTION FENCE
  - PERMIT FROM GREENSPACE MANAGEMENT IS REQUIRED FOR REMOVAL / RELOCATION
  - PERMIT FROM GREENSPACE MANAGEMENT IS REQUIRED FOR REMOVAL / RELOCATION

- C.M.B. PUBLIC WORKS / GREENSPACE MANAGEMENT CONDITIONS**
- SHOULD ANY EXISTING TREES OR PALMS BE DAMAGED THEY SHALL BE EVALUATED BY THE CITY URBAN FORESTER TO DETERMINE CORRECTIVE ACTIONS THAT MAY INCLUDE REMOVAL, CORRECTIVE PRUNING AND OR REPLACEMENT. ANY CORRECTIVE ACTIONS REQUIRED SHALL BE PERFORMED IN ACCORDANCE WITH MIAMI BEACH CODE, THE MOST CURRENT ANSI A-300 PRUNING STANDARDS AND OR AN ISSUED CITY OF MIAMI BEACH TREE WORK PERMIT. ANY CORRECTIVE PRUNING REQUIRED SHALL BE PERFORMED BY AN ISA CERTIFIED ARBORIST AND THE CITY URBAN FORESTER SHALL BE CONSULTED.
  - CARE SHALL BE TAKEN TO AVOID UTILITY OR CONSTRUCTION TRENCHING THROUGH EXISTING TREE OR PALM DRILINES OF TREES SLATED TO REMAIN IN PLACE OR BE RELOCATED. IF CONSTRUCTION REQUIRES THE CUTTING OF ANY ROOTS WITH A DIAMETER OF 2" OR GREATER, ROOTS SHALL BE CLEANLY CUT WITH A SHARP TOOL, AS DIRECTED BY AN ISA CERTIFIED ARBORIST, AND IN ACCORDANCE WITH THE ANSI A-300 STANDARDS. CUT ROOTS SHOULD BE IMMEDIATELY COVERED WITH SOIL TO PREVENT DRYING. ROOTS SHOULD NOT BE TORN OR BROKEN BY HEAVY EQUIPMENT, AND NO SHREDDED, RAGGED OR BROKEN ROOT ENDS SHOULD BE LEFT. THE CITY URBAN FORESTER SHALL BE NOTIFIED IN WRITING AND OR CONSULTED PRIOR TO ANY ROOT PRUNING TAKING PLACE.
  - SHOULD ANY CORRECTIVE STRUCTURAL PRUNING BE NECESSARY FOR TREES PROPOSED TO REMAIN ONSITE, DUE TO CLEARANCE, SAFETY OR FOR CONSTRUCTION RELATED REASONS THE PRUNING SHALL BE PERFORMED BY AN ISA OR ASCA CERTIFIED ARBORIST IN ACCORDANCE WITH THE LATEST VERSION OF THE ANSI A-300 PRUNING STANDARDS AND GOOD HORTICULTURAL PRACTICES. THE CITY URBAN FORESTER SHALL BE PROVIDED WITH A WRITTEN COPY OF THE PROPOSED PRUNING PLAN INCLUDING THE REASONS WHY PRUNING IS NECESSARY, PRIOR TO THE PRUNING ACTIVITIES TAKING PLACE.
  - ANY ROOT PRUNING, IF REQUIRED DURING THE PROJECT, SHALL BE CONDUCTED UNDER THE SUPERVISION OF AN ISA CERTIFIED ARBORIST OR ASCA CONSULTING ARBORIST. ANY ROOT PRUNING, IF REQUIRED, WILL BE LIMITED TO WHAT IS ABSOLUTELY NECESSARY FOR CONSTRUCTION. ADDITIONALLY, AND ROOT PRUNING WORK WILL BE DOCUMENTED WITH COLOR PICTURES AND PROVIDED TO MR. MARK WILLIAMS AT C.M.B. PUBLIC WORKS / GREENSPACE MANAGEMENT + MR. RICARDO GUZMAN AT C.M.B. PLANNING + ZONING DEPARTMENTS ON A REGULAR BASIS.

C.M.B. EXISTING TREE INVENTORY + DISPOSITION CHART - 503 EAST DILIDO DRIVE													
NUMBER	COMMON NAME	BOTANICAL NAME	SPECIMEN	D.B.H. (IN)	HEIGHT (FT)	SPREAD (FT)	CONDITION	DISPOSITION	CANOPY AREA	CANOPY LOSS / MIT. REQ. (SF)	COMMENTS	PERMIT REQUIREMENTS	
#1	Christmas Palm	Adonidia merrillii	NO	+/- 6"	+/- 25'	+/- 6'	GOOD	REMOVE	28 SF	0 SF	LOCATED IN ROW / IN CONFLICT / TO BE REMOVED	GREENSPACE MANAGMT / PW	
#2	Christmas Palm	Adonidia merrillii	NO	+/- 6"	+/- 25'	+/- 6'	GOOD	REMOVE	28 SF	0 SF	LOCATED IN ROW / IN CONFLICT / TO BE REMOVED	GREENSPACE MANAGMT / PW	
#3	Christmas Palm	Adonidia merrillii	NO	+/- 6"	+/- 25'	+/- 6'	GOOD	REMAIN	28 SF	0 SF	PRESERVE + PROTECT DURING CONSTRUCTION	N/A	
#4	Christmas Palm	Adonidia merrillii	NO	+/- 6"	+/- 25'	+/- 6'	GOOD	REMAIN	28 SF	0 SF	PRESERVE + PROTECT DURING CONSTRUCTION	N/A	
#5	Royal Palm	Roystonea elata	YES	+/- 30"	+/- 50'	+/- 30'	GOOD	REMAIN	707 SF	0 SF	PRESERVE + PROTECT DURING CONSTRUCTION	N/A	
#6	Royal Palm	Roystonea elata	YES	+/- 30"	+/- 50'	+/- 30'	GOOD	REMAIN	707 SF	0 SF	PRESERVE + PROTECT DURING CONSTRUCTION	N/A	
#7	Royal Palm	Roystonea elata	YES	+/- 30"	+/- 50'	+/- 30'	GOOD	REMAIN	707 SF	0 SF	PRESERVE + PROTECT DURING CONSTRUCTION	N/A	
#8	Royal Palm (double)	Roystonea elata	YES	+/- 30"	+/- 50'	+/- 30'	GOOD	RELOCATE	707 SF	0 SF	IN CONFLICT SEE PROPOSED NEW LOCATION	GREENSPACE MANAGMT / PW	
#9	White Bird of Paradise (double)	Strelitzia nicotai	YES	+/- 14"	+/- 16'	+/- 6'	GOOD	RELOCATE	28 SF	0 SF	IN CONFLICT / TO BE REMOVED	GREENSPACE MANAGMT / PW	
#10	Umbrella Tree	Schefflera actinophylla	NO	+/- 6"	+/- 30'	+/- 12'	GOOD	REMOVE	113 SF	113 SF	POOR CONDITION TO BE REMOVED	NO PERMIT REQUIRED	
#11	Umbrella Tree	Schefflera actinophylla	NO	+/- 6"	+/- 30'	+/- 12'	GOOD	REMOVE	113 SF	113 SF	POOR CONDITION TO BE REMOVED	NO PERMIT REQUIRED	
#12	Umbrella Tree	Schefflera actinophylla	NO	+/- 6"	+/- 30'	+/- 12'	GOOD	REMOVE	113 SF	113 SF	POOR CONDITION TO BE REMOVED	NO PERMIT REQUIRED	
#13	Weeping Fig	Ficus benjamina	NO	+/- 7"	+/- 25'	+/- 15'	POOR	REMOVE	177 SF	177 SF	POOR CONDITION TO BE REMOVED	NO PERMIT REQUIRED	
#14	Alexander Palm	Ptychosperma elegans	NO	+/- 4"	+/- 40'	+/- 5'	GOOD	REMAIN	20 SF	0 SF	PRESERVE + PROTECT DURING CONSTRUCTION	N/A	
#15	Alexander Palm	Ptychosperma elegans	NO	+/- 4"	+/- 40'	+/- 5'	GOOD	REMAIN	20 SF	0 SF	PRESERVE + PROTECT DURING CONSTRUCTION	N/A	
#16	White Bird of Paradise	Strelitzia nicotai	NO	+/- 5"	+/- 12'	+/- 6'	GOOD	REMAIN	28 SF	0 SF	PRESERVE + PROTECT DURING CONSTRUCTION	N/A	
#17	Alexander Palm	Ptychosperma elegans	NO	+/- 5"	+/- 10'	+/- 5'	GOOD	REMOVE	20 SF	20 SF	IN CONFLICT / TO BE REMOVED	NO PERMIT REQUIRED	
#18	Alexander Palm	Ptychosperma elegans	NO	+/- 5"	+/- 10'	+/- 5'	GOOD	REMOVE	20 SF	20 SF	IN CONFLICT / TO BE REMOVED	NO PERMIT REQUIRED	
#19	Fishtail Palm	Caryota mitis	NO	+/- 4"	+/- 18'	+/- 6'	GOOD	REMOVE	28 SF	28 SF	IN CONFLICT / TO BE REMOVED	NO PERMIT REQUIRED	
#20	Coconut Palm	Cocos nucifera	NO	+/- 10"	+/- 50'	+/- 40'	GOOD	REMAIN	1257 SF	0 SF	PRESERVE + PROTECT DURING CONSTRUCTION	N/A	
#21	Coconut Palm	Cocos nucifera	NO	+/- 12"	+/- 8'	+/- 6'	GOOD	REMAIN	28 SF	0 SF	PRESERVE + PROTECT DURING CONSTRUCTION	N/A	
#22	Weeping Fig	Ficus benjamina	YES	+/- 24"	+/- 35'	+/- 12'	POOR	REMOVE	113 SF	113 x 2 = 226 SF	POOR CONDITION TO BE REMOVED	GREENSPACE MANAGMT / PW	
#23	Weeping Fig	Ficus benjamina	NO	+/- 12"	+/- 18'	+/- 10'	POOR	REMOVE	79 SF	79 SF	POOR CONDITION TO BE REMOVED	P + Z APPROVAL REQUIRED	
#24	Montgomery Palm	Veitchia montgomeryana	NO	+/- 7"	+/- 40'	+/- 8'	GOOD	REMAIN	50 SF	0 SF	PRESERVE + PROTECT DURING CONSTRUCTION	N/A	
#25	Montgomery Palm	Veitchia montgomeryana	NO	+/- 7"	+/- 40'	+/- 8'	GOOD	REMAIN	50 SF	0 SF	PRESERVE + PROTECT DURING CONSTRUCTION	N/A	
#26	Christmas Palm (cluster)	Adonidia merrillii	NO	+/- 7"	+/- 40'	+/- 8'	GOOD	REMAIN	50 SF	0 SF	PRESERVE + PROTECT DURING CONSTRUCTION	N/A	
#27	Christmas Palm	Adonidia merrillii	NO	+/- 7"	+/- 40'	+/- 12'	GOOD	REMOVE	113 SF	113 SF	IN CONFLICT / TO BE REMOVED	NO PERMIT REQUIRED	
#28	Christmas Palm	Adonidia merrillii	NO	+/- 7"	+/- 40'	+/- 12'	GOOD	REMOVE	113 SF	113 SF	IN CONFLICT / TO BE REMOVED	NO PERMIT REQUIRED	
#29	Christmas Palm	Adonidia merrillii	NO	+/- 7"	+/- 40'	+/- 12'	GOOD	REMOVE	113 SF	113 SF	IN CONFLICT / TO BE REMOVED	NO PERMIT REQUIRED	
#30	Christmas Palm	Adonidia merrillii	NO	+/- 4"	+/- 35'	+/- 6'	GOOD	REMOVE	28 SF	28 SF	IN CONFLICT / TO BE REMOVED	NO PERMIT REQUIRED	
#31	Fishtail Palm	Caryota mitis	NO	+/- 12"	+/- 45'	+/- 12'	GOOD	REMAIN	113 SF	0 SF	PRESERVE + PROTECT DURING CONSTRUCTION	N/A	
#32	Queen Palm	Syagrus romanzoffiana	YES	+/- 24"	+/- 50'	+/- 30'	GOOD	REMAIN	707 SF	0 SF	PRESERVE + PROTECT DURING CONSTRUCTION	N/A	
#33	Washington Palm	Washingtonia robusta	NO	+/- 12"	+/- 40'	+/- 5'	GOOD	REMOVE	20 SF	20 SF	INVASIVE / IN CONFLICT / TO BE REMOVED	NO PERMIT REQUIRED	
#34	Christmas Palm	Adonidia merrillii	NO	+/- 6"	+/- 35'	+/- 5'	GOOD	REMOVE	20 SF	20 SF	IN CONFLICT / TO BE REMOVED	NO PERMIT REQUIRED	
#35	Christmas Palm	Adonidia merrillii	NO	+/- 6"	+/- 35'	+/- 5'	GOOD	REMOVE	20 SF	20 SF	IN CONFLICT / TO BE REMOVED	NO PERMIT REQUIRED	
#36	Royal Palm	Roystonea elata	YES	+/- 24"	+/- 50'	+/- 30'	GOOD	REMAIN	707 SF	0 SF	PRESERVE + PROTECT DURING CONSTRUCTION	N/A	
#37	Alexander Palm	Ptychosperma elegans	NO	+/- 4"	+/- 40'	+/- 6'	GOOD	REMAIN	28 SF	0 SF	PRESERVE + PROTECT DURING CONSTRUCTION	N/A	
#38	Washington Palm	Washingtonia robusta	NO	+/- 10"	+/- 50'	+/- 25'	GOOD	REMAIN	491 SF	0 SF	PRESERVE + PROTECT DURING CONSTRUCTION	N/A	
#39	Christmas Palm	Adonidia merrillii	NO	+/- 5"	+/- 25'	+/- 6'	GOOD	REMOVE	28 SF	28 SF	IN CONFLICT / TO BE REMOVED	NO PERMIT REQUIRED	
#40	Christmas Palm	Adonidia merrillii	NO	+/- 5"	+/- 25'	+/- 6'	GOOD	REMOVE	28 SF	28 SF	IN CONFLICT / TO BE REMOVED	NO PERMIT REQUIRED	
#41	Christmas Palm	Adonidia merrillii	NO	+/- 5"	+/- 25'	+/- 6'	GOOD	REMOVE	28 SF	28 SF	IN CONFLICT / TO BE REMOVED	NO PERMIT REQUIRED	
#42	Christmas Palm	Adonidia merrillii	NO	+/- 6"	+/- 30'	+/- 6'	GOOD	REMAIN	28 SF	0 SF	PRESERVE + PROTECT DURING CONSTRUCTION	N/A	
#43	Ruffled Fan Palm	Licuala grandis	YES	+/- 18"	+/- 40'	+/- 30'	GOOD	RELOCATE	707 SF	0 SF	IN CONFLICT SEE PROPOSED NEW LOCATION	GREENSPACE MANAGMT / PW	
#43a	Pongam Oil Tree	Pongamia pinnata	YES	+/- 20"	+/- 30'	+/- 25'	GOOD	REMOVE	707 SF	707 X 2 = 1014 SF	INVASIVE / IN CONFLICT / TO BE REMOVED	NO PERMIT REQUIRED	
TOTAL MITIGATION REQUIRED: 2,414 SF												TOTAL MITIGATION PROVIDED : 4,250 SF	

EXISTING TREE SURVEY + DISPOSITION PLAN



COPYRIGHT 2015 ALL RIGHTS RESERVED. THIS DOCUMENT AND THE IMPROVEMENTS DESCRIBED HEREIN ARE COPY-RIGHTED UNDER THE LAWS OF THE UNITED STATES OF AMERICA. USE OF THIS DOCUMENT IS GRANTED BY LICENSE ONLY FOR A ONE-TIME SINGLE-USE BY REGISTERED LICENSE HOLDER. THIS DOCUMENT MAY NOT BE MODIFIED OR DUPLICATED WITHOUT THE WRITTEN CONSENT OF CHRISTOPHER CAWLEY LANDSCAPE ARCHITECTURE LLC. FAILURE TO COMPENSATE CHRISTOPHER CAWLEY LANDSCAPE ARCHITECTURE LLC FULLY SHALL IMMEDIATELY VOID THAT LICENSE AND ALL RIGHTS TO USE THIS DOCUMENT. CONTRACTORS OR USERS OF THIS DOCUMENT ARE RESPONSIBLE FOR FIELD VERIFYING ALL SITE CONDITIONS PRIOR TO PROCEEDING WITH WORK.

CHRISTOPHER CAWLEY | CC LA  
LANDSCAPE ARCHITECTURE LLC  
Florida Landscape Architecture Business, LC 26000460  
780 NE 69th Street | Suite 1106 | Miami, FL 33138  
T 305.979.1865 | www.christophercawley.com

NEW RESIDENCE  
503 EAST DILIDO DRIVE,  
MIAMI BEACH, FL, 33139

No.	Date	Description

Professional Seal

CHRISTOPHER CAWLEY, RLA  
Florida License LA 669768

Title: Master Plan

Scale: As Noted

Date: July 29, 2016

Drawing:

L-1



EXISTING ROYAL PALMS #5, #6, #7 +  
RELOCATED WHITE BIRD OF PARADISE #9.  
PRESERVE + PROTECT DURING CONSTRUCTION

EXISTING ALEXANDER PALMS #14, #15 +  
EXISTING WHITE BIRD OF PARADISE #16.  
PRESERVE + PROTECT DURING CONSTRUCTION

RELOCATED DOUBLE TRUNK ROYAL PALM #8.  
PRESERVE + PROTECT DURING CONSTRUCTION

EXISTING FISHTAIL PALM #31 + EXISTING  
ALEXANDER PALM # 37. PRESERVE +  
PROTECT DURING CONSTRUCTION

RELOCATED LICUALA PALM #43 + EXISTING  
QUEEN PALM #32 + WASHINGTON PALM #38.  
PRESERVE + PROTECT DURING CONSTRUCTION

EXISTING FISHTAIL PALM #31 + EXISTING  
ALEXANDER PALM # 37. PRESERVE +  
PROTECT DURING CONSTRUCTION

#### C.M.B. CANOPY MITIGATION NOTES

MB TREE REMOVAL / RELOCATION PERMIT TP15-005 dated 09/16/15 HAS BEEN OBTAINED FOR THIS PROJECT. THE CANOPY MITIGATION OF --- SF AS REQUIRED BY THE PERMIT HAS BEEN MET AND EXCEEDED. A TOTAL 4,250 SF OF FLORIDA NATIVE CANOPY HAS BEEN PROVIDED.

##### CANOPY MITIGATION SUMMARY

- (13) NATIVE PITCH APPLE TREES: 3,900 SF (MB category I @ 300 SF each)
- (7) COCONUT PALMS: 350 SF (MB category IV @ 50 SF each)

#### LANDSCAPE LEGEND

MIAMI - DADE COUNTY LANDSCAPE ORDINANCE CHAPTER 18-A (RESIDENTIAL VERSION)

##### TREES

3 TREES REQUIRED PER LOT / 13 TREES PROVIDED MEETING MINIMUM REQUIREMENTS  
(13 NATIVE PITCH APPLE TREES PROVIDED)

##### NATIVE TREES

30% OF REQUIRED TREES OR .30 X 3 = .9 NATIVE TREES REQUIRED / 13 NATIVE TREES PROVIDED  
(13 NATIVE PITCH APPLE TREES PROVIDED)

##### SHRUBS

10 SHRUBS REQUIRED FOR EACH REQUIRED TREE or 10 X (3) = 30 REQUIRED / 30 PROVIDED  
(30 NATIVE CRABWOOD SHRUBS PROVIDED)

##### NATIVE SHRUBS

30% OF TOTAL SHRUBS REQUIRED MUST BE NATIVE or .30 X 30 = 9 / 30 PROVIDED  
(30 NATIVE CRABWOOD SHRUBS PROVIDED)

##### LAWN AREA

50% MAXIMUM OF LANDSCAPE AREA: NEW LAWN AREAS ARE LESS THAN 50% OF LANDSCAPE AREA

##### IRRIGATION SYSTEM

100% COVERAGE PROVIDED PURSUANT TO MIAMI DADE CODE

#### PLANTLIST - 503 EAST DILIDO DRIVE

KEY	NATIVE	QTY.	COMMON NAME	BOTANICAL NAME	HEIGHT, SPECIFICATION, & NOTES
<b>TREES</b>					
CR	YES	13	PITCH APPLE TREE	Clusia rosea	45 gallon, 12" height, 5' ct, standard, single leader, Treeworld Wholesale
<b>PALMS</b>					
CM	NO	14	FISHTAIL PALM	Caryota mitis	45 gallon, 14' - 16' height, 5' spread, space 5' on center
CN	NO	7	COCONUT PALM	Cocos nucifera	45 gallon, 14' - 16' height, 5' spread, space 5' on center
<b>BAMBOO</b>					
BT	YES	20	GRACEFUL WEAVER BAMBOO	Bambusa textilis	45 gallon, space 36" on center
<b>SHRUBS</b>					
GYL	YES	30	CRABWOOD	Gymnanthes lucida	7 gallon, 24" height, 24" spread, space 24" on center
<b>TROPICALS, GROUNDCOVERS, + ACCENTS</b>					
LIR	NO	180	LILYTRUF GRASS	Liriope musc 'Evergreen Giant'	1 gallon, 12" height, 12" spread, space 12" on center
PBM	NO	190	PHILODENDRON 'BURLE MARX'	Same	3 gallon, 12" height, 12" spread, space 18" on center
PIL	NO	50	ARTILERY FERN	Pilea microphylla	1 gallon, 12" height, 12" spread, space 18" on center
TRD	NO	20	FAKAHATCHEE GRASS	Tripsacum dactyloides	3 gallon, 36" on center
ZAP	NO	16	COONTIE	Zamia pumila	7 gallon, 36" on center

##### SAND, AGGREGATE & MULCH

DGA	3/8" DECOMPOSED GRANITE AGGREGATE OR STONE TO BE SELECTED, INSTALLED OVER FILTER FABRIC AND WEED BARRIER MATERIAL / OLIMAR, 2" MIN. DEPTH
MLC	DARK BROWN 'FLORI MULCH' SHREDDED ORGANIC MULCH (NO CYPRESS), TO BE DETERMINED
SND	NEW BEACH SAND

CONTRACTOR TO PROVIDE IMAGES OF ALL MAJOR PLANT MATERIAL TO LANDSCAPE ARCHITECT AND OWNER FOR APPROVAL BEFORE PURCHASE + INSTALLATION. LANDSCAPE CONTRACTOR TO MEET WITH LANDSCAPE ARCHITECT AND OWNER ON SITE TO REVIEW THE PROPOSED DESIGN PRIOR TO SUBMITTING A BID FOR THE PROJECT. THE LANDSCAPE CONTRACTOR IS TO PROVIDE AN ADDITIONAL ALLOWANCE OF \$5,000 DOLLARS FOR POTTED PLANTS + MISCELLANEOUS VEGETATION TO BE SELECTED DURING THE INSTALLATION OF THE PROJECT

LANDSCAPE PLAN



COPYRIGHT 2015 ALL RIGHTS RESERVED.  
THIS DOCUMENT AND THE IMPROVEMENTS  
DESCRIBED HEREIN ARE COPY RIGHTED  
UNDER THE LAWS OF THE UNITED STATES OF  
AMERICA. USE OF THIS DOCUMENT IS  
GRANTED BY LICENSE ONLY FOR A ONE TIME  
SINGULAR USE BY REGISTERED LICENSE  
HOLDER. THIS DOCUMENT MAY NOT BE  
MODIFIED OR DUPLICATED WITHOUT THE  
WRITTEN CONSENT OF CHRISTOPHER  
CRAWLEY LANDSCAPE ARCHITECT. FAILURE  
TO COMPENSATE CHRISTOPHER CRAWLEY  
LANDSCAPE ARCHITECTURE LLC FULLY  
SHALL IMMEDIATELY VOID THAT LICENSE  
AND ALL RIGHTS TO USE THIS DOCUMENT.

CONTRACTORS OR USERS OF THIS  
DOCUMENT ARE RESPONSIBLE FOR FIELD  
VERIFYING ALL SITE CONDITIONS PRIOR TO  
PROCEEDING WITH WORK.

**CHRISTOPHER CRAWLEY** | CC  
LANDSCAPE ARCHITECTURE LLC | LA  
Florida Landscape Architecture Business, LC 26000460  
780 NE 69th Street | Suite 1106 | Miami, FL 33138  
T 305.979.1865 | www.christophercrawley.com

**NEW RESIDENCE**  
503 EAST DILIDO DRIVE,  
MIAMI BEACH, FL, 33139

No.	Date	Description

Professional Seal

CHRISTOPHER CRAWLEY, RLA  
Florida License LA 6696786

Title: Master Plan

Scale: As Noted

Date: July 27,2016

Drawing:

L-2



No.	Date	Description

Professional Seal

CHRISTOPHER CAWLEY, RLA  
Florida License LA 6666768

Title: Master Plan

Scale: As Noted

Date: July 27,2016

Drawing:

L-3

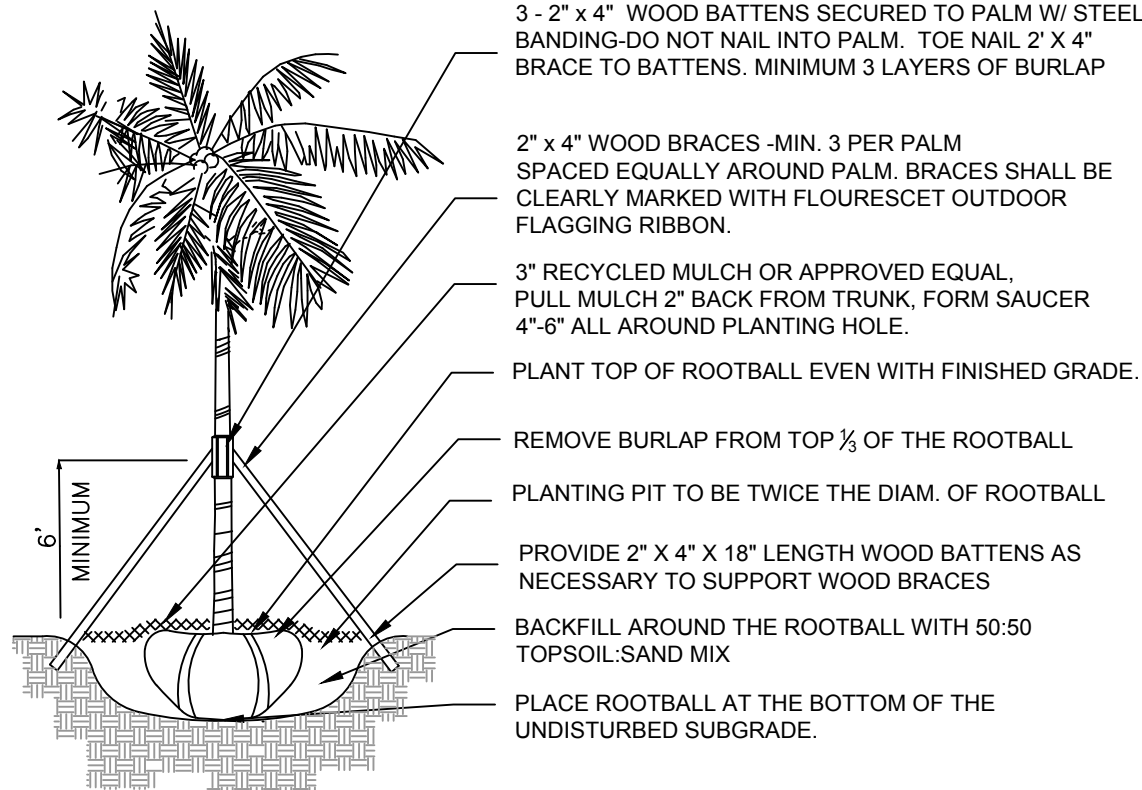

PALM PLANTING DETAIL

N.T.S.

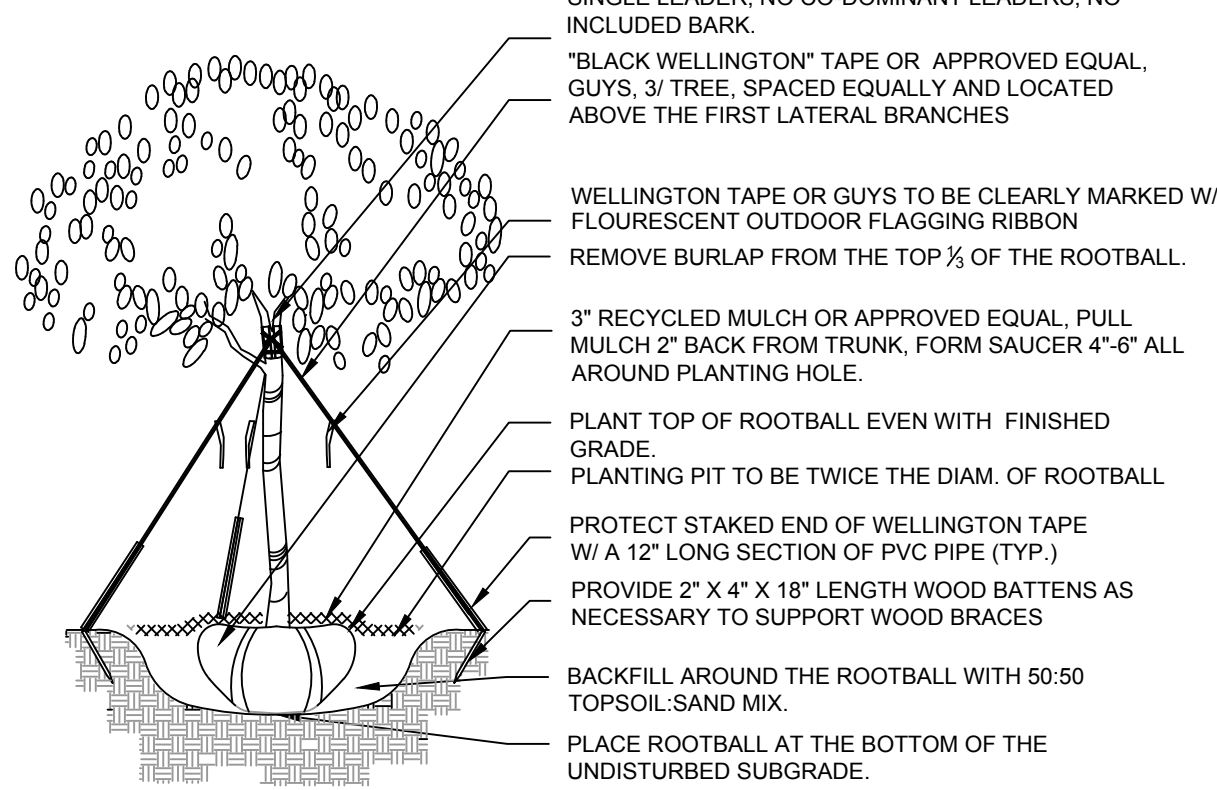

TREE PLANTING DETAIL

N.T.S.

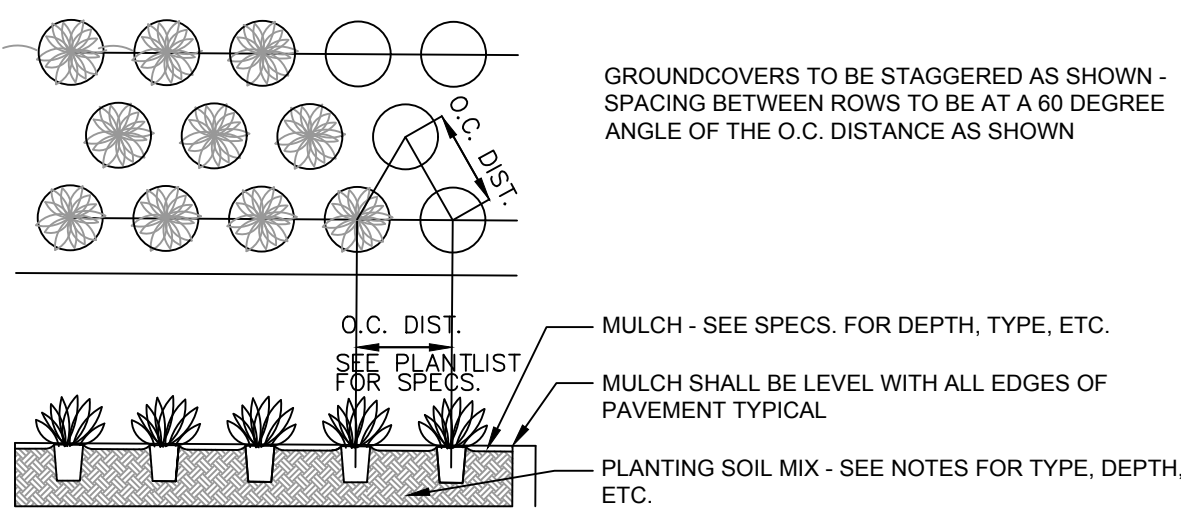

GROUNDCOVER PLANTING DETAIL

N.T.S.

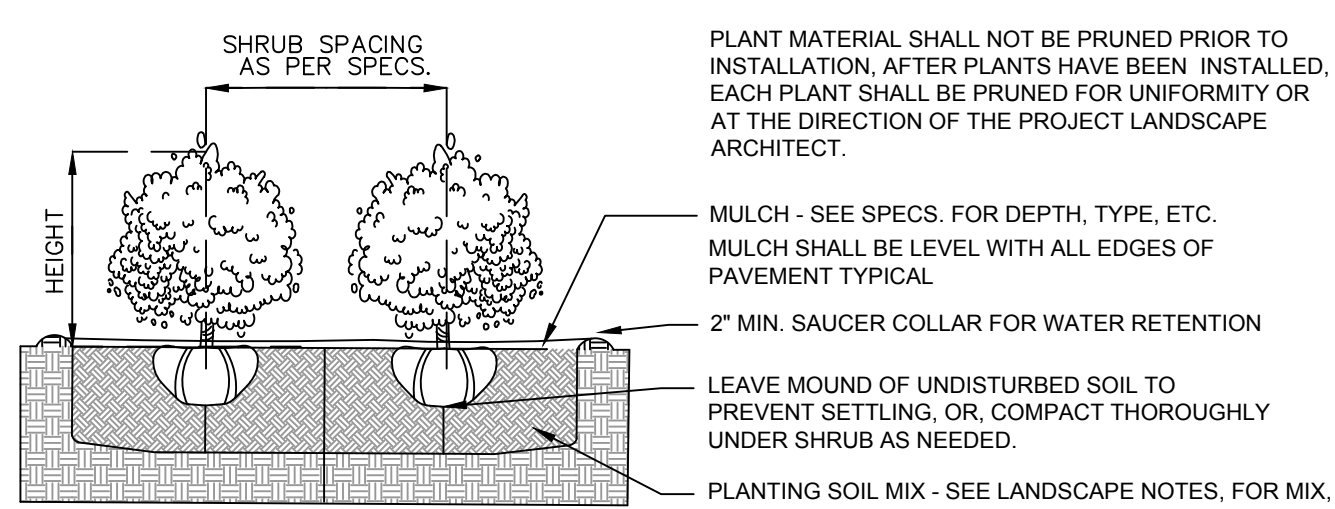

SHRUB PLANTING DETAIL

N.T.S.

## LANDSCAPE NOTES

- ALL PLANT MATERIAL SHALL BE FLORIDA GRADE NO. 1 OR BETTER.
- CONTRACTOR SHALL BECOME FAMILIAR WITH THE LOCATION OF, AVOID, AND PROTECT ALL UTILITY LINES, BURIED CABLES, AND OTHER UTILITIES.
- TREE, PALM, ACCENT AND BED LINES ARE TO BE LOCATED IN THE FIELD AND APPROVED BY THE LANDSCAPE ARCHITECT PRIOR TO INSTALLATION.
- ALL PLANTING SOIL SHALL BE 50:50 TOPSOIL:SAND MIX, FREE OF CLAY, STONES, ROCKS, OR OTHER FOREIGN MATTER. THIS SPECIFICATION INCLUDES ALL BACKFILL FOR BERMS AND OTHER LANDSCAPE AREAS.
- THE SITE CONTRACTOR SHALL BE RESPONSIBLE TO BRING ALL GRADES TO WITHIN 2" OF FINAL GRADES. THIS SHALL INCLUDE A 2" APPLICATION OF 50:50 TOPSOIL:SAND MIX FOR ALL LANDSCAPE AND AREAS TO BE SODDED.
- ALL PLANTING BEDS SHALL BE MULCHED TO A DEPTH OF 2" WITH A SMALL GRAY GRANITE AGGREGATE FREE FROM WEEDS AND PESTS. NO 'CYPRESS MULCH' OR 'RED DYED MULCH' TO BE ACCEPTED. KEEP MULCH 3" AWAY FROM TREE OR PALM TRUNKS AS PER INDUSTRY RECOMMENDATIONS.
- SOD SHALL BE 'EMPIRE TURF' ZOYSIA GRASS IN ALL LAWN AREAS AS SHOWN ON THE PLANS. SOD SHALL BE STRONGLY ROOTED, FREE FROM WEED, FUNGUS, INSECTS AND DISEASE. CONTRACTOR SHALL SOD ALL AREAS AS INDICATED ON THE PLANS OR AS DIRECTED. PAYMENT SHALL BE DETERMINED BY THE TOTAL MEASURED SODDED AREAS X THE UNIT PRICE SUBMITTED AND FIELD VERIFIED. SOD SHALL CARRY A 5-MONTH WARRANTY.
- ALL TREES, PALMS, SHRUBS AND GROUNDCOVERS, AND SOD / LAWN SHALL CARRY A ONE-YEAR WARRANTY FROM THE DATE OF FINAL ACCEPTANCE.
- IRRIGATION SHALL PROVIDE FOR A 100% COVERAGE WITH 50% OVERLAP MINIMUM AND BE PROVIDED BY A FULLY AUTOMATIC IRRIGATION SYSTEM W/ RAIN MOISTURE SENSOR ATTACHED TO CONTROLLER. ALL FLORIDA BUILDING CODE APPENDIX "F" IRRIGATION REQUIREMENTS SHALL BE STRICTLY ADHERED TO FOR INSTALLATION AND PREVAILING WATER MANAGEMENT DISTRICT RESTRICTIONS AND REGULATIONS SHALL BE IN COMPLIANCE FOR POST-INSTALLATION WATERING SCHEDULES.

TREE PROTECTION FENCES SHALL BE CONSTRUCTED PRIOR TO ANY CONSTRUCTION ACTIVITY INCLUDING GRUBBING FOR ALL TREES / PALMS THAT ARE TO REMAIN, BE PROTECTED, or BE RELOCATED'

NO ACTIVITY OR DISTURBANCE SHOULD OCCUR WITHIN THE FENCED AREAS, INCLUDING VEHICLE USE, STORAGE OF MATERIALS, DUMPING OF LIQUIDS OR MATERIALS, GRADE CHANGES, GRUBBING, AND MECHANICAL TRENCHING FOR IRRIGATION, ELECTRICAL, LIGHTING, ETC.

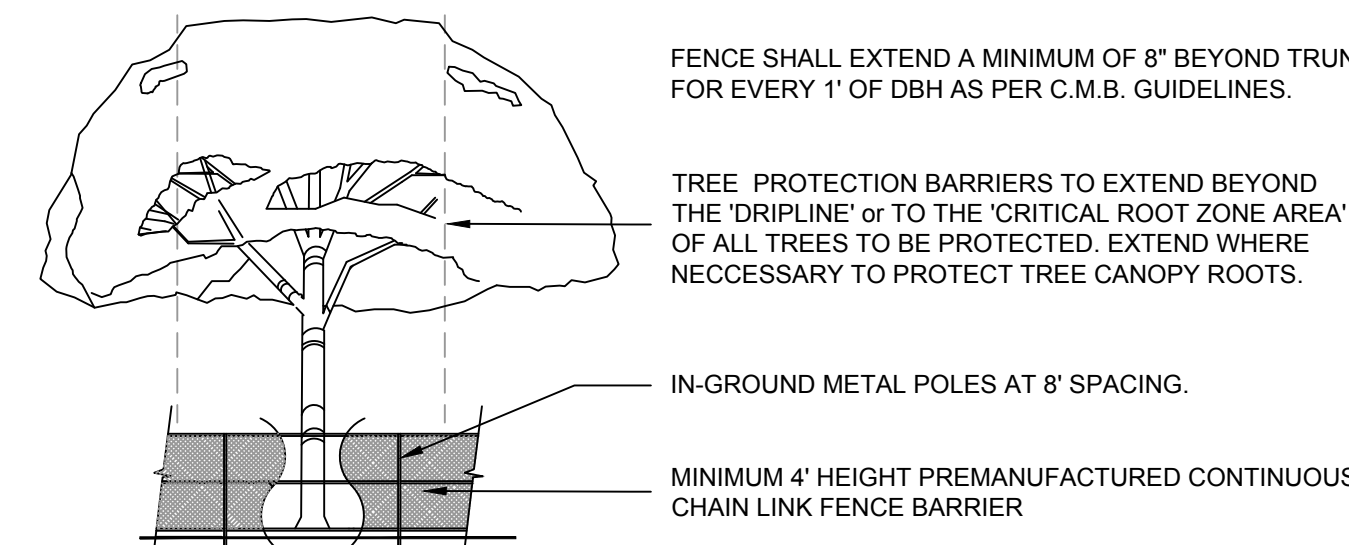

PROTECTION DETAIL NOTE  
CONTRACTOR TO INSTALL 'TREE PROTECTION FENCE BARRIERS' AROUND ALL EXISTING TREES OR PALMS AT THE START OF THE PROJECT. BARRIERS TO REMAIN IN PLACE THROUGHOUT THE DURATION OF THE PROJECT AND SHOULD NOT BE REMOVED OR DROPPED FOR ANY REASON WITHOUT AUTHORIZATION FROM THE CITY OF MIAMI BEACH URBAN FORESTER + PLANNING + ZONING DEPARTMENT

C.M.B. TREE PROTECTION. DETAIL (CHAINLINK)

N.T.S.