

# 41<sup>st</sup> Street Parklet Designs

DASH

FEBRUARY 2019

# GYÖK

GYÖK is a parklet designed to bring people together and relax from everyday life activities. Roots are the main inspiration of the symbol. Roots create organic shapes and show a unified connection. The space invites you to rest in modules, resembling segments of a tunnel. Modular units can slide to create different configurations. Seating is created by unique trapezoid pieces with overlapping, organic shapes creating curvilinear forms. Some openings from the sides are used for the display of plants, greenery from one side, roots on the other.

The resting site is made from sustainable materials. The faces of the modules are reclaimed corrugated metal with a reclaimed wooden frame. Square tiles of distressed white wood create a geometrical pattern on the floor. Alternate openings have LED lights, placed on the inside to attract pedestrians and light up the parklet at night. The minimal design with a color palette of rich earth tones, creates a relaxing and inviting environment for pedestrians to experience.

When arriving, you can scan a QR code that will take you to a website where you can select songs that will be played in the parklet. Each album showcases different types of music from different cultural roots.



The name GYÖK comes from the Hungarian word roots. The designer, Santiago Krössler's roots are Hungarian.

Santiago Krössler

## RESEARCH [FURNITURE]

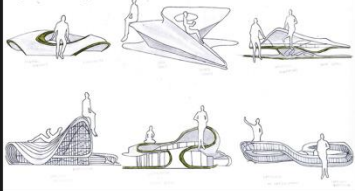

## RESEARCH [PARKLET]

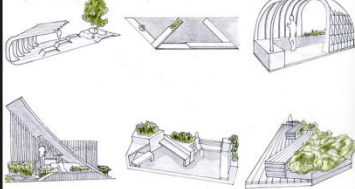

## CONCEPTS

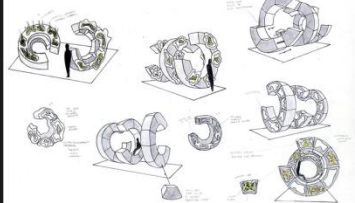

## SYMBOL

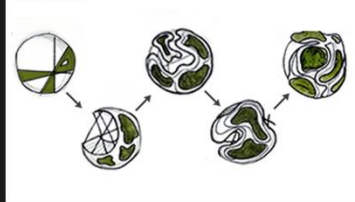

## MATERIALS



RECLAIMED CORRUGATED METAL RECLAIMED WOOD WHITE-WASHED WOOD

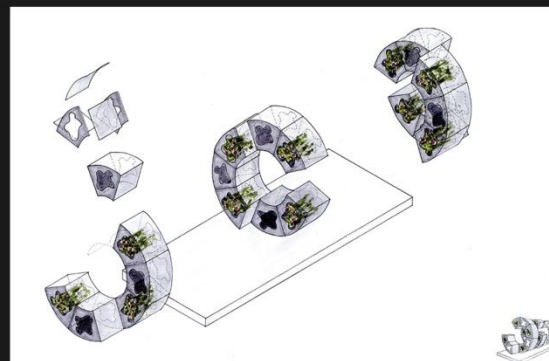
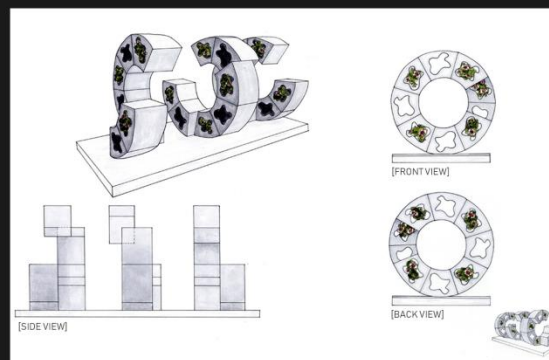
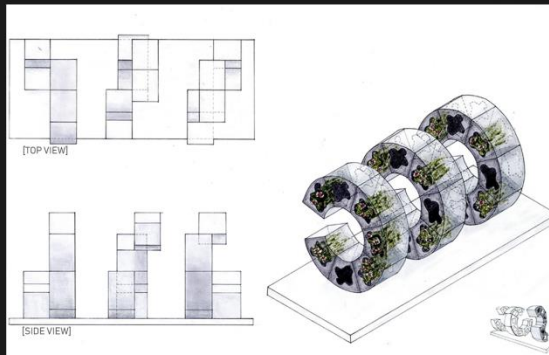

## MODEL

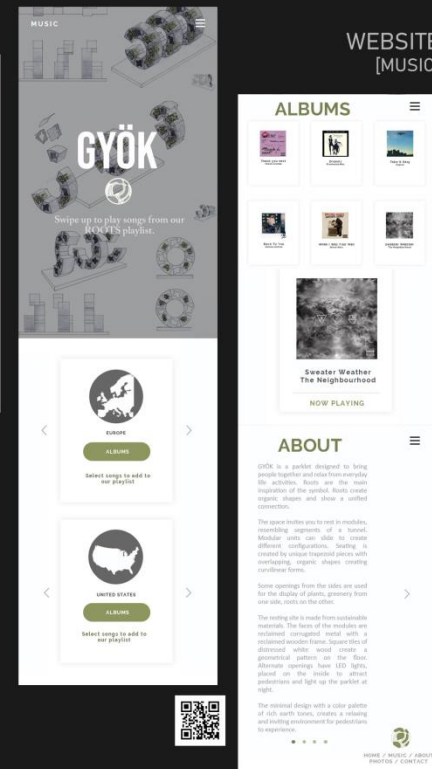
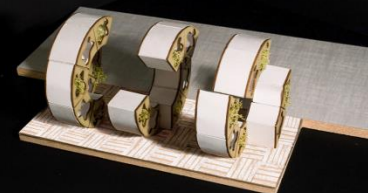

# SYNTHESIS

SYNTHESIS, A COMMUNITY AREA THE SIZE OF A PARKING SPACE, IS INSPIRED BY THE VEINS IN LEAVES. THEY CONNECT DIFFERENT PARTS OF THE PLANT TOGETHER TO UNIFY A WHOLE. ALL SEATING AREAS ARE VEINS THAT STEM OUT FROM THE SIDEWALK, ENCOURAGING EVERYONE TO STEP INSIDE AND INTERACT.

THE ORGANIC FORM OF THE LEAF IS INCORPORATED INTO THE OVERARCHING SHADES. AS THEY ARCH FROM THE SIDEWALK TO THE INSIDE, THE SHADES INVITE YOU INTO TWO SEATING AREAS. A CANTILEVERED TABLE ALONG WITH BENCHES STEM OUT FROM THE ARCH, CREATING A COHESIVE AND OPEN ENVIRONMENT. NEXT TO IT IS A SEATING AREA FOR THOSE WHO DON'T DESIRE TO USE THE TABLE. THE PERPENDICULAR SEATING ENCOURAGES INTERACTIONS BETWEEN PEOPLE. ONE PART IS COVERED BY SHADING WHILE THE OTHER IS EXPOSED TO LIGHT. ALL OF THE SPACE IS PROTECTED BY A BUFFER WHICH HAS PLANTS ON TOP, CREATING PRIVACY AND GIVING LIFE TO THE PARKLET.



OMAR LEON

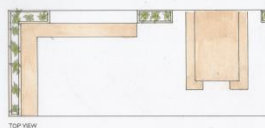
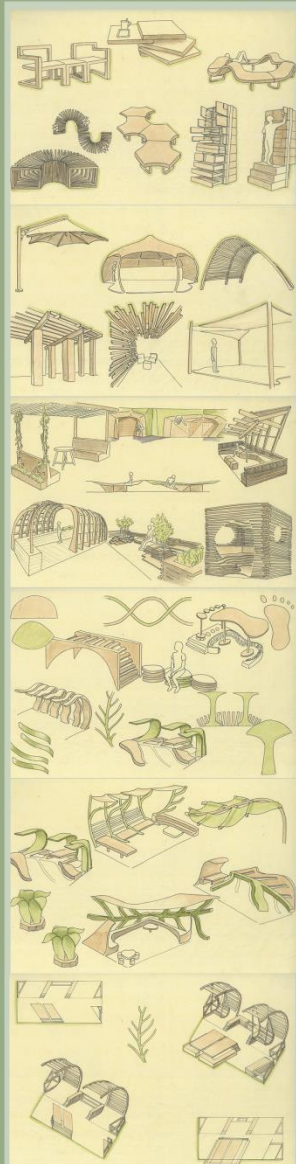

## SYNTHESIS

- RIBBON PLANT
- WHITE OAK
- CLOTH CANVAS

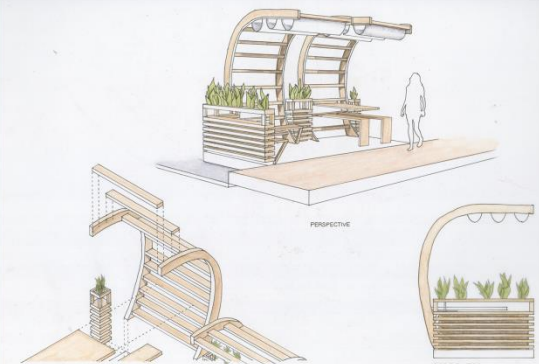
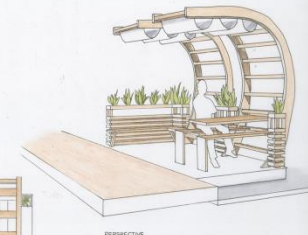
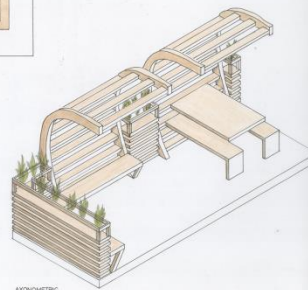





# Botánica

Botánica is a representation of a walk under a tree canopy. The concept is inspired by natural symbol: a treetop, representing community and creating diversity. The semi-enclosed area made from geometrical figures creates an atmosphere similar to a tree canopy—acting as natural protection and providing a space for social interactions.

Botánica claims a parking space as a small public area. A zig-zag bench attached to planters runs along the entire parklet with interspersed tables allow people to retreat from the crowded streets of the city by creating a natural atmosphere. Four arches made out of wood with meshed roofs and plants protect from the harsh South Florida climate. Botánica creates a relaxing ambience created by the plants and enhanced by the sounds of wind chimes.



Carlos Cepeda

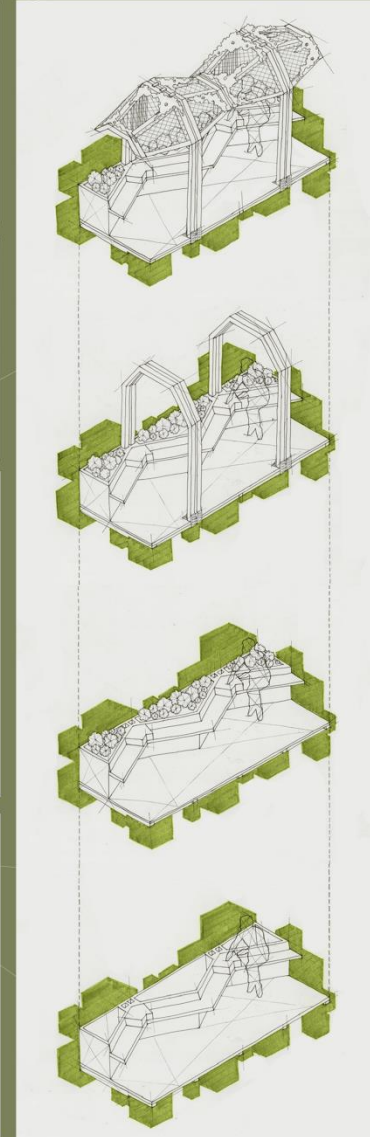
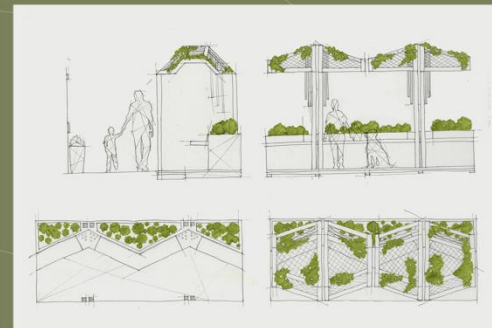
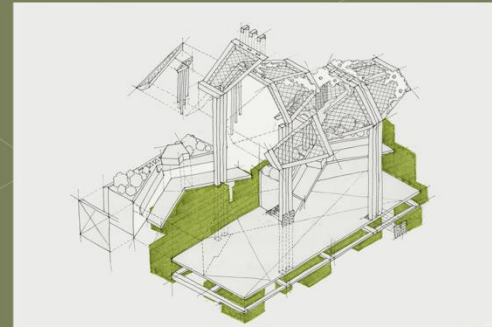
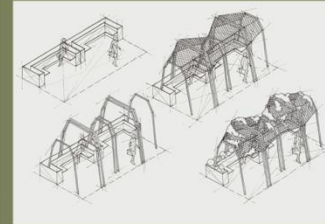
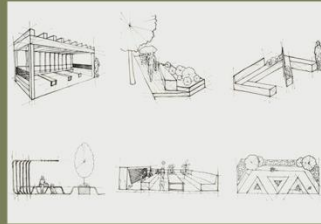
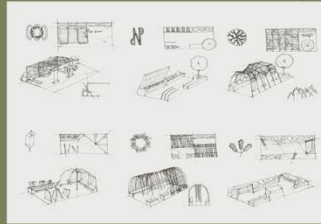

## Circa Parklet

Circa uses concentric circles to symbolize unity and togetherness. This array of continuously smaller circles both above and below the eye level draws people into the center. Various scattered connections create the paths towards unity. The Radial design invites people from all backgrounds, guiding them into a place to convene.

A point will be selected within the space, that through the concentric design, will drive everything around it. The circular arrays are then generated through parallel aluminum frames that curve about the center above and around the viewer. Pressure treated wooden slabs are then placed ontop of the frame, pointing towards the center. Additional wooden seating and tables meander below the viewer, and are integrated both as modular and connected pieces.



Alan Lomba

