

SCOPE OF WORK

THE FOLLOWING DRAWINGS ILLUSTRATE THE PROPOSED LANDSCAPE SCOPE OF WORK FOR A NEW RESIDENTIAL PROJECT ON PROPERTY LOCATED IN THE NAUTILUS NEIGHBORHOOD OF THE CITY OF MIAMI BEACH.

- RESIDENTIAL TREE REMOVAL AND ON SITE MITIGATION
- RESIDENTIAL LANDSCAPE PLANTING
- RESIDENTIAL LANDSCAPE IRRIGATION
- RESIDENTIAL LANDSCAPE SITE LIGHTING

SHEET INDEX				
			LANDSCAPE DRAWINGS	DRAWING NOTES
12/07/18	DRB SUBMISSION	REV.	LCVR	COVER PAGE
09/07/18	DRB SUBMISSION		TD100	TREE DISPOSITION NOTES/SCHEDULE
08/16/18	DRB PRELIMINARY		TD101	TREE DISPOSITION PLAN
			L200	MATERIALS NOTES AND SPECIFICATIONS
			L201	MATERIALS PLAN
			L400	PLANTING NOTES AND SCHEDULE
			L401	PLANTING PLAN
			L400.1	LANDSCAPE LEGEND
			L450	PLANTING DETAILS
			L800	SITE LIGHTING NOTE AND SPECIFICATIONS
			L801	SITE LIGHTING PLAN
			IR100	IRRIGATION DETAILS
			IR101	IRRIGATION DETAILS
			IR200	IRRIGATION NOTES AND PLAN



7580 NE 4th Court  
Studio 100  
Miami, FL 33138

PROJECT NUMBER  
1819



Designer/  
Landscape Architect

PROJECT:  
4354 ALTON  
ROAD  
RESIDENCES

4354 ALTON RD.  
MIAMI BEACH,  
FLORIDA, 33139

DRAWING:

PROJECT COVER  
SOUTH  
RESIDENCE

SOUTH RESIDENCE



NORTH

MARSH C. KRIPLEN, FLORIDA, LIC# LA6667007  
ALL DRAWINGS AND WRITTEN MATERIAL APPEARING HEREIN CONSTITUTE THE ORIGINAL AND UNPUBLISHED WORK OF MCG ARCHITECTURE AND MAY NOT BE DUPLICATED, USED OR DISCLOSED WITHOUT THE EXPRESS WRITTEN CONSENT OF MCG ARCHITECTURE & PLANNING, INC. © 2018  
SCALE:  
CHECK: MCK  
DATE: 07/09/2018  
SHEET NUMBER

LCVR

TREE DISPOSITION AND MITIGATION SCHEDULE

TREE DISPOSITION SCHEDULE

TREE No.	TREE - LATIN NAME	TREE - COMMON NAME	DIAMETER at BREAST HEIGHT (in inches)	MULTI TRUNK	OVERALL HEIGHT (in feet)	CANOPY DIAMETER (in feet)	CANOPY (in Sq. Ft.)	DISPOSITION	CONDITION	REMOVAL- MUNICIPAL CRITERIA AND NOTES		
										CRITERIA	CANOPY SQ. FT.	ROW CANOPY SQ. FT.
5	PTYCHOSPERMA ELEGANS	SOLITAIRE PALM	5		13	10	79	REMAIN	GOOD			
6	ADONIDIA MERRILLII	CHRISTMAS PALM	8	X	14	14	154	REMOVE	FAIR	CONFLICTS WITH NEW CONSTRUCTION	154	
15	PERSEA AMERICANA	AVOCADO	15		22	20	314	REMOVE	FAIR	EXEMPT FROM MITIGATION		
STREET TREES												

UNITS REMOVED FROM ROW		-	
UNITS REMOVED		154	
TOTAL UNITS REMOVED:		154	
PROPOSED ON SITE MITIGATION BREAKDOWN			
		credit/tree	TREE CREDIT
CATEGORY 1 TREE 2" CAL/12' HT MIN:	3	300	Category 1 Tree = 300sf credit/tree 900
CATEGORY 2 TREE 2" CAL/10' HT MIN:	2	150	Category 2 Tree = 150sf credit/tree 300
CATEGORY 3 TREE 2" CAL/8' HT MIN:	-	100	Category 3 Tree = 100sf credit/tree -
**FOR MITIGATION ONLY** CATEGORY 4 PALM 6' CLR TRUNK MIN:	-	50	Category 4 Palm = 50sf credit/tree -
TOTAL PROPOSED REPLACEMENT TREES (REFER TO PLANTING PLANS):	5	COMBINATION FULFILLS SITE MITIGATION OF CANOPY SF: 1,200	

TRANSPLANTING SPECIFICATIONS

- 1.Root prune all trees and palms to a minimum depth of 24" for the palms and 48" for the trees.
- 2.Trim frayed roots with clippers saws or similar and leave clean cuts.
- 3.Wrap balls with shrink wrap plastic, back filling with Shredded peat moss, fill up voids between plastic & ball, covering all cut roots.
- 4.Backfill with existing soil to hold plastic firmly against newly wrapped ball. Keep 2" deep trench exposed so as to find root ball when harvesting.
- 5.Water three times per week for next 2 months or until trees are ready to move.
- 6.Harvest palms after 5 weeks minimum and trees after 8 to 10 weeks depending on size. Consult with LA prior to moving on schedule.
- 7.Re-dig holes well outside the pastic plant wrap being careful not to disturb or tear, preserving root ball, re-wrap if needed for transplanting.
- 8.When digging trees, break off large piece of existing coral rock, +/- 36" deep as feasible, by under cutting ball. Do Not Peel Ball off Rock.. If necessary, the horizontal chipping or drilling may be required to break off specimen Oak ball at a minimum 30" depth
- 9.Replant transplanted trees and palms at correct height in new location, keeping original ball top exposed.
10. Properly wrap and hook-up trees and palms to lifting equipment in such a way as to not tear cambium layer and exsively disfigure appearance.
11. Plants that are not properly lifted and die due to girdling, compression or excessive damage to the cambium layer will be charged to the G.C. and Sub-contractor at a rate of \$500 per caliper inch.
12. Remove plastic, backfill with 50% existing soil blended with 50% planting soil plus ¼ bale of Canadian peat moss for palms and ½ bale for trees.
13. Backfill, sink, place in Agriform fertilizer tablets per recommendations, brace, and trim broken branches and fronds as needed. Brace per specification.
14. Water daily for duration of overall job will be required. Having bubblers as part of automatic irrigation system for post construction can supplement additional drenching, but are not a sustitution.

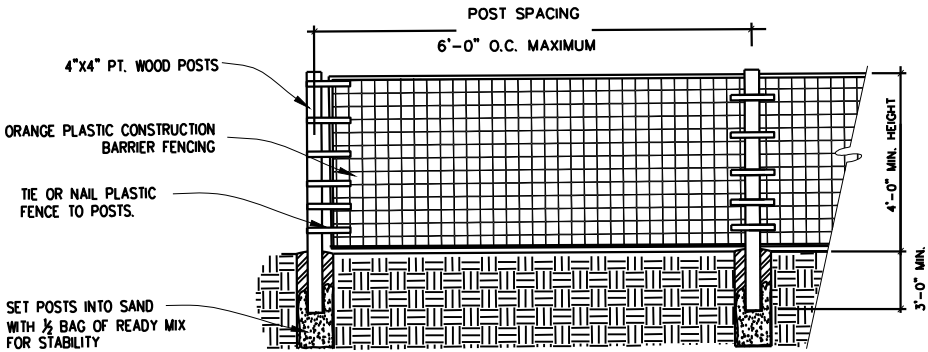
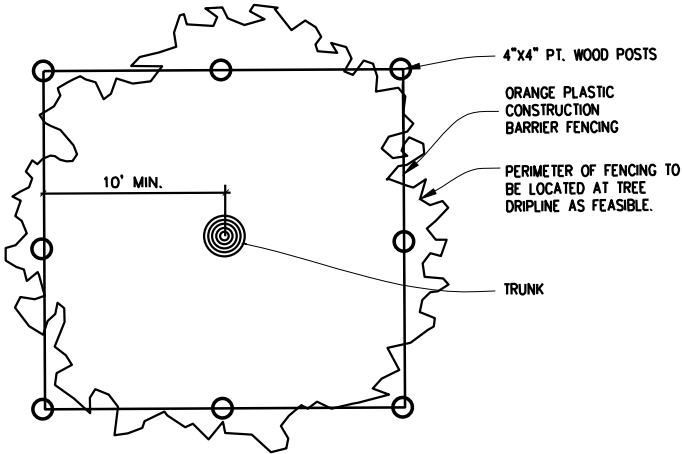

TREE PROTECTION FENCE DETAIL

SCALE: NTS



7580 NE 4th Court  
Studio 100  
Miami, FL 33138

PROJECT NUMBER  
1819



Designer/  
Landscape Architect

PROJECT:  
4354 ALTON  
ROAD  
RESIDENCES

4354 ALTON RD.  
MIAMI BEACH,  
FLORIDA, 33139

DRAWING:

TREE DISPOSITION  
NOTES, SCHEDULE  
AND  
TREE PROTECTION  
DETAIL

MARSH C. KRIPILEN FLORIDA LIC# LA6667007  
ALL DRAWINGS AND WRITTEN MATERIAL APPEARING  
HEREIN CONSTITUTE THE ORIGINAL AND UNPUBLISHED  
WORK OF MCK ARCHITECTURE AND MAY NOT BE  
DUPLICATED, USED OR DISCLOSED WITHOUT THE  
EXPRESS WRITTEN CONSENT OF MCK ARCHITECTURE &  
PLANNING, INC. (c) 2018

SCALE:  
CHECK: MCK  
DATE: 07/09/2018  
SHEET NUMBER

TD100

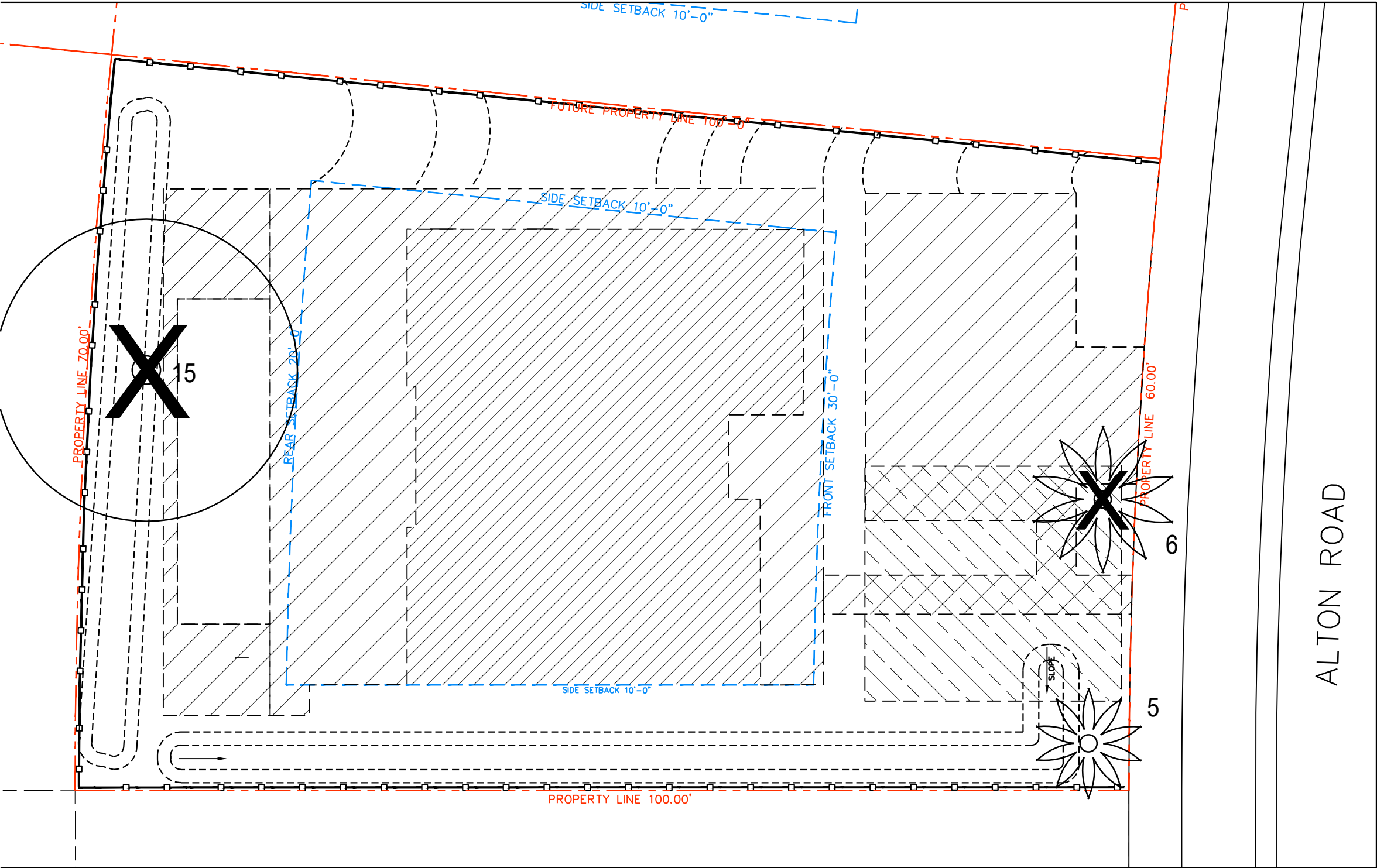

LEGEND



EXISTING TREES & PALMS



EXISTING TREES & PALMS TO BE REMOVED



EXISTING TREES & PALMS TO BE RELOCATED

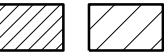

PROPOSED BUILDING/HARDSCAPE

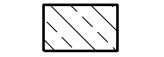

CONSTRUCTION PARKING

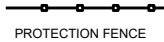

PROTECTION FENCE



7580 NE 4th Court  
Studio 100  
Miami, FL 33138

PROJECT NUMBER  
1819



Designer/  
Landscape Architect

PROJECT:  
4354 ALTON  
ROAD  
RESIDENCES

4354 ALTON RD.  
MIAMI BEACH,  
FLORIDA, 33139

DRAWING:  
TREE DISPOSITION  
PLAN



MARSH C. KRIPLEN, FLORIDA LIC# LA6667007  
ALL DRAWINGS AND WRITTEN MATERIAL APPEARING  
HEREIN CONSTITUTE THE ORIGINAL AND UNPUBLISHED  
WORK OF MCG ARCHITECTURE AND MAY NOT BE  
DUPLICATED, USED OR DISCLOSED WITHOUT THE  
EXPRESS WRITTEN CONSENT OF MCG ARCHITECTURE &  
PLANNING, INC. (c) 2018

SCALE:

CHECK: MCK

DATE: 07/09/2018

SHEET NUMBER

PLANTING NOTES

1.

PLANT MATERIAL IS TO BE HEALTHY SPECIMENS FREE FROM DISEASE OR DAMAGE, AND IS TO BE MAINTAINED IN EXCELLENT CONDITION WHILE ON THE JOBSITE. LANDSCAPE ARCHITECT SHALL INSPECT PLANT MATERIAL UPON ARRIVAL TO JOBSITE AND WILL REJECT PLANT MATERIAL THAT DOES NOT MEET THE STANDARDS DESCRIBED WITHIN THE CONTRACT DOCUMENTS.
2.

THE LANDSCAPE ARCHITECT WILL PERIODICALLY INSPECT PLANT MATERIAL STOCKPILED AND/OR PLANTED ON SITE DURING THE COURSE OF CONSTRUCTION. PLANT MATERIAL NOT MEETING THE STANDARDS CONTAINED WITHIN CONTRACT DOCUMENTS SHALL BE REPLACED AT NO COST TO THE OWNER.
3.

PRESERVE & PROTECT ALL EXISTING VEGETATION INDICATED TO REMAIN AT ALL TIMES.
4.

PROVIDE MATCHING SIZES AND FORMS FOR EACH PLANT OF THE SAME SPECIES UNLESS OTHERWISE INDICATED.
5.

CONTRACTOR TO VERIFY ALL QUANTITIES. IN CASE OF DISCREPANCIES, GRAPHICALLY SHOWN QUANTITIES SHALL TAKE PRECEDENCE.
6.

ALL MATERIALS USED SHALL CONFORM TO THE GUIDELINES ESTABLISHED BY THE CURRENT AMERICAN STANDARDS FOR NURSERY STOCK, PUBLISHED BY THE AMERICAN ASSOCIATION OF NURSERYMEN.
7.

ALL PLANT MATERIAL SHALL BE INSTALLED PLUMB AND PER THE SPECIFICATIONS CONTAINED WITHIN THE CONTRACT DOCUMENTS. ANY NECESSARY STAKING AND/OR OTHER SUPPORTS MATERIALS/METHODS SHALL BE SUBMITTED TO THE LANDSCAPE ARCHITECT FOR REVIEW AND APPROVAL PRIOR TO INSTALLATION.
8.

THE CONTRACTOR SHALL PRUNE EXISTING AND/OR NEW TREES ONLY PER LANDSCAPE ARCHITECT DIRECTION.
9.

THE CONTRACTOR SHALL STAKE THE LOCATIONS OF ALL TREES AND B&B SHRUBS FOR LANDSCAPE ARCHITECT REVIEW AND APPROVAL, PRIOR TO INSTALLATION.
10.

ALL ROOT-WRAPPING MATERIALS THAT ARE NOT BIO-DEGRADABLE SHALL BE REMOVED FROM THE ROOT BALL. ROOT BALLS SHALL BE FREE OF WEEDS.
11.

SPECIFIED PLANT MATERIAL SIZES SHALL BE CONSIDERED MINIMUM SIZES.
12.

FINISH GRADE OF PLANTING BEDS SHALL BE TWO (2) INCHES BELOW ADJACENT FLATWORK, UNLESS SPECIFIED OTHERWISE.
13.

MULCH OR PLANTING BED DRESSING SHALL BE PLACED IN ALL PLANTING AREAS AS SPECIFIED. MULCH OR PLANTING BED DRESSING SHALL NOT BE PLACED WITHIN SIX (6) INCHES OF TREE TRUNKS. MULCHING SHOULD BE REPEATED ANNUALLY DURING THE AUTUMN TO A THREE (3) INCH DEPTH.
14.

ALL PLANT MATERIAL SHOULD RECEIVE AN ORGANIC FERTILIZER IN LIMITED APPLICATION FOLLOWING INSTALLATION. TYPE AND APPLICATION RATE AND METHOD OF APPLICATION TO BE SPECIFIED BY THE CONTRACTOR AND APPROVED BY THE LANDSCAPE ARCHITECT.
15.

EXCESS FERTILIZER SHALL BE DISPOSED OF PROPERLY OFF-SITE. IT SHALL NOT BE DISPOSED OF IN STORM DRAINS AND/OR DRYWELLS.
16.

STOCKPILED PLANT MATERIAL TO BE PLACED IN THE SHADE AND PROPERLY HAND-WATERED UNTIL PLANTED.
17.

MULCH ALL BEDS WITH 2-3" AT TIME OF PLANTING. REFER TO PLANTING DETAILS FOR MULCH SPECIFICATIONS. REPLENTISH MULCH AS REQUIRED OVER THE COURSE OF THE GUARANTEE PERIOD TO ENSURE ADEQUATE COVERAGE.
18.

SIX (6) INCH PLANT MIX SHALL BE PROVIDED FOR ALL LAWN, TURF, AND NATIVE PLANTING ZONES. 18 INCH PLANT MIX SHALL BE PROVIDED FOR ALL PERENNIAL PLANTING BEDS UNLESS OTHERWISE NOTED.
19.

LANDSCAPE CONTRACTOR TO PAINT ALL TREE & PALM SUPPORTS WITH BENJAMIN MOORE ARBORCOAT ASHLAND SLATE EXTERIOR WOOD PAINT. ALL BRACING CUTS TO BE NEAT AND CLEAN, NO CHAINSAW CUTS.
20.

GUARANTEE PERIOD: CONTRACTOR IS RESPONSIBLE FOR SITE MAINTENANCE AND MATERIAL REPLACEMENT FOR ONE YEAR FROM THE DATE OF SUBSTANTIAL COMPLETION. REMOVE AND REPLACE ALL DEAD PLANT MATERIAL OR MATERIAL WHICH IS FAILING AS DETERMINED BY ARBORIST AND LANDSCAPE ARCHITECT. CORRECT DEFICIENCIES WITH MULCH AND IRRIGATION.
21.

MAINTENANCE PLAN: DURING THE GUARANTEE PERIOD CONTRACTOR SHALL PERFORM THE FOLLOWING TASKS ON A REGULARLY SCHEDULED BASIS. WEEKLY WATERING (JAN-APR) WHEN IRRIGATION SYSTEMS ARE NOT OPERATIONAL. WEEKLY SITE INSPECTION FOR PLANT HEALTH, TREE/PALM GUYING, IRRIGATION OPERATION. QUARTERLY FERTILIZATION (MAR-SEPT) APPROPRIATE FOR MATERIAL (REF IFAS PUBLICATION ENH858) WEEKLY MOWING OF LAWNS AND PLANT BED WEEDING DURING THE GROWING AND SHOULDER SEASONS. MONTHLY VISITS FOR SAME OVER WINTER.

PLANTING SCHEDULE

TYPE	ABR.	QUANTITY	BOTANICAL NAME	COMMON NAME	SPECIFICATIONS
PALMS					
	BNO	2	BISMARCKIA NOBILIS	BISMARCK PALM	10' GW, MATCHED
	DCA	3	DYPSIS CABADAE	CABADA PALM	45 GAL
	DCA	3	DYPSIS CABADAE	CABADA PALM	100 GAL

TREES					
*/***	ACH	2	ACACIA CHORIOPHYLLA	CINNECORD	2" CAL. & 12' HT. MIN.
**	CGR	3	CAESALPINIA GRANADILLO	BRIDAL VEIL- 4' CLR TRUNK	3" CAL. & 14' HT. MIN.
*/***	CRO	1	CLUSIA ROSEA	AUTOGRAPH TREE	4" CAL. & 16' HT. MIN
*/***	CUV	1	COCOLOBA UVIFERA	SEA GRAPE- MULTI-TRUNK SPECIMEN	3" CAL. & 14' HT. MIN
*/***	PPT	1	PELTOPHORUM PTERCARPUM	COPPER POD	2" CAL. & 12' HT. MIN.
*/***	QVI	1	QUERCUS VIRGINIANA	LIVE OAK- SPECIMEN	3" CAL. & 14' HT. MIN.

UNDERSTORY TREES / LARGE SHRUBS					
	GLU	2	GYMNANTHES LUCIDA	CRABWOOD- MULTI TRUNK	6' HT. & 4' SPREAD MIN.
	MFR	5	MYRCIANTHES FRAGRANS	SIMPSON STOPPER- LOW BRANCHING	6' HT. & 4' SPREAD MIN.

ACCENTS / SHRUBS					
	AG	12	ARGUSIA GNAPHALODES	SEA LAVANDER	7 GAL
	BA	7	BRUNFELSIA AMERICANA	LADY OF THE NIGHT	3 GAL
	CWI	8	CANELLA WINTERANA	CINNAMON BARK	15 GAL
	CO	11	COLOCASIA 'BLACK MAGIC'	BLACK TARO	7 GAL
	Cs	8	COLOCASIA SPECIES	TARO	7 GAL
	EFE	1	ENCEPHALARTOS FEROX	ZULULAND CYCAD	15 GAL
	EAX	2	EUGENIA AXILLARIS	WHITE STOPPER	15 GAL, BUSH FORM
	ECO	4	EUGENIA CONFUSA	REDBERRY STOPPER	15 GAL, BUSH FORM
	MD	7	MONSTERA DELICIOUSA	MONSTERA	3 GAL
	HC	3	HELICONIA CARIBAEA	WILD PLANTAIN	7 GAL
	HR	6	HELICONIA ROSTRATA	LOBSTER CLAW	15 GAL
	PM	23	PODOCARPUS MACROPHYLLUS	JAPANESE YEW	25 GAL. 6' HT MIN., MATCHED
	RE	11	RUSSELIA EQUISETIFORMIS	FIRECRACKER	3 GAL
	ZI	2	ZAMIA INTEGRIFOLIA (FLORIDANA)	COONTIE	7 GALLON

GROUNCOVER					
	LM	56	LIRIOPE MUSCARI	LILY TURF	1 GALLON
	MS	96	MICROSORUM SCOLOPENDRIA	WART FERN	1 GALLON
	PB	84	PHILODENDRON BURLE MARX	PHILODENDRON BURLE MARX	1 GALLON
	TA	57	TRACHELOSPERMUM ASIATICUM	CREEPING JASMINE	1 GALLON

ORNAMENTAL GRASSES					
	SBA	4	SPARTINA BAKERI	SAND CORDGRASS	7 GALLON
	TDA	3	TRIPSACUM DACTYLOIDES	FAKAHATCHEE GRASS	7 GALLON

LAWN					
	LAWN	690 SF	STENOTAPHRUM SECUNDATUM	ST. AUGUSTINE GRASS	SOD

TREE AND PALM ALLOCATION LEGEND

- \*

MITIGATION
- \*\*

STREET TREE
- \*\*\*

SITE LANDSCAPE

DEFINITIONS

1.

TREE: ANY SELF SUPPORTING WOODY PLANT OR PALM WHICH USUALLY HAS A MAIN AXIS OR TRUNK. 12' HT, 6' CANOPY DIA. AND 2" CAL. TRUNK MINIMUM AT TIME OF PLANTING.
2.

STREET TREE: A SPECIES TYPICALLY GROWN IN MIAMI BEACH WHICH NORMALLY MATURES TO A HEIGHT OF AT LEAST 20'. 12' HT., 3" CAL. TRUNK AND 4' CLR TRUNK MINIMUM AT TIME OF PLANTING. MAXIMUM AVERAGE TREE SPACING 20' O.C. (CITY DISCRETION ALLOWED DEPENDING ON SITE CONDITIONS).
3.

PALMS (STREET TREES): SINGLE TRUNK SPECIES. 15' CLEAR WOOD AND 10" DBH TRUNK MINIMUM AT TIME OF PLANTING. PALMS SHALL NOT COUNT TOWARD THE REQUIRED STREET TREES.
4.

LARGE SHRUB - SMALL TREE: NORMALLY MATURES AT MINIMUM HEIGHT OF 10'. 6' HT. AND 4' CANOPY DIA. MINIMUM AT TIME OF PLANTING.



7580 NE 4th Court  
Studio 100  
Miami, FL 33138

PROJECT NUMBER  
1819



Designer/  
Landscape Architect

PROJECT:  
4354 ALTON  
ROAD  
RESIDENCES

4354 ALTON RD.  
MIAMI BEACH,  
FLORIDA, 33139

DRAWING:

PLANTING NOTES  
& SCHEDULE

MARSH C. KRIPLEN FLORIDA LIC# LA6667007  
ALL DRAWINGS AND WRITTEN MATERIAL APPEARING HEREIN CONSTITUTE THE ORIGINAL AND UNPUBLISHED WORK OF MCG ARCHITECTURE AND MAY NOT BE DUPLICATED, USED OR DISCLOSED WITHOUT THE EXPRESS WRITTEN CONSENT OF MCG ARCHITECTURE & PLANNING, INC. (c) 2018  
SCALE:  
CHECK: MCK  
DATE: 07/09/2018  
SHEET NUMBER

L400





LANDSCAPE LEGEND

MUNICIPALITY: City of Miami Beach

ZONING CLASS: RS-4

LOT AREA: 6,500

ACRES: 0.1492

ORDINANCE/CODE SECTION: CITY OF MIAMI BEACH SECTION 126

STREET TREES

A.	Street trees (maximum average spacing of 30' o.c.)	2	2
	Linear ft of street frontage: 60		
	Multiplier: 30		
	Percentage of Palms counted toward Street Trees on 1:1 basis	1	1
	Multiplier: 30%		
B.	Street trees directly below power lines	0	0
	Linear ft of street frontage: 0		
	Multiplier: 25		

\*\*One site tree (CUV) being counted toward street tree requirements)\*\*

SHRUBS

A.	Number of shrubs required	72	72
	Lot and street trees required: 6		
	Multiplier: 12		
B.	% Native species required	36	36
	Shrubs provided: 72		
	Multiplier: 50%		

LARGE SHRUBS OR SMALL TREES

A.	Number of large shrubs or small tree required	7	7
	Shrubs required: 72		
	Multiplier: 10%		
B.	% Native species required	4	4
	Shrubs provided: 7		
	Multiplier: 50%		

OPEN SPACE

A.	Sq. Ft. of required Open Space	4,550	4,857
	Lot area: 6,500		
	Multiplier: 70%		
B.	Sq. Ft. of parking lot open space	20	0
	Parking Spaces: 2		
	Multiplier: 10 sf/space		
C.	Total Sq. Ft. of landscaped Open Space required	4,570	4,857

LAWN AREA

A.	Total Sq. Ft. of landscaped Open Space	4,570	4,857
B.	Maximum Lawn Area (sod) permitted-	2,285	690
	Open space required: 4,570		
	Multiplier: 50%		

TREES

A.	Number of trees required per lot, less existing trees	6	6
	Required Trees/Lot: 6		
	Net lot acres: 0.1492		
	Required Trees: 6		
	Existing trees: 0		
B.	% Palms allowed	na	na
	Palms allowed 1:1 for mitigation only.		
C.	% Native required	2	1
	Trees provided: 5		
	Multiplier: 30%		
D.	% Drought tolerant and low maintenance species required	3	1
	Trees provided: 5		
	Multiplier: 50%		

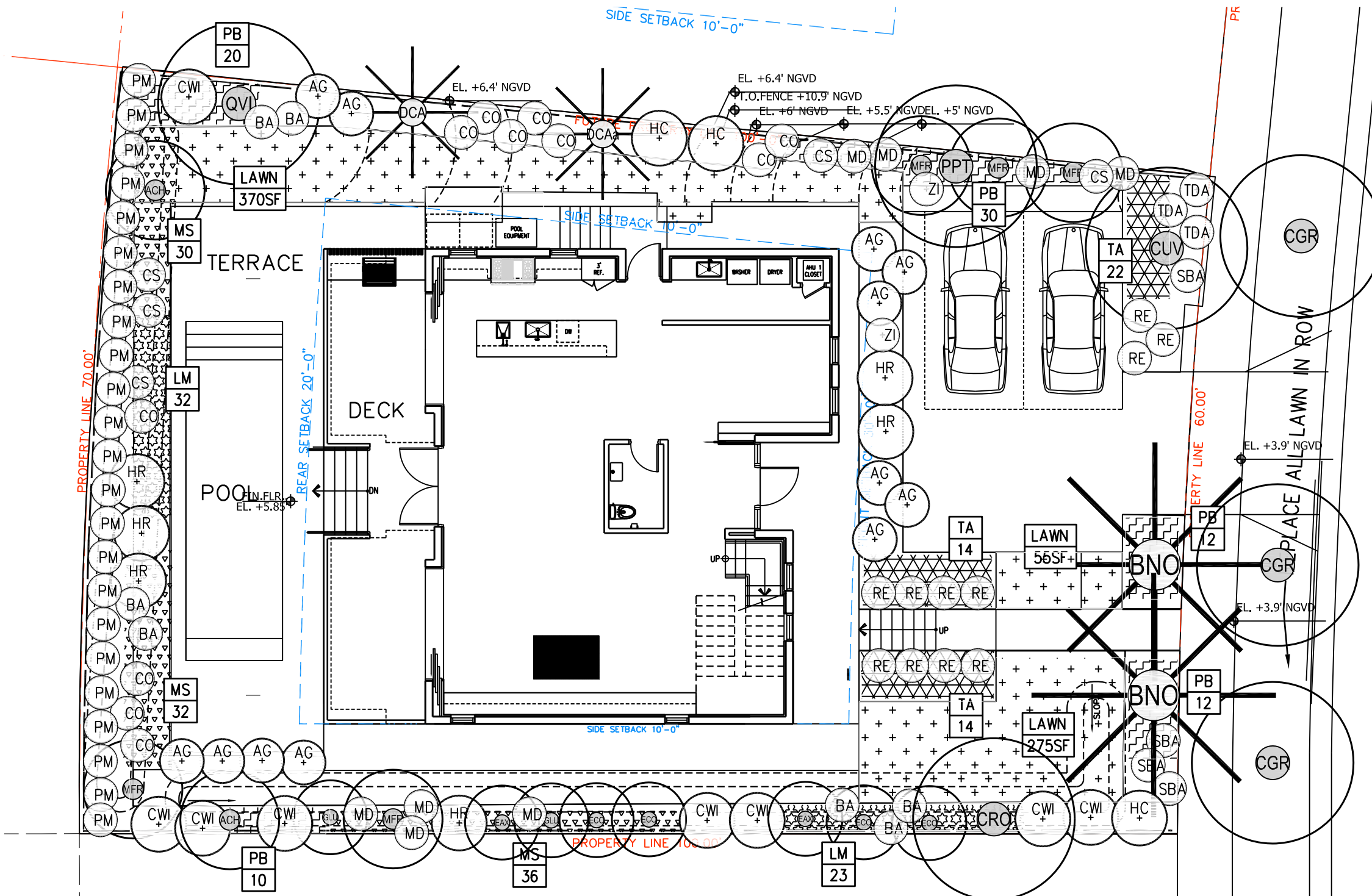

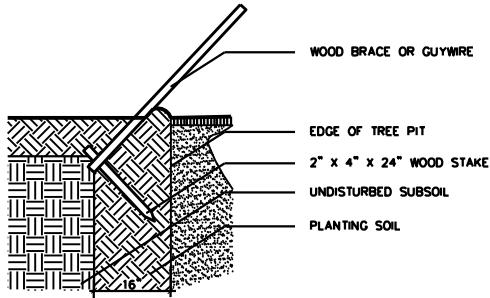

- STAKING NOTES:
1. SAW CUT ALL WOOD STAKING MATERIALS LEAVE ENDS NEAT AND TRIM.
  2. PAINT ALL WOOD STAKING MATERIALS HUNTER GREEN.

#### 9 STAKING DETAIL & NOTES

SCALE: NOT TO SCALE

PREPARATION:  
STORE ALL MATERIAL IN DRY, CLEAN AREA, COVER TO PROTECT FROM RAIN AND MINIMIZE DUST. COORDINATE RUN-OFF CONTROL WITH GENERAL CONTRACTOR.  
TEST EXISTING SOIL TO ENSURE IT IS FREE OF EXCESSIVE CLAY OR SALT AND ANY CHEMICALS/PETROCHEMICALS WHICH MAY HARM PLANT HEALTH.

EXISTING MATERIAL:  
IF INCORPORATING EXISTING SITE SOIL REMOVE ALL ROOTS, AND ROCK LARGER THAN 2" IN SIZE. REMOVE ALL PLASTIC, METAL AND MANMADE DETRITUS.

MIX:  
50% EXISTING SOIL  
10% COCO PEAT  
10% COMPOST  
20% CLEAN SAND  
10% PERLITE

BLEND QUANTITIES NEEDED BY HAND OR MACHINE.

INSTALLATION:  
REFER TO APPROPRIATE DETAILS FOR AMENDMENTS, COMPACTION DEPTHS ETC.

GENERAL: REFER TO LANDSCAPE NOTES FOR ADDITIONAL INFORMATION

#### 10 PLANTING SOIL- TYPICAL

MULCH A:  
PINE STRAW, FOR USE IN GENERAL PLANTING AREAS AND ON SLOPES GREATER THAN 10%

MULCH B:  
OPTION, MELALEUCA MULCH, FOR USE IN GENERAL PLANTING AREAS AND ON SLOPES GREATER THAN 10%

MULCH C:  
IF SPECIFIED, MINI PINE BARK NUGGETS, FOR USE IN SPECIALTY AREAS

INSTALLATION:  
REFER TO APPROPRIATE DETAILS FOR EXTENTS AND DEPTHS.

GENERAL: REFER TO LANDSCAPE NOTES FOR ADDITIONAL INFORMATION, CONFIRM TYPE TO BE USED WITH LANDSCAPE ARCHITECT PRIOR TO INSTALLATION.

#### 11 MULCH- TYPICAL

MIX:  
# 5050- MUCK AND FINE SAND  
SUPPLIER: ATLAS PEAT AND SOIL 561.734.7300

#### 12 PLANTING SOIL- LAWN TOP DRESSING

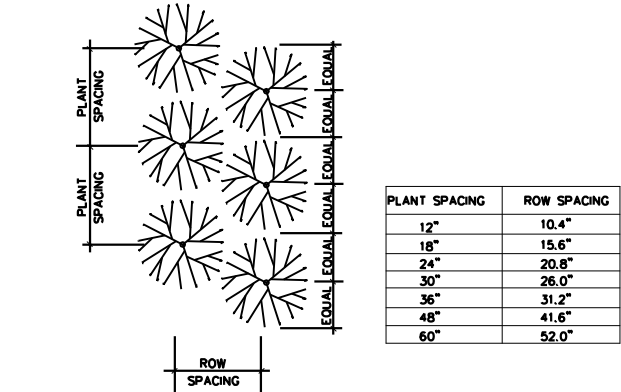

#### 6 PLANT SPACING

SCALE: NOT TO SCALE

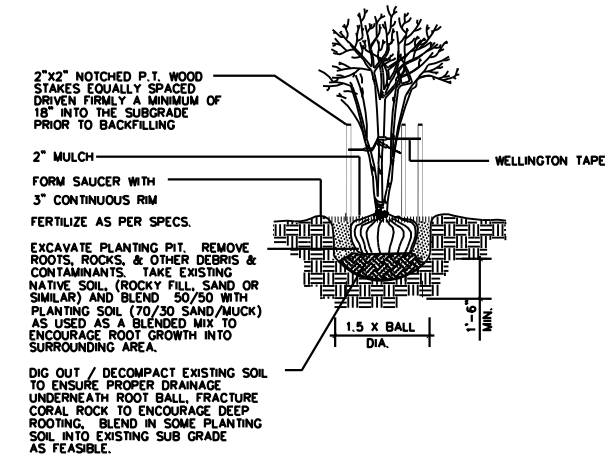

#### 7 MULTI TRUNK TREE- PLANTING & STAKING

SCALE: NOT TO SCALE

CALIPER	TIES	STRANDS	STAKES
1" - 1 1/2"	2	1 # 12	2 - 2 x 2
1 1/2" - 2"	3	1 # 12	3 - 2 x 2
2" - 3"	3	2 # 12	2 - 2 x 2

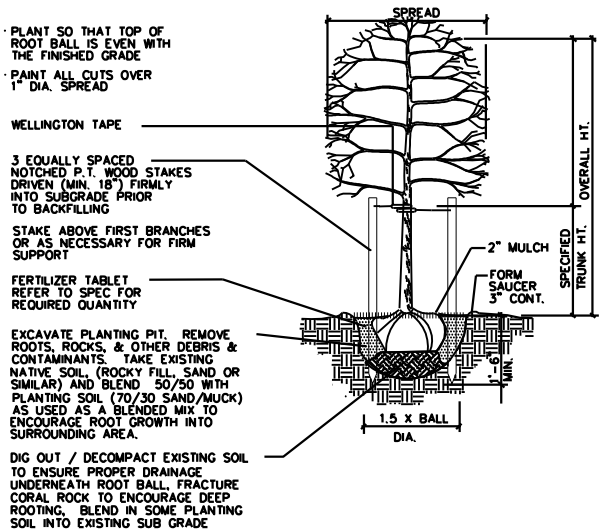

NOTE:  
USE FOR 3" OR LESS SINGLE STEM TREES & PALMS

#### 8 CANOPY AND PALM TREE- PLANTING & VERTICAL STAKING

SCALE: NOT TO SCALE

NOTE:  
IN MOST CASES TRIANGULAR SPACING IS PREFERRED. USE SQUARE SPACING ONLY IN SMALL RECTILINEAR AREAS.

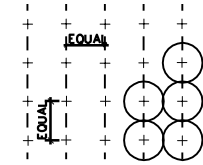

TYPICAL PLANT SPACING

SQUARE SPACING PLAN

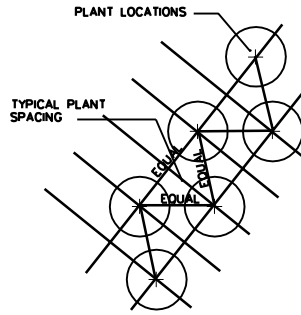

TRIANGULAR SPACING PLAN

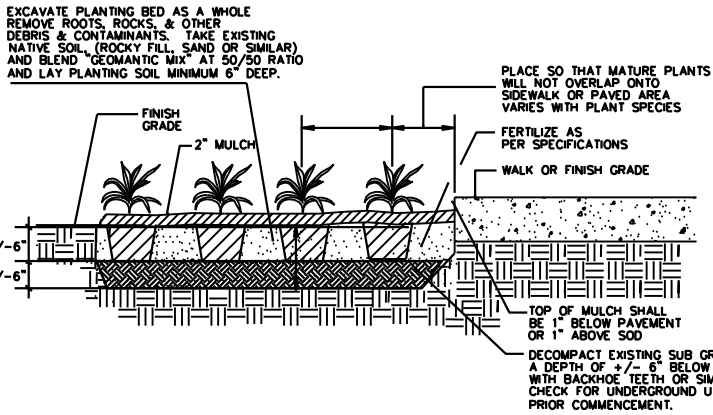

#### 4 SHRUB- HEDGE AND MASS PLANTING

SCALE: NOT TO SCALE

CALIPER	CLEATS	STRAPS	BRACES	NAILS
3" - 8"	2 x 4 x 8"	1 # 12	3 - 2 x 4	2 - 16d
8" - 10"	2 x 4 x 12"	1 # 12	3 - 2 x 4	3 - 16d
10" - 16"	2 x 4 x 12"	2 # 12	4 - 2 x 4	3 - 16d

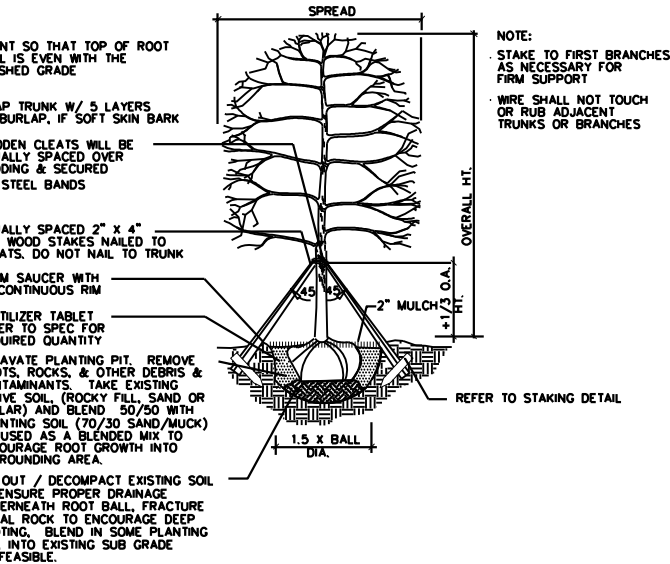

NOTE:  
USE FOR 3" TO 12" SINGLE TRUNK TREES

#### 5 CANOPY TREE- PLANTING & TRIPLE BRACE STAKING

SCALE: NOT TO SCALE

FERTILIZE PER SPECIFICATIONS

FORM SAUCER WITH 3" CONTINUOUS RIM IF APPLICABLE

EXCAVATE PLANTING PIT. REMOVE ROOTS, ROCKS, & OTHER DEBRIS & CONTAMINANTS. TAKE EXISTING NATIVE SOIL (ROCKY FILL, SAND OR SIMILAR) AND BLEND 50/50 WITH SPECIFIED PLANTING SOIL

DIG OUT / DECOMPACT EXISTING SOIL TO ENSURE PROPER DRAINAGE UNDERNEATH ROOT BALL. FRACTURE CORAL ROCK TO ENCOURAGE DEEP ROOTING. BLEND IN SOME PLANTING SOIL INTO EXISTING SUB GRADE AS FEASIBLE.

#### 1 SHRUB PLANTING

SCALE: NOT TO SCALE

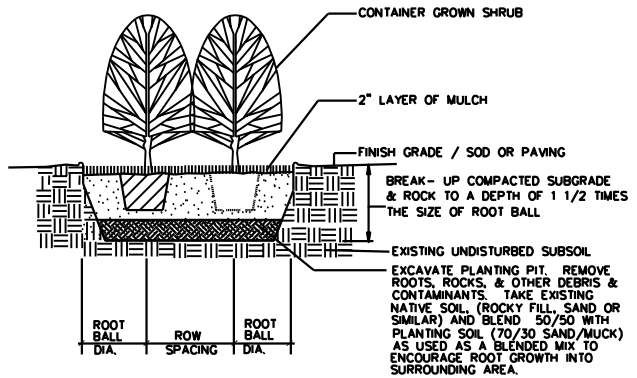

#### 2 SHRUB- HEDGE AND MASS PLANTING

SCALE: NOT TO SCALE

NOTE:  
GUYING WIRES OR RUBBER TUBING CAN BE SUBSTITUTED FOR WELLINGTON TAPE FOR BRACING TREES WITH PRIOR APPROVAL BY LANDSCAPE ARCHITECT

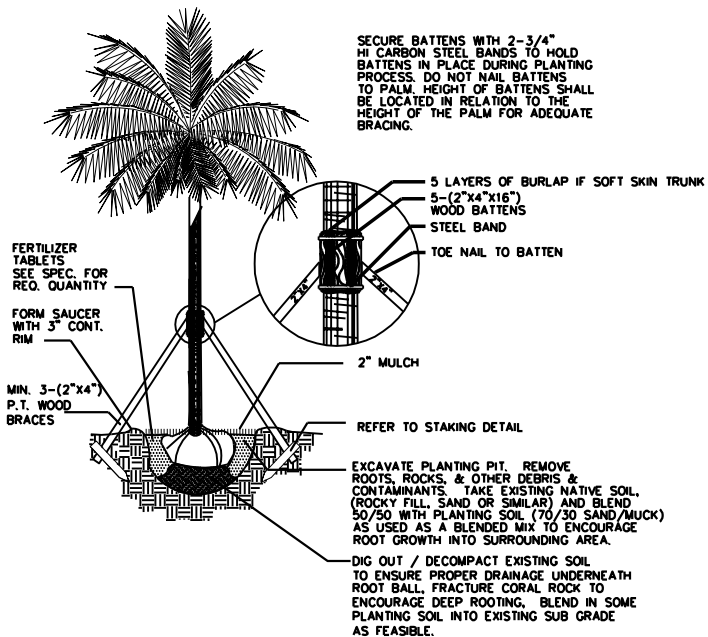

#### 3 PALM- PLANTING & STAKING

SCALE: NOT TO SCALE







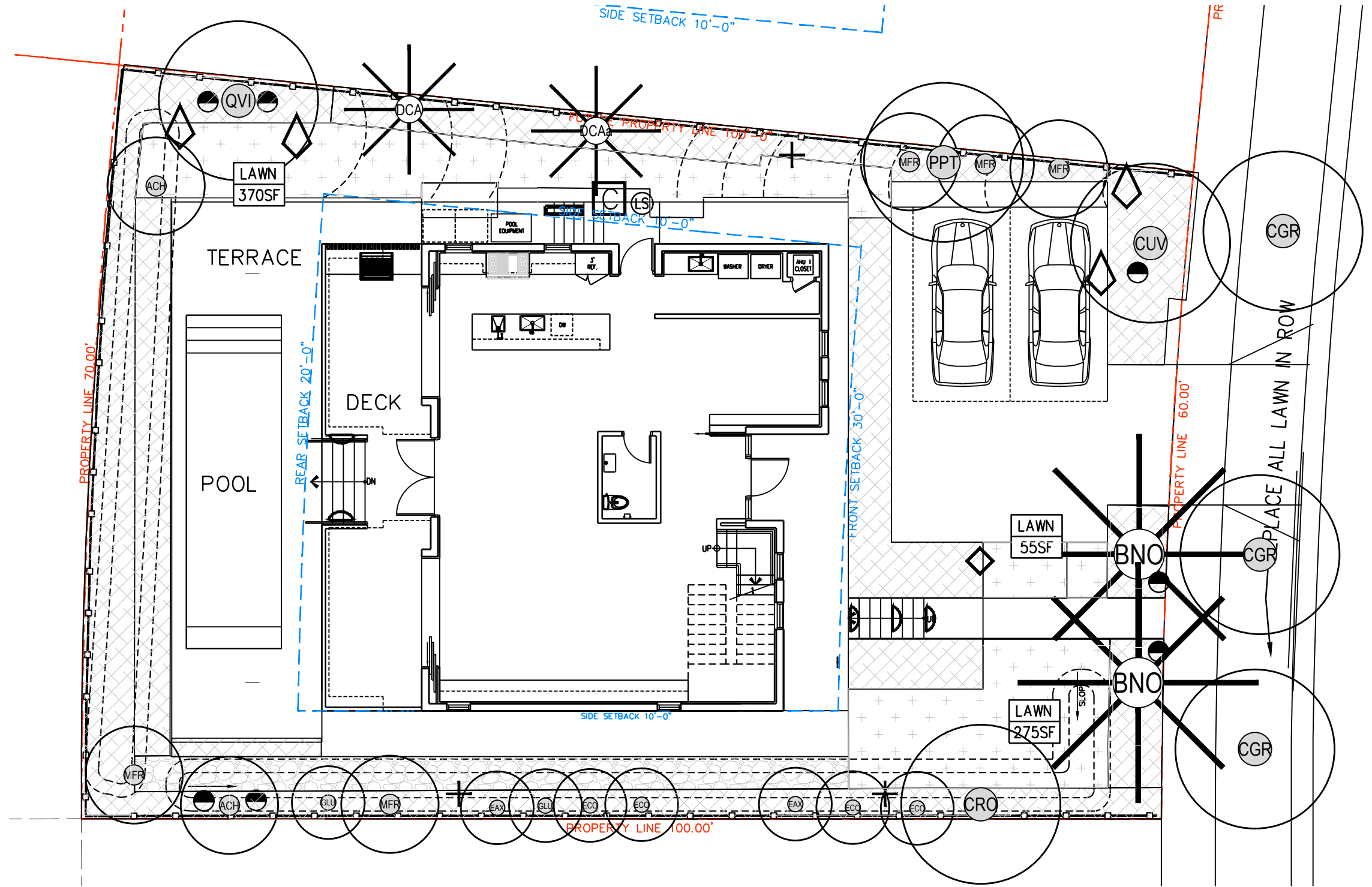

LIGHTING LEGEND

- LIGHTING CONTROLLER AND LIGHT SENSOR
- TRANSFORMER
- LIGHT TYPE 1
- MOONLIGHT
- PATH LIGHT
- BOLLARD
- STEP LIGHT