

NORTH
SCALE: 1"=10' (SHEET SIZE 24"x36")
SCALE: 1"=20' (SHEET SIZE 11"x17")

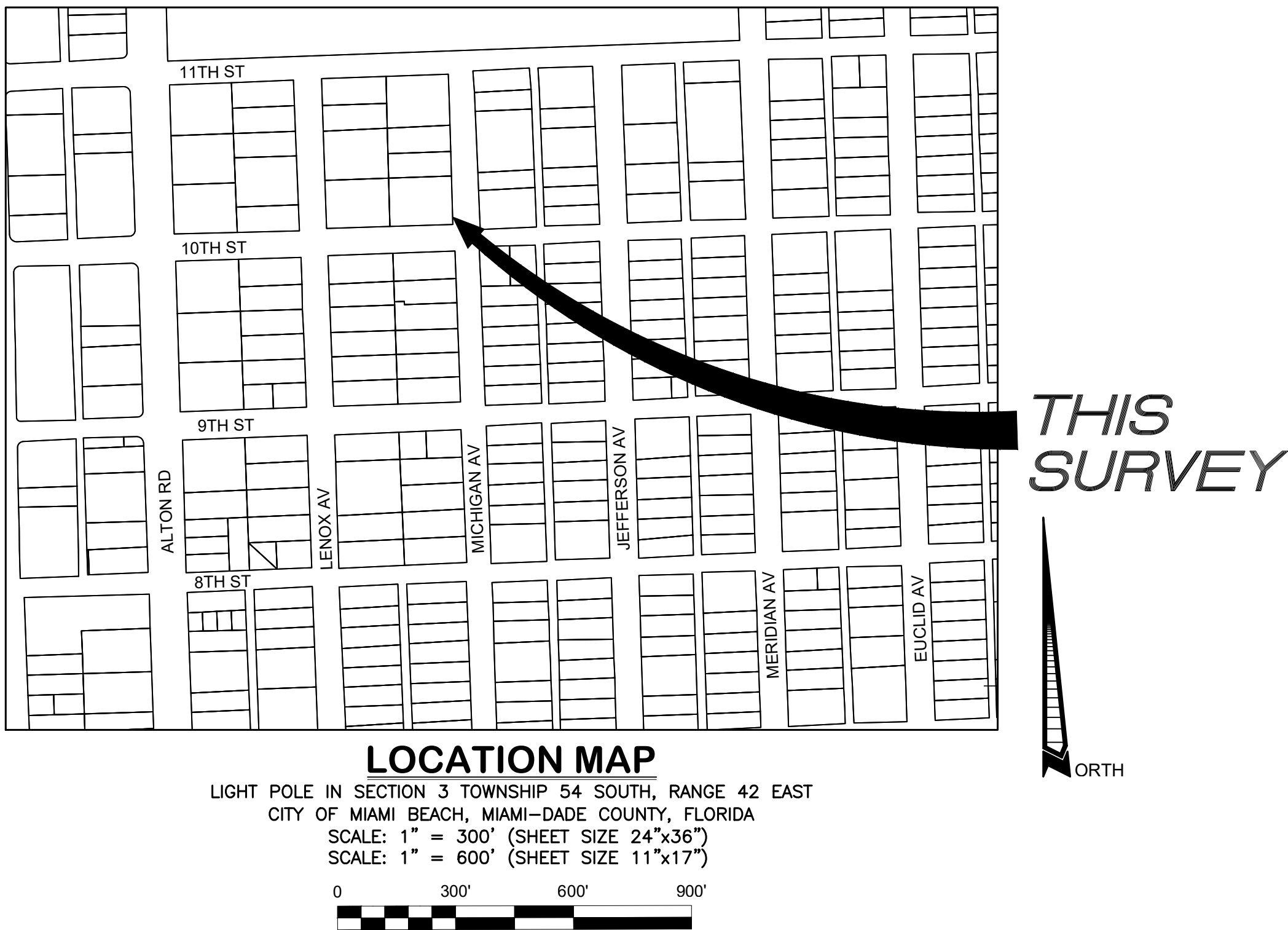

- NOTES:**
- This is a Specific Purpose Radial Survey for the stated purpose of locating improvements within a 50' wide radius of the existing light pole to be used for proposed telecommunications equipment. Client provided the location of the subject light pole.
 - BEARINGS shown hereon are based upon the centerline of 10th Street with an assumed bearing of N88°08'28"E.
 - Right-of-way widths determined from: Plat Book 2 Page 81 and Plat Book 7 Page 15.
 - Geodetic and Florida State Plane coordinates shown hereon are based on G.P.S. observation using the Florida Permanent Reference Network (FRPN) base station "FLMB". Accuracy within tolerances as set forth by the F.A.A. Referenced to North American Datum 1983, 1990 Adjustment.
 - 2016 Aerial Photograph shown hereon obtained from Florida Department of Transportation.
 - All dimensions are shown in feet and decimal feet.
 - No attempt was made by this firm to determine the nature, size, and location of underground utilities. Underground paint mark locations were located at the time of this survey and plotted hereon. Contractor should notify "Sunshine No-Cuts" prior to ANY excavation work. This is not a comprehensive Utility Survey.
 - All documents are recorded in the Public Records of Miami-Dade County, Florida, unless otherwise noted.
 - The lands shown hereon have not been abstracted by this firm regarding matters of interest to other parties, such as easements, rights-of-ways, reservations, etc. A Title Commitment review has not been performed.
 - Roof overhangs, if any, not shown unless otherwise noted.
 - The subject light pole lies in Section 3-54S-42E in the City of Miami Beach, Miami-Dade County, Florida.
 - Right-Of-Way lines do not represent an opinion of ownership by this Firm.
 - Fence and wall ownership is not determined. This survey does not reflect or determine ownership.
 - In some instances graphic representation have been exaggerated to more clearly illustrate the relationship between physical improvements and/or lot lines. Dimensions shall control the location of the improvements over scaled positions.
 - THIS IS NOT A BOUNDARY SURVEY.

- LEGEND:**
- CONCRETE
 - CB - CATCH BASIN
 - CBS - CONCRETE BLOCK & STUCCO
 - D - DIAMETER
 - DCR - MIAMI-DADE COUNTY RECORDS
 - DMH - DRAINAGE MANHOLE
 - F.A.A. - FEDERAL AVIATION ADMINISTRATION
 - FEMA - FEDERAL EMERGENCY MANAGEMENT AGENCY
 - FH - FIRE HYDRANT
 - G.P.S. - GLOBAL POSITIONING SYSTEM
 - H - HEIGHT
 - HCR - HANDICAP RAMP
 - ID - IDENTIFICATION
 - IP - IRON PIPE
 - MLP - METAL LIGHT POLE
 - NO - NUMBER
 - NPB - NEWSPAPER BOX
 - ORB - OFFICIAL RECORDS BOOK
 - PB - PLAT BOOK
 - PKD - PARKER-KALON NAIL & DISC
 - PL - PLANTER
 - S - SPREAD
 - WV - WATER VALVE

FEMA FLOOD ZONE

Community No.: 120651
Community Name: CITY OF MIAMI BEACH
Panel No.: 0319 Suffix: L
Map Number: 12086C0319L
Flood Zone: AE
Base Flood Elevation: 8.0' NGVD 1929
Date of Map Panel: 9/11/2009
Date of Firm Index: 9/11/2009



CROWN CASTLE SFL10265

NEAR ADDRESS: 950 10th STREET, MIAMI BEACH, FLORIDA 33139

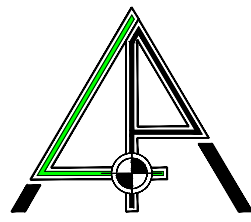

E-Mail: office@lettierperez.com

TYPE OF SURVEY: SPECIFIC PURPOSE RADIAL SURVEY
PREPARED FOR: MORRISON HERSHFIELD CORP.

LEITER PEREZ & ASSOCIATES, INC.
LAND DEVELOPMENT CONSULTANTS
CIVIL ENGINEERS - LAND SURVEYORS
LAND PLANNERS - ENVIRONMENTAL
520 N.W. 16TH STREET ROAD, SUITE 208 MIAMI, FLORIDA 33139
MIAMI-DADE (305) 652-5133 BROWARD (954) 524-2202 FAX: (305) 652-0411
WEBSITE: www.lettierperez.com LICENSED BUSINESS NO. 6767

REVISIONS:

DATE	JOB ORDER	DESCRIPTION	F.B.	P.G.
11-28-18	18-217	POLE RELOCATION	354	66

NOTES

- ELEVATIONS WHEN SHOWN REFER TO THE NATIONAL GEODETIC VERTICAL DATUM (NGVD) 1929.
- THIS FIRM HAS MADE NO ATTEMPT TO LOCATE FOOTINGS AND/OR FOUNDATIONS (UNLESS OTHERWISE NOTED).
- THE LANDS SHOWN HEREON HAVE NOT BEEN ABSTRACTED BY THIS FIRM REGARDING MATTERS OF INTEREST. OTHER PARTIES, SUCH AS EASEMENTS, RIGHTS-OF-WAY, ETC.
- THIS SURVEY WAS PREPARED FOR AND CERTIFIED TO THE PARTY (AND/OR PARTIES) INDICATED HEREON AND IS NOT TRANSFERABLE OR ASSIGNABLE.
- ALL IRON PIPES & NAILS AND DISCS SET BY THIS FIRM, SET WITH CAP OR DISC WITH LB# 6767.

SURVEYOR'S CERTIFICATE:

WE HEREBY CERTIFY THAT THIS SURVEY IS TRUE AND CORRECT TO THE BEST OF OUR KNOWLEDGE AND BELIEF AS RECENTLY SURVEYED AND DRAWN UNDER OUR DIRECTION AND THAT THIS SURVEY MEETS THE STANDARDS OF PRACTICE AS SET FORTH BY THE FLORIDA STATE BOARD OF PROFESSIONAL SURVEYORS AND MAPPERS IN CHAPTER 461, FLORIDA ADMINISTRATIVE CODE, PURSUANT TO SECTION 470.022, FLORIDA STATUTES.

LEITER PEREZ & ASSOCIATES, INC.
BY: GEOFFREY LEITER, PRESIDENT
PROFESSIONAL SURVEYOR & MAPPER #6396
STATE OF FLORIDA

