



Designer/
Landscape Architect

PROJECT:
**4354 ALTON
ROAD
RESIDENCES**

4354 ALTON RD.
MIAMI BEACH,
FLORIDA, 33139

DRAWING:

PROJECT COVER

SCOPE OF WORK

THE FOLLOWING DRAWINGS ILLUSTRATE THE PROPOSED LANDSCAPE SCOPE OF WORK FOR A NEW RESIDENTIAL PROJECT ON PROPERTY LOCATED IN THE NAUTILUS NEIGHBORHOOD OF THE CITY OF MIAMI BEACH.

- RESIDENTIAL TREE REMOVAL AND ON SITE MITIGATION.
- RESIDENTIAL LANDSCAPE PLANTING
- RESIDENTIAL LANDSCAPE IRRIGATION
- RESIDENTIAL LANDSCAPE SITE LIGHTING

09/07/18 DRB SUBMISSION
08/16/18 DRB PRELIMINARY

SHEET INDEX

LANDSCAPE DRAWINGS		DRAWING NOTES
■ ■	LCVR	COVER PAGE
■ ■	TD100	TREE DISPOSITION NOTES/SCHEDULE
■ ■	TD101	TREE DISPOSITION PLAN
■ ■	L200	MATERIALS NOTES AND SPECIFICATIONS
■ ■	L201	MATERIALS PLAN
■ ■	L400	PLANTING NOTES AND SCHEDULE
■ ■	L401	PLANTING PLAN
■ ■	L400.1	LANDSCAPE LEGEND
■ ■	L450	PLANTING DETAILS
■ ■	L800	SITE LIGHTING NOTE AND SPECIFICATIONS
■ ■	L801	SITE LIGHTING PLAN
■ ■	IR100	IRRIGATION DETAILS
■ ■	IR101	IRRIGATION DETAILS
■ ■	IR200	IRRIGATION NOTES AND PLAN

NORTH RESIDENCE

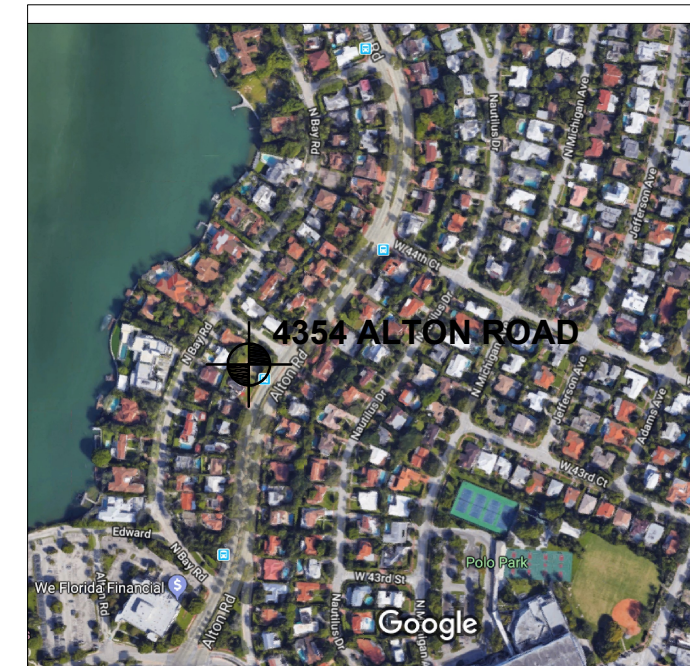

NORTH

MARSH C. KRIPLEN FLORIDA LIC# LA6667007

ALL DRAWINGS AND WRITTEN MATERIAL APPEARING HEREIN CONSTITUTE THE ORIGINAL AND UNPUBLISHED WORK OF MCG ARCHITECTURE AND MAY NOT BE DUPLICATED, USED OR DISCLOSED WITHOUT THE EXPRESS WRITTEN CONSENT OF MCG ARCHITECTURE & PLANNING, INC. (c) 2018

SCALE:

CHECK: MCK

DATE: 07/09/2018

SHEET NUMBER

LCVR

TREE DISPOSITION AND MITIGATION SCHEDULE



Designer/
Landscape Architect

PROJECT:
4354 ALTON ROAD RESIDENCES

4354 ALTON RD.
MIAMI BEACH,
FLORIDA, 33139

DRAWING:

TREE DISPOSITION
NOTES, SCHEDULE
AND
TREE PROTECTION
DETAIL

TREE No.	TREE - LATIN NAME	TREE - COMMON NAME	DIAMETER at BREST HEIGHT (in inches)	MULTI TRUNK	OVERALL HEIGHT (in feet)	CANOPY DIAMETER (in feet)	CANOPY (in Sq. Ft.)	DISPOSITION	CONDITION	REMOVAL-MUNICIPAL CRITERIA AND NOTES		
										CRITERIA	CANOPY SQ. FT.	ROW CANOPY SQ. FT.
7	COCUS NUCIFERA	COCONUT PALM	14		28	17	227	REMAIN	FAIR			
8	WASHINGTONIA ROBUSTA	MEXICAN FAN PALM	20		32	16	201	REMOVE	FAIR	EXEMPT FROM MITIGATION		
9	COCUS NUCIFERA	COCONUT PALM	14		27	16	201	REMAIN	FAIR			
10	COCUS NUCIFERA	COCONUT PALM	14		27	16	201	REMAIN	FAIR			
11	FICUS RELIGIOSA	BODHI TREE	46		35	40	1257	REMAIN	FAIR			
12	ADONIDIA MERRILLII	CHRISTMAS PALM	8		12	10	79	REMOVE	FAIR	CONFLICTS WITH NEW CONSTRUCTION	79	
13	ADONIDIA MERRILLII	CHRISTMAS PALM	8	X	14	12	113	REMOVE	FAIR	CONFLICTS WITH NEW CONSTRUCTION	113	
14	LAGERSTROEMIA INDICA	CRAPE MYRTLE	10		18	18	254	REMOVE	FAIR	CONFLICTS WITH NEW CONSTRUCTION	254	

STREET TREES

1	PHOENIX DACTYLIFERA	DATE PALM	24		14	14	154	REMAIN	FAIR			
2	PHOENIX DACTYLIFERA	20	24		14	14	154	TRANSPLANT	FAIR	CONFLICTS WITH PROPOSED DRIVE		
3	PHOENIX DACTYLIFERA	DATE PALM	24		14	14	154	REMAIN	FAIR			
4	SWIETENIA MAHAGONI	MAHOGANY	24		35	38	1134	REMAIN	FAIR			

UNITS REMOVED FROM ROW	-		
UNITS REMOVED	446		
TOTAL UNITS REMOVED:	446		
PROPOSED ON SITE MITIGATION BREAKDOWN		credit/tree	TREE CREDIT
CATEGORY 1 TREE 2" CAL/12' HT MIN:	3	300	Category 1 Tree = 300sf credit/tree 900
CATEGORY 2 TREE 2" CAL/10' HT MIN:	1	150	Category 2 Tree = 150sf credit/tree 150
CATEGORY 3 TREE 2" CAL/8' HT MIN:	-	100	Category 3 Tree = 100sf credit/tree -
CATEGORY 4 PALM 6' CLR TRUNK MIN:	-	50	Category 4 Palm = 50sf credit/tree -
TOTAL PROPOSED REPLACEMENT TREES (REFER TO PLANTING PLANS):	4	COMBINATION FULFILLS SITE MITIGATION OF CANOPY SF:	1,050

TRANSPLANTING SPECIFICATIONS

1. Root prune all trees and palms to a minimum depth of 24" for the palms and 48" for the trees.
2. Trim frayed roots with clippers saws or similar and leave clean cuts.
3. Wrap balls with shrink wrap plastic, back filling with Shredded peat moss, fill up voids between plastic & ball, covering all cut roots.
4. Backfill with existing soil to hold plastic firmly against newly wrapped ball. Keep 2" deep trench exposed so as to find root ball when harvesting.
5. Water three times per week for next 2 months or until trees are ready to move.
6. Harvest palms after 5 weeks minimum and trees after 8 to 10 weeks depending on size. Consult with LA prior to moving on schedule.
7. Re-dig holes well outside the pastic plant wrap being careful not to disturb or tear, preserving root ball, re-wrap if needed for transplanting.
8. When digging trees, break off large piece of existing coral rock, +/- 36" deep as feasible, by under cutting ball. Do Not Peel Ball off Rock.. If necessary, the horizontal chipping or drilling may be required to break off specimen Oak ball at a minimum 30" depth
9. Replant transplanted trees and palms at correct height in new location, keeping original ball top exposed.
10. Properly wrap and hook-up trees and palms to lifting equipment in such a way as to not tear cambium layer and exessivly disfigure appearance.
11. Plants that are not properly lifted and die due to girdling, compression or excessive damage to the cambium layer will be charged to the G.C. and Sub-contractor at a rate of \$500 per caliper inch.
12. Remove plastic, backfill with 50% existing soil blended with 50% planting soil plus 1/4 bale of Canadian peat moss for palms and 1/2 bale for trees.
13. Backfill, sink, place in Agriform fertilizer tablets per recommendations, brace, and trim broken branches and fronds as needed. Brace per specification.
14. Water daily for duration of overall job will be required. Having bubblers as part of automatic irrigation system for post construction can supplement additional drenching, but are not a sustitution.

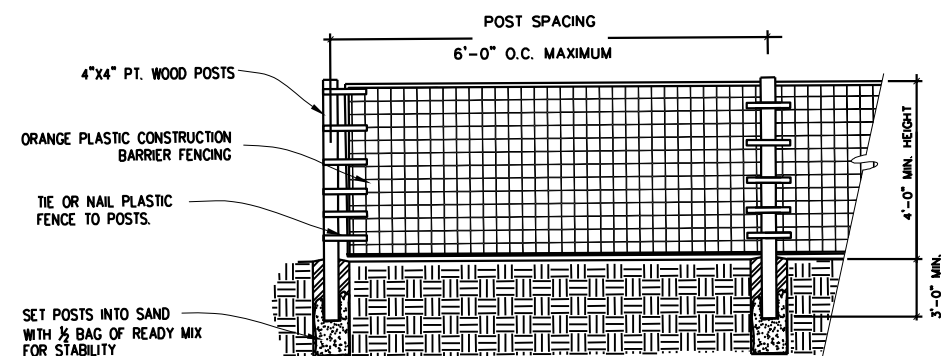
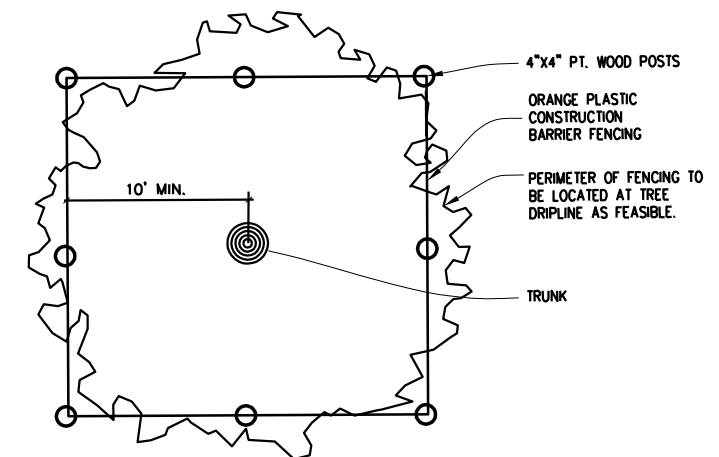

MARSH C. KRIELEN FLORIDA LIC# LA6667007
ALL DRAWINGS AND WRITTEN MATERIAL APPEARING HEREIN CONSTITUTE THE ORIGINAL AND UNPUBLISHED WORK OF MCG ARCHITECTURE AND MAY NOT BE DUPLICATED, USED OR DISCLOSED WITHOUT THE EXPRESS WRITTEN CONSENT OF MCG ARCHITECTURE & PLANNING, INC. (c) 2018
SCALE:
CHECK: JMcG
DATE: 07/09/2018
SHEET NUMBER



1 TREE PROTECTION FENCE DETAIL

SCALE: NTS

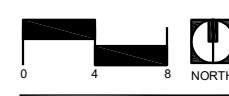

MARSH C. KRIPLEN FLORIDA LIC# LA6667007
ALL DRAWINGS AND WRITTEN MATERIAL APPEARING
HEREIN CONSTITUTE THE ORIGINAL AND UNPUBLISHED
WORK OF MCG ARCHITECTURE AND PLANNING, INC. AND MAY NOT BE
DUPLICATED, USED OR DISCLOSED WITHOUT THE
EXPRESS WRITTEN CONSENT OF MCG ARCHITECTURE &
PLANNING, INC. (c) 2018

SCALE:
CHECK: JMcG
DATE: 07/09/2018
SHEET NUMBER

LEGEND

- EXISTING TREES & PALMS
- EXISTING TREES & PALMS TO BE REMOVED
- EXISTING TREES & PALMS TO BE RELOCATED
- PROPOSED BUILDING/HARDSCAPE
- CONSTRUCTION PARKING
- PROTECTION FENCE

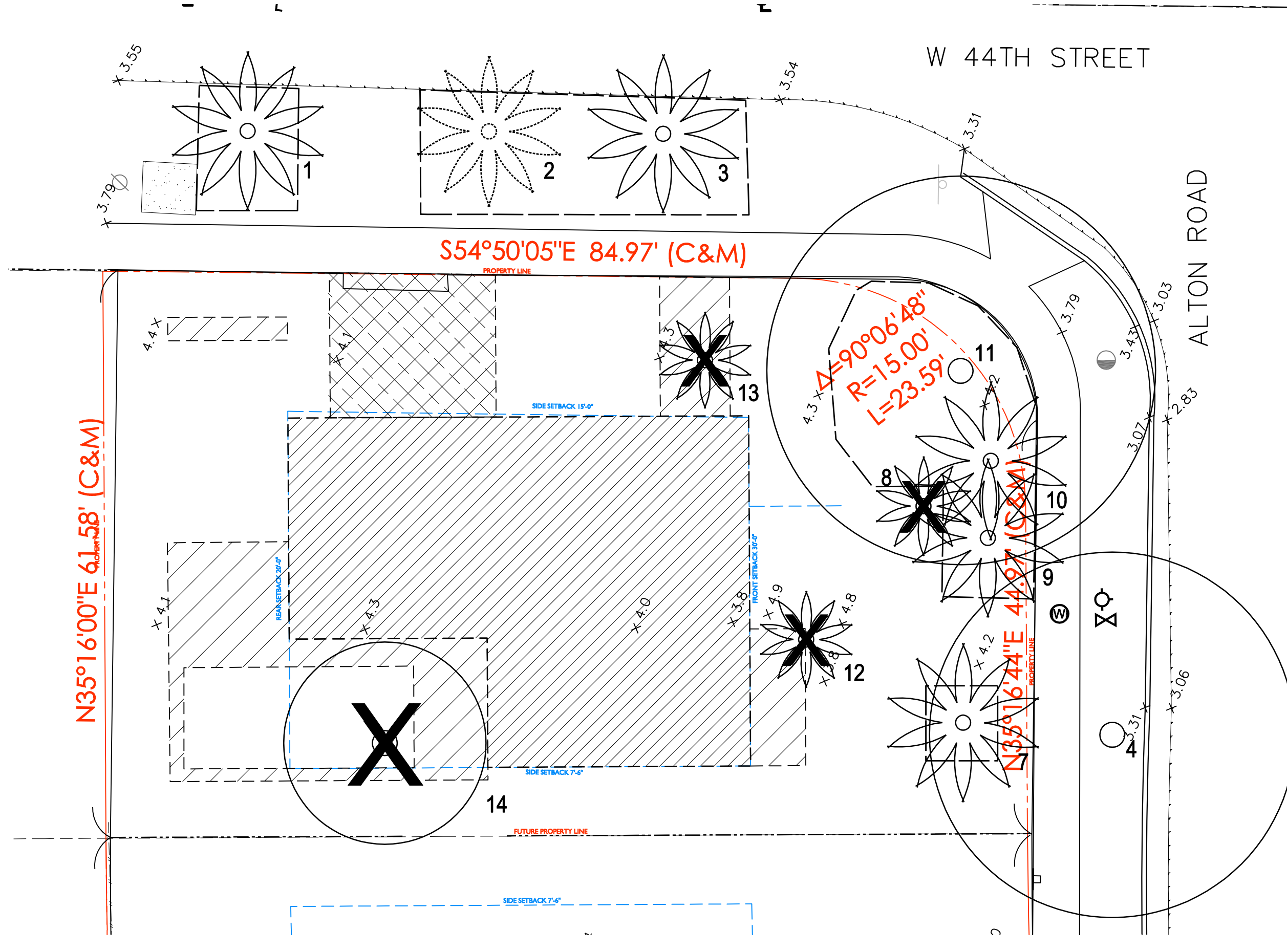

MATERIALS NOTES

1. CONTRACTOR TO VERIFY ALL QUANTITIES. IN CASE OF ANY DISCREPANCIES, GRAPHICALLY SHOWN MATERIAL QUANTITIES SHALL TAKE PRECEDENCE.
2. ALL CONSTRUCTION AND MATERIALS NOT SPECIFICALLY ADDRESSED IN THE CONTRACT DOCUMENTS OR SPECIFICATIONS SHALL BE IN ACCORDANCE WITH LOCAL, STATE AND FEDERAL JURISDICTIONS AND GOVERNING BODIES/AGENCIES STANDARDS.
3. THE CONTRACTOR SHALL PROVIDE A FULL-SCALE MOCKUP AND RECEIVE APPROVAL FROM THE LANDSCAPE ARCHITECT FOR ALL SYSTEMS BEFORE BEGINNING CONSTRUCTION OF PAVEMENT.
4. EXPANSION JOINTS SHALL BE PROVIDED WHERE FLATWORK MEETS VERTICAL STRUCTURES, SUCH AS WALLS, CURBS, STEPS, AND OTHER HARDSCAPE ELEMENTS. EXPANSION JOINTS SHALL ALSO BE PROVIDED AT MATERIAL CHANGES. EXPANSION JOINT MATERIALS/METHODS SHALL BE SUBMITTED TO THE LANDSCAPE ARCHITECT FOR REVIEW AND APPROVAL PRIOR TO INSTALLATION.
5. CONTROL JOINTS SHOULD BE SPACED NO GREATER THAN TEN (10) LINEAR FEET MAXIMUM, UNLESS OTHERWISE SPECIFIED. EXPANSION JOINTS SHOULD BE SPACED NO GREATER THAN FORTY (40) LINEAR FEET MAXIMUM, UNLESS OTHERWISE SPECIFIED. CONTRACTOR SHALL ADVISE ON OTHER JOINTS AS NEEDED TO MINIMIZE CRACKING. THIS INFORMATION SHALL BE SUBMITTED TO THE LANDSCAPE ARCHITECT FOR REVIEW AND APPROVAL PRIOR TO INSTALLATION.
6. CONTROL JOINTS SHALL BE PROVIDED AS SPECIFIED IN THE CONTRACT DOCUMENTS. CONTROL JOINT MATERIALS, METHODS AND RECOMMENDATIONS ON ADDITIONAL CONTROL JOINTS TO MINIMIZE CRACKING SHALL BE SUBMITTED TO THE LANDSCAPE ARCHITECT FOR REVIEW AND APPROVAL.
7. ALL STEPS SHALL HAVE TWELVE (12) INCH TREADS AND SIX (6) INCH RISERS, UNLESS OTHERWISE SPECIFIED.
8. HOLD TOP OF WALLS AND FENCES LEVEL, UNLESS OTHERWISE SPECIFIED.
9. CONTRACTOR SHALL NOT INSTALL WORK LOCATED ON TOP OF ARCHITECTURAL STRUCTURES WITHOUT FIRST REVIEWING ARCHITECTURAL DRAWINGS.
10. SAMPLES OF SPECIFIED MATERIALS SHALL BE SUBMITTED TO THE LANDSCAPE ARCHITECT FOR REVIEW AND APPROVAL PRIOR TO ORDERING FOR JOB.



PAVING I: UNIT PAVERS

MATERIAL: HANOVER- PREST PLANKSTONE PAVERS
 COLOR: GRAY/SLATE
 FINISH: STD
 LOCATION: MOTORCOURT



PAVING II: WOOD

MATERIAL: IPE
 COLOR: OILED
 FINISH: FACTORY SANDED
 LOCATION: PORCH, TERRACE AND DECK



PAVING III: CRUSHED GRANITE

MATERIAL: OLIMAR STONE
 COLOR: STANDARD- GRAY
 FINISH: NA
 LOCATION: SERVICE WALKWAY



Designer/
 Landscape Architect

PROJECT:
**4354 ALTON
 ROAD
 RESIDENCES**





4354 ALTON RD.
 MIAMI BEACH,
 FLORIDA, 33139

DRAWING:

MATERIALS NOTES
 AND
 SPECIFICATIONS



MATERIALS LEGEND

-  PROPOSED WOOD PAVING
-  PROPOSED UNIT PAVING
-  PROPOSED CRUSHED STONE/SHELL PAVING
-  PROPOSED PLANTING
-  PROPOSED LAWN

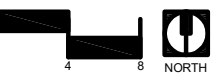
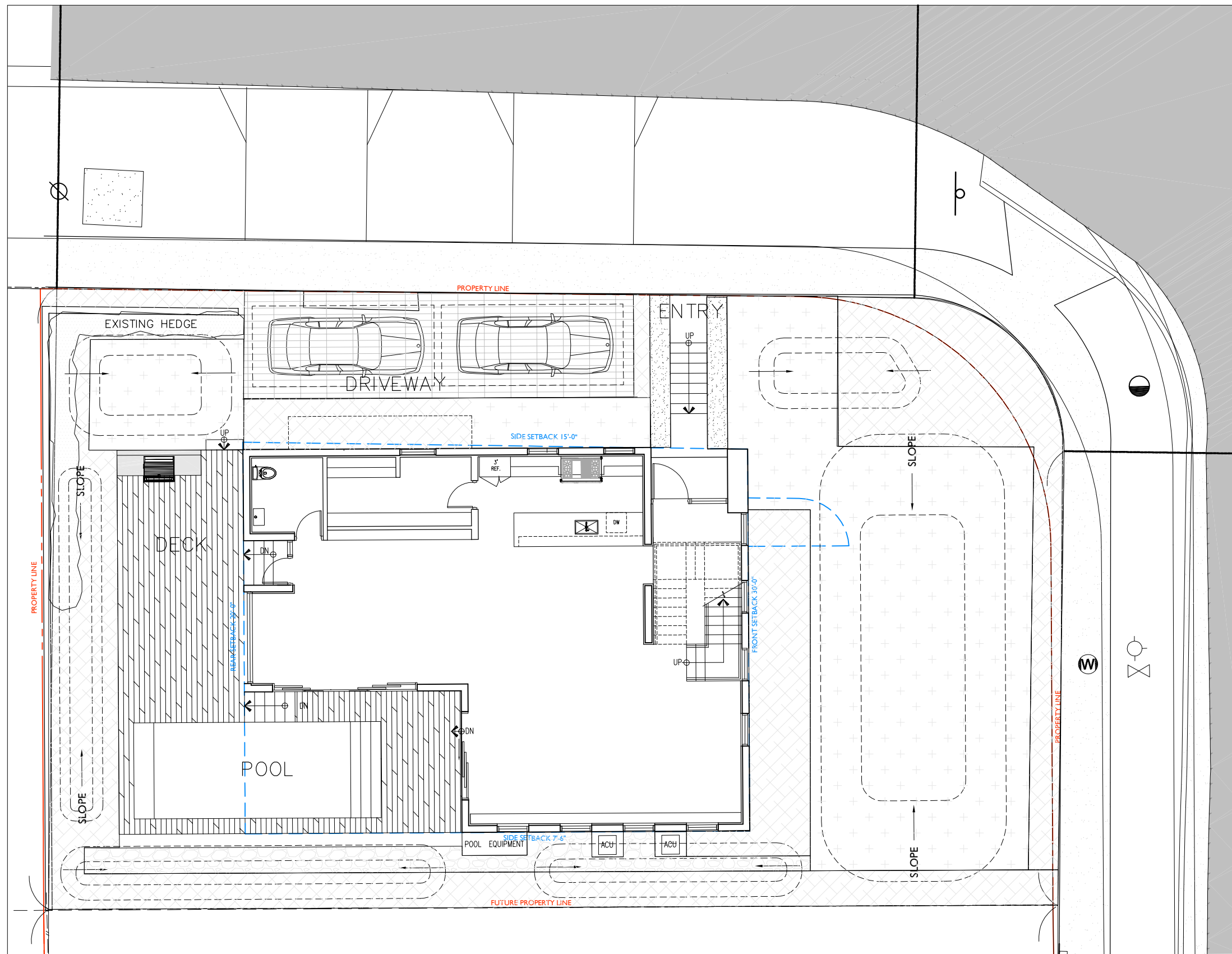

MARSH C. KRIPLIN FLORIDA LIC# LA6667007

ALL DRAWINGS AND WRITTEN MATERIAL APPEARING HEREIN CONSTITUTE THE ORIGINAL AND UNPUBLISHED WORK OF MCG ARCHITECTURE AND PLANNING, INC. AND MAY NOT BE REPRODUCED, COPIED, OR DISCLOSED WITHOUT THE EXPRESS WRITTEN CONSENT OF MCG ARCHITECTURE & PLANNING, INC. (c) 2018

SCALE: _____
CHECK: MCK
DATE: 07/09/2018
SHEET NUMBER

PLANTING NOTES

- PLANT MATERIAL IS TO BE HEALTHY SPECIMENS FREE FROM DISEASE OR DAMAGE, AND IS TO BE MAINTAINED IN EXCELLENT CONDITION WHILE ON THE JOBSITE. LANDSCAPE ARCHITECT SHALL INSPECT PLANT MATERIAL UPON ARRIVAL TO JOBSITE AND WILL REJECT PLANT MATERIAL THAT DOES NOT MEET THE STANDARDS DESCRIBED WITHIN THE CONTRACT DOCUMENTS.
- THE LANDSCAPE ARCHITECT WILL PERIODICALLY INSPECT PLANT MATERIAL STOCKPILED AND/OR PLANTED ON SITE DURING THE COURSE OF CONSTRUCTION. PLANT MATERIAL NOT MEETING THE STANDARDS CONTAINED WITHIN CONTRACT DOCUMENTS SHALL BE REPLACED AT NO COST TO THE OWNER.
- PRESERVE & PROTECT ALL EXISTING VEGETATION INDICATED TO REMAIN AT ALL TIMES.
- PROVIDE MATCHING SIZES AND FORMS FOR EACH PLANT OF THE SAME SPECIES UNLESS OTHERWISE INDICATED.
- CONTRACTOR TO VERIFY ALL QUANTITIES. IN CASE OF DISCREPANCIES, GRAPHICALLY SHOWN QUANTITIES SHALL TAKE PRECEDENCE.
- ALL MATERIALS USED SHALL CONFORM TO THE GUIDELINES ESTABLISHED BY THE CURRENT AMERICAN STANDARDS FOR NURSERY STOCK, PUBLISHED BY THE AMERICAN ASSOCIATION OF NURSERYMEN.
- ALL PLANT MATERIAL SHALL BE INSTALLED PLUMB AND PER THE SPECIFICATIONS CONTAINED WITHIN THE CONTRACT DOCUMENTS. ANY NECESSARY STAKING AND/OR OTHER SUPPORTS MATERIALS/METHODS SHALL BE SUBMITTED TO THE LANDSCAPE ARCHITECT FOR REVIEW AND APPROVAL PRIOR TO INSTALLATION.
- THE CONTRACTOR SHALL PRUNE EXISTING AND/OR NEW TREES ONLY PER LANDSCAPE ARCHITECT DIRECTION.
- THE CONTRACTOR SHALL STAKE THE LOCATIONS OF ALL TREES AND B&B SHRUBS FOR LANDSCAPE ARCHITECT REVIEW AND APPROVAL, PRIOR TO INSTALLATION.
- ALL ROOT-WRAPPING MATERIALS THAT ARE NOT BIO-DEGRADABLE SHALL BE REMOVED FROM THE ROOT BALL. ROOT BALLS SHALL BE FREE OF WEEDS.
- SPECIFIED PLANT MATERIAL SIZES SHALL BE CONSIDERED MINIMUM SIZES.
- FINISH GRADE OF PLANTING BEDS SHALL BE TWO (2) INCHES BELOW ADJACENT FLATWORK, UNLESS SPECIFIED OTHERWISE.
- MULCH OR PLANTING BED DRESSING SHALL BE PLACED IN ALL PLANTING AREAS AS SPECIFIED. MULCH OR PLANTING BED DRESSING SHALL NOT BE PLACED WITHIN SIX (6) INCHES OF TREE TRUNKS. MULCHING SHOULD BE REPEATED ANNUALLY DURING THE AUTUMN TO A THREE (3) INCH DEPTH.
- ALL PLANT MATERIAL SHOULD RECEIVE AN ORGANIC FERTILIZER IN LIMITED APPLICATION FOLLOWING INSTALLATION. TYPE AND APPLICATION RATE AND METHOD OF APPLICATION TO BE SPECIFIED BY THE CONTRACTOR AND APPROVED BY THE LANDSCAPE ARCHITECT.
- EXCESS FERTILIZER SHALL BE DISPOSED OF PROPERLY OFF-SITE. IT SHALL NOT BE DISPOSED OF IN STORM DRAINS AND/OR DRYWELLS.
- STOCKPILED PLANT MATERIAL TO BE PLACED IN THE SHADE AND PROPERLY HAND-WATERED UNTIL PLANTED.
- MULCH ALL BEDS WITH 2-3" AT TIME OF PLANTING. REFER TO PLANTING DETAILS FOR MULCH SPECIFICATIONS. REPLENTISH MULCH AS REQUIRED OVER THE COURSE OF THE GUARANTEE PERIOD TO ENSURE ADEQUATE COVERAGE.
- SIX (6) INCH PLANT MIX SHALL BE PROVIDED FOR ALL LAWN, TURF, AND NATIVE PLANTING ZONES. 18 INCH PLANT MIX SHALL BE PROVIDED FOR ALL PERENNIAL PLANTING BEDS UNLESS OTHERWISE NOTED.
- LANDSCAPE CONTRACTOR TO PAINT ALL TREE & PALM SUPPORTS WITH BENJAMIN MOORE ARBORCOAT ASHLAND SLATE EXTERIOR WOOD PAINT. ALL BRACING CUTS TO BE NEAT AND CLEAN, NO CHAINSAW CUTS.
- GUARANTEE PERIOD: CONTRACTOR IS RESPONSIBLE FOR SITE MAINTENANCE AND MATERIAL REPLACEMENT FOR ONE YEAR FROM THE DATE OF SUBSTANTIAL COMPLETION. REMOVE AND REPLACE ALL DEAD PLANT MATERIAL OR MATERIAL WHICH IS FAILING AS DETERMINED BY ARBORIST AND LANDSCAPE ARCHITECT. CORRECT DEFICIENCIES WITH MULCH AND IRRIGATION.
- MAINTENANCE PLAN: DURING THE GUARANTEE PERIOD CONTRACTOR SHALL PERFORM THE FOLLOWING TASKS ON A REGULARLY SCHEDULED BASIS. WEEKLY WATERING (JAN-APR) WHEN IRRIGATION SYSTEMS ARE NOT OPERATIONAL. WEEKLY SITE INSPECTION FOR PLANT HEALTH, TREE/PALM GUYING, IRRIGATION OPERATION. QUARTERLY FERTILIZATION (MAR-SEPT) APPROPRIATE FOR MATERIAL (REF IFAS PUBLICATION ENH858) WEEKLY MOWING OF LAWNS AND PLANT BED WEEDING DURING THE GROWING AND SHOULDER SEASONS. MONTHLY VISITS FOR SAME OVER WINTER.

PLANTING SCHEDULE

TYPE	ABR.	QUANTITY	BOTANICAL NAME	COMMON NAME	SPECIFICATIONS
PALMS					
	DCA	2	DYPSIS CABADAE	CABADA PALM	45 GAL
	PSA	1	PSEUDOPHOENIX SARGENTII	BUCANEER PALM	FG 7' CT MIN

TREES					
**	CGR	1	CAESALPINIA GRANADILLO	BRIDAL VEIL- 4' CLR TRUNK	3" CAL. & 14' HT. MIN.
*/***	CRO	1	CLUSIA ROSEA	AUTOGRAPH TREE	2" CAL. & 12' HT. MIN.
*/***	MFR _d	1	MYRCIANTHES FRAGRANS	SIMPSON STOPPER- LOW BRANCHING	2" CAL. & 12' HT. MIN.
*/***	PPT	2	PELTOPHORUM PTERCARPUM	COPPER POD	2" CAL. & 12' HT. MIN.
*/***	TCA	2	TABEBUIA CARAIBA	YELLOW TABEBUIA	4" CAL. & 16' HT. MIN.

UNDERSTORY TREES / LARGE SHRUBS					
	GLU	5	GYMNANTHES LUCIDA	CRABWOOD- MULTI TRUNK	6' HT. & 4' SPREAD MIN.
	MFR	2	MYRCIANTHES FRAGRANS	SIMPSON STOPPER- LOW BRANCHING	6' HT. & 4' SPREAD MIN.

ACCENTS / SHRUBS					
	AAM	1	AGAVE AMERICANA	CENTURY PLANT	7 GAL
	AA	3	AGAVE ATTENUATA	SPINELESS AGAVE	7 GAL
	AM	2	ALOCASIA MACRORRRI	GIANT ELEPHANT EAR	7 GAL
	AP	2	ALPINIA PURPURATA	DWARF RED GINGER	7 GAL
	CCY	4	CAPPARIS CYNOPHALLOPHORA	JAMAICA CAPER	30 GAL- BUSH FORM
	CO	7	COLOCASIA 'BLACK MAGIC'	BLACK TARO	7 GAL
	Cs	3	COLOCASIA SPECIES	TARO	7 GAL
	EFE	1	ENCEPHALARTOS FEROX	ZULULAND CYCAD	15 GAL
	HR	1	HELICONIA ROSTRATA	LOBSTER CLAW	15 GAL
	PO	5	PHILODENDRON 'ROJO CONGO'	PHILODENDRON	3 GAL
	PM	10	PODOCARPUS MACROPHYLLUS	JAPANESE YEW	25 GAL. 6' HT MIN., MATCHED
	ZI	9	ZAMIA INTEGRIFOLIA (FLORIDANA)	COONTIE	7 GALLON

GROUNCOVER					
	EL	45	ERNODEA LITTORALIS	GOLDEN BEACH CREEPER	1 GALLON
	MS	68	MICROSORUM SCOLOPENDRIA	WART FERN	1 GALLON
	PB	130	PHILODENDRON BURLE MARX	PHILODENDRON BURLE MARX	1 GALLON
	TA	145	TRACHELOSPERMUM ASIATICUM	CREEPING JASMINE	1 GALLON

ORNAMENTAL GRASSES					
	SBA	10	SPARTINA BAKERI	SAND CORDGRASS	7 GALLON
	TDA	5	TRIPSACUM DACTYLOIDES	FAKAHATCHEE GRASS	7 GALLON
	UPA	9	UNIOLA PANICULATA	SEA OATS	5 GAL

LAWN					
	LAWN	1,400 SF	STENOTAPHRUM SECUNDATUM	ST. AUGUSTINE GRASS	SOD

TREE AND PALM ALLOCATION LEGEND

- * MITIGATION
- ** STREET TREE
- *** SITE LANDSCAPE

DEFINITIONS

- TREE: ANY SELF SUPPORTING WOODY PLANT OR PALM WHICH USUALLY HAS A MAIN AXIS OR TRUNK. 12' HT, 6' CANOPY DIA. AND 2" CAL. TRUNK MINIMUM AT TIME OF PLANTING.
- STREET TREE: A SPECIES TYPICALLY GROWN IN MIAMI BEACH WHICH NORMALLY MATURES TO A HEIGHT OF AT LEAST 20'. 12' HT., 3" CAL. TRUNK AND 4' CLR TRUNK MINIMUM AT TIME OF PLANTING. MAXIMUM AVERAGE TREE SPACING 20' O.C. (CITY DISCRETION ALLOWED DEPENDING ON SITE CONDITIONS).
- PALMS (STREET TREES): SINGLE TRUNK SPECIES. 15' CLEAR WOOD AND 10" DBH TRUNK MINIMUM AT TIME OF PLANTING. PALMS SHALL NOT COUNT TOWARD THE REQUIRED STREET TREES.
- LARGE SHRUB - SMALL TREE: NORMALLY MATURES AT MINIMUM HEIGHT OF 10'. 6' HT. AND 4' CANOPY DIA. MINIMUM AT TIME OF PLANTING.



MUNICIPALITY: City of Miami Beach

ZONING CLASS: **RS-4**

LOT AREA: 6,030

ACRES: 0.1384

ORDINANCE/CODE SECTION: CITY OF MIAMI BEACH SECTION 126

PROJECT NUMBER
1819



Designer/
Landscape Architect

PROJECT:
4354 ALTON ROAD RESIDENCES

4354 ALTON RD.
MIAMI BEACH,
FLORIDA, 33139

DRAWING:

LANDSCAPE LEGEND

STREET TREES

A.	Street trees (maximum average spacing of 30' o.c.)	<u>8</u>	<u>3</u>
	Linear ft of street frontage: <u>160</u>		
	Multiplier: <u>20</u>		
	Percentage of Palms counted toward Street Trees on 1:1 basis	<u>0</u>	<u>0</u>
	Multiplier: <u>30%</u>		
B.	Street trees directly below power lines	<u>0</u>	<u>0</u>
	Linear ft of street frontage: <u>0</u>		
	Multiplier: <u>30</u>		

SHRUBS

A.	Number of shrubs required	<u>72</u>	<u>72</u>
	Lot and street trees required: <u>6</u>		
	Multiplier: <u>12</u>		
B.	% Native species required	<u>36</u>	<u>36</u>
	Shrubs provided: <u>72</u>		
	Multiplier: <u>50%</u>		

LARGE SHRUBS OR SMALL TREES

A.	Number of large shrubs or small tree required	<u>7</u>	<u>7</u>
	Shrubs required: <u>72</u>		
	Multiplier: <u>10%</u>		
B.	% Native species required	<u>4</u>	<u>4</u>
	Shrubs provided: <u>7</u>		
	Multiplier: <u>50%</u>		

OPEN SPACE

A.	Sq. Ft. of required Open Space	<u>4,221</u>	<u>4,430</u>
	Lot area: <u>6,030</u>		
	Multiplier: <u>70%</u>		
B.	Sq. Ft. of parking lot open space	<u>20</u>	<u>0</u>
	Parking Spaces: <u>2</u>		
	Multiplier: <u>10</u> sf/space		
C.	Total Sq. Ft. of landscaped Open Space required	<u>4,241</u>	<u>4,430</u>

LAWN AREA

A.	Total Sq. Ft. of landscaped Open Space	<u>4,241</u>	<u>4,430</u>
B.	Maximum Lawn Area (sod) permitted-	<u>2,121</u>	<u>1,400</u>
	Open space required: <u>4,241</u>		
	Multiplier: <u>50%</u>		

TREES

A.	Number of trees required per lot, less existing trees	<u>5</u>	<u>5</u>
	Required Trees/Lot: <u>6</u>		
	Net lot acres: <u>0.1384</u>		
	Required Trees: <u>6</u>		
	Existing trees: <u>1</u>		
B.	% Palms allowed	<u>na</u>	<u>na</u>
	Palms allowed 1:1 for mitigation only.		
C.	% Native required	<u>1</u>	<u>1</u>
	Trees provided: <u>3</u>		
	Multiplier: <u>30%</u>		
D.	% Drought tolerant and low maintenance species required	<u>2</u>	<u>1</u>
	Trees provided: <u>3</u>		
	Multiplier: <u>50%</u>		

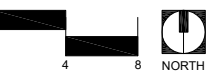

MARSH C. KRIELEN FLORIDA LIC# LA6667007

ALL DRAWINGS AND WRITTEN MATERIAL APPEARING
HEREIN CONSTITUTE THE ORIGINAL AND UNPUBLISHED
WORK OF MCG ARCHITECTURE AND MAY NOT BE
DUPLICATED, USED OR DISCLOSED WITHOUT THE
EXPRESS WRITTEN CONSENT OF MCG ARCHITECTURE &
PLANNING, INC. (c) 2018

SCALE:

CHECK: MCK

DATE: 07/09/2018

SHEET NUMBER

PLANTING LEGEND

- EXISTING TREE
- PROPOSED TREE
- EXISTING
- PROPOSED PALM
- PROPOSED SHRUBS-ACCENTS
- PROPOSED GROUNDCOVER
- PROPOSED LAWN

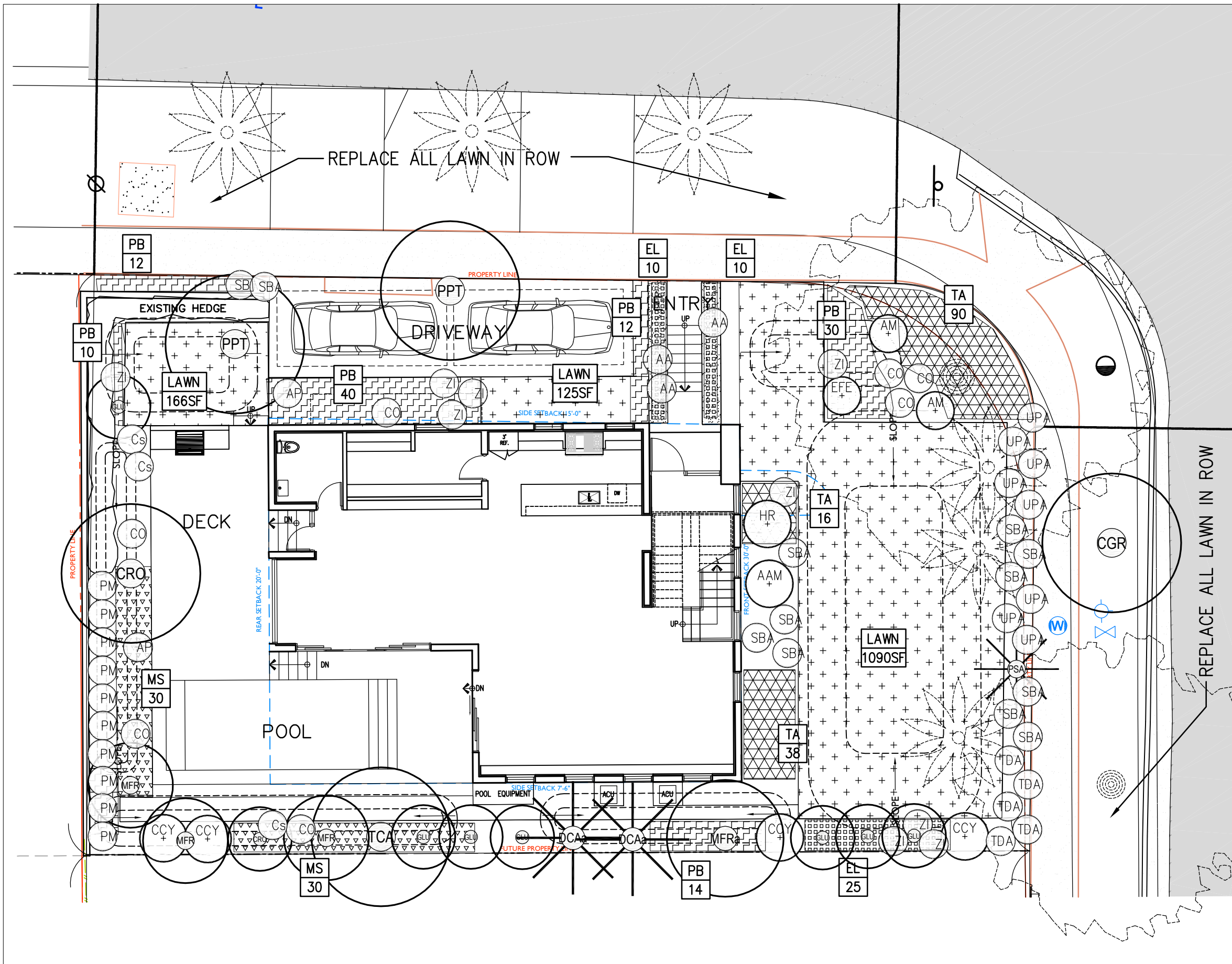



Designer/
Landscape Architect

PROJECT:
**4354 ALTON
ROAD
RESIDENCES**

4354 ALTON RD.
MIAMI BEACH,
FLORIDA, 33139

DRAWING:

PLANTING DETAILS

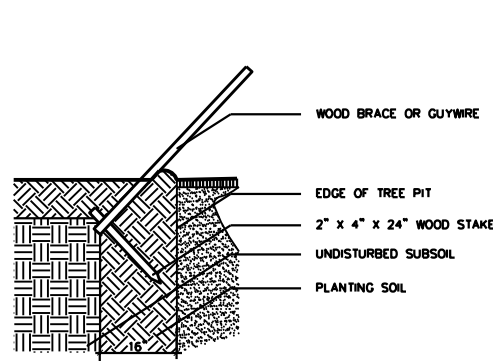

TOP OF STAKE MUST BE MINIMUM OF 3" BELOW FINISHED GRADE

- STAKING NOTES:
1. SAW CUT ALL WOOD STAKING MATERIALS LEAVE ENDS NEAT AND TRIM.
 2. PAINT ALL WOOD STAKING MATERIALS HUNTER GREEN.

9 STAKING DETAIL & NOTES
SCALE: NOT TO SCALE

PREPARATION:
STORE ALL MATERIAL IN DRY, CLEAN AREA, COVER TO PROTECT FROM RAIN AND MINIMIZE DUST. COORDINATE RUN-OFF CONTROL WITH GENERAL CONTRACTOR.
TEST EXISTING SOIL TO ENSURE IT IS FREE OF EXCESSIVE CLAY OR SALT AND ANY CHEMICALS/PETROCHEMICALS WHICH MAY HARM PLANT HEALTH.

EXISTING MATERIAL:
IF INCORPORATING EXISTING SITE SOIL REMOVE ALL ROOTS, AND ROCK LARGER THAN 2" IN SIZE. REMOVE ALL PLASTIC, METAL AND MANMADE DEBRIS.

- Mix:
- 50% EXISTING SOIL
 - 10% COCO PEAT
 - 10% COMPOST
 - 20% CLEAN SAND
 - 10% PERLITE

BLEND QUANTITIES NEEDED BY HAND OR MACHINE.

INSTALLATION:
REFER TO APPROPRIATE DETAILS FOR AMENDMENTS, COMPACTION DEPTHS ETC.

GENERAL: REFER TO LANDSCAPE NOTES FOR ADDITIONAL INFORMATION

10 PLANTING SOIL- TYPICAL

MULCH A:
PINE STRAW, FOR USE IN GENERAL PLANTING AREAS AND ON SLOPES GREATER THAN 10%

MULCH B:
OPTION, MELALEUCA MULCH, FOR USE IN GENERAL PLANTING AREAS AND ON SLOPES GREATER THAN 10%

MULCH C:
IF SPECIFIED, MINI PINE BARK NUGGETS, FOR USE IN SPECIALTY AREAS

INSTALLATION:
REFER TO APPROPRIATE DETAILS FOR EXTENTS AND DEPTHS.

GENERAL: REFER TO LANDSCAPE NOTES FOR ADDITIONAL INFORMATION, CONFIRM TYPE TO BE USED WITH LANDSCAPE ARCHITECT PRIOR TO INSTALLATION.

11 MULCH- TYPICAL

Mix:
5050- MULCH AND FINE SAND
SUPPLIER: ATLAS PEAT AND SOIL 561.734.7300

12 PLANTING SOIL- LAWN TOP DRESSING

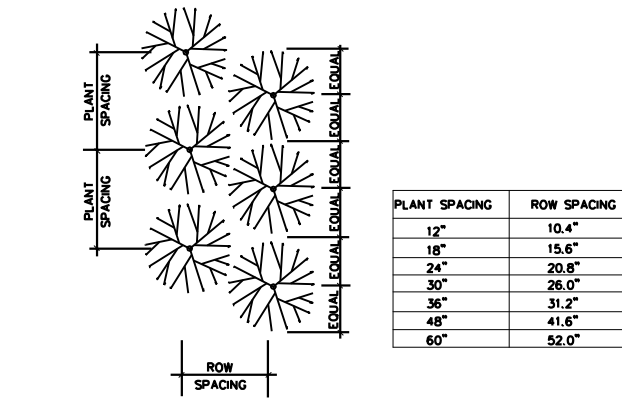

6 PLANT SPACING
SCALE: NOT TO SCALE

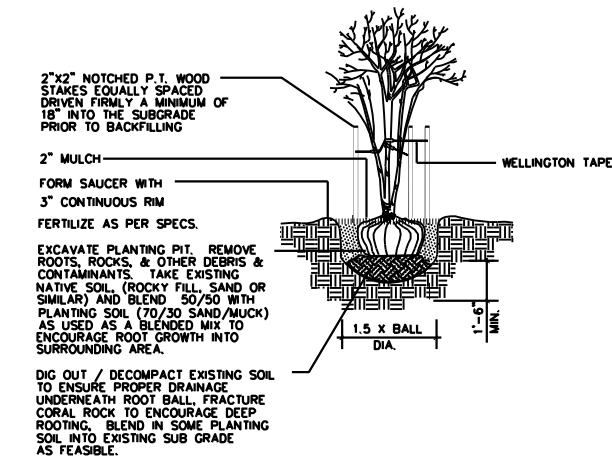

7 MULTI TRUNK TREE- PLANTING & STAKING
SCALE: NOT TO SCALE

CALIPER	TIES	STRANDS	STAKES
1" - 1 1/2"	2	1 # 12	2 - 2 x 2
1 1/2" - 2"	3	1 # 12	3 - 2 x 2
2" - 3"	3	2 # 12	2 - 2 x 2

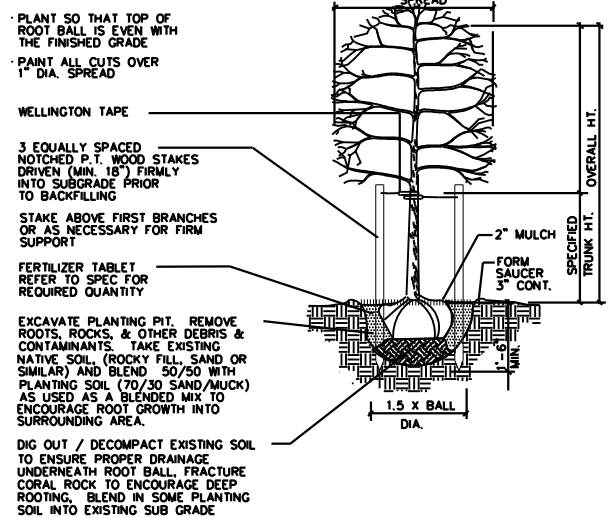

NOTE:
USE FOR 3" OR LESS SINGLE STEM TREES & PALMS

8 CANOPY AND PALM TREE- PLANTING & VERTICAL STAKING
SCALE: NOT TO SCALE

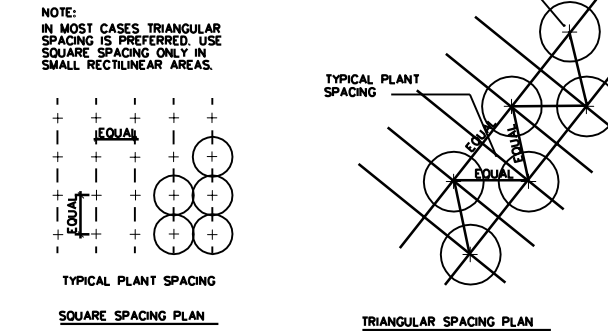

4 SHRUB- HEDGE AND MASS PLANTING
SCALE: NOT TO SCALE

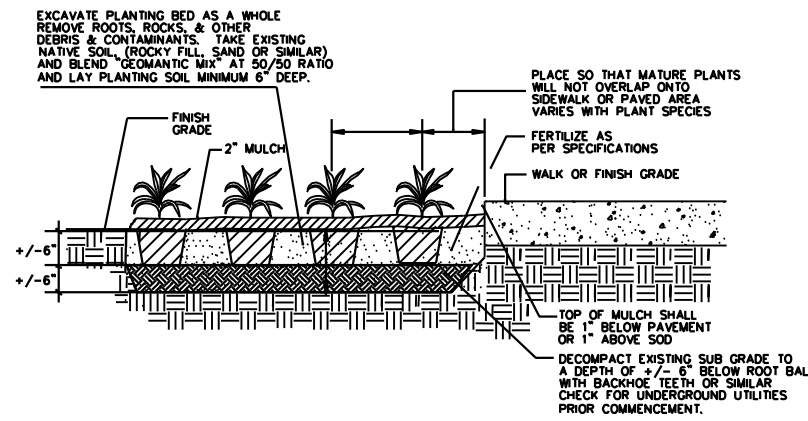

4 SHRUB- HEDGE AND MASS PLANTING
SCALE: NOT TO SCALE

CALIPER	CLEATS	STRAPS	BRACES	NAILS
3" - 8"	2 x 4 x 8"	1 # 12	3 - 2 x 4	2 - 16d
8" - 10"	2 x 4 x 12"	1 # 12	3 - 2 x 4	3 - 16d
10" - 16"	2 x 4 x 12"	2 # 12	4 - 2 x 4	3 - 16d

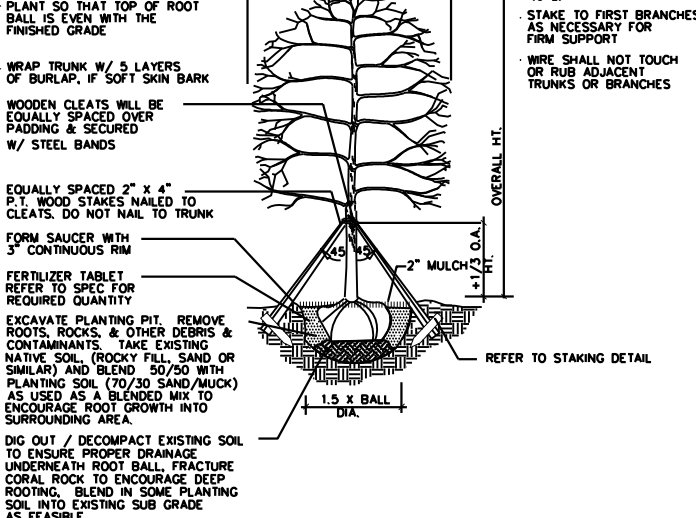

NOTE:
USE FOR 3" TO 12" SINGLE TRUNK TREES

5 CANOPY TREE- PLANTING & TRIPLE BRACE STAKING
SCALE: NOT TO SCALE

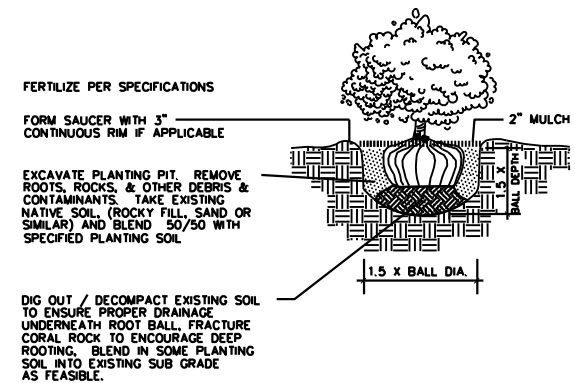

1 SHRUB PLANTING
SCALE: NOT TO SCALE

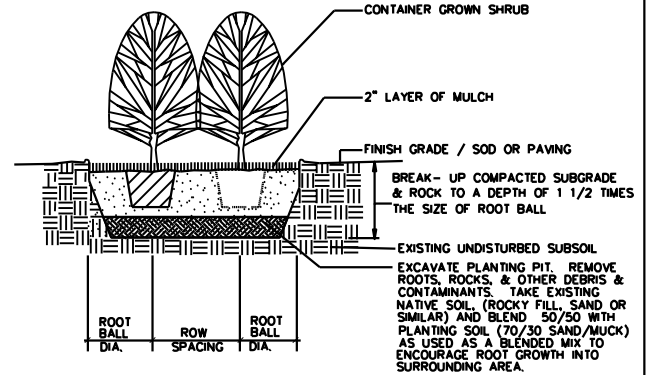

2 SHRUB- HEDGE AND MASS PLANTING
SCALE: NOT TO SCALE

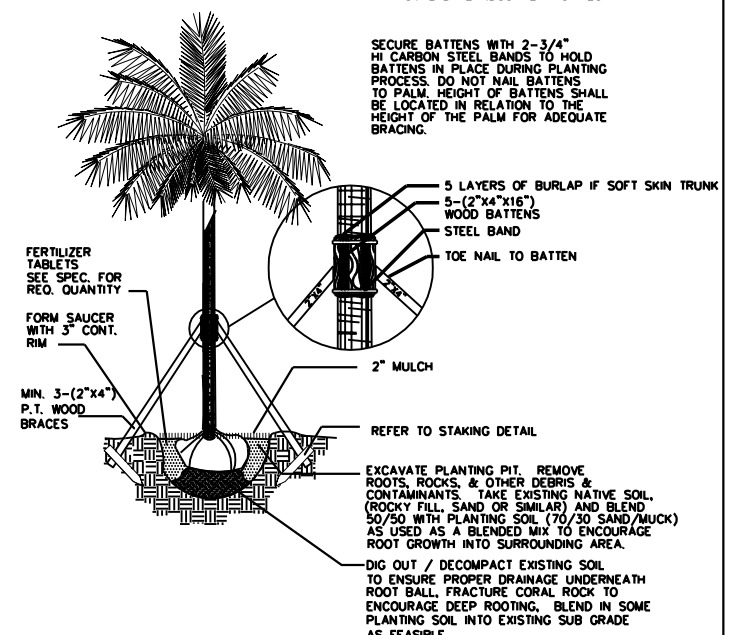

3 PALM- PLANTING & STAKING
SCALE: NOT TO SCALE

MARSH C. KRIPLEN FLORIDA LIC# LA6667007

ALL DRAWINGS AND WRITTEN MATERIAL APPEARING HEREIN CONSTITUTE THE ORIGINAL AND UNPUBLISHED WORK OF MCG ARCHITECTURE AND MAY NOT BE DUPLICATED, USED OR DISCLOSED WITHOUT THE EXPRESS WRITTEN CONSENT OF MCG ARCHITECTURE + PLANNING, INC. (c) 2018

SCALE: _____
CHECK: _____ JMcG
DATE: 07/09/2018

SHEET NUMBER

LIGHTING NOTES

1. PRIMARY CONTROLLERS AND GENERAL FIXTURE LOCATIONS SHOWN ONLY. CONTRACTOR TO SUBMIT SHOP DRAWINGS FOR COMPLETE SYSTEM DESIGN FOR APPROVAL BY LANDSCAPE ARCHITECT PRIOR TO INSTALLATION.
2. CONTRACTOR TO PROVIDE CODE COMPLIANT SYSTEM DESIGN INCLUDING FOOT CANDLE COVERAGE AND SEA TURTLE REQUIREMENTS FOR ENTIRE SITE.
3. COORDINATE LANDSCAPE LIGHTING WITH INTERIOR AND EXTERIOR ARCHITECTURAL LIGHTING. ENSURE COMPATIBILITY WITH ARCHITECTURAL LIGHTING SYSTEM CONTROLLERS.
4. PROVIDE NEMA RATED EQUIPMENT AND ENCLOSURES FOR SYSTEM CONTROLLERS EXPOSED TO THE ELEMENTS. SUBMIT PROPOSED MOUNTING SYSTEM, ENCLOSURES AND LOCATIONS AS PART OF THE SUBMISSION PROCESS.

Landscape Lighting LED Horizontal Step Light

By WAC Lighting



Product Options

Finish: Black on Aluminum, Bronze on Aluminum, Bronze on Brass, Cast Stainless Steel, White on Aluminum
Light Option: Amber, Warm White, White

Details

- Designed in 2016
- Shade Material: Glass
- Protected against high-pressure water jets
- Rated Hours: 60,000 hours
- 10%-100% dimming
- 50° beam spread
- Features frosted glass diffuser
- Solid diecast brass, corrosion resistant aluminum alloy or cast stainless steel construction
- Dimmable when used with Electronic low voltage (ELV) dimmer dimmers(not included)
- Title 24 compliant
- UL Listed Wet
- Warranty: 10 Years Functional / 5 Years Functional for Black Finish
- Made in China

Dimensions

Fixture: Length 5", Height 3", Depth 1.93"

Lighting

- 2 Watt (68 Lumens) 12 Volt Integrated LED- CRI: 90 Lifespan: 60000 hours

Additional Details

Product URL:
<https://www.ylighting.com/led-12v-ledme-step-light-by-wac-lighting-WACP138098.html>
Rating: UL Listed Wet

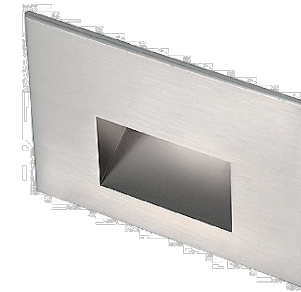

Notes:

3 STEP LIGHT
L800

Landscape Lighting LED Spot & Flood Light

By WAC Lighting



Product Options

Material: Bronze on Aluminum, Bronze on Brass
Light Temperature: 2700, 3000

Details

- Designed in 2016
- Finish: Bronze
- Integral dimmer and adjustable beam angle
- Rated life: 70,000 hours
- Protected against high-pressure water jets
- Includes ground stake and direct wire nuts
- Brass option: Enhanced protection from coastal or marine environments
- Warranty: Lifetime on bronze on brass finish
- Warranty: 2 years on bronze on aluminum finish
- UL Listed Wet
- Warranty: 10 years functional
- Made in China

Dimensions

Fixture: Length 6.62", Width 2.87", Height 5.87"

Lighting

- 2700K Option: 16 Watt (1045 Lumens) 12 Volt Integrated LED- CRI: 85 Color Temp: 2700K
- 3000K Option: 16 Watt (1045 Lumens) 12 Volt Integrated LED- CRI: 85 Color Temp: 3000K

Additional Details

Product URL:
<https://www.ylighting.com/led-12v-accent-landscape-light-by-wac-lighting-WACP124198.html>
Rating: UL Listed Wet



Notes:

1 LIGHT TYPE 1
L800

Box LED Bollard

By SONNEMAN Lighting



Product Options

Finish: Textured Bronze, Textured Gray
Sizes: 16 Inch, 22 Inch, 28 Inch

Details

- Designed in 2017
- Material: Diecast Aluminum
- 12VAC power supply required (sold separately)
- ETL Listed Wet
- Warranty: 5 years
- Made in China

Dimensions

16 Inch Option Fixture: Width 3.5", Height 16", Depth 3.25"

22 Inch Option Fixture: Width 3.5", Height 22", Depth 3.25"

28 Inch Option Fixture: Width 3.5", Height 28", Depth 3.25"

Lighting

- 10 Watt (645 Lumens) 12 Volt Integrated LED- CRI: 90 Color Temp: 3000K

Additional Details

Product URL:
<https://www.ylighting.com/box-led-bollard-by-sonneman-lighting-SNMP157785.html>
Rating: ETL Listed Wet

Product ID: SNMP157785

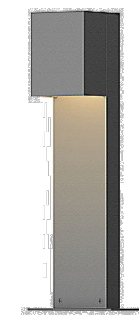

Notes:

2 PATHWAY LIGHT
L800



7580 NE 4th Court
 Studio 100
 Miami, FL 33138

PROJECT NUMBER
1819



Designer/
Landscape Architect

PROJECT:
4354 ALTON
ROAD
RESIDENCES

4354 ALTON RD.
 MIAMI BEACH,
 FLORIDA, 33139

DRAWING:

LIGHTING NOTES &
SPECIFICATIONS

MARSH C. KRIPLEN FLORIDA LIC# LA6667007

ALL DRAWINGS AND WRITTEN MATERIAL APPEARING HEREIN CONSTITUTE THE ORIGINAL AND UNPUBLISHED WORK OF MCG ARCHITECTURE AND MAY NOT BE DUPLICATED, USED OR DISCLOSED WITHOUT THE EXPRESS WRITTEN CONSENT OF MCG ARCHITECTURE & PLANNING, INC. (c) 2018

SCALE:

CHECK: MCK





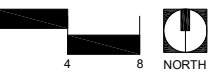

DATE: 07/09/2018

SHEET NUMBER

L800



LIGHTING LEGEND

-  LIGHTING CONTROLLER AND LIGHT SENSOR
-  TRANSFORMER
-  LIGHT TYPE 1
-  LIGHT TYPE 2
-  PATH LIGHT
-  BOLLARD
-  STEP LIGHT

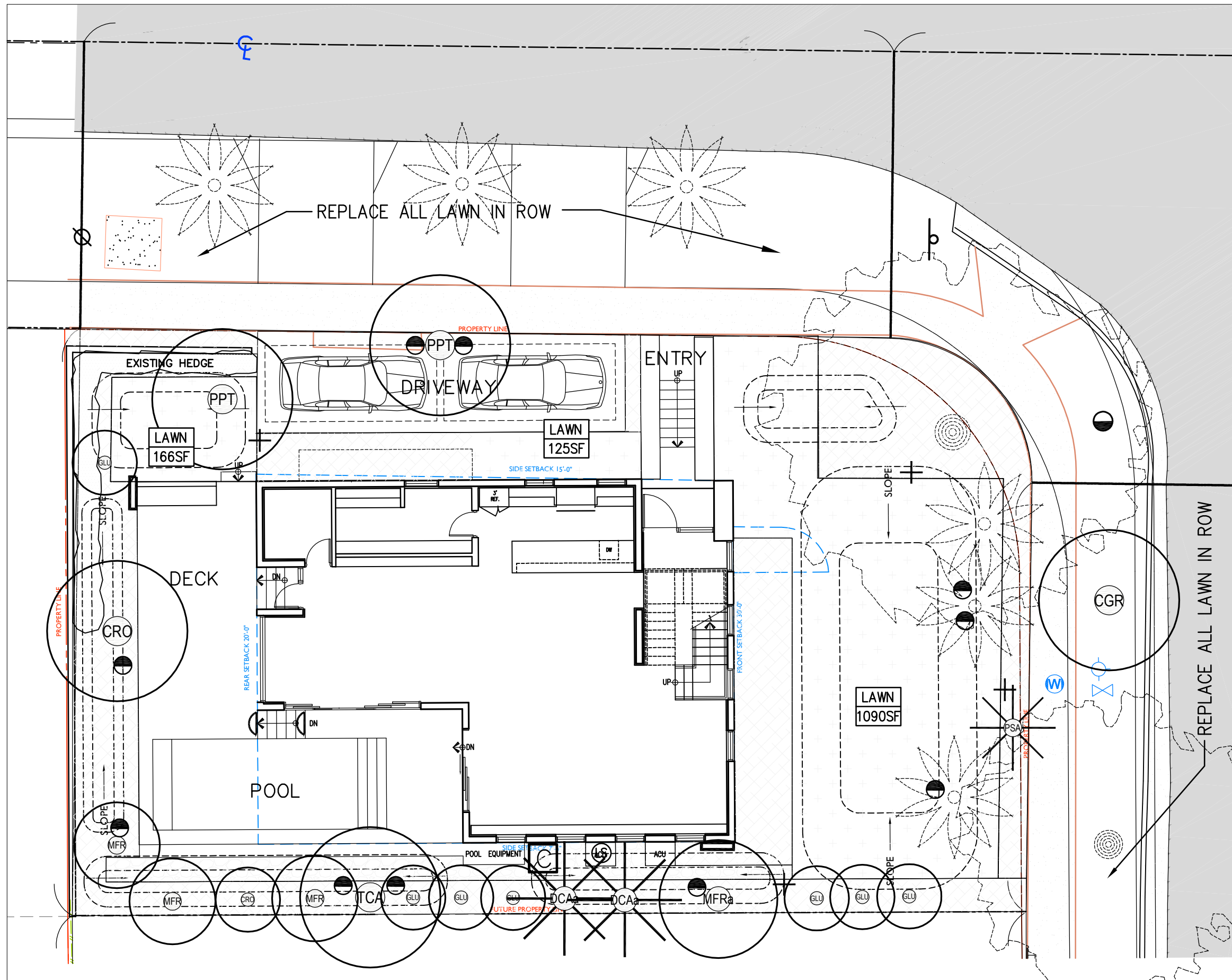



Designer/
Landscape Architect

PROJECT:
**4354 ALTON
ROAD
RESIDENCES**

4354 ALTON RD.
MIAMI BEACH,
FLORIDA, 33139

DRAWING:

IRRIGATION
DETAILS

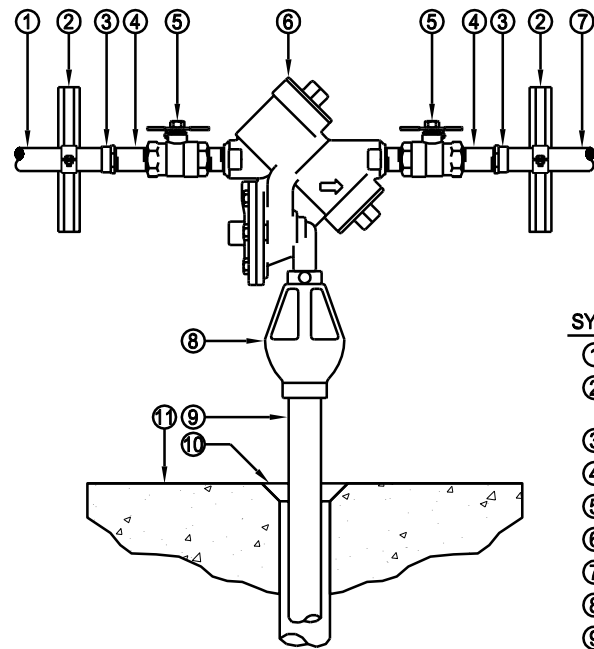

SYM. DETAIL COMPONENT LEGEND

- ① 1 1/4" COPPER STUB OUT FROM BUILDING WATER (BY PLUMBER)
- ② UNI-STRUT SUPPORT BRACKET, 24" MINIMUM LENGTH, WITH CUSH-A-CLAMP PIPE HANGERS
- ③ 1 1/4" X 1" COPPER SWEAT X FIPT REDUCING FEMALE ADAPTER
- ④ 1" X 3" BRASS THREADED NIPPLE
- ⑤ UNION STYLE BALL VALVE, PART OF BACKFLOW DEVICE
- ⑥ REDUCED PRESSURE BACKFLOW PREVENTION DEVICE
- ⑦ 1" COPPER PIPE TO ADJACENT PRV, MCV AND FS ASSEMBLY
- ⑧ AIR GAP REQUIRED FOR BACKFLOW PREVENTION DEVICE
- ⑨ 1" DRAIN LINE, SCH. 40 PVC TO FLOOR DRAIN
- ⑩ DRAIN IN FLOOR OF ROOM (BY PLUMBER)
- ⑪ FLOOR OF ROOM (BY OTHERS)

SECTION VIEW

3 REDUCED PRESSURE BACKFLOW DEVICE

NTS

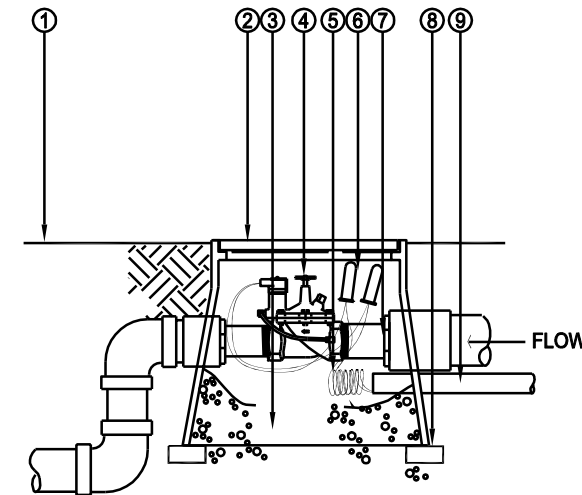

SYM. DETAIL COMPONENT LEGEND

- ① GROUND LEVEL
- ② VALVE BOX COVER LABELED IRRIGATION CONTROL VALVE GREEN
- ③ GRAVEL 30 IN. MINIMUM DEPTH
- ④ REMOTE CONTROL VALVE RAINBIRD PGA
- ⑤ 12 IN. WIRE COIL EACH WIRE
- ⑥ WATER PROOF CONNECTION
- ⑦ SCH 80 NIPPLE
- ⑧ BRICK (1 OF 4)
- ⑨ ELECTRIC CONDUIT UL APPROVED

SECTION VIEW

1 ELECTRIC REMOTE CONTROL VALVE WITH VALVE BOX

NTS

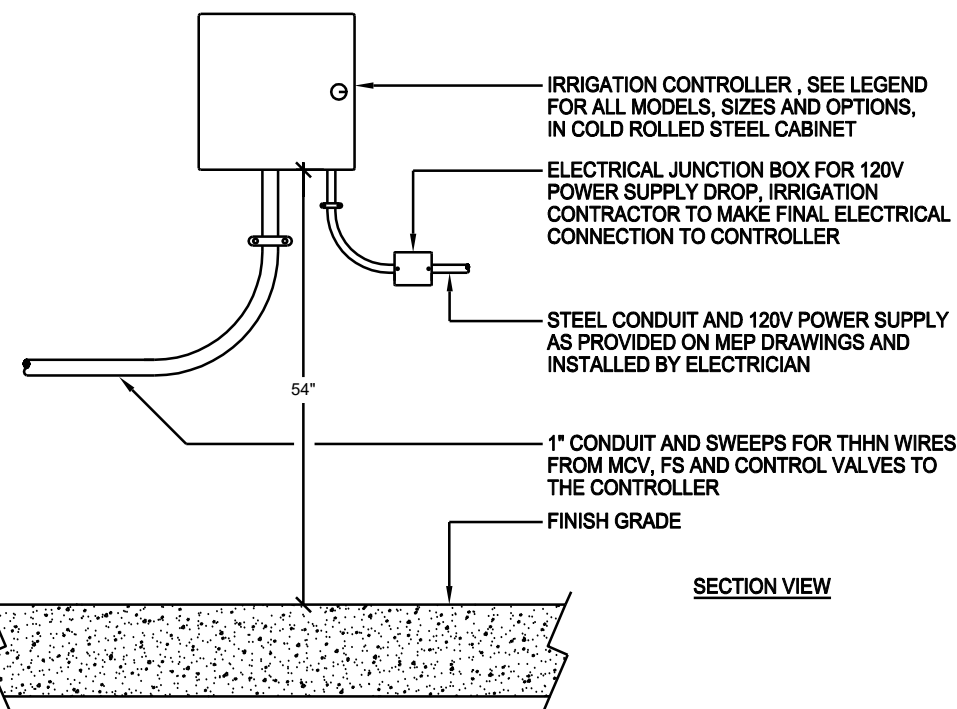

SECTION VIEW

4 CONTROLLER INSTALLATION

NTS

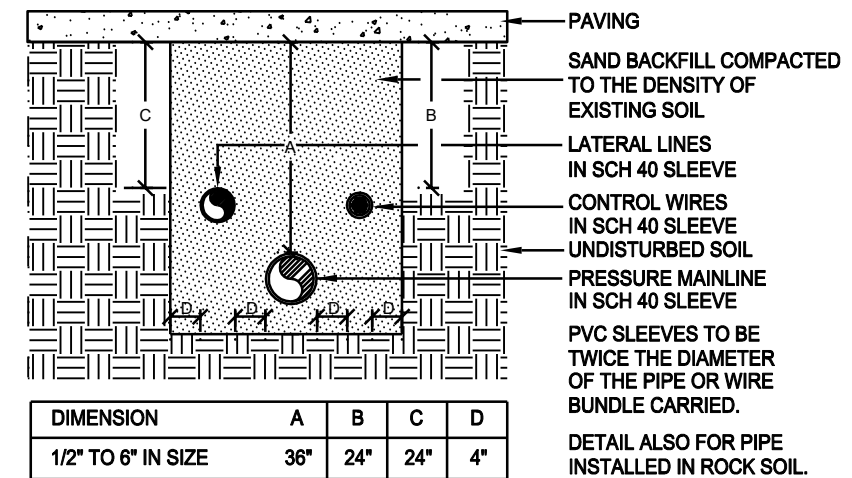

NOTE:
SLEEVES TO EXTEND AT LEAST 12" PAST THE EDGE OF THE PAVING.

SECTION VIEW

2 SLEEVE INSTALLATION

NTS

MARSH C. KRIELEN FLORIDA LIC# LA6667007
ALL DRAWINGS AND WRITTEN MATERIAL APPEARING HEREIN CONSTITUTE THE ORIGINAL AND UNPUBLISHED WORK OF MCG ARCHITECTURE AND MAY NOT BE DUPLICATED, USED OR DISCLOSED WITHOUT THE EXPRESS WRITTEN CONSENT OF MCG ARCHITECTURE & PLANNING, INC. (c) 2018

SCALE:
CHECK: JMcG
DATE: 07/09/2018
SHEET NUMBER

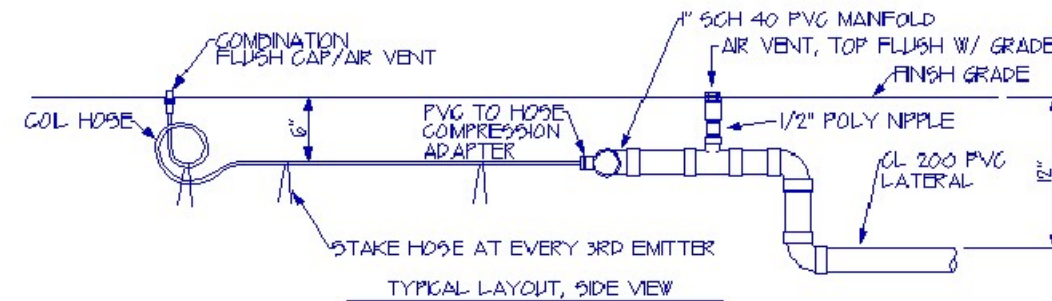
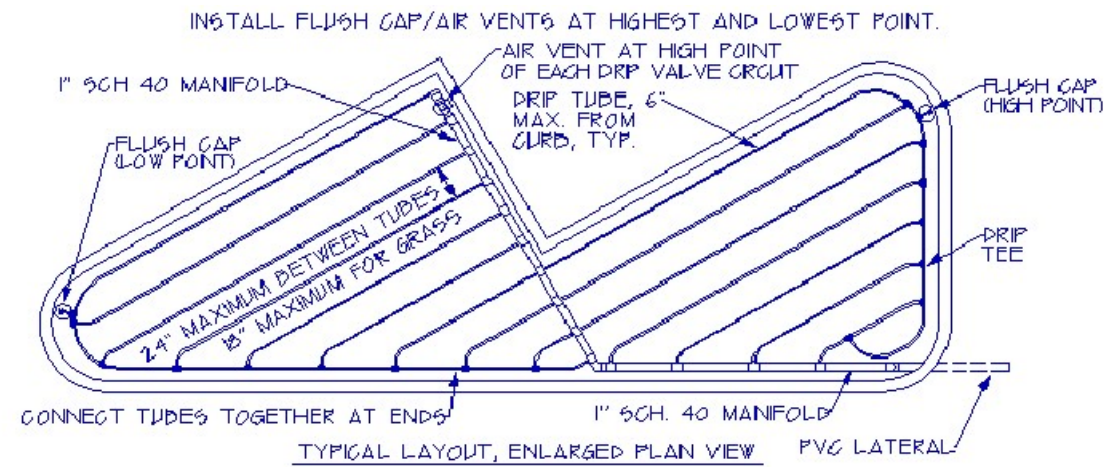

7 TYPICAL DRIP IRRIGATION- PLAN & SECTION

NTS

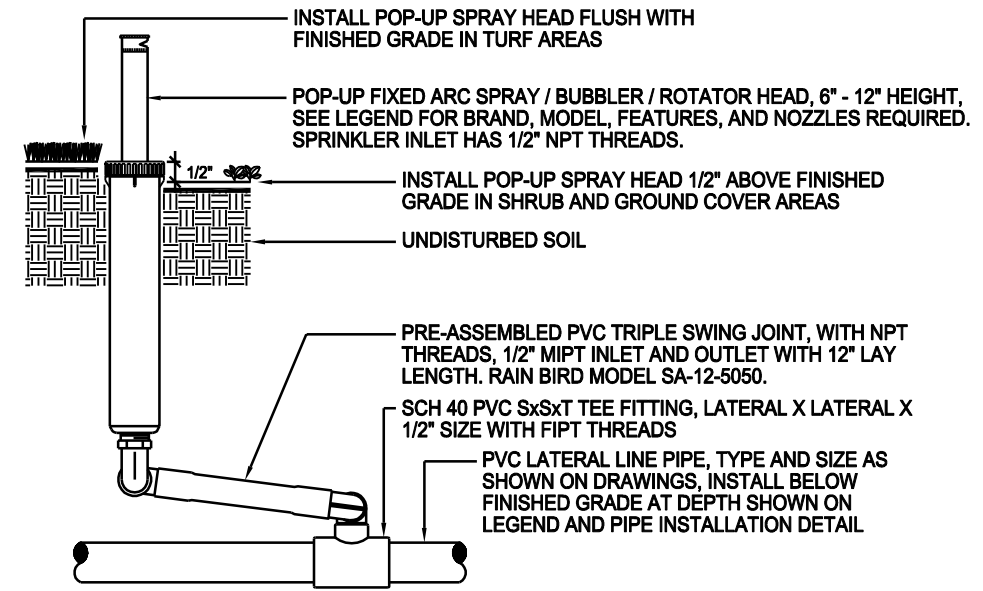

SECTION VIEW

NOTE:
INSTALL SPRAY HEADS 4" FROM PAVING EDGE IN TURF AREAS.
INSTALL SPRAY HEADS 6" FROM PAVING EDGE IN SHRUB AND GROUND COVER AREAS.
INSTALL SPRAY HEADS 12" FROM THE FACE OF BUILDING WALLS OR WINDOWS.
INSTALL SPRAY HEADS PLUMB. ADJUST NOZZLE SPRAY TO COVER THE LANDSCAPE AREA WITHOUT OVERSPRAY ONTO PAVING, FENCES, WALLS OR BUILDINGS.
SPRINKLER, SWING JOINT, AND PVC FITTINGS SHALL ALL HAVE "NPT" STYLE THREADS.

5 POP - UP SPRINKLER HEAD

NTS

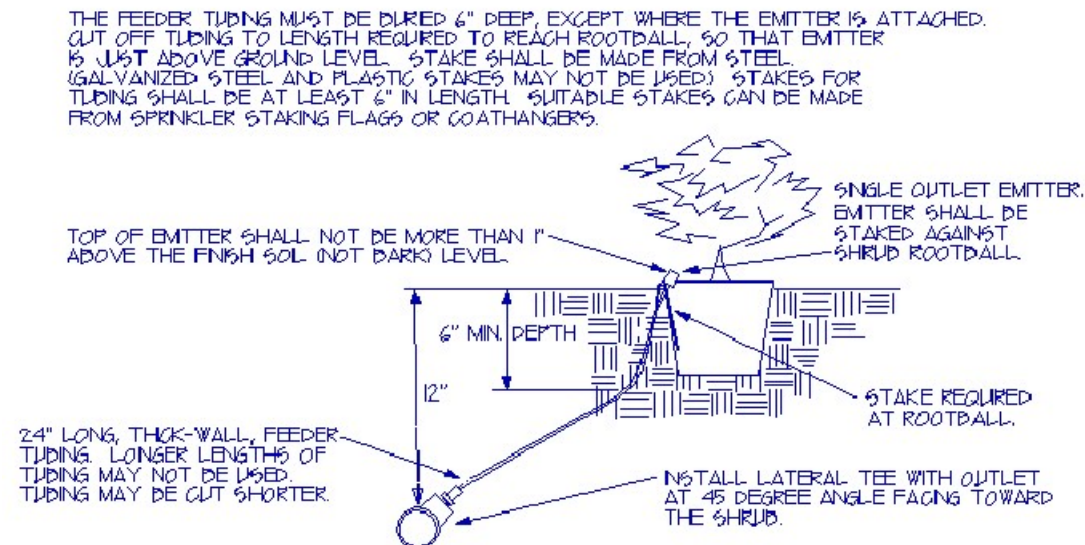

8 SHRUB EMITTER

NTS

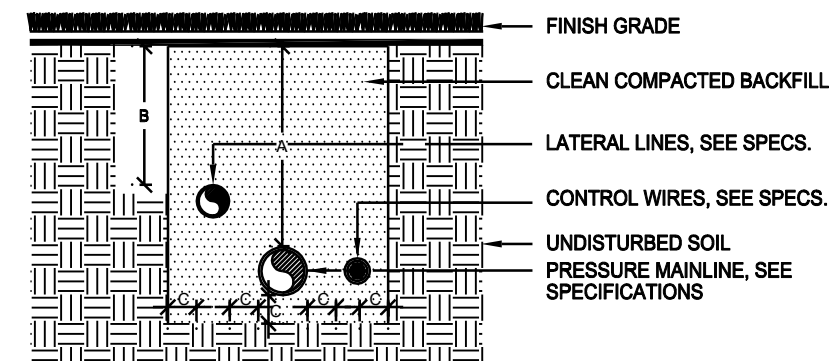

DIMENSION	A	B	C
1/2" TO 2" IN SIZE	18"	12"	4"

SECTION VIEW

6 PIPE INSTALLATION

NTS



IRRIGATION LEGEND

	WATER TAP AND METER.
	REDUCED PRESSURE BACKFLOW PREVEN
	IRRIGATION CONTROLLER WITH RAIN SW
	IRRIGATION CONTROL VALVE.
	IRRIGATION ISOLATION VALVE.
SIZE	PVC MAIN LINE PIPE.
SIZE	PVC LATERAL LINE PIPE.
SIZE SLV.	PVC SLEEVE PIPE.
	1" BRASS QUICK COUPLER VALVE.
	DRIP IRRIGATION ZONE

IRRIGATION NOTES

1. INFORMATION ON DRAWINGS FOR POINT OF CONNECTION, CONTROLLER, VALVE AND MAIN LINE ONLY. CONTRACTOR TO PROVIDE FINAL DRAWINGS AND SPECIFICATIONS FOR PERMIT.

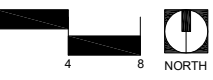

MARSH C. KRIELEN FLORIDA LIC# LA6667007
ALL DRAWINGS AND WRITTEN MATERIAL APPEARING HEREIN CONSTITUTE THE ORIGINAL AND UNPUBLISHED WORK OF MCG ARCHITECTURE AND PLANNING, INC. AND MAY NOT BE REPRODUCED, COPIED, OR DISCLOSED WITHOUT THE EXPRESS WRITTEN CONSENT OF MCG ARCHITECTURE & PLANNING, INC. (c) 2018

SCALE:
CHECK: MCK
DATE: 07/09/2018
SHEET NUMBER

