

KEY	ITEM	QTY.
	PVC laterals & mains shall be schedule 40 PVC (sized as shown on plans)	as required
	MAIN	as required
	PVC sleeves shall be Schedule 40 PVC (sized 2 sizes larger than the pipe running through it)	as required
	Flexible PVC or Polypipe (for swing joints)	as required
IM	Irrigation Meter and RPZ Backflow Prevention (See Civil Plans)	
EC	Electric Controller RAINBIRD ESP-Me Series Controller	1
△	MINI-Click II Rain Sensor (locate in area of free rainfall)	1
☛	RAINBIRD 200-PESB 2" Electromechanical Solenoid Control Valve	4
	Irrigation Control Wire	as required
	RAINBIRD Spray Heads 1800 @ 30 PSI Series w/MPR nozzles 4" pop-up in grass areas 12" pop-up on risers in shrub beds	as required
■	15-sst (1.21 gpm)	
■	15-cst (1.21 gpm)	
■	15-est (.61 gpm)	
○	10-H (.79 gpm)	
○	10-T (.53 gpm)	
○	10-Q (.39 gpm)	
■	5-F (.41 gpm)	
■	5-TQ (.33 gpm)	
■	5-H (.20 gpm)	
■	5-Q (.10 gpm)	
★	RAINBIRD 1300A-F Adjustable Flood Bubbler 1300A-F (1.5 gpm)	as required

The Contractor is responsible to properly size all laterals. All laterals shall be sized according to the following schedule. Total gallonage per pipe section shall be calculated by adding the GPM per head for every head downstream of the pipe.

SIZE	GPM
1/2"	0-4 GPM
3/4"	4-6 GPM
1"	6-10 GPM
1 1/4"	10-18 GPM
1 1/2"	18-25 GPM
2"	25-40 GPM
2 1/2"	40-60 GPM
3"	60-90 GPM

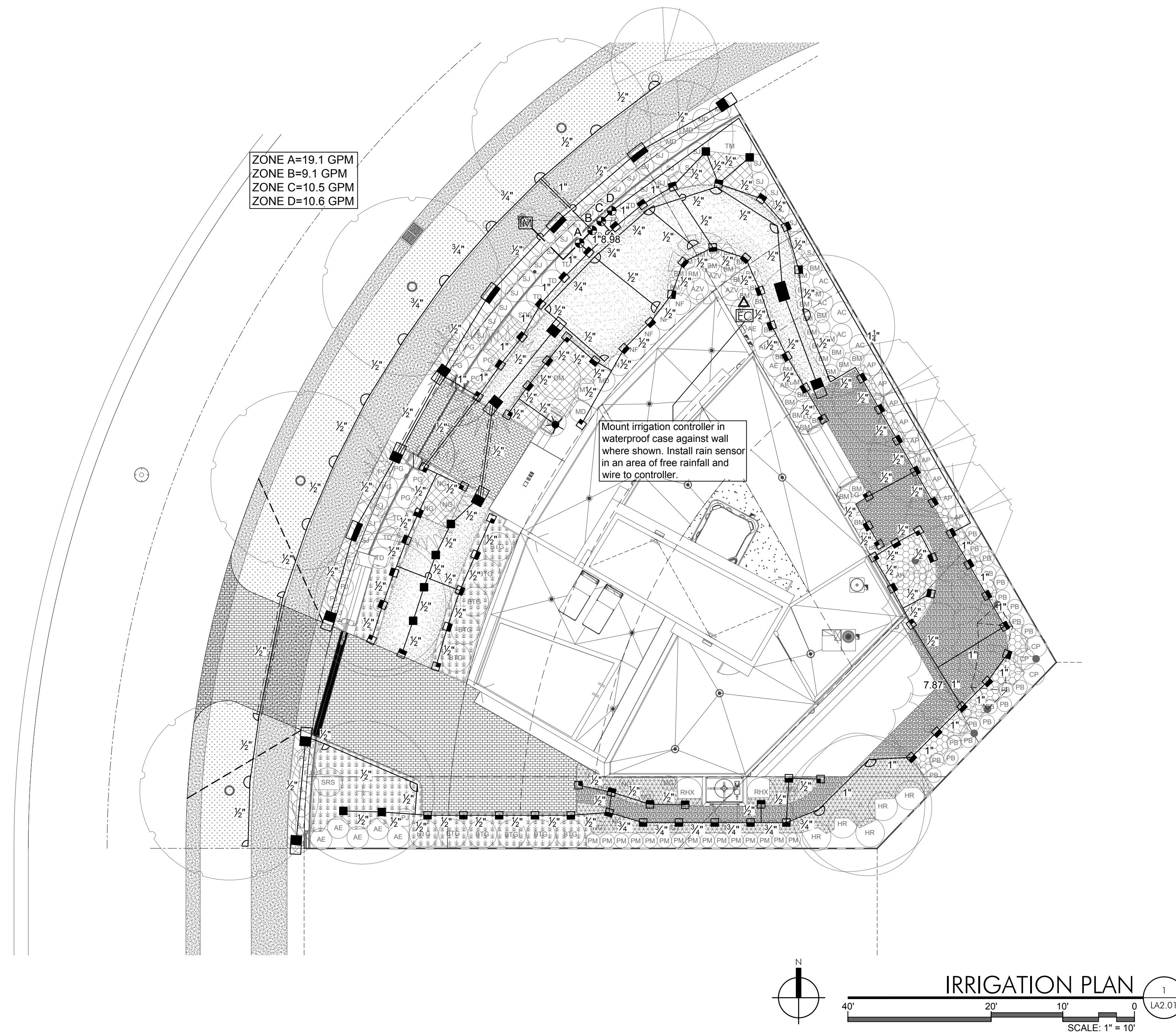

17670 NW 78th AVE., SUITE 214
M I A M I, F L 3 3 0 1 5
P 305.392.1016 F 305.392.1019
C O R P. I D # 0 0 0 0 2 6 6

This drawing is the property of GS&A Design and is not to be reproduced or copied in whole or part without written permission. It is not to be used on any other project and is to be returned on request. Contractor is responsible for verifying all site conditions prior to proceeding with work.
C O P Y R I G H T © 2 0 1 7

Di Lido Residence
815 West Di Lido Drive
Miami Beach, FL 33139

[illegible]

TITLE	
-------	--

IRRIGATION PLAN

Ken Gardner
Kiehl Semler

DATE 07.30.2018

SCALE _____ as noted

SHEET LA2.01