

# AS-BUILT SURVEY

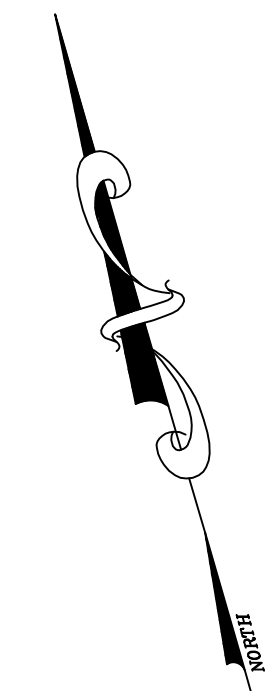
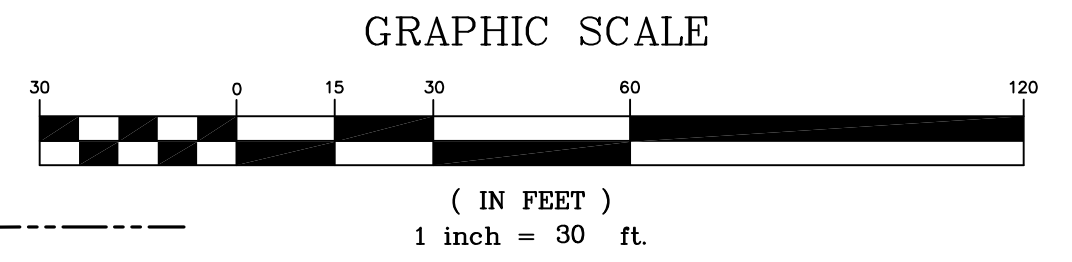
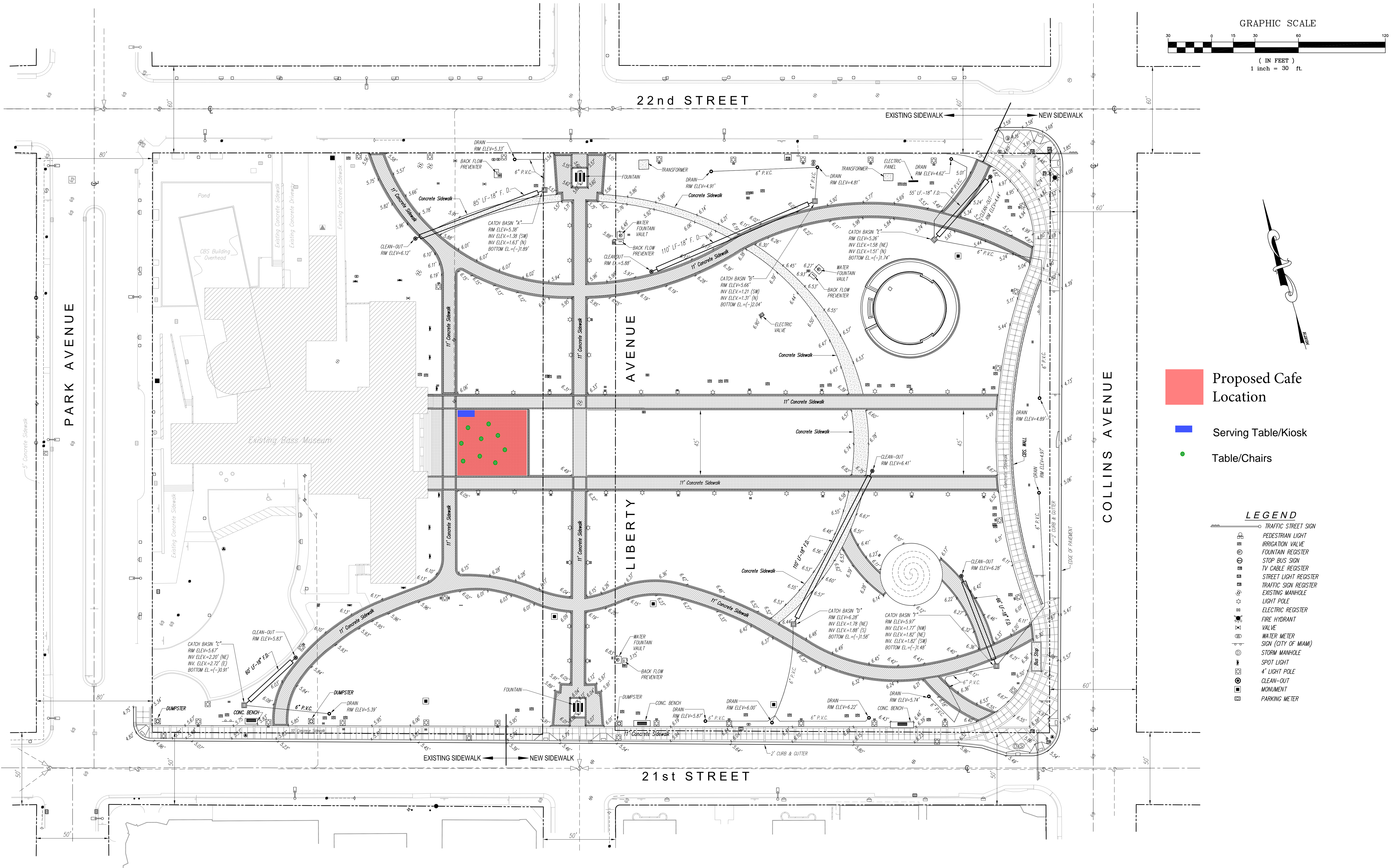

- Proposed Cafe Location
- Serving Table/Kiosk
- Table/Chairs

- LEGEND**
- TRAFFIC STREET SIGN
  - PEDESTRIAN LIGHT
  - IRRIGATION VALVE
  - FOUNTAIN REGISTER
  - STOP BUS SIGN
  - TV CABLE REGISTER
  - STREET LIGHT REGISTER
  - TRAFFIC SIGN REGISTER
  - EXISTING MANHOLE
  - LIGHT POLE
  - ELECTRIC REGISTER
  - FIRE HYDRANT
  - VALVE
  - WATER METER
  - SIGN (CITY OF MIAMI)
  - STORM MANHOLE
  - SPOT LIGHT
  - 4' LIGHT POLE
  - CLEAN-OUT
  - MONUMENT
  - PARKING METER

**SURVEYORS NOTES:**  
 1. This is not a Land Survey.  
 2. Elevations if any, shown hereon are relative to National Geodetic Vertical Datum.  
 3. Not valid unless sealed with an embossed surveyor's seal.

**SURVEYORS CERTIFICATE:**  
 I HEREBY CERTIFY: That the attached AS-BUILT SURVEY is correct to the best of my knowledge and belief as recently surveyed under my direction, and meets the intent of the Minimum Technical Standards set forth by the Florida Board of Professional Surveyors and Mappers in Chapter 5J-17 Florida Administrative Code, pursuant to Section 472.027, Florida.

BY: ARTURO MENDIGUTIA DATE  
 PROFESSIONAL SURVEYOR AND MAPPER  
 STATE OF FLORIDA, No. 5844

SEAL: \_\_\_\_\_  
 DATE: \_\_\_\_\_

**COLLINS PARK CULTURAL CAMPUS (BASS MUSEUM)**  
 DRAWN: ELF/MC. CHECKED: A.M. FIELD DATE: 08/30/10 DATE: 09/15/10 SCALE: 1" = 30'  
 REVISION \_\_\_\_\_  
 DATE: \_\_\_\_\_  
**MPG TECHNICAL GROUP CORP.**  
 CERTIFICATE OF AUTH. # LB-8932  
 908 S.W. 141st Avenue,  
 Miami, Florida 33184  
 Ph. (305) 559-9043 Fax. (305) 559-8914