



COLLINS PARK HOTEL

2000 PARK AVENUE

MIAMI BEACH, FLORIDA 33139

HISTORIC RESOURCES REPORT

by

ARTHUR J. MARCUS ARCHITECT P. A.

HISTORIC ARCHITECTURAL PRESERVATION CONSULTANT

August 14, 2012





COLLINS PARK : INTERIOR LOBBY AT MAIN ENTRANCE 1999

COLLINS PARK HOTEL
2000 PARK AVENUE
MIAMI BEACH, FLORIDA 33139
HISTORIC RESOURCES REPORT

by
ARTHUR J. MARCUS ARCHITECT P.A.
HISTORIC ARCHITECTURAL PRESERVATION CONSULTANT

1450 LINCOLN ROAD #806
MIAMI BEACH, FLORIDA 33139
305-674-8945 * 305-467-6141
www.arthurmarcus.com * www.AbstractImagesPhotography.com
for the

CITY of MIAMI BEACH
HISTORIC PRESERVATION BOARD

AUGUST 14, 2012

prepared for the

Owners:

CG SUNNY ISLES LLC

1221 COLLINS AVENUE
MIAMI BEACH, FLORIDA 33139
TELE: 786-379-3789

ALL PHOTOGRAPHS © COPYRIGHT BY ARTHUR MARCUS
UNLESS OTHERWISE SPECIFICALLY NOTED.



TYLER: INTERIOR at COURTYARD LOBBY 1999

COLLINS PARK

This remarkable collection of historic buildings is located within the Museum Historic District in Miami Beach, and includes seven of the eight historic and contributing structures on this city block, designed by some of the most creative and well known Architects in Miami Beach history.

The Museum Historic District was created together with the Flamingo Park Historic District by the Miami Beach City Commission on June 20, 1990.

These existing structures are to be restored to their historic grandeur with new interior structural systems where required to repair fire damage, as well as the installation of new interior building, window and door, mechanical, electrical, plumbing and fire protection systems to bring these structures up to current code standards.

TABLE OF CONTENTS

SITE

• BUILDING CARD + ARCHITECT INFORMATION	5
• NEIGHBORHOOD CONTEXT	6
• THE CAMPUS	7
• NEIGHBORING BUILDINGS	8
• COMPONENT BUILDINGS	9
• STATUS of DOCUMENTATION	10
HISTORIC PUBLIC INTERIORS	11
• HISTORIC TERRAZZO COMPASS	12
• INTERIOR-OF-BLOCK ELEVATIONS	13
• USE + UNITS	14

COLLINS PARK

• HISTORIC RESOURCES	17
• ORIGINAL ARCHITECTURAL DRAWINGS	30
• STATE OF FLORIDA HISTORIC SITE DATA	33
• BUILDING CARD	36

ADAMS

• HISTORIC RESOURCES	39
• ORIGINAL ARCHITECTURAL DRAWINGS	50
• STATE OF FLORIDA HISTORIC SITE DATA	54
• BUILDING CARD	57

TYLER

• HISTORIC RESOURCES	60
• ORIGINAL ARCHITECTURAL DRAWINGS	68
• BUILDING CARD	73

SUNKING 1

• HISTORIC RESOURCES	76
• BUILDING CARD	79
• STATE OF FLORIDA HISTORIC SITE DATA	81

SUNKING 2

• HISTORIC RESOURCES	85
• BUILDING CARD	88

LORD CHARLES

• HISTORIC RESOURCES	91
• BUILDING CARD	94
• ORIGINAL ARCHITECTURAL DRAWINGS	96

GAMSHIRE

• HISTORIC RESOURCES	99
• ORIGINAL ARCHITECTURAL DRAWINGS	102
• BUILDING CARD	105

HISTORIC RESOURCES REPORT by CAROLYN KLEPSEK / 5.25.2000	107
--	-----

ARCHITECT BIOGRAPHIES by CAROLYN KLEPSEK / 5.25.2000	110
--	-----

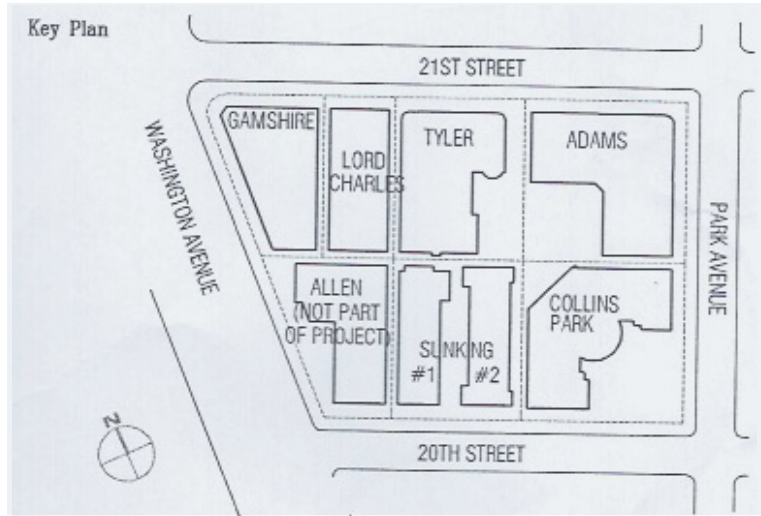

COLLINS PARK:BUILDING CARD INFORMATION

BUILDING CARDS ARE INCLUDED IN THIS REPORT TOWARDS THE END OF EACH BUILDING SECTION

PRESENT NAME (ORIGINAL NAME)	ADDRESS	ARCHITECT	PERMIT DATE	HEIGHT	COST
COLLINS PARK	2000 Park Avenue	Henry Hohauser	May 5, 1939	38'	\$77,000.
ADAMS	2040 Park Avenue	L. Murray Dixon	June 7, 1938	38'	\$76,000.
TYLER (Wilshire Arms)	430 21st Street	Albert Anis	July 6, 1940	40'	\$90,000.
SUNKING #1 (Copley Terrace)	435 20th Street	L. Murray Dixon	Aug 1, 1938	24'	\$25,000.
SUNKING #2	425 20th Street	Milton Sherman	May 21, 1948	25'	\$80,000.
LORD CHARLES (Gamsa #B)	450 21st Street	Albert Anis	June 19, 1953	21'-6"	\$70,000.
GAMSHIRE (Gamsa Apts #A)	2035 Washington Ave	Albert Anis	June 19, 1953	21'-6'	\$90,000.

COLORED RENDERING BELOW by SWANKE HAYDEN CONNELL ARCHITECTS 2002



VIEW FROM PARK AVENUE