

LAND

2610 NORTH MIAMI AVENUE
MIAMI, FL 33127
614.439.4895
WWW.LAND.DESIGN

SCOPE OF WORK

THE FOLLOWING DRAWINGS ILLUSTRATE THE PROPOSED SCOPE OF WORK FOR 1500 COLLINS AVENUE TO BE PERMITTED BY THE CITY OF MIAMI BEACH:

- NEW LANDSCAPE DESIGN FOR COURTYARD IN THE BACK OF THE PROPERTY ALONG WASHINGTON AVENUE.

05/04/2016 HPS SUBMITTAL

SHEET INDEX

LANDSCAPE DRAWINGS		DRAWING NOTES
LCVR	COVER PAGE	BY OTHERS
L001	GENERAL SITE NOTES	
LSVR	SURVEY	
L100	TREE DISPOSITION NOTES	
L101	TREE DISPOSITION PLAN	
L400	PLANTING SCHEDULE & NOTES	
L401	TREE & PALM PLANTING PLAN	
L450	PLANTING DETAILS	

LOCATION MAP



LANDSCAPE ARCHITECT
LAND
2610 NORTH MIAMI AVENUE
MIAMI, FL 33127
614.439.4895
WWW.LAND.DESIGN

ARCHITECT
TSAO DESIGN GROUP
7636 NE 4TH COURT, SUITE 101
MIAMI, FL 33138
305.576.2006
305.576.2005
WWW.TSAODESIGN.COM

AXEL HOTEL
1500 COLLINS AVENUE | MIAMI BEACH, FL 33139

SEAL
(MARSH C. KRIPILEN LIC.FL.LA6667007)
NOT FOR CONSTRUCTION

05.15.18

COVER PAGE
DATE ISSUE
05/04/2016 HPS SUBMITTAL

LCVR

05/04/2016 HPS SUBMITTAL



Know what's below.
Call before you dig.

SITWORK GENERAL NOTES

1. THE GENERAL CONTRACTOR SHALL BE RESPONSIBLE FOR COORDINATING ALL WORK BY THE SUBCONTRACTORS.
2. CONTRACTOR SHALL VERIFY ALL CONDITIONS AT JOB SITE AND NOTIFY LANDSCAPE ARCHITECT AND GENERAL CONTRACTOR OF DIMENSIONAL ERRORS, OMISSIONS OR DISCREPANCIES BEFORE BEGINNING ANY WORK.
3. CONTRACTOR TO OBTAIN ALL NECESSARY PERMITS PRIOR TO CONSTRUCTION. ALL CONTRACTORS MUST COMPLY WITH PERMIT REQUIREMENTS, LOCAL, STATE AND FEDERAL JURISDICTIONS AND GOVERNING BODIES/AGENCIES RULES AND REGULATIONS AND LAND USE APPROVAL CONDITIONS AT ALL TIMES.
4. WORK PERFORMED WITHOUT APPROVAL OF LOCAL, STATE AND FEDERAL JURISDICTIONS AND GOVERNING BODIES/AGENCIES AND/OR NOT IN COMPLIANCE WITH SPECIFICATIONS AND/OR DRAWINGS IS SUBJECT TO REMOVAL AT CONTRACTOR'S EXPENSE.
5. ALL WORK SHALL CONFORM TO THE APPROPRIATE AGENCIES. CONTRACTOR SHALL VERIFY LOCATION OF ALL EXISTING UTILITIES, LINES AND STRUCTURES PRIOR TO EXCAVATION OR TRENCHING. DAMAGE SHALL BE REPAIRED BY THE CONTRACTOR AT NO COST TO THE OWNER. THE LANDSCAPE ARCHITECT ASSUMES NO RESPONSIBILITY FOR UTILITIES OR STRUCTURES NOT SHOWN ON THE DRAWINGS. CONTRACTOR IS TO VERIFY THE EXACT LOCATION OF UTILITIES PRIOR TO CONSTRUCTION AND NOTIFY THE LANDSCAPE ARCHITECT OF ANY DISCREPANCIES. CONTRACTOR SHALL USE EXTREME CAUTION WHEN WORKING OVER OR NEAR EXISTING GAS AND ELECTRICAL LINES.
6. THE CONTRACTOR SHALL BE RESPONSIBLE FOR RESETTING ALL LAND MONUMENTS DISRUPTED BY CONSTRUCTION ACTIVITIES OR NEGLIGENCE ON THE PART OF THE CONTRACTOR. RESETS SHALL BE PERFORMED UNDER THE SUPERVISION OF A REGISTERED LAND SURVEYOR AND MONUMENT RECORDS MUST BE FILED AS REQUIRED BY STATUTE FOR ALL MONUMENTS.
7. THE CONTRACTOR SHALL TAKE ALL PRECAUTIONARY MEASURES NECESSARY TO PROTECT EXISTING IMPROVEMENTS FROM DAMAGE AND ALL SUCH IMPROVEMENTS AND STRUCTURES DAMAGED BY THE CONTRACTOR'S OPERATIONS SHALL BE REPAIRED OR RECONSTRUCTED SATISFACTORY TO THE LANDSCAPE ARCHITECT AT THE CONTRACTOR'S EXPENSE.
8. ALL BARRICADING AND TEMPORARY TRAFFIC CONTROL DEVICES OR METHODS USED DURING CONSTRUCTION SHALL BE IN ACCORDANCE WITH LOCAL, STATE AND FEDERAL JURISDICTIONS AND GOVERNING BODIES/AGENCIES STANDARDS. PROVIDE ADEQUATE TIME FOR REVIEW AND APPROVAL BY THE ABOVE JURISDICTIONS PRIOR TO COMMENCEMENT.
9. THE LANDSCAPE ARCHITECT IS NOT RESPONSIBLE FOR THE CONSTRUCTION MEANS, METHODS, TECHNIQUES, SEQUENCES UTILIZED OR FOR SAFETY PRECAUTIONS OR PROBLEMS IN CONNECTION WITH THE WORK. THE LANDSCAPE ARCHITECT WILL NOT BE RESPONSIBLE FOR THE CONTRACTOR'S FAILURE TO CARRY OUT THE WORK IN ACCORDANCE WITH THE CONTRACT DOCUMENTS. CONTRACT DOCUMENTS INCLUDE THE CONSTRUCTION DOCUMENT DRAWING SET/TECHNICAL SPECIFICATIONS MANUAL/LASIS.
10. CONTRACTOR TO VERIFY ALL QUANTITIES. IN CASE OF ANY DISCREPANCIES, GRAPHICALLY SHOWN MATERIAL QUANTITIES SHALL TAKE PRECEDENCE.
11. A SYSTEM OF DIAGRAMMATIC SYMBOLS, HATCHES AND NOTATIONS IS USED IN THESE DRAWINGS. REVIEW NOTATIONS CAREFULLY, NOTIFY LANDSCAPE ARCHITECT AND REQUEST CLARIFICATION OF ANY UNCLEAR NOTATION OR DISCREPANCY PRIOR TO COMMENCING WORK.

SITWORK GENERAL NOTES CONTINUED

1. PROVIDE SLEEVES AS REQUIRED FOR DRAINAGE, IRRIGATION AND ELECTRICAL LINES. IRRIGATION AND ELECTRICAL SLEEVES AND SUBSURFACE DRAINAGE SYSTEMS SHALL BE CONSTRUCTED PRIOR TO PAVING AND LANDSCAPE WORK. UTILITY SLEEVES ARE REQUIRED IN ALL PLANT BEDS ISOLATED BY PAVEMENT OR ANY OTHER STRUCTURES.
2. SPECIAL CONSIDERATION IS GIVEN TO THE DESIGN AND INTENDED RELATIONSHIP BETWEEN ARCHITECTURE, PLANTING AREAS AND PAVING SYSTEMS. PAVEMENT JOINTING, PAVERS, STONE, FINISHES AND GRADES HAVE BEEN STRICTLY COORDINATED IN THE CONTRACT DOCUMENTS. CONSTRUCTION OF THESE SYSTEMS SHALL BE STRICTLY COORDINATED.
3. VEHICLES, EQUIPMENT, AND/OR MATERIALS SHALL NOT BE PARKED OR STORED IN AREAS OF EXISTING VEGETATION, INCLUDING WITHIN THE DRIPLINE OF EXISTING TREES TO REMAIN.
4. CONSTRUCTION WASTE-INCLUDING BUT NOT LIMITED TO: PLANT MATERIAL, BUILDING MATERIALS, DEMOLISHED MATERIALS, PACKAGING, LEFTOVER PAINT AND CONCRETE SLURRY-SHOULD BE PROPERLY REUSED, RECYCLED, DISPOSED OF LEGALLY OFF-SITE OR IN DESIGNATED WASH-OUT AREAS DETERMINED BY THE GENERAL CONTRACTOR.
5. RECYCLING AND TRASH BINS TO BE PROVIDED ON SITE. SEPARATE BINS FOR CARDBOARD, CO-MINGLED, AND OTHER RECYCLABLE/REUSABLE MATERIALS IDENTIFIED BY THE LOCAL JURISDICTION SHALL BE MAINTAINED. ALL BINS TO BE WILDLIFE-PROOF.
6. ON-SITE FUEL STORAGE FOR CONSTRUCTION EQUIPMENT IS DISCOURAGED. CONSTRUCTION EQUIPMENT USED ON SITE TO BE CHECKED REGULARLY TO ASSURE CONTAMINATION CONCERNS FROM OILS AND GREASES ARE ELIMINATED. NO TOXIC MATERIALS SHALL BE STORED ON-SITE.
7. GENERAL CONTRACTOR TO KEEP ALL ITEMS IMPLEMENTED BY LANDSCAPE ARCHITECT IN PROPER WORKING ORDER THROUGHOUT THE DURATION OF THE PROJECT.
8. THE CONSTRUCTION SITE TO BE INSPECTED ON A MONTHLY BASIS BY LANDSCAPE ARCHITECT AND/OR CIVIL ENGINEER TO ASSURE THAT THE SILT FENCE AND MUD TRACKING PAD ARE PROPERLY IN PLACE AND FUNCTIONING AS DESIGNED.
9. GREEN BUILDING PRACTICES SHALL BE EMPLOYED TO THE EXTENT FEASIBLE. SUCH PRACTICES INCLUDE: CARPOOLING/VANPOOLING TO JOB SITE, MINIMIZING MATERIALS PACKING BEFORE ARRIVAL TO JOB SITE, REDUCING MATERIAL/RESOURCE INEFFICIENCIES BY COORDINATING WORK.
10. THE PROJECT LIMIT OF CONSTRUCTION AND ALL EXISTING VEGETATION TO REMAIN IS TO BE CLEARLY DEFINED BY STURDY, WEATHERPROOF FENCING AT A MINIMUM OF FOUR (4) FEET HIGH.
11. WATERPROOFING OF SUBGRADE AND OTHER ARCHITECTURAL SPACES BELOW AND/OR ADJACENT TO IMPROVEMENTS DESIGNED BY THE LANDSCAPE ARCHITECT IS TO BE ADEQUATELY DESIGNED AND DETAILED BY OTHERS TO PERMANENTLY REPEL ALL WATER SOURCES INCLUDING, BUT NOT LIMITED TO: PRECIPITATION, STORM WATER RUNOFF, GROUND WATER, IRRIGATION, ROOF RUNOFF, GROUND WATER, AND PLUMBING LEAKS.
12. STRUCTURAL DESIGN TO SUPPORT IMPROVEMENTS DESIGNED BY THE LANDSCAPE ARCHITECT AND LOCATED ABOVE, BELOW, AND/OR ADJACENT TO SUBGRADE AND OTHER ARCHITECTURAL SPACES IS THE RESPONSIBILITY OF THE STRUCTURAL ENGINEER. THE STRUCTURAL DESIGN SHOULD BE ADEQUATELY DESIGNED TO SUPPORT ALL POSSIBLE LOADS INCLUDING, BUT NOT LIMITED TO: BACKFILL, COMPACTION, PLANTINGS, HARDSCAPES, RETAINING AND FREESTANDING SITE WALLS, AND CONSTRUCTION MATERIALS/EQUIPMENT/ACTIVITY.

SOIL EROSION CONTROL NOTES

1. PRIOR TO BEGINNING ANY EARTH CHANGE, THE CONTRACTOR SHALL INSTALL AND MAINTAIN ALL SESC MEASURES AS SHOWN ON THE CONTRACT DOCUMENTS AND AS REQUIRED BY ANY GOVERNING AGENCIES.
2. ALL SESC MEASURES TO BE MAINTAINED DAILY.
3. THE CONTRACTOR TO CONDUCT ALL EXCAVATION, FILLING, GRADING, AND CLEANUP OPERATIONS IN A MANNER SUCH THAT SEDIMENT, GENERATED BY WIND OR WATER IS NOT DISCHARGED INTO ANY STORM SEWER, DRAINAGE DITCH, RIVER, LAKE, AIR, OR UNDERGROUND UTILITY SYSTEM. STAGE WORK TO MINIMIZE THE AREA OF EXPOSED SOIL, THEREBY REDUCING THE OPPORTUNITY FOR SOIL EROSION.
4. WATER FROM TRENCHES AND OTHER EXCAVATION TO BE PUMPED INTO A FILTRATION BAG TO REMOVE SEDIMENTS FROM THE WATER.
5. NORTH AMERICAN GREEN SC-150 OR EQUIVALENT EROSION CONTROL FABRIC IS REQUIRED ON ALL DISTURBED SLOPES GREATER THAN 3:1 UNTIL PROJECT AREA IS REVEGETATED PER THE PLANTING PLAN.
6. PROVIDE POSITIVE DRAINAGE AWAY FROM ALL STRUCTURES.
7. CONTRACTOR TO PROVIDE ONSITE WATERING TO REDUCE FUGITIVE DUST LEAVING THE SITE DURING CONSTRUCTION.
8. SOIL EROSION CONTROL MEASURES TO BE PROVIDED FOR ALL EXISTING AND PROPOSED DRAINAGE STRUCTURES WITHIN THE PROJECT LIMITS.
9. CONSTRUCTION STAGING AND PHASING SHALL OCCUR, WHERE APPLICABLE, TO MINIMIZE SOIL DISTURBANCE TIME.
10. BEST MANAGEMENT PRACTICES (BMPs) SHALL BE ADJUSTED AS NEEDED TO MEET ANY OTHER UNFORESEEN CONDITIONS.
11. THE GENERAL CONTRACTOR IS RESPONSIBLE FOR INSTALLING A MUD TRACKING PAD/WASHING PAD AT THE CONSTRUCTION ENTRANCES TO MINIMIZE MUD DETACHMENT FROM TRUCK TIRES. 1-1/2 INCH SCREENED ROCK TO BE PLACED ON MIRAFI 140-N FILTER FABRIC. ADDITIONAL CLEAN GRAVEL TO BE ADDED THROUGHOUT THE DURATION OF CONSTRUCTION AS NEEDED.
12. CONTRACTOR SHALL ABIDE BY THE LOCAL, STATE AND FEDERAL JURISDICTIONS AND GOVERNING BODIES/AGENCIES CONSTRUCTION MANAGEMENT PLAN REQUIREMENTS.
13. RESEED AS INDICATED IN SEEDING NOTES.

AXEL HOTEL
1500 COLLING AVENUE | MIAMI BEACH, FL 33139

SEAL
(MARSH C. KRIPLEN LIC. FL. LA6667007)
NOT FOR CONSTRUCTION

GENERAL SITE NOTES
DATE ISSUE

DISCREPANCIES NOT QUANTIFIED

MITIGATION NOTES

1. THE PROPOSED PLAN SPECIFIES THE REMOVAL OF 334 SQUARE FEET OF CANOPY AREA FOR SITE TREES. PER , CITY OF MIAMI BEACH CODE OF ORDINANCES, CHAPTER 46, DIVISION 2.

DEFINITIONS

1. TREE: ANY SELF-SUPPORTING WOODY PLANT OR PALM WHICH USUALLY HAS A SINGLE MAIN AXIS OR TRUNK, WITH A MINIMUM TRUNK DIAMETER AT BREAST HEIGHT OF TWO INCHES AND A MINIMUM OVERALL HEIGHT OF 12 FEET. THIS DEFINITION EXCLUDES PLANTS WHICH ARE DEFINED AS SHRUBS, HEDGES, VINES, OR GROUND COVERS. PALMS SHALL HAVE A MINIMUM HEIGHT OF 14 FEET IN ORDER TO BE CLASSIFIED AS A TREE. - CITY OF MIAMI BEACH CODE OF ORDINANCES, CHAPTER 46, DIVISION 2

TREES & PLANTING TO BE PRESERVED NOTES

1. EXISTING TREES TO BE PRESERVED SHALL BEAR SAME RELATIONSHIP TO FINISHED GRADE AS THEY BEAR TO PRE-CONSTRUCTION GRADE.
2. EXISTING TREES TO BE PRESERVED SHALL BE PROTECTED WITH STURDY, WEATHERPROOF FENCING AT A MINIMUM FOUR (4) FEET HEIGHT INSTALLED NO CLOSER TO THE TREE TRUNK THAN ITS DRIPLINE. THIS FENCE SHALL BE MAINTAINED IN WORKING ORDER DURING ALL PHASES OF CONSTRUCTION. MAINTAIN TREE PROTECTION ZONES FREE OF WEEDS AND TRASH.
3. NO WORK SHALL BE CONDUCTED WITHIN THE DRIPLINE, UNLESS REVIEWED AND APPROVED BY THE LANDSCAPE ARCHITECT. ALL WORK APPROVED WITHIN THE DRIPLINE SHALL BE COMPLETED BY HAND. PROTECT ROOT SYSTEMS FROM PONDING, ERODING, OR EXCESSIVE WETTING.
4. THE PROJECT LIMIT OF CONSTRUCTION AND ALL EXISTING VEGETATION TO REMAIN IS TO BE CLEARLY DEFINED BY STURDY, WEATHERPROOF FENCING AT A MINIMUM OF FOUR (4) FEET HIGH.

TREES & PLANTING TO BE REMOVED NOTES

1. THE CONTRACTOR IS TO COMPLETELY REMOVE ALL PLANTER MATERIAL DESIGNATED FOR REMOVAL (I.E. ROOT BALL, DEBRIS, SAW DUST, ETC.).
2. THE CONTRACTOR IS TO BACKFILL ALL EXCAVATED ROOT BALLS FLUSH TO THE ADJACENT ELEVATION LEVEL.
3. CONTRACTOR TO NOTIFY LANDSCAPE ARCHITECT TWO WEEKS IN ADVANCE OF ALL SCHEDULED WORK PERTAINING TO THE RELOCATION OF SITE TREES.

TREE PROTECTION NOTES

1. PROTECTION FENCE SHALL BE GALVANIZED CHAIN LINK STANDARD 2"X2" MESH.
2. PROVIDE HINGED GATE.
3. ALTERNATE: 2X4 WOOD POSTS (6'-0" O.C. MAX) WITH THREE EVENLY SPACED WOODEN RAILS. MIN. HT 4'
4. POSTS MAY BE SHIFTED TO AVOID ROOTS.
5. NO STORAGE, DEBRIS, VEHICULAR TRAFFIC OR EQUIPMENT CLEANING IS ALLOWED WITHIN THE PROTECTED AREA.
6. REFER TO MUNICIPAL REQUIREMENTS FOR ADDITIONAL INFORMATION.

TREE PRUNING

1. RETAIN CERTIFIED ARBORIST TO UNDERTAKE PRUNING OF ANY ON SITE OR OFF SITE PLANTING MATERIAL TO REMAIN.
2. USE BEST PRACTICES AND FOLLOW MUNICIPAL GUIDELINES FOR ALL PRUNING. DO NOT REMOVE MORE MATERIAL THAN ALLOWED. DO NOT LEAVE MATERIAL MISSHAPEN.

TREE PROTECTION DETAIL

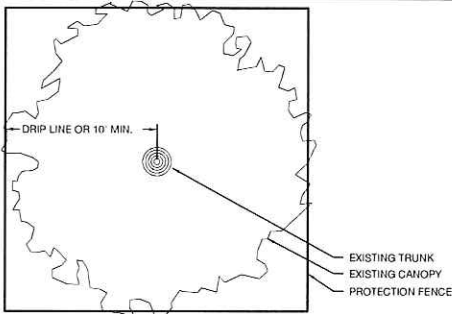

PLAN

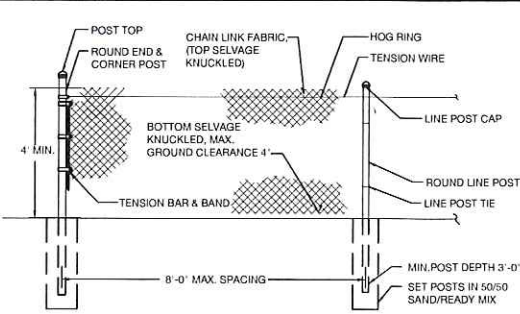

ELEVATION

TREES DISPOSITION SCHEDULE

TREE No.	TREE - LATIN NAME	TREE - COMMON NAME	DIAMETER at BREAST HEIGHT (in inches)	HEIGHT OF CANOPY TREES (in feet)	CLEAR TRUNK HEIGHT OF PALM TREES (in feet)	CANOPY DIAMETER (in feet)	CANOPY (in Sq. FTL)	DISPOSITION	CONDITION	REMOVAL- MUNICIPAL CRITERIA AND NOTES		
										CRITERIA	CANOPY SQ. FT.	ROW CANOPY SQ. FT.
17	<i>Ficus benghalensis</i>	BANYAN TREE	60	35		50	1963	REMAIN	GOOD			
18	<i>Tamarindus indica</i>	TAMARIN TREE	4	18		10	79	REMOVE	FAIR		79	
19	<i>Ficus aurea</i>	FICUS TREE	6	20		12	113	REMOVE	POOR		113	
20	<i>Psychotermia elegans</i>	ALEXANDER PALM	6		18	9	64	REMOVE	POOR		64	
21	<i>Conocarpus erectus</i>	SILVER BUTTONWOOD	6	18		10	79	REMOVE	POOR		79	
STREET TREES												
1	<i>Cocos nucifera</i>	COCONUT PALM	10		15	15	177	REMAIN	GOOD			
2	<i>Cocos nucifera</i>	COCONUT PALM	10		15	15	177	REMAIN	GOOD			
3	<i>Cocos nucifera</i>	COCONUT PALM	10		15	15	177	REMAIN	GOOD			
4	<i>Cocos nucifera</i>	COCONUT PALM	8		15	15	177	REMAIN	GOOD			
5	<i>Cocos nucifera</i>	COCONUT PALM	10		15	15	177	REMAIN	GOOD			
6	<i>Cocos nucifera</i>	COCONUT PALM	10		15	15	177	REMAIN	GOOD			
7	<i>Cocos nucifera</i>	COCONUT PALM	10		15	15	177	REMAIN	GOOD			
8	<i>Cocos nucifera</i>	COCONUT PALM	7		15	15	177	REMAIN	GOOD			
9	<i>Cocos nucifera</i>	COCONUT PALM	8		15	15	177	REMAIN	GOOD			
10	<i>Cocos nucifera</i>	COCONUT PALM	8		15	15	177	REMAIN	GOOD			
11	<i>Cocos nucifera</i>	COCONUT PALM	8		15	15	177	REMAIN	GOOD			
12	<i>Cocos nucifera</i>	COCONUT PALM	8		15	15	177	REMAIN	GOOD			
13	<i>Cocos nucifera</i>	COCONUT PALM	8		15	15	177	REMAIN	GOOD			
14	<i>Cocos nucifera</i>	COCONUT PALM	8		15	15	177	REMAIN	GOOD			
15	<i>Cocos nucifera</i>	COCONUT PALM	7		15	15	177	REMAIN	GOOD			
16	<i>Cocos nucifera</i>	COCONUT PALM	7		15	15	177	REMAIN	GOOD			

UNITS REMOVED FROM ROW		3,780
UNITS REMOVED FROM SITE		334
TOTAL UNITS REMOVED:		334
PROPOSED ON SITE MITIGATION BREAKDOWN:		
CATEGORY 1 TREE 2" CAL/12' HT MIN:	credit/tree	
CATEGORY 2 TREE 2" CAL/10' HT MIN:	2 150	Category 1 Tree = 300sf credit/tree
CATEGORY 3 TREE 2" CAL/8' HT MIN:	3 100	Category 2 Tree = 150sf credit/tree
CATEGORY 4 PALM 6' CLR TRUNK MIN:	7 50	Category 3 Tree = 100sf credit/tree
TOTAL PROPOSED REPLACEMENT TREES (REFER TO PLANTING PLANS):		13 COMBINATION FULFILLS SITE MITIGATION OF CANOPY SF: 1,250

LAND

2510 NORTH MIAMI AVENUE
MIAMI, FL 33127
614.439.4895
WWW.LAND.DESIGN

AXEL HOTEL

1500 COLLINS AVENUE | MIAMI BEACH, FL 33139

SEAL
(MARSH C. KRIPLEN LIC.FL LA6667007)
NOT FOR CONSTRUCTION

11.5.18

TREE DISPOSITION NOTES &
SCHEDULE

DATE _____ ISSUE _____
05/04/2018 HPS SUBMITTED

TD100

© COPYRIGHT LAND

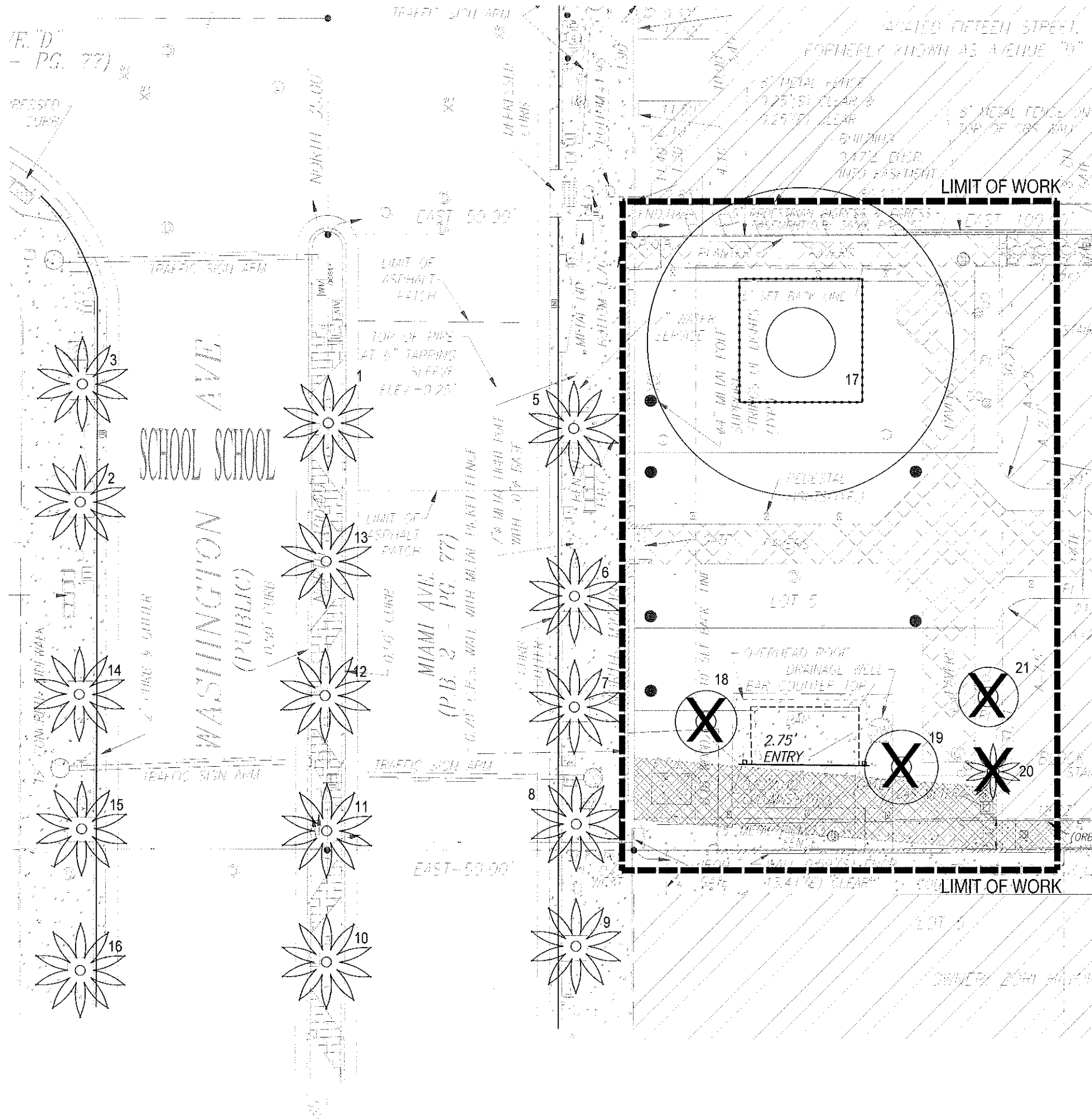

TREE DISPOSITION LEGEND

- TREE TO BE PRESERVED
- TREE TO BE RELOCATED
- PALM TO BE PRESERVED
- PALM TO BE RELOCATED
- TREE TO BE REMOVED
- PALM TO BE REMOVED
- LIMIT OF WORK
- TREE PROTECTION

LAND

2610 NORTH MIAMI AVENUE
MIAMI, FL 33127
314.439.4895
WWW.LAND.DESIGN

AXEL HOTEL

1500 COLLINS AVENUE | MIAMI BEACH, FL 33139

SEAL
(MARSH C. KRIELEN LIC. FL. LA6667007)
NOT FOR CONSTRUCTION

05.15.18

TREE DISPOSITION PLAN
DATE _____ ISSUE _____

05/04/2018 A.S. REPRESENTATIVE



SCALE 1/8"=1'-0"

TD101

© 2018 LAND DESIGN

PLANTING NOTES

1. PLANT MATERIAL IS TO BE HEALTHY SPECIMENS FREE FROM DISEASE OR DAMAGE, AND IS TO BE MAINTAINED IN EXCELLENT CONDITION WHILE ON THE JOBSITE. LANDSCAPE ARCHITECT SHALL INSPECT PLANT MATERIAL UPON ARRIVAL TO JOBSITE AND WILL REJECT PLANT MATERIAL THAT DOES NOT MEET THE STANDARDS DESCRIBED WITHIN THE CONTRACT DOCUMENTS.
2. THE LANDSCAPE ARCHITECT WILL PERIODICALLY INSPECT PLANT MATERIAL STOCKPILED AND/OR PLANTED ON SITE DURING THE COURSE OF CONSTRUCTION. PLANT MATERIAL NOT MEETING THE STANDARDS CONTAINED WITHIN CONTRACT DOCUMENTS SHALL BE REPLACED AT NO COST TO THE OWNER.
3. PROVIDE MATCHING SIZES AND FORMS FOR EACH PLANT OF THE SAME SPECIES UNLESS OTHERWISE INDICATED.
4. CONTRACTOR TO VERIFY ALL QUANTITIES. IN CASE OF DISCREPANCIES, GRAPHICALLY SHOWN QUANTITIES SHALL TAKE PRECEDENCE.
5. ALL MATERIALS USED SHALL CONFORM TO THE GUIDELINES ESTABLISHED BY THE CURRENT AMERICAN STANDARDS FOR NURSERY STOCK, PUBLISHED BY THE AMERICAN ASSOCIATION OF NURSERYMEN.
6. ALL PLANT MATERIAL SHALL BE INSTALLED PLUMB AND PER THE SPECIFICATIONS CONTAINED WITHIN THE CONTRACT DOCUMENTS. ANY NECESSARY STAKING AND/OR OTHER SUPPORTS MATERIALS/METHODS SHALL BE SUBMITTED TO THE LANDSCAPE ARCHITECT FOR REVIEW AND APPROVAL PRIOR TO INSTALLATION.
7. THE CONTRACTOR SHALL PRUNE EXISTING AND/OR NEW TREES ONLY PER LANDSCAPE ARCHITECT DIRECTION.
8. THE CONTRACTOR SHALL STAKE THE LOCATIONS OF ALL TREES AND B&B SHRUBS FOR LANDSCAPE ARCHITECT REVIEW AND APPROVAL, PRIOR TO INSTALLATION.
9. ALL ROOT-WRAPPING MATERIALS THAT ARE NOT BIO-DEGRADABLE SHALL BE REMOVED FROM THE ROOT BALL. ROOT BALLS SHALL BE FREE OF WEEDS.
10. SPECIFIED PLANT MATERIAL SIZES SHALL BE CONSIDERED MINIMUM SIZES.
11. FINISH GRADE OF PLANTING BEDS SHALL BE ONE (1) INCH BELOW ADJACENT FLATWORK, UNLESS SPECIFIED OTHERWISE.
12. MULCH OR PLANTING BED DRESSING SHALL BE PLACED IN ALL PLANTING AREAS AS SPECIFIED. MULCH OR PLANTING BED DRESSING SHALL NOT BE PLACED WITHIN SIX (6) INCHES OF TREE TRUNKS. MULCHING SHOULD BE REPEATED ANNUALLY DURING THE AUTUMN TO A THREE (3) INCH DEPTH.
13. ALL PLANT MATERIAL SHOULD RECEIVE AN ORGANIC FERTILIZER IN LIMITED APPLICATION FOLLOWING INSTALLATION. TYPE AND APPLICATION RATE AND METHOD OF APPLICATION TO BE SPECIFIED BY THE CONTRACTOR AND APPROVED BY THE LANDSCAPE ARCHITECT.
14. EXCESS FERTILIZER SHALL BE DISPOSED OF PROPERLY OFF-SITE. IT SHALL NOT BE DISPOSED OF IN STORM DRAINS AND/OR DRYWELLS.
15. STOCKPILED PLANT MATERIAL TO BE PLACED IN THE SHADE AND PROPERLY HAND-WATERED UNTIL PLANTED.
16. MINI-NUGGET TYPE DECORATIVE BARK MULCH WILL BE USED TO RETURN NUTRIENTS TO THE SOIL, REDUCE MAINTENANCE AND MINIMIZE EVAPORATION FOR AREAS APPROXIMATE TO THE RESIDENCE. LARGER SHREDDED BARK MULCH WILL BE USED FOR STEEP AREAS SO SLOUGHING IS LESS LIKELY TO OCCUR.
17. PRESERVE & PROTECT ALL EXISTING VEGETATION INDICATED TO REMAIN AT ALL TIMES.
18. ALL VEGETATION PROPOSED FOR OUTSIDE THE BUILDING ENVELOPE TO BE NATIVE UNLESS OTHERWISE NOTED. PLANTING THAT OCCURS OUTSIDE THE BUILDING ENVELOPE IS FOR RESTORATION PURPOSES ONLY OR IS SPECIFIC TO UTILITIES RESTORATION.
19. SIX (6) INCH PLANT MIX SHALL BE PROVIDED FOR ALL LAWN, TURF, AND NATIVE PLANTING ZONES. 18 INCH PLANT MIX SHALL BE PROVIDED FOR ALL PERENNIAL PLANTING BEDS UNLESS OTHERWISE NOTED.
20. LANDSCAPE CONTRACTOR SHALL GUARANTEE ALL NEW TREES AND PALMS FOR A PERIOD OF 1-YEAR FROM DATE OF INITIAL ACCEPTANCE.
21. A FINAL ONSITE INSPECTION SHALL BE REQUIRED WITH URBAN FORESTRY DIVISION STAFF PRIOR TO ANY OFFICIAL ACCEPTANCE OF ROW PLANT MATERIAL, IN ORDER TO VERIFY PROPER PLANTING DEPTH, SPACING AND QUALITY OF MATERIAL. FAILURE TO CONDUCT THE INSPECTION COULD RESULT IN REJECTION OF THE PLANT MATERIAL.

PLANTING SCHEDULE

EXISTING TREES TO REMAIN									
#	BOTANICAL NAME		COMMON NAME		DBH.	HT.	SPREAD	ACTION	NOTES
17	FICUS BENGHALENSIS		BANYAN TREE		60"	35'	50'	REMAIN	

PALMS				
ABR.	QUANTITY	BOTANICAL NAME	COMMON NAME	SPECIFICATIONS
CNU	5	COCOS NUCIFERA	COCONUT PALM	CHARACTER CURVE TRUNK 25' OA
SPA	11	SABAL PALMETTO	CABBAGE PALM	CHARACTER CURVE TRUNK 30" OA

TREES				
CGR	4	CAESALPINIA GRANADILLO	BRIDALVEIL	200 GALLON, 4" CAL. 12' HEIGHT MIN.
CRO	3	CLUSIA ROSEA	AUTOGRAPH TREE	200 GALLON, 2" CAL. 10' HEIGHT MIN. MULTI.
CUV	1	COCOLOBA UVIFERA	SEA GRAPE	300 GALLON, 4" CAL. 12' HEIGHT MIN. MULTI.
PRA	6	PIMENTA RACEMOSA	BAY RUM	25 GALLON, 2" CAL. 8' HEIGHT MIN.

SHRUBS & GROUNDCOVERS				
AT	312	ASCLEPIAS TURBEROSA	ORANGE BUTTERFLY PLANT	3 GAL. 18" O.C.
MS	20	MICROSORUM SCOLOPENDRIUM	WART FERN	3 GAL. 24" O.C.
MD	130	MONSTERA DELICIOSA	MONSTERA	3 GAL. 24" O.C.
NB	129	NEPHROLEPIS BISERRATA	MACHO FERN	3 GAL. 24" O.C.
PB	394	PHILODENDRON BURLE MARX	PHILODENDRON	3 GAL. 18" O.C.
CONTRACTOR TO PROVIDE LANDSCAPE ARCHITECT WITH \$6,000 WHOLESALE PLANT ALLOWANCE FOR ORCHIDS, AND ACCENTS				

AXEL HOTEL

1500 COLLINS AVENUE | MIAMI BEACH, FL 33139

SEAL
(MARSH C. KRIPLIN LIC. FL. LA6667007)
NOT FOR CONSTRUCTION

PLANTING SCHEDULE & NOTES
DATE: 05.15.18
ISSUE: 1



L400

© COPYRIGHT LAND

WASHINGTON AVE.

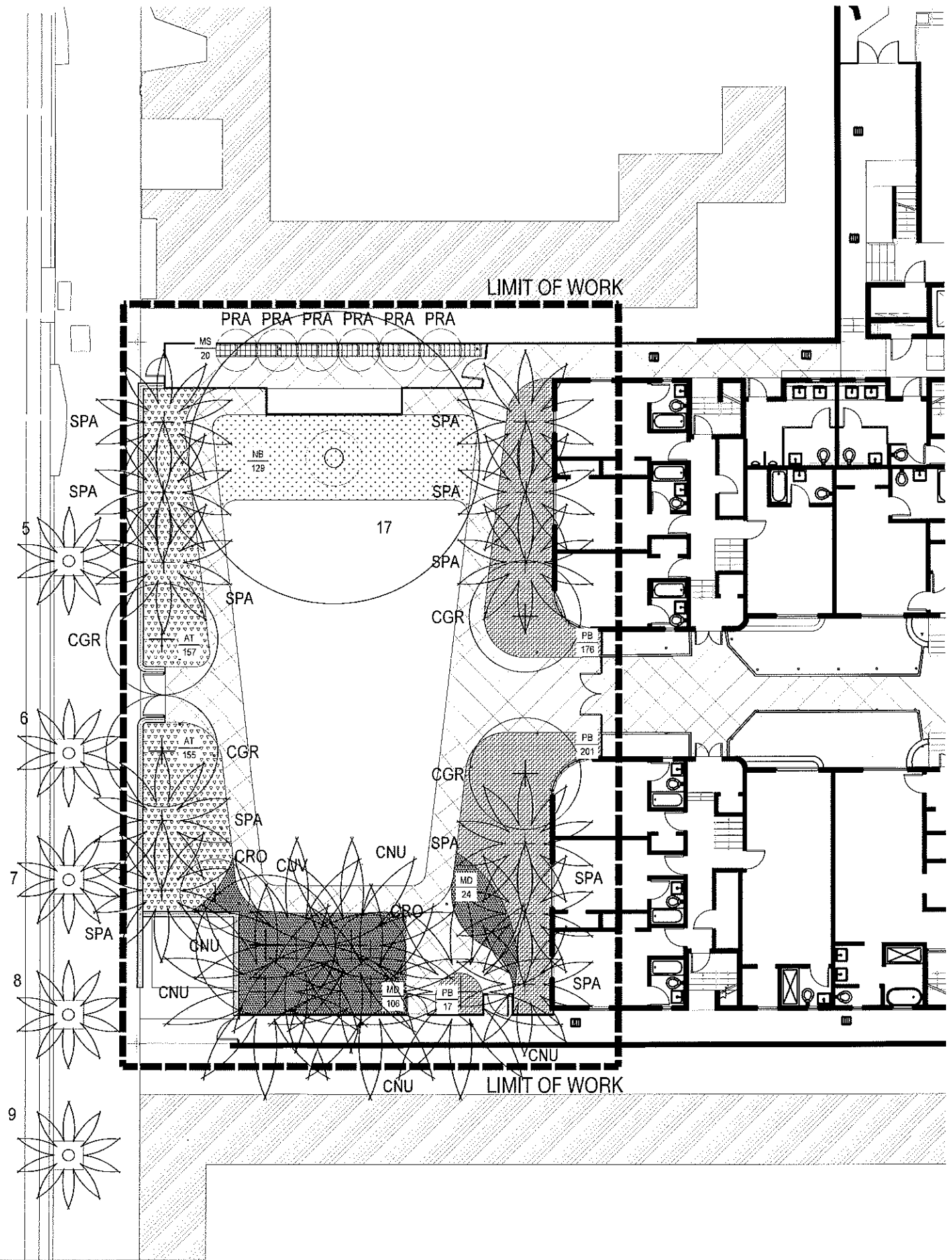

PLANTING LEGEND

- TREE TO BE PRESERVED
- PROPOSED TREE
- PALM TO BE PRESERVED
- PROPOSED PALM

UNDERSTORY LEGEND

- AT, ASCLEPIAS TUBEROSA
- NB, NEPHROLEPIS BISERRA
- MS, MICROSORUM SCOLOPENDRIUM
- PB, PHILODENDRON BURLE
- MD, MONSTERA DELICIOSA
- LIMIT OF WORK

LAND

2010 NORTH MIAMI AVENUE
MIAMI, FL 33127
614.439.4895
WWW.LAND.DESIGN

AXEL HOTEL

1500 COLLINS AVENUE | MIAMI BEACH, FL 33139

SEAL
(MARSH C. KRIPLIN LIC. FL. LA6667007)
NOT FOR CONSTRUCTION

PLANTING PLAN
DATE: 05/04/2015
ISSUE: 01/16/2015



0 4' 8'

SCALE 1/8"=1' - 0"

L401

© 2015 LAND DESIGN

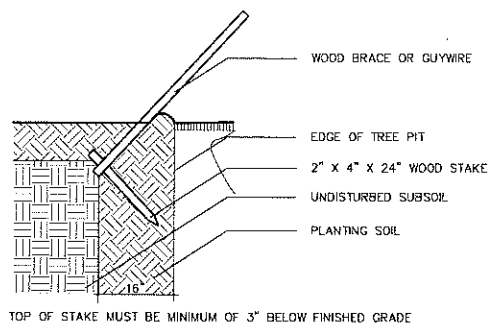

9 STAKING DETAIL
SCALE: NOT TO SCALE

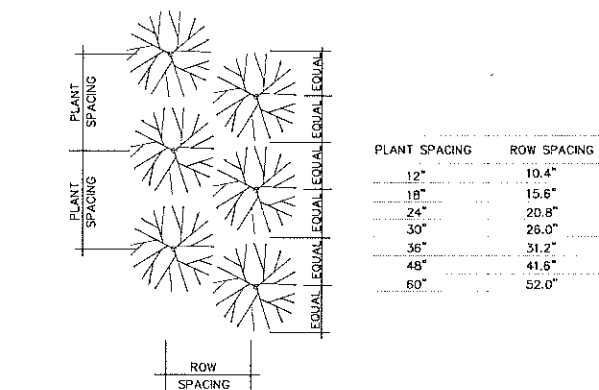

6 PLANT SPACING
SCALE: NOT TO SCALE

NOTE:
IN MOST CASES TRIANGULAR
SPACING IS PREFERRED. USE
SQUARE SPACING ONLY IN
SMALL RECTILINEAR AREAS.

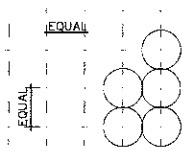

TYPICAL PLANT SPACING

SQUARE SPACING PLAN

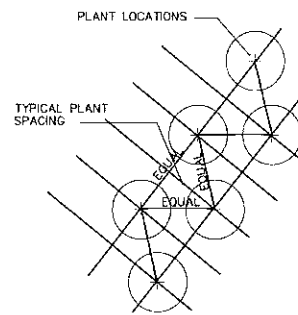

TRIANGULAR SPACING PLAN

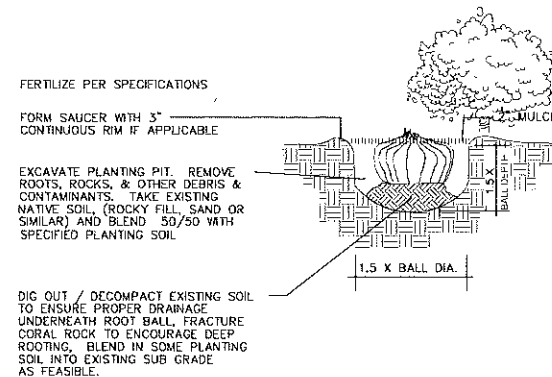

1 SHRUB PLANTING
SCALE: NOT TO SCALE

PREPARATION:
STORE ALL MATERIAL IN DRY, CLEAN AREA, COVER TO PROTECT FROM RAIN AND
MINIMIZE DUST. COORDINATE RUN-OFF CONTROL WITH GENERAL CONTRACTOR.
TEST EXISTING SOIL TO ENSURE IT IS FREE OF EXCESSIVE CLAY OR SALT AND ANY
CHEMICALS/PETROCHEMICALS WHICH MAY HARM PLANT HEALTH.

EXISTING MATERIAL:
IF INCORPORATING EXISTING SITE SOIL REMOVE ALL ROOTS, AND ROCK LARGER THAN
2" IN SIZE. REMOVE ALL PLASTIC, METAL AND MANMADE DETRITUS.

MIX:
50% EXISTING SOIL
10% COCO PEAT
10% COMPOST
20% CLEAN SAND
10% PERLITE

BLEND QUANTITIES NEEDED BY HAND OR MACHINE.

INSTALLATION:
REFER TO APPROPRIATE DETAILS FOR AMENDMENTS, COMPACTION DEPTHS ETC.

GENERAL: REFER TO LANDSCAPE NOTES FOR ADDITIONAL INFORMATION

10 PLANTING SOIL- TYPICAL

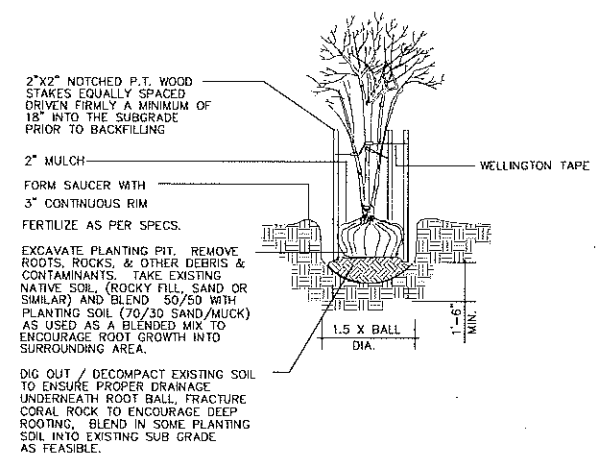

7 MULTI TRUNK TREE- PLANTING & STAKING
SCALE: NOT TO SCALE

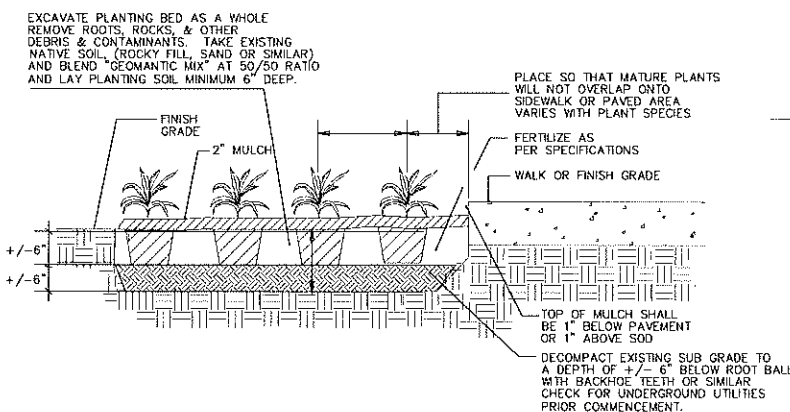

4 SHRUB- HEDGE AND MASS PLANTING
SCALE: NOT TO SCALE

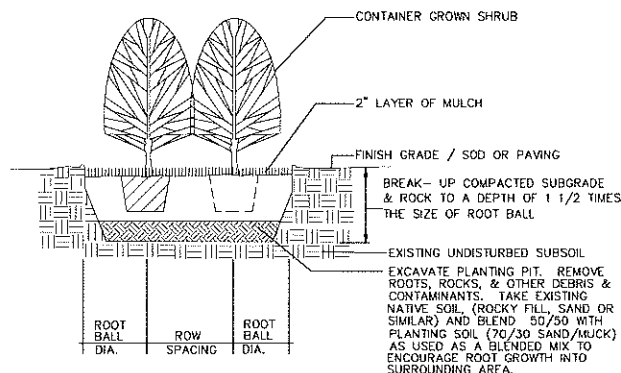

2 SHRUB- HEDGE AND MASS PLANTING
SCALE: NOT TO SCALE

MULCH A:
PINE STRAW, FOR USE IN GENERAL PLANTING AREAS AND ON SLOPES
GREATER THAN 10%

MULCH B:
MINI PINE BARK NUGGETS, FOR USE IN SPECIALTY AREAS

MULCH C:
MELALEUCA MULCH, FOR USE IN GENERAL PLANTING AREAS AND ON
SLOPES GREATER THAN 10%

BLEND QUANTITIES NEEDED BY HAND OR MACHINE.

INSTALLATION:
REFER TO APPROPRIATE DETAILS FOR EXTENTS AND DEPTHS.

GENERAL: REFER TO LANDSCAPE NOTES FOR ADDITIONAL INFORMATION,
CONFORM TYPE TO BE USED WITH LANDSCAPE ARCHITECT PRIOR TO
INSTALLATION.

11 MULCH- TYPICAL

MIX:
5050- MUCK AND FINE SAND
SUPPLIER: ATLAS PEAT AND SOIL 561.734.7300

12 PLANTING SOIL- LAWN TOP DRESSING

CALIPER	TIES	STRANDS	STAKES
1" - 1 1/2"	2	1 # 12	2 - 2 X 2
1 1/2" - 2"	3	1 # 12	3 - 2 X 2
2" - 3"	3	2 # 12	2 - 2 X 2

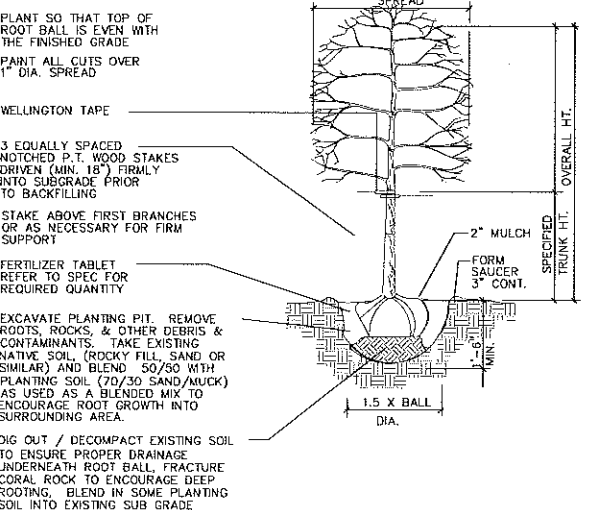

NOTE:
USE FOR 3" OR LESS SINGLE STEM TREES & PALMS

8 CANOPY AND PALM TREE- PLANTING & VERTICAL STAKING
SCALE: NOT TO SCALE

CALIPER	CLEATS	STRAPS	BRACES	NAILS
3" - 8"	2 x 4 x 8"	1 # 12	3 - 2 X 4	2 - 16d
8" - 10"	2 x 4 x 12"	1 # 12	3 - 2 X 4	3 - 16d
10" - 16"	2 x 4 x 12"	2 # 12	4 - 2 X 4	3 - 16d

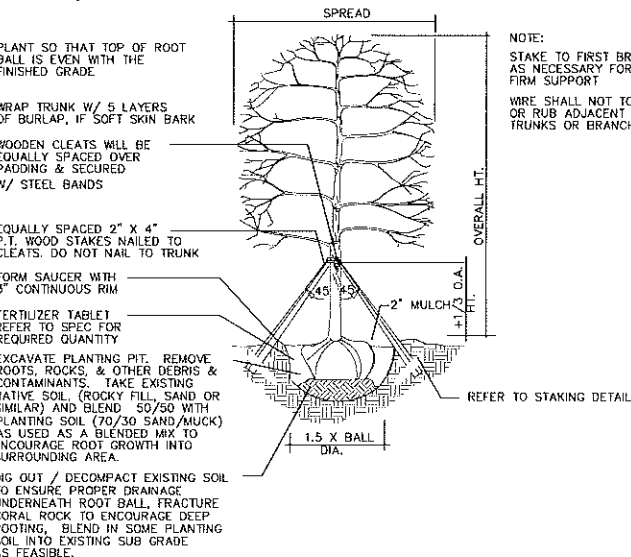

NOTE:
USE FOR 3" TO 12" SINGLE TRUNK TREES

5 CANOPY TREE- PLANTING & TRIPLE BRACE STAKING
SCALE: NOT TO SCALE

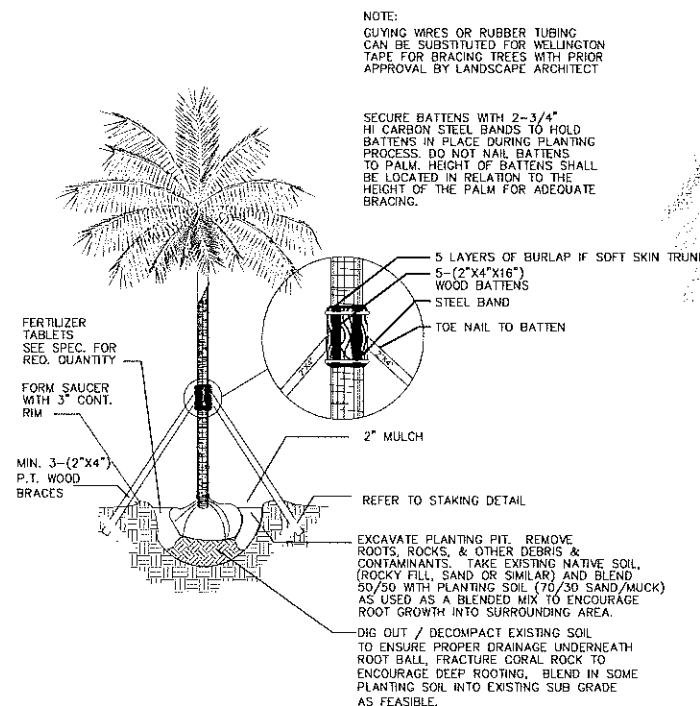

3 PALM- PLANTING & STAKING
SCALE: NOT TO SCALE

SEAL
(MARSH C. KRIPLEY LIC. FLA 06667007)
NOT FOR CONSTRUCTION

PLANTING DETAILS
DATE: 05-15-18 ISSUE: 1

SCALE AS NOTED: