

BP 1501, LLC.

1211 ALTON ROAD
MIAMI BEACH, FL. 33139

JOB TITLE:

HISTORIC PRESERVATION
BOARD

1501 MICHIGAN AVE,
MIAMI BEACH, FL. 33139

SHEET TITLE:

EXISTING TREE SURVEY
AND DISPOSITION PLAN

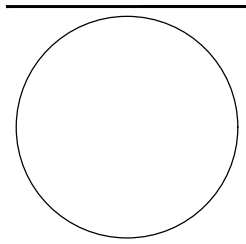

STRUCTURAL ENGINEER
JOSE LUIS GUZMAN
4869 SW 75th AVE.
MIAMI, FL. 33155
786-338-1082 PE 56138
LANDSCAPE ARCHITECT & PLANNER
VINCENT FILIGENZI
5130 CHEROKEE AVE
MIAMI BEACH, FL. 33140
786-346-8909 RLA 6667191
LANDSCAPE CONSULTANT
PAUL LORENZO
7915 EAST DR. #1A.
NORTH BAY VILLAGE, FL. 33141
786-453-2455

REVISIONS:
SHEET:

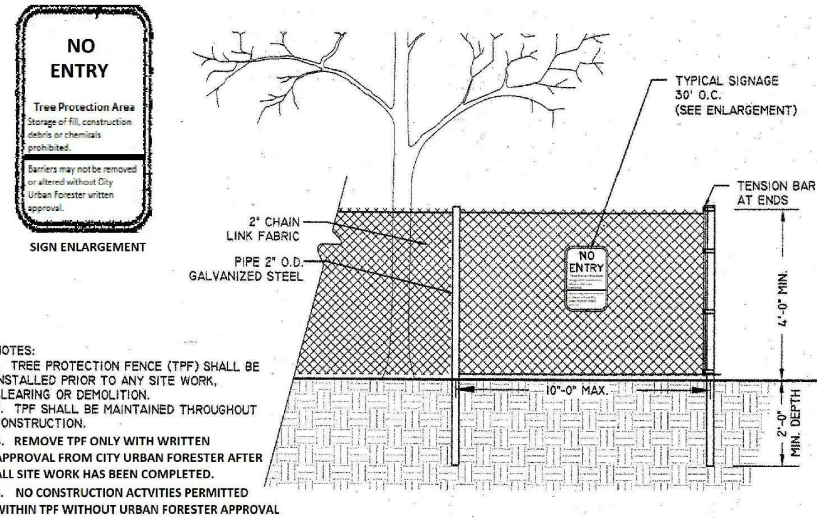
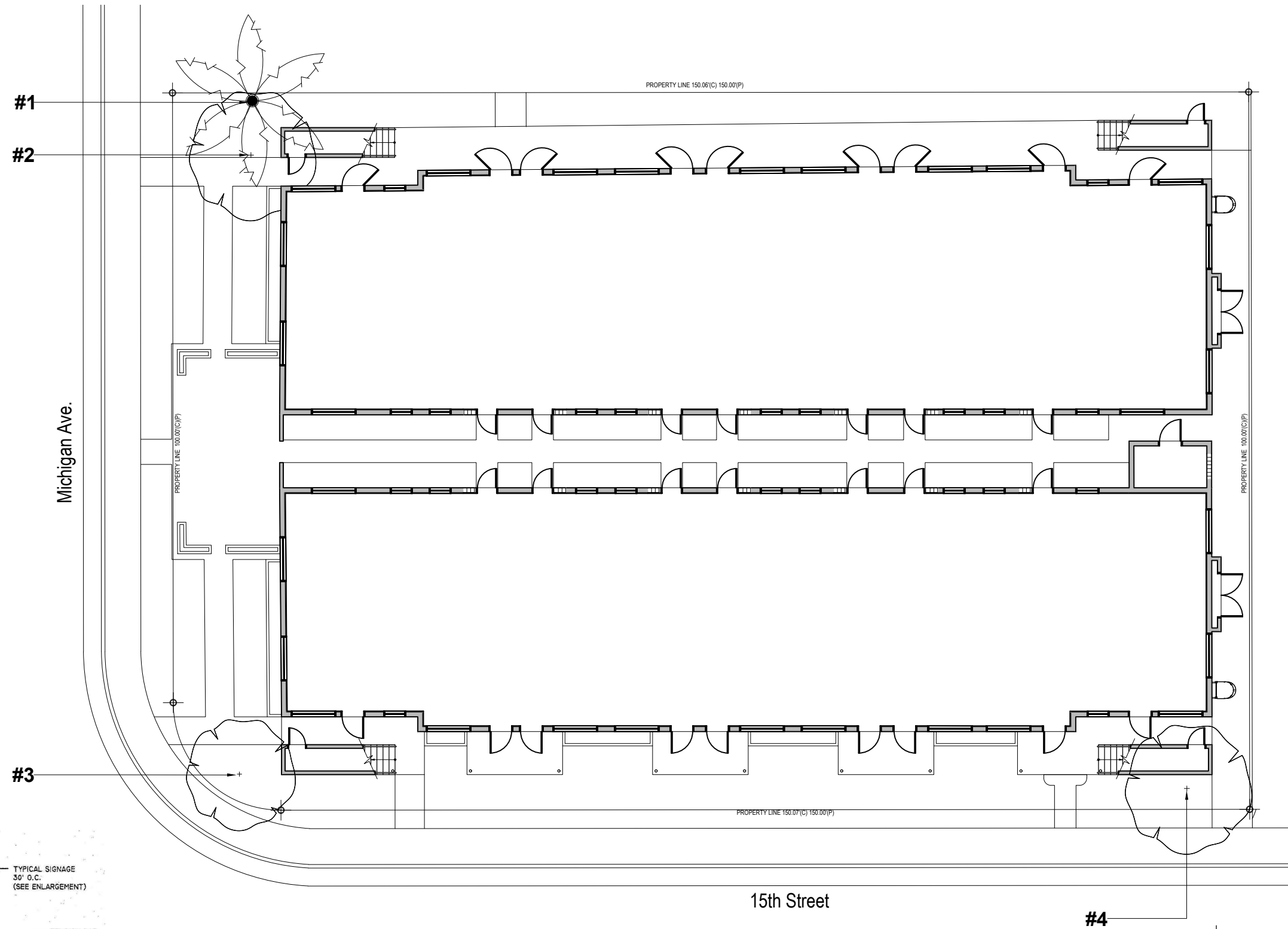

NOTES:
1. TREE PROTECTION FENCE (TPF) SHALL BE INSTALLED PRIOR TO ANY SITE WORK, CLEARING OR DEMOLITION.
2. TPF SHALL BE MAINTAINED THROUGHOUT CONSTRUCTION.
3. REMOVE TPF ONLY WITH WRITTEN APPROVAL FROM CITY URBAN FORESTER AFTER ALL SITE WORK HAS BEEN COMPLETED.
4. NO CONSTRUCTION ACTIVITIES PERMITTED WITHIN TPF WITHOUT URBAN FORESTER APPROVAL

2 4' CHAIN LINK TREE PROTECTION FENCE
SCALE: NTS

1 EXISTING TREE SURVEY AND DISPOSITION LEGEND
SCALE: 1/16" = 1'-0"

#	Name - Common (Scientific)	SIZE			NATIVE		CONDITION	DISPOSITION
		DBH	HEIGHT	SPREAD (DIAM)	YES	NO		
1	COCONUT (<i>Cocos nucifera</i>)	13"	35'-CT-20'	24'		x	GOOD	REMAIN
2	UMBRELLA TREE (<i>Schefflera actinophylla</i>)	29"	27'	24'		X	GOOD	REMOVE (PROHIBITED SPECIES)
3	WHITE BIRD OF PARADISE (<i>Strelitzia Nicolai</i>)	4 TRUNKS AT 8" ea.	24'	16'		X	GOOD	REMOVE
4	WHITE BIRD OF PARADISE (<i>Strelitzia Nicolai</i>)	6 TRUNKS AT 8" ea.	25'	22'		X	GOOD	REMOVE

NOTE
PRIOR TO REMOVAL OF THE GIANT BIRD OF PARADISE A PERMIT MUST BE OBTAINED FROM THE CMB URBAN FORESTRY DIVISION.

NOTES

1. MULCH - INSTALL 'FLORIMULCH' 3" DEEP IN ALL SHRUB AREAS EXCEPTED WHERE NOTED MULCH TO BE GRAVEL.
2. LAWN TO BE ST. AUGUSTINE 'PALMETTO'. REFER TO SHEET L-3 FOR INSTALLATION TECHNIQUES.
3. ALL PLANT MATERIALS SHALL CONFORM TO, OR EXCEED, THE MINIMUM STANDARDS FOR FLORIDA NO. 1 GRADE OR EQUIVALENT IN THE MOST CURRENT EDITION OF THE FLORIDA GRADES AND STANDARDS FOR NURSERY PLANTS PREPARED BY THE STATE OF FLORIDA DEPARTMENT OF AGRICULTURE AND CONSUMER SERVICES.
4. GUARANTEE: THERE SHALL BE A ONE YEAR GUARANTEE ON ALL PLANT MATERIALS INSTALLED AT THIS SITE. THE WARRANTY SHALL BE PROVIDED BY THE SUB CONTRACTOR RESPONSIBLE FOR INSTALLATION. DEFECTIVE OR DYING PLANTS MUST BE REPLACED WITHIN 2 WEEKS OF NOTIFICATION SUCH PLANTS NEED TO BE REPLACED.
5. TREE STAKING: THE SUB CONTRACTOR SHALL MAINTAIN ALL TREE SUPPORTS FOR ONE YEAR. THIS SHALL INCLUDE ADJUSTMENTS TO SUPPORTS TO INSURE ALL TREE TRUNKS ARE MAINTAINED IN A VERTICAL POSITION. AFTER ONE YEAR THE SUB CONTRACTOR WILL REMOVE ALL STAKES AND RELATED MATERIALS.
6. SPRINKLER SYSTEM: REFER TO PAGE L-4 "SPRINKLER SYSTEM". SPRINKLER SYSTEM SHALL CONSIST OF A BACK FLOW PREVENTION DEVICE, DIGITAL TIMER, RAIN SENSOR, ELECTRIC VALVES, POP UP SPRAY HEADS, PVC MAIN LINE AND LATERAL LINES.
7. REFER TO SHEET L-3 FOR TYPICAL PLANT INSTALLATION DETAILS.
8. PRIOR TO REMOVAL OF THE GIANT BIRD OF PARADISE A PERMIT MUST BE OBTAINED FROM THE CMB URBAN FORESTRY DIVISION.

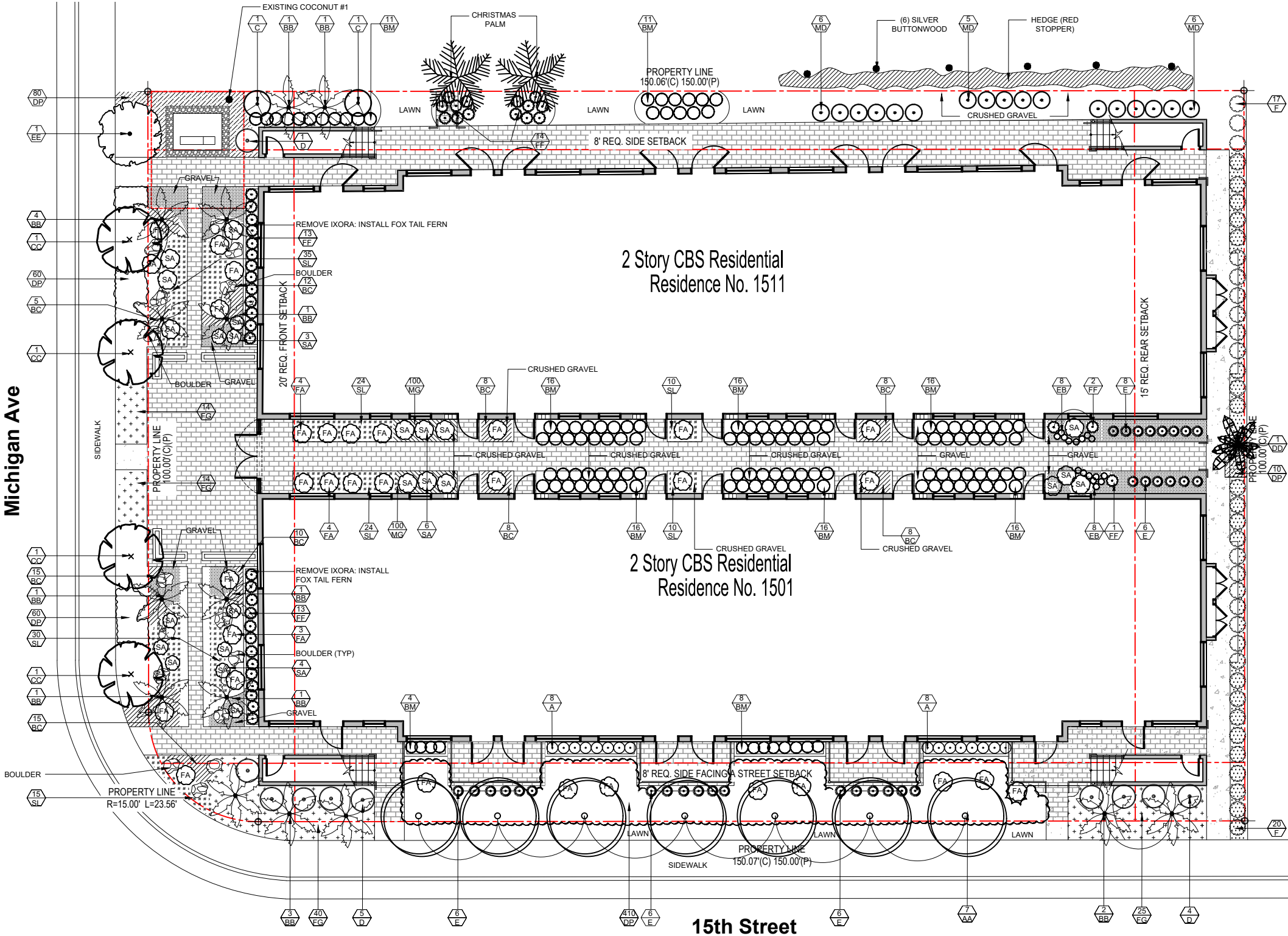

15th Street

1 PROPOSED LANDSCAPE PLAN
SCALE: 1/16" = 1'-0"

#	Name - Common (Scientific)		SIZE	QTY	NATIVE	
	TREES AND PALMS				YES	NO
AA	SILVER BUTTONWOOD	(Conocarpus erectus sericeus)	45 gal. 12'-14 'ht x 6' sp. 3" cal., min 3 trunks, CT 4' min	7	X	
BB	MONTGOMERY PAL	(Veitchia montgomeriana)	single 14'-16' OA x 6' sp.	13		X
CC	AUTOGRAPH TREE	(Clusia rosea)	45 gal. std 12'-14' ht, 5'-6'sp x 3" cal trunk	4	X	
DD	CHRISTMAS PALM	(Adonidia merrillii)	TPL 12'-14'HT x 6'sp	1		X
EE	PINK TRUMPET TREE	(Tabebuia heterophylla)	45 gal. 12'-14'HT x 6'sp, 3"cal.	1		X
SHRUBS						
A	DWARF CLUSIA	(Clusia rosea 'nana')	3 gal. 18" HT x 18" sp	16		X
B	AGAVE	(Agave lurida 'Variegata')	7 gal. 28" HT x 18"sp.	2		X
C	MEXICAN CYCAD	(Dioon spinulosum)	7 gal. 24"-36"	2		X
D	LITTLE LEAF CLUSIA	(Clusia guttifera)	25 gal. 6'-7'HT ,4'sp	10		X
E	GREEN COCOPLUM	(Chrysobalanus icaco)	3 gal. 18" HT x 18" sp	32	X	
F	RED STOPPER	(Eugenia rhombea)	3 gal. 18"-24" HT multi steam	37	X	

GROUNDCOVERS					
BC	BLUE CHALKSTICKS	(Senecio serpens)	1 gal.	91	X
BM	PHILODENDRON	(Philodendron 'Burle Marx)	3 gal.	130	X
DP	DECORATIVE PEANUT	(Arachis glabrata)	1 gal. FULL	560	X
EB	ECHEVERRIA	(Echeveria 'Blue Atoll')	1 gal.	16	X
FG	FOUNTAIN GRASS	(Pennisetum setaceum)	1 gal.	93	X
FA	FALSE AGAVE	(Furcracea foetida 'variegata')	7 gal. 2'-3'	29	X
FF	FOXTAIL FERN	(Asparagus densiflorus 'Meyersii')	1 gal.	44	X
MD	SWISS CHEESE	(Monstera deliciosa)	7 gal. 24"-30"	17	X
MG	MONDO GRASS	(Ophiopogon japonicas)	1 gal. FULL	100	X
SA	SOFT TIP AGAVE	(Agave attenuata)	3 gal.	28	X
SL	LEMON BALL SEDUM	(Sedum rupestre)	1 gal.	123	X

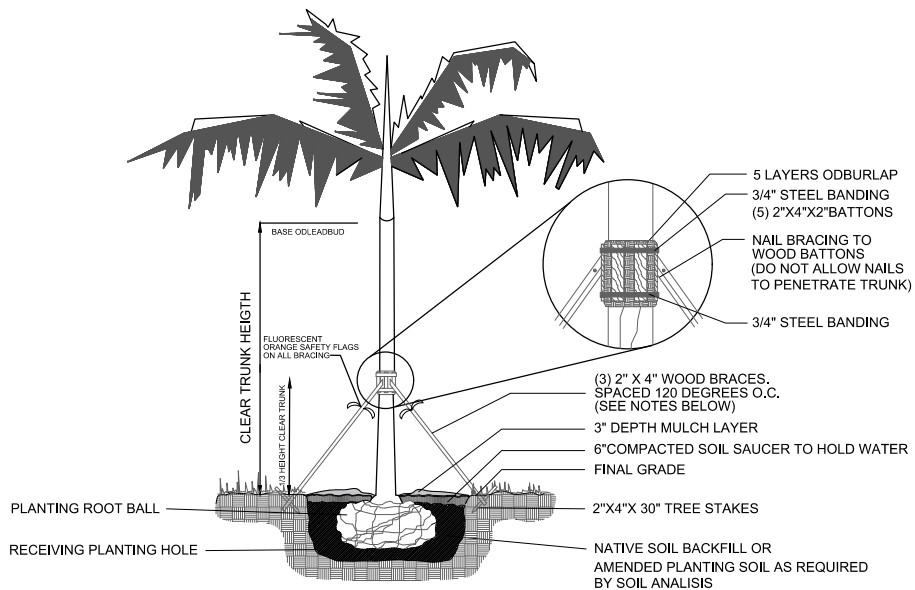

1. PALMS OVER 30' GW HEIGHT USE MINIMUM (4) BRACING AND STAKES
2. PRIMARY STAKES SHOULD BE PLACED PARALLEL TO WALKWAYS WHENEVER POSSIBLE
3. RECEIVING PLANTING HOLE SHALL BE APPROXIMATELY 1/3 LARGER THAN ROOT BALL
4. BUD SHALL BE PERPENDICULAR TO THE GROUND PLANE
5. TRUNK SHALL BE STRAIGHT AND WITHOUT CURVES
6. NO SCARRED OR BLACKENED TRUNKS
7. AMENDED SOIL MIX TO BE ADDED AT THE TIME OF PLANTING IF NEEDED, SHALL CONSIST OF A RATIO MIX OD80% CLEAN SILICA SAND AND 20% SCREENED, PULVERIZED TOPSOIL AS NEEDED.
8. ANCHORING STAKES SHALL BE DRIVEN A MINIMUM OD3" BELOW GRADE
9. MULCH SHALL BE AMERIGROW RECYCLED PINEBARK BROWN OR CITY APPROVED EQUIVALENT

1 CITY OF MIAMI BEACH
TYPICAL PALM PLANTING DETAIL
SCALE: NTS

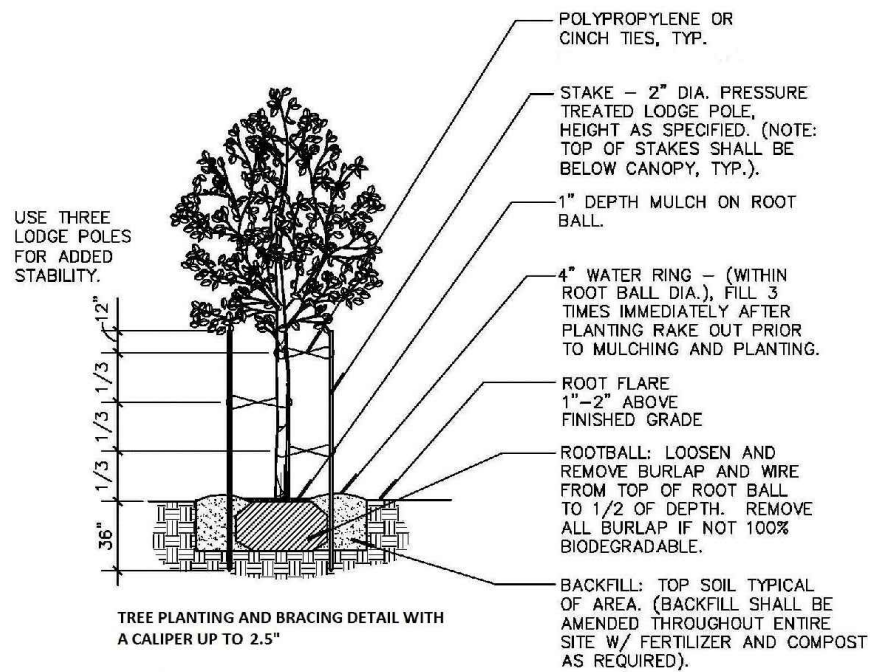

NOTES

1. MULCH SHALL BE AMERIGROW RECYCLED PREMIUM PINEBARK BROWN OR CITY APPROVED EQUIVALENT.
2. DO NOT APPLY MULCH WITHIN 6" OF THE TREE TRUNK

5 TREE PLANTING AND BRACING DETAIL
WITH A CALIPER UP TO 2.5"
SCALE: NTS

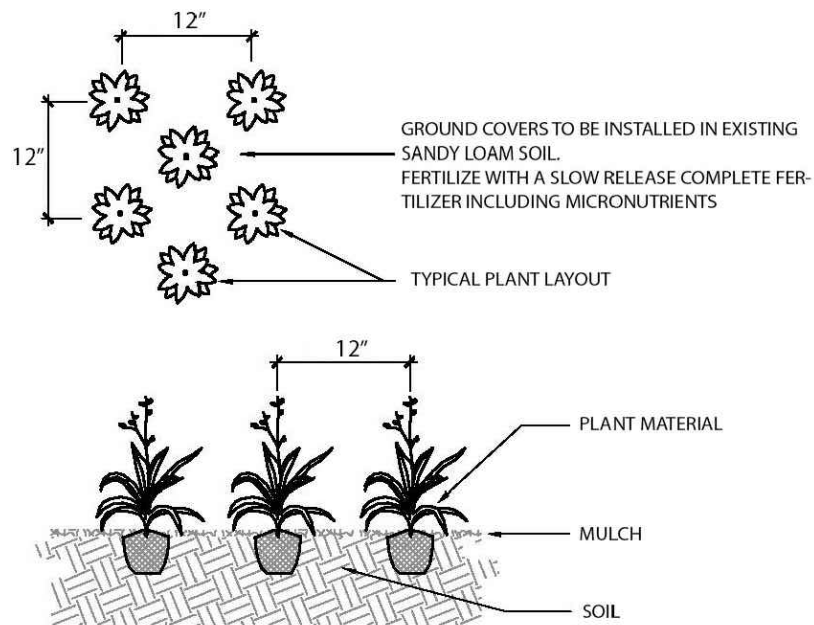

2 GROUND COVERS PLANTING DETAIL
SCALE: NTS

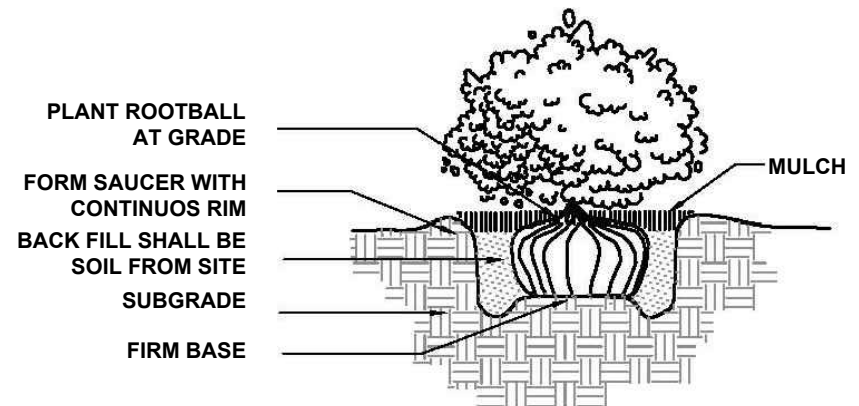

3 GROUND COVERS PLANTING DETAIL
SCALE: NTS

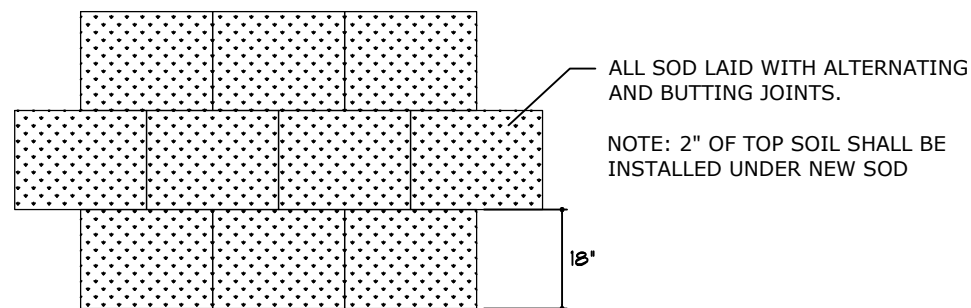

4 TYPICAL SOD DETAIL
SCALE: NTS

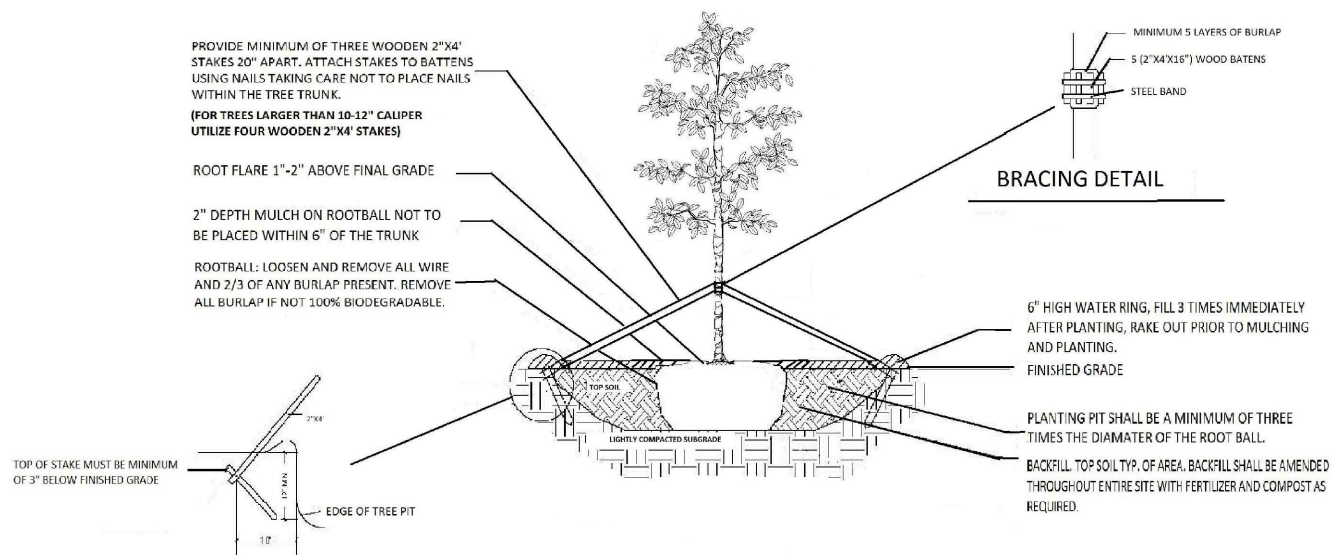

STAKING DETAIL

6 TREE PLANTING AND BRACING DETAIL
WITH A CALIPER OF 2.5" OR GREATER
SCALE: NTS

OWNER:

BP 1501, LLC.

1211 ALTON ROAD
MIAMI BEACH, FL. 33139

JOB TITLE:

HISTORIC PRESERVATION
BOARD

1501 MICHIGAN AVE,
MIAMI BEACH, FL. 33139

SHEET TITLE:

PLANTING TECHNIQUES

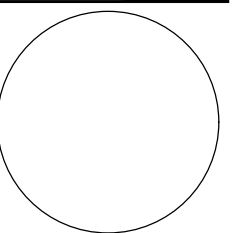

STRUCTURAL ENGINEER
JOSE LUIS GUZMAN
4869 SW 75th AVE.
MIAMI, FL. 33155
786-338-1082 PE 56138
LANDSCAPE ARCHITECT & PLANNER
VINCENT FILIGENZI
5130 CHEROKEE AVE
MIAMI BEACH, FL. 33140
786-346-8909 RLA 6667191
LANDSCAPE CONSULTANT
PAUL LORENZO
7915 EAST DR. #1A.
NORTH BAY VILLAGE, FL. 33141
786-453-2455

REVISIONS:

SHEET:

L1.03

PLOT DATE: 2018-03-02

NOTES

1. MAINLINE TO BE 1 1/2" PVC SCH 40
2. NEW RAIN BIRD ESP 4M TIMER W/ SENSOR TO BE INSTALLED ON EXTERIOR WALL
3. NEW RAIN BIRD SERIES VALVES 1
4. CONTRACTOR SHALL DETERMINE FINAL POSITIONING AND SPACING ODDSIGN

LEGEND

- R

NEW RAIN SENSOR - RAINBIRD
- T

NEW TIMER RAINBIRD ESP 4ME
- NEW 1 1/2" WILKINS RPZ BACKFLOW PREVENTOR
- PVC SLEEVE - SCH 40 SIZE NOTED ON PLAN
- SHUT - OFDVALVE
- MAINLINE 1 1/2" PVC SCHEDULE 40
- 1" RB VALVE W/ VALVE BOX
- RB SST PATTERN (SIDE STRIP)
- W

WATER METER
- POP UP SPRAY HEADS
(Spray Body: TORO 570Z-Pro Series 6" and 12" pop-ups)
- (Nozzles: TORO 570 Adjustable)
- STRIP NOZZLE - (on TORO 570Z Body) 6" and 12" pop-up risers.

1/2" - 2" ASSEMBLY
PRESSURE VACUUM BREAKER (PVB)
BACKFLOW PREVENTER (BFP)

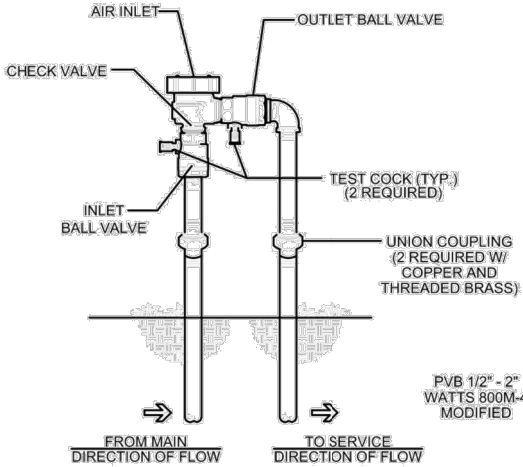

A PVB SHALL BE INSTALLED A MIN. OF 12" ABOVE THE HIGHEST POINT OF USE IN DOWN STREAM PIPING SUPPLIED BY OR FROM THE ASSEMBLY

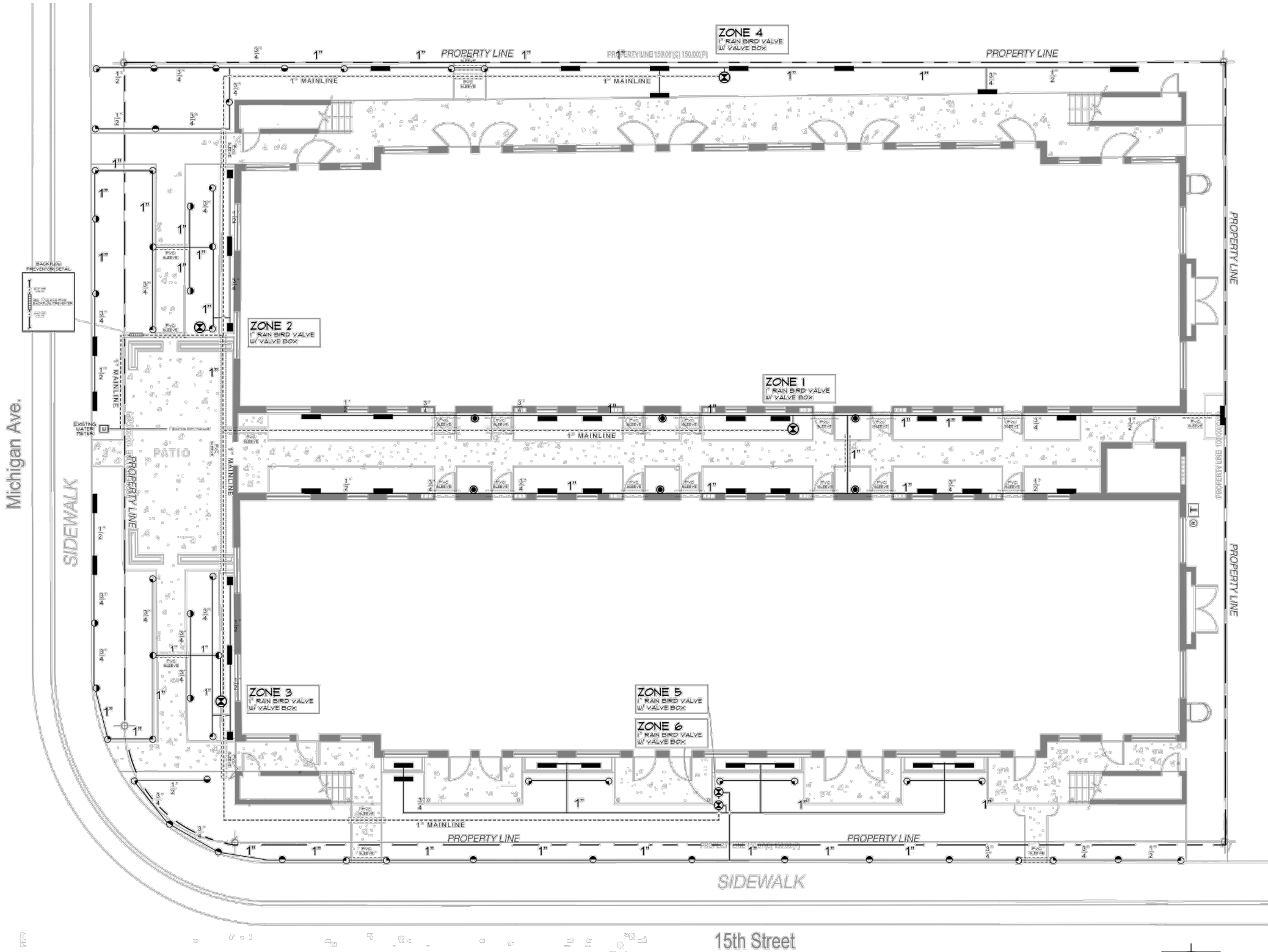

1 PROPOSED SPRINKLER DESIGN
SCALE: 1/16" = 1'-0"