

Morris Adjmi Architects
www.ma.com

O'Brien Lighting Inc

Washington
Squared LLC

Ken Fulk

Nichols Brosch Wurst
Wolfe & Associates

Raymond Jungles inc.

601-685 Washington Ave.
Miami Beach, FL

L-04 Ground Floor - Hardscape

Historic Preservation Board Interim Resubmittal / 17 March 2016

DRAWINGS NOT FOR CONSTRUCTION



SCALE: 1/16" = 1'-0"
@ 30" X 42"

HISTORIC PRESERVATION BOARD INTERIM RESUBMITTAL

601-685 Washington Avenue
Miami Beach, FL | March 17, 2016

JUNGLES

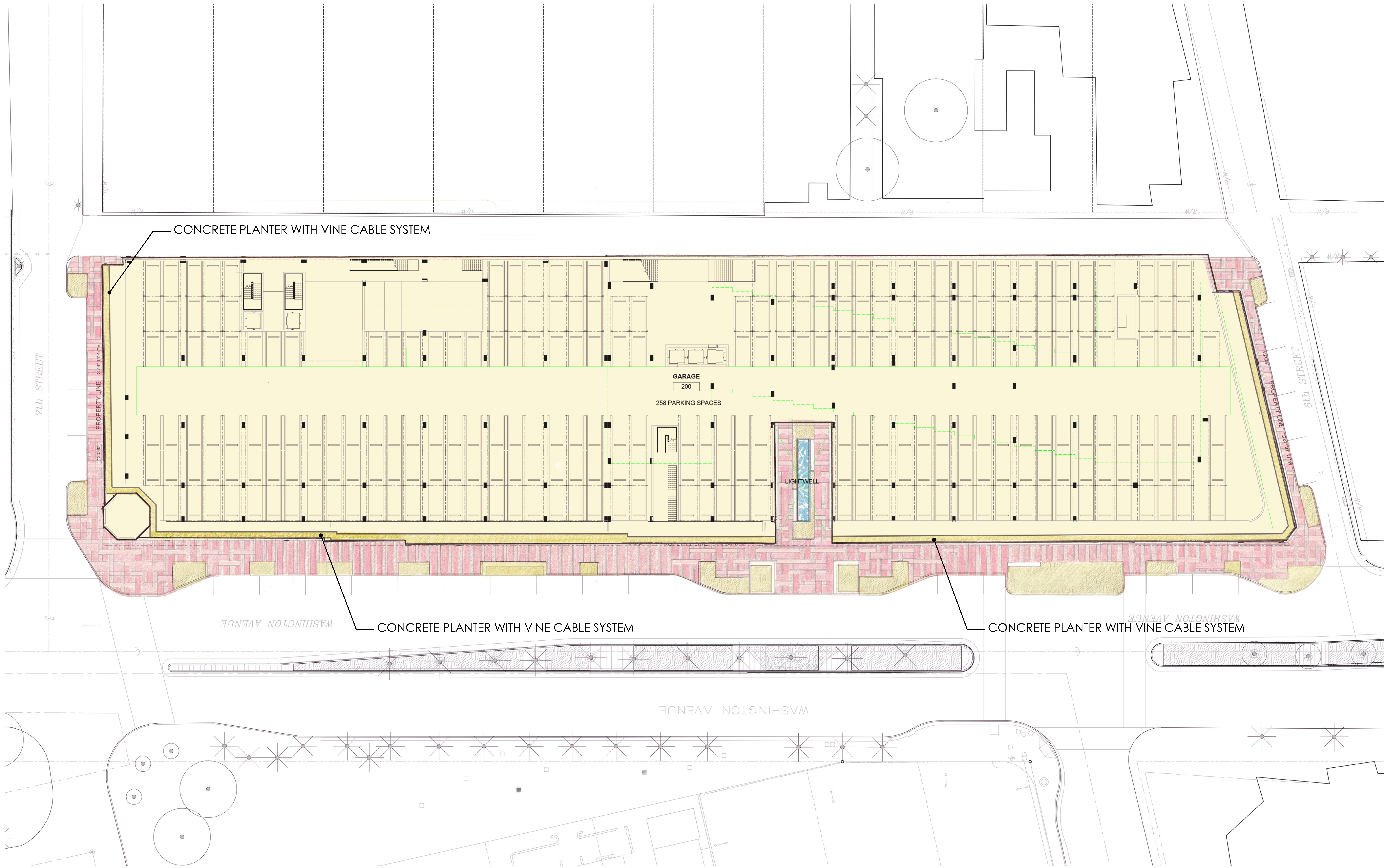

Morris Adjmi Architects
www.ma.com

O'Brien Lighting Inc

Washington
Squared LLC

Ken Fulk

Nichols Brosch Wurst
Wolfe & Associates

Raymond Jungles inc.

601-685 Washington Ave.
Miami Beach, FL

L-06 Second Level - Hardscape

Historic Preservation Board Interim Resubmittal / 17 March 2016

DRAWINGS NOT FOR CONSTRUCTION



0 8' 16' 32'
SCALE: 1/16" = 1'-0"
@ 30" X 42"

HISTORIC PRESERVATION BOARD INTERIM RESUBMITTAL

601-685 Washington Avenue
Miami Beach, FL | March 17, 2016

JUNGLES

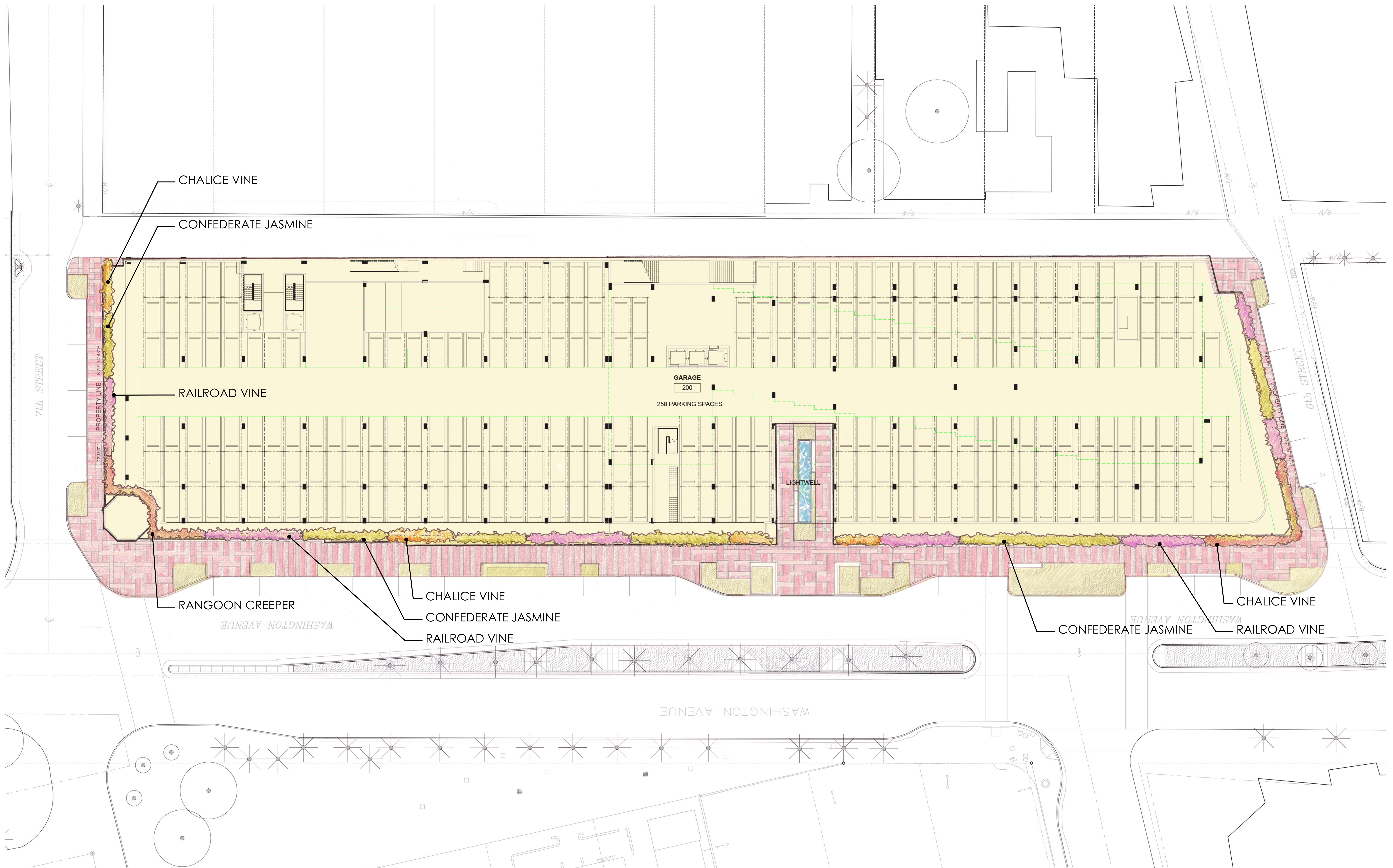

Morris Adjmi Architects
www.ma.com

O'Brien Lighting Inc

Washington
Squared LLC

Ken Fulk

Nichols Brosch Wurst
Wolfe & Associates

Raymond Jungles inc.

601-685 Washington Ave.
Miami Beach, FL

L-07 Second Level - Planting

Historic Preservation Board Interim Resubmittal / 17 March 2016

DRAWINGS NOT FOR CONSTRUCTION



0 8' 16' 32'
SCALE: 1/16" = 1'-0"
@ 30" X 42"

HISTORIC PRESERVATION BOARD INTERIM RESUBMITTAL

601-685 Washington Avenue
Miami Beach, FL | March 17, 2016

JUNGLES