

La Gorce Drive

TWO STORY C.B.S  
RESIDENCE No 5709

West 57th Street

17-112-5709 LA GORCE DRIVE, MIAMI BEACH, FL. 33140											
12/22/2017											
TREE NUM	SYM	COMMON NAME	BOTANICAL NAME	HEIGHT	SPREAD	DBH Inches	STATUS	CANOPY	CANOPY LOSS	DBH LOSS	REMARKS
1	FIC	FICUS SPECIES	<i>Ficus species</i>	20	35	30	NOT FOUND	962	962		
2	BA	SCHEFFLERA	<i>Brassaia actinophylla</i>	35	35	24	NOT FOUND	962	962		PROHIBITED SPECIES-MUST REMOVE
3	TA	TROPICAL ALMOND	<i>Terminalia catappa</i>	40	35	14	NOT FOUND	962	962		PROHIBITED SPECIES-MUST REMOVE
4	BA	SCHEFFLERA	<i>Brassaia actinophylla</i>	35	35	24	NOT FOUND	962	962		PROHIBITED SPECIES-MUST REMOVE
5	SR	QUEEN PALM	<i>Syragrus romanzoffiana</i>	15	10	12	NOT FOUND	79	79		
6	FIC	FICUS SPECIES	<i>Ficus species</i>	40	55	60	REMAIN	2,376			
7	TH	PINK TABEBUIA	<i>Tabebuia heterophylla</i>	25	15	11	REMAIN	177			STREET TREE
8	SR	QUEEN PALM	<i>Syragrus romanzoffiana</i>	15	10	6	NOT FOUND	79	79		
9	SR	QUEEN PALM	<i>Syragrus romanzoffiana</i>	15	10	6	NOT FOUND	79	79		
10	SR	QUEEN PALM	<i>Syragrus romanzoffiana</i>	15	10	6	NOT FOUND	79	79		
11	SR	QUEEN PALM	<i>Syragrus romanzoffiana</i>	15	10	6	NOT FOUND	79	79		
12	SR	QUEEN PALM	<i>Syragrus romanzoffiana</i>	15	10	6	NOT FOUND	79	79		
13	SM	MAHOGANY	<i>Swietenia mahagoni</i>	30	20	6	REMAIN	314			STORM DAMAGED
14	LL	WILD TAMARIND	<i>Lysitoma latissiliqua</i>	18	25	9	REMAIN	491			STREET TREE
15	MEL	MELALEUCA	<i>Meleleuca species</i>	30	15	14	NOT FOUND	177	177		PROHIBITED SPECIES-MUST REMOVE
TOTALS								7,857	4,499		
FIELD INVENTORY CONDUCTED BY JFS DESIGN INC. ON DECEMBER 2, 2017											
PROHIBITED SPECIES MUST BE REMOVED AND ARE NOT REQUIRED TO MITIGATE CANOPY											

TREE REMOVAL REPLACEMENT SCHEDULE		
5709 LA GORCE DRIVE, MIAMI BEACH, FL. 33140		
6-Dec-17		
EXISTING TREE CANOPY 7,857 SQ. FT.	REQUIRED SQ. FT.	PROVIDED SQ. FT.
TOTAL TREE CANOPY LOSS	4,499 SQ. FT.	
PROPOSED TREES:		
CATEGORY 1 TREE (12' ht) = 9 Trees		2,700
300 sq. ft. / tree		
CATEGORY 2 TREE (10' ht) = 11 Trees		1,650
150 sq. ft. / tree		
CATEGORY 3 TREE (10' ht) = 0 Tree		0
100 sq. ft. / tree		
CATEGORY 4 PALM (6' Clear trunk) = 3 palms		150
50 sq. ft. / palm		
TOTAL TREE CANOPY PROVIDED		4,500 SQ.FT.

CITY OF MIAMI BEACH TREE DISPOSITION NOTES	
SHALL TAKE PRECEDENCE OVER ANY OTHER NOTES OR DISCREPANCIES	
1	The Landscape Contractor shall guarantee all new and or relocated trees and palms for a period of 1-year from the date of initial acceptance and approval.
2	All guying and staking shall be removed from all trees and palms within twelve months after planting. Exceptions require written authorization from the City Urban Forester.
3	Tree protection barriers may not be taken down, modified and or removed without written authorization from the City Urban Forester.
4	Mulch shall not be applied within 6" of any tree or palm trunks that are installed or incorporated into the project.
5	A final on-site inspection shall be required by the Urban Forestry Division staff prior to any official acceptance of ROW plant material, in order to verify proper planting depth, spacing and quality of the material. Failure to conduct the inspection could result in rejection of the plant material.

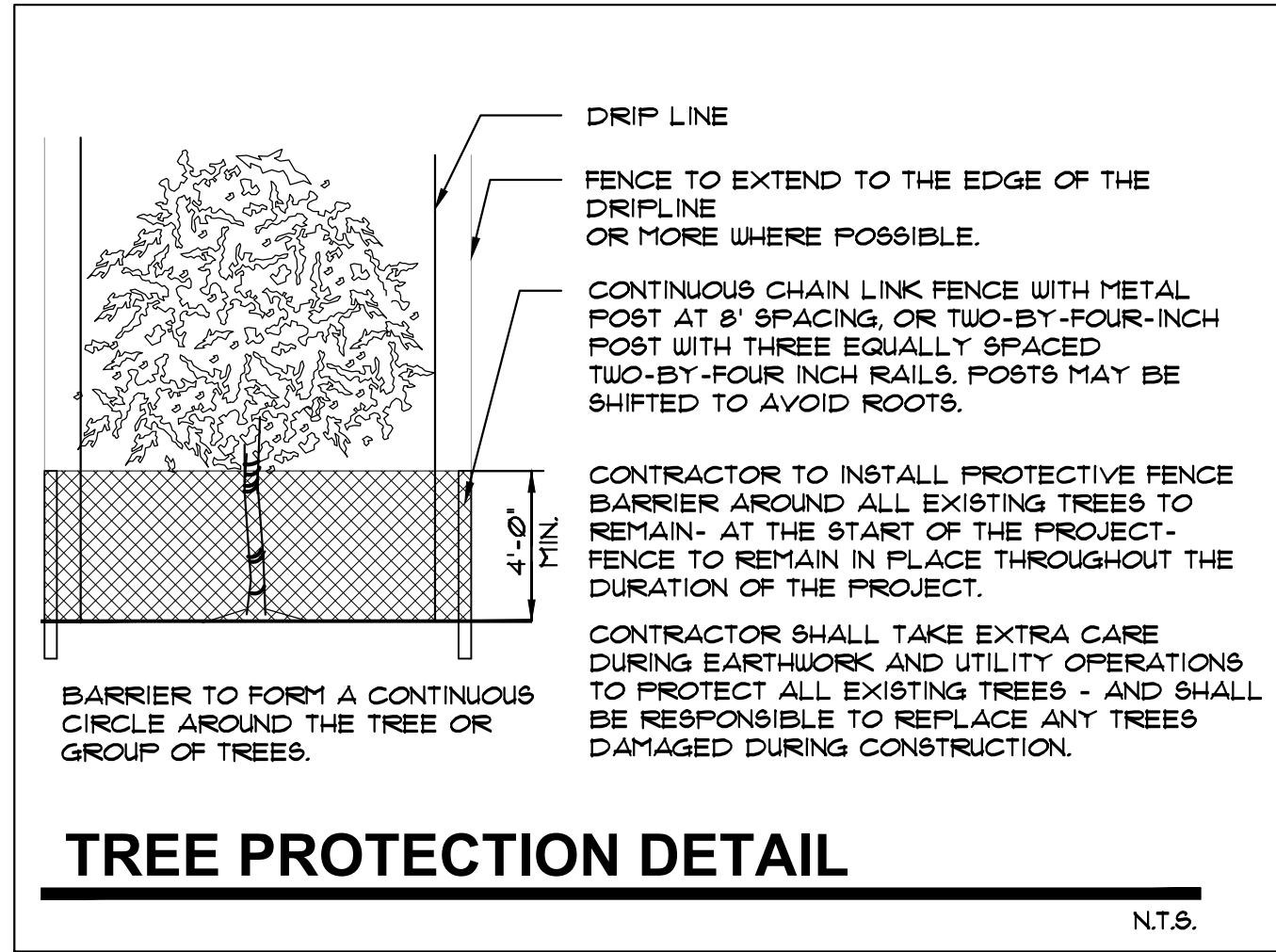

### POST-STORM LANDSCAPE REVIEW:

- THE PROPERTY SHALL BE REVIEWED BY AN ISA CERTIFIED ARBORIST FOR ANY HAZARDOUS CONDITIONS, I.E. HAZARD OR POTENTIAL HAZARDOUS TREES TO BE ELIMINATED IMMEDIATELY.
- EXISTING SITE CONDITIONS ARE TO BE RETROFITTED TO INCLUDE CLEANUP, REMOVAL OF DEAD OR DAMAGED PLANT MATERIAL, REMOVAL OF ALL PROHIBITED SPECIES, I.E. BRAZILIAN PEPPER, MELALEUCA, AUSTRALIAN PINE, ETC. AND REMOVAL OF ALL DEBRIS FROM THE PROPERTY.  
UNDERTAKING OF THIS TASK SHALL FURTHER PROVIDE ADEQUATE OPPORTUNITY TO SUBSEQUENTLY PLANT PER THE APPROVED LANDSCAPE PLANS.
- EXISTING TREES AND PALMS TO REMAIN SHALL BE TRIMMED PER ANSI-3000 STANDARDS. SUPERVISION OF THE TRIMMING SHALL BE PERFORMED BY AN ISA-CERTIFIED ARBORIST.
- ALL EXISTING TREES AND PALMS SHALL BE 'LIFTED AND THINNED' TO PROVIDE FOR AN 8' MINIMUM CLEARANCE FOR SIDEWALKS AND PEDESTRIAN WALKWAYS AND A 14' MINIMUM CLEARANCE FOR ROADWAYS, DRIVEWAYS, AND ALL VEHICULAR USE AREAS.
- ALL PERIMETERS (TO INCLUDE PROPERTY AND BUILDING) ARE TO BE CLEANED-UP OF OVERGROWN VEGETATION WITH REMOVAL OF VINES, WEEDS, ETC. AND SHALL BE APPROVED BY THE CITY LANDSCAPE INSPECTOR PRIOR TO FINAL LANDSCAPE APPROVAL.
- MODIFICATIONS TO THE LANDSCAPE RELATED PLANS (BY THIS OFFICE) DO NOT CONSTITUTE IDENTIFICATION OF HAZARDOUS CONDITIONS OR VEGETATION WITHOUT A WRITTEN AND SIGNED REPORT FROM AN ISA CERTIFIED ARBORIST.

### PROHIBITED SPECIES:

SEC. 18A-12. PROHIBITIONS:  
(4) 'PROHIBITED PLANT SPECIES. PROHIBITED SPECIES SHALL NOT BE PLANTED AND SHALL BE REMOVED FROM ANY SITE AND SHALL BE REMOVED FROM ANY SITE WHICH IS SUBJECT TO THE REQUIREMENTS OF THIS CHAPTER.'

### NOTES:

- A WRITTEN TREE REMOVAL PERMIT IS REQUIRED FROM THE LOCAL GOVERNING AGENCY PRIOR TO REMOVAL OF ANY TREES OR PALMS FROM THE SITE.
- SEE LANDSCAPE PLANS FOR PROPOSED LANDSCAPE PLANTINGS, LANDSCAPE LEGEND, PLANTLIST, SPECIFICATIONS, DETAILS, ETC.
- THE CONTRACTOR SHALL REMOVE ALL TREES AND HEDGES AS PER PLANS AND AS APPROVED BY THE LOCAL GOVERNING AGENCIES (CITY OF MIAMI BEACH). TREE, PALM AND HEDGE MATERIAL SHALL INCLUDE ALL TRUNKS, STUMPS AND ROOTS. ALL EXCESS DEBRIS SHALL BE REMOVED FROM THE SITE AND DISPOSED OF AT AN APPROVED SITE. ALL HOLES AND DEPRESSIONS SHALL BE BACKFILLED WITH CLEAN, APPROVED BACKFILL.
- LOCATIONS SHOWN FOR THE EXISTING TREES AND PALMS ARE APPROXIMATE, EXACT LOCATIONS ARE TO BE FIELD VERIFIED BY A REGISTERED LAND SURVEYOR (RLS) PRIOR TO ANY PAVING OR ANY OTHER SUCH WORK WHICH WILL BE IMPACTED BY ANY TREES OR PALMS TO REMAIN.
- ALL INVASIVE EXOTIC VEGETATION AND ANY ANY OTHER PLANTS LISTED AS CATEGORY 1, ON THE FLORIDA EXOTIC PEST PLANT COUNCIL'S LIST OF FLORIDA'S MOST INVASIVE SPECIES SHALL BE REMOVED FROM THE SITE AND MAINTENANCE SHALL GUARANTEE CONTROL OF RE-INVASION.

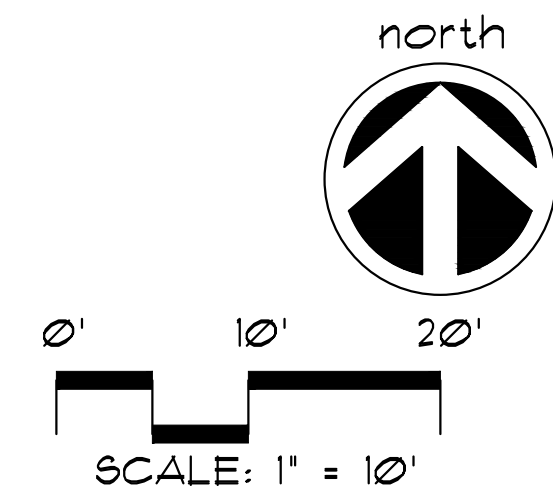

A WRITTEN TREE REMOVAL PERMIT IS REQUIRED FROM THE CITY OF MIAMI BEACH PRIOR TO REMOVAL OF ANY TREES FROM THIS SITE.  
SEE LANDSCAPE PLANS FOR PROPOSED PLANTINGS, LANDSCAPE LEGEND, DETAILS, NOTES, ETC.

## TREE DISPOSITION PLAN

No.	Date	Revision

designed: JIMMYTICO  
drawn: CURRO  
checked: T.Y. MORAN  
approved: J. F. SOCASH  
project #: 17-112  
scale: AS SHOWN  
date: Dec. 8, 2017  
folio: -

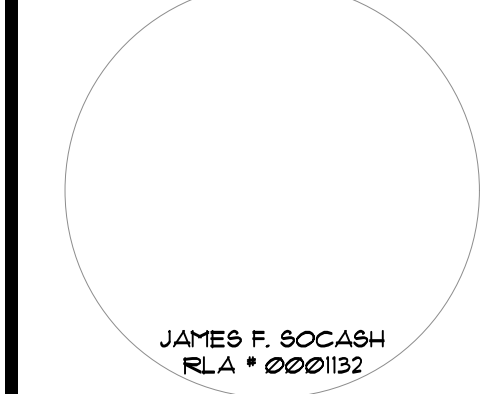



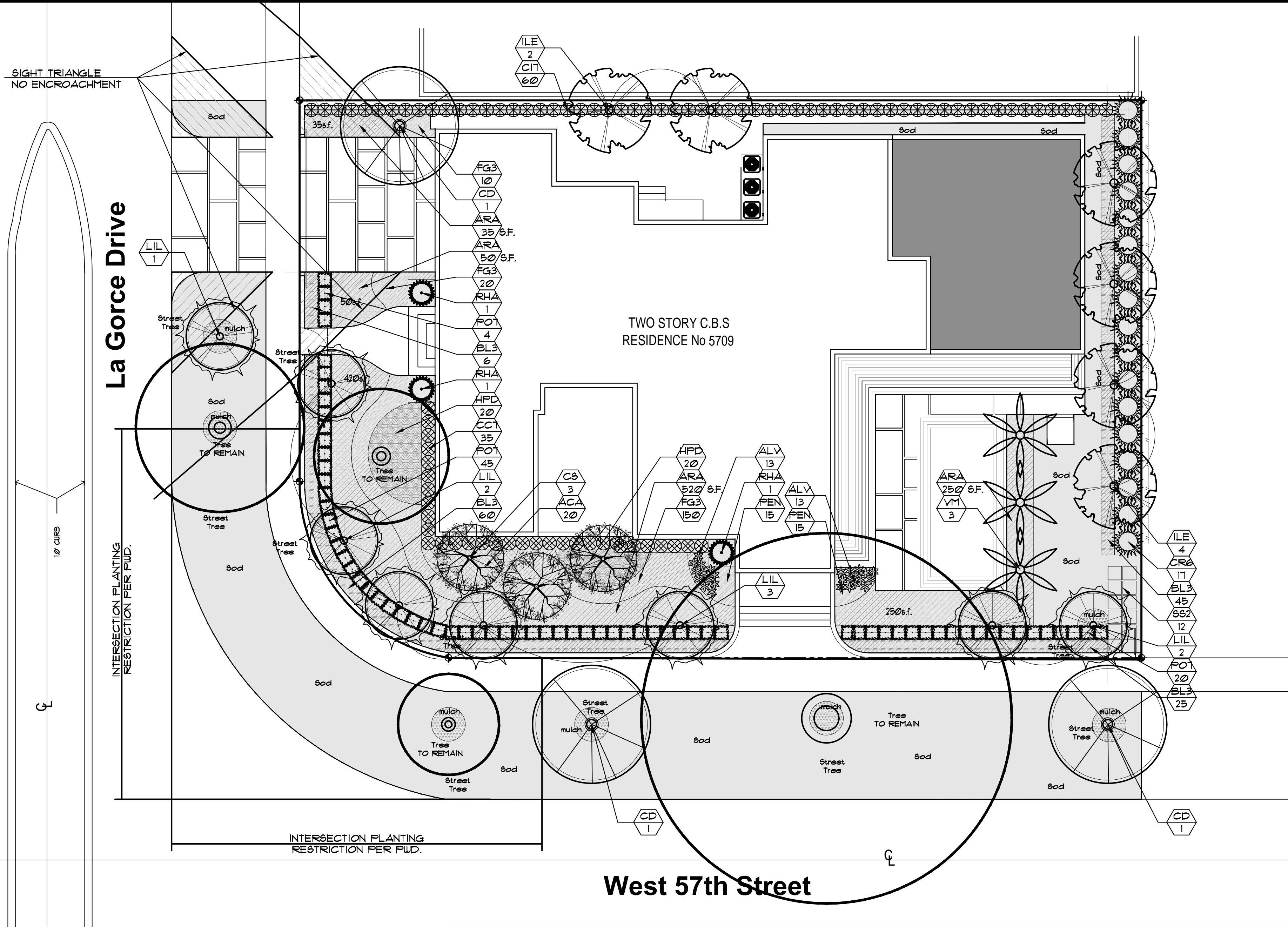

PLANTLIST			
SYM.	NATIVE *	NAME	BOTANICAL NAME SPECIFICATION
EXISTING TREES TO REMAIN			
SEE TREE DISPOSITION PLAN, SHEET TD-1			
PROPOSED TREES			
CD	YES	3 PIGEON PLUM	Coccoloba diversifolia 12' x 6' apr., 2 1/2' cal.
CS	YES	3 ORANGE GEIGER	Cordia sebestena FG, 10' x 5', 2' cal.
ILE	YES	6 EAGLESTON HOLLY	Ilex x attenuata 'Eagleston' FG, 12' o.a., full
LIL		8 CRAPE MYRTLE 'LAVENDER'	Lagerstroemia indica 'Muskogee' 10' x 6', max. 5 tks. * o.a. ht.
PALMS			
VM		3 MONTGOMERY PALMS	Veitchia montgomeryana SGL. TK, FG, 14' o.a., full hd.
SHRUBS			
ACA	20	COPPER LEAF ACALYPHA	Acalypha sp. 3 gal., 24' x 24', 24' o.c., full
CC1	YES	35 JAMAICA CAPER	Capparis cynophallophora 1 gal., 30' x 24', 24' o.c. full
C17	YES	60 COCOPLUM	Chrysobalanus icaco 1 GAL., 30' x 24' full, 24' o.c.
CR6	YES	20 SMALL-LEAVED CLUSIA	Clusia guttifera 6' ht., 48' o.c., FTB.
HPD	YES	40 DWARF FIREBUSH	Hamelia nodosa 3 gal., 18' x 18', 24' o.c.
PO1		69 PODOCARPUS HEDGE	Podocarpus spp. 1 gal., 30' x 24', full heavy
LANDSCAPE MATERIALS			
SS2	12	STEPPING STONES	24' x 24', SIMULATED KEYSTONE, on 2' sand leveling course, level to grade

PLANTLIST			
SYM.	NATIVE *	NAME	BOTANICAL NAME SPECIFICATION
ACCENT PLANTS AND GROUNDCOVERS			
ALV	26	AECHMEA 'ALVAREZ'	Aechmea spp. 9' pot, 12' o.c., GRANTS FARM
ARA	855 s.f.	PERENNIAL PEANUT	Arachis glabrata 'EcoTurf' SOLID SOD, price per s.f.
BL3	136	BLUEBERRY FLAX LILY	Dianella tasmanica 3 gal., 12' x 18', 18' o.c., full
FG3	180	'GREEN ISLAND' FICUS	Ficus 'Green Island' 3 gal., 18' x 18', 18' o.c., full
PEN	30	EGYPTIAN STAR CLUSTER	Pentas lanceolata 1 gal., 10' x 10', 14' o.c., full
RHA	3	LADY PALMS	Rhapis excelsa 5' o.a., FTG., sun acclimated
SOD			
FLO	2,900 S.F.	'FLORATAM' ST. AUGUSTINE	Stenotaphrum secundatum SOLID SOD, price per s.f.
TOPSOIL:			
		TOPSOIL: SAND MIX	50:50 TOPSOIL: SAND MIX, SPREAD IN PLACE
		23 C.Y.	TREES, PALMS, SHRUBS AND GROUNDCOVERS
		18 C.Y.	AREA TO BE SODDED WITH A 2' DEPTH OF TOPSOIL SPREAD IN PLACE
MULCHING:			
		13 C.Y.-V-	'PINE BARK' MULCH 3' DEPTH, SPREAD IN PLACE, ATLAS PEAT AND SOIL
		---	PROVIDE SAMPLE FOR APPROVAL PRIOR TO INSTALLATION
		---	TOPSOIL, SOD AND MULCH QUANTITIES SHOWN ARE APPROXIMATE, CONTRACTOR TO PROVIDE A UNIT PRICE PER UNIT AND WILL BE PAID ON THAT UNIT PRICE BASIS UPON FINAL INSPECTION AND APPROVAL.

CITY OF MIAMI BEACH LANDSCAPE NOTES			
SHALL TAKE PRECEDENCE OVER ANY OTHER LANDSCAPE NOTES OR DISCREPANCIES			
1	"Tree protection fences shall be constructed prior to any construction activity including grubbing for all trees/palms to remain or be relocated. Fences should be of sturdy construction, preferably 4x4 posts with wire mesh. Orange plastic mesh fences are ineffective because they are easily removed, dropped, knocked down, ignored, etc. Fences must be maintained intact until the project is completed. They should not be removed or dropped for any reason without authorization from the city's urban forester. No activity or disturbance should occur within the fenced areas, including vehicle use, storage of materials, dumping of liquids or materials, grade changes, grubbing, and mechanical trenching for irrigation, electrical lighting, etc."		
2	All proposed irrigation in City property shall follow CMB irrigation specifications.		
3	"Do not place fill, rocks, grading sand nor any other construction material over the roots or in the root zone."		
4	"Any proposed tree root or structural pruning shall be performed by an ISA Certified Arborist in accordance with ANSI A-300 (part 1) pruning standards. Tree pruning should be limited to the bare minimum required to achieve clearance for construction activities and the City Urban Forester shall be consulted prior to the start of any tree or root pruning onsite."		
5	"Mulch shall be kept a minimum of 6" away from all trunks of trees and palms. Fill/topsoil shall not be placed on top of the root ball."		
6	"The City Urban Forester and or Greenspace Management Staff shall be notified prior to installation of trees or palms in the ROW to inspect the planting holes and conduct a grades and standards inspection."		
7	"Contractor is responsible for the maintenance and/or repair of all staking and guying of trees and palms during warranty period and removal & disposal of staking within 1-year of installation. Exceptions to this require the written approval of the City Urban Forester."		
8	Required street trees are subject to the review and approval of the CIP office and PW/ Greenspace Division prior to installation		

CITY OF MIAMI BEACH

LANDSCAPE LEGEND

INFORMATION REQUIRED TO BE PERMANENTLY AFFIXED TO PLANS

Zoning District RS-4 Lot Area 10,218 s.f.

Acres 0.23

OPEN SPACE

A. Square feet of required Open Space as indicated on site plan:

Lot Area = 10,218 s.f. x 50 % = 5,109 s.f.

REQUIRED/ ALLOWED PROVIDED

5,109 s.f. 3,219 s.f.

B. Square feet of parking lot open space required as indicated on site plan:

Number of parking spaces 2 x 10 s.f. parking space =

N/A N/A

C. Total square feet of landscaped open space required: A+B=

5,109 s.f. 3,219 s.f.

LAWN AREA CALCULATION

A. Square feet of landscaped open space required

5,109 s.f. 3,319s.f.

B. Maximum lawn area (sod) permitted= 50 % x 5,109 s.f.

2,555s.f. 2,555s.f.

TREES

A. Number of trees required per lot or net lot acre, less existing number of trees meeting minimum requirements=

10 14

\_\_\_\_\_ trees x \_\_\_\_\_ net lot acres - number of existing trees=

3 12

B. % Natives required: Number of trees provided x 30% =

5 12

C. % Low maintenance / drought and salt tolerant required:

Number of trees provided x 50%=

10 10

D. Street Trees (maximum average spacing of 20' o.c.)

\_\_\_\_\_ ft \_\_\_\_\_ linear feet along street divided by 20'=

N/A N/A

E. Street tree species allowed directly beneath power lines:

(maximum average spacing of 20' o.c.):

\_\_\_\_\_ linear feet along street divided by 20'=

N/A N/A

SHRUBS

A. Number of shrubs required: Sum of lot and street trees required x 12=

240 244

B. % Native shrubs required: Number of shrubs provided x 50%=

120 155

LARGE SHRUBS OR SMALL TREES

A. Number of large shrubs or small trees required: Number of required shrubs x 10%=

12 20

B. % Native large shrubs or small trees required: Number of large shrubs or small trees provided x 50%=

6 20

STREET TREE TABULATIONS

REQUIRED STREET TREES ARE SUBJECT TO THE REVIEW AND APPROVAL OF THE CIP OFFICE AND PW GREENSPACE DIVISION PRIOR TO INSTALLATION.

	REQUIRED	PROVIDED
West 57th St. 120 L.F. * 1 TREE / 20 L.F. = 6	6	6 2 EXIST * 4 CD + 2 LIL
La Gorce Drive 76 L.F. * 1 TREE / 20 L.F. = 4	4	4 1 EXIST * 3 LIL
TOTAL	10	10

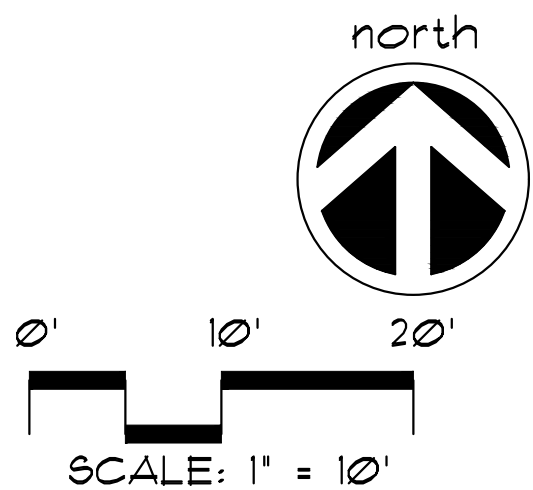

A WRITTEN TREE REMOVAL PERMIT IS REQUIRED FROM THE CITY OF MIAMI BEACH PRIOR TO REMOVAL OF ANY TREES FROM THIS SITE.

SEE SHEET L-2 FOR LANDSCAPE DETAILS, NOTES, SPECIFICATIONS, ETC.

LANDSCAPE PLAN

SINGLE FAMILY RESIDENCE

5709 LA GORCE DRIVE MIAMI BEACH, FL. 33140

No: Date Revision

designed: JIMMYTICO

drawn: CURRO

checked: T.Y. MORAN

approved: J. F. SOCASH

project #: 17-112

scale: AS SHOWN

date: Dec. 8, 2017

Folio: -



Drawing:

L-1



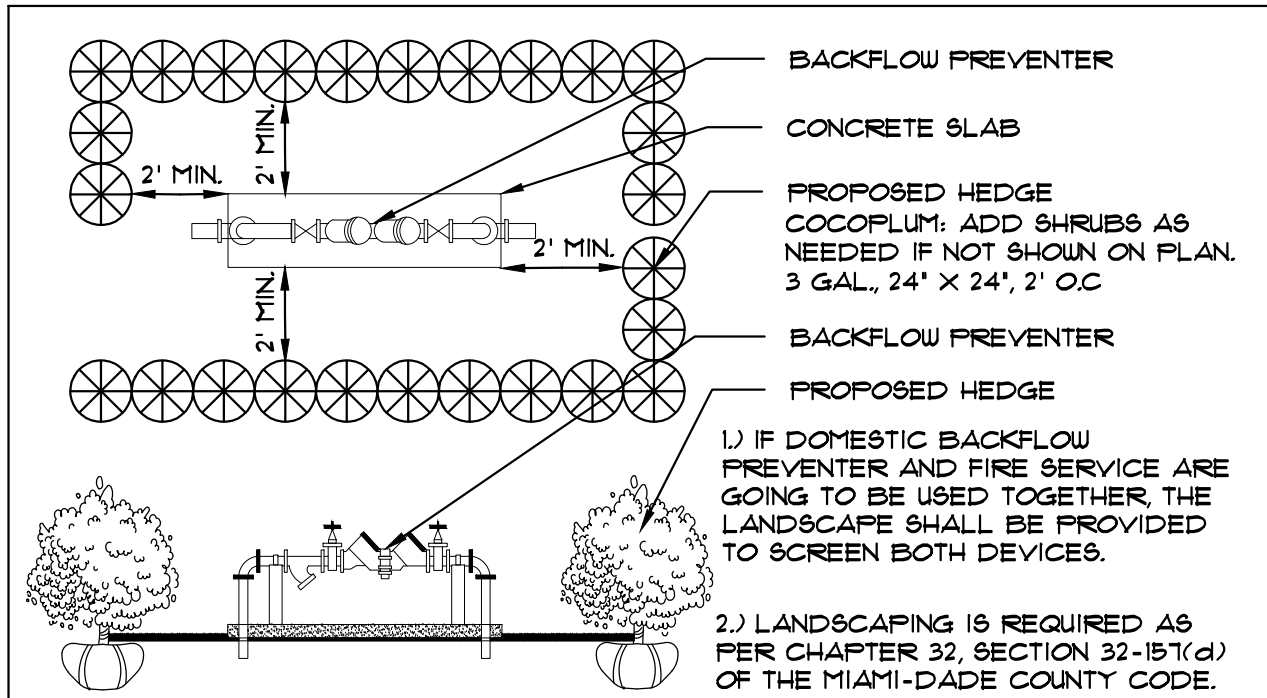

TYPICAL PLANTING SCREEN FOR ABOVE-GROUND UTILITIES

N.T.S.

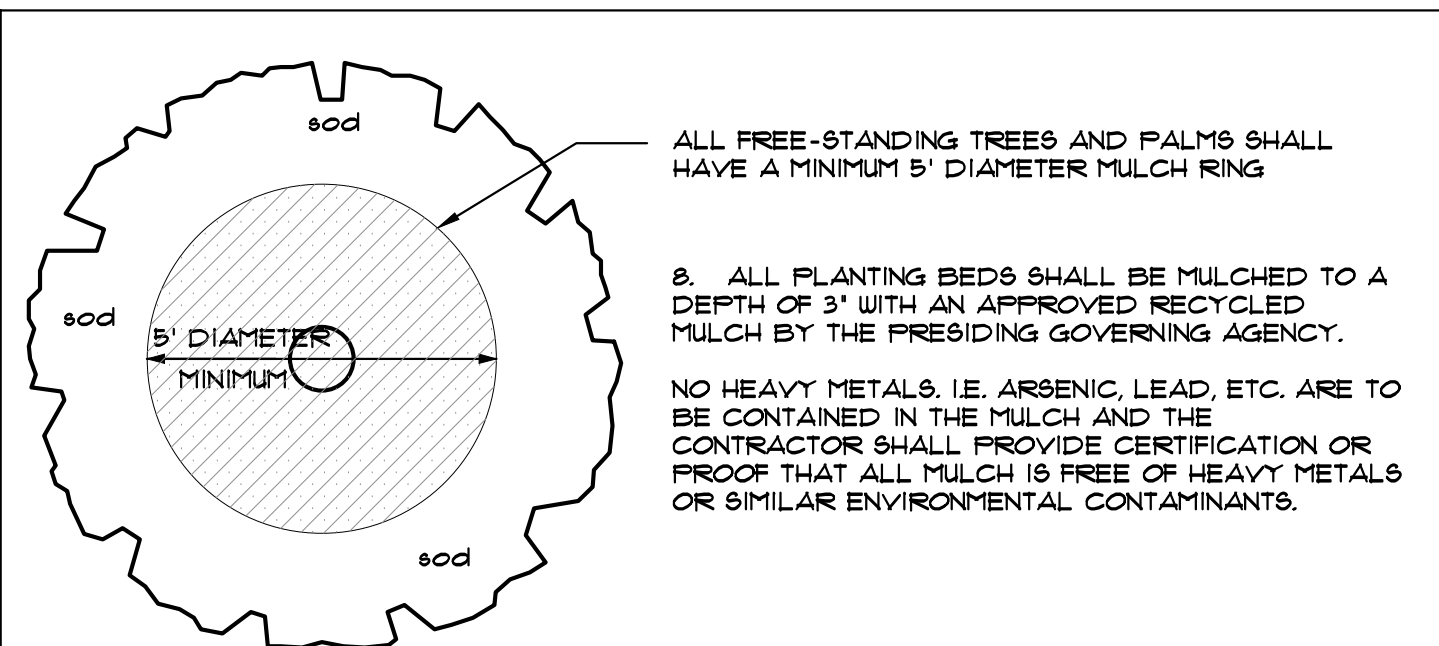

TYPICAL MULCH RING FOR FREE-STANDING TREES AND PALMS

N.T.S.

- FINISH GRADE PER CIVIL DRAWINGS
- SLOPE TO DRAIN OR PER CIVIL DRAWINGS
- INSTALLATION PER MANUFACTURER'S SPECIFICATIONS

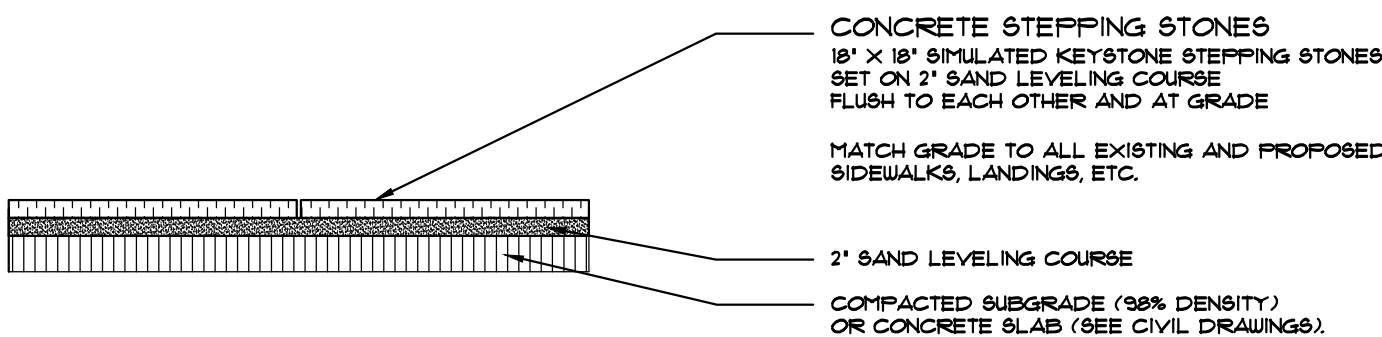

TYPICAL SECTION STEPPING STONES

N.T.S.

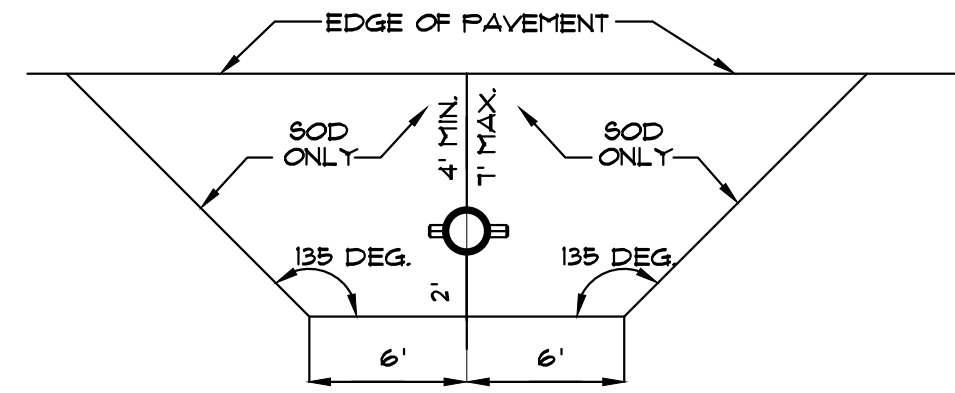

FIRE HYDRANT CLEAR ZONE

N.T.S.

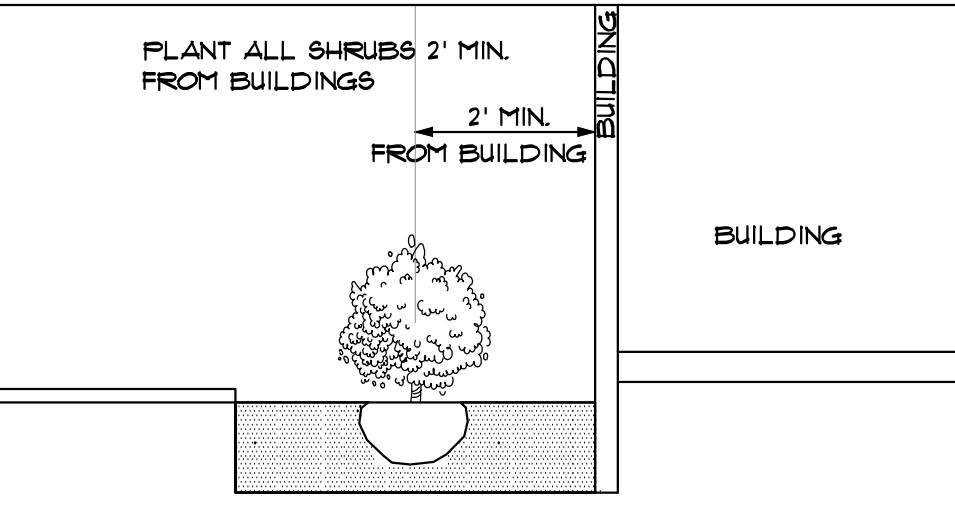

SHRUB PLANTINGS BUILDING DETAIL

N.T.S.

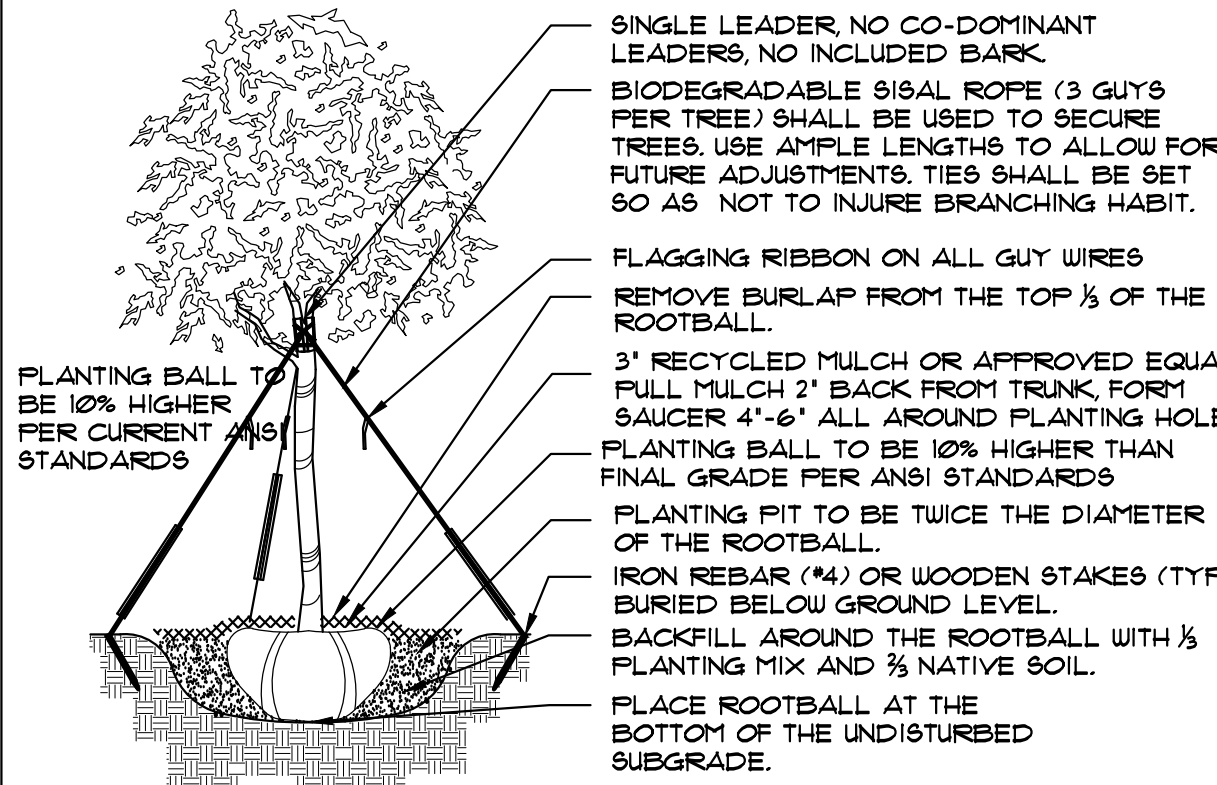

TREE PLANTING DETAIL

N.T.S.

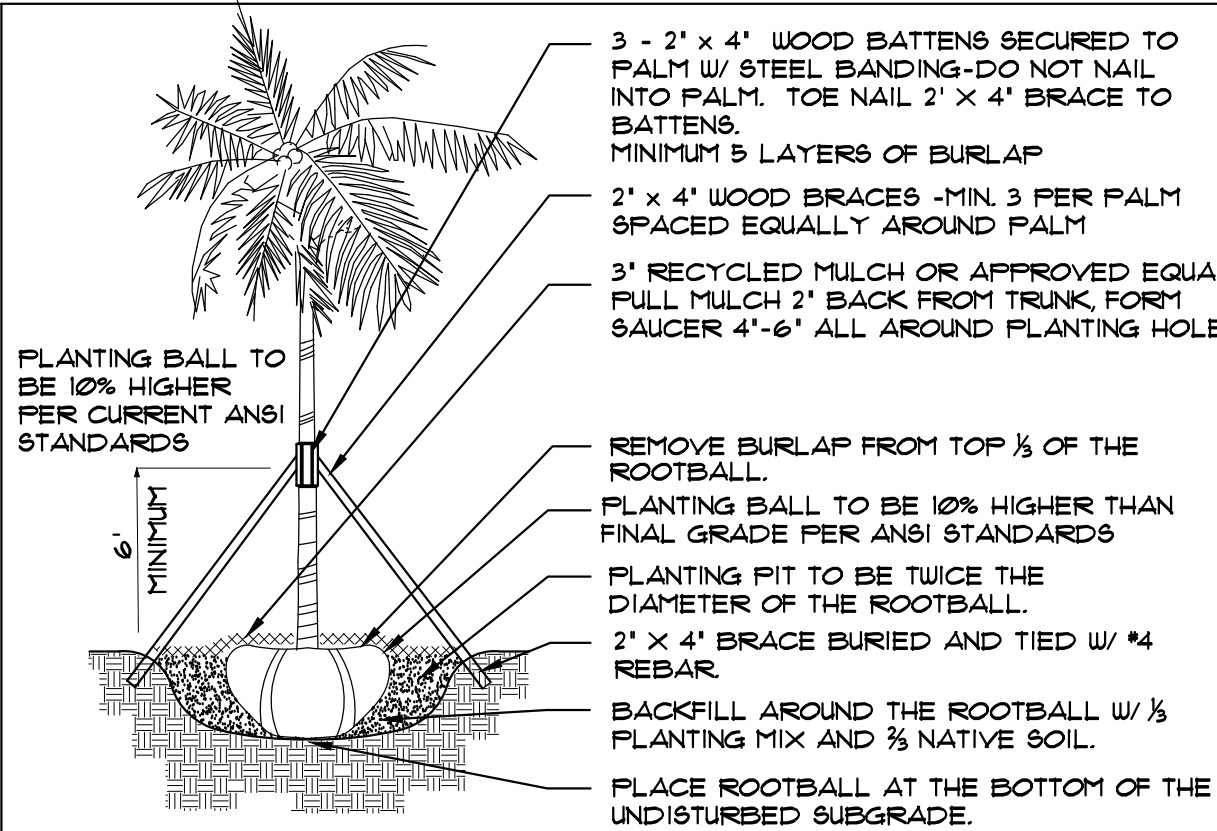

PALM PLANTING DETAIL

N.T.S.

FERTILIZATION:

ONE COMPLETE APPLICATION OF GRANULAR FERTILIZER SHALL BE APPLIED PRIOR TO FINAL ACCEPTANCE AND APPROVAL BY THE LANDSCAPE ARCHITECT. AN ADDITIONAL FERTILIZATION PROGRAM SHALL BE SUBMITTED TO THE PROJECT MANAGER FOR AN ANNUAL FERTILIZATION APPLICATION PROGRAM. FERTILIZERS SHALL BE PER ATLANTIC -AFEC FERTILIZER 4 CHEMICAL (AFEC) OR AN APPROVED EQUAL. CONTRACTOR SHALL SUBMIT FERTILIZATION AS A SEPARATE ITEM IN THE BID.

FERTILIZATION SHALL BE AS FOLLOWS: TREES: 12-06-08 (AFEC # 5231) RATE: 15 LBS/ INCH OF DIA. # DBH PALMS: 12-04-12 (AFEC # 7216) RATE: 15 LBS/ INCH OF DIA. # DBH SHRUBS AND GROUNDCOVERS: (12-06-08 AFEC # 5231) RATE: 15 OZ/ FT. OF HEIGHT

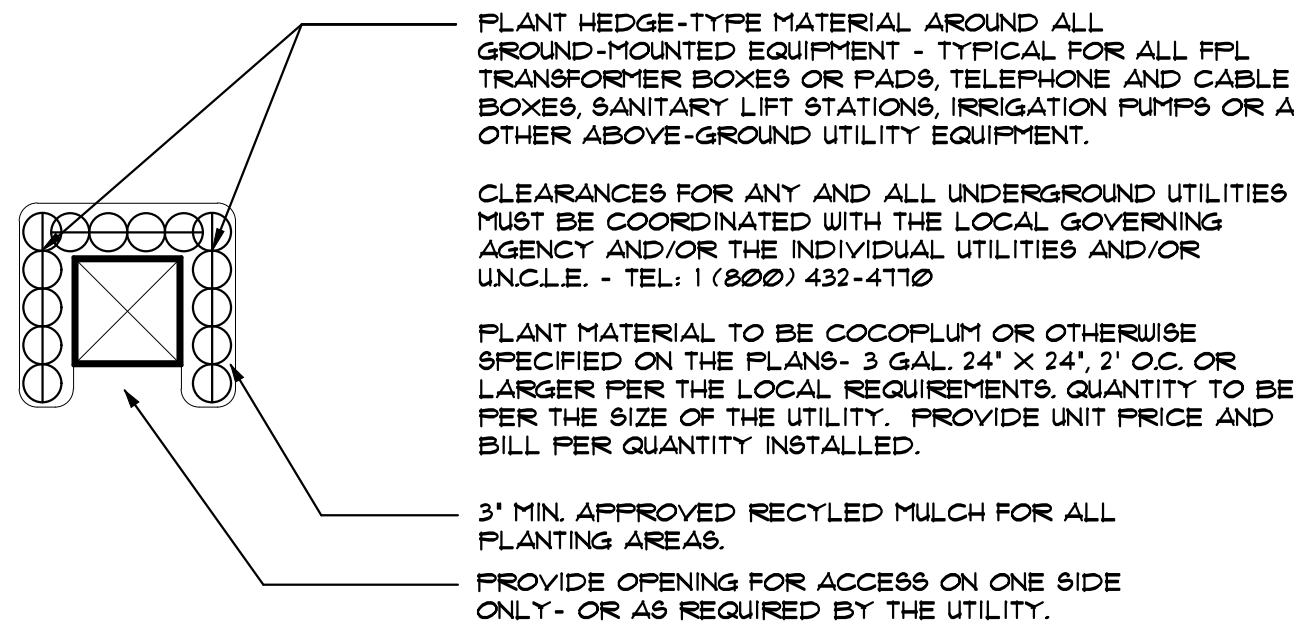

TYPICAL PLANTINGS FOR GROUND-MOUNTED EQUIPMENT

N.T.S.

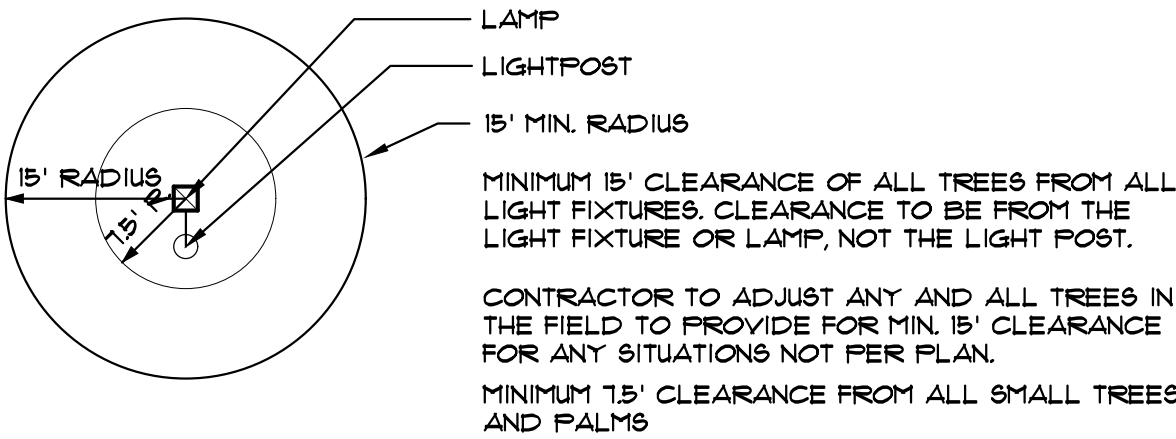

MINIMUM TREE CLEARANCE FROM LIGHT FIXTURES

N.T.S.

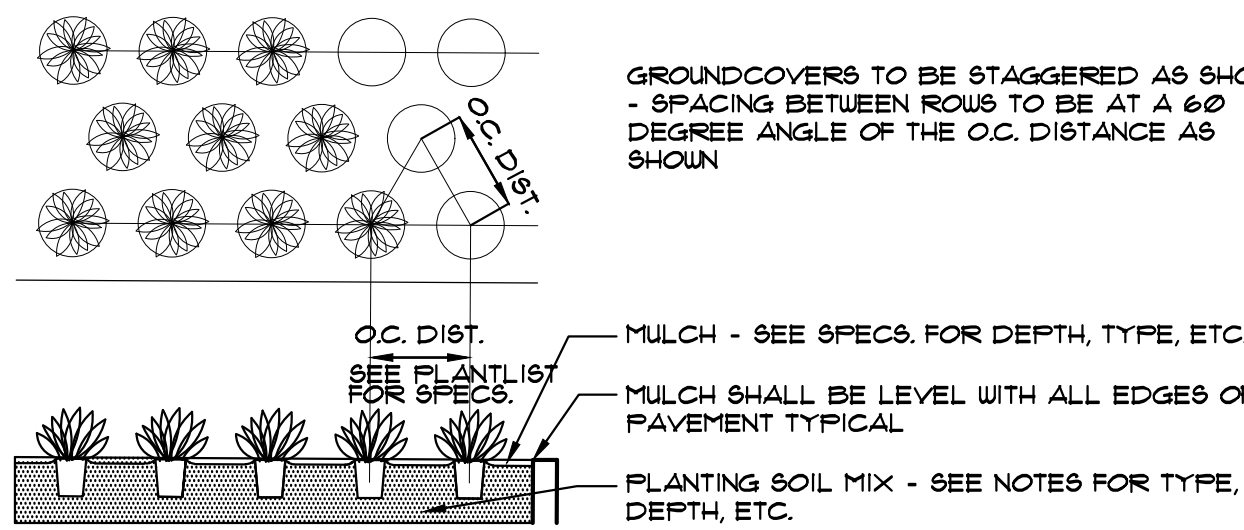

GROUNDCOVER DETAIL

N.T.S.

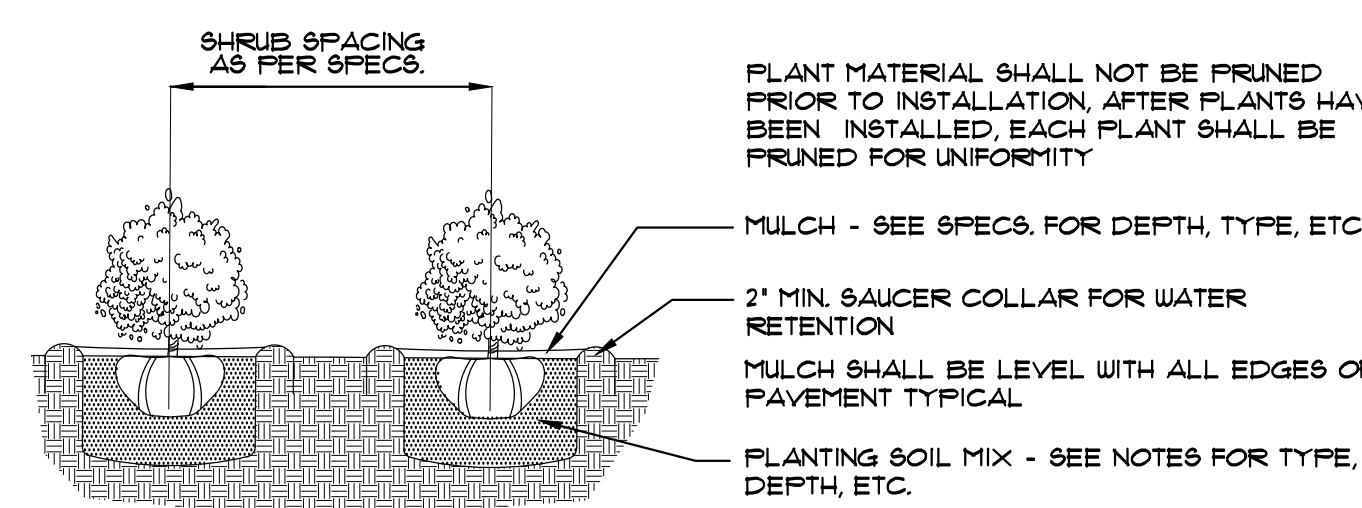

SHRUB PLANTING DETAIL

N.T.S.

LANDSCAPE NOTES

1. ALL PLANT MATERIAL SHALL BE FLORIDA NO. 1 GRADE OR BETTER.
2. CONTRACTOR SHALL FAMILIARIZE HIMSELF WITH THE LOCATION OF AND AVOID AND PROTECT UTILITY LINES, BURIED CABLES, AND OTHER UTILITIES.
3. TREE, PALM, ACCENT AND BED LINES ARE TO BE LOCATED IN THE FIELD AND APPROVED BY THE LANDSCAPE ARCHITECT PRIOR TO INSTALLATION.
4. ALL PLANTING SOIL SHALL BE 50:50 TOPSOIL:SAND MIX, FREE OF CLAY, STONES, ROCKS, OR OTHER FOREIGN MATTER. THIS SPECIFICATION INCLUDES ALL BACKFILL FOR BERTIS AND OTHER LANDSCAPE AREAS.

SODDED-LAWN AREAS  
2\"/>

5. THE SITE CONTRACTOR SHALL BE RESPONSIBLE TO BRING ALL GRADES TO WITHIN 2\"/>
6. THE LANDSCAPE CONTRACTOR SHALL CALCULATE AND SUBMIT AN ITEMIZED PRICE FOR THE 2\"/>

7. CONTRACTOR SHALL COORDINATE WITH THE IRRIGATION CONTRACTOR AND LEAVE PROVISIONS FOR ALL INCLUDING UNDERGROUND UTILITY LINE LOCATIONS DIAL 811 NO CUTS AS REQUIRED BY LAW.

8. ALL PLANTING BEDS SHALL BE MULCHED TO A DEPTH OF 3\"/>

9. SOD SHALL BE ARGENTINE 'BAHIA' OR ST. AUGUSTINE 'FLORATAM' AS SHOWN ON THE PLANS, STRONGLY ROOTED, FREE FROM WEED, FUNGUS, INSECTS AND DISEASE. CONTRACTOR SHALL SOD ALL AREAS AS INDICATED ON THE PLAN OR AS DIRECTED. PAYMENT SHALL BE DETERMINED BY THE TOTAL MEASURED SODDED AREAS X THE UNIT PRICE SUBMITTED AND FIELD VERIFIED.

10. SOD SHALL BE INSTALLED IN ACCORDANCE WITH THE SPECIFICATIONS AS DEFINED BY FDOT. SOD SHALL CARRY A 5-MONTH WARRANTY.

11. ALL TREES, PALMS, SHRUBS AND GROUNDCOVERS SHALL CARRY A ONE-YEAR WARRANTY FROM THE DATE OF FINAL ACCEPTANCE.

12. ALL TREES AND PALMS SHALL BE STAKED PER ACCEPTED STANDARDS BY THE FLORIDA NURSERY AND LANDSCAPE ASSOCIATION (FNLA). THERE SHALL BE ONE FINAL INSPECTION FOR APPROVAL BY THE PRESIDING GOVERNING AGENCY. CONTRACTOR SHALL INSURE THAT THE PLANS, DETAILS, SPECIFICATIONS AND NOTES HAVE BEEN ADHERED TO AND THAT THE LANDSCAPE AND IRRIGATION INSTALLATION IS COMPLIANT TO ALL ITEMS AS DIRECTED ON THE PLANS PRIOR TO SCHEDULING OF THE FINAL INSPECTION.

13. THE PLANT LIST IS INTENDED ONLY AS AN AID TO BIDDING. ANY DISCREPANCIES FOUND BETWEEN THE QUANTITIES ON THE PLAN AND PLANT LIST, THE QUANTITIES ON THE PLAN SHALL BE HELD VALID.

14. IRRIGATION SHALL PROVIDE FOR A 100% COVERAGE WITH A 100% OVERLAP, AUTOMATIC SYSTEM W/ RAIN MOISTURE SENSOR ATTACHED TO CONTROLLER. ALL FLORIDA BUILDING CODE APPENDIX 'F' IRRIGATION REQUIREMENTS SHALL BE STRICTLY ADHERED TO FOR INSTALLATION AND PREVAILING WATER MANAGEMENT DISTRICT RESTRICTIONS AND REGULATIONS SHALL BE IN COMPLIANCE FOR POST-INSTALLATION WATERING SCHEDULES.

15. EXISTING IRRIGATION SYSTEM (IF APPLICABLE) SHALL BE RETROFITTED TO COMPLY WITH THOSE SPECIFICATIONS AS OUTLINED ABOVE.

16. CONTRACTOR SHALL PROVIDE A WATER TRUCK DURING PLANTING TO INSURE PROPER WATERING-IN DURING INSTALLATION AND WILL BE RESPONSIBLE FOR CONTINUAL WATERING UNTIL FINAL ACCEPTANCE BY THE OWNER.

17. ALL EXISTING TREES, PALMS AND PLANT MATERIAL TO REMAIN SHALL BE PROTECTED DURING CONSTRUCTION. CONTRACTOR SHALL INSTALL PROTECTIVE BARRIERS SUCH AS 'TENAX' PROTECTIVE FENCING OR AS SHOWN ON THE DETAILS TO BE INSTALLED AT THE BEGINNING OF THE PROJECT. BARRIERS SHALL BE LOCATED TO INCLUDE THE DRIPLINE OF THE TREES, PALMS AND PLANT MATERIAL WHERE POSSIBLE. THE CONTRACTOR SHALL TAKE EXTRA CAUTION TO PREVENT ANY DAMAGE TO THE TRUNK, BRANCHES, ROOTS, ROOT ZONE AREAS AND ADJACENT GRADES.

18. EXISTING TREES AND PALMS TO REMAIN SHALL BE TRIMMED PER ANSI-300 STANDARDS. SUPERVISION OF THE TRIMMING SHALL BE PERFORMED BY AN ISA-CERTIFIED ARBORIST.

19. ALL EXISTING TREES AND PALMS SHALL BE 'LIFTED AND THINNED' TO PROVIDE FOR AN 8' MINIMUM CLEARANCE FOR SIDEWALKS AND PEDESTRIAN WALKWAYS AND A 14' MINIMUM CLEARANCE FOR ROADWAYS, DRIVEWAYS, AND ALL VEHICULAR USE AREAS.

20. REMOVAL OF ANY TREES OR PALMS WILL REQUIRE A WRITTEN 'TREE REMOVAL PERMIT' FROM THE LOCAL GOVERNING AGENCY PRIOR TO REMOVAL.
21. ALL PLANTINGS IN NON-IRRIGATED AREAS, IE. RIGHTS OF WAYS, SWALES, ETC. SHALL BE WATERED-IN THOROUGHLY AND CONTINUED TO BE WATERED THROUGHOUT UNTIL C.O. ACCEPTANCE. COORDINATE WITH OWNER AND PROJECT MANAGER TO PROVIDE POST C.O. WATERING TO INSURE PLANT ESTABLISHMENT FOR A MINIMUM OF ONE YEAR AFTER CERTIFICATE OF OCCUPANCY ACCEPTANCE.

No.	Date	Revision

designed:	JIMMYTICO
drawn:	CURRO
checked:	T.Y. MORAN
approved:	J. F. SOCASH
project #:	17-112
scale:	AS SHOWN
date:	Dec. 8, 2017
Folio:	-