

17-67-5288 ALTON ROAD, MIAMI BEACH, FL. 33140											
TREE #	SYM	COMMON NAME	BOTANICAL NAME	HEIGHT	SPREAD	DBH	STATUS	CANOPY	CANOPY	DBH	REMARKS
						INCHES			LOSS	LOSS	
1	MAH	MAHOE TREE	Hibiscus tiliaceus	25	25	m	REMOVE	491			PROHIBITED SPECIES-MUST REMOVE
2	MAH	MAHOE TREE	Hibiscus tiliaceus	25	25	m	REMOVE	491			PROHIBITED SPECIES-MUST REMOVE
3	MAH	MAHOE TREE	Hibiscus tiliaceus	25	25	m	REMOVE	491			PROHIBITED SPECIES-MUST REMOVE
4	SP	SABAL PALM	Sabal palmetto	25	12	10	REMAIN	113			EXISTING IN RIGHT OF WAY
5	SP	SABAL PALM	Sabal palmetto	25	12	10	REMAIN	113			EXISTING IN RIGHT OF WAY
6	DR	ROYAL PONCIANA	Delonix regia	25	30	22	REMAIN	707			EXISTING IN RIGHT OF WAY
7	SM	MAHOAGANY	Swietenia mahagoni	30	35	26	REMAIN	962			EXISTING IN RIGHT OF WAY
8	NOH	NORONHIA	Noronhia emarginata	14	14	8	REMAIN	154			EXISTING IN RIGHT OF WAY
9	POD	PODOCARPUS HEDGE	Podocarpus spp.	14	10	6	REMOVE	79	79		
10	PE	ALEXANDER PALM	Pythosperma elegans	20	8	4	REMOVE	50	50		
11	PE	ALEXANDER PALM	Pythosperma elegans	20	8	4	REMOVE	50	50		
12	PE	ALEXANDER PALM	Pythosperma elegans	20	8	4	REMOVE	50	50		
13	PE	ALEXANDER PALM	Pythosperma elegans	20	8	4	REMOVE	50	50		
14	PE	ALEXANDER PALM	Pythosperma elegans	20	8	4	REMOVE	50	50		
15	PE	ALEXANDER PALM	Pythosperma elegans	20	8	4	REMOVE	50	50		
16	PE	ALEXANDER PALM	Pythosperma elegans	20	8	4	REMOVE	50	50		
17	PE	ALEXANDER PALM	Pythosperma elegans	20	8	4	REMOVE	50	50		
18	PE	ALEXANDER PALM	Pythosperma elegans	20	8	4	REMOVE	50	50		
19	PE	ALEXANDER PALM	Pythosperma elegans	20	8	4	REMOVE	50	50		
20	FA	STRANGLER FIG	Ficus aurea	30	30	60	REMOVE	707	707		SEVERE TRUNK DECAY
21	PE	ALEXANDER PALM	Pythosperma elegans	20	10	5	REMOVE	79	79		
22	PE	ALEXANDER PALM	Pythosperma elegans	20	8	4	REMOVE	50	50		
23	PE	ALEXANDER PALM	Pythosperma elegans	20	8	4	REMOVE	50	50		
24	PE	ALEXANDER PALM	Pythosperma elegans	20	8	4	REMOVE	50	50		
25	PE	ALEXANDER PALM	Pythosperma elegans	20	8	4	REMOVE	50	50		
26	PE	ALEXANDER PALM	Pythosperma elegans	20	8	4	REMOVE	50	50		
27	PE	ALEXANDER PALM	Pythosperma elegans	20	8	4	REMOVE	50	50		
28	PE	ALEXANDER PALM	Pythosperma elegans	20	8	4	REMOVE	50	50		
29	PE	ALEXANDER PALM	Pythosperma elegans	20	8	4	REMOVE	50	50		
30	PE	ALEXANDER PALM	Pythosperma elegans	20	8	4	REMOVE	50	50		
31	PE	ALEXANDER PALM	Pythosperma elegans	20	8	4	REMOVE	50	50		
32	PE	ALEXANDER PALM	Pythosperma elegans	20	8	4	REMOVE	50	50		
33	PE	ALEXANDER PALM	Pythosperma elegans	20	8	4	REMOVE	50	50		
34	PE	ALEXANDER PALM	Pythosperma elegans	20	8	4	REMOVE	50	50		
35	PE	ALEXANDER PALM	Pythosperma elegans	20	8	4	REMOVE	50	50		
36	PE	ALEXANDER PALM	Pythosperma elegans	20	8	4	REMOVE	50	50		
37	PE	ALEXANDER PALM	Pythosperma elegans	20	8	4	REMOVE	50	50		
38	PE	ALEXANDER PALM	Pythosperma elegans	20	8	4	REMOVE	50	50		
39	PE	ALEXANDER PALM	Pythosperma elegans	20	8	4	REMOVE	50	50		
40	PE	ALEXANDER PALM	Pythosperma elegans	20	8	4	REMOVE	50	50		
41	PE	ALEXANDER PALM	Pythosperma elegans	20	8	4	REMOVE	50	50		
42	PE	ALEXANDER PALM	Pythosperma elegans	20	8	4	REMOVE	50	50		
43	PE	ALEXANDER PALM	Pythosperma elegans	20	8	4	REMOVE	50	50		
44	PE	ALEXANDER PALM	Pythosperma elegans	20	8	4	REMOVE	50	50		
45	PE	ALEXANDER PALM	Pythosperma elegans	20	8	4	REMOVE	50	50		
46	PE	ALEXANDER PALM	Pythosperma elegans	20	8	4	REMOVE	50	50		
47	AM	CHRISTMAS PALM	Adonidia merrillii	30	10	4	REMOVE	79	79		PROHIBITED SPECIES-MUST REMOVE
48	AP	AUSTRALIAN PINE	Casuarina species	20	10	4	REMOVE	79	79		PROHIBITED SPECIES-MUST REMOVE
49	AP	AUSTRALIAN PINE	Casuarina species				REMOVE				PROHIBITED SPECIES-MUST REMOVE
50	AP	AUSTRALIAN PINE	Casuarina species				REMOVE				PROHIBITED SPECIES-MUST REMOVE
TOTALS								6,445	2,923		
FIELD INVENTORY CONDUCTED BY JFS DESIGN INC. ON AUGUST 2, 2017											

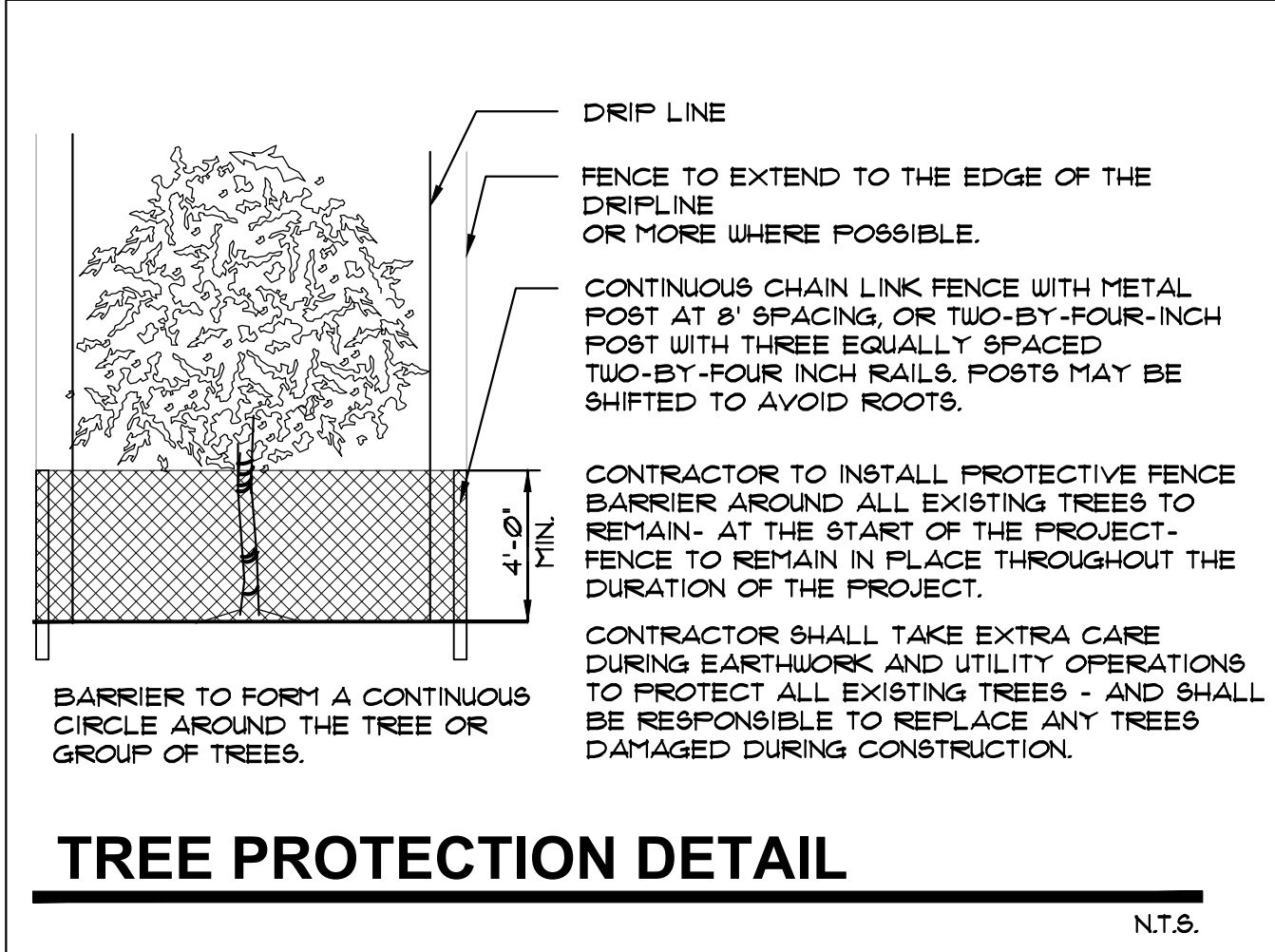

TREE REMOVAL REPLACEMENT SCHEDULE		
EXISTING TREE CANOPY 6,445 SQ. FT.	REQUIRED SQ. FT.	PROVIDED SQ. FT.
TOTAL TREE CANOPY LOSS		
2,923 SQ. FT.		
PROPOSED TREES:		
CATEGORY 1 TREE (12' ht) = 10 Trees 300 sq. ft. / tree		3,000
CATEGORY 2 TREE (10' ht) = 3 Tree 150 sq. ft. / tree		450
CATEGORY 3 TREE (10' ht) = 0 Tree 100 sq. ft. / tree		0
CATEGORY 4 PALM (6' Clear trunk) = 9 palms 50 sq. ft. / palm		450
TOTAL TREE CANOPY PROVIDED		3,900 SQ. FT.

CITY OF MIAMI BEACH TREE DISPOSITION NOTES	
SHALL TAKE PRECEDENCE OVER ANY OTHER NOTES OR DISCREPANCIES	
1	The Landscape Contractor shall guarantee all new and or relocated trees and palms for a period of 1-year from the date of initial acceptance and approval.
2	All guying and staking shall be removed from all trees and palms within twelve months after planting. Exceptions require written authorization from the City Urban Forester.
3	Tree protection barriers may not be taken down, modified and or removed without written authorization from the City Urban Forester.
4	Mulch shall not be applied within 6" of any tree or palm trunks that are installed or incorporated into the project.
5	A final on-site inspection shall be required by the Urban Forestry Division staff prior to any official acceptance of ROW plant material, in order to verify proper planting depth, spacing and quality of the material. Failure to conduct the inspection could result in rejection of the plant material.

■ POST-STORM LANDSCAPE REVIEW:

- THE PROPERTY SHALL BE REVIEWED BY AN ISA CERTIFIED ARBORIST FOR ANY HAZARDOUS CONDITIONS, I.E. HAZARD OR POTENTIAL HAZARDOUS TREES TO BE ELIMINATED IMMEDIATELY.
- EXISTING SITE CONDITIONS ARE TO BE RETROFITTED TO INCLUDE CLEANUP REMOVAL OF DEAD OR DAMAGED PLANT MATERIAL, REMOVAL OF ALL PROHIBITED SPECIES, I.E. BRAZILIAN PEPPER, MELALEUCA, AUSTRALIAN PINE, ETC. AND REMOVAL OF ALL DEBRIS FROM THE PROPERTY.
UNDERTAKING OF THIS TASK SHALL FURTHER PROVIDE ADEQUATE OPPORTUNITY TO SUBSEQUENTLY PLANT PER THE APPROVED LANDSCAPE PLANS.
- EXISTING TREES AND PALMS TO REMAIN SHALL BE TRIMMED PER ANSI-300 STANDARDS. SUPERVISION OF THE TRIMMING SHALL BE PERFORMED BY AN ISA-CERTIFIED ARBORIST.
- ALL EXISTING TREES AND PALMS SHALL BE 'LIFTED AND THINNED' TO PROVIDE FOR AN 8' MINIMUM CLEARANCE FOR SIDEWALKS AND PEDESTRIAN WALKWAYS AND A 14' MINIMUM CLEARANCE FOR ROADWAYS, DRIVEWAYS, AND ALL VEHICULAR USE AREAS.
- ALL PERIMETERS (TO INCLUDE PROPERTY AND BUILDING) ARE TO BE CLEANED-UP OF OVERGROWN VEGETATION WITH REMOVAL OF VINES, WEEDS, ETC. AND SHALL BE APPROVED BY THE CITY LANDSCAPE INSPECTOR PRIOR TO FINAL LANDSCAPE APPROVAL.
- MODIFICATIONS TO THE LANDSCAPE RELATED PLANS (BY THIS OFFICE) DO NOT CONSTITUTE IDENTIFICATION OF HAZARDOUS CONDITIONS OR VEGETATION WITHOUT A WRITTEN AND SIGNED REPORT FROM AN ISA CERTIFIED ARBORIST.

■ PROHIBITED SPECIES:

SEC. 18A-12: PROHIBITIONS:

(A) PROHIBITED PLANT SPECIES. PROHIBITED SPECIES SHALL NOT BE PLANTED AND SHALL BE REMOVED FROM ANY SITE AND SHALL BE REMOVED FROM ANY SITE WHICH IS SUBJECT TO THE REQUIREMENTS OF THIS CHAPTER.

NOTES:

- A WRITTEN TREE REMOVAL PERMIT IS REQUIRED FROM THE LOCAL GOVERNING AGENCY PRIOR TO REMOVAL OF ANY TREES OR PALMS FROM THE SITE.
- SEE LANDSCAPE PLANS FOR PROPOSED LANDSCAPE PLANTINGS, LANDSCAPE LEGEND, PLANTLIST, SPECIFICATIONS, DETAILS, ETC.
- THE CONTRACTOR SHALL REMOVE ALL TREES AND HEDGES AS PER PLANS AND AS APPROVED BY THE LOCAL GOVERNING AGENCIES (CITY OF MIAMI BEACH). TREE, PALM AND HEDGE MATERIAL SHALL INCLUDE ALL TRUNKS, STUMPS AND ROOTS. ALL EXCESS DEBRIS SHALL BE REMOVED FROM THE SITE AND DISPOSED OF AT AN APPROVED SITE. ALL HOLES AND DEPRESSIONS SHALL BE BACKFILLED WITH CLEAN, APPROVED FILL.
- LOCATIONS SHOWN FOR THE EXISTING TREES AND PALMS ARE APPROXIMATE, EXACT LOCATIONS ARE TO BE FIELD VERIFIED BY A REGISTERED LAND SURVEYOR (RLS) PRIOR TO ANY PAVING OR ANY OTHER SUCH WORK WHICH WILL BE IMPACTED BY ANY TREES OR PALMS TO REMAIN.
- ALL INVASIVE EXOTIC VEGETATION AND ANY ANY OTHER PLANTS LISTED AS CATEGORY 1, ON THE FLORIDA EXOTIC PEST PLANT COUNCIL'S LIST OF FLORIDA'S MOST INVASIVE SPECIES SHALL BE REMOVED FROM THE SITE AND MAINTENANCE SHALL GUARANTEE CONTROL OF RE-INVASION.

north

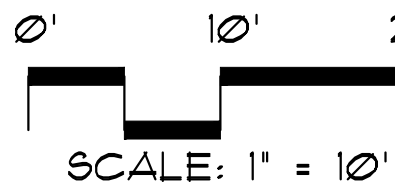
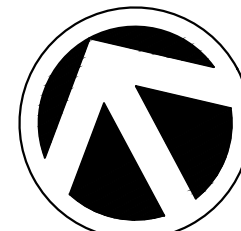

SCALE: 1" = 10'

A WRITTEN TREE REMOVAL PERMIT IS REQUIRED FROM THE CITY OF MIAMI BEACH PRIOR TO REMOVAL OF ANY TREES FROM THIS SITE.

SEE LANDSCAPE PLANS FOR PROPOSED PLANTINGS, LANDSCAPE LEGEND, DETAILS, NOTES, ETC.

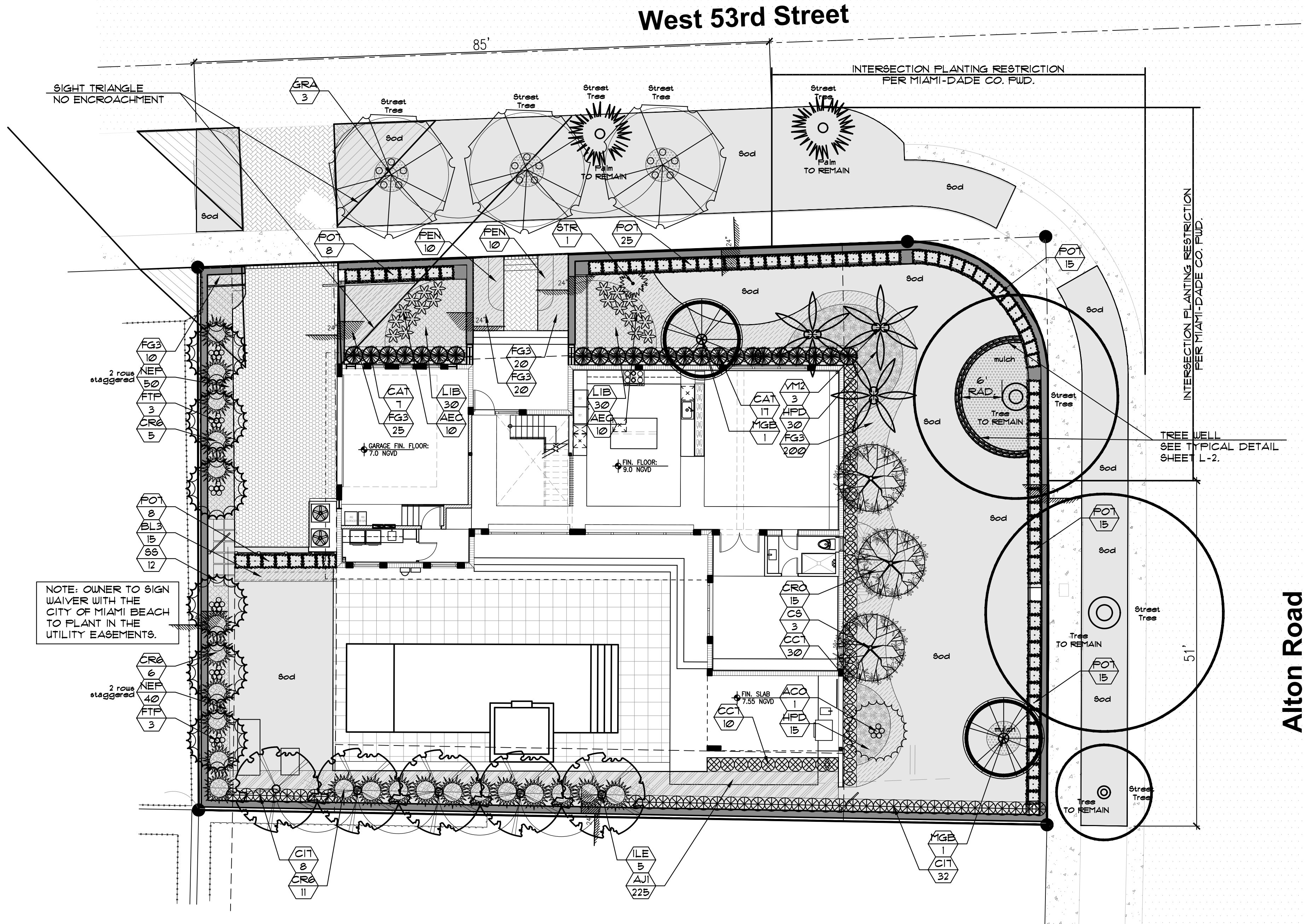

CITY OF MIAMI BEACH LANDSCAPE NOTES	
SHALL TAKE PRECEDENCE OVER ANY OTHER LANDSCAPE NOTES OR DISCREPANCIES	
1	"Tree protection fences shall be constructed prior to any construction activity including grubbing for all trees/palms to remain or be relocated. Fences should be of sturdy construction, preferably 4x4 posts with wire mesh. Orange plastic mesh fences are ineffective because they are easily removed, dropped, knocked down, ignored, etc. Fences must be maintained intact until the project is completed. They should not be removed or dropped for any reason without authorization from the city's urban forester. No activity or disturbance should occur within the fenced areas, including vehicle use, storage of materials, dumping of liquids or materials, grade changes, grubbing, and mechanical trenching for irrigation, electrical lighting, etc."
2	All proposed irrigation in City property shall follow CMB irrigation specifications.
3	"Do not place fill, rocks, grading sand nor any other construction material over the roots or in the root zone."
4	"Any proposed tree root or structural pruning shall be performed by an ISA Certified Arborist in accordance with ANSI A-300 (part 1) pruning standards. Tree pruning should be limited to the bare minimum required to achieve clearance for construction activities and the City Urban Forester shall be consulted prior to the start of any tree or root pruning onsite."
5	"Mulch shall be kept a minimum of 6" away from all trunks of trees and palms. Fill/topsoil shall not be placed on top of the root ball."
6	"The City Urban Forester and or Greenspace Management Staff shall be notified prior to installation of trees or palms in the ROW to inspect the planting holes and conduct a grades and standards inspection."
7	"Contractor is responsible for the maintenance and/or repair of all staking and guying of trees and palms during warranty period and removal & disposal of staking within 1-year of installation. Exceptions to this require the written approval of the City Urban Forester."
8	Required street trees are subject to the review and approval of the CIP office and PW/ Greenspace Division prior to installation

CITY OF MIAMI BEACH

LANDSCAPE LEGEND

INFORMATION REQUIRED TO BE PERMANENTLY AFFIXED TO PLANS

Zoning District RS-4 Lot Area 10,329 s.f. Acres 0.23

OPEN SPACE

A. Square feet of required Open Space as indicated on site plan:

Lot Area = 10,329 s.f. x 50 % = 5,165 s.f.

B. Square feet of parking lot open space required as indicated on site plan:

Number of parking spaces 2 x 10 s.f. parking space =

C. Total square feet of landscaped open space required: A+B=

LAWN AREA CALCULATION

A. Square feet of landscaped open space required

B. Maximum lawn area (sod) permitted= 50 % x 5,165 s.f.

TREES

A. Number of trees required per lot or net lot acre, less existing number of trees meeting minimum requirements=

_____ trees x _____ net lot acres - number of existing trees=

B. % Natives required: Number of trees provided x 30% =

C. % Low maintenance / drought and salt tolerant required:

Number of trees provided x 50% =

D. Street Trees (maximum average spacing of 20' o.c.)

136 ft linear feet along street divided by 20' =

E. Street tree species allowed directly beneath power lines:

(maximum average spacing of 20' o.c.):

_____ linear feet along street divided by 20' =

SHRUBS

A. Number of shrubs required: Sum of lot and street trees required x 12=

B. % Native shrubs required: Number of shrubs provided x 50% =

LARGE SHRUBS OR SMALL TREES

A. Number of large shrubs or small trees required: Number of required shrubs x 10% =

B. % Native large shrubs or small trees required: Number of large shrubs or small trees provided x 50% =

STREET TREE TABULATIONS

REQUIRED STREET TREES ARE SUBJECT TO THE REVIEW AND APPROVAL OF THE CIP OFFICE AND PW GREENSPACE DIVISION PRIOR TO INSTALLATION.	REQUIRED	PROVIDED
West 53rd St. 85 LF. @ 1 TREE / 20 LF. = 5	5	5 2 EXIST. + 3 GRA
Alton Road 51 LF. @ 1 TREE / 20 LF. = 3	3	3 3 EXIST.
TOTAL	8	8

north

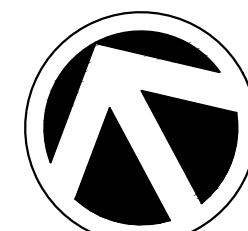

A WRITTEN TREE REMOVAL PERMIT IS REQUIRED FROM THE CITY OF MIAMI BEACH PRIOR TO REMOVAL OF ANY TREES FROM THIS SITE.

SEE SHEET L-2 FOR LANDSCAPE DETAILS, NOTES, SPECIFICATIONS, ETC.

SEE IRRIGATION PLANS FOR IRRIGATION LAYOUT, IRRIGATION DETAILS, NOTES, SPECIFICATIONS, ETC.

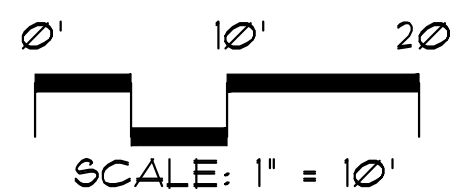

SCALE: 1" = 10'

PLANTLIST

SYM.	NATIVE	*	NAME	BOTANICAL NAME	SPECIFICATION
EXISTING TREES TO REMAIN					
SEE TREE DISPOSITION PLAN, SHEET TD-1					
PROPOSED TREES					
GRA	3		BRIDALVEIL TREE	Caesalpinia granadillo	12' x 6' apr., 2 1/2" cal., 6' c.t.
CS	YES	3	ORANGE GEIGER	Cordia sebestena	FG, 10' x 5', 2' cal.
ILE	YES	5	EAGLESTON HOLLY	Ilex x attenuata 'Eagleston'	FG, 12' o.a., full
MGB	YES	2	'BLANCHARD' MAGNOLIA	Magnolia grandiflora 'Blanchard'	100 gal, 12'-14', x 6'
PALMS					
ACO	YES	1	PAUROTIS PALMS	Acroelorrhaphe wrightii	FG, 10' o.a., min. 5 tks @ o.a.
FTP		6	FISHTAIL PALM	Caryota mitis	FG, 12'-14' o.a. cluster
YM2		3	MONTGOMERY PALMS	Veitchia montgomeryana	DBL. TK, FG, 14' o.a., full hd.
SHRUBS					
CC1	YES	40	JAMAICA CAPER	Capparis cynophallophora	1 gal, 30" x 24", 24" o.c. full
C17	YES	40	COCOPLUM	Chrysobalanus icaco	1 GAL., 30" x 24" full, 24" o.c.
CR6	YES	22	SMALL-LEAVED CLUSIA	Clusia guttifera	6' ht., 48" ØC, FTB.
CRO		15	CROTON 'PETRA'	Codiaeum variegatum	3 gal, 18" x 18", 18" o.c., full
HPD	YES	45	DWARF FIREBUSH	Hamelia nodosa	3 gal, 18" x 18", 24" o.c.
POT		86	PODOCARPUS HEDGE	Podocarpus spp.	1 gal, 30" x 24", full heavy
LANDSCAPE MATERIALS					
SS		12	STEPPING STONES	18" x 18", SIMULATED KEYSTONE,	on 2" sand leveling course, level to grade

PLANTLIST

SYM.	NATIVE	*	NAME	BOTANICAL NAME	SPECIFICATION
ACCENT PLANTS AND GROUNDCOVERS					
AEC	20		AECHMEA BROMELIADS	Aechmea blanchetiana 'Orange'	3 gal, 18" x 18", BULLIS
CAT	24		CAT PALMS	Chamadorea cataractarum	1 gal, 30" x 24", 30" o.c.
BL3	15		BLUEBERRY FLAX LILY	Dianella tasmanica	3 gal, 12" x 18", 18" o.c., full
FG3	235		'GREEN ISLAND' FICUS	Ficus 'Green Island'	3 gal, 18" x 18", 18" o.c., full
LIB	60		LIRIOPE 'BIG BLUE'	Liriope muscari 'Big Blue'	1 gal, 9" x 9", 10" o.c.
NEP	YES	90	BOSTON FERN	Neprolepis exaltata	1 gal, 12" x 12" full, 15" o.c.
PEN	20		EGYPTIAN STAR CLUSTER	Pentas lanceolata	1 gal, 10" x 10", 14" o.c., full
RHA	1		LADY PALMS	Rhapis excelsa	5'o.a., FTG, sun acclimated
STR	1		BIRD OF PARADISE	Strelitzia reginae	1 gal, 24" o.a. ht.
AJ1	225		ASIATIC JASMINE	Tracheloperum asiaticum	1 gal, 12" o.c.
SOD					
FLO	4500	SF.	'FLORATAM' ST. AUGUSTINE	Stenotaphrum secundatum	SOLID SOD, price per s.f.
TOPSOIL:					
			TOPSOIL: SAND MIX	50:50 TOPSOIL: SAND MIX, SPREAD IN PLACE	
			12 C.Y.	TREES, PALMS, SHRUBS AND GROUNDCOVERS	
			30 C.Y.	AREA TO BE SODDED WITH A 2" DEPTH OF TOPSOIL SPREAD IN PLACE	
MULCHING:					
			20 C.Y. +/-	'PINE BARK' MULCH	3" DEPTH, SPREAD IN PLACE, ATLAS PEAT AND SOIL
PROVIDE SAMPLE FOR APPROVAL PRIOR TO INSTALLATION					
--- TOPSOIL, SOD AND MULCH QUANTITIES SHOWN ARE APPROXIMATE, CONTRACTOR TO PROVIDE A UNIT PRICE PER UNIT AND WILL BE PAID ON THAT UNIT PRICE BASIS UPON FINAL INSPECTION AND APPROVAL.					

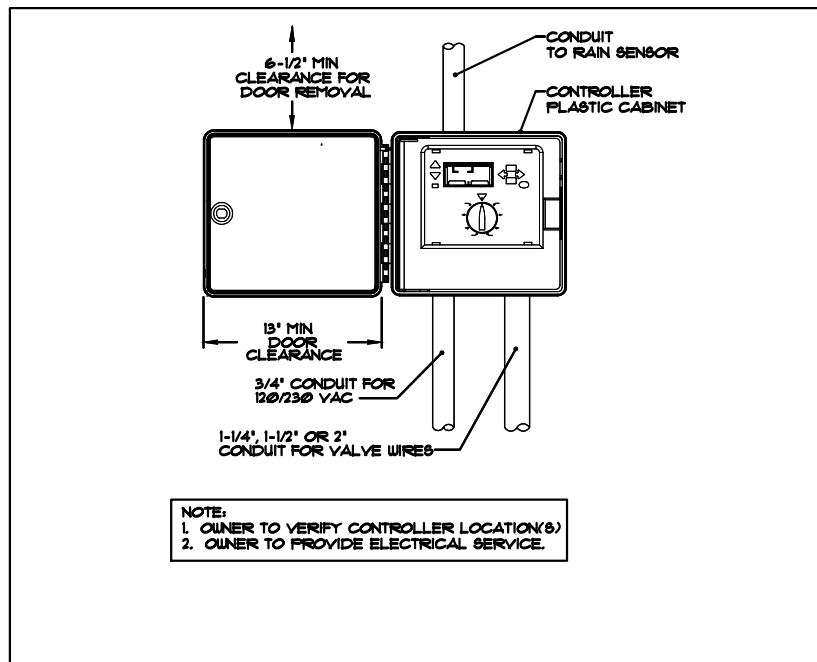
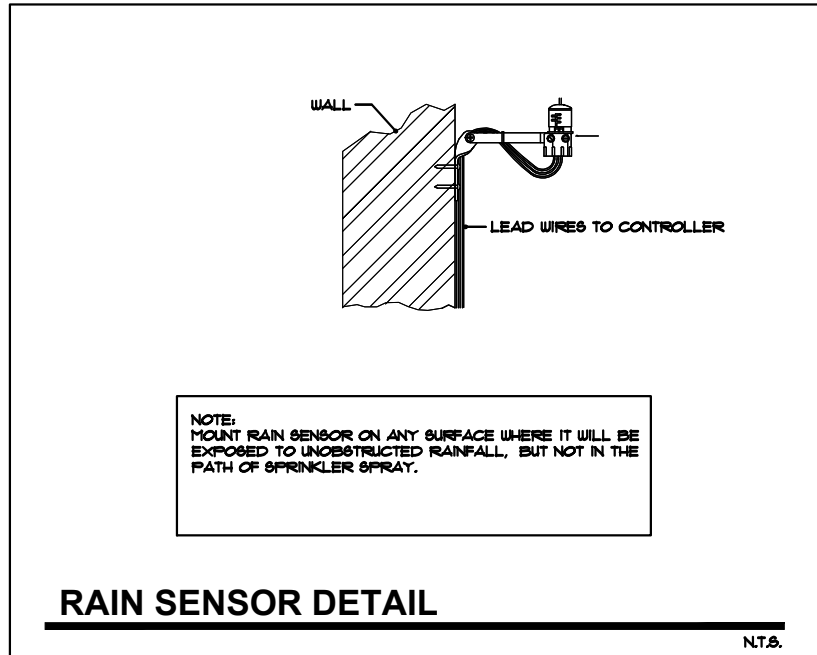
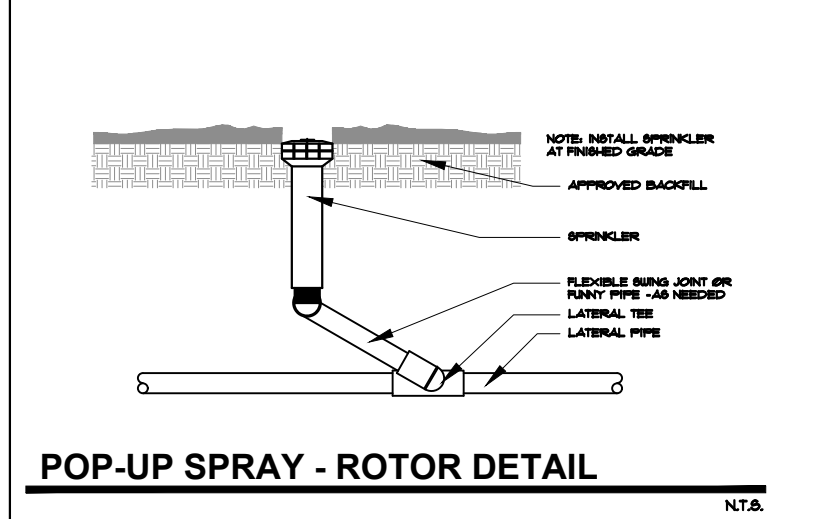

- GENERAL IRRIGATION NOTES**
- IRRIGATION CONTRACTOR SHALL PROVIDE, FURNISH AND INSTALL A FULLY AUTOMATIC IRRIGATION SYSTEM WHICH WILL COMPLY WITH ALL LOCAL CODE, STATE CODE & FLORIDA WATER MANAGEMENT DISTRICT (SFWMD) REQUIREMENTS.
 - THE IRRIGATION CONTRACTOR SHALL SCHEDULE AN ON-SITE PRE-CONSTRUCTION CONFERENCE WITH THE OWNER & THE OWNER'S AUTHORIZED REPRESENTATIVE PRIOR TO COMMENCEMENT OF INSTALLATION OF THE IRRIGATION SYSTEM.
 - CONTRACTOR SHALL INSTALL A POP-UP TYPE HEADS. SPRAY TYPE SHALL BE ROTOR, IMPACT, SPRAY OR BUBBLER AND SHALL BE SO INSTALLED TO NOT CAUSE ANY OVERSPRAY ONTO ANY PAVED SURFACES, I.E. ROADS, SIDEWALKS, ETC. ALL FITTINGS SHALL BE "TORO", "RAINBIRD" OR AN APPROVED EQUAL. MAIN LINE SHALL BE DONE IN A PROFESSIONAL MANNER AND AS PER THE MANUFACTURER'S SPECIFICATIONS. SPRAY HEADS SHALL BE 4" POP-UPS FOR SOODED AREAS, 8" FOR GROUND COVER PLANTINGS AND 12" POP-UPS FOR ALL PLANTING AND SHRUB BEDS. SPRAY HEADS ON RISERS SHALL ONLY BE PERMITTED PER THE LAND ARCH.
 - ALL MAIN SUPPLY LINE SHALL BE PVC SCHEDULE 40 PIPE. ALL PVC FITTINGS SHALL BE SCHEDULE 40. THE MAIN LINE IS SHOWN SCHEMATICALLY. LOCATE MAIN LINES IN LANDSCAPE AREAS WHERE POSSIBLE AND SLEEVE UNDER PAVEMENT WHERE NECESSARY. MAIN LINES SHALL BE IN THE SAME TRENCH WITH LATERAL LINES WHERE POSSIBLE.
 - CONTRACTOR SHALL CONSTRUCT CONCRETE THRUST BLOCKS, 12" X 12" X 12" AT ALL "T" INTERSECTIONS OR BENDS 45 DEGREES OR GREATER ON THE MAIN LINE.
 - MINIMUM PIPE SIZE SHALL BE 3/4" PIPE.
 - CONTRACTOR SHALL FAMILIARIZE HIMSELF WITH THE LOCATION OF AND AVOID & PROTECT ALL UTILITY LINES, DUCTS, BURIED CABLES AND OTHER UTILITIES IN THE AREA. CONTRACTOR WILL BE RESPONSIBLE FOR THE REPAIR, LIABILITY AND COSTS INCURRED IN THE DAMAGE OR DESTRUCTION OF SAID UTILITIES. CALL U.N.C.L.E. (800) 432-8770, 48 HOURS PRIOR TO COMMENCEMENT OF ANY WORK FOR PROPER UTILITY LOCATION AND CLEARANCES.
 - THE CONTRACTOR SHALL SECURE ALL WORK WITH THE PROJECT MANAGER, LANDSCAPE CONTRACTOR AND ALL OTHER CONTRACTORS TO INSURE PROPER INSTALLATION, SCHEDULING AND PROCEDURE.
 - THE CONTRACTOR SHALL COORDINATE WITH THE PROJECT MANAGER TO PROVIDE ELECTRICAL SUPPLY TO THE CONTROLLER, PUMP, ETC. AS NEEDED.
 - THE CONTRACTOR SHALL BE RESPONSIBLE TO SECURE ALL PERMITS AS MAY BE DEEMED NECESSARY TO PERFORM THE WORK. ENTIRE SYSTEM SHALL BE INSTALLED IN COMPLIANCE WITH ALL LOCAL AND STATE CODES. THE OWNER IS RESPONSIBLE FOR ALL PERMIT FEES.
 - ALL SLEEVES UNDER PAVEMENT SHALL BE BURIED PER FL. BLDG CODE, APPENDIX "F". ALL LATERAL SLEEVES UNDER SIDEWALKS SHALL BE BURIED BELOW WALKWAYS AND SHALL BE SCHEDULE 40 PVC. ALL SLEEVING SHALL BE SCHEDULE 40 PVC PIPE & SHALL BE 2 TIMES THE MAIN OR LATERAL PIPE SIZE.
 - THE CONTRACTOR SHALL CONNECT THE MASTER VALVE (WHEN APPLICABLE) & ALL ELECTRIC VALVES TO THE CONTROLLER & PROVIDE PROPER SYNCHRONIZATION.
 - ALL LOW-VOLTAGE ELECTRIC VALVES SHALL BE #14 DIRECT BURIAL. ALL WIRES UNDER ROADS TO BE PLACED IN A SEPARATE 1" SLEEVE. CONTRACTOR SHALL PROVIDE A MINIMUM OF 2 EXTRA WIRES FOR EMERGENCY POST-INSTALLATION WIRING.
 - ALL LINE LOCATIONS ARE APPROXIMATE. CONTRACTOR SHALL ADJUST TRENCHING AND LOCATION OF SPRAY HEADS IN THE FIELD FOR EXISTING CONDITIONS, WALKS, UTILITIES, STRUCTURES & PLANTINGS TO PROVIDE AND INSURE 100% COVERAGE AND 100% OVERLAP.
 - CONTRACTOR SHALL PROVIDE A ONE-YEAR GUARANTEE ON ALL PARTS AND A 90-DAY GUARANTEE ON LABOR FROM THE DATE OF FINAL ACCEPTANCE.
 - THE IRRIGATION CONTRACTOR SHALL RECORD ALL CHANGES MADE TO THE IRRIGATION SYSTEM DURING INSTALLATION & PROVIDE AN AS-BUILT DRAWING TO THE OWNER'S REPRESENTATIVE UPON COMPLETION AND ACCEPTANCE OF THE WORK.
 - THE IRRIGATION CONTRACTOR SHALL INSTRUCT THE OWNER OR THE OWNER'S REPRESENTATIVE IN THE COMPLETE OPERATION & MAINTENANCE OF THE SYSTEM. THE CONTRACTOR SHALL FURNISH TWO (2) COPIES OF AN IRRIGATION SYSTEM MANAGEMENT MANUAL PREPARED BY THE MANUFACTURER & THE SYSTEM INSTALLER.
 - THE IRRIGATION CONTRACTOR SHALL CHECK AND ADJUST THE SYSTEM AT THE END OF THE 90-DAY PERIOD, FROM THE DATE OF FINAL ACCEPTANCE.
 - ANY IRRIGATION PIPING WITHIN THE CONFINES OF ANY BUILDING SHALL BE CLEARLY MARKED "NON POTABLE WATER".
 - TREE AND PALM PLANTINGS IN RIGHTS OF WAYS SHALL HAVE ONE FLOOD BUBBLER PER TREE OR PALM. COORDINATE PIPING AND SEEVING AS NEEDED.

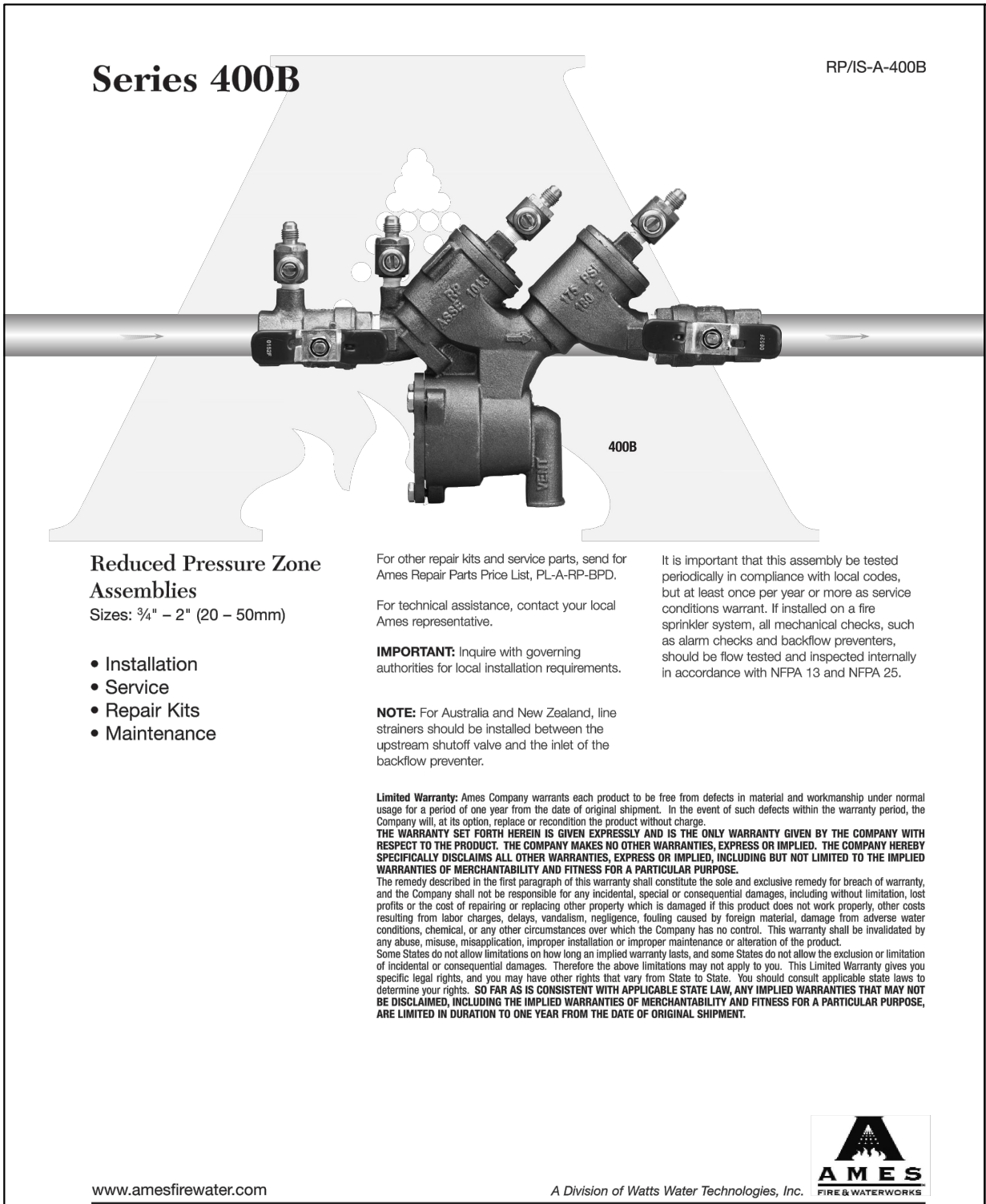
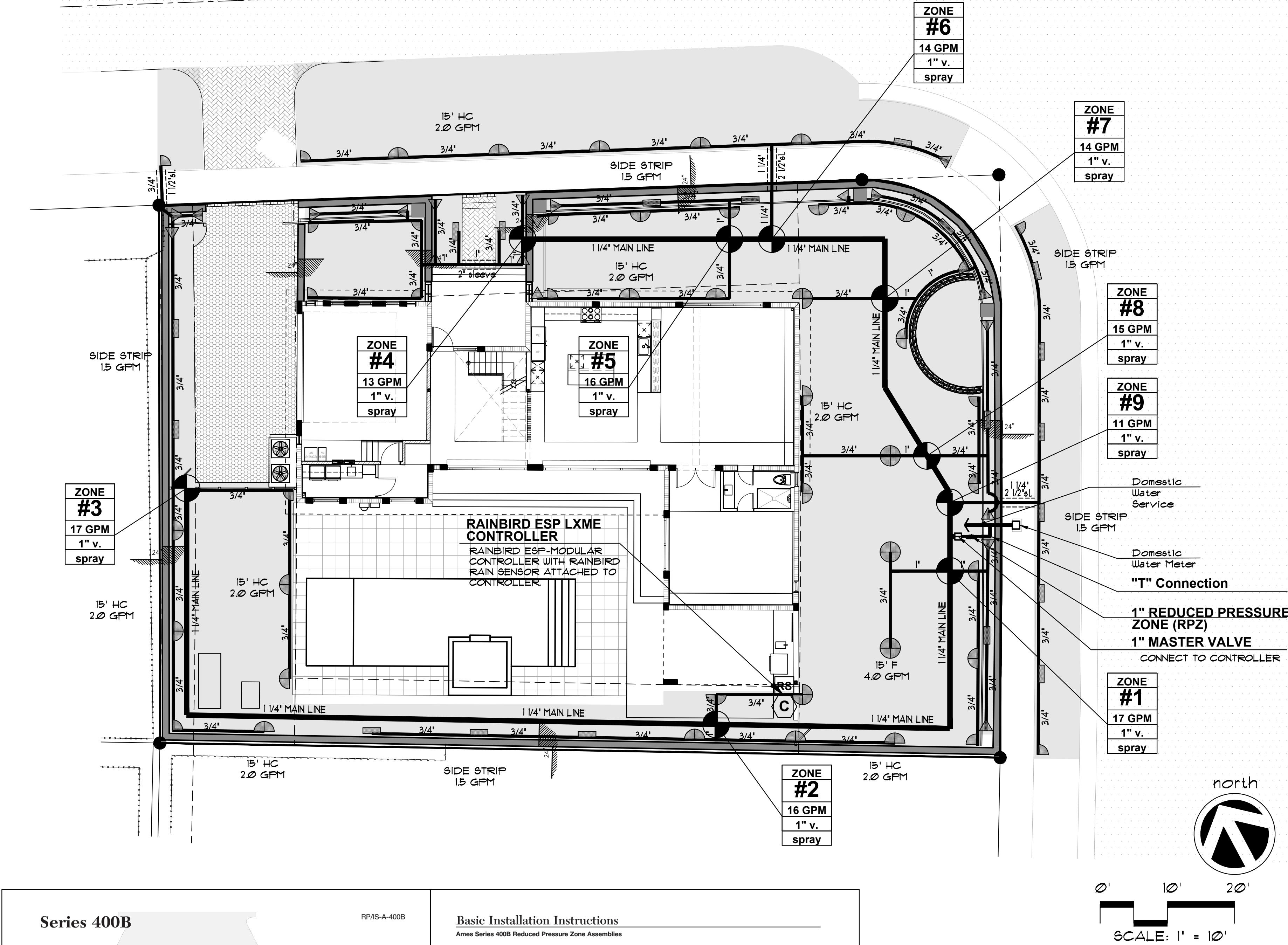

- Basic Installation Instructions**
- Ames Series 400B Reduced Pressure Zone Assemblies**
- Indoor Installation**
- For indoor installations, make sure the Series 400B is easily accessible to facilitate testing and servicing. Do not install in concealed locations. If the location of the Series 400B is parallel and close to the wall, make sure the test cocks are easily accessible, and the drain line can adequately drain if required. An air gap and drain line (see literature ES-A-AG/EL/TC) are piped from the relief valve connection as shown, allowing evidence of discharge to be clearly visible and preventing the occurrence of water damage.
- Outdoor, Above Ground Installation**
- For outdoor installations, it is recommended that you install the Series 400B-A where there are no freezing conditions and above ground whenever possible.
- You must install the Series 400B in an accessible location to facilitate testing and servicing. The installation must also allow for adequate drainage from the air gap and the discharge line if needed.
- WARNING**
- Do not allow the drain line to empty directly into a drainage ditch, sewer system, or sump.
 - Do not install the Series 400B in any location where any part of the unit could become submerged in standing water.
- Parallel Installation**
- For parallel installations, you can install two or more small sized Series 400B's (when approved) to serve a large supply close main. You can use this type of installation in an application where increased capacity beyond that provided by a single valve is required. Additionally, this type of installation permits testing and/or servicing of a single valve without shutting down the complete line.
- The number of Series 400B units installed in parallel should be determined by the engineer's judgement, based on the operating conditions of a specific application.
- NOTE:** The total capacity of all the units installed in the application should equal or exceed that required by the system.

IRRIGATION LEGEND

- DOMESTIC WATER METER
- 1' REDUCED PRESSURE ZONE (RPZ)
- PROPOSED 1 1/4" PVC Main Supply Line- SCHEDULE 40
- IRRIGATION CONTROLLER RAINBIRD ESP-LX-ME MODULAR
- RAIN SENSOR- RAINBIRD RSD SERIES ATTACHED TO CONTROLLER
- UNION BOX W/ WATERPROOF CONNECTORS
- EXISTING ELECTRIC VALVE
- 1' ELECTRIC VALVES, RAINBIRD FEB SERIES, OR APPROVED EQUAL IN 10" VALVE BOX
- ZONE DESIGNATION
- LATERAL LINE (SCHEDULE 160)
- PIPE IN SLEEVE (SEE SIZING CHART)
- PIPE CONNECTION
- PIPE CROSSING
- RAINBIRD "FALCON" 6504 ROTORS, 8.3 GPM OR APPROVED EQUAL, FULL OR PART CIRCLE AS NEEDED
- RAINBIRD 3500 ROTORS OR APPROVED EQUAL, 3.0 GPM, FULL OR PART CIRCLE AS NEEDED
- RAINBIRD ROTARY NOZZLES, MODEL 1800 13'-24' SPACING AS SHOWN, PART OR FULL CIRCLES AS NEEDED 2.5 GPM
- RAINBIRD 1800 STRIP-TYPE 15' EST (END STRIP), 15' CST (CENTER STRIP)
- RAINBIRD 1800 "U" SERIES' FRB, 4", 6", 12" POP-UP- QUARTER, HALF FULL 10", 12", 15' RADII AS SHOWN.
- RAINBIRD -5 SERIES MFR STREAM BUBBLER, NOZZLES, 5" RADII, 15 GPM

SPECIAL NOTES:

A ROUGH INSPECTION IS REQUIRED BY THE CITY OF MIAMI BEACH PRIOR TO THE BACKFILLING AND A FINAL INSPECTION SHALL BE REQUIRED PRIOR TO COMPLETION OF IRRIGATION WORK.

SOUTH FLORIDA WATER MANAGEMENT DISTRICT WATER RESTRICTIONS PHASE II MODIFIED - ARE IN EFFECT. ALL REQUIREMENTS FOR THESE REGULATIONS SHALL BE STRICTLY ENFORCED WITH CONTRACTOR AND/OR OWNER TO BE RESPONSIBLE THROUGHOUT THIS PROJECT AND POST CERTIFICATE OF OCCUPANCY.

IRRIGATION / SPRINKLER SYSTEM AND RISERS FOR SPRAY HEADS SHALL NOT BE INSTALLED WITHIN 1' (305mm) OF THE BUILDING SIDEWALK IN COMPLIANCE WITH FLORIDA BUILDING CODE, PLUMBING 318.

ALL REQUIREMENTS PER SOUTH FLORIDA BUILDING CODE APPENDIX F ARE TO BE COMPLIED WITH PER CITY OF MIAMI BEACH.

A WRITTEN TREE REMOVAL PERMIT IS REQUIRED FROM THE CITY OF MIAMI BEACH PRIOR TO REMOVAL OF ANY TREES FROM THIS SITE.

SEE LANDSCAPE PLANS FOR PROPOSED PLANTINGS, LANDSCAPE LEGEND, PLANTLIST, DETAILS, ETC.