



Safety Systems Barricades Corp.

Temporary Traffic Control & Protection Services
 "The Right Turn For Your Company"

6138 NW 74th Ave Tel: 305-591-2688
 Miami, FL 33166 Fax: 305-591-2689
 email: contactus@ssbarricades.com

This Certifies that
Sandor Morales
 Has Completed a Florida Department of Transportation Approved
 Temporary Traffic Control (TTC) Advanced (Refresher) Course
 Date Expires: 04/17/2021 Certificate #: 27642
 Instructor: Richard Cabrera FDOT Provider #37

ATSSA
 Phone: 540-368-1701
 15 Powerside Parkway Ste. 100
 Fredericksburg, VA
 www.atssa.com
 donna.clark@atssa.com

Company : ACCURATE EVENT GROUP
 Job Description: **LANE CLOSURE**
 Address: CONVENTION CENTER DR & 18 ST
 MOT Drawing by: Safety Systems Barricades Corp
 Drawings NOT TO SCALE
 Drawing by Sandor Morales
 ATSSA Certificate # 37 Exp. Date: **04/17/2021**

Note: All Traffic Control Devices Must be Set and Place by a certified control personnel.
 Safety Systems Barricades does not Warrant any Traffic control Set Up by others.

To Be Set Up in Accordance with
FDOT Index 621

To Be Set Up in Accordance with
FDOT Index 616

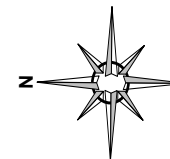

10/24/17

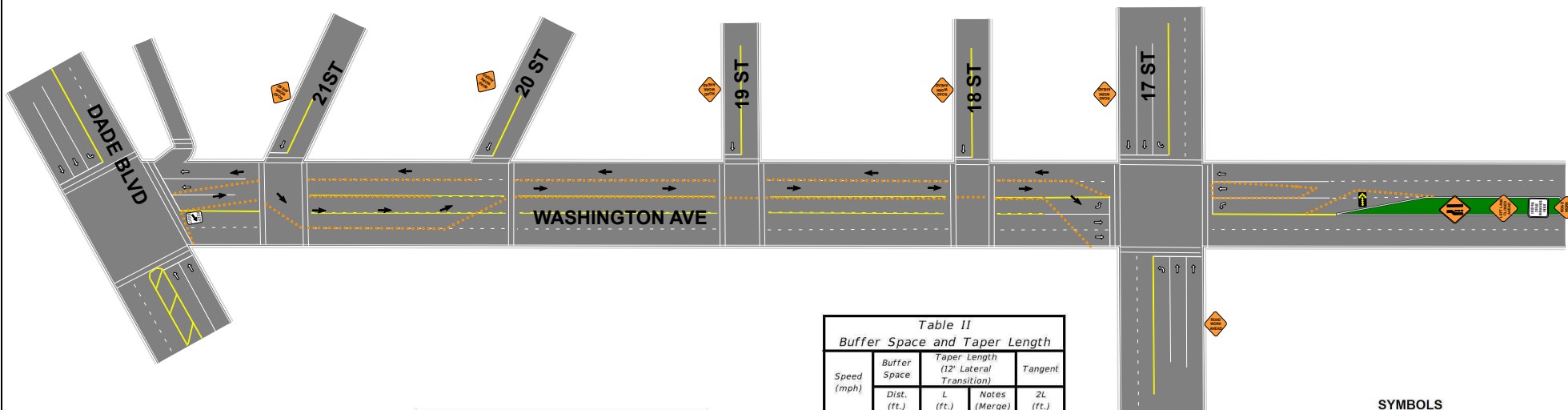

Table I
 Device Spacing

Speed (mph)	Max. Distance Between Devices (ft.)			
	Cones or Tubular Markers		Type I or Type II Barricades or Vertical Panels or Drums	
	Taper	Tangent	Taper	Tangent
25	25	50	25	50
30 to 45	25	50	30	50
50 to 70	25	50	50	100

DISTANCE BETWEEN SIGNS

Speed	Spacing (ft.)			
	A	B	C	D**
40 mph or less	200	200	200	L
45 mph	350	350	350	L
50 mph	500	500	500	L
*55 mph or greater	2640	1640	1000	L

Table II
 Buffer Space and Taper Length

Speed (mph)	Buffer Space	Taper Length (12' Lateral Transition)		Notes (Merge)	Tangent 2L (ft.)
	Dist. (ft.)	L (ft.)	L (ft.)		
25	155	125	125	L = WS ² / 60	250
30	200	180	180		360
35	250	245	245	L = WS	490
40	305	320	320		640
45	360	540	540	1080	
50	425	600	600	1200	
55	495	660	660	1320	
60	570	720	720	1440	
65	645	780	780	1560	
70	730	840	840	1680	

- SYMBOLS**
- Work Area
 - Sign With 18"x18"(Min.)
 - Orange Flag And Type B Light
 - Channelizing Device (See Index No 600)
 - Work Zone Sign
 - Type III Barricades
 - Advance Warning Arrow Board
 - Lane Identification + Direction of Traffic
 - Law Enforcement Officer
 - Flagger