

SURVEYOR'S NOTES

1. This is a Right-of-Way Survey, made on the ground under the supervision of a Florida Registered Land Surveyor. Date of field survey is December 2, 2015.
2. The following surveying instruments were used at time of field visit: Nikon NPL-352, Total Station, Reflectorless and Hiper + Legacy E RTK, GD 1HZ.
3. Bearings are based on Florida East State Plane Coordinates NAD 83 by GPS observation.
4. No underground utilities, underground encroachments or building foundations were measured or located as a part of this survey, unless otherwise shown. Trees and shrubs not located, unless otherwise shown.
5. Benchmark used is a GPS Continuously Operating Reference Station, PID AC2231. Onsite benchmark is as shown hereon. Elevations shown are in feet and refer to NAVD 88.
6. This survey was conducted for the purpose of a Right-of-Way Survey only, and is not intended to delineate the regulatory jurisdiction of any federal, state, regional or local agency, board, commission or other similar entity.
7. Attention is directed to the fact that this survey may have been reduced or enlarged in size due to reproduction. This should be taken into consideration when obtaining scaled data.
8. This Survey was conducted without the benefit of an Abstract Title search.
9. Surveyor hereby states the Geodetic Coordinates and the elevation shown for the proposed centerline of the tower are accurate to within +/- 20 feet horizontally and to within +/- 3 feet vertically (FAA Accuracy Code 1A).
10. Survey shown hereon conforms to the Minimum Requirements as set forth by the State Board for a Class "A" Survey.
11. Field data upon which this map or plat is based has a closure precision of not less than one-foot in 15,000 feet (1':15,000') and an angular error that does not exceed 10 seconds times the square root of the number of angles turned. Field traverse was not adjusted.
12. This survey is not valid without the original signature and the original seal of a state licensed surveyor and mapper.
13. This survey does not constitute a boundary survey of the Parent Tract. Any parent tract property lines shown hereon are from supplied information and may not be field verified.

SURVEYOR'S CERTIFICATION

I certify that all parts of this survey and drawing have been completed in accordance with the current requirements of the Standards of Practice for Surveying in the State of Florida to the best of my knowledge, information, and belief.

William H. Sommerville, III
William H. Sommerville, III
Florida License No. 0006141

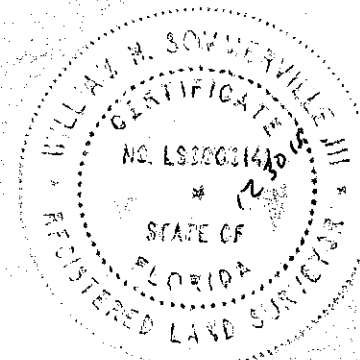

DAS NODE INFO

LATITUDE: 25°46'33.022" NORTH
LONGITUDE: 80°08'14.605" WEST (NAD 83)

GROUND ELEVATION: 1.8'
ABOVE MEAN SEA LEVEL (NAVD88)

VICINITY MAP

NOT TO SCALE

FLORIDA EAST

GRID NORTH
GRID TO TRUE NORTH
CONVERGENCE
0°22'

TRUE NORTH TO MAGNETIC
DECLINATION
6°32' W

COMBINED SCALE FACTOR
1.000033000

LEGEND

- = 5/8" REBAR SET
- = FOUND PROPERTY CORNER
- ⊠ = FOUND P.K. NAIL/DISK
- POB = POINT OF BEGINNING
- POC = POINT OF COMMENCEMENT
- POE = POINT OF ENDING
- ▲ = CALCULATED POINT
- (R) = REFERENCED INFORMATION
- (M) = MEASURED
- ☼ = LIGHT POLE
- ⊞ = WATER METER
- ⊙ = SANITARY MANHOLE
- ⊞ = SIGN
- ✶ = PALM TREE

FLOOD NOTE

By graphic plotting only, the subject property appears to lie in Zone "AE" of the Flood Insurance Rate Map Community Panel No. 12086C0319L, which bears an effective date of 09/11/2009 and is in a special flood hazard area.
Zone AE: Base Flood Elevation is 8', more or less, per the FIRM.

5_17

FRACT. SEC. 3, T-54-S, R-42-E
DADE COUNTY, FLORIDA

RIGHT-OF-WAY SURVEY

AW SOLUTIONS

300 CROWN OAK CENTRE DRIVE
LONGWOOD, FL 32750

SMW Engineering Group, Inc.

158 Business Center Drive
Birmingham, Alabama 35244
Ph: 205-252-6985
www.smweng.com

5_17

525 Jefferson Ave., Miami Beach, FL 33139

Aerial View

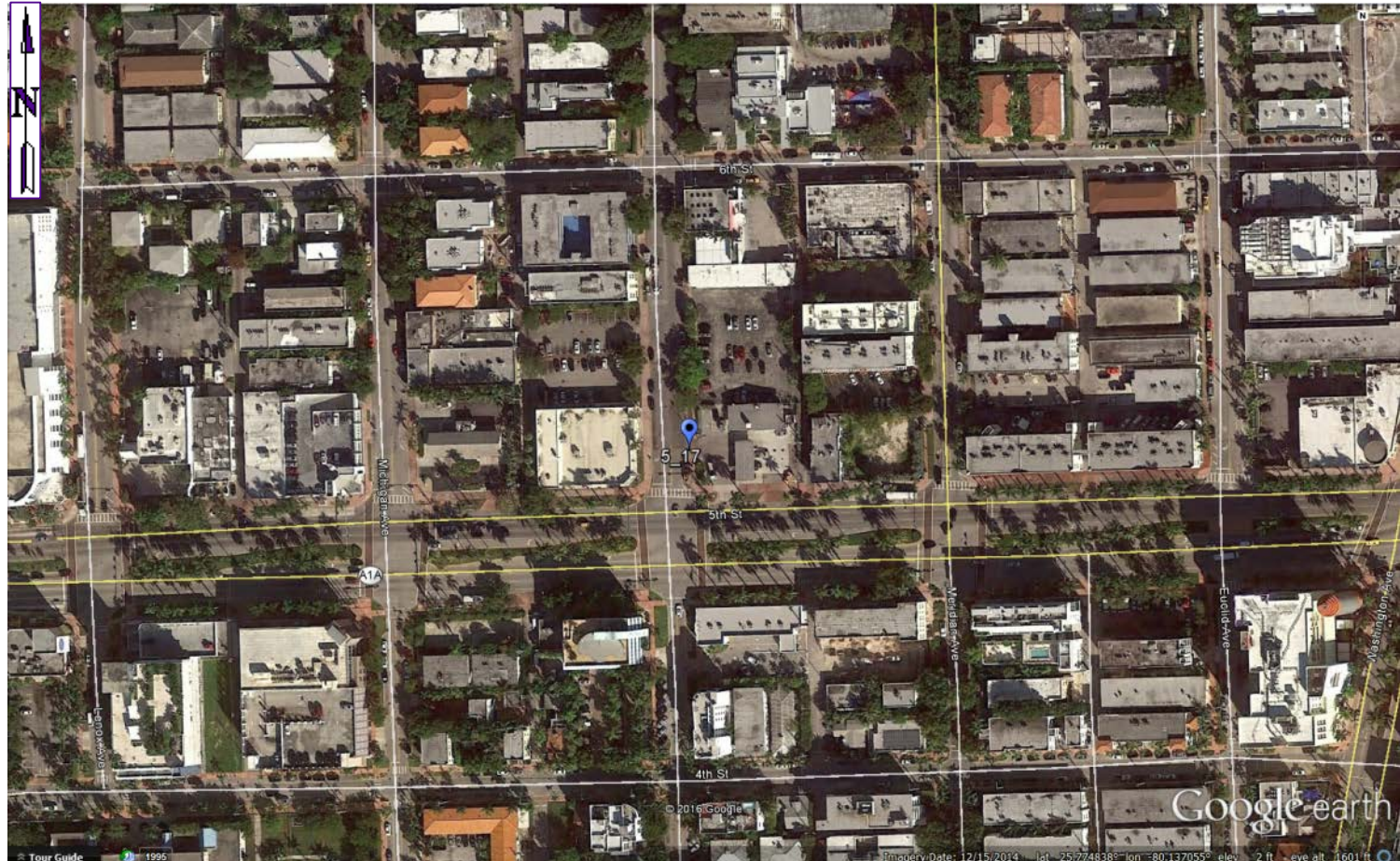

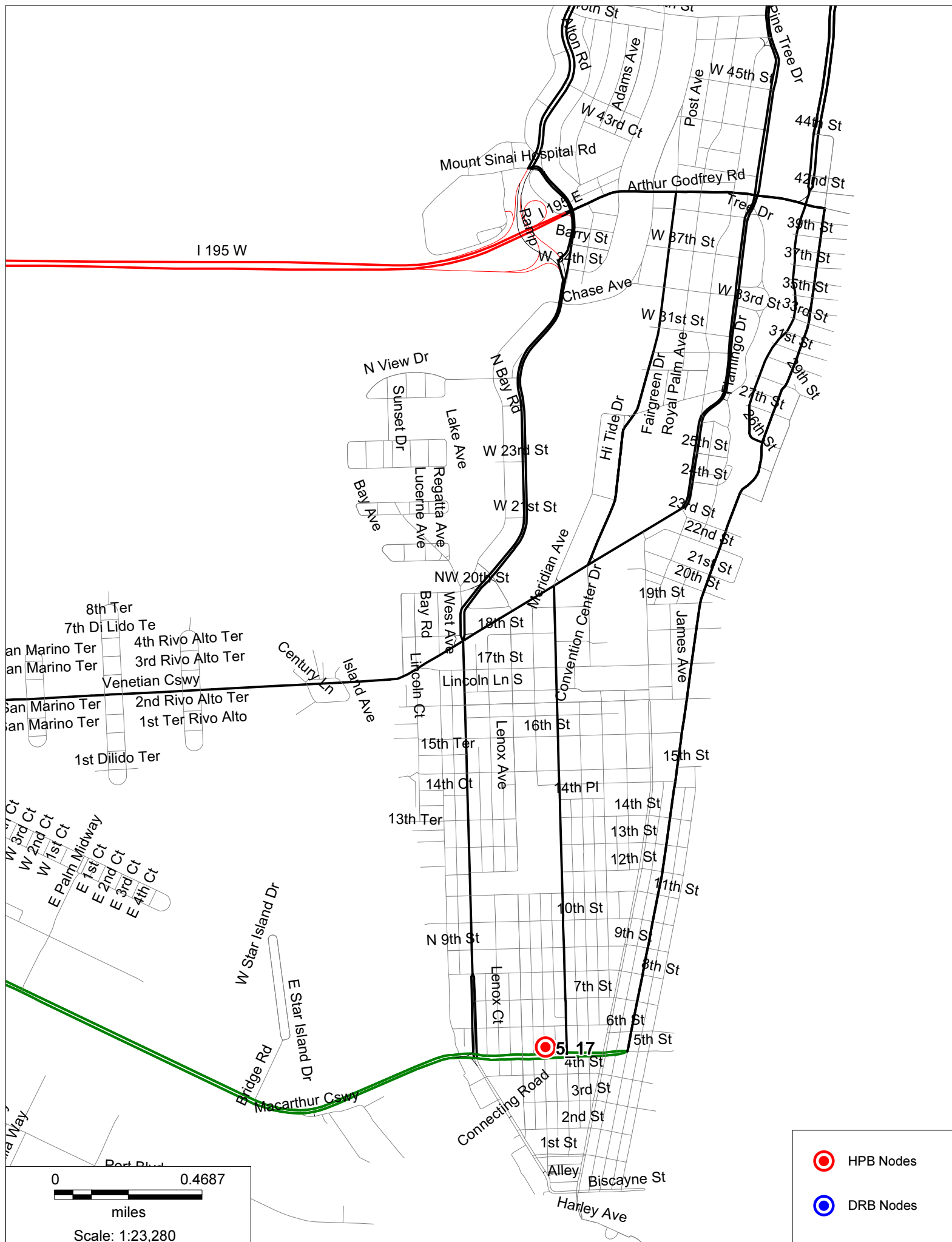

5_17

525 Jefferson Ave., Miami Beach, FL 33139

Aerial View

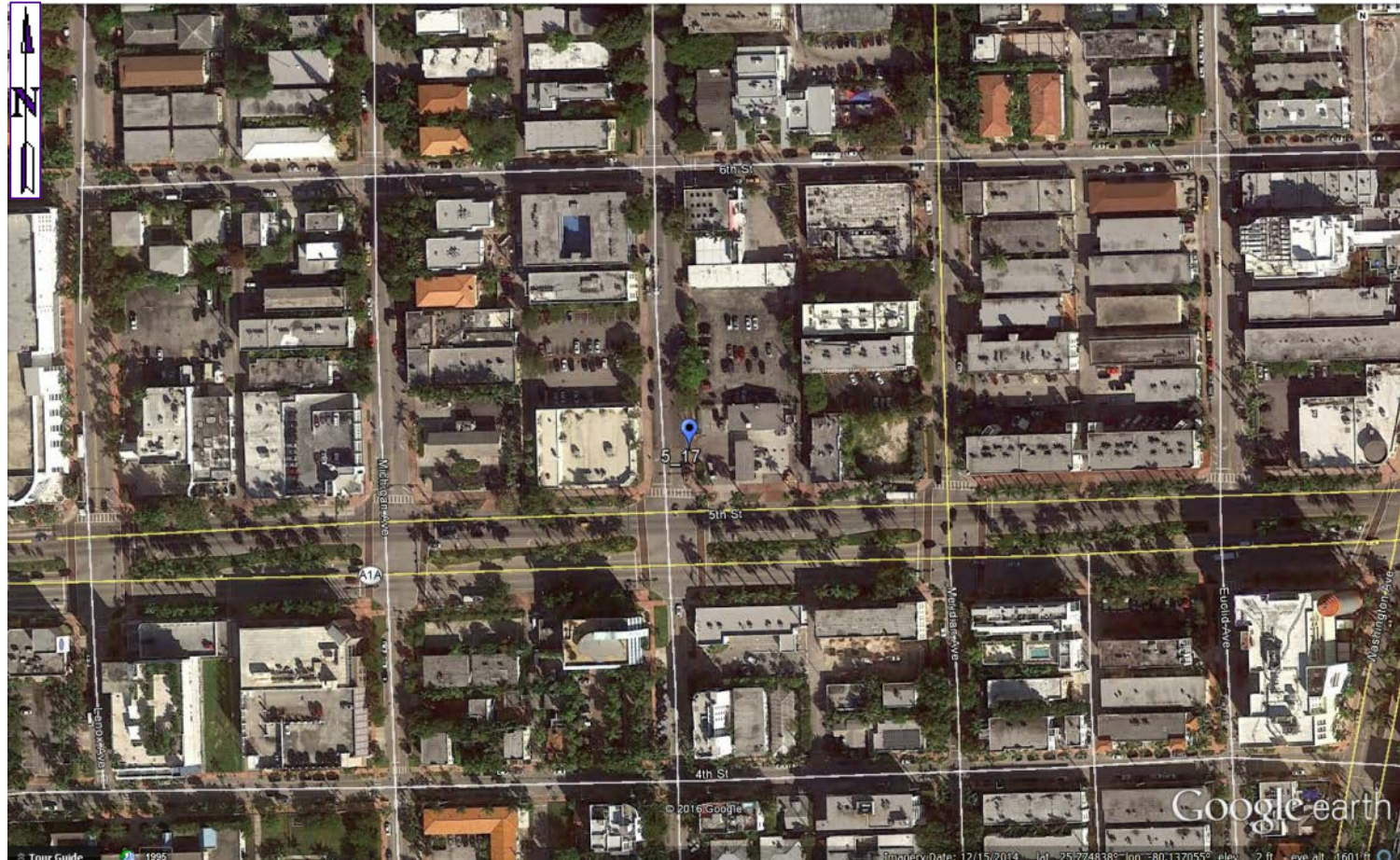

5_17

525 Jefferson Ave., Miami Beach, FL 33139

North



5_17

525 Jefferson Ave., Miami Beach, FL 33139

East



5_17

525 Jefferson Ave., Miami Beach, FL 33139

South



5_17

525 Jefferson Ave., Miami Beach, FL 33139

West

