

LOCATION SKETCH SCALE: NTS

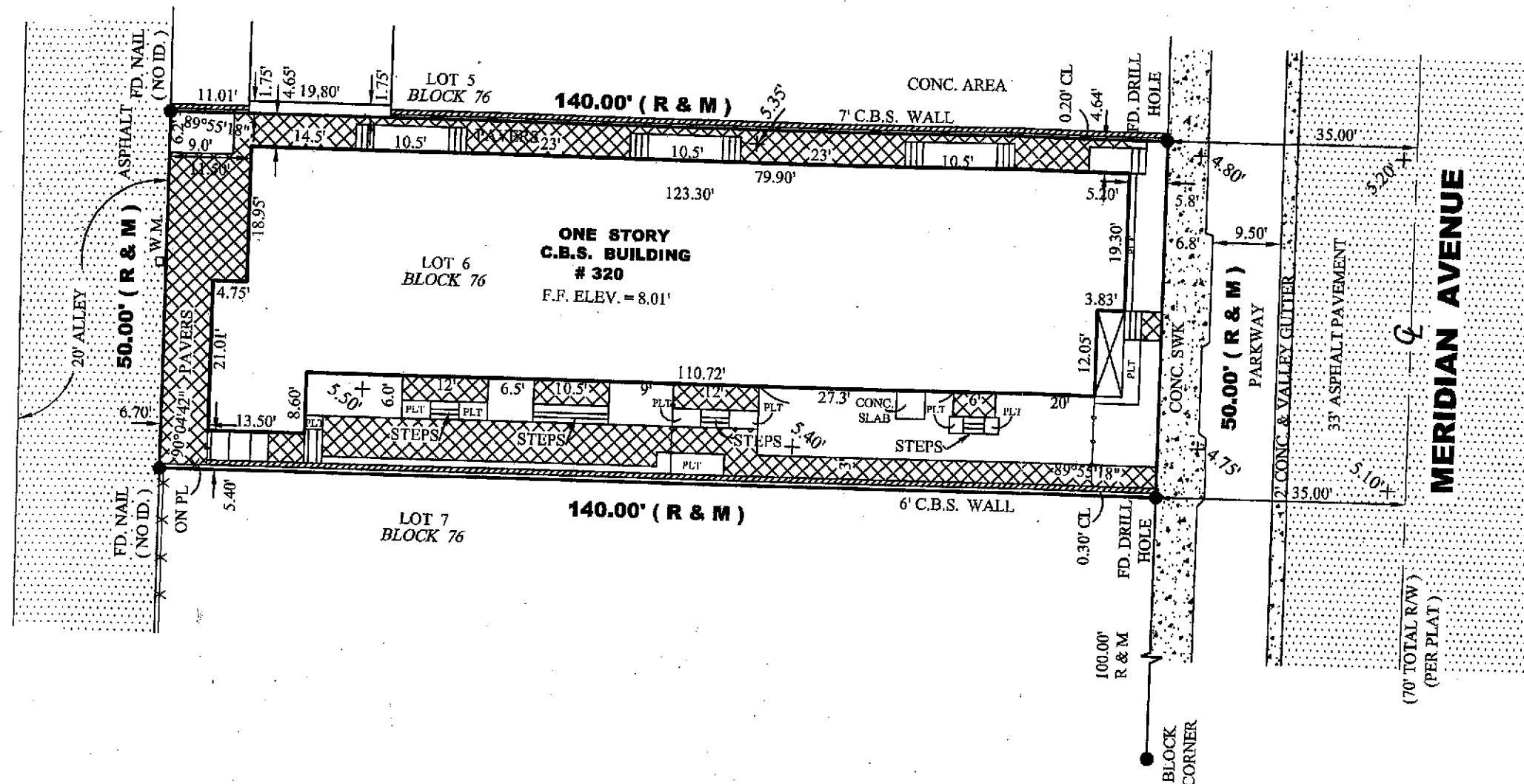

16	1
15	3
14	2
13	4
12	5
11	6
10	7
9	8

ABBREVIATIONS:

SWK=SIDEWALK, CBS=CONCRETE BLOCK STRUCTURE, CLF=CHAIN LINK FENCE, PL=PROPERTY LINE, DUE=DRAINAGE UTILITY EASEMENT, IP=IRON PIPE, F=FOUND, A/C=AIR CONDITIONER PAD, P/C=PROPERTY CORNER, D/H=DRILLED HOLE, WF=WOODEN FENCE, RES=RESIDENCE, CL=CLEAR, RB=REBAR, UE=UTILITY EASEMENT, CONC=CONCRETE SLAB, R/W=RIGHT OF WAY, DE=DRAINAGE EASEMENT, CL=CENTER LINE, O=DIAMETER, TYP=TYPICAL, M=MEASURED, R=RECORDED, ENCR=ENCROACHMENT, COMP=COMPUTER, ASH=ASPHALT, N/D=NAIL & DISC, S=SET, FEE=FINISH FLOOR ELEVATION, O/S=OFFSET, P/P=POWER POLE, OHP=OVERHEAD POWERLINE, VM=VALVE METER, WOOD FENCE=WOOD FENCE, MASONRY WALL=MASONRY WALL, CONCRETE=CONCRETE, MAINTENANCE & DRAINAGE EASEMENT=M & D.E.

ELEVATION BASED ON LOC. # 4203-W.

CBM# D-151 ELV. 3.72' TYPE OF SURVEY: BOUNDARY SURVEY

SURVEYOR'S NOTES: 1) OWNERSHIP SUBJECT TO OPINION OF TITLE. 2) NOT VALID WITHOUT THE SIGNATURE AND RAISED SEAL OF A FLORIDA LICENSED SURVEYOR AND MAPPER. 3) THE SURVEY DEPICTED HERE IS NOT COVERED BY PROFESSIONAL LIABILITY INSURANCE. 4) LEGAL DESCRIPTION PROVIDED BY CLIENT. 5) UNDERGROUND ENCROACHMENTS NOT LOCATED. 6) ELEVATIONS ARE BASED ON NATIONAL GEODETIC VERTICAL DATUM OF 1929. 7) OWNERSHIP OF FENCES ARE UNKNOWN. 8) THERE MAY BE ADDITIONAL RESTRICTIONS NOT SHOWN ON THIS SURVEY THAT MAY BE FOUND IN THE PUBLIC RECORDS OF THIS COUNTY. 9) CONTACT THE APPROPRIATE AUTHORITY PRIOR TO ANY DESIGN WORK FOR BUILDING AND ZONING INFORMATION. 10) EXAMINATION OF THE ABSTRACT OF TITLE WILL HAVE TO BE MADE TO DETERMINE RECORDED INSTRUMENTS, IF ANY, AFFECTING THIS PROPERTY.

Additions or deletions to survey maps or reports by other than the signing party or parties is prohibited without written consent of the signing party or parties.

BEARINGS WHEN SHOWN ARE REFERRED TO AN ASSUMED VALUE OF SAID PB. 2 PAGE 81

Property Address: 320 Meridian Ave, Miami Beach, FL 33139

Legal Description: Lot 6, Block 76, of OCEAN BEACH ADDITION NO. 3, according to the Plat thereof, as recorded in Plat Book 2, Page 81, of the Public Records of Miami-Dade County, Florida.

NOT VALID UNLESS EMBOSSED WITH
SURVEYOR'S SEAL

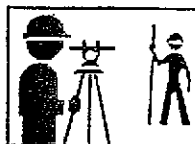

REVISED:

9/15/17

I HEREBY CERTIFY That the survey represented thereon meets the minimum technical requirements adopted by the STATE OF FLORIDA Board of Land Surveyors pursuant to Section 472.027 Florida Statutes.

There are no encroachments, overlaps, easements appearing on the plat or visible easements other than as shown hereon.

Adis N. Nunez
ADIS N. NUNEZ
REGISTERED LAND SURVEYOR
STATE OF FLORIDA #5924

SINCE 1987

BLANCO SURVEYORS INC.

Engineers • Land Surveyors • Planners • LB # 0007059

555 NORTH SHORE DRIVE

MIAMI BEACH, FL 33141

(305) 865-1200 Email: blancosurveyorsinc@yahoo.com Fax: (305) 865-7810

FLOOD ZONE: AE

SUFFIX: L

DATE: 9/11/09 BASE: 8'

PANEL: 0319

COMMUNITY # 120651

DATE: 3/11/16

SCALE: 1" = 20'

DWN. BY: F. Blanco

JOB No

16-245