



February 16, 2017

Ali Soltani Sobh, Ph.D.  
City of Miami Beach  
1700 Convention Center Drive  
Miami Beach, Florida 33139

**Re: 947 Lincoln Road Traffic Assessment  
Miami Beach, Florida**

Dear Mr. Sobh:

Kimley-Horn and Associates, Inc. has performed a traffic assessment for the proposed redevelopment located at 947 Lincoln Road in Miami Beach, Florida. The proposed redevelopment consists of 14,747 square feet of specialty retail space. Currently, the site consists of 7,476 square feet of specialty retail space and two (2) residential apartment units. A conceptual site plan and location map are provided in Attachment A. The traffic assessment's methodology is consistent with the requirements outlined by the City of Miami Beach. Methodology correspondence detailing the traffic assessment requirements are included in Appendix B. The following section summarizes the trip generation and pedestrian evaluation.

## **TRIP GENERATION**

Trip generation calculations for the existing development and proposed redevelopment were performed using the Institute of Transportation Engineers' (ITE's) *Trip Generation Manual*, 9<sup>th</sup> Edition. The trip generation for the existing development was determined using ITE Land Use Code (LUC) 826 (Specialty Retail Center) and LUC 220 (Apartment). The trip generation for the proposed redevelopment was determined using ITE LUC 826 (Specialty Retail Center). Please note that the existing and proposed specialty retail space is expected to be closed during the weekday A.M. peak hour. Therefore, only the existing apartments are expected to generate trips in the A.M. peak hour.

A multimodal (public transit, bicycle, and pedestrian) reduction of 10 percent (10%) was applied to the trip generation calculations to account for the urban environment in which the project site is located. It is expected that employees, nearby residents, and visitors will choose to walk, bike, or use public transit to the proposed redevelopment.

Miami-Dade Transit (MDT) provides several bus service routes in the vicinity of the site including:

- Route 103/C operates with 20-minute headways during the P.M. peak hour
- Route 115 operates with 45-minute headways during the P.M. peak hour
- Route 117 operates with 45-minute headways during the P.M. peak hour
- Route 119/S operates with 12-minute headways during the P.M. peak hour
- Route 120 operates with 12-minute headways during the P.M. peak hour
- Route 123/South Beach Local operates with 13-minute headways during the P.M. peak hour
- Route 150 operates with 20-minute headways during the P.M. peak hour

Detailed MDT route information is provided in Attachment C.

The project is expected to result in a net decrease of one (1) net new vehicle trip during the A.M. peak hour and an increase of 15 net new vehicle trips during the P.M. peak hour. Table 1 provides a summary of the trip generation for the proposed redevelopment. Detailed trip generation calculations and are included in Attachment C.

Table 1: Trip Generation Summary						
Development Plan	A.M. Peak Hour Trip Generation			P.M. Peak Hour Trip Generation		
	In	Out	Total	In	Out	Total
Existing Development	0	1	1	16	20	36
Proposed Redevelopment	0	0	0	22	29	51
<b>Net New Vehicle Trips</b>	<b>0</b>	<b>-1</b>	<b>-1</b>	<b>6</b>	<b>9</b>	<b>15</b>

## PEDESTRIAN EVALUATION

Pedestrian features including sidewalks, crosswalks, and pedestrian amenities were evaluated on Lenox Avenue between 17<sup>th</sup> Street and Lincoln Road, Michigan Avenue between 17<sup>th</sup> Street and Lincoln Road, and Jefferson Avenue between 17<sup>th</sup> Street and Lincoln Road. A detailed evaluation of pedestrian features is provided below:

### Lenox Avenue between 17<sup>th</sup> Street and Lincoln Road

Lenox Avenue between 17<sup>th</sup> Street and Lincoln Lane North operates as a two-lane, divided roadway with a two-way, left-turn lane (TWLTL) and a raised landscaped median at the northern limit. Sidewalk widths vary from 5 feet to 16 feet as on-street parking is provided along the east and west sides of the roadway. Crosswalks are provided at the north and south legs at the unsignalized intersection of Lenox Avenue and 17<sup>th</sup> Street.

Lenox Avenue between Lincoln Lane North and Lincoln Road operates as a two-lane, undivided roadway. Sidewalk widths vary from 14 feet to 16 feet along the east and west sides of the roadway. Crosswalks with countdown pedestrian signal heads are provided at the north and south legs at the signalized intersection of Lenox Avenue and Lincoln Road. Please note that the pedestrian phase is in recall mode at this intersection. Additionally, a Citibike station with 16 bicycle docks is located along the west side of Lenox Avenue just south of 17<sup>th</sup> Street.

### Michigan Avenue between 17<sup>th</sup> Street and Lincoln Road

Michigan Avenue between 17<sup>th</sup> Street and Lincoln Road operates as a two-lane, divided roadway with a TWLTL and a raised landscaped median at the southern limit. Sidewalk widths vary from 5 feet to 16 feet as on-street parking is provided along the east and west sides of the roadway. Crosswalks with pedestrian signal heads are provided at all the legs and push-buttons are provided at the east and west legs at the signalized intersection of Michigan Avenue and 17<sup>th</sup> Street. Additionally, crosswalks with pedestrian signal heads are provided at the north and south legs at the signalized intersection of Michigan Avenue and Lincoln Road. Please note that the pedestrian phase is in recall mode at this

intersection. Furthermore, a Citibike station with 16 bicycle docks is located along the west side of Michigan Avenue just north of Lincoln Road.

Jefferson Avenue between 17<sup>th</sup> Street and Lincoln Road

Jefferson Avenue between 17<sup>th</sup> Street and Lincoln Road operates as a two-lane, divided roadway with a TWLTL and a raised landscaped median at the northern limit. Sidewalk widths vary from 5 feet to 16 feet as on-street parking is provided along the east and west sides of the roadway. Crosswalks are provided at the north and south legs at the unsignalized intersection of Jefferson Avenue and 17<sup>th</sup> Street. Additionally, crosswalks with pedestrian signal heads are provided at the north and south legs at the signalized intersection of Jefferson Avenue and Lincoln Road. Please note that the pedestrian phase is in recall mode at this intersection. Furthermore, a Citibike station with 16 bicycle docks is located along the west side of Jefferson Avenue just north of Lincoln Road.

Pedestrian features and routes between the following parking areas and the proposed redevelopment were also evaluated:

P20: Lincoln Lane South and Jefferson Avenue – West Side

Sidewalks are provided along the west side of Jefferson Avenue, the east side of Michigan Avenue, the north side of Lincoln Road, and the south side of Lincoln Road.

P21: Lincoln Lane South and Michigan Avenue

Sidewalks are provided along the south side of Lincoln Lane South, the west side of Michigan Avenue, the north side of Lincoln Road, and the south side of Lincoln Road. Additionally, crosswalks with pedestrian signal heads are provided at the north and south legs at the signalized intersection of Michigan Avenue and Lincoln Road.

P25: Lincoln Lane North and Lenox Avenue – West Side

Sidewalks are provided along the west side of Lenox Avenue and the north side of Lincoln Road. Additionally, a crosswalk with countdown pedestrian signal heads is provided at the north leg at the signalized intersection of Lenox Avenue at Lincoln Road and a crosswalk with pedestrian signal heads is provided at the north leg at the signalized intersection of Michigan Avenue at Lincoln Road.

P26: Lincoln Lane North and Lenox Avenue – East Side

Sidewalks are provided along the east side of Lenox Avenue, the west side of Michigan Avenue, and the north side of Lincoln Road. Additionally, a crosswalk with pedestrian signal heads is provided at the north leg at the signalized intersection of Michigan Avenue and Lincoln Road.

P27: Lincoln Lane North and Meridian Avenue

Sidewalks are provided along the east side of Jefferson Avenue, the west side of Meridian Avenue, and the north side of Lincoln Road. Additionally, a crosswalk with pedestrian signal heads is provided at the north leg at the signalized intersection of Jefferson Avenue and Lincoln Road.

The Lincoln Garage

Sidewalks are provided along the east side of Michigan Avenue, the west side of Jefferson Avenue, and the north side of Lincoln Road.

Signalization Evaluation

The signalized intersections located along Lincoln Road at Lenox Avenue, Michigan Avenue, Jefferson Avenue, and Meridian Avenue are not expected to be impacted by the increased pedestrian activity associated with the proposed redevelopment as the intersections operate under actuated control for the north-south vehicular movements and recall mode for the east-west pedestrian movements. As a result, the pedestrian phase is illuminated (walk phase) unless a north-south vehicle arrives at the signal which will result in a call to the signal controller for the vehicular phase. Therefore, increased pedestrian activity is not expected to degrade intersection vehicular level of service. Signal timing data collected from Miami-Dade County Department of Transportation and Public Works – Signals and Signs Division is included in Attachment D.

A detailed illustration of pedestrian routes from each of the parking areas to the proposed redevelopment is presented in Attachment D.

**CONCLUSION**

Based on the trip generation analysis, the project is expected to result in a decrease of one (1) net new vehicle trip during the A.M. peak hour and an increase of 15 net new vehicle trips during the P.M. peak hour. The signalized intersections located along Lincoln Road at Lenox Avenue, Michigan Avenue, Jefferson Avenue, and Meridian Avenue are not expected to be impacted by the proposed redevelopment as the intersections operate under actuated control for the north-south vehicular movements and recall mode for the east-west pedestrian movements.

As a result of the pedestrian evaluation it was determined that pedestrian amenities such as sidewalks, crosswalks, and pedestrian signal heads are provided for increased pedestrian activity expected by the proposed redevelopment.

If you have any questions regarding this analysis, please feel free to contact me.

Sincerely,

KIMLEY-HORN AND ASSOCIATES, INC.



Adrian K. Dabkowski, P.E., PTOE  
Associate

Attachments

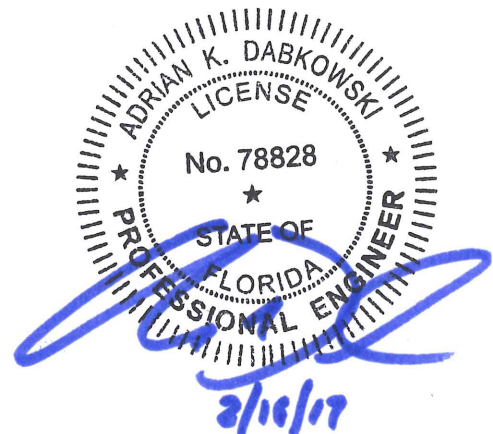

Adrian K. Dabkowski, P.E., PTOE  
Florida Registration Number 78828  
Kimley-Horn and Associates, Inc.  
600 North Pine Island Road, Suite 450  
Plantation, Florida 33324  
CA # 00000696

K:\FTL\_TPTO\043878000-947 Lincoln Road\Correspondence\ltr\947 Lincoln Road - Traffic Assessment Letter.docx



**Attachment A:**  
**Conceptual Site Plan and Location Map**



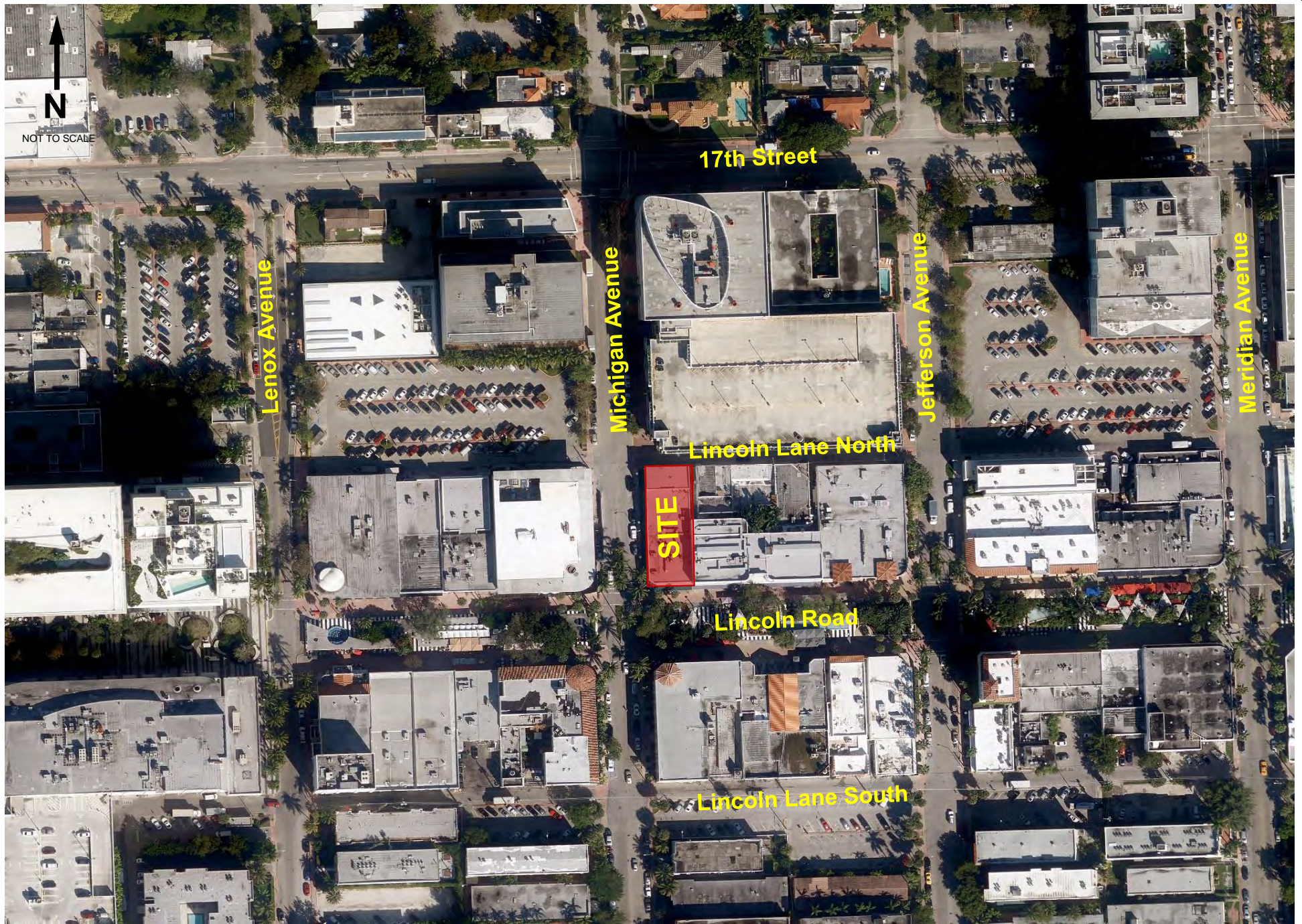







CITY OF MIAMI BEACH ZONING INFORMATION					
ITEM					
1	Address	947 Lincoln Rd, Miami Beach, Florida			
2	Board and File Numbers				
3	Folio Number(s)	02-3234-018-0010			
4	Year Constructed	1925			
5	Base Flood Elevation			Zoning District	CD-3
6	Adjusted Grade (Flood+Grade/2)			Lot Area	7,452
7	Lot Width	50'-0"		Lot Depth	150'-0"
8	Minimum Unit Size			Grade value in NGVD	8'-0"
9	Existing Use	MIXED USE		Proposed use:	RETAIL
		Maximum	Existing	Proposed	Deficiencies
10	Height	50'-0"	24'-4"	35'-0	
11	Number of Stories	5	2	2	
12	FAR	2.25	1.20	1.97	
13	Gross Square Footage	16,767	9,000	14,747 SF	
14	Square Footage by Use		7,476 RETAIL 1,524 RESIDIAL	14,747 (RETAIL)	
15	Number of Units Residential		4	0	
16	Number of units Hotel	N/A		N/A	
17	Number of Seats	N/A		N/A	
18	Occupancy load	N/A		N/A	
		Maximum	Existing	Proposed	Deficiencies
	Subterranean	N/A	N/A	N/A	N/A
19	Front Setback	N/A	N/A	N/A	
20	Side Setback	N/A	N/A	N/A	
21	Side Setback	N/A	N/A	N/A	
22	Side Setback Facing Street	N/A	N/A	N/A	
23	Rear Setback	N/A	N/A	N/A	
		Maximum	Existing	Proposed	Deficiencies
	At Grade Parking	N/A		N/A	
24	Front Setback	N/A	N/A	N/A	
25	Side Setback	N/A	N/A	N/A	
26	Side Setback	N/A	N/A	N/A	
27	Side Setback Facing Street	N/A	N/A	N/A	
28	Rear Setback	N/A	N/A	N/A	
		Maximum	Existing	Proposed	Deficiencies
	Pedestal				
29	Front Setback	0'-0"	0'-0"	0'-0"	
30	Side Setback	0'-0"	0'-0"	0'-0"	
31	Side Setback	0'-0"	0'-0"	0'-0"	
32	Side Setback Facing Street	0'-0"	0'-0"	0'-0"	
33	Rear Setback	0'-0"	0'-0"	0'-0"	
		Maximum	Existing	Proposed	Deficiencies
	Tower	N/A	N/A	N/A	
34	Front Setback	N/A	N/A	N/A	
35	Side Setback	N/A	N/A	N/A	
36	Side Setback	N/A	N/A	N/A	
37	Side Setback Facing Street	N/A	N/A	N/A	
38	Rear Setback	N/A	N/A	N/A	

		Maximum	Existing	Proposed	Deficiencies	
	Parking	Retail in Parking District 2: None		n/a		
39	Parking district	Parking District No. 2				
40	Total # of parking spaces					
	# of parking spaces per use (Provide a separate chart for a breakdown calculation)					
41						
	# of parking spaces per level (Provide a separate chart for a breakdown calculation)					
42						
	Parking Space Dimensions					
43						
	Parking Space configuration (45,60,90,Parallel)					
44						
45	ADA Spaces	0		0		
46	Tandem Spaces			0		
47	Drive aisle width					
48	Valet drop off and pick up	N/A		N/A		
49	Loading zones and Trash collection areas	Two Loading Spaces		Variance Requested		
50	Racks					
		Maximum	Existing	Proposed	Deficiencies	
51	Type of use		MIXED USE	RETAIL		
52	Total # of seats					
	Total # of seats per venue (Provide a separation chart for a breakdown calculation)					
53						
54	Total occupant content					
	Occupant content per venue (Provide a separate chart for a breakdown calculation)					
55						
56	Is this a contributing building?	Yes				
	Located within a Local Historic District?		HISTORIC DISTRICT Flamingo Park Historic District			
57						
		Maximum	Required	Proposed	Deficiencies	
	Parking and Loading space requirement					
58	Handicap					
59	8'-6" x 18'-0" Standard Parking					
60	TOTAL PARKING					
61	Loading					

EXISTING FAR

Lot Size	7,452 SF
Levels	Area
Level 1	7,476 SF
Level 2	1,524 SF
9,000 SF FAR 1.2	

LOT COVERAGE

LOT SIZE	7,452 SF
BLDG	7,452 SF (100.0%)

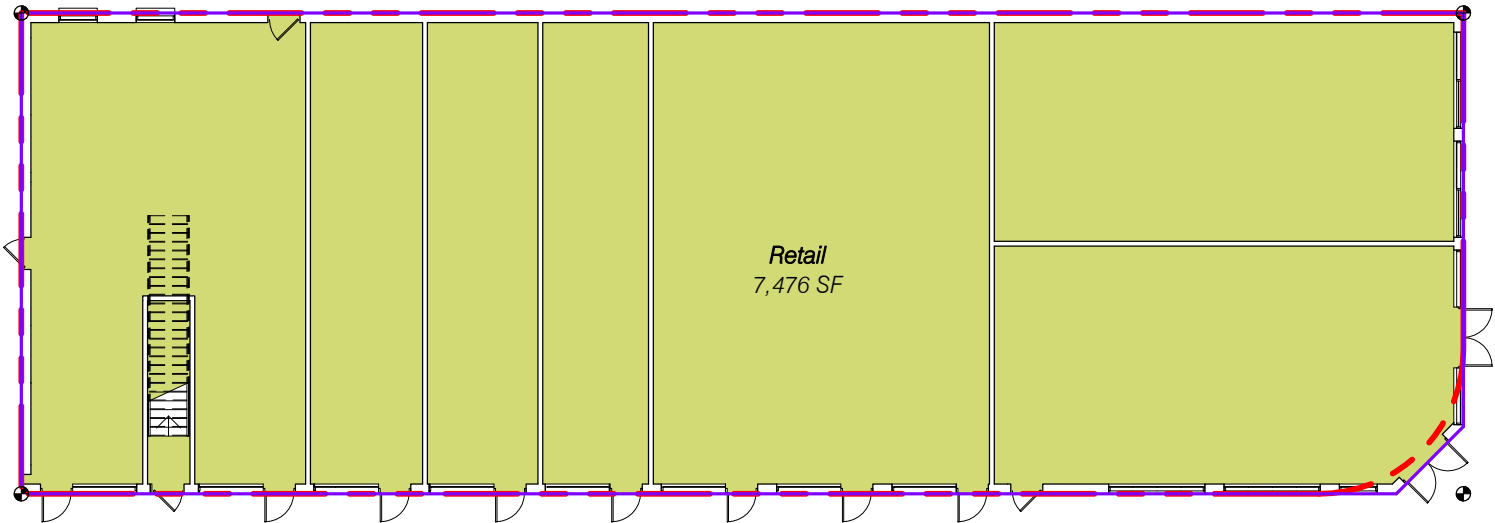

LEVEL 1

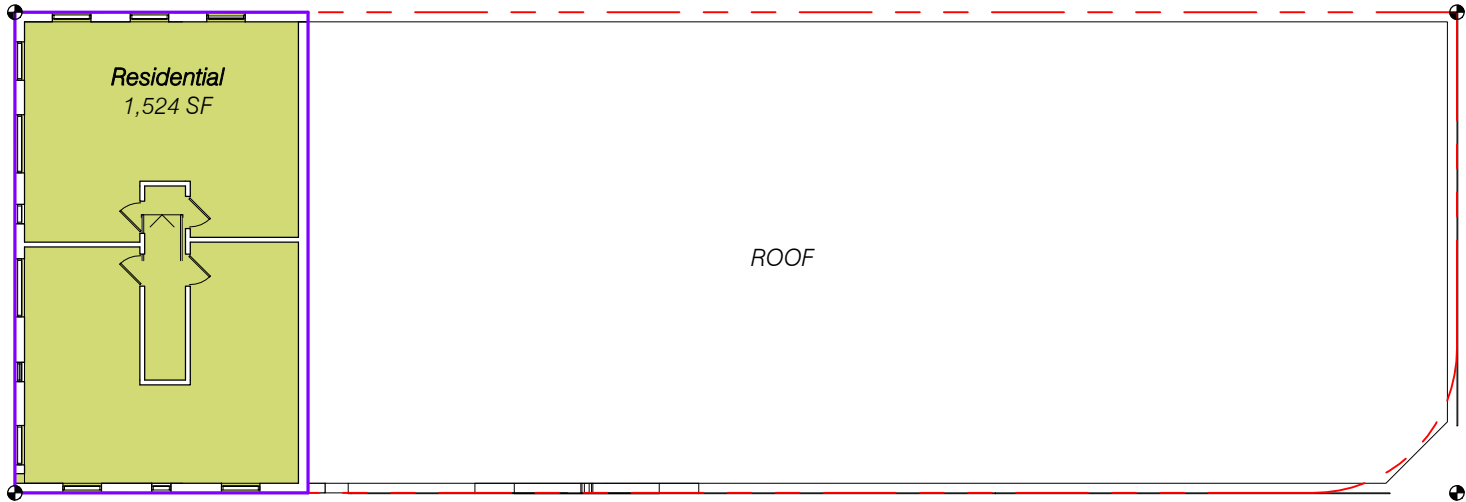

LEVEL 2

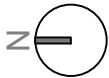



EXISTING FAR

Levels	Area
Level 1	7,393 SF
Level 2	7,355 SF
2	14,747 SF

LOT COVERAGE

LOT SIZE	7,452 SF
BLDG	7,393 SF (99%)

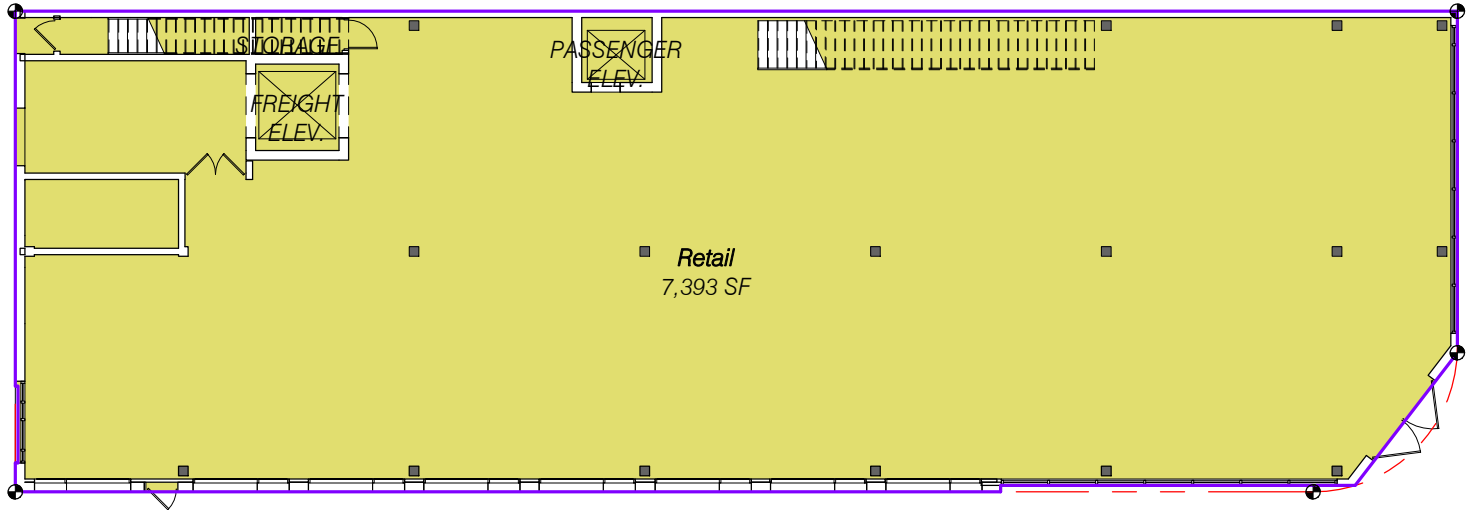

LEVEL 1

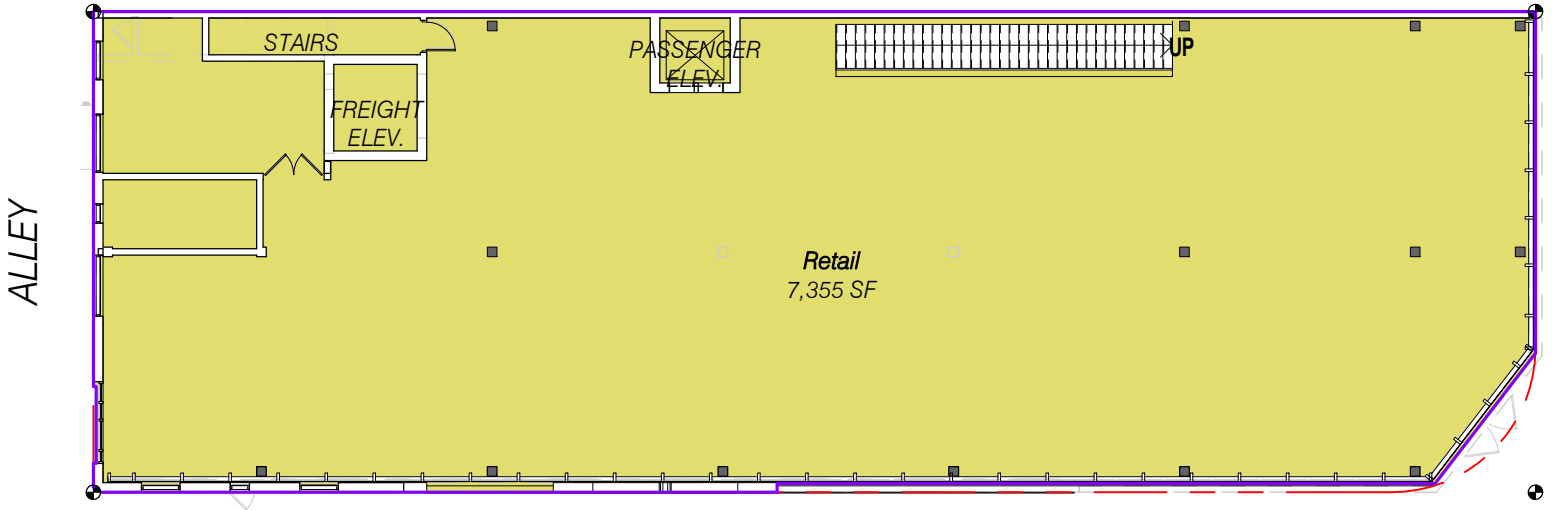

LEVEL 2

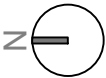



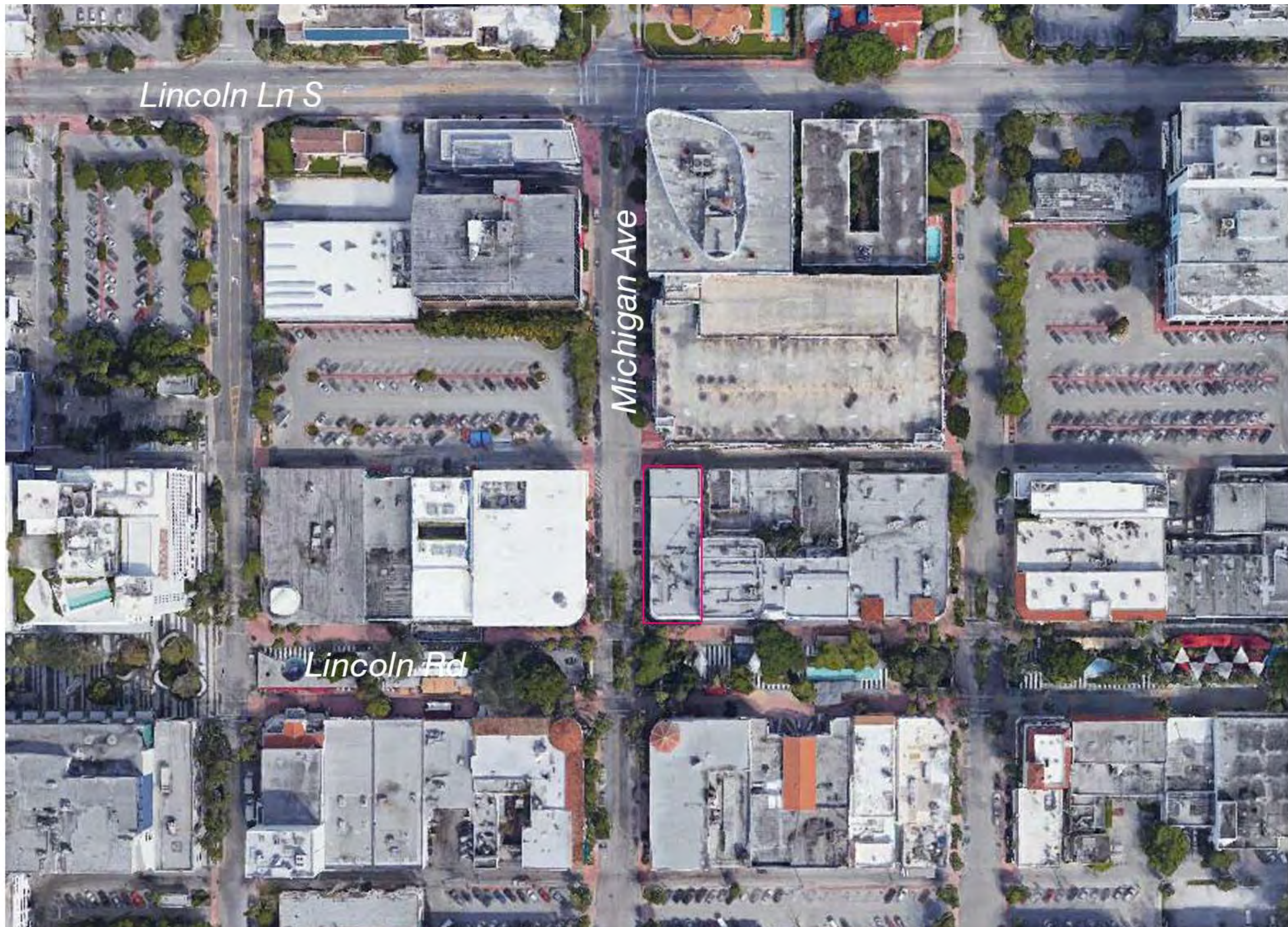

**947 LINCOLN**

**Miami Beach, Florida**

*Context Aerial*

*02-15-2017*

No copies, transmissions, reproductions, or electronic revisions of any portions of these drawings in whole or in part be made without the express written permission of Zyscovich Architects. All designs indicated in these drawings are property of Zyscovich Architects. All copyrights reserved © 2016.

**ZYSCOVICH**  
ARCHITECTS

100 N Biscayne Blvd., 27th Fl  
Miami, FL 33132-2304  
t 305.372.5222 f 305.577.4521

e info@zyscovich.com  
w www.zyscovich.com

**X-1**



**Attachment B:**  
**Methodology Correspondence**



## **Memorandum**

To: Ali Soltani Sobh, Ph.D.  
City of Miami Beach

From: Adrian K. Dabkowski, P.E., PTOE 

Cc: Carli Koshal, Esq., Bercow Radell Fernandez & Larkin

Date: February 3, 2017

**Subject: 947 Lincoln Road Redevelopment  
Traffic Assessment Methodology**

The purpose of this memorandum is to summarize the traffic assessment methodology discussed at our January 30, 2017 meeting. The proposed redevelopment is located on the northeast quadrant of Lincoln Road and Michigan Avenue in Miami Beach, Florida. The proposed redevelopment consists of 14,976 square feet of specialty retail space. Currently, the site is occupied by 8,625 square feet of specialty retail space. Detailed development program information and a conceptual site plan are provided in Attachment A. The following sections summarize the proposed methodology.

### **TRIP GENERATION**

A trip generation comparison analysis was conducted using the Institute of Transportation Engineers' (ITE) *Trip Generation Manual*, 9<sup>th</sup> Edition for the existing development and proposed redevelopment. The trip generation for the existing development and proposed redevelopment was determined using ITE Land Use Code (LUC) 826 (Specialty Shopping Center). Please note that the existing development and proposed redevelopment are expected to be closed during the weekday A.M. peak hour. Therefore, project trips were estimated for the weekday P.M. peak hour only.

A multimodal (public transit, bicycle, and pedestrian) reduction of 10 percent (10%) was applied to the trip generation calculations to account for the urban environment in which the project site is located. It is expected that employees, nearby residents, and visitors will choose to walk to the proposed redevelopment.

The project is expected to result in a net increase of 13 net new vehicle trips during the P.M. peak hour. The site will not provide on-site parking nor valet service. Therefore, all patrons will arrive as pedestrians to the site. Further note that Lincoln Road is the destination as patrons and visitors tend to visit multiple venues along Lincoln Road and not individual retail facilities. Detailed trip generation calculations are included in Attachment B.

The proposed redevelopment does not represent a significant increase in trip generation and is expected to have minimal impacts to the roadway network.

### **PEDESTRIAN EVALUATION**

Pedestrian features near the site will be documented. Sidewalks, crosswalks, and pedestrian amenities will be documented on Lenox Avenue between 17<sup>th</sup> Street and Lincoln Road, Michigan Avenue between

17<sup>th</sup> Street and Lincoln Road, and Jefferson Avenue between 17<sup>th</sup> Street and Lincoln Road. Specifically, pedestrian features and routes between the following parking areas and the site will be documented:

- P20: Lincoln Lane South and Jefferson Avenue – West Side
- P21: Lincoln Lane South and Michigan Avenue
- P25: Lincoln Lane North & Lenox Avenue – West Side
- P26: Lincoln Lane North & Lenox Avenue – East Side
- P27: Lincoln Lane North & Meridian Avenue
- The Lincoln Garage

The impact of additional pedestrians generated by the proposed redevelopment will be evaluated at the intersections of Lincoln Road at Lenox Avenue and Lincoln Road at Michigan Avenue.

## DOCUMENTATION

The results of the trip generation analysis and pedestrian evaluation will be summarized in a technical letter. The letter will summarize the analysis assumptions, results, and will include supporting documents.

O:\adabkowski\947 Lincoln Road\02 03 17 947 Lincoln Road Meth.docx



## **Attachment A**





**All measurements are subject to change. Not for construction.**

947 LINCOLN	Miami Beach, Florida	Opt 1 Renderings	01-24-2017
-------------	----------------------	------------------	------------

No copies, transmissions, reproductions, or electronic revisions of any portions of these drawings in whole or in part be made without the express written permission of Zyscovich Architects. All designs indicated in these drawings are property of Zyscovich Architects. All copyrights reserved © 2016.



CITY OF MIAMI BEACH ZONING INFORMATION					
ITEM					
1	Address	947 Lincoln Rd, Miami Beach, Florida			
2	Board and File Numbers				
3	Folio Number(s)	02-3234-018-0010			
4	Year Constructed	1925			
5	Base Flood Elevation			Zoning District	CD-3
6	Adjusted Grade (Flood+Grade/2)			Lot Area	7,500 SF
7	Lot Width	50'-0"		Lot Depth	150'-0"
8	Minimum Unit Size			Grade value in NGVD	XXX' NGVD
9	Existing Use	MIXED USE		Proposed use:	RETAIL
		Maximum	Existing	Proposed	Deficiencies
10	Height	50'-0"		35'-0	
11	Number of Stories	5		2	
12	FAR	2.25 * 7,500 SF= 16,875 SF	8,625 SF	14,807 SF	
13	Gross Square Footage		8,625 SF	14976 SF	
14	Square Footage by Use			14,976 (RETAIL)	
15	Number of Units Residential	N/A		N/A	
16	Number of units Hotel	N/A		N/A	
17	Number of Seats	N/A		N/A	
18	Occupancy load	N/A		N/A	
		Maximum	Existing	Proposed	Deficiencies
	Subterranean	N/A	N/A	N/A	N/A
19	Front Setback	N/A	N/A	N/A	
20	Side Setback	N/A	N/A	N/A	
21	Side Setback	N/A	N/A	N/A	
22	Side Setback Facing Street	N/A	N/A	N/A	
23	Rear Setback	N/A	N/A	N/A	
		Maximum	Existing	Proposed	Deficiencies
	At Grade Parking	N/A		N/A	
24	Front Setback	N/A	N/A	N/A	
25	Side Setback	N/A	N/A	N/A	
26	Side Setback	N/A	N/A	N/A	
27	Side Setback Facing Street	N/A	N/A	N/A	
28	Rear Setback	N/A	N/A	N/A	
	Pedestal				
29	Front Setback	0'-0"	0'-0"	0'-0"	
30	Side Setback	0'-0"	0'-0"	0'-0"	
31	Side Setback	0'-0"	0'-0"	0'-0"	
32	Side Setback Facing Street	0'-0"	0'-0"	0'-0"	
33	Rear Setback	0'-0"	0'-0"	0'-0"	
	Tower	N/A	N/A	N/A	
34	Front Setback	N/A	N/A	N/A	
35	Side Setback	N/A	N/A	N/A	
36	Side Setback	N/A	N/A	N/A	
37	Side Setback Facing Street	N/A	N/A	N/A	
38	Rear Setback	N/A	N/A	N/A	

		Maximum	Existing	Proposed	Deficiencies
	Parking				
39	Parking district				
40	Total # of parking spaces				
	# of parking spaces per use (Provide a separate chart for a breakdown calculation)				
41					
	# of parking spaces per level (Provide a separate chart for a breakdown calculation)				
42					
	Parking Space Dimensions			8'-6" X 18'-0"	
43					
	Parking Space configuration (45,60,90, Parallel)			90 DEGREES	
44					
45	ADA Spaces	0		0	
46	Tandem Spaces			0	
47	Drive aisle width				
48	Valet drop off and pick up	N/A		N/A	
	Loading zones and Trash collection areas				
49					
50	Racks				
		Maximum	Existing	Proposed	Deficiencies
51	Type of use		MIXED USE	RETAIL	
52	Total # of seats				
	Total # of seats per venue (Provide a separation chart for a breakdown calculation)				
53					
54	Total occupant content				
	Occupant content per venue (Provide a separate chart for a breakdown calculation)				
55					
56	Is this a contributing building?		YES	YES	
	Located within a Local Historic District?		HISTORIC DISTRICT Flamingo Park Historic District		
57					

		Maximum	Required	Proposed	Deficiencies
	Parking and Loading space requirement				
58	Handicap				
59	8'-6" x 18'-0" Standard Parking				
60	TOTAL PARKING				
61	Loading				

All measurements are subject to change. Not for construction.



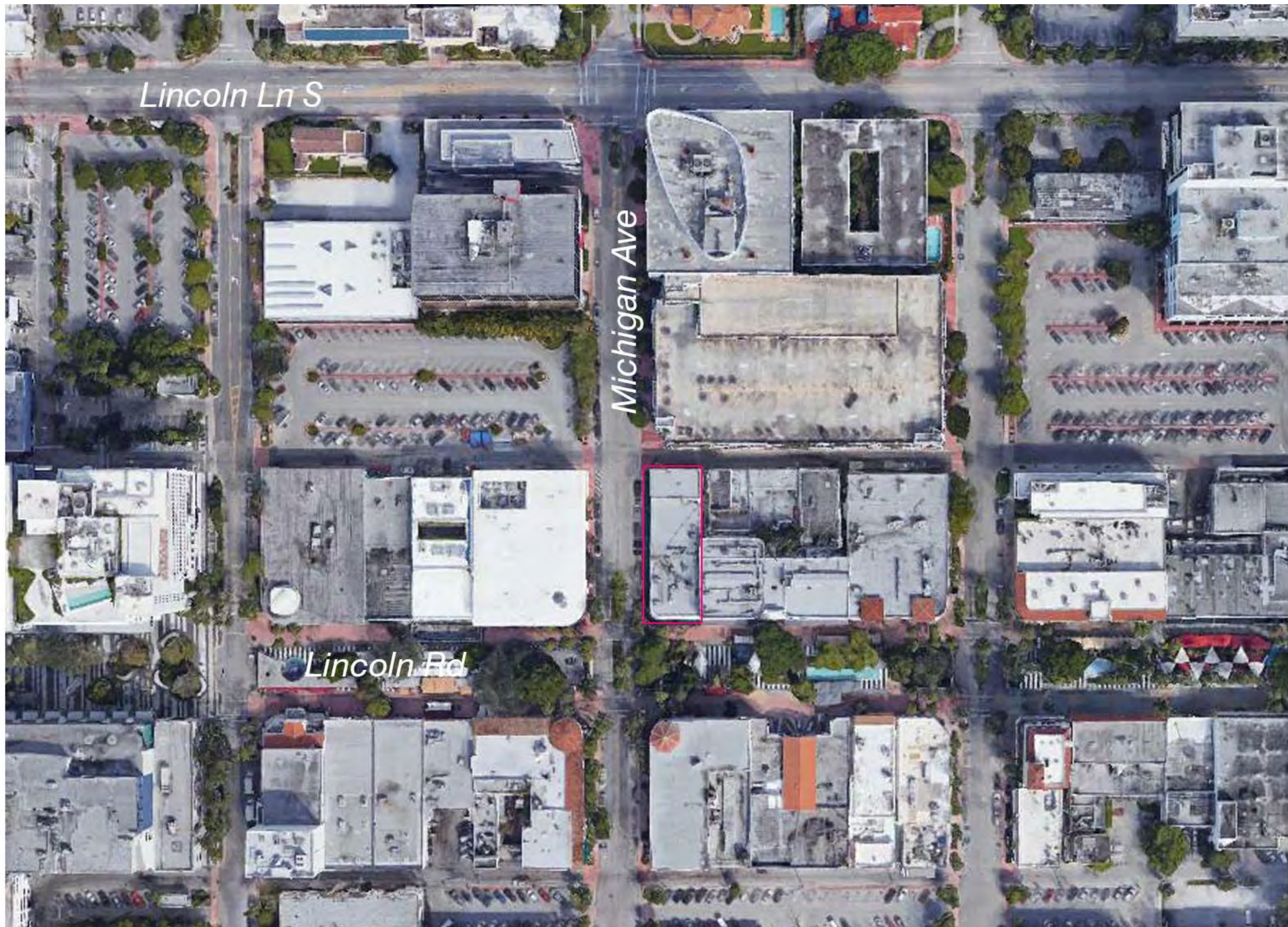

**All measurements are subject to change. Not for construction.**



Area FAR (Proposed)	
Level	Area
Level 1	7,382 SF
Exist. Low Roof	7,425 SF
2	

FAR 2.0

MAX FAR 2.25

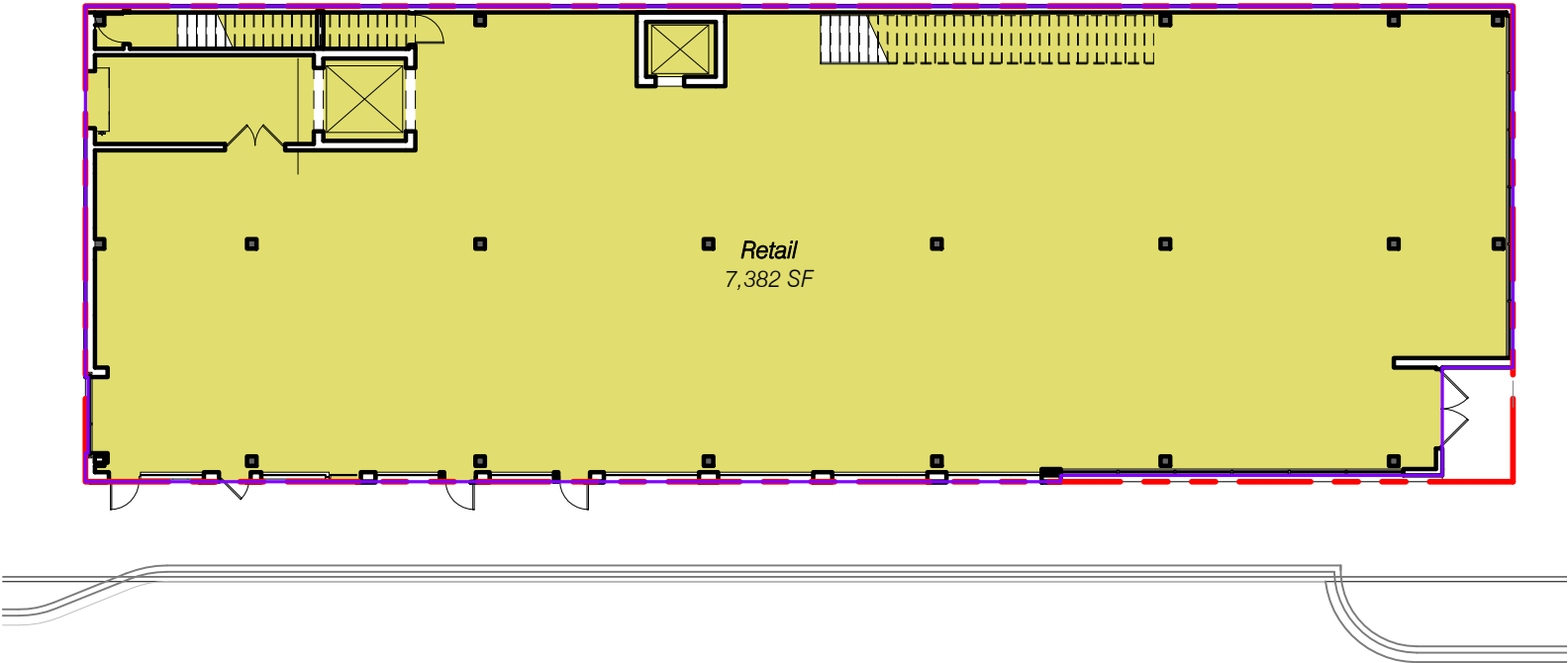

LEVEL 1

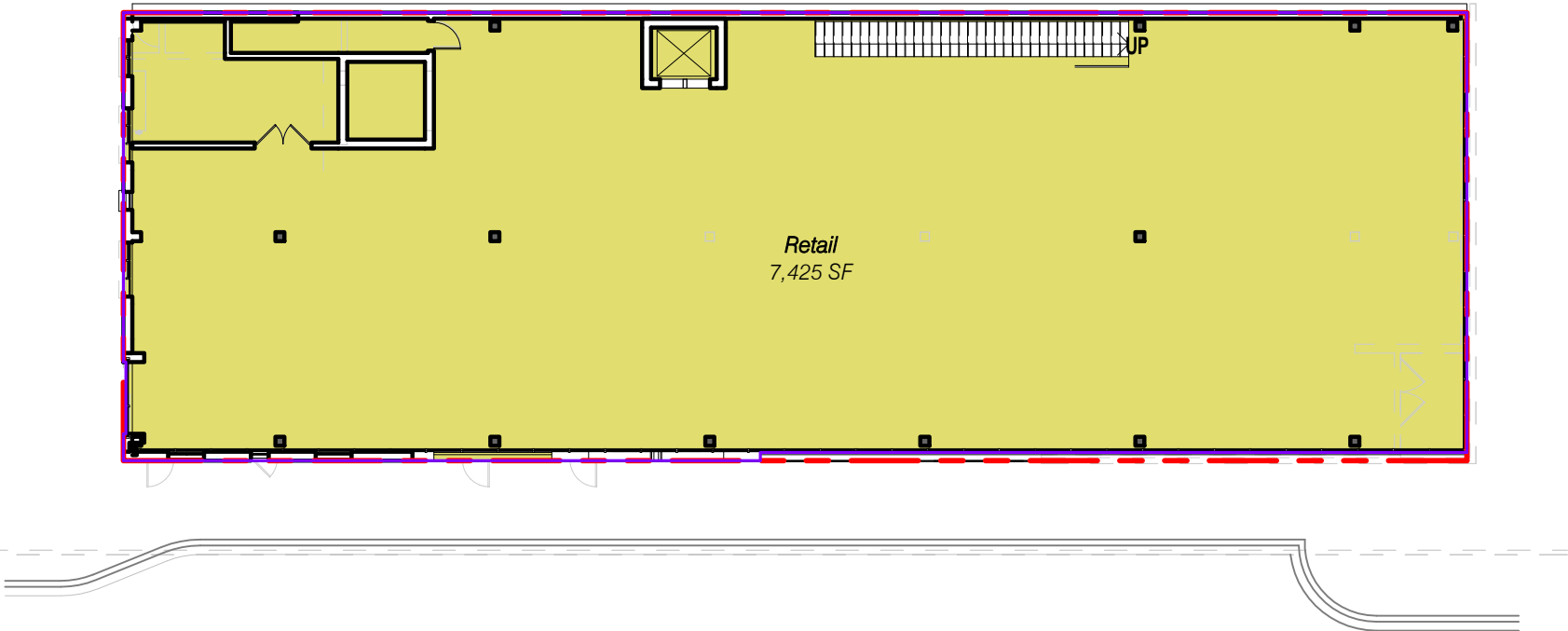

LEVEL 2

All measurements are subject to change. Not for construction.

947 LINCOLN

Miami Beach, Florida

Proposed FAR

1" = 20'-0"

01-24-2017

No copies, transmissions, reproductions, or electronic revisions of any portions of these drawings in whole or in part be made without the express written permission of Zyscovich Architects. All designs indicated in these drawings are property of Zyscovich Architects. All copyrights reserved © 2016.

ZYSCOVICH  
ARCHITECTS

100 N Biscayne Blvd . 27th Fl  
Miami . FL 33132.2304  
t 305.372.5222 f 305.577.4521

e info@zyscovich.com  
w www.zyscovich.com



Area Schedule (Existing FAR)	
Level	Area
Level 1	7,476 SF
Exist. Low Roof	1,524 SF

FAR 1.15

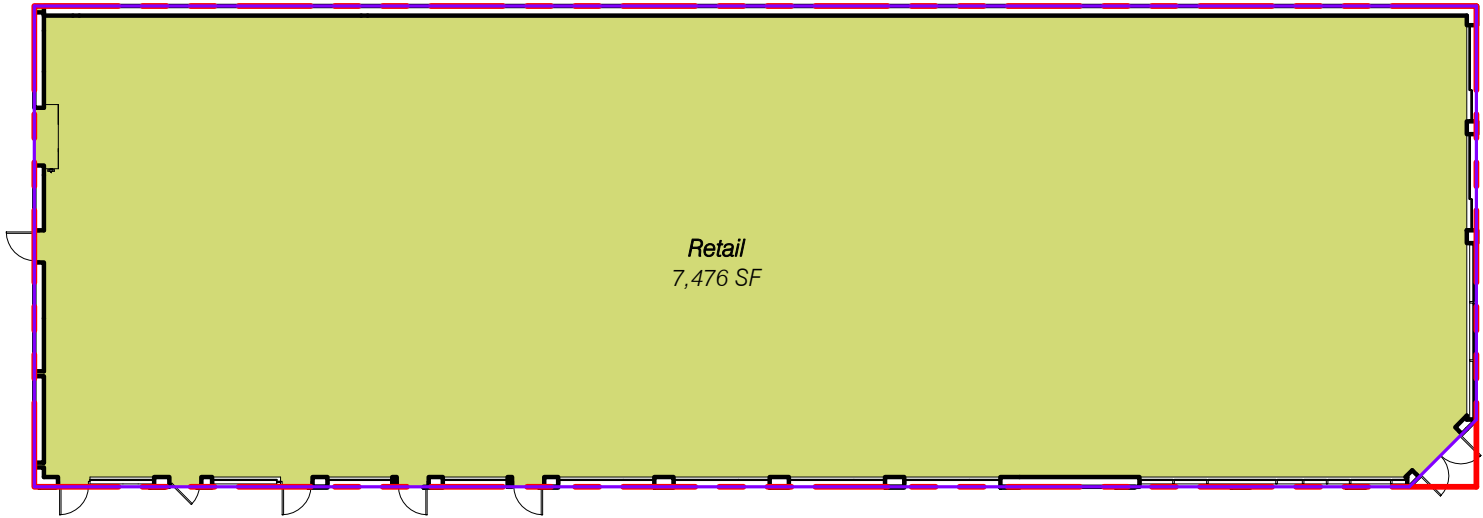

LEVEL 1

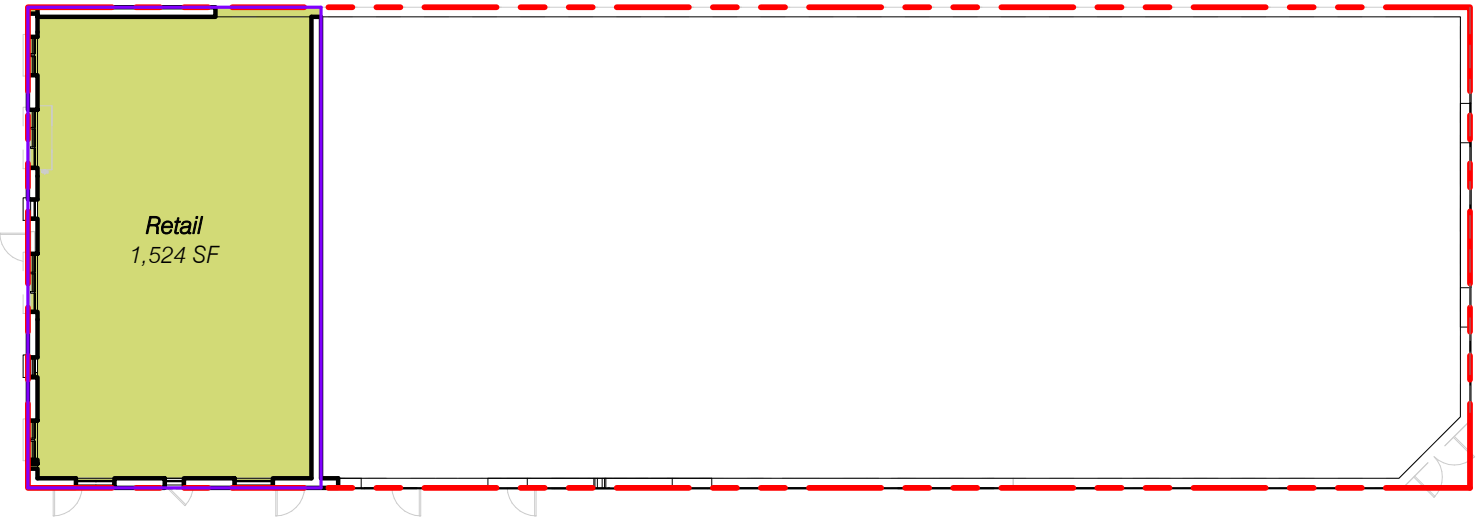

LEVEL 2

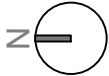

All measurements are subject to change. Not for construction.

## **Attachment B**

# PM PEAK HOUR TRIP GENERATION COMPARISON

## EXISTING WEEKDAY PM PEAK HOUR TRIP GENERATION

ITE TRIP GENERATION CHARACTERISTICS					DIRECTIONAL DISTRIBUTION		GROSS VOLUMES			INTERNAL CAPTURE		EXTERNAL TRIPS			MULTIMODAL REDUCTION		NET NEW EXTERNAL TRIPS		
Land Use	ITE Edition	ITE Code	Scale	ITE Units	Percent		In	Out	Total	Percent	IC Trips	In	Out	Total	Percent	PB Trips	In	Out	Total
					In	Out													
1 Specialty Retail Center	9	826	8.625	ksf	44%	56%	18	24	42	0.0%	0	18	24	42	10.0%	4	16	22	38
2																			
3																			
4																			
5																			
6																			
7																			
8																			
9																			
10																			
11																			
12																			
13																			
14																			
15																			
ITE Land Use Code					Rate or Equation		Total:												
826					Y=2.4*(X)+21.48														

## PROPOSED WEEKDAY PM PEAK HOUR TRIP GENERATION

ITE TRIP GENERATION CHARACTERISTICS					DIRECTIONAL DISTRIBUTION		GROSS VOLUMES			INTERNAL CAPTURE		EXTERNAL TRIPS			MULTIMODAL REDUCTION		NET NEW EXTERNAL TRIPS		
Land Use	ITE Edition	ITE Code	Scale	ITE Units	Percent		In	Out	Total	Percent	IC Trips	In	Out	Total	Percent	PB Trips	In	Out	Total
					In	Out													
1 Specialty Retail Center	9	826	14.976	ksf	44%	56%	25	32	57	0.0%	0	25	32	57	10.0%	6	22	29	51
2																			
3																			
4																			
5																			
6																			
7																			
8																			
9																			
10																			
11																			
12																			
13																			
14																			
15																			
ITE Land Use Code					Rate or Equation		Total:												
826					Y=2.4*(X)+21.48														

	IN	OUT	TOTAL
NET DIFFERENCE	6	7	13

# **Attachment C: Trip Generation**

## **Miami-Dade Transit Data**





C

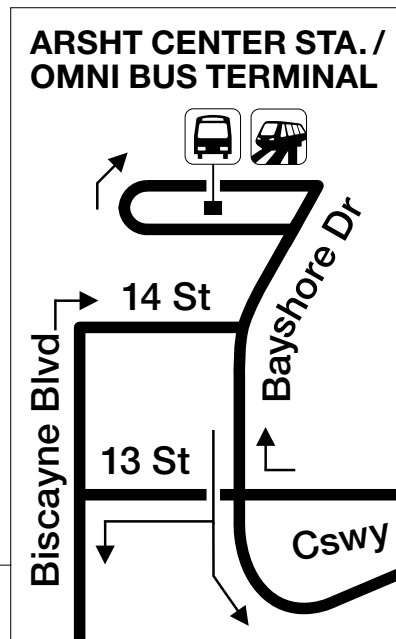

(see detail lower right)

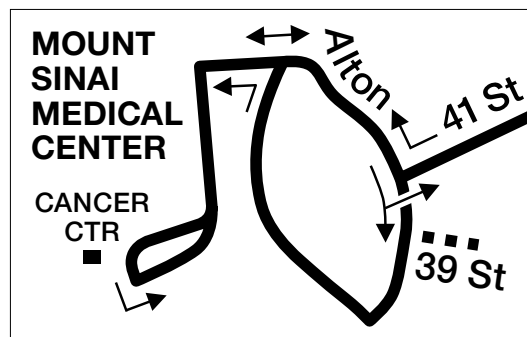
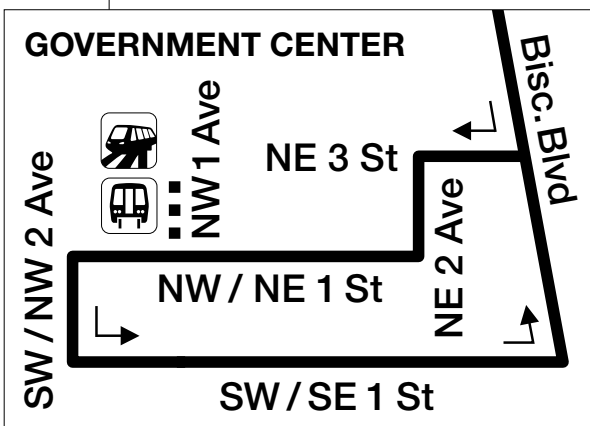
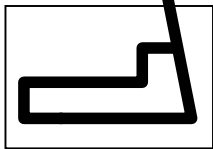
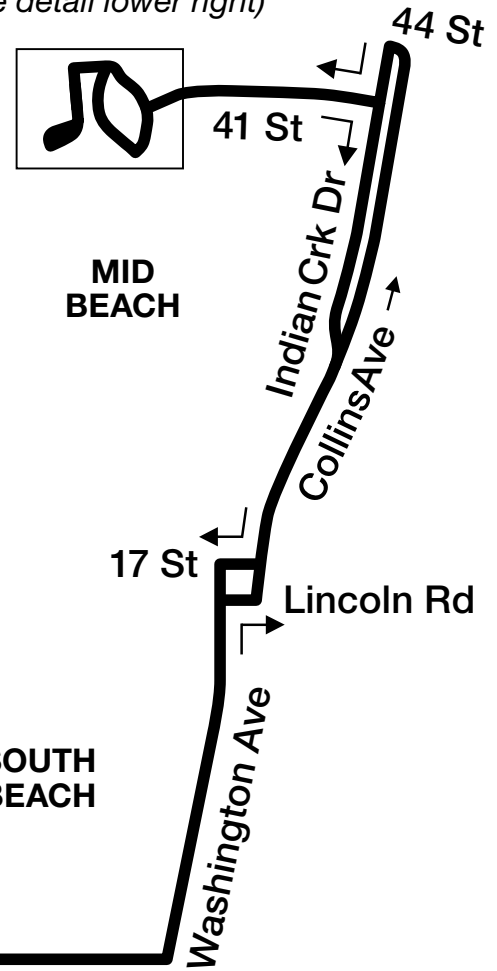

**NORTH**  
11/2016

# Routes Schedule



[\(https://facebook.com/GoMiamiDade/](https://facebook.com/GoMiamiDade/)



[\) \(https://twitter.com/gomiamidade \)](https://twitter.com/gomiamidade)



[\(https://www.instagram.com/gomiamidade/](https://www.instagram.com/gomiamidade/)

)



## 103 (Northbound) WEEKDAY

NW 1 St & 2 Ave	Omni Terminal / Arsht Metromover	5 St & Lenox Ave	Lincoln Rd & James Ave	INDIAN CREEK DR & 43 ST	MT SINAI HOSPITAL	ALTON RD & 39 ST MIAMI BEACH
04:59AM	05:09AM	05:16AM	05:26AM	05:35AM	05:43AM	05:46AM
05:19AM	05:29AM	05:36AM	05:46AM	05:55AM	06:05AM	06:08AM
05:40AM	05:50AM	05:57AM	06:09AM	06:19AM	06:29AM	06:32AM
06:00AM	06:12AM	06:20AM	06:32AM	06:42AM	06:52AM	06:55AM
06:20AM	06:32AM	06:40AM	06:52AM	07:03AM	07:14AM	07:17AM
06:40AM	06:52AM	07:02AM	07:15AM	07:26AM	07:37AM	07:40AM
07:00AM	07:14AM	07:24AM	07:37AM	07:48AM	07:59AM	08:02AM
07:20AM	07:34AM	07:44AM	07:57AM	08:09AM	08:20AM	08:23AM
07:40AM	07:54AM	08:05AM	08:18AM	08:30AM	08:41AM	08:44AM
08:00AM	08:14AM	08:25AM	08:38AM	08:50AM	09:02AM	09:05AM
08:20AM	08:34AM	08:45AM	08:58AM	09:12AM	09:24AM	09:27AM
08:40AM	08:54AM	09:06AM	09:21AM	09:35AM	09:47AM	09:50AM
09:00AM	09:16AM	09:28AM	09:43AM	09:57AM	10:09AM	10:12AM
09:20AM	09:36AM	09:48AM	10:03AM	10:17AM	10:29AM	10:32AM
09:40AM	09:56AM	10:08AM	10:23AM	10:37AM	10:49AM	10:52AM
10:00AM	10:16AM	10:28AM	10:43AM	10:57AM	11:09AM	11:12AM
10:20AM	10:36AM	10:48AM	11:03AM	11:17AM	11:29AM	11:32AM
10:40AM	10:56AM	11:08AM	11:23AM	11:37AM	11:49AM	11:52AM
11:00AM	11:16AM	11:28AM	11:43AM	11:57AM	12:09PM	12:12PM
11:25AM	11:41AM	11:53AM	12:08PM	12:22PM	12:34PM	12:37PM

11:45AM	12:01PM	12:13PM	12:28PM	12:42PM	12:54PM	12:57PM
12:05PM	12:21PM	12:33PM	12:48PM	01:02PM	01:14PM	01:17PM
12:25PM	12:41PM	12:53PM	01:08PM	01:22PM	01:34PM	01:37PM
12:45PM	01:01PM	01:13PM	01:28PM	01:42PM	01:54PM	01:57PM
01:05PM	01:21PM	01:33PM	01:48PM	02:02PM	02:14PM	02:17PM
01:25PM	01:41PM	01:53PM	02:08PM	02:22PM	02:34PM	02:37PM
01:40PM	01:56PM	02:08PM	02:23PM	02:37PM	02:49PM	02:52PM
02:00PM	02:16PM	02:28PM	02:43PM	02:57PM	03:09PM	03:12PM
02:20PM	02:36PM	02:48PM	03:03PM	03:17PM	03:29PM	03:32PM
02:40PM	02:56PM	03:08PM	03:23PM	03:37PM	03:49PM	03:52PM
03:00PM	03:16PM	03:28PM	03:43PM	03:57PM	04:10PM	04:13PM
03:20PM	03:36PM	03:48PM	04:03PM	04:17PM	04:30PM	04:33PM
03:40PM	03:56PM	04:08PM	04:23PM	04:37PM	04:50PM	04:53PM
04:00PM	04:17PM	04:29PM	04:44PM	04:58PM	05:11PM	05:14PM
04:20PM	04:37PM	04:49PM	05:04PM	05:18PM	05:31PM	05:34PM
04:40PM	04:57PM	05:09PM	05:24PM	05:38PM	05:51PM	05:54PM
05:00PM	05:17PM	05:29PM	05:44PM	05:58PM	06:11PM	06:14PM
05:20PM	05:37PM	05:49PM	06:04PM	06:18PM	06:31PM	-
05:40PM	05:57PM	06:09PM	06:24PM	06:38PM	06:51PM	06:54PM
06:00PM	06:17PM	06:29PM	06:44PM	06:58PM	07:11PM	07:14PM
06:20PM	06:37PM	06:49PM	07:04PM	07:14PM	07:25PM	-
06:40PM	06:57PM	07:09PM	07:22PM	07:32PM	07:43PM	07:46PM
07:00PM	07:14PM	07:23PM	07:36PM	07:46PM	07:57PM	-
07:32PM	07:46PM	07:55PM	08:08PM	08:18PM	08:29PM	08:32PM
08:02PM	08:16PM	08:25PM	08:38PM	08:48PM	08:59PM	09:02PM
08:32PM	08:46PM	08:55PM	09:08PM	09:18PM	09:29PM	-
09:04PM	09:18PM	09:27PM	09:40PM	09:50PM	10:01PM	10:04PM
09:39PM	09:53PM	10:02PM	10:14PM	10:25PM	10:34PM	10:37PM
10:15PM	10:28PM	10:36PM	10:48PM	10:59PM	11:08PM	-
11:10PM	11:23PM	11:31PM	11:43PM	11:54PM	12:03AM	-
12:12AM	12:23AM	12:31AM	12:41AM	12:50AM	12:58AM	-

[Back to previous page \(javascript: history.go\(-1\) \)](#)

# Routes Schedule



[\(https://facebook.com/GoMiamiDade/](https://facebook.com/GoMiamiDade/)



[\)](https://twitter.com/gomiamidade)



[\(https://www.instagram.com/gomiamidade/](https://www.instagram.com/gomiamidade/)

[\)](https://www.instagram.com/gomiamidade/)



## 103 (Southbound) WEEKDAY

ALTON RD & 39 ST MIAMI BEACH	MT SINAI HOSPITAL	INDIAN CREEK DR & 40 ST	Washington Ave & Lincoln Rd	5 St & Lenox Ave	Omni Terminal / Arsht Metromover	NW 1 St & 2 Ave
-	-	-	04:50AM	05:00AM	05:07AM	05:17AM
-	-	-	05:11AM	05:21AM	05:28AM	05:38AM
-	05:16AM	05:24AM	05:31AM	05:41AM	05:48AM	05:58AM
-	05:31AM	05:39AM	05:46AM	05:56AM	06:04AM	06:18AM
-	05:50AM	05:58AM	06:06AM	06:16AM	06:24AM	06:38AM
06:07AM	06:10AM	06:18AM	06:26AM	06:36AM	06:44AM	06:58AM
06:26AM	06:29AM	06:37AM	06:45AM	06:55AM	07:03AM	07:18AM
06:44AM	06:47AM	06:55AM	07:04AM	07:15AM	07:23AM	07:38AM
-	07:05AM	07:15AM	07:24AM	07:35AM	07:43AM	07:58AM
07:20AM	07:23AM	07:33AM	07:42AM	07:53AM	08:03AM	08:18AM
07:38AM	07:41AM	07:51AM	08:01AM	08:13AM	08:23AM	08:38AM
07:57AM	08:00AM	08:11AM	08:21AM	08:33AM	08:43AM	08:58AM
08:17AM	08:20AM	08:31AM	08:41AM	08:53AM	09:03AM	09:18AM
08:34AM	08:37AM	08:48AM	08:58AM	09:13AM	09:23AM	09:38AM
-	08:55AM	09:07AM	09:18AM	09:33AM	09:43AM	09:58AM
09:12AM	09:15AM	09:27AM	09:38AM	09:53AM	10:03AM	10:18AM
09:32AM	09:35AM	09:47AM	09:58AM	10:13AM	10:23AM	10:38AM
09:52AM	09:55AM	10:07AM	10:18AM	10:33AM	10:43AM	10:58AM
10:17AM	10:20AM	10:32AM	10:43AM	10:58AM	11:08AM	11:23AM
10:37AM	10:40AM	10:52AM	11:03AM	11:18AM	11:28AM	11:43AM

10:57AM	11:00AM	11:12AM	11:23AM	11:38AM	11:48AM	12:03PM
11:17AM	11:20AM	11:32AM	11:43AM	11:58AM	12:08PM	12:23PM
11:37AM	11:40AM	11:52AM	12:03PM	12:18PM	12:28PM	12:43PM
11:57AM	12:00PM	12:12PM	12:23PM	12:38PM	12:48PM	01:03PM
12:17PM	12:20PM	12:32PM	12:43PM	12:58PM	01:08PM	01:23PM
12:32PM	12:35PM	12:47PM	12:58PM	01:13PM	01:23PM	01:38PM
12:52PM	12:55PM	01:07PM	01:18PM	01:33PM	01:43PM	01:58PM
01:12PM	01:15PM	01:27PM	01:38PM	01:53PM	02:03PM	02:18PM
01:32PM	01:35PM	01:47PM	01:58PM	02:13PM	02:23PM	02:38PM
01:52PM	01:55PM	02:07PM	02:18PM	02:33PM	02:43PM	02:58PM
02:12PM	02:15PM	02:27PM	02:38PM	02:53PM	03:03PM	03:18PM
02:32PM	02:35PM	02:47PM	02:58PM	03:13PM	03:23PM	03:38PM
02:52PM	02:55PM	03:07PM	03:18PM	03:33PM	03:43PM	03:58PM
03:11PM	03:14PM	03:26PM	03:37PM	03:52PM	04:02PM	04:18PM
03:31PM	03:34PM	03:46PM	03:57PM	04:12PM	04:22PM	04:38PM
03:50PM	03:53PM	04:05PM	04:17PM	04:32PM	04:42PM	04:58PM
04:09PM	04:13PM	04:25PM	04:37PM	04:52PM	05:02PM	05:18PM
04:29PM	04:33PM	04:45PM	04:57PM	05:12PM	05:22PM	05:38PM
04:49PM	04:53PM	05:05PM	05:17PM	05:32PM	05:42PM	05:58PM
05:09PM	05:13PM	05:25PM	05:37PM	05:52PM	06:02PM	06:18PM
05:29PM	05:33PM	05:45PM	05:57PM	06:12PM	06:22PM	06:38PM
05:49PM	05:53PM	06:05PM	06:17PM	06:32PM	06:42PM	06:58PM
06:09PM	06:13PM	06:25PM	06:37PM	06:52PM	07:02PM	07:16PM
06:25PM	06:29PM	06:41PM	06:53PM	07:08PM	07:16PM	07:30PM
07:03PM	07:06PM	07:16PM	07:26PM	07:38PM	07:46PM	08:00PM
07:33PM	07:36PM	07:46PM	07:56PM	08:08PM	08:16PM	08:30PM
08:05PM	08:08PM	08:18PM	08:28PM	08:40PM	08:48PM	09:02PM
08:40PM	08:43PM	08:53PM	09:03PM	09:15PM	09:23PM	09:37PM
09:10PM	09:13PM	09:23PM	09:33PM	09:45PM	09:53PM	10:07PM
10:14PM	10:17PM	10:26PM	10:35PM	10:46PM	10:54PM	11:05PM
10:57PM	11:00PM	11:09PM	11:18PM	11:29PM	11:37PM	11:48PM
-	12:08AM	12:15AM	12:23AM	12:33AM	12:40AM	12:50AM

[Back to previous page \(javascript: history.go\(-1\) \)](#)



# Route 115

## Mid-North Beach Connection

### Clockwise

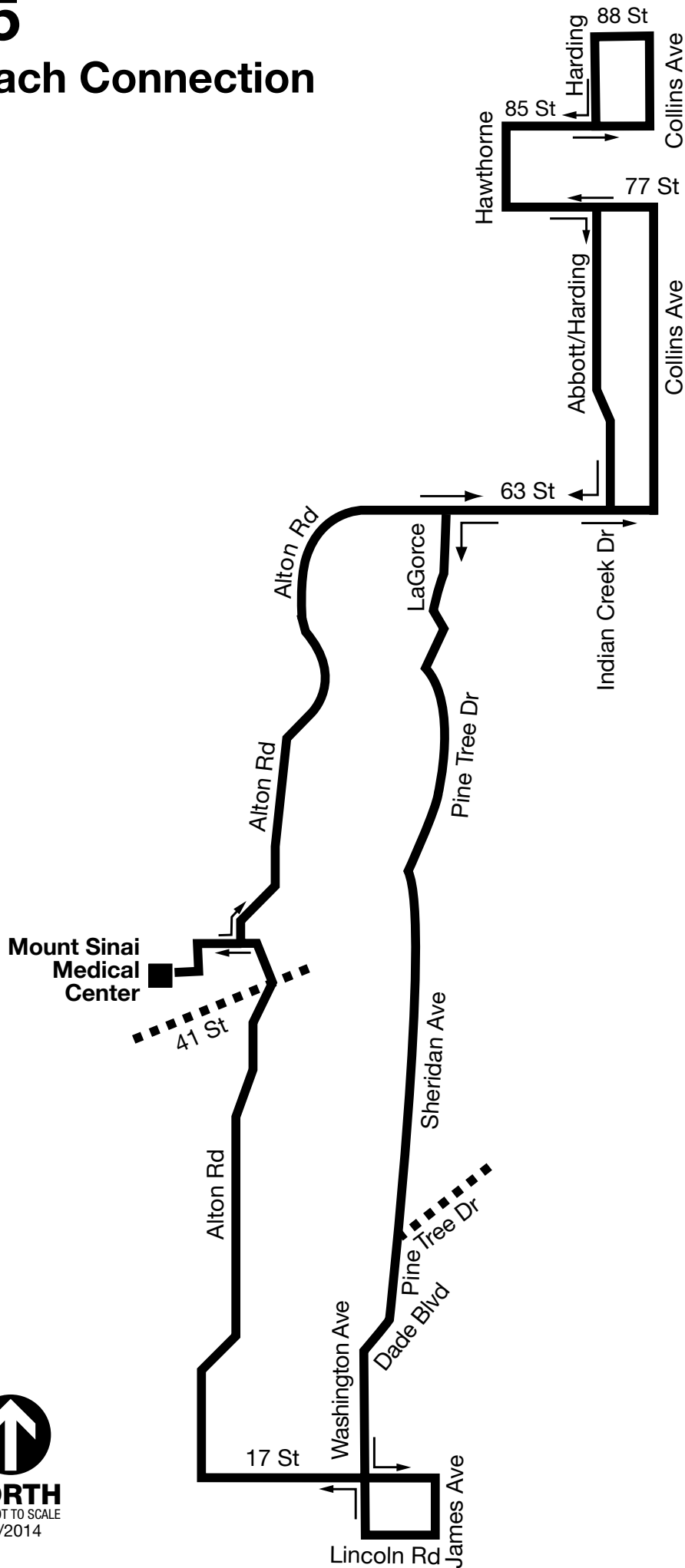
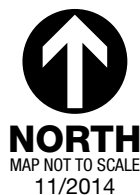

# Routes Schedule



[\(https://facebook.com/GoMiamiDade/](https://facebook.com/GoMiamiDade/)



[\)](https://twitter.com/gomiamidade)



[\(https://www.instagram.com/gomiamidade/](https://www.instagram.com/gomiamidade/)

[\)](#)



115 (Clockwise) WEEKDAY

COLLINS AVE & 87 ST	ABBOTT AVE & 69 ST MIAMI BEACH	SHERIDAN AVE & 41 ST	LINCOLN RD & WASHINGTON AVE	MT SINAI HOSPITAL	COLLINS AVE & 69 ST	COLLINS AVE & 87 ST
06:40AM	06:52AM	07:03AM	07:13AM	07:28AM	07:42AM	07:58AM
07:25AM	07:39AM	07:50AM	08:00AM	08:15AM	08:29AM	08:45AM
08:10AM	08:24AM	08:35AM	08:45AM	09:00AM	09:14AM	09:30AM
08:55AM	09:09AM	09:20AM	09:30AM	09:44AM	09:58AM	10:14AM
09:40AM	09:52AM	10:03AM	10:13AM	10:27AM	10:41AM	10:57AM
10:25AM	10:37AM	10:48AM	10:58AM	11:12AM	11:26AM	11:42AM
11:10AM	11:22AM	11:33AM	11:43AM	11:57AM	12:11PM	12:27PM
11:55AM	12:07PM	12:18PM	12:28PM	12:42PM	12:56PM	01:12PM
12:40PM	12:52PM	01:03PM	01:13PM	01:27PM	01:41PM	01:57PM
01:25PM	01:37PM	01:48PM	01:58PM	02:12PM	02:26PM	02:42PM
02:10PM	02:22PM	02:33PM	02:43PM	02:57PM	03:11PM	03:27PM
02:55PM	03:07PM	03:18PM	03:28PM	03:42PM	03:56PM	04:12PM
03:40PM	03:52PM	04:03PM	04:14PM	04:28PM	04:42PM	04:57PM
04:25PM	04:37PM	04:48PM	04:59PM	05:13PM	05:27PM	05:42PM
05:10PM	05:22PM	05:33PM	05:44PM	05:58PM	06:12PM	06:27PM
05:55PM	06:07PM	06:18PM	06:29PM	06:43PM	06:57PM	07:12PM
06:50PM	07:02PM	07:12PM	07:22PM	07:33PM	07:45PM	08:00PM
07:50PM	08:02PM	08:12PM	08:22PM	08:33PM	08:45PM	09:00PM

[Back to previous page \(javascript: history.go\(-1\) \)](#)

# Route 117

## Mid-North Beach Connection

### Counterclockwise



Mount Sinai  
Medical  
Center



41 St

Alton Rd

Alton Rd

Alton Rd

17 St

Dade  
Blvd

Washington  
Ave

Sheridan Ave



Pine Tree Dr

Lincoln Rd

James Ave

Pine Tree Dr

Indian Creek Dr

Abbott/Harding

Dickens

77 St

Hawthorne

85 St

Harding

88 St

Collins Ave

73 St

Collins Ave

# Routes Schedule



[\(https://facebook.com/GoMiamiDade/](https://facebook.com/GoMiamiDade/)



[\) \(https://twitter.com/gomiamidade \)](https://twitter.com/gomiamidade)



[\(https://www.instagram.com/gomiamidade/](https://www.instagram.com/gomiamidade/)

)



117 (CntClockwise) WEEKDAY

COLLINS AVE & 87 ST	ABBOTT AVE & 69 ST MIAMI BEACH	MT SINAI HOSPITAL	LINCOLN RD & WASHINGTON AVE	SHERIDAN AVE & 40 ST	COLLINS AVE & 69 ST	COLLINS AVE & 87 ST
06:20AM	06:30AM	06:41AM	06:56AM	07:04AM	07:17AM	07:32AM
07:05AM	07:18AM	07:31AM	07:48AM	07:56AM	08:09AM	08:24AM
07:50AM	08:03AM	08:16AM	08:33AM	08:41AM	08:54AM	09:09AM
08:35AM	08:48AM	09:01AM	09:20AM	09:28AM	09:42AM	09:57AM
09:20AM	09:31AM	09:44AM	10:03AM	10:11AM	10:25AM	10:40AM
10:05AM	10:16AM	10:29AM	10:48AM	10:56AM	11:10AM	11:25AM
10:50AM	11:01AM	11:14AM	11:33AM	11:41AM	11:55AM	12:10PM
11:35AM	11:46AM	11:59AM	12:18PM	12:26PM	12:40PM	12:55PM
12:20PM	12:31PM	12:44PM	01:03PM	01:11PM	01:25PM	01:40PM
01:05PM	01:16PM	01:29PM	01:48PM	01:56PM	02:10PM	02:25PM
01:50PM	02:01PM	02:14PM	02:33PM	02:41PM	02:55PM	03:10PM
02:35PM	02:46PM	02:59PM	03:18PM	03:26PM	03:40PM	03:55PM
03:20PM	03:31PM	03:44PM	04:03PM	04:12PM	04:26PM	04:41PM
04:05PM	04:16PM	04:29PM	04:48PM	04:57PM	05:11PM	05:26PM
04:50PM	05:01PM	05:14PM	05:33PM	05:42PM	05:56PM	06:11PM
05:35PM	05:46PM	05:59PM	06:18PM	06:27PM	06:41PM	06:56PM
06:20PM	06:31PM	06:44PM	07:03PM	07:11PM	07:23PM	07:34PM
07:20PM	07:31PM	07:41PM	07:56PM	08:04PM	08:16PM	08:27PM
08:20PM	08:31PM	08:41PM	08:56PM	09:04PM	09:16PM	09:27PM
09:20PM	09:31PM	09:41PM	09:56PM	10:04PM	10:16PM	10:27PM

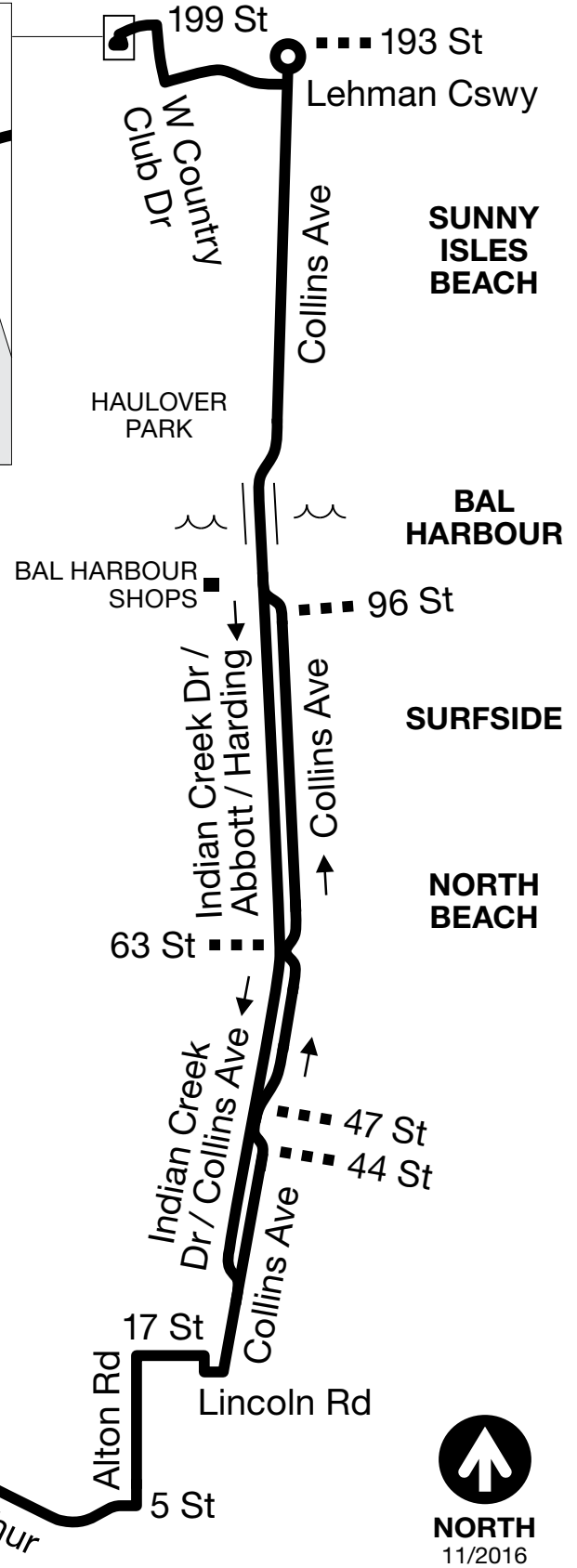
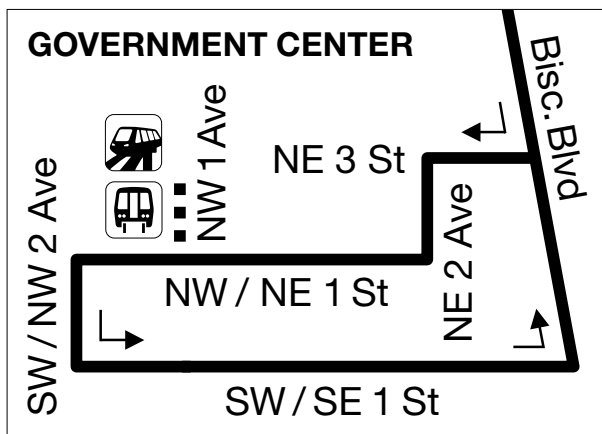
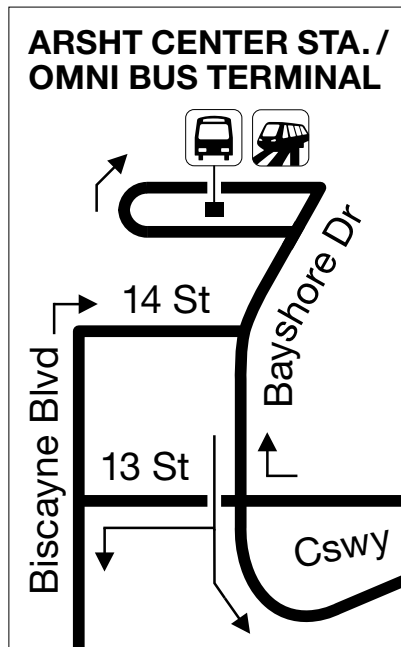
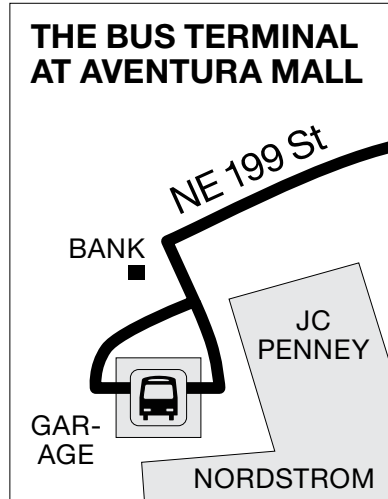



# Routes Schedule



[\(https://facebook.com/GoMiamiDade/](https://facebook.com/GoMiamiDade/)



[\) \(https://twitter.com/gomiamidade \)](https://twitter.com/gomiamidade)



[\(https://www.instagram.com/gomiamide](https://www.instagram.com/gomiamidade/)

[\) \(https://www.instagram.com/gomiamidade \)](https://www.instagram.com/gomiamidade/)



119 (Northbound) WEEKDAY										
NW 1 St & 2 Ave	Omni Terminal / Arsht Metromover	Alton Rd & 6 St	17 ST & LENOX AV	Lincoln Rd & James Ave	COLLINS AVE & 41 ST	COLLINS AVE & 69 ST	COLLINS AVE & 96 ST MIAMI BEACH	COLLINS AVE & SUNNY ISLES BLVD	COLLINS AVE & 193 ST	Bus Terminal at Aventura Mall
05:00AM	05:09AM	05:16AM	05:22AM	05:27AM	05:33AM	05:41AM	05:49AM	05:55AM	06:03AM	06:10AM
05:24AM	05:33AM	05:40AM	05:46AM	05:51AM	05:57AM	06:08AM	06:18AM	06:26AM	06:34AM	06:41AM
05:34AM	05:43AM	05:50AM	05:56AM	06:02AM	06:10AM	06:21AM	06:31AM	06:39AM	06:47AM	06:54AM
05:44AM	05:53AM	06:01AM	06:08AM	06:14AM	06:22AM	06:33AM	06:43AM	06:51AM	06:59AM	07:07AM
05:56AM	06:08AM	06:16AM	06:23AM	06:29AM	06:37AM	06:48AM	06:58AM	07:07AM	07:17AM	07:25AM
06:07AM	06:19AM	06:27AM	06:34AM	06:40AM	06:48AM	06:59AM	07:10AM	07:19AM	07:29AM	07:37AM
06:20AM	06:32AM	06:40AM	06:47AM	06:53AM	07:01AM	07:14AM	07:25AM	07:34AM	07:44AM	07:52AM
06:33AM	06:45AM	06:53AM	07:01AM	07:07AM	07:15AM	07:28AM	07:39AM	07:48AM	07:58AM	08:06AM
06:45AM	06:57AM	07:07AM	07:15AM	07:21AM	07:29AM	07:42AM	07:53AM	08:03AM	08:13AM	08:21AM
06:56AM	07:09AM	07:19AM	07:27AM	07:33AM	07:41AM	07:54AM	08:05AM	08:15AM	08:25AM	08:33AM
07:08AM	07:21AM	07:31AM	07:39AM	07:45AM	07:53AM	08:06AM	08:17AM	08:27AM	08:37AM	08:45AM
07:20AM	07:33AM	07:43AM	07:51AM	07:57AM	08:06AM	08:19AM	08:30AM	08:40AM	08:50AM	08:58AM
07:32AM	07:45AM	07:55AM	08:03AM	08:10AM	08:19AM	08:32AM	08:43AM	08:53AM	09:03AM	09:12AM
07:44AM	07:57AM	08:08AM	08:16AM	08:23AM	08:32AM	08:45AM	08:56AM	09:06AM	09:16AM	09:25AM
07:56AM	08:10AM	08:21AM	08:29AM	08:36AM	08:45AM	08:58AM	09:09AM	09:18AM	09:28AM	09:37AM
08:08AM	08:22AM	08:33AM	08:41AM	08:48AM	08:57AM	09:11AM	09:22AM	09:31AM	09:41AM	09:50AM
08:20AM	08:34AM	08:45AM	08:53AM	09:01AM	09:12AM	09:26AM	09:37AM	09:46AM	09:56AM	10:05AM
08:32AM	08:46AM	08:57AM	09:06AM	09:14AM	09:25AM	09:39AM	09:50AM	09:59AM	10:09AM	10:18AM

08:44AM	08:58AM	09:10AM	09:19AM	09:27AM	09:38AM	09:52AM	10:03AM	10:12AM	10:22AM	10:31AM
08:56AM	09:12AM	09:24AM	09:33AM	09:41AM	09:52AM	10:06AM	10:17AM	10:26AM	10:36AM	10:45AM
09:08AM	09:24AM	09:36AM	09:45AM	09:53AM	10:04AM	10:18AM	10:29AM	10:38AM	10:48AM	10:57AM
09:20AM	09:36AM	09:48AM	09:57AM	10:05AM	10:16AM	10:30AM	10:41AM	10:50AM	11:00AM	11:09AM
09:32AM	09:48AM	10:00AM	10:09AM	10:17AM	10:28AM	10:42AM	10:53AM	11:02AM	11:12AM	11:21AM
09:44AM	10:00AM	10:12AM	10:21AM	10:29AM	10:40AM	10:54AM	11:05AM	11:14AM	11:24AM	11:33AM
09:56AM	10:12AM	10:24AM	10:33AM	10:41AM	10:52AM	11:06AM	11:17AM	11:26AM	11:36AM	11:45AM
10:08AM	10:24AM	10:36AM	10:45AM	10:53AM	11:04AM	11:18AM	11:29AM	11:38AM	11:48AM	11:57AM
10:20AM	10:36AM	10:48AM	10:57AM	11:05AM	11:16AM	11:30AM	11:41AM	11:50AM	12:00PM	12:09PM
10:32AM	10:48AM	11:00AM	11:09AM	11:17AM	11:28AM	11:42AM	11:53AM	12:02PM	12:12PM	12:21PM
10:44AM	11:00AM	11:12AM	11:21AM	11:29AM	11:40AM	11:54AM	12:05PM	12:14PM	12:24PM	12:33PM
10:56AM	11:12AM	11:24AM	11:33AM	11:41AM	11:52AM	12:06PM	12:17PM	12:26PM	12:36PM	12:45PM
11:08AM	11:24AM	11:36AM	11:45AM	11:53AM	12:04PM	12:18PM	12:29PM	12:38PM	12:48PM	12:57PM
11:20AM	11:36AM	11:48AM	11:57AM	12:05PM	12:16PM	12:30PM	12:41PM	12:50PM	01:00PM	01:09PM
11:32AM	11:48AM	12:00PM	12:09PM	12:17PM	12:28PM	12:42PM	12:53PM	01:02PM	01:12PM	01:21PM
11:44AM	12:00PM	12:12PM	12:21PM	12:29PM	12:40PM	12:54PM	01:05PM	01:14PM	01:24PM	01:33PM
11:56AM	12:12PM	12:24PM	12:33PM	12:41PM	12:52PM	01:06PM	01:17PM	01:26PM	01:36PM	01:45PM
12:08PM	12:24PM	12:36PM	12:45PM	12:53PM	01:04PM	01:18PM	01:29PM	01:38PM	01:48PM	01:57PM
12:20PM	12:36PM	12:48PM	12:57PM	01:05PM	01:16PM	01:30PM	01:41PM	01:50PM	02:00PM	02:09PM
12:32PM	12:48PM	01:00PM	01:09PM	01:17PM	01:28PM	01:42PM	01:53PM	02:03PM	02:13PM	02:22PM
12:44PM	01:00PM	01:12PM	01:21PM	01:29PM	01:40PM	01:54PM	02:06PM	02:16PM	02:26PM	02:35PM
12:56PM	01:12PM	01:24PM	01:33PM	01:41PM	01:52PM	02:07PM	02:19PM	02:29PM	02:39PM	02:48PM
01:08PM	01:24PM	01:36PM	01:45PM	01:53PM	02:05PM	02:20PM	02:32PM	02:42PM	02:52PM	03:01PM
01:20PM	01:36PM	01:48PM	01:57PM	02:06PM	02:18PM	02:33PM	02:45PM	02:55PM	03:05PM	03:14PM
01:32PM	01:48PM	02:01PM	02:11PM	02:20PM	02:32PM	02:47PM	02:59PM	03:09PM	03:19PM	03:28PM
01:44PM	02:00PM	02:13PM	02:23PM	02:32PM	02:44PM	02:59PM	03:11PM	03:21PM	03:31PM	03:40PM
01:56PM	02:12PM	02:25PM	02:35PM	02:44PM	02:56PM	03:11PM	03:23PM	03:33PM	03:43PM	03:52PM
02:08PM	02:24PM	02:37PM	02:47PM	02:56PM	03:08PM	03:23PM	03:35PM	03:45PM	03:55PM	04:04PM
02:20PM	02:36PM	02:49PM	02:59PM	03:08PM	03:20PM	03:35PM	03:47PM	03:57PM	04:07PM	04:16PM
02:32PM	02:48PM	03:01PM	03:11PM	03:20PM	03:32PM	03:47PM	03:59PM	04:09PM	04:18PM	04:27PM
02:44PM	03:00PM	03:13PM	03:23PM	03:32PM	03:44PM	03:59PM	04:11PM	04:21PM	04:30PM	04:39PM
02:56PM	03:12PM	03:25PM	03:35PM	03:44PM	03:56PM	04:11PM	04:22PM	04:32PM	04:41PM	04:50PM
03:08PM	03:24PM	03:37PM	03:47PM	03:56PM	04:08PM	04:23PM	04:34PM	04:44PM	04:53PM	05:02PM
03:20PM	03:36PM	03:49PM	03:59PM	04:08PM	04:19PM	04:34PM	04:45PM	04:55PM	05:04PM	05:13PM
03:32PM	03:48PM	04:01PM	04:11PM	04:20PM	04:31PM	04:46PM	04:57PM	05:07PM	05:16PM	05:25PM
03:44PM	04:01PM	04:13PM	04:23PM	04:32PM	04:43PM	04:58PM	05:09PM	05:19PM	05:28PM	05:37PM
03:56PM	04:13PM	04:25PM	04:35PM	04:44PM	04:55PM	05:10PM	05:21PM	05:31PM	05:40PM	05:49PM

04:08PM	04:25PM	04:37PM	04:47PM	04:56PM	05:07PM	05:22PM	05:33PM	05:43PM	05:52PM	06:01PM
04:20PM	04:37PM	04:49PM	04:59PM	05:08PM	05:19PM	05:34PM	05:45PM	05:55PM	06:04PM	06:13PM
04:32PM	04:49PM	05:01PM	05:11PM	05:20PM	05:31PM	05:46PM	05:57PM	06:07PM	06:16PM	06:25PM
04:44PM	05:01PM	05:13PM	05:23PM	05:32PM	05:43PM	05:58PM	06:09PM	06:19PM	06:28PM	06:37PM
04:56PM	05:13PM	05:25PM	05:35PM	05:44PM	05:55PM	06:10PM	06:21PM	06:31PM	06:40PM	06:49PM
05:08PM	05:25PM	05:37PM	05:47PM	05:56PM	06:07PM	06:22PM	06:33PM	06:43PM	06:52PM	07:01PM
05:20PM	05:37PM	05:49PM	05:59PM	06:08PM	06:19PM	06:34PM	06:45PM	06:55PM	07:04PM	07:12PM
05:32PM	05:49PM	06:01PM	06:11PM	06:20PM	06:31PM	06:46PM	06:57PM	07:07PM	07:15PM	07:23PM
05:44PM	06:01PM	06:13PM	06:23PM	06:32PM	06:43PM	06:58PM	07:09PM	07:17PM	07:25PM	07:33PM
05:56PM	06:13PM	06:25PM	06:35PM	06:44PM	06:55PM	07:10PM	07:19PM	07:27PM	07:35PM	07:43PM
06:08PM	06:25PM	06:37PM	06:47PM	06:56PM	07:07PM	07:19PM	07:28PM	07:36PM	07:44PM	07:52PM
06:20PM	06:37PM	06:49PM	06:59PM	07:08PM	07:18PM	07:30PM	07:39PM	07:47PM	07:55PM	08:03PM
06:32PM	06:49PM	07:01PM	07:09PM	07:17PM	07:27PM	07:39PM	07:48PM	07:56PM	08:04PM	08:12PM
06:44PM	07:01PM	07:10PM	07:18PM	07:26PM	07:36PM	07:48PM	07:57PM	08:05PM	08:13PM	08:21PM
06:56PM	07:13PM	07:22PM	07:30PM	07:38PM	07:48PM	08:00PM	08:09PM	08:17PM	08:25PM	08:33PM
07:08PM	07:22PM	07:31PM	07:39PM	07:47PM	07:57PM	08:09PM	08:18PM	08:26PM	08:34PM	08:42PM
07:20PM	07:34PM	07:43PM	07:51PM	07:59PM	08:09PM	08:21PM	08:30PM	08:38PM	08:46PM	08:54PM
07:32PM	07:46PM	07:55PM	08:03PM	08:11PM	08:21PM	08:33PM	08:42PM	08:50PM	08:58PM	09:06PM
07:44PM	07:58PM	08:07PM	08:15PM	08:23PM	08:33PM	08:45PM	08:54PM	09:02PM	09:10PM	09:18PM
07:56PM	08:10PM	08:19PM	08:27PM	08:35PM	08:45PM	08:57PM	09:06PM	09:14PM	09:22PM	09:30PM
08:20PM	08:34PM	08:43PM	08:51PM	08:59PM	09:09PM	09:21PM	09:30PM	09:38PM	09:46PM	09:54PM
08:44PM	08:58PM	09:07PM	09:15PM	09:23PM	09:33PM	09:45PM	09:54PM	10:02PM	10:09PM	10:16PM
09:08PM	09:22PM	09:31PM	09:39PM	09:47PM	09:57PM	10:09PM	10:18PM	10:25PM	10:32PM	10:39PM
09:32PM	09:46PM	09:55PM	10:03PM	10:11PM	10:21PM	10:33PM	10:42PM	10:49PM	10:56PM	11:03PM
09:56PM	10:10PM	10:17PM	10:24PM	10:32PM	10:42PM	10:54PM	11:03PM	11:10PM	11:17PM	11:24PM
10:20PM	10:33PM	10:40PM	10:47PM	10:55PM	11:05PM	11:17PM	11:26PM	11:33PM	11:40PM	11:47PM
10:44PM	10:57PM	11:04PM	11:11PM	11:19PM	11:29PM	11:41PM	11:50PM	11:57PM	12:04AM	12:10AM
11:10PM	11:23PM	11:30PM	11:37PM	11:45PM	11:55PM	12:07AM	12:15AM	12:21AM	12:27AM	12:33AM
11:40PM	11:53PM	12:00AM	12:06AM	12:13AM	12:21AM	12:30AM	12:38AM	12:44AM	12:50AM	12:56AM
12:10AM	12:21AM	12:28AM	12:34AM	12:41AM	12:49AM	12:58AM	01:06AM	01:12AM	01:18AM	01:24AM
12:40AM	12:51AM	12:58AM	01:04AM	01:11AM	01:19AM	01:28AM	01:36AM	01:42AM	01:48AM	01:54AM
01:10AM	01:21AM	01:28AM	01:34AM	01:41AM	01:49AM	01:58AM	02:06AM	02:12AM	02:18AM	02:24AM
02:10AM	02:21AM	02:28AM	02:34AM	02:41AM	02:49AM	02:58AM	03:06AM	03:12AM	03:18AM	03:24AM
03:10AM	03:21AM	03:28AM	03:34AM	03:41AM	03:49AM	03:58AM	04:06AM	04:12AM	04:18AM	04:24AM
04:10AM	04:21AM	04:28AM	04:34AM	04:41AM	04:49AM	04:58AM	05:06AM	05:12AM	05:18AM	05:24AM

[Back to previous page \(javascript: history.go\(-1\) \)](#)

# Routes Schedule



[\(https://facebook.com/GoMiamiDade/](https://facebook.com/GoMiamiDade/)



[\) \(https://twitter.com/gomiamidade \)](https://twitter.com/gomiamidade)



[\(https://www.instagram.com/gomiamidade/](https://www.instagram.com/gomiamidade/)

)



## 119 (Southbound) WEEKDAY

Bus Terminal at Aventura Mall	COLLINS AVE & 193 ST	COLLINS AVE & 163 ST	BAL HARBOUR SHOPS	ABBOTT AVE & 69 ST MIAMI BEACH	INDIAN CREEK DR & 40 ST	LINCOLN RD & WASHINGTON AVE	ALTON RD & LINCOLN RD MIAMI BEACH	ALTON RD & 6 ST MIAMI BEACH	Omni Terminal / Arsht Metromover	NW 1 St & 2 Ave
04:16AM	04:23AM	04:29AM	04:35AM	04:44AM	04:52AM	04:58AM	05:03AM	05:08AM	05:14AM	05:24AM
04:49AM	04:56AM	05:02AM	05:08AM	05:17AM	05:25AM	05:31AM	05:36AM	05:41AM	05:47AM	05:57AM
05:08AM	05:15AM	05:21AM	05:27AM	05:36AM	05:44AM	05:50AM	05:55AM	06:01AM	06:09AM	06:23AM
05:25AM	05:32AM	05:38AM	05:44AM	05:53AM	06:04AM	06:12AM	06:18AM	06:24AM	06:32AM	06:46AM
05:46AM	05:53AM	05:59AM	06:06AM	06:16AM	06:27AM	06:35AM	06:41AM	06:47AM	06:55AM	07:10AM
05:54AM	06:03AM	06:11AM	06:18AM	06:28AM	06:39AM	06:47AM	06:53AM	06:59AM	07:07AM	07:22AM
06:05AM	06:14AM	06:22AM	06:29AM	06:39AM	06:50AM	06:58AM	07:05AM	07:11AM	07:19AM	07:34AM
06:15AM	06:24AM	06:32AM	06:39AM	06:49AM	07:01AM	07:10AM	07:17AM	07:23AM	07:31AM	07:46AM
06:25AM	06:34AM	06:42AM	06:49AM	06:59AM	07:11AM	07:20AM	07:27AM	07:33AM	07:41AM	07:56AM
06:36AM	06:45AM	06:53AM	07:01AM	07:13AM	07:25AM	07:34AM	07:41AM	07:47AM	07:55AM	08:10AM
06:47AM	06:56AM	07:05AM	07:13AM	07:25AM	07:37AM	07:46AM	07:53AM	07:59AM	08:07AM	08:22AM
06:56AM	07:07AM	07:16AM	07:24AM	07:36AM	07:48AM	07:57AM	08:04AM	08:11AM	08:19AM	08:34AM
07:06AM	07:17AM	07:26AM	07:34AM	07:46AM	07:58AM	08:07AM	08:14AM	08:21AM	08:29AM	08:44AM
07:18AM	07:29AM	07:38AM	07:46AM	07:58AM	08:12AM	08:21AM	08:28AM	08:35AM	08:43AM	08:58AM
07:30AM	07:41AM	07:50AM	07:58AM	08:10AM	08:24AM	08:33AM	08:40AM	08:47AM	08:55AM	09:10AM
07:39AM	07:50AM	07:59AM	08:07AM	08:19AM	08:33AM	08:42AM	08:49AM	08:56AM	09:05AM	09:20AM
07:48AM	07:59AM	08:10AM	08:18AM	08:30AM	08:44AM	08:53AM	09:02AM	09:10AM	09:19AM	09:34AM
07:58AM	08:10AM	08:21AM	08:29AM	08:41AM	08:55AM	09:05AM	09:14AM	09:22AM	09:31AM	09:46AM



08:09AM	08:21AM	08:32AM	08:40AM	08:52AM	09:07AM	09:17AM	09:26AM	09:34AM	09:43AM	09:58AM
08:21AM	08:33AM	08:44AM	08:52AM	09:04AM	09:19AM	09:29AM	09:38AM	09:46AM	09:55AM	10:10AM
08:33AM	08:45AM	08:56AM	09:04AM	09:16AM	09:31AM	09:41AM	09:50AM	09:58AM	10:07AM	10:22AM
08:45AM	08:57AM	09:08AM	09:16AM	09:28AM	09:43AM	09:53AM	10:02AM	10:10AM	10:19AM	10:34AM
08:56AM	09:09AM	09:20AM	09:28AM	09:40AM	09:55AM	10:05AM	10:14AM	10:22AM	10:31AM	10:46AM
09:08AM	09:21AM	09:32AM	09:40AM	09:52AM	10:07AM	10:17AM	10:26AM	10:34AM	10:43AM	10:58AM
09:20AM	09:33AM	09:44AM	09:52AM	10:04AM	10:19AM	10:29AM	10:38AM	10:46AM	10:55AM	11:10AM
09:32AM	09:45AM	09:56AM	10:04AM	10:16AM	10:31AM	10:41AM	10:50AM	10:58AM	11:07AM	11:22AM
09:44AM	09:57AM	10:08AM	10:16AM	10:28AM	10:43AM	10:53AM	11:02AM	11:10AM	11:19AM	11:34AM
09:56AM	10:09AM	10:20AM	10:28AM	10:40AM	10:55AM	11:05AM	11:14AM	11:22AM	11:31AM	11:46AM
10:08AM	10:21AM	10:32AM	10:40AM	10:52AM	11:07AM	11:17AM	11:26AM	11:34AM	11:43AM	11:58AM
10:20AM	10:33AM	10:44AM	10:52AM	11:04AM	11:19AM	11:29AM	11:38AM	11:46AM	11:55AM	12:10PM
10:32AM	10:45AM	10:56AM	11:04AM	11:16AM	11:31AM	11:41AM	11:50AM	11:58AM	12:07PM	12:22PM
10:44AM	10:57AM	11:08AM	11:16AM	11:28AM	11:43AM	11:53AM	12:02PM	12:10PM	12:19PM	12:34PM
10:56AM	11:09AM	11:20AM	11:28AM	11:40AM	11:55AM	12:05PM	12:14PM	12:22PM	12:31PM	12:46PM
11:08AM	11:21AM	11:32AM	11:40AM	11:52AM	12:07PM	12:17PM	12:26PM	12:34PM	12:43PM	12:58PM
11:20AM	11:33AM	11:44AM	11:52AM	12:04PM	12:19PM	12:29PM	12:38PM	12:46PM	12:55PM	01:10PM
11:32AM	11:45AM	11:56AM	12:04PM	12:16PM	12:31PM	12:41PM	12:50PM	12:58PM	01:07PM	01:22PM
11:44AM	11:57AM	12:08PM	12:16PM	12:28PM	12:43PM	12:53PM	01:02PM	01:10PM	01:19PM	01:34PM
11:56AM	12:09PM	12:20PM	12:28PM	12:40PM	12:55PM	01:05PM	01:14PM	01:22PM	01:31PM	01:46PM
12:08PM	12:21PM	12:32PM	12:40PM	12:52PM	01:07PM	01:17PM	01:26PM	01:34PM	01:43PM	01:58PM
12:19PM	12:32PM	12:43PM	12:51PM	01:03PM	01:18PM	01:28PM	01:37PM	01:45PM	01:54PM	02:10PM
12:31PM	12:44PM	12:55PM	01:03PM	01:15PM	01:30PM	01:40PM	01:49PM	01:57PM	02:06PM	02:22PM
12:42PM	12:55PM	01:06PM	01:14PM	01:26PM	01:41PM	01:51PM	02:00PM	02:09PM	02:18PM	02:34PM
12:54PM	01:07PM	01:18PM	01:26PM	01:38PM	01:53PM	02:03PM	02:12PM	02:21PM	02:30PM	02:46PM
01:05PM	01:18PM	01:29PM	01:37PM	01:49PM	02:05PM	02:15PM	02:24PM	02:33PM	02:42PM	02:58PM
01:12PM	01:25PM	01:36PM	01:44PM	01:56PM	02:12PM	02:22PM	02:31PM	02:40PM	02:49PM	03:05PM
01:24PM	01:37PM	01:48PM	01:56PM	02:13PM	02:29PM	02:39PM	02:48PM	02:57PM	03:06PM	03:22PM
01:35PM	01:48PM	01:59PM	02:07PM	02:24PM	02:40PM	02:50PM	02:59PM	03:08PM	03:17PM	03:33PM
01:47PM	02:00PM	02:12PM	02:20PM	02:37PM	02:53PM	03:03PM	03:12PM	03:21PM	03:30PM	03:46PM
01:59PM	02:12PM	02:24PM	02:32PM	02:49PM	03:05PM	03:15PM	03:24PM	03:33PM	03:42PM	03:58PM
02:11PM	02:24PM	02:36PM	02:44PM	03:01PM	03:17PM	03:27PM	03:36PM	03:45PM	03:54PM	04:10PM
02:22PM	02:35PM	02:47PM	02:55PM	03:12PM	03:28PM	03:38PM	03:47PM	03:56PM	04:06PM	04:22PM
02:35PM	02:48PM	03:00PM	03:08PM	03:25PM	03:41PM	03:51PM	04:00PM	04:08PM	04:18PM	04:34PM
02:47PM	03:00PM	03:12PM	03:20PM	03:37PM	03:53PM	04:03PM	04:12PM	04:20PM	04:30PM	04:46PM
02:59PM	03:12PM	03:24PM	03:32PM	03:49PM	04:05PM	04:15PM	04:24PM	04:32PM	04:42PM	04:58PM
03:12PM	03:25PM	03:37PM	03:45PM	04:02PM	04:17PM	04:27PM	04:36PM	04:44PM	04:54PM	05:10PM

03:29PM	03:42PM	03:54PM	04:02PM	04:14PM	04:29PM	04:39PM	04:48PM	04:56PM	05:06PM	05:22PM
03:41PM	03:54PM	04:06PM	04:14PM	04:26PM	04:41PM	04:51PM	05:00PM	05:08PM	05:18PM	05:34PM
03:50PM	04:07PM	04:18PM	04:26PM	04:38PM	04:53PM	05:03PM	05:12PM	05:20PM	05:30PM	05:46PM
04:02PM	04:19PM	04:30PM	04:38PM	04:50PM	05:05PM	05:15PM	05:24PM	05:32PM	05:42PM	05:58PM
04:14PM	04:31PM	04:42PM	04:50PM	05:02PM	05:17PM	05:27PM	05:36PM	05:44PM	05:54PM	06:10PM
04:26PM	04:43PM	04:54PM	05:02PM	05:14PM	05:29PM	05:39PM	05:48PM	05:56PM	06:06PM	06:22PM
04:38PM	04:55PM	05:06PM	05:14PM	05:26PM	05:41PM	05:51PM	06:00PM	06:08PM	06:18PM	06:34PM
04:50PM	05:07PM	05:18PM	05:26PM	05:38PM	05:53PM	06:03PM	06:12PM	06:20PM	06:30PM	06:46PM
05:02PM	05:19PM	05:30PM	05:38PM	05:50PM	06:05PM	06:15PM	06:24PM	06:32PM	06:42PM	06:58PM
05:14PM	05:31PM	05:42PM	05:50PM	06:02PM	06:17PM	06:27PM	06:36PM	06:44PM	06:54PM	07:10PM
05:33PM	05:50PM	06:01PM	06:09PM	06:21PM	06:36PM	06:46PM	06:55PM	07:03PM	07:10PM	07:22PM
05:49PM	06:06PM	06:17PM	06:25PM	06:37PM	06:52PM	07:02PM	07:09PM	07:15PM	07:22PM	07:34PM
06:00PM	06:17PM	06:28PM	06:36PM	06:48PM	07:03PM	07:12PM	07:19PM	07:25PM	07:32PM	07:44PM
06:16PM	06:33PM	06:44PM	06:52PM	07:04PM	07:15PM	07:24PM	07:31PM	07:37PM	07:44PM	07:56PM
06:30PM	06:47PM	06:58PM	07:06PM	07:16PM	07:27PM	07:36PM	07:43PM	07:49PM	07:56PM	08:08PM
06:45PM	07:02PM	07:11PM	07:18PM	07:28PM	07:39PM	07:48PM	07:55PM	08:01PM	08:08PM	08:20PM
06:57PM	07:14PM	07:23PM	07:30PM	07:40PM	07:51PM	08:00PM	08:07PM	08:13PM	08:20PM	08:32PM
07:11PM	07:26PM	07:35PM	07:42PM	07:52PM	08:03PM	08:12PM	08:19PM	08:25PM	08:32PM	08:44PM
07:23PM	07:38PM	07:47PM	07:54PM	08:04PM	08:15PM	08:24PM	08:31PM	08:37PM	08:44PM	08:56PM
07:35PM	07:50PM	07:59PM	08:06PM	08:16PM	08:27PM	08:36PM	08:43PM	08:49PM	08:56PM	09:08PM
07:47PM	08:02PM	08:11PM	08:18PM	08:28PM	08:39PM	08:48PM	08:55PM	09:01PM	09:08PM	09:20PM
07:59PM	08:14PM	08:23PM	08:30PM	08:40PM	08:51PM	09:00PM	09:07PM	09:13PM	09:20PM	09:32PM
08:11PM	08:26PM	08:35PM	08:42PM	08:52PM	09:03PM	09:12PM	09:19PM	09:25PM	09:32PM	09:44PM
08:23PM	08:38PM	08:47PM	08:54PM	09:04PM	09:15PM	09:24PM	09:31PM	09:37PM	09:44PM	09:56PM
08:35PM	08:50PM	08:59PM	09:06PM	09:16PM	09:27PM	09:36PM	09:43PM	09:49PM	09:56PM	10:08PM
08:49PM	09:04PM	09:13PM	09:20PM	09:30PM	09:41PM	09:50PM	09:57PM	10:03PM	10:10PM	10:20PM
09:02PM	09:17PM	09:26PM	09:33PM	09:43PM	09:54PM	10:03PM	10:10PM	10:15PM	10:22PM	10:32PM
09:15PM	09:30PM	09:39PM	09:46PM	09:56PM	10:07PM	10:15PM	10:22PM	10:27PM	10:34PM	10:44PM
09:29PM	09:44PM	09:53PM	10:00PM	10:09PM	10:19PM	10:27PM	10:34PM	10:39PM	10:46PM	10:56PM
09:42PM	09:57PM	10:06PM	10:12PM	10:21PM	10:31PM	10:39PM	10:46PM	10:51PM	10:58PM	11:08PM
10:08PM	10:20PM	10:28PM	10:34PM	10:43PM	10:53PM	11:01PM	11:08PM	11:13PM	11:20PM	11:30PM
10:33PM	10:45PM	10:53PM	10:59PM	11:08PM	11:18PM	11:26PM	11:33PM	11:38PM	11:45PM	11:55PM
10:55PM	11:07PM	11:15PM	11:21PM	11:30PM	11:40PM	11:48PM	11:55PM	12:00AM	12:06AM	12:16AM
11:20PM	11:32PM	11:40PM	11:46PM	11:55PM	12:05AM	12:11AM	12:17AM	12:22AM	12:28AM	12:38AM
11:43PM	11:55PM	12:03AM	12:09AM	12:17AM	12:25AM	12:31AM	12:37AM	12:42AM	12:48AM	12:58AM
12:13AM	12:23AM	12:30AM	12:36AM	12:44AM	12:52AM	12:58AM	01:04AM	01:09AM	01:15AM	01:25AM
12:43AM	12:53AM	01:00AM	01:06AM	01:14AM	01:22AM	01:28AM	01:34AM	01:39AM	01:45AM	01:55AM

01:43AM	01:53AM	02:00AM	02:06AM	02:14AM	02:22AM	02:28AM	02:34AM	02:39AM	02:45AM	02:55AM
02:43AM	02:53AM	03:00AM	03:06AM	03:14AM	03:22AM	03:28AM	03:34AM	03:39AM	03:45AM	03:55AM
03:43AM	03:53AM	04:00AM	04:06AM	04:14AM	04:22AM	04:28AM	04:34AM	04:39AM	04:45AM	04:55AM

[Back to previous page \(javascript: history.go\(-1\) \)](#)

Page Last Edited: Mon Jan 30, 2017 2:39:07 PM







# 120

BEACH MAX

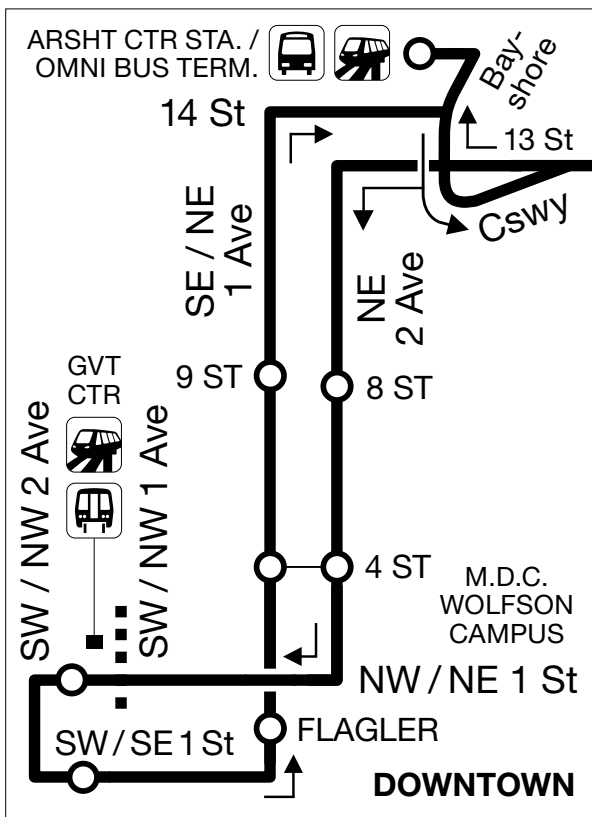
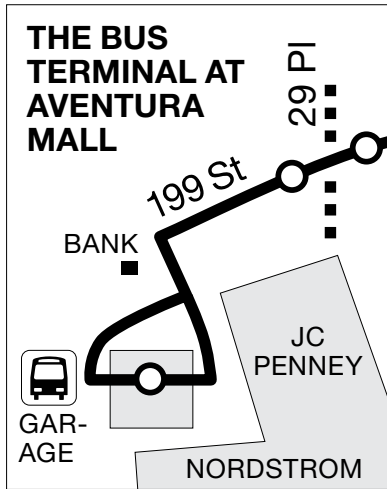

**LIMITED STOPS**  
entire route

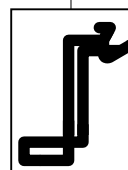

JUNGLE IS.

MacArthur Cswy

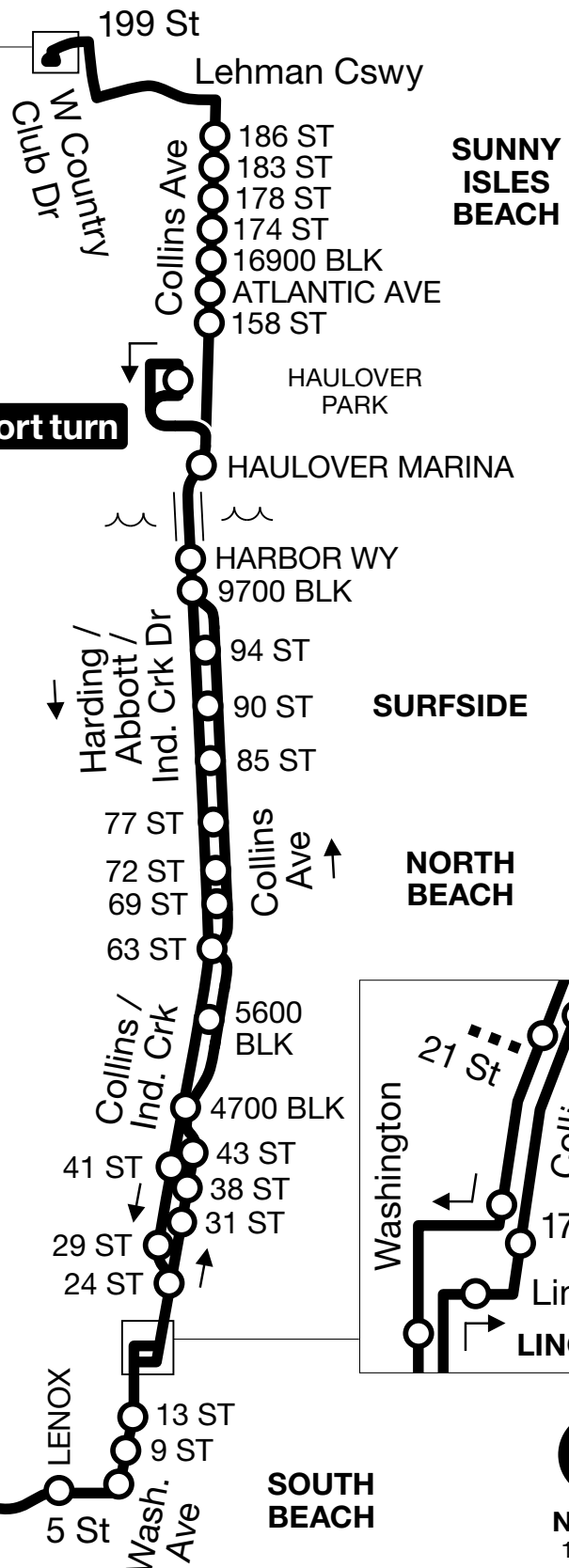

NORTH  
12/2016



# Routes Schedule



[\(https://facebook.com/GoMiamiDade/](https://facebook.com/GoMiamiDade/)



[\) \(https://twitter.com/gomiamidade \)](https://twitter.com/gomiamidade)



[\(https://www.instagram.com/gomiamidade/](https://www.instagram.com/gomiamidade/)

)



## 120 (Northbound) WEEKDAY

NW 1 St & 2 Ave	Omni Terminal / Arsht Metromover	Lincoln Rd & James Ave	COLLINS AV & 43 ST	COLLINS AVE & 69 ST	COLLINS AV & # 9701	HAULOVER CLUB PARKING LOT	COLLINS AVE & ATLANTIC AVE	Bus Terminal at Aventura Mall
05:00AM	05:10AM	05:26AM	05:33AM	05:40AM	05:47AM	-	05:53AM	05:59AM
05:45AM	05:55AM	06:12AM	06:20AM	06:28AM	06:36AM	-	06:42AM	06:50AM
06:15AM	06:26AM	06:43AM	06:51AM	06:59AM	07:08AM	07:13AM	-	-
06:45AM	06:56AM	07:14AM	07:22AM	07:31AM	07:40AM	-	07:47AM	07:59AM
07:00AM	07:15AM	07:33AM	07:41AM	07:50AM	07:59AM	08:04AM	-	-
07:12AM	07:27AM	07:45AM	07:53AM	08:03AM	08:12AM	-	08:20AM	08:32AM
07:23AM	07:38AM	07:56AM	08:05AM	08:15AM	08:25AM	08:30AM	-	-
07:29AM	07:44AM	08:04AM	08:13AM	08:23AM	08:32AM	-	08:40AM	08:52AM
07:35AM	07:50AM	08:10AM	08:19AM	08:29AM	08:38AM	-	08:46AM	08:58AM
07:46AM	08:04AM	08:24AM	08:33AM	08:43AM	08:53AM	08:58AM	-	-
08:00AM	08:18AM	08:38AM	08:47AM	08:57AM	09:07AM	-	09:15AM	09:27AM
08:11AM	08:29AM	08:49AM	08:58AM	09:08AM	09:18AM	09:23AM	-	-
08:23AM	08:41AM	09:03AM	09:13AM	09:23AM	09:33AM	-	09:41AM	09:53AM
08:36AM	08:54AM	09:16AM	09:26AM	09:36AM	09:46AM	09:51AM	-	-
08:47AM	09:05AM	09:27AM	09:37AM	09:47AM	09:57AM	-	10:05AM	10:17AM
09:00AM	09:18AM	09:40AM	09:50AM	10:00AM	10:10AM	10:15AM	-	-
09:12AM	09:30AM	09:52AM	10:02AM	10:12AM	10:22AM	-	10:30AM	10:42AM
09:24AM	09:42AM	10:04AM	10:14AM	10:24AM	10:34AM	10:39AM	-	-
09:36AM	09:54AM	10:16AM	10:26AM	10:36AM	10:46AM	-	10:54AM	11:06AM

09:48AM	10:06AM	10:28AM	10:38AM	10:48AM	10:58AM	11:03AM	-	-
10:00AM	10:18AM	10:40AM	10:50AM	11:00AM	11:10AM	-	11:18AM	11:30AM
10:12AM	10:30AM	10:52AM	11:02AM	11:12AM	11:22AM	11:27AM	-	-
10:24AM	10:42AM	11:04AM	11:14AM	11:24AM	11:34AM	-	11:42AM	11:54AM
10:36AM	10:54AM	11:16AM	11:26AM	11:36AM	11:46AM	11:51AM	-	-
10:48AM	11:06AM	11:28AM	11:38AM	11:48AM	11:58AM	-	12:06PM	12:18PM
11:00AM	11:18AM	11:40AM	11:50AM	12:00PM	12:10PM	12:15PM	-	-
11:12AM	11:30AM	11:52AM	12:02PM	12:12PM	12:22PM	-	12:30PM	12:42PM
11:24AM	11:42AM	12:04PM	12:14PM	12:24PM	12:34PM	12:39PM	-	-
11:36AM	11:54AM	12:16PM	12:26PM	12:36PM	12:46PM	-	12:54PM	01:06PM
11:48AM	12:06PM	12:28PM	12:38PM	12:48PM	12:58PM	01:03PM	-	-
12:00PM	12:18PM	12:40PM	12:50PM	01:00PM	01:10PM	-	01:18PM	01:30PM
12:12PM	12:30PM	12:52PM	01:02PM	01:12PM	01:22PM	01:27PM	-	-
12:24PM	12:42PM	01:04PM	01:14PM	01:24PM	01:34PM	-	01:42PM	01:54PM
12:36PM	12:54PM	01:16PM	01:26PM	01:36PM	01:46PM	01:51PM	-	-
12:48PM	01:06PM	01:28PM	01:38PM	01:48PM	01:58PM	-	02:06PM	02:18PM
01:00PM	01:18PM	01:40PM	01:50PM	02:00PM	02:10PM	02:15PM	-	-
01:12PM	01:30PM	01:52PM	02:02PM	02:12PM	02:22PM	-	02:30PM	02:42PM
01:24PM	01:42PM	02:04PM	02:14PM	02:24PM	02:34PM	02:39PM	-	-
01:36PM	01:54PM	02:16PM	02:26PM	02:36PM	02:46PM	-	02:54PM	03:07PM
01:48PM	02:06PM	02:28PM	02:38PM	02:48PM	02:58PM	03:03PM	-	-
02:00PM	02:18PM	02:40PM	02:50PM	03:01PM	03:11PM	-	03:19PM	03:32PM
02:12PM	02:30PM	02:52PM	03:02PM	03:13PM	03:23PM	03:28PM	-	-
02:24PM	02:42PM	03:04PM	03:14PM	03:25PM	03:35PM	-	03:43PM	03:56PM
02:36PM	02:54PM	03:16PM	03:26PM	03:37PM	03:47PM	03:52PM	-	-
02:48PM	03:07PM	03:29PM	03:39PM	03:50PM	04:00PM	-	04:08PM	04:21PM
02:59PM	03:18PM	03:40PM	03:50PM	04:01PM	04:11PM	04:16PM	-	-
03:12PM	03:31PM	03:53PM	04:03PM	04:14PM	04:24PM	-	04:32PM	04:45PM
03:24PM	03:43PM	04:05PM	04:15PM	04:26PM	04:36PM	04:41PM	-	-
03:36PM	03:55PM	04:17PM	04:27PM	04:38PM	04:48PM	-	04:56PM	05:09PM
03:48PM	04:07PM	04:29PM	04:39PM	04:50PM	05:00PM	05:05PM	-	-
04:00PM	04:19PM	04:41PM	04:51PM	05:02PM	05:12PM	-	05:20PM	05:33PM
04:12PM	04:31PM	04:53PM	05:03PM	05:14PM	05:24PM	05:29PM	-	-
04:24PM	04:43PM	05:05PM	05:15PM	05:26PM	05:36PM	-	05:44PM	05:57PM
04:36PM	04:55PM	05:17PM	05:27PM	05:38PM	05:48PM	05:53PM	-	-
04:48PM	05:07PM	05:29PM	05:39PM	05:50PM	06:00PM	-	06:08PM	06:21PM
05:00PM	05:19PM	05:41PM	05:51PM	06:02PM	06:12PM	06:17PM	-	-



05:12PM	05:31PM	05:53PM	06:03PM	06:14PM	06:24PM	-	06:32PM	06:45PM
05:24PM	05:43PM	06:05PM	06:15PM	06:26PM	06:36PM	06:41PM	-	-
05:36PM	05:55PM	06:17PM	06:27PM	06:38PM	06:48PM	-	06:56PM	07:09PM
05:48PM	06:07PM	06:29PM	06:39PM	06:50PM	07:00PM	07:05PM	-	-
06:00PM	06:19PM	06:41PM	06:51PM	07:02PM	07:10PM	-	07:17PM	07:28PM
06:12PM	06:31PM	06:53PM	07:03PM	07:12PM	07:20PM	-	07:27PM	07:38PM
06:24PM	06:43PM	07:05PM	07:15PM	07:24PM	07:32PM	07:37PM	-	-
06:36PM	06:55PM	07:17PM	07:27PM	07:36PM	07:44PM	-	07:51PM	08:02PM
07:00PM	07:13PM	07:33PM	07:43PM	07:52PM	08:00PM	-	08:07PM	08:18PM
07:30PM	07:43PM	08:03PM	08:13PM	08:22PM	08:30PM	-	08:37PM	08:48PM
08:00PM	08:13PM	08:33PM	08:43PM	08:52PM	09:00PM	-	09:07PM	09:18PM
08:30PM	08:43PM	09:03PM	09:13PM	09:22PM	09:30PM	-	09:37PM	09:48PM
09:00PM	09:13PM	09:33PM	09:43PM	09:52PM	10:00PM	-	10:06PM	10:16PM
09:30PM	09:43PM	10:03PM	10:12PM	10:20PM	10:28PM	10:32PM	-	-

[Back to previous page \(javascript: history.go\(-1\) \)](#)

Page Last Edited: Mon Jan 30, 2017 2:39:07 PM



# Routes Schedule



[\(https://facebook.com/GoMiamiDade/](https://facebook.com/GoMiamiDade/)



[\) \(https://twitter.com/gomiamidade \)](https://twitter.com/gomiamidade)



[\(https://www.instagram.com/gomiamidade/](https://www.instagram.com/gomiamidade/)

)



## 120 (Southbound) WEEKDAY

Bus Terminal at Aventura Mall	COLLINS AV & ATLANTIC AV	HAUOVER CLUB PARKING LOT	BAL HARBOUR SHOPS	ABBOTT AVE & 69 ST MIAMI BEACH	INDIAN CREEK DR & 40 ST	Washington Ave & Lincoln Rd	Omni Terminal / Arsht Metromover	NW 1 St & 2 Ave
-	-	06:00AM	06:05AM	06:14AM	06:23AM	06:31AM	06:46AM	06:56AM
06:00AM	06:13AM	-	06:19AM	06:28AM	06:37AM	06:45AM	07:02AM	07:13AM
06:22AM	06:35AM	-	06:41AM	06:50AM	06:59AM	07:08AM	07:25AM	07:36AM
-	-	06:26AM	06:31AM	06:40AM	06:49AM	06:57AM	07:14AM	07:25AM
06:42AM	06:55AM	-	07:02AM	07:14AM	07:24AM	07:33AM	07:50AM	08:01AM
-	-	06:46AM	06:51AM	07:03AM	07:13AM	07:22AM	07:39AM	07:50AM
07:03AM	07:18AM	-	07:25AM	07:37AM	07:47AM	07:56AM	08:15AM	08:26AM
-	-	07:05AM	07:12AM	07:24AM	07:34AM	07:43AM	08:02AM	08:13AM
07:23AM	07:38AM	-	07:45AM	08:00AM	08:11AM	08:20AM	08:39AM	08:50AM
-	-	07:29AM	07:36AM	07:48AM	07:58AM	08:07AM	08:26AM	08:37AM
07:34AM	07:49AM	-	07:56AM	08:11AM	08:22AM	08:31AM	08:50AM	09:02AM
07:43AM	08:00AM	-	08:07AM	08:22AM	08:33AM	08:42AM	09:02AM	09:14AM
08:06AM	08:23AM	-	08:30AM	08:45AM	08:56AM	09:06AM	09:26AM	09:38AM
-	-	08:12AM	08:19AM	08:34AM	08:45AM	08:54AM	09:14AM	09:26AM
08:28AM	08:45AM	-	08:52AM	09:07AM	09:20AM	09:30AM	09:50AM	10:02AM
-	-	08:33AM	08:40AM	08:55AM	09:08AM	09:18AM	09:38AM	09:50AM
08:56AM	09:13AM	-	09:20AM	09:31AM	09:44AM	09:54AM	10:14AM	10:26AM
-	-	09:01AM	09:08AM	09:19AM	09:32AM	09:42AM	10:02AM	10:14AM
09:20AM	09:37AM	-	09:44AM	09:55AM	10:08AM	10:18AM	10:38AM	10:50AM

-	-	09:25AM	09:32AM	09:43AM	09:56AM	10:06AM	10:26AM	10:38AM
09:44AM	10:01AM	-	10:08AM	10:19AM	10:32AM	10:42AM	11:02AM	11:14AM
-	-	09:49AM	09:56AM	10:07AM	10:20AM	10:30AM	10:50AM	11:02AM
10:08AM	10:25AM	-	10:32AM	10:43AM	10:56AM	11:06AM	11:26AM	11:38AM
-	-	10:13AM	10:20AM	10:31AM	10:44AM	10:54AM	11:14AM	11:26AM
10:32AM	10:49AM	-	10:56AM	11:07AM	11:20AM	11:30AM	11:50AM	12:02PM
-	-	10:37AM	10:44AM	10:55AM	11:08AM	11:18AM	11:38AM	11:50AM
10:56AM	11:13AM	-	11:20AM	11:31AM	11:44AM	11:54AM	12:14PM	12:26PM
-	-	11:01AM	11:08AM	11:19AM	11:32AM	11:42AM	12:02PM	12:14PM
11:20AM	11:37AM	-	11:44AM	11:55AM	12:08PM	12:18PM	12:38PM	12:50PM
-	-	11:25AM	11:32AM	11:43AM	11:56AM	12:06PM	12:26PM	12:38PM
11:44AM	12:01PM	-	12:08PM	12:19PM	12:32PM	12:42PM	01:02PM	01:14PM
-	-	11:49AM	11:56AM	12:07PM	12:20PM	12:30PM	12:50PM	01:02PM
12:08PM	12:25PM	-	12:32PM	12:43PM	12:56PM	01:06PM	01:26PM	01:38PM
-	-	12:13PM	12:20PM	12:31PM	12:44PM	12:54PM	01:14PM	01:26PM
12:32PM	12:49PM	-	12:56PM	01:07PM	01:20PM	01:30PM	01:50PM	02:02PM
-	-	12:37PM	12:44PM	12:55PM	01:08PM	01:18PM	01:38PM	01:50PM
12:56PM	01:13PM	-	01:20PM	01:31PM	01:44PM	01:54PM	02:14PM	02:26PM
-	-	01:01PM	01:08PM	01:19PM	01:32PM	01:42PM	02:02PM	02:14PM
01:19PM	01:36PM	-	01:43PM	01:54PM	02:07PM	02:17PM	02:37PM	02:49PM
-	-	01:25PM	01:32PM	01:43PM	01:56PM	02:06PM	02:26PM	02:38PM
01:44PM	02:01PM	-	02:08PM	02:19PM	02:32PM	02:42PM	03:02PM	03:14PM
-	-	01:49PM	01:56PM	02:07PM	02:20PM	02:30PM	02:50PM	03:02PM
02:08PM	02:25PM	-	02:32PM	02:43PM	02:56PM	03:06PM	03:26PM	03:38PM
-	-	02:13PM	02:20PM	02:31PM	02:44PM	02:54PM	03:14PM	03:26PM
02:31PM	02:48PM	-	02:55PM	03:06PM	03:19PM	03:29PM	03:49PM	04:02PM
-	-	02:37PM	02:44PM	02:55PM	03:08PM	03:18PM	03:38PM	03:50PM
02:51PM	03:08PM	-	03:15PM	03:26PM	03:39PM	03:49PM	04:13PM	04:26PM
-	-	02:56PM	03:03PM	03:14PM	03:27PM	03:37PM	04:01PM	04:14PM
03:15PM	03:32PM	-	03:39PM	03:50PM	04:03PM	04:13PM	04:37PM	04:50PM
-	-	03:20PM	03:27PM	03:38PM	03:51PM	04:01PM	04:25PM	04:38PM
03:38PM	03:55PM	-	04:03PM	04:14PM	04:27PM	04:37PM	05:01PM	05:14PM
-	-	03:44PM	03:51PM	04:02PM	04:15PM	04:25PM	04:49PM	05:02PM
04:00PM	04:19PM	-	04:27PM	04:38PM	04:51PM	05:01PM	05:25PM	05:38PM
-	-	04:08PM	04:15PM	04:26PM	04:39PM	04:49PM	05:13PM	05:26PM
04:24PM	04:43PM	-	04:51PM	05:02PM	05:15PM	05:25PM	05:49PM	06:02PM
-	-	04:32PM	04:39PM	04:50PM	05:03PM	05:13PM	05:37PM	05:50PM



04:50PM	05:09PM	-	05:17PM	05:28PM	05:41PM	05:51PM	06:15PM	06:26PM
-	-	04:58PM	05:05PM	05:16PM	05:29PM	05:39PM	06:03PM	06:14PM
05:22PM	05:41PM	-	05:49PM	06:00PM	06:10PM	06:20PM	06:39PM	06:50PM
-	-	05:27PM	05:34PM	05:45PM	05:58PM	06:08PM	06:27PM	06:38PM
05:56PM	06:15PM	-	06:22PM	06:32PM	06:42PM	06:52PM	07:11PM	07:22PM
-	-	06:00PM	06:09PM	06:19PM	06:29PM	06:39PM	06:58PM	07:09PM
06:27PM	06:43PM	-	06:50PM	07:00PM	07:10PM	07:20PM	07:39PM	07:50PM
06:57PM	07:13PM	-	07:20PM	07:30PM	07:40PM	07:50PM	08:09PM	08:20PM
07:27PM	07:43PM	-	07:50PM	08:00PM	08:10PM	08:20PM	08:39PM	08:50PM
07:57PM	08:13PM	-	08:20PM	08:30PM	08:40PM	08:50PM	09:09PM	09:20PM
08:27PM	08:43PM	-	08:50PM	09:00PM	09:10PM	09:20PM	09:39PM	09:50PM
08:58PM	09:14PM	-	09:21PM	09:31PM	09:41PM	09:51PM	10:10PM	10:20PM
09:32PM	09:48PM	-	09:55PM	10:05PM	10:14PM	10:23PM	10:40PM	10:50PM
10:01PM	10:15PM	-	10:21PM	10:30PM	10:39PM	10:48PM	11:05PM	11:15PM
10:31PM	10:45PM	-	10:51PM	11:00PM	11:09PM	11:18PM	11:35PM	11:45PM

[Back to previous page \(javascript: history.go\(-1\) \)](#)

Page Last Edited: Mon Jan 30, 2017 2:39:07 PM



# South Beach Local

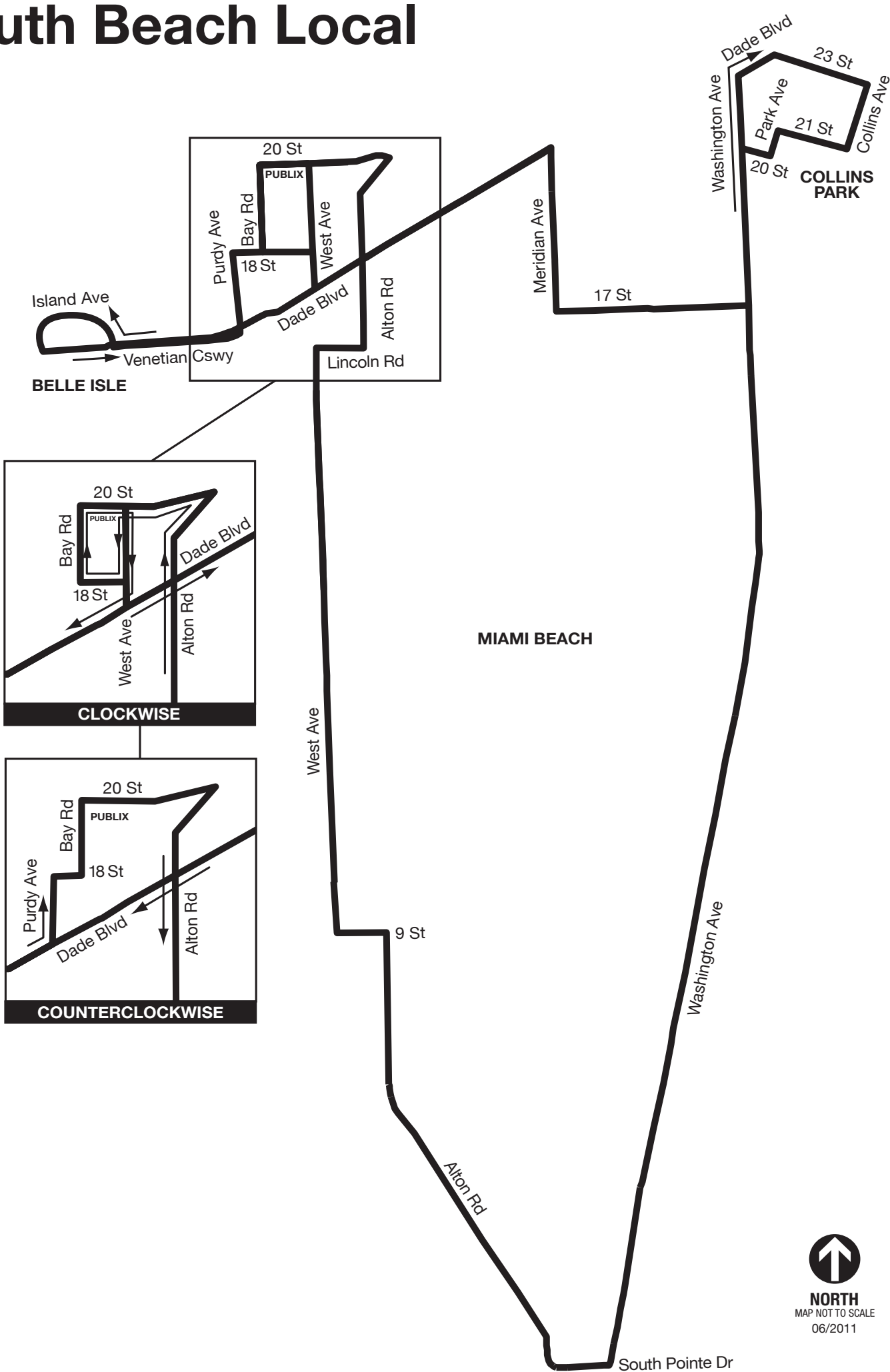

# Routes Schedule



[\(https://facebook.com/GoMiamiDade/](https://facebook.com/GoMiamiDade/)



[\) \(https://twitter.com/gomiamidade \)](https://twitter.com/gomiamidade)



[\(https://www.instagram.com/gomiamidade/](https://www.instagram.com/gomiamidade/)

)



123 (Clockwise) WEEKDAY

WEST AVE & 20 ST MIAMI BEACH	VENETIAN WAY & E ISLAND AVE	23 ST & LIBERTY AVE	Washington Ave & Lincoln Rd	Washington Ave & 5 St	ALTON RD & 2 ST	WEST AVE & 15 TERR	WEST AVE & 20 ST MIAMI BEACH
07:50AM	07:53AM	08:06AM	08:12AM	08:21AM	08:25AM	08:33AM	08:39AM
08:20AM	08:24AM	08:37AM	08:43AM	08:52AM	08:56AM	09:04AM	09:10AM
08:40AM	08:44AM	08:57AM	09:03AM	09:12AM	09:16AM	09:24AM	09:30AM
09:00AM	09:04AM	09:17AM	09:23AM	09:32AM	09:36AM	09:44AM	09:50AM
09:20AM	09:24AM	09:37AM	09:43AM	09:52AM	09:56AM	10:05AM	10:12AM
09:40AM	09:44AM	09:57AM	10:04AM	10:14AM	10:18AM	10:27AM	10:34AM
10:00AM	10:04AM	10:17AM	10:24AM	10:34AM	10:38AM	10:47AM	10:54AM
10:13AM	10:17AM	10:30AM	10:37AM	10:47AM	10:51AM	11:00AM	11:07AM
10:26AM	10:30AM	10:43AM	10:50AM	11:00AM	11:04AM	11:13AM	11:20AM
10:39AM	10:43AM	10:56AM	11:03AM	11:13AM	11:17AM	11:26AM	11:33AM
10:52AM	10:56AM	11:09AM	11:16AM	11:26AM	11:30AM	11:39AM	11:46AM
11:05AM	11:09AM	11:22AM	11:29AM	11:39AM	11:43AM	11:52AM	11:59AM
11:18AM	11:22AM	11:35AM	11:42AM	11:52AM	11:56AM	12:05PM	12:12PM
11:31AM	11:35AM	11:48AM	11:55AM	12:05PM	12:09PM	12:18PM	12:25PM
11:44AM	11:48AM	12:01PM	12:08PM	12:18PM	12:22PM	12:31PM	12:38PM
11:57AM	12:01PM	12:14PM	12:21PM	12:31PM	12:35PM	12:44PM	12:51PM
12:10PM	12:14PM	12:27PM	12:34PM	12:44PM	12:48PM	12:57PM	01:04PM
12:23PM	12:27PM	12:40PM	12:47PM	12:57PM	01:01PM	01:10PM	01:17PM
12:36PM	12:40PM	12:53PM	01:00PM	01:10PM	01:14PM	01:23PM	01:30PM



12:49PM	12:53PM	01:07PM	01:14PM	01:24PM	01:28PM	01:37PM	01:44PM
01:02PM	01:06PM	01:20PM	01:27PM	01:37PM	01:41PM	01:50PM	01:57PM
01:15PM	01:19PM	01:33PM	01:40PM	01:50PM	01:54PM	02:03PM	02:10PM
01:28PM	01:32PM	01:46PM	01:53PM	02:03PM	02:07PM	02:16PM	02:23PM
01:41PM	01:45PM	01:59PM	02:06PM	02:16PM	02:20PM	02:29PM	02:36PM
01:59PM	02:03PM	02:17PM	02:24PM	02:34PM	02:38PM	02:47PM	02:54PM
02:12PM	02:16PM	02:30PM	02:37PM	02:47PM	02:51PM	03:00PM	03:07PM
02:25PM	02:29PM	02:43PM	02:50PM	03:00PM	03:04PM	03:13PM	03:20PM
02:38PM	02:42PM	02:56PM	03:03PM	03:13PM	03:17PM	03:26PM	03:33PM
02:51PM	02:55PM	03:09PM	03:16PM	03:26PM	03:30PM	03:39PM	03:46PM
03:09PM	03:13PM	03:27PM	03:34PM	03:44PM	03:48PM	03:57PM	04:04PM
03:22PM	03:26PM	03:40PM	03:47PM	03:57PM	04:01PM	04:10PM	04:17PM
03:35PM	03:39PM	03:53PM	04:00PM	04:11PM	04:15PM	04:24PM	04:31PM
03:48PM	03:52PM	04:06PM	04:13PM	04:24PM	04:28PM	04:37PM	04:44PM
04:01PM	04:05PM	04:19PM	04:26PM	04:37PM	04:41PM	04:50PM	04:57PM
04:14PM	04:18PM	04:32PM	04:39PM	04:50PM	04:54PM	05:03PM	05:10PM
04:27PM	04:31PM	04:45PM	04:52PM	05:03PM	05:07PM	05:16PM	05:23PM
04:40PM	04:44PM	04:58PM	05:05PM	05:16PM	05:20PM	05:29PM	05:36PM
04:53PM	04:57PM	05:11PM	05:18PM	05:29PM	05:33PM	05:42PM	05:49PM
05:06PM	05:10PM	05:24PM	05:31PM	05:42PM	05:46PM	05:55PM	06:02PM
05:19PM	05:23PM	05:37PM	05:44PM	05:55PM	05:59PM	06:08PM	06:14PM
05:32PM	05:36PM	05:50PM	05:57PM	06:08PM	06:12PM	06:20PM	06:26PM
05:45PM	05:49PM	06:03PM	06:09PM	06:19PM	06:23PM	06:31PM	06:37PM
05:58PM	06:02PM	06:15PM	06:21PM	06:31PM	06:35PM	06:43PM	06:49PM
06:11PM	06:15PM	06:28PM	06:34PM	06:44PM	06:48PM	06:56PM	07:02PM
06:30PM	06:34PM	06:47PM	06:53PM	07:03PM	07:07PM	07:15PM	07:21PM
06:50PM	06:54PM	07:07PM	07:13PM	07:23PM	07:27PM	07:35PM	07:41PM
07:10PM	07:14PM	07:27PM	07:33PM	07:43PM	07:47PM	07:55PM	08:01PM
07:30PM	07:34PM	07:47PM	07:53PM	08:04PM	08:08PM	08:16PM	08:21PM
07:50PM	07:54PM	08:07PM	08:12PM	08:23PM	08:27PM	08:35PM	08:40PM
08:10PM	08:14PM	08:26PM	08:31PM	08:42PM	08:46PM	08:54PM	08:59PM
08:30PM	08:34PM	08:46PM	08:51PM	09:02PM	09:06PM	09:14PM	09:19PM
08:50PM	08:54PM	09:06PM	09:11PM	09:22PM	09:26PM	09:34PM	09:39PM
09:10PM	09:14PM	09:26PM	09:31PM	09:42PM	09:46PM	09:54PM	09:59PM
09:30PM	09:34PM	09:46PM	09:51PM	10:02PM	10:06PM	10:14PM	10:19PM
09:50PM	09:54PM	10:06PM	10:11PM	10:22PM	10:26PM	10:34PM	10:39PM
10:10PM	10:14PM	10:26PM	10:31PM	10:42PM	10:46PM	10:54PM	10:59PM

10:30PM	10:34PM	10:46PM	10:51PM	11:02PM	11:06PM	11:14PM	11:19PM
10:50PM	10:54PM	11:06PM	11:11PM	11:22PM	11:26PM	11:34PM	11:39PM
11:10PM	11:14PM	11:26PM	11:31PM	11:42PM	11:46PM	11:54PM	11:59PM
11:30PM	11:34PM	11:46PM	11:51PM	12:02AM	12:06AM	12:14AM	12:19AM
11:50PM	11:54PM	12:06AM	12:11AM	12:22AM	12:26AM	12:34AM	12:39AM

[Back to previous page \(javascript: history.go\(-1\) \)](#)

Page Last Edited: Mon Jan 30, 2017 2:39:07 PM



# Routes Schedule



[\(https://facebook.com/GoMiamiDade/](https://facebook.com/GoMiamiDade/)



[\) \(https://twitter.com/gomiamidade \)](https://twitter.com/gomiamidade)



[\(https://www.instagram.com/gomiamidade/](https://www.instagram.com/gomiamidade/)

)



123 (CntClockwise) WEEKDAY

BAY RD & 20 ST	WEST AVE & 15 TERR MIAMI BEACH	ALTON RD & 2 ST MIAMI BEACH	Washington Ave & 5 St	WASHINGTON AVE & LINCOLN RD	23 ST & LIBERTY AVE	VENETIAN WAY & E ISLAND AVE	BAY RD & 20 ST
07:40AM	07:44AM	07:51AM	07:55AM	08:06AM	08:10AM	08:23AM	08:26AM
08:10AM	08:14AM	08:22AM	08:26AM	08:37AM	08:41AM	08:54AM	08:57AM
08:30AM	08:34AM	08:42AM	08:46AM	08:57AM	09:01AM	09:14AM	09:17AM
08:50AM	08:54AM	09:02AM	09:06AM	09:17AM	09:21AM	09:34AM	09:37AM
09:10AM	09:14AM	09:22AM	09:26AM	09:37AM	09:41AM	09:54AM	09:57AM
09:30AM	09:34AM	09:42AM	09:46AM	09:57AM	10:02AM	10:15AM	10:18AM
09:50AM	09:54AM	10:03AM	10:08AM	10:20AM	10:25AM	10:38AM	10:41AM
10:06AM	10:11AM	10:20AM	10:25AM	10:37AM	10:42AM	10:55AM	10:58AM
10:19AM	10:24AM	10:33AM	10:38AM	10:50AM	10:55AM	11:08AM	11:11AM
10:32AM	10:37AM	10:46AM	10:51AM	11:03AM	11:08AM	11:21AM	11:24AM
10:45AM	10:50AM	10:59AM	11:04AM	11:16AM	11:21AM	11:34AM	11:37AM
10:58AM	11:03AM	11:12AM	11:17AM	11:29AM	11:34AM	11:47AM	11:50AM
11:11AM	11:16AM	11:25AM	11:30AM	11:42AM	11:47AM	12:00PM	12:03PM
11:24AM	11:29AM	11:38AM	11:43AM	11:55AM	12:00PM	12:13PM	12:16PM
11:37AM	11:42AM	11:51AM	11:56AM	12:08PM	12:13PM	12:26PM	12:29PM
11:50AM	11:55AM	12:04PM	12:09PM	12:21PM	12:26PM	12:39PM	12:42PM
12:03PM	12:08PM	12:17PM	12:22PM	12:34PM	12:39PM	12:52PM	12:55PM
12:16PM	12:21PM	12:30PM	12:35PM	12:47PM	12:52PM	01:05PM	01:08PM
12:29PM	12:34PM	12:43PM	12:48PM	01:01PM	01:06PM	01:19PM	01:22PM

12:42PM	12:47PM	12:56PM	01:01PM	01:14PM	01:19PM	01:32PM	01:35PM
12:55PM	01:01PM	01:10PM	01:15PM	01:28PM	01:33PM	01:46PM	01:49PM
01:08PM	01:14PM	01:23PM	01:28PM	01:41PM	01:46PM	01:59PM	02:02PM
01:21PM	01:27PM	01:36PM	01:41PM	01:54PM	01:59PM	02:12PM	02:15PM
01:34PM	01:40PM	01:49PM	01:54PM	02:07PM	02:12PM	02:25PM	02:28PM
01:52PM	01:58PM	02:07PM	02:12PM	02:25PM	02:30PM	02:43PM	02:46PM
02:05PM	02:11PM	02:20PM	02:25PM	02:38PM	02:43PM	02:56PM	02:59PM
02:18PM	02:24PM	02:33PM	02:38PM	02:51PM	02:56PM	03:09PM	03:12PM
02:31PM	02:37PM	02:46PM	02:51PM	03:04PM	03:09PM	03:22PM	03:25PM
02:44PM	02:50PM	02:59PM	03:04PM	03:17PM	03:22PM	03:35PM	03:38PM
03:02PM	03:08PM	03:17PM	03:22PM	03:35PM	03:40PM	03:53PM	03:56PM
03:15PM	03:21PM	03:30PM	03:35PM	03:48PM	03:53PM	04:07PM	04:10PM
03:28PM	03:34PM	03:43PM	03:48PM	04:01PM	04:06PM	04:20PM	04:23PM
03:41PM	03:47PM	03:56PM	04:01PM	04:14PM	04:19PM	04:33PM	04:36PM
03:54PM	04:00PM	04:09PM	04:14PM	04:27PM	04:32PM	04:46PM	04:49PM
04:07PM	04:13PM	04:22PM	04:27PM	04:40PM	04:45PM	04:59PM	05:02PM
04:20PM	04:26PM	04:35PM	04:40PM	04:53PM	04:58PM	05:12PM	05:15PM
04:33PM	04:39PM	04:48PM	04:53PM	05:06PM	05:11PM	05:25PM	05:28PM
04:46PM	04:52PM	05:01PM	05:06PM	05:19PM	05:24PM	05:38PM	05:41PM
04:59PM	05:05PM	05:14PM	05:19PM	05:32PM	05:37PM	05:51PM	05:54PM
05:12PM	05:18PM	05:27PM	05:32PM	05:45PM	05:50PM	06:04PM	06:07PM
05:25PM	05:31PM	05:40PM	05:45PM	05:58PM	06:03PM	06:16PM	06:19PM
05:38PM	05:44PM	05:53PM	05:58PM	06:11PM	06:15PM	06:28PM	06:31PM
05:51PM	05:57PM	06:06PM	06:11PM	06:22PM	06:26PM	06:39PM	06:42PM
06:04PM	06:09PM	06:17PM	06:22PM	06:33PM	06:37PM	06:50PM	06:53PM
06:20PM	06:25PM	06:33PM	06:38PM	06:49PM	06:53PM	07:06PM	07:09PM
06:40PM	06:45PM	06:53PM	06:58PM	07:09PM	07:13PM	07:26PM	07:29PM
07:00PM	07:05PM	07:13PM	07:18PM	07:29PM	07:33PM	07:46PM	07:49PM
07:20PM	07:25PM	07:33PM	07:38PM	07:49PM	07:53PM	08:06PM	08:09PM
07:40PM	07:45PM	07:53PM	07:58PM	08:09PM	08:13PM	08:26PM	08:29PM
08:00PM	08:04PM	08:11PM	08:16PM	08:26PM	08:30PM	08:43PM	08:46PM
08:20PM	08:24PM	08:31PM	08:36PM	08:46PM	08:50PM	09:03PM	09:06PM
08:40PM	08:44PM	08:51PM	08:56PM	09:06PM	09:10PM	09:23PM	09:26PM
09:00PM	09:04PM	09:11PM	09:16PM	09:26PM	09:30PM	09:43PM	09:46PM
09:20PM	09:24PM	09:31PM	09:36PM	09:46PM	09:50PM	10:03PM	10:06PM
09:40PM	09:44PM	09:51PM	09:56PM	10:06PM	10:10PM	10:23PM	10:26PM
10:00PM	10:04PM	10:11PM	10:16PM	10:26PM	10:30PM	10:43PM	10:46PM



10:20PM	10:24PM	10:31PM	10:36PM	10:46PM	10:50PM	11:03PM	11:06PM
10:40PM	10:44PM	10:51PM	10:56PM	11:06PM	11:10PM	11:23PM	11:26PM
11:00PM	11:04PM	11:11PM	11:16PM	11:26PM	11:30PM	11:43PM	11:46PM
11:20PM	11:24PM	11:31PM	11:36PM	11:46PM	11:50PM	12:03AM	12:06AM
11:40PM	11:44PM	11:51PM	11:56PM	12:06AM	12:10AM	12:23AM	12:26AM
12:00AM	12:04AM	12:11AM	12:16AM	12:26AM	12:30AM	12:43AM	12:46AM

[Back to previous page \(javascript: history.go\(-1\) \)](#)

Page Last Edited: Mon Jan 30, 2017 2:39:07 PM



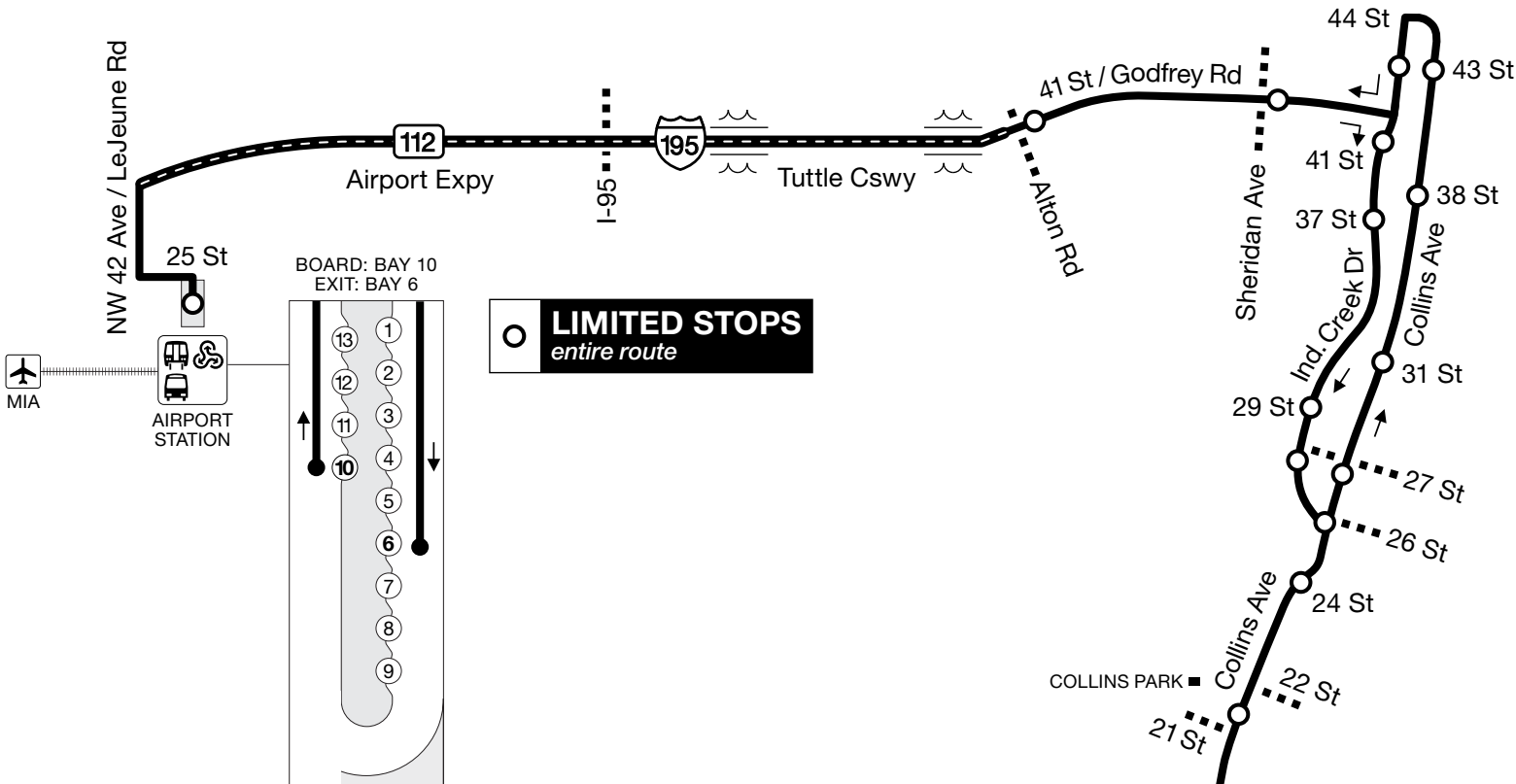

# 150

MIAMI BEACH  
AIRPORT EXPRESS

**BUS SERVICE  
EVERY 20  
MINUTES**

SERVICIO DE AUTOBUSES  
CADA 20 MINUTOS  
SEVIS BIS CHAK 20 MINIT

## SCHEDULE HORARIO • ORÈ

<b>EASTBOUND</b> RUMBO ESTE DIREKSYON IS	<b>FROM</b> DESDE • DE	<b>UNTIL</b> HASTA • A
MIA METRORAIL STATION	6:00 a.m.	11:40 p.m.
41 ST & ALTON RD	6:14 a.m.	11:52 p.m.
41 ST & INDIAN CREEK	6:20 a.m.	11:57 p.m.
LINCOLN RD & WASHINGTON AVE	6:29 a.m.	12:06 a.m.
SOUTH POINTE DR & WASHINGTON AVE	6:39 a.m.	12:16 a.m.

<b>WESTBOUND</b> RUMBO OESTE DIREKSYON WES	<b>FROM</b> DESDE • DE	<b>UNTIL</b> HASTA • A
SOUTH POINTE DR & WASHINGTON AVE	5:10 a.m.	10:55 p.m.
LINCOLN RD & WASHINGTON AVE	5:20 a.m.	11:05 p.m.
41 ST & INDIAN CREEK	5:29 a.m.	11:14 p.m.
41 ST & ALTON RD	5:33 a.m.	11:18 p.m.
MIA METRORAIL STATION	5:45 a.m.	11:30 p.m.

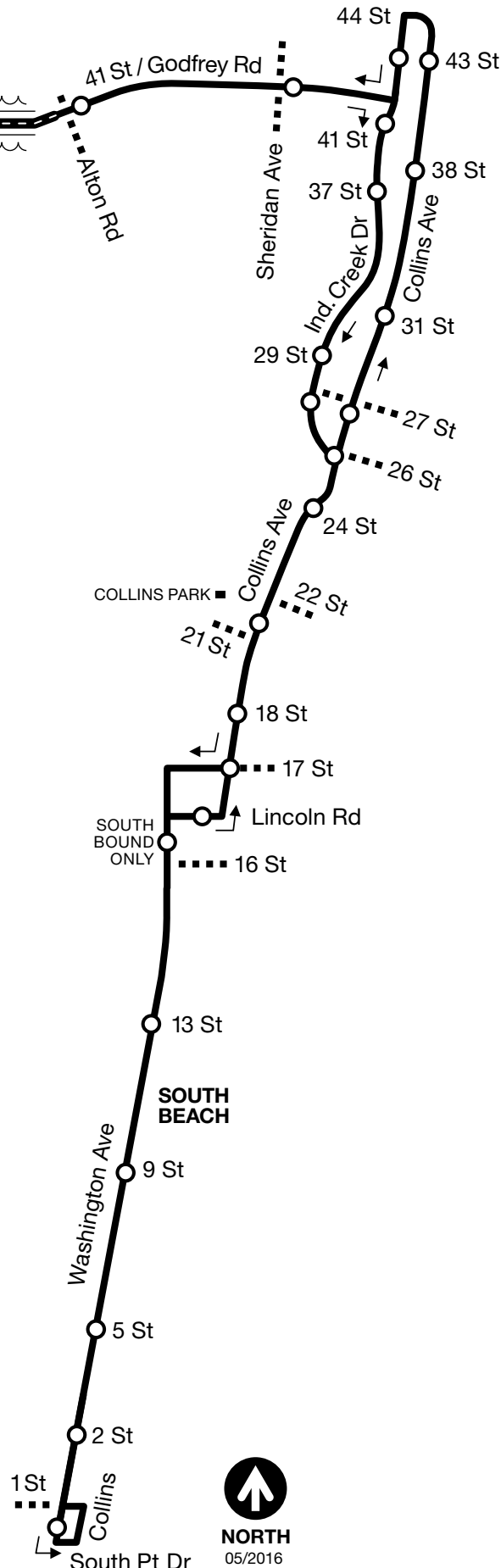

NORTH  
05/2016

[www.miamidade.gov/transit](http://www.miamidade.gov/transit)

**311** (305.468.5900) TDD: 305.468.5402



MiamiDadeTransit



@IRideMDT



@IRideMDT



MDT TRACKER / MDT TRANSIT WATCH



DEPARTMENT OF TRANSPORTATION AND PUBLIC WORKS

# Routes Schedule



[\(https://facebook.com/GoMiamiDade/](https://facebook.com/GoMiamiDade/)



[\) \(https://twitter.com/gomiamidade \)](https://twitter.com/gomiamidade)



[\(https://www.instagram.com/gomiamide](https://www.instagram.com/gomiamidade/)

[\)](https://www.instagram.com/gomiamidade/)



## 150 (Eastbound) WEEKDAY

Airport Station	41 ST & ALTON RD MIAMI BEACH	INDIAN CREEK DR & 40 ST	Washington Ave & Lincoln Rd	WASHINGTON AVE & SOUTH POINTE DR
06:00AM	06:15AM	06:21AM	06:31AM	06:41AM
06:20AM	06:35AM	06:41AM	06:51AM	07:01AM
06:40AM	06:55AM	07:01AM	07:11AM	07:21AM
07:00AM	07:15AM	07:21AM	07:31AM	07:41AM
07:20AM	07:35AM	07:41AM	07:51AM	08:01AM
07:40AM	07:55AM	08:01AM	08:11AM	08:21AM
08:00AM	08:15AM	08:21AM	08:31AM	08:41AM
08:20AM	08:35AM	08:41AM	08:51AM	09:02AM
08:40AM	08:55AM	09:01AM	09:12AM	09:23AM
09:00AM	09:14AM	09:20AM	09:31AM	09:42AM
09:20AM	09:34AM	09:40AM	09:51AM	10:02AM
09:40AM	09:54AM	10:00AM	10:11AM	10:22AM
10:00AM	10:14AM	10:20AM	10:31AM	10:42AM
10:20AM	10:34AM	10:40AM	10:51AM	11:02AM
10:40AM	10:54AM	11:00AM	11:11AM	11:22AM
11:00AM	11:14AM	11:20AM	11:31AM	11:42AM
11:20AM	11:34AM	11:40AM	11:51AM	12:02PM
11:40AM	11:54AM	12:00PM	12:11PM	12:22PM
12:00PM	12:14PM	12:20PM	12:31PM	12:42PM
12:20PM	12:34PM	12:40PM	12:51PM	01:02PM

12:40PM	12:54PM	01:00PM	01:11PM	01:22PM
01:00PM	01:14PM	01:20PM	01:31PM	01:42PM
01:20PM	01:34PM	01:40PM	01:51PM	02:02PM
01:40PM	01:54PM	02:00PM	02:11PM	02:22PM
02:00PM	02:14PM	02:20PM	02:31PM	02:42PM
02:16PM	02:30PM	02:36PM	02:47PM	02:58PM
02:36PM	02:50PM	02:56PM	03:07PM	03:20PM
02:53PM	03:09PM	03:16PM	03:27PM	03:40PM
03:13PM	03:29PM	03:36PM	03:47PM	04:00PM
03:33PM	03:49PM	03:56PM	04:07PM	04:20PM
03:53PM	04:09PM	04:16PM	04:27PM	04:40PM
04:13PM	04:29PM	04:36PM	04:47PM	05:00PM
04:33PM	04:49PM	04:56PM	05:07PM	05:20PM
04:53PM	05:09PM	05:16PM	05:27PM	05:40PM
05:13PM	05:29PM	05:36PM	05:47PM	06:00PM
05:33PM	05:49PM	05:56PM	06:07PM	06:20PM
05:53PM	06:09PM	06:16PM	06:27PM	06:40PM
06:13PM	06:29PM	06:36PM	06:47PM	07:00PM
06:37PM	06:53PM	07:00PM	07:09PM	07:20PM
07:00PM	07:14PM	07:20PM	07:29PM	07:40PM
07:20PM	07:34PM	07:40PM	07:49PM	08:00PM
07:40PM	07:54PM	08:00PM	08:09PM	08:20PM
08:00PM	08:14PM	08:20PM	08:29PM	08:40PM
08:20PM	08:34PM	08:40PM	08:49PM	09:00PM
08:40PM	08:54PM	09:00PM	09:09PM	09:20PM
09:00PM	09:14PM	09:20PM	09:29PM	09:40PM
09:30PM	09:44PM	09:50PM	09:59PM	10:10PM
10:00PM	10:13PM	10:18PM	10:27PM	10:37PM
10:30PM	10:43PM	10:48PM	10:57PM	11:07PM
11:10PM	11:23PM	11:28PM	11:37PM	11:47PM
11:40PM	11:53PM	11:58PM	12:07AM	12:17AM

[Back to previous page \(javascript: history.go\(-1\) \)](javascript: history.go(-1))



# Routes Schedule



[\(https://facebook.com/GoMiamiDade/](https://facebook.com/GoMiamiDade/)



[\) \(https://twitter.com/gomiamidade \)](https://twitter.com/gomiamidade)



[\(https://www.instagram.com/gomiamidade/](https://www.instagram.com/gomiamidade/)

)



## 150 (Westbound) WEEKDAY

WASHINGTON AVE & SOUTH POINTE DR	Lincoln Rd & James Ave	INDIAN CREEK DR & 43 ST	41 ST & ALTON RD MIAMI BEACH	Airport Station
05:10AM	05:20AM	05:29AM	05:33AM	05:45AM
05:30AM	05:40AM	05:49AM	05:53AM	06:07AM
05:50AM	06:01AM	06:11AM	06:16AM	06:30AM
06:10AM	06:21AM	06:31AM	06:36AM	06:50AM
06:30AM	06:41AM	06:51AM	06:56AM	07:10AM
06:50AM	07:01AM	07:11AM	07:16AM	07:30AM
07:10AM	07:21AM	07:31AM	07:36AM	07:50AM
07:30AM	07:41AM	07:51AM	07:56AM	08:10AM
07:50AM	08:01AM	08:11AM	08:16AM	08:30AM
08:10AM	08:21AM	08:31AM	08:36AM	08:50AM
08:30AM	08:41AM	08:51AM	08:56AM	09:11AM
08:50AM	09:02AM	09:15AM	09:20AM	09:35AM
09:10AM	09:22AM	09:35AM	09:40AM	09:55AM
09:30AM	09:42AM	09:55AM	10:00AM	10:15AM
09:50AM	10:02AM	10:15AM	10:20AM	10:35AM
10:10AM	10:22AM	10:35AM	10:40AM	10:55AM
10:30AM	10:42AM	10:55AM	11:00AM	11:15AM
10:50AM	11:02AM	11:15AM	11:20AM	11:35AM
11:10AM	11:22AM	11:35AM	11:40AM	11:55AM
11:30AM	11:42AM	11:55AM	12:00PM	12:15PM

11:50AM	12:02PM	12:15PM	12:20PM	12:35PM
12:10PM	12:22PM	12:35PM	12:40PM	12:55PM
12:30PM	12:42PM	12:55PM	01:00PM	01:15PM
12:50PM	01:02PM	01:15PM	01:20PM	01:35PM
01:10PM	01:22PM	01:35PM	01:40PM	01:55PM
01:30PM	01:42PM	01:55PM	02:00PM	02:15PM
01:50PM	02:02PM	02:15PM	02:20PM	02:35PM
02:10PM	02:22PM	02:35PM	02:40PM	02:55PM
02:30PM	02:42PM	02:55PM	03:01PM	03:20PM
02:50PM	03:04PM	03:17PM	03:23PM	03:42PM
03:10PM	03:24PM	03:37PM	03:43PM	04:02PM
03:30PM	03:44PM	03:57PM	04:03PM	04:22PM
03:50PM	04:04PM	04:17PM	04:23PM	04:42PM
04:10PM	04:24PM	04:37PM	04:43PM	05:02PM
04:30PM	04:44PM	04:57PM	05:03PM	05:22PM
04:50PM	05:04PM	05:17PM	05:23PM	05:42PM
05:10PM	05:24PM	05:37PM	05:43PM	06:02PM
05:30PM	05:44PM	05:57PM	06:03PM	06:22PM
05:50PM	06:04PM	06:17PM	06:23PM	06:42PM
06:10PM	06:24PM	06:37PM	06:43PM	07:02PM
06:30PM	06:44PM	06:57PM	07:03PM	07:17PM
06:50PM	07:04PM	07:14PM	07:19PM	07:33PM
07:10PM	07:22PM	07:32PM	07:37PM	07:51PM
07:30PM	07:42PM	07:52PM	07:57PM	08:11PM
07:50PM	08:02PM	08:12PM	08:17PM	08:31PM
08:10PM	08:22PM	08:32PM	08:37PM	08:51PM
08:30PM	08:42PM	08:52PM	08:57PM	09:11PM
08:50PM	09:02PM	09:12PM	09:17PM	09:31PM
09:20PM	09:32PM	09:42PM	09:47PM	10:01PM
09:50PM	10:02PM	10:11PM	10:15PM	10:27PM
10:20PM	10:30PM	10:39PM	10:43PM	10:55PM
10:55PM	11:05PM	11:14PM	11:18PM	11:30PM

[Back to previous page \(javascript: history.go\(-1\) \)](#)

## **Trip Generation**

## PM PEAK HOUR TRIP GENERATION COMPARISON

### EXISTING WEEKDAY AM PEAK HOUR TRIP GENERATION

ITE TRIP GENERATION CHARACTERISTICS					DIRECTIONAL DISTRIBUTION		GROSS VOLUMES			INTERNAL CAPTURE		EXTERNAL TRIPS			MULTIMODAL REDUCTION		NET NEW EXTERNAL TRIPS				
Land Use		ITE Edition	ITE Code	Scale	ITE Units	Percent		In	Out	Total	Percent	IC Trips	In	Out	Total	Percent	PB Trips	In	Out	Total	
						In	Out														
GROUP 1	1	Specialty Retail Center	9	826	7,476	ksf	50%	50%	0	0	0	0.0%	0	0	0	0	0	0	0	0	
	2	Apartment	9	220	2	du	20%	80%	0	1	1	0.0%	0	0	1	1	0.0%	0	0	1	
	3																				
	4																				
	5																				
	6																				
	7																				
	8																				
	9																				
	10																				
	11																				
	12																				
	13																				
	14																				
	15																				
ITE Land Use Code		Rate or Equation				Total:			1	1		0.0%	0		1	1	10.0%	0	0	1	1
826		Y=0(X)				(1) Note: (1) ITE does not provide trip generation rate nor equation for the A.M. peak period. Therefore, it is assumed that the facility will be closed.															
220		Y=0.51(X)																			

### PROPOSED WEEKDAY AM PEAK HOUR TRIP GENERATION

ITE TRIP GENERATION CHARACTERISTICS					DIRECTIONAL DISTRIBUTION		GROSS VOLUMES			INTERNAL CAPTURE		EXTERNAL TRIPS			MULTIMODAL REDUCTION		NET NEW EXTERNAL TRIPS				
Land Use		ITE Edition	ITE Code	Scale	ITE Units	Percent		In	Out	Total	Percent	IC Trips	In	Out	Total	Percent	PB Trips	In	Out	Total	
						In	Out														
GROUP 2	1	Specialty Retail Center	9	826	14.747	ksf	50%	50%		0	0	0	0.0%	0	0	0	10.0%	0	0	0	0
	2																				
	3																				
	4																				
	5																				
	6																				
	7																				
	8																				
	9																				
	10																				
	11																				
	12																				
	13																				
	14																				
	15																				
ITE Land Use Code		Rate or Equation				Total:					0.0%	0				10.0%	0	0	0	0	
826		Y=0(X) <sup>(1)</sup>				Note: (1) ITE does not provide trip generation rate nor equation for the A.M. peak period. Therefore, it is assumed that the facility will be closed.															

	IN	OUT	TOTAL
NET DIFFERENCE	0	-1	-1



# PM PEAK HOUR TRIP GENERATION COMPARISON

## EXISTING WEEKDAY PM PEAK HOUR TRIP GENERATION

		ITE TRIP GENERATION CHARACTERISTICS					DIRECTIONAL DISTRIBUTION		GROSS VOLUMES			INTERNAL CAPTURE		EXTERNAL TRIPS			MULTIMODAL REDUCTION		NET NEW EXTERNAL TRIPS		
		Land Use	ITE Edition	ITE Code	Scale	ITE Units	Percent		In	Out	Total	Percent	IC Trips	In	Out	Total	Percent	PB Trips	In	Out	Total
							In	Out													
GROUP 1	1	Specialty Retail Center	9	826	7.476	ksf	44%	56%	17	22	39	0.0%	0	17	22	39	10.0%	4	15	20	35
	2	Apartment	9	220	2	du	65%	35%	1	0	1	0.0%	0	1	0	1	10.0%	0	1	0	1
	3																				
	4																				
	5																				
	6																				
	7																				
	8																				
	9																				
	10																				
	11																				
	12																				
	13																				
	14																				
	15																				
		ITE Land Use Code		Rate or Equation		Total:		18	22	40	0.0%	0	18	22	40	10.0%	4	16	20	36	
		826		Y=2.4*(X)+21.48																	
		220		Y=0.62(X)																	

## PROPOSED WEEKDAY PM PEAK HOUR TRIP GENERATION

ITE TRIP GENERATION CHARACTERISTICS					DIRECTIONAL DISTRIBUTION		GROSS VOLUMES			INTERNAL CAPTURE		EXTERNAL TRIPS			MULTIMODAL REDUCTION		NET NEW EXTERNAL TRIPS				
Land Use	ITE Edition	ITE Code	Scale	ITE Units	Percent		In	Out	Total	Percent	IC Trips	In	Out	Total	Percent	PB Trips	In	Out	Total		
					In	Out															
1	Specialty Retail Center	9	826	14.747	ksf	44%	56%	25	32	57	0.0%	0	25	32	57	10.0%	6	22	29	51	
2																					
3																					
4																					
5																					
6																					
7																					
8																					
9																					
10																					
11																					
12																					
13																					
14																					
15																					
ITE Land Use Code					Rate or Equation		Total:		25	32	57	0.0%	0	25	32	57	10.0%	6	22	29	51
826					Y=2.4*(X)+21.48																

		IN	OUT	TOTAL
NET DIFFERENCE		6	9	15

**Attachment D:**  
**Pedestrian Routing**







## Signal Timings

**TOD Schedule Report**  
for 2735: Lenox Av&Lincoln Rd

Print Date:  
1/25/2016

Print Time:  
10:34 AM

<u>Asset</u>	<u>Intersection</u>	<u>TOD Schedule</u>	<u>Op Mode</u>	<u>Plan #</u>	<u>Cycle</u>	<u>Offset</u>	<u>TOD Setting</u>	<u>Active PhaseBank</u>	<u>Active Maximum</u>
2735	Lenox Av&Lincoln Rd	DOW-2		N/A	0	0	N/A	0	Max 0

**Splits**

<u>PH 1</u>	<u>PH 2</u>	<u>PH 3</u>	<u>PH 4</u>	<u>PH 5</u>	<u>PH 6</u>	<u>PH 7</u>	<u>PH 8</u>
-	PED	-	NBT	-	XPD	-	SBT
0	0	0	0	0	0	0	0

N/A



N/A



Active Phase Bank: Phase Bank 1

<u>Phase</u>	<u>Walk</u>	<u>Don't Walk</u>	<u>Min Initial</u>	<u>Veh Ext</u>	<u>Max Limit</u>	<u>Max 2</u>	<u>Yellow</u>	<u>Red</u>
<u>Phase Bank</u>								
	1 2 3	1 2 3	1 2 3	1 2 3	1 2 3	1 2 3		
1 -	0 - 0 - 0	0 - 0 - 0	0 - 0 - 0	0 - 0 - 0	0 - 0 - 0	0 - 0 - 0	0	0
2 PED	7 - 7 - 7	14 - 14 - 14	0 - 0 - 0	0 - 0 - 0	0 - 0 - 0	0 - 0 - 0	0	0
3 -	0 - 0 - 0	0 - 0 - 0	0 - 0 - 0	0 - 0 - 0	0 - 0 - 0	0 - 0 - 0	0	0
4 NBT	0 - 0 - 0	0 - 0 - 0	10 - 7 - 7	2.5 - 2.5 - 2.5	10 - 25 - 25	25 - 0 - 0	4	1
5 -	0 - 0 - 0	0 - 0 - 0	0 - 0 - 0	0 - 0 - 0	0 - 0 - 0	0 - 0 - 0	0	0
6 XPD	7 - 7 - 7	14 - 14 - 14	0 - 0 - 0	0 - 0 - 0	0 - 0 - 0	0 - 0 - 0	0	0
7 -	0 - 0 - 0	0 - 0 - 0	0 - 0 - 0	0 - 0 - 0	0 - 0 - 0	0 - 0 - 0	0	0
8 SBT	0 - 0 - 0	0 - 0 - 0	10 - 7 - 7	2.5 - 2.5 - 2.5	10 - 25 - 25	25 - 0 - 0	4	1

Last In Service Date: 05/17/2010 09:00

**Permitted Phases**

**12345678**

Default -2-4-6-8  
External Permit 0 -----  
External Permit 1 -----  
External Permit 2 -----

<u>Current</u>	<u>Green Time</u>											
<u>TOD Schedule</u>	<u>Plan</u>	<u>Cycle</u>	1	2	3	4	5	6	7	8	<u>Ring Offset</u>	<u>Offset</u>
			-	PED	-	NBT	-	XPD	-	SBT		
	1	53	0	23	0	25	0	23	0	25	0	7

**Local TOD Schedule**

<u>Time</u>	<u>Plan</u>	<u>DOW</u>
0000	Free	Su M T W Th F S
0600	1	Su M T W Th F S



**TOD Schedule Report**  
**for 2735: Lenox Av&Lincoln Rd**

Print Date:  
**1/25/2016**

Print Time:  
**10:34 AM**

Current Time of Day Function				Local Time of Day Function				* Settings
<u>Time</u>	<u>Function</u>	<u>Settings *</u>	<u>Day of Week</u>	<u>Time</u>	<u>Function</u>	<u>Settings *</u>	<u>Day of Week</u>	
0000	TOD OUTPUTS	-----	SuM T W ThF S	0000	TOD OUTPUTS	-----	SuM T W ThF S	Blank - FREE - Phase Bank 1, Max 1 Blank - Plan - Phase Bank 1, Max 2 1 - Phase Bank 2, Max 1 2 - Phase Bank 2, Max 2 3 - Phase Bank 3, Max 1 4 - Phase Bank 3, Max 2 5 - EXTERNAL PERMIT 1 6 - EXTERNAL PERMIT 2 7 - X-PED OMIT 8 - TBA

***No Calendar Defined/Enabled***

# SIGNAL OPERATING PLAN



	Direction			SB	NB	Ped Heads		
Timing Phases	Head No.			8	4	P2	P6	Movements/Display/Actuation
(2+6 )	Dwell			R	R	W	W	P2
E/W LINCOLN RD  (RECALL)	C	(4+8)		R	R	FDW	FDW	
	l							
	e							
	a							
	r							
	t							
	o							P6
	Dwell							
	C							
	l							
	e							
	a							
	r							
	t							
	o							
(4+8)	Dwell			G	G	DW	DW	
	C	(2+6)		Y	Y	DW	DW	
	l							
	e							
N/S LENOX AV  (ACTUATED)	a							
	r							
	t							
	o							
	Dwell							
	C							
	l							
	e							
	a							
	r							
	t							
	o							
	Dwell							
	C							
	l							
	e							
	a							
	r							
	t							
	o							
Flashing Operation				FR	FR	Page 1 of 1		
Miami-Dade County Public Works Department								
Drawn William Rivera-Paz		Date 4/21/2010		Lenox Av & Lincoln Rd				
Checked H. Hernandez		Date 5/4/10		Placed in Service Date 5/17/10 By STI		Phasing No. 5		Asset Number 2735

**TOD Schedule Report**  
for 2754: Lincoln Rd&Michigan Av

Print Date:  
1/25/2016

Print Time:  
10:37 AM

<u>Asset</u>	<u>Intersection</u>	<u>TOD Schedule</u>	<u>Op Mode</u>	<u>Plan #</u>	<u>Cycle</u>	<u>Offset</u>	<u>TOD Setting</u>	<u>Active PhaseBank</u>	<u>Active Maximum</u>
2754	Lincoln Rd&Michigan Av	DOW-2		N/A	0	0	N/A	0	Max 0

**Splits**

<u>PH 1</u>	<u>PH 2</u>	<u>PH 3</u>	<u>PH 4</u>	<u>PH 5</u>	<u>PH 6</u>	<u>PH 7</u>	<u>PH 8</u>
-	XPD	-	NBT	-	PED	-	SBT
0	0	0	0	0	0	0	0

N/A



N/A



Active Phase Bank: Phase Bank 1

<u>Phase</u>	<u>Walk</u>	<u>Don't Walk</u>	<u>Min Initial</u>	<u>Veh Ext</u>	<u>Max Limit</u>	<u>Max 2</u>	<u>Yellow</u>	<u>Red</u>
<u>Phase Bank</u>								
	1 2 3	1 2 3	1 2 3	1 2 3	1 2 3	1 2 3		
1 -	0 - 0 - 0	0 - 0 - 0	0 - 0 - 0	0 - 0 - 0	0 - 0 - 0	0 - 0 - 0	0	0
2 XPD	7 - 7 - 7	14 - 14 - 14	0 - 0 - 0	0 - 0 - 0	0 - 0 - 0	0 - 0 - 0	0	0
3 -	0 - 0 - 0	0 - 0 - 0	0 - 0 - 0	0 - 0 - 0	0 - 0 - 0	0 - 0 - 0	0	0
4 NBT	0 - 0 - 0	0 - 0 - 0	10 - 7 - 7	2.5 - 2.5 - 2.5	10 - 25 - 25	20 - 0 - 0	4	1
5 -	0 - 0 - 0	0 - 0 - 0	0 - 0 - 0	0 - 0 - 0	0 - 0 - 0	0 - 0 - 0	0	0
6 PED	7 - 7 - 7	14 - 14 - 14	0 - 0 - 0	0 - 0 - 0	0 - 0 - 0	0 - 0 - 0	0	0
7 -	0 - 0 - 0	0 - 0 - 0	0 - 0 - 0	0 - 0 - 0	0 - 0 - 0	0 - 0 - 0	0	0
8 SBT	0 - 0 - 0	0 - 0 - 0	10 - 7 - 7	2.5 - 2.5 - 2.5	10 - 25 - 25	20 - 0 - 0	4	1

Last In Service Date: unknown

**Permitted Phases**

**12345678**

Default -2-4-6-8  
External Permit 0 -----  
External Permit 1 -----  
External Permit 2 -----

<u>Current</u>	<u>Green Time</u>											
<u>TOD Schedule</u>	<u>Plan</u>	<u>Cycle</u>	1	2	3	4	5	6	7	8	<u>Ring Offset</u>	<u>Offset</u>
			-	XPD	-	NBT	-	PED	-	SBT		
	1	49	0	24	0	20	0	24	0	20	0	7

**Local TOD Schedule**

<u>Time</u>	<u>Plan</u>	<u>DOW</u>
0000	Free	Su M T W Th F S
0600	1	Su M T W Th F S

**TOD Schedule Report**  
**for 2754: Lincoln Rd&Michigan Av**

Print Date:  
**1/25/2016**

Print Time:  
**10:37 AM**

Current Time of Day Function				Local Time of Day Function				* Settings
<u>Time</u>	<u>Function</u>	<u>Settings *</u>	<u>Day of Week</u>	<u>Time</u>	<u>Function</u>	<u>Settings *</u>	<u>Day of Week</u>	
0000	TOD OUTPUTS	-----	SuM T W ThF S	0000	TOD OUTPUTS	-----	SuM T W ThF S	Blank - FREE - Phase Bank 1, Max 1 Blank - Plan - Phase Bank 1, Max 2 1 - Phase Bank 2, Max 1 2 - Phase Bank 2, Max 2 3 - Phase Bank 3, Max 1 4 - Phase Bank 3, Max 2 5 - EXTERNAL PERMIT 1 6 - EXTERNAL PERMIT 2 7 - X-PED OMIT 8 - TBA

***No Calendar Defined/Enabled***



# SIGNAL OPERATING PLAN

PHASE		SIGNAL HEAD NUMBER											
INT.	4	8	P2	P6									
<div style="font-size: 2em; margin-bottom: 10px;">Φ<sub>A</sub></div> <div style="font-size: 1.5em; margin-bottom: 10px;">P<sub>2</sub> + P<sub>6</sub></div> <div style="margin-bottom: 10px;">LINCOLN Rd.</div> <div style="margin-bottom: 10px;">EBND &amp; WBND</div> <div style="margin-bottom: 10px;">RECALL</div> <div>PEDS ONLY</div>	R/W.	R	R	W	W								
	PED. CL.	R	R	FW	FW								
	TO	Φ <sub>B</sub>	R	R	DW	DW							
	CLEAR												
<div style="font-size: 2em; margin-bottom: 10px;">Φ<sub>B</sub></div> <div style="font-size: 1.5em; margin-bottom: 10px;">4 + 8</div> <div style="margin-bottom: 10px;">MICHIGAN AV</div> <div style="margin-bottom: 10px;">NBND &amp; SBND</div> <div>ACTUATED</div>	R/W	G	G	DW	DW								
	PED. CL.												
	TO	Φ <sub>A</sub>	Y	Y	DW	DW							
	CLEAR												
	R/W												
	PED. CL.												
	TO												
	CLEAR												
	R/W												
	PED. CL.												
	TO												
	CLEAR												
FLASHING OPERATION			R	R									
Drawn <div style="font-size: 1.2em; font-family: cursive;">H. FRANCHILLON</div>	Date <div style="font-size: 1.2em; font-family: cursive;">4/25/97</div>	METROPOLITAN DADE COUNTY DEPARTMENT OF TRAFFIC AND TRANSPORTATION  <div style="border: 1px solid black; padding: 5px; display: inline-block; margin: 10px 0;">ASSET NO. 2754</div>  <div style="font-size: 1.5em; margin: 10px 0;">LINCOLN Rd &amp; MICHIGAN AV</div>											
Check <div style="font-size: 1.5em; font-family: cursive;">JCL</div>	Date <div style="font-size: 1.2em; font-family: cursive;">4/25/97</div>												
Division Engineer	Date												
		Placed In Service								Phasing Number			
		Date:				By:				4			

**TOD Schedule Report**  
for 2732: Jefferson Av&Lincoln Rd

Print Date:  
1/25/2016

Print Time:  
10:33 AM

<u>Asset</u>	<u>Intersection</u>	<u>TOD Schedule</u>	<u>Op Mode</u>	<u>Plan #</u>	<u>Cycle</u>	<u>Offset</u>	<u>TOD Setting</u>	<u>Active PhaseBank</u>	<u>Active Maximum</u>
2732	Jefferson Av&Lincoln Rd	DOW-2		N/A	0	0	N/A	0	Max 0

**Splits**

<u>PH 1</u>	<u>PH 2</u>	<u>PH 3</u>	<u>PH 4</u>	<u>PH 5</u>	<u>PH 6</u>	<u>PH 7</u>	<u>PH 8</u>
-	XPD	-	NBT	-	PED	-	SBT
0	0	0	0	0	0	0	0

N/A



N/A



Active Phase Bank: Phase Bank 1

<u>Phase</u>	<u>Walk</u>	<u>Don't Walk</u>	<u>Min Initial</u>	<u>Veh Ext</u>	<u>Max Limit</u>	<u>Max 2</u>	<u>Yellow</u>	<u>Red</u>
<u>Phase Bank</u>								
	1 2 3	1 2 3	1 2 3	1 2 3	1 2 3	1 2 3		
1 -	0 - 0 - 0	0 - 0 - 0	0 - 0 - 0	0 - 0 - 0	0 - 0 - 0	0 - 0 - 0	0	0
2 XPD	7 - 7 - 7	14 - 14 - 14	0 - 0 - 0	0 - 0 - 0	0 - 0 - 0	0 - 0 - 0	0	0
3 -	0 - 0 - 0	0 - 0 - 0	0 - 0 - 0	0 - 0 - 0	0 - 0 - 0	0 - 0 - 0	0	0
4 NBT	0 - 0 - 0	0 - 0 - 0	10 - 7 - 7	2.5 - 2.5 - 2.5	10 - 25 - 25	20 - 0 - 0	4	1
5 -	0 - 0 - 0	0 - 0 - 0	0 - 0 - 0	0 - 0 - 0	0 - 0 - 0	0 - 0 - 0	0	0
6 PED	7 - 7 - 7	14 - 14 - 14	0 - 0 - 0	0 - 0 - 0	0 - 0 - 0	0 - 0 - 0	0	0
7 -	0 - 0 - 0	0 - 0 - 0	0 - 0 - 0	0 - 0 - 0	0 - 0 - 0	0 - 0 - 0	0	0
8 SBT	0 - 0 - 0	0 - 0 - 0	10 - 7 - 7	2.5 - 2.5 - 2.5	10 - 25 - 25	20 - 0 - 0	4	1

Last In Service Date: unknown

**Permitted Phases**

**12345678**

Default -2-4-6-8  
External Permit 0 -----  
External Permit 1 -----  
External Permit 2 -----

<u>Current</u>	<u>Green Time</u>											
<u>TOD Schedule</u>	<u>Plan</u>	<u>Cycle</u>	1	2	3	4	5	6	7	8	<u>Ring Offset</u>	<u>Offset</u>
			-	XPD	-	NBT	-	PED	-	SBT		
	1	48	0	23	0	20	0	23	0	20	0	7

**Local TOD Schedule**

<u>Time</u>	<u>Plan</u>	<u>DOW</u>
0000	Free	Su M T W Th F S
0600	1	Su M T W Th F S

**TOD Schedule Report**  
**for 2732: Jefferson Av&Lincoln Rd**

Print Date:  
**1/25/2016**

Print Time:  
**10:33 AM**

Current Time of Day Function				Local Time of Day Function				* Settings
<u>Time</u>	<u>Function</u>	<u>Settings *</u>	<u>Day of Week</u>	<u>Time</u>	<u>Function</u>	<u>Settings *</u>	<u>Day of Week</u>	
0000	TOD OUTPUTS	-----	SuM T W ThF S	0000	TOD OUTPUTS	-----	SuM T W ThF S	Blank - FREE - Phase Bank 1, Max 1 Blank - Plan - Phase Bank 1, Max 2 1 - Phase Bank 2, Max 1 2 - Phase Bank 2, Max 2 3 - Phase Bank 3, Max 1 4 - Phase Bank 3, Max 2 5 - EXTERNAL PERMIT 1 6 - EXTERNAL PERMIT 2 7 - X-PED OMIT 8 - TBA

***No Calendar Defined/Enabled***

# SIGNAL OPERATING PLAN

		SIGNAL HEAD NUMBER														
PHASE	INT.	4	8	P2	P6											
$\Phi_A$ P2 + P6  LINCOLN Rd.  EBND & WBND  RECALL PEDS ONLY	R/W	R	R	W	W											
	PED. CL	R	R	W	W											
	<div style="display: flex; align-items: center;"> <div style="writing-mode: vertical-rl; transform: rotate(180deg); font-size: small;">TO</div> <div style="margin-left: 5px;"> <math>\Phi_B</math> R R DW DW           </div> </div>															
<div style="display: flex; align-items: center;"> <div style="writing-mode: vertical-rl; transform: rotate(180deg); font-size: small;">CLEAR</div> <div style="margin-left: 5px;"></div> </div>																
$\Phi_B$ 4 + 8  JEFFERSON AV  NBND & SBND  ACTUATED	R/W	G	G	DW	DW											
	PED. CL															
	<div style="display: flex; align-items: center;"> <div style="writing-mode: vertical-rl; transform: rotate(180deg); font-size: small;">TO</div> <div style="margin-left: 5px;"> <math>\Phi_A</math> Y Y DW DW           </div> </div>															
<div style="display: flex; align-items: center;"> <div style="writing-mode: vertical-rl; transform: rotate(180deg); font-size: small;">CLEAR</div> <div style="margin-left: 5px;"></div> </div>																
	R/W															
	PED. CL															
	<div style="display: flex; align-items: center;"> <div style="writing-mode: vertical-rl; transform: rotate(180deg); font-size: small;">TO</div> <div style="margin-left: 5px;"></div> </div>															
<div style="display: flex; align-items: center;"> <div style="writing-mode: vertical-rl; transform: rotate(180deg); font-size: small;">CLEAR</div> <div style="margin-left: 5px;"></div> </div>																
	R/W															
	PED. CL															
	<div style="display: flex; align-items: center;"> <div style="writing-mode: vertical-rl; transform: rotate(180deg); font-size: small;">TO</div> <div style="margin-left: 5px;"></div> </div>															
<div style="display: flex; align-items: center;"> <div style="writing-mode: vertical-rl; transform: rotate(180deg); font-size: small;">CLEAR</div> <div style="margin-left: 5px;"></div> </div>																
FLASH OPERATION			R	R												

Drawn  
**H. FRANCHILLON**

Check

Division Engineer

Date  
**4/25/97**

Date  
**4/25/97**

Date

METROPOLITAN DADE COUNTY  
DEPARTMENT OF TRAFFIC AND TRANSPORTATION

**ASSET NO. 2732**

**LINCOLN Rd. & JEFFERSON AV**

Placed in Service

Date:

Bv:

Phasing Number

**LL**

**TOD Schedule Report**  
for 2747: Lincoln Rd&Meridian Av

Print Date:  
1/25/2016

Print Time:  
10:36 AM

<u>Asset</u>	<u>Intersection</u>	<u>TOD Schedule</u>	<u>Op Mode</u>	<u>Plan #</u>	<u>Cycle</u>	<u>Offset</u>	<u>TOD Setting</u>	<u>Active PhaseBank</u>	<u>Active Maximum</u>
2747	Lincoln Rd&Meridian Av	DOW-2		N/A	0	0	N/A	0	Max 0

**Splits**

<u>PH 1</u>	<u>PH 2</u>	<u>PH 3</u>	<u>PH 4</u>	<u>PH 5</u>	<u>PH 6</u>	<u>PH 7</u>	<u>PH 8</u>
-	PED	-	NBT	-	XPD	-	SBT
0	0	0	0	0	0	0	0

N/A



N/A



Active Phase Bank: Phase Bank 1

<u>Phase</u>	<u>Walk</u>	<u>Don't Walk</u>	<u>Min Initial</u>	<u>Veh Ext</u>	<u>Max Limit</u>	<u>Max 2</u>	<u>Yellow</u>	<u>Red</u>
<u>Phase Bank</u>								
	1 2 3	1 2 3	1 2 3	1 2 3	1 2 3	1 2 3	1 2 3	
1 -	0 - 0 - 0	0 - 0 - 0	0 - 0 - 0	0 - 0 - 0	0 - 0 - 0	0 - 0 - 0	0	0
2 PED	7 - 7 - 7	14 - 14 - 14	0 - 0 - 0	0 - 0 - 0	0 - 0 - 0	0 - 0 - 0	0	0
3 -	0 - 0 - 0	0 - 0 - 0	0 - 0 - 0	0 - 0 - 0	0 - 0 - 0	0 - 0 - 0	0	0
4 NBT	0 - 0 - 0	0 - 0 - 0	10 - 7 - 7	3.2 - 2.5 - 2.5	12 - 25 - 25	35 - 0 - 0	4	1
5 -	0 - 0 - 0	0 - 0 - 0	0 - 0 - 0	0 - 0 - 0	0 - 0 - 0	0 - 0 - 0	0	0
6 XPD	7 - 7 - 7	14 - 14 - 14	0 - 0 - 0	0 - 0 - 0	0 - 0 - 0	0 - 0 - 0	0	0
7 -	0 - 0 - 0	0 - 0 - 0	0 - 0 - 0	0 - 0 - 0	0 - 0 - 0	0 - 0 - 0	0	0
8 SBT	0 - 0 - 0	0 - 0 - 0	10 - 7 - 7	3.2 - 2.5 - 2.5	12 - 25 - 25	35 - 0 - 0	4	1

Last In Service Date: unknown

**Permitted Phases**

**12345678**

Default -2-4-6-8  
External Permit 0 -----  
External Permit 1 -----  
External Permit 2 -----

<u>Current</u>	<u>Green Time</u>											
<u>TOD Schedule</u>	<u>Plan</u>	<u>Cycle</u>	1	2	3	4	5	6	7	8	<u>Ring Offset</u>	<u>Offset</u>
			-	PED	-	NBT	-	XPD	-	SBT		
	1	95	0	60	0	30	0	60	0	30	0	7

**Local TOD Schedule**

<u>Time</u>	<u>Plan</u>	<u>DOW</u>
0000	Free	Su M T W Th F S
0600	1	Su M T W Th F S



**TOD Schedule Report**  
**for 2747: Lincoln Rd&Meridian Av**

Print Date:  
**1/25/2016**

Print Time:  
**10:36 AM**

Current Time of Day Function				Local Time of Day Function				* Settings
<u>Time</u>	<u>Function</u>	<u>Settings *</u>	<u>Day of Week</u>	<u>Time</u>	<u>Function</u>	<u>Settings *</u>	<u>Day of Week</u>	
0000	TOD OUTPUTS	-----	SuM T W ThF S	0000	TOD OUTPUTS	-----	SuM T W ThF S	Blank - FREE - Phase Bank 1, Max 1 Blank - Plan - Phase Bank 1, Max 2 1 - Phase Bank 2, Max 1 2 - Phase Bank 2, Max 2 3 - Phase Bank 3, Max 1 4 - Phase Bank 3, Max 2 5 - EXTERNAL PERMIT 1 6 - EXTERNAL PERMIT 2 7 - X-PED OMIT 8 - TBA

***No Calendar Defined/Enabled***

# SIGNAL OPERATING PLAN

		SIGNAL HEAD NUMBER											
PHASE	INT.	4	8	P2	P6								
$\Phi_A$ P2 + P6  LINCOLN Rd. EBND & WBND RECALL PEDS ONLY	R/W	R	R	W	W								
	PED. CL.	R	R	W	W								
		$\Phi_B$	R	R	W	W							
	TO												
	CLEAR												
$\Phi_B$ 4 + 8  MERIDIAN AV. NBND & SBND ACTUATED	R/W	G	G	W	W								
	PED. CL.												
		$\Phi_A$	Y	Y	W	W							
	TO												
	CLEAR												
	R/W												
	PED. CL.												
	TO												
	CLEAR												
	R/W												
	PED. CL.												
	TO												
	CLEAR												
FLASH OPERATION		R	R										
Drawn <i>H. Francillon</i>		Date 4/25/97		METROPOLITAN DADE COUNTY DEPARTMENT OF TRAFFIC AND TRANSPORTATION									
Check <i>[Signature]</i>		Date 4/25/97											
Division Engineer		Date		ASSET NO. 2747									
				LINCOLN Rd. & MERIDIAN AV.									
				Placed In Service									
				Phasing Number									
				4									