

ONE OCEAN
1 COLLINS AVENUE, UNIT 708
MIAMI BEACH, FL 33139

OWNER:
Franklin
1 Collins Avenue, Unit 708
Miami Beach, FL 33139

ARCHITECT OF RECORD:

RYAN ALDERMAN ARCHITECT

14970 E Falcons Lea Drive
Davie, Florida 33331
305.801.9185 TEL
305.735.2846 FAX
www.ryanalderman.com

INTERIOR DESIGNER:

DWD

DEBORAH WECSSELMAN DESIGN

7580 NE 4th Court, Studio 108
Miami, Florida 33331
P. 305.758.1112
F. 305.758.7718
DWDINC.COM

SEAL / SIGNATURE / DATE

RYAN NEIL ALDERMAN

OWNERSHIP AND USE OF THE DOCUMENTS: THESE DRAWINGS, SCHEDULES, SPECIFICATIONS AND EXPRESSED IDEAS AS INSTRUMENTS OF SERVICE ARE AND SHALL REMAIN THE PROPERTY OF RYAN ALDERMAN ARCHITECT WHETHER THE PROJECT FOR WHICH THEY ARE PREPARED IS EXECUTED OR NOT. THE OWNER AND/OR TENANT SHALL ONLY BE GRANTED LIMITED PERMISSION TO REPRODUCE COPIES OF THESE DRAWINGS, SCHEDULES, SPECIFICATIONS AND EXPRESSED IDEAS FOR INFORMATION AND REFERENCE. THE DRAWINGS, SCHEDULES, SPECIFICATIONS AND EXPRESSED IDEAS SHALL NOT BE USED BY THE OWNER AND/OR TENANT ON OTHER PROJECTS, FOR ADDITIONS TO THIS PROJECT OR FOR COMPLETION OF THE PROJECT BY OTHERS EXCEPT BY AGREEMENT IN WRITING AND WITH APPROPRIATE COMPENSATION TO RYAN ALDERMAN ARCHITECT. ALL COPYRIGHTS RESERVED 2016.

PERMIT SET

09-22-16

Issue #	Issue Date / For
3	06-06-2017 / Bldg Dept. Comments

RAA Project No.: 16-026

Drawn by:

Approved by

SHEET INDEX

ROOFTOP FLOOR PLAN

SCALE :

SHEET NO.

A-4

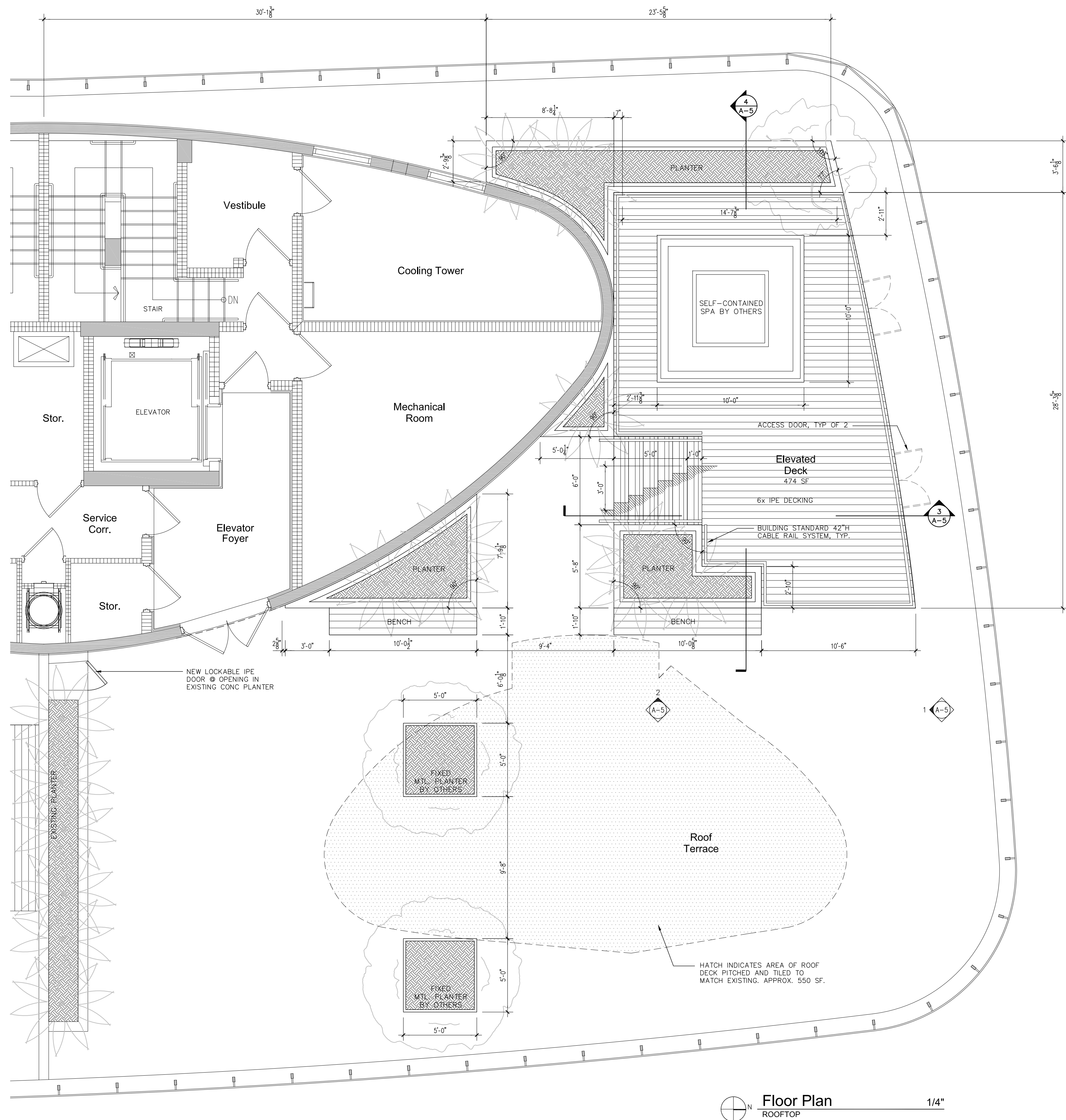

FRANKLIN
RESIDENCE

INTERIOR ALTERATION

ONE OCEAN
1 COLLINS AVENUE, UNIT 708
MIAMI BEACH, FL 33139

OWNER:
Franklin
1 Collins Avenue, Unit 708
Miami Beach, FL 33139



ARCHITECT OF RECORD:
RYAN ALDERMAN ARCHITECT
14970 E Falcons Lea Drive
Davie, Florida 33331
305.801.9185 TEL
305.735.2846 FAX
www.ryanalderman.com

INTERIOR DESIGNER:
DWD
DEBORAH WECELMAN DESIGN
7580 NE 4th Court, Studio 108
Miami, Florida 33331
P. 305.758.1112
F. 305.758.7718
DWDINC.COM

RYAN NEL ALDERMAN
ARCHITECT

OWNERSHIP AND USE OF THE DOCUMENTS: THESE DRAWINGS, SCHEDULES, SPECIFICATIONS AND EXPRESSED IDEAS AS INSTRUMENTS OF SERVICE ARE AND SHALL REMAIN THE PROPERTY OF RYAN ALDERMAN ARCHITECT. NO PART OF THESE DRAWINGS, SCHEDULES, SPECIFICATIONS OR EXPRESSED IDEAS SHALL BE REPRODUCED OR TRANSMITTED IN ANY FORM OR BY ANY MEANS, ELECTRONIC OR MECHANICAL, INCLUDING PHOTOCOPYING, RECORDING, OR BY ANY INFORMATION STORAGE AND RETRIEVAL SYSTEM, WITHOUT THE WRITTEN PERMISSION OF RYAN ALDERMAN ARCHITECT. ANY VIOLATION OF THIS AGREEMENT SHALL BE CONSIDERED A BREACH OF CONTRACT AND SHALL BE SUBJECT TO LEGAL ACTION. ALL COPYRIGHTS RESERVED 2016.

PERMIT SET
09-22-16

Issue #  Issue Date / For
 06-06-2017 / Bldg Dept. Comments

RAA Project No.: 16-026

Drawn by:

Approved by:

SHEET INDEX

ROOFTOP ELEVATIONS
& SECTIONS

SCALE:

SHEET NO.

A-5

