

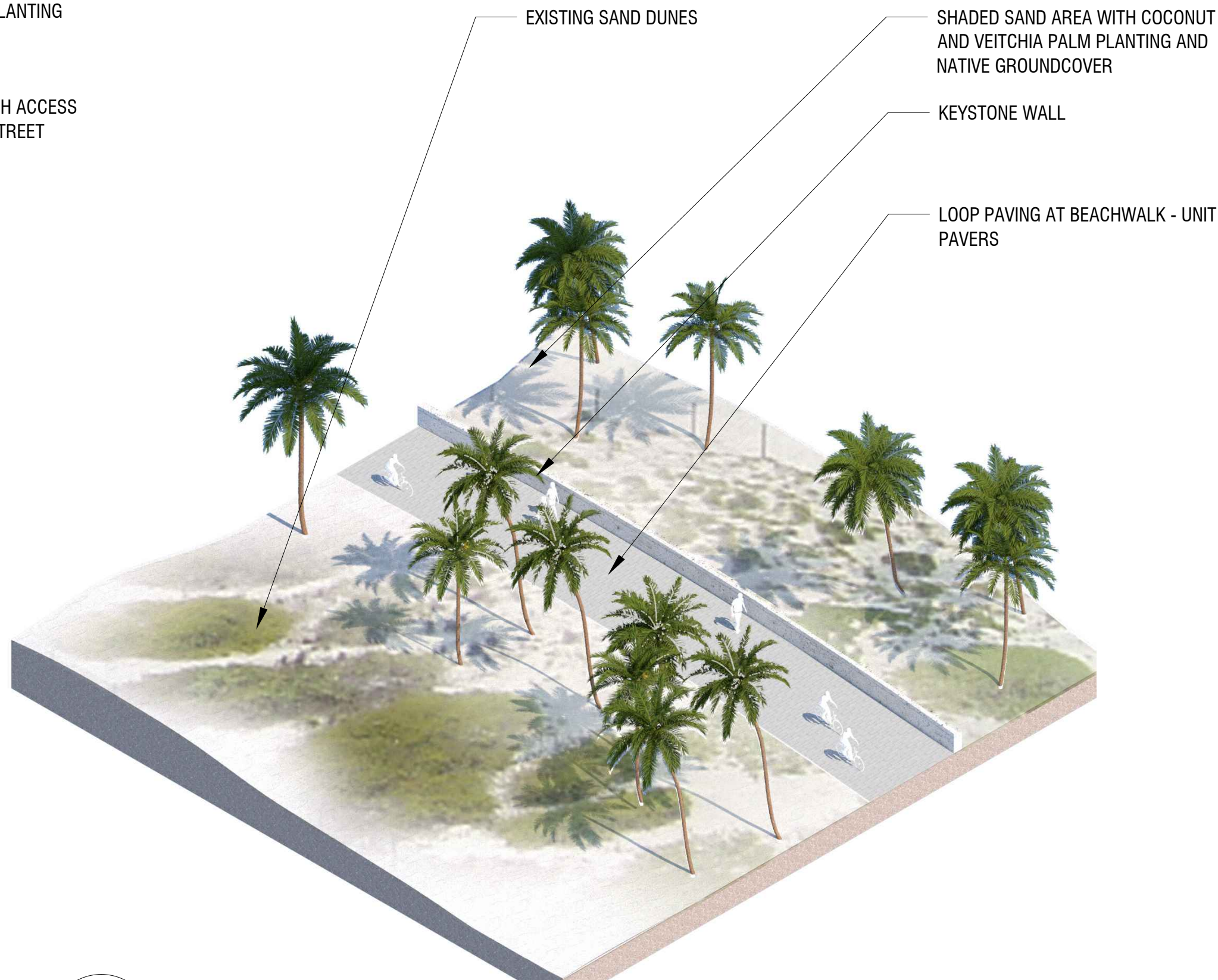

1
-
EDGE CONDITION - SOUTH
NTS

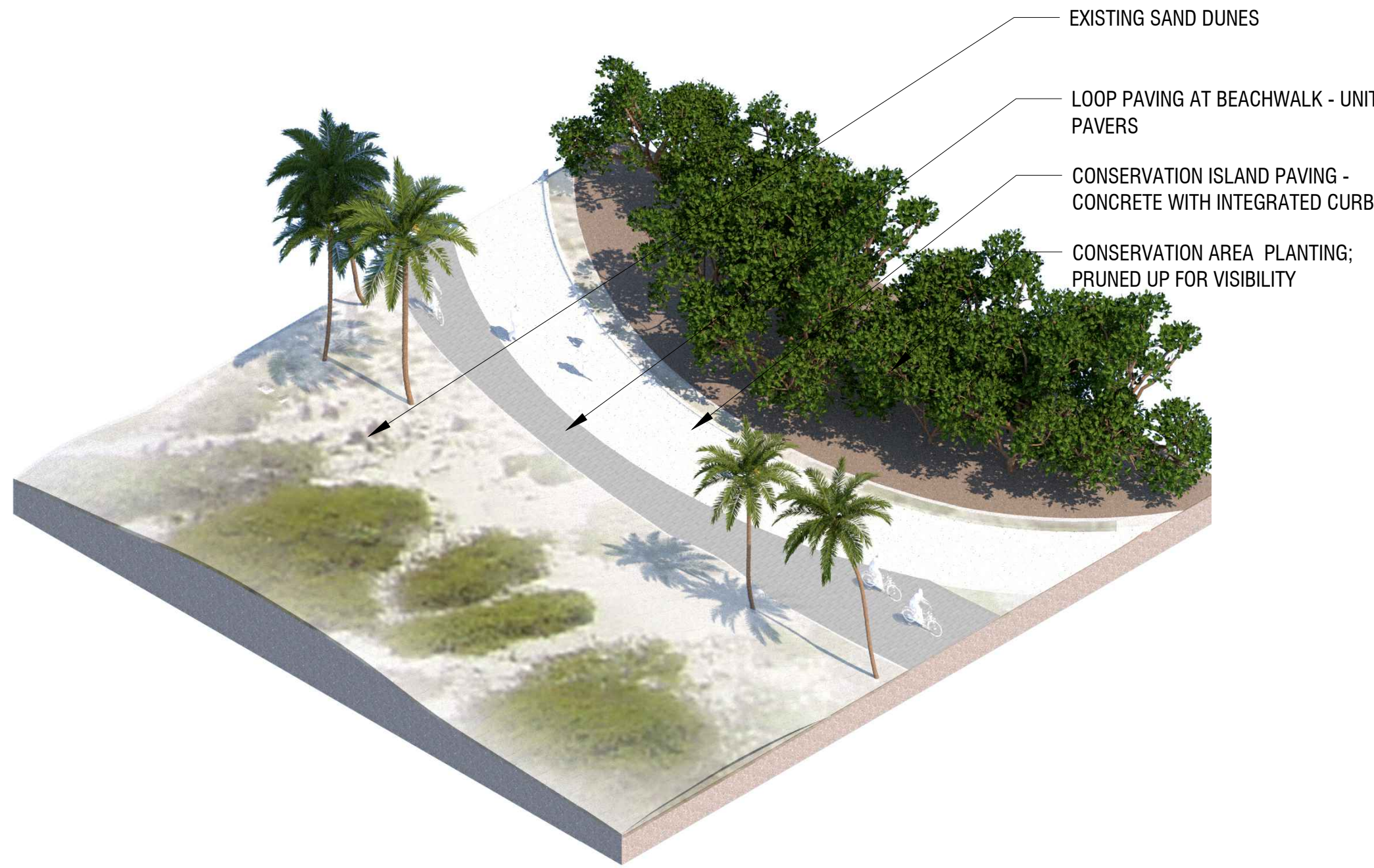

2
-
EDGE CONDITION - EAST 1
NTS



3
-
EDGE CONDITION - EAST 2
NTS

CLIENT:

MIAMI BEACH
CITY OF MIAMI BEACH
1700 CONVENTION CENTER DRIVE
MIAMI BEACH, FL 33139

PRIME CONSULTANT:

Calvin, Giordano & Associates, Inc.
1800 Eller Drive, Suite 600, Fort Lauderdale, Florida 33316
Phone: 954.521.7791 • Fax: 954.521.9807
CERTIFICATES OF AUTHORIZATION:
LANDSCAPE ARCHITECTURE: LC00000339
ENGINEERING: 514
SURVEYING: 6791
SERVICES PROVIDED:
LANDSCAPE ARCHITECTURE
CIVIL ENGINEERING
COASTAL ENGINEERING
ELECTRICAL ENGINEERING
SURVEYING & MAPPING
COST ESTIMATING
CONCEPTUAL DESIGNER:
WEST 8
333 HUDSON STREET
SUITE 905
NEW YORK CITY, NY 10013

ARCHITECTURAL CONSULTANT:

SYNALOVSKI ROMANIK SAYE, LLC
1800 ELLER DRIVE
SUITE 500
FORT LAUDERDALE, FL 33316
FIRM LICENSE: AA26001863
GEOTECHNICAL CONSULTANT:
NUTTING ENGINEERS OF FLORIDA, INC.
2051 NW 112TH AVENUE
SUITE 120
MIAMI, FL 33176
CERTIFICATE OF AUTHORIZATION: XXXX

NORTH SHORE OPEN SPACE PARK
BETWEEN 79TH AND 87TH STREETS,
EAST OF COLLINS AVENUE

SEAL:

REVISIONS:

1
2
3
4
5
6
7
8
9
10

SUBMITTAL:

30% SD

SCALE:

DATE:

NOV 14, 2016

CGA PROJECT NUMBER:

SHEET TITLE:

DETAILS - EDGE CONDITIONS

SHEET NUMBER:

L904

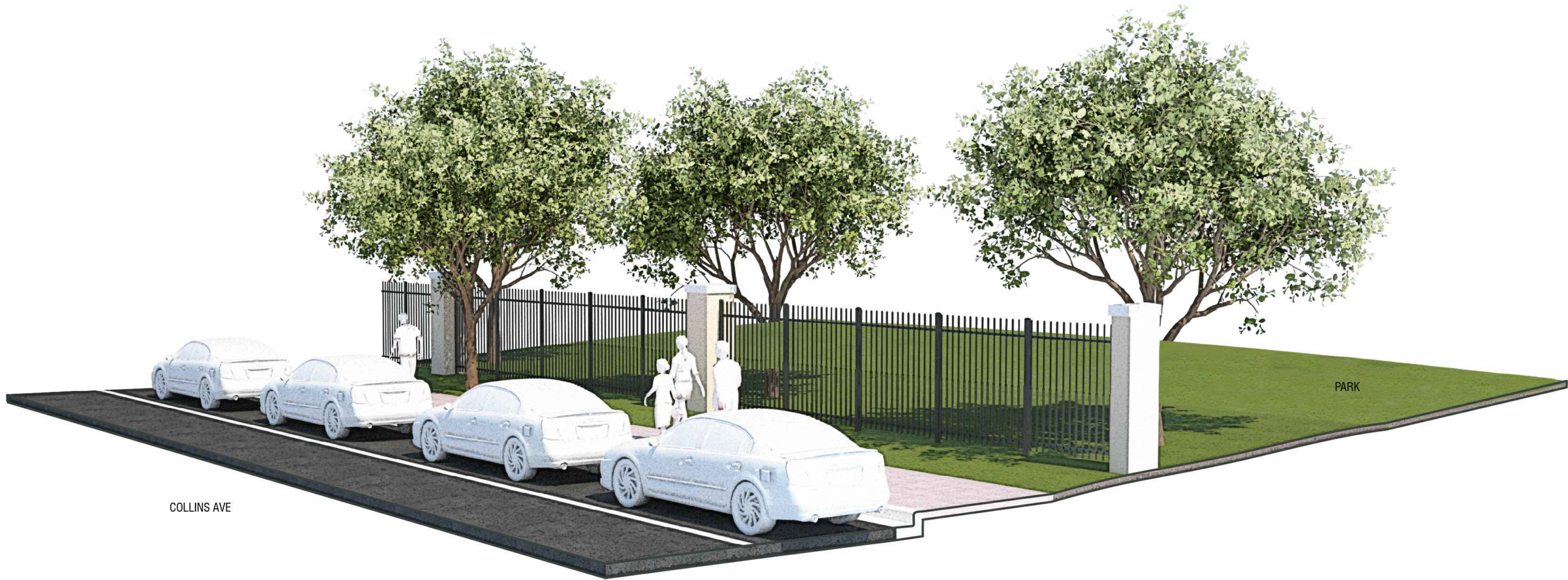

1 EXISTING EDGE CONDITION - COLLINS AVENUE
- NTS

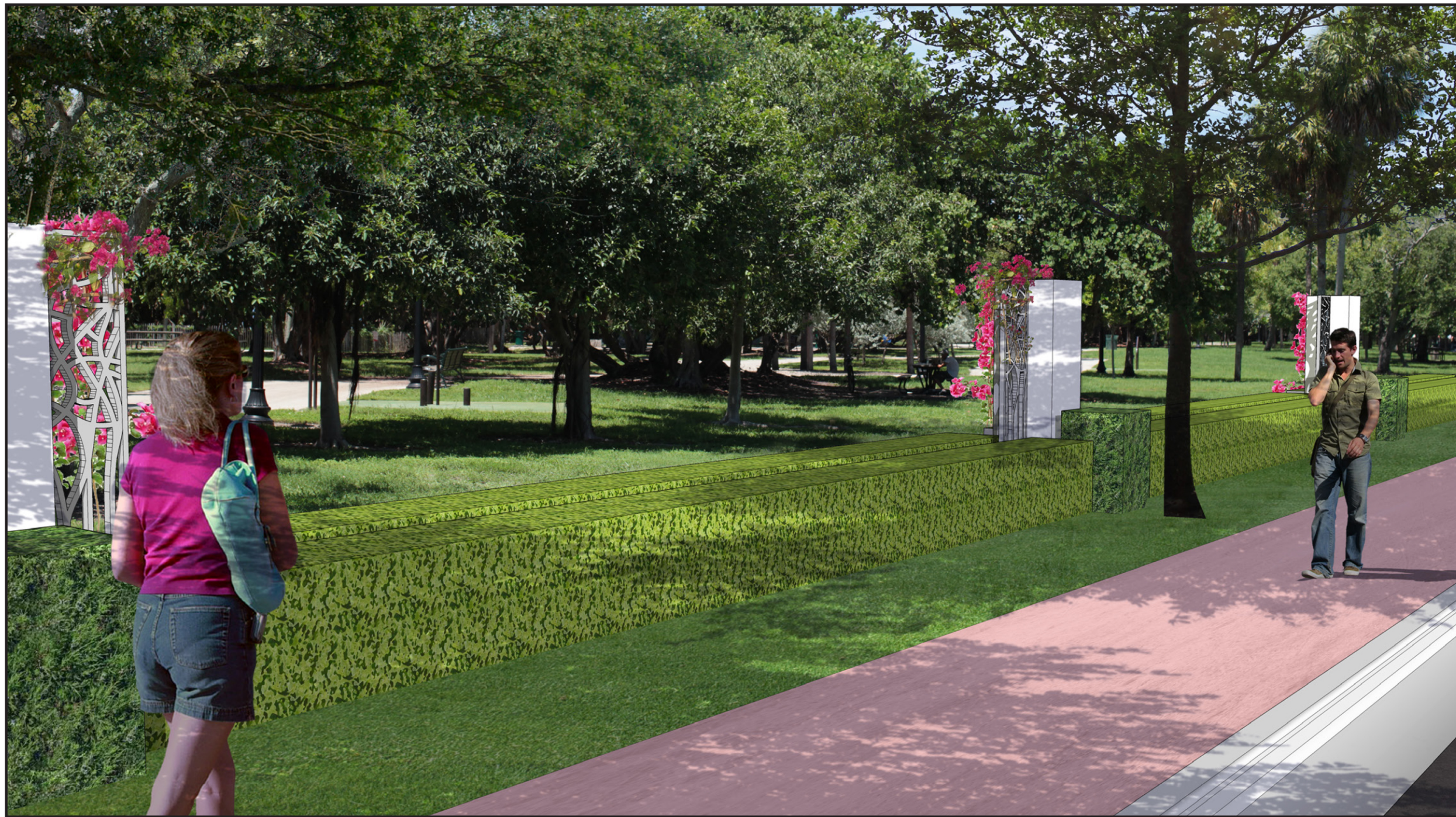

24-inch high modified fence with mature hedge



36-inch high modified fence with mature hedge

Proposed Modifications to Estate Fencing Along Collins Avenue Edge

CLIENT:
MIAMI BEACH
CITY OF MIAMI BEACH
1700 CONVENTION CENTER DRIVE
MIAMI BEACH, FL 33139

PRIME CONSULTANT:

Calvin, Giordano &
Associates, Inc.
1800 Eller Drive, Suite 600, Fort Lauderdale,
Florida 33316
Phone: (954) 321-7791 • Fax: (954) 321-9807
CERTIFICATES OF AUTHORIZATION:
LANDSCAPE ARCHITECTURE: LC00000339
ENGINEERING: 514
SURVEYING: 6791

SERVICES PROVIDED:
LANDSCAPE ARCHITECTURE
CIVIL ENGINEERING
COASTAL ENGINEERING
ELECTRICAL ENGINEERING
SURVEYING & MAPPING
COST ESTIMATING

CONCEPTUAL DESIGNER:
WEST 8
333 HUDSON STREET
SUITE 905
NEW YORK CITY, NY 10013

ARCHITECTURAL CONSULTANT:
SYNALOVSKI ROMANIK SAYE, LLC
1800 ELLER DRIVE
SUITE 500
FORT LAUDERDALE, FL 33316
FIRM LICENSE: AAZ6001863

GEOTECHNICAL CONSULTANT:
NUTTING ENGINEERS OF FLORIDA, INC.
2051 NW 112TH AVENUE
SUITE 120
MIAMI, FL 33176
CERTIFICATE OF AUTHORIZATION: XXXX

NORTH SHORE OPEN SPACE PARK
BETWEEN 79TH AND 87TH STREETS,
EAST OF COLLINS AVENUE

SEAL:

REVISIONS:
1
2
3
4
5
6
7
8
9
10

SUBMITTAL:
30% SD

SCALE:

DATE:
NOV 14, 2016

CGA PROJECT NUMBER:

SHEET TITLE:
DETAILS - EDGE CONDITIONS

SHEET NUMBER:
L905