

MITIGATION TREE SCHEDULE TO BE REPLACED	
TOTAL TO MITIGATE: 1 Palm # 1	*Tree #2 Umbrella tree is a listed invasive and requires no mitigation.
MITIGATION PROPOSED: 2 Trees = 2 Black Calabash trees, each having 14'HT 3"DBH 8"SP (ALL NATIVE)	

EXISTING TREE DISPOSITION CHART							
NO.	BOTANICAL NAME	COMMON NAME	HEIGHT	CANOPY	CALIPER (DBH)	CONDITION	ACTION
1.	<i>Roystonea regia</i>	Royal palm	30'	20'	16"	GOOD	REMOVE
2.	<i>Schefflera actinophylla</i>	Umbrella tree	14'	17'	6" multi	MODERATE	REMOVE

MITIGATION LIST								
PALMS AND TREES			QTY	DBH	HEIGHT	SPREAD	NATIVE	CANOPY CREDIT
BCS	<i>Amphitecna latifolia</i>	Black calabash	2	3"	14'	8'	YES	500

\*100% of the total proposed as replacement is met by natives.

**LEGEND**

- EXISTING TO REMAIN
- EXISTING TO RELOCATE
- EXISTING TO REMOVE
- RELOCATED LOCATION

**EXOTICSCAPE & ASSOCIATES  
LANDSCAPE ARCHITECTURE**  
 181 Harbor Dr. Key Biscayne, Fl. 33149  
 (305)785-8256  
 LA Theresa Wymmer LA6667363  
 Mercedes B.Porcari

**"La Casita" landscape**  
 1439 Alton road, MIAMI Miami Beach 33139

SHEET TITLE	TREE DISPOSITION PLAN
ISSUE DATE	12/14/2022
REVISION	
DESIGN	MERCEDES PORCARI
DRAWN	ROBERTO CARMONA
SCALE	1/8" = 1" - 0
DATE	2022.12.19
Digitally signed by Theresa Wymmer Date: 2022.12.19 13:42:44 -0500 THERESA WYMMER LA6667363	
SHEET NUMBER	LA.00



Landscape maintenance.

(A) An owner is responsible to ensure that landscaping required to be planted pursuant to this chapter, or the ordinances which were in effect prior to the effective date of this chapter, is:

- (1) Installed in compliance with the Landscape requirements;
  - (2) Maintained as to present a healthy, vigorous, and neat appearance free from refuse and debris; and
  - (3) Sufficiently fertilized and watered to maintain the plant material in a healthy condition.
- (B) If any tree or plant dies which is being used to satisfy current landscape code requirements, such tree or plant shall be replaced with the same landscape material or an approved substitute.
- (C) Trees shall be pruned in the following manner:
- (1) All cuts shall be clean, flush and at junctions, laterals or crotches. All cuts shall be made as close as possible to the trunk or parent limb, without cutting into the branch collar or leaving a protruding stub.
  - (2) Removal of dead wood, crossing branches, weak or insignificant branches, and sucker shall be accomplished simultaneously with any reduction in crown.
  - (3) Cutting of lateral branches that results in the removal of more than one-third (1/3) of all branches on one (1) side of a tree shall only be allowed if required for hazard reduction or clearance pruning.
  - (4) Lifting of branches or tree thinning shall be designed to distribute over half of the tree mass in the lower two-thirds (2/3) of the tree.
  - (5) No more than one-third (1/3) of a tree's living canopy shall be removed within a one (1) year period.
  - (6) Trees shall be pruned according to the current ANSI A300 Standards and the Landscape Manual.
  - (7) All newly installed planting material will be maintained in a condition that meets or exceeds Florida Grade #01 and has (01) one year replacement guarantee.

**LANDSCAPE LEGEND**

TRANSECT ZONE: CD-2 LOT AREA: 7,500 SF ACRES: 0.17

	REQUIRED/	ALLOWED	PROVIDED
<b>TREES</b>			
A. NUMBER OF TREES REQUIRED PER LOT ACRE, LESS EXISTING NUMBER OF TREE MEETING MINIMUM REQUIREMENTS =			
1. TREES / LOT ACRE / 22 - NUMBER OF EXISTING TREES =	4	5	
B. % PALMS ALLOWED: NUMBER OF TREE PROVIDED X 40% =	2	2	
C. % NATIVES REQUIRED: NUMBER OF TREE PROVIDED X 40% =	2	2	
D. % DROUGHT TOLERANT AND LOW MAINTENANCE: NUMBER OF TREE PROVIDED X 20% =	4	8	
E. STREET TREES (MAXIMUM AVERAGE SPACING OF 30' O.C.): LINEAR FEET ALONG STREET / 30' =	2	2	
F. STREET TREES LOCATED DIRECTLY BENEATH POWER LINES ( MAXIMUM AVERAGE SPACING OF 30' O.C.): LINEAR FEET ALONG STREET / 30' =	2	2	EXIST
<b>SHRUBS</b>			
A. NUMBER OF SHRUBS REQUIRED: NUMBER OF TREES REQUIRED X 12 =	48	48	
B. % NATIVE SHRUBS REQUIRED: NUMBER OF SHRUBS PROVIDED X 40% =	20	22	
<b>LARGE SHRUBS OR SMALL TREE</b>			
A. NUMBER OF SHRUBS REQUIRED X 10% =	5	5	
B. % NATIVE REQUIRED: NUMBER OF SHRUBS PROVIDED X 50% =	3	5	

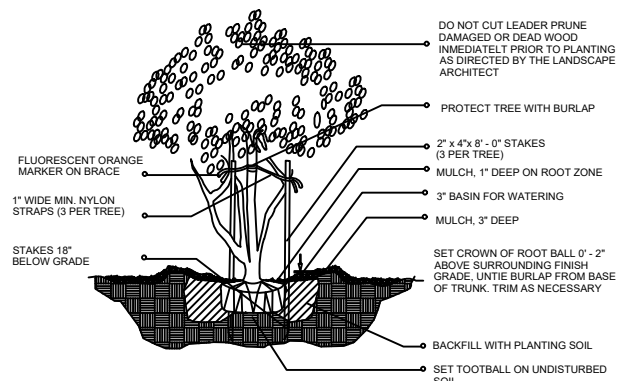

MULTI-TRUNK AND SMALL TREE (2' cal. and under) / PLANTING DETAIL

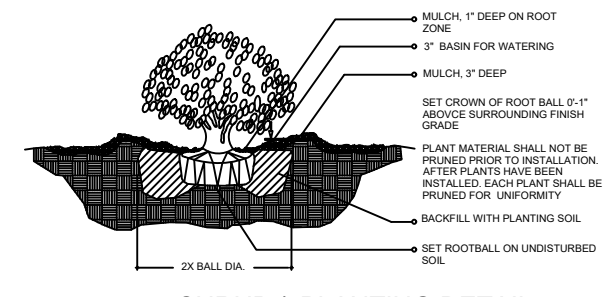

SHRUB / PLANTING DETAIL

**LANDSCAPE NOTES**

01. Non Cypress variety mulch shall extend under all trees, shrubs and ground cover beds to the closest hard edge or soil border, in a minimum of 3" depth.
02. All plants shall meet the minimum standard of Florida No. 1 or better as specified in Grade and Standards for Nursery Plants as published by the Division of Plant Industry, Florida Department of Agriculture, latest edition.
03. All shrubs to be planted a minimum of 24", and ground covers a minimum of 12" from the edge of walks, building walls, pond's edge, etc... Ixora Nora Grant and Raphiolepis Indica to be planted 30" from edge of walkways.
04. All trees and palms over 8" in height shall be braced to prevent lateral movement for a period of six months from the date of planting. Either wood braces as shown in the planting detail, or the wire and turnbuckle method shall be used. No nails, screws, metal straps or wires are to be used directly against the trees or palms trunks.
05. All palms except for species such as Cocos, Acoelorrhaphe, Raphis, and other multitrunk palms, shall have straight trunks, free of scars, decay or any damage caused by digging, transport or planting handling of the same.
06. All work by the Landscape Contractor shall be performed in a professional and sound manner in accordance with established standards of landscape installation practices and workmanship.
07. Landscape Contractor is responsible for verifying plant quantities prior to bidding. Quantities shown in the plans may vary due to actual site scale, job conditions, etc... Landscape Architect assumes no responsibility for the actual plant count necessary for the successful completion of the work.
08. Landscape Contractor and his subcontractors shall be licensed and insured as required by the municipality, county, state or any other governmental agency requiring a license or insurance in order for the Landscape Contractor to perform his work.
09. All work shall conform to Miami-Dade County's Landscape ordinance Chapter 18-A, ordinance # 98-13, and any other municipal landscape ordinance in effect at the projects location, including streets-trees.
10. Landscape Contractor is required to procure and obtain any necessary permits applicable for the successful completion of this project, if applicable.
11. Landscape material shall not be allowed to grow in such a manner as to impede streetfront triangle of visibility to property owner or neighbors, so as to materially impede vision between a height of 3 feet and 8 feet.
12. Landscape Contractor shall call Sunshine State One Call Center of Florida at 1-800-432-4770 (Toll Free) 48 hours before digging.
13. Landscape Contractor is responsible for inspecting the site and physically observing all the site conditions prior to entering into Agreements or Contract with Owner. Landscape Contractor shall coordinate his work with the General Contractor of Construction Manager in such a manner as to allow for a speedy and orderly completion of all work on the site.
14. Any excess soil, landscape materials and debris from the landscape Contractor's work shall be removed from the site immediately upon completion of his work.
15. Landscape Contractor shall coordinate the proposed planting in the Planting Plan with the work required in regrading and removal of trees in sheet L-1 (Existing Trees).
16. One year guarantee on plan material.

**PROPOSED LOT TREES (5)	**PROPOSED SHRUBS (145)	***PROPOSED LARGE SHRUBS/SMALL TREES (5)
+2 BLACK CALABASH +3 BRIDALVEIL TREES	+22 SPANISH STOPPER +26 BLUE PLUMBAGO	+5 SPANISH STOPPERS
		***PROPOSED STREET TREES (2)
		+2 EXISTING LIVE OAKS

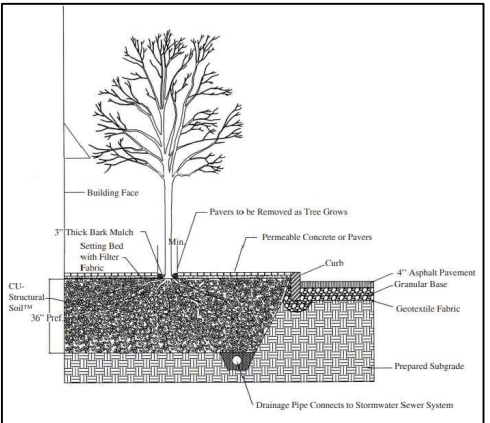
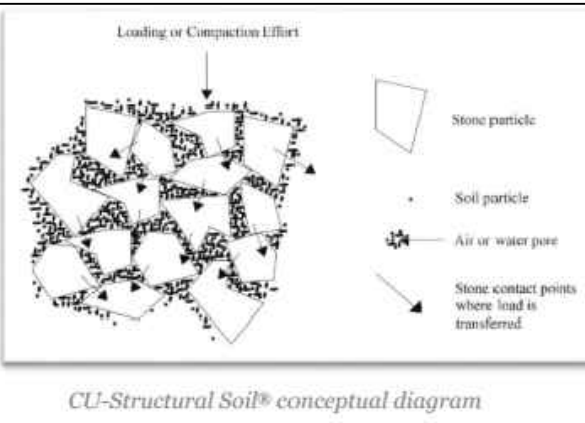

**Growing larger trees in parking lot islands with CU-Structural Soil®**

2 MEDIUM TREES  
mature crown spread = ~30' in diameter

2 SMALL TREES  
mature crown spread = ~20' in diameter

~720 ft³ of loam soil (36' x 8' x 2.5')

~1475 ft³ of CU-Soil® (16.5' x 36' x 2.5')

**Sec. 30-242 - Artificial turf.**

- (a) Definitions. The following words, terms and phrases when used in this section, shall have the meanings ascribed to them in this section:
- (1) Corner Lot. A Lot located at the intersection of two streets and abutting such streets on two adjacent sides.
  - (2) Artificial Turf. An artificial product manufactured from synthetic materials that simulates the appearance of natural turf, grass, sod or lawn.
- (b) Installation.
- (1) Single Family and Two-Family Districts. Within the VR, VE, IR and PS Districts, Artificial Turf shall not be permitted to be installed within a Front Yard of any Lot, or within a Street Side Yard of a Corner Lot.
  - (2) Other Districts. Within all other zoning districts with the exception of the PROS Public Recreation and Open Space Use District and the GU Government Use District, Artificial Turf shall not be permitted to be installed within a Front Yard, or within a Side Yard facing a Street.
- (c) Installation, Maintenance and Repair.
- (1) No person shall install Artificial Turf without first obtaining a permit from the Village Planning, Building and Zoning Department.
  - (2) All Artificial Turf shall, at a minimum, be installed according to the manufacturer's specifications.
  - (3) All seams shall be nailed and glued, not sewn, and edges shall be trimmed to fit against all regular and irregular edges to resemble a natural look.
  - (4) If Artificial Turf is planned to be installed immediately adjacent to a seawall, the Artificial Turf shall be pinned or staked behind the seawall. No Artificial Turf or installation mechanism shall be attached directly to or placed on a seawall or seawall cap.
  - (5) Artificial Turf shall be visually level, with the grain pointing in a single direction.
  - (6) An appropriate solid barrier device (e.g., concrete mow strip, bumper board) is required to separate Artificial Turf from soil and live vegetation.
  - (7) Precautions for installation around existing trees, including a proper radius, shall be provided to ensure that tree roots are not damaged with the installation of the base material and that the overall health of the tree will not be compromised.
  - (8) All Artificial Turf shall be maintained in a green fadeless condition and shall be maintained free of dirt, animal waste, mud, stains, weeds, debris, tears, holes, and impressions. Maintenance shall include, but not be limited to cleaning, brushing, debris removal, repairing of depressions and ruts to maintain a visually-level surface; elimination of any odors, flat or matted areas, weeds, and evasive roots; and all edges of the Artificial Turf shall not be loose and must be maintained with appropriate edging or stakes.
  - (9) All Artificial Turf must be replaced if it falls into disrepair with fading or holes or loose areas. Replacement and repairs shall be done with like materials from the same manufacturer and done so in a manner that results in a repair that blends with the existing Artificial Turf, without any matting.
  - (10) All Artificial Turf shall be installed on a permeable backing in order to ensure proper drainage.
  - (11) All Artificial Turf shall be of the highest quality available from a list of Village-approved manufacturers, and shall be a natural green color selected from a palette of colors approved by the Village.

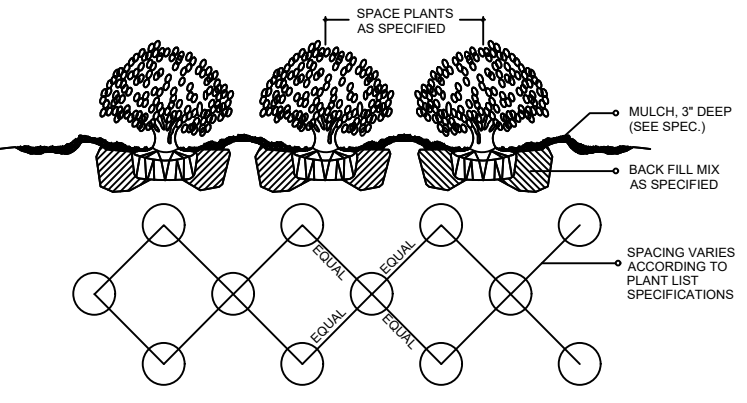

SHRUB / GROUNDCOVER SPACING PLANTING DETAIL

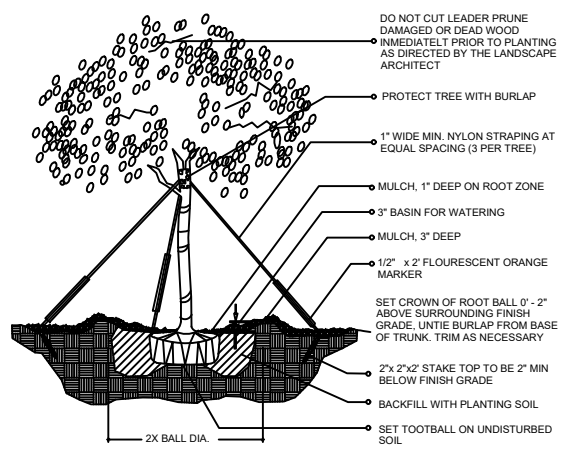

(2" cal. and over) LARGE TREE / PLANTING DETAIL

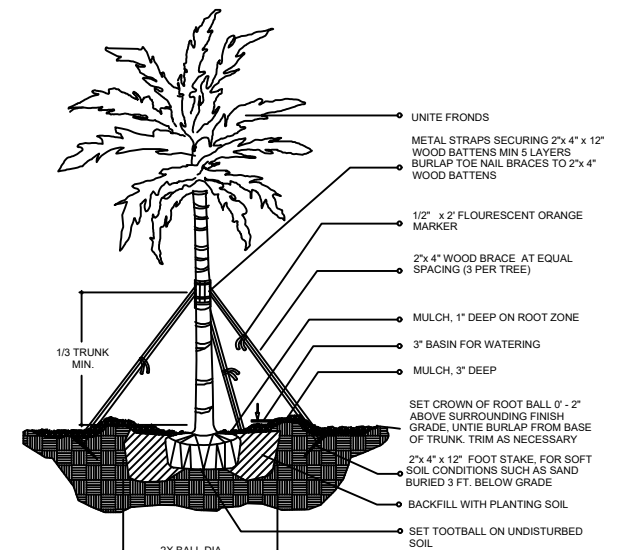

LARGE PALM / PLANTING DETAIL

**EXOTICSCAPE & ASSOCIATES  
LANDSCAPE ARCHITECTURE**

181 Harbor Dr. Key Biscayne, Fl. 33149  
(305)785-8256  
LA Theresa Wymmer LA6667363  
Mercedes B.Porcari

**"La Casita" landscape**  
1439 Alton road, MIAMI Miami Beach 33139

SHEET TITLE	LANDSCAPE DETAILS
ISSUE DATE	12/14/2022
REVISION	
DESIGN	MERCEDES PORCARI
DRAWN	ROBERTO CARMONA
SCALE	1 / 16" = 1" - 0
SEAL	Theresa Wymmer Digitally signed by Theresa Wymmer Date: 2022.12.19 13:42:59 LA6667363
SHEET NUMBER	LA.02