

NOTES:  
 1. EXISTING SITE PLAN IS BASED UPON DRAWINGS PREPARED BY STONER AND ASSOCIATES, INC. TITLED "SKETCH OF TOPOGRAPHIC, UTILITY AND SPECIFIC PURPOSE (TREE) SURVEY WASTE WATER PUMP STATION NO. 2" DATED 6/6/2022.

LEGEND

- TREES TO BE PROTECTED IN PLACE
- TREES / PALMS TO BE REMOVED
- TREES / PALMS TO BE RELOCATED
- OFF-SITE PALM
- TREE PROTECTION BARRICADE



PLAN  
 SCALE: 1"=20'

HPB FINAL SUBMITTAL:  
 JANUARY 10, 2023

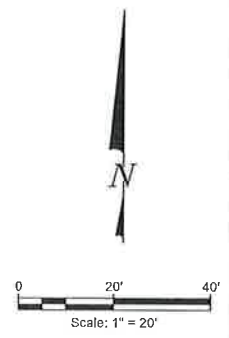

KEY PLAN (NOT TO SCALE):

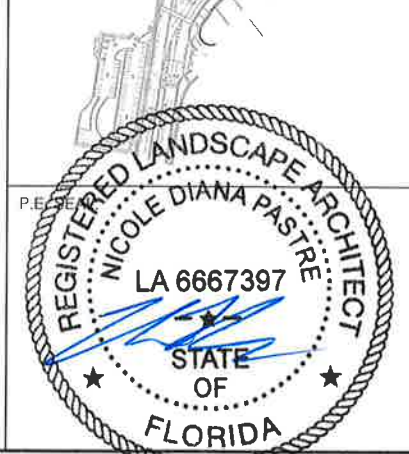

LUIS SUAREZ: 1/6/2023 12:16 PM BY: NPALSTRE  
 PLOTTED: 1/6/2023 12:20 PM BY: NPALSTRE

**MIAMI BEACH**  
 PUBLIC WORKS DEPARTMENT  
 1700 CONVENTION CENTER DRIVE, MIAMI BEACH, FL 33139

CITY MANAGER: ALINA T. HUDAK  
 DIRECTOR: JOE GOMEZ, PE  
 CITY ENGINEER: CRISTINA ORTEGA, PE, ENV SF

NO.	DATE	REVISION	APPD. BY
5			
4			
3			
2			
1			

**Hazen**  
 HAZEN AND SAWYER  
 999 P.O. BOX 44 LEON BLVD, SUITE 1150  
 CORAL GABLES, FLORIDA 33134  
 LIC# NS-16-2271

ENGINEER OF RECORD:  
 NICOLE D. PASTRE  
 FL R.L.A. NO. 6667397

ENGINEER OF RECORD: NDP  
 DESIGN ENGINEER: NDP  
 DRAWN BY: NDP  
 CHECKER: SMP  
 SCALE: AS NOTED

NEIGHBORHOOD: PS 28 DETAILED DESIGN SERVICES  
 TITLE: TREE DISPOSITION PLAN

File Name: 49000-025-TD-1.dwg  
 Survey Reference:  
 Field Book: N/A Page: N/A Work Order: N/A  
 Date: 09/2022 Sheet: 1 of 2 Drawing: TD-1

90% DESIGN SUBMITTAL - NOT FOR CONSTRUCTION



TREE#	SCIENTIFIC NAME	COMMON NAME	CONDITION (%)	CALIPER IN. (DBH)	HEIGHT FT	SPREAD FT	CANOPY SF	DISPOSITION	CLASS	NOTES	DBH MITIGATION
1008	<i>Calophyllum brasiliense</i>	Brazilian Beautyleaf	75%	6 in.	17 ft.	15 ft.	177 SF	Protect in Place	1		
1009	<i>Bursera simaruba</i>	Gumbo Limbo	75%	18 in.	30 ft.	35 ft.	962 SF	Protect in Place	2	Specimen	
1010	<i>Tabebuia caraba</i>	Silver Trumpet Tree	75%	10 in.	17 ft.	20 ft.	314 SF	Protect in Place	1		
1011	<i>Bursera simaruba</i>	Gumbo Limbo	80%	22 in.	30 ft.	35 ft.	962 SF	Protect in Place	2	Specimen	
1012	<i>Lagerstroemia speciosa</i>	Queen Crape Myrtle	70%	20 in.	20 ft.	18 ft.	254 SF	Protect in Place	2	Multi-Trunk	
1013	<i>Lagerstroemia speciosa</i>	Queen Crape Myrtle	65%	20 in.	18 ft.	15 ft.	177 SF	Protect in Place	2	Multi-Trunk	
1014	<i>Calophyllum brasiliense</i>	Brazilian Beautyleaf	75%	6 in.	15 ft.	10 ft.	79 SF	Protect in Place	1		
1015	<i>Calophyllum brasiliense</i>	Brazilian Beautyleaf	75%	8 in.	18 ft.	15 ft.	177 SF	Protect in Place	1		
1016	<i>Tabebuia caraba</i>	Silver Trumpet Tree	70%	17 in.	20 ft.	18 ft.	254 SF	Protect in Place	2	Specimen	
1072	<i>Albizia julibrissin</i>	Mimosa Tree	75%	12 in.	22 ft.	30 ft.	707 SF	Protect in Place	1		
1073	<i>Cordia sebestena</i>	Orange Geiger	80%	15 in.	25 ft.	25 ft.	491 SF	Protect in Place	1		
1074	<i>Schinus terebinthifolia</i>	Brazilian Pepper	80%	7 in.	17 ft.	15 ft.	177 SF	REMOVE	0	Cat. I Invasive	0 in.
1075	<i>Tabebuia caraba</i>	Silver Trumpet Tree	70%	18 in.	35 ft.	35 ft.	962 SF	Protect in Place	2	Specimen	
1076	<i>Albizia julibrissin</i>	Mimosa Tree	75%	12 in.	30 ft.	30 ft.	707 SF	Protect in Place	1		
1077	<i>Tabebuia caraba</i>	Silver Trumpet Tree	75%	12 in.	18 ft.	15 ft.	177 SF	Protect in Place	2	Specimen	
1078	<i>Bursera simaruba</i>	Gumbo Limbo	70%	10 in.	25 ft.	15 ft.	177 SF	RELOCATE	1		
1273	<i>Bischofia javanica</i>	Bishop Wood	MISSING	5 in.	18 ft.	15 ft.	177 SF	MISSING	0	Cat. I Invasive	0 in.
1274	<i>Chrysophyllum oliviforme</i>	Satinleaf	MISSING	6 in.	18 ft.	15 ft.	177 SF	MISSING	1	Mitigate for removal	6 in.
1275	<i>Tabebuia roseo 'Alba'</i>	White Trumpet Tree	70%	6 in.	18 ft.	15 ft.	177 SF	Protect in Place	1		
1276	<i>Delonix regia</i>	Royal Poinciana	75%	9 in.	20 ft.	18 ft.	254 SF	Protect in Place	1		
1277	<i>Sabal palmetto</i>	Cabbage Palm	65%	11 in.	18 ft.	10 ft.	79 SF	RELOCATE	1		
1278	<i>Sabal palmetto</i>	Cabbage Palm	65%	11 in.	18 ft.	10 ft.	79 SF	RELOCATE	1		
1279	<i>Dyopsis lutescens</i>	Areca Palm	60%	15 in.	8 ft.	5 ft.	20 SF	Protect in Place	0	Cluster - <10' ht.	
1280	<i>Dyopsis lutescens</i>	Areca Palm	60%	7 in.	6 ft.	5 ft.	20 SF	Protect in Place	0	Cluster - <10' ht.	
1281	<i>Dyopsis lutescens</i>	Areca Palm	60%	7 in.	6 ft.	5 ft.	20 SF	Protect in Place	0	Cluster - <10' ht.	
1282	<i>Dyopsis lutescens</i>	Areca Palm	60%	8 in.	6 ft.	5 ft.	20 SF	Protect in Place	0	Cluster - <10' ht.	
1283	<i>Dyopsis lutescens</i>	Areca Palm	60%	24 in.	6 ft.	5 ft.	20 SF	Protect in Place	0	Cluster - <10' ht.	
1284	<i>Dyopsis lutescens</i>	Areca Palm	60%	30 in.	6 ft.	5 ft.	20 SF	Protect in Place	0	Cluster - <10' ht.	
1285	<i>Dyopsis lutescens</i>	Areca Palm	60%	30 in.	6 ft.	5 ft.	20 SF	Protect in Place	0	Cluster - <10' ht.	
1286	<i>Dyopsis lutescens</i>	Areca Palm	60%	10 in.	6 ft.	5 ft.	20 SF	Protect in Place	0	Cluster - <10' ht.	
1287	<i>Ficus elastica 'Decora'</i>	Indian Rubber Tree	85%	48 in.	45 ft.	70 ft.	3848 SF	Protect in Place	2	Specimen	
1288	<i>Albizia julibrissin</i>	Mimosa Tree	65%	12 in.	30 ft.	25 ft.	491 SF	REMOVE	0	Cat. I Invasive	0 in.
1289	<i>Albizia julibrissin</i>	Mimosa Tree	65%	12 in.	30 ft.	25 ft.	491 SF	REMOVE	0	Cat. I Invasive	0 in.
1293	<i>Lagerstroemia speciosa</i>	Queen Crape Myrtle	75%	20 in.	18 ft.	15 ft.	177 SF	Protect in Place	2	Multi-Trunk	
1294	<i>Albizia julibrissin</i>	Mimosa Tree	75%	12 in.	30 ft.	25 ft.	491 SF	Protect in Place	0		
1295	<i>Podocarpus gracilior</i>	Weeping Podocarpus	70%	15 in.	22 ft.	18 ft.	254 SF	Protect in Place	2	Specimen	
1296	<i>Podocarpus gracilior</i>	Weeping Podocarpus	65%	10 in.	20 ft.	15 ft.	177 SF	Protect in Place	1		
1297	<i>Lagerstroemia speciosa</i>	Queen Crape Myrtle	75%	20 in.	18 ft.	15 ft.	177 SF	Protect in Place	2	Multi-Trunk	
1298	<i>Bursera simaruba</i>	Gumbo Limbo	75%	16 in.	25 ft.	20 ft.	314 SF	Protect in Place	2	Specimen	
1299	<i>Bischofia javanica</i>	Bishop Wood	80%	30 in.	35 ft.	35 ft.	962 SF	REMOVE	0	Cat. I Invasive	0 in.
1300	<i>Washington Fan Palm</i>	Washingtonia robusta	85%	12 in.	30 ft.	10 ft.	79 SF	REMOVE	0	Cat. II Invasive	0 in.
1301	<i>Tabebuia roseo 'Alba'</i>	White Trumpet Tree	70%	5 in.	15 ft.	10 ft.	79 SF	REMOVE	1		5 in.
1391	<i>Tabebuia roseo 'Alba'</i>	White Trumpet Tree	65%	5 in.	18 ft.	10 ft.	79 SF	REMOVE	1		5 in.
1392	Missing	Unknown	MISSING	5 in.	18 ft.	10 ft.	79 SF	MISSING	1	Mitigate for removal	5 in.
1393	<i>Lagerstroemia speciosa</i>	Queen Crape Myrtle	50%	5 in.	16 ft.	12 ft.	113 SF	Protect in Place	1	Sparse canopy	
1394	<i>Lagerstroemia speciosa</i>	Queen Crape Myrtle	45%	5 in.	16 ft.	12 ft.	113 SF	Protect in Place	1	Sparse canopy	
1395	<i>Tabebuia roseo 'Alba'</i>	White Trumpet Tree	75%	4 in.	16 ft.	8 ft.	50 SF	RELOCATE	1		
1396	<i>Tabebuia roseo 'Alba'</i>	White Trumpet Tree	70%	4 in.	16 ft.	8 ft.	50 SF	Protect in Place	1		
1397	<i>Tabebuia roseo 'Alba'</i>	White Trumpet Tree	55%	4 in.	16 ft.	8 ft.	50 SF	Protect in Place	1		
1398	<i>Tabebuia roseo 'Alba'</i>	White Trumpet Tree	55%	4 in.	16 ft.	8 ft.	50 SF	Protect in Place	1		
1399	<i>Tabebuia roseo 'Alba'</i>	White Trumpet Tree	60%	4 in.	16 ft.	8 ft.	50 SF	Protect in Place	1		
1400	<i>Tabebuia roseo 'Alba'</i>	White Trumpet Tree	65%	4 in.	16 ft.	8 ft.	50 SF	Protect in Place	1		
1401	<i>Tabebuia roseo 'Alba'</i>	White Trumpet Tree	65%	4 in.	16 ft.	8 ft.	50 SF	Protect in Place	1		
1402	<i>Tabebuia roseo 'Alba'</i>	White Trumpet Tree	65%	4 in.	16 ft.	8 ft.	50 SF	Protect in Place	1		
1403	<i>Tabebuia roseo 'Alba'</i>	White Trumpet Tree	75%	4 in.	16 ft.	8 ft.	50 SF	Protect in Place	1		
1404	<i>Tabebuia roseo 'Alba'</i>	White Trumpet Tree	70%	4 in.	16 ft.	8 ft.	50 SF	Protect in Place	1		
1405	<i>Tabebuia roseo 'Alba'</i>	White Trumpet Tree	55%	4 in.	16 ft.	8 ft.	50 SF	Protect in Place	1		
1406	<i>Tabebuia roseo 'Alba'</i>	White Trumpet Tree	75%	4 in.	16 ft.	8 ft.	50 SF	Protect in Place	1		
1407	<i>Tabebuia roseo 'Alba'</i>	White Trumpet Tree	65%	4 in.	16 ft.	8 ft.	50 SF	Protect in Place	1		
1408	<i>Tabebuia roseo 'Alba'</i>	White Trumpet Tree	70%	4 in.	16 ft.	8 ft.	50 SF	RELOCATE	1		

TREE/ PALM PROTECTION FENCES SHALL BE CONSTRUCTED PRIOR TO ANY CONSTRUCTION ACTIVITY INCLUDING GRUBBING FOR ALL TREES/PALMS THAT ARE TO REMAIN, BE PROTECTED OR BE RELOCATED'

NO ACTIVITY OR DISTURBANCE SHOULD OCCUR WITHIN THE FENCED AREAS, INCLUDING VEHICLE USE, STORAGE OF MATERIALS, DUMPING OF LIQUIDS OR MATERIALS, GRADE CHANGES, GRUBBING, AND MECHANICAL TRENCHING FOR IRRIGATION, ELECTRICAL, LIGHTING, ETC.

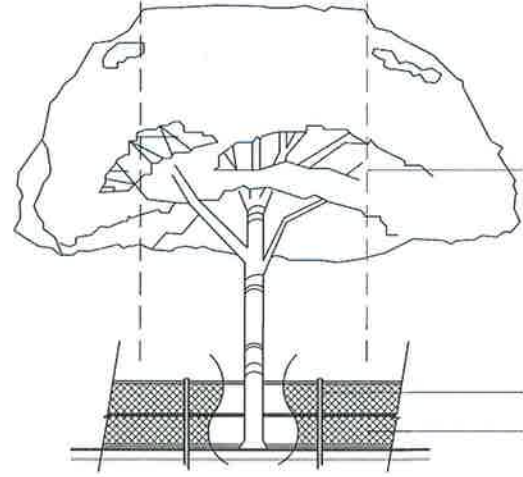

IN NO CASE SHALL THE FENCE BE INSTALLED LESS THAN TEN FEET FROM THE TRUNK

TREE + PALM PROTECTION BARRIERS TO EXTEND BEYOND THE 'DRIFLINE' OR TO THE 'CRITICAL ROOT ZONE AREA' OF ALL TREES/PALMS TO BE PROTECTED. EXTEND WHERE NECESSARY TO PROTECT TREE CANOPY ROOTS

BARRIERS SHALL BE A MINIMUM OF FOUR FEET HIGH, AND SHALL BE CONSTRUCTED OF CONTINUOUS CHAIN LINK FENCE WITH METAL POSTS AT EIGHT-FOOT SPACING OR 2"x4" POSTS WITH THREE EQUALLY SPACED 2"x4" RAILS. POSTS MAY BE SHIFTED TO AVOID ROOTS.

PROTECTION DETAIL NOTE: CONTRACTOR TO INSTALL 'TREE/PALM PROTECTION FENCE BARRIERS' AROUND ALL EXISTING TREES OR PALMS AT THE START OF THE PROJECT. BARRIERS TO REMAIN IN PLACE THROUGHOUT THE DURATION OF THE PROJECT AND SHOULD NOT BE REMOVED OR DROPPED FOR ANY REASON WITHOUT AUTHORIZATION FROM THE CITY OF MIAMI BEACH URBAN FORESTER + PLANNING + ZONING DEPARTMENT

1 CITY OF MIAMI BEACH  
TREE PROTECTION DETAIL

KEY PLAN (NOT TO SCALE):

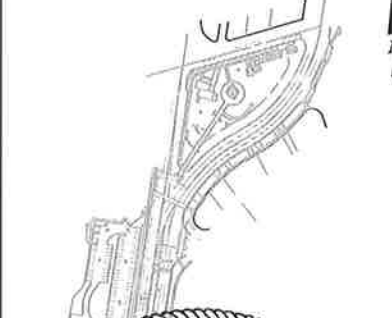

PROPOSED MITIGATION:	
Total Mitigation Required:	21 in.
Total Mitigation Proposed:	
(1) Live Oak @ 2" ea.	2 in.
(6) Silver Buttonwood @ 2" ea.	12 in.
(4) Spanish Stopper @ 2" ea.	8 in.
Total Mitigation Proposed:	22 in.

HPB FINAL SUBMITTAL:  
JANUARY 10, 2023



CITY MANAGER: ALINA T. HUDAK  
DIRECTOR: JOE GOMEZ, PE  
CITY ENGINEER: CRISTINA ORTEGA, PE, ENV SF

NO.	DATE	REVISION	APP'D. BY
5			
4			
3			
2			
1			



ENGINEER OF RECORD: NICOLE D. PASTRE  
FL R.L.A. NO. 6667397

ENGINEER OF RECORD: NDP  
DESIGN ENGINEER: NDP  
DRAWN BY: NDP  
CHECKER: SMP  
SCALE: AS NOTED

NEIGHBORHOOD: PS 28 DETAILED DESIGN SERVICES  
TITLE: TREE DISPOSITION PLAN

File Name: 49000-025-ID-2.dwg  
Survey Reference:  
Field Book: N/A Page: N/A Work Order: N/A  
Date: 09/2022 Sheet: 2 of 2 Drawing: ID-2



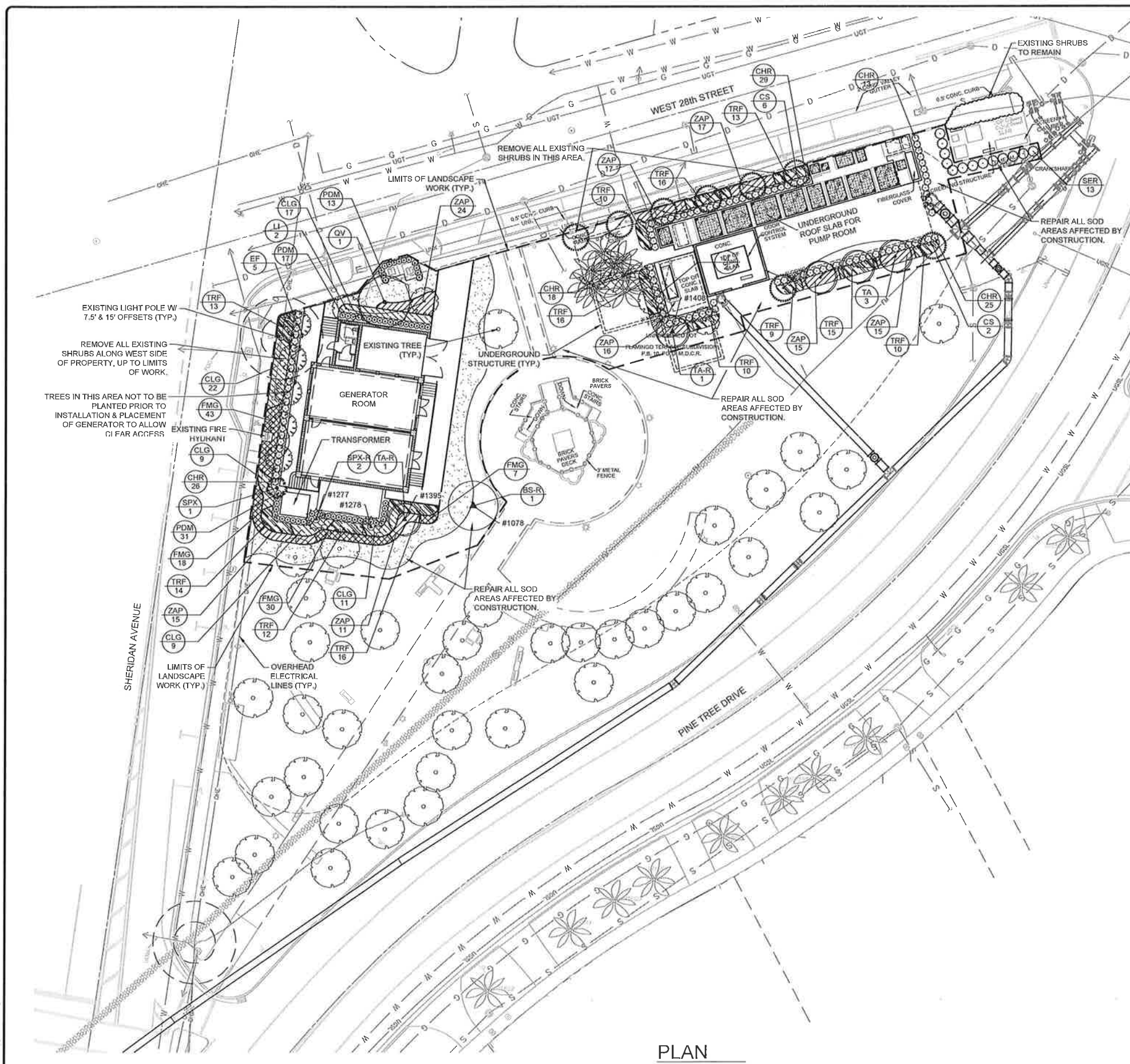

PLANT SCHEDULE						
TREES	CODE	QTY	BOTANICAL NAME	COMMON NAME	SPECIFICATIONS	
	CS	8	Conocarpus erectus sericeus Standard Form	Silver Buttonwood	2" Cal., 12' Hl. x 5' Sprd.	
	EF	5	Eugenia foetida	Spanish Stopper	2" Cal., 10' Hl. x 4' Sprd.	
	LI	4	Lagerstroemia indica 'Tuskegee' Multi-Trunk	Crape Myrtle	2" Cal., 10' Hl. x 5' Sprd.	
	QV	1	Quercus virginiana	Live Oak	2" Cal., 12' Hl. x 6' Spr.	
	TA	3	Tabebuia roseo 'Alba'	White Trumpet Tree	2" Cal., 12' Hl. x 5' Sprd.	
RELOCATED TREES/PALMS	CODE	QTY	BOTANICAL NAME	COMMON NAME	SPECIFICATIONS	
	BS-R	1	Bursera Simaruba	RELOCATED Gumbo Limbo	RELOCATED TREE	
	SPX-R	2	Sabal palmetto	RELOCATED Sabal Palm	RELOCATED PALM	
	TA-R	2	Tabebuia roseo 'Alba'	RELOCATED White Trumpet Tree	RELOCATED TREE	
PALMS	CODE	QTY	BOTANICAL NAME	COMMON NAME	SPECIFICATIONS	
	SPX	1	Sabal palmetto STAGGERED	Sabal Palm	20' - 25' OA. HT.	
SHRUBS	CODE	QTY	BOTANICAL NAME	COMMON NAME	SPECIFICATIONS	
	CHR	111	Chrysobalanus icaco 'Red Tip'	Red Tip Cocoplum	24" HT X 24" SPRD.	
	PDM	61	Podocarpus macrophyllus Full to Ground	Yew Pine	36" Hl. x 24" Sprd.	
	SER	13	Serenoa repens 'Cinerea'	Silver Saw Palmetto	36" HT. X 36" SPRD.	
SHRUB AREAS	CODE	QTY	BOTANICAL NAME	COMMON NAME	SPECIFICATIONS	SPACING
	CLG	68	Clusia gulfifera	Small Leaf Clusia	24" HT X 24" SPRD.	30" o.c.
	FMG	98	Ficus microcarpa 'Green Island'	Green Island Ficus	15" HT. X 15" SPRD.	20" o.c.
	TRF	154	Tripsacum floridanum	Florida Gamagrass	24" HT X 24" SPRD.	24" o.c.
	ZAP	130	Zamia pumila	Coontie	18" HT X 18" SPRD	24" o.c.
GROUND COVERS	CODE	QTY	BOTANICAL NAME	COMMON NAME	SPECIFICATIONS	SPACING
	SOD	As Needed	Stenotaphrum secundatum	St. Augustine Grass	SOD	

NOTES:  
 1. EXISTING SITE PLAN IS BASED UPON DRAWINGS PREPARED BY STONER AND ASSOCIATES, INC. TITLED "SKETCH OF TOPOGRAPHIC, UTILITY AND SPECIFIC PURPOSE (TREE) SURVEY WASTE WATER PUMP STATION NO. 2" DATED 6/6/2022.



KEY PLAN (NOT TO SCALE):

P.E. REGISTERED LANDSCAPE ARCHITECT  
 NICOLE DIANA PASTRE  
 LA 6667397  
 STATE OF FLORIDA

PLAN  
 SCALE: 1"=20'

HPB FINAL SUBMITTAL:  
 JANUARY 10, 2023

MIAMI BEACH  
 PUBLIC WORKS DEPARTMENT  
 1700 CONVENTION CENTER DRIVE, MIAMI BEACH, FL 33139

CITY MANAGER: ALINA T. HUDAK  
 DIRECTOR: JOE GOMEZ, PE  
 CITY ENGINEER: CRISTINA ORTEGA, PE, ENV SP

NO.	DATE	REVISION	APP'D. BY
5			
4			
3			
2			
1			

**Hazen**  
 HAZEN AND SAWYER  
 999 P.O. BOX 999 LEON BLVD SUITE 1150  
 CORAL GABLES, FLORIDA 33134  
 LICENSE NO. 2721

ENGINEER OF RECORD: NICOLE D. PASTRE  
 FL R.L.A. NO. 6667397  
 ENGINEER OF RECORD: NDP  
 DESIGN ENGINEER: NDP  
 DRAWN BY: NDP  
 CHECKER: NDP  
 SCALE: AS NOTED

NEIGHBORHOOD: PS 28 DETAILED DESIGN SERVICES  
 TITLE: LANDSCAPE PLAN

File Name: 49000-025-LP-1.dwg  
 Survey Reference:  
 Field Book: N/A Page: N/A Work Order: N/A  
 Date: 09/2022 Sheet: 1 of 3 Drawing: LP-1

L:\s\work\19\2023\12\10 PM By: NPASTRE  
 P:\work\19\2023\12\10 PM By: NPASTRE

90% DESIGN SUBMITTAL - NOT FOR CONSTRUCTION



NOTE:  
ALL RELOCATED TREES AND PALMS SHALL BEAR SAME RELATION TO FINISH GRADE AS IT BORE TO PREVIOUS EXISTING GRADE.

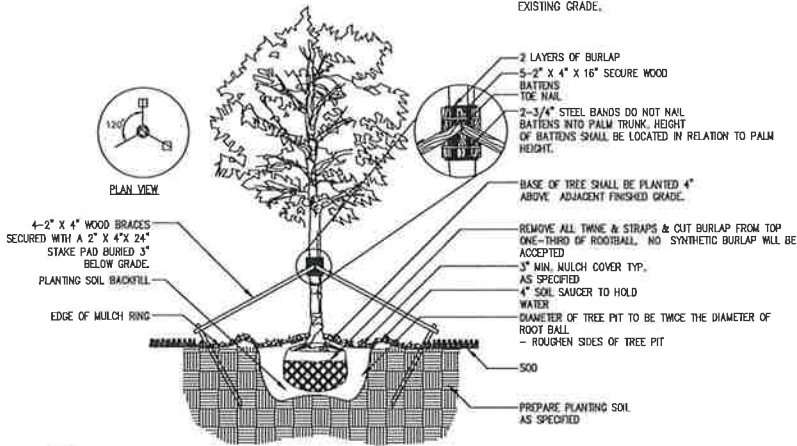

1 TREE SECTION NTS

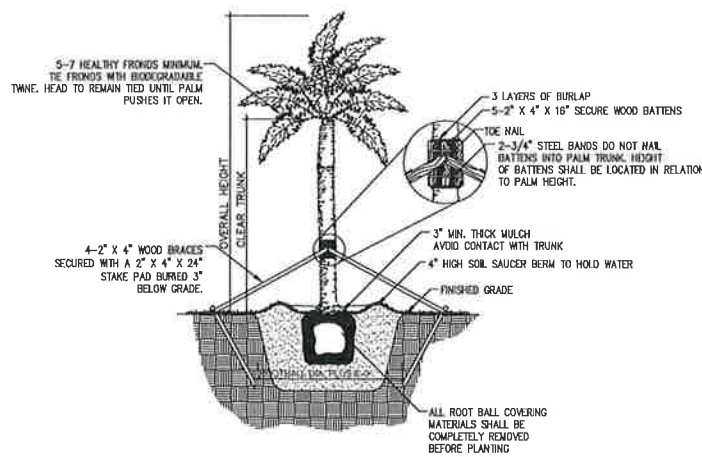

2 PALM (TYPICAL) SECTION NTS

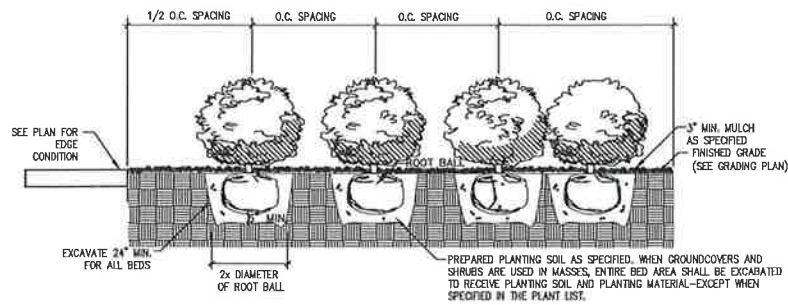

4 SHRUB PLANTING SECTION NTS

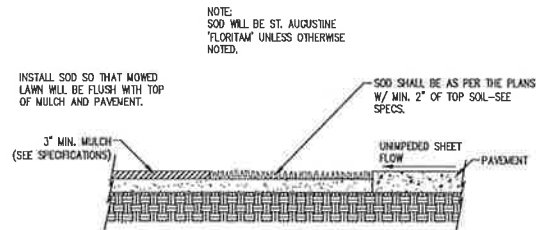

5 SOD INSTALLATION SECTION NTS

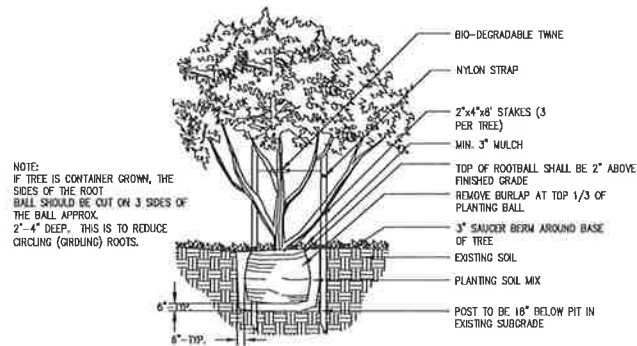

3 SMALL TREE SECTION NTS

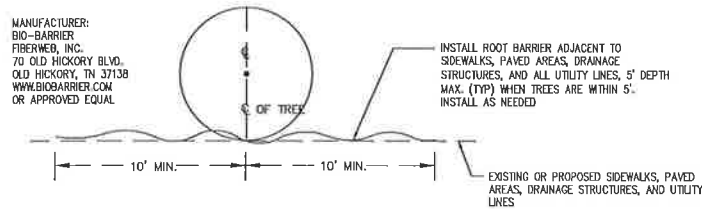

6 ROOT BARRIER INSTALLATION SECTION NTS

LANDSCAPE DATA - PUMP STATION NO. 28		
Site Location:	300 W. 26th Street	
Zoning:	GU (Civic & Government Use)	
Site Area (area of work only):	00.39 Acres	17,114.97 SF
<b>Sec. 126-6 - Minimum Standards</b>		
<b>Landscape Standards for lots and sites - required landscaping buffer and street trees adjacent to public rights-of-way</b>		
(a) Trees	Street trees shall be provided at 20' on center:	
	West 28th Street - 178.3 LF	9 Trees Min. 9 Trees (2 ex. + 3 new)
	Sheridan Avenue - 89.5 LF (overhead high voltage transmission lines)	5 Trees Min. 5 Trees
(b) Lawn grass/sod area	Maximum permitted lawn grass/sod area shall be 20% of open space	
	Total open space:	4,813 SF
	4,813 sf open space X 20% =	963 SF
(c) Min. number of trees	22 Trees required per acre of net lot area	
	0.39 acres x 22 =	9 Trees Min. 14 Trees
(c)(7) Native species	No less than 30% of the req'd trees shall be native	
	23 required trees X 30% =	7 Trees Min. 15 Trees
(c)(8) Low maint/drought tolerant	No less than 50% of the req'd trees shall be low maintenance or drought & salt tolerant species	
	23 total required trees X 50% =	12 Trees Min. 23 Trees
(c)(9) Diversity of tree species	21 to 30 req'd trees = 6 tree species	
		6 min. 6 species
(d) Shrubs	Min. 12 shrubs per number of req'd lot & street trees	
	23 required trees X 12 =	276 Shrubs Min. 635 Shrubs
	No less than 50% of the req'd shrubs shall be native	
	276 total required shrubs X 50% =	138 Shrubs Min. 276 Shrubs
	No one species shall constitute more than 25% of the total shrubs	
	635 total required shrubs X 25% =	159 Max. 154 Florida Gamagrass
<b>Notes:</b>		
* No new areas of sod are being added to the site, only restored to existing conditions		

KEY PLAN (NOT TO SCALE):

REGISTERED LANDSCAPE ARCHITECT  
NICOLE DIANA PASTRE  
LA 6667397  
STATE OF FLORIDA

HPB FINAL SUBMITTAL:  
JANUARY 10, 2023

<p>PUBLIC WORKS DEPARTMENT 1700 CONVENTION CENTER DRIVE, MIAMI BEACH, FL 33139</p>	<p>CITY MANAGER: ALINA T. HUDAK DIRECTOR: JOE GOMEZ, PE CITY ENGINEER: CRISTINA ORTEGA, PE, ENV SF</p>	5				<p>HAZEN AND SAWYER 999 PRINCETON AVE, SUITE 1150 CORAL GABLES, FLORIDA 33134 LICENSE NO. 2711</p>	<p>ENGINEER OF RECORD: NICOLE D. PASTRE FL R.L.A. NO. 6667397</p>	<p>ENGINEER OF RECORD: NDP DESIGN ENGINEER: NDP DRAWN BY: NDP CHECKER: SMP SCALE: AS NOTED</p>	<p>NEIGHBORHOOD: PS 28 DETAILED DESIGN SERVICES</p>	<p>TITLE: LANDSCAPE DETAILS</p>	File Name: 49000-025-LP-2.dwg
		NO.	DATE	REVISION	APP'D. BY						Survey Reference:

List saved: 1/10/2023 12:17 PM by: NPASTRE  
 Printed: 1/10/2023 12:21 PM by: NPASTRE

90% DESIGN SUBMITTAL - NOT FOR CONSTRUCTION



# GENERAL NOTES

- A PRE-CONSTRUCTION MEETING WITH THE CITY OF MIAMI BEACH IS REQUIRED PRIOR TO LANDSCAPING ACTIVITIES INCLUDING REMOVAL OF TREES AND/OR INSTALLATION OF PLANT MATERIAL. CALL 954-797-1072 A MINIMUM OF 5 DAYS PRIOR TO DESIRED START DATE TO SCHEDULE PRE-CONSTRUCTION MEETING.
- ALL EXISTING TREES PROPOSED TO REMAIN ARE TO BE SEPARATED FROM THE LIMITS OF DISTURBANCE OF THE CONSTRUCTION AREA BY TREE PROTECTION FENCING AND SIGNAGE. THE TREE PROTECTION FENCING SHALL BE LOCATED AT THE EDGE OF THE TREE PROTECTION ZONE AS DEPICTED ON THE PLAN OR AT THE EDGE OF THE DRIP LINE(S) IF A TREE PROTECTION ZONE IS NOT DESIGNATED, NO MATERIAL STORAGE OR CONSTRUCTION ACCESS IS PERMITTED WITHIN THE TREE PROTECTION ZONE.
- ALL EXISTING TREES SHALL BE PRUNED TO ANSI A-300 STANDARDS TO CORRECT POTENTIAL HAZARDS.
- A TREE REMOVAL PERMIT IS REQUIRED PRIOR TO REMOVAL OR RELOCATION OF ANY TREE OR PALM. CONTACT THE CITY OF MIAMI BEACH TO OBTAIN PERMIT INFORMATION.
- LANDSCAPE CONTRACTOR SHALL NOTIFY SUNSHINE ONE CALL OF FLORIDA, INC. AT 1-800-432-4770 A MINIMUM OF 2 FULL BUSINESS DAYS PRIOR TO DIGGING. LANDSCAPE CONTRACTOR IS RESPONSIBLE FOR AVOIDING DAMAGE TO UTILITIES FROM PLANT INSTALLATION.
- TREE RELOCATIONS:
  - EXISTING TREES TO BE RELOCATED SHALL BE ROOT PRUNED A MINIMUM OF 120 DAYS PRIOR TO RELOCATION
  - MINIMUM ROOT BALL SIZES SHALL BE IN ACCORDANCE WITH ANSI STANDARDS AS FOLLOWS:
 

CALIPER	MINIMUM ROOT BALL DIAMETER
1	16
2	24
3	32
4	42
5	54
6	60
7	70
8	80
>8	12 INCHES PER INCH OF TRUNK DIAMETER

 TRANSPLANTED TREES WITH UNDERSIZED ROOT BALLS MAY BE REJECTED BY THE CITY AND REPLACEMENT TREES MAY BE REQUIRED.
  - A TEMPORARY IRRIGATION SYSTEM SHALL BE PROVIDED DURING AND FOR THE FIRST 40 DAYS AFTER ROOT PRUNING.
- ALL PLANTING MUST FOLLOW PLANTING SPECIFICATIONS AND DETAILS SHOWN ON THE PLAN.
- SUBSTITUTIONS OF PLANT SPECIES OR SPECIFICATIONS MUST BE APPROVED IN WRITING BY THE CITY OF MIAMI BEACH PRIOR TO USE.
- ALL PLANT MATERIAL PLANTED PER THIS LANDSCAPE PLAN SHALL BE FLORIDA GRADE #1 OR BETTER, AS SPECIFIED IN THE CURRENT EDITION OF THE FLORIDA DEPARTMENT OF AGRICULTURE'S GRADES AND STANDARDS FOR NURSERY PLANTS. DAMAGED PLANT MATERIAL SHALL BE REJECTED AND REPLACED PRIOR TO INSTALLATION.
- ALL SIZES SHOWN FOR PLANT MATERIAL ARE TO BE CONSIDERED MINIMUMS.
- WHERE QUANTITIES AND/OR SPECIES DIFFER BETWEEN THE PLANTING PLANS AND PLANT LISTS, THE PLANS SHALL TAKE PRECEDENCE.
- ALL NEW PLANT MATERIAL SHALL BE WARRANTED BY THE LANDSCAPE CONTRACTOR FOR A MINIMUM PERIOD OF ONE YEAR. THE WARRANTY PERIOD SHALL BEGIN AFTER ACCEPTANCE OF THE PLANTS BY THE CITY.
- PLANT BEDS TO BE TREATED WITH PRE-EMERGENT HERBICIDE PRIOR TO PLANTING
- ALL TREE AND PALM STAKING AND SUPPORT SHALL BE REMOVED ONE YEAR AFTER INSTALLATION.
- ALL LANDSCAPE MATERIAL SHALL BE THOROUGHLY WATERED AT THE TIME OF PLANTING, NO DRY PLANTING PERMITTED.
- LANDSCAPE CONTRACTOR SHALL BE RESPONSIBLE FOR PROVIDING TEMPORARY WATER PROVISIONS UNTIL SUCH TIME AS THE IRRIGATION SYSTEM IS OPERATIONAL.
- ALL WIRE GUYS AND/OR FABRIC STRAPS SHALL BE FLAGGED WITH FLORESCENT COLORED TAPE.
- MULCHING:
  - ALL LANDSCAPE AREAS NOT COVERED BY SOD SHALL BE COVERED BY A MINIMUM 3-INCH LAYER OF MULCH.
  - A MULCH RING WITH A MINIMUM RADIUS OF 24 INCHES (48 INCH DIAMETER), IS REQUIRED AROUND ALL NEWLY INSTALLED TREES AND PALMS.
  - CYPRESS MULCH SHALL NOT BE USED.
  - NO MULCH SHALL BE PLACED TOUCHING OR WITHIN SIX INCHES OF THE TRUNK OF A TREE OR PALM.
- ALL NEWLY LANDSCAPED AREAS SHALL BE EXCAVATED DOWN TO A DEPTH OF 24 INCHES BELOW FINAL GRADE AND BACK FILLED WITH CLEAN DEBRIS-FREE SOIL. EXISTING SOIL MAY BE RE-USED FOR BACKFILLING IF DEBRIS IS REMOVED AND ORGANIC CONTENT IS AT LEAST 30% OR SOIL IS AUGMENTED WITH TOPSOIL TO GET TO 30% ORGANIC CONTENT. CONSTRUCTION ACCESS SHALL BE RESTRICTED FROM THE LANDSCAPE AREA AFTER EXCAVATION AND BACKFILL IS COMPLETE. A MINIMUM OF 2" OF SOIL SHALL BE PLACED UNDER SOD AREAS AND A MINIMUM OF 6" PLACED IN PLANTING BEDS.
- ALL LANDSCAPE AREAS SHALL BE FINISH GRADED SUCH THAT THEY ARE A MINIMUM OF 3.5 INCHES BELOW SURROUNDING PAVED SURFACES SO AS NOT TO IMPEDE THE FLOW OF DRAINAGE INTO LANDSCAPED AREAS AND TO ALLOW FOR A 3-INCH MULCH LAYER.
- THE LOCATION OF PLANT MATERIAL AS SHOWN ON THESE PLANS IS FINAL. THE FINAL LOCATIONS CAN BE ADJUSTED ON SITE TO ACCOMMODATE UNFORESEEN FIELD CONDITIONS. THESE CHANGES MUST COMPLY WITH ALL SAFETY SETBACK CRITERIA AND BE DIRECTED OR APPROVED BY THE LANDSCAPE ARCHITECT AND THE CITY OF MIAMI BEACH CODES.
- REPORT ANY AND ALL DISCREPANCIES BETWEEN THE CONSTRUCTION DRAWINGS AND FIELD CONDITIONS TO THE LANDSCAPE ARCHITECT IMMEDIATELY.
- THE CONTRACTOR IS RESPONSIBLE FOR VERIFYING ALL PLANT COUNTS AND REPORT ANY DISCREPANCIES TO THE LANDSCAPE ARCHITECT PRIOR TO CONSTRUCTION.
- BEFORE CONSTRUCTION BEGINS THE CONTRACTOR IS RESPONSIBLE FOR LOCATING ALL UNDERGROUND UTILITIES AND SHALL AVOID DAMAGE TO ALL UTILITIES DURING CONSTRUCTION. IF SUCH DAMAGE OCCURS THE CONTRACTOR IS RESPONSIBLE FOR ANY NECESSARY REPAIRS AND THEY SHOULD BE MADE IMMEDIATELY AT THE CONTRACTORS EXPENSE WITH SUPERVISION OF THE LANDSCAPE ARCHITECT.
- ALL WORK MUST COMPLY WITH THE FLORIDA STATE STATUTE 553.81- "PROTECTION OF UNDERGROUND PIPELINES."

- THE CONTRACTOR MUST COMPLY WITH ALL STATE AND LOCAL WATER QUALITY STANDARDS.
- THE LOCATION OF ALL THE UTILITIES SHOWN ON THE PLAN IS APPROXIMATE. THE EXACT LOCATION SHALL BE DETERMINED BY THE CONTRACTOR ON SITE. ALL PLANTING MAY BE ADJUSTED TO AVOID CONFLICTS WITH UTILITIES AND/OR EXISTING ABOVE GROUND ELEMENTS. ANY ADJUSTMENTS GREATER THAN 10 FEET SHALL BE DONE ONLY WITH THE APPROVAL OF THE LANDSCAPE ARCHITECT.
- CAUTION SHOULD BE EXERCISED WHEN WORKING NEAR EXISTING PLANTING AND ANY FURNISHING THAT IS TO REMAIN ON SITE TO PREVENT ANY DAMAGE. ANY SIGNS, STRUCTURES, OR PLANTING SHALL BE REPLACED AT THE CONTRACTORS EXPENSE IF DAMAGED BEYOND USE. DAMAGED BEYOND USE WILL BE DETERMINED BY THE LANDSCAPE ARCHITECT.
- ANY PUBLIC LAND CORNER WITHIN THE LIMITS OF CONSTRUCTION IS TO BE PROTECTED. IF A CORNER MONUMENT IS IN DANGER OF BEING DESTROYED AND HAS NOT BEEN PROPERLY REFERENCED, THE CONTRACTOR SHALL NOTIFY THE DISTRICT LOCATION SURVEYOR IMMEDIATELY.
- MAINTENANCE OF TRAFFIC FOR THIS PROJECT SHALL BE IN ACCORDANCE WITH THE MANUAL OF UNIFORM TRAFFIC CONTROL DEVICES FOR STREETS AND HIGHWAYS (U.S. DEPARTMENT OF TRANSPORTATION, F.H.W.A.). ATTENTION IS DIRECTED TO STANDARD INDEX NUMBER 623 OF THE ROADWAY AND TRAFFIC DESIGN STANDARDS.
- THE CONTRACTOR SHALL INSURE THAT INSTALLATION OF ALL PLANTING IN MEDIANS AND RIGHT OF WAYS CONFORMS TO CRITERIA SET FORTH IN F.D.O.T. ROADWAY AND TRAFFIC DESIGN STANDARDS AND IN F.D.O.T. MAINTENANCE RATING PROGRAM.
- ANY MAINTENANCE THAT INVOLVES TRAFFIC ACTIVITY SHALL BE COORDINATED WITH THE CONTRACTOR AND ONGOING CONSTRUCTION ACTIVITIES.
- CONTRACTOR IS RESPONSIBLE FOR CLEANING ALL WORK AREAS AT THE END OF EACH WORKING DAY. ANY DEBRIS SHALL BE COLLECTED AND DEPOSITED APPROPRIATELY OFF SITE DAILY. ALL MATERIALS, PRODUCTS, AND EQUIPMENT SHALL BE STORED IN AN ORGANIZED FASHION AS DIRECTED BY THE LANDSCAPE ARCHITECT.
- THE CONTRACTOR IS RESPONSIBLE FOR OBTAINING ALL PERMITS THAT ARE REQUIRED BY THE CITY FOR TREE REMOVAL, RELOCATION, TREE PROTECTION OR INSTALLATION BEFORE BEGINNING WORK.
- ALL EXISTING TREES TO REMAIN SHALL BE PROTECTED BY INSTALLING PROTECTIVE BARRIERS AROUND THE DRIP LINE OF TREES. THESE PROTECTIVE BARRIERS SHALL BE SEEN EASILY BY OPERATORS OF TRUCKS AND OTHER EQUIPMENT. THEY SHALL BE CONSTRUCTED OF STURDY MATERIALS (NOT FLAGGING OR RIBBON) AND SHALL BE INSTALLED PRIOR TO AND DURING CONSTRUCTION.
- DO NOT STORE OR USE ANY MATERIALS OR EQUIPMENT WITHIN THE DRIP LINE OF ANY TREE THAT IS TO BE RELOCATED OR PROTECTED IN PLACE UNLESS THE ACTIVITY IS BEING DONE TO PROTECT THE TREES.
- DO NOT DISCHARGE OR CONTAMINATE THE SOIL WITHIN THE DRIP LINE OF ANY OF THE TREES TO BE RELOCATED OR PROTECTED IN PLACE. THIS INCLUDES SUBSTANCES SUCH AS PAINT, OIL, SOLVENTS, PETROLEUM PRODUCTS, ASPHALT, CONCRETE, MORTAR, OR ANY OTHER MATERIAL THAT MAY CAUSE DAMAGE TO THE TREE'S ROOT SYSTEM.
- CLEARING OF VEGETATION WITHIN THE DRIP LINE OF THE TREES DESIGNATED TO BE PROTECTED IN PLACE OR RELOCATED SHALL BE PERFORMED CAUTIOUSLY WITH HAND TOOLS TO MINIMIZE ANY DAMAGE TO THE TREE'S ROOT SYSTEM.
- DO NOT ATTACH ANYTHING TO TREES THAT ARE TO REMAIN ON THE SITE UNLESS IT IS SOMETHING THAT WILL PROTECT AND NOT DAMAGE THE TREE.
- KEEP A NATURAL GRADE ABOVE THE DRIP LINE ON ANY TREE THAT IS TO BE PROTECTED IN PLACE. ANY PRESERVED TREES DISTURBED DURING CONSTRUCTION MUST BE RETURNED TO ITS ORIGINAL GRADE AFTER CONSTRUCTION.
- ALL LANDSCAPE AND LIGHTING WILL BE IN ACCORDANCE WITH ORDINANCE #2011-029 FOR PROTECTION OF SEA TURTLES.
- ALL LANDSCAPE AND PLANTING SHALL COMPLY WITH BROWARD COUNTY LAND USE POLICY 9.03.03 AND WITH CHAPTER 62B-55 OF THE FLORIDA ADMINISTRATIVE CODE.

# CITY OF MIAMI BEACH LANDSCAPE NOTES

- QUANTITIES AND LOCATIONS: THE CITY LANDSCAPE INSPECTOR RESERVES THE RIGHT TO ADJUST THE NUMBER AND LOCATIONS OF THE DESIGNATED TYPES AND SPECIES TO BE USED AT ANY OF THE LOCATIONS SHOWN IN ORDER TO PROVIDE FOR ANY MODIFICATIONS WHICH MIGHT BECOME DESIRABLE TO THE CITY.
- INVESTIGATION OF SUBSURFACE CONDITIONS: THE CONTRACTOR SHALL BE RESPONSIBLE FOR MAKING ON-SITE SURFACE AND SUBSURFACE INVESTIGATIONS AND EXAMINATIONS AS HE OR SHE CHOOSES IN ORDER TO BECOME FAMILIAR WITH THE CHARACTER OF THE EXISTING MATERIAL AND THE CONSTRUCTION CONDITIONS. THESE INVESTIGATIONS AND EXAMINATIONS SHALL BE INCLUDED IN THE BID. THE CONTRACTOR SHALL NOT RECEIVE SEPARATE, ADDITIONAL COMPENSATION FOR THIS WORK.
- EXCAVATION RELATED TO INADEQUATE DRAINAGE: SOME OR ALL WORK AREAS MAY CONTAIN EXISTING MATERIALS SUCH AS BUT NOT LIMITED TO, PEAT, CLAY, LIME ROCK AND POSSIBLY COMPACTED MATERIAL WHICH COULD INTERFERE WITH ADEQUATE VERTICAL DRAINAGE AND/OR PROPER PLANT SURVIVAL AND GROWTH. REMOVAL OF THIS MATERIAL, IN ORDER TO HAVE ADEQUATE VERTICAL DRAINAGE, IS PART OF THE SCOPE OF WORK FOR THE PROJECT. THEREFORE, SUBSURFACE INVESTIGATIONS AND EXAMINATIONS ARE NECESSARY IN ORDER TO DETERMINE THE EXTENT OF REMOVAL AND EXCAVATION REQUIRED ABOVE AND BEYOND THE MINIMUM REQUIREMENTS INDICATED IN THESE TSP. UNDER THE HEADING OF "EXCAVATION OF PLANT HOLES", WHICH IS IN PART 3 SECTION 3.04 (E), COMPENSATION FOR REMOVAL AND EXCAVATION REQUIRED ABOVE AND BEYOND THE MINIMUM REQUIREMENTS INDICATED, INCLUDING ANY ADDITIONAL PLANTING SOIL NEEDED IN ORDER TO FILL THE LARGER EXCAVATED AREA, SHALL BE INCLUDED IN THE PROPOSAL. THE CONTRACTOR SHALL NOT RECEIVE SEPARATE, ADDITIONAL COMPENSATION FOR THIS.
- NO SEPARATE, ADDITIONAL COMPENSATION WILL BE GRANTED BECAUSE OF ANY UNUSUAL DIFFICULTIES WHICH MAY BE ENCOUNTERED IN THE EXECUTION OF ANY PORTION OF THE WORK, INCLUDING TRAFFIC CONTROL AND MAINTENANCE OF TRAFFIC.
- ALL WORK SHALL BE IN COMPLIANCE WITH THE CITY OF MIAMI BEACH LANDSCAPE INSTALLATION SPECIFICATIONS AND STANDARDS.

# LANDSCAPE NOTES

- ALL PLANT MATERIAL FURNISHED BY THE LANDSCAPE CONTRACTOR UNLESS OTHERWISE SPECIFIED SHALL BE FLORIDA NO. 1 GRADE OR BETTER, AND SHALL BE INSTALLED AS SPECIFIED IN "GRADES AND STANDARDS FOR NURSERY PLANTS," PUBLISHED BY THE FLORIDA DEPARTMENT OF AGRICULTURE AND CONSUMER SERVICES. ALL PLANT MATERIAL MUST BE HEALTHY, VIGOROUS MATERIALS, FREE OF PESTS AND DISEASES.
- ALL SIZES SHOWN FOR PLANT MATERIAL ON THE PLAN ARE TO BE CONSIDERED AS MINIMUMS. ALL PLANT MATERIAL MUST MEET OR EXCEED THESE MINIMUM REQUIREMENTS FOR BOTH HEIGHT AND SPREAD. ANY OTHER REQUIREMENTS FOR SPECIFIC SHAPE OR EFFECT AS NOTED ON THE PLAN OR SPECIFICATIONS WILL ALSO BE REQUIRED FOR ACCEPTANCE. ANY SUBSTITUTIONS MUST BE APPROVED BY LANDSCAPE ARCHITECT BEFORE PLANTING.
- THE CONTRACTOR IS RESPONSIBLE FOR ALL PLANTING MEETING SPECIFICATIONS AS NOTED BEFORE INSTALLATION. CONTRACTOR SHALL IMMEDIATELY REMOVE ALL PLANTING THAT DOES NOT MEET SPECIFICATIONS AND BE HELD RESPONSIBLE TO REPLACE IT WITH APPROPRIATE PLANTING.
- IN THE EVENT OF A VARIATION BETWEEN THE PLANT LISTS AND THE ACTUAL QUANTITY OF PLANTS SHOWN, THE PLANS HOLD TRUE.
- ALL ROOT BALLS SHALL CONFORM TO THE SIZE STANDARDS SET FORTH
- CONTRACTOR TO SUBMIT TO THE LANDSCAPE ARCHITECT THE GROWERS AND/OR SITE INSPECTION CERTIFICATE FOR PLANT MATERIALS TWO (2) WEEKS PRIOR TO COMMENCEMENT OF WORK.
- ALL PLANT MATERIALS MUST BE PROTECTED DURING TRANSPORT AND DELIVERY TO THE JOB SITE WITH SHADE CLOTH OR OTHER ACCEPTABLE MEANS OF WINDBURN PREVENTION.
- CONTRACTORS SHALL FIELD VERIFY ALL INFORMATION PRIOR TO INITIATING PLANTING INSTALLATION. ALL EXISTING PLANTING SHALL REMAIN INTACT AND UNDISTURBED UNLESS OTHERWISE NOTED ON THE PLANS.
- LANDSCAPE CONTRACTOR SHALL FIELD STAKE THE LOCATION OF ALL PLANT MATERIAL PRIOR TO INSTALLATION FOR THE REVIEW AND APPROVAL OF THE LANDSCAPE ARCHITECT.
- ALL TREES MUST BE FLORIDA #1, STRAIGHT TRUNKED, FULL HEADED, AND MEET ALL REQUIREMENTS SPECIFIED.
- CONTRACTOR TO GUARANTEE PLANT MATERIAL FOR A FULL YEAR ESTABLISHMENT PERIOD FOLLOWING DATE OF SUBSTANTIAL COMPLETION.
- CONTRACTOR TO REPLACE REJECTED PLANT MATERIAL WITHIN ONE WEEK OF NOTICE.
- CONTRACTOR TO REQUEST INSPECTION OF PROJECT IN WRITING. IF ALL WORK IS SATISFACTORY AND COMPLETE IN ACCORDANCE WITH CONDITIONS OF CONTRACT DOCUMENTS, THEN THE CITY AND LANDSCAPE ARCHITECT SHALL DECLARE SUBSTANTIALLY COMPLETE. SUBSTANTIAL COMPLETION CONSTITUTES THE BEGINNING OF THE GUARANTEE PERIOD.
- INSTALLATION- ALL PLANT MATERIAL SHALL BE INSTALLED IN A SOUND WORKMANLIKE MANNER AND ACCORDING TO GOOD PLANTING PROCEDURES WITH THE QUALITY OF PLANT MATERIALS AS HEREINAFTER DESCRIBED. ALL ELEMENTS OF LANDSCAPING SHALL BE INSTALLED SO AS TO MEET ALL APPLICABLE ORDINANCES AND CODE REQUIREMENTS.
- CONTRACTOR IS RESPONSIBLE FOR WATERING AND MAINTAINING ALL TREES AND LANDSCAPE UNTIL FINAL ACCEPTANCE BY OWNER. CONTRACTOR SHALL INSURE THAT ALL DRAINAGE AND PERCOLATION OF ALL PLANTING PITS PRIOR TO INSTALLATION OF PLANT MATERIAL. CONTRACTOR IS RESPONSIBLE FOR REPLACEMENT OF PLANTS IF DEAD OR DYING PRIOR TO FINAL ACCEPTANCE.
- TYPICALLY, SHRUB AND GROUND COVER PLANTINGS ARE SHOWN AS MASS PLANTING BEDS. PLANTS SHOULD BE PLACED ON A TRIANGULAR SPACING SHOWN IN THE PLANTING DETAILS. PLANT CENTER TO CENTER DIMENSIONS (O.C.) ARE LISTED ON THE PLANT LIST.
- TREES GROWN IN GROW BAGS OR GROW BAG TYPE MATERIAL MUST HAVE THE GROW BAG REMOVED ENTIRELY BEFORE PLANTING.
- ALL PLANT ROOT BALLS SHALL BE 10% ABOVE GRADE AND THE WIRE BASKETS, BURLAP, STRING AND ROPE MUST BE REMOVED PRIOR TO INSTALLATION.
- CONTRACTOR SHALL REFER TO THE LANDSCAPE PLANTING DETAILS, PLANT LIST, GENERAL NOTES, AND ANY OTHER MATERIALS FROM THE LANDSCAPE ARCHITECT FOR COMPLETE LANDSCAPE PLANTING INSTRUCTIONS.
- "BRANCH TOUCHING BRANCH" PROVIDED AT TIME OF INSTALLATION. ALL HEDGES - BOTH COCOPLUM AND SILVER BUTTWOOD TO BE MIN. 24" AT PLANTING AND 36" HIGH WITHIN ONE YEAR.
- THE FOLLOWING GUIDELINES SHALL BE FOLLOWED TO ENSURE SUCCESSFUL TRANSPLANTING OF TREES:
  - ANY TREE BEING RELOCATED SHALL NOT BE UNNECESSARILY DAMAGED DURING REMOVAL, TRANSPORT, OR REPLANTING OF THAT TREE.
  - TREES MUST BE ROOT PRUNED APPROPRIATELY PRIOR TO REMOVAL.
  - DURING AND FOLLOWING TRANSPLANTING THE ROOT BALL MUST BE KEPT MOIST AT ALL TIMES.
  - TRANSPLANTED TREES SHALL BE BRACED AT LEAST ONE FULL YEAR.
  - TRANSPLANTED TREES SHALL NOT BE FERTILIZED AT PLANTING TIME BUT SHALL BE WATERED SUFFICIENTLY UNTIL THE TREE GROWTH IS REESTABLISHED.
  - RELOCATED TREES/PALMS WILL BE MOVED IN ACCORDANCE WITH MINIMUM STANDARDS SET FORTH IN ANSI A-300
  - ALL CROWN PRUNING SHALL BE DONE IN ACCORDANCE WITH NATIONAL ARBORIST ASSOCIATION STANDARDS OR PALM PRUNING IN ACCORDANCE WITH CITY STANDARDS.
- LANDSCAPE CONTRACTOR SHALL REGRADE ALL AREAS DISTURBED BY PLANT REMOVAL, RELOCATION, AND/OR INSTALLATION WORK. LANDSCAPE CONTRACTOR SHALL REPLACE (BY EQUAL SIZE AND QUALITY) ANY AND ALL EXISTING PLANT MATERIAL DISTURBED OR DAMAGED BY PLANT REMOVAL, RELOCATION OR INSTALLATION.
- CONTRACTOR SHALL BE RESPONSIBLE TO REPLACE ALL PORTIONS OF EXISTING LAWN AREAS DAMAGED WHILE COMPLETING PLANTING INSTALLATION WITH SAME GRASS SPECIES TO THE SATISFACTION OF THE LANDSCAPE ARCHITECT.
- GENERAL GRADING TO APPROXIMATELY 1 INCH SHALL BE PROVIDED BY THE CONTRACTOR. ALL FINISHED SITE GRADING AND FINAL DECORATIVE BERM SHAPING SHALL BE PROVIDED BY THE LANDSCAPE CONTRACTOR.
- ALL LANDSCAPE MATERIALS SHALL BE MAINTAINED TO PROVIDE CONTINUOUS CLEAR ZONES FOR SIGHT VISIBILITY FOR PEDESTRIANS AND VEHICULAR TRAFFIC AND LANDSCAPE MAINTENANCE SHALL CONFORM TO STANDARD INDEX 546 CRITERIA SET FORTH IN F.D.O.T. ROADWAY AND TRAFFIC DESIGN STANDARDS.

# SOIL PREPARATION, SOIL MIX, FERTILIZER, & MULCH NOTES:

- ENSURE THAT ALL PLANTING SOIL IS FERTILE, FRIABLE, NATURAL LOAM SURFACE SOIL, REASONABLY FREE OF SUBSOIL, CLAY LUMPS, WEEDS AND OTHER LITTER, AND FREE OF ROOTS, STUMPS AND STONES LARGER THAN ONE INCH IN ANY DIMENSION, AND OTHER EXTRANEIOUS OR TOXIC MATTER HARMFUL TO PLANT GROWTH. SHOULD ANY SOIL AMENDMENT BE NECESSARY, THE CONTRACTOR SHALL BRING THIS TO THE ATTENTION OF THE LANDSCAPE ARCHITECT.
- APPLY APPROVED HERBICIDE- ACCORDING TO MANUFACTURERS RATE AND SPECS WITHIN LIMITS OF ALL AREAS TO BE PLANTED. PROTECT EXISTING PLANTS TO REMAIN FROM OVERSPRAY OR SPRAY WITHIN ROOT ZONE. CONTRACTOR TO ENSURE TOTAL WEED ERADICATION.
- SCARIFY SUBSOIL TO A DEPTH OF 3 INCHES
- PLANTING MIX FOR TREES, SHRUBS, AND GROUNDCOVERS SHALL CONSIST OF A THOROUGHLY BLENDED MIXTURE OF:
  - 50% MUCK
  - 50% SAND
- PLANTING MIX FOR BACKFILL AROUND ROOT BALLS OF PALMS:
  - 90% NATIVE SAND FROM ON SITE OR APPROVED SUBSTITUTE
  - 10% TOPSOIL
- ALL PLANT MATERIAL SHALL RECEIVE A MINIMUM NPK FERTILIZER WITH MINOR TRACE ELEMENTS AND THAT 50% OF THE NITROGEN MUST BE DERIVED FROM AN ORGANIC SOURCE.
- ALL LANDSCAPE ISLANDS AND MEDIANS SHALL BE EXCAVATED TO A DEPTH OF 30" AND BACK FILLED WITH SPECIFIC PLANTING MIX. ALSO LANDSCAPE AREAS OR PLANTERS ALONG THE BUILDINGS REQUIRE EXCAVATION TO A DEPTH OF 12" AND BACKFILLED WITH SPECIFIC PLANTING SOIL MIX. A MINIMUM OF 6" OF TOPSOIL SHALL BE PLACED IN PLANTING BEDS.
- SMOOTH ALL PREPARED TOPSOIL TO 3" EXCEPT WITHIN DRIP LINES OF EXISTING TREES AND 4" BELOW TOP OF SURROUNDING PAVING EDGES. REMOVE ALL ROCKS AND OTHER OBJECTS OVER 1" IN DIAMETER.
- FINISH GRADE ALL PREPARED TOPSOIL AREAS TO A SMOOTH, EVEN SURFACE ASSURING POSITIVE DRAINAGE AWAY FROM THE STRUCTURES AND ELIMINATE ANY LOW AREAS WHICH MAY COLLECT WATER.
- TOPSOIL SHALL NOT BE EXTREMELY ACIDIC OR ALKALINE, NOR CONTAIN ANY TOXIC SUBSTANCE WHICH MAY BE HARMFUL TO PLANT GROWTH. THE PH SHALL BE IN THE RANGE OF 6.5-7.0.
- CONTRACTOR SHALL MULCH ALL PLANTING MATERIAL THROUGHOUT AND COMPLETELY TO A 3 INCH DEPTH WITH CLEAN, WEED FREE, ARSENIC FREE ORGANIC MULCH.
- MINIMUM OF 2" TOPSOIL MUST BE ADDED UNDER ALL SODDED AREAS.
- LANDSCAPE INSPECTOR SHALL BE CALLED TO APPROVE SOIL MIXTURE PRIOR TO INSTALLATION.

# IRRIGATION NOTES:

- XERISCAPE PRINCIPLES HAVE BEEN APPLIED TO THIS LANDSCAPE PLAN AS SPECIFIED IN SFWMID'S XERISCAPE PLANT GUIDE II AND SHALL BE APPLIED ALL THROUGHOUT LANDSCAPE INSTALLATION AND MAINTENANCE.
- THE CONTRACTOR SHALL MAINTAIN TEMPORARY IRRIGATION OR PROVIDE HAND WATERING FOR ALL RELOCATED TREES AND PALMS FROM NOTICE TO PROCEED UNTIL PERMANENT IRRIGATION SYSTEM IS OPERABLE.
- THE IRRIGATION SYSTEM SHALL BE CONFIGURED TO ACCOMMODATE EXISTING TREES AND PALMS.
- ALL LANDSCAPED AREAS MUST BE IRRIGATED IN ACCORDANCE WITH ALL LOCAL COUNTY REQUIREMENTS.
- REMOVE EXISTING IRRIGATION EQUIPMENT WHICH INTERFERES WITH ANY CONSTRUCTION. THIS INCLUDES, BUT IS NOT LIMITED TO, CONTROLLERS, SPRINKLER HEADS, PIPE, QUICK COUPLERS, BACKFLOW PREVENTERS, CONTROL WIRE AND CONDUITS. ADDITIONALLY THE CONTRACTOR IS RESPONSIBLE FOR MAINTAINING THE EXISTING SYSTEM THROUGHOUT THE CONSTRUCTION PROCESS.
- LANDSCAPE CONTRACTOR SHALL COORDINATE ALL PLANTING WORK WITH IRRIGATION WORK. INSPECT IRRIGATION SYSTEM AND INSURE THAT ADEQUATE WATER IS AVAILABLE BEFORE BEGINNING PLANTING OPERATIONS. IRRIGATION SYSTEMS WILL NOT PROVIDE SUFFICIENT QUANTITIES OF WATER FOR NEWLY PLANTED MATERIALS. THE LANDSCAPE CONTRACTOR IS RESPONSIBLE FOR DEEP ROOT HAND WATERING.
- SEE IRRIGATION PLANS FOR ADDITIONAL NOTES AND DETAILS.

KEY PLAN (NOT TO SCALE):

P.E. SEAL

HPB FINAL SUBMITTAL:  
JANUARY 10, 2023

PUBLIC WORKS DEPARTMENT  
1700 CONVENTION CENTER DRIVE, MIAMI BEACH, FL 33139

CITY MANAGER: ALINA T. HUDAK  
DIRECTOR: JOE GOMEZ, PE  
CITY ENGINEER: CRISTINA ORTEGA, PE, ENV SF

NO	DATE	REVISION	APP'D. BY
5			
4			
3			
2			
1			

HAZEN AND SAWYER  
999 Ponce de Leon Blvd, Suite 1150  
Coral Gables, Florida 33134  
License No. 2711

ENGINEER OF RECORD:  
NICOLE D. PASTRE  
FL R.L.A. NO. 6667397

ENGINEER OF RECORD: NDP  
DESIGN ENGINEER: NDP  
DRAWN BY: NDP  
CHECKER: SMP  
SCALE: AS NOTED

NEIGHBORHOOD: PS 28 DETAILED DESIGN SERVICES  
TITLE: LANDSCAPE NOTES

File Name: 49000-025-LP-3.dwg
Survey Reference:
Field Book: N/A Page: N/A Work Order: N/A
Date: 09/2022 Sheet: 2 of 3 Drawing: LP-3

DATE PLOTTED: 12/21/23 12:15 PM BY: NIPASTRE  
PLOTTED: 12/21/23 12:22 PM BY: NIPASTRE

90% DESIGN SUBMITTAL - NOT FOR CONSTRUCTION