

# LOCATION SKETCH

## FLORIDA INTERNATIONAL LAND SURVEYORS, INC.

5881 NW. 151th. STREET, SUITE 213  
MIAMI LAKES, FLORIDA 33014  
PH.(305) 468-9650 FAX: (305) 828-2315

**SUBJECT  
SITE**

SCALE: N.T.S

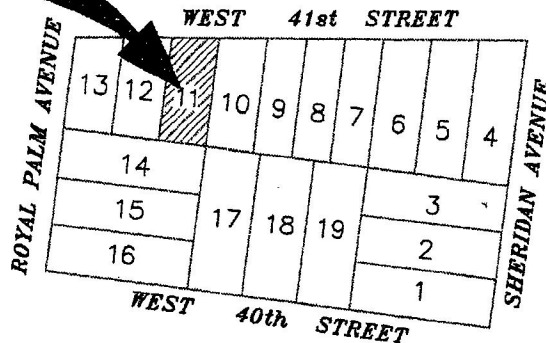

### NATIONAL FLOOD INSURANCE DATA:

Community-Panel No.: 120651-0309-L

Flood Zone: A-E

Base Flood Elevation: 7.00 Feet

Firm Date : 09/11/09

### LEGAL DESCRIPTION:

Lots 11, in Block 54 of "ORCHARD SUBDIVISION No 2 AND 3", according to the plat thereof, as recorded in Plat Book 26, at Page 52 of the Public Records of Miami-Dade County, Florida.

### SURVEYOR'S CERTIFICATION

I HEREBY CERTIFY: that the attached BOUNDARY SURVEY of the above described property is correct to the best of my knowledge and belief as recently surveyed under my direction, and that there are no encroachments other than those shown, and meets the intent of the Minimum Technical Standards set forth by the Florida Board of Professional Land Surveyors and Mappers in Chapter 5J-17, Florida Administrative Code, pursuant to Section 472.027 of Florida Statutes

### SURVEYOR'S NOTES:

- 1.- Legal description was furnished by the client.
- 2.- Examination of Abstract of Title will have to be made to determined recorded instruments, the property.
- 3.- Legal description subject to any dedication, limitations, restrictions, reservation, or easements of record.
- 4.- Bearings, if any, shown hereon are based upon an assumed value. N/A
- 5.- Elevations if any, shown hereon are relative to N.G.V.D.
- 6.- Underground improvements and utilities, if any, not located.
- 7.- Fences ownership by visual means only. Legal ownership not determined.
- 8.- This has been prepared for the exclusive use of the entities named hereon and the certification does not extended to any unnamed party.
- 9.- This survey does not reflect any existing improvement of any kind that maybe hidden and therefore not ascertainable by visual inspection as a result of overgrowth vegetation or fill material in the subject property.
- 10.- Additions or delations to survey maps or reports by other the signed party or parties is prohibited without written consent of the signing party or parties.
- 11.- Not valid unless sealed with an embossed surveyor's seal.

### LEGEND

CBS Concrete Block Structure  
(R) Record Measurements  
(F) Field Measurements  
WPP Wood Power Pole  
LP Light Pole  
OH Overhead Line  
EB Electric Box  
WM Water Meter  
CB Catch Basin  
EB Electric Box

WM Water Meter  
CB Catch Basin  
WF Wood Fence  
PL Planter  
NTS. Not to scale  
Denotes Concrete  
Denotes Asphalt  
Denotes Brick  
Denotes Tile

FLORIDA INTERNATIONAL LAND SURVEYORS, INC. (LB #2668)

BY:   
VICENTE A. TOME  
Reg. Land Surveyor No. 3103  
State of Florida.

JOB.No.: 289-15

F.B.No.: SCHERMER

DATE: 12-5-15

Drawn: LLC

Sheet 1 of 1 Sheet

# BOUNDARY SURVEY



WEST 41st STREET

