

# ELEVATION CERTIFICATE

21-003858EC

**Important:** Follow the instructions on pages 1–9.

Copy all pages of this Elevation Certificate and all attachments for (1) community official, (2) insurance agent/company, and (3) building owner.

SECTION A – PROPERTY INFORMATION				FOR INSURANCE COMPANY USE	
A1. Building Owner's Name <b>FREDERIC CUMENAL AND LESLIE DIAMOND</b>				Policy Number:	
A2. Building Street Address (including Apt., Unit, Suite, and/or Bldg. No.) or P.O. Route and Box No. <b>1600 CLEVELAND ROAD</b>				Company NAIC Number:	
City <b>MIAMI BEACH</b>		State <b>FLORIDA</b>		ZIP Code <b>33141</b>	
A3. Property Description (Lot and Block Numbers, Tax Parcel Number, Legal Description, etc.) <b>LOT 30, BLOCK 5 BISCAYNE POINT ACCORDING TO THE PLAT THEREOF, AS RECORDED IN PLAT BOOK 14, PAGE 35 OF THE PUBLIC RECORDS OF MIAMI-DADE COUNTY, FLORIDA.</b>					
A4. Building Use (e.g., Residential, Non-Residential, Addition, Accessory, etc.) <u><b>RESIDENTIAL</b></u>					
A5. Latitude/Longitude: Lat. <u><b>25° 51' 51.60 N</b></u> Long. <u><b>80° 8' 11.30 W</b></u> Horizontal Datum: <input type="checkbox"/> NAD 1927 <input checked="" type="checkbox"/> NAD 1983					
A6. Attach at least 2 photographs of the building if the Certificate is being used to obtain flood insurance.					
A7. Building Diagram Number <u><b>1B</b></u>					
A8. For a building with a crawlspace or enclosure(s):					
a) Square footage of crawlspace or enclosure(s) <u><b>N/A</b></u> sq ft					
b) Number of permanent flood openings in the crawlspace or enclosure(s) within 1.0 foot above adjacent grade <u><b>N/A</b></u>					
c) Total net area of flood openings in A8.b <u><b>N/A</b></u> sq in					
d) Engineered flood openings? <input type="checkbox"/> Yes <input checked="" type="checkbox"/> No					
A9. For a building with an attached garage:					
a) Square footage of attached garage <u><b>N/A</b></u> sq ft					
b) Number of permanent flood openings in the attached garage within 1.0 foot above adjacent grade <u><b>N/A</b></u>					
c) Total net area of flood openings in A9.b <u><b>N/A</b></u> sq in					
d) Engineered flood openings? <input type="checkbox"/> Yes <input checked="" type="checkbox"/> No					
SECTION B – FLOOD INSURANCE RATE MAP (FIRM) INFORMATION					
B1. NFIP Community Name & Community Number <b>CITY OF MIAMI BEACH 120651</b>			B2. County Name <b>MIAMI-DADE</b>		B3. State <b>FLORIDA</b>
B4. Map/Panel Number <b>12086C - 0307</b>	B5. Suffix <b>L</b>	B6. FIRM Index Date <b>9/11/2009</b>	B7. FIRM Panel Effective/ Revised Date <b>09/11/09</b>	B8. Flood Zone(s) <b>AE</b>	B9. Base Flood Elevation(s) (Zone AO, use Base Flood Depth) <b>8.00 FT</b>
B10. Indicate the source of the Base Flood Elevation (BFE) data or base flood depth entered in Item B9: <input type="checkbox"/> FIS Profile <input checked="" type="checkbox"/> FIRM <input type="checkbox"/> Community Determined <input type="checkbox"/> Other/Source: _____					
B11. Indicate elevation datum used for BFE in Item B9: <input checked="" type="checkbox"/> NGVD 1929 <input type="checkbox"/> NAVD 1988 <input type="checkbox"/> Other/Source: _____					
B12. Is the building located in a Coastal Barrier Resources System (CBRS) area or Otherwise Protected Area (OPA)? <input type="checkbox"/> Yes <input checked="" type="checkbox"/> No Designation Date: _____ <input type="checkbox"/> CBRS <input type="checkbox"/> OPA					

# ELEVATION CERTIFICATE

21-003858EC

OMB No. 1660-0008

Expiration Date: November 30, 2022

<b>IMPORTANT: In these spaces, copy the corresponding information from Section A.</b>			<b>FOR INSURANCE COMPANY USE</b>
Building Street Address (including Apt., Unit, Suite, and/or Bldg. No.) or P.O. Route and Box No. 1600 CLEVELAND ROAD			Policy Number:
City MIAMI BEACH	State FLORIDA	ZIP Code 33141	Company NAIC Number

## SECTION C – BUILDING ELEVATION INFORMATION (SURVEY REQUIRED)

C1. Building elevations are based on: ☐ Construction Drawings\* ☐ Building Under Construction\* ☒ Finished Construction

\*A new Elevation Certificate will be required when construction of the building is complete.

C2. Elevations – Zones A1–A30, AE, AH, A (with BFE), VE, V1–V30, V (with BFE), AR, AR/A, AR/AE, AR/A1–A30, AR/AH, AR/AO. Complete Items C2.a–h below according to the building diagram specified in Item A7. In Puerto Rico only, enter meters.

Benchmark Utilized: CITY OF MIAMI BEACH BM ; BP-03 ; 2.89 Vertical Datum: NGVD 1929

Indicate elevation datum used for the elevations in items a) through h) below.

☒ NGVD 1929 ☐ NAVD 1988 ☐ Other/Source: \_\_\_\_\_

Datum used for building elevations must be the same as that used for the BFE.



Check the measurement used.

- |   |       |  |                                 |
|---|-------|--|---------------------------------|
| a) Top of bottom floor (including basement, crawlspace, or enclosure floor)   | 6. 28 | <input checked="" type="checkbox"/> feet | <input type="checkbox"/> meters |
| b) Top of the next higher floor   | N/A.  | <input checked="" type="checkbox"/> feet | <input type="checkbox"/> meters |
| c) Bottom of the lowest horizontal structural member (V Zones only)   | N/A.  | <input checked="" type="checkbox"/> feet | <input type="checkbox"/> meters |
| d) Attached garage (top of slab)  | N/A.  | <input checked="" type="checkbox"/> feet | <input type="checkbox"/> meters |
| e) Lowest elevation of machinery or equipment servicing the building<br>(Describe type of equipment and location in Comments) | 5. 66 | <input checked="" type="checkbox"/> feet | <input type="checkbox"/> meters |
| f) Lowest adjacent (finished) grade next to building (LAG)  | 4. 9  | <input checked="" type="checkbox"/> feet | <input type="checkbox"/> meters |
| g) Highest adjacent (finished) grade next to building (HAG)   | 5. 2  | <input checked="" type="checkbox"/> feet | <input type="checkbox"/> meters |
| h) Lowest adjacent grade at lowest elevation of deck or stairs, including structural support                                  | N/A.  | <input checked="" type="checkbox"/> feet | <input type="checkbox"/> meters |

## SECTION D – SURVEYOR, ENGINEER, OR ARCHITECT CERTIFICATION

This certification is to be signed and sealed by a land surveyor, engineer, or architect authorized by law to certify elevation information. I certify that the information on this Certificate represents my best efforts to interpret the data available. I understand that any false statement may be punishable by fine or imprisonment under 18 U.S. Code, Section 1001.

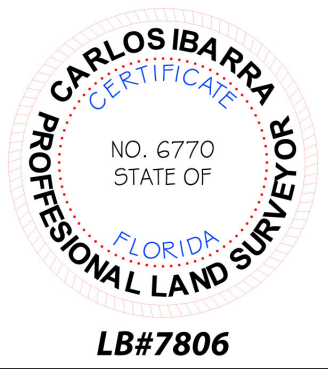
Were latitude and longitude in Section A provided by a licensed land surveyor? ☒ Yes ☐ No ☐ Check here if attachments.

Certifier's Name CARLOS IBARRA	License Number 6770	
Title PROFESSIONAL LAND SURVEYOR		
Company Name JOHN IBARRA & ASSOCIATES, INC		
Address 777 NW 72 AVE #3025		
City MIAMI	State FLORIDA	
Signature 	Date 11/9/2021	Telephone P: (305)262-0400
11/9/2021		

Copy all pages of this Elevation Certificate and all attachments for (1) community official, (2) insurance agent/company, and (3) building owner.

Comments (including type of equipment and location, per C2(e), if applicable)

NOTE: C2.E = A/C UNIT PAD. LATITUDE & LONGITUDE OBTAINED BY GPS DEVICE. THIS ELEVATION CERTIFICATE IS ONLY VALID FOR THE PERSON OR PERSONS NAMED ON THIS CERTIFICATE. THIS CERTIFICATE IS FOR FLOOD INSURANCE PURPOSES ONLY. THE INFORMATION ON THIS CERTIFICATE SHOULD NOT BE USED FOR CONSTRUCTION OR PLANNING.

NO ACCESS TO THE INTERIOR, ALL INTERIOR ELEVATIONS WERE TAKEN FROM THE DOOR WELLS ON THE OUTSIDE OF THE BUILDING. IF THERE ARE OTHER FLOOR ELEVATIONS INSIDE THE DWELLING, PLEASE NOTIFY THE SURVEYOR, SO WE CAN MAKE AN APPOINTMENT TO MEASURE THE EXTRA FLOORS, IF ANY.

CENTERLINE ROAD ELEVATION:

**ELEVATION CERTIFICATE**

21-003858EC

OMB No. 1660-0008

Expiration Date: November 30, 2022

<b>IMPORTANT: In these spaces, copy the corresponding information from Section A.</b>			<b>FOR INSURANCE COMPANY USE</b>
Building Street Address (including Apt., Unit, Suite, and/or Bldg. No.) or P.O. Route and Box No. 1600 CLEVELAND ROAD			Policy Number:
City MIAMI BEACH	State FLORIDA	ZIP Code 33141	Company NAIC Number

**SECTION E – BUILDING ELEVATION INFORMATION (SURVEY NOT REQUIRED)  
FOR ZONE AO AND ZONE A (WITHOUT BFE)**

For Zones AO and A (without BFE), complete Items E1–E5. If the Certificate is intended to support a LOMA or LOMR-F request, complete Sections A, B, and C. For Items E1–E4, use natural grade, if available. Check the measurement used. In Puerto Rico only, enter meters.

- E1. Provide elevation information for the following and check the appropriate boxes to show whether the elevation is above or below the highest adjacent grade (HAG) and the lowest adjacent grade (LAG).
- a) Top of bottom floor (including basement, crawlspace, or enclosure) is \_\_\_\_\_ . \_\_\_\_\_ ☒ feet ☐ meters ☐ above or ☐ below the HAG.
- b) Top of bottom floor (including basement, crawlspace, or enclosure) is \_\_\_\_\_ . \_\_\_\_\_ ☒ feet ☐ meters ☐ above or ☐ below the LAG.
- E2. For Building Diagrams 6–9 with permanent flood openings provided in Section A Items 8 and/or 9 (see pages 1–2 of Instructions), the next higher floor (elevation C2.b in the diagrams) of the building is \_\_\_\_\_ . \_\_\_\_\_ ☒ feet ☐ meters ☐ above or ☐ below the HAG.
- E3. Attached garage (top of slab) is \_\_\_\_\_ . \_\_\_\_\_ ☒ feet ☐ meters ☐ above or ☐ below the HAG.
- E4. Top of platform of machinery and/or equipment servicing the building is \_\_\_\_\_ . \_\_\_\_\_ ☒ feet ☐ meters ☐ above or ☐ below the HAG.
- E5. Zone AO only: If no flood depth number is available, is the top of the bottom floor elevated in accordance with the community's floodplain management ordinance? ☐ Yes ☐ No ☐ Unknown. The local official must certify this information in Section G.

**SECTION F – PROPERTY OWNER (OR OWNER'S REPRESENTATIVE) CERTIFICATION**

The property owner or owner's authorized representative who completes Sections A, B, and E for Zone A (without a FEMA-issued or community-issued BFE) or Zone AO must sign here. The statements in Sections A, B, and E are correct to the best of my knowledge.

Property Owner or Owner's Authorized Representative's Name

Address City State ZIP Code

Signature Date Telephone

Comments

☐ Check here if attachments.

# ELEVATION CERTIFICATE

21-003858EC

OMB No. 1660-0008

Expiration Date: November 30, 2022

<b>IMPORTANT: In these spaces, copy the corresponding information from Section A.</b>			<b>FOR INSURANCE COMPANY USE</b>
Building Street Address (including Apt., Unit, Suite, and/or Bldg. No.) or P.O. Route and Box No. 1600 CLEVELAND ROAD			Policy Number:
City MIAMI BEACH	State FLORIDA	ZIP Code 33141	Company NAIC Number

## SECTION G – COMMUNITY INFORMATION (OPTIONAL)

The local official who is authorized by law or ordinance to administer the community's floodplain management ordinance can complete Sections A, B, C (or E), and G of this Elevation Certificate. Complete the applicable item(s) and sign below. Check the measurement used in Items G8–G10. In Puerto Rico only, enter meters.

- G1. ☐ The information in Section C was taken from other documentation that has been signed and sealed by a licensed surveyor, engineer, or architect who is authorized by law to certify elevation information. (Indicate the source and date of the elevation data in the Comments area below.)
- G2. ☐ A community official completed Section E for a building located in Zone A (without a FEMA-issued or community-issued BFE) or Zone AO.
- G3. ☐ The following information (Items G4–G10) is provided for community floodplain management purposes.

G4. Permit Number	G5. Date Permit Issued	G6. Date Certificate of Compliance/Occupancy Issued
-------------------	------------------------	---

G7. This permit has been issued for: ☐ New Construction ☐ Substantial Improvement

G8. Elevation of as-built lowest floor (including basement) of the building: \_\_\_\_\_ ☐ feet ☐ meters Datum \_\_\_\_\_

G9. BFE or (in Zone AO) depth of flooding at the building site: \_\_\_\_\_ ☐ feet ☐ meters Datum \_\_\_\_\_

G10. Community's design flood elevation: \_\_\_\_\_ ☐ feet ☐ meters Datum \_\_\_\_\_

Local Official's Name	Title
Community Name	Telephone
Signature	Date

Comments (including type of equipment and location, per C2(e), if applicable)

☐ Check here if attachments.



# BUILDING PHOTOGRAPHS

See Instructions for Item A6. 21-003858EC

OMB No. 1660-0008

Expiration Date: November 30, 2022

## ELEVATION CERTIFICATE

**IMPORTANT: In these spaces, copy the corresponding information from Section A.**

Building Street Address (including Apt., Unit, Suite, and/or Bldg. No.) or P.O. Route and Box No.

1600 CLEVELAND ROAD

City

State

ZIP Code

MIAMI BEACH

FLORIDA

33141

FOR INSURANCE COMPANY USE

Policy Number:

Company NAIC Number

If using the Elevation Certificate to obtain NFIP flood insurance, affix at least 2 building photographs below according to the instructions for Item A6. Identify all photographs with date taken; "Front View" and "Rear View"; and, if required, "Right Side View" and "Left Side View." When applicable, photographs must show the foundation with representative examples of the flood openings or vents, as indicated in Section A8. If submitting more photographs than will fit on this page, use the Continuation Page.



Front View

Front View Date: 11/11/2021



Rear View

Rear View Date: 11/11/2021



Right Side View

Right Side View: 11/11/2021

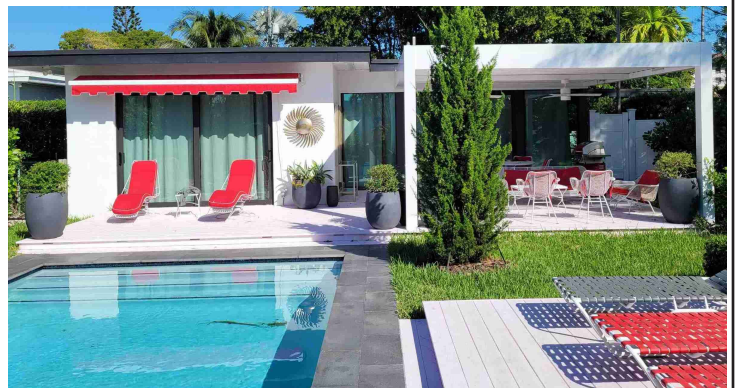

Left Side View

Left Side View: 11/11/2021

# ELEVATION CERTIFICATE

## BUILDING PHOTOGRAPHS

Continuation Page

21-003858EC

OMB No. 1660-0008

Expiration Date: November 30, 2022

**IMPORTANT: In these spaces, copy the corresponding information from Section A.**

**FOR INSURANCE COMPANY USE**

Building Street Address (including Apt., Unit, Suite, and/or Bldg. No.) or P.O. Route and Box No.

Policy Number:

1600 CLEVELAND ROAD

City

State

ZIP Code

Company NAIC Number

MIAMI BEACH

FLORIDA

33141

If submitting more photographs than will fit on the preceding page, affix the additional photographs below. Identify all photographs with: date taken; "Front View" and "Rear View"; and, if required, "Right Side View" and "Left Side View." When applicable, photographs must show the foundation with representative examples of the flood openings or vents, as indicated in Section A8.

Photo One

Photo Two

Photo Three

Photo Four