

Existing Trees & Palms							NOTES	Disposition
Number	Symbol	Scientific Name	Common Name	DBH (in)	HT (ft)	SPR (ft)		
1	PCA	<i>Phoenix canariensis</i>	CANARY DATE PALM	2'	15'	7'		RELOCATE
2	AME	<i>Adonidia merrillii</i>	CHRISTMAS PALM	1'	30'	10'	TOO CLOSE TO STRUCTURE	DEMO
3	AME	<i>Adonidia merrillii</i>	CHRISTMAS PALM	1'	30'	10'	TOO CLOSE TO STRUCTURE	DEMO
4	AME	<i>Adonidia merrillii</i>	CHRISTMAS PALM	1'	30'	10'	TOO CLOSE TO STRUCTURE	DEMO
5	AME	<i>Adonidia merrillii</i>	CHRISTMAS PALM	1'	30'	10'	TOO CLOSE TO STRUCTURE	DEMO
6	LCH	<i>Livistona chinensis</i>	CHINESE FAN PALM	1'	30'	10'	TOO CLOSE TO STRUCTURE	DEMO
7	PEL	<i>Ptychosperma elegans</i>	ALEXANDER PALM	0.6'	35'	10'		REMAIN
8	PEL	<i>Ptychosperma elegans</i>	ALEXANDER PALM	0.6'	35'	10'		REMAIN
9	PEL	<i>Ptychosperma elegans</i>	ALEXANDER PALM	0.6'	35'	10'		REMAIN
10	PEL	<i>Ptychosperma elegans</i>	ALEXANDER PALM	0.6'	35'	10'		REMAIN
11	CNU	<i>Cocos nucifera</i>	COCONUT PALM	1.5'	50'	12'		REMAIN
12	PEL	<i>Ptychosperma elegans</i>	ALEXANDER PALM	1.5'	50'	12'		REMAIN
13	PEL	<i>Ptychosperma elegans</i>	ALEXANDER PALM	1.5'	50'	12'		REMAIN
14	PEL	<i>Ptychosperma elegans</i>	ALEXANDER PALM	1.5'	50'	12'		REMAIN
15	PEL	<i>Ptychosperma elegans</i>	ALEXANDER PALM	0.4'	30'	5'		REMAIN
16	PEL	<i>Ptychosperma elegans</i>	ALEXANDER PALM	0.4'	30'	5'		REMAIN
17	PEL	<i>Ptychosperma elegans</i>	ALEXANDER PALM	0.4'	30'	5'		REMAIN
18	CNU	<i>Cocos nucifera</i>	COCONUT PALM	0.6'	30'	5'		REMAIN
19	PEL	<i>Ptychosperma elegans</i>	ALEXANDER PALM	0.6'	30'	5'		REMAIN

Required number of trees	Required minimum number of species
01—10	2
11—20	3
21—30	4
31—40	5
41 or greater	6

Provided Tree Size and Species
2" DBH None
4" DBH Seagrape (8), Green Buttonwood (3), Live Oak (4)
Species Diversity: 3 Species
Total Trees: 15 Trees

Mitigation Calculations
Palm Removal: 5 palms = 5 trees
Total Mitigation Trees Required: 5 Trees
Total Trees Proposed: 15 Trees

Deficiency in required number of trees will be made up for by complying with Miami Beach Code Section 46-61 (6) or (7). Please advise Landscape Architect of City preference.

Total diameter of tree(s) to be removed (sum of inches at DBH)	Total number of replacement trees required (where each replacement tree is a minimum of 2" DBH x 6' spread in canopy x 12' in height)	OR	Total number of replacement trees required (where each replacement tree is a minimum of 4" DBH x 8' spread in canopy x 16' in height)	OR	Contribution to Tree Trust Fund
2"—3"	1	or	0	or	\$1,000.00
4"—6"	2	or	1	or	\$2,000.00
7"—12"	4	or	2	or	\$4,000.00
13"—18"	6	or	3	or	\$6,000.00
19"—24"	8	or	4	or	\$8,000.00
25"—30"	10	or	5	or	\$10,000.00
31"—36"	12	or	6	or	\$12,000.00
37"—42"	14	or	7	or	\$14,000.00
43"—48"	16	or	8	or	\$16,000.00
49"—60"	20	or	10	or	\$20,000.00

TREE / PALM PROTECTION FENCES SHALL BE CONSTRUCTED PRIOR TO ANY CONSTRUCTION ACTIVITY INCLUDING GRUBBING FOR ALL TREES / PALMS THAT ARE TO REMAIN, BE PROTECTED, OR BE RELOCATED.

NO ACTIVITY OR DISTURBANCE SHOULD OCCUR WITHIN THE FENCED AREAS, INCLUDING VEHICLE USE, STORAGE OF MATERIALS, DUMPING OF LIQUIDS OR MATERIALS, GRADE CHANGES, GRUBBING, AND MECHANICAL TRENCHING FOR IRRIGATION, ELECTRICAL, LIGHTING, ETC.

In no case shall the fence be installed less than ten feet from the trunk.

Tree + Palm protection barriers to extend beyond the 'drip-line' or to the 'critical root zone area' of all trees/palms to be protected. Extend where necessary to protect tree canopy roots.

Barriers shall be a minimum of four feet high, and shall be constructed of continuous chain link fence with metal posts at eight-foot spacing, or of two-by-four-inch posts with three equally spaced two-by-four-inch rails. Posts may be shifted to avoid roots.

PROTECTION DETAIL NOTE
CONTRACTOR TO INSTALL TREE / PALM PROTECTION FENCE BARRIERS AROUND ALL EXISTING TREES OR PALMS AT THE START OF THE PROJECT. BARRIERS TO REMAIN IN PLACE THROUGHOUT THE DURATION OF THE PROJECT AND SHOULD NOT BE REMOVED OR DROPPED FOR ANY REASON WITHOUT AUTHORIZATION FROM THE CITY OF MIAMI BEACH URBAN FORESTER + PLANNING + ZONING DEPARTMENT.

C.M.B. TREE / PALM PROTEC. DETAIL

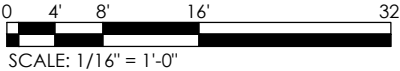

REVISIONS / SUBMISSIONS

PRIVATE RESIDENCE	TREE DISPOSITION PLAN
5757 LA GORCE DR. Miami Beach, FL	

--

--

FERNANDO WONG OUTDOOR LIVING DESIGN
--

DRAWN BY: JL
CHECKED BY: FW
DATE: 05.05.2022

SCALE: 1/16" = 1'-0"

TD-100



GATE - FRONT ELEVATION
N.T.S.

PROPOSED GATE TO MATCH
EXISTING GATE ON
5774 PINE TREE DR. + 5777 LA GORCE DR.
AT 5' TALL.



GATE VIEW 1
N.T.S.



GATE VIEW 2
N.T.S.

NOTE:
PROPOSED GATE MATERIAL
TO BE VISUALLY PERMEABLE

REVISIONS / SUBMISSIONS	
△	
△	
△	
△	
△	
△	
△	
△	
△	
△	

PRIVATE RESIDENCE 5757 LA GORCE DR. Miami Beach, FL	
GATE IMAGERY REFERENCE	

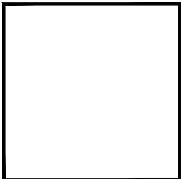
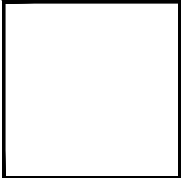

FERNANDO WONG OUTDOOR LIVING DESIGN	
--	--

DRAWN BY:	JL
CHECKED BY:	FW
DATE:	05.03.2022
SCALE:	N.T.S.

H-101	
-------	--

LA GORCE DRIVE

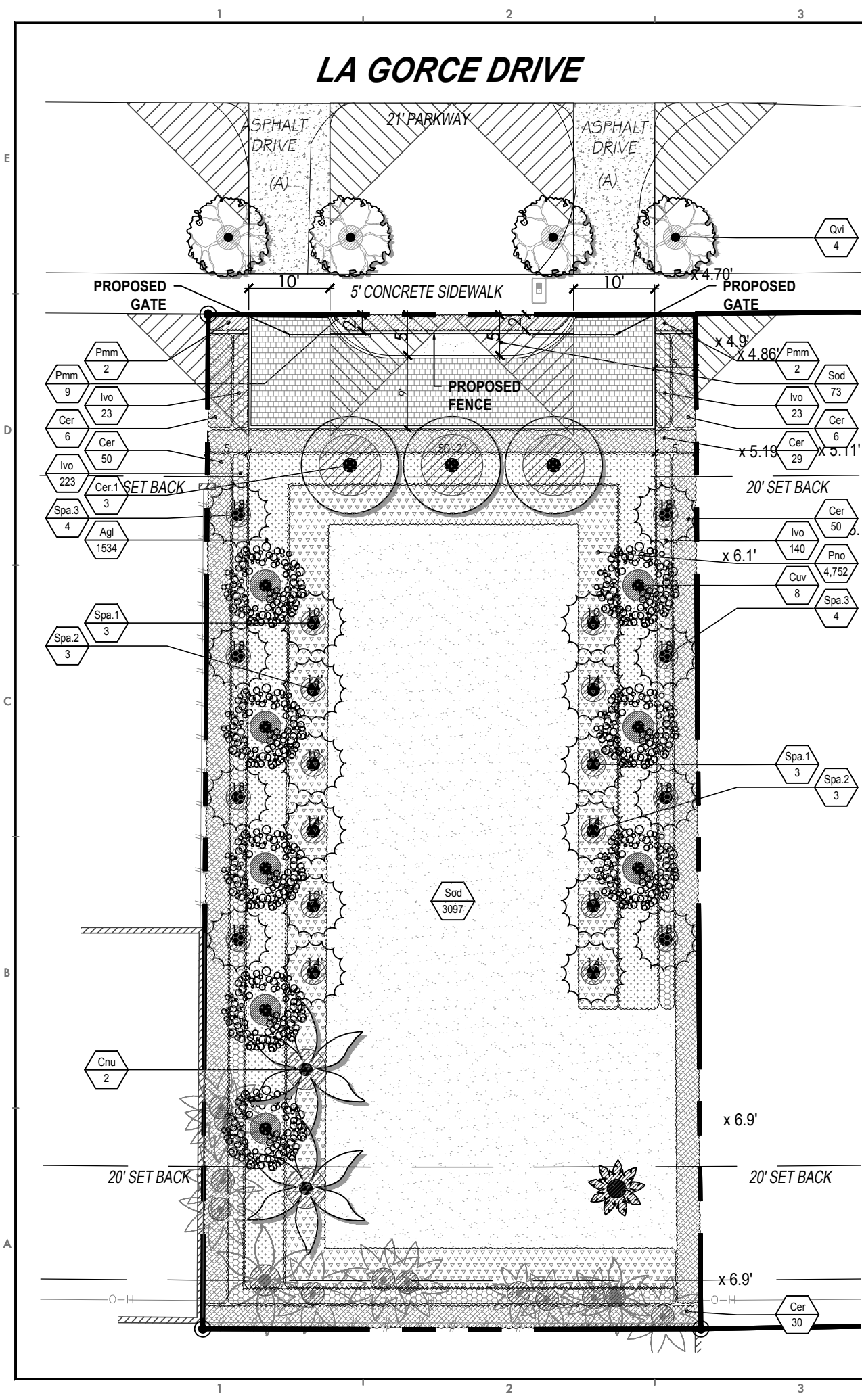

LANDSCAPE LIST

TREES				
SYMBOL	KEY	QUAN.	PROPOSED MATERIAL	DESCRIPTION
	CUV	8	*Coccoloba uvifera	14' HT. 10' SPR. 3 - 4" CAL. STD.
	CER.1	3	*Conocarpus erectus	16'-18' HT. 6-8" SPR. STANDARD 4" CAL.
	QVI	4	*Quercus virginiana	12'-13" HT. 4" SPR. 5' CT. 2"-3" CAL. STD.
			SEAGRAPE	100 GAL. FLORIDA GRADE #1
			GREEN BUTTONWOOD	100 GAL. FLORIDA GRADE #1
			LIVE OAK	45 GAL. GRADE #1

PALMS				
SYMBOL	KEY	QUAN.	PROPOSED MATERIAL	DESCRIPTION
	CNU	2	Cocos nucifera	16' CT.
	SPA.1	6	*Sabal palmetto	10' CT.
	SPA.2	6	*Sabal palmetto	14' CT.
	SPA.3	8	*Sabal palmetto	18' CT.
			COCONUT PALM	F.G.
			CABBAGE PALM	F.G.
			CABBAGE PALM	F.G.
			CABBAGE PALM	F.G.

HEDGES				
SYMBOL	KEY	QUAN.	PROPOSED MATERIAL	DESCRIPTION
	CER	171	*Conocarpus erectus	8' HT 30" O.C. FULL TO BASE
	IVO	409	*Ilex vomitoria	12" HT. 12" O.C.
	PMM	13	Podocarpus macrophyllus "Maki"	8' HT. 30" O.C.
			GREEN BUTTONWOOD	30 GAL.
			YAUPOON HOLLY	3 GAL.
			PODOCARPUS MAKI	30 GAL.

GROUND COVERS				
SYMBOL	KEY	SQ. FT	PROPOSED MATERIAL	DESCRIPTION
	AGL	1,534	Arachis glabrata	10" O.C.
	PNO	4,752	*Phyla nodiflora	6" O.C.
			PERENNIAL PEANUT	1 GAL.
			FROGFRUIT	1 GAL.

SOD				
SYMBOL	KEY	SQ. FT	PROPOSED MATERIAL	DESCRIPTION
	SOD	3,170	Empire zoysia	
			EMPIRE GRASS	

MULCH			
BAGS	SQ. FT	PROPOSED MATERIAL	DESCRIPTION
144		Mini Pine Bark	2" THICK
			2 CU FT. BAGS

* DENOTES NATIVE PLANTS SPECIES

LANDSCAPE LEGEND Information Required to be Permanently Affixed to Plan
Following City of Miami Beach Landscape Code

Zoning District: RS-4 (Single Family Residential) Net Lot Area .17 acres 7,584 s.f.

	REQUIRED	PROVIDED
--	----------	----------

OVERALL PERVIOUS AREA
Square Feet of pervious space required, as indicated on site plan:
Net lot area = 7,584 s.f. x 50 % = 3,792 s.f.

MAXIMUM LAWN AREA
Square Feet of pervious space required, as indicated on site plan:
Net lot area = 7,584 s.f. x 50 % = 3,791 s.f.

FRONT YARD 20' SET BACK PERVIOUS AREA
Square Feet of pervious space required, as indicated on site plan:
Net lot area = 1,201 s.f. x 50 % = 600.5 s.f.

INTERIOR SIDE YARD 10' SET BACK PERVIOUS AREA
Square Feet of pervious space required, as indicated on site plan:
Net lot area = 2,517.8 s.f. x 10 % = 252 s.f.

REAR YARD 20' SET BACK PERVIOUS AREA
Square Feet of pervious space required, as indicated on site plan:
Net lot area = 1,225 s.f. x 70 % = 857.5 s.f.

TREES
A. No. trees required per lot or net, less existing number of trees meeting minimum requirements = 26 Trees x N/A net lot acres - acres - number of existing trees = 4 11
B. % Natives Required: No. trees provided x 30% = 1 11
C. % Low maintenance / drought and salt tolerant required = Number of trees provided x 50% = 2 11
D. Street Trees (maximum average spacing 20' O.C.) 170 Linear Feet Frontage = 60 L.F. x 20 O.C. = 3 Trees 3 4
TOTAL TREES 7 15

SHRUBS
A. No. trees required x 12 = No. of shrubs allowed 84 593
B. No. shrubs allowed x 50% = No. of native shrubs required 42 580
C. Diversity of large shrubs or small trees required Number of required shrubs x 10% = 8.4 171
D. Native % Diversity of large shrubs or small trees required Number of required shrubs or small trees provided x 50% = 4.2 171

SEE LANDSCAPE LIST

REVISIONS / SUBMISSIONS	
1	
2	
3	
4	
5	
6	
7	
8	
9	
10	
11	
12	
13	
14	
15	
16	
17	
18	
19	
20	

PRIVATE RESIDENCE
5757 LA GORCE DR.
Miami Beach, FL

LANDSCAPE PLAN

FERNANDO WONG
OUTDOOR LIVING DESIGN

DRAWN BY: JL
CHECKED BY: FW
DATE: 05.05.2022
SCALE: 1/16" = 1'-0"

L-100

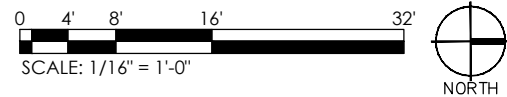

TREES



Coccoloba uvifera
SEAGRAE



Conocarpus erectus
GREEN BUTTOMWOOD

PALMS

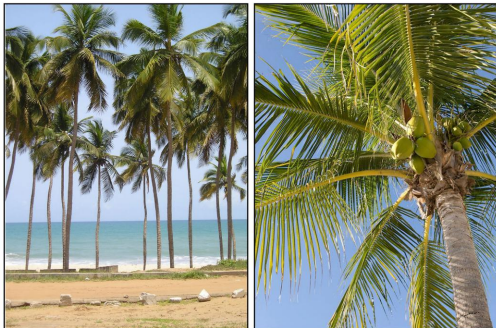

Cocos nucifera
COCONUT PALM



Sabal palmetto
CABBAGE PALM

SOD



Empire zoysia

HEDGES



Conocarpus erectus
GREEN BUTTOMWOOD



Ilex vomitoria
STOKES DWARF



Podocarpus macrophyllus 'Maki'
PODOCARPUS MAKI

GROUND COVERS



Arachis glabrata 'Golden Glory'
PERRENIAL PEANUT



Phyla nodiflora
FROGFRUIT

REVISIONS / SUBMISSIONS
△
△
△
△
△
△
△
△
△
△

PRIVATE RESIDENCE
5757 LA GORCE DR.
Miami Beach, FL

PLANT MATERIAL

FERNANDO WONG
OUTDOOR LIVING DESIGN

DRAWN BY:	JL
CHECKED BY:	FW
DATE:	05.05.2022
SCALE:	N.T.S



WEST - FRONT ELEVATION

SCALE: 3/32" = 1'-0"

GATE HEIGHT 5' FROM GRADE



EAST - REAR ELEVATION

SCALE: 3/32" = 1'-0"



SOUTH ELEVATION

SCALE: 3/32" = 1'-0"



NORTH ELEVATION

SCALE: 3/32" = 1'-0"

REVISIONS / SUBMISSIONS	
Δ	
Δ	
Δ	
Δ	
Δ	
Δ	
Δ	
Δ	
Δ	
Δ	
Δ	
Δ	

PRIVATE RESIDENCE

5757 LA GORCE DR.
Miami Beach, FL

LANDSCAPE ELEVATIONS

FERNANDO WONG
OUTDOOR LIVING DESIGN

DRAWN BY:	JL
CHECKED BY:	FW
DATE:	06.08.2022
SCALE:	3/32" = 1'-0"



EXISTING CONDITIONS

N.T.S.



STREET ELEVATION

SCALE: 1/16" = 1'-0"

REVISIONS / SUBMISSIONS	
Δ	
Δ	
Δ	
Δ	
Δ	
Δ	
Δ	
Δ	
Δ	
Δ	

PRIVATE RESIDENCE	
5757 LA GORCE DR.	
Miami Beach, FL	
STREET ELEVATIONS	

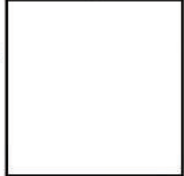

FERNANDO WONG	
OUTDOOR LIVING DESIGN	

DRAWN BY:	JL
CHECKED BY:	FW
DATE:	05.05.2022
SCALE:	3/32" = 1'-0"

L-103	
-------	--



PROPOSED FRONT DRIVEWAY - RENDERING

N.T.S.

REVISIONS / SUBMISSIONS	
Δ	
Δ	
Δ	
Δ	
Δ	
Δ	
Δ	
Δ	
Δ	
Δ	

--

PRIVATE RESIDENCE
5757 LA GORCE DR.
Miami Beach, FL

FRONT DRIVEWAY RENDERING

--

--

FERNANDO WONG
OUTDOOR LIVING DESIGN

DRAWN BY:	JL
CHECKED BY:	FW
DATE:	05.05.2022
SCALE:	N.T.S.

L-104

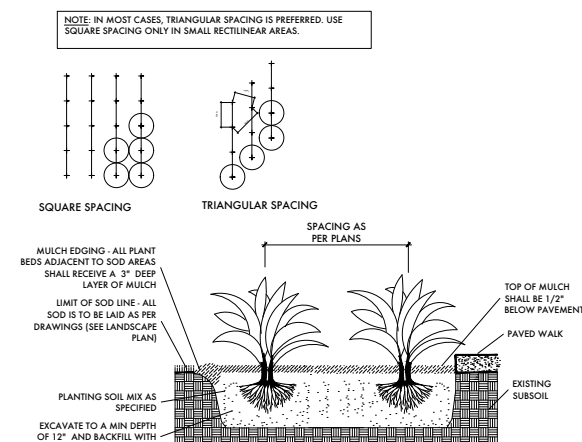
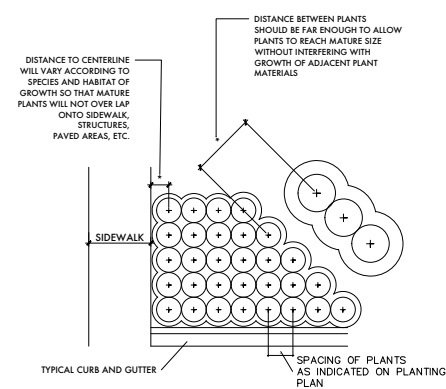
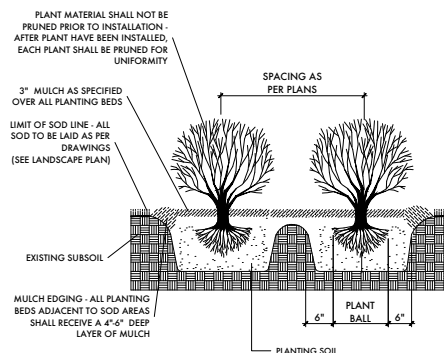
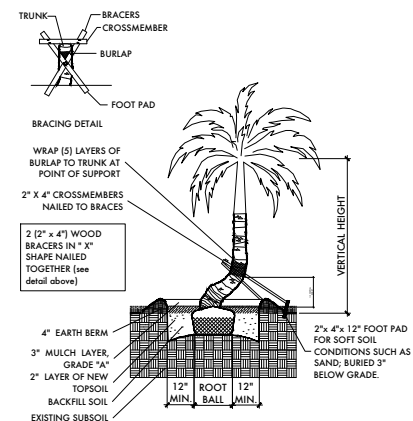
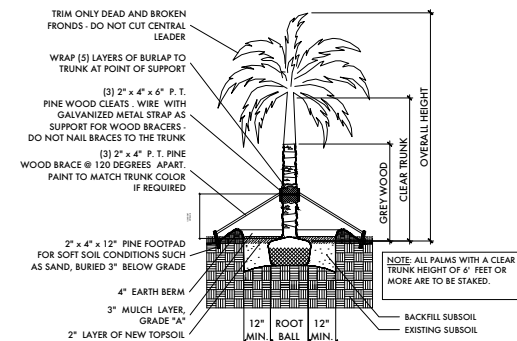
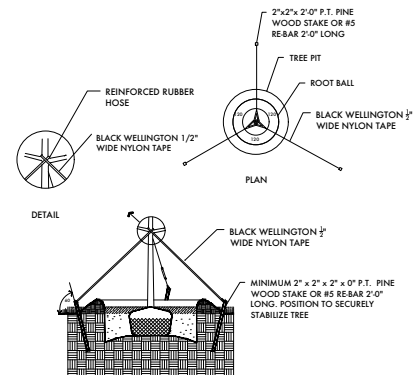
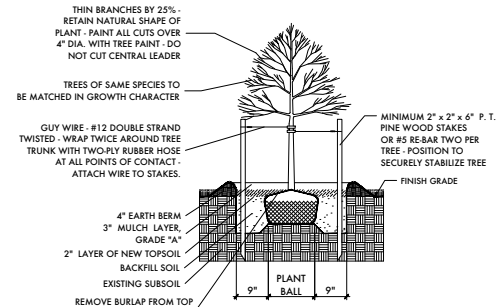
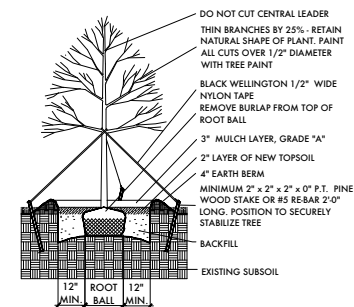

PLANTING NOTES (See plant specification and details for additional standards)

-All plant material is to be Florida Number 1 or better pursuant to the Florida Department of Agriculture's Grades and Standards for Nursery Plants.

-All plants are to be top dressed with a minimum 3" layer of Melaleuca mulch, Eucalyptus mulch or equal.

-Planting plans shall take precedence over plant list in case of discrepancies.

-No changes are to be made without the prior consent of the Landscape Architect and Owner. Additions and deletions to the plant material must be approved by the project engineer.

-Landscape Contractor is responsible for providing their own square footage takeoffs and field verification for 100% sod coverage for all areas specified.

- All landscape areas are to be provided with automatic sprinkler system which provide 100% coverage, and 50% overlap.

- All trees in lawn areas are to receive a 24" diameter mulched saucer at the base of the trunk.

- No mulch, fill or soil will be placed over the rootballs or within 4" of the trunks of the newly installed trees, and the trees will be installed at or slightly above the soil grade.

-Nursery Support Poles shall be removed at the Nursery, prior to delivery, and trees with the nursery poles will not be accepted and therefore rejected, with the exception of the following species: Clusea rosea and Silver Buttonwood trees.

- All straps, poles and braces shall be removed from all of the installed trees and palms within the 1-year of planting.

- No changes are to be made without the prior consent of the Landscape Architect, owner, City Urban Forester and City Planning Department. Additions and or deletions to the plant material must be approved per the Project Engineer, City Urban Forester and City Planning Department.

- Trees are to be planted within parking islands after soil is brought up to grade. Deeply set root balls are not acceptable.

- Planting soil for topsoil and backfill shall be 50/50 mix, nematode free. Planting soil for annual beds to be comprised of 50% Canadian peat moss, 25% salt free coarse sand and 25% Aerolite.

- Tree and shrub pits will be supplemented with "Agriform Pells", 21 gram size with a 20-10-5 analysis, or substitute application accepted by Landscape Architect. Deliver in manufacturer's standard containers showing weight, analysis and name of manufacturer.

- Tree protection fences shall be constructed prior to any construction activity including grubbing for all trees/palms to remain or be relocated. The fences should be of sturdy construction, 4x4 posts with wire mesh. Fences must be intact until the project is completed. They should not be removed or dropped for any reason without authorization from the city Urban Forester. No activity or disturbance should occur within the fenced areas, including vehicle use, storage of materials, dumping of liquids or materials, grade changes, grubbing and mechanical trenching for irrigation, electrical and lighting, etc.

GENERAL NOTES

-The Landscape Contractor is to locate and verify all underground and overhead utilities prior to beginning work. Contact proper utility companies and / or General Contractor prior to digging for field verification. The Owner and the Landscape Architect shall not be responsible for any damages to utility or irrigation lines (see Roadway Plans for more utility notes).

-Landscape Contractor is to verify all current drawings and check for discrepancies and bring to the attention of the Landscape Architect prior to commencing with the work.

-All unattended and unplanted tree pits are to be properly barricaded and flagged during installation.

-All planting plans are issued as directives for site layout. Any deviations, site changes, etcetera are to be brought to the attention of the Landscape Architect for clarification prior to installation.

[illegible]

PRIVATE RESIDENCE
5757 LA GORCE DR.
Miami Beach, FL

PLANTING DETAILS

FERNANDO WONG
OUTDOOR LIVING DESIGN

DRAWN BY:	JL
CHECKED BY:	FW
DATE:	05.05.2022
SCALE:	N.T.S

L-105