

| | BLOCK A | | | | BLOCK B | | | |
|--------------|------------------|------------------|------------------|-------------------|------------------|------------------|------------------|-------------------|
| | Office NSF | GSF | FAR | Floorplate | Office NSF | GSF | FAR | Floorplate |
| Roof Level | | | | 5,677 SF | | | | 7,092 SF |
| Level 06 | | 5,677 SF | 2,021 SF | 11,144 SF | | 7,092 SF | 2,427 SF | 20,793 SF |
| Level 05 | 10,576 SF | 11,144 SF | 11,144 SF | 12,786 SF | 20,102 SF | 20,793 SF | 20,793 SF | 16,372 SF |
| Level 04 | 12,218 SF | 12,786 SF | 12,786 SF | 14,563 SF | 15,681 SF | 16,372 SF | 16,372 SF | 17,891 SF |
| Level 03 | 13,995 SF | 14,563 SF | 14,563 SF | 16,805 SF | 17,200 SF | 17,891 SF | 17,891 SF | 19,546 SF |
| Level 02 | 14,541 SF | 15,109 SF | 15,109 SF | 17,503 SF | 18,855 SF | 19,546 SF | 19,546 SF | 19,546 SF |
| Level 01 | 4,603 SF | 5,171 SF | 5,171 SF | 5,171 SF | 4,751 SF | 5,442 SF | 5,442 SF | 5,442 SF |
| Lower Level | 0 SF | 21,402 SF | 16,369 SF | 21,402 SF | | | See Block A | See Block A |
| TOTAL | 55,933 SF | 85,852 SF | 77,163 SF | 105,051 SF | 76,589 SF | 87,136 SF | 82,471 SF | 106,682 SF |

| | |
|--------------------------------|-------------------|
| Office NSF (Level 02-05) | 123,168 SF |
| Office NSF (Level 01) | 9,354 SF |
| Total Office NSF | 132,522 SF |
| Total Office GSF | 173,393 SF |
| Total Office Floorplate | 212,138 SF |

| | |
|---------------------------------|-------------------|
| Total Parking Count | 322 Spaces |
| Total Parking SF | 121,979 SF |
| Total Parking GSF | 131,587 SF |
| Total Parking Floorplate | 139,005 SF |

| | |
|-------------------------|-------------------|
| Total FAR | 161,716 SF |
| Total GSF | 304,980 SF |
| Total Floorplate | 351,143 SF |

| | |
|--------------|------|
| Leftover FAR | 0 SF |
|--------------|------|

(Max FAR Allowed: 161,716 SF)

(Max FAR Allowed: 161,716 SF)

Surface Parking

13 Spaces

Parking Garage

| | Parking Spaces | Parking SF | Core SF | GSF | FAR | Floorplate |
|-----------------------|-------------------|-------------------|-----------------|-------------------|-----------------|-------------------|
| Roof | | | | 7,418 SF | 0 SF | 7,418 SF |
| P Level 06/ Roof Mech | 0 Spaces | | 327 SF | 7,864 SF | 0 SF | 7,864 SF |
| P Level 05 | 32 Spaces | 10,773 SF | 309 SF | 11,082 SF | 309 SF | 11,082 SF |
| P Level 04 | 73 Spaces | 23,393 SF | 287 SF | 23,680 SF | 287 SF | 23,680 SF |
| P Level 03 | 73 Spaces | 23,393 SF | 287 SF | 23,680 SF | 287 SF | 23,680 SF |
| P Level 02 | 61 Spaces | 23,076 SF | 287 SF | 23,363 SF | 287 SF | 23,363 SF |
| P Level 01 | 39 Spaces | 23,693 SF | 287 SF | 23,980 SF | 228 SF | 23,980 SF |
| Lower Level | 31 Spaces | 17,651 SF | 287 SF | 17,938 SF | 279 SF | 17,938 SF |
| TOTAL | 309 Spaces | 121,979 SF | 2,071 SF | 131,587 SF | 1,677 SF | 139,005 SF |

Guard House

| Office Usable SF | Guard | GSF | FAR | Floorplate |
|------------------|---------------|---------------|---------------|---------------|
| 0 SF | 405 SF | 405 SF | 405 SF | 405 SF |
| 0 SF | 405 SF | 405 SF | 405 SF | 405 SF |

ARQUITECTONICA

2900 Oak Avenue, Miami, FL 33133
T 305.372.1812 F 305.372.1175

ALL DESIGNS INDICATED IN THESE DRAWINGS ARE PROPERTY OF ARQUITECTONICA INTERNATIONAL CORP. NO COPIES, TRANSMISSIONS, REPRODUCTIONS OR ELECTRONIC MANIPULATION OF ANY PORTION OF THESE DRAWINGS IN THE WHOLE OR IN PART ARE TO BE MADE WITHOUT THE EXPRESS WRITTEN AUTHORIZATION OF ARQUITECTONICA INTERNATIONAL CORP. DESIGN INTENT SHOWN IS SUBJECT TO REVIEW AND APPROVAL OF ALL APPLICABLE LOCAL AND GOVERNMENTAL AUTHORITIES HAVING JURISDICTION. ALL COPYRIGHTS RESERVED © 2021. THE DATA INCLUDED IN THIS STUDY IS CONCEPTUAL IN NATURE AND WILL CONTINUE TO BE MODIFIED THROUGHOUT THE COURSE OF THE PROJECTS DEVELOPMENT WITH THE EVENTUAL INTEGRATION OF STRUCTURAL, MEP AND LIFE SAFETY SYSTEMS. AS THESE ARE FURTHER REFINED, THE NUMBERS WILL BE ADJUSTED ACCORDINGLY.

PB FINAL SUBMITTAL
120 MACARTHUR CAUSEWAY
MIAMI BEACH, FL

SELF PARKING OPTION
PROJECT DATA

SCALE:

DATE:
11/29/2021

AX-300

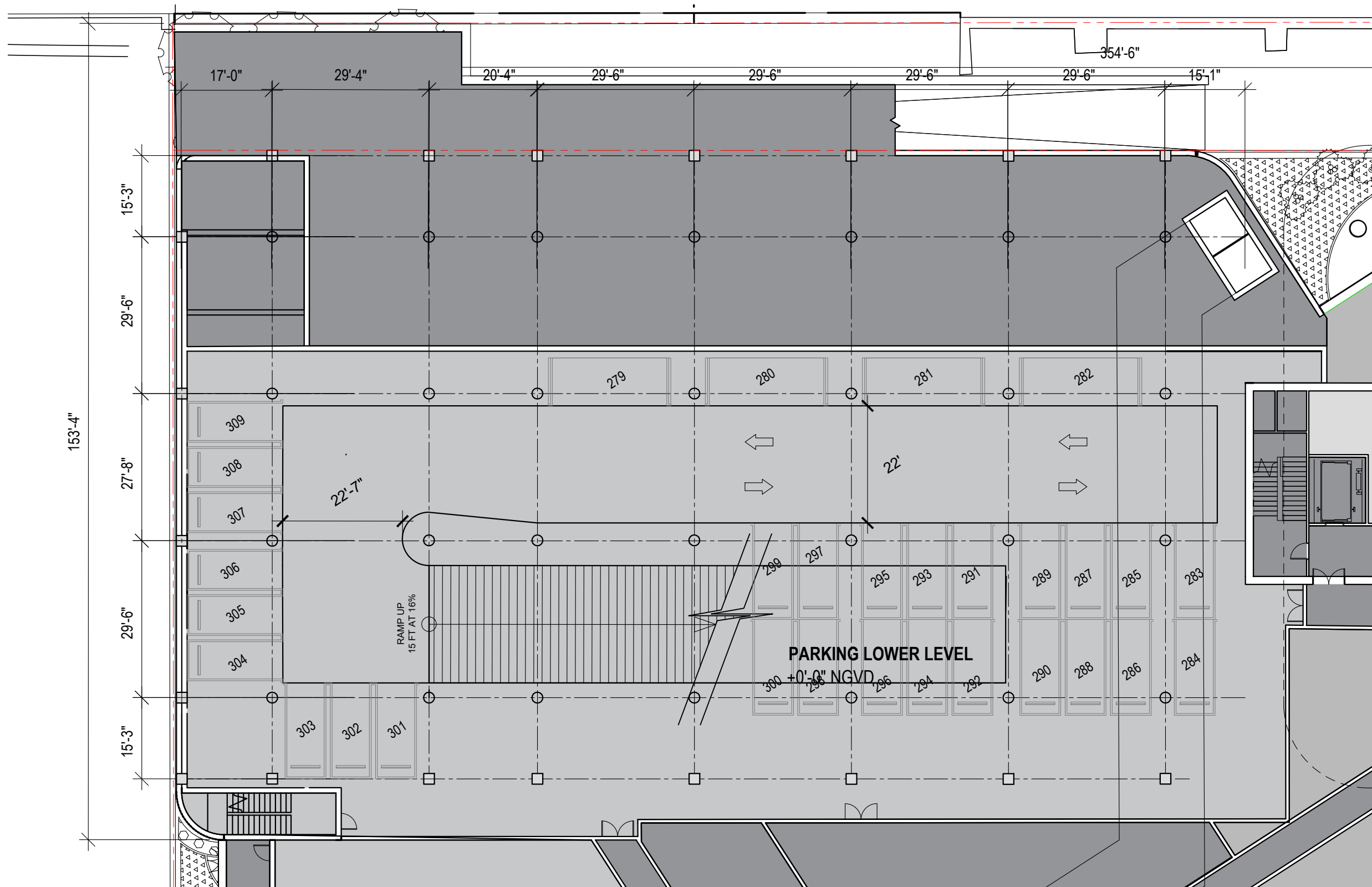

PARKING LOWER LEVEL
31 SPACES

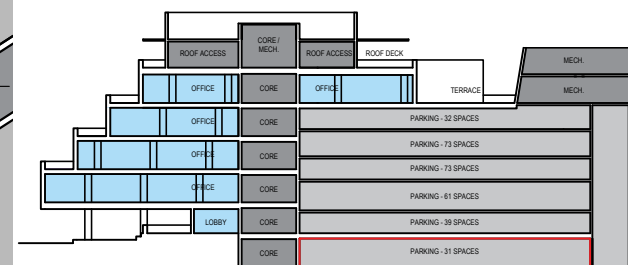

ARQUITECTONICA

2900 Oak Avenue, Miami, FL 33133
T 305.372.1812 F 305.372.1175

ALL DESIGNS INDICATED IN THESE DRAWINGS ARE PROPERTY OF ARQUITECTONICA INTERNATIONAL CORP. NO COPIES, TRANSMISSIONS, REPRODUCTIONS OR ELECTRONIC MANIPULATION OF ANY PORTION OF THESE DRAWINGS IN THE WHOLE OR IN PART ARE TO BE MADE WITHOUT THE EXPRESS WRITTEN AUTHORIZATION OF ARQUITECTONICA INTERNATIONAL CORP. DESIGN INTENT SHOWN IS SUBJECT TO REVIEW AND APPROVAL OF ALL APPLICABLE LOCAL AND GOVERNMENTAL AUTHORITIES HAVING JURISDICTION. ALL COPYRIGHTS RESERVED © 2021. THE DATA INCLUDED IN THIS STUDY IS CONCEPTUAL IN NATURE AND WILL CONTINUE TO BE MODIFIED THROUGHOUT THE COURSE OF THE PROJECTS DEVELOPMENT WITH THE EVENTUAL INTEGRATION OF STRUCTURAL, MEP AND LIFE SAFETY SYSTEMS. AS THESE ARE FURTHER REFINED, THE NUMBERS WILL BE ADJUSTED ACCORDINGLY.

PB FINAL SUBMITTAL
120 MACARTHUR CAUSEWAY
MIAMI BEACH, FL

SELF-PARKING OPTION
LOWER LEVEL

SCALE: 1"=20'-0"

DATE:
11/29/2021

AX-301

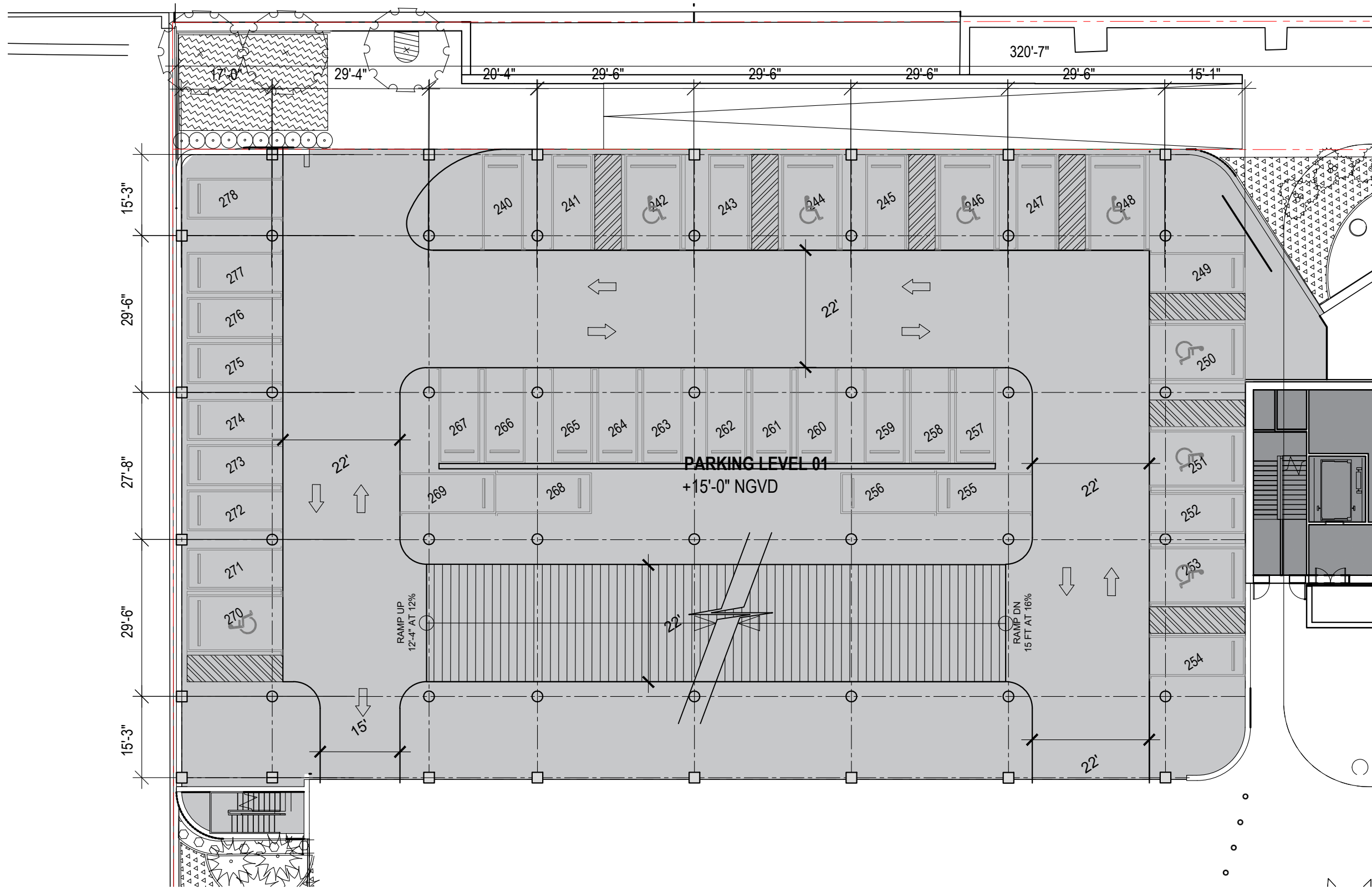

PARKING LEVEL 01
39 SPACES

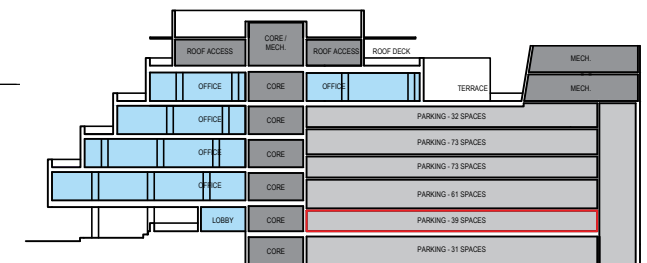
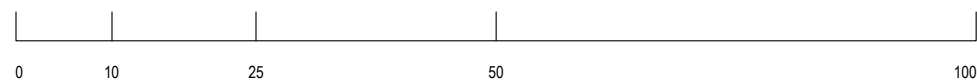

ARQUITECTONICA

2900 Oak Avenue, Miami, FL 33133
T 305.372.1812 F 305.372.1175

ALL DESIGNS INDICATED IN THESE DRAWINGS ARE PROPERTY OF ARQUITECTONICA INTERNATIONAL CORP. NO COPIES, TRANSMISSIONS, REPRODUCTIONS OR ELECTRONIC MANIPULATION OF ANY PORTION OF THESE DRAWINGS IN THE WHOLE OR IN PART ARE TO BE MADE WITHOUT THE EXPRESS WRITTEN AUTHORIZATION OF ARQUITECTONICA INTERNATIONAL CORP. DESIGN INTENT SHOWN IS SUBJECT TO REVIEW AND APPROVAL OF ALL APPLICABLE LOCAL AND GOVERNMENTAL AUTHORITIES HAVING JURISDICTION. ALL COPYRIGHTS RESERVED © 2021. THE DATA INCLUDED IN THIS STUDY IS CONCEPTUAL IN NATURE AND WILL CONTINUE TO BE MODIFIED THROUGHOUT THE COURSE OF THE PROJECTS DEVELOPMENT WITH THE EVENTUAL INTEGRATION OF STRUCTURAL, MEP AND LIFE SAFETY SYSTEMS. AS THESE ARE FURTHER REFINED, THE NUMBERS WILL BE ADJUSTED ACCORDINGLY.

PB FINAL SUBMITTAL
120 MACARTHUR CAUSEWAY
MIAMI BEACH, FL

SELF-PARKING OPTION
LEVEL 01

SCALE: 1"=20'-0"

DATE:
11/29/2021

AX-302

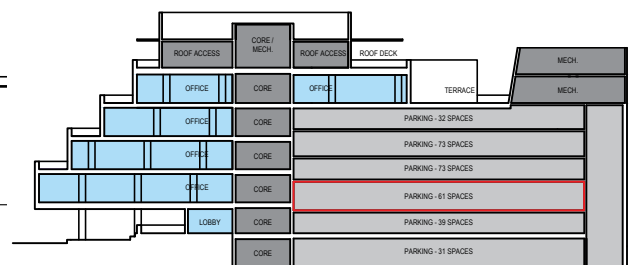
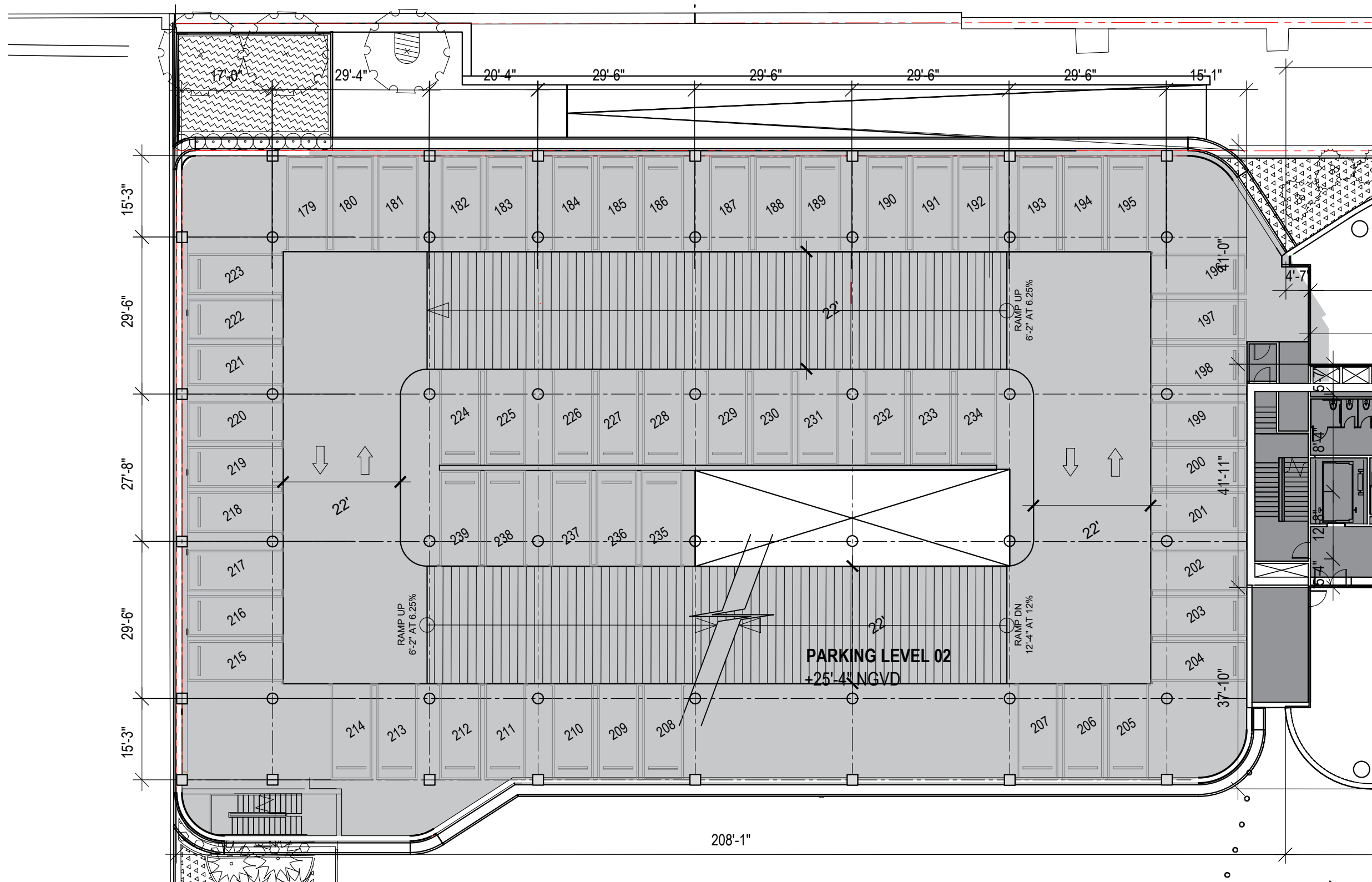

PARKING LEVEL 02
61 SPACES



ARQUITECTONICA

2900 Oak Avenue, Miami, FL 33133
T 305.372.1812 F 305.372.1175

ALL DESIGNS INDICATED IN THESE DRAWINGS ARE PROPERTY OF ARQUITECTONICA INTERNATIONAL CORP. NO COPIES, TRANSMISSIONS, REPRODUCTIONS OR ELECTRONIC MANIPULATION OF ANY PORTION OF THESE DRAWINGS IN THE WHOLE OR IN PART ARE TO BE MADE WITHOUT THE EXPRESS WRITTEN AUTHORIZATION OF ARQUITECTONICA INTERNATIONAL CORP. DESIGN INTENT SHOWN IS SUBJECT TO REVIEW AND APPROVAL OF ALL APPLICABLE LOCAL AND GOVERNMENTAL AUTHORITIES HAVING JURISDICTION. ALL COPYRIGHTS RESERVED © 2021. THE DATA INCLUDED IN THIS STUDY IS CONCEPTUAL IN NATURE AND WILL CONTINUE TO BE MODIFIED THROUGHOUT THE COURSE OF THE PROJECTS DEVELOPMENT WITH THE EVENTUAL INTEGRATION OF STRUCTURAL, MEP AND LIFE SAFETY SYSTEMS. AS THESE ARE FURTHER REFINED, THE NUMBERS WILL BE ADJUSTED ACCORDINGLY.

PB FINAL SUBMITTAL
120 MACARTHUR CAUSEWAY
MIAMI BEACH, FL

SELF-PARKING OPTION
LEVEL 02
SCALE: 1"=20'-0"

DATE:
11/29/2021

AX-303

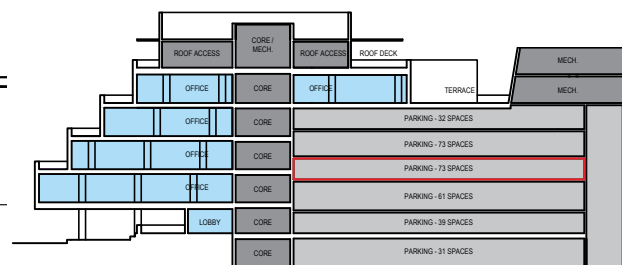
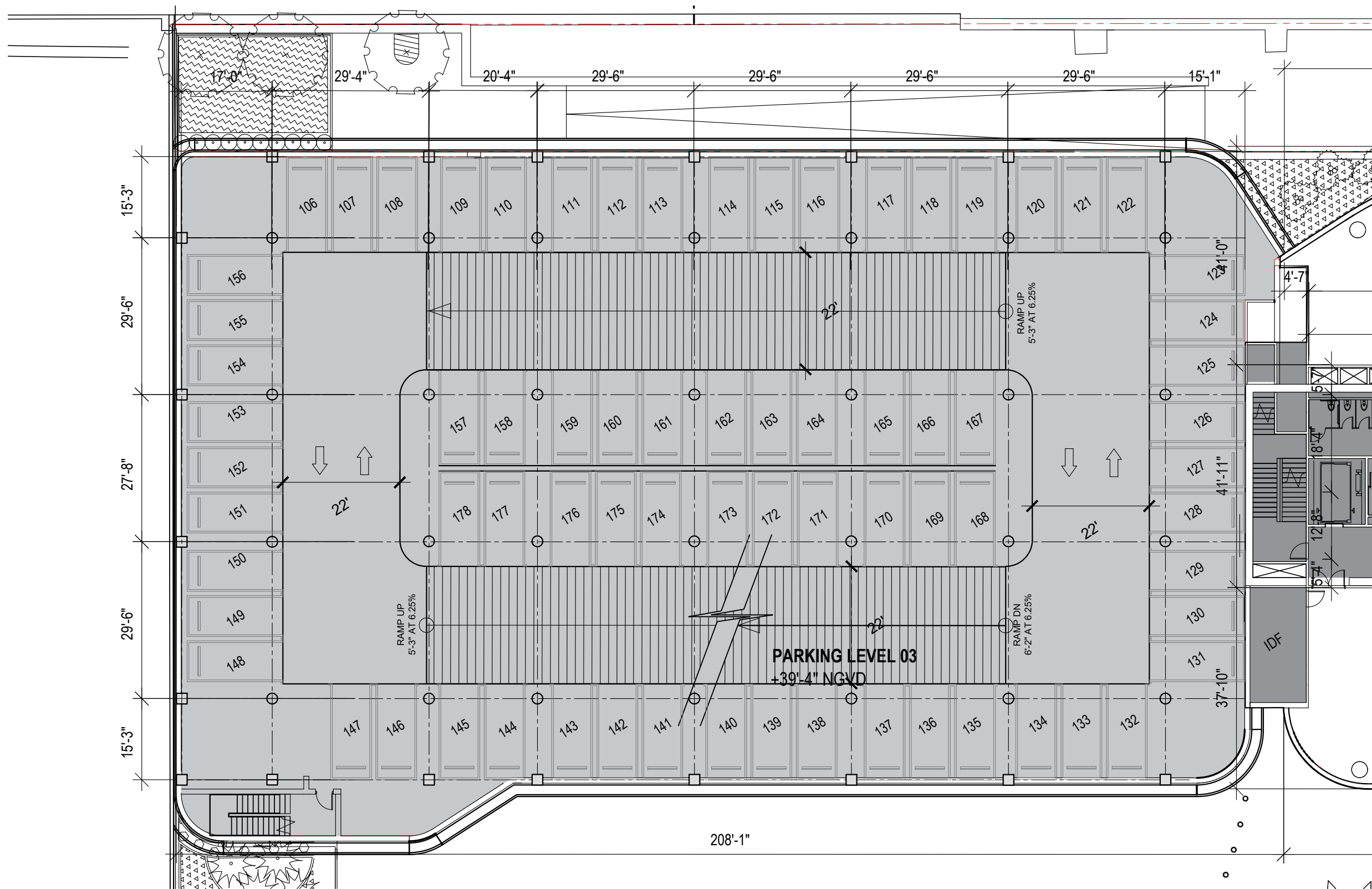

PARKING LEVEL 03
73 SPACES

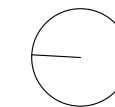
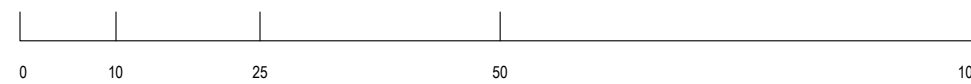

ARQUITECTONICA

2900 Oak Avenue, Miami, FL 33133
T 305.372.1812 F 305.372.1175

ALL DESIGNS INDICATED IN THESE DRAWINGS ARE PROPERTY OF ARQUITECTONICA INTERNATIONAL CORP. NO COPIES, TRANSMISSIONS, REPRODUCTIONS OR ELECTRONIC MANIPULATION OF ANY PORTION OF THESE DRAWINGS IN THE WHOLE OR IN PART ARE TO BE MADE WITHOUT THE EXPRESS WRITTEN AUTHORIZATION OF ARQUITECTONICA INTERNATIONAL CORP. DESIGN INTENT SHOWN IS SUBJECT TO REVIEW AND APPROVAL OF ALL APPLICABLE LOCAL AND GOVERNMENTAL AUTHORITIES HAVING JURISDICTION. ALL COPYRIGHTS RESERVED © 2021. THE DATA INCLUDED IN THIS STUDY IS CONCEPTUAL IN NATURE AND WILL CONTINUE TO BE MODIFIED THROUGHOUT THE COURSE OF THE PROJECTS DEVELOPMENT WITH THE EVENTUAL INTEGRATION OF STRUCTURAL, MEP AND LIFE SAFETY SYSTEMS. AS THESE ARE FURTHER REFINED, THE NUMBERS WILL BE ADJUSTED ACCORDINGLY.

PB FINAL SUBMITTAL
120 MACARTHUR CAUSEWAY
MIAMI BEACH, FL

SELF-PARKING OPTION
LEVEL 03

SCALE: 1"=20'-0"

DATE:
11/29/2021

AX-304

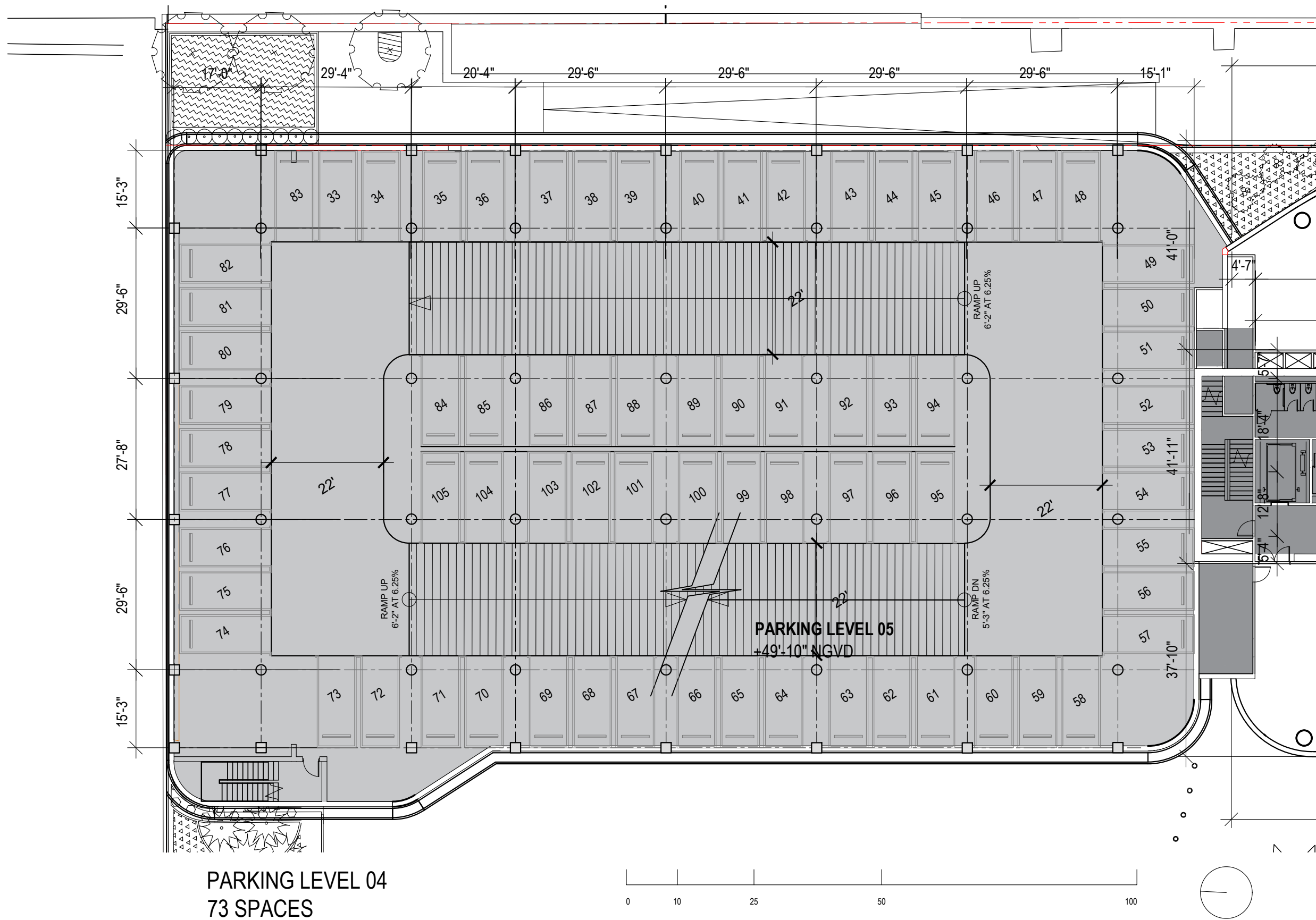

PARKING LEVEL 04
73 SPACES

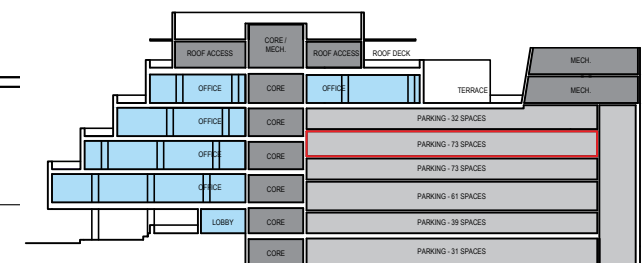
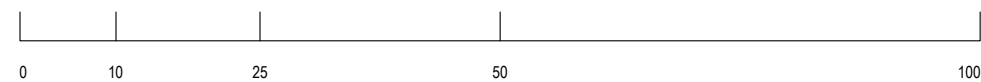

ARQUITECTONICA

2900 Oak Avenue, Miami, FL 33133
T 305.372.1812 F 305.372.1175

ALL DESIGNS INDICATED IN THESE DRAWINGS ARE PROPERTY OF ARQUITECTONICA INTERNATIONAL CORP. NO COPIES, TRANSMISSIONS, REPRODUCTIONS OR ELECTRONIC MANIPULATION OF ANY PORTION OF THESE DRAWINGS IN THE WHOLE OR IN PART ARE TO BE MADE WITHOUT THE EXPRESS WRITTEN AUTHORIZATION OF ARQUITECTONICA INTERNATIONAL CORP. DESIGN INTENT SHOWN IS SUBJECT TO REVIEW AND APPROVAL OF ALL APPLICABLE LOCAL AND GOVERNMENTAL AUTHORITIES HAVING JURISDICTION. ALL COPYRIGHTS RESERVED © 2021. THE DATA INCLUDED IN THIS STUDY IS CONCEPTUAL IN NATURE AND WILL CONTINUE TO BE MODIFIED THROUGHOUT THE COURSE OF THE PROJECTS DEVELOPMENT WITH THE EVENTUAL INTEGRATION OF STRUCTURAL, MEP AND LIFE SAFETY SYSTEMS. AS THESE ARE FURTHER REFINED, THE NUMBERS WILL BE ADJUSTED ACCORDINGLY.

PB FINAL SUBMITTAL
120 MACARTHUR CAUSEWAY
MIAMI BEACH, FL

SELF-PARKING OPTION
LEVEL 04

SCALE: 1"=20'-0"

DATE:
11/29/2021

AX-305

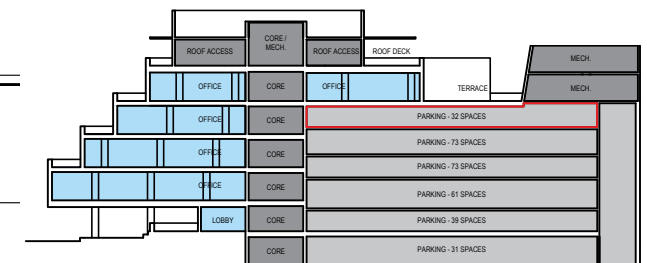
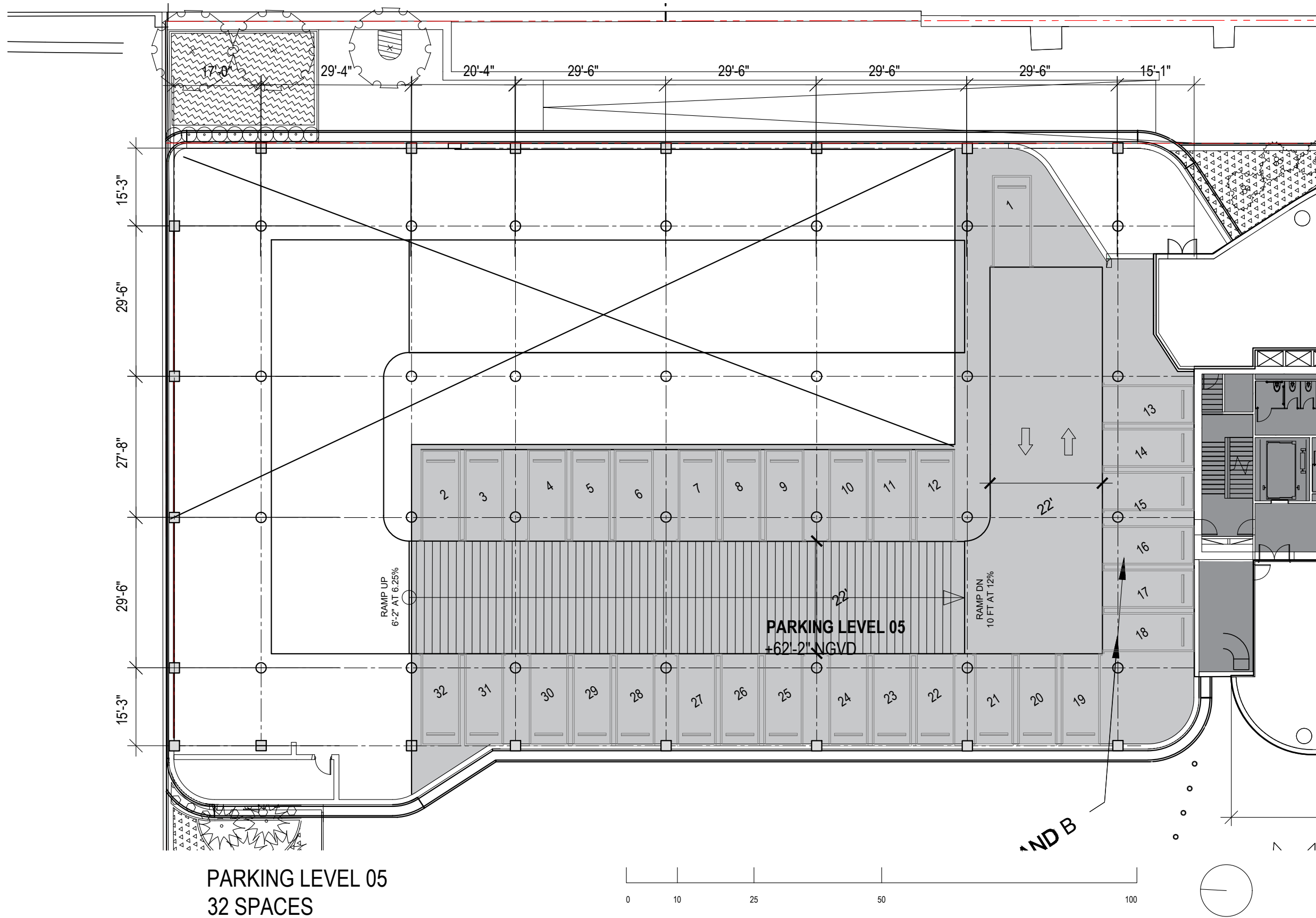

ARQUITECTONICA

2900 Oak Avenue, Miami, FL 33133
 T 305.372.1812 F 305.372.1175

ALL DESIGNS INDICATED IN THESE DRAWINGS ARE PROPERTY OF ARQUITECTONICA INTERNATIONAL CORP. NO COPIES, TRANSMISSIONS, REPRODUCTIONS OR ELECTRONIC MANIPULATION OF ANY PORTION OF THESE DRAWINGS IN THE WHOLE OR IN PART ARE TO BE MADE WITHOUT THE EXPRESS WRITTEN AUTHORIZATION OF ARQUITECTONICA INTERNATIONAL CORP. DESIGN INTENT SHOWN IS SUBJECT TO REVIEW AND APPROVAL OF ALL APPLICABLE LOCAL AND GOVERNMENTAL AUTHORITIES HAVING JURISDICTION. ALL COPYRIGHTS RESERVED © 2021. THE DATA INCLUDED IN THIS STUDY IS CONCEPTUAL IN NATURE AND WILL CONTINUE TO BE MODIFIED THROUGHOUT THE COURSE OF THE PROJECTS DEVELOPMENT WITH THE EVENTUAL INTEGRATION OF STRUCTURAL, MEP AND LIFE SAFETY SYSTEMS. AS THESE ARE FURTHER REFINED, THE NUMBERS WILL BE ADJUSTED ACCORDINGLY.

PB FINAL SUBMITTAL
120 MACARTHUR CAUSEWAY
MIAMI BEACH, FL

SELF-PARKING OPTION
LEVEL 05

SCALE: 1"=20'-0"

DATE:
 11/29/2021

AX-306