

- RIGHT-OF-WAY ENCROACHMENTS:**  
1. NOT APPLICABLE.
- PRIVATE PROPERTY IMPACTS:**  
1. PARKING STALL ELEVATIONS SHALL BE MODIFIED AS SHOWN.  
2. DRIVEWAY SLOPES SHALL BE MODIFIED AS SHOWN.  
3. ALL EXISTING TREES, HEDGES, UTILITIES, VALVE COVERS, LIDS, AND OTHER SUCH FACILITIES WITHIN THE AREA OF HARMONIZATION SHALL BE ADJUSTED AND COORDINATED WITH THE OWNER.  
4. EXISTING FENCE AND GATE SHALL BE ADJUSTED TO FINAL GRADE AS COORDINATED WITH THE OWNER.

LUIS FERNANDO LEON, STATE OF FLORIDA, PROFESSIONAL ENGINEER, LICENSE NO. 58670  
THIS ITEM HAS BEEN DIGITALLY SIGNED AND SEALED BY LUIS FERNANDO LEON ON THE DATE INDICATED HERE, 11/03/2021.  
PRINTED COPIES OF THIS DOCUMENT ARE NOT CONSIDERED SIGNED AND SEALED AND THE SIGNATURE MUST BE VERIFIED ON ANY ELECTRONIC COPIES

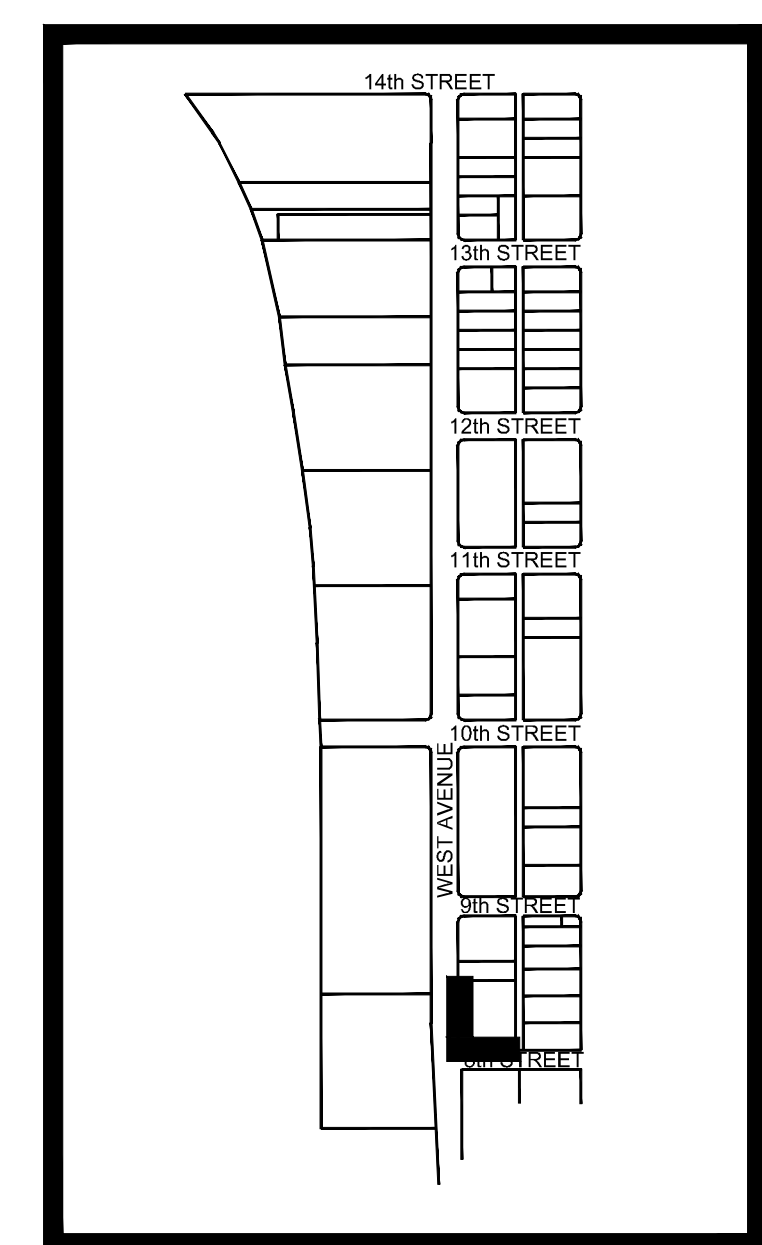

**LEGEND**

- 3.64' DENOTES PROPOSED ELEVATIONS. ELEVATIONS WITH "" DENOTES ELEVATIONS PRIOR TO PAVEMENT RELIEF PER FDOT INDEX 522-002
- 3.0 DENOTES EXISTING ELEVATIONS
- DENOTES RIGHT OF WAY LINE
- DENOTES CENTER LINE
- DENOTES PROPOSED CONCRETE
- P.L. PROPERTY LINE

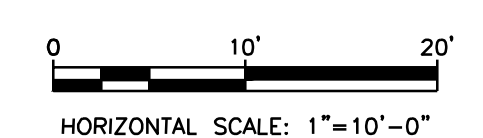
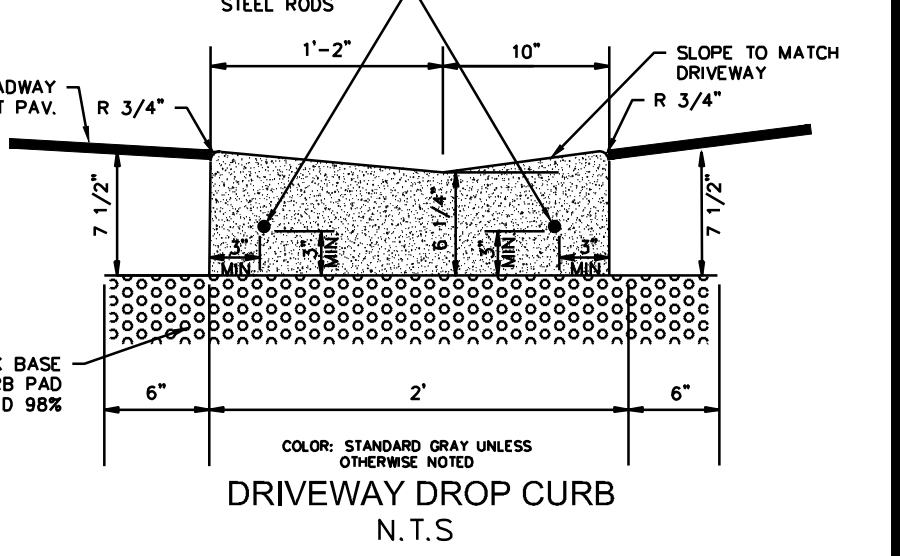
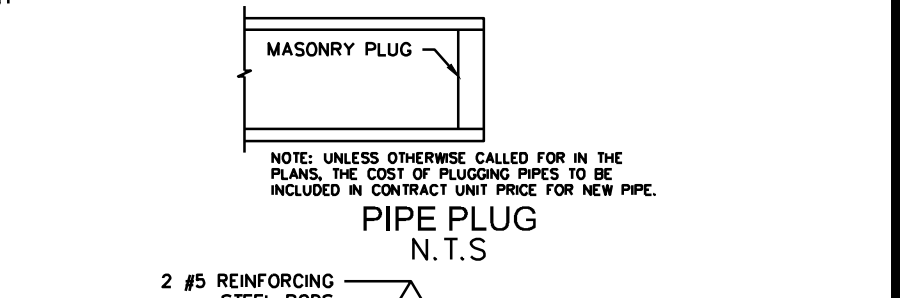
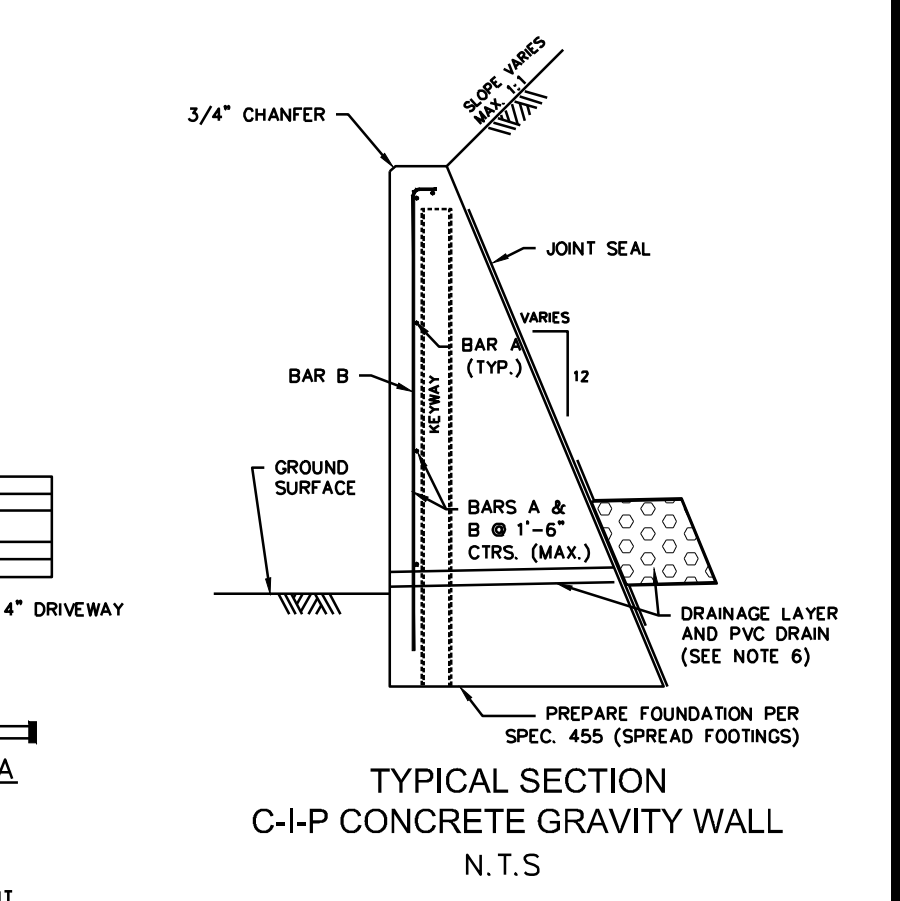
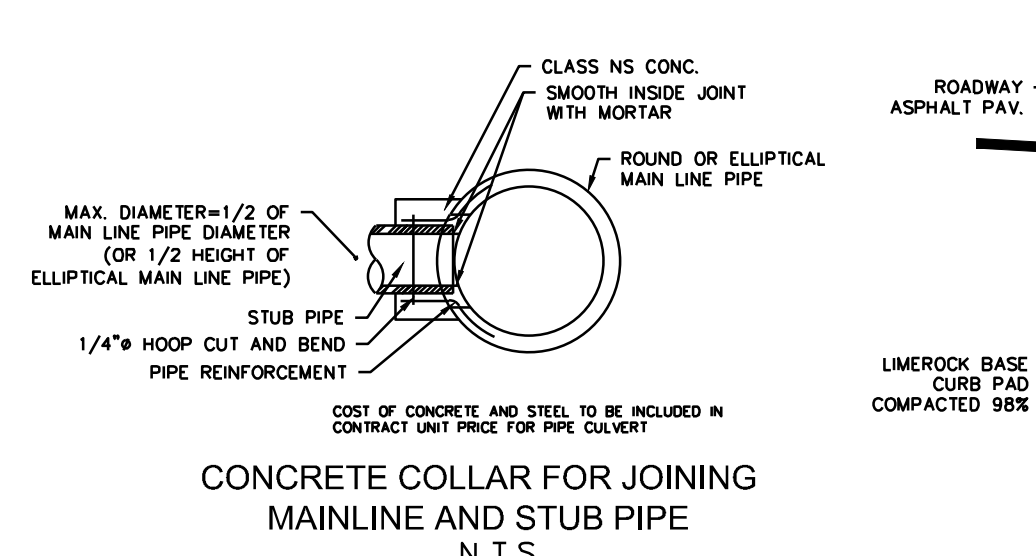
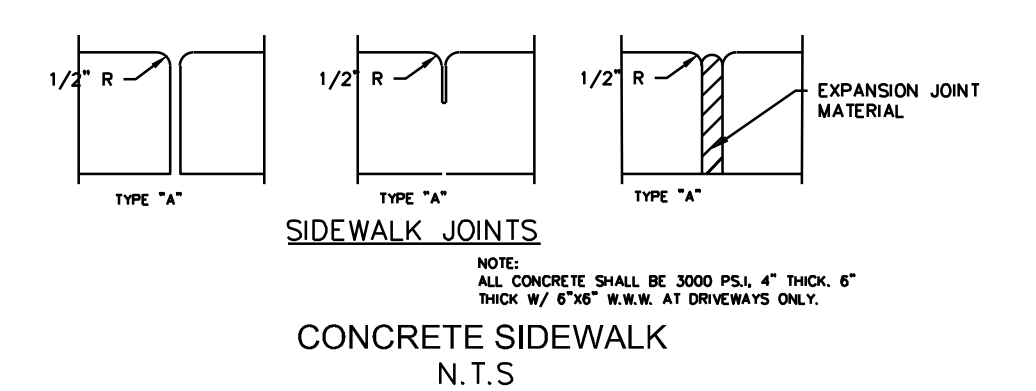
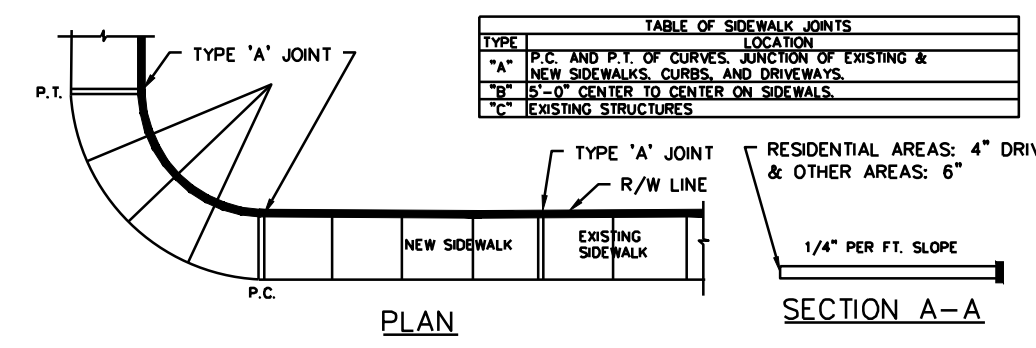
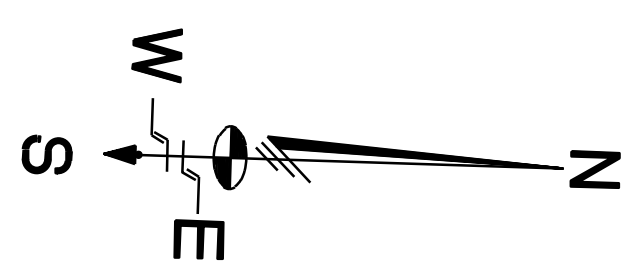
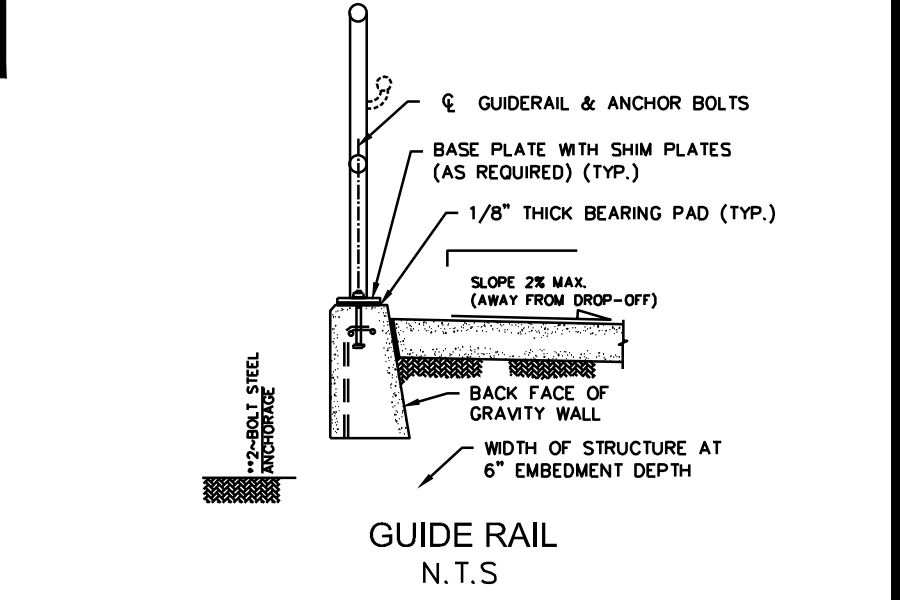
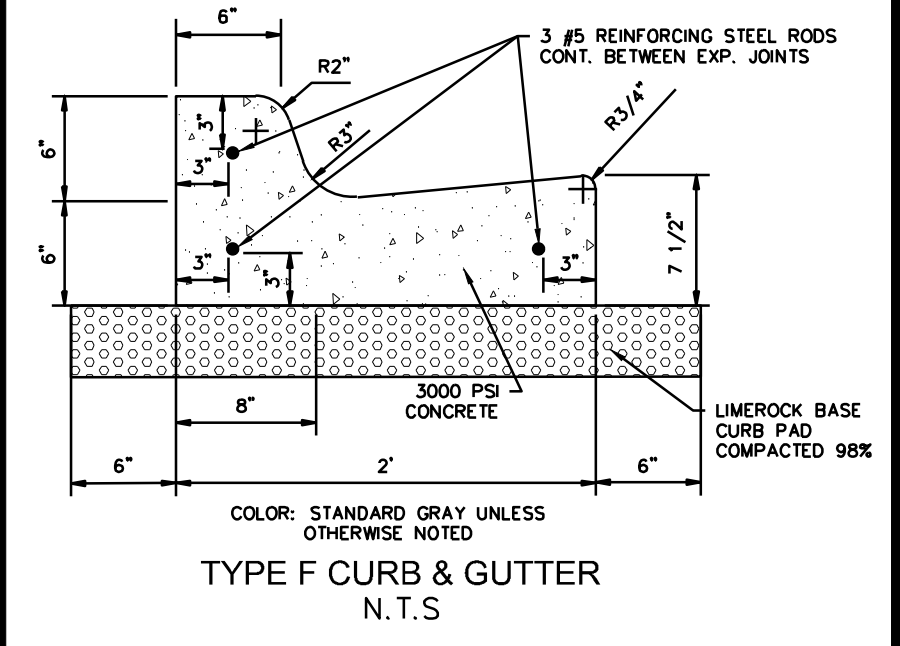
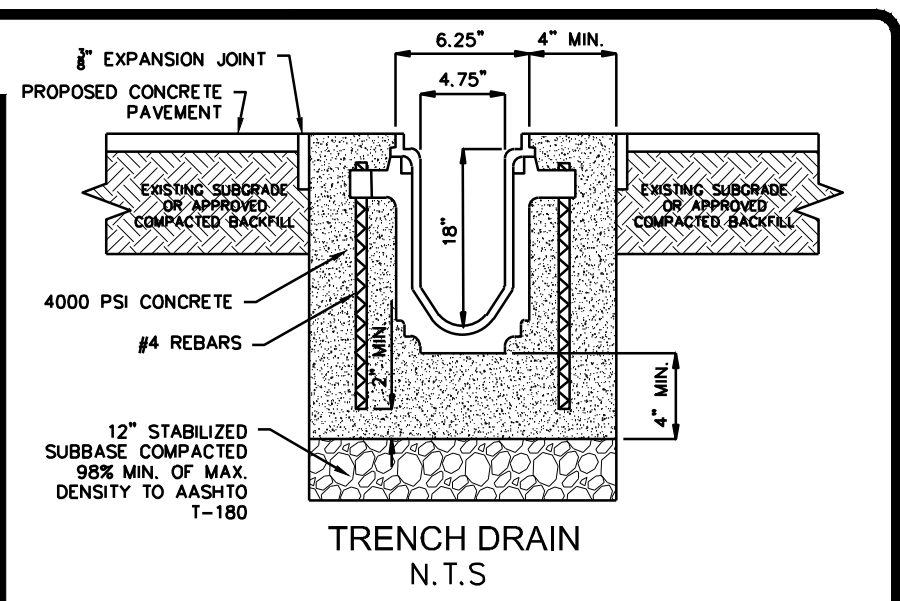

LA-1

NO.	DATE	REVISION	APP'D. BY
5			
4			
3			
2			
1	11/01/17	60% DESIGN SUBMITTAL	