

5661 PINE TREE DRIVE

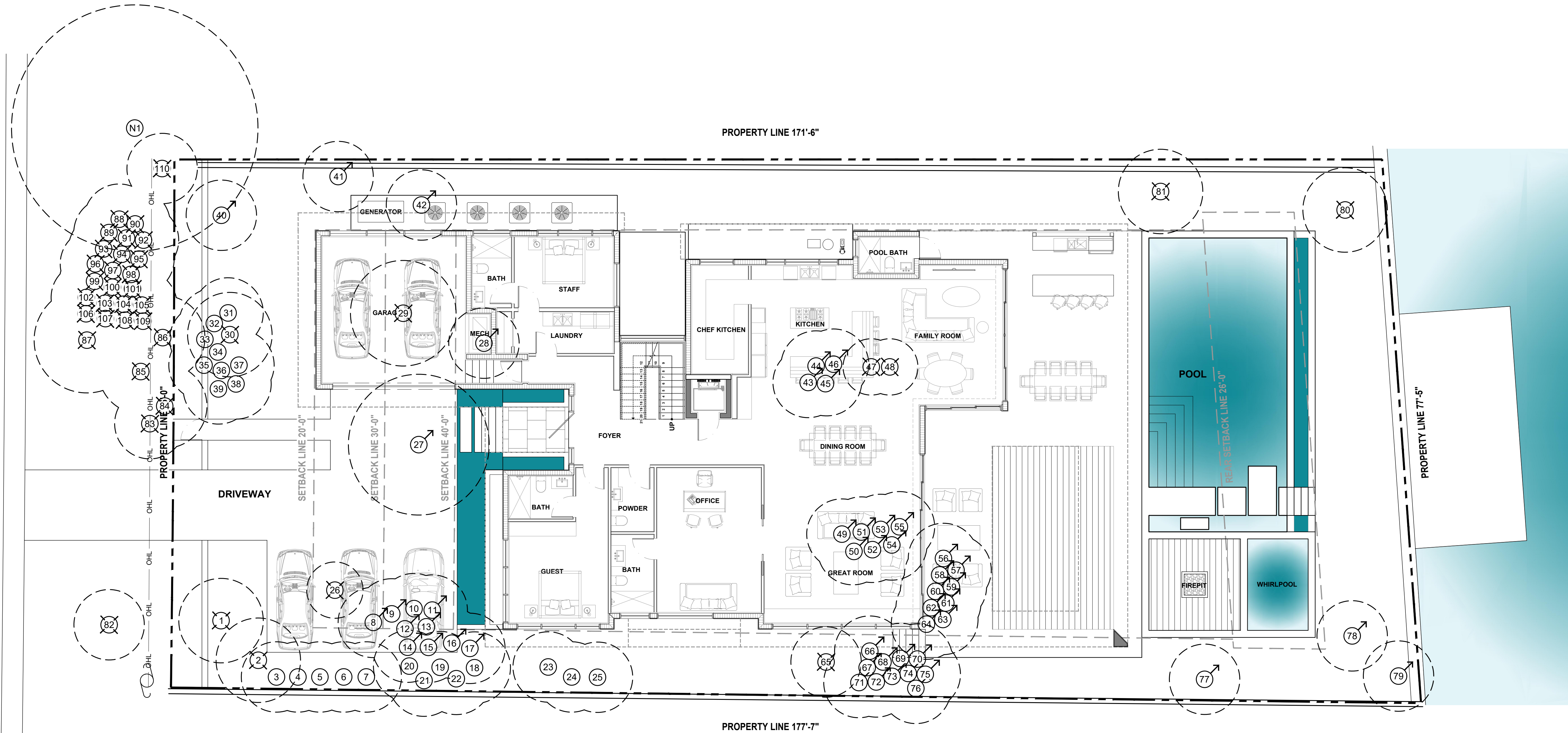

EXISTING TREE & PALM LEGEND	
	= TREE OR PALM TO REMAIN
	= TREE OR PALM TO RELOCATE
	= TREE OR PALM TO REMOVE

TREE DISPOSITION PLAN

SCALE: 1/8" = 1'-0"

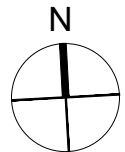
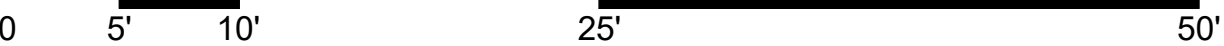

Rev.	Date	Rev.	Date
1		9	
2		10	
3		11	
4		12	
5		14	
6		15	
7		16	
8		17	

ALL DRAWINGS AND WRITTEN MATERIAL APPEARING HEREIN CONSTITUTE THE ORIGINAL AND UNPUBLISHED WORK OF Kobi Karp AIA, AND MAY NOT BE DUPLICATED, USED, OR DISCLOSED WITHOUT THE EXPRESS WRITTEN CONSENT OF Kobi Karp Architecture & Interior Design, Inc. AIA (c) 2020

DRB SUBMITTAL

PRIVATE RESIDENCE

5661 PINE TREE DRIVE
MIAMI BEACH, FL 33140

Owner:

PRIVATE RESIDENCE

Consultant:

Name
Address
Tel:
Email

Consultant:

Name
Address
Tel:
Email

Landscape Architect of Record:

David O. Design
p.o. box 331615
Coconut Grove, FL 33233-1615, USA
Tel: +1(305) 854.9299 - Fax: +1(305) 854.9882
Email: davidodesign@hotmail.com
www.davidodishoo.com

Architect of Record:

Kobi Karp Architecture and Interior Design, Inc.
2915 Biscayne Boulevard, Suite #200
Miami, Florida 33137, USA
Tel: +1(305) 573 1818
Fax: +1(305) 573 3766

david o.
landscape
architecture

DAVID J. ODISHOO
RLA #6666969

TREE DISPOSITION PLAN

Date: 10-18-2021	Sheet No.
Scale: 1/8"=1'-0"	LR-100
Project #:	

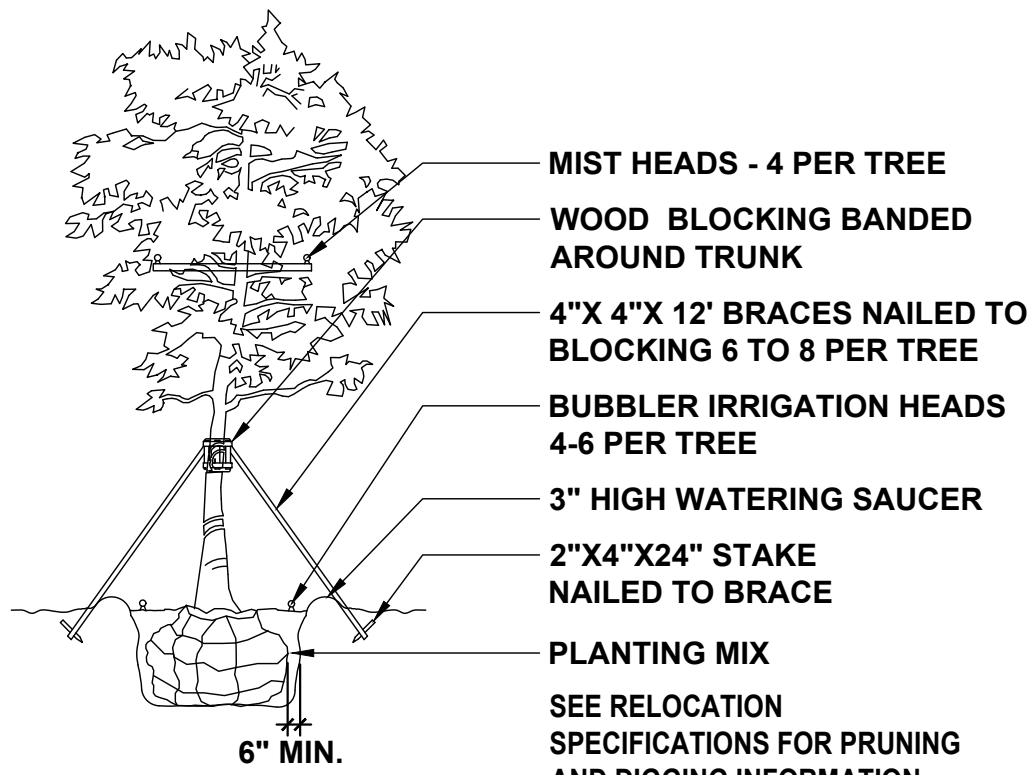

1 TREE RELOCATION DETAIL

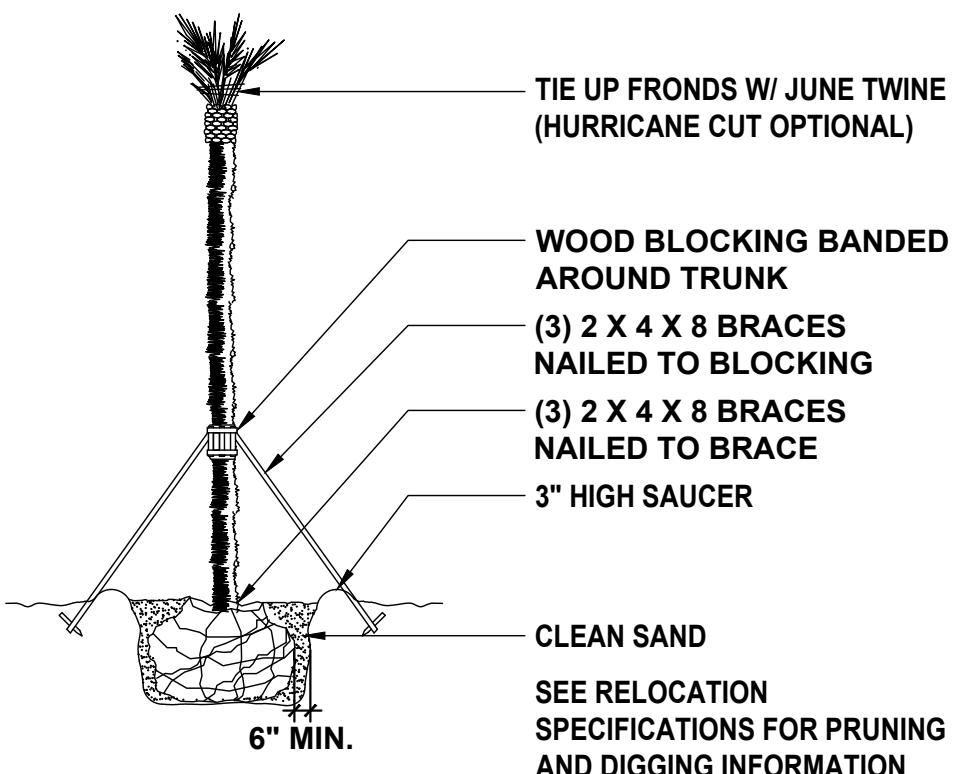

2 PALM RELOCATION DETAIL

TREE / PALM PROTECTION FENCES SHALL BE CONSTRUCTED PRIOR TO ANY CONSTRUCTION ACTIVITY INCLUDING GRUBBING FOR ALL TREES / PALMS THAT ARE 'TO REMAIN, BE PROTECTED, OR BE RELOCATED'

NO ACTIVITY OR DISTURBANCE SHOULD OCCUR WITHIN THE FENCED AREAS, INCLUDING 'VEHICLE USE, STORAGE OF MATERIALS, DUMPING OF LIQUIDS OR MATERIALS, GRADE CHANGES, GRUBBING, AND MECHANICAL TRENCHING FOR IRRIGATION, ELECTRICAL, LIGHTING, ETC.

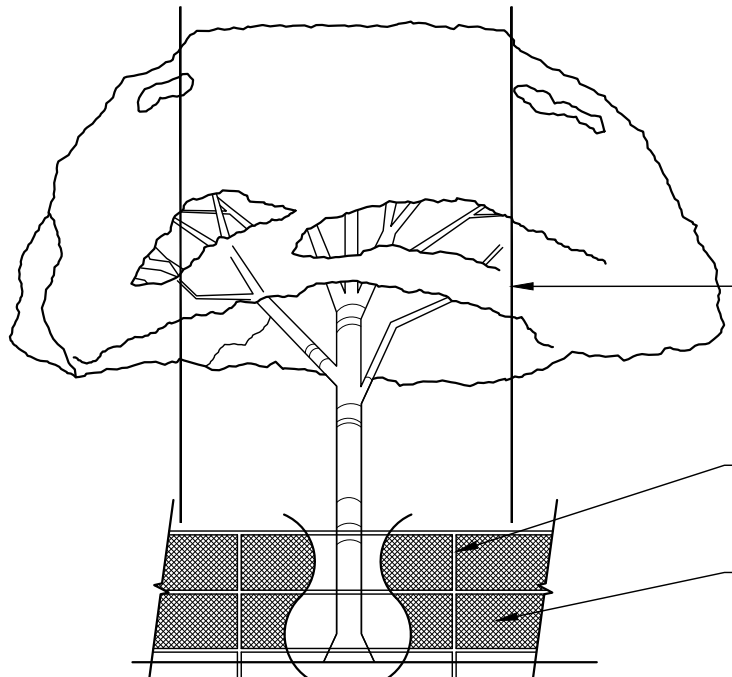

PROTECTION DETAIL NOTE

CONTRACTOR TO INSTALL 'TREE / PALM PROTECTION FENCE BARRIERS' AROUND ALL EXISTING TREES OR PALMS AT THE START OF THE PROJECT. BARRIERS TO REMAIN IN PLACE THROUGHOUT THE DURATION OF PROJECT AND SHOULD NOT BE REMOVED OR DROPPED FOR ANY REASON WITHOUT AUTHORIZATION FROM THE CITY OF MIAMI BEACH URBAN FORESTED + PLANNING + ZONING DEPARTMENT.

3 CITY OF MIAMI BEACH TREE / PALM PROTECTION DETAIL

TREE DISPOSITION SUMMARY					
	REMAIN	RELOCATE	REMOVE	TOTAL TREES	TOTAL PALMS
TREES	0	0	2	2	
PALMS	13	58	7		78

TREE DISPOSITION SCHEDULE (PROPERTY)									
TREE NUMBER	COMMON NAME	SCIENTIFIC NAME	NATIVE	DIAMETER (INCHES)	HEIGHT (FT)	CANOPY (FT)	TRUNKS	DISPOSITION	
2	ARECA PALM	DYPSIS LUTESCENS	NO	3	15	12	MULTI	REMOVE	
3	ALEXANDER PALM	PTYCHOSPERMA ELEGANS	NO	5	25	10	SINGLE	REMAIN	
4	ALEXANDER PALM	PTYCHOSPERMA ELEGANS	NO	5	25	10	SINGLE	REMAIN	
5	ALEXANDER PALM	PTYCHOSPERMA ELEGANS	NO	5	25	10	SINGLE	REMAIN	
6	ALEXANDER PALM	PTYCHOSPERMA ELEGANS	NO	5	20	10	SINGLE	REMAIN	
7	ALEXANDER PALM	PTYCHOSPERMA ELEGANS	NO	5	20	10	SINGLE	REMAIN	
8	ALEXANDER PALM	PTYCHOSPERMA ELEGANS	NO	5	20	10	SINGLE	RELOCATE	
9	ALEXANDER PALM	PTYCHOSPERMA ELEGANS	NO	5	25	10	SINGLE	RELOCATE	
10	ALEXANDER PALM	PTYCHOSPERMA ELEGANS	NO	5	15	10	SINGLE	RELOCATE	
11	ALEXANDER PALM	PTYCHOSPERMA ELEGANS	NO	5	25	10	SINGLE	RELOCATE	
12	ALEXANDER PALM	PTYCHOSPERMA ELEGANS	NO	5	25	10	SINGLE	RELOCATE	
13	ALEXANDER PALM	PTYCHOSPERMA ELEGANS	NO	5	25	10	SINGLE	RELOCATE	
14	ALEXANDER PALM	PTYCHOSPERMA ELEGANS	NO	5	20	10	SINGLE	RELOCATE	
15	ALEXANDER PALM	PTYCHOSPERMA ELEGANS	NO	5	25	10	SINGLE	RELOCATE	
16	ALEXANDER PALM	PTYCHOSPERMA ELEGANS	NO	5	25	10	SINGLE	RELOCATE	
17	ALEXANDER PALM	PTYCHOSPERMA ELEGANS	NO	5	20	10	SINGLE	RELOCATE	
18	ALEXANDER PALM	PTYCHOSPERMA ELEGANS	NO	5	20	10	SINGLE	REMAIN	
19	ALEXANDER PALM	PTYCHOSPERMA ELEGANS	NO	5	20	10	SINGLE	REMAIN	
20	ALEXANDER PALM	PTYCHOSPERMA ELEGANS	NO	5	20	10	SINGLE	REMAIN	
21	ALEXANDER PALM	PTYCHOSPERMA ELEGANS	NO	5	20	10	SINGLE	REMAIN	
22	ALEXANDER PALM	PTYCHOSPERMA ELEGANS	NO	5	20	10	SINGLE	REMAIN	
23	ALEXANDER PALM	PTYCHOSPERMA ELEGANS	NO	5	20	10	SINGLE	REMAIN	
24	ALEXANDER PALM	PTYCHOSPERMA ELEGANS	NO	5	15	10	SINGLE	REMAIN	
25	ALEXANDER PALM	PTYCHOSPERMA ELEGANS	NO	5	20	10	SINGLE	REMAIN	
26	THATCH PALM	THRINAX RADIATA	YES	4	16	8	SINGLE	REMOVE	
27	ROYAL PALM	ROYSTONEA ELATA	YES	15	25	20	SINGLE	RELOCATE	
28	ALEXANDER PALM	PTYCHOSPERMA ELEGANS	NO	5	50	10	SINGLE	RELOCATE	
29	ARECA PALM	DYPSIS LUTESCENS	NO	3	45	15	MULTI	REMOVE	
30	CHINESE FAN PALM	LIVISTONEA CHINENSIS	NO	9	14	12	SINGLE	REMOVE	
31	ALEXANDER PALM	PTYCHOSPERMA ELEGANS	NO	5	25	10	SINGLE	RELOCATE	
32	ALEXANDER PALM	PTYCHOSPERMA ELEGANS	NO	5	20	10	SINGLE	RELOCATE	
33	ALEXANDER PALM	PTYCHOSPERMA ELEGANS	NO	5	15	10	SINGLE	RELOCATE	
34	ALEXANDER PALM	PTYCHOSPERMA ELEGANS	NO	5	15	10	SINGLE	RELOCATE	
35	ALEXANDER PALM	PTYCHOSPERMA ELEGANS	NO	5	15	10	SINGLE	RELOCATE	
36	ALEXANDER PALM	PTYCHOSPERMA ELEGANS	NO	5	15	10	SINGLE	RELOCATE	
37	ALEXANDER PALM	PTYCHOSPERMA ELEGANS	NO	5	15	10	SINGLE	RELOCATE	
38	ALEXANDER PALM	PTYCHOSPERMA ELEGANS	NO	5	25	10	SINGLE	RELOCATE	
39	ALEXANDER PALM	PTYCHOSPERMA ELEGANS	NO	5	20	10	SINGLE	RELOCATE	
40	ALEXANDER PALM	PTYCHOSPERMA ELEGANS	NO	5	15	10	SINGLE	RELOCATE	
41	ALEXANDER PALM	PTYCHOSPERMA ELEGANS	NO	5	15	10	SINGLE	RELOCATE	
42	ALEXANDER PALM	PTYCHOSPERMA ELEGANS	NO	5	20	10	SINGLE	RELOCATE	
43	ALEXANDER PALM	PTYCHOSPERMA ELEGANS	NO	5	25	10	SINGLE	RELOCATE	
44	ALEXANDER PALM	PTYCHOSPERMA ELEGANS	NO	5	25	10	SINGLE	RELOCATE	
45	ALEXANDER PALM	PTYCHOSPERMA ELEGANS	NO	5	20	10	SINGLE	RELOCATE	
46	ALEXANDER PALM	PTYCHOSPERMA ELEGANS	NO	5	15	10	SINGLE	RELOCATE	
47	DWARF ROEBELLINI	PHOENIX ROEBELLINI	NO	4	10	8	SINGLE	REMOVE	
48	DWARF ROEBELLINI	PHOENIX ROEBELLINI	NO	4	10	8	SINGLE	REMOVE	
49	ALEXANDER PALM	PTYCHOSPERMA ELEGANS	NO	5	15	10	SINGLE	RELOCATE	
50	ALEXANDER PALM	PTYCHOSPERMA ELEGANS	NO	5	15	10	SINGLE	RELOCATE	
51	ALEXANDER PALM	PTYCHOSPERMA ELEGANS	NO	5	15	10	SINGLE	RELOCATE	
52	ALEXANDER PALM	PTYCHOSPERMA ELEGANS	NO	5	20	10	SINGLE	RELOCATE	
53	ALEXANDER PALM	PTYCHOSPERMA ELEGANS	NO	5	20	10	SINGLE	RELOCATE	
54	ALEXANDER PALM	PTYCHOSPERMA ELEGANS	NO	5	15	10	SINGLE	RELOCATE	
55	ALEXANDER PALM	PTYCHOSPERMA ELEGANS	NO	5	15	10	SINGLE	RELOCATE	
56	ALEXANDER PALM	PTYCHOSPERMA ELEGANS	NO	5	20	10	SINGLE	RELOCATE	
57	ALEXANDER PALM	PTYCHOSPERMA ELEGANS	NO	5	15	10	SINGLE	RELOCATE	
58	ALEXANDER PALM	PTYCHOSPERMA ELEGANS	NO	5	15	10	SINGLE	RELOCATE	
59	ALEXANDER PALM	PTYCHOSPERMA ELEGANS	NO	5	25	10	SINGLE	RELOCATE	
60	ALEXANDER PALM	PTYCHOSPERMA ELEGANS	NO	5	20	10	SINGLE	RELOCATE	
61	ALEXANDER PALM	PTYCHOSPERMA ELEGANS	NO	5	15	10	SINGLE	RELOCATE	
62	ALEXANDER PALM	PTYCHOSPERMA ELEGANS	NO	5	15	10	SINGLE	RELOCATE	
63	ALEXANDER PALM	PTYCHOSPERMA ELEGANS	NO	5	25	10	SINGLE	RELOCATE	
64	ALEXANDER PALM	PTYCHOSPERMA ELEGANS	NO	5	20	10	SINGLE	RELOCATE	
65	LAKEVIEW JASMINE	MURRAYA PANICULATA	NO	9	12	10	SINGLE	REMOVE	
66	ALEXANDER PALM	PTYCHOSPERMA ELEGANS	NO	5	15	10	SINGLE	RELOCATE	
67	ALEXANDER PALM	PTYCHOSPERMA ELEGANS	NO	5	15	10	SINGLE	RELOCATE	
68	ALEXANDER PALM	PTYCHOSPERMA ELEGANS	NO	5	15	10	SINGLE	RELOCATE	
69	ALEXANDER PALM	PTYCHOSPERMA ELEGANS	NO	5	25	10	SINGLE	RELOCATE	
70	ALEXANDER PALM	PTYCHOSPERMA ELEGANS	NO	5	20	10	SINGLE	RELOCATE	
71	ALEXANDER PALM	PTYCHOSPERMA ELEGANS	NO	5	15	10	SINGLE	RELOCATE	
72	ALEXANDER PALM	PTYCHOSPERMA ELEGANS	NO	5	20	10	SINGLE	RELOCATE	
73	ALEXANDER PALM	PTYCHOSPERMA ELEGANS	NO	5	15	10	SINGLE	RELOCATE	
74	ALEXANDER PALM	PTYCHOSPERMA ELEGANS	NO	5	25	10	SINGLE	RELOCATE	
75	ALEXANDER PALM	PTYCHOSPERMA ELEGANS	NO	5	20	10	SINGLE	RELOCATE	
76	ALEXANDER PALM	PTYCHOSPERMA ELEGANS	NO	5	15	10	SINGLE	RELOCATE	
77	ALEXANDER PALM	PTYCHOSPERMA ELEGANS	NO	5	20	10	SINGLE	RELOCATE	
78	ALEXANDER PALM	PTYCHOSPERMA ELEGANS	NO	5	15	10	SINGLE	RELOCATE	
79	ALEXANDER PALM	PTYCHOSPERMA ELEGANS	NO	5	15	10	SINGLE	RELOCATE	
80	SPANISH BAYONETTE	YUCCA ALOIFOLIA	NO	12	12	12	SINGLE	REMOVE	
81	CRAPE MYRTLE	LAGERSTROEMIA INDICA	NO	9	14	12	SINGLE	REMOVE	

TREE DISPOSITION SCHEDULE (RIGHT-OF-WAY)									
TREE NUMBER	COMMON NAME	SCIENTIFIC NAME	NATIVE	DIAMETER (INCHES)	HEIGHT (FT)	CANOPY (FT)	TRUNKS	DISPOSITION	
82	ALEXANDER PALM	PTYCHOSPERMA ELEGANS	NO	5	30	10	SINGLE	REMOVE	
83	THATCH PALM	THRINAX RADIATA	YES	6	5	15	SINGLE	REMOVE	
84	CHINESE FAN PALM	LIVISTONEA CHINENSIS	NO	9	15	12	SINGLE	REMOVE	
85	CHINESE FAN PALM	LIVISTONEA CHINENSIS	NO	9	15	12	SINGLE	REMOVE	
86	CHINESE FAN PALM	LIVISTONEA CHINENSIS	NO	9	15	12	SINGLE	REMOVE	
87	DATE PALM	PHOENIX CANARIENSIS	NO	24	35	15	SINGLE	REMOVE	
88	ALEXANDER PALM	PTYCHOSPERMA ELEGANS	NO	5	15	10	SINGLE	REMOVE	
89	ALEXANDER PALM	PTYCHOSPERMA ELEGANS	NO	5	15	10	SINGLE	REMOVE	
90	ALEXANDER PALM	PTYCHOSPERMA ELEGANS	NO	5	20	10	SINGLE	REMOVE	
91	ALEXANDER PALM	PTYCHOSPERMA ELEGANS	NO	5	25	10	SINGLE	REMOVE	
92	ALEXANDER PALM	PTYCHOSPERMA ELEGANS	NO	5	20	10	SINGLE	REMOVE	
93	ALEXANDER PALM	PTYCHOSPERMA ELEGANS	NO	5	20	10	SINGLE	REMOVE	
94	ALEXANDER PALM	PTYCHOSPERMA ELEGANS	NO	5	20	10	SINGLE	REMOVE	
95	ALEXANDER PALM	PTYCHOSPERMA ELEGANS	NO	5	15	10	SINGLE	REMOVE	
96	ALEXANDER PALM	PTYCHOSPERMA ELEGANS	NO	5	25	10	SINGLE	REMOVE	
97	ALEXANDER PALM	PTYCHOSPERMA ELEGANS	NO	5	20	10	SINGLE	REMOVE	
98	ALEXANDER PALM	PTYCHOSPERMA ELEGANS	NO	5	25	10	SINGLE	REMOVE	
99	ALEXANDER PALM	PTYCHOSPERMA ELEGANS	NO	5	15	10	SINGLE	REMOVE	
100	ALEXANDER PALM	PTYCHOSPERMA ELEGANS	NO	5	15	10	SINGLE	REMOVE	
101	ALEXANDER PALM	PTYCHOSPERMA ELEGANS	NO	5	15	10	SINGLE	REMOVE	
102	ALEXANDER PALM	PTYCHOSPERMA ELEGANS	NO	5	20	10	SINGLE	REMOVE	
103	ALEXANDER PALM	PTYCHOSPERMA ELEGANS	NO	5	25	10	SINGLE	REMOVE	
104	ALEXANDER PALM	PTYCHOSPERMA ELEGANS	NO	5	20	10	SINGLE	REMOVE	
105	ALEXANDER PALM	PTYCHOSPERMA ELEGANS	NO	5	20	10	SINGLE	REMOVE	
106	ALEXANDER PALM	PTYCHOSPERMA ELEGANS	NO	5	15	10	SINGLE	REMOVE	
107	ALEXANDER PALM	PTYCHOSPERMA ELEGANS	NO	5	20	10	SINGLE	REMOVE	
108	ALEXANDER PALM	PTYCHOSPERMA ELEGANS	NO	5	20	10	SINGLE	REMOVE	
109	ALEXANDER PALM	PTYCHOSPERMA ELEGANS	NO	5	20	10	SINGLE	REMOVE	
110	QUEEN PALM	SYAGRUS ROMANZOFFIANA	NO	6	14	8	SINGLE	REMOVE	

TREE DISPOSITION SCHEDULE (NEIGHBOR'S RIGHT-OF-WAY)								
TREE NUMBER	COMMON NAME	SCIENTIFIC NAME	NATIVE	DIAMETER (INCHES)	HEIGHT (FT)	CANOPY (FT)	TRUNKS	DISPOSITION
N1	BANYAN TREE	FICUS BENJAMINA	NO	54	45	35	SINGLE	REMAIN

Rev.	Date	Rev.	Date
1		9	
2		10	
3		11	
4		12	
5		14	
6		15	
7		16	
8		17	

ALL DRAWINGS AND WRITTEN MATERIAL APPEARING HEREIN CONSTITUTE THE ORIGINAL AND UNPUBLISHED WORK OF KOBİ KARP AIA, AND MAY NOT BE DUPLICATED, USED, OR DISCLOSED WITHOUT THE EXPRESS WRITTEN CONSENT OF KOBİ KARP ARCHITECTURE & INTERIOR DESIGN, INC. AIA (© 2020)

DRB SUBMITTAL

PRIVATE RESIDENCE

5661 PINE TREE DRIVE
MIAMI BEACH, FL 33140

Owner:

PRIVATE RESIDENCE

Consultant:

Name
Address
Address
Tel.
Email

Consultant:

Name
Address
Address
Tel.
Email

Landscape Architect of Record:

David O. Design
p.o. box 331615
Coconut Grove, FL 33233-1615, USA
Tel: +1(305) 854.9299 - Fax: +1(305) 854.9882
Email: davidodesign@hotmail.com
www.davidodishoo.com

Architect of Record:

Kobi Karp Architecture and Interior Design, Inc.
2915 Biscayne Boulevard, Suite #200
Miami, Florida 33137 USA
Tel: +1(305) 573 1816
Fax: +1(305) 573 3766

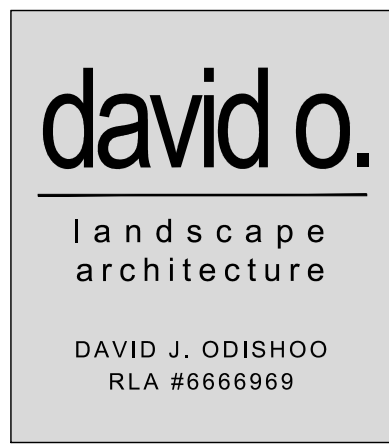

TREE DISPOSITION SCHEDULE & TREE PROTECTION DETAILS

Date:	10-18-2021	Sheet No.
Scale :		LR-200
Project # :		

TREE / PALM PROTECTION NOTES

1. CONTRACTOR QUALIFICATIONS

- 1.1. CONTRACTOR MUST BE A LICENSED LANDSCAPE CONTRACTOR.
- 1.2. CONTRACTOR MUST HAVE A MINIMUM OF 10 YEARS OF PROVEN EXPERIENCE RELOCATING LARGE SPECIMEN TREES AND PALMS IN SOUTH FLORIDA.
- 1.3. CONTRACTOR MUST HAVE PROVEN EXPERIENCE RELOCATING TREES AND PALMS OF THE SAME SPECIES AND SIZE AS THOSE TO BE RELOCATED FOR THE CURRENT PROJECT.
- 1.4. CONTRACTOR MUST HAVE A CERTIFIED ARBORIST ON STAFF.

2. CONTRACTOR REQUIREMENTS

- 2.1. CONTRACTOR MUST VISIT THE JOBSITE AND INSPECT ALL TREES AND PALMS TO BE RELOCATED AS WELL AS EXISTING SITE CONDITIONS, CO-ORDINATE WITH THE LANDSCAPE ARCHITECT TO PREPARE BID.
- 2.2. CONTRACTOR MUST VERIFY AND ENSURE THAT ALL TREES AND PALMS IDENTIFIED ON THE PLANS AND THOSE TAGGED ON THE JOBSITE CORRESPOND AS TO NUMBER AND DESCRIPTION. ANY DISCREPANCIES MUST BE BROUGHT TO THE ATTENTION OF THE LANDSCAPE ARCHITECT IMMEDIATELY, PRIOR TO PREPARING BID.
- 2.3. CONTRACTOR MUST CONDUCT ALL WORK ASSOCIATED WITH RELOCATION AND MAINTENANCE OF TREES AND PALMS TO BE RELOCATED. NO WORK IS TO BE SUBCONTRACTED WITHOUT PRIOR WRITTEN CONSENT OF THE OWNER AND/OR LANDSCAPE ARCHITECT.
- 2.4. CONTRACTOR MUST DESIGNATE A COMPETENT, SUPERVISOR OR FOREMAN TO OVERSEE AND DIRECT ALL RELOCATION AND MAINTENANCE ACTIVITIES AS OUTLINED IN THESE SPECIFICATIONS.
- 2.5. CONTRACTOR MUST SCHEDULE ROOT PRUNING TO PROVIDE THE MAXIMUM POSSIBLE TIME FOR NEW ROOT GROWTH: EVEN TREES AND PALMS THAT TYPICALLY DO NOT REQUIRE LONG (OR ANY) ROOT PRUNING WILL BENEFIT FROM MORE ROOT PRUNING TIME. THEREFORE, ALL TREES AND PALMS TO BE RELOCATED MUST BE ROOT PRUNED. CONTRACTOR MUST PROVIDE A ROOT PRUNE SCHEDULE FOR EACH TREE OR PALM TO BE RELOCATED AS AN ATTACHMENT TO THE BID.
- 2.6. CONTRACTOR MUST CALL SUNSHINE 811 TO HAVE ALL UNDERGROUND UTILITIES LOCATED UNDER OR IN THE VICINITY OF THE CURRENT OR FUTURE LOCATIONS OF ALL TREES AND PALMS TO BE RELOCATED PRIOR TO WORK COMMENCING.
- 2.7. CONTRACTOR MUST VERIFY WITH THE GENERAL CONTRACTOR THE ABSENCE OF ANY UNDERGROUND CONSTRUCTION OR OBSTRUCTIONS (E.G., BULKHEADS, SEPTIC SYSTEMS, ETC.) IN THE CURRENT AND FUTURE LOCATIONS OF ALL TREES AND PALMS TO BE RELOCATED.
- 2.8. CONTRACTOR MUST ALERT THE LANDSCAPE ARCHITECT OF ANY TREES OR PALMS THAT WILL NOT SUCCESSFULLY RELOCATE DUE TO POOR HEALTH PRIOR TO BEGINNING ROOT PRUNING.
- 2.9. CONTRACTOR MUST FLAG ALL PROPOSED TRANSPLANT LOCATIONS FOR THE LANDSCAPE ARCHITECT'S APPROVAL, A MINIMUM OF 15 DAYS PRIOR TO RELOCATION.
- 2.10. CONTRACTOR MUST ENSURE THAT ALL TREES AND PALMS TO BE RELOCATED ARE INSTALLED AT THE CORRECT GRADE OR ELEVATION, ACCORDING TO THE GRADING PLAN.
- 2.11. CONTRACTOR MUST ENSURE THAT ALL ROOT FLARES ARE EXPOSED AFTER RELOCATION.
- 2.12. CONTRACTOR MUST REMOVE ALL RESIDUAL ROOTS, STUMPS, AND PORTIONS THEREOF AND BACKFILL PITS FROM WHICH RELOCATED TREES AND PALMS WERE REMOVED WITH CLEAN FILL FLUSH WITH THE SURROUNDING GRADE.
- 2.13. CONTRACTOR MUST REPAIR ANY DAMAGE TO OTHER PLANTS, LAWN, HARDSCAPES, OR NEW CONSTRUCTION WITHIN THE RELOCATION AREA AT CONTRACTOR'S EXPENSE. HARDSCAPES INCLUDE BUT ARE NOT LIMITED TO CURBS, WALKS, ROADS, FENCES, SITE FURNISHINGS, ETC.
- 2.14. CONTRACTOR MUST PHOTOGRAPHICALLY DOCUMENT NEW ROOT GROWTH FOLLOWING EACH ROOT PRUNE AND SUBMIT THIS DOCUMENTATION TO THE LANDSCAPE ARCHITECT. THE PURPOSE OF THIS REQUIREMENT IS TO ENSURE THAT SUFFICIENT ROOT GROWTH HAS OCCURRED PRIOR TO THE SECOND AND SUBSEQUENT ROOT PRUNES AND FOLLOWING THE FINAL ROOT PRUNE PRIOR TO RELOCATION.
- 2.15. CONTRACTOR MUST INSTALL AND MAINTAIN PROTECTION FENCING AROUND EACH TREE AND PALM TO BE RELOCATED BOTH DURING ROOT PRUNING AND AFTER RELOCATION. PROTECTION FENCING MUST CONSIST OF GALVANIZED WELDED WIRE FABRIC OR PLASTIC MESH ATTACHED TO 4" X 4' POSTS INSERTED AROUND THE PERIMETER OF THE DRIPLINE OF THE TREE OR PALM. PROTECTION FENCING MUST BE PLUMB, TAUT, AND STURDY AT ALL TIMES AND MUST REMAIN IN PLACE THROUGHOUT THE ROOT PRUNING AND WARRANTY PERIODS, OR AS DIRECTED BY THE LANDSCAPE ARCHITECT.
- 2.16. CONTRACTOR MUST OBTAIN ALL NECESSARY OR REQUIRED PERMITS FOR THE RELOCATION AND TRANSPORTATION OF THE TREES AND PALMS TO BE RELOCATED.
- 2.17. CONTRACTOR MUST REPLACE ANY TREES OR PALMS SCARRED OR DAMAGED DURING RELOCATION, AT THE CONTRACTOR'S EXPENSE, WITH THE SAME OR SIMILAR SPECIES, SIZE, AND QUALITY. REPLACEMENT TREES OR PALMS MUST BE APPROVED BY THE LANDSCAPE ARCHITECT PRIOR TO PROCUREMENT, PREPARATION, AND/OR INSTALLATION. REPLACEMENT TREES AND PALMS MUST BE INSTALLED WITHIN 60 DAYS OF NOTICE.
- 2.18. CONTRACTOR MUST GUARANTEE ALL RELOCATED TREES AND PALMS FOR ONE YEAR FROM THE DATE OF RELOCATION TO THE FINAL LOCATION. GUARANTY MUST INCLUDE TREE HEALTH AND SETTLING.
- 2.19. CONTRACTOR MUST PROVIDE ALL MATERIAL NECESSARY TO PERFORM THE WORK COVERED HEREIN, INCLUDING BUT NOT LIMITED TO BACKFILL MATERIAL, PROTECTION FENCING, FLAGGING, ADDITIVES AND SUPPLEMENTS, TEMPORARY IRRIGATION, BURLAP, WIRE, SHRINK WRAP, AND ALL NECESSARY TOOLS AND EQUIPMENT.

3. ROOT PRUNING SPECIFICATIONS

3.1. GENERAL

- 3.1.1. ALL TREES AND PALMS TO BE RELOCATED MUST BE WATERED DAILY FOR AT LEAST 2-3 DAYS PRIOR TO ANY ROOTS BEING CUT TO ENSURE THAT THEY ARE FULLY HYDRATED. EACH WATERING MUST THOROUGHLY SATURATE THE ROOTBALL TO ITS FULL DEPTH.
- 3.1.2. EACH TREE AND PALM MUST THEN BE WATERED EVERY OTHER DAY, NOT RELYING ON RAIN, DURING THE ENTIRE ROOT PRUNING PROCESS EITHER BY A TEMPORARY IRRIGATION SYSTEM OR BY HAND. EACH WATERING MUST THOROUGHLY SATURATE THE ROOTBALL TO ITS FULL DEPTH.
- 3.1.3. TREE AND PALM RELOCATION ACTIVITIES MUST BE SCHEDULED SO THAT REMOVAL AND REPLANTING TAKE PLACE IN THE SAME 24-HOUR PERIOD. NO TREES OR PALMS MAY BE "STOCKPILED" ONSITE OR OFFSITE FOR ANY PERIOD OF TIME WITHOUT PRIOR WRITTEN APPROVAL OF THE LANDSCAPE ARCHITECT. WHEN ALLOWED, APPROVAL FOR THE METHOD OF "STOCKPILING" MUST BE OBTAINED FROM THE LANDSCAPE ARCHITECT.
- 3.1.4. ALL DIGGING IN THE ROOT ZONE DURING THE ROOT PRUNE PROCESS MUST BE DONE BY HAND; NO MACHINERY WILL BE ALLOWED. PRUNING OF ROOTS MUST BE DONE BY HAND WITH CLEAN, SHARP TOOLS. DO NOT PAINT CUT ROOTS WITH TREE PAINT OR ANY KIND OF SEALANT.
- 3.1.5. MYCORRHIZA (ROOTS® TRANSPLANT OR EQUIVALENT) MUST BE INCORPORATED INTO THE BACKFILL SOIL PRIOR TO BACKFILLING AS PER MANUFACTURES RECOMMENDATIONS.
- 3.1.6. AFTER EACH ROOT PRUNE, EACH SECTION OF ROOTBALL THAT IS PRUNED MUST BE WRAPPED WITH BLACK PLASTIC AND THE TRENCH BACKFILLED WITH ORIGINAL EXCAVATED SOIL. A TREE RING WITH A MINIMUM HEIGHT OF 6" MUST BE CONSTRUCTED 6-12" OUTSIDE THE OUTERMOST EDGE OF THE ROOTBALL AND AROUND THE ENTIRE PERIMETER OF THE ROOTBALL TO DIRECT IRRIGATION WATER AND ANY ADDED SUPPLEMENTS DOWN INTO THE ROOTBALL DURING ROOT REGENERATION.
- 3.1.7. ONCE THE TREE RING IS CONSTRUCTED AFTER EACH ROOT PRUNE, A HIGH-PHOSPHORUS ROOT STIMULANT MUST BE LIBERALLY APPLIED TO THE SURFACE OF THE ROOTBALL AND THOROUGHLY WATERED IN TO ENCOURAGE NEW ROOT GROWTH.

3.2. TREES

- 3.2.1. PRIOR TO ANY ROOTS BEING CUT, ALL MAJOR ROOTS MUST BE IDENTIFIED TO DETERMINE THE ROOTBALL DIAMETER BASED ON THE RELATIVE LOCATION AND SIZE OF THE ROOTS.
- 3.2.2. MANY TREE RELOCATION SPECIFICATIONS USE "GENERAL RULES" TO CALCULATE MINIMUM ROOTBALL DIAMETER, SUCH AS MULTIPLYING THE DIAMETER AT BREAST HEIGHT (DBH) OF THE TREE BY A FACTOR OF 10 OR ALLOWING A MINIMUM OF 9-12" OF ROOTBALL FOR EVERY 1" OF TREE CALIPER. OTHERS LIST UNREALISTIC MINIMUM SIZES FOR THE ROOTBALLS OF VARIOUS TREE CALIPERS OR HEIGHTS. IN MANY CASES, SUCH APPROACHES RESULT IN ROOTBALLS THAT ARE EITHER TOO LARGE OR TOO SMALL FOR A GIVEN TREE. THE FOLLOWING TABLE LISTS MINIMUM ROOTBALL DIAMETERS BASED ON REAL-WORLD EXPERIENCE OF TREE RELOCATION SPECIALISTS IN SOUTH FLORIDA:

CALIPER (inches)	MIN. ROOTBALL DIA. (feet)	CALIPER (inches)	MIN. ROOTBALL DIA. (feet)
1 - 4	3	12 - 14	8
4 - 5	4	15 - 17	10
6 - 7	5	18 - 24	12 - 15
8 - 9	6	25 - 30	15 - 25
10 - 11	7	30 +	as needed

- 3.2.3. WHENEVER POSSIBLE, ROOTBALLS MUST BE CIRCULAR IN SHAPE WITH AN EQUAL DISTANCE FROM THE TRUNK TO THE EDGE OF THE ROOTBALL ALL AROUND.
- 3.2.4. MINIMUM ROOTBALL DEPTH MUST BE 24-36" FOR ALL TREES TO BE RELOCATED, WITH THE ACTUAL DEPTH TO BE DETERMINED ONLY AFTER A THOROUGH EXAMINATION OF ALL ROOTS DURING THE INITIAL ROOT INSPECTION AND BASED ON THE ABSENCE OF MAJOR ROOTS AT THE BOTTOM OF THE ROOTBALL. ROOTBALLS DEEPER THAN 36" MAY BE REQUIRED FOR LARGE SPECIMEN TREES. DEPENDING ON THE RELATIVE LOCATIONS AND DEPTHS OF THE MAJOR ROOTS AS OBSERVED DURING THE INITIAL ROOT INSPECTION.

- 3.2.5. AS A GENERAL RULE, MINIMUM ROOT PRUNE TIME FOR TREES WITH A DBH OF LESS THAN 10" IS 12 WEEKS. THE FIRST ROOT PRUNE MUST BE ON TWO OPPOSING SIDES OF THE ROOTBALL, WITH THE SECOND ROOT PRUNE ON ONE OF THE OTHER TWO SIDES DONE A MINIMUM OF 6 WEEKS LATER, AND A THIRD ROOT PRUNE ON THE LAST SIDE DONE A MINIMUM OF 3 WEEKS AFTER THAT. THE SECOND AND THIRD ROOT PRUNES MAY ONLY BE DONE WHEN HEALTHY NEW ROOT GROWTH FROM EARLIER ROOT PRUNES IS EVIDENT (SEE SECTION 2.14 ABOVE FOR SPECIFICATIONS ON PHOTOGRAPHICALLY DOCUMENTING NEW ROOT GROWTH DURING THE ROOT PRUNE PROCESS). MORE TIME MAY BE NEEDED DURING THE COOLER MONTHS OF THE YEAR.
- 3.2.6. AS A GENERAL RULE, MINIMUM ROOT PRUNE TIME FOR TREES WITH A DBH OF 10" OR GREATER IS 24 WEEKS. THE FIRST ROOT PRUNE MUST BE ON TWO OPPOSING SIDES OF THE ROOTBALL, WITH THE SECOND ROOT PRUNE ON ONE OF THE OTHER TWO SIDES DONE A MINIMUM OF 12 WEEKS LATER, AND A THIRD ROOT PRUNE ON THE LAST SIDE DONE A MINIMUM OF 6 WEEKS AFTER THAT. THE SECOND AND THIRD ROOT PRUNES MAY ONLY BE DONE WHEN HEALTHY NEW ROOT GROWTH FROM EARLIER ROOT PRUNES IS EVIDENT (SEE SECTION 2.14 ABOVE FOR SPECIFICATIONS ON PHOTOGRAPHICALLY DOCUMENTING NEW ROOT GROWTH DURING THE ROOT PRUNE PROCESS). MORE TIME MAY BE NEEDED DURING THE COOLER MONTHS OF THE YEAR.
- 3.2.7. CERTAIN HARDWOOD TREES AND GYMNOSPERMS REQUIRE LONGER ROOT PRUNING TIMES. THESE INCLUDE, BUT ARE NOT LIMITED TO, THE FOLLOWING:
 - AVOCADO (*PERSEA AMERICANA*)
 - BLACK OLIVE (*BUCIDA BUCERAS*)
 - BRIDALVEIL (*CAESALPINIA GRANADILLO*)
 - CASSIAS (ALL SPECIES OF *CASSIA*)
 - LIGNUM VITAE (*GUAIACUM SANCTUM & G. OFFICINALE*)
 - PODOCARPUS (*PODOCARPUS* SP.)
 - LIVE OAK (*QUERCUS VIRGINIANA*)
 - MANGOCANY (*SWIETENIA KHAHANGOWI*)
 - MANGO (*MANGIFERA INDICA*)
 - PIGEON PLUM (*COCCOLOBA DIVERSIFOLIA*)
 - SWEET ACACIA (*ACACIA FARNESIANA*)
 - VERAWOOD (*BULNESIA ARBOREA*)
 - WILD TAMARIND (*LYSILOMA LATISILIQUUM & L. SABIQU*)

FOR THESE TREES, THE MINIMUM ROOT PRUNE TIMES DISCUSSED IN SECTIONS 3.2.5 AND 3.2.6 ABOVE MAY BE INSUFFICIENT. ONLY WHEN SUFFICIENT NEW ROOT GROWTH HAS TAKEN PLACE FOLLOWING AN EARLIER ROOT PRUNE CAN THE NEXT ROOT PRUNE BE DONE, AND ONLY WHEN SUFFICIENT NEW ROOT GROWTH HAS TAKEN PLACE FOLLOWING THE FINAL ROOT PRUNE MAY THE TREE BE RELOCATED (SEE SECTION 2.14 ABOVE FOR SPECIFICATIONS ON PHOTOGRAPHICALLY DOCUMENTING NEW ROOT GROWTH DURING THE ROOT PRUNE PROCESS).

3.1. PALMS

- 3.1.1. THE FOLLOWING TABLE LISTS MINIMUM ROOTBALL DIAMETERS FOR VARIOUS SPECIES OF PALMS BASED ON REAL-WORLD EXPERIENCE OF RELOCATION SPECIALISTS IN SOUTH FLORIDA:

PALM SPECIES	ROOTBALL SPECIFICATIONS
SABAL / CABBAGE PALM	36" diameter
QUEEN & FOXTAIL PALMS	12" from trunk in all directions
ROYAL & COCONUT PALMS	18 - 24" from trunk in all directions
CANARY DATE PALM	24" from trunk in all directions
SLOW-GROWING PALMS (see sec. 3.3.4)	24" from trunk in all directions

- 3.1.2. PALM ROOTBALLS MUST BE A MINIMUM OF 24" DEEP. WHENEVER POSSIBLE, ROOTBALLS MUST BE CIRCULAR IN SHAPE WITH AN EQUAL DISTANCE FROM THE TRUNK TO THE EDGE OF THE ROOTBALL ALL AROUND.
- 3.1.3. AS A GENERAL RULE, MINIMUM ROOT PRUNE TIME FOR PALMS IS 6-8 WEEKS. THE FIRST ROOT PRUNE MUST BE ON TWO OPPOSING SIDES OF THE ROOTBALL, WITH THE SECOND ROOT PRUNE ON ONE OF THE OTHER TWO SIDES DONE A MINIMUM OF 3-4 WEEKS LATER, AND A THIRD ROOT PRUNE ON THE LAST SIDE DONE A MINIMUM OF 4-6 WEEKS AFTER THAT. THE SECOND AND THIRD ROOT PRUNES MAY ONLY BE DONE WHEN HEALTHY NEW ROOT GROWTH FROM EARLIER ROOT PRUNES IS EVIDENT (SEE SECTION 2.14 ABOVE FOR SPECIFICATIONS ON PHOTOGRAPHICALLY DOCUMENTING NEW ROOT GROWTH DURING THE ROOT PRUNE PROCESS). MORE TIME MAY BE NEEDED DURING THE COOLER MONTHS OF THE YEAR.
- 3.1.4. CERTAIN PALMS, IN PARTICULAR THOSE THAT ARE SLOW GROWING, REQUIRE LONGER ROOT PRUNING TIME. THESE INCLUDE, BUT ARE NOT LIMITED TO, THE FOLLOWING:
 - ALL SPECIES OF *ARCHONTOPHOENIX*
 - ALL SPECIES OF *CORYPHA*
 - AMERICAN OIL PALMS (ALL SPECIES OF *ATTALEA*)
 - BISMARCK PALM (*BISMARCKIA NOBILIS*)
 - CUBAN & CARIBBEAN *COPERNICIA*
 - CUBAN BELLY PALM (*GASTROCOCOS CRISPA*)
 - GINGERBREADDOUM PALMS (ALL SPECIES OF *HYPHAENE*)
 - PALMYRA PALMS (ALL SPECIES OF *BORASSUS*)
 - SATAKE PALM (*SATAKENTIA LUKIUNENSIS*)
 - SAW PALMETTO (*SERENOA REPENS*)
 - SILVER PALM (*COCCOTHRIHAX ARGENTATA*)
 - ZOMBIE PALM (*ZOMBIA ANTILLARUM*)

FOR THESE PALMS, THE MINIMUM ROOT PRUNING TIME IS 4-6 MONTHS OR GREATER. ONLY WHEN SUFFICIENT NEW ROOT GROWTH HAS TAKEN PLACE FOLLOWING AN EARLIER ROOT PRUNE CAN THE NEXT ROOT PRUNE BE DONE, AND ONLY WHEN SUFFICIENT NEW ROOT GROWTH HAS TAKEN PLACE FOLLOWING THE FINAL ROOT PRUNE MAY THE TREE BE RELOCATED (SEE SECTION 2.14 ABOVE FOR SPECIFICATIONS ON PHOTOGRAPHICALLY DOCUMENTING NEW ROOT GROWTH DURING THE ROOT PRUNE PROCESS).

4. CANOPY PRUNING SPECIFICATIONS

4.1. TREES

- 4.1.1. PRIOR TO RELOCATION, THE CANOPY OF EACH TREE TO BE RELOCATED MUST BE SELECTIVELY PRUNED TO REMOVE CROSSING, DEAD, DISEASED, BROKEN, AND LOW-HANGING BRANCHES THAT MAY INTERFERE WITH CONSTRUCTION ACTIVITIES, OR THAT MAY INTERFERE OR RESTRICT STRAPPING OR LIFTING THE TREE DURING RELOCATION.
- 4.1.2. FOR TREES BEING RELOCATED ONSITE, THE CANOPY MAY BE SELECTIVELY THINNED AND REDUCED BY NO MORE THAN 1/3 OF THE OVERALL CANOPY MASS, AT THE DIRECTION OF THE LANDSCAPE ARCHITECT; HOWEVER, THE BASIC SHAPE, FORM, AND CHARACTER OF THE TREE MUST BE PRESERVED.
- 4.1.3. FOR TREES BEING RELOCATED OFFSITE, THE CANOPY MUST BE PRUNED, AT THE DIRECTION OF THE LANDSCAPE ARCHITECT, TO FIT ON THE TRAILER FOR TRANSPORT. EVERY EFFORT MUST BE MADE TO RETAIN AS MANY LARGE BRANCHES AS POSSIBLE AND TO PRESERVE AS MUCH OF THE SHAPE, FORM, AND CHARACTER OF THE TREE AS POSSIBLE TO THE WIDEST LOAD WIDTH ALLOWABLE BY THE FLORIDA DEPARTMENT OF TRANSPORTATION. CONTRACTOR MUST OBTAIN ALL NECESSARY PERMITS AND ESCORTS TO TRANSPORT WIDE LOADS, PER FLORIDA LAW.
- 4.1.4. ALL CANOPY PRUNING MUST BE CONDUCTED FOLLOWING ANSI A-300 TREE PRUNING STANDARDS AND BEST MANAGEMENT PRACTICES.
- 4.1.5. ALL DEBRIS GENERATED DURING CANOPY PRUNING MUST BE REMOVED OFFSITE AND DISPOSED.

4.2. PALMS

- 4.2.1. IT IS WELL KNOWN THAT SOME PALMS SURVIVE RELOCATION BETTER WHEN ALL OF THE LEAVES ARE REMOVED (E.G., CABBAGE PALM, *SABAL PALMETTO*), AND THAT OTHER PALMS BENEFIT FROM HAVING THEIR LEAVES CUT IN HALF DURING RELOCATION (E.G., COCONUT PALM, *COCOS NUCIFERA*). BOTH OF THESE HORTICULTURAL PRACTICES, WHILE TRUE, ARE ONLY APPLICABLE WHEN PALMS ARE NOT ROOT PRUNED. LEAVES DO NOT NEED TO BE CUT IN HALF OR REMOVED FROM PALMS THAT ARE ADEQUATELY ROOT PRUNED. ON OCCASION WHEN SUFFICIENT ROOT PRUNING TIME IS NOT AVAILABLE, PALMS TO BE RELOCATED MAY HAVE THEIR LEAVES CUT IN HALF OR REMOVED ENTIRELY AT THE DIRECTION OF THE LANDSCAPE ARCHITECT.
- 4.2.2. PALM LEAVES MUST BE TIED UP WITH 2-PLY BIODEGRADABLE TWINE PRIOR TO RELOCATION TO PREVENT MECHANICAL DAMAGE DURING THE RELOCATION PROCESS.
- 4.2.3. PALM TRUNKS SHALL ONLY BE "CLEANED UP" ACCORDING TO THE LANDSCAPE ARCHITECT'S SPECIFICATIONS SPECIFIC TO EACH PALM.

5.RELOCATION SPECIFICATIONS

5.1. GENERAL

- 5.1.1. LANDSCAPE CONTRACTOR TO FLAG ALL PROPOSED PLANT LOCATIONS FOR LANDSCAPE ARCHITECT'S APPROVAL PRIOR TO INSTALLATION. NOTIFY LANDSCAPE ARCHITECT A MINIMUM OF 15 DAYS PRIOR TO REVIEW.
- 5.1.2. ALL TREES AND PALMS TO BE RELOCATED MUST BE WATERED DAILY FOR AT LEAST 5 DAYS PRIOR TO ANY RELOCATION TO ENSURE THAT THEY ARE FULLY HYDRATED. EACH WATERING MUST THOROUGHLY SATURATE THE ROOTBALL TO ITS FULL DEPTH.
- 5.1.3. ALL ROOTBALLS MUST BE WRAPPED IN BURLAP AND THEN TIGHTLY WIRE-WRAPPED (USING RED LINE HORSE WIRE OR EQUIVALENT) TO KEEP THE ENTIRE ROOTBALL INTACT DURING RELOCATION. TREES AND PALMS GROWING IN LIMESTONE MUST BE DUG AND RELOCATED WITH THE ROOTS ATTACHED TO A SECTION OF ROCK AS PART OF THE ROOTBALL, SUCH THAT THE ROOTS REMAIN INTACT. ROOTBALLS COMING FROM SAND OR SANDY SOIL MAY ALSO NEED TO BE BOXED PRIOR TO RELOCATION, AT THE DISCRETION OF THE LANDSCAPE ARCHITECT.
- 5.1.4. TREES AND PALMS BEING RELOCATED OFFSITE MUST HAVE THEIR ENTIRE ROOTBALLS THOROUGHLY AND TIGHTLY WRAPPED WITH PLASTIC SHRINK WRAP ON THE OUTSIDE OF THE WIRE WRAP, AND THE ENTIRE TREE OR PALM (INCLUDING CANOPY, TRUNK, AND ROOTBALL) MUST BE COVERED WITH A BREATHABLE TARP (E.G., SHADE CLOTH) DURING TRANSPORT.
- 5.1.5. NEW PLANTING PITS FOR RELOCATED TREES AND PALMS MUST BE PREPARED PRIOR TO LIFTING THE PALM OR TREE FROM ITS CURRENT LOCATION AND MUST BE AT LEAST 3-4 FEET WIDER THAN THE ROOTBALL AND THE SAME DEPTH AS THE ROOTBALL, SUCH THAT THE FINAL ELEVATION OF THE TOP OF THE ROOTBALL IS AT OR SLIGHTLY ABOVE (NO MORE THAN 2" HIGHER) FINAL GRADE.
- 5.1.6. TREES AND PALMS TO BE RELOCATED MUST BE LIFTED BY THE ROOTBALL ONLY, USING APPROPRIATELY SIZED (LENGTH AND STRENGTH) LIFTING STRAPS OR CHAINS. DURING LIFTING, THE TREE OR PALM MUST BE BALANCED IN A MORE-OR-LESS UPRIGHT POSITION, WITH THE STRAP ON THE TRUNK USED ONLY FOR BALANCING AND MANEUVERING THE TREE OR PALM INTO POSITION. NO CHAINS MAY BE USED AROUND OR AGAINST THE TRUNK AT ANY TIME. AT NO TIME SHALL 100% OF THE WEIGHT OF THE TREE OR PALM BE ON THE STRAP ATTACHED TO THE TRUNK. TRUNKS MUST BE HEAVILY PADDED WITH 30-60 LAYERS (DEPENDING ON SIZE AND WEIGHT) OF BURLAP BENEATH THE BALANCING STRAP.
- 5.1.7. TREES AND PALMS MUST BE LIFTED WITH A CRANE OR BACKHOE APPROPRIATELY SIZED FOR THE SIZE AND WEIGHT OF THE TREE OR PALM AND LIFTED OR CARRIED DIRECTLY TO THE FINAL INSTALL LOCATION OR TRANSPORT TRAILER.
- 5.1.8. ONCE LIFTING BEGINS, ANY UNCUT ROOTS UNDER OR AROUND THE ROOTBALL THAT MAY YET REMAIN MUST BE IMMEDIATELY SEVERED WITH HAND PRUNING TOOLS TO MINIMIZE TEARING AND ROOT DAMAGE.
- 5.1.9. AGRIFORM PLANTING TABLETS (OR APPROVED EQUIVALENT) MUST BE EVENLY DISTRIBUTED AROUND THE PERIMETER OF THE PLANTING PIT AT THE RATE OF 2 TABLETS PER 1" TRUNK CALIPER PRIOR TO BACKFILLING.
- 5.1.10. MYCORRHIZA (ROOTS® TRANSPLANT OR EQUIVALENT) MUST BE INCORPORATED INTO THE BACKFILL SOIL PRIOR TO BACKFILLING.
- 5.1.11. RELOCATED TREES AND PALMS MUST BE CENTERED IN THE PLANTING PIT, AND THE PIT BACKFILLED USING A 1:1 MIXTURE OF EXISTING SOIL AND 80:20 (DOT SAND:MUCK) SOIL MIX THOROUGHLY BLENDED TOGETHER. DO NOT USE MUDDY SOIL AS BACKFILL. (SEE 5.2.2 BELOW FOR SPECIAL CONDITIONS REGARDING DATE PALM BACKFILL SPECIFICATIONS.)
- 5.1.12. SMALL TREES AND PALMS MUST BE FIRMLY BRACED USING A MINIMUM OF FOUR 4" X 4" WOODEN BRACES ATTACHED TO 2" X 4" WOODEN BATTENS HELD IN PLACE WITH TWO STEEL BANDS. LARGER TREES MAY REQUIRE 6" X 6" WOODEN POSTS OR EVEN TELEPHONE POLES TO PROVIDE SUFFICIENT BRACING STRENGTH TO PREVENT TOPPLING DURING WIND EVENTS. A SUFFICIENT NUMBER OF BATTENS MUST BE STRATEGICALLY PLACED AROUND THE TRUNK SUCH THAT THE STEEL BANDS NEVER CONTACT THE TRUNK. NO BURLAP IS TO REMAIN UNDER THE WOODEN BATTENS ON TREES DURING BRACING, BUT SEVERAL LAYERS OF BURLAP SHOULD BE LEFT UNDER THE WOODEN BATTENS WHEN BRACING PALMS. NAILS SHALL NEVER BE DRIVEN DIRECTLY INTO THE TRUNK DURING BRACING. BRACING MUST REMAIN IN PLACE FOR A MINIMUM OF ONE YEAR.
- 5.1.13. A TREE RING WITH A MINIMUM HEIGHT OF 6" MUST BE CONSTRUCTED 6-12" OUTSIDE THE OUTERMOST EDGE OF THE ROOTBALL AND AROUND THE ENTIRE PERIMETER OF THE ROOTBALL TO DIRECT IRRIGATION WATER AND ANY SUPPLEMENTS THAT ARE ADDED DOWN INTO THE ROOTBALL DURING ROOT REGENERATION.
- 5.1.14. ONCE THE TREE RING IS CONSTRUCTED, A HIGH-PHOSPHORUS ROOT STIMULANT MUST BE LIBERALLY APPLIED TO THE SURFACE OF THE ROOTBALL AND THOROUGHLY WATERED IN.
- 5.1.15. ROOTBALLS MUST BE THOROUGHLY WATERED IN USING A HOSE AND A JOHNSON BAR INSERTED TO THE VERY BOTTOM OF THE ROOTBALL AND SWUNG BACK AND FORTH TO PREVENT FORMATION OF AIR POCKETS. THE JOHNSON BAR TECHNIQUE MUST BE REPEATED AT LEAST ONCE MORE WITHIN ONE WEEK AFTER RELOCATION, AND AGAIN IF ANY SIGNS OF STRESS BECOME APPARENT.
- 5.1.16. ORGANIC MULCH (MELALEUCA IS PREFERRED) MUST BE APPLIED WITHIN 48 HOURS OF RELOCATION AT A DEPTH OF 3-4" OVER THE ENTIRE TOP OF THE ROOTBALL FROM THE TREE RING TO WITHIN 6" OF THE TRUNK. MULCH MUST NOT BE APPLIED OR ALLOWED TO ACCUMULATE DIRECTLY AGAINST THE TRUNK.
- 5.1.17. PITS FROM WHICH THE RELOCATED TREES AND PALMS WERE REMOVED MUST BE CLEANED OF ALL RESIDUAL ROOTS, STUMPS, AND PORTIONS THEREOF AND BACKFILLED WITH CLEAN FILL FLUSH WITH THE SURROUNDING GRADE.
- 5.1.18. RESTORE THE SURFACE WITH MATERIAL TO MATCH ADJACENT AREAS. MATERIAL TO BE APPROVED BY LANDSCAPE ARCHITECT. CONTRACTOR TO PROVIDE A MINIMUM OF ONE YEAR WARRANTY ON SETTLING AND PLANT MATERIAL FROM TIME OF SUBSTANTIAL COMPLETION.
- 5.2. SPECIAL CONDITIONS

- 5.2.1. MULTI-TRUNK TREES AND PALMS MUST BE RELOCATED AS ONE UNIT WITH A SINGLE ROOTBALL.

6. MAINTENANCE SPECIFICATIONS

6.1. GENERAL

- 6.1.1. ALL RELOCATED TREES AND PALMS MUST BE MAINTAINED FOR ONE YEAR FROM THE DATE OF RELOCATION TO THEIR FINAL LOCATIONS.
- 6.1.2. CONTRACTOR MUST MAINTAIN ALL RELOCATED TREES AND PALMS FOR ONE FULL YEAR FROM THE DATE OF RELOCATION TO THE FINAL LOCATION.
- 6.1.3. WHENEVER POSSIBLE, EACH TREE AND PALM MUST BE WATERED BY A PERMANENT AUTOMATIC IRRIGATION SYSTEM FOLLOWING RELOCATION. EACH WATERING MUST THOROUGHLY SATURATE THE ROOTBALL TO ITS FULL DEPTH; THIS WILL REQUIRE 25-50 GALLONS OF WATER FOR SMALL TREES AND PALMS, DEPENDING ON ROOTBALL SIZE, WHILE LARGE TREES WILL REQUIRE A MINIMUM OF 10 GALLONS PER FOOT OF ROOTBALL DIAMETER (I.E., A 10' DIAMETER ROOTBALL WILL REQUIRE A MINIMUM OF 100 GALLONS PER WATERING EVENT). WATERING FREQUENCY MUST BE EVERY DAY FOR THE FIRST TWO WEEKS, EVERY OTHER DAY FOR THE NEXT THREE WEEKS, AND EVERY THIRD DAY FOR THE NEXT 6-8 WEEKS.
- 6.1.4. WHEN AN AUTOMATIC IRRIGATION SYSTEM IS NOT POSSIBLE, CONTRACTOR IS RESPONSIBLE FOR HAND WATERING RELOCATED TREES AND PALMS THROUGHOUT THE MAINTENANCE PERIOD AND UNTIL FINAL ACCEPTANCE BY THE LANDSCAPE ARCHITECT AND/OR CLIENT.
- 6.1.5. IMMEDIATELY AFTER RELOCATION TO THE FINAL LOCATION, A HIGH-PHOSPHORUS ROOT STIMULANT MUST BE APPLIED TO THE SURFACE OF THE ROOTBALL AT THE RECOMMENDED LABEL RATE AND WATERED IN WITH A DRENCH CONSISTING OF A SYSTEMIC INSECTICIDE AND A CONTACT ROOT ROT FUNGICIDE, FOLLOWING LABEL INSTRUCTIONS, AS INITIAL PREVENTATIVE MAINTENANCE.
- 6.1.6. EVERY THREE MONTHS THEREAFTER, A HIGH-PHOSPHORUS ROOT STIMULANT MUST BE APPLIED TO THE SURFACE OF THE ROOTBALL AT THE RECOMMENDED LABEL RATE AND WATERED IN WITH A DRENCH CONSISTING OF A SYSTEMIC INSECTICIDE AND A BROAD-SPECTRUM SYSTEMIC FUNGICIDE, FOLLOWING LABEL INSTRUCTIONS, AS CONTINUING PREVENTATIVE MAINTENANCE.
- 6.1.7. IRRIGATION AND BRACING MUST BE CHECKED AND EACH TREE OR PALM THOROUGHLY INSPECTED FOR SIGNS OF STRESS, DISEASE, OR PEST PROBLEMS ON A MONTHLY BASIS.

6.2. SHADE TREES

- 6.2.1. IMMEDIATELY AFTER RELOCATION TO THE FINAL LOCATION AND EVERY THREE MONTHS THEREAFTER, A HIGH-QUALITY, SLOW-RELEASE 15-2-15 GRANULAR FERTILIZER MUST BE APPLIED, AT THE RECOMMENDED LABEL RATE, SPREAD EVENLY ACROSS THE SURFACE OF THE ROOTBALL.
- 6.2.2. FOLIAR FEED FOUR TIMES PER YEAR.

6.2.3. FLOWERING TREES

- 6.2.4. IMMEDIATELY AFTER RELOCATION TO THE FINAL LOCATION AND EVERY THREE MONTHS THEREAFTER, A HIGH-QUALITY, SLOW-RELEASE 5-10-15 GRANULAR FERTILIZER MUST BE APPLIED, AT THE RECOMMENDED LABEL RATE, SPREAD EVENLY ACROSS THE SURFACE OF THE ROOTBALL.
- 6.2.5. FOLIAR FEED FOUR TIMES PER YEAR.

6.3. PALMS

- 6.3.1. STRING MUST BE REMOVED FROM THE TIED UP LEAVES IMMEDIATELY AFTER RELOCATION TO THE FINAL LOCATION IF THE PALM WAS ROOT PRUNED OR WITHIN 30-45 DAYS AFTER RELOCATION ON THE OCCASION THE LANDSCAPE ARCHITECT APPROVED RELOCATION WITHOUT ROOT PRUNING DUE TO TIME CONSTRAINTS.
- 6.3.2. IMMEDIATELY AFTER RELOCATION TO THE FINAL LOCATION AND EVERY THREE MONTHS THEREAFTER, A HIGH-QUALITY, SLOW-RELEASE 8-4-12 GRANULAR PALM FERTILIZER WITH MINORS MUST BE APPLIED, AT THE RECOMMENDED LABEL RATE, SPREAD EVENLY ACROSS THE SURFACE OF THE ROOTBALL.
- 6.3.3. FOLIAR FEED SIX TIMES PER YEAR.

7. WARRANTY

- 7.1. ALL RELOCATED TREES AND PALMS MUST BE GUARANTEED FOR ONE YEAR FROM THE DATE OF RELOCATION TO THEIR FINAL LOCATIONS.
- 7.2. IF A TREE OR PALM DIES WITHIN THE 1-YEAR WARRANTY PERIOD, IT MUST BE REMOVED AND REPLACED AT CONTRACTOR'S EXPENSE.
- 7.3. IF A TREE OR PALM PERFORMS POORLY WITHIN THE 1-YEAR WARRANTY PERIOD, IT MUST BE REMOVED AND REPLACED AT THE CONTRACTOR'S EXPENSE. THE DECISION TO REPLACE BASED ON POOR HEALTH IS AT THE DISCRETION OF THE LANDSCAPE ARCHITECT.
- 7.4. IF A TREE OR PALM SETTLES TO AN UNHEALTHY DEPTH WITHIN THE 1-YEAR WARRANTY PERIOD, AS DEEMED BY THE LANDSCAPE ARCHITECT, IT MUST BE RAISED TO THE CORRECT GRADE AT CONTRACTOR'S EXPENSE.

Rev.	Date	Rev.	Date
<u>1</u>		<u>9</u>	
<u>2</u>		<u>10</u>	
<u>3</u>		<u>11</u>	
<u>4</u>		<u>12</u>	
<u>5</u>		<u>14</u>	
<u>6</u>		<u>15</u>	
<u>7</u>		<u>16</u>	
<u>8</u>		<u>17</u>	

ALL DRAWINGS AND WRITTEN MATERIAL APPEARING HEREIN CONSTITUTE THE ORIGINAL AND UNPUBLISHED WORK OF KOBİ KARP ARCH. AND MAY NOT BE REPRODUCED, COPIED, OR DISCLOSED WITHOUT THE EXPRESS WRITTEN CONSENT OF KOBİ KARP ARCHITECTURE & INTERIOR DESIGN, INC. (A/C 10/2020)

DRB SUBMITTAL

PRIVATE RESIDENCE

5661 PINE TREE DRIVE
MIAMI BEACH, FL 33140

Owner:

PRIVATE RESIDENCE

Consultant:

Name
Address
Address
Tel.
Email

Consultant:

Name
Address
Address
Tel.
Email

Landscape Architect of Record:

David O. Design
p.o. box 331615
Coconut Grove, FL 33233-1615, USA
Tel: +1(305) 854 9299 - Fax: +1(305) 854.9882
Email: davidodesign@hotmail.com
www.davidodishoo.com

Architect of Record:

Kobi Karp Architecture and Interior Design, Inc.
2915 Biscayne Boulevard, Suite #200
Miami, Florida 33137 USA
Tel: +1(305) 573 1816
Fax: +1(305) 573 3766

TREE DISPOSITION GENERAL NOTES

Date:	10-18-2021	Sheet No.
Scale :		LR-300
Project # :		

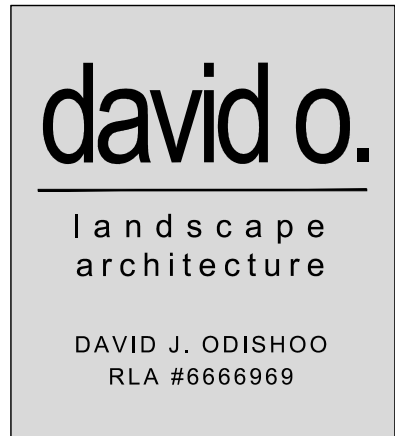

5661 PINE TREE DRIVE

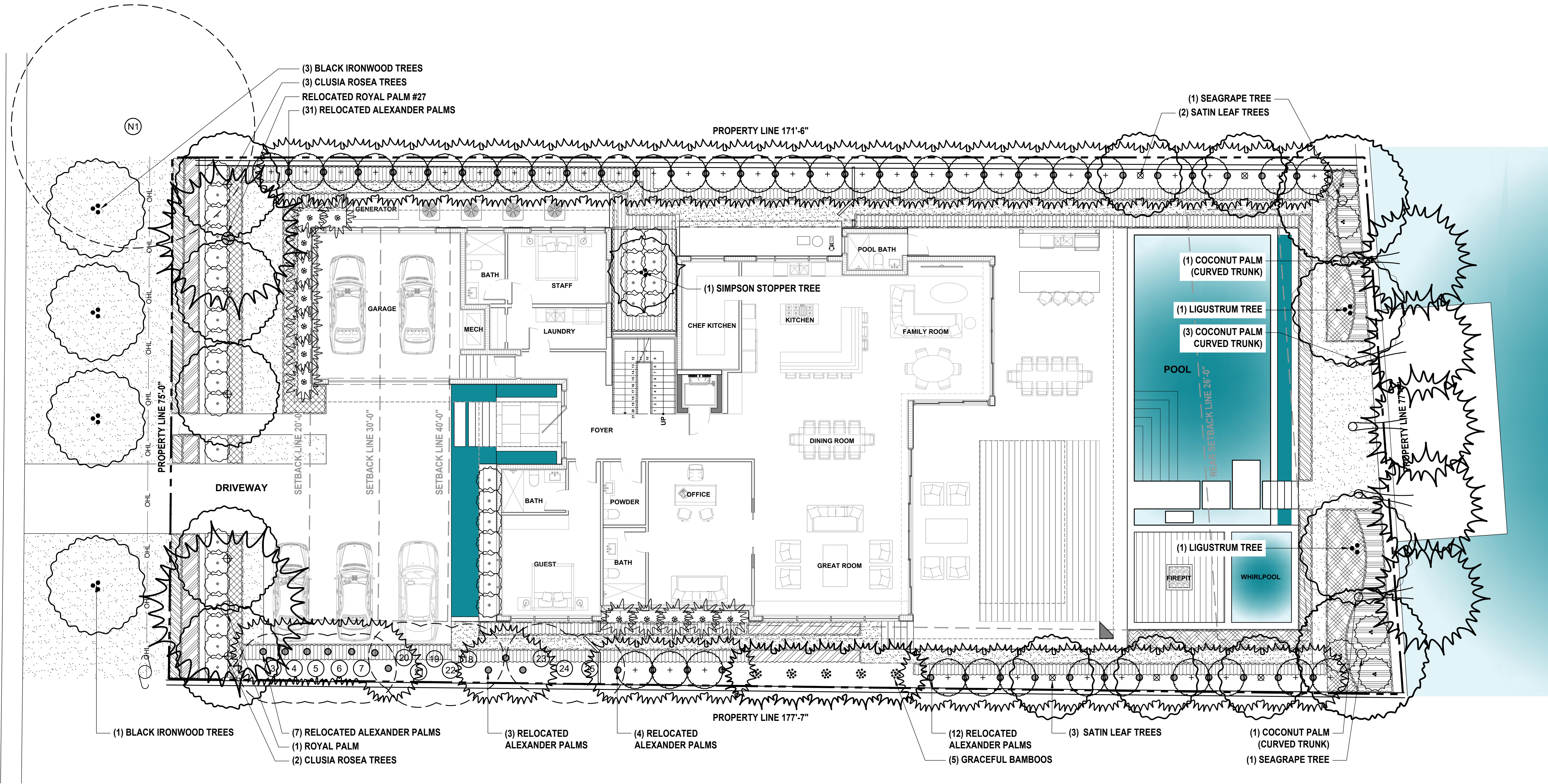

Rev.	Date	Rev.	Date
1		9	
2		10	
3		11	
4		12	
5		14	
6		15	
7		16	
8		17	

ALL DRAWINGS AND WRITTEN MATERIAL APPEARING HEREIN CONSTITUTE THE ORIGINAL AND UNPUBLISHED WORK OF Kobi Karp AIA, AND MAY NOT BE REPRODUCED, USED, OR DISCLOSED WITHOUT THE EXPRESS WRITTEN CONSENT OF Kobi Karp Architecture & Interior Design, Inc. AIA (c) 2020

DRB SUBMITTAL

PRIVATE RESIDENCE

5661 PINE TREE DRIVE
MIAMI BEACH, FL 33140

Owner:

PRIVATE RESIDENCE

Consultant:

Name
Address
Tel:
Email

Consultant:

Name
Address
Tel:
Email

Landscape Architect of Record:

David O. Design
p.o. box 331615
Coconut Grove, FL 33233-1615, USA
Tel: +1(305) 854.9299 - Fax: +1(305) 854.9882
Email: davidodesign@hotmail.com
www.davidodishoo.com

Architect of Record:

Kobi Karp Architecture and Interior Design, Inc.
2915 Biscayne Boulevard, Suite #200
Miami, Florida 33137, USA
Tel: +1(305) 573.1818
Fax: +1(305) 573.3766

david o.
landscape
architecture

DAVID J. ODISHOO
RLA #666969

PLANTING CANOPY PLAN

Date:	10-18-2021	Sheet No.
Scale:	1/8"=1'-0"	LP-100
Project #:		

PLANTING CANOPY PLAN

SCALE: 1/8" = 1'-0"

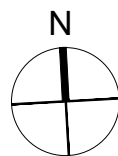
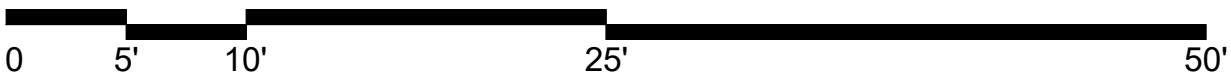

5661 PINE TREE DRIVE

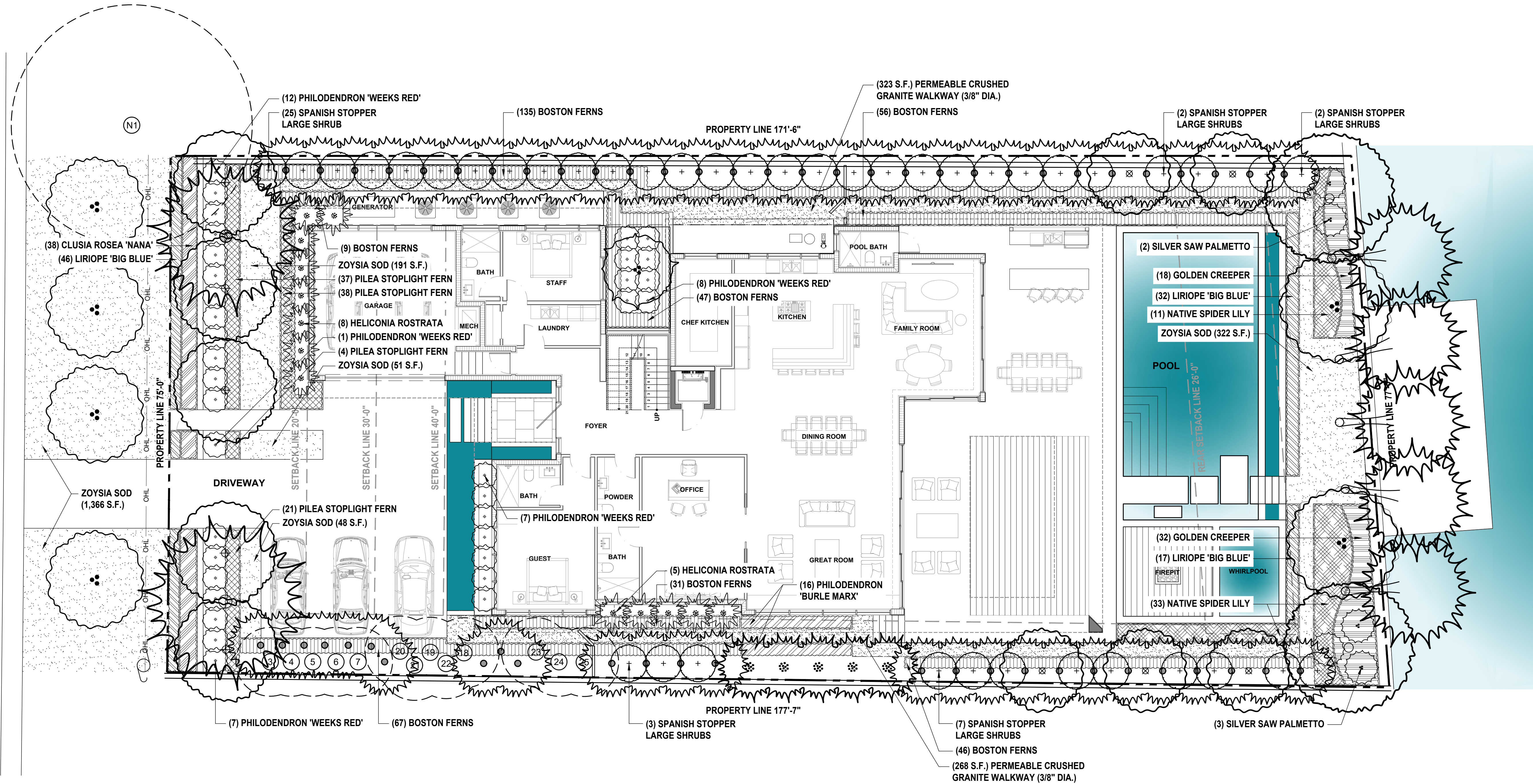

Rev.	Date	Rev.	Date
1		9	
2		10	
3		11	
4		12	
5		13	
6		14	
7		15	
8		16	
		17	

ALL DRAWINGS AND WRITTEN MATERIAL APPEARING HEREIN CONSTITUTE THE ORIGINAL AND UNPUBLISHED WORK OF Kobi Karp Architecture, Inc. AND MAY NOT BE REPRODUCED, COPIED, OR DISCLOSED WITHOUT THE EXPRESS WRITTEN CONSENT OF Kobi Karp Architecture, Inc. AIA, (c) 2020

DRB SUBMITTAL

PRIVATE RESIDENCE

5661 PINE TREE DRIVE
MIAMI BEACH, FL 33140

Owner:

PRIVATE RESIDENCE

Consultant:

Name
Address
Tel:
Email

Consultant:

Name
Address
Tel:
Email

Landscape Architect of Record:

David O. Design
p.o. box 331615
Coconut Grove, FL 33233-1615, USA
Tel: +1(305) 854.9299 - Fax: +1(305) 854.9882
Email: davidodesign@hotmail.com
www.davidodishoo.com

Architect of Record:

Kobi Karp Architecture and Interior Design, Inc.
2915 Biscayne Boulevard, Suite #200
Miami, Florida 33137, USA
Tel: +1(305) 573.1818
Fax: +1(305) 573.3766

david o.
landscape
architecture

DAVID J. ODISHOO
RLA #6666969

PLANTING UNDERSTORY PLAN

Date:	10-18-2021	Sheet No.
Scale:	1/8"=1'-0"	LP-200
Project #:		

PLANTING UNDERSTORY PLAN

SCALE: 1/8" = 1'-0"

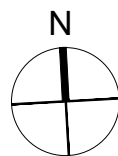

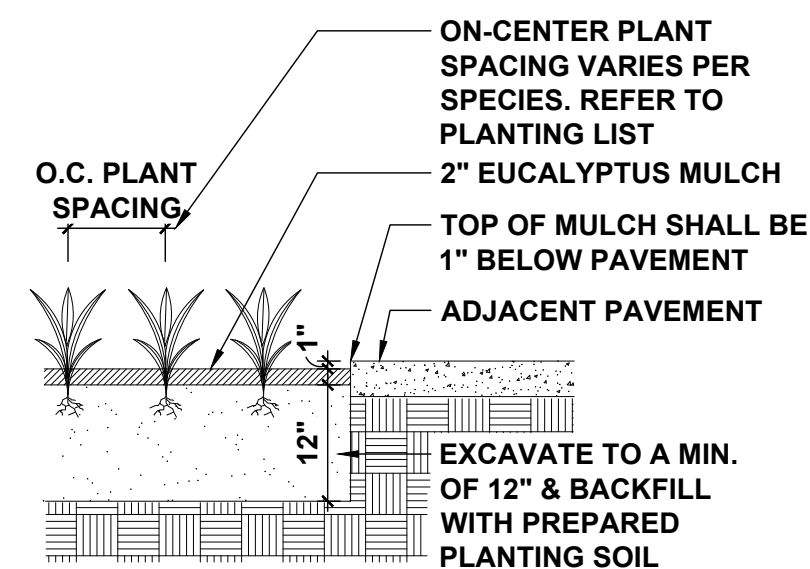
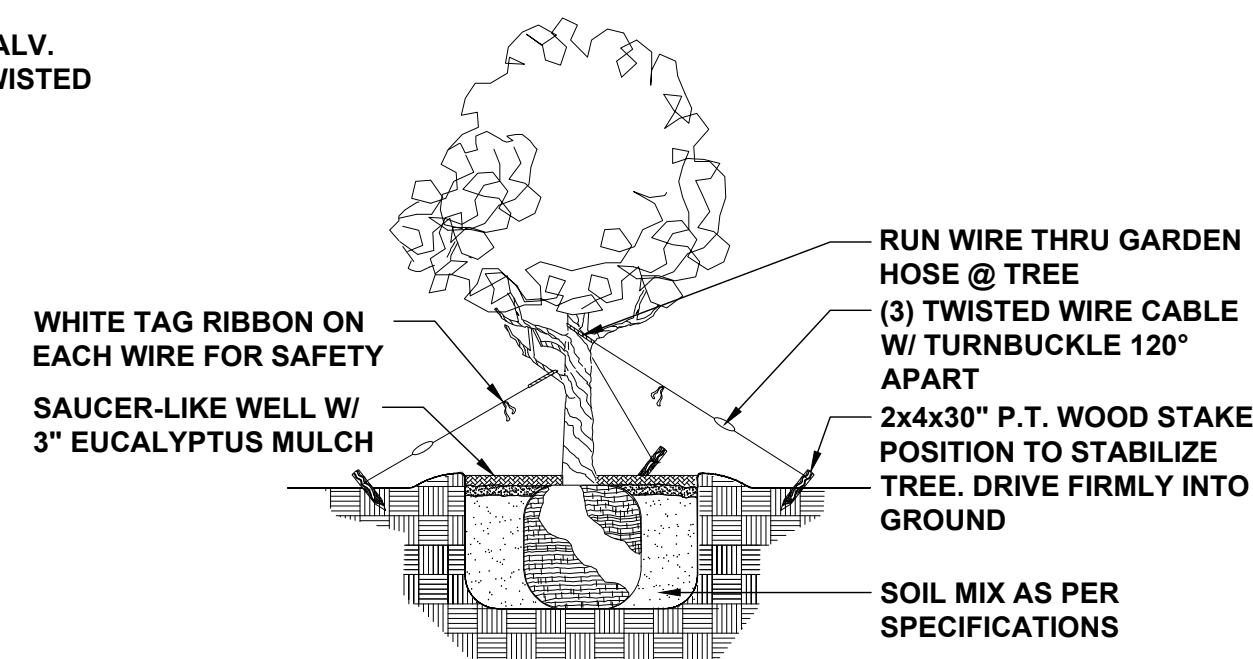
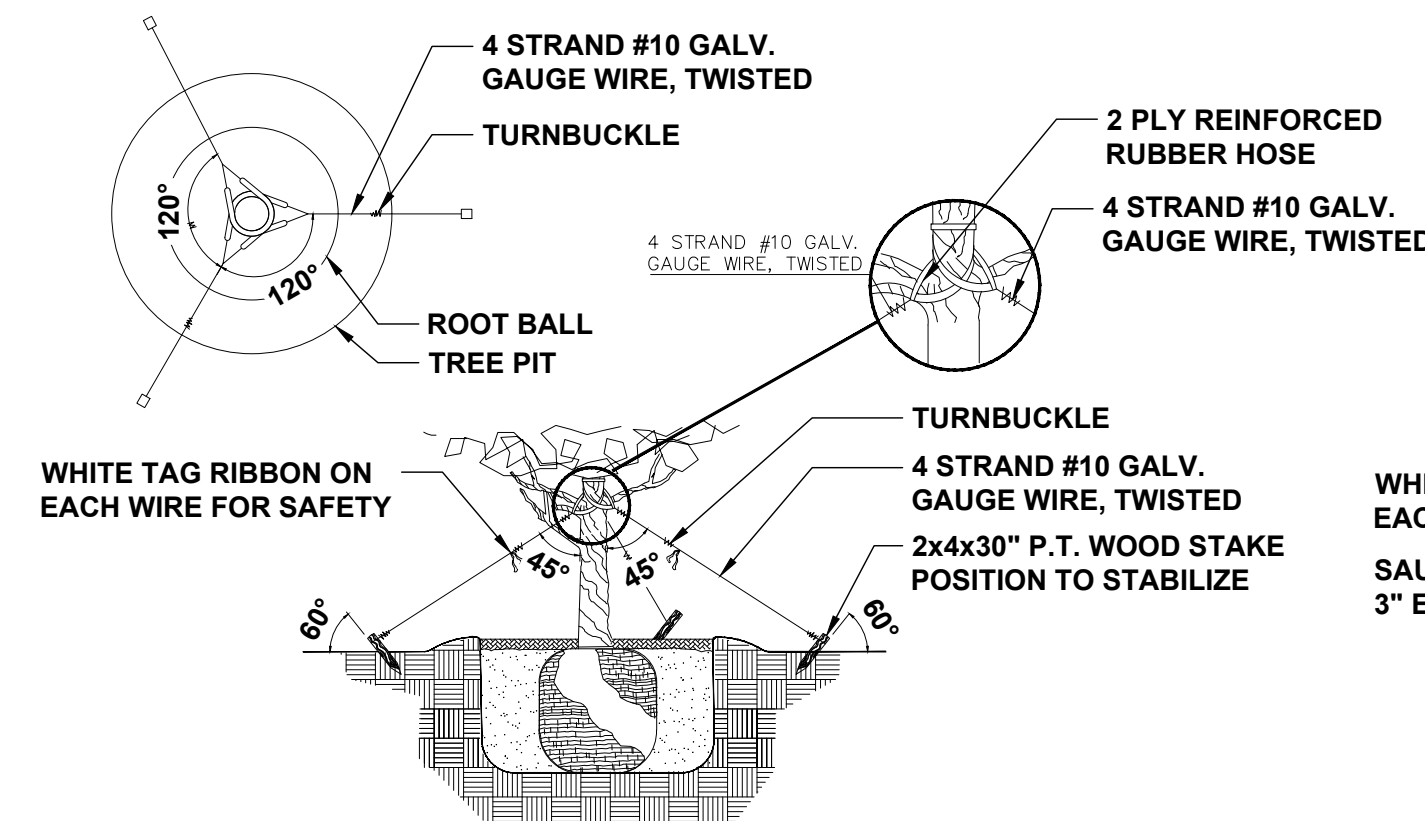
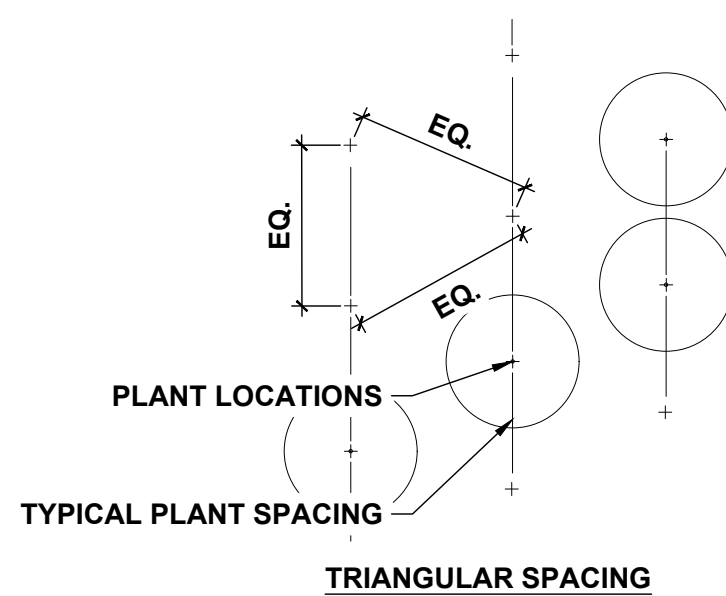
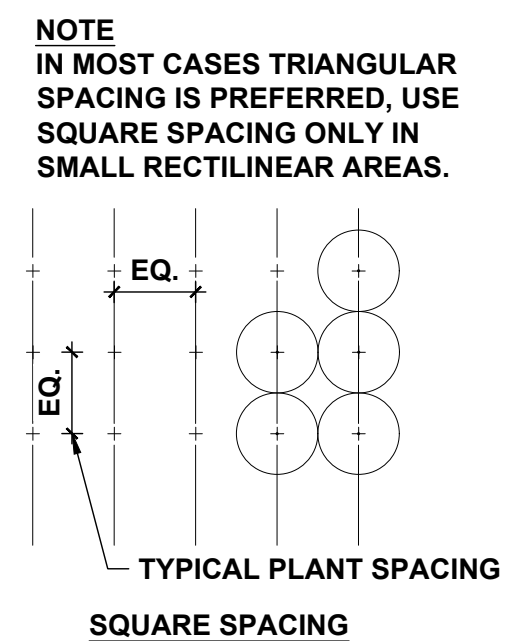
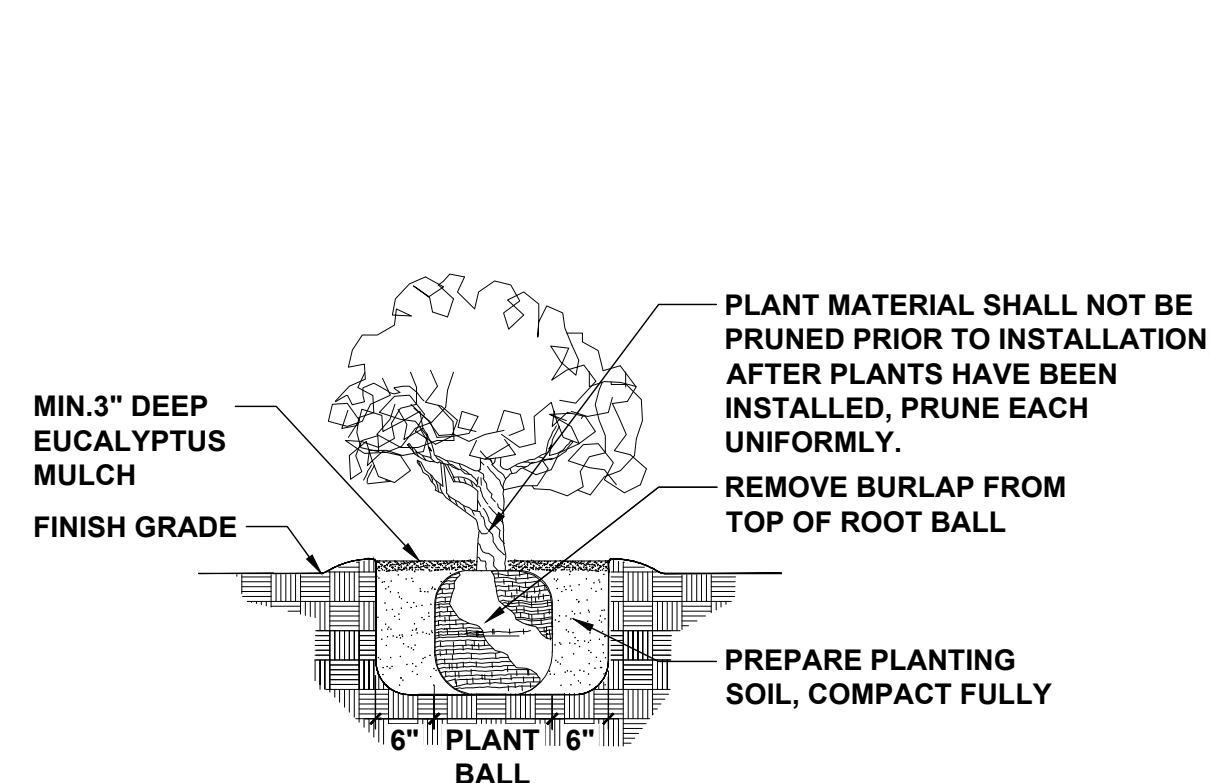
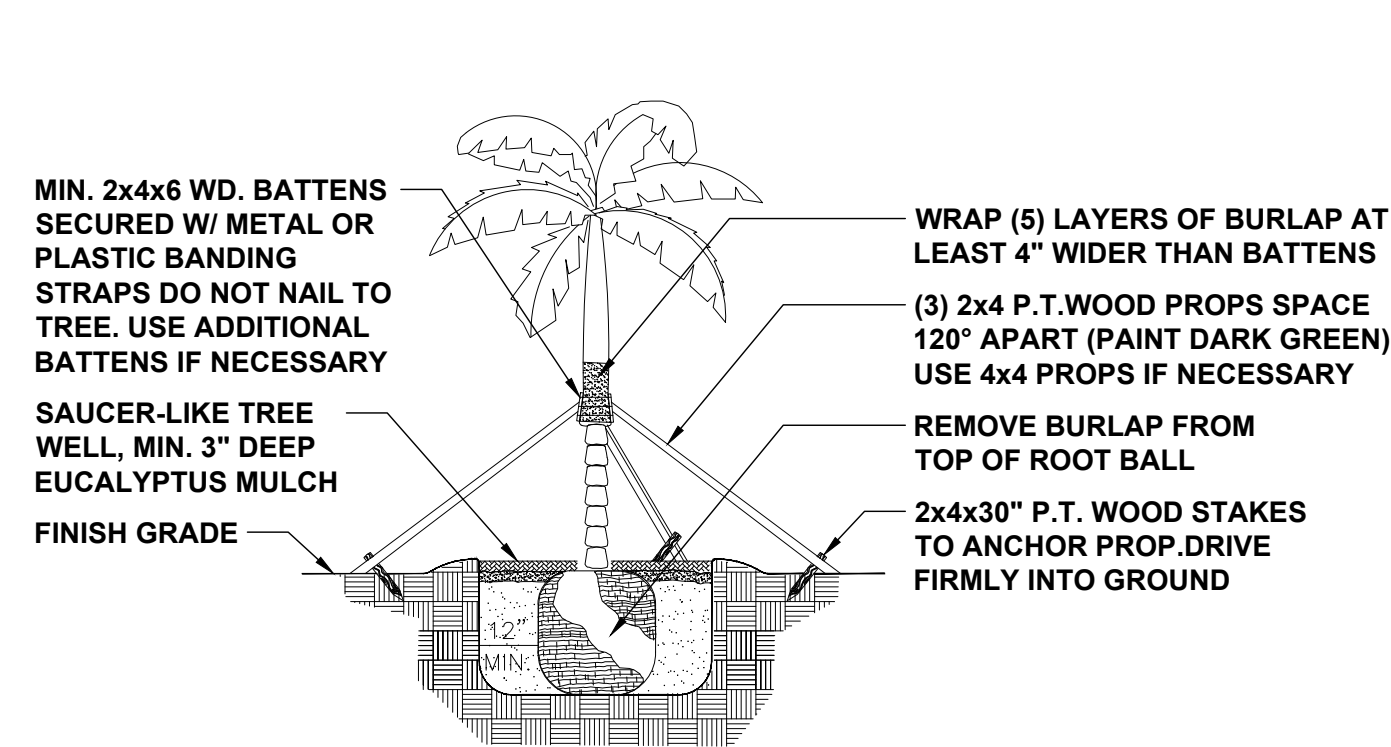

GENERAL LANDSCAPE NOTES:

1. ALL PLANT MATERIAL IS TO BE FLORIDA NO. 1 OR BETTER. FLORIDA DEPARTMENT OF AGRICULTURE GRADES AND STANDARDS, PARTS I & II 1973, 1975 RESPECTIVELY.
2. ALL PLANTING BEDS TO BE TOPPED WITH 2" MIN. "GRADE A" CYPRESS OR EUCALYPTUS MULCH, UNLESS OTHERWISE NOTED.
3. ALL TREES TO BE STAKED IN A GOOD WORKMANLIKE MANNER. NO NAIL STAKING PERMITTED. (REFER TO PLANTING DETAILS.)
4. LANDSCAPE PLAN SHALL BE INSTALLED IN COMPLIANCE WITH ALL LOCAL CODES.
5. ALL TREE HOLDS TO BE BACK FILLED AROUND AND UNDER ROOT BALL WITH PLANTING SOIL. ALL SHRUB BEDS TO BE INSTALLED WITH PLANTING SOIL. (SEE SPECS)
6. SOD SHALL BE "FLORATAM" ST. AUGUSTINE (UNLESS OTHERWISE NOTED) SOLID SOD LAID WITH ALTERNATIVE AND ABUTTING JOINTS, WITH 2" TOP SOIL MINIMUM IF REQUIRED. (SEE SPECS)
7. ALL TREES, SHRUBS AND GROUND COVERS SHALL BE GUARANTEED FOR TWELVE MONTHS FROM DATE OF FINAL ACCEPTANCE. ALL PALMS ARE TO BE GUARANTEED FOR ONE YEAR.
8. ALL PLANTING BEDS SHALL BE WEED AND GRASS FREE.
9. ALL TREES, PALMS, SHRUBS AND GROUND COVER PLANTS SHALL BE FERTILIZED AT INSTALLATION WITH LONG LASTING FERTILIZER, ACCORDING TO MANUFACTURERS RECOMMENDATIONS. (SUBMIT SAMPLE FOR APPROVAL.) (SEE SPEC)
10. PLANTING PLAN SHALL TAKE PRECEDENCE OVER PLANT LIST IN CASE OF DISCREPANCIES. (NOTIFY LANDSCAPE ARCHITECT FOR DIRECTION.)
11. LANDSCAPE CONTRACTOR SHALL LOCATE AND VERIFY ALL UNDERGROUND UTILITIES PRIOR TO DIGGING.
12. NO CHANGE SHALL BE MADE WITHOUT THE PRIOR CONSENT OF THE LANDSCAPE ARCHITECT.
13. ALL MATERIAL IS SUBJECT TO AVAILABILITY AT TIME OF INSTALLATION. SUBSTITUTIONS MAY BE MADE AFTER CONSULTATION WITH LANDSCAPE ARCHITECT.
14. ALL NEWLY PLANTED AREAS TO RECEIVE 100% COVERAGE BY AUTOMATIC IRRIGATION SYSTEM. (REFER TO IRRIGATION PLAN.)
15. ALL PLANTING BEDS TO RECEIVE NEW PLANTING SOIL (1/3 EVERGLADES PEAT, 1/3 SAND, 1/3 CYPRESS SAWDUST & CHOPS) MINIMUM 6" DEEP. (REFER TO PLANTING DETAILS.)
16. CONTRACTOR SHALL VISIT SITE TO FAMILIARIZE HIMSELF WITH THE SCOPE OF WORK PRIOR TO SUBMITTING A BID.
17. LANDSCAPE CONTRACTOR TO COORDINATE HIS WORK WITH THE GENERAL CONTRACTOR, THE IRRIGATION CONTRACTOR, AND THE ELECTRICAL CONTRACTOR.

18. ALL EXISTING PLANT MATERIAL TO REMAIN SHALL BE PROTECTED. (REFER TO DEMOLITION PLAN.)
19. ALL TREES TO BE RELOCATED WILL GET ROOT PRUNED 30 DAYS MIN. (OR MORE IF REQUIRED BY THE SPECIES). UPON RELOCATION, THIN OUT (UNDER LANDSCAPE ARCHITECT'S DIRECTION) 30% OF THE TREE CANOPY TO BE RELOCATED.
20. AFTER REMOVAL OR RELOCATION OF EXISTING TREES AND PALMS, BACKFILL TREE PIT WITH PLANTING SOIL AND SOD DISTURBED AREA, AS REQUIRED.
21. ALL TREES ON SOD AREAS SHALL RECEIVE A MULCH RING 2' IN DIAMETER TYPICAL.
22. ALL TREES SHALL HAVE A 2" CALIPER AT D.B.H. MINIMUM FOR A 10' HEIGHT TREE.
23. ALL 1 GALLON MATERIAL TO HAVE A 12" SPREAD MINIMUM, ALL 3 GALLON MATERIAL TO HAVE A 20-24" SPREAD MINIMUM.

TREE BRACING NOTES:

2" AND LARGER CALIPER TREES BRACED BY GUYING -

1. CHOOSE THE CORRECT SIZE AND NUMBER OF STAKES AND SIZE OF HOSE AND WIRE. GUYING SHALL BE COMPLETED WITHIN 48 HOURS OF PLANTING THE TREE.
2. CUT LENGTHS OF STAKING HOSE TO EXTEND 2 INCHES PAST TREE TRUNK WHEN WRAPPING AROUND.
3. SPACE STAKES EVENLY ON OUTSIDE OF WATER RING AND DRIVE EACH FIRMLY INTO THE GROUND. STAKES SHOULD BE DRIVING AT A 30 DEGREE ANGLE WITH THE POINT OF THE STAKE TOWARD THE TREE UNTIL 4 TO 5 INCHES ARE LEFT SHOWING.
4. PLACE THE HOSE AROUND THE TREE TRUNK JUST ABOVE THE LOWEST BRANCH.
5. THREAD THE WIRE THROUGH THE HOSE AND PAST THE STAKE, ALLOWING APPROXIMATELY 2 FEET OF EACH OF THE TWO ENDS BEYOND THE STAKE BEFORE CUTTING THE WIRE.
6. TWIST WIRE AT RUBBER HOSE TO KEEP IT IN PLACE.
7. PULL WIRE DOWN AND WIND BOTH ENDS AROUND STAKE TWICE. TWIST WIRE BACK ONTO ITSELF TO SECURE IT BEFORE CUTTING OFF THE EXCESS.
8. THE ABOVE PROCEDURES ARE TO BE FOLLOWED FOR EACH STAKE, KEEPING THE TREE STRAIGHT AT ALL TIMES. THERE SHOULD BE A 1 TO 3 INCH SWAY IN THE TREE (THE WIRES SHOULD NOT BE PULLED TIGHT) FOR BEST ESTABLISHMENT.
9. FLAG THE GUY WIRES WITH SURVEYOR'S FLAGGING OR APPROVED EQUAL FOR SAFETY.
10. GUYS ARE NOT TO BE REMOVED UNTIL APPROVED BY LANDSCAPE CONTRACTOR.

PLANTING SCHEDULE (PROPERTY)			
TREES			
Native	Qty	Botanical/Common Name	Specifications
Y	5	<i>Chrysophyllum oliviforme</i> Satinleaf Tree	4" DBH x 16' Ht. x 12' Sp. Min., FL Grade #1 or Better. (See General Note #1 Below)
Y	5	<i>Clusia rosea 'Nana'</i> Pitch Apple / Autograph Tree	4" DBH x 16' Ht. x 12' Sp. Min., FL Grade #1 or Better. (See General Note #1 Below)
Y	2	<i>Coccoloba uvifera</i> Sea Grape Tree	4" DBH x 16' Ht. x 12' Sp. Min., FL Grade #1 or Better. (See General Note #1 Below)
N	2	<i>Ligustrum japonicum</i> Wax Leaf Ligustrum Tree	4" DBH x 16' Ht. x 12' Sp. Min., FL Grade #1 or Better. (See General Note #1 Below)
Y	1	<i>Myrciaines fragrans</i> Simpson Stopper Tree	2" DBH x 12' Ht. x 8' Sp. Min., FL Grade #1 or Better. (See General Note #1 Below)

PALMS			
Native	Qty	Botanical/Common Name	Specifications
N	5	<i>Cocos nucifera</i> Coconut Palm	20' Wd., Matching, Curved Trunk (See General Note #1 Below)
Y	1	<i>Royal elata</i> Royal Palm	15" DBH. x 25' Ht. x 20" Sp. (Match Existing Royal Palm #27) (See General Note #1 Below)

BAMBOOS			
N	5	<i>Bambusa textilis</i> 'Gracilis' Graceful Bamboo	30 Gal., 15'-18" Ht., Full, 10-15 Canes Min. (See General Note #1 Below)

SHRUBS, GROUND COVERS AND VINES		
Native	Qty	Botanical/Common Name
Y	50	<i>Ernodea littoralis</i> Golden Creeper
N	38	<i>Clusia rosea</i> 'Nana' Same
Y	39	<i>Eugenia foetida</i> Spanish Stopper
N	13	<i>Heliconia rostrata</i> Hanging Lobster Claw Heliconia
Y	45	<i>Hymenocallis latifolia</i> Spider Lily
N	95	<i>Liriope muscari</i> 'Big Blue' Liriope 'Big Blue'
Y	391	<i>Nephrolepis exaltata</i> Boston Fern
N	16	<i>Philodendron</i> 'Burlle Marx' Same
N	35	<i>Philodendron</i> 'Weeks Red Hybrid' Philodendron Weeks Red
N	100	<i>Pilea serpyllacea</i> 'Stoplight' Stoplight Pilea
Y	5	<i>Serenoa repens</i> 'Cinerea' Silver Saw Palmetto

MISCELLANEOUS			
Native	Qty	Botanical/Common Name	Specifications
N	612 S.F.	Zoysia Sod	Empire

PLANTING SCHEDULE (RIGHT-OF-WAY)			
TREES			
Native	Qty	Botanical/Common Name	Specifications
Y	4	<i>Krugiodendron ferreum</i> Black Ironwood	12'-0" Ht. x 3" DBH min. x 8'-0" Sp. (See General Note #1 Below)

MISCELLANEOUS			
Native	Qty	Botanical/Common Name	Specifications
N	1,366 S.F.	Zoysia Sod in Right-of-Way	Empire

GENERAL NOTES	
1	Landscape Contractor shall provide photographic submittal with person for scale reference to Landscape Architect for review and approval prior to purchasing plants.
2	Landscape Architect to approve all specimen trees & palms in person.
3	All plant locations to approved on site by Landscape Architect.
4	Final grades shall be approved in the field by Landscape Architect prior to planting.
5	Landscape contractor to coordinate installation with Landscape Architect at least 1 month prior to installation date.
6	In addition to the above plant list and specifications there is to be an additional \$5,000.00 wholesale plant allowance.

Rev.	Date	Rev.	Date
1		9	
2		10	
3		11	
4		12	
5		14	
6		15	
7		16	
8		17	

ALL DRAWINGS AND WRITTEN MATERIAL APPEARING HEREIN CONSTITUTE THE ORIGINAL AND UNPUBLISHED WORK OF KOBİ KARP AIA, AND MAY NOT BE DUPLICATED, USED, OR DISCLOSED WITHOUT THE EXPRESS WRITTEN CONSENT OF KOBİ KARP ARCHITECTURE & INTERIOR DESIGN, INC. AIA. (c) 2020

DRB SUBMITTAL

PRIVATE RESIDENCE

5661 PINE TREE DRIVE
MIAMI BEACH, FL 33140

Owner:

PRIVATE RESIDENCE

Consultant:
Name
Address
Address
Tel:
Email

Consultant:
Name
Address
Address
Tel:
Email

Landscape Architect of Record:
David O. Design
p.o. box 331615
Coconut Grove, FL. 33233-1615, USA
Tel: +1(305) 854.9299 - Fax: +1(305) 854.9882
Email: davidodesign@hotmail.com
www.davidodishoo.com

Architect of Record:
Kobi Karp Architecture and Interior Design, Inc.
2915 Biscayne Boulevard, Suite #200
Miami, Florida 33137 USA
Tel: +1(305) 573 1818
Fax: +1(305) 573 3766

david o.
landscape
architecture

DAVID J. ODISHOO
RLA #6666969

PLANTING SCHEDULE, DETAILS, & NOTES

Date: 10-18-2021	Sheet No. LP-300
Scale :	
Project # :	

CITY OF MIAMI BEACH

LANDSCAPE LEGEND

INFORMATION REQUIRED TO BE PERMANENTLY AFFIXED TO PLANS
Zoning District RS-3 Lot Area 13,623 s.f. Acres 0.31274

OPEN SPACE

A. Square feet of required Open Space as indicated on site plan: Lot Area = 13,623 s.f. s.f.x 50% = 6,811.50 s.f.	REQUIRED/ ALLOWED	PROVIDED
B. Square feet of parking lot open space required as indicated on site plan: Number of parking spaces n/a x 10 s.f. parking space =	n/a	n/a
C. Total square feet of landscaped open space required: A+B=	6,811.50 s.f.	6,434 s.f.

LAWN AREA CALCULATION

A. Square feet of landscaped open space required	6,811.50 s.f.	6,434 s.f.
B. Maximum lawn area (sod) permitted= 50 % x 6,434 s.f.	3,217 s.f.	612 s.f.

TREES

A. Number of trees required per lot or net lot acre, less existing number of trees meeting minimum requirements= 13 trees x n/a net lot acres - number of existing trees=	13	15
B. % Natives required: Number of trees provided x 30% =	5	13
C. % Low maintenance / drought and salt tolerant required: Number of trees provided x 50%=	8	15
D. Street Trees (maximum average spacing of 20' o.c.) 75' linear feet along street divided by 20'=	4	4
E. Street tree species allowed directly beneath power lines: (maximum average spacing of 20' o.c.): 75' linear feet along street divided by 20'=	4	4

SHRUBS

A. Number of shrubs required: Sum of lot and street trees required x 12=	204	680
B. % Native shrubs required: Number of shrubs provided x 50%=	340	491

LARGE SHRUBS OR SMALL TREES

A. Number of large shrubs or small trees required: Number of required shrubs x 10%=	21	52
B. % Native large shrubs or small trees required: Number of large shrubs or small trees provided x 50%=	26	39

EXISTING TREE AND PALMS MITIGATION SCHEDULE (PROPERTY)

TREE NUMBER	COMMON NAME	SCIENTIFIC NAME	DIAMETER (INCHES)	HEIGHT (FT)	CANOPY (FT)
1	ARECA PALM	DYPSIS LUTESCENS	3 EA.	15	12
2	ARECA PALM	DYPSIS LUTESCENS	3 EA.	15	12
26	THATCH PALM	THRINAX RADIATA	4	16	8
29	ARECA PALM	DYPSIS LUTESCENS	3 EA.	45	15
30	CHINESE FAN PALM	LIVISTONEA CHINENSIS	9	14	12
47	DWARF ROEBELLINI	PHOENIX ROEBELLINI	4	10	8
48	DWARF ROEBELLINI	PHOENIX ROEBELLINI	4	10	8
65	LAKEVIEW JASMINE	MURRAYA PANICULATA	9	12	10
81	GRAPE MYRTLE	LAGERSTROEMIA INDICA	9	14	12

Total Amount of DBH to be Mitigated = 18 Inches

Total Amount of Palms to be Mitigated = 7

MITIGATION REQUIREMENTS (PROPERTY)

TOTAL TREE DBH INCHES REMOVED	REQUIREMENT	PROVIDED
18 DBH Inches	3 Trees @ 16ft Ht. x 8ft Sp. x 4in D.B.H. Min. or 6 Trees @ 12ft Ht. x 6ft Sp. x 2in D.B.H. Min.	14 Trees @ 16ft Ht. x 8ft Sp. x 4in D.B.H. Min. & 1 Trees @ 12ft Ht. x 6ft Sp. x 2in D.B.H. Min.
TOTAL PALMS REMOVED	REQUIREMENT	
7 Palms	7 Trees @ 12ft Ht. X 2in D.B.H. Min.	

Note 1: Chapter 46-61, (1) (c): The removal of a palm shall be replaced with one canopy tree 12 feet overall height with a two-inch DBH.

EXISTING PALMS MITIGATION SCHEDULE (RIGHT-OF-WAY)

TREE NUMBER	COMMON NAME	SCIENTIFIC NAME	DIAMETER (INCHES)	HEIGHT (FT)	CANOPY (FT)
82	ALEXANDER PALM	PTYCHOSPERMA ELEGANS	5	30	10
83	THATCH PALM	THRINAX RADIATA	6	5	15
84	CHINESE FAN PALM	LIVISTONEA CHINENSIS	9	15	12
85	CHINESE FAN PALM	LIVISTONEA CHINENSIS	9	15	12
86	CHINESE FAN PALM	LIVISTONEA CHINENSIS	9	15	12
87	DATE PALM	PHOENIX CANARIENSIS	24	35	15
88	ALEXANDER PALM	PTYCHOSPERMA ELEGANS	5	15	10
89	ALEXANDER PALM	PTYCHOSPERMA ELEGANS	5	15	10
90	ALEXANDER PALM	PTYCHOSPERMA ELEGANS	5	20	10
91	ALEXANDER PALM	PTYCHOSPERMA ELEGANS	5	25	10
92	ALEXANDER PALM	PTYCHOSPERMA ELEGANS	5	20	10
93	ALEXANDER PALM	PTYCHOSPERMA ELEGANS	5	20	10
94	ALEXANDER PALM	PTYCHOSPERMA ELEGANS	5	20	10
95	ALEXANDER PALM	PTYCHOSPERMA ELEGANS	5	15	10
96	ALEXANDER PALM	PTYCHOSPERMA ELEGANS	5	25	10
97	ALEXANDER PALM	PTYCHOSPERMA ELEGANS	5	20	10
98	ALEXANDER PALM	PTYCHOSPERMA ELEGANS	5	25	10
99	ALEXANDER PALM	PTYCHOSPERMA ELEGANS	5	15	10
100	ALEXANDER PALM	PTYCHOSPERMA ELEGANS	5	15	10
101	ALEXANDER PALM	PTYCHOSPERMA ELEGANS	5	15	10
102	ALEXANDER PALM	PTYCHOSPERMA ELEGANS	5	20	10
103	ALEXANDER PALM	PTYCHOSPERMA ELEGANS	5	25	10
104	ALEXANDER PALM	PTYCHOSPERMA ELEGANS	5	20	10
105	ALEXANDER PALM	PTYCHOSPERMA ELEGANS	5	20	10
106	ALEXANDER PALM	PTYCHOSPERMA ELEGANS	5	15	10
107	ALEXANDER PALM	PTYCHOSPERMA ELEGANS	5	20	10
108	ALEXANDER PALM	PTYCHOSPERMA ELEGANS	5	20	10
109	ALEXANDER PALM	PTYCHOSPERMA ELEGANS	5	20	10
110	QUEEN PALM	SYAGRUS ROMANZOFFIANA	6	14	8

Total Amount of Palms to be Mitigated = 29

MITIGATION REQUIREMENTS (RIGHT-OF-WAY)

TOTAL PALMS REMOVED	REQUIREMENT	PROVIDED
29 Palms	4 Trees @ 12ft Ht. X 2in D.B.H. Min. (75 Linear Feet along Street)	4 Trees @ 12ft Ht. x 6ft Sp. x 2in D.B.H. Min.

Note 1: Sec. 126-6 Minimum Standards (a) (3) Power lines: Under high voltage transmission lines installed independent of underbuilt distribution lines, tree height and spread shall not exceed the minimum approach distances specified in the FPL Plant the Right Tree in the Right Place guidelines and illustrations. The maximum spacing of appropriate and allowed tree species planted under power lines shall be 20 feet on center.

PROPOSED TREES MITIGATION SCHEDULE (PROPERTY)

NATIVE	QUANTITY	BOTANICAL/COMMONG NAME	SPECIFICATIONS
Y	5	Chrysophyllum oliviforme Satinleaf Tree	4" DBH. x 16' Ht. x 12' Sp. Min., FL Grade #1 or Better. (See General Note #1 Below)
Y	5	Clusia rosea 'Nana' Pitch Apple / Autograph Tree	4" DBH. x 16' Ht. x 12' Sp. Min., FL Grade #1 or Better. (See General Note #1 Below)
Y	2	Coccoloba uvifera Sea Grape Tree	4" DBH. x 16' Ht. x 12' Sp. Min., FL Grade #1 or Better. (See General Note #1 Below)
N	2	Ligustrum japonicum Wax Leaf Ligustrum Tree	4" DBH. x 16' Ht. x 12' Sp. Min., FL Grade #1 or Better. (See General Note #1 Below)
Y	1	Myrcianthes fragrans Simpson Stopper Tree	2" DBH. x 12' Ht. x 8' Sp. Min., FL Grade #1 or Better. (See General Note #1 Below)

Total Trees Required = 7 Trees @ 16ft Ht. x 8ft Sp. x 4in D.B.H. Min. -or- 13 Trees @ 12ft Ht. x 6ft Sp. x 2in D.B.H. Min.

Total Trees Provided = 14 Trees @ 16ft Ht. x 8ft Sp. x 4in D.B.H. Min. and 1 Tree @ 12ft Ht. x 6ft Sp. x 2in D.B.H. Min.

PROPOSED TREES MITIGATION SCHEDULE (RIGHT-OF-WAY)

NATIVE	QUANTITY	BOTANICAL/COMMONG NAME	SPECIFICATIONS
Y	4	Krugiodendron ferreum Black Ironwood	12'-0" Ht. x 3" DBH min. x 8'-0" Sp. (See General Note #1 Below)

Total Trees Required = 4 Trees @ 12ft Ht. x 2in D.B.H. Min.

Total Trees Provided = 4 Trees @ 12ft Ht. x 2in D.B.H. Min.

Rev.	Date	Rev.	Date
1		9	
2		10	
3		11	
4		12	
5		14	
6		15	
7		16	
8		17	

ALL DRAWINGS AND WRITTEN MATERIAL APPEARING HEREIN CONSTITUTE THE ORIGINAL AND UNPUBLISHED WORK OF KOBİ KARP ARCHITECTURE, AND MAY NOT BE DUPLICATED, USED, OR DISCLOSED WITHOUT THE EXPRESS WRITTEN CONSENT OF KOBİ KARP ARCHITECTURE, & INTERIOR DESIGN, INC. AIA. (c) 2020

DRB SUBMITTAL

PRIVATE RESIDENCE

5661 PINE TREE DRIVE
MIAMI BEACH, FL 33140

Owner:

PRIVATE RESIDENCE

Consultant:

Name
Address
Tel:
Email

Consultant:

Name
Address
Tel:
Email

Landscape Architect of Record:

David O. Design
p.o. box 331615
Coconut Grove, FL 33233-1615, USA
Tel: +1(305) 854.9299 - Fax: +1(305) 854.9882
Email: davidodesign@hotmail.com
www.davidodishoo.com

Architect of Record:

Kobi Karp Architecture and Interior Design, Inc.
2915 Biscayne Boulevard, Suite #200
Miami, Florida 33137, USA
Tel: +1(305) 573 1818
Fax: +1(305) 573 3766

david o.

landscape
architecture

DAVID J. ODISHOO
RLA #666969

TREE REPLACEMENT SCHEDULE &
LANDSCAPE LEGEND

Date: 10-18-2021	Sheet No.
Scale :	LP-400
Project # :	