

| Rev. | Date | Rev. | Date |
|------|------|------|------|
| | | | |
| | | | |
| | | | |
| | | | |
| | | | |
| | | | |
| | | | |
| | | | |
| | | | |
| | | | |

Shore Club
 1901 Collins Ave.
 Miami Beach, FL 33139

Owner: WITKOFF.
 Name: 40 West 57th Street, Suite 1620
 Address: New York, NY 10019
 Address: 212-672-4700
 Tel: wtkoff@rossetipr.com
 Email:

Consultant: RAMSA
 Name: Robert A.M. Stern Architects.
 Address: One Park Avenue
 Address: New York, NY 10016
 Tel: 212-667-5100
 Email:

Consultant: LANDSCAPE
 Name: Island Planning Corporation.
 Address: 243 Washington Ave.
 Address: Miami Beach, FL 33139
 Tel: 305-534-5725
 Email: info@islandplanningcorporation.com

Consultant: LANDSCAPE
 Name: Greenspace Strategies
 Address: 7905 SW 17th Street
 Address: Miami, FL 33157
 Tel: 561-460-8499
 Email: ca@greenspacestrategies.com

Architect of Record:
 Kobi Karp Architecture and Interior Design, Inc.
 571 NW 28th Street
 Miami, Florida 33127 USA
 Tel: +1(305) 573 1818
 Fax: +1(305) 573 3786



| FINISH / MATERIALS SCHEDULE | | | FINISH / MATERIALS SCHEDULE | | |
|-----------------------------|---------------------|--|-----------------------------|---------------|---|
| SYM | ITEM | SPECIFICATIONS | SYM | ITEM | SPECIFICATIONS |
| 1 | KEYSTONE | TYPE: FLORIDA KEYSTONE COLOR: NATURAL FINISH: TBD SOURCE: TBD | A | CAFE TABLE | TYPE: 4 PERSON CAFE TABLE COLOR: TBD FINISH: TBD SOURCE: TBD |
| 2 | COBBLE PAVERS | TYPE: 4 X 4 VEHICULAR RATED PAVERS COLOR: TBD FINISH: TBD SOURCE: TBD | B | GARDEN BENCH | TYPE: 6' GARDEN BENCH COLOR: TBD FINISH: TBD SOURCE: TBD |
| 3 | CRUSHED SHELL STONE | TYPE: CRUSHED SEA SHELL COLOR: WHITE FINISH: TBD SOURCE: TBD | C | LOUNGE CHAIRS | TYPE: POOL LOUNGE CHAIRS COLOR: TBD FINISH: TBD SOURCE: TBD |
| 4 | SOIL CELL | TYPE: SILVA CELL COLOR: BLACK FINISH: PLASTIC SOURCE: TBD | | | |
| 5 | WOOD DECK CELL | TYPE: IPE COLOR: NATURAL FINISH: NATURAL SOURCE: TBD | | | |

| FINISH / MATERIALS SCHEDULE | | | FINISH / MATERIALS SCHEDULE | | |
|-----------------------------|---------------------|--|-----------------------------|---------------|---|
| SYM | ITEM | SPECIFICATIONS | SYM | ITEM | SPECIFICATIONS |
| 1 | KEYSTONE | TYPE: FLORIDA KEYSTONE COLOR: NATURAL FINISH: TBD SOURCE: TBD | A | CAFE TABLE | TYPE: 4 PERSON CAFE TABLE COLOR: TBD FINISH: TBD SOURCE: TBD |
| 2 | COBBLE PAVERS | TYPE: 4 X 4 VEHICULAR RATED PAVERS COLOR: TBD FINISH: TBD SOURCE: TBD | B | GARDEN BENCH | TYPE: 6' GARDEN BENCH COLOR: TBD FINISH: TBD SOURCE: TBD |
| 3 | CRUSHED SHELL STONE | TYPE: CRUSHED SEA SHELL COLOR: WHITE FINISH: TBD SOURCE: TBD | C | LOUNGE CHAIRS | TYPE: POOL LOUNGE CHAIRS COLOR: TBD FINISH: TBD SOURCE: TBD |
| 4 | SOIL CELL | TYPE: SILVA CELL COLOR: BLACK FINISH: PLASTIC SOURCE: TBD | | | |
| 5 | WOOD DECK CELL | TYPE: IPE COLOR: NATURAL FINISH: NATURAL SOURCE: TBD | | | |

HARDSCAPE MATERIALS PLAN
 1" = 50'-0"

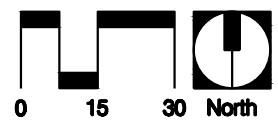

| | | | |
|---------|-------------|-----------|----------|
| Date | 2021-12-06 | Sheet No. | L1-03.00 |
| Scale | See Drawing | | |
| Project | 2104 | | |

| FINISH / MATERIALS SCHEDULE | | |
|-----------------------------|---------------------|--|
| SYM | ITEM | SPECIFICATIONS |
| ① | KEYSTONE | TYPE: FLORIDA KEYSTONE COLOR: NATURAL FINISH: TBD SOURCE: TBD |
| ② | COBBLE PAVERS | TYPE: 4 X 4 VEHICULAR RATED PAVERS COLOR: TBD FINISH: TBD SOURCE: TBD |
| ③ | CRUSHED SHELL STONE | TYPE: CRUSHED SEA SHELL COLOR: WHITE FINISH: TBD SOURCE: TBD |
| ④ | SOIL CELL | TYPE: SILVA CELL COLOR: BLACK FINISH: PLASTIC SOURCE: TBD |
| Ⓐ | CAFE TABLE | TYPE: 4 PERSON CAFE TABLE COLOR: TBD FINISH: TBD SOURCE: TBD |
| Ⓑ | GARDEN BENCH | TYPE: 6' GARDEN BENCH COLOR: TBD FINISH: TBD SOURCE: TBD |
| Ⓒ | LOUNGE CHAIRS | TYPE: POOL LOUNGE CHAIRS COLOR: TBD FINISH: TBD SOURCE: TBD |

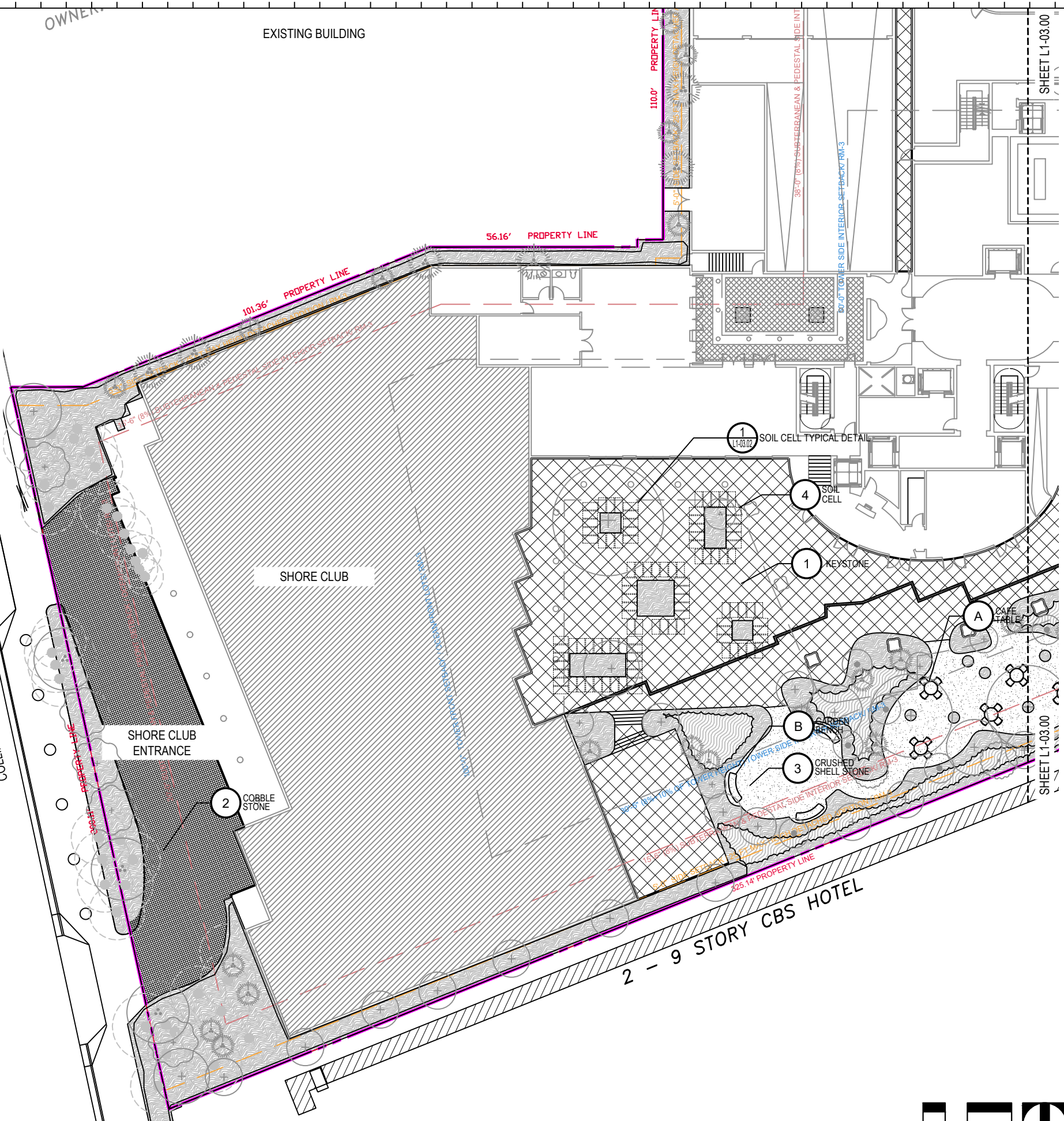

| Rev. | Date | Rev. | Date |
|------|------|------|------|
| | | | |
| | | | |
| | | | |
| | | | |
| | | | |
| | | | |
| | | | |
| | | | |
| | | | |
| | | | |

Shore Club
1901 Collins Ave.
Miami Beach, FL 33139

Owner: WITKOFF.
Name: 40 West 57th Street, Suite 1620
Address: New York, NY 10019
Tel: 212-672-4700
Email: witkoff@rossettipjr.com

Consultant: RAMSA
Name: Robert A.M. Stern Architects.
Address: One Park Avenue
Address: New York, NY 10016
Tel: 212-667-5100
Email: info@ramsa.com

Consultant: LANDSCAPE
Name: Island Planning Corporation.
Address: 243 Washington Ave.
Address: Miami Beach, FL 33139
Tel: 305-534-5725
Email: info@islandplanningcorporation.com

Consultant: LANDSCAPE
Name: Greenspace Strategies
Address: 7905 SW 17th Street
Address: Miami, FL 33157
Tel: 561-460-8499
Email: ca@greenspacestrategies.com

Architect of Record:
Kobi Karp Architecture and Interior Design, Inc.
571 NW 28th Street
Miami, Florida 33127 USA
Tel: +1(305) 573 1818
Fax: +1(305) 573 3766

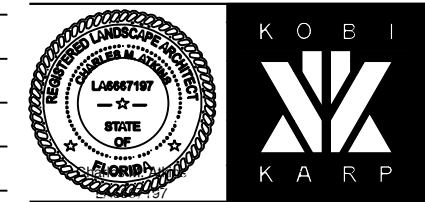

①-03.01 HARDSCAPE MATERIALS PLAN 1" = 30'-0"

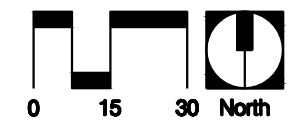

| | | | |
|-------|-------------|-----------|----------|
| Date | 2021-12-06 | Sheet No. | L1-03.01 |
| Scale | See Drawing | Project | 2104 |



DeepRoot Green Infrastructure
www.deeproot.com

T 415 781 9700
F 415 781 0191

RELEASE VERSION: V1.1 | RELEASE DATE: 2019.03.20

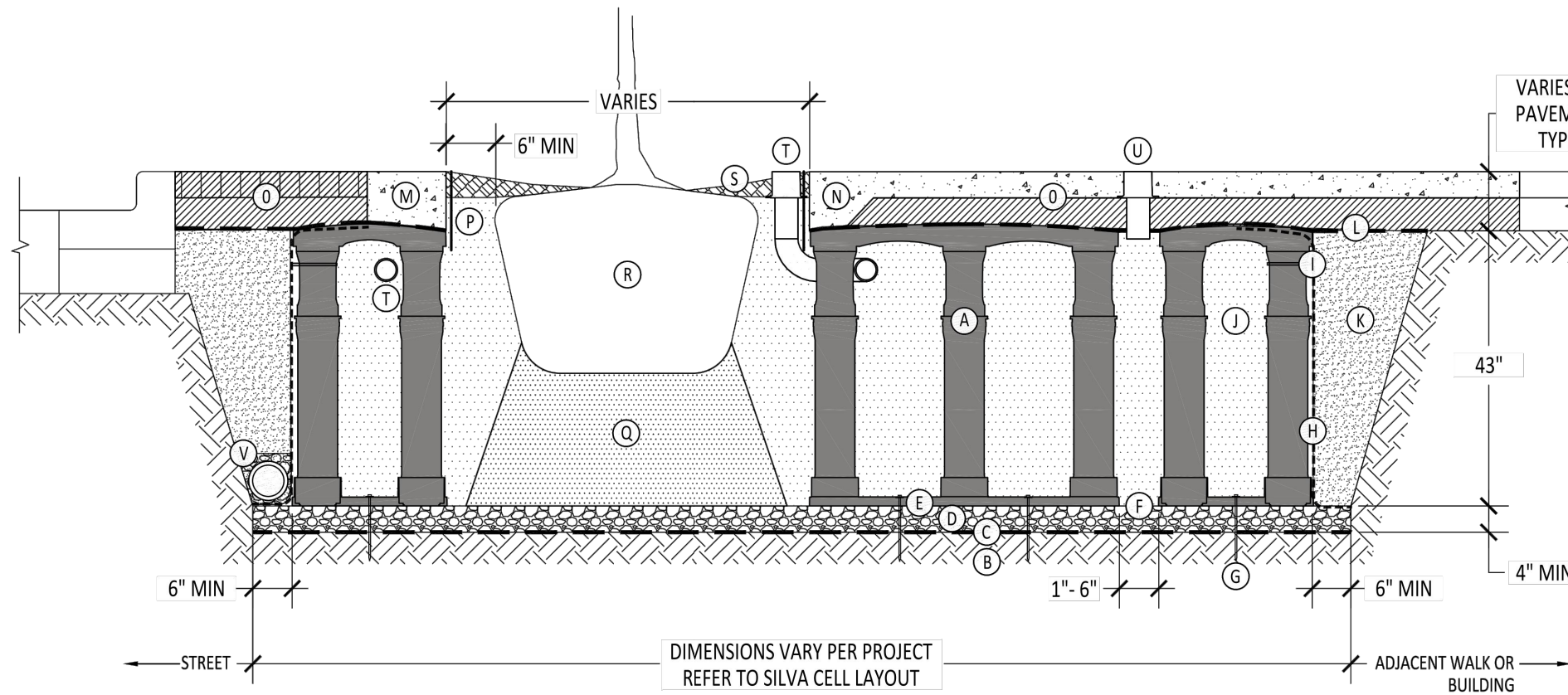

SILVA CELL SYSTEM 3X

SILVA CELL SYSTEM 3X

NOT TO SCALE

KEY PLAN

- (A) SILVA CELL SYSTEM (DECK, BASE, AND POSTS)
- (B) SUBGRADE, COMPACTED
- (C) GEOTEXTILE FABRIC, PLACED ABOVE SUBGRADE
- (D) 4" MIN AGGREGATE SUB BASE, COMPACTED TO 95% PROCTOR
- (E) SILVA CELL BASE SLOPE, 10% MAX
- (F) 1" TO 6" SPACING BETWEEN SILVA CELLS AT BASE
- (G) ANCHORING SPIKES, CONTACT DEEPROOT FOR ALTERNATIVE
- (H) GEOGRID, WRAPPED AROUND PERIMETER OF SYSTEM, WITH 6" TOE (OUTWARD FROM BASE) AND 12" EXCESS (OVER TOP OF DECK)
- (I) CABLE TIE, ATTACHING GEOGRID TO SILVA CELL AT BASE OF UPPER LEG FLARE, AS NEEDED

- (J) PLANTING SOIL, PER PROJECT SPECIFICATIONS, PLACED IN LIFTS AND WALK-IN COMPACTED TO 75-85% PROCTOR
- (K) COMPACTED BACKFILL, PER PROJECT SPECIFICATIONS
- (L) GEOTEXTILE FABRIC TO EDGE OF EXCAVATION
- (M) RIBBON CURB AT TREE OPENING (TO BE USED WITH PAVERS OR ASPHALT)
- (N) THICKENED EDGE AT TREE OPENING (TO BE USED WITH CONCRETE)
- (O) PAVEMENT AND AGGREGATE BASE PER PROJECT *

| *MINIMUM PAVEMENT PROFILE OPTIONS TO MEET H-20 LOADING | |
|--|-------------------------|
| PAVEMENT | + AGGREGATE BASE COURSE |
| 4" CONCRETE | + 4" AGGREGATE |
| 3" PAVER | + 12" AGGREGATE |
| 4" ASPHALT | + 12" AGGREGATE |
| 2.6" PAVER | + 5" CONCRETE |

- (P) DEEPROOT ROOT BARRIER, 12" OR 18", DEPTH DETERMINED BY THICKNESS OF PAVEMENT SECTION, INSTALL DIRECTLY ADJACENT TO CONCRETE EDGE RESTRAINT
- (Q) PLANTING SOIL BELOW ROOT BALL, COMPACTED WELL TO PREVENT SETTLING
- (R) ROOT BALL
- (S) TREE OPENING TREATMENT, PER PROJECT SPECIFICATIONS
- (T) DEEPROOT WATER AND AIR VENT, ROOTBALL, WHEN REQUIRED
- (U) DEEPROOT WATER AND AIR VENT, WHEN REQUIRED
- (V) UNDERDRAIN SYSTEM, WHEN REQUIRED (LOCATION AND DETAILS BY OTHERS)

NOTES

1. EXCAVATION SHALL BE DONE IN ACCORDANCE WITH ALL APPLICABLE HEALTH AND SAFETY REGULATIONS
2. INSTALLATION TO BE COMPLETED IN ACCORDANCE WITH MANUFACTURER'S SPECIFICATIONS
3. PROVIDE SUPPLEMENTAL IRRIGATION
4. DO NOT SCALE DRAWINGS

NOT TO SCALE
FEET

| Rev. | Date | Rev. | Date |
|------|------|------|------|
| | | | |
| | | | |
| | | | |
| | | | |
| | | | |
| | | | |
| | | | |
| | | | |
| | | | |
| | | | |

ALL DRAWINGS AND WRITTEN MATERIAL APPEARING HEREIN CONSTITUTE THE ORIGINAL AND UNPUBLISHED WORK OF KOBI KARP AIA, AND MAY NOT BE DUPLICATED, USED, OR DISCLOSED WITHOUT THE EXPRESS WRITTEN CONSENT OF KOBI KARP ARCHITECTURE, & INTERIOR DESIGN, INC. AIA 01-2019.

Shore Club
1901 Collins Ave.
Miami Beach, FL 33139

Owner: WITKOFF.
Name: 40 West 57th Street, Suite 1620
Address: New York, NY 10019
Address: New York, NY 10019
Tel: 212-672-4700
Email: witkof@rossettipr.com

Consultant: RAMSA
Name: Robert A.M. Stern Architects.
Address: One Park Avenue
Address: New York, NY 10016
Tel: 212-967-5100
Email: info@islandplanningcorporation.com

Consultant: LANDSCAPE
Name: Island Planning Corporation.
Address: 243 Washington Ave.
Address: Miami Beach, FL 33139
Tel: 305-534-5725
Email: info@islandplanningcorporation.com

Consultant: LANDSCAPE
Name: Greenspace Strategies
Address: 7905 SW 170th Street
Address: Miami, FL 33157
Tel: 561-460-8499
Email: ca@greenspacestrategies.com

Architect of Record:
Kobi Karp Architecture and Interior Design, Inc.
571 NW 28th Street
Miami, Florida 33127 USA
Tel: +1(305) 573 1818
Fax: +1(305) 573 3786

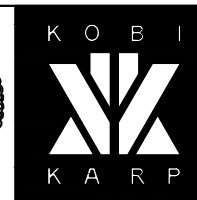



| Rev. | Date | Rev. | Date |
|------|------|------|------|
| | | | |
| | | | |
| | | | |
| | | | |
| | | | |
| | | | |
| | | | |
| | | | |
| | | | |
| | | | |

ALL DRAWINGS AND WRITTEN MATERIAL APPEARING HEREIN CONSTITUTE THE ORIGINAL AND UNPUBLISHED WORK OF KOBİ KARP AIA, AND MAY NOT BE DUPLICATED, USED, OR DISCLOSED WITHOUT THE EXPRESS WRITTEN CONSENT OF KOBİ KARP ARCHITECTURE & INTERIOR DESIGN, INC. AIA 01-2020

Shore Club
 1901 Collins Ave.
 Miami Beach, FL 33139

Owner: WITKOFF.
Name: 40 West 57th Street, Suite 1620
Address: New York, NY 10019
Address: 212-672-4700
Tel: 212-672-4700
Email: witkoff@rossettipr.com

Consultant: RAMSA
Name: Robert A.M. Stern Architects.
Address: One Park Avenue
Address: New York, NY 10016
Tel: 212-667-5100
Email: info@ramsa.com

Consultant: LANDSCAPE
Name: Island Planning Corporation.
Address: 243 Washington Ave.
Address: Miami Beach, FL 33139
Tel: 305-534-5725
Email: info@islandplanningcorporation.com

Consultant: LANDSCAPE
Name: Greenspace Strategies
Address: 7905 SW 170th Street
Address: Miami, FL 33157
Tel: 561-460-8499
Email: ca@greenspacestrategies.com

Architect of Record:
 Kobi Karp Architecture and Interior Design, Inc.
 571 NW 28th Street
 Miami, Florida 33127 USA
Tel: +1(305) 573 1818
Fax: +1(305) 573 3766



SHORE CLUB OVERALL WEST ENTRANCE ELEVATION
 N.T.S.

| | | | |
|---------|-------------|-----------|----------|
| Date | 2021-12-06 | Sheet No. | L1-04.00 |
| Scale | See Drawing | | |
| Project | 2104 | | |



| Rev. | Date | Rev. | Date |
|------|------|------|------|
| | | | |
| | | | |
| | | | |
| | | | |
| | | | |
| | | | |
| | | | |
| | | | |
| | | | |
| | | | |

ALL DRAWINGS AND WRITTEN MATERIAL APPEARING HEREIN CONSTITUTE THE ORIGINAL AND UNPUBLISHED WORK OF KOBİ KARP AIA, AND MAY NOT BE DUPLICATED, USED, OR DISCLOSED WITHOUT THE EXPRESS WRITTEN CONSENT OF KOBİ KARP ARCHITECTURE & INTERIOR DESIGN, INC. AIA 10-2020

Shore Club
1901 Collins Ave.
Miami Beach, FL 33139

Owner: WITKOFF.
Name: 40 West 57th Street, Suite 1620
Address: New York, NY 10019
Address: 212-672-4700
Tel: wtkoff@rossettipr.com
Email:

Consultant: RAMSA
Name: Robert A.M. Stern Architects.
Address: One Park Avenue
Address: New York, NY 10016
Tel: 212-667-5100
Email:

Consultant: LANDSCAPE
Name: Island Planning Corporation.
Address: 248 Washington Ave.
Address: Miami Beach, FL 33139
Tel: 305-534-5725
Email: info@islandplanningcorporation.com

Consultant: LANDSCAPE
Name: Greenspace Strategies
Address: 7905 SW 170th Street
Address: Miami, FL 33157
Tel: 561-460-8499
Email: ca@greenspacestrategies.com

Architect of Record:
Kobi Karp Architecture and Interior Design, Inc.
571 NW 28th Street
Miami, Florida 33127 USA
Tel: +1(305) 573 1818
Fax: +1(305) 573 3786

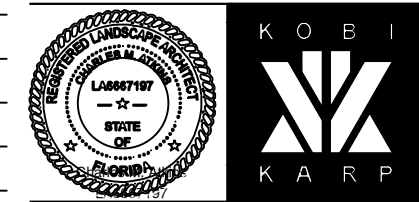

CROMWELL OVERALL NORTH ENTRANCE ELEVATION
N.T.S.

| | | | |
|---------|-------------|-----------|----------|
| Date | 2021-12-06 | Sheet No. | L1-05.00 |
| Scale | See Drawing | | |
| Project | 2104 | | |



THE SHORE CLUB BEYOND

PROPOSED TOWER

NATIVE CANOPY, PALM AND UNDERSTORY PLANTING MIX

THE CROMWELL

PROPOSED BOUQUET OF PALM SPECIES ADJACENT TO LAP POOL

NATIVE PLANTING MIX AT CROMWELL ENTRANCE

VILLAS

GUEST POOL

LAP POOL

20TH STREET

| Rev. | Date | Rev. | Date |
|------|------|------|------|
| | | | |
| | | | |
| | | | |
| | | | |
| | | | |
| | | | |
| | | | |
| | | | |
| | | | |
| | | | |

ALL DRAWINGS AND WRITTEN MATERIAL APPEARING HEREIN CONSTITUTE THE ORIGINAL AND UNPUBLISHED WORK OF KOBI KARP AIA, AND MAY NOT BE DUPLICATED, USED, OR DISCLOSED WITHOUT THE EXPRESS WRITTEN CONSENT OF KOBI KARP ARCHITECTURE & INTERIOR DESIGN, INC. AIA 101200.

Shore Club
1901 Collins Ave.
Miami Beach, FL 33139

Owner: WITKOFF.
Name: 40 West 57th Street, Suite 1620
Address: New York, NY 10019
Tel: 212-672-4700
Email: witkoff@rossettipr.com

Consultant: RAMSA
Name: Robert A.M. Stern Architects.
Address: One Park Avenue
Address: New York, NY 10016
Tel: 212-967-5100
Email: info@islandplanningcorporation.com

Consultant: LANDSCAPE
Name: Island Planning Corporation.
Address: 243 Washington Ave.
Address: Miami Beach, FL 33139
Tel: 305-534-5725
Email: info@islandplanningcorporation.com

Consultant: LANDSCAPE
Name: Greenspace Strategies
Address: 7905 SW 170th Street
Address: Miami, FL 33157
Tel: 561-460-8499
Email: ca@greenspacestrategies.com

Architect of Record:
Kobi Karp Architecture and Interior Design, Inc.
571 NW 28th Street
Miami, Florida 33127 USA
Tel: +1(305) 573 1818
Fax: +1(305) 573 3786



SHORE CLUB EAST ELEVATION
L1-06.00 N.T.S.

| | | | |
|---------|-------------|-----------|----------|
| Date | 2021-12-06 | Sheet No. | L1-06.00 |
| Scale | See Drawing | | |
| Project | 2104 | | |



| Rev. | Date | Rev. | Date |
|------|------|------|------|
| | | | |
| | | | |
| | | | |
| | | | |
| | | | |
| | | | |
| | | | |
| | | | |
| | | | |
| | | | |

ALL DRAWINGS AND WRITTEN MATERIAL APPEARING HEREIN CONSTITUTE THE ORIGINAL AND UNPUBLISHED WORK OF KOBI KARP AIA, AND MAY NOT BE DUPLICATED, USED, OR DISCLOSED WITHOUT THE EXPRESS WRITTEN CONSENT OF KOBI KARP ARCHITECTURE & INTERIOR DESIGN, INC. AIA 101200.

Shore Club
1901 Collins Ave.
Miami Beach, FL 33139

Owner: WITKOFF.
Name: 40 West 57th Street, Suite 1620
Address: New York, NY 10019
Address: 212-672-4700
Tel: 212-672-4700
Email: witkoff@rossettipr.com

Consultant: RAMSA
Name: Robert A.M. Stern Architects.
Address: One Park Avenue
Address: New York, NY 10016
Tel: 212-967-5100
Email: 212-967-5100

Consultant: LANDSCAPE
Name: Island Planning Corporation.
Address: 243 Washington Ave.
Address: Miami Beach, FL 33139
Tel: 305-534-5725
Email: info@islandplanningcorporation.com

Consultant: LANDSCAPE
Name: Greenspace Strategies
Address: 7905 SW 170th Street
Address: Miami, FL 33157
Tel: 561-460-8499
Email: ca@greenspacestrategies.com

Architect of Record:
Kobi Karp Architecture and Interior Design, Inc.
571 NW 28th Street
Miami, Florida 33127 USA
Tel: +1(305) 573 1818
Fax: +1(305) 573 3786

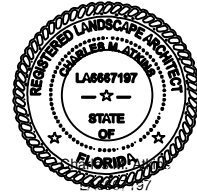

SHORE CLUB SOUTH ELEVATION
N.T.S.

| | | | |
|---------|-------------|-----------|----------|
| Date | 2021-12-06 | Sheet No. | L1-07.00 |
| Scale | See Drawing | | |
| Project | 2104 | | |