

Hardscape - Material and Pattern Examples

Wood and Crushed Shellstone Combination

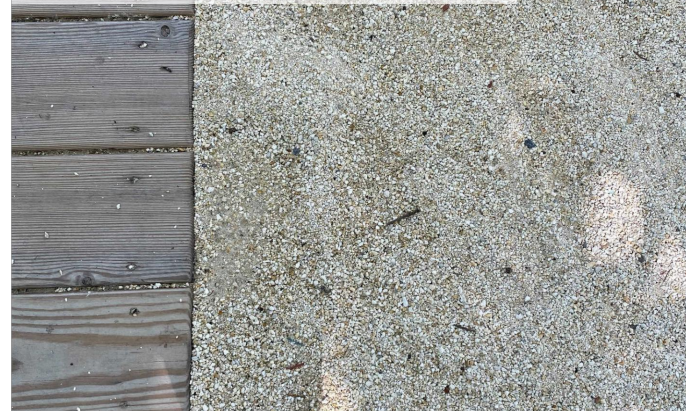

Keystone - Flagstone



Oolite Monoliths- Privacy Walls and Garden Spaces



Crushed Shellstone



Oolite Greenwall - Epiphytes & Ferns



Keystone - French Pattern



| Rev. | Date | Rev. | Date |
|------|------|------|------|
| | | | |
| | | | |
| | | | |
| | | | |
| | | | |
| | | | |
| | | | |
| | | | |
| | | | |
| | | | |

ALL DRAWINGS AND WRITTEN MATERIAL APPEARING HEREIN CONSTITUTE THE ORIGINAL AND UNPUBLISHED WORK OF KOBI KARP AIA, AND MAY NOT BE DUPLICATED, USED, OR DISCLOSED WITHOUT THE EXPRESS WRITTEN CONSENT OF KOBI KARP ARCHITECTURE & INTERIOR DESIGN, INC. AIA 02-2009

Shore Club
1901 Collins Ave.
Miami Beach, FL 33139

Owner: WITKOFF.
Name: 40 West 57th Street, Suite 1620
Address: New York, NY 10019
Address: 212-672-4700
Tel: witkoff@rossettipr.com
Email:

Consultant: RAMSA
Name: Robert A.M. Stern Architects.
Address: One Park Avenue
Address: New York, NY 10016
Tel: 212-967-5100
Email:

Consultant: LANDSCAPE
Name: Island Planning Corporation.
Address: 243 Washington Ave.
Address: Miami Beach, FL 33139
Tel: 305-534-5725
Email: info@islandplanningcorporation.com

Consultant: LANDSCAPE
Name: Greenspace Strategies
Address: 7905 SW 170th Street
Address: Miami, FL 33157
Tel: 561-460-8499
Email: ca@greenspacestrategies.com

Architect of Record:
Kobi Karp Architecture and Interior Design, Inc.
571 NW 28th Street
Miami, Florida 33127 USA
Tel: +1(305) 573 1818
Fax: +1(305) 573 3786



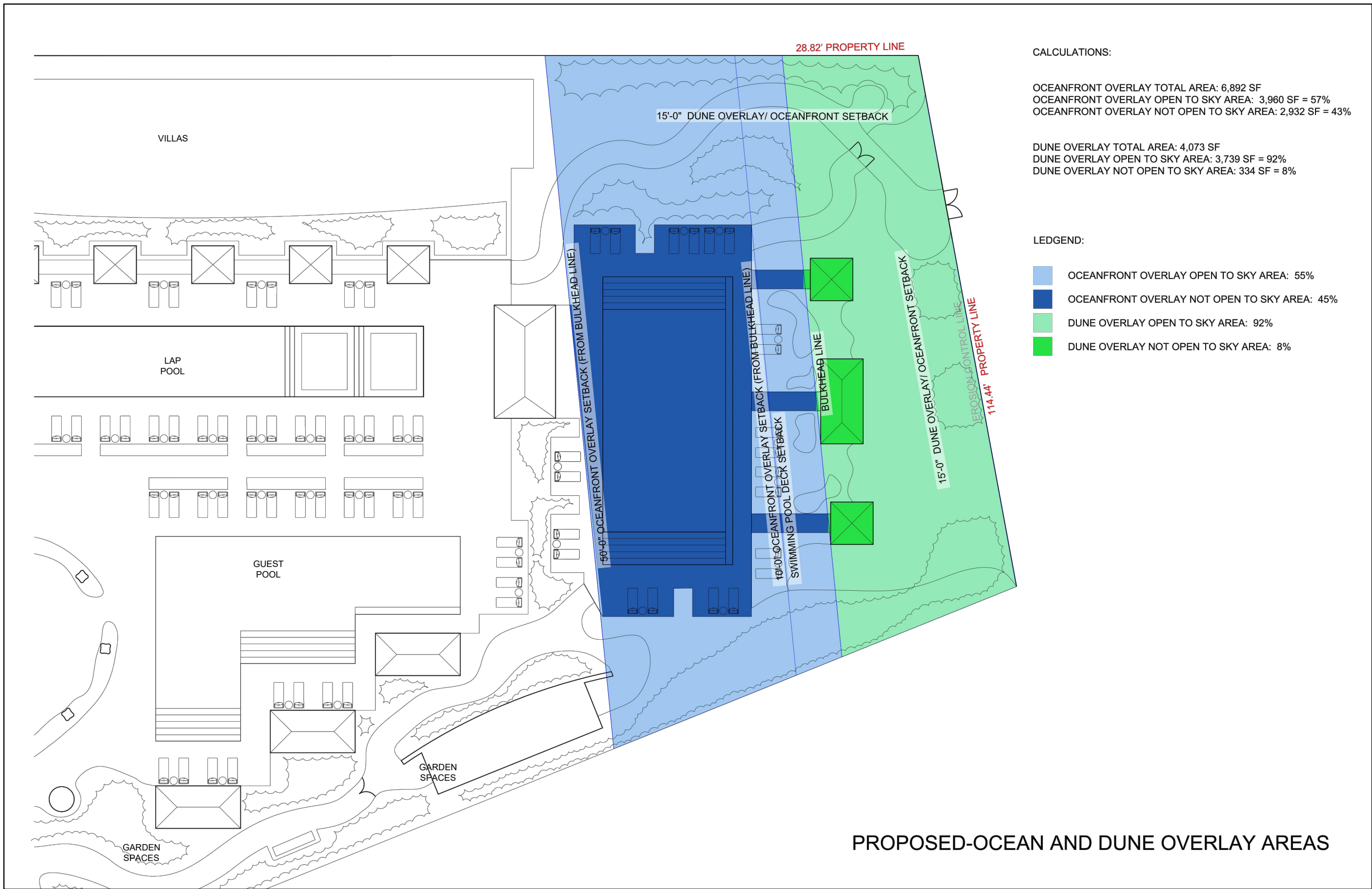

CALCULATIONS:

OCEANFRONT OVERLAY TOTAL AREA: 6,892 SF
 OCEANFRONT OVERLAY OPEN TO SKY AREA: 3,960 SF = 57%
 OCEANFRONT OVERLAY NOT OPEN TO SKY AREA: 2,932 SF = 43%

DUNE OVERLAY TOTAL AREA: 4,073 SF
 DUNE OVERLAY OPEN TO SKY AREA: 3,739 SF = 92%
 DUNE OVERLAY NOT OPEN TO SKY AREA: 334 SF = 8%

LEDGEND:

- OCEANFRONT OVERLAY OPEN TO SKY AREA: 55%
- OCEANFRONT OVERLAY NOT OPEN TO SKY AREA: 45%
- DUNE OVERLAY OPEN TO SKY AREA: 92%
- DUNE OVERLAY NOT OPEN TO SKY AREA: 8%

PROPOSED-OCEAN AND DUNE OVERLAY AREAS

| Rev. | Date | Rev. | Date |
|------|------|------|------|
| | | | |
| | | | |
| | | | |
| | | | |
| | | | |
| | | | |
| | | | |
| | | | |
| | | | |
| | | | |

ALL DRAWINGS AND WRITTEN MATERIAL APPEARING HEREIN CONSTITUTE THE ORIGINAL AND UNPUBLISHED WORK OF KOBİ KARP AIA, AND MAY NOT BE DUPLICATED, USED, OR DISCLOSED WITHOUT THE EXPRESS WRITTEN CONSENT OF KOBİ KARP ARCHITECTURE, & INTERIOR DESIGN, INC. AIA 01-2009.

Shore Club
 1901 Collins Ave.
 Miami Beach, FL 33139

Owner: WITKOFF.
Name: 40 West 57th Street, Suite 1620
Address: New York, NY 10019
Address: 212-672-4700
Tel: 212-672-4700
Email: witkoff@rossettpr.com

Consultant: RAMSA
Name: Robert A.M. Stern Architects.
Address: One Park Avenue
Address: New York, NY 10016
Tel: 212-667-5100
Email: info@ramsa.com

Consultant: LANDSCAPE
Name: Island Planning Corporation.
Address: 243 Washington Ave.
Address: Miami Beach, FL 33139
Tel: 305-534-5725
Email: info@islandplanningcorporation.com

Consultant: LANDSCAPE
Name: Greenspace Strategies
Address: 7905 SW 170th Street
Address: Miami, FL 33157
Tel: 561-460-8499
Email: ca@greenspacestrategies.com

Architect of Record:
 Kobi Karp Architecture and Interior Design, Inc.
 571 NW 28th Street
 Miami, Florida 33127 USA
Tel: +1(305) 573 1818
Fax: +1(305) 573 3766

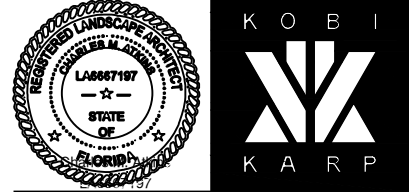

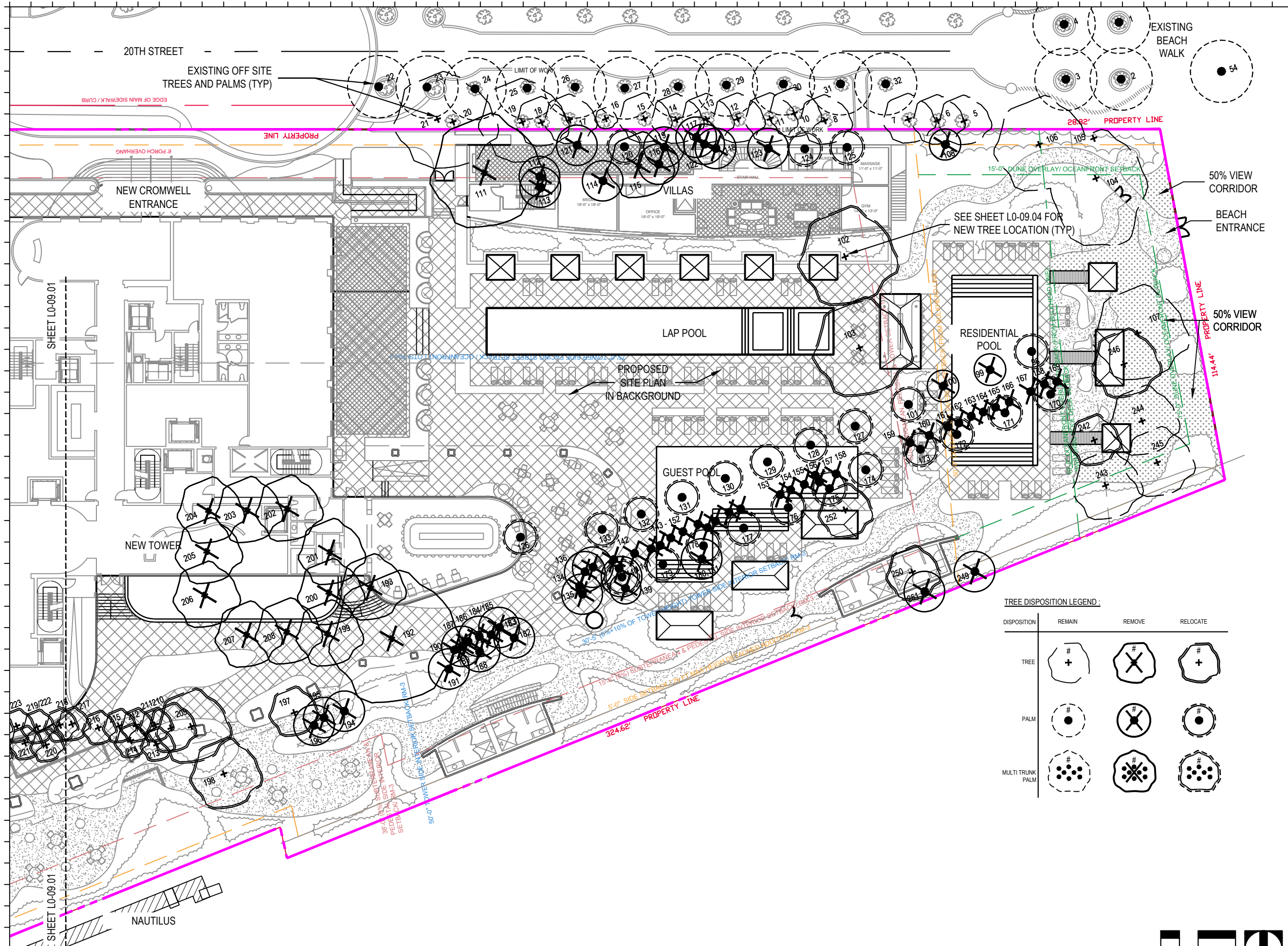

TREE DISPOSITION LEGEND:

| DISPOSITION | REMAIN | REMOVE | RELOCATE |
|------------------|--------|--------|----------|
| TREE | | | |
| PALM | | | |
| MULTI TRUNK PALM | | | |

| Rev. | Date | Rev. | Date |
|------|------|------|------|
| | | | |
| | | | |
| | | | |
| | | | |
| | | | |
| | | | |
| | | | |
| | | | |
| | | | |
| | | | |

Shore Club
 1901 Collins Ave.
 Miami Beach, FL 33139

Owner: WITKOFF.
 Name: 40 West 57th Street, Suite 1620
 Address: New York, NY 10019
 Address: 212-672-4700
 Tel: wtkoff@rossetipr.com
 Email:

Consultant: RAMSA
 Name: Robert A.M. Stern Architects.
 Address: One Park Avenue
 Address: New York, NY 10016
 Tel: 212-667-5100
 Email:

Consultant: LANDSCAPE
 Name: Island Planning Corporation.
 Address: 243 Washington Ave.
 Address: Miami Beach, FL 33139
 Tel: 305-534-5725
 Email: info@islandplanningcorporation.com

Consultant: LANDSCAPE
 Name: Greenspace Strategies
 Address: 7905 SW 17th Street
 Address: Miami, FL 33157
 Tel: 561-460-8499
 Email: ca@greenspacestrategies.com

Architect of Record:
 Name: Kobi Karp Architecture and Interior Design, Inc.
 Address: 571 NW 28th Street
 Address: Miami, Florida 33127 USA
 Tel: +1(305) 573 1818
 Fax: +1(305) 573 3786



TREE DISPOSITION PLAN
 1" = 30'-0"

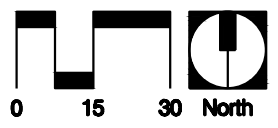

| | | | |
|---------|-------------|-----------|----------|
| Date | 2021-12-06 | Sheet No. | L0-09.00 |
| Scale | See Drawing | | |
| Project | 2104 | | |

TREE DISPOSITION LEGEND:

| DISPOSITION | REMAIN | REMOVE | RELOCATE |
|------------------|--------|--------|----------|
| TREE | | | |
| PALM | | | |
| MULTI TRUNK PALM | | | |

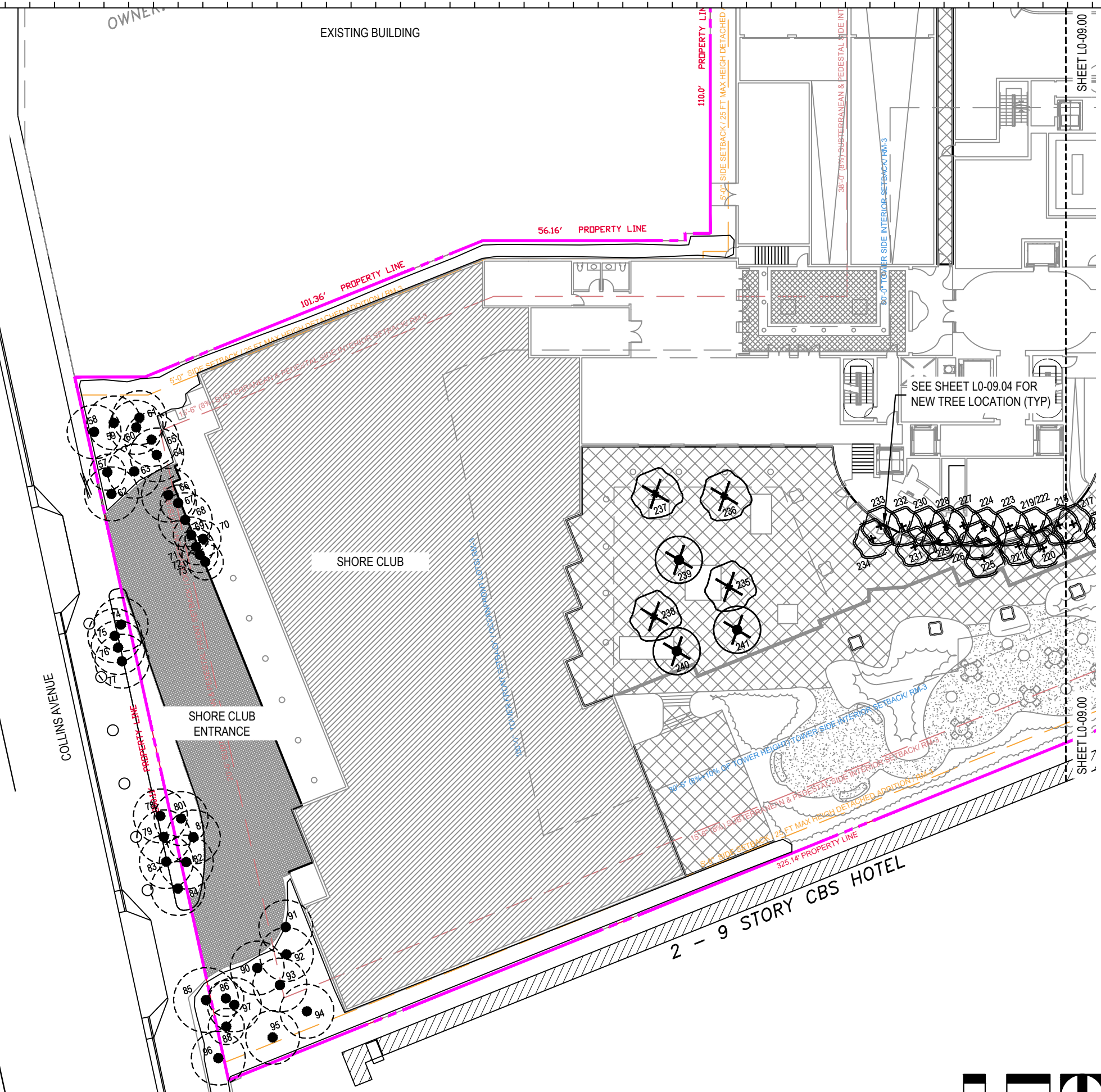

| Rev. | Date | Rev. | Date |
|------|------|------|------|
| | | | |
| | | | |
| | | | |
| | | | |
| | | | |
| | | | |
| | | | |
| | | | |
| | | | |
| | | | |
| | | | |

Shore Club
1901 Collins Ave.
Miami Beach, FL 33139

Owner: WITKOFF.
Name: 40 West 57th Street, Suite 1620
Address: New York, NY 10019
Address: 212-672-4700
Tel: 212-672-4700
Email: witkoff@rossettipr.com

Consultant: RAMSA
Name: Robert A.M. Stern Architects.
Address: One Park Avenue
Address: New York, NY 10016
Tel: 212-667-5100
Email: info@ramsa.com

Consultant: LANDSCAPE
Name: Island Planning Corporation.
Address: 243 Washington Ave.
Address: Miami Beach, FL 33139
Tel: 305-534-5725
Email: info@islandplanningcorporation.com

Consultant: LANDSCAPE
Name: Greenspace Strategies
Address: 7905 SW 17th Street
Address: Miami, FL 33157
Tel: 561-460-8499
Email: ca@greenspacestrategies.com

Architect of Record:
Kobi Karp Architecture and Interior Design, Inc.
571 NW 28th Street
Miami, Florida 33127 USA
Tel: +1(305) 573 1818
Fax: +1(305) 573 3786

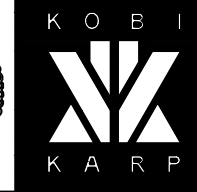

TREE DISPOSITION PLAN
1" = 30'-0"

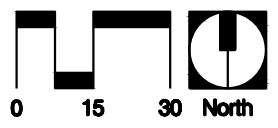

| | | | |
|---------|-------------|-----------|----------|
| Date | 2021-12-06 | Sheet No. | L0-09.01 |
| Scale | See Drawing | | |
| Project | 2104 | | |

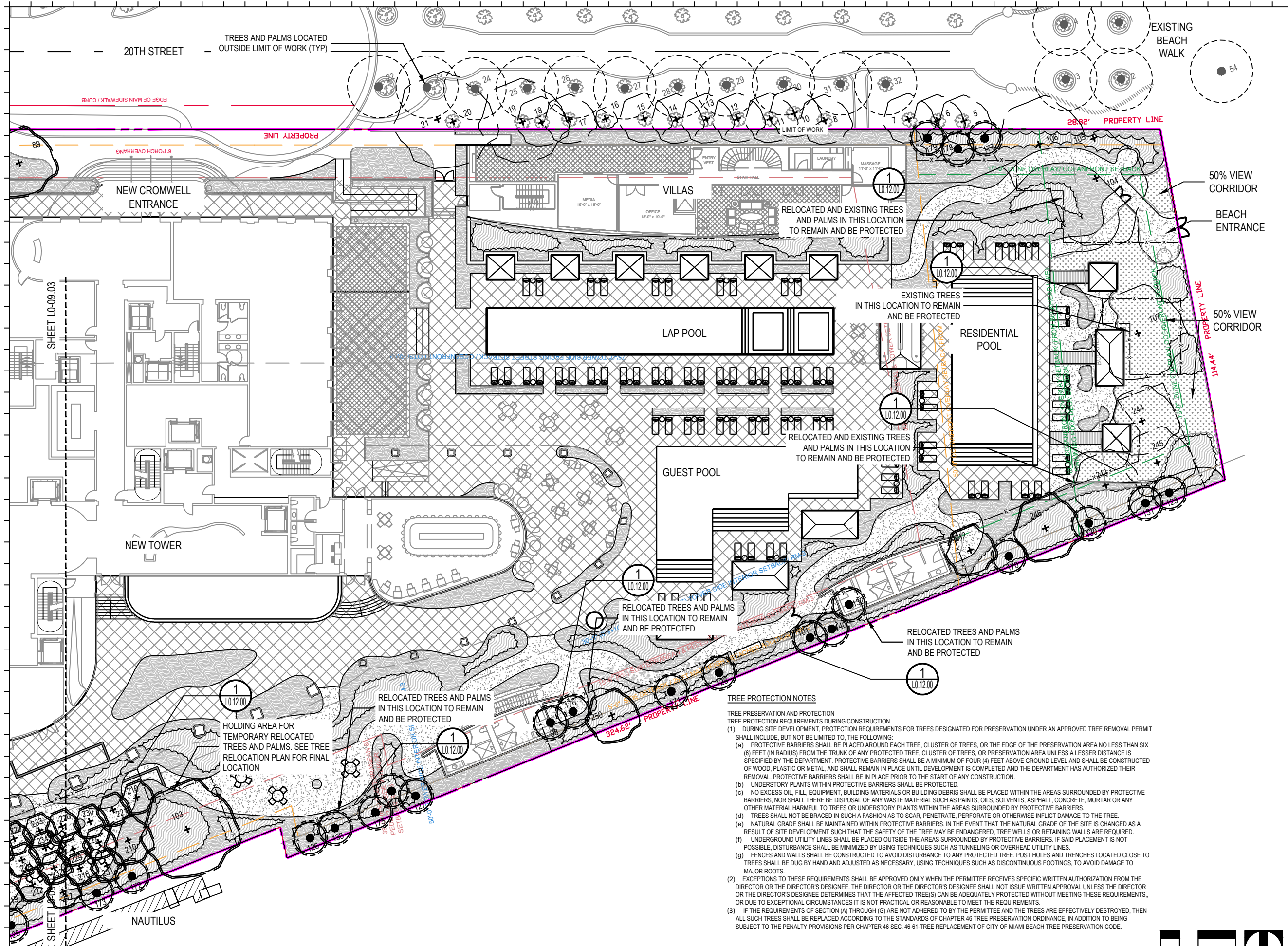

| Rev. | Date | Rev. | Date |
|------|------|------|------|
| | | | |
| | | | |
| | | | |
| | | | |
| | | | |
| | | | |
| | | | |
| | | | |
| | | | |
| | | | |
| | | | |

Shore Club
 1901 Collins Ave.
 Miami Beach, FL 33139

Owner: WITKOFF.
 Name: 40 West 57th Street, Suite 1620
 Address: New York, NY 10019
 Address: 212-672-4700
 Tel: witkoff@rossetipr.com
 Email:

Consultant: RAMSA
 Name: Robert A.M. Stern Architects.
 Address: One Park Avenue
 Address: New York, NY 10016
 Tel: 212-667-5100
 Email:

Consultant: LANDSCAPE
 Name: Island Planning Corporation.
 Address: 243 Washington Ave.
 Address: Miami Beach, FL 33139
 Tel: 305-534-5725
 Email: info@islandplanningcorporation.com

Consultant: LANDSCAPE
 Name: Greenspace Strategies
 Address: 7905 SW 170th Street
 Address: Miami, FL 33157
 Tel: 561-460-8499
 Email: ca@greenspacestrategies.com

Architect of Record:
 Kobi Karp Architecture and Interior Design, Inc.
 Address: 571 NW 28th Street
 Address: Miami, Florida 33127 USA
 Tel: +1(305) 573 1818
 Fax: +1(305) 573 3786

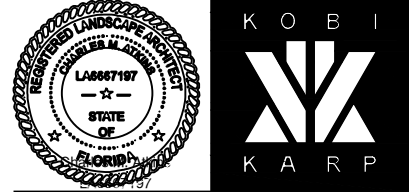

TREE PROTECTION NOTES

TREE PRESERVATION AND PROTECTION
 TREE PROTECTION REQUIREMENTS DURING CONSTRUCTION

(1) DURING SITE DEVELOPMENT, PROTECTION REQUIREMENTS FOR TREES DESIGNATED FOR PRESERVATION UNDER AN APPROVED TREE REMOVAL PERMIT SHALL INCLUDE, BUT NOT BE LIMITED TO, THE FOLLOWING:

(a) PROTECTIVE BARRIERS SHALL BE PLACED AROUND EACH TREE, CLUSTER OF TREES, OR THE EDGE OF THE PRESERVATION AREA NO LESS THAN SIX (6) FEET (IN RADIUS) FROM THE TRUNK OF ANY PROTECTED TREE, CLUSTER OF TREES, OR PRESERVATION AREA UNLESS A LESSER DISTANCE IS SPECIFIED BY THE DEPARTMENT. PROTECTIVE BARRIERS SHALL BE A MINIMUM OF FOUR (4) FEET ABOVE GROUND LEVEL AND SHALL BE CONSTRUCTED OF WOOD, PLASTIC OR METAL, AND SHALL REMAIN IN PLACE UNTIL DEVELOPMENT IS COMPLETED AND THE DEPARTMENT HAS AUTHORIZED THEIR REMOVAL. PROTECTIVE BARRIERS SHALL BE IN PLACE PRIOR TO THE START OF ANY CONSTRUCTION.

(b) UNDERSTORY PLANTS WITHIN PROTECTIVE BARRIERS SHALL BE PROTECTED.

(c) NO EXCESS OIL, FILL, EQUIPMENT, BUILDING MATERIALS OR BUILDING DEBRIS SHALL BE PLACED WITHIN THE AREAS SURROUNDED BY PROTECTIVE BARRIERS, NOR SHALL THERE BE DISPOSAL OF ANY WASTE MATERIAL SUCH AS PAINTS, OILS, SOLVENTS, ASPHALT, CONCRETE, MORTAR OR ANY OTHER MATERIAL HARMFUL TO TREES OR UNDERSTORY PLANTS WITHIN THE AREAS SURROUNDED BY PROTECTIVE BARRIERS.

(d) TREES SHALL NOT BE BRACED IN SUCH A FASHION AS TO SCAR, PENETRATE, PERFORATE OR OTHERWISE INFLECT DAMAGE TO THE TREE.

(e) NATURAL GRADE SHALL BE MAINTAINED WITHIN PROTECTIVE BARRIERS. IN THE EVENT THAT THE NATURAL GRADE OF THE SITE IS CHANGED AS A RESULT OF SITE DEVELOPMENT SUCH THAT THE SAFETY OF THE TREE MAY BE ENDANGERED, TREE WELLS OR RETAINING WALLS ARE REQUIRED.

(f) UNDERGROUND UTILITY LINES SHALL BE PLACED OUTSIDE THE AREAS SURROUNDED BY PROTECTIVE BARRIERS. IF SAID PLACEMENT IS NOT POSSIBLE, DISTURBANCE SHALL BE MINIMIZED BY USING TECHNIQUES SUCH AS TUNNELING OR OVERHEAD UTILITY LINES.

(g) FENCES AND WALLS SHALL BE CONSTRUCTED TO AVOID DISTURBANCE TO ANY PROTECTED TREE. POST HOLES AND TRENCHES LOCATED CLOSE TO TREES SHALL BE DUG BY HAND AND ADJUSTED AS NECESSARY, USING TECHNIQUES SUCH AS DISCONTINUOUS FOOTINGS, TO AVOID DAMAGE TO MAJOR ROOTS.

(2) EXCEPTIONS TO THESE REQUIREMENTS SHALL BE APPROVED ONLY WHEN THE PERMITTEE RECEIVES SPECIFIC WRITTEN AUTHORIZATION FROM THE DIRECTOR OR THE DIRECTOR'S DESIGNEE. THE DIRECTOR OR THE DIRECTOR'S DESIGNEE SHALL NOT ISSUE WRITTEN APPROVAL UNLESS THE DIRECTOR OR THE DIRECTOR'S DESIGNEE DETERMINES THAT THE AFFECTED TREE(S) CAN BE ADEQUATELY PROTECTED WITHOUT MEETING THESE REQUIREMENTS, OR DUE TO EXCEPTIONAL CIRCUMSTANCES IT IS NOT PRACTICAL OR REASONABLE TO MEET THE REQUIREMENTS.

(3) IF THE REQUIREMENTS OF SECTION (A) THROUGH (G) ARE NOT ADHERED TO BY THE PERMITTEE AND THE TREES ARE EFFECTIVELY DESTROYED, THEN ALL SUCH TREES SHALL BE REPLACED ACCORDING TO THE STANDARDS OF CHAPTER 46 TREE PRESERVATION ORDINANCE, IN ADDITION TO BEING SUBJECT TO THE PENALTY PROVISIONS PER CHAPTER 46 SEC. 46-61-TREE REPLACEMENT OF CITY OF MIAMI BEACH TREE PRESERVATION CODE.

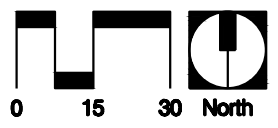

EXISTING TREE MANAGEMENT PLAN
 1" = 30'-0"

| | | | |
|---------|-------------|-----------|----------|
| Date | 2021-12-06 | Sheet No. | L0-09.02 |
| Scale | See Drawing | | |
| Project | 2104 | | |

TREE PROTECTION NOTES

- TREE PRESERVATION AND PROTECTION
 TREE PROTECTION REQUIREMENTS DURING CONSTRUCTION
- (1) DURING SITE DEVELOPMENT, PROTECTION REQUIREMENTS FOR TREES DESIGNATED FOR PRESERVATION UNDER AN APPROVED TREE REMOVAL PERMIT SHALL INCLUDE, BUT NOT BE LIMITED TO, THE FOLLOWING:
 - (a) PROTECTIVE BARRIERS SHALL BE PLACED AROUND EACH TREE, CLUSTER OF TREES, OR THE EDGE OF THE PRESERVATION AREA NO LESS THAN SIX (6) FEET (IN RADIUS) FROM THE TRUNK OF ANY PROTECTED TREE, CLUSTER OF TREES, OR PRESERVATION AREA UNLESS A LESSER DISTANCE IS SPECIFIED BY THE DEPARTMENT. PROTECTIVE BARRIERS SHALL BE A MINIMUM OF FOUR (4) FEET ABOVE GROUND LEVEL AND SHALL BE CONSTRUCTED OF WOOD, PLASTIC OR METAL, AND SHALL REMAIN IN PLACE UNTIL DEVELOPMENT IS COMPLETED AND THE DEPARTMENT HAS AUTHORIZED THEIR REMOVAL. PROTECTIVE BARRIERS SHALL BE IN PLACE PRIOR TO THE START OF ANY CONSTRUCTION.
 - (b) UNDERSTORY PLANTS WITHIN PROTECTIVE BARRIERS SHALL BE PROTECTED.
 - (c) NO EXCESS OIL, FILL, EQUIPMENT, BUILDING MATERIALS OR BUILDING DEBRIS SHALL BE PLACED WITHIN THE AREAS SURROUNDED BY PROTECTIVE BARRIERS, NOR SHALL THERE BE DISPOSAL OF ANY WASTE MATERIAL SUCH AS PAINTS, OILS, SOLVENTS, ASPHALT, CONCRETE, MORTAR OR ANY OTHER MATERIAL HARMFUL TO TREES OR UNDERSTORY PLANTS WITHIN THE AREAS SURROUNDED BY PROTECTIVE BARRIERS.
 - (d) TREES SHALL NOT BE BRACED IN SUCH A FASHION AS TO SCAR, PENETRATE, PERFORATE OR OTHERWISE INFLECT DAMAGE TO THE TREE.
 - (e) NATURAL GRADE SHALL BE MAINTAINED WITHIN PROTECTIVE BARRIERS. IN THE EVENT THAT THE NATURAL GRADE OF THE SITE IS CHANGED AS A RESULT OF SITE DEVELOPMENT SUCH THAT THE SAFETY OF THE TREE MAY BE ENDANGERED, TREE WELLS OR RETAINING WALLS ARE REQUIRED.
 - (f) UNDERGROUND UTILITY LINES SHALL BE PLACED OUTSIDE THE AREAS SURROUNDED BY PROTECTIVE BARRIERS. IF SAID PLACEMENT IS NOT POSSIBLE, DISTURBANCE SHALL BE MINIMIZED BY USING TECHNIQUES SUCH AS TUNNELING OR OVERHEAD UTILITY LINES.
 - (g) FENCES AND WALLS SHALL BE CONSTRUCTED TO AVOID DISTURBANCE TO ANY PROTECTED TREE. POST HOLES AND TRENCHES LOCATED CLOSE TO TREES SHALL BE DUG BY HAND AND ADJUSTED AS NECESSARY, USING TECHNIQUES SUCH AS DISCONTINUOUS FOOTINGS, TO AVOID DAMAGE TO MAJOR ROOTS.
 - (2) EXCEPTIONS TO THESE REQUIREMENTS SHALL BE APPROVED ONLY WHEN THE PERMITTEE RECEIVES SPECIFIC WRITTEN AUTHORIZATION FROM THE DIRECTOR OR THE DIRECTOR'S DESIGNEE. THE DIRECTOR OR THE DIRECTOR'S DESIGNEE SHALL NOT ISSUE WRITTEN APPROVAL UNLESS THE DIRECTOR OR THE DIRECTOR'S DESIGNEE DETERMINES THAT THE AFFECTED TREE(S) CAN BE ADEQUATELY PROTECTED WITHOUT MEETING THESE REQUIREMENTS, OR DUE TO EXCEPTIONAL CIRCUMSTANCES IT IS NOT PRACTICAL OR REASONABLE TO MEET THE REQUIREMENTS.
 - (3) IF THE REQUIREMENTS OF SECTION (A) THROUGH (G) ARE NOT ADHERED TO BY THE PERMITTEE AND THE TREES ARE EFFECTIVELY DESTROYED, THEN ALL SUCH TREES SHALL BE REPLACED ACCORDING TO THE STANDARDS OF CHAPTER 46 TREE PRESERVATION ORDINANCE, IN ADDITION TO BEING SUBJECT TO THE PENALTY PROVISIONS PER CHAPTER 46 SEC. 46-61-TREE REPLACEMENT OF CITY OF MIAMI BEACH TREE PRESERVATION CODE.

EXISTING BUILDING

56.16' PROPERTY LINE

101.36' PROPERTY LINE

1100' PROPERTY LN

SHEET LO-09.02

EXISTING TREES IN THIS LOCATION TO REMAIN AND BE PROTECTED

1 LO.12.00

SHORE CLUB

HOLDING AREA FOR TEMPORARY RELOCATED TREES AND PALMS. SEE TREE RELOCATION PLAN FOR FINAL LOCATION

1 LO.12.00

SHORE CLUB ENTRANCE

COLLINS AVENUE

EXISTING TREES IN THIS LOCATION TO REMAIN AND BE PROTECTED

1 LO.12.00

2 - 9 STORY CBS HOTEL

EXISTING TREE MANAGEMENT PLAN
 1" = 30'-0"

| Rev. | Date | Rev. | Date |
|------|------|------|------|
| | | | |
| | | | |
| | | | |
| | | | |
| | | | |
| | | | |
| | | | |
| | | | |
| | | | |
| | | | |

Shore Club
 1901 Collins Ave.
 Miami Beach, FL 33139

- Owner:** WITKOFF.
 Name: 40 West 57th Street, Suite 1620
 Address: New York, NY 10019
 Address: 212-672-4700
 Tel: 212-672-4700
 Email: witkoff@rossettjpr.com
- Consultant:** RAMSA
 Name: Robert A.M. Stern Architects.
 Address: One Park Avenue
 Address: New York, NY 10016
 Tel: 212-667-5100
 Email: 212-667-5100
- Consultant:** LANDSCAPE
 Name: Island Planning Corporation.
 Address: 243 Washington Ave.
 Address: Miami Beach, FL 33139
 Tel: 305-534-5725
 Email: info@islandplanningcorporation.com
- Consultant:** LANDSCAPE
 Name: Greenspace Strategies
 Address: 7905 SW 170th Street
 Address: Miami, FL 33157
 Tel: 561-460-8499
 Email: ca@greenspacestrategies.com

Architect of Record:
 Kobi Karp Architecture and Interior Design, Inc.
 571 NW 28th Street
 Miami, Florida 33127 USA
 Tel: +1(305) 573 1818
 Fax: +1(305) 573 3786

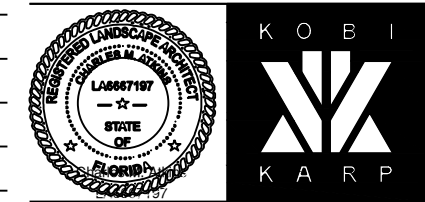

| | | | |
|---------|-------------|-----------|----------|
| Date | 2021-12-06 | Sheet No. | L0-09.03 |
| Scale | See Drawing | | |
| Project | 2104 | | |

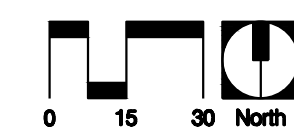

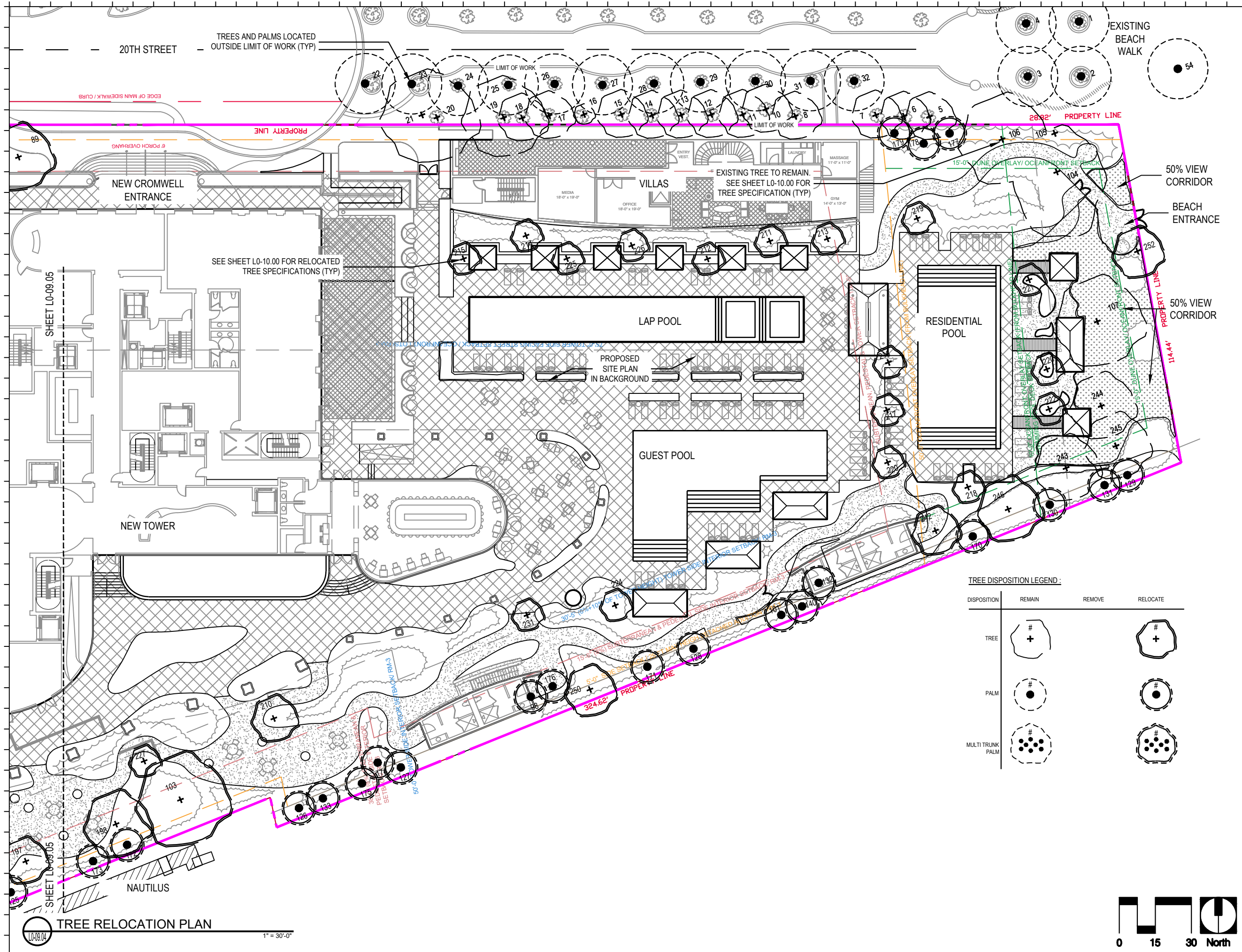

20TH STREET
TREES AND PALMS LOCATED OUTSIDE LIMIT OF WORK (TYP)

EXISTING BEACH WALK

NEW CROMWELL ENTRANCE

VILLAS

LAP POOL

RESIDENTIAL POOL

GUEST POOL

NEW TOWER

SEE SHEET L0-10.00 FOR RELOCATED TREE SPECIFICATIONS (TYP)

EXISTING TREE TO REMAIN. SEE SHEET L0-10.00 FOR TREE SPECIFICATION (TYP)

50% VIEW CORRIDOR

BEACH ENTRANCE

50% VIEW CORRIDOR

TREE DISPOSITION LEGEND:

| DISPOSITION | REMAIN | REMOVE | RELOCATE |
|------------------|----------|--------|----------|
| TREE | # + | | # + |
| PALM | # ● | | # ● |
| MULTI TRUNK PALM | # ●●● | | # ●●● |

| Rev. | Date | Rev. | Date |
|------|------|------|------|
| | | | |
| | | | |
| | | | |
| | | | |
| | | | |
| | | | |
| | | | |
| | | | |
| | | | |
| | | | |
| | | | |

Shore Club
1901 Collins Ave.
Miami Beach, FL 33139

Owner: WITKOFF.
Name: 40 West 57th Street, Suite 1620
Address: New York, NY 10019
Address: 212-672-4700
Tel: 212-672-4700
Email: witkoff@rossetipr.com

Consultant: RAMSA
Name: Robert A.M. Stern Architects.
Address: One Park Avenue
Address: New York, NY 10016
Tel: 212-667-5100
Email: 212-667-5100

Consultant: LANDSCAPE
Name: Island Planning Corporation.
Address: 243 Washington Ave.
Address: Miami Beach, FL 33139
Tel: 305-534-5725
Email: info@islandplanningcorporation.com

Consultant: LANDSCAPE
Name: Greenspace Strategies
Address: 7905 SW 17th Street
Address: Miami, FL 33157
Tel: 561-460-8499
Email: ca@greenspacestrategies.com

Architect of Record:
Kobi Karp Architecture and Interior Design, Inc.
571 NW 28th Street
Miami, Florida 33127 USA
Tel: +1(305) 573 1818
Fax: +1(305) 573 3786

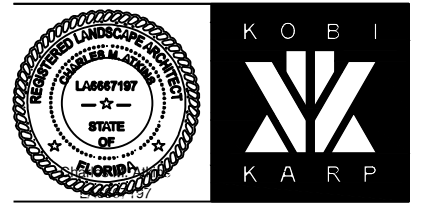

TREE RELOCATION PLAN
1" = 30'-0"

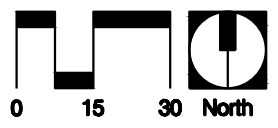

| | | | |
|---------|-------------|-----------|----------|
| Date | 2021-12-06 | Sheet No. | L0-09.04 |
| Scale | See Drawing | | |
| Project | 2104 | | |

TREE DISPOSITION LEGEND :

| DISPOSITION | REMAIN | REMOVE | RELOCATE |
|------------------|--------|--------|----------|
| TREE | | | |
| PALM | | | |
| MULTI TRUNK PALM | | | |

EXISTING TREE TO REMAIN.
SEE SHEET L0-10.00 FOR
TREE SPECIFICATION (TYP)

EXISTING BUILDING

COLLINS AVENUE

SHORE CLUB
ENTRANCE

SHORE CLUB

SEE SHEET L0-10.00 FOR RELOCATED
TREE SPECIFICATIONS (TYP)

2 - 9 STORY CBS HOTEL

56.16' PROPERTY LINE

101.36' PROPERTY LINE

110.0' PROPERTY LINE

PROPOSED
SITE PLAN
IN BACKGROUND

SHOOT L0-09.04

SHOOT L0-09.04

| Rev. | Date | Rev. | Date |
|------|------|------|------|
| | | | |
| | | | |
| | | | |
| | | | |
| | | | |
| | | | |
| | | | |
| | | | |
| | | | |

Shore Club
1901 Collins Ave.
Miami Beach, FL 33139

Owner: WITKOFF.
Name: 40 West 57th Street, Suite 1620
Address: New York, NY 10019
Address: 212-672-4700
Tel: 212-672-4700
Email: witkoff@rossettipr.com

Consultant: RAMSA
Name: Robert A.M. Stern Architects.
Address: One Park Avenue
Address: New York, NY 10016
Tel: 212-667-5100
Email: 212-667-5100

Consultant: LANDSCAPE
Name: Island Planning Corporation.
Address: 243 Washington Ave.
Address: Miami Beach, FL 33139
Tel: 305-534-5725
Email: info@islandplanningcorporation.com

Consultant: LANDSCAPE
Name: Greenspace Strategies
Address: 7905 SW 17th Street
Address: Miami, FL 33157
Tel: 561-460-8499
Email: ca@greenspacestrategies.com

Architect of Record:
Kobi Karp Architecture and Interior Design, Inc.
571 NW 28th Street
Miami, Florida 33127 USA
Tel: +1(305) 573 1818
Fax: +1(305) 573 3786

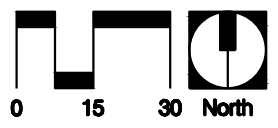
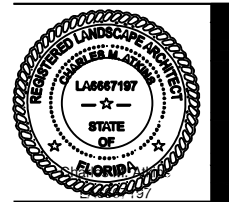

TREE RELOCATION PLAN
1" = 30'-0"

| | | | |
|---------|-------------|-----------|----------|
| Date | 2021-12-06 | Sheet No. | L0-09.05 |
| Scale | See Drawing | | |
| Project | 2104 | | |

CITY OF MIAMI BEACH TREE REPLACEMENT CHART

| Total Diameter of Tree(s) to be Removed (DBH Total Amount of Inches) | Total Number of Replacement Tree(s) (Minimum 2" DBH & 12' HT.) | Total Number of Replacement Tree(s) (Minimum 4" DBH & 16' HT.) | Contribution to Tree Trust Fund |
|---|---|---|------------------------------------|
| 2"-3" | 1 | 0 | \$1,000.00 |
| 4"-6" | 2 | 1 | \$2,000.00 |
| 7"-12" | 4 | 2 | \$4,000.00 |
| 13"-18" | 6 | 3 | \$6,000.00 |
| 19"-24" | 8 | 4 | \$8,000.00 |
| 25"-30" | 10 | 5 | \$10,000.00 |
| 31"-36" | 12 | 6 | \$12,000.00 |
| 37"-42" | 14 | 7 | \$14,000.00 |
| 43"-48" | 16 | 8 | \$16,000.00 |
| 49"-60" | 20 | 10 | \$20,000.00 |

SPECIES DIVERSITY CHART

| Required Number of Trees | Required Number of Tree Species |
|--------------------------|---------------------------------|
| 11-20 | 2 |
| 21-50 | 4 |
| 51 or Greater | 6 |

Total Inches Required to Replace = 202 See Tree Replacement Calculations

Total Required Species = 6

TREE REPLACEMENT CALCULATIONS

| | | | |
|---|------------|----|--------------|
| Total Tree Inches Removed = | 202 | | |
| Total Palms Removed = | 4 | | |
| Total No. of Replacement Trees Required (2" DBH; 12' ht. Min.) = | 68 (trees) | or | 136 (inches) |
| OR | | | |
| Total No. of Replacement Trees Required (4" DBH; 16' ht. Min.) = | 33 (trees) | or | 132 (inches) |
| PLUS | | | |
| One Replacement Tree (2" DBH; 12' ht. Min.) Per One Palm Removed = | 4 (trees) | or | 6 (inches) |
| Total 2" TreesTree REQUIRED = | 72 | | |
| Total Replacement Trees Provided up to 30% @ (1.5" DBH; 10' ht. Min.) = | 22 (trees) | or | 30 (inches) |
| Total Replacement Trees Provided @ (2" DBH; 12' ht. Min.) = | 50 (trees) | or | 92 (inches) |
| Total Replacement Trees Provided @ (4" DBH; 16' ht. Min.) = | 0 (trees) | or | 0 (inches) |
| Total Trees PROVIDED = | 72 (trees) | or | 122 (inches) |
| Total Replacement Trees Required @ 4" DBH; 16' ht.; Min.) = | 0 | | |

| Rev. | Date | Rev. | Date |
|------|------|------|------|
| | | | |
| | | | |
| | | | |
| | | | |
| | | | |
| | | | |
| | | | |
| | | | |
| | | | |
| | | | |

ALL DRAWINGS AND WRITTEN MATERIAL APPEARING HEREIN CONSTITUTE THE ORIGINAL AND UNPUBLISHED WORK OF KOB KARP AIA, AND MAY NOT BE DUPLICATED, USED, OR DISCLOSED WITHOUT THE EXPRESS WRITTEN CONSENT OF KOB KARP ARCHITECTURE & INTERIOR DESIGN, INC. AIA 01-2009

Shore Club
1901 Collins Ave.
Miami Beach, FL 33139

Owner: WITKOFF.
Name: 40 West 57th Street, Suite 1620
Address: New York, NY 10019
Address: 212-672-4700
Tel: witkoff@rossettijpr.com
Email:

Consultant: RAMSA
Name: Robert A.M. Stern Architects.
Address: One Park Avenue
Address: New York, NY 10016
Tel: 212-667-5100
Email:

Consultant: LANDSCAPE
Name: Island Planning Corporation.
Address: 248 Washington Ave.
Address: Miami Beach, FL 33139
Tel: 305-534-5725
Email: info@islandplanningcorporation.com

Consultant: LANDSCAPE
Name: Greenspace Strategies
Address: 7905 SW 170th Street
Address: Miami, FL 33157
Tel: 561-460-8499
Email: ca@greenspacestrategies.com

Architect of Record:
Kobi Karp Architecture and Interior Design, Inc.
571 NW 28th Street
Miami, Florida 33127 USA
Tel: +1(305) 573 1818
Fax: +1(305) 573 3786



NOTE:

1. THE TREE PROTECTION BARRICADE SHALL BE AT LEAST FOUR (4) FEET HIGH. THE BARRIER SHALL BE 6" X 6" X 6" WIRE MESH. WOOD POST SHALL BE INSTALLED AT 8' O.C. THE BARRICADE SHALL BE AT LEAST ONE FOOT IN DIAMETER FOR EACH INCH OF TRUNK DIAMETER. LOCATE FENCING AT THE EDGE OF THE CRZ, OR AGAINST PAVEMENT EDGES AS PER DISPOSITION PLAN.
2. TREES LESS THAN 10" DBH, THE MINIMUM BARRICADE SHALL BE PLACED AT LEAST SIX (6) FEET AWAY FROM THE BASE OF THE TREE.
3. HAND WORK ONLY WITHIN TREE BARRICADES
4. TREE BARRICADE APPROVAL: OBTAIN CITY / COUNTY APPROVAL OF TREE BARRICADES BEFORE BEGINNING CLEARING OPERATIONS OR ANY SITE DEVELOPMENT.

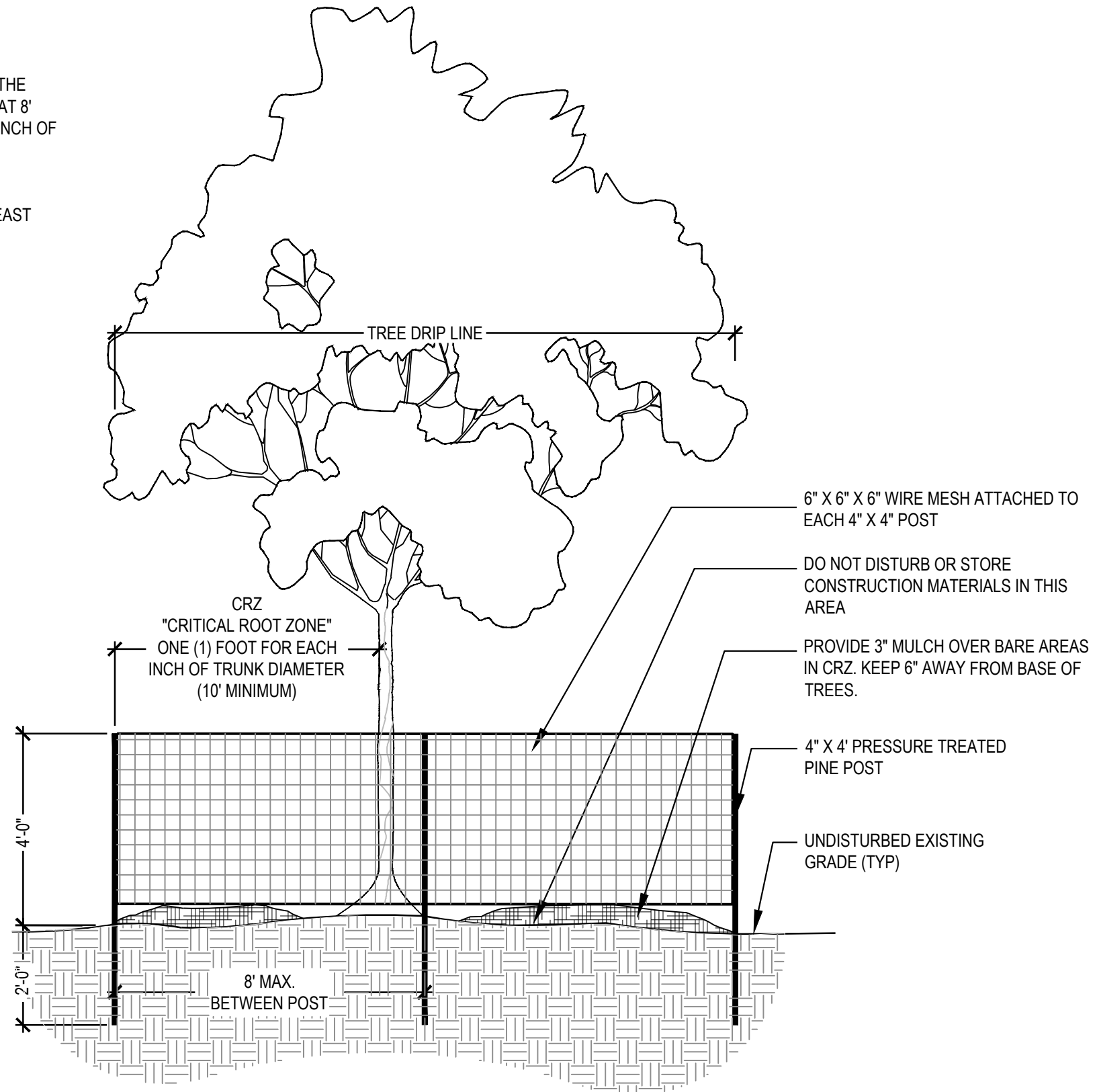

| Rev. | Date | Rev. | Date |
|------|------|------|------|
| | | | |
| | | | |
| | | | |
| | | | |
| | | | |
| | | | |
| | | | |
| | | | |
| | | | |
| | | | |

ALL DRAWINGS AND WRITTEN MATERIAL APPEARING HEREIN CONSTITUTE THE ORIGINAL AND UNPUBLISHED WORK OF KOBI KARP AIA, AND MAY NOT BE DUPLICATED, USED, OR DISCLOSED WITHOUT THE EXPRESS WRITTEN CONSENT OF KOBI KARP ARCHITECTURE & INTERIOR DESIGN, INC. AIA 10-2020

Shore Club
1901 Collins Ave.
Miami Beach, FL 33139

Owner: WITKOFF.
Name: 40 West 57th Street, Suite 1620
Address: New York, NY 10019
Address: 212-672-4700
Tel: 212-672-4700
Email: witkoff@rossettjpr.com

Consultant: RAMSA
Name: Robert A.M. Stern Architects.
Address: One Park Avenue
Address: New York, NY 10016
Tel: 212-667-5100
Email: 212-667-5100

Consultant: LANDSCAPE
Name: Island Planning Corporation.
Address: 243 Washington Ave.
Address: Miami Beach, FL 33139
Tel: 305-534-5725
Email: info@islandplanningcorporation.com

Consultant: LANDSCAPE
Name: Greenspace Strategies
Address: 7905 SW 17th Street
Address: Miami, FL 33157
Tel: 561-460-8499
Email: ca@greenspacestrategies.com

Architect of Record:
Kobi Karp Architecture and Interior Design, Inc.
571 NW 28th Street
Miami, Florida 33127 USA
Tel: +1(305) 573 1818
Fax: +1(305) 573 3786

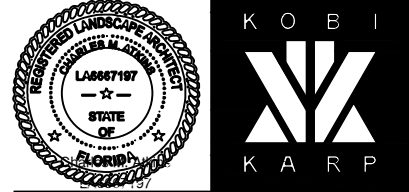

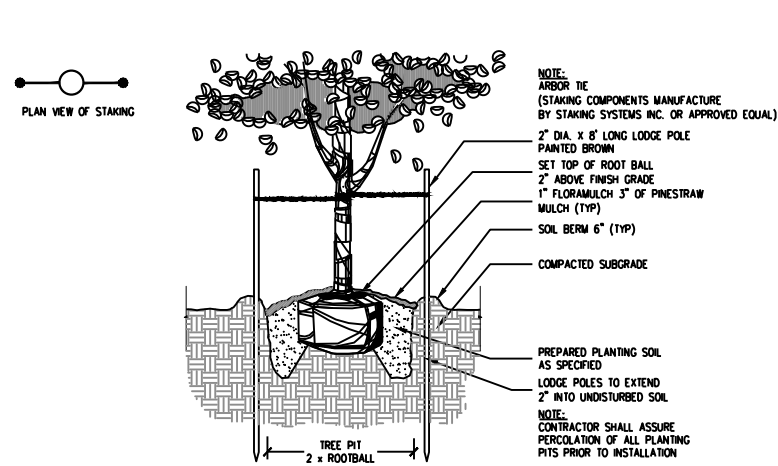

1 TREE PLANTING DETAIL (15-30 GAL.)
SECTION/ELEVATION SCALE: N.T.S.

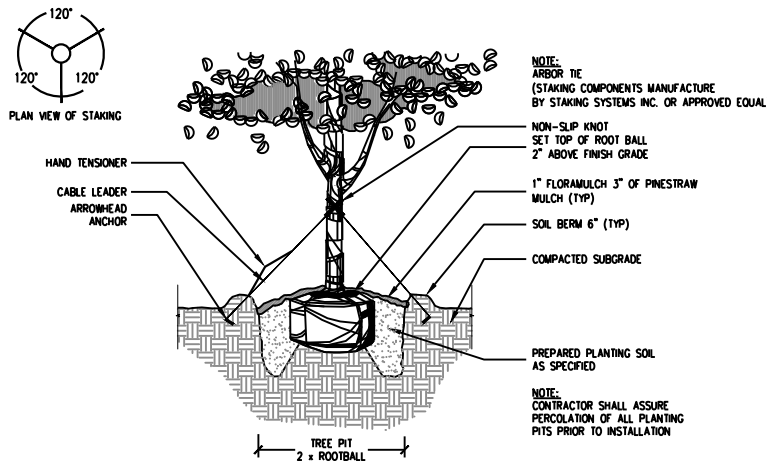

2 TREE PLANTING DETAIL (65-100 GAL.)
SECTION/ELEVATION SCALE: N.T.S.

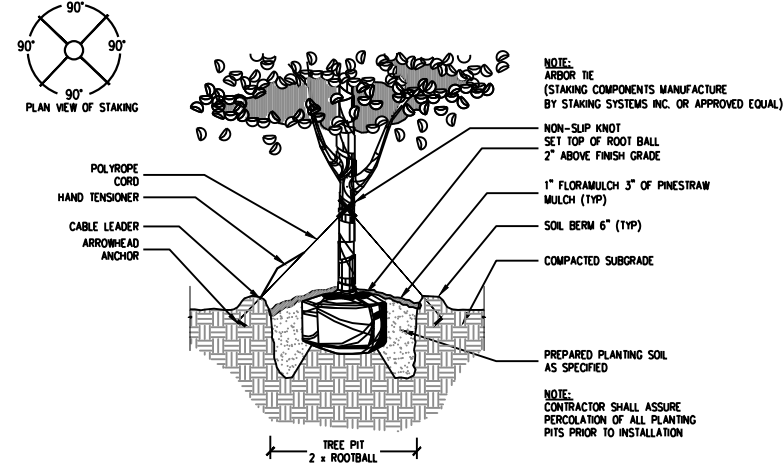

3 TREE PLANTING DETAIL (200 GAL. OR LARGER)
SECTION/ELEVATION SCALE: N.T.S.

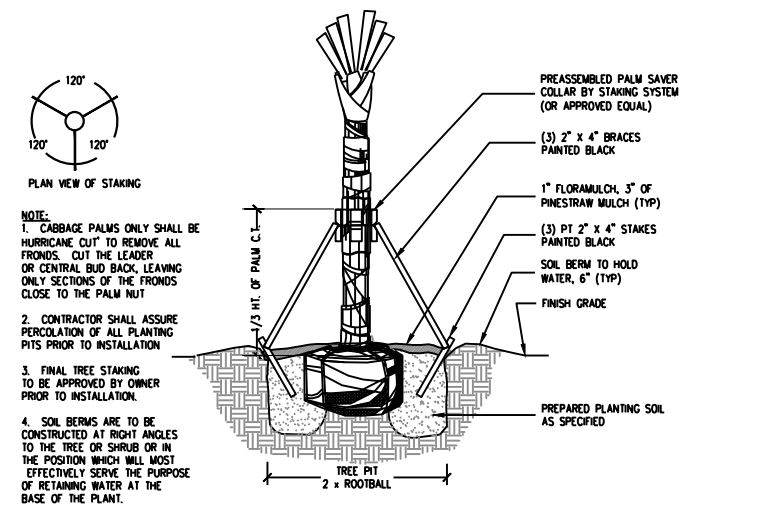

4 PALM PLANTING DETAIL
SECTION/ELEVATION SCALE: N.T.S.

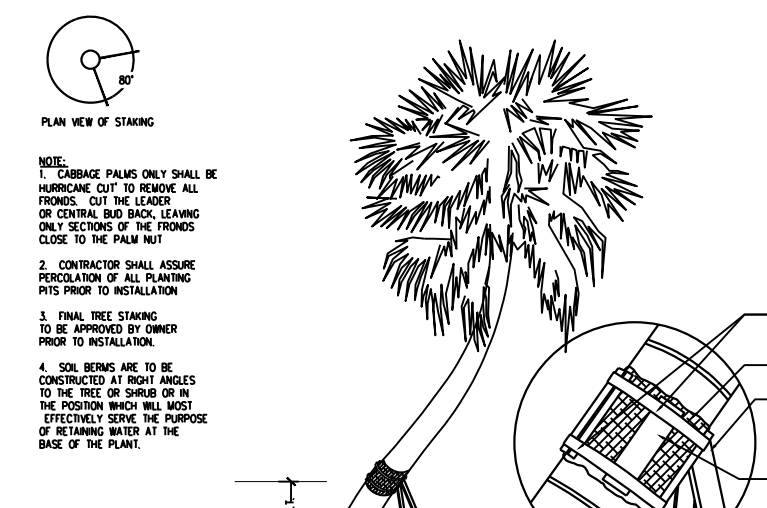

5 CURVED PALM PLANTING DETAIL
SECTION/ELEVATION SCALE: N.T.S.

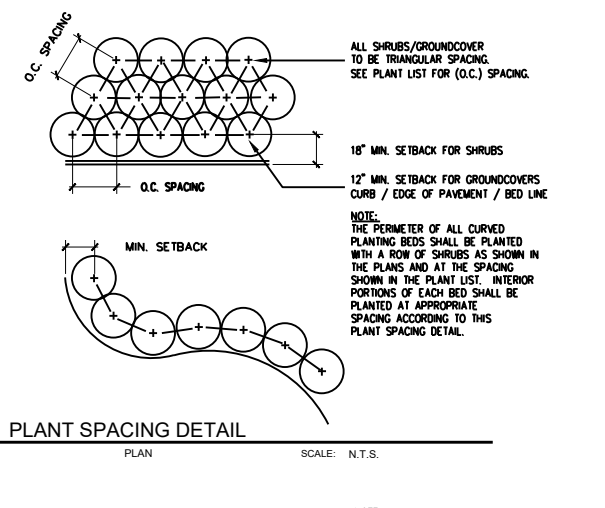

6 PLANT SPACING DETAIL
PLAN SCALE: N.T.S.

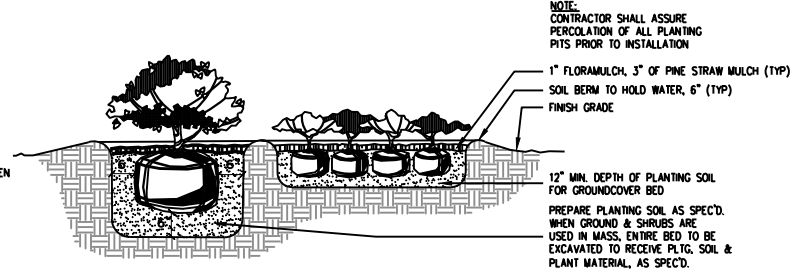

7 SHRUB AND GROUNDCOVER PLANTING DETAIL
SECTION/ELEVATION SCALE: N.T.S.

| Rev. | Date | Rev. | Date |
|------|------|------|------|
| | | | |
| | | | |
| | | | |
| | | | |
| | | | |
| | | | |
| | | | |
| | | | |
| | | | |

ALL DRAWINGS AND WRITTEN MATERIAL APPEARING HEREIN CONSTITUTE THE ORIGINAL AND UNPUBLISHED WORK OF KOBİ KARP AIA, AND MAY NOT BE DUPLICATED, USED, OR DISCLOSED WITHOUT THE EXPRESS WRITTEN CONSENT OF KOBİ KARP ARCHITECTURE & INTERIOR DESIGN, INC. AIA 01-2020.

Shore Club
1901 Collins Ave.
Miami Beach, FL 33139

Owner: WITKOFF.
Name: 40 West 57th Street, Suite 1620
Address: New York, NY 10019
Address: 212-672-4700
Tel: 212-672-4700
Email: witkoff@rossettjpr.com

Consultant: RAMSA
Name: Robert A.M. Stern Architects.
Address: One Park Avenue
Address: New York, NY 10016
Tel: 212-667-5100

Consultant: LANDSCAPE
Name: Island Planning Corporation.
Address: 243 Washington Ave.
Address: Miami Beach, FL 33139
Tel: 305-534-5725
Email: info@islandplanningcorporation.com

Consultant: LANDSCAPE
Name: Greenspace Strategies
Address: 7905 SW 170th Street
Address: Miami, FL 33157
Tel: 561-460-8499
Email: ca@greenspacestrategies.com

Architect of Record:
Kobi Karp Architecture and Interior Design, Inc.
571 NW 28th Street
Miami, Florida 33127 USA
Tel: +1(305) 573 1818
Fax: +1(305) 573 3786



| | | | |
|---------|-------------|-----------|----------|
| Date | 2021-12-06 | Sheet No. | L0-13.00 |
| Scale | See Drawing | | |
| Project | 2104 | | |

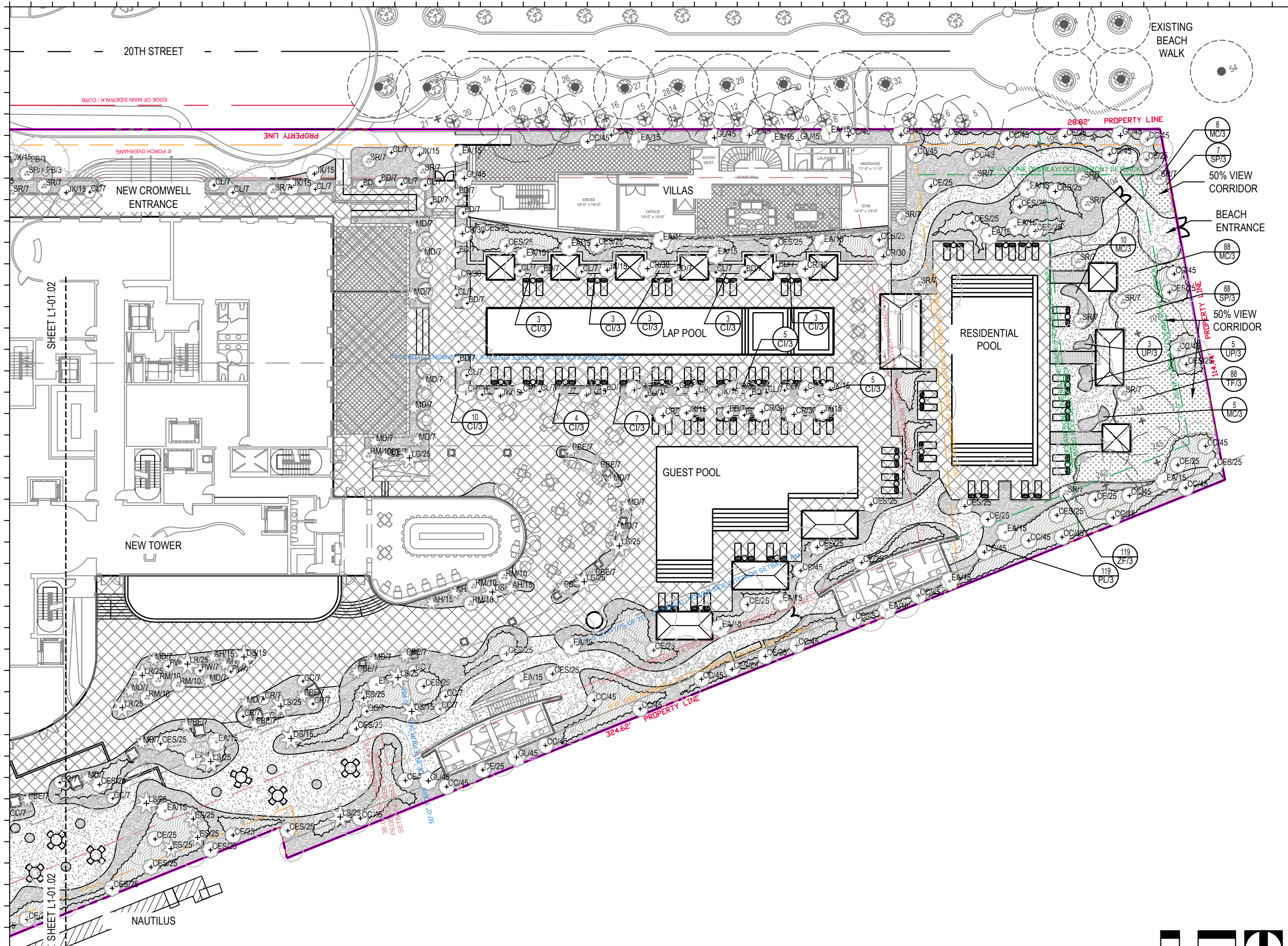

| Rev. | Date | Rev. | Date |
|------|------|------|------|
| | | | |
| | | | |
| | | | |
| | | | |
| | | | |
| | | | |
| | | | |
| | | | |
| | | | |
| | | | |

Shore Club
 1901 Collins Ave.
 Miami Beach, FL 33139

Owner: WITKOFF.
Name: 40 West 57th Street, Suite 1620
Address: New York, NY 10019
Address: 212-672-4700
Tel: 212-672-4700
Email: witkoff@rossettjpr.com

Consultant: RAMSA
Name: Robert A.M. Stern Architects.
Address: One Park Avenue
Address: New York, NY 10016
Tel: 212-667-5100
Email:

Consultant: LANDSCAPE
Name: Island Planning Corporation.
Address: 243 Washington Ave.
Address: Miami Beach, FL 33139
Tel: 305-534-5725
Email: info@islandplanningcorporation.com

Consultant: LANDSCAPE
Name: Greenspace Strategies
Address: 7905 SW 17th Street
Address: Miami, FL 33157
Tel: 561-460-8499
Email: ca@greenspacestrategies.com

Architect of Record:
Name: Kobi Karp Architecture and Interior Design, Inc.
Address: 571 NW 28th Street
Address: Miami, Florida 33127 USA
Tel: +1(305) 573 1818
Fax: +1(305) 573 3786



LANDSCAPE UNDERSTORY PLAN
 1" = 30'-0"

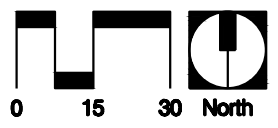

| | | | |
|---------|-------------|-----------|----------|
| Date | 2021-12-06 | Sheet No. | L1-01.00 |
| Scale | See Drawing | | |
| Project | 2104 | | |

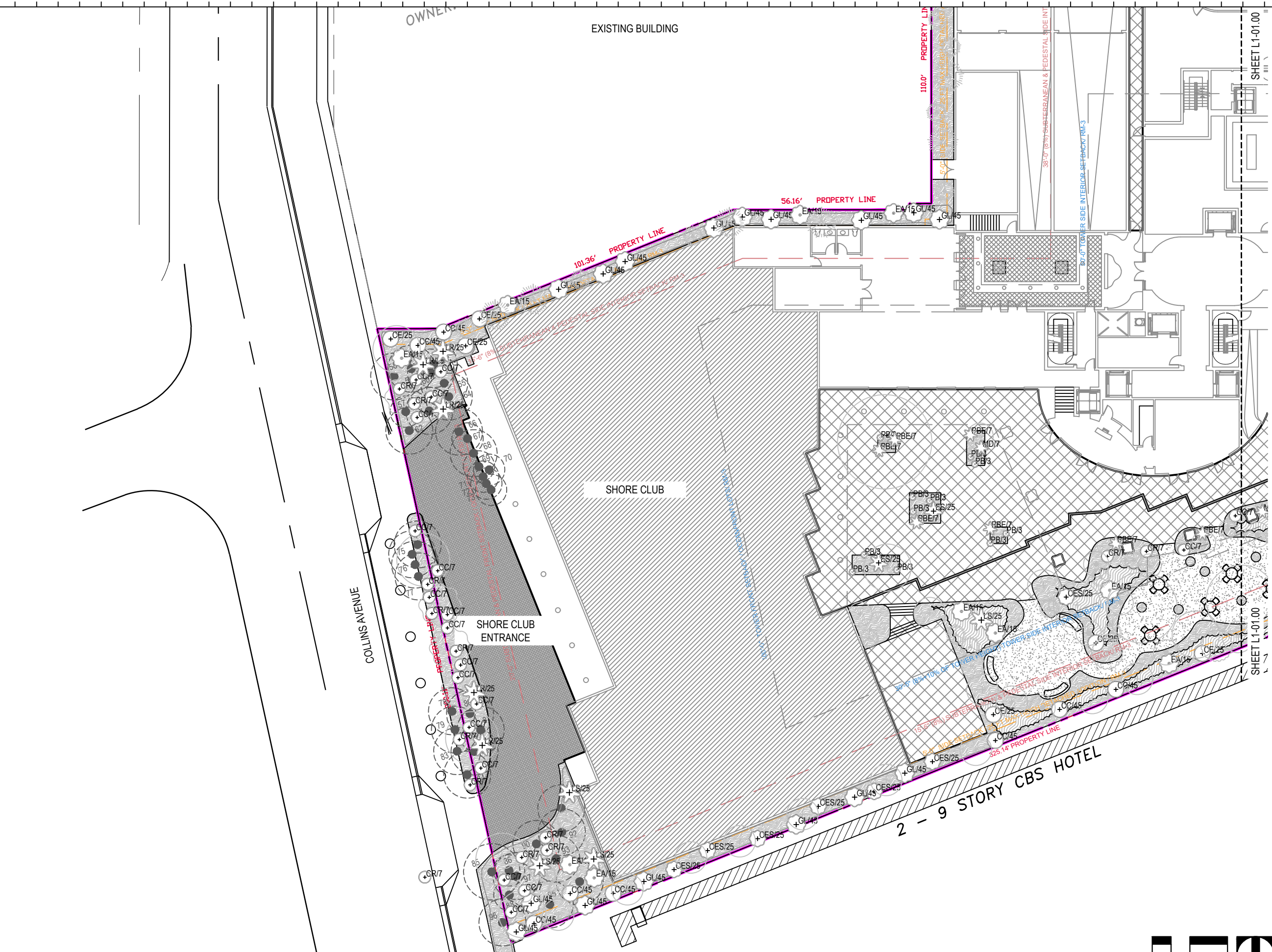

| Rev. | Date | Rev. | Date |
|------|------|------|------|
| | | | |
| | | | |
| | | | |
| | | | |
| | | | |
| | | | |
| | | | |
| | | | |
| | | | |
| | | | |

Shore Club
 1901 Collins Ave.
 Miami Beach, FL 33139

Owner: WITKOFF.
 Name: 40 West 57th Street, Suite 1620
 Address: New York, NY 10019
 Address: 212-672-4700
 Tel: 212-672-4700
 Email: witkoff@rossettipr.com

Consultant: RAMSA
 Name: Robert A.M. Stern Architects.
 Address: One Park Avenue
 Address: New York, NY 10016
 Tel: 212-667-5100
 Email: 212-667-5100

Consultant: LANDSCAPE
 Name: Island Planning Corporation.
 Address: 243 Washington Ave.
 Address: Miami Beach, FL 33139
 Tel: 305-534-5725
 Email: info@islandplanningcorporation.com

Consultant: LANDSCAPE
 Name: Greenspace Strategies
 Address: 7905 SW 17th Street
 Address: Miami, FL 33157
 Tel: 561-460-8499
 Email: ca@greenspacestrategies.com

Architect of Record:
 Kobi Karp Architecture and Interior Design, Inc.
 571 NW 28th Street
 Miami, Florida 33127 USA
 Tel: +1(305) 573 1818
 Fax: +1(305) 573 3786

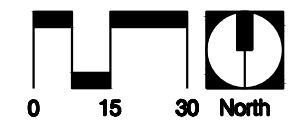
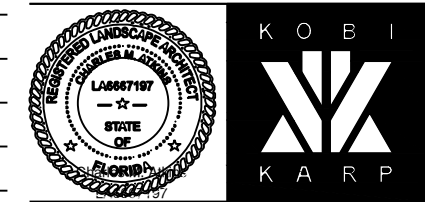

| | | | |
|---------|-------------|-----------|----------|
| Date | 2021-12-06 | Sheet No. | L1-01.01 |
| Scale | See Drawing | | |
| Project | 2104 | | |

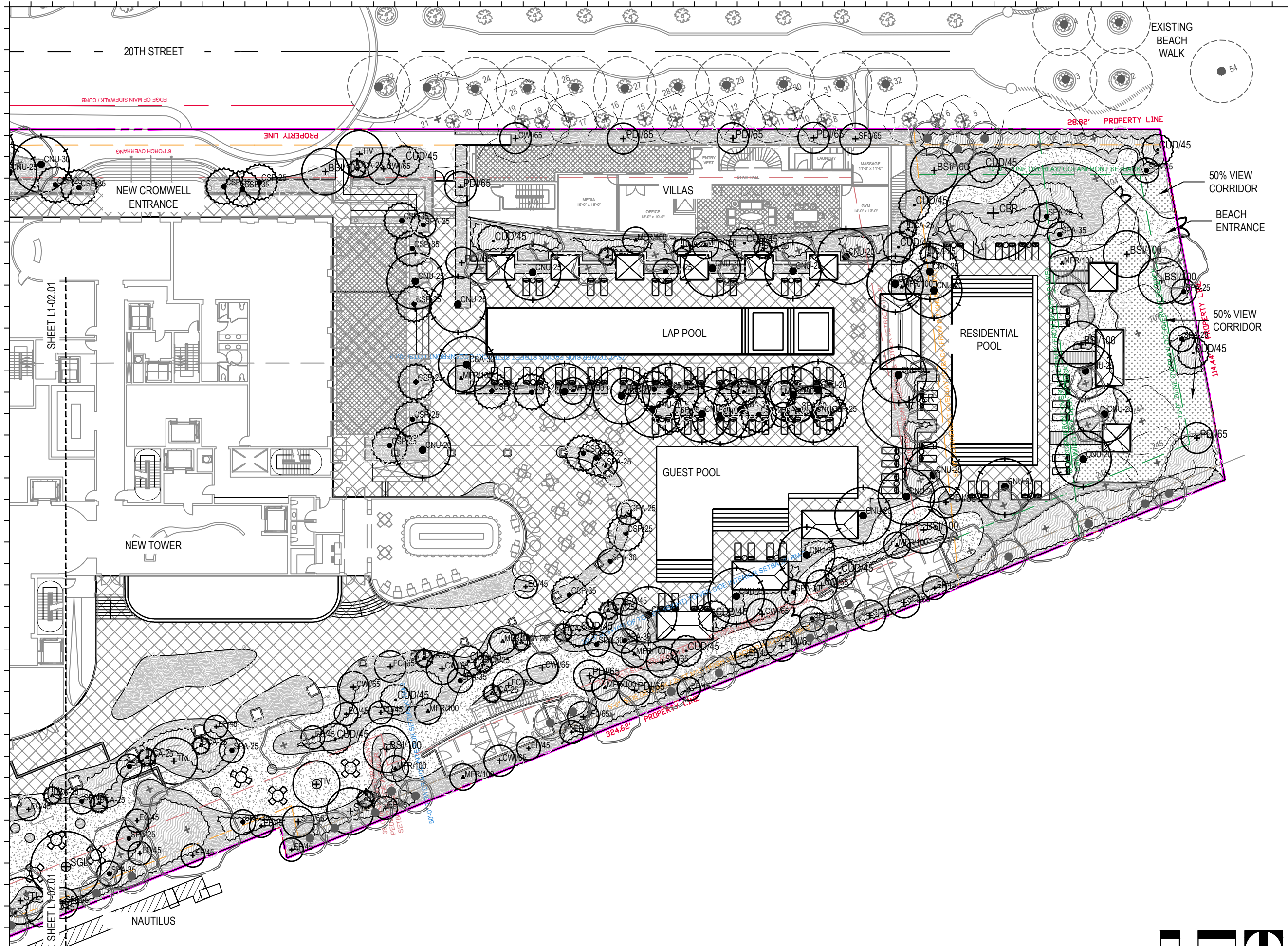

| Rev. | Date | Rev. | Date |
|------|------|------|------|
| | | | |
| | | | |
| | | | |
| | | | |
| | | | |
| | | | |
| | | | |
| | | | |
| | | | |
| | | | |

Shore Club
 1901 Collins Ave.
 Miami Beach, FL 33139

Owner: WITKOFF.
 Name: 40 West 57th Street, Suite 1620
 Address: New York, NY 10019
 Address: 212-672-4700
 Tel: witkoff@rossettipr.com
 Email:

Consultant: RAMSA
 Name: Robert A.M. Stern Architects.
 Address: One Park Avenue
 Address: New York, NY 10016
 Tel: 212-667-5100
 Email:

Consultant: LANDSCAPE
 Name: Island Planning Corporation.
 Address: 243 Washington Ave.
 Address: Miami Beach, FL 33139
 Tel: 305-534-5725
 Email: info@islandplanningcorporation.com

Consultant: LANDSCAPE
 Name: Greenspace Strategies
 Address: 7905 SW 170th Street
 Address: Miami, FL 33157
 Tel: 561-460-8499
 Email: ca@greenspacestrategies.com

Architect of Record:
 Kobi Karp Architecture and Interior Design, Inc.
 571 NW 28th Street
 Miami, Florida 33127 USA
 Tel: +1(305) 573 1818
 Fax: +1(305) 573 3786

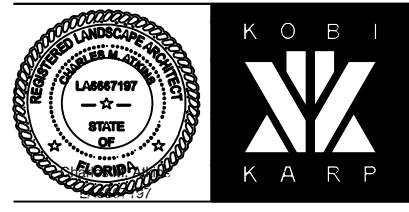

LANDSCAPE CANOPY PLAN
 1" = 30'-0"

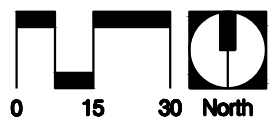

| | | | |
|---------|-------------|-----------|----------|
| Date | 2021-12-06 | Sheet No. | L1-02.00 |
| Scale | See Drawing | | |
| Project | 2104 | | |

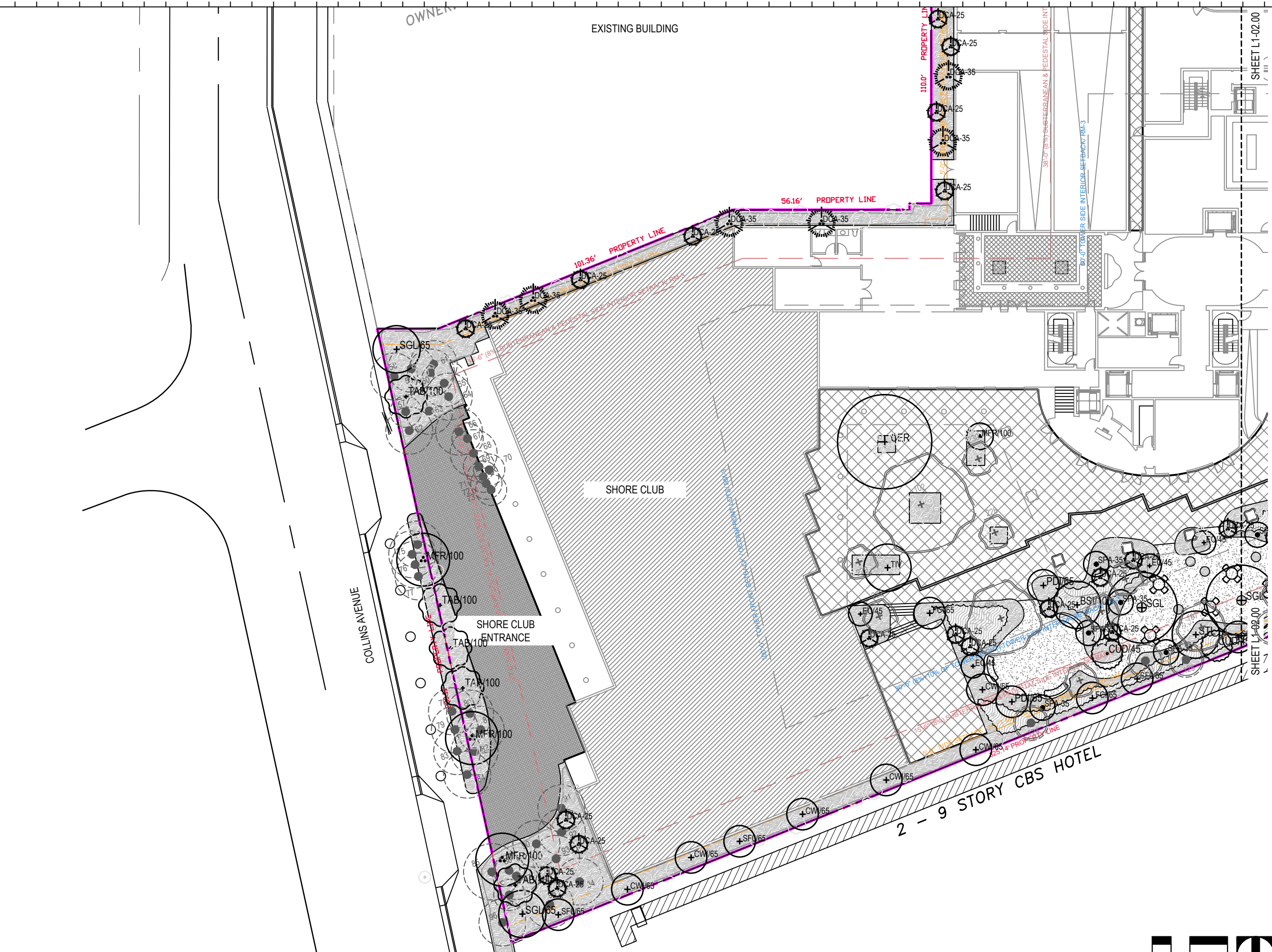

| Rev. | Date | Rev. | Date |
|------|------|------|------|
| | | | |
| | | | |
| | | | |
| | | | |
| | | | |
| | | | |
| | | | |
| | | | |
| | | | |
| | | | |

Shore Club
 1901 Collins Ave.
 Miami Beach, FL 33139

Owner: WITKOFF.
 Name: 40 West 57th Street, Suite 1620
 Address: New York, NY 10019
 Address: 212-672-4700
 Tel: 212-672-4700
 Email: witkoff@rossettipr.com

Consultant: RAMSA
 Name: Robert A.M. Stern Architects.
 Address: One Park Avenue
 Address: New York, NY 10016
 Tel: 212-667-5100
 Email: 212-667-5100

Consultant: LANDSCAPE
 Name: Island Planning Corporation.
 Address: 243 Washington Ave.
 Address: Miami Beach, FL 33139
 Tel: 305-534-5725
 Email: info@islandplanningcorporation.com

Consultant: LANDSCAPE
 Name: Greenspace Strategies
 Address: 7905 SW 17th Street
 Address: Miami, FL 33157
 Tel: 561-460-8499
 Email: ca@greenspacestrategies.com

Architect of Record:
 Kobi Karp Architecture and Interior Design, Inc.
 571 NW 28th Street
 Miami, Florida 33127 USA
 Tel: +1(305) 573 1818
 Fax: +1(305) 573 3786



LANDSCAPE CANOPY PLAN
 1" = 30'-0"

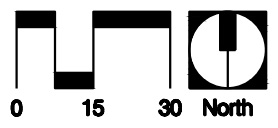

| | | | |
|---------|-------------|-----------|----------|
| Date | 2021-12-06 | Sheet No. | L1-02.01 |
| Scale | See Drawing | | |
| Project | 2104 | | |