

A.	Number of large shrubs or small trees required: Number of required shrubs x 10%=	16	16
B.	% Native large shrubs or small trees required: Number of large shrubs or small trees provided x 50%=	8	16

<u>CODE</u>	<u>QTY</u>	<u>BOTANICAL/COMMON NAME</u>	<u>CONT. SIZE/SPACING</u>	<u>DIMENSIONS</u>	<u>NATIVE</u>	<u>WATER USE</u>	<u>REMARKS</u>
QV	4	Quercus virginiana / Live Oak	B&B/ as shown	12' oah. 3"d.b.h.	Yes	Low	4' min. c.t. min. Florida no. 1
CE	5	Conocarpus erectus / Green Buttonwood	B&B/ as shown	10' oah. 2"d.b.h.	Yes	Low	Standard form, 4' min. c.t. min. Florida no. 1
CES	9	Conocarpus erectus 'Serius' / Silver Buttonwood	B&B/ as shown	6' oah. 2"d.b.h.	Yes	Low	min.Florida no. 1
HP	7	Hamelia Patens / Firebush	B&B/ as shown	6' oah. 2"d.b.h.	Yes	Low	min.Florida no. 1
KF	4	Krugiodendron ferreum / Black Ironwood	B&B/ as shown	10' oah. 2"d.b.h.	Yes	Low	Standard form, 4' min. c.t. min. Florida no. 1

CODE	QTY	BOTANICAL/COMMON NAME	CONT. SIZE/SPACING	DIMENSIONS	NATIVE	WATER USE	REMARKS
CHR	60	Chrysobalanus icaco 'Red Tip' / Red Tip Cocoplum	3 gal @ 24"oc	30" ht. x 24" spr.	Yes	Low	
MUC	18	Muhlenbergia capillaris/ Muhly Grass	3 gal @ 24"oc	24" ht. x 12" spr.	Yes	Low	
SUM	58	Suriana Maritima / Bay Cedar	3 gal@24" oc	30" ht. x 24" spr.	Yes	Low	
TRD	24	Tripsicum dactyloides/ Fakahatchee Grass	3 gal @ 24"oc	24" ht. x 24" spr.	Yes	Low	

<u>CODE</u>	<u>QTY</u>	<u>BOTANICAL/COMMON</u>	<u>SIZE</u>	<u>REMARKS</u>
SOD	3,551	Stenotaphrum secundatum / St. Augustine Grass	1,430 S.F.	Contractor to verify qty.
Mulch	3,551	Mellaluca or Eucalyptus Mulch	700 S.F.	3" depth.Contractor to verify qty.
Shell	3,551	Crushed Shell	1,137 S.F.	Contractor to verify qty.

OWNER AGREES THAT THE STREET TREE
AND IRRIGATION SYSTEM REQUIREMENTS
ARE TO BE IMPLEMENTED AFTER THE CIP
PROJECT HAS BEEN COMPLETED



SCALE: 1" = 10'

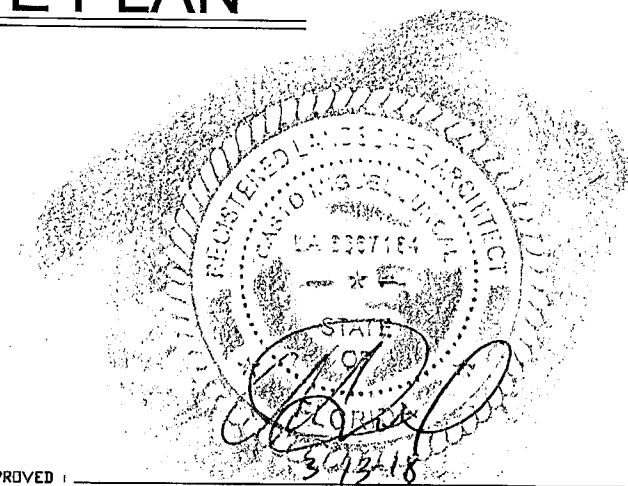

JUNCAL
DESIGN STUDIO

CMJ	CMJ	CMJ
DES.	DWN.	CHK.

LNP-1

10/27/17 1 OF 2

NO.	DATE	REVISIONS

117 WEST 1ST COURT
MIAMI BEACH, FL
LANDSCAPE NOTES & DETAILS

JUN CAL
DESIGN STUDIO

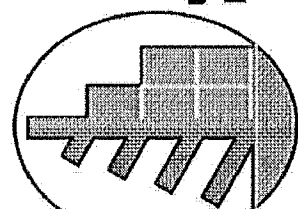

Casto Miguel Juncal
Registered Landscape Architect
LA6667184
20449 SW 93rd Ave.
Cutler Bay, FL 33189
ph: 786-877-2034
JuncalDesignStudio@gmail.com

CMJ	CMJ	CMJ
DES.	DWN.	CHK.

LND-1

05/11/17

SHEET
2 OF 2

1.07 WATERING NEW & TRANSPLANTED TREES:

A. ROOTBALL WATERING: MAINTAIN A SOIL MOISTURE IN THE ROOT ZONE AT AN OPTIMUM LEVEL FOR HEALTHY GROWTH. DEEP WATER THE ENTIRE ROOTBALL AREA AT A MINIMUM ACCORDING TO THE FOLLOWING SCHEDULE:

WHEN	FREQUENCY	AMOUNT
FIRST MONTH	ONCE DAILY	3" PER TREE OR PALM
SECOND MONTH	EVERY OTHER DAY	2" PER TREE OR PALM
FOLLOWING TWO MONTHS	TWICE A WEEK	1" PER TREE OR PALM
LAST EIGHT MONTHS	ONCE PER WEEK	1" PER TREE OR PALM

B. IF THERE IS NO SOURCE FOR WATER AVAILABLE AT THE PROJECT, SUCH AS A HOSE BIB(S) OR FIRE HYDRANT(S) IF APPROVED FOR USE, THEN THE CONTRACTOR SHALL BE RESPONSIBLE FOR SUPPLYING WATER BY MEANS OF A TRUCK OR TANK. IT IS THE CONTRACTOR'S RESPONSIBILITY TO PAY ANY FEES FOR WATER USE.

C. THE CONTRACTOR SHALL ADHERE TO THE SOUTH FLORIDA WATER MANAGEMENT DISTRICT'S WATER RESTRICTIONS CURRENT AT THE TIME OF RELOCATION ACTIVITIES.

1.08 MULCHING OF PLANT SAUCER:

A. SPREAD 3" MINIMUM DEPTH THICK LAYER OF SHREDDED EUCALYPTUS OR MELALEUCA GRADE 'B' MULCH OR EQUAL OVER ENTIRE AREA OF THE ROOTBALL.

1.09 APPLICATION OF FERTILIZER:

A. AT TIME OF WATERING ROOT-PRUNED TREES PRIOR TO TRANSPLANTING, DRENCH ROOTBALL ONCE PER WEEK DURING THE COURSE OF WATERING WITH A SOLUBLE FERTILIZER THAT HAS A 20-20-20 ANALYSIS AT MANUFACTURER'S RECOMMENDED RATE.

B. THREE (3) WEEKS AFTER TRANSPLANTING, AND AFTER MULCHING, APPLY ON THE SURFACE, EVENLY SPREAD OVER THE AREA OF THE ENTIRE ROOTBALL, FEC (FLORIDA EAST COAST FERTILIZER CO.) #5231 (12-6-8) OR EQUAL AT THE RATE OF 0.5KG PER 1" OF TRUNK DIAMETER.

1.10 STAKING TREES:

A. STAKE ALL TREES AND PALMS AT THE NEW SITE WITH NEW TIMBERS WITH A MINIMUM 2" X 4" DIMENSION AS PER THE DETAILS ENCLOSED, OR IN THE CASE OF OBSTACLE, IN ANOTHER MANNER WHICH WILL SUPPORT THE TREES.

1.11 CLEAN-UP:

A. DISPOSAL OF WASTE: ALL WASTE AND OTHER OBJECTIONABLE MATERIAL CREATED THROUGH PLANTING OPERATIONS AND LANDSCAPE CONSTRUCTION SHALL BE REMOVED COMPLETELY ON A DAILY BASIS FROM THE JOB OR AS DIRECTED BY THE PROJECT ENGINEER. ANY PAVED AREAS, INCLUDING CURBS AND SIDEWALKS THAT HAVE BEEN STAINED WITH SOIL, SOD WASTE, FERTILIZER OR OTHER WASTE SHALL BE THOROUGHLY SWEEP.

B. THE CONTRACTOR SHALL REMOVE AND DISPOSE OF STAKES AND BATTENS AND ANY TIED-UP CANOPIES WHEN IT IS DETERMINED BY THE PROJECT ENGINEER THAT SUFFICIENT TIME HAS ELAPSED FOR THE PLANTS TO ROOT STABILIZE, AND/OR AT THE END OF THE ONE YEAR GUARANTEE PERIOD. THIS SHALL BE DONE EVEN IF THE PROJECT HAS BEEN COMPLETED AND GIVEN FINAL ACCEPTANCE. THE CONTRACTOR SHALL REMOVE CANOPIES IMMEDIATELY AFTER INSTALLATION AND REMOVE STAKES AFTER ONE YEAR.

C. BACKFILLING OF HOLE LEFT BY RELOCATED TREE SHALL BE DONE IMMEDIATELY AFTER TREE REMOVAL, OR SUITABLE BARRICADES SHALL BE PROVIDED TO PREVENT INJURIES UNTIL HOLES ARE FILLED. THE CONTRACTOR SHALL BACKFILL HOLES WITH CLEAN FILL AND TOP SOIL TO A LEVEL FLUSH WITH ADJACENT GRADE.

1.12 GUARANTEE AND REPLACEMENT:

A. ALL RELOCATED PLANT MATERIAL SHALL BE GUARANTEED FOR 1 YEAR FROM TIME OF RELOCATION.

B. FOR ALL REPLACEMENT PLANT MATERIAL, THE WARRANTY PERIOD SHALL BE EXTENDED AN ADDITIONAL 45 DAYS BEYOND THE ORIGINAL WARRANTY PERIOD. ALL TREES THAT CLEAN OR ARE BLOWN OVER, CAUSED BY WINDS LESS THAN 75 MPH AS DEFINED BY THE MIAMI HURRICANE CENTER, WILL BE RE-SET AND BRACED BY THE CONTRACTOR AT NO ADDITIONAL COST TO DATE CODE.

1.13 SCHEDULE AND APPROVALS:

THE CONTRACTOR SHALL SUBMIT A WRITTEN SCHEDULE OF OPERATIONS AND WRITTEN REQUESTS FOR APPROVALS IN ACCORDANCE WITH PROJECT SPECIFICATIONS OR AS OTHERWISE AGREED UPON WITH THE OWNER.

1.14 FINAL ACCEPTANCE:

OWNER SHALL REVIEW PROJECT UPON NOTIFICATION BY CONTRACTOR. OWNER SHALL ISSUE A FINAL ACCEPTANCE AFTER ALL CONTRACT ITEMS AND OBLIGATIONS ARE SATISFACTORY.

GENERAL PLANTING NOTES

1. **MATERIAL STANDARDS:**
ALL PLANT MATERIAL SHALL MEET OR EXCEED PLANT LIST SIZES AND THE SHAPE RELATIONSHIPS AND BALL DIAMETERS AS SPECIFIED IN THE LATEST EDITION OF THE AMERICAN STANDARD FOR NURSERY STOCK PUBLISHED BY THE AMERICAN ASSOCIATION OF NURSERYMEN AND FLORIDA NO. 1 AS CLASSIFIED IN GRADES AND STANDARDS FOR NURSERY PLANTS PUBLISHED BY THE FLORIDA DEPARTMENT OF AGRICULTURE (EXCEPT AS NOTED IN THE PLANT LIST). NO MATERIAL SHALL BE ACCEPTED WHICH IS NOT PEST AND DISEASE FREE.

2. **LIST OF PLANT MATERIAL:**
THE CONTRACTOR WILL VERIFY THE PLANT QUANTITIES PRIOR TO BIDDING AND ANY DISCREPANCIES SHALL BE BROUGHT TO THE ATTENTION OF THE PROJECT ENGINEER. THE CONTRACTOR SHALL FURNISH AND PLANT ALL PLANT REQUIRED TO COMPLETE THE WORK SHOWN ON THE DRAWINGS. SUBSTITUTIONS SHALL NOT BE MADE WITHOUT THE WRITTEN APPROVAL OF THE LANDSCAPE ARCHITECT. THIS CONTRACT WILL BE BASED ON THE BIDDER HAVING VERIFIED PRIOR TO BIDDING THE AVAILABILITY OF THE REQUIRED PLANT MATERIAL AS SPECIFIED ON THE PLANT LIST. ALL PLANTS SHALL BE PROPERLY MARKED FOR IDENTIFICATION.

3. **PLANT BED PREPARATION:**
APPROXIMATELY ONE WEEK PRIOR TO BEGINNING PLANTING OPERATIONS, ALL PLANT BEDS SHOULD BE WATERED TO GERMINATE ANY WEED SEED. TWO TO FIVE DAYS LATER, SPRAY PLANT BEDS WITH ROUNDUP OR OTHER APPROVED SYSTEMIC WEED KILLER, APPLIED AT THE MANUFACTURER'S RECOMMENDED RATE OF DILUTION AND COVERAGE OF HERBICIDE APPLICATION SHALL BE WITNESSED AND APPROVED BY CONSULTANT.

4. **EXCAVATION:**
ROADCROCK BACKFILL IN MEDIANS SHALL BE EXCAVATED TO A DEPTH OF EIGHTEEN (18") FROM THE TOP OF CURB. HOLES FOR TREES SHALL BE (24") LARGER IN DIAMETER THAN THE SIZE OF BALL OR CONTAINER AND SHALL HAVE VERTICAL SIDES. HOLES FOR SHRUBS SHALL BE (12") WIDER WITH VERTICAL SIDES. PLANT BEDS SHALL BE BACKFILLED WITH SPECIFIED SOIL MIX AT THE TIME OF PLANTING TO A DEPTH OF (8") AN AREA (18") BEYOND THE AVERAGE OUTSIDE EDGE OF PLANT BALLS AFTER APPLYING A MINIMUM OF (2") OF GENERAL PURPOSE PLANTING SOIL.

5. **SOIL MIX:**
SOIL MIX FOR ALL PLANT BEDS, EXCEPT PALM PLANTINGS, WILL BE 80/20 MIX OF GENERAL PURPOSE PLANTING SOIL TO SAND. PALM PLANT PITS ARE TO RECEIVE A 70/30 GENERAL PLANTING SOIL TO SAND MIX.

6. **PLANTING:**

BACKFILLING SHALL BE DONE WITH SPECIFIED SOIL MIX FREE OF STONES, SUBSOIL, STUMPS, ROOTS, WEEDS, LITTER, TOXIC SUBSTANCES, OR ANY OTHER MATERIAL WHICH MAY BE HARMFUL TO PLANT GROWTH OR HINDER GRADING, PLANTING, OR MAINTENANCE OPERATIONS. SHOULD ANY UNFORESSEEN OR UNSUITABLE PLANTING CONDITIONS ARISE, SUCH AS FAULTY SOIL DRAINAGE OR CHEMICAL RESIDUES, THE CONTRACTOR SHALL NOTIFY THE OWNER AND AWAIT INSTRUCTIONS FOR POSSIBLE EXTRA WORK BEFORE PLANTING. THE CONTRACTOR WILL BE RESPONSIBLE FOR ADEQUATE DRAINAGE FROM ALL PLANTS. THE PLANT SHALL BE SET PLUMB AND STRAIGHT, AND SHALL BE STAKED AT THE TIME OF PLANTING. BACKFILL SHALL BE WELL WORKED ABOUT THE ROOTS AND SETTLED BY WATERING. PLANTS SHALL BE PLANTED AS TO BEAR SAME RELATION TO FINISH GRADE. SAUCERS SHALL BE FORMED ABOVE EXISTING GRAD AND AROUND THE OUTER RIM OF THE PLANT PIT. ALL TREES SHALL BE PLANTED VERTICALLY AND BACKFILL COMPACTED WITH WATER AND FOOTING TO REMOVE ALL VOIDS AND TO SEAT ROOT BALL. SEE TREE PLANTING DETAILS. TREES TRANSPLANTED BY MACHINE SHALL BE MOVED BY MACHINES THAT PROVIDE A MINIMUM BALL DIAMETER OF 8" PER 1" OF TREE CALIPER. HOLES ARE TO BE DUG BY THE SAME SIZE MACHINE AS THE ONE TRANSPORTING THE PLANT. THE PLANT MATERIAL SHALL BE TRANSPORTED IN APPROXIMATELY THE SAME GROWING CONDITIONS OF SOIL TYPE AND MOISTURE CONTENT AS IT IS PRESENTLY GROWING. SHRUBS AND TREE-FORM SHRUBS SHOULD BE TURNED IN THE PLANT PIT TO OBTAIN THE BEST FOLIAGE RELATIONSHIP TO RELOCATION PRIOR TO STARTING BACKFILL. GROUNDCOVERS SHALL BE PLANTED AFTER MULCH HAD BEEN INSTALLED. NO PLANTS EXCEPT VINES, PLANT GROUNDCOVERS OR ESPALIRED MATERIAL SHALL BE PLANTED CLOSER THAN 30" TO BUILDINGS, WALK, OR CURBS.

CONTRACTOR SHALL STAKE & GUY ALL TREES & PALMS AT TIME OF PLANTING AS PER THE APPROPRIATE DETAIL. CONTRACTOR IS RESPONSIBLE FOR THE MAINTENANCE AND/OR REPAIR OF ALL STAKING AND GUYING DURING WARRANTY PERIOD. ALL RELOCATED TREES & PALMS SHALL BE BRACED AT LEAST ONE (1) YEAR.

NO PLANT MATERIAL WILL BE ACCEPTED SHOWING EVIDENCE OF CABLE, CHAIN MARKS, EQUIPMENT SCARS, OR WHEN THE BALL OF EARTH SURROUNDING ITS ROOTS HAS BEEN CRACKED, BROKEN OR OTHERWISE DAMAGED.

7. **FERTILIZATION:**

FERTILIZATION FOR DICOT TREES, SHRUBS, GROUND COVERS AND VINES SHALL BE OF 8% NITROGEN, 10% PHOSPHORUS AND 10% POTASSIUM COMPOSITION ANALYSIS. FERTILIZER FOR PALMS SHALL BE "PALM FERTILIZER" OF 13% NITROGEN, 3% PHOSPHORUS AND 13% POTASSIUM COMPOSITION ANALYSIS. FERTILIZER FOR GRASSING AREAS SHALL BE OF 8% NITROGEN (OF WHICH 50% SHALL BE ORGANICALLY DERIVED), 6% PHOSPHORUS AND 8% POTASSIUM COMPOSITION ANALYSIS. CONTRACTOR SHALL APPLY GRANULAR FERTILIZER TO THE SOIL MIX AT THE FOLLOWING RATES: TREE PITS, 1-2 LBS. PER CALIPER INCH; SHRUB BEDS, 2-3 LBS. PER 100 SQUARE FEET; GROUND COVER, 1-2 LBS. PER 100 SQUARE FEET; GRASSING AREAS, 1LB. PER 100 SQUARE FEET.

8. **MULCH:**

ALL PLANT BEDS AND SAUCERS SHALL BE THOROUGHLY MULCHED WITH SHREDDED MELALEUCA OR EQUIVALENT NON-TOXIC MULCH GRADE 'B' OR BETTER. MULCH SHALL BE A MINIMUM OF 3" DEEP. THOROUGH WEEDING AND REPLENISHING OF MULCH SHALL BE REQUIRED IMMEDIATELY PRIOR TO THE INSPECTION AT THE END OF THE GUARANTEE PERIOD. ALL BEDS SHALL BE FREE OF WEEDS AND DEBRIS PRIOR TO FINAL INSPECTION.

9. **MAINTENANCE:**

THE CONTRACTOR SHALL BE RESPONSIBLE, DURING THE CONTRACT AND UP TO THE TIME OF ACCEPTANCE, FOR KEEPING NEW PLANTINGS AND WORK INCIDENTAL THEREIN IN GOOD CONDITION. THIS MAY BE ACCOMPLISHED BY REPLANTING, PLANT REPLACEMENT, WATERING, WEEDING, CULTIVATING, PRUNING, SPRAYING, RESTAKING AND CLEANING UP, AND BY PERFORMING ALL OTHER NECESSARY OPERATIONS OF CARE FOR PROMOTION OF GOOD PLANT GROWTH SO THAT ALL WORK IS IN SATISFACTORY CONDITION AT THE TIME OF ACCEPTANCE. THIS MAINTENANCE SHALL BE AT NO ADDITIONAL COST TO THE OWNER.

10. **MISCELLANEOUS:**

THE CONTRACTOR IS RESPONSIBLE FOR DETERMINING ALL UTILITY LOCATIONS AND INSTALLING FACILITIES SO AS TO NOT CONFLICT. REFER TO THE "UTILITY" SECTION OF THE NOTES ON THE ENGINEERING PLANS.

THE CONTRACTOR SHALL COMPLY WITH ALL COUNTY AND MUNICIPAL CODES AND ORDINANCES. CONTRACTOR SHALL BE RESPONSIBLE FOR OBTAINING ALL APPLICABLE PERMITS UNLESS OTHERWISE DIRECTED BY THE PROJECT ENGINEER.

EXISTING TREES AND PALMS TO REMAIN SHALL BE PROTECTED DURING CONSTRUCTION. AN ORANGE BARRICADE FENCE SHALL BE INSTALLED AROUND THE TREES AND PALMS TO REMAIN (SEE TREE PROTECTION DETAIL).

THE CONTRACTOR IS RESPONSIBLE FOR CLEAN-UP OF DEBRIS RESULTING FROM LANDSCAPE CONSTRUCTION ACTIVITIES. THIS SHALL INCLUDE, BUT NOT BE LIMITED TO, THE REMOVAL OF ALL DEBRIS INCLUDING TRASH, LARGE ROCKS, BOTTLES, CANS, STAKES, WIRE, ETC.

THE CONTRACTOR SHALL FURNISH TO BROWARD COUNTY ENGINEERING DIVISION A UNIT PRICE BREAKDOWN FOR ALL MATERIALS. B.O.B.D. MAY, AT ITS DISCRETION, ADD OR DELETE FROM THE MATERIALS UTILIZING THE UNIT PRICE BREAKDOWN SUBMITTED.

11. **SUBSTITUTIONS AND CHANGES:** ALL SUBSTITUTIONS AND CHANGES SHALL BE APPROVED IN WRITING PRIOR TO INSTALLATION. ANY DISCREPANCIES BETWEEN PLANS, SITE, AND SPECIFICATIONS SHALL BE BROUGHT TO THE IMMEDIATE ATTENTION OF THE PROJECT ENGINEER.

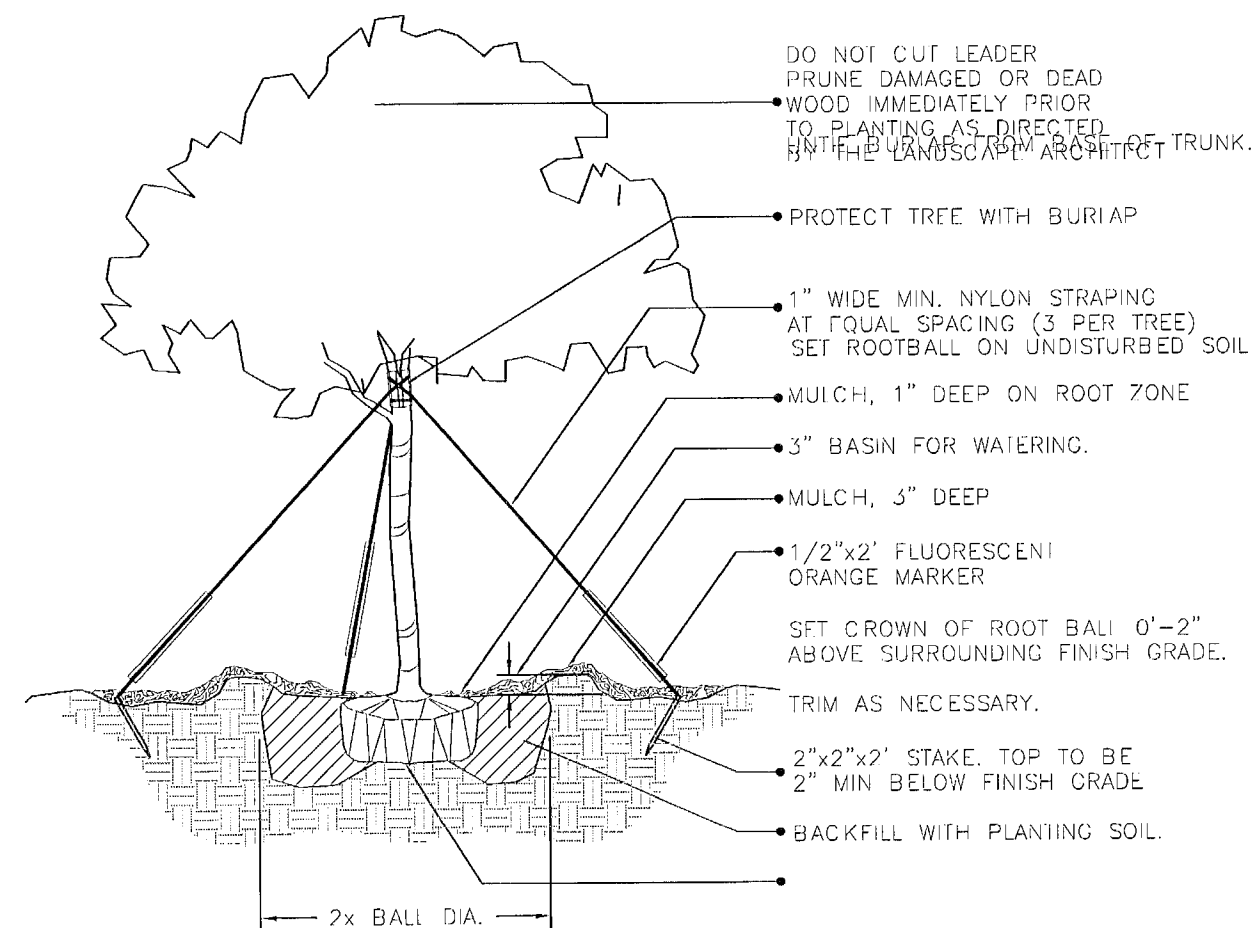

(2" cal. and over)
LARGE TREE PLANTING DETAIL

NT8

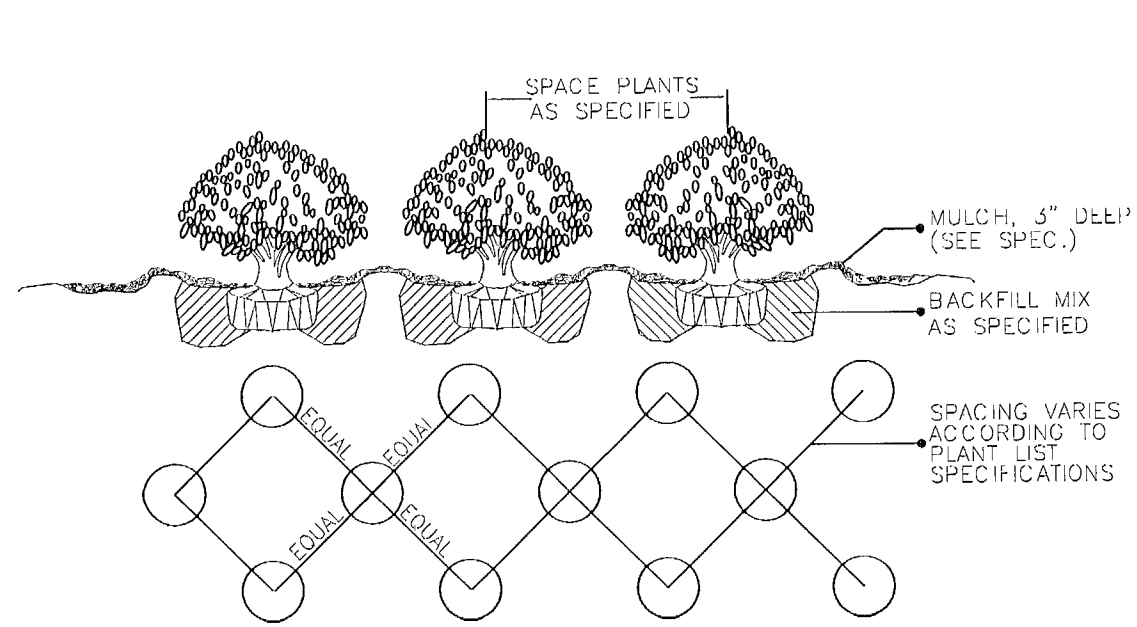
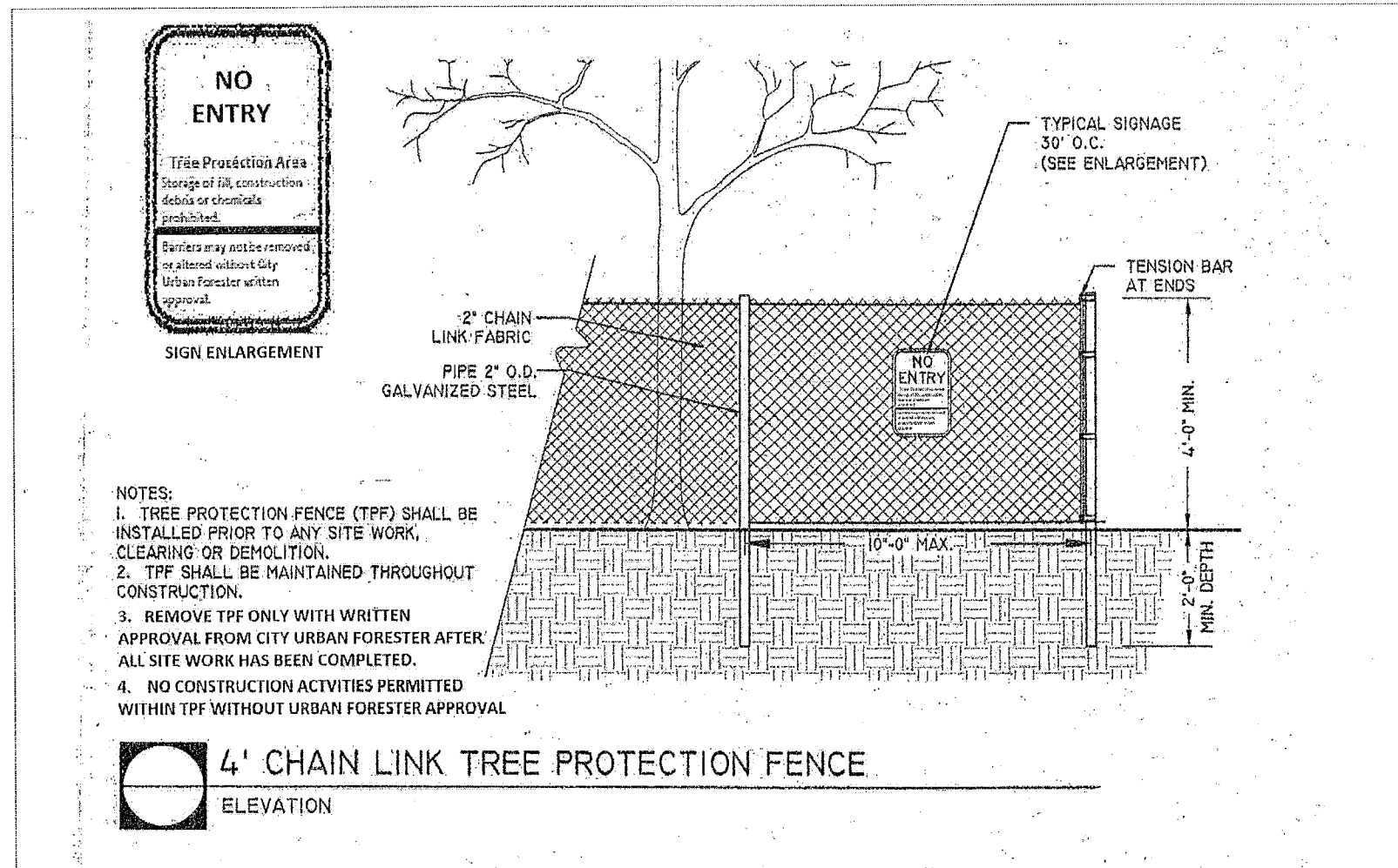

SHRUB / GROUNDCOVER
SPACING / PLANTING DETAIL

NT8

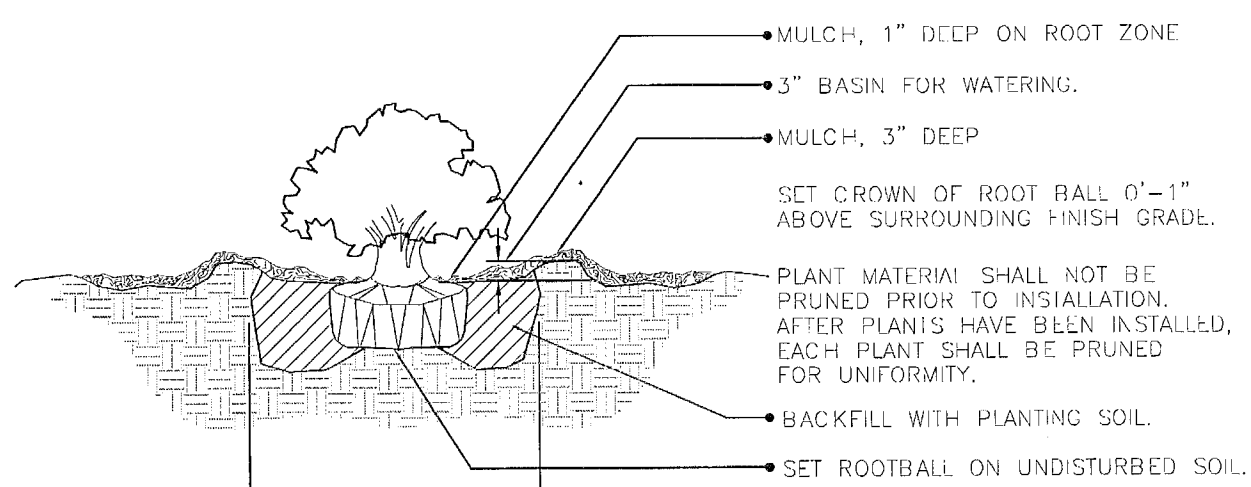

SHRUB PLANTING DETAIL

NT8

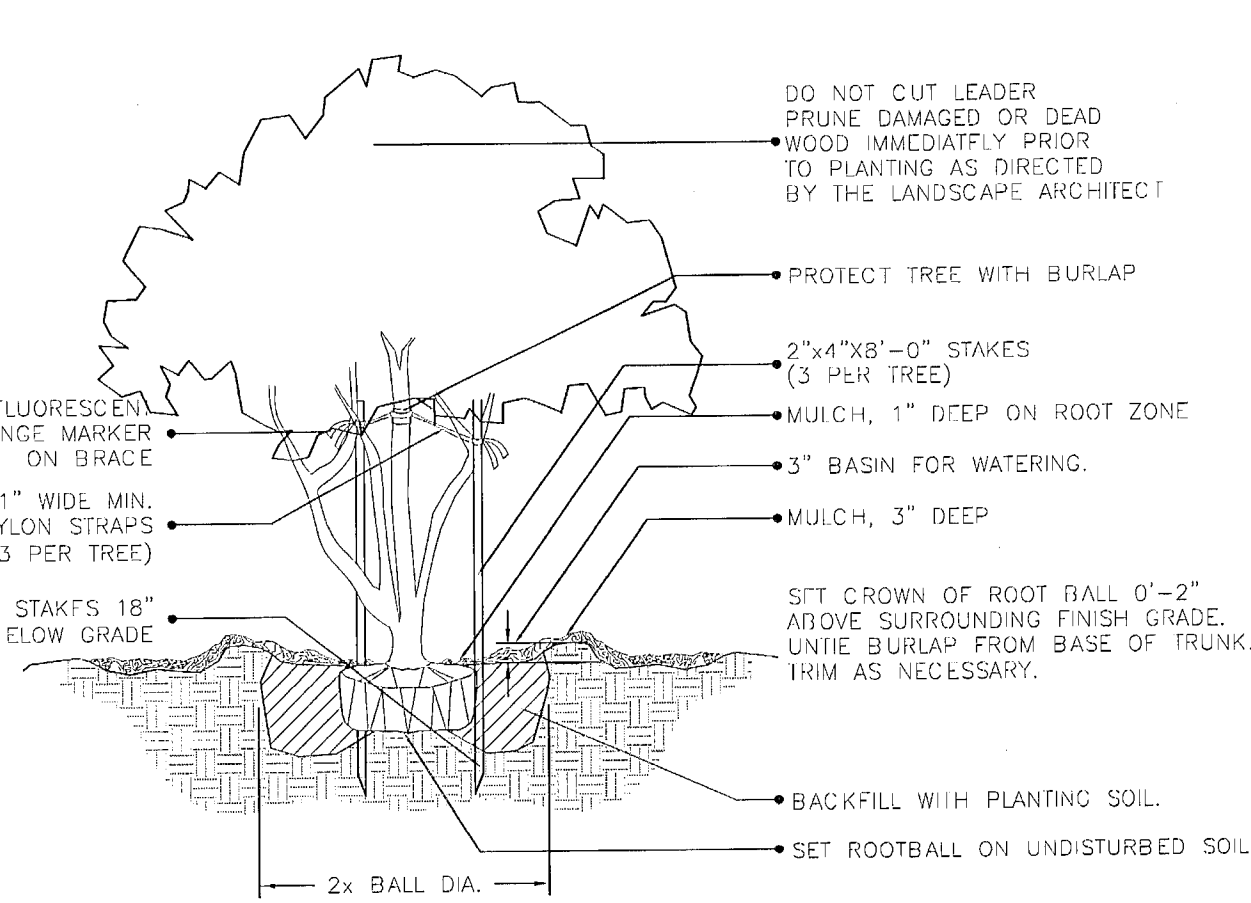

(2" cal. and under)
MULTI- TRUNK AND SMALL TREE
(2" cal. and under) PLANTING DETAIL

NT8

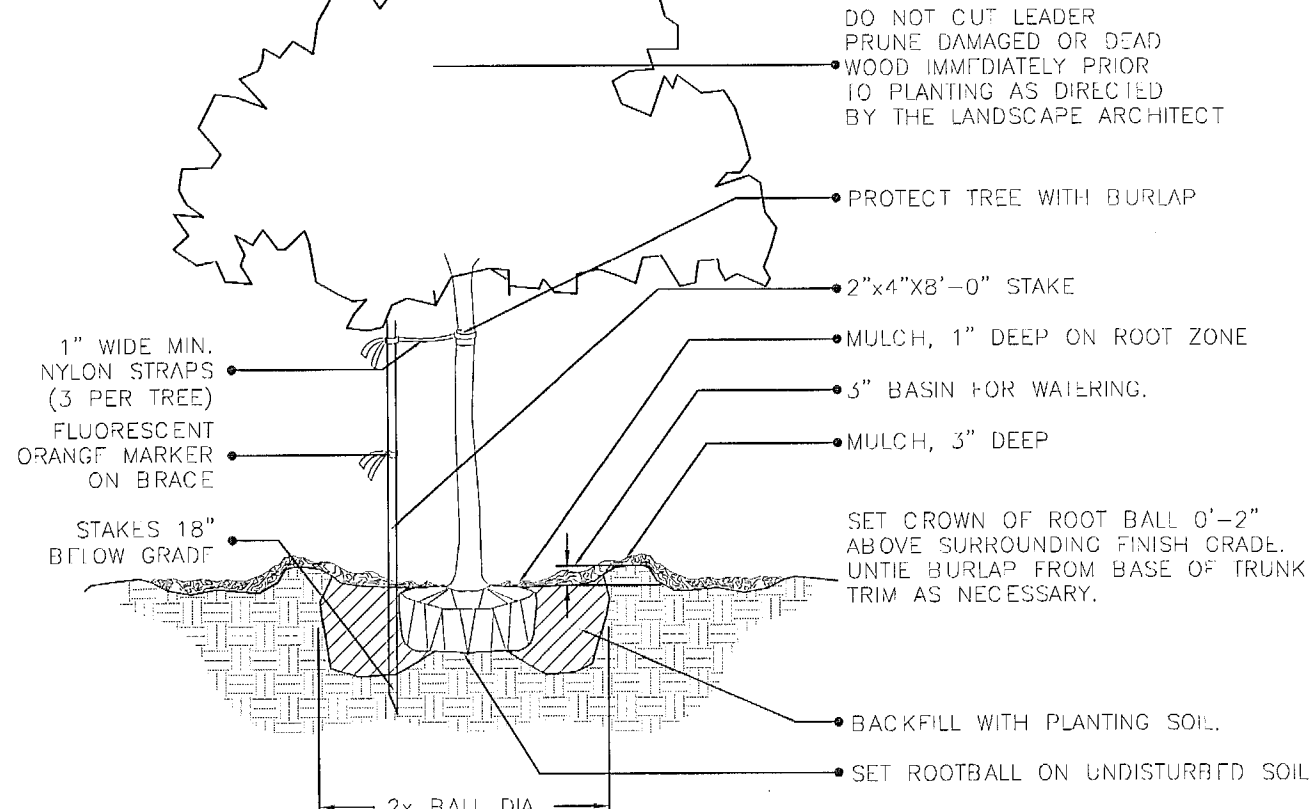

(2" cal. and under)
SMALL TREE PLANTING DETAIL

NT8

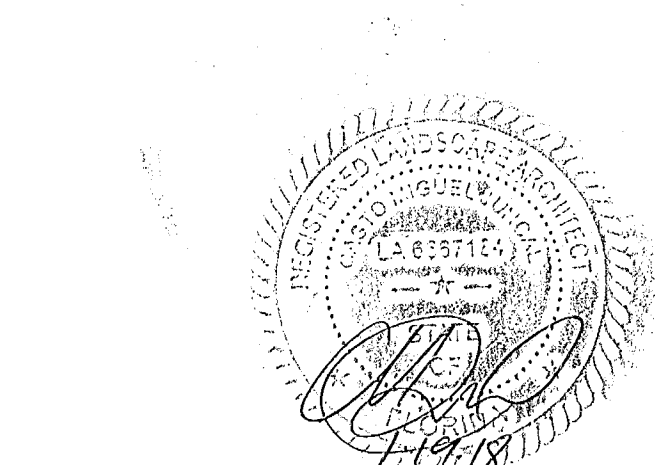

APPROVED: _____
FLA. REGISTRATION NO. _____ DATE: _____