

CONTRACTOR QUALIFICATIONS

1. CONTRACTOR MUST BE A LICENSED LANDSCAPE CONTRACTOR.
2. CONTRACTOR MUST HAVE A MINIMUM OF 10 YEARS OF PROVEN EXPERIENCE RELOCATING LARGE SPECIMEN TREES AND PALMS IN SOUTH FLORIDA.
3. CONTRACTOR MUST HAVE PROVEN EXPERIENCE RELOCATING TREES AND PALMS OF THE SAME SPECIES AND SIZE AS THOSE TO BE RELOCATED FOR THE CURRENT PROJECT.
4. CONTRACTOR MUST HAVE A CERTIFIED ARBORIST ON STAFF

CONTRACTOR REQUIREMENTS

1. CONTRACTOR MUST VISIT THE JOBSITE AND INSPECT ALL TREES AND PALMS TO BE RELOCATED AS WELL AS EXISTING SITE CONDITIONS AND RESTRICTIONS PRIOR TO PREPARING BID.
2. CONTRACTOR MUST VERIFY AND ENSURE THAT ALL TREES AND PALMS IDENTIFIED ON THE PLANS AND THOSE TAGGED ON THE JOBSITE CORRESPOND AS TO NUMBER AND DESCRIPTION. ANY DISCREPANCIES MUST BE BROUGHT TO THE ATTENTION OF THE LANDSCAPE ARCHITECT IMMEDIATELY, PRIOR TO PREPARING BID.
3. CONTRACTOR MUST CONDUCT ALL WORK ASSOCIATED WITH RELOCATION AND MAINTENANCE OF TREES AND PALMS TO BE RELOCATED. NO WORK IS TO BE SUBCONTRACTED WITHOUT PRIOR WRITTEN CONSENT OF THE OWNER AND/OR LANDSCAPE ARCHITECT.
4. CONTRACTOR MUST DESIGNATE A COMPETENT, ENGLISH-SPEAKING SUPERVISOR OR FOREMAN OVERSEE AND DIRECT ALL RELOCATION AND MAINTENANCE ACTIVITIES AS OUTLINED IN THESE SPECIFICATIONS.
5. CONTRACTOR MUST SCHEDULE ROOT PRUNING TO PROVIDE THE MAXIMUM POSSIBLE TIME FOR NEW ROOT GROWTH. EVEN TREES AND PALMS THAT TYPICALLY DO NOT REQUIRE LONG (OR ANY) ROOT PRUNING WILL BENEFIT FROM MORE ROOT PRUNING TIME; THEREFORE, ALL TREES AND PALMS TO BE RELOCATED MUST BE ROOT PRUNED. CONTRACTOR MUST PROVIDE A ROOT PRUNE SCHEDULE FOR EACH TREE OR PALM TO BE RELOCATED AS AN ATTACHMENT TO THE BID.
6. CONTRACTOR MUST CALL SUNSHINE 811 TO HAVE ALL UNDERGROUND UTILITIES LOCATED UNDER OR IN THE VICINITY OF THE CURRENT OF FUTURE LOCATIONS OF ALL TREES AND PALMS TO BE RELOCATED PRIOR TO WORK COMMENCING.
7. CONTRACTOR MUST VERIFY WITH THE GENERAL CONTRACTOR THE ABSENCE OF ANY UNDERGROUND CONSTRUCTION OR OBSTRUCTIONS (E.G., BULKHEADS, SEPTIC SYSTEMS, ETC.) IN THE CURRENT AND FUTURE LOCATIONS OF ALL TREES AND PALMS TO BE RELOCATED.
8. CONTRACTOR MUST ALERT THE LANDSCAPE ARCHITECT OF ANY TREES OR PALMS THAT WILL NOT SUCCESSFULLY RELOCATE DUE TO POOR HEALTH PRIOR TO BEGINNING ROOT PRUNING.
9. CONTRACTOR MUST FLAG ALL PROPOSED TRANSPLANT LOCATION FOR THE LANDSCAPE ARCHITECT'S APPROVAL A MINIMUM OF 15 DAYS PRIOR TO RELOCATION.
10. CONTRACTOR MUST ENSURE THAT ALL TREES AND PALMS TO BE RELOCATED ARE INSTALLED AT THE CORRECT GRADE OR ELEVATION, ACCORDING TO THE GRADING PLAN.
11. CONTRACTOR MUST BE ENSURE THAT ALL ROOT FLARES ARE EXPOSED AFTER RELOCATION.
12. CONTRACTOR MUST REMOVE ALL RESIDUAL ROOTS, STUMPS, AND PORTIONS THEREOF AND BACKFILL PITS FROM WHICH RELOCATED TREES AND PALMS WERE REMOVED WITH CLEAN FILL FLUSH WITH THE SURROUNDING GRADE.
13. CONTRACTOR MUST BE REPAIR ANY DAMAGE TO OTHER PLANTS, LAWN, HARDSCAPES, OR NEW CONSTRUCTION WITHIN THE RELOCATION AREA AT CONTRACTOR'S EXPENSE. HARDSCAPES INCLUDE BUT ARE NOT LIMITED TO CURBS, WALKS, ROADS, FENCES, SITE FURNISHINGS, ETC.
14. CONTRACTOR MUST PHOTOGRAPHICALLY DOCUMENT NEW ROOT GROWTH FOLLOWING EACH ROOT PRUNE AND SUBMIT THIS DOCUMENTATION TO THE LANDSCAPE ARCHITECT. THE PURPOSE OF THIS REQUIREMENT IS TO ENSURE THAT SUFFICIENT ROOT GROWTH HAS OCCURRED PRIOR TO THE SECOND AND SUBSEQUENT ROOT PRUNES AND FOLLOWING THE FINAL ROOT PRUNE PRIOR TO RELOCATION.
15. CONTRACTOR MUST INSTALL AND MAINTAIN PROTECTION FENCING AROUND EACH TREE AND PALM TO BE RELOCATED BOTH DURING ROOT PRUNING AND AFTER RELOCATION. PROTECTION FENCING MUST CONSIST OF GALVANIZED WELDED WIRE FABRIC OR PLASTIC MESH ATTACHED TO 4" X 4" POSTS INSERTED AROUND THE PERIMETER OF THE DRIPLINE OF THE TREE OR PALM. PROTECTION FENCING MUST BE PLUMB, TAUT, AND STURDY AT ALL TIMES AND MUST REMAIN IN PLACE THROUGHOUT THE ROOT PRUNING AND WARRANTY PERIODS, OR AS DIRECTED BY THE LANDSCAPE ARCHITECT.
16. CONTRACTOR MUST OBTAIN ALL NECESSARY OR REQUIRED PERMITS FOR THE RELOCATION AND TRANSPORTATION OF THE TREES AND PALMS TO BE RELOCATED.
17. CONTRACTOR MUST GUARANTEE ALL RELOCATED TREES AND PALMS FOR ONE YEAR FROM THE DATE OF RELOCATION TO THE FINAL LOCATION. GUARANTEE MUST INCLUDE TREE HEALTH AND SETTLING.
18. CONTRACTOR MUST PROVIDE ALL MATERIAL NECESSARY TO PERFORM THE WORK COVERED HEREIN, INCLUDING BUT NOT LIMITED TO BACKFILL MATERIAL, PROTECTION FENCING, FLAGGING, ADDITIVES AND SUPPLEMENTS, TEMPORARY IRRIGATION, BURLAP, WIRE, SHRINK WRAP, AND ALL NECESSARY TOOLS AND EQUIPMENT.

TREES PROTECTION NOTES

1. CONTRACTOR TO PROTECT ALL EXISTING TREES PRIOR TO THE DEMOLITION OF THE EXISTING STRUCTURE.
2. UPON COMPLETION OF OF SITE DEMOLITION, CONTRACTOR TO RELOCATE ALL SPECIFIED TREES AND PALMS FOR RELOCATION. CONTRACTOR TO REINSTALL TREE PROTECTION FENCE AROUND RELOCATED AND EXISTING TREES.
3. FENCING AT A MINIMUM FOUR (4) FEET HEIGHT INSTALLED NO CLOSER TO THE TREE TRUNK THAN ITS DRIPLINE. THIS FENCE SHALL BE MAINTAINED IN WORKING ORDER DURING ALL PHASES OF CONSTRUCTION. MAINTAIN TREE PROTECTION ZONES FREE OF WEEDS AND TRASH.
4. THE PROJECT LIMIT OF CONSTRUCTION AND ALL EXISTING VEGETATION TO REMAIN IS TO BE CLEARLY DEFINED BY STURDY, WEATHERPROOF FENCING AT A MINIMUM OF FOUR (4) FEET HIGH.
5. STURDY TEMPORARY BARRIERS SHALL BE INSTALLED AROUND ALL TREE PROTECTION ZONES. BARRIERS SHALL BE A MINIMUM OF FOUR FEET HIGH, AND SHALL BE CONSTRUCTED OF CONTINUOUS CHAIN LINK FENCE WITH METAL POSTS AT EIGHT-FOOT SPACING, OR OF TWO-BY-FOUR INCH POSTS WITH THREE EQUALLY SPACED TWO-BY-FOUR RAILS. POSTS MAY BE SHIFTED TO AVOID ROOTS.

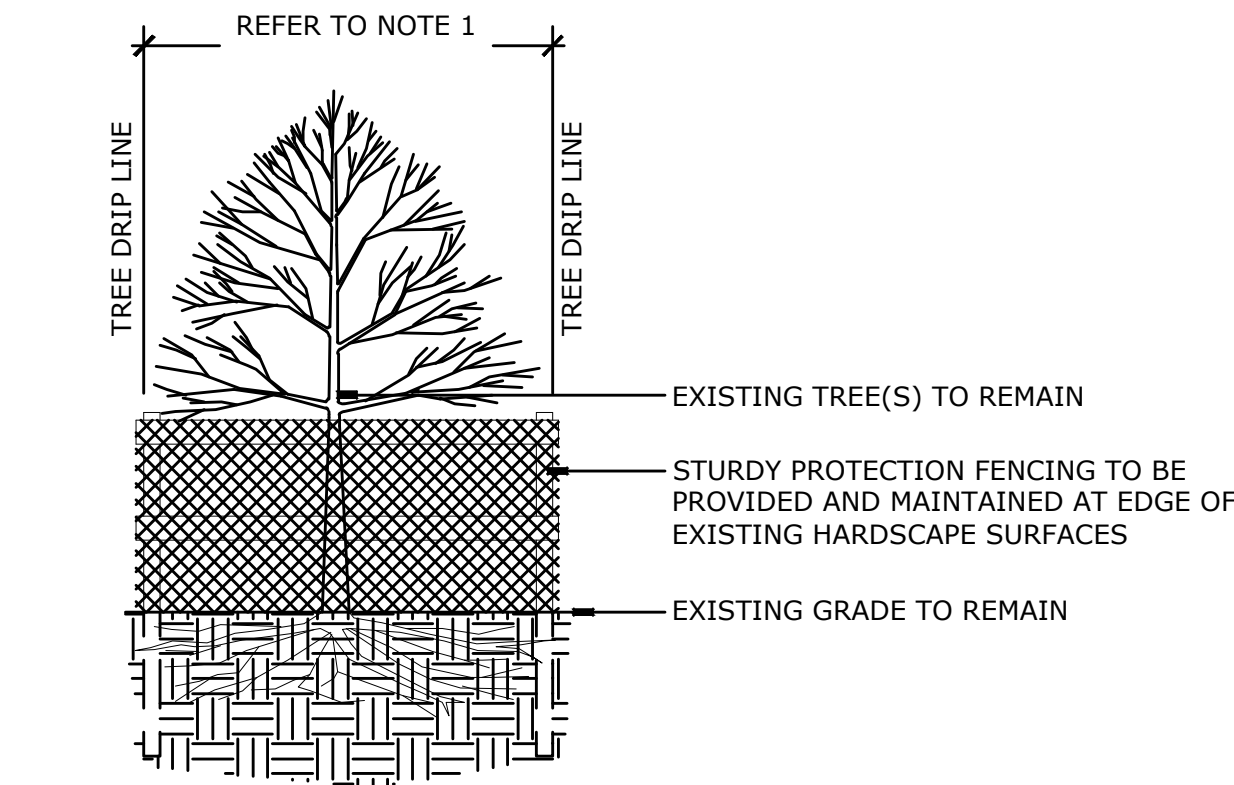

- NOTE:
1. DUE TO SITE CONSTRAINTS TREE PROTECTION FENCE MAY BE CONTINUOUS TO PROTECT MULTIPLE TREES. TREE PROTECTION FENCE TO BE INSTALLED AT EDGE OF EXISTING HARDSCAPE. WHERE SPACE ALLOWS TREE PROTECTION FENCE TO ALIGN WITH DRIPLINE OF TREE / PALM.
 2. MAINTAIN FENCE THROUGHOUT CONSTRUCTION.
 3. REFER TO LOCAL, STATE AND FEDERAL JURISDICTIONS AND GOVERNING BODIES/AGENCIES FOR ADDITIONAL REQUIREMENTS.

1 TREE PROTECTION FENCE Scale: 1/4" = 1'- 0"

TREE DISPOSITION SCHEDULE

#	BOTANICAL NAME	COMMON NAME	DBH	HT.	SPREAD	ACTION	NOTES
1	PHOENIX SYLVESTRIS	SILVER DATE PALM	10"	24'	16'	RELOCATE	LOCATION OF PLANT MATERIAL CONFLICTS WITH CONSTRUCTION ENVELOPE
2	PHOENIX SYLVESTRIS	SILVER DATE PALM	10"	24'	16'	RELOCATE	LOCATION OF PLANT MATERIAL CONFLICTS WITH CONSTRUCTION ENVELOPE
3	PHOENIX SYLVESTRIS	SILVER DATE PALM	10"	24'	16'	RELOCATE	LOCATION OF PLANT MATERIAL CONFLICTS WITH CONSTRUCTION ENVELOPE
4	PHOENIX SYLVESTRIS	SILVER DATE PALM	10"	24'	16'	RELOCATE	LOCATION OF PLANT MATERIAL CONFLICTS WITH CONSTRUCTION ENVELOPE
5	MANGIFERA INDICA	MANGO	28"	40'	30'	REMOVE	PLANT MATERIAL DOES NOT CORRESPOND WITH PROPOSED PLANT COMPOSITION
6	MANGIFERA INDICA	MANGO	28"	40'	30'	REMOVE	PLANT MATERIAL DOES NOT CORRESPOND WITH PROPOSED PLANT COMPOSITION
7	MANGIFERA INDICA	MANGO	28"	40'	30'	REMOVE	PLANT MATERIAL DOES NOT CORRESPOND WITH PROPOSED PLANT COMPOSITION
8	MANGIFERA INDICA	MANGO	28"	40'	30'	REMOVE	PLANT MATERIAL DOES NOT CORRESPOND WITH PROPOSED PLANT COMPOSITION
9	MANGIFERA INDICA	MANGO	28"	40'	30'	REMOVE	PLANT MATERIAL DOES NOT CORRESPOND WITH PROPOSED PLANT COMPOSITION
10	MANGIFERA INDICA	MANGO	10"	24'	20'	REMOVE	PLANT MATERIAL DOES NOT CORRESPOND WITH PROPOSED PLANT COMPOSITION

SEAL (S TYLER NIELSEN - LA6667067)

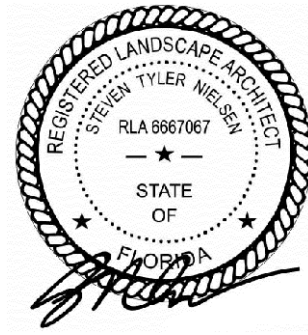

09.07.2021

TREE DISPOSITION NOTES & SCHEDULE	
DATE	ISSUE
07.29.2021	DRB SUBMITTAL
08.11.2021	DRB SUBMITTAL
09.07.2021	FINAL SUBMITTAL

Steven Nielsen Digitally signed by Steven Nielsen Date: 2021.08.31 10:40:32 -04'00'

PINETREE DRIVE

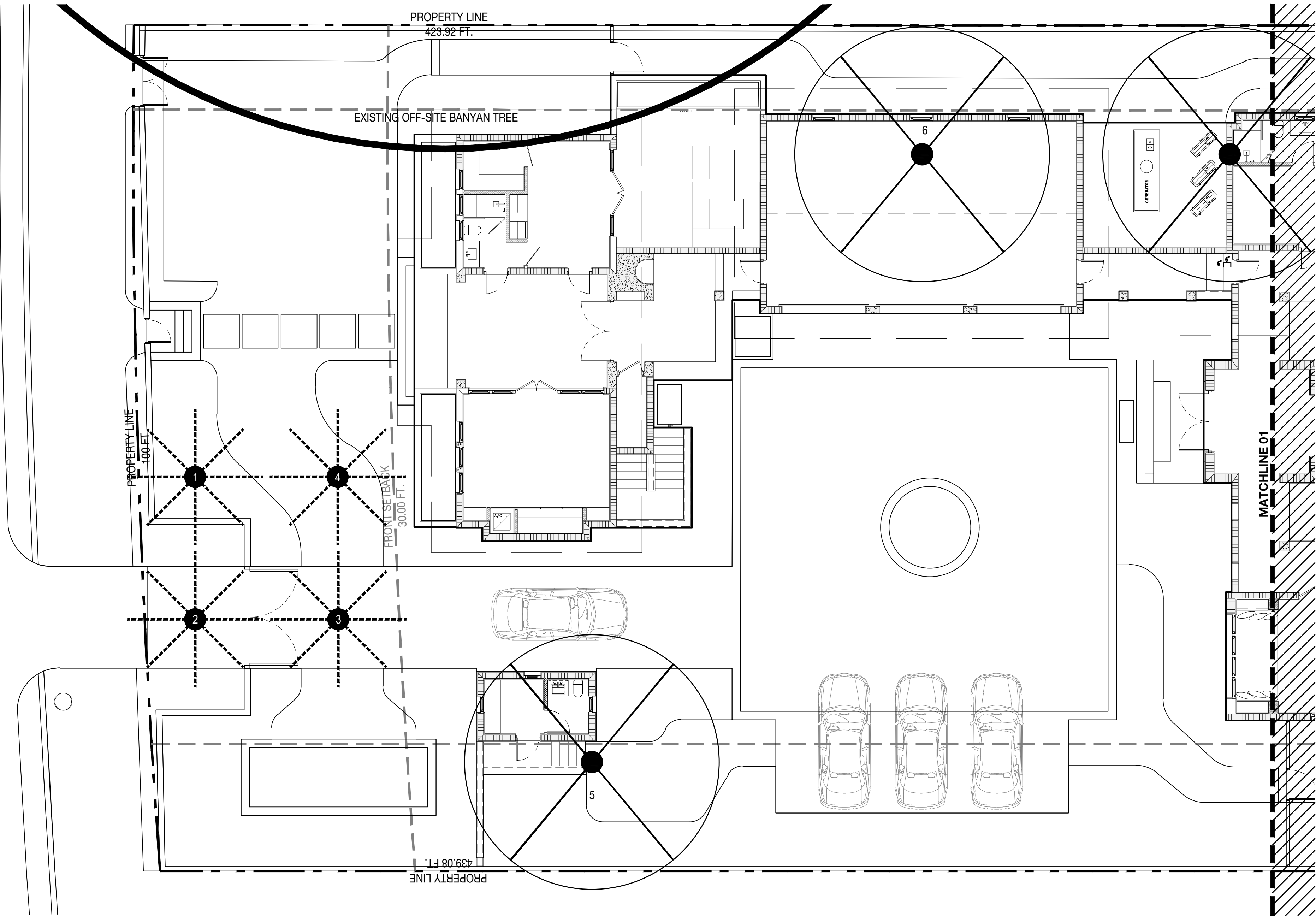

TREE DISPOSITION SCHEDULE

#	BOTANICAL NAME	COMMON NAME	DBH.	HT.	SPREAD	ACTION	NOTES
1	PHOENIX SYLVESTRIS	SILVER DATE PALM	10"	24'	16'	RELOCATE	LOCATION OF PLANT MATERIAL CONFLICTS WITH CONSTRUCTION ENVELOPE
2	PHOENIX SYLVESTRIS	SILVER DATE PALM	10"	24'	16'	RELOCATE	LOCATION OF PLANT MATERIAL CONFLICTS WITH CONSTRUCTION ENVELOPE
3	PHOENIX SYLVESTRIS	SILVER DATE PALM	10"	24'	16'	RELOCATE	LOCATION OF PLANT MATERIAL CONFLICTS WITH CONSTRUCTION ENVELOPE
4	PHOENIX SYLVESTRIS	SILVER DATE PALM	10"	24'	16'	RELOCATE	LOCATION OF PLANT MATERIAL CONFLICTS WITH CONSTRUCTION ENVELOPE
5	MANGIFERA INDICA	MANGO	28"	40'	30'	REMOVE	PLANT MATERIAL DOES NOT CORRESPOND WITH PROPOSED PLANT COMPOSITION
6	MANGIFERA INDICA	MANGO	28"	40'	30'	REMOVE	PLANT MATERIAL DOES NOT CORRESPOND WITH PROPOSED PLANT COMPOSITION
7	MANGIFERA INDICA	MANGO	28"	40'	30'	REMOVE	PLANT MATERIAL DOES NOT CORRESPOND WITH PROPOSED PLANT COMPOSITION
8	MANGIFERA INDICA	MANGO	28"	40'	30'	REMOVE	PLANT MATERIAL DOES NOT CORRESPOND WITH PROPOSED PLANT COMPOSITION
9	MANGIFERA INDICA	MANGO	28"	40'	30'	REMOVE	PLANT MATERIAL DOES NOT CORRESPOND WITH PROPOSED PLANT COMPOSITION
10	MANGIFERA INDICA	MANGO	10"	24'	20'	REMOVE	PLANT MATERIAL DOES NOT CORRESPOND WITH PROPOSED PLANT COMPOSITION

TREE DISPOSITION LEGEND

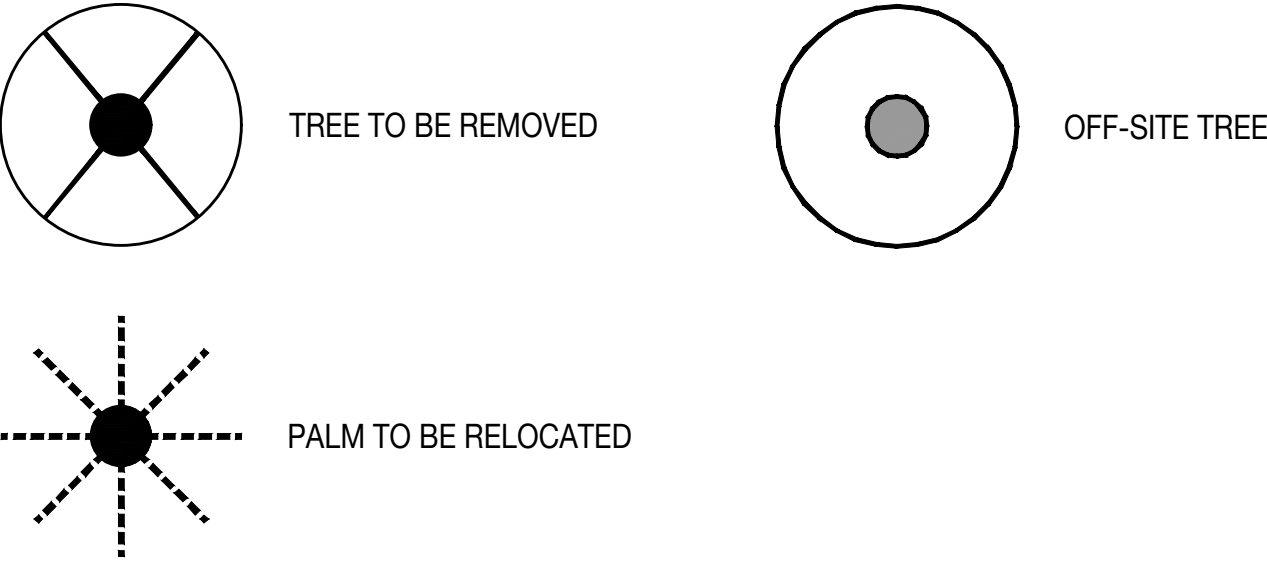

THE BUERSTEDDE GARDEN

4721 PINE TREE DRIVE | MIAMI BEACH, FLORIDA 33140

SEAL (S TYLER NIELSEN - LA6667067)

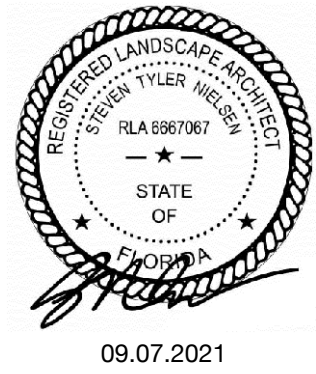

TREE DISPOSITION PLAN A	
DATE	ISSUE
07.29.2021	DRB SUBMITTAL
08.11.2021	DRB SUBMITTAL
09.07.2021	FINAL SUBMITTAL

Steven Nielsen
Digitally signed by Steven Nielsen
Date: 2021.08.31 10:40:45 -04'00'

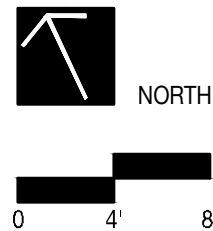

L101

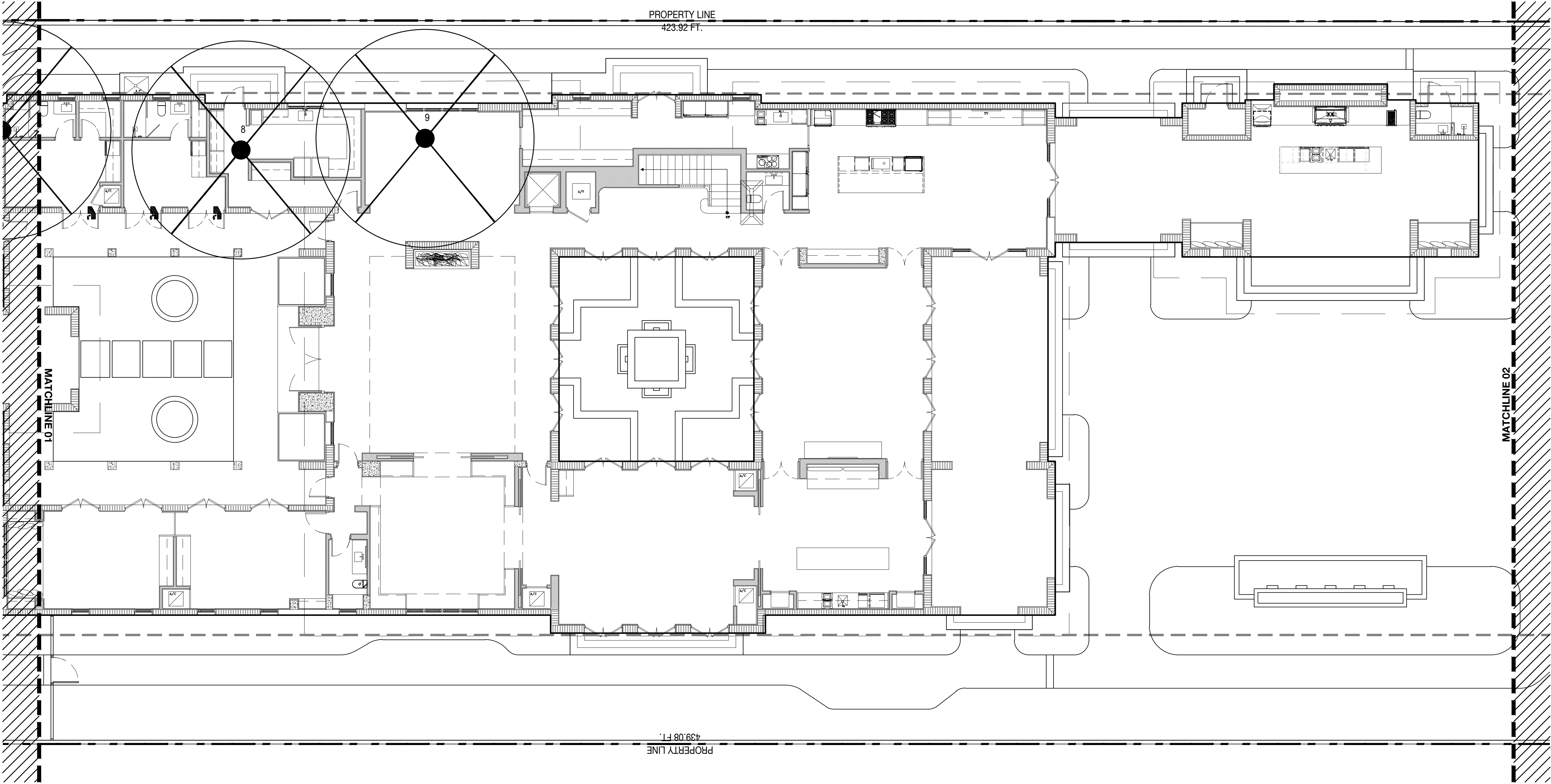

TREE DISPOSITION SCHEDULE

#	BOTANICAL NAME	COMMON NAME	DBH.	HT.	SPREAD	ACTION	NOTES
1	PHOENIX SYLVESTRIS	SILVER DATE PALM	10"	24'	16'	RELOCATE	LOCATION OF PLANT MATERIAL CONFLICTS WITH CONSTRUCTION ENVELOPE
2	PHOENIX SYLVESTRIS	SILVER DATE PALM	10"	24'	16'	RELOCATE	LOCATION OF PLANT MATERIAL CONFLICTS WITH CONSTRUCTION ENVELOPE
3	PHOENIX SYLVESTRIS	SILVER DATE PALM	10"	24'	16'	RELOCATE	LOCATION OF PLANT MATERIAL CONFLICTS WITH CONSTRUCTION ENVELOPE
4	PHOENIX SYLVESTRIS	SILVER DATE PALM	10"	24'	16'	RELOCATE	LOCATION OF PLANT MATERIAL CONFLICTS WITH CONSTRUCTION ENVELOPE
5	MANGIFERA INDICA	MANGO	28"	40'	30'	REMOVE	PLANT MATERIAL DOES NOT CORRESPOND WITH PROPOSED PLANT COMPOSITION
6	MANGIFERA INDICA	MANGO	28"	40'	30'	REMOVE	PLANT MATERIAL DOES NOT CORRESPOND WITH PROPOSED PLANT COMPOSITION
7	MANGIFERA INDICA	MANGO	28"	40'	30'	REMOVE	PLANT MATERIAL DOES NOT CORRESPOND WITH PROPOSED PLANT COMPOSITION
8	MANGIFERA INDICA	MANGO	28"	40'	30'	REMOVE	PLANT MATERIAL DOES NOT CORRESPOND WITH PROPOSED PLANT COMPOSITION
9	MANGIFERA INDICA	MANGO	28"	40'	30'	REMOVE	PLANT MATERIAL DOES NOT CORRESPOND WITH PROPOSED PLANT COMPOSITION
10	MANGIFERA INDICA	MANGO	10"	24'	20'	REMOVE	PLANT MATERIAL DOES NOT CORRESPOND WITH PROPOSED PLANT COMPOSITION

TREE DISPOSITION LEGEND

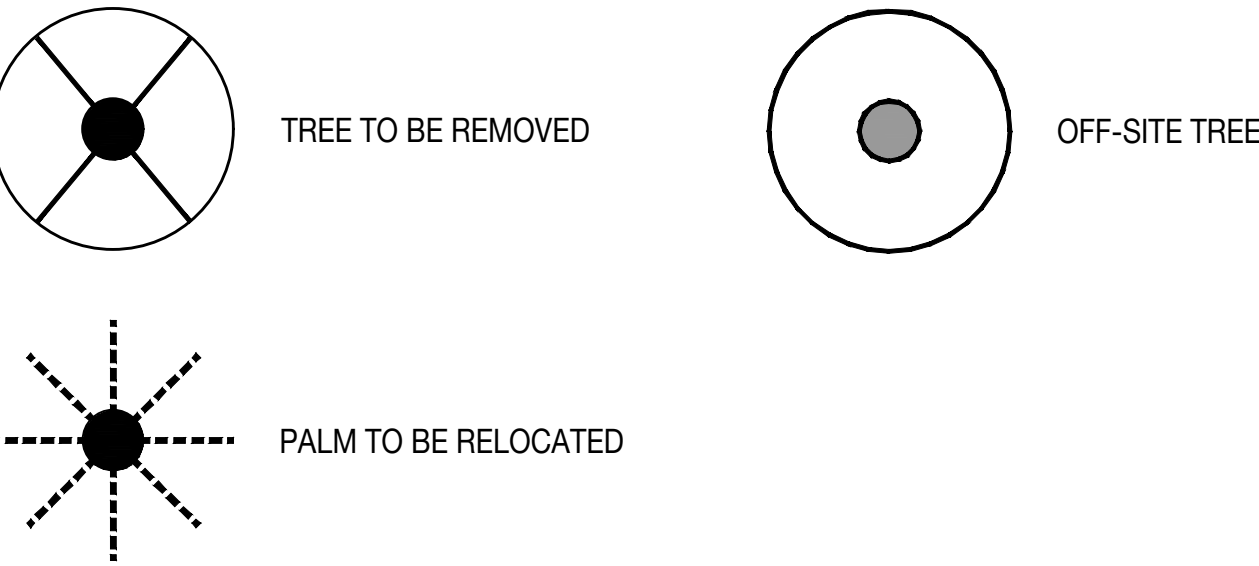

SEAL (S TYLER NIELSEN - LA6667067)



TREE DISPOSITION PLAN B	
DATE	ISSUE
07.29.2021	DRB SUBMITTAL
08.11.2021	DRB SUBMITTAL
09.07.2021	FINAL SUBMITTAL

Steven
Nielsen

Digitally signed
by Steven Nielsen
Date: 2021.08.31
10:41:00 -04'00'

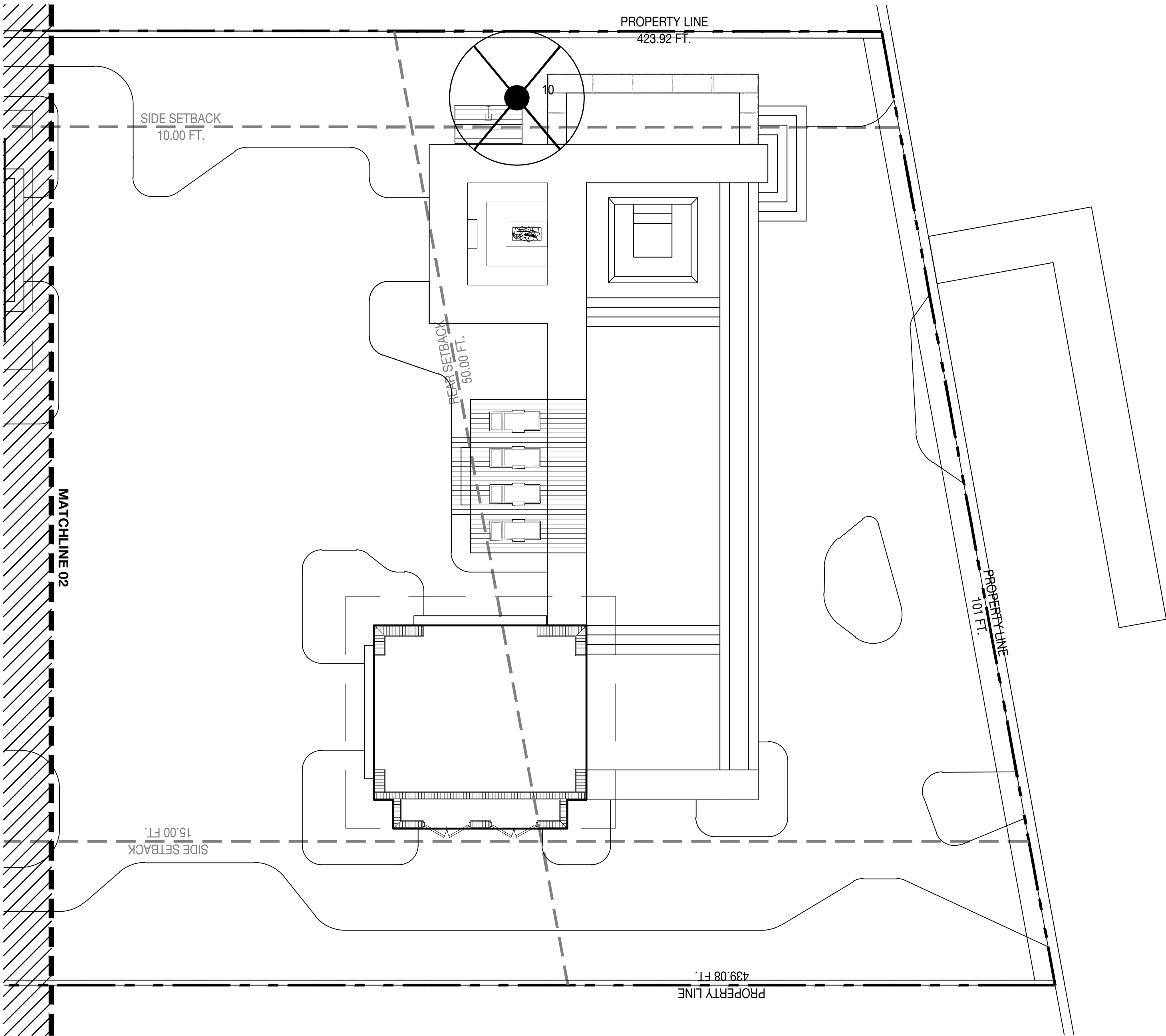

THE BUERSTEDDE GARDEN

4721 PINE TREE DRIVE | MIAMI BEACH, FLORIDA 33140

TREE DISPOSITION SCHEDULE

#	BOTANICAL NAME	COMMON NAME	DBH.	HT.	SPREAD	ACTION	NOTES
1	PHOENIX SYLVESTRIS	SILVER DATE PALM	10"	24'	16'	RELOCATE	LOCATION OF PLANT MATERIAL CONFLICTS WITH CONSTRUCTION ENVELOPE
2	PHOENIX SYLVESTRIS	SILVER DATE PALM	10"	24'	16'	RELOCATE	LOCATION OF PLANT MATERIAL CONFLICTS WITH CONSTRUCTION ENVELOPE
3	PHOENIX SYLVESTRIS	SILVER DATE PALM	10"	24'	16'	RELOCATE	LOCATION OF PLANT MATERIAL CONFLICTS WITH CONSTRUCTION ENVELOPE
4	PHOENIX SYLVESTRIS	SILVER DATE PALM	10"	24'	16'	RELOCATE	LOCATION OF PLANT MATERIAL CONFLICTS WITH CONSTRUCTION ENVELOPE
5	MANGIFERA INDICA	MANGO	28"	40'	30'	REMOVE	PLANT MATERIAL DOES NOT CORRESPOND WITH PROPOSED PLANT COMPOSITION
6	MANGIFERA INDICA	MANGO	28"	40'	30'	REMOVE	PLANT MATERIAL DOES NOT CORRESPOND WITH PROPOSED PLANT COMPOSITION
7	MANGIFERA INDICA	MANGO	28"	40'	30'	REMOVE	PLANT MATERIAL DOES NOT CORRESPOND WITH PROPOSED PLANT COMPOSITION
8	MANGIFERA INDICA	MANGO	28"	40'	30'	REMOVE	PLANT MATERIAL DOES NOT CORRESPOND WITH PROPOSED PLANT COMPOSITION
9	MANGIFERA INDICA	MANGO	28"	40'	30'	REMOVE	PLANT MATERIAL DOES NOT CORRESPOND WITH PROPOSED PLANT COMPOSITION
10	MANGIFERA INDICA	MANGO	10"	24'	20'	REMOVE	PLANT MATERIAL DOES NOT CORRESPOND WITH PROPOSED PLANT COMPOSITION

TREE DISPOSITION LEGEND

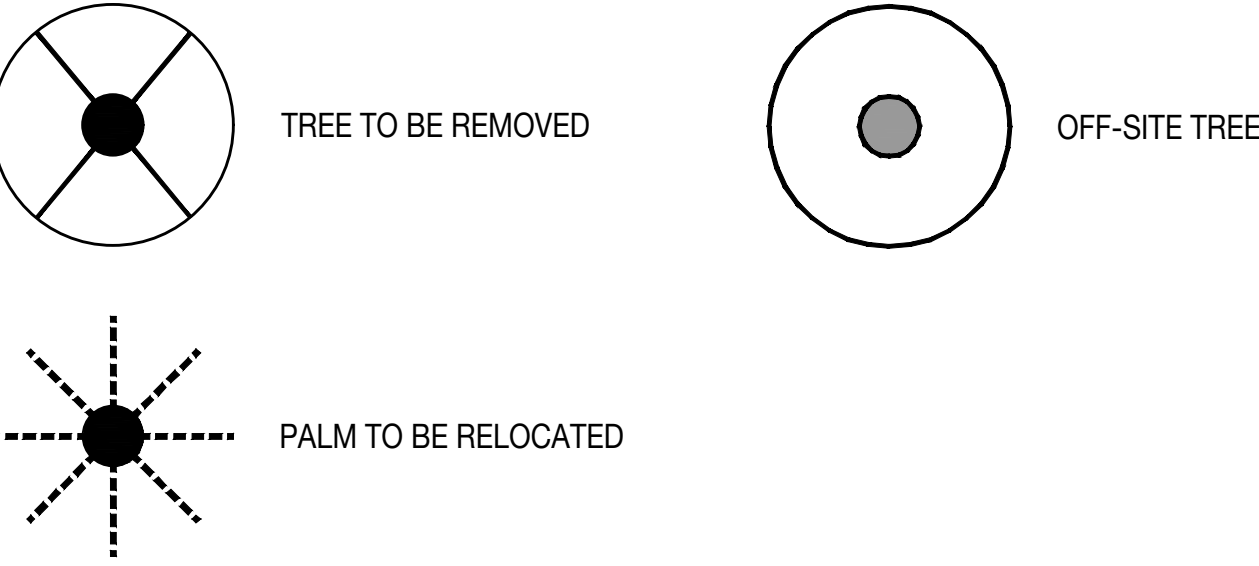

SEAL (S TYLER NIELSEN - LA6667067)



TREE DISPOSITION PLAN C	
DATE	ISSUE
07.29.2021	DRB SUBMITTAL
08.11.2021	DRB SUBMITTAL
09.07.2021	FINAL SUBMITTAL

Steven
Nielsen

Digitally signed
by Steven Nielsen
Date: 2021.08.31
10:41:13 -04'00'

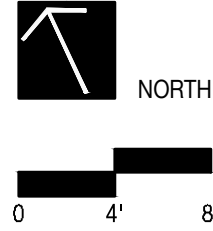

L103