

OCEAN TERRACE, MIAMI BEACH, FL 33141

OCEAN TERRACE, MIAMI BEACH, FL 33141

[illegible]

LANDSCAPE ARCHITECT:

FLORIDA LICENSE NO.
LA 0000856
valid for construction unless signed in this box

SITE SECTIONS

Scale: AS NOTED
 Drawn By: .
 Checked By: .
 Date: 06/14/2021

SHEET NUMBER:

LH.400



23' RAISED PLANTER WITH PERIMETER BENCH

100'
LAWN

9'
STEPS

15'
EACHWALK

BEACH DUNE

EROSION CONTROL LINE

1 SECTION E-W: 74TH STREET
Scale: See Scale Bar

Scale: See Scale Bar

GENERAL NOTES:
ALL TREES 8'-0" CLEAR HEIGHT TO LOWEST BRANCHES TO MAINTAIN VISIBILITY.
ALL SHRUBS 3'-0" MAXIMUM HEIGHT TO MAINTAIN VISIBILITY.
ALL IMPERVIOUS SURFACES SLOPE TOWARDS PLANTING AREAS.

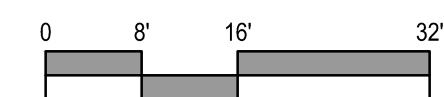

OCEAN TERRACE
OCEAN TERRACE, MIAMI BEACH, FL 33141

SUBMISSION:
06/25/2021 HPB SUBMITTAL - REVISION 1

No.	Date	Description
AL: LANDSCAPE ARCHITECT:		

FLORIDA LICENSE NO.
LA 0000856
valid for construction unless signed in this box

ET TITLE:

SITE SECTIONS

le: AS NOTED

Checked By: .

ET NUMBER:

LH.401

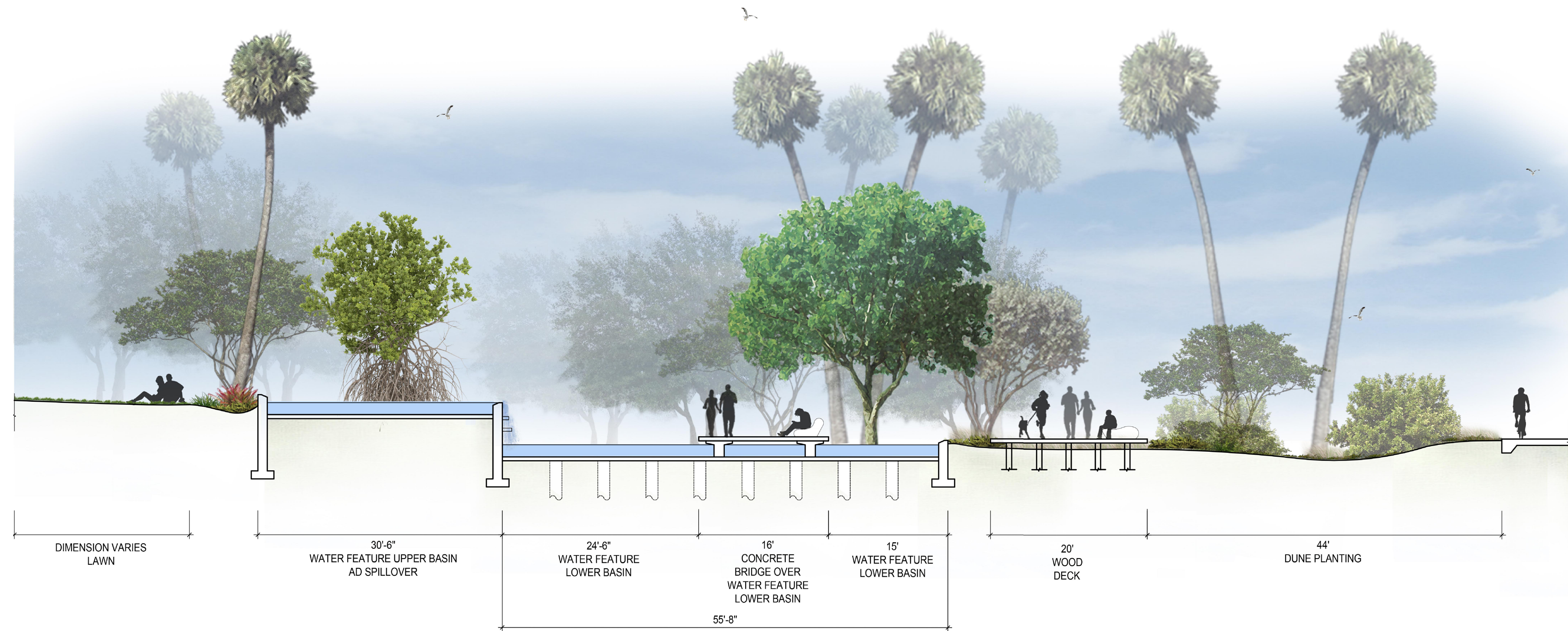
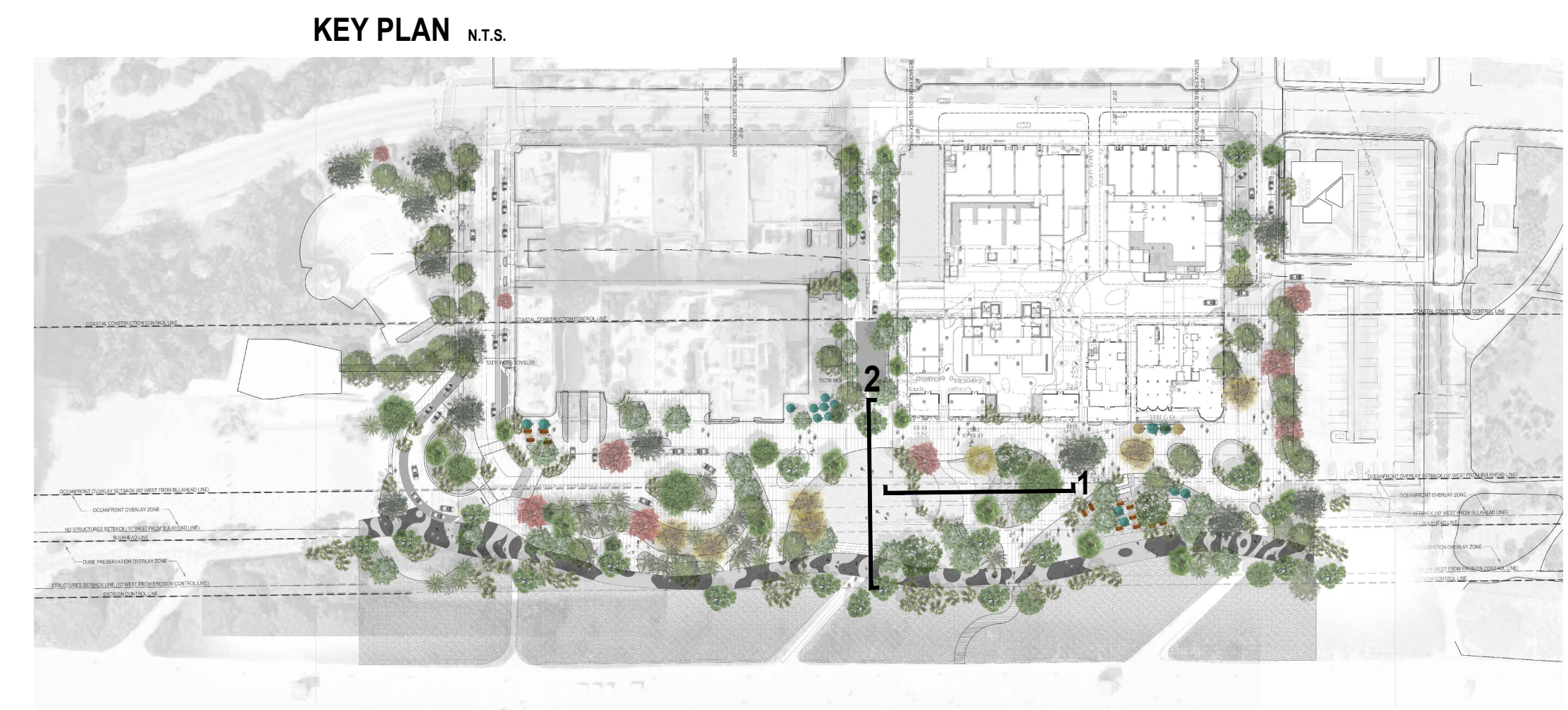

1 SECTION N-S: CENTRAL WATER FEATURE
Scale: See Scale Bar



2 SECTION E-W: BEACHWALK TO ELEVATED LAWN
Scale: See Scale Bar

GENERAL NOTES:
ALL TREES 8'-0" CLEAR HEIGHT TO LOWEST BRANCHES TO MAINTAIN VISIBILITY.
ALL SHRUBS 3'-0" MAXIMUM HEIGHT TO MAINTAIN VISIBILITY.
ALL IMPERVIOUS SURFACES SLOPE TOWARDS PLANTING AREAS.

