

MATERIALS NOTES

1. CONTRACTOR TO VERIFY ALL QUANTITIES. IN CASE OF ANY DISCREPANCIES, GRAPHICALLY SHOWN MATERIAL QUANTITIES SHALL TAKE PRECEDENCE.
2. ALL CONSTRUCTION AND MATERIALS NOT SPECIFICALLY ADDRESSED IN THE CONTRACT DOCUMENTS OR SPECIFICATIONS SHALL BE IN ACCORDANCE WITH LOCAL, STATE AND FEDERAL JURISDICTIONS AND GOVERNING BODIES/AGENCIES STANDARDS.
3. THE CONTRACTOR SHALL PROVIDE A FULL-SCALE MOCKUP AND RECEIVE APPROVAL FROM THE LANDSCAPE ARCHITECT FOR ALL SYSTEMS BEFORE BEGINNING CONSTRUCTION OF PAVEMENT.
4. EXPANSION JOINTS SHALL BE PROVIDED WHERE FLATWORK MEETS VERTICAL STRUCTURES, SUCH AS WALLS, CURBS, STEPS, AND OTHER HARDSCAPE ELEMENTS. EXPANSION JOINTS SHALL ALSO BE PROVIDED AT MATERIAL CHANGES. EXPANSION JOINT MATERIALS/METHODS SHALL BE SUBMITTED TO THE LANDSCAPE ARCHITECT FOR REVIEW AND APPROVAL PRIOR TO INSTALLATION.
5. CONTROL JOINTS SHOULD BE SPACED NO GREATER THAN TEN (10) LINEAR FEET MAXIMUM, UNLESS OTHERWISE SPECIFIED. EXPANSION JOINTS SHOULD BE SPACED NO GREATER THAN FORTY (40) LINEAR FEET MAXIMUM, UNLESS OTHERWISE SPECIFIED. CONTRACTOR SHALL ADVISE ON OTHER JOINTS AS NEEDED TO MINIMIZE CRACKING. THIS INFORMATION SHALL BE SUBMITTED TO THE LANDSCAPE ARCHITECT FOR REVIEW AND APPROVAL PRIOR TO INSTALLATION.
6. CONTROL JOINTS SHALL BE PROVIDED AS SPECIFIED IN THE CONTRACT DOCUMENTS. CONTROL JOINT MATERIALS, METHODS AND RECOMMENDATIONS ON ADDITIONAL CONTROL JOINTS TO MINIMIZE CRACKING SHALL BE SUBMITTED TO THE LANDSCAPE ARCHITECT FOR REVIEW AND APPROVAL.
7. ALL STEPS SHALL HAVE TWELVE (12) INCH TREADS AND SIX (6) INCH RISERS, UNLESS OTHERWISE SPECIFIED.
8. HOLD TOP OF WALLS AND FENCES LEVEL, UNLESS OTHERWISE SPECIFIED.
9. CONTRACTOR SHALL NOT INSTALL WORK LOCATED ON TOP OF ARCHITECTURAL STRUCTURES WITHOUT FIRST REVIEWING ARCHITECTURAL DRAWINGS.
10. SAMPLES OF SPECIFIED MATERIALS SHALL BE SUBMITTED TO THE LANDSCAPE ARCHITECT FOR REVIEW AND APPROVAL PRIOR TO ORDERING FOR JOB.



A

MATERIAL: GRANITE PAVERS  
LOCATION: DRIVEWAY  
SPECS: AS PER MANUFACTURER'S SPECS  
SIZE: 4" x 4" x 4"  
SOURCE: T.B.D.



B

MATERIAL: CRUSHED GRANITE FINES  
LOCATION: PEDESTRIAN CIRCULATION  
SPECS: "SALT & PEPPER"  
SIZE: 1/2" - 1" Ø  
SOURCE: BERNIE'S ROCK & GARDEN  
www.berniesrockandgarden.com  
786.242.4443



C

MATERIAL: IPE HARDWOOD  
LOCATION: POOL DECK & OUTDOOR SHOWERS AREA  
SPECS: CLIPPED  
SIZE: REFER TO DETAILS  
SOURCE: T.B.D.

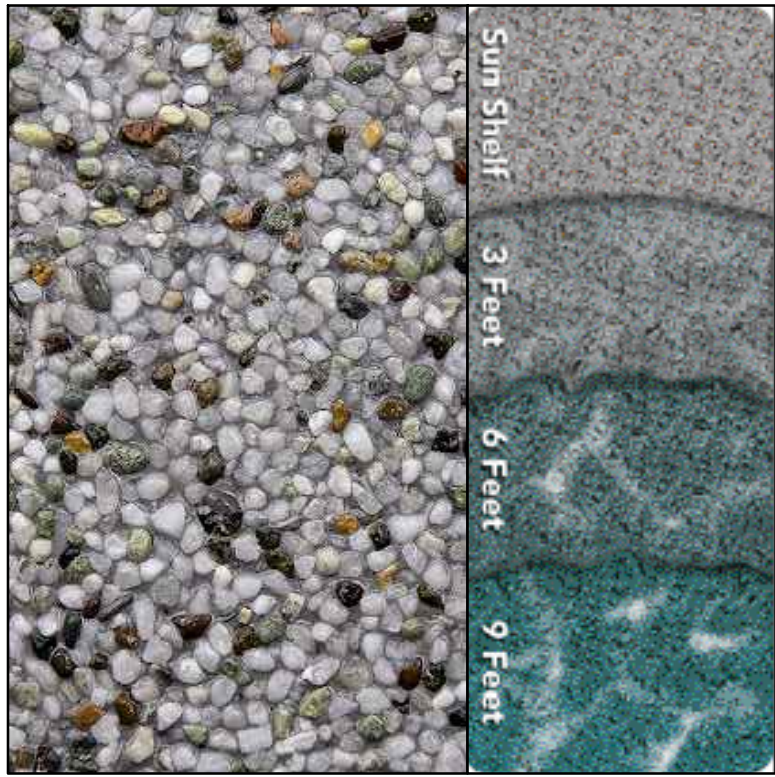

D

MATERIAL: PEEBLETEC - MIDNIGHT GREY  
LOCATION: WATER FEATURES / POOL  
SPECS: PER MANUFACTURER  
SOURCE: PEEBLETEC®  
www.peebletec.com



E

MATERIAL: DOMINICAN CORAL STONE  
LOCATION: POOL TERRACE  
SPECS: SAW CUT  
SIZE: REFER TO DETAILS  
SOURCE: EPIC STONE WORKS SOUTH FLORIDA  
305.255.2848  
www.epicstoneworks.com



F

MATERIAL: ALUMINUM PRO-LINE LANDSCAPE EDGING  
LOCATION: LANDSCAPE AREAS  
SPECS: 1/8" x 4" - BLACK  
SOURCE: PERMALOC  
www.permaloc.com  
800.356.9660



G

MATERIAL: OUTDOOR SHOWER MODEL "PIPE"  
LOCATION: AS SHOWN ON PLAN  
SPECS: SATIN STAINLESS STEEL AISI 304  
SOURCE: BOFFI  
www.boffi.com

LAND

7294 NW 1st COURT, MIAMI FL 33150  
614.439.4895 | www.land.design

LAKE HOUSE RESIDENCE  
2581 LAKE AVE. MIAMI BEACH, FL

DESIGN REVIEW BOARD  
FINAL SUBMISSION  
NOT FOR CONSTRUCTION

SEAL (MARSH C. KRIPLEN-LA6667007)



Digitally signed  
by marsh c kriplen  
Date: 2021.05.07  
15:07:32 -04'00'

MATERIALS SCHEDULE & NOTES

DATE	ISSUE
05/07/2021	FINAL DRB SUBMITTAL

L200



**LAND**

7294 NW 1st COURT, MIAMI FL 33150  
614.439.4895 | www.land.design

# LAKE HOUSE RESIDENCE

2581 LAKE AVE. MIAMI BEACH, FL

DESIGN REVIEW BOARD  
FINAL SUBMISSION  
NOT FOR CONSTRUCTION

SEAL (MARSH C. KRIPLEN-LA6667007)

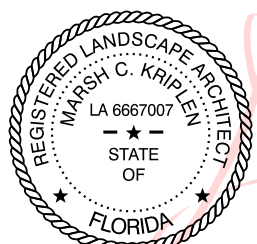

Digitally signed  
by marsh c  
kriplen  
Date: 2021.05.07  
15:08:28 -04'00'

**MATERIALS PLAN**  
DATE: 05/07/2021  
ISSUE: FINAL DRB SUBMITTAL

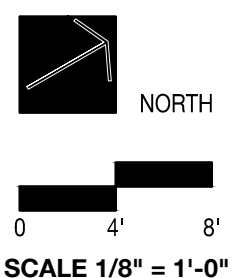

SCALE 1/8" = 1'-0"

**L210**

© COPYRIGHT LAND

PLANTING NOTES

1.

PLANT MATERIAL IS TO BE HEALTHY SPECIMENS FREE FROM DISEASE OR DAMAGE, AND IS TO BE MAINTAINED IN EXCELLENT CONDITION WHILE ON THE JOBSITE. LANDSCAPE ARCHITECT SHALL INSPECT PLANT MATERIAL UPON ARRIVAL TO JOBSITE AND WILL REJECT PLANT MATERIAL THAT DOES NOT MEET THE STANDARDS DESCRIBED WITHIN THE CONTRACT DOCUMENTS.
2.

THE LANDSCAPE ARCHITECT WILL PERIODICALLY INSPECT PLANT MATERIAL STOCKPILED AND/OR PLANTED ON SITE DURING THE COURSE OF CONSTRUCTION. PLANT MATERIAL NOT MEETING THE STANDARDS CONTAINED WITHIN CONTRACT DOCUMENTS SHALL BE REPLACED AT NO COST TO THE OWNER.
3.

PROVIDE MATCHING SIZES AND FORMS FOR EACH PLANT OF THE SAME SPECIES UNLESS OTHERWISE INDICATED.
4.

CONTRACTOR TO VERIFY ALL QUANTITIES. IN CASE OF DISCREPANCIES, GRAPHICALLY SHOWN QUANTITIES SHALL TAKE PRECEDENCE.
5.

ALL MATERIALS USED SHALL CONFORM TO THE GUIDELINES ESTABLISHED BY THE CURRENT AMERICAN STANDARDS FOR NURSERY STOCK, PUBLISHED BY THE AMERICAN ASSOCIATION OF NURSERYMEN.
6.

ALL PLANT MATERIAL SHALL BE INSTALLED PLUMB AND PER THE SPECIFICATIONS CONTAINED WITHIN THE CONTRACT DOCUMENTS. ANY NECESSARY STAKING AND/OR OTHER SUPPORTS MATERIALS/METHODS SHALL BE SUBMITTED TO THE LANDSCAPE ARCHITECT FOR REVIEW AND APPROVAL PRIOR TO INSTALLATION.
7.

THE CONTRACTOR SHALL PRUNE EXISTING AND/OR NEW TREES ONLY PER LANDSCAPE ARCHITECT DIRECTION.
8.

THE CONTRACTOR SHALL STAKE THE LOCATIONS OF ALL TREES AND B&B SHRUBS FOR LANDSCAPE ARCHITECT REVIEW AND APPROVAL, PRIOR TO INSTALLATION.
9.

ALL ROOT-WRAPPING MATERIALS THAT ARE NOT BIO-DEGRADABLE SHALL BE REMOVED FROM THE ROOT BALL. ROOT BALLS SHALL BE FREE OF WEEDS.
10.

SPECIFIED PLANT MATERIAL SIZES SHALL BE CONSIDERED MINIMUM SIZES.
11.

FINISH GRADE OF PLANTING BEDS SHALL BE ONE (1) INCH BELOW ADJACENT FLATWORK, UNLESS SPECIFIED OTHERWISE.
12.

MULCH OR PLANTING BED DRESSING SHALL BE PLACED IN ALL PLANTING AREAS AS SPECIFIED. MULCH OR PLANTING BED DRESSING SHALL NOT BE PLACED WITHIN SIX (6) INCHES OF TREE TRUNKS. MULCHING SHOULD BE REPEATED ANNUALLY DURING THE AUTUMN TO A THREE (3) INCH DEPTH.
13.

ALL PLANT MATERIAL SHOULD RECEIVE AN ORGANIC FERTILIZER IN LIMITED APPLICATION FOLLOWING INSTALLATION. TYPE AND APPLICATION RATE AND METHOD OF APPLICATION TO BE SPECIFIED BY THE CONTRACTOR AND APPROVED BY THE LANDSCAPE ARCHITECT.
14.

EXCESS FERTILIZER SHALL BE DISPOSED OF PROPERLY OFF-SITE. IT SHALL NOT BE DISPOSED OF IN STORM DRAINS AND/OR DRYWELLS.
15.

STOCKPILED PLANT MATERIAL TO BE PLACED IN THE SHADE AND PROPERLY HAND-WATERED UNTIL PLANTED.
16.

MINI-NUGGET TYPE DECORATIVE BARK MULCH WILL BE USED TO RETURN NUTRIENTS TO THE SOIL, REDUCE MAINTENANCE AND MINIMIZE EVAPORATION FOR AREAS APPROXIMATE TO THE RESIDENCE. LARGER SHREDDED BARK MULCH WILL BE USED FOR STEEP AREAS SO SLOUGHING IS LESS LIKELY TO OCCUR.
17.

PRESERVE & PROTECT ALL EXISTING VEGETATION INDICATED TO REMAIN AT ALL TIMES.
18.

ALL VEGETATION PROPOSED FOR OUTSIDE THE BUILDING ENVELOPE TO BE NATIVE UNLESS OTHERWISE NOTED. PLANTING THAT OCCURS OUTSIDE THE BUILDING ENVELOPE IS FOR RESTORATION PURPOSES ONLY OR IS SPECIFIC TO UTILITIES RESTORATION.
19.

SIX (6) INCH PLANT MIX SHALL BE PROVIDED FOR ALL LAWN, TURF, AND NATIVE PLANTING ZONES. 18 INCH PLANT MIX SHALL BE PROVIDED FOR ALL PERENNIAL PLANTING BEDS UNLESS OTHERWISE NOTED.

TREES & PALMS PLANTING SCHEDULE

ABR	QTTY	BOTANICAL NAME	COMMON NAME	SPECIFICATIONS
TREES				
CGR	1	CAESALPINA GRANADILLO	BRIDALVEIL	200 GAL / 2" DBH / 18' HT MIN
COE	2	CONOCARPUS ERECTUS	GREEN BUTTOM WOOD	200 GAL / 2" DBH / 18' HT MIN
CRO	3	CLUSIA ROSEA	AUTOGRAPH TREE	200 GAL / 2" DBH / 18' HT MIN
CUV	1	COCOLOBA UVIFERA	SEA GRAPE	200 GAL / 3" DBH / 18' HT MIN
FBE	1	FICUS BENGHALENSIS	BANYAN TREE	FG 30' x 30'
MIN	1	MAGNIFERA INDICA	MANGO TREE	200 GAL / 2" DBH / 18' HT MIN
PALMS				
AAL	3	ARCHONTOPHOENIX ALEXANDRAE	ALEXANDER PALM	FG 20' OA
CNU1	1	COCOS NUCIFERA	COCONUT PALM	FG 25' CT
CNU2	3	COCOS NUCIFERA	COCONUT PALM	FG 30' CT
CNU3	2	COCOS NUCIFERA	COCONUT PALM	FG 40' CT
DAL1	2	DICTYOSPERMA ALBUM	HURRICANE PALM	FG 25' CT
DAL2	2	DICTYOSPERMA ALBUM	HURRICANE PALM	FG 30' CT
DAL3	2	DICTYOSPERMA ALBUM	HURRICANE PALM	FG 35' CT
EGU	3	ELAEIS GUINEENSIS	OIL PALM	FG 25' CT
SDO	2	SABAL DOMINIGENSIS	DOMINICAN SABAL	FG 40' CT
SPA1	2	SABAL PALMETTO	SABAL PALM	FG 25' CT
SPA2	2	SABAL PALMETTO	SABAL PALM	FG 30' CT
SPA3	2	SABAL PALMETTO	SABAL PALM	FG 35' CT
BAMBOO				
BCH	2	BAMBUSA CHUNGI	BLUE BAMBOO	25' HT
PNI	3	PHYLLOSTACHYS NIGRA	BLACK BAMBOO	25' HT
NATIVE UNDERSTORY TREES				
CWI	9	CANELLA WINTERANA	CINNAMON BARK	100 GAL / 10' HT
EAX	3	EUGENIA AXILLARIS	WHITE STOPPER	100 GAL /12' HT
GLU	15	GYMNANTHES LUCIDA	CRABWOOD	100 GAL /12' HT
MFR	5	MYRCIANTHES FRAGRANS	SIMPSON'S STOPPER	100 GAL /12' HT
PDI	2	PIMENTA DIOICA	ALLPSICE	100 GAL / 10' HT
★ TREE USED TOWARDS MITIGATION				

UNDERSTORY PLANTING SCHEDULE

ABR	QTTY	BOTANICAL NAME	COMMON NAME	SPECIFICATIONS
SHRUBS & GROUNDCOVERS				
AD	113	ASPARAGUS DENSIFLORUS	FOXTAIL FERN	3 GAL /24" O.C.
CI	551	CHRYSOBALANUS ICACO	COCOPLUM	3 GAL / 12" O.C.
CN	65	CLUSIA NANA	DWARF CLUSIA	3 GAL / 24" O.C.
LM	301	LIRIOPE MUSCARI	LILYTURF	1 GAL / 18" O.C.
MD	77	MONSTERA DELICIOSA	SWISS CHEESE PLANT	3 GAL / 48" O.C.
NF	100	NEPHROLEPIS FALCATA	MACHO FERN	3 GAL / 36" O.C.
PG	27	PHILODENDRON GIGANTEUM	GIANT PHILODENDRON	3 GAL / 36" O.C.
PS	422	PHYMATOSORUS SCOLOPENDRIA	WART FERN	1 GAL / 18" O.C.
TM	308	TRADESCANTIA MICROFOLIA	ARGENTINE IVY	1 GAL / 12" OC
GRASSES				
TD	-	TRIPSACUM DACTYLOIDES	FAKAHATCHEE GRASS	3 GAL / 36" O.C.
ZJ	1413 SF	ZOYSIA JAPONICA	ZOYSIA GRASS	SOD

LANDSCAPE LEGEND

MUNICIPALITY: City of Miami Beach			
ZONING CLASS: <b>RS-2</b> LOT AREA: 20,703 ACRES: 0.4753			
ORDINANCE/CODE SECTION: CITY OF MIAMI BEACH SECTION 126			
OPEN SPACE		REQUIRED/ ALLOWED	PROVIDED
A.	Sq. Ft. of required Open Space Lot area: 20,703 Multiplier: 30%	6,211	6,211
B.	Sq. Ft. of parking lot open space Parking Spaces: 2 Multiplier: 10 sf/space	20	20
C.	Total Sq. Ft. of landscaped Open Space required	6,231	6,231
LAWN AREA			
A.	Total Sq. Ft. of landscaped Open Space	6,231	6,231
B.	Maximum Lawn Area (sod) permitted- Open space required: 6,231 Multiplier: 20%	1,246	2,476
TREES			
A.	Number of trees required per lot, less existing trees Required Trees/Lot: 5 Net lot acres: 0.4753 Required Trees: 15 Existing trees: 0	20	20
B.	% Palms allowed Trees provided: 20 Multiplier: 0%	0	0
PER CODE SECTION 126-6.C.10 PALMS DO NOT COUNT TOWARD MIN. TREE REQUIREMENTS			
C.	% Native required Trees provided: 20 Multiplier: 30%	6	6
D.	% Drought tolerant and low maintenance species required Trees provided: 20 Multiplier: 50%	10	10
STREET TREES			
NO WORK IN THE ROW INCLUDED IN THIS SCOPE			
A.	Street trees (maximum average spacing of 20' o.c.) Linear ft of street frontage: 39 Multiplier: 20 Existing trees: 0	2	2
B.	Street trees directly below power lines Linear ft of street frontage: 20 Multiplier: 20	1	0
SHRUBS			
A.	Number of shrubs required Lot and street trees required: 22 Multiplier: 12	264	264
B.	% Native species required Shrubs provided: 264 Multiplier: 50%	132	132
LARGE SHRUBS OR SMALL TREES			
A.	Number of shrubs or small tree required Shrubs required: 264 Multiplier: 10%	27	27
B.	% Native species required Shrubs provided: 27 Multiplier: 50%	14	14

DESIGN REVIEW BOARD  
FINAL SUBMISSION  
NOT FOR CONSTRUCTION

SEAL (MARSH C. KRIPLEN-LA6667007)

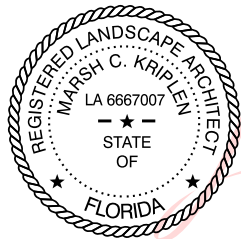

Digitally signed  
by marsh c  
kriplen  
Date: 2021.05.07  
15:08:54 -04'00'

PLANTING SCHEDULE & NOTES	
DATE	ISSUE
05/07/2021	FINAL DRB SUBMITTAL

L400

TREES

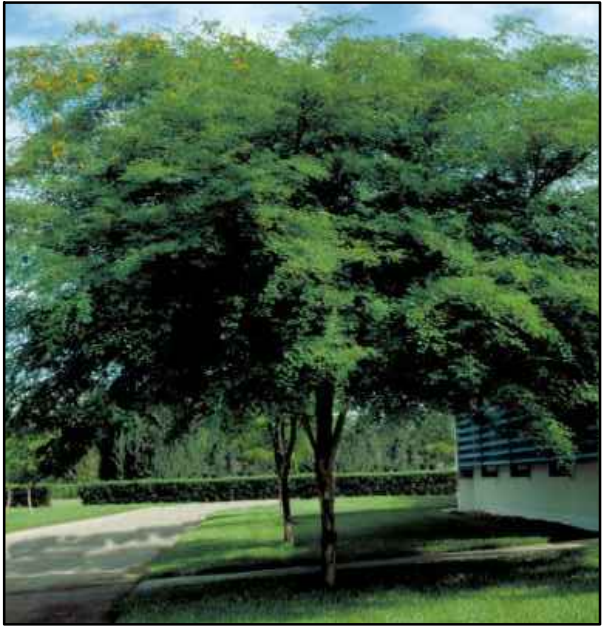

**CGR**  
*CAESALPINIA GRANADILLO*  
BRIDAL VEIL



**COE**  
*CONOCARPUS ERECTUS*  
GREEN BOTTOM WOOD

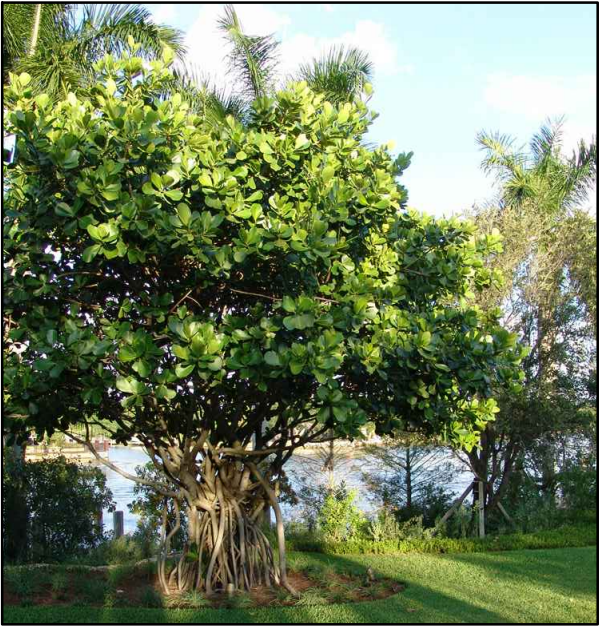

**CRO**  
*CLUSIA ROSEA*  
AUTOGRAPH TREE



**CUV**  
*COCOLOBA UVIFERA*  
SEA GRAPE



**FBE**  
*FICUS BENGHALENSIS*  
BANYAN TREE

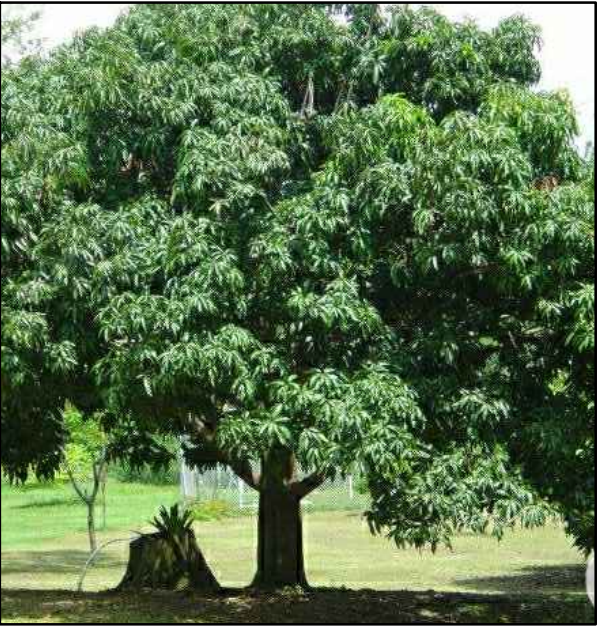

**MIN**  
*MAGNIFERA INDICA*  
MANGO TREE

PALMS



**AAL**  
*ARCHONTOPHOENIX ALEXANDRAE*  
ALEXANDER PALM



**CNU**  
*COCOS NUCIFERA*  
COCONUT PALM



**DAL**  
*DICTYOSPERMA ALBUM*  
HURRICANE PALM



**EGU**  
*ELAEIS GUINEENSIS*  
OIL PALM

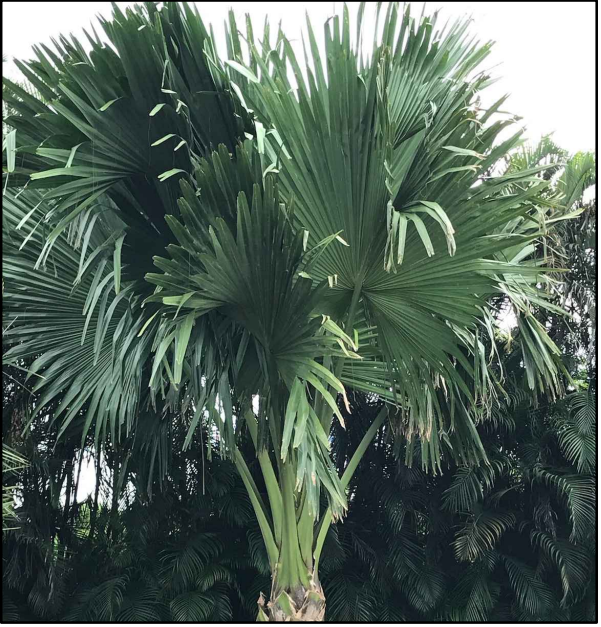

**SDO**  
*SABAL DOMINIGENSIS*  
DOMINICAN SABAL



**SPA**  
*SABAL PALMETTO*  
SABAL PALM



**BCH**  
*BAMBUSA CHUNGI*  
BLUE BAMBOO



**PNI**  
*PHYLLOSTACHYS NIGRA*  
BLACK BAMBOO

NATIVE UNDERSTORY TREES



**CWI**  
*CANELLA WINTERANA*  
CINNAMON BARK



**EAX**  
*EUGENIA AXILLARIS*  
WHITE STOPPER



**GLU**  
*GYMNANTHES LUCIDA*  
CRABWOOD



**MFR**  
*MYRCIANTHES FRAGRANS*  
SIMPSON STOPPER



**PDI**  
*PIMENTA DIOICA*  
ALLSPICE



**TD**  
*TRIPSACUM DACTYLOIDES*  
FAKAHATCHEE GRASS



**ZJ**  
*ZOYSIA JAPONICA*  
ZOYSIA GRASS

SHRUBS & GROUNDCOVERS



**AD**  
*ASPARAGUS DENSIFLORUS*  
FOXTAIL FERN



**CI**  
*CHRYSOBALANUS ICACO*  
COCOPLUM



**CN**  
*CLUSIA NANA*  
DWARF CLUSIA



**LM**  
*LIRIOPE MUSCARI*  
LILYTURF



**MD**  
*MONSTERA DELICIOSA*  
SWISS CHEESE PLANT



**NF**  
*NEPHROLEPIS FALCATA*  
MACHO FERN



**PG**  
*PHILODENDRON GIGANTEUM*  
GIANT PHILODENDRON



**PS**  
*PHYMATOSORUS SCOLOPENDRIA*  
WART FERN

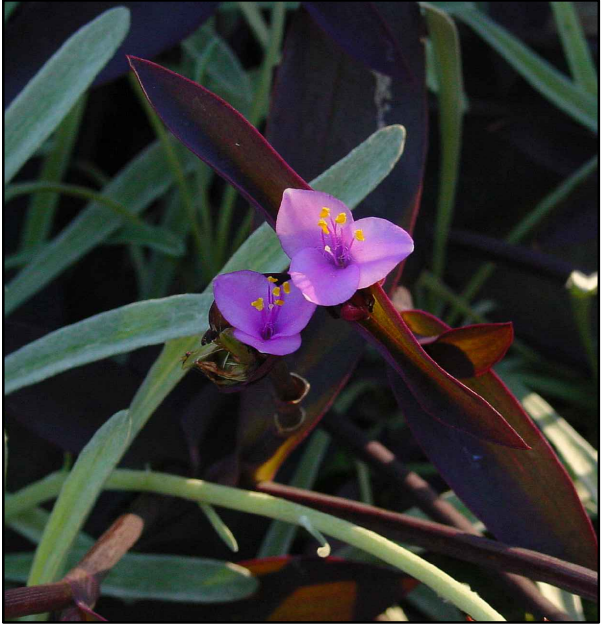

**TM**  
*TRADESCANTIA MICROFOLIA*  
ARGENTINE IVY

PLANTING LEGEND

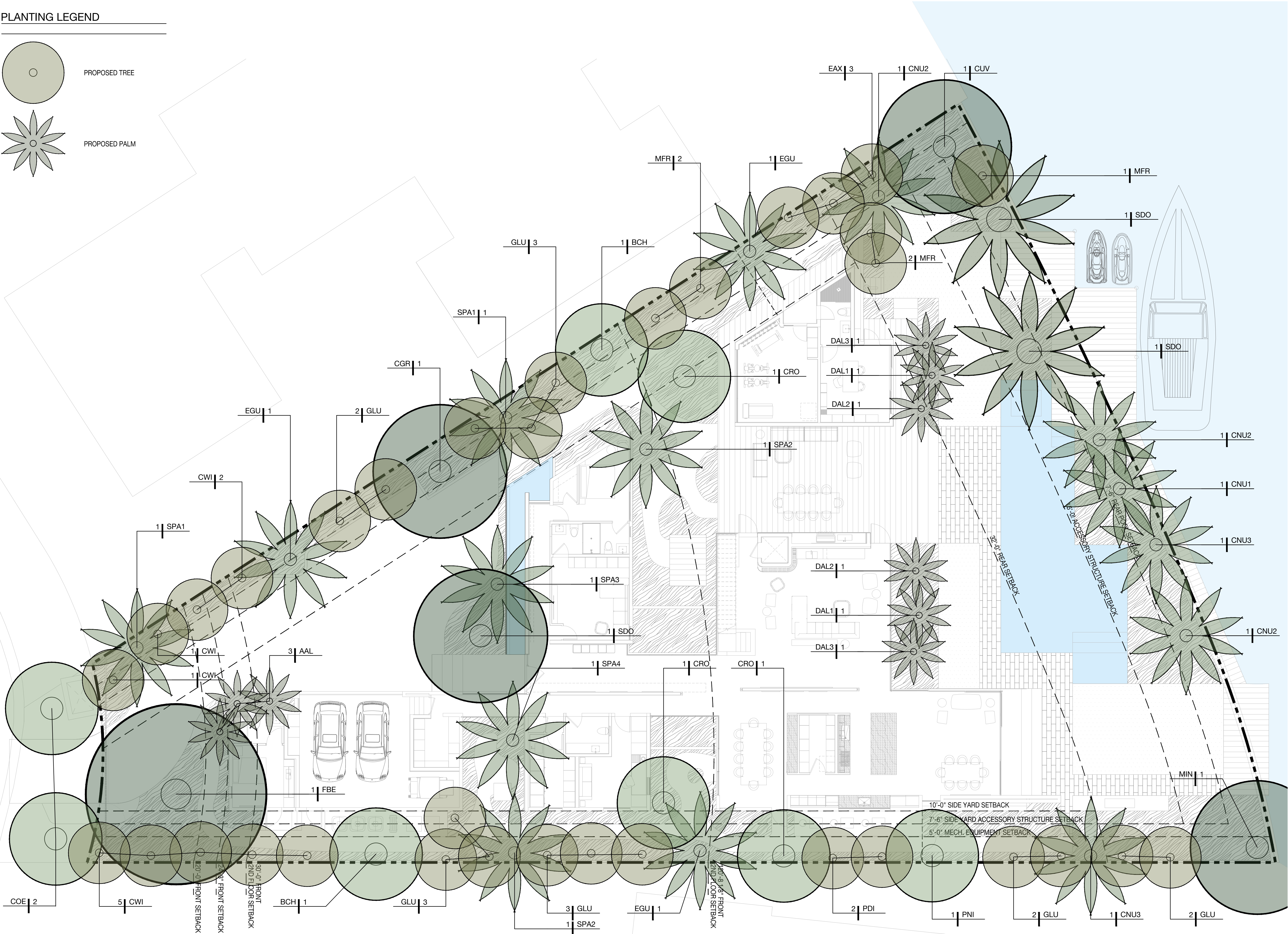
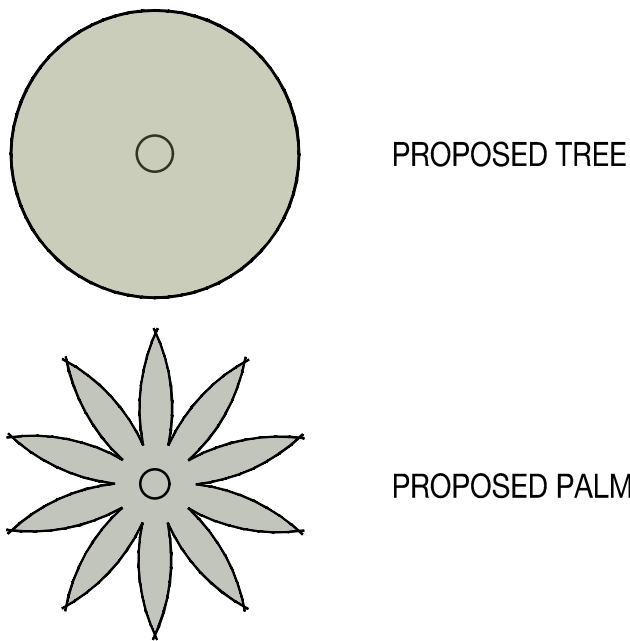

LAND

7294 NW 1st COURT, MIAMI FL 33150  
614.439.4895 | www.land.design

LAKE HOUSE RESIDENCE

2561 LAKE AVE. MIAMI BEACH, FL

DESIGN REVIEW BOARD  
FINAL SUBMISSION  
NOT FOR CONSTRUCTION

SEAL (MARSH C. KRIPLEN-LA6667007)

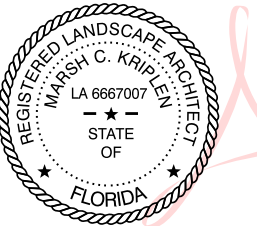

Digitally signed by  
marsh c kriplen  
Date: 2021.05.07  
15:22:32 -04'00'

TREE & PALM PLANTING PLAN  
DATE ISSUE  
05/07/2021 FINAL DRB SUBMITTAL

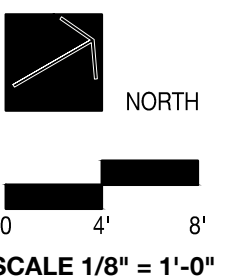

L410

© COPYRIGHT LAND

PLANTING LEGEND

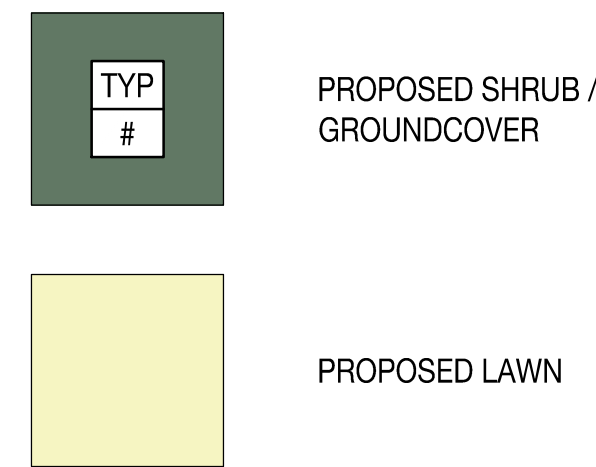

LAND

7294 NW 1st COURT, MIAMI FL 33150  
614.439.4895 | www.land.design

LAKE HOUSE RESIDENCE

2581 LAKE AVE. MIAMI BEACH, FL

DESIGN REVIEW BOARD  
FINAL SUBMISSION  
NOT FOR CONSTRUCTION

SEAL (MARSH C. KRIPLEN-LA6667007)

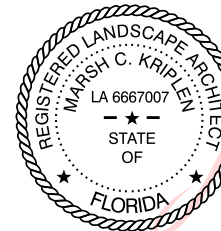

Digitally signed  
by marsh c  
kriplen  
Date: 2021.05.07  
15:23:10 -04'00'

UNDERSTORY PLANTING

DATE ISSUE  
05/07/2021 FINAL DRB SUBMITTAL

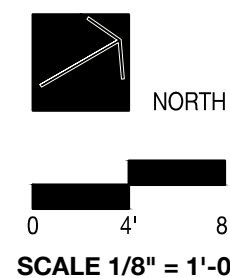

SCALE 1/8" = 1'-0"

L420

© COPYRIGHT LAND

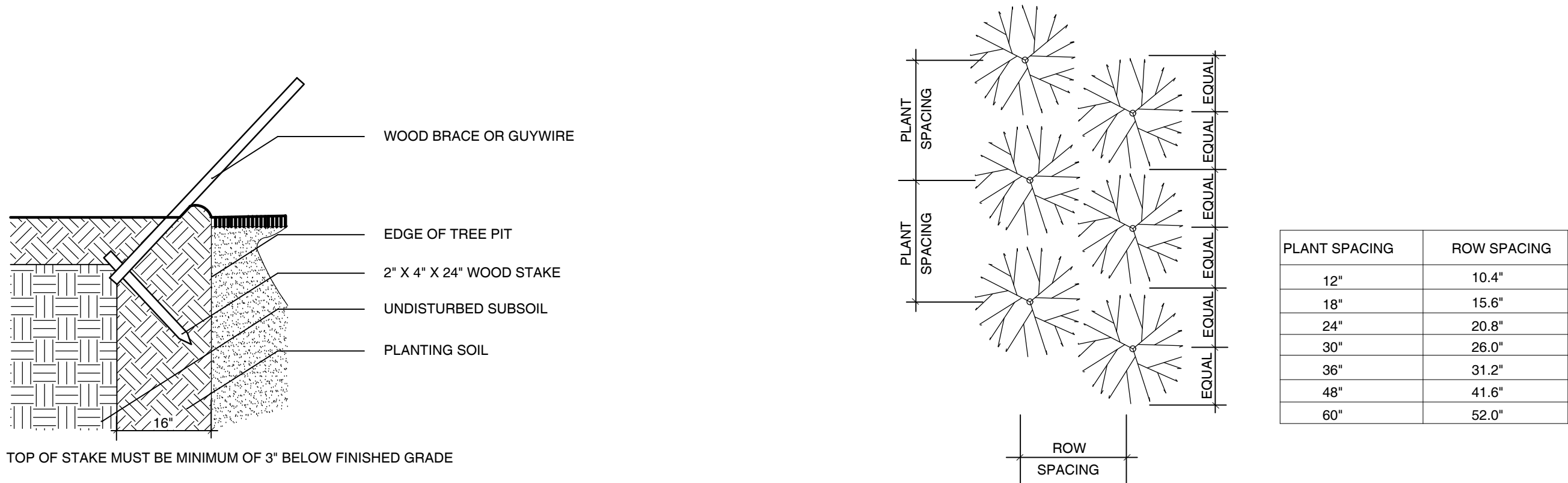

1 STAKING DETAIL  
SCALE: NOT TO SCALE

PREPARATION:  
STORE ALL MATERIAL IN DRY, CLEAN AREA, COVER TO PROTECT FROM RAIN AND MINIMIZE DUST. COORDINATE RUN-OFF CONTROL WITH GENERAL CONTRACTOR.  
TEST EXISTING SOIL TO ENSURE IT IS FREE OF EXCESSIVE CLAY OR SALT AND ANY CHEMICALS/PETROCHEMICALS WHICH MAY HARM PLANT HEALTH.

EXISTING MATERIAL:  
IF INCORPORATING EXISTING SITE SOIL REMOVE ALL ROOTS, AND ROCK LARGER THAN 2" IN SIZE. REMOVE ALL PLASTIC, METAL AND MANMADE DETRITUS.

MIX:  
50% EXISTING SOIL  
10% COCO PEAT  
10% COMPOST  
20% CLEAN SAND  
10% PERLITE

BLEND QUANTITIES NEEDED BY HAND OR MACHINE.

INSTALLATION:  
REFER TO APPROPRIATE DETAILS FOR AMENDMENTS, COMPACTION DEPTHS ETC.

GENERAL: REFER TO LANDSCAPE NOTES FOR ADDITIONAL INFORMATION

4 PLANTING SOIL- TYPICAL

MULCH A:  
PINE STRAW, FOR USE IN GENERAL PLANTING AREAS AND ON SLOPES GREATER THAN 10%

MULCH B:  
MINI PINE BARK NUGGETS, FOR USE IN SPECIALTY AREAS

MULCH C:  
MELALEUCA MULCH, FOR USE IN GENERAL PLANTING AREAS AND ON SLOPES GREATER THAN 10%

BLEND QUANTITIES NEEDED BY HAND OR MACHINE.

INSTALLATION:  
REFER TO APPROPRIATE DETAILS FOR EXTENTS AND DEPTHS.

GENERAL: REFER TO LANDSCAPE NOTES FOR ADDITIONAL INFORMATION, CONFIRM TYPE TO BE USED WITH LANDSCAPE ARCHITECT PRIOR TO INSTALLATION.

5 MULCH- TYPICAL

MIX:  
# 5050- MUCK AND FINE SAND

SUPPLIER: ATLAS PEAT AND SOIL 561.734.7300

6 PLANTING SOIL- LAWN TOP DRESSING

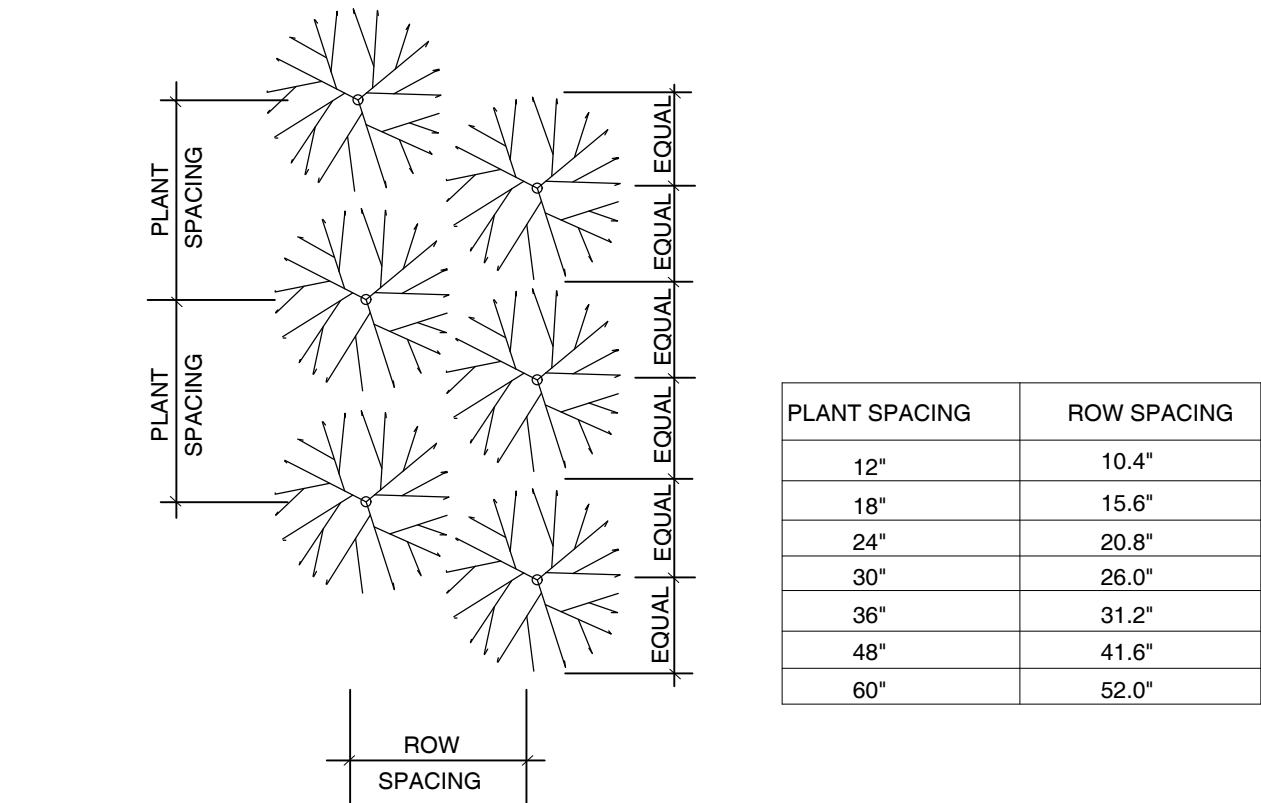

2 PLANT SPACING  
SCALE: NOT TO SCALE

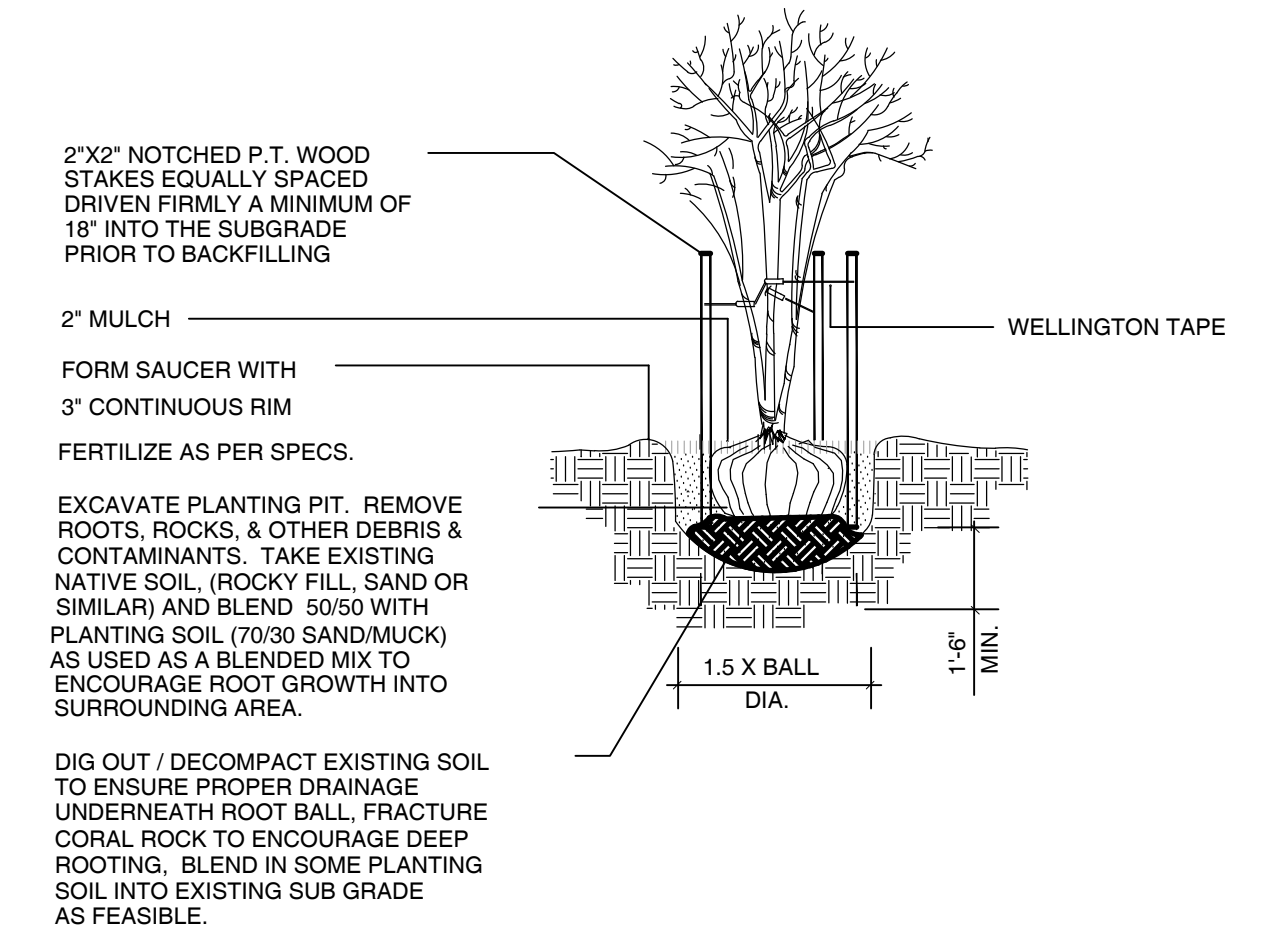

7 MULTI TRUNK TREE- PLANTNG & STAKING  
SCALE: NOT TO SCALE

CALIPER	TIES	STRANDS	STAKES
1" - 1 1/2"	2	1 # 12	2 - 2 X 2
1 1/2" - 2"	3	1 # 12	3 - 2 X 2
2" - 3"	3	2 # 12	2 - 2 X 2

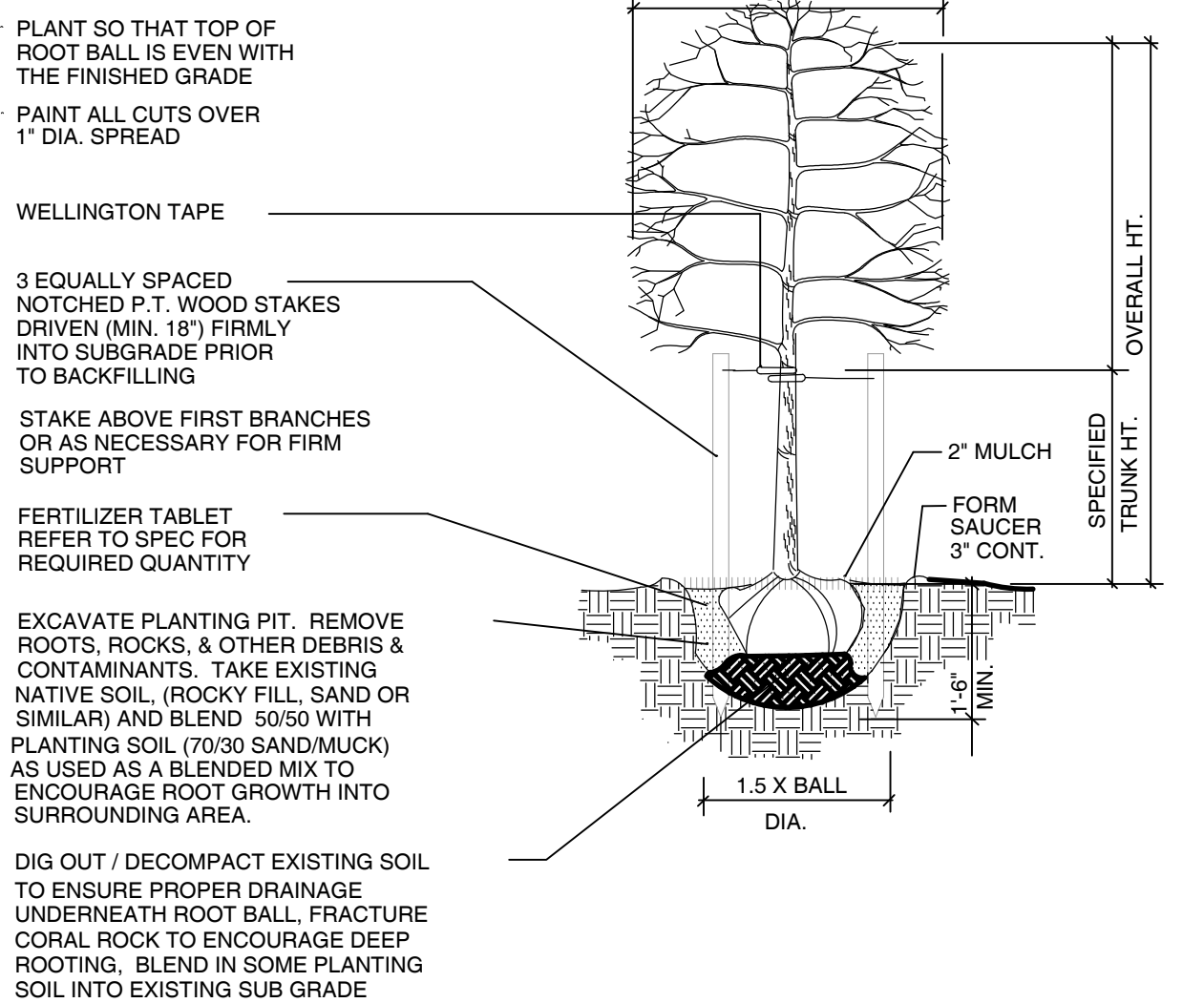

NOTE:  
USE FOR 3" OR LESS SINGLE STEM TREES & PALMS

10 CANOPY AND PALM TREE- PLANTING & VERTICAL STAKING  
SCALE: NOT TO SCALE

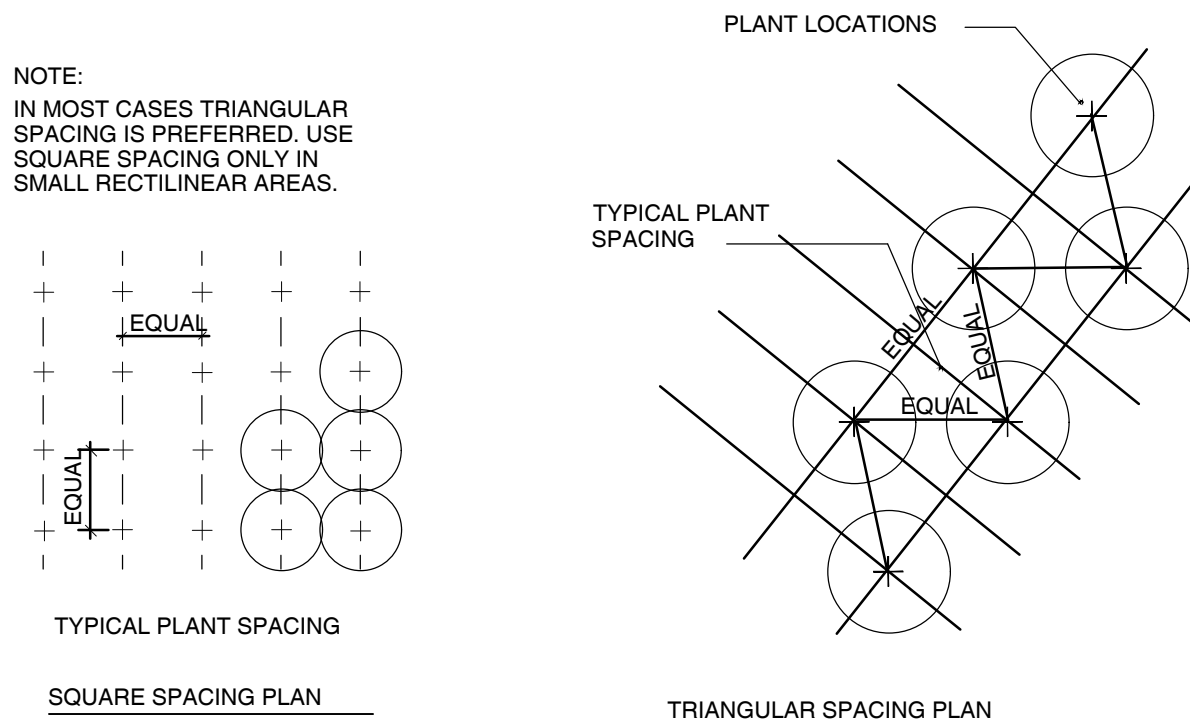

8 SHRUB- HEDGE AND MASS PLANTING  
SCALE: NOT TO SCALE

CALIPER	CLEATS	STRAPS	BRACES	NAILS
3" - 8"	2 x 4 x 8"	1 # 12	3 - 2 X 4	2 - 16d
8" - 10"	2 x 4 x 12"	1 # 12	3 - 2 X 4	3 - 16d
10" - 16"	2 x 4 x 12"	2 # 12	4 - 2 X 4	3 - 16d

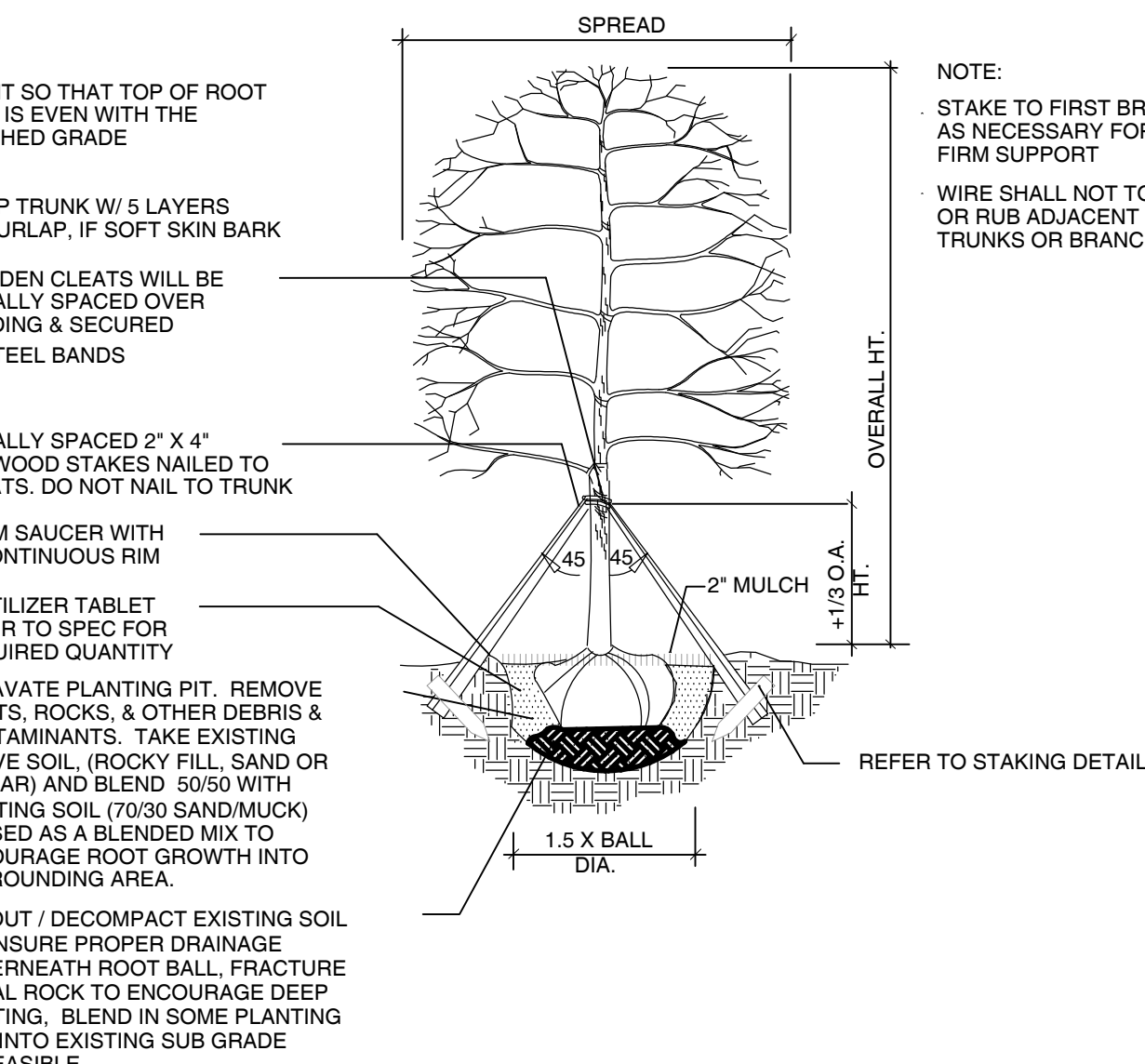

NOTE:  
USE FOR 3" TO 12" SINGLE TRUNK TREES

11 CANOPY TREE- PLANTING & TRIPLE BRACE STAKING  
SCALE: NOT TO SCALE

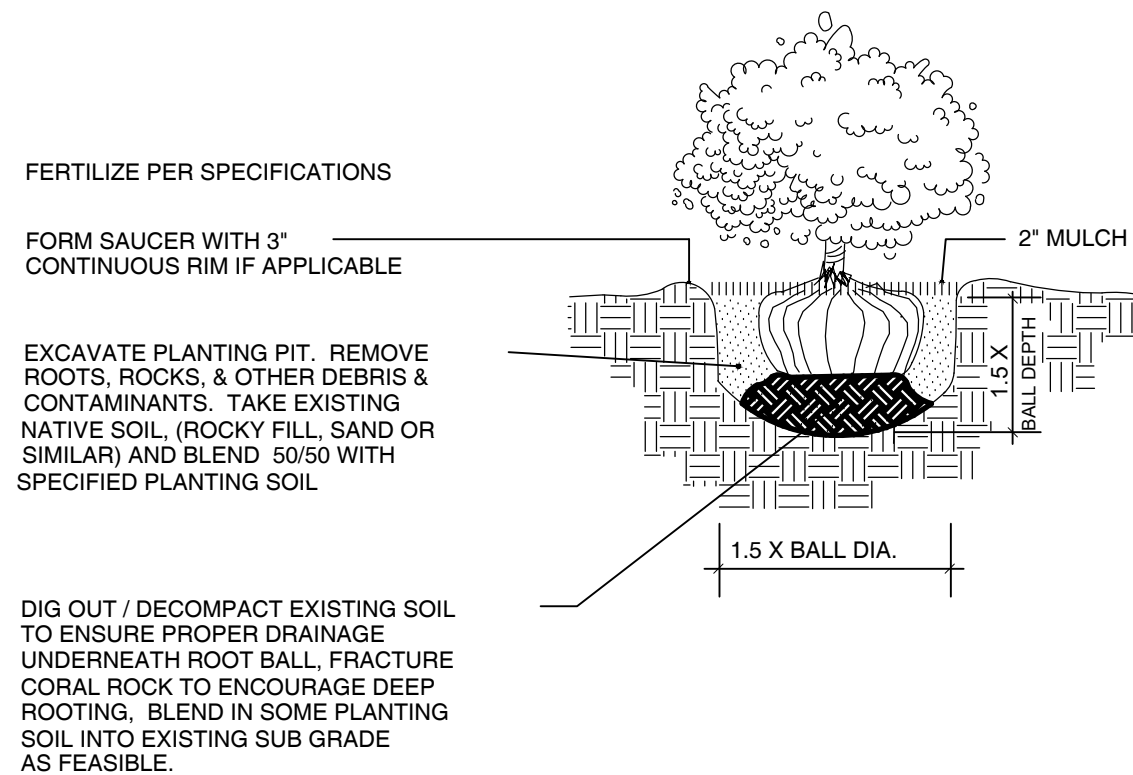

3 SHRUB PLANTING  
SCALE: NOT TO SCALE

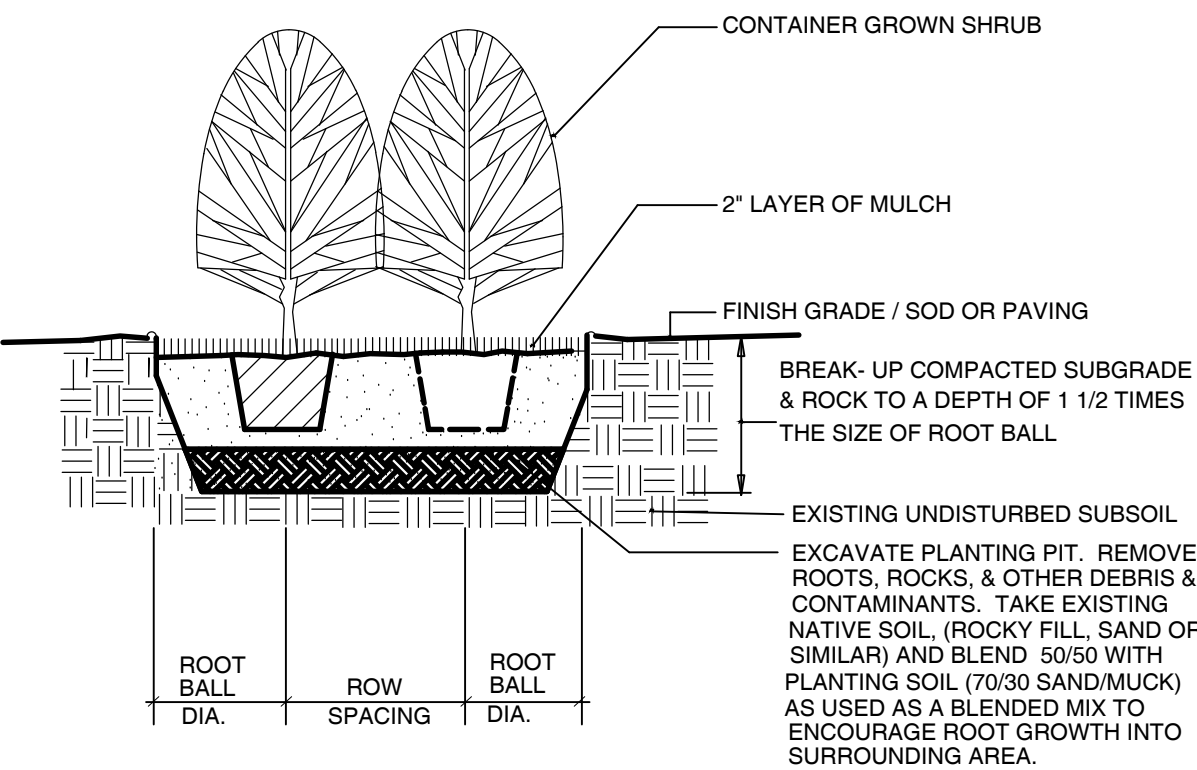

9 SHRUB- HEDGE AND MASS PLANTING  
SCALE: NOT TO SCALE

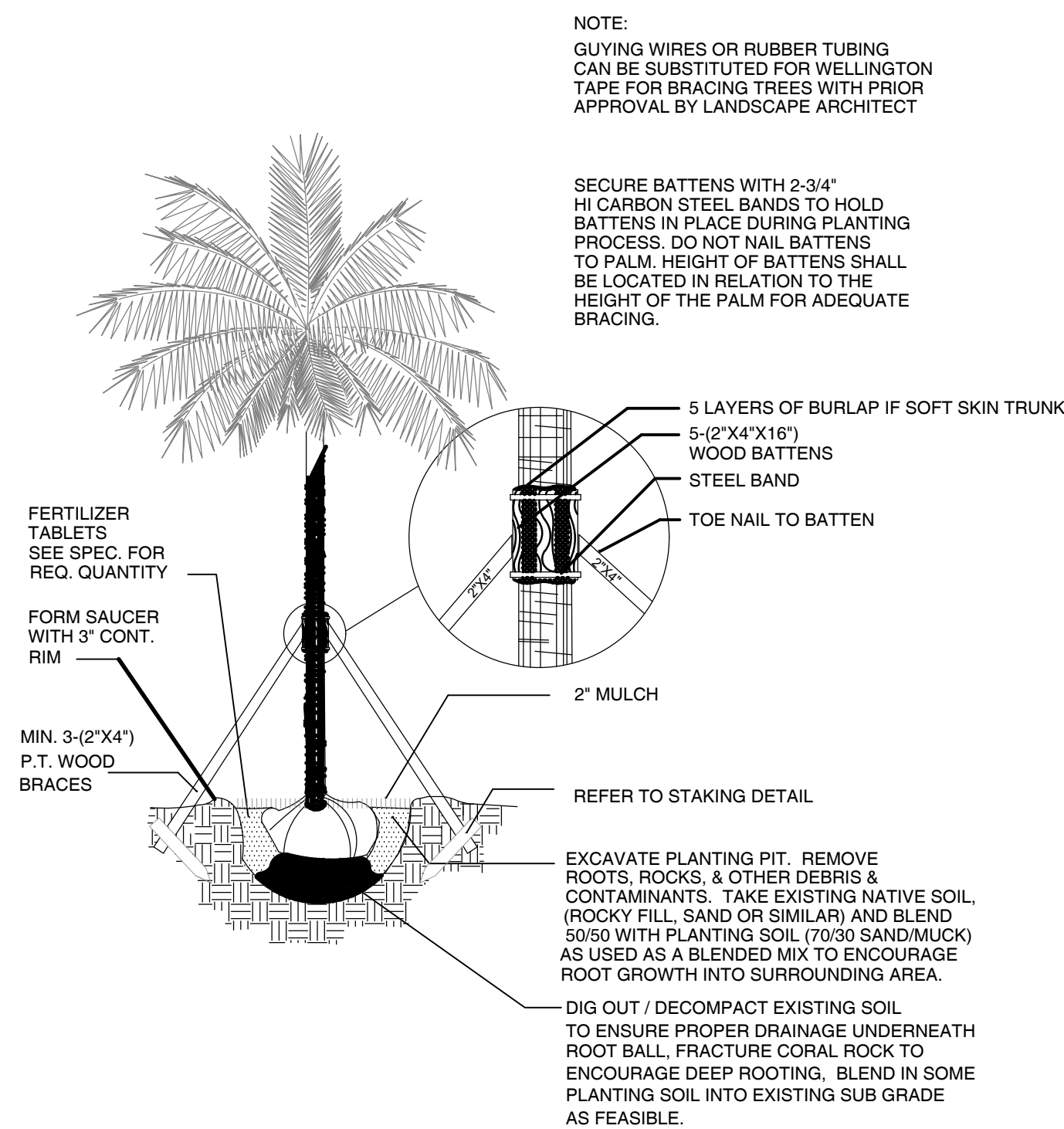

12 PALM- PLANTING & STAKING  
SCALE: NOT TO SCALE

